

Terms of Use: NOTICE: This is a dated, archived document that does not represent current mining claim activity in Ontario. This archived document is provided for information purposes only and MNDM and the Government of Ontario accept no liability and make no warranty or any representation regarding the use, accuracy, applicability, completeness, performance, availability, security or reliability of the information. *This archive "Historical Claim Map" does not meet provincial accessibility standards. If you need accessible formats, communication support or would like information about this map please contact the Provincial Recording Office @ 1-888-415-9845 Ext 5784. For current mining claim status, please use the MNDM online claim maps website at: <http://www.mndm.gov.on.ca/en/mines-and-minerals/applications/claimaps>

3036

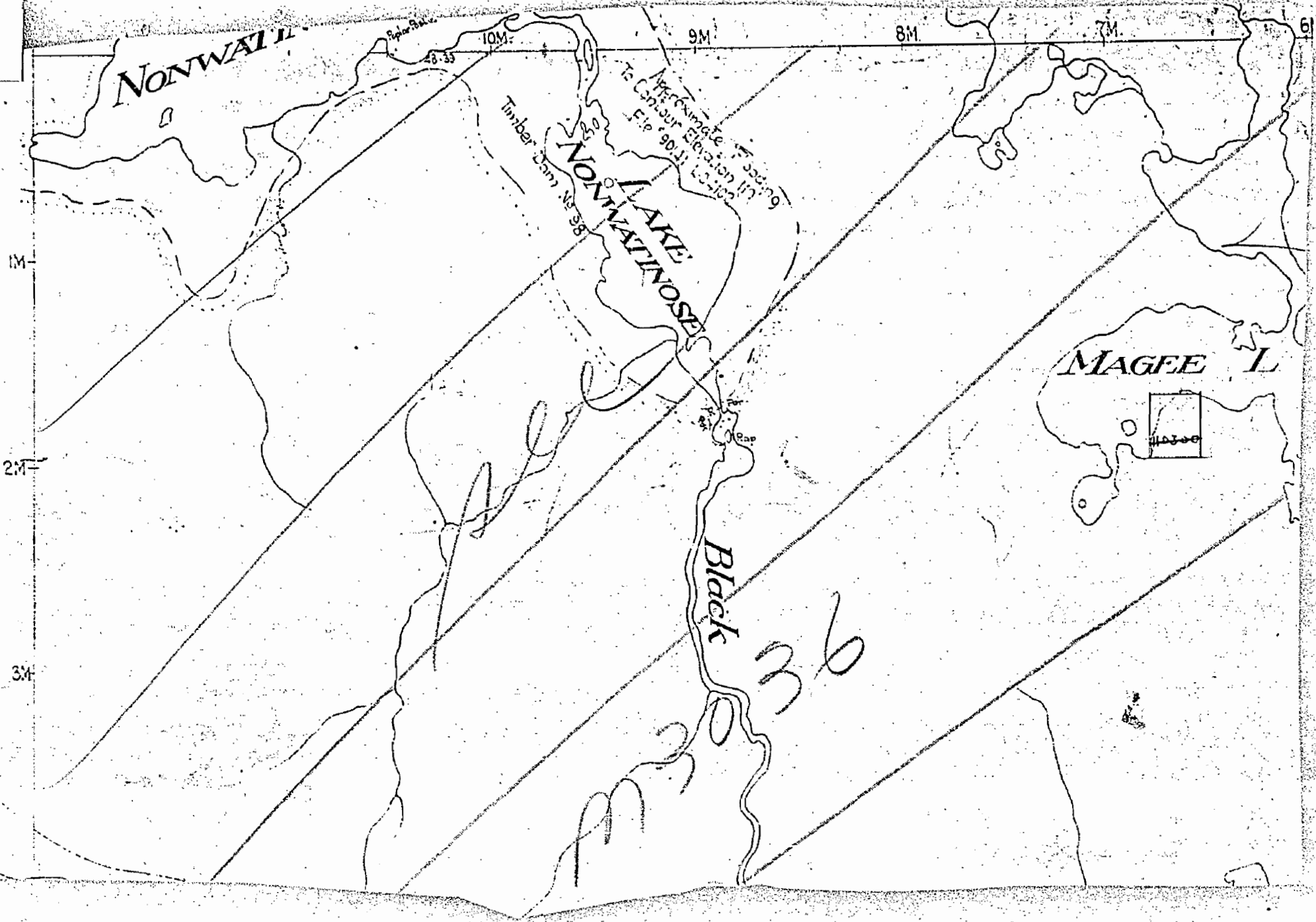

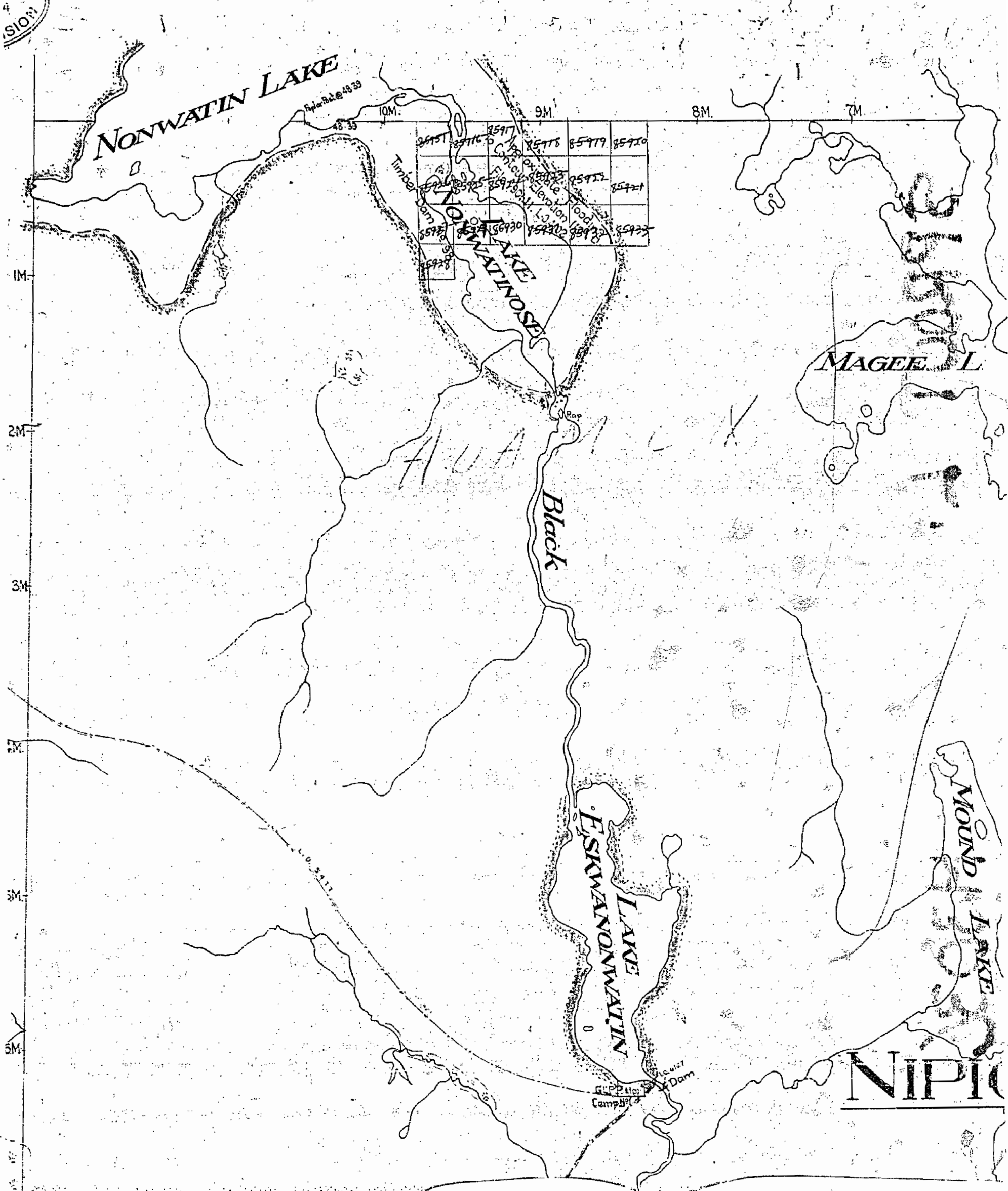

AREA OF
**SPROUT LAKE
 AND
 ADAMSON TWP.**
 DISTRICT OF
 THUNDER BAY
 THUNDER BAY
 MINING DIVISION
 SCALE: 1-INCH = 40 CHAINS

LEGEND

- PATENTED LAND Ⓟ
- CROWN LAND SALE Ⓢ
- LEASES Ⓛ
- LOCATED LAND Ⓛ
- LICENSE OF OCCUPATION Ⓛ
- MINING RIGHTS ONLY Ⓛ
- SURFACE RIGHTS ONLY Ⓛ
- ROADS Ⓛ
- IMPROVED ROADS Ⓛ
- KING'S HIGHWAYS Ⓛ
- RAILWAYS Ⓛ
- POWER LINES Ⓛ
- MARSH OR MUSKEG Ⓛ
- MINES Ⓛ
- CANCELLED Ⓛ

NOTES

400' Surface Rights Reservation around
 all lakes and rivers

Flooding
 Flooding rights on Eskwanonwatin Lake and
 Black Sturgeon River LO 4102, File 9014

Approximate flooding to contour elevation 410'
 on Nonwatin and Nonwatinose Lakes shown
 thus

Little Sturge Lake - M.3025

Purdom Twp. & Area north of - M.1870

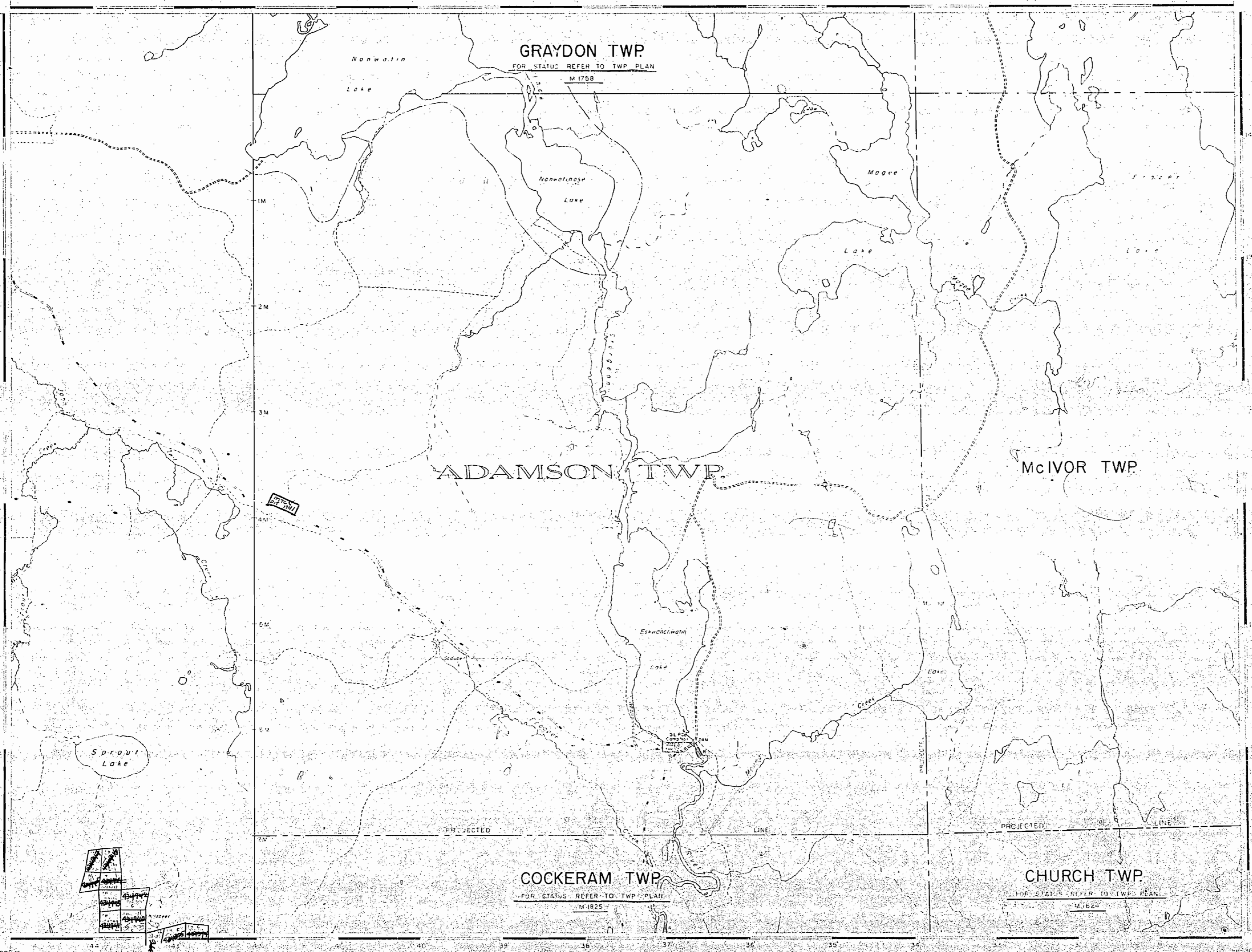

1971
 T. J. THORNTON
 + J. THORNTON

NIP.

NATIONAL TOPOGRAPHIC SERIES 52 H2

PLAN NO. **M.3036**

ONTARIO
 DEPARTMENT OF MINES
 AND NORTHERN AFFAIRS

3036

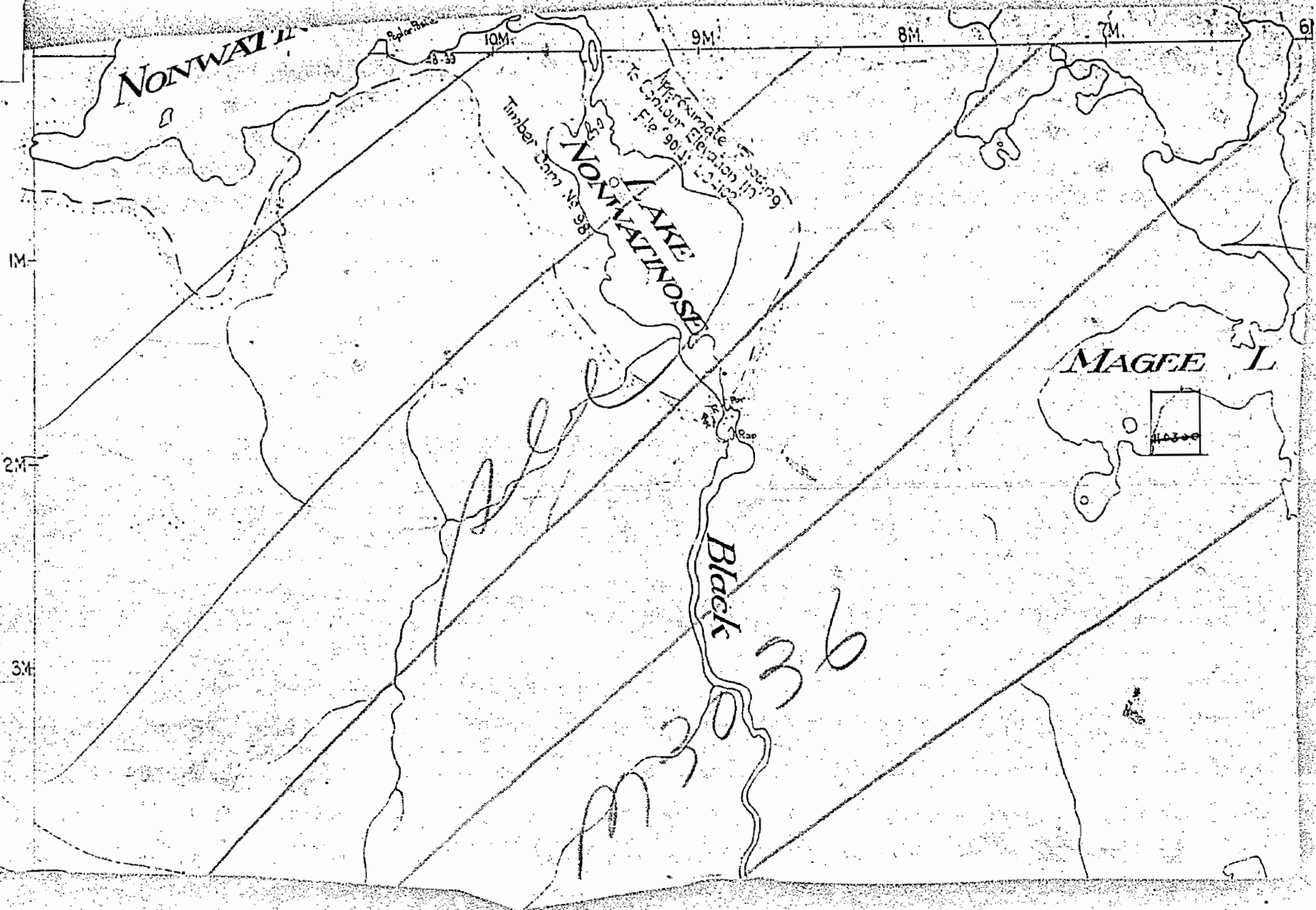

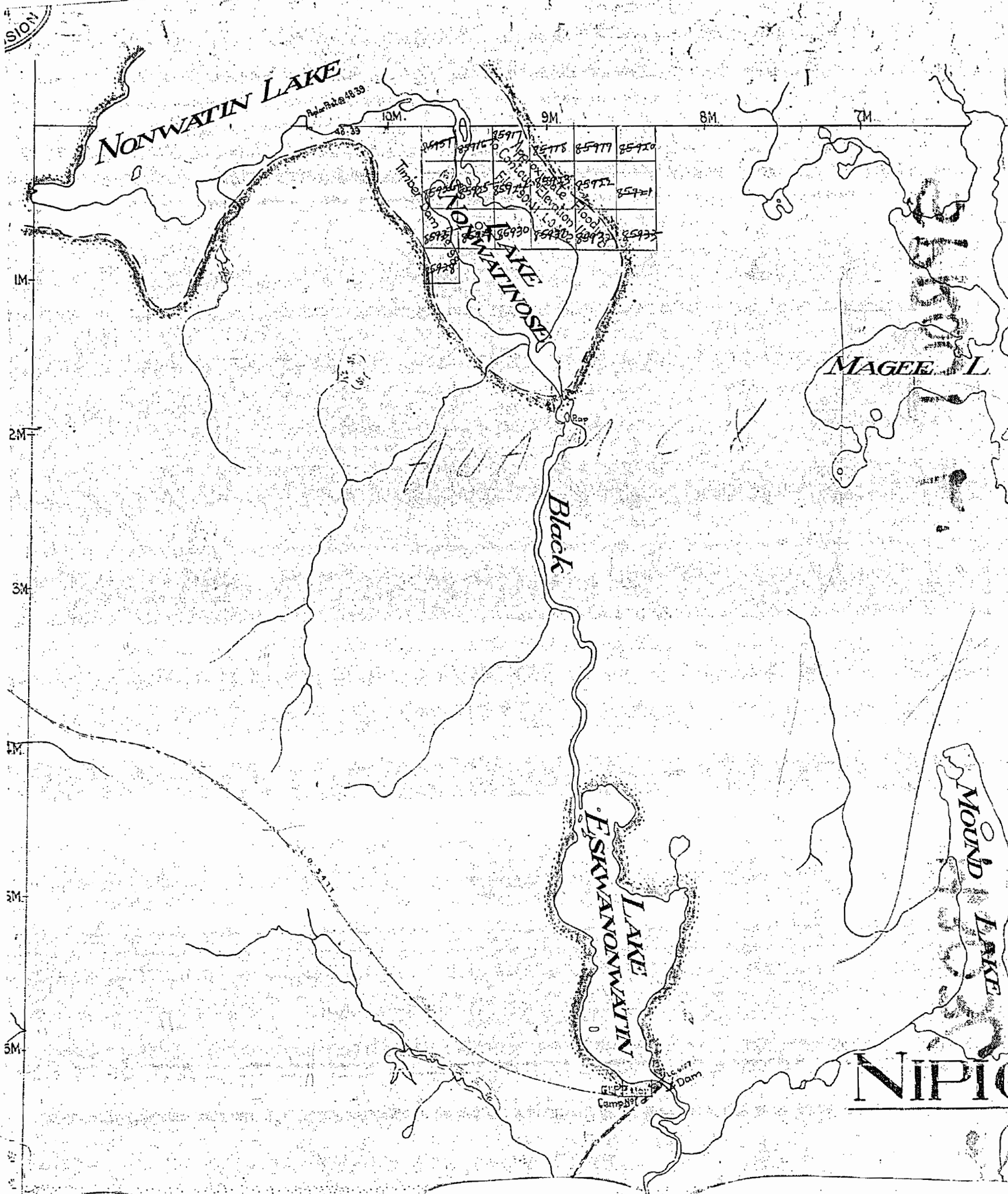

NIPIC

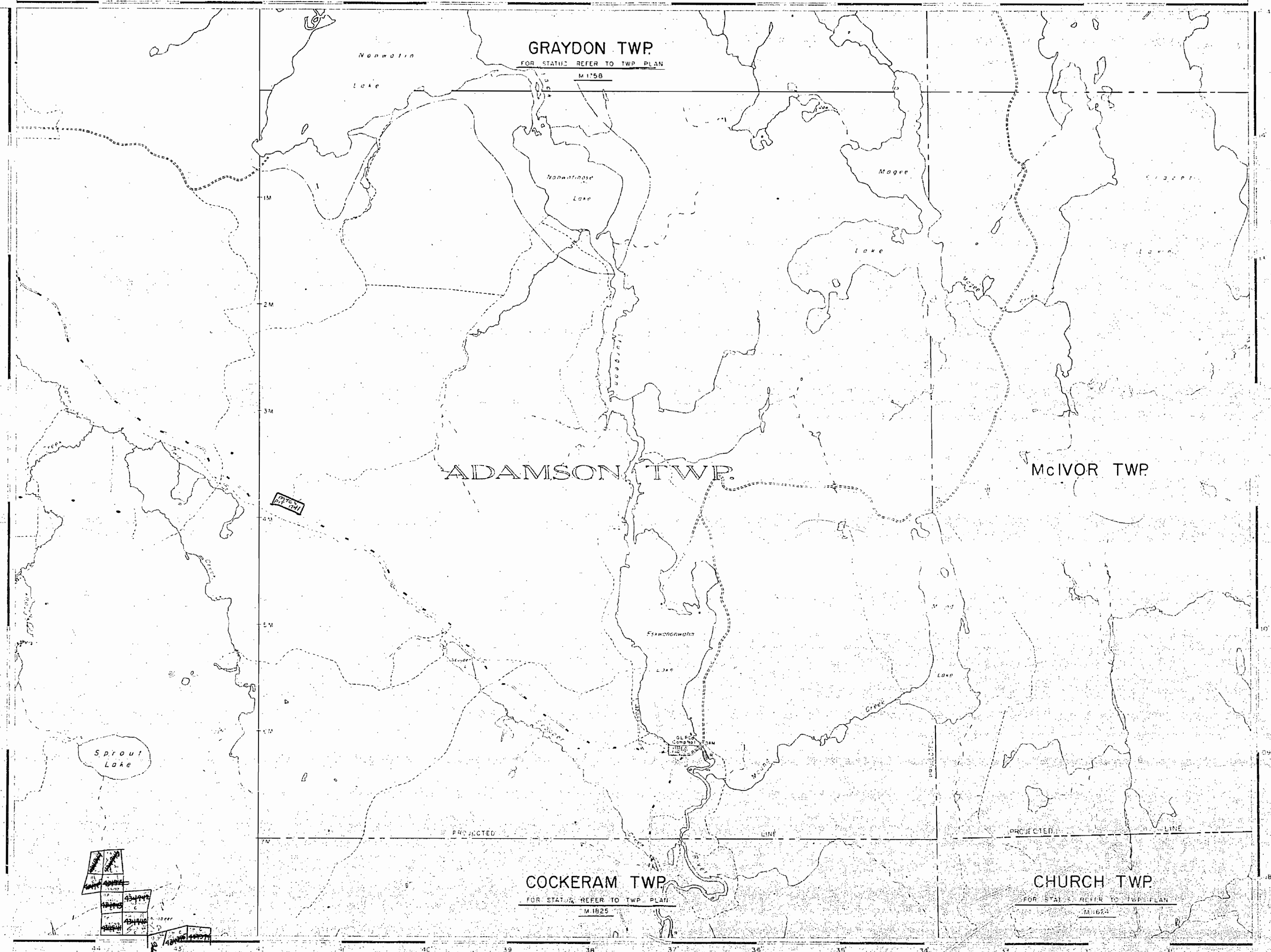

AREA OF
**SPROUT LAKE
 AND
 ADAMSON TWP.**
 DISTRICT OF
 THUNDER BAY
 THUNDER BAY
 MINING DIVISION
 SCALE: 1-INCH = 40 CHAINS

LEGEND

| | |
|------------------------|---|
| PATENTED LAND | Ⓢ |
| CROWN LAND SALE LEASES | Ⓢ |
| LOCATED LAND | Ⓢ |
| LICENSE OF OCCUPATION | Ⓢ |
| MINING RIGHTS ONLY | Ⓢ |
| SURFACE RIGHTS ONLY | Ⓢ |
| ROADS | Ⓢ |
| IMPROVED ROADS | Ⓢ |
| KING'S HIGHWAYS | Ⓢ |
| RAILWAYS | Ⓢ |
| POWER LINES | Ⓢ |
| MARSH OR MUSKEG | Ⓢ |
| MINES | Ⓢ |
| CANCELLED | Ⓢ |

NOTES

4/20 Surface Rights Reservation around all lakes and rivers

Flooding
 Flooding rights on Eskwanonwata Lake and Big Sturgeon River LO 4102, File 90141

Approximate flooding to contour elevation on Nonwatin and Nonwatnose Lakes shown thus

1971
 T. J. THORNTON
 NIP.
 NATIONAL TOPOGRAPHIC SERIES 52 H2
 PLAN NO. M.3036

Graydon Lake - M.3039

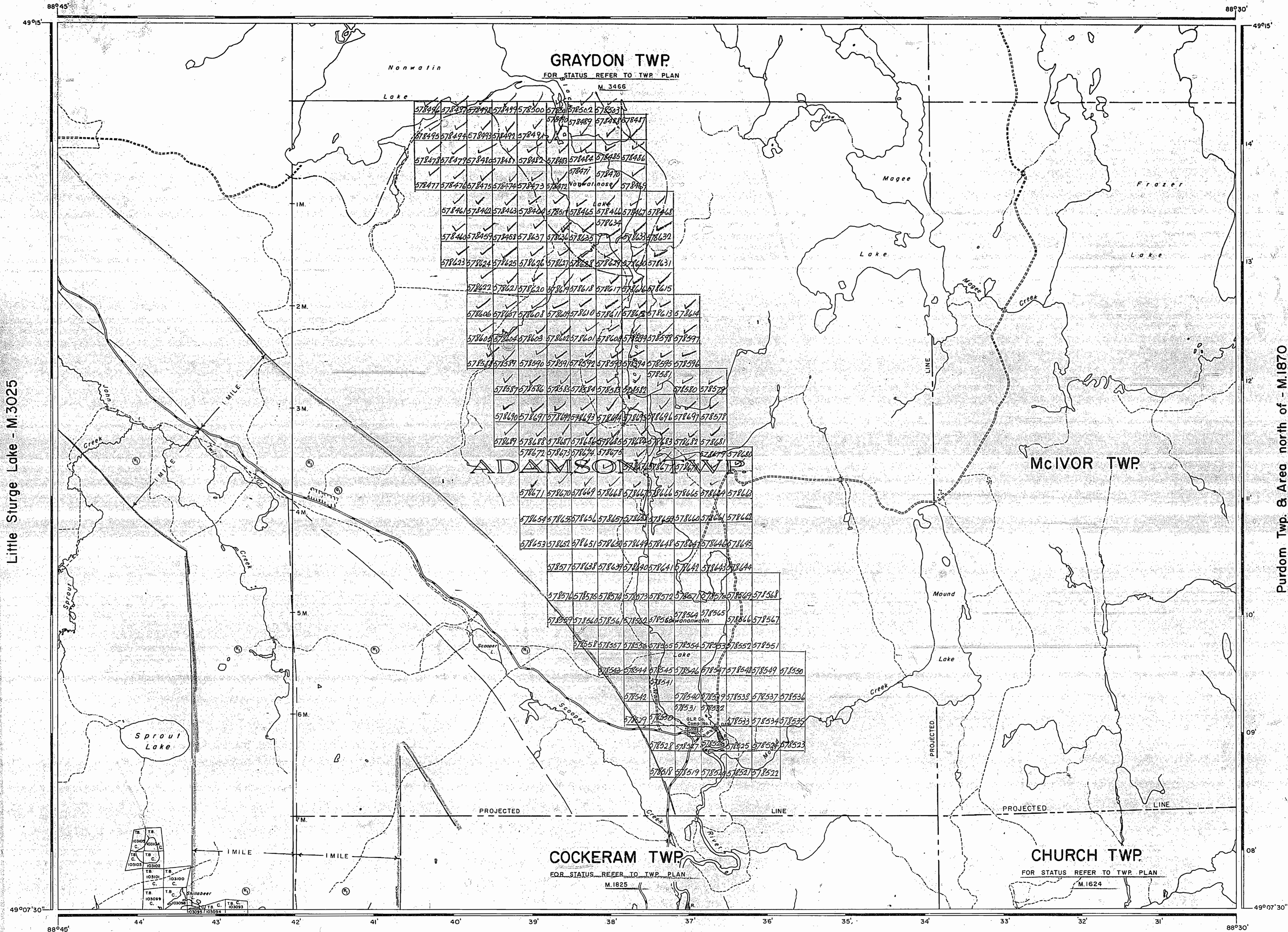

AREA OF
**SPROUT LAKE
AND
ADAMSON TWP.**
DISTRICT OF
THUNDER BAY

THUNDER BAY
MINING DIVISION

SCALE: 1-INCH = 40 CHAINS

LEGEND

| | |
|-----------------------|--------|
| PATENTED LAND | Ⓟ |
| CROWN LAND SALE | C.S. |
| LEASES | Ⓛ |
| LOCATED LAND | Loc. |
| LICENSE OF OCCUPATION | L.O. |
| MINING RIGHTS ONLY | M.R.O. |
| SURFACE RIGHTS ONLY | S.R.O. |
| ROADS | — |
| IMPROVED ROADS | — |
| KING'S HIGHWAYS | — |
| RAILWAYS | — |
| POWER LINES | — |
| MARSH OR MUSKEG | — |
| MINES | — |
| CANCELLED | C. |

NOTES

400' Surface Rights Reservation around all lakes and rivers.

Flooding
Flooding rights on Eskwanowatin Lake and Black Sturgeon River L.O. 4102, File: 90141

Approximate flooding to contour elev. 110' on Nonwatin and Nonwatinose Lakes shown thus: —

AREAS WITHDRAWN FROM DISPOSITION

| | | | | |
|-----------------------|----------------------|---------|-------------|--------|
| S.R. — SURFACE RIGHTS | M.R. — MINING RIGHTS | | | |
| Description | Order No. | Date | Disposition | File |
| Ⓟ W3/80 | | 18/2/80 | SRO | 188538 |

SAND & GRAVEL

Ⓟ M.T.C. GRAVEL PIT No. 20-31

NIDIGON DIST. 2008/80
NATIONAL TOPOGRAPHIC SERIES 52 H2

PLAN NO. **M.3036**

ONTARIO
MINISTRY OF NATURAL RESOURCES
SURVEYS AND MAPPING BRANCH

Shillaber Lake - M.3035