

ALANEN TP.

M.1572
G.7594

NOTE: Part of this township is covered by "Unexpl. Pros. Pit Permit # 1245" Abitibi-Price Inc. (See file for details) (Tp. 32; R. 28)

Revised by G. 1596
March 1962

THUNDER

BAY

MINING DIVISION.

Notes: ① Surface Rights Only are withdrawn from staking - See order # W 4184-Wawa dated Feb 1/62.

DISTRICT OF ALGOMA.

Scale, 40 chains to an inch.

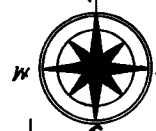

VASILOFF TP. M.1597

80.00 35 M 80.00 34 M 80.00 33 M 80.00 32 M 80.00 31 M 80.00

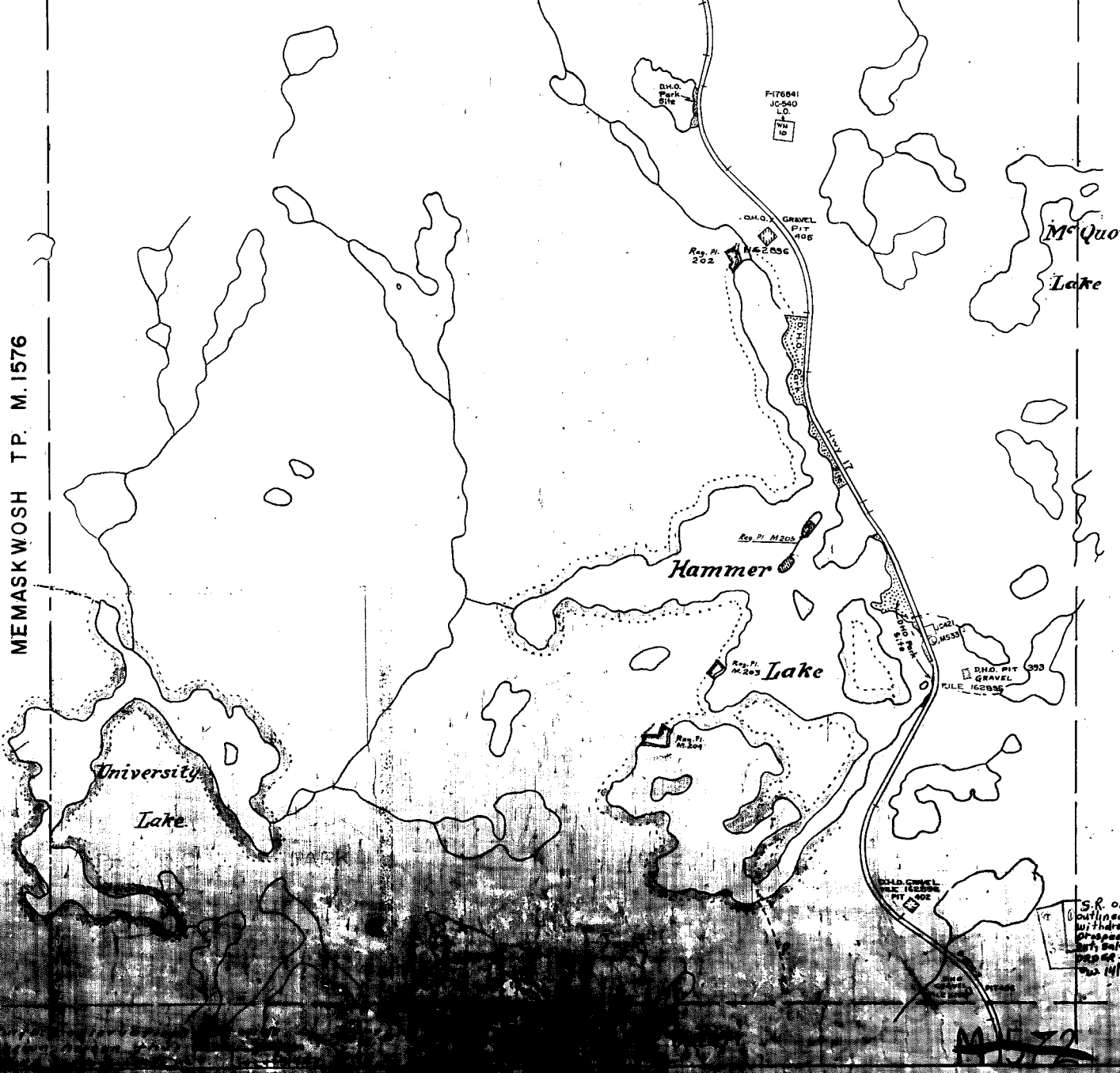

MEMASKWOSH TP. M. 1576

ASHLEY TP. M. 1590

S.R. only of area outlined in red is withdrawn from prospecting, staking and sale of leases. See Section 11 of M.A. Act.

6 4 2 1 2 4 6

REFERENCES

AREAS WITHDRAWN FROM DISPOSITION

M.R.O. - MINING RIGHTS ONLY
 S.R.O. - SURFACE RIGHTS ONLY
 M.+S. - MINING AND SURFACE RIGHTS

Description	Order No.	Date	Disposition	File
W 14/81		20/10/81	S.R.O.	
W 4/82		1/2/82	S.R.O.	188545

SAND AND GRAVEL

M.T.C. PIT 403	FILE	182896
M.T.C. PIT 393	FILE	182896
M.T.C. PIT 402	FILE	182896
M.T.C. PIT 466	FILE	182896
M.T.C. PIT 276	FILE	182896

RESERVE - ONE-HALF MILE WIDE STRIP ON EACH SIDE OF HIGHWAY #17, JULY 21, 1980 File # 163006

THE INFORMATION THAT APPEARS ON THIS MAP HAS BEEN COMPILED FROM VARIOUS SOURCES, AND ACCURACY IS NOT GUARANTEED. THOSE WISHING TO STAKE MINING CLAIMS SHOULD CONSULT WITH THE MINING RECORDER, MINISTRY OF NORTHERN DEVELOPMENT AND MINES, FOR ADDITIONAL INFORMATION ON THE STATUS OF THE LANDS SHOWN HEREON.

The 1985 Magnetic Bearing Approx. $2'W$ Annual Change Increasing $6'$

S. S. MARIE
 MINING DIV.
RECEIVED
 MAR 13 1985
 AN 9, 10, 11, 12, 1, 2, 3, 4, 5, 6

VASILOFF TWP

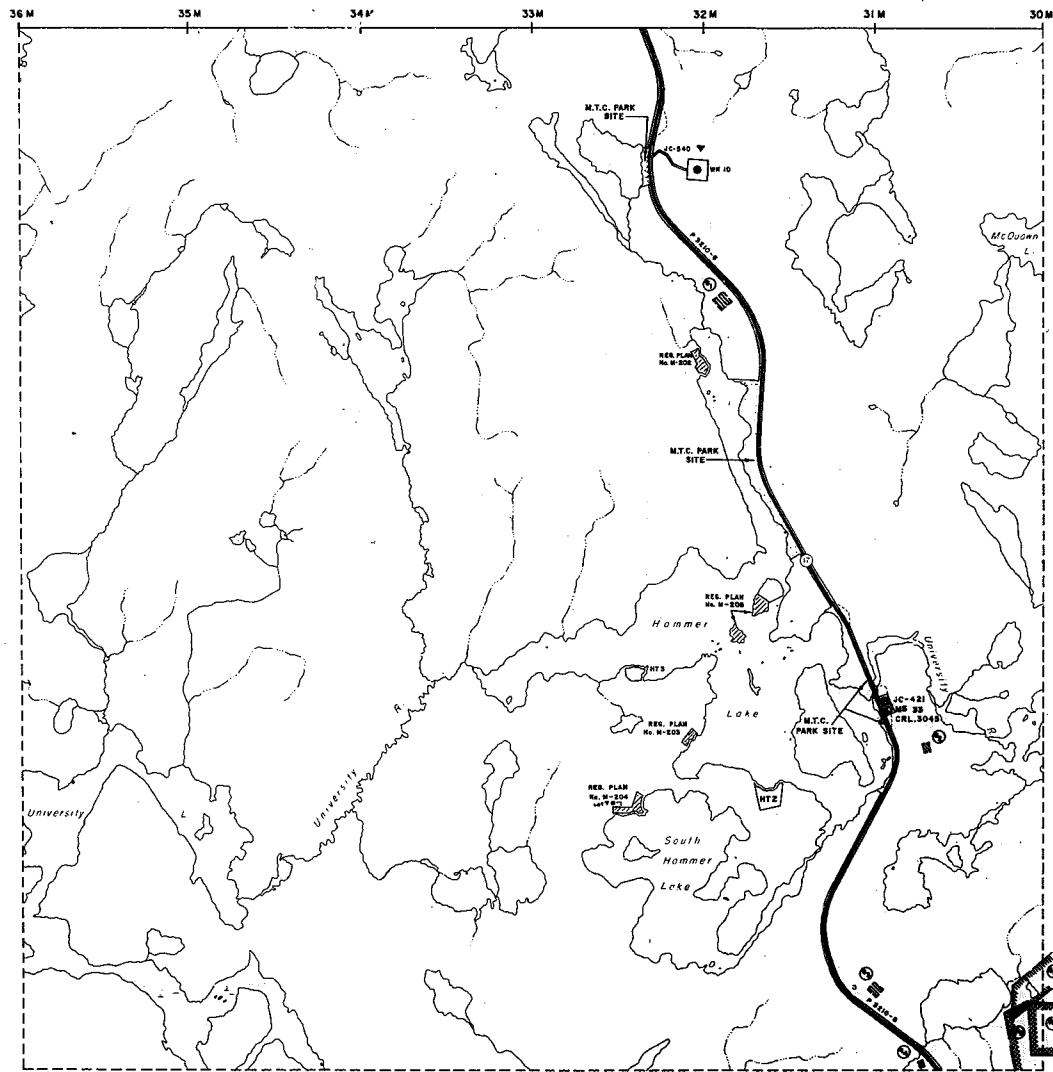

CHAPAI TWP

LEGEND

HIGHWAY AND ROUTE No.	
OTHER ROADS	
TRAILS	
SURVEYED LINES:	
TOWNSHIPS, BASE LINES, ETC.	
LOTS, MINING CLAIMS, PARCELS, ETC.	
UNSURVEYED LINES:	
LOT LINES	
PARCEL BOUNDARY	
MINING CLAIMS ETC.	
RAILWAY AND RIGHT OF WAY	
UTILITY LINES	
NON-PERENNIAL STREAM	
FLOODING OR FLOODING RIGHTS	
SUBDIVISION OR COMPOSITE PLAN	
RESERVATIONS	
ORIGINAL SHORELINE	
MARCH OR MUSKEG	
MINES	
TRAVERSE MONUMENT	

DISPOSITION OF CROWN LANDS

TYPE OF DOCUMENT	SYMBOL
PATENT, SURFACE & MINING RIGHTS	
" SURFACE RIGHTS ONLY	
" MINING RIGHTS ONLY	
LEASE, SURFACE & MINING RIGHTS	
" SURFACE RIGHTS ONLY	
" MINING RIGHTS ONLY	
LICENCE OF OCCUPATION	
ORDER-IN-COUNCIL	
RESERVATION	
CANCELLED	
SAND & GRAVEL	

NOTE: MINING RIGHTS IN PARCELS PATENTED PRIOR TO MAY 6, 1912, VESTED IN ORIGINAL PATENTEE BY THE PUBLIC LANDS ACT, R.S.O. 1979, CHAP. 306, SEC. 62, SUBSEC. 1.

SCALE: 1 INCH = 40 CHAINS

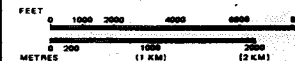

TOWNSHIP

ALANEN

M.N.R. ADMINISTRATIVE DISTRICT

WAWA

MINING DIVISION

SAULT STE. MARIE

LAND TITLES / REGISTRY DIVISION

ALGOMA



Ministry of Natural Resources
 Land Management Branch

Date: OCTOBER 1984

Number
G-1596

ONTARIO

MINISTRY OF NATURAL RESOURCES
SURVEYS AND MAPPING BRANCH

G.1596
~~M.1572~~

ALANEN TP.

(Tp. 32, R.28)

THUNDER

BAY

MINING DIVISION

DISTRICT OF ALGOMA.

Scale, 40 chains to an inch.

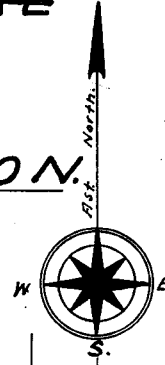

VASILOFF TP. M.1597

80.00 35.47 80.00 34.47 80.00 33.47 80.00 32.47 80.00 31.47 80.00

MEMASKWOSH TP. M.1576

McQuown
Lake

Aug. 25/76

ASHLEY TP. M.1590

Hammer

Lake

University
Lake

WHITE RIVER
DISTRICT

6 4 2 1 2 4 6