

NOTES

ATTAWAPISKAT RIVER G-1447

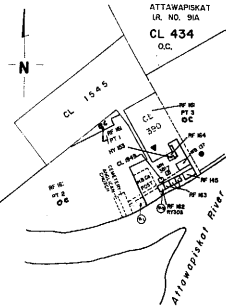
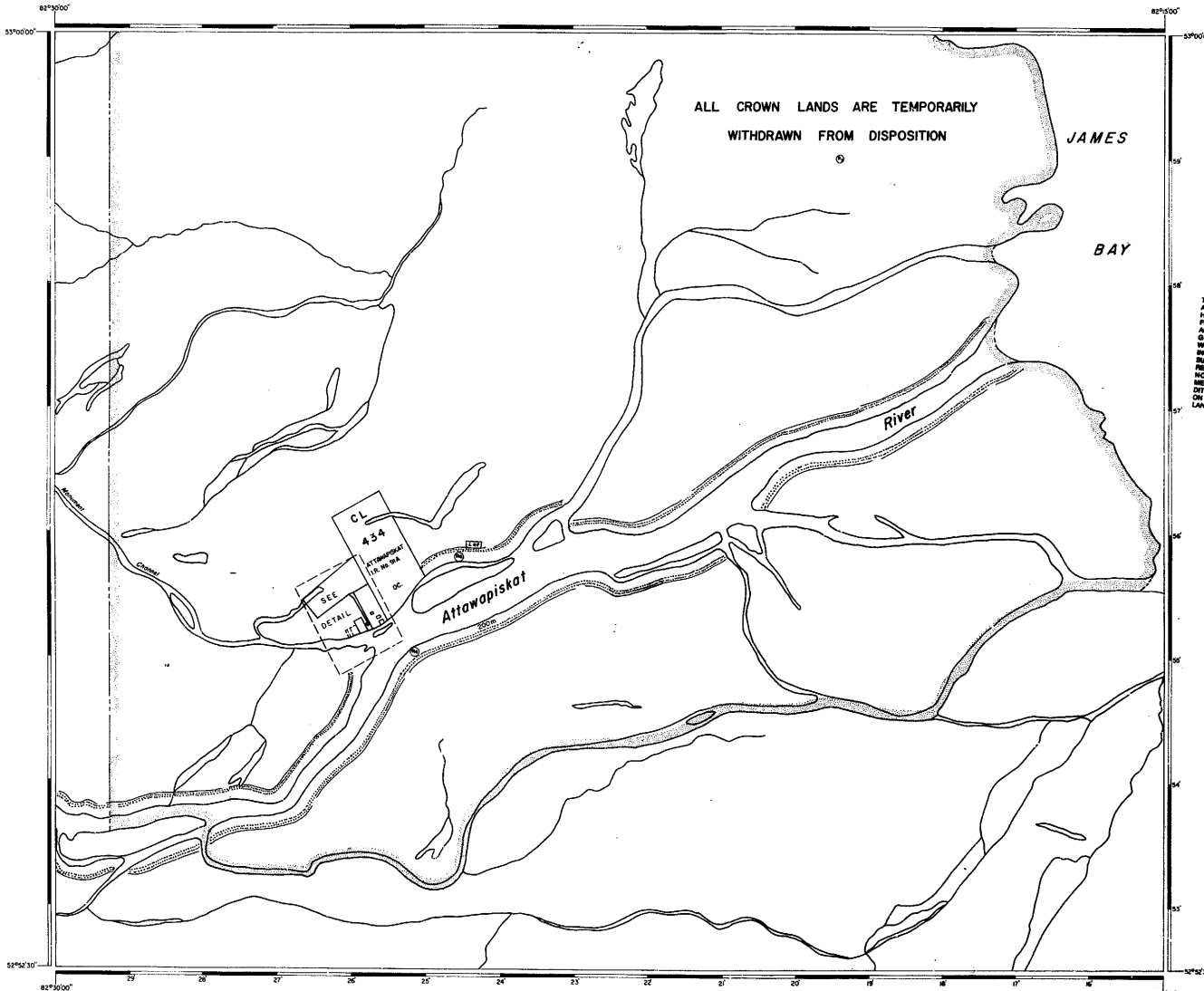

DETAIL  
SCALE: 1 INCH = 40 CHAINS

**REFERENCES**

**AREAS WITHDRAWN FROM DISPOSITION**

M.R.O. - MINING RIGHTS ONLY  
S.R.O. - SURFACE RIGHTS ONLY  
M+S. - MINING AND SURFACE RIGHTS

Description	Order No.	Date	Disposition	File
MNR				159305
Public Use	18/7643			154584
CROWN RESERVE	W42/72	20/4/72	20.01	16,400
SEC. 43	W21/79	21/1/79	SRMR	158226

**LEGEND**

THE INFORMATION THAT APPEARS ON THIS MAP HAS BEEN COMPILED FROM RECORDS SOURCED AND ACCURACY IS NOT GUARANTEED. THOSE DESIRING TO OBTAIN THE CLAIMS SHOULD CONSULT WITH THE MINING RECORDS, MINISTRY OF NORTHERN DEVELOPMENT AND MINES, FOR ADDITIONAL INFORMATION ON THE STATUS OF THE LANDS SHOWN HEREON.

Symbol	Description
—	HIGHWAY AND ROUTE NO.
—	OTHER ROADS
—	TRAILS
—	SURVEYED LINES
—	TOWNSHIPS, BASE LINES, ETC.
—	LOTE MINING CLAIM, PARCELS, ETC.
—	UNSURVEYED LINES
—	LOT LINES
—	PARCEL BOUNDARY
—	MINING CLAIMS ETC.
—	RAILWAY AND RIGHT OF WAY
—	UTILITY LINES
—	NON-PERMANENT STREAM
—	FLOODING OR FLOODING RIGHTS
—	SUBDIVISION OR COMPOSITE PLAN
—	RESERVATIONS
—	ORIGINAL SHORELINE
—	BARREN OR BARREN
—	MINES
+	TRAVERSE MONUMENT

**DISPOSITION OF CROWN LANDS**

TYPE OF DOCUMENT	SYMBOL
PATENT, SURFACE & MINING RIGHTS	○
— SURFACE RIGHTS ONLY	○
— MINING RIGHTS ONLY	○
LEASE, SURFACE & MINING RIGHTS	□
— SURFACE RIGHTS ONLY	□
— MINING RIGHTS ONLY	□
LICENSE OF OCCUPATION	▽
ORDER-IN-COUNCIL	OC
RESERVATION	○
CANCELLED	○
SAND & GRAVEL	○

NOTE: MINING RIGHTS IN PARCELS PATENTED PRIOR TO MAY 1, 1971, VEST IN ORIGINAL PATENTEE BY THE PUBLIC LANDS ACT, R.S.O. 1970, CHAP. 280, SEC. 61, SUBSEC. 1.

SCALE: 1 INCH = 40 CHAINS

FEET: 0 1000 2000 3000 4000

METRES: 0 1000 2000 3000 4000

2000 June 29/83

**AREA**

**ATTAWAPISKAT**

M.S.B. ADMINISTRATIVE DISTRICT  
**MOOSONEE**

MINING DIVISION  
**PORCUPINE**

LAND TITLES / RESERVATIONS / RESERVATIONS  
**KENORA**  
**PATRICIA PORTION**

Ministry of Natural Resources  
Land Management Branch

DATE: JANUARY, 1983

G-1446

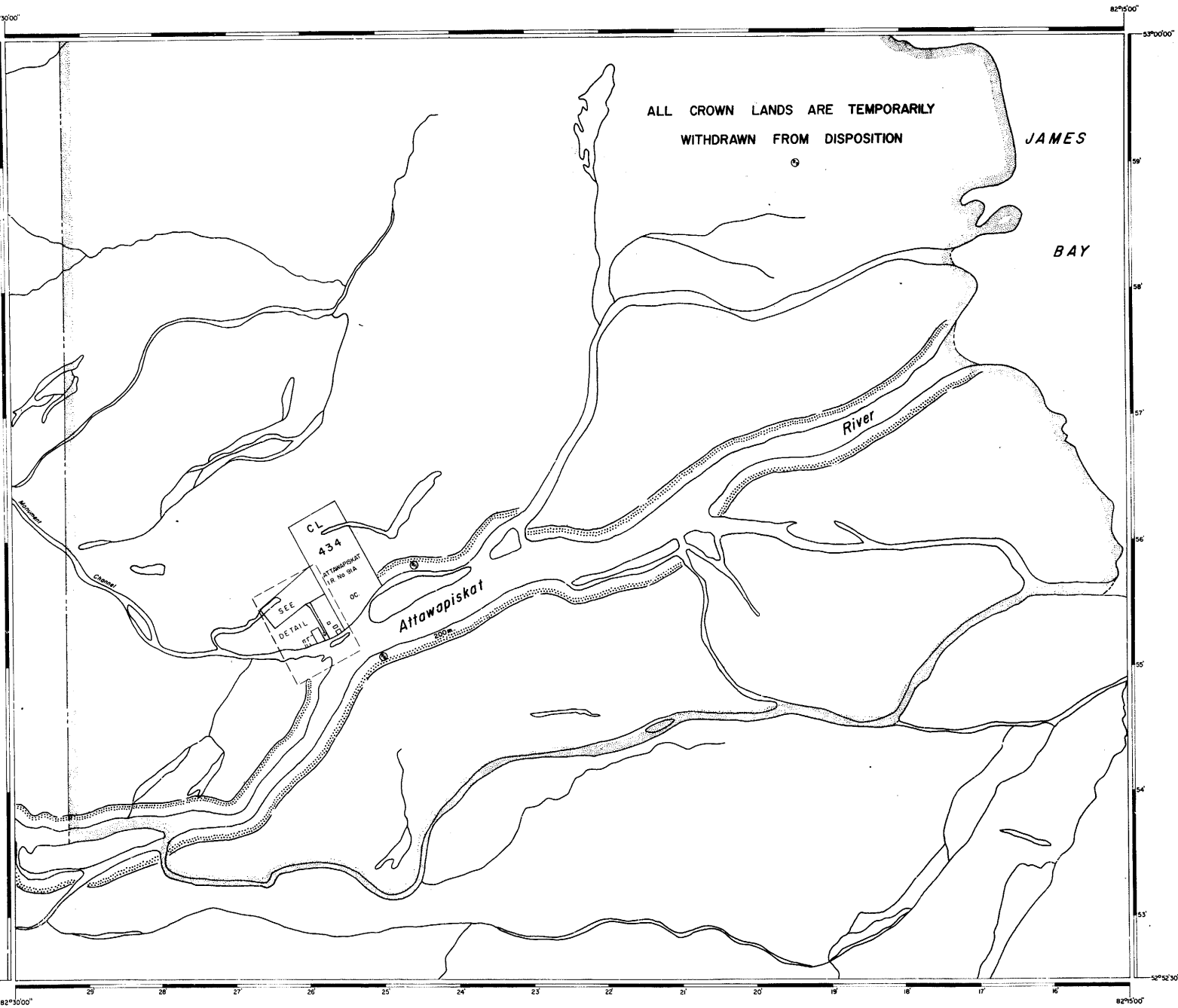

ALL CROWN LANDS ARE TEMPORARILY  
WITHDRAWN FROM DISPOSITION

JAMES  
BAY

River

Attawapiskat

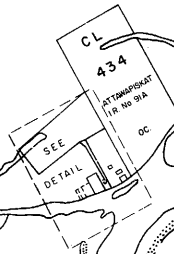

**NOTE**  
THIS PLAN HAS BEEN PREPARED FROM DATA BELIEVED TO BE RELIABLE AT THE TIME OF COMPLETION, HOWEVER, LAND DISPOSITION, THE POSITION AND STATUS OF MINING CLAIMS, TOWNSHIP FABRIC AND OTHER SURVEY INFORMATION DISPLAYED ON THE PLAN IS NOT GUARANTEED. TO ENSURE MAXIMUM ACCURACY, ADDITIONAL CHECKS SHOULD BE MADE IN THE MINING RECORDER'S OFFICE, LAND REGISTRY OFFICE, ETC.

**LEGEND**

- HIGHWAY AND ROUTE No.
- OTHER ROADS
- TRAILS
- SURVEYED LINES:
  - TOWNSHIPS, BASE LINES, ETC.
  - LOTS, MINING CLAIMS, PARCELS, ETC.
- UNSURVEYED LINES:
  - LOT LINES
  - PARCEL BOUNDARY
  - MINING CLAIMS, ETC.
- RAILWAY AND RIGHT OF WAY
- UTILITY LINES
- NON-PERENNIAL STREAM
- FLOODING OR FLOODING RIGHTS
- SUBDIVISION
- ORIGINAL SHORELINE
- MARSH OR MUSKEG
- MINES
- RESERVATIONS

**DISPOSITION OF CROWN LANDS**

TYPE OF DOCUMENT	SYMBOL
PATENT, SURFACE & MINING RIGHTS	●
" SURFACE RIGHTS ONLY	○
" MINING RIGHTS ONLY	◐
LEASE, SURFACE & MINING RIGHTS	■
" SURFACE RIGHTS ONLY	◼
" MINING RIGHTS ONLY	▼
LICENCE OF OCCUPATION	CS
CROWN LAND SALE	OC
ORDER-IN-COUNCIL	⊙
RESERVATION	⊖
CANCELLED	⊕
SAND & GRAVEL	⊗

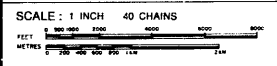

ACRES	HECTARES
40	16

AREA Replaced Area 25/83

**ATTAWAPISKAT**

DISTRICT  
KEMORA PATRICIA PORTION  
MINING DIVISION

**PORCUPINE**  
Dec 71, 13/80

Ministry of Natural Resources  
Ontario Surveys and Mapping Branch

Date: DECEMBER 15, 1977 Plan No.  
National Topographical Series 43B  
**M. 3451**

NOTES

400' surface rights reservation along the shores of all lakes and rivers.

AREAS WITHDRAWN FROM DISPOSITION

S.R. - SURFACE RIGHTS      M.R. - MINING RIGHTS

Description	Order No.	Date	Disposition	File
① M.N.R.				158305
② Public Use		19/8/63		164584
③ Crown Reserve	W.42/73	31/8/73	SR MR	185909
④ Sec. 43	W.21/79	21 Nov. '79	SR, MR	188526

82°30'00"  
53°00'00"

ATTAWAPISKAT RIVER M-3446

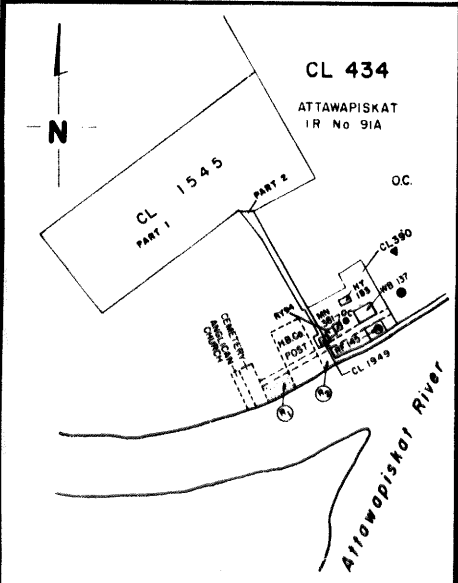

DETAIL  
SCALE 1 INCH = 20 CHAINS