

AUBREY

DISTRICT OF KENORA
KENORA MINING DIVISION
Scale - 40 Chains - 1 inch

M.1944

MINISTRY OF NATURAL RESOURCES
SURVEYS AND MAPPING BRANCH

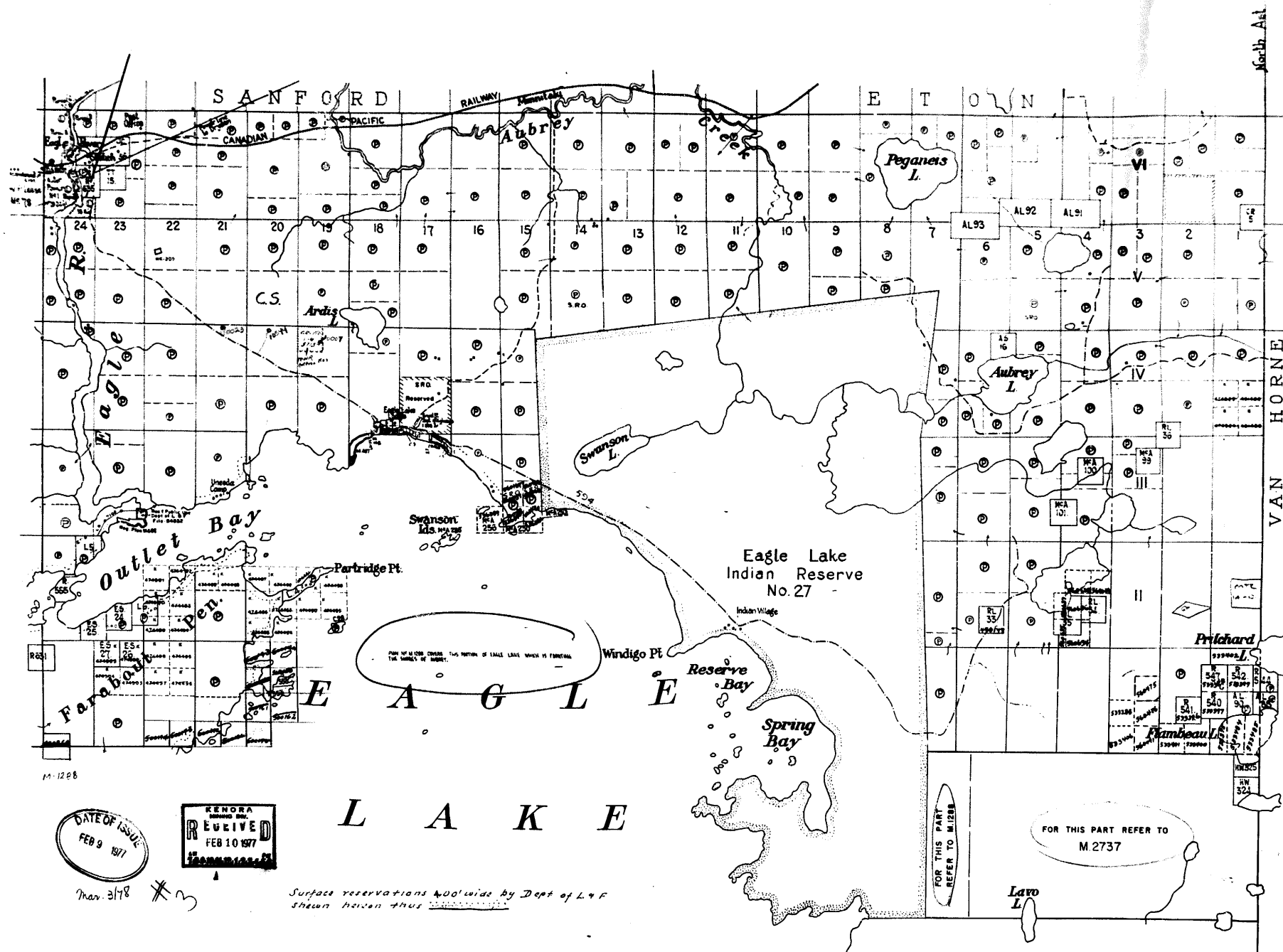

AUBREY

KENORA MG. DIV.
DISTRICT OF KENORA

Scale - 40 Chains - 1 inch

The easterly part of the south part of broken lot #15 in the 3rd Concession of the said Township of Aubrey being mining claim K.863 containing 42 acres more or less described as follows: Commencing at the southeast angle of the said broken lot, thence north along the east limit of the lot, 20 chains to the southeast angle of that portion of the said lot heretofore granted by patent to Wm. Gibson on November 23, 1911, thence west astronomically along the south limit of the lot so granted 14 chains; thence south parallel with the east limit of the lot 10 chains more or less to the highwater mark of the shore of Eagle Lake; thence northeasterly following the highwater mark along the shore of the said lake to the point of commencement.

In good standing.



NOTE.
SW 40th Lot 5 Con. 5 & 5 1/2
Lot 2 Con. 6 - Sand & Gravel
returned to Dept of Highways.

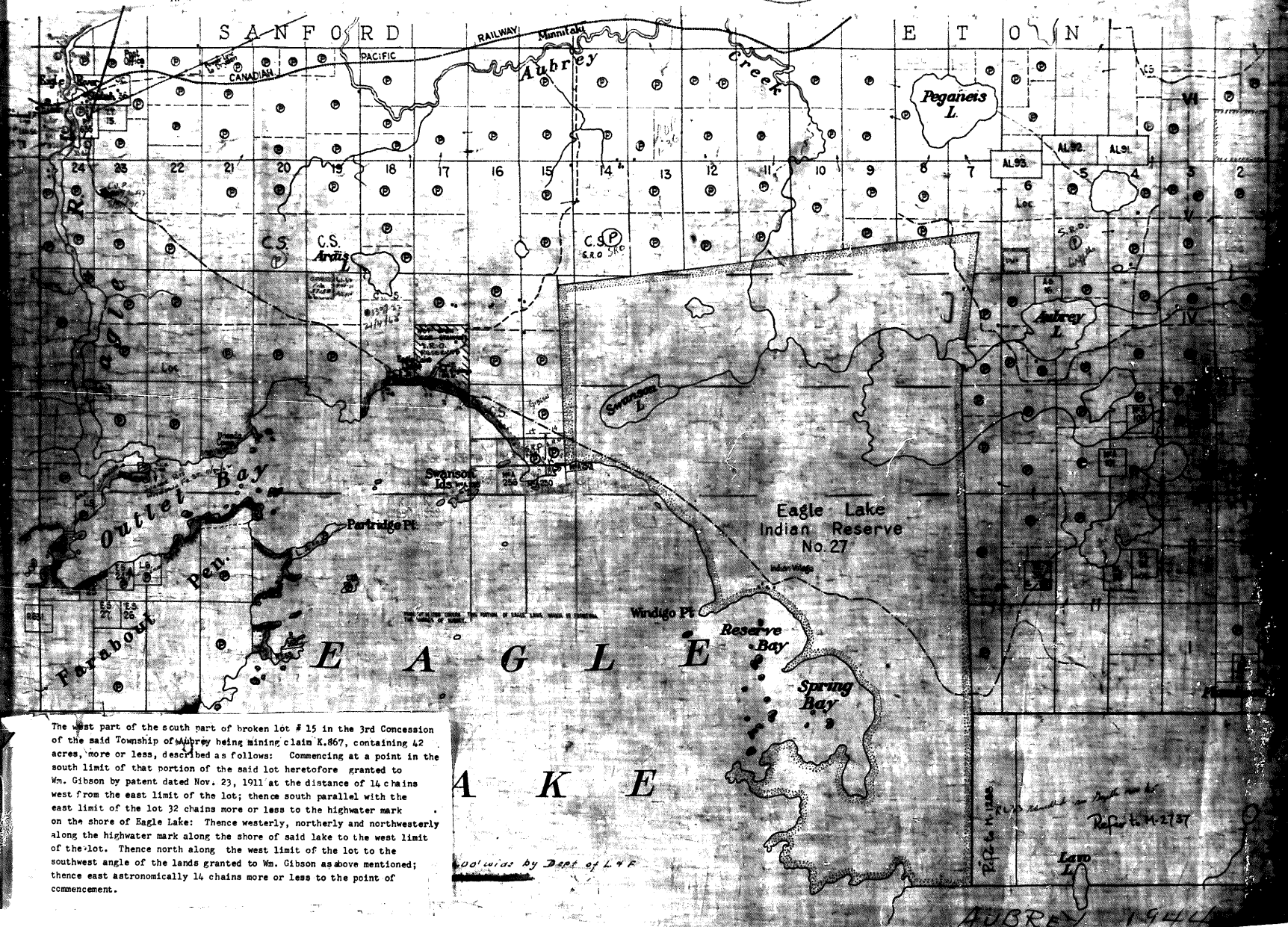

The west part of the south part of broken lot # 15 in the 3rd Concession of the said Township of Aubrey being mining claim K.867, containing 42 acres, more or less, described as follows: Commencing at a point in the south limit of that portion of the said lot heretofore granted to Wm. Gibson by patent dated Nov. 23, 1911 at the distance of 14 chains west from the east limit of the lot; thence south parallel with the east limit of the lot 32 chains more or less to the highwater mark on the shore of Eagle Lake; Thence westerly, northerly and northwesterly along the highwater mark along the shore of said lake to the west limit of the lot. Thence north along the west limit of the lot to the southwest angle of the lands granted to Wm. Gibson as above mentioned; thence east astronomically 14 chains more or less to the point of commencement.

A K E

Map made by Dept of L & F

AUBREY 1944

1944

AUBREY

DISTRICT OF KENORA

Scale - 40 Chains - 1 Inch



S^h Lot 17 Con. 4 SRO withdrawn from staking
48, 1955 - See RES-A- 12/7/62 (15295)
S^h Lot 23. Con. 3 Res. Public Land Use
11/27/62 (129.1) RES.A.

NOTE.
SW 40 of Lot 6 Con 5 & 5^h
Lot 2 Con 6 - Sand & Gravel
reserved to Dept of Highways.

The easterly part of the south part of broken lot #15 in the 3rd Concession of the said Township of Aubrey being mining claim K.863 containing 42 acres more or less described as follows: Commencing at the southeast angle of the said broken lot, thence north along the east limit of the lot, 20 chains to the southeast angle of that portion of the said lot heretofore granted to patent to Wm. Gibson on November 23, 1911, thence west astronomically along the south limit of the lot so granted 14 chains; thence south parallel with the east limit of the lot 32 chains more or less to the highwater mark of the shore of Eagle Lake; thence northeasterly following the highwater mark along the shore of the said lake to the point of commencement.

In good state

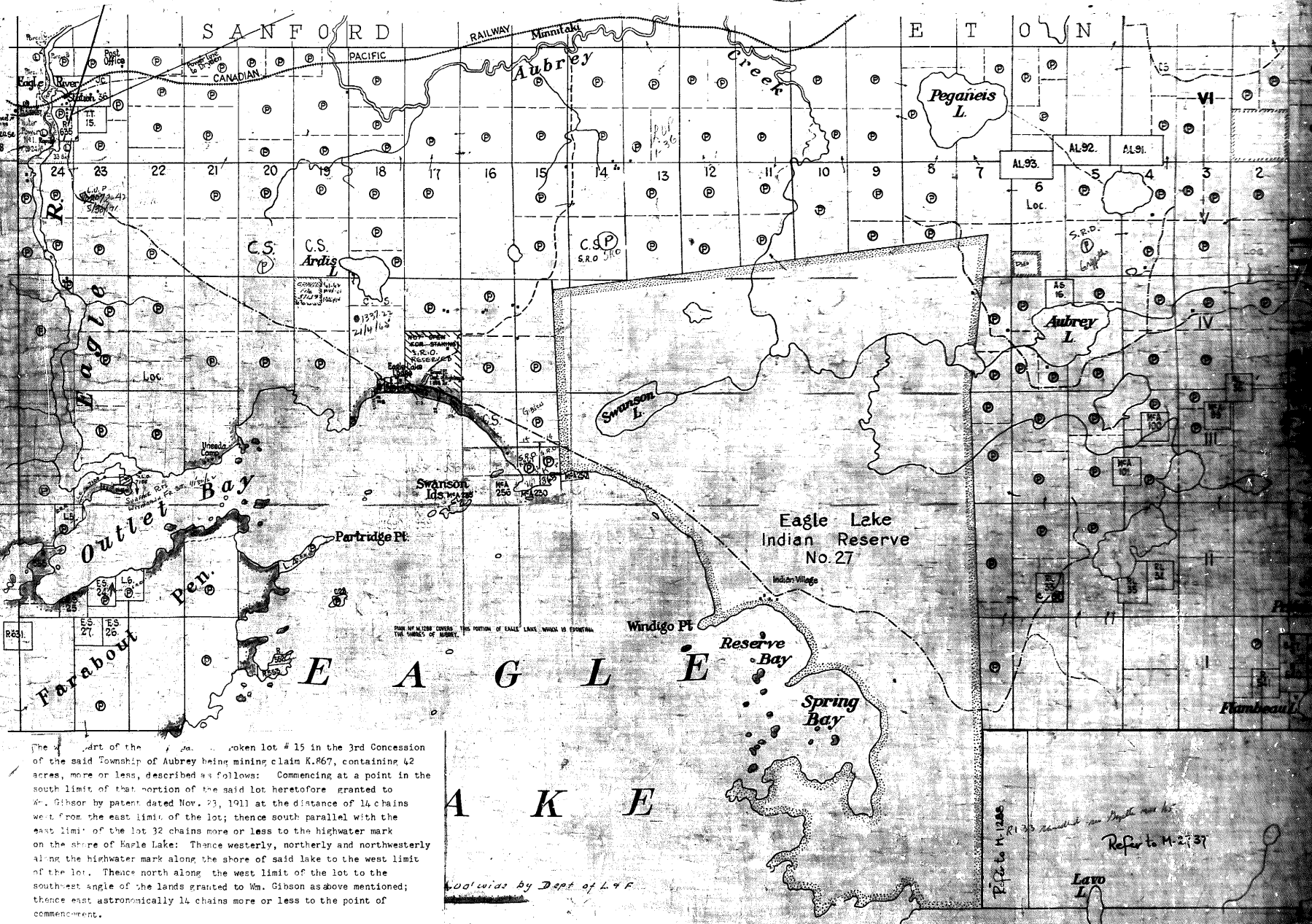

The easterly part of the south part of broken lot #15 in the 3rd Concession of the said Township of Aubrey being mining claim K.867, containing 42 acres, more or less, described as follows: Commencing at a point in the south limit of that portion of the said lot heretofore granted to Wm. Gibson by patent dated Nov. 23, 1911 at the distance of 14 chains west from the east limit of the lot; thence south parallel with the east limit of the lot 32 chains more or less to the highwater mark on the shore of Eagle Lake; thence westerly, northerly and northwesterly along the highwater mark along the shore of said lake to the west limit of the lot. Thence north along the west limit of the lot to the southeast angle of the lands granted to Wm. Gibson as above mentioned; thence east astronomically 14 chains more or less to the point of commencement.

Laid out by Dept of L & F

AUBREY 1944

1944

AUBREY

DISTRICT OF KENORA

Scale - 40 Chains = 1 Inch

FILED KENORA
REC'D. MAY 31 1944
RECEIPT NO.
MINING DIVISION

52 P 14

M1944

ONTARIO
DEPARTMENT OF MINES
AND NORTHERN AFFAIRS

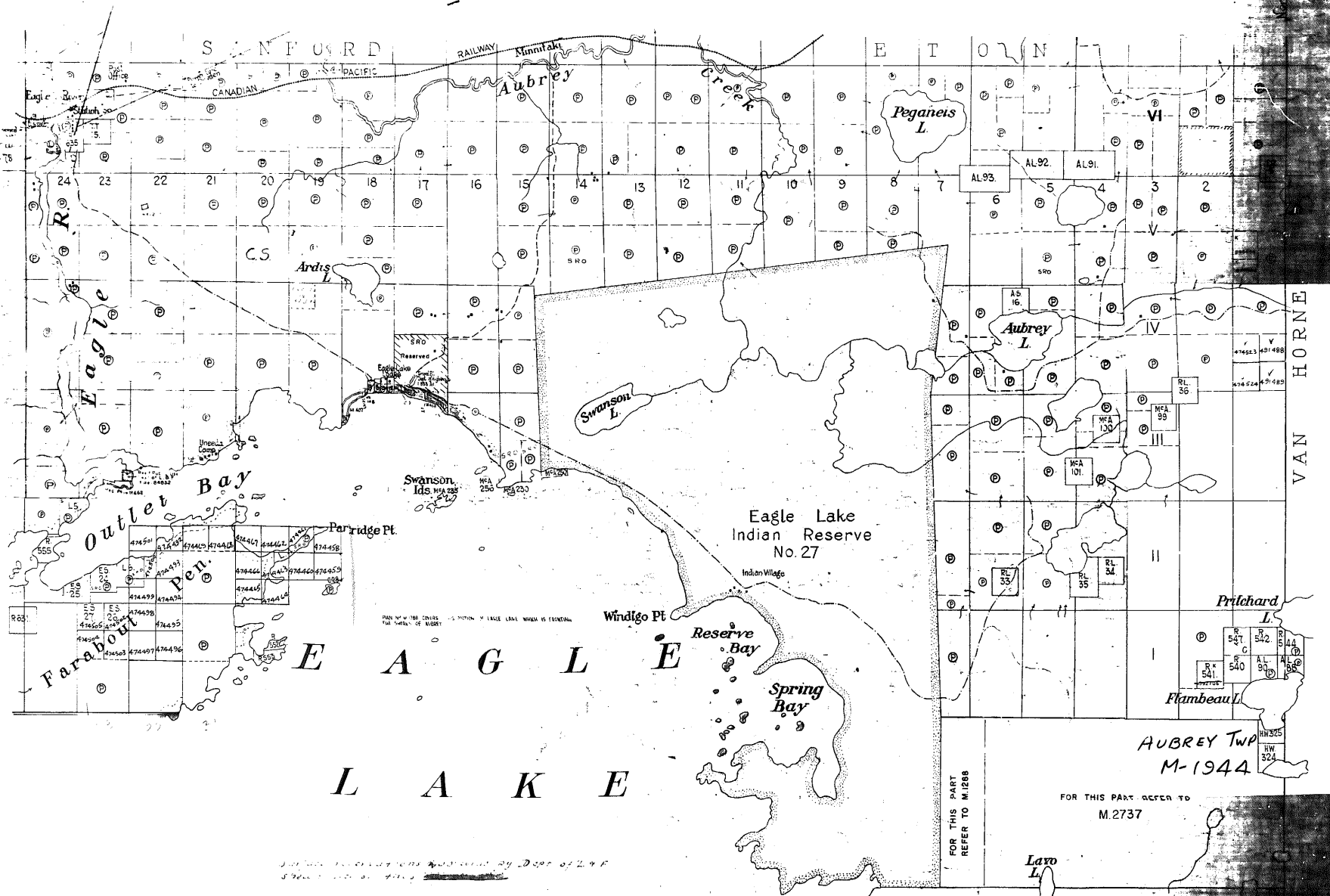

FOR THIS PART
REFER TO M.273

FOR THIS PART REFER TO
M.2737

Lavo
L

Aubrey Twp M-1944

1944

AUBREY

DISTRICT OF KENORA

Scale - 40 Chains = 1 Inch



S; Lot 17 Con. 4 SRO withdrawn from staking
18, 1955 - See RES-A- 12/7/62 (15298)
S; Lot 23, Con. 3 Res. Public Land Use
11/27/62 (129.1) RES.A.

NOTE.
SW 40 ac. Lot 6 Con. 5 & 5 1/2
Lot 2 Con. 6 - Sand & Gravel
reserved to Dept of Highways.

In good state

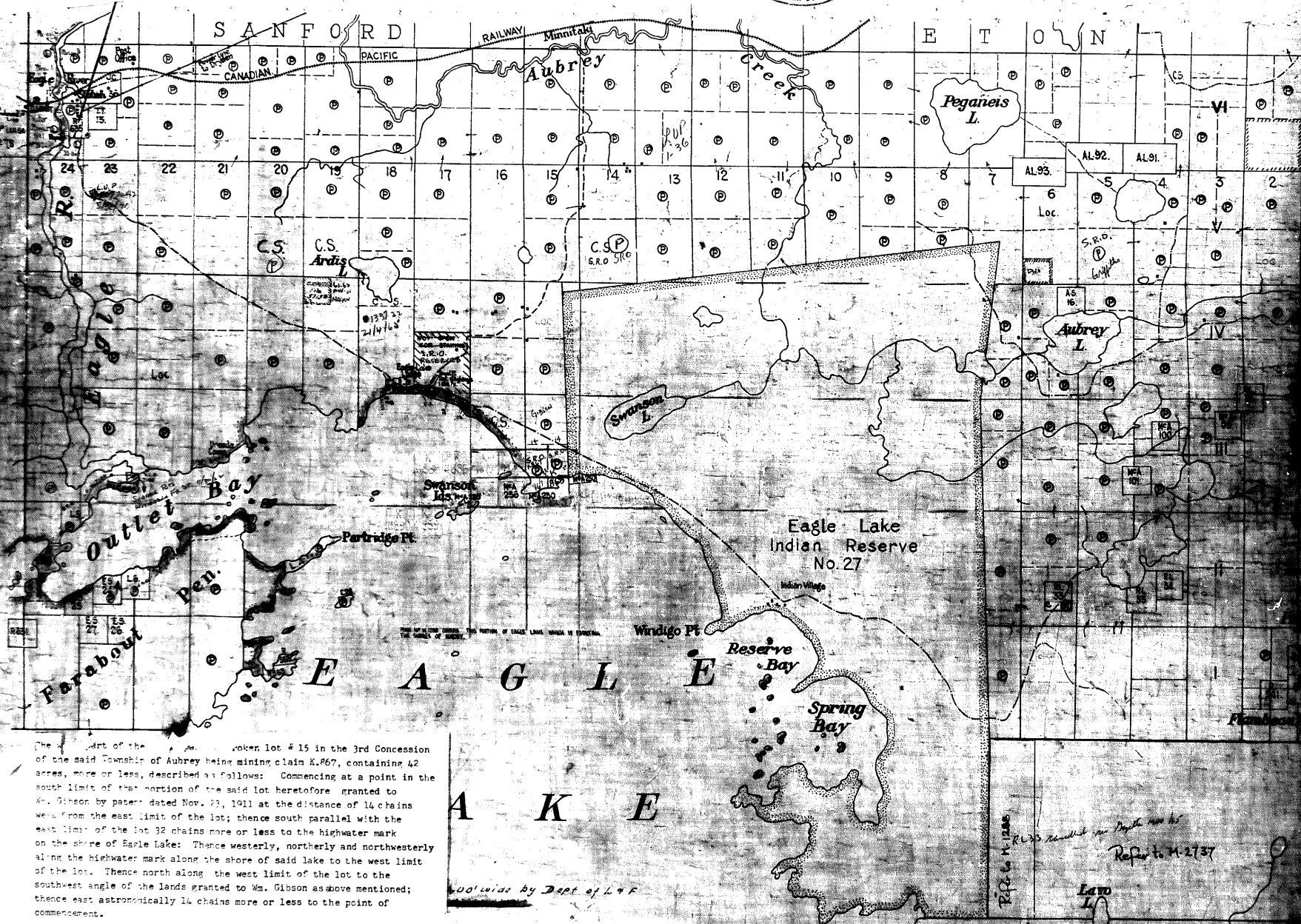

The easterly part of the south part of broken lot #15 in the 3rd Concession of the said Township of Aubrey being mining claim K.863 containing 42 acres, more or less, described as follows: Commencing at a point in the south limit of that portion of the said lot heretofore granted to Mr. Gibson by patent dated Nov. 23, 1911 at the distance of 14 chains west from the east limit of the lot; thence south parallel with the east limit of the lot 32 chains more or less to the highwater mark on the shore of Eagle Lake; Thence westerly, northerly and northwesterly along the highwater mark along the shore of said lake to the west limit of the lot. Thence north along the west limit of the lot to the southwest angle of the lands granted to Wm. Gibson as above mentioned; thence east astronomically 14 chains more or less to the point of commencement.

Good title by Dept of L & F

Refer to M-2737
Law

1944

AUBREY

DISTRICT OF KENORA

Scale - 40 Chains - 1 inch

FILED: KENORA
REC'D. MAY 31 1944
RECEIPT No.
MINING DIVISION

52 P 14
M1944

ONTARIO
DEPARTMENT OF MINES
AND NORTHERN AFFAIRS

422 16/72
up 18/72

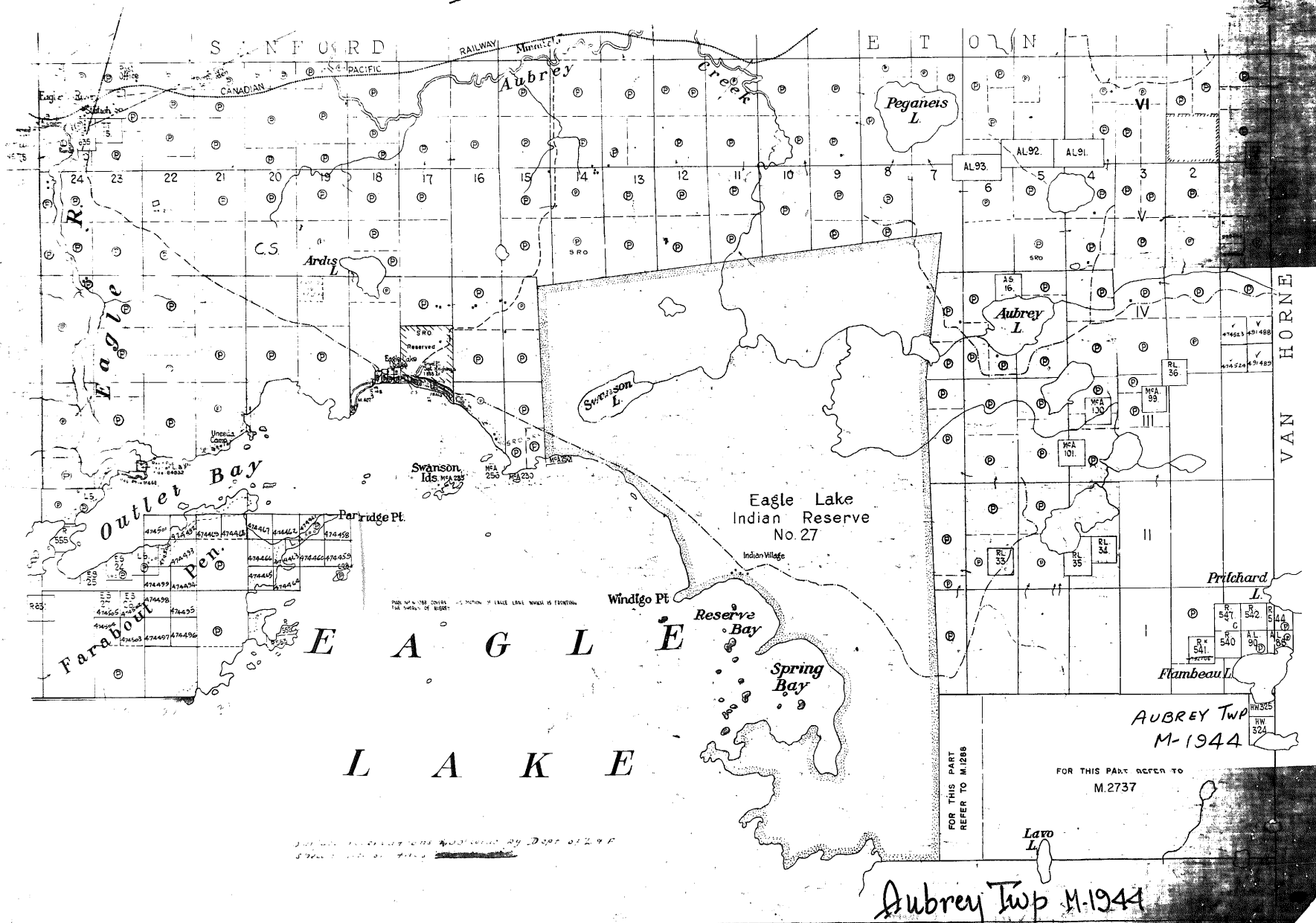

AUBREY

DISTRICT OF KENORA
KENORA MINING DIVISION
Scale - 40 Chains - 1 inch

M1944

MINISTRY OF NATURAL RESOURCES
SURVEYS AND MAPPING BRANCH

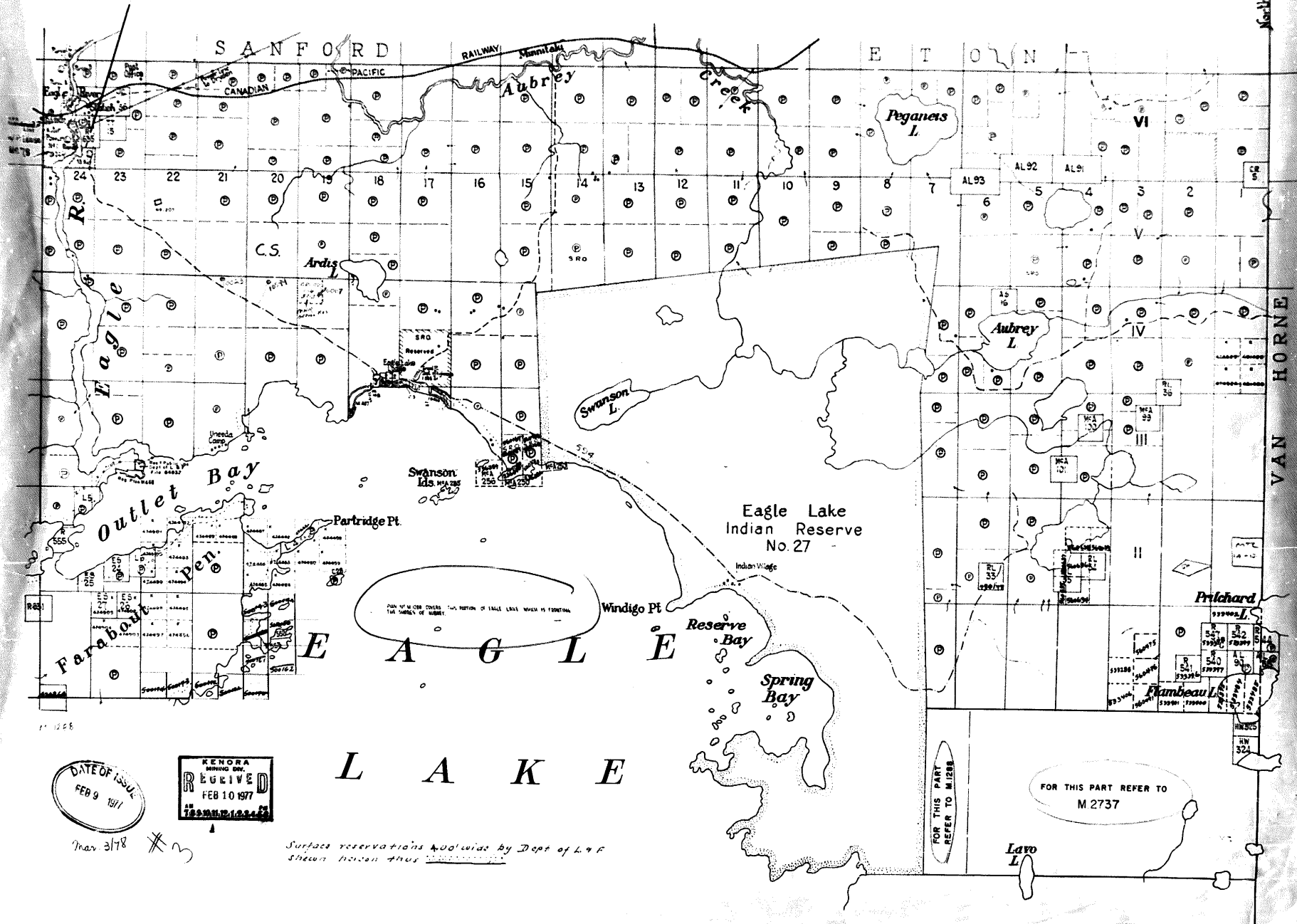

DATE OF ISSUE
FEB 9 1971

KENORA
RECEIVED
FEB 10 1971

Mar 3/78

Surface reservations and claims by Dept of L & F
Shaded portion thus

FOR THIS PART
REFER TO M1228

FOR THIS PART REFER TO
M2737

Lavo
L

R.1 W.M.R. 17/7/92 21/92 1944

AUBREY

DISTRICT OF KENORA
KENORA MINING DIVISION
Scale - 40 Chains - 1 Inch

M.1944
ONTARIO

MINISTRY OF NATURAL RESOURCES
SURVEYS AND MAPPING BRANCH

DATE OF ISSUE
JUL 10 1981
Ministry of Natural Resources
TORONTO

KENORA
MINING DIV.
REV. 1
JUL 20 1981
1 2 3 4 5 6

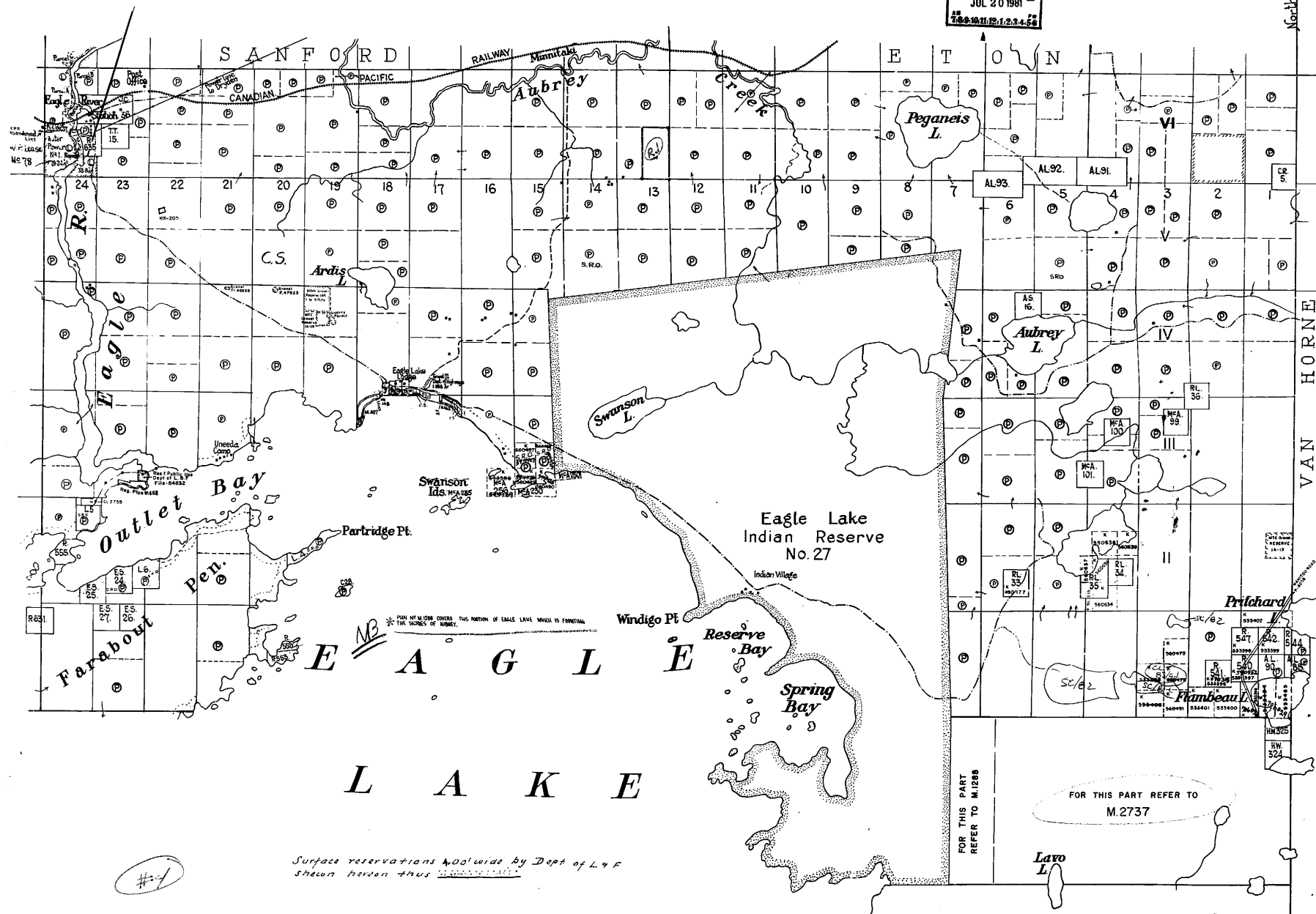

AUBREY

DISTRICT OF KENORA
KENORA MINING DIVISION
Scale - 40 Chains - 1 Inch

M.1944
ONTARIO
MINISTRY OF NATURAL RESOURCES
SURVEYS AND MAPPING BRANCH

DATE OF ISSUE
MAY 30 1983
Ministry of Natural Resources
TORONTO

KENORA
MINING DIV.
EAGLE LAKE
JUN 10 1983
78.9 10.4 11.1 12.1 13.3 14.6 15.8

Effective
as
Linen

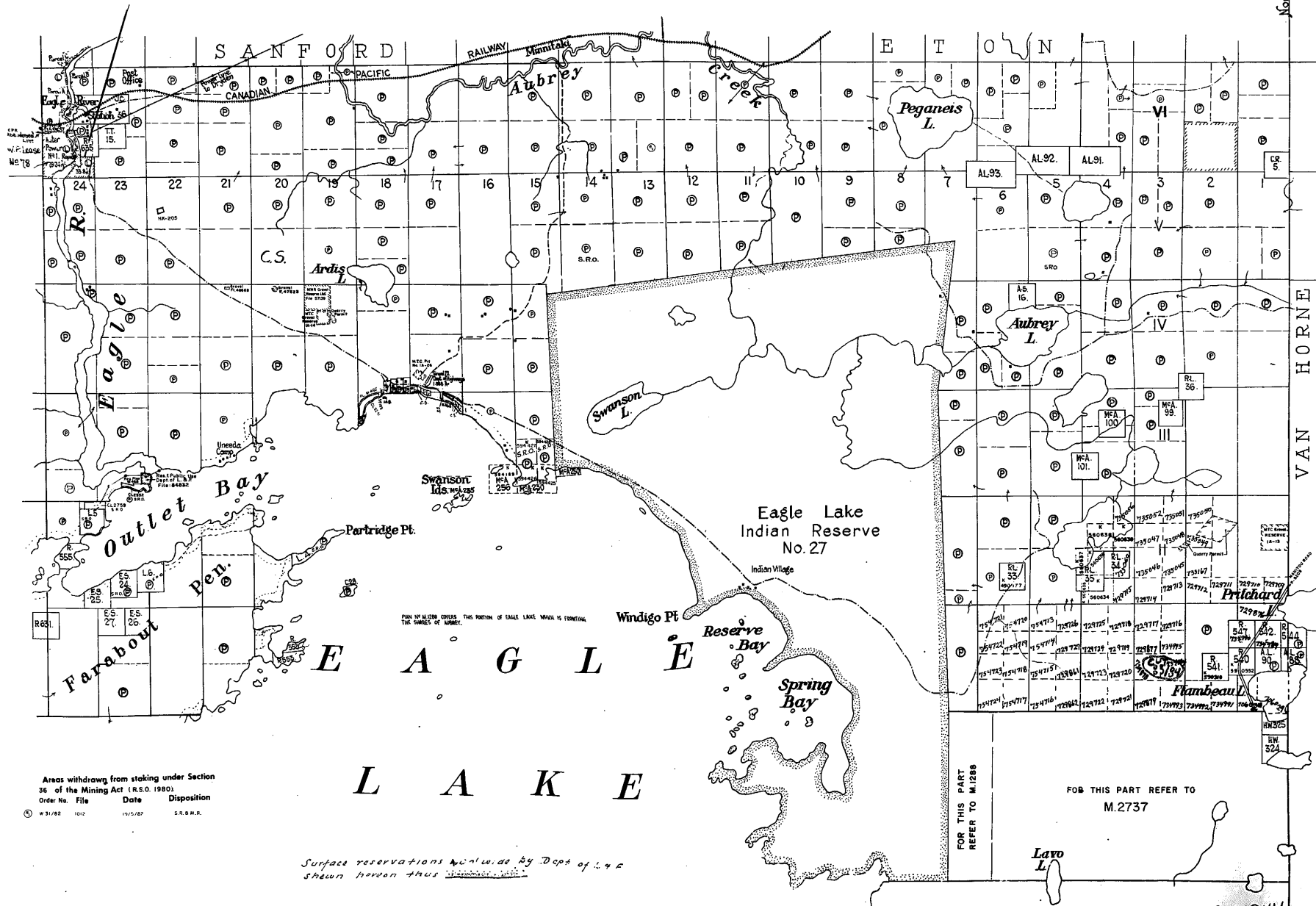

AUBREY

DISTRICT OF KENORA
KENORA MINING DIVISION

Scale - 40 Chains - 1 Inch

JAN 27 1894
AM 10 50 PM 4 50

M.1944
ONTARIO

MINISTRY OF NATURAL RESOURCES
SURVEYS AND MAPPING BRANCH

G832 SANDFORD TP.

G2599 MATHIEU TP.

G837 TEMPLE TP.

G839 VAN HORNE

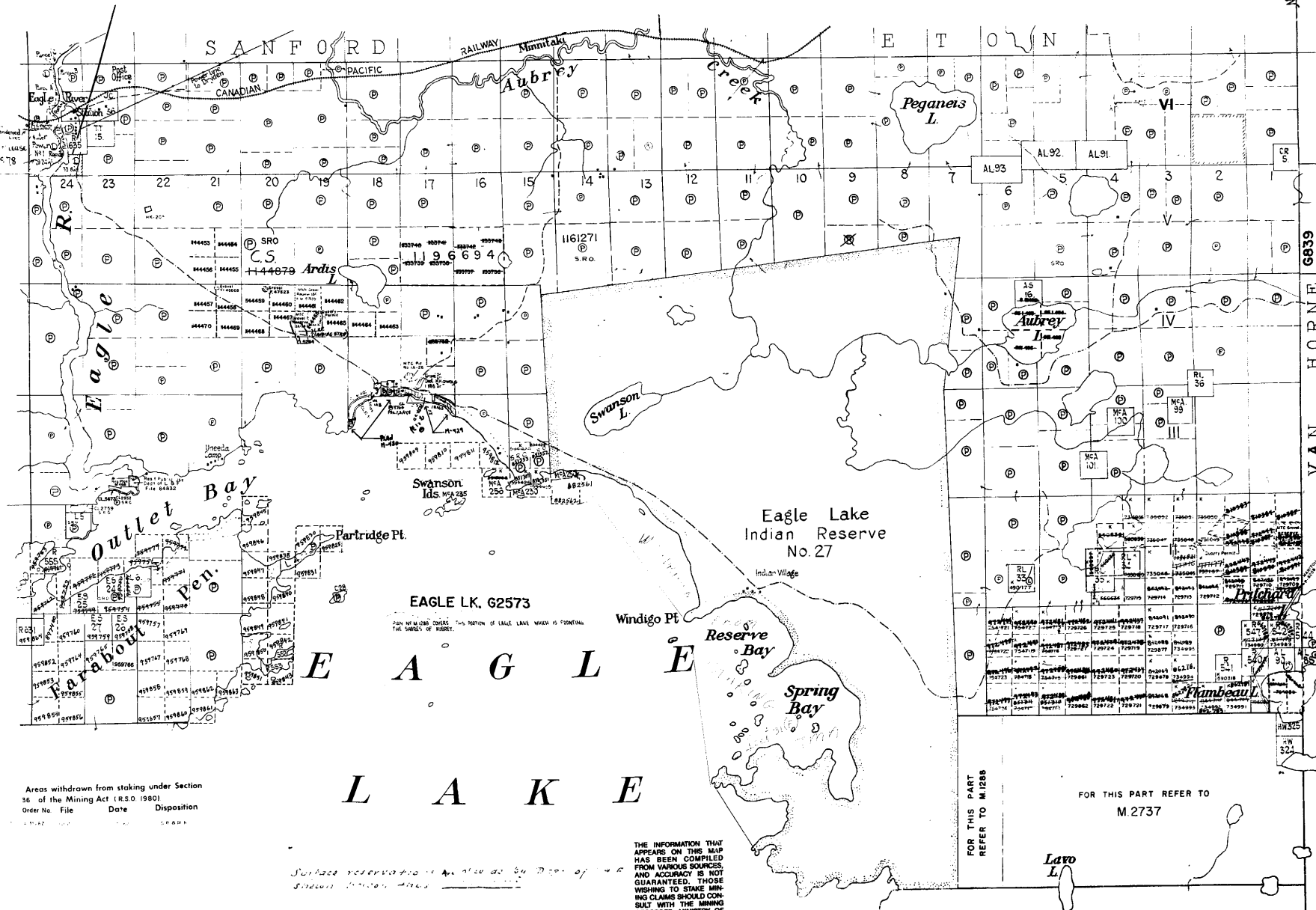

Areas withdrawn from staking under Section
36 of the Mining Act (R.S.O. 1980)

Order No. File Date Disposition

E A G L E L A K E

Surface reservation is also shown by the dotted line.

THE INFORMATION THAT
APPEARS ON THIS MAP
HAS BEEN COMPILED
FROM VARIOUS SOURCES
AND ACCURACY IS NOT
GUARANTEED. THOSE
WISHING TO STAKE MIN-
ING CLAIMS SHOULD CON-
SULT WITH THE MINING
RECORDS, MINISTRY OF
NORTHERN DEVELOP-
MENT AND MINES FOR AD-
DITIONAL INFORMATION
ON THE STATUS OF THE
LANDS SHOWN HEREON.

FOR THIS PART
REFER TO M.1288

FOR THIS PART REFER TO
M.2737

Lavo
L.

Map of Eagle Lake, Minnesota, showing land parcels, water bodies, and the Eagle Lake Indian Reserve No. 27. The map includes a grid system for land parcels, with labels such as 'R. 24', 'R. 23', 'R. 22', 'R. 21', 'R. 20', 'R. 19', 'R. 18', 'R. 17', 'R. 16', 'R. 15', 'R. 14', 'R. 13', 'R. 12', 'R. 11', 'R. 10', 'R. 9', 'R. 8', 'R. 7', 'R. 6', 'R. 5', 'R. 4', 'R. 3', 'R. 2', 'R. 1'. The map also shows the 'CANADIAN PACIFIC RAILWAY' and 'Sinnitah Creek'. The map is titled 'EAGLE LAKE' in large letters at the bottom. The map is dated 'AUBREY TWP M-1944' and 'M.2737'. The map is a black and white reproduction of a historical document.

AUBREY

DISTRICT OF KENORA

Scale - 40 Chains - 1 inch

FILED KENORA
REC'D MAY 31 1911
RECEIPT NO.
MINING DIVISION

M1944

ONTARIO
DEPARTMENT OF MINES
AND NORTHERN AFFAIRS

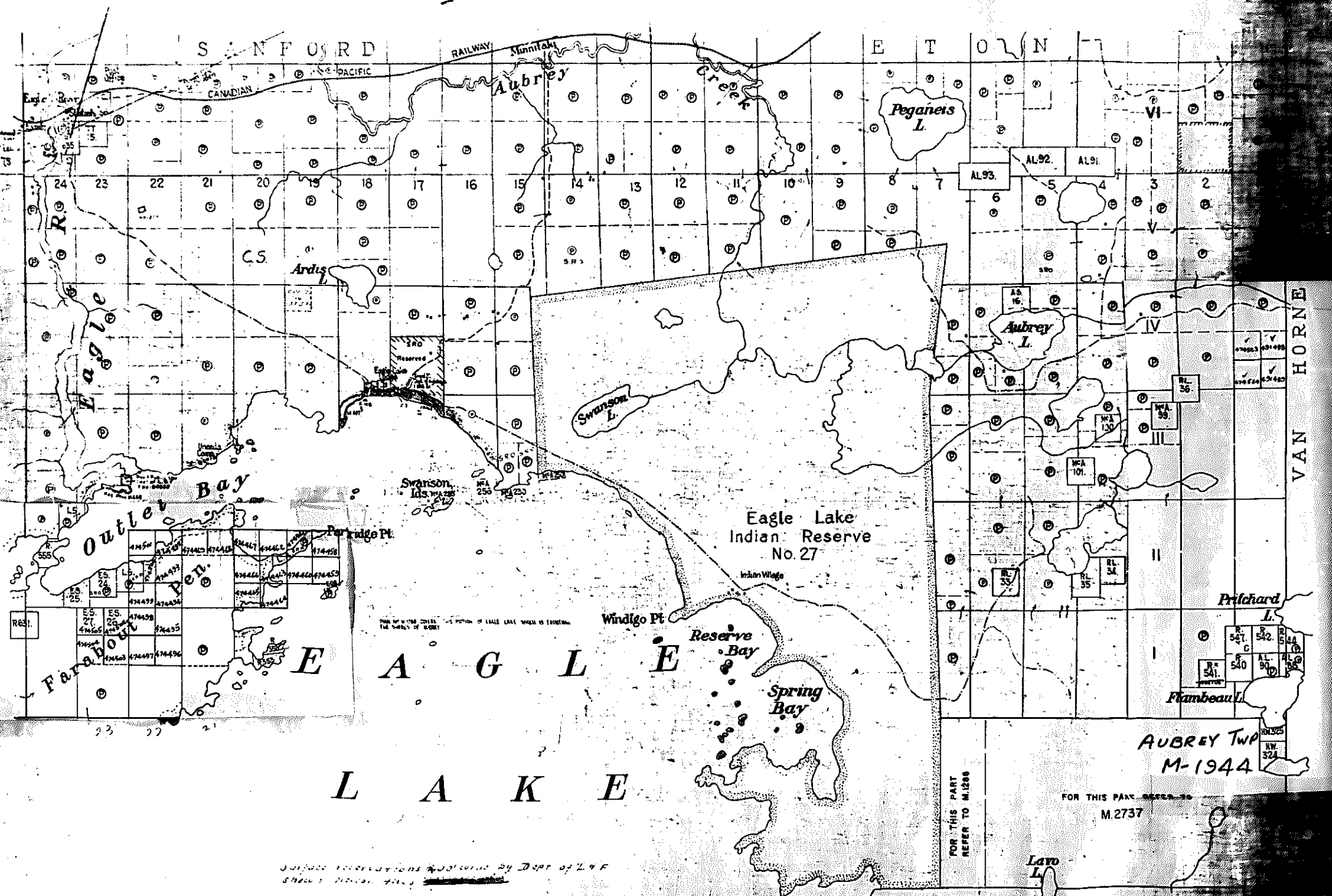

Aubrey Twp M-1944

1944

AUBREY

DISTRICT OF KENORA

Scale - 40 Chains - 1 Inch

FILED
KENORA
REC'D. MAY 31 1941
RECEIPT NO.
MINING DIVISION

4th. 16/72
Apr. 18/72

52714

M1944

ONTARIO
DEPARTMENT OF MINES
AND NORTHERN AFFAIRS

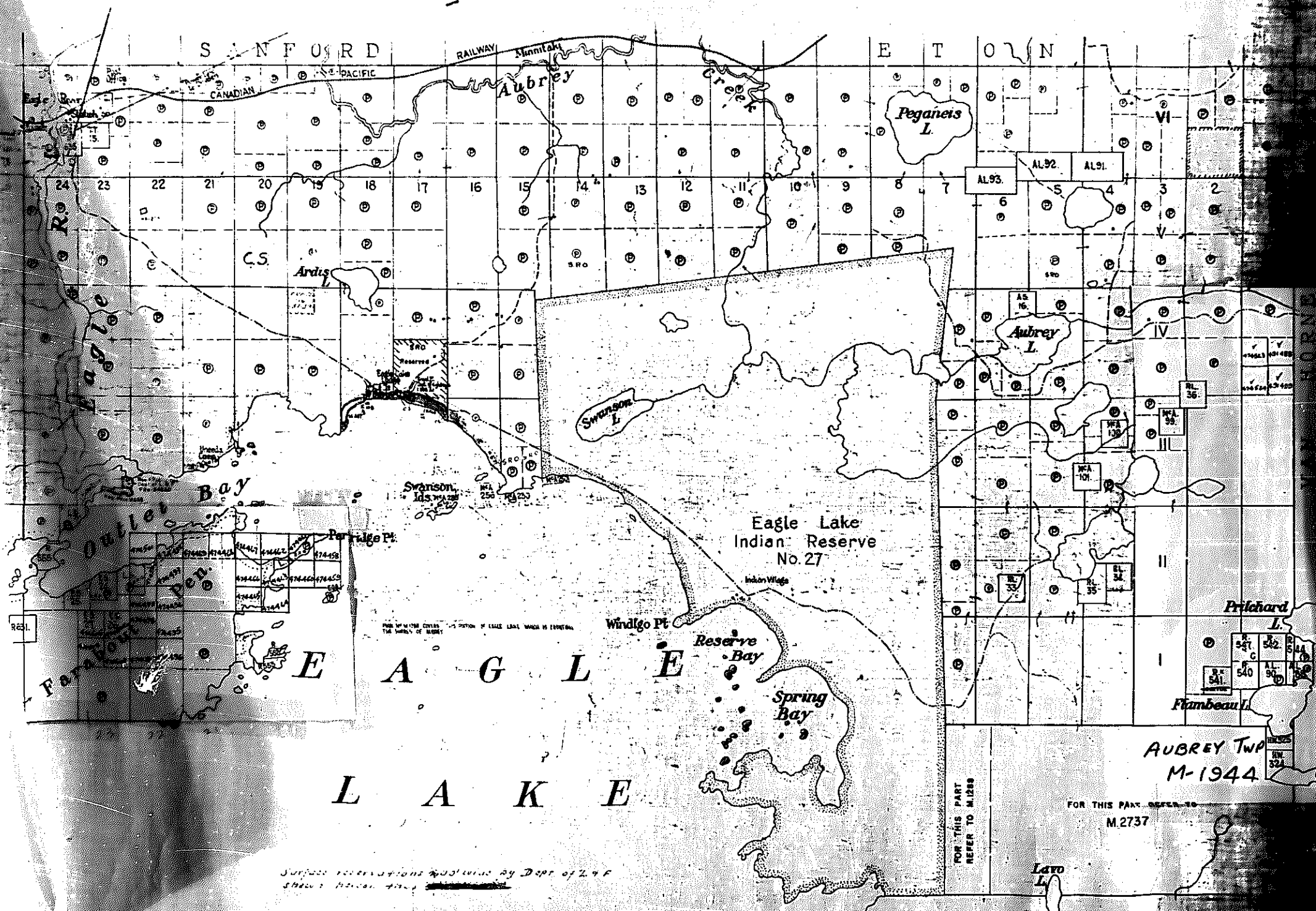

Surface elevations provided by Dept. of L. & F.
Shaded relief from 1944

FOR THIS PART
REFER TO M.1288

FOR THIS PART REFER TO
M.2737

AUBREY TWP
M-1944

Aubrey Twp M.1944

AUBREY

DISTRICT OF KENORA

Scale - 40 Chains - 1 inch

KENORA
FILED
RECEIVED
MAY 31 1911
RECEIPT NO.
MINING DIVISION

Dec 16/12
Apr 18/12

52 P 14

M1944

ONTARIO
DEPARTMENT OF MINES
AND NORTHERN AFFAIRS

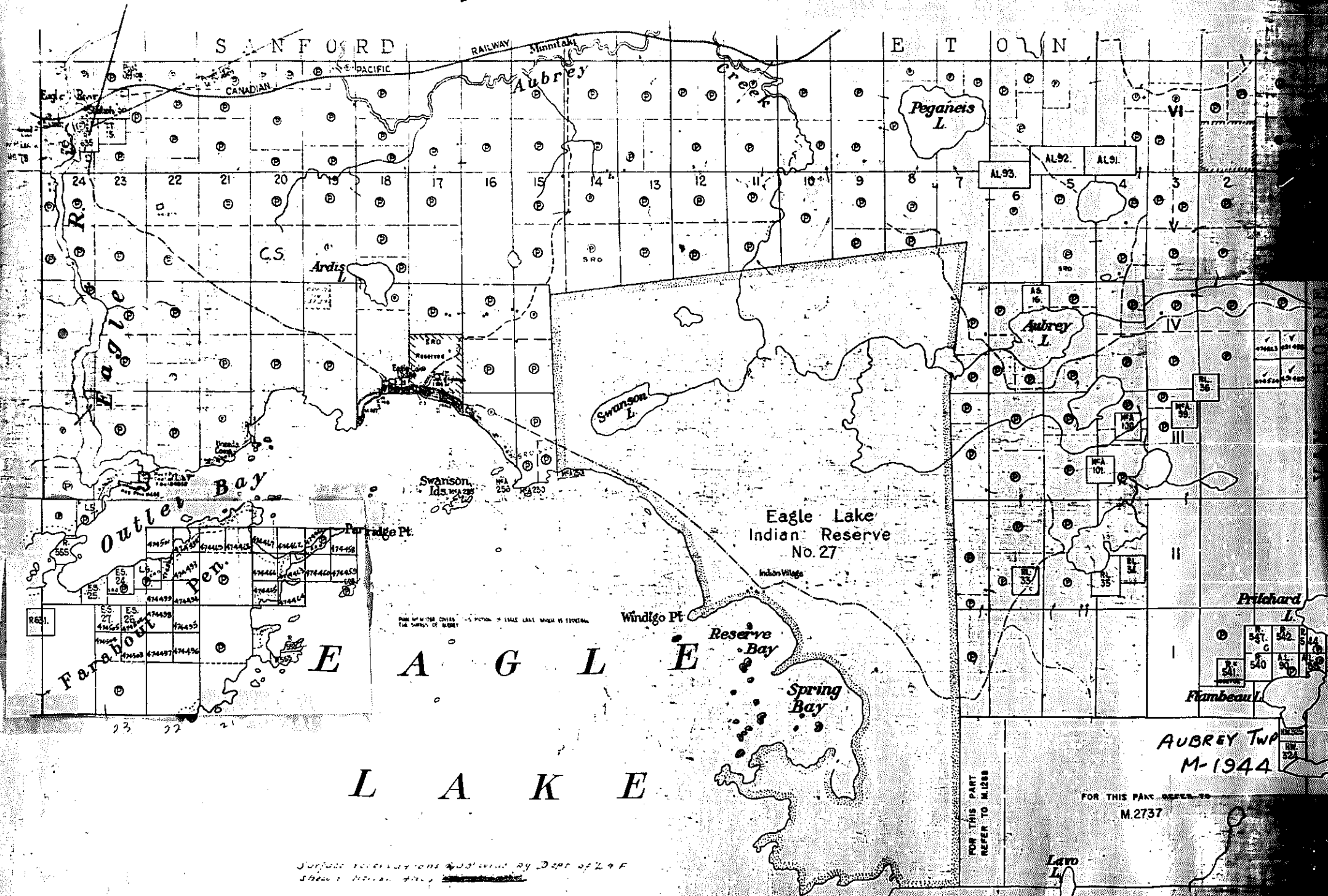

Surface boundaries and locations by Dept of L & F
Shaded areas are ~~not~~ ~~not~~ ~~not~~