

Gibbons Twp.

THE TOWNSHIP
OF
BADGEROW

DISTRICT OF
NIPISSING
SUDBURY

MINING DIVISION

SCALE: 1-INCH=40 CHAINS

LEGEND

PATENTED LAND	(P)
CROWN LAND SALE	(C.S.)
LEASES	(L)
LOCATED LAND	(Loc.)
LICENSE OF OCCUPATION	(L.O.)
ROADS	—
IMPROVED ROADS	—
RAILWAYS	—
POWER LINES	—
MARSH OR MUSKEG	—

NOTES

400' Surface Rights Reservation around all Lakes and Rivers.

SURFACE RIGHTS ONLY WITHDRAWN FROM STAKING IN AREA SHOWN THUS: Res. Dept. of L. & F. Sec. 39(d) of the Mining Act. File: 45455.

Areas withdrawn from staking under Section 39 of the Mining Act (R.S.O. 1970)

Order No	File	Date	Disposition
4974	188555	1979/74	S.R.O.

* IN DEGREE 1983 0804 - 06

* 1/2 Lot 8, Con. IV - MRO OPEN FOR STAKING,
ON JUNE 1, 1985
Sec. 212(7) of the Mining Act, R.S.O. 1980
ONE GAZETTE DATED MAY 4, 1985

BADGEROW

PLAN NO. - M-644

ONTARIO
MINISTRY OF NATURAL RESOURCES
SURVEYS AND MAPPING BRANCH

VI
V
IV
III
II
I

Field Twp.

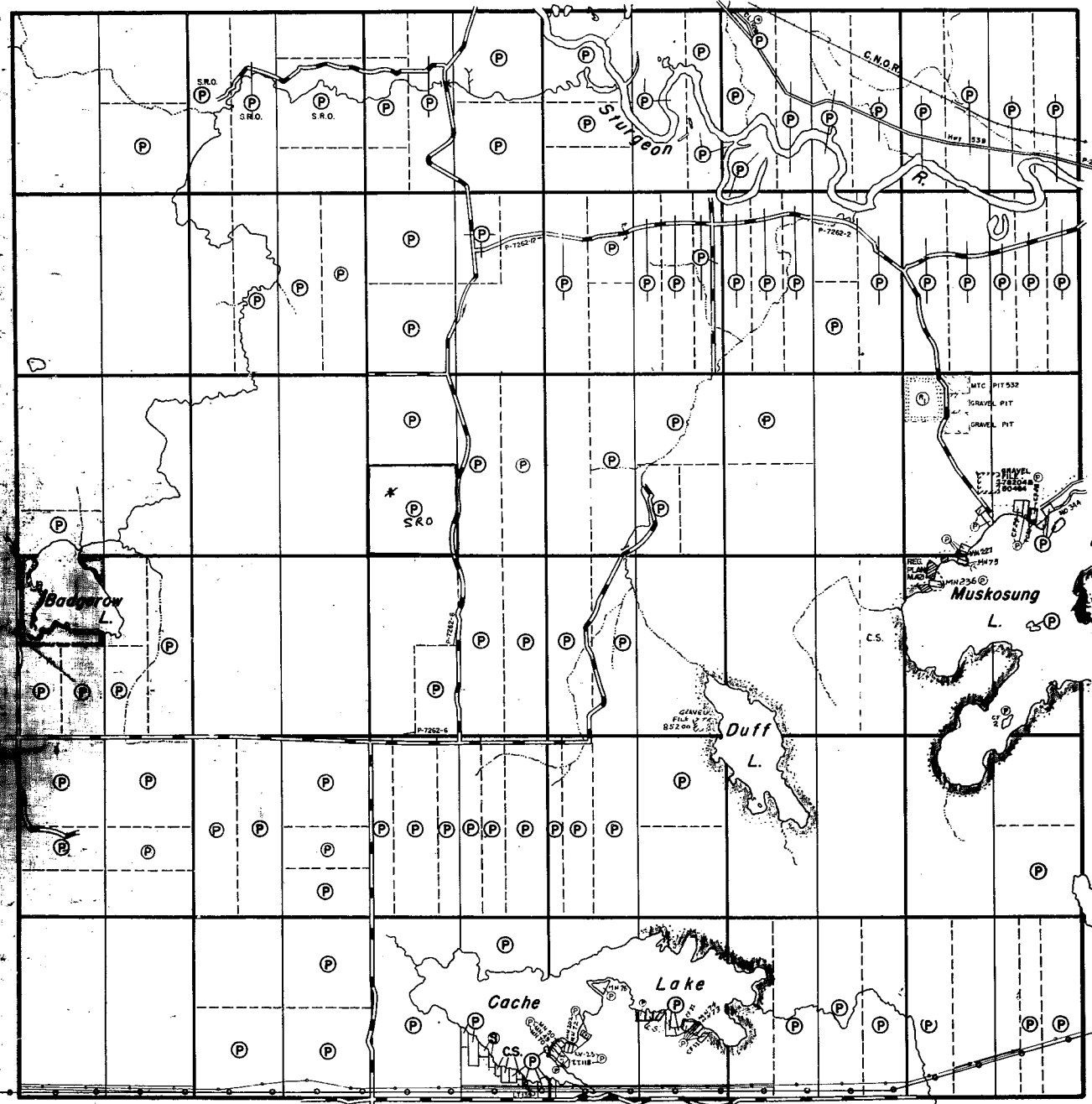

Hugel Twp.

Caldwell Twp.

INDEX TO LAND DISPOSITION

PLAN:
G-2902
TOWNSHIP

M.N.R. ADMINISTRATIVE DISTRICT
NORTH BAY
MINING DIVISION
SUDBURY
LAND TITLES/REGISTRY DIVISION
NIPISSING

BADGEROW

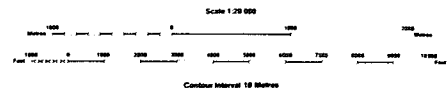

AREAS WITHDRAWN FROM DISPOSITION

Description	Order No.	Date	Disposition	File
MRO - Mining Rights Only				
SRO - Surface Rights Only				
M - S - Mining and Surface Rights				
RESERVED FOR PUBLIC USE	44776	6/28/74	SRO	46656
RESERVED FOR PUBLIC USE	44777	6/28/74	SRO	46656
RESERVED FOR PUBLIC USE	44778	6/28/74	SRO	46656
RESERVED FOR PUBLIC USE	44779	6/28/74	SRO	46656

SYMBOLS

- Boundary Township, Meridian, Baseline
- Road allowance surveyed
- shoreline
- Lot/Concession surveyed
- unsurveyed
- Parcel surveyed
- unsurveyed
- Right-of-way road
- railway
- utility
- Reservation
- Cliff: Pa, Pie
- Contour
- Interpretation
- Approximate
- Depression
- Control point (horizontal)
- Flooded land
- Mine head frame
- Pipeline (above ground)
- Railway, single track
- double track
- abandoned
- Road, highway, county, township
- access
- trail, bush
- Shoreline Longmark
- Transmission line
- Wooded area

DISPOSITION OF KNOWN LINES

- Patent
- Surface & Mining Rights
- Surface Rights Only
- Mining Rights Only
- Lease
- Surface & Mining Rights
- Surface Rights Only
- Mining Rights Only
- Licence of Occupation
- Order-in-Council
- Cancelled
- Reservation
- Sand & Gravel
- LAND USE PERMIT



THE INFORMATION THAT APPEARS ON THIS MAP HAS BEEN COMPILED FROM VARIOUS SOURCES AND ACCURACY IS NOT GUARANTEED. THOSE WISHING TO MAKE SOME CLAIMS SHOULD CONSULT WITH THE MINING RECORDS DIVISION OF NORTHERN DEVELOPMENT AND MINES FOR ADDITIONAL INFORMATION ON THE STATUS OF THE LANDS SHOWN HEREON.

Map base is a land disposition drafting by Surveys and Mapping Branch, Ministry of Natural Resources. The disposition of land, location of lot fabric and parcel boundaries on this index was compiled for administrative purposes only.

BADGEROW

40 Chains = 1 Inch

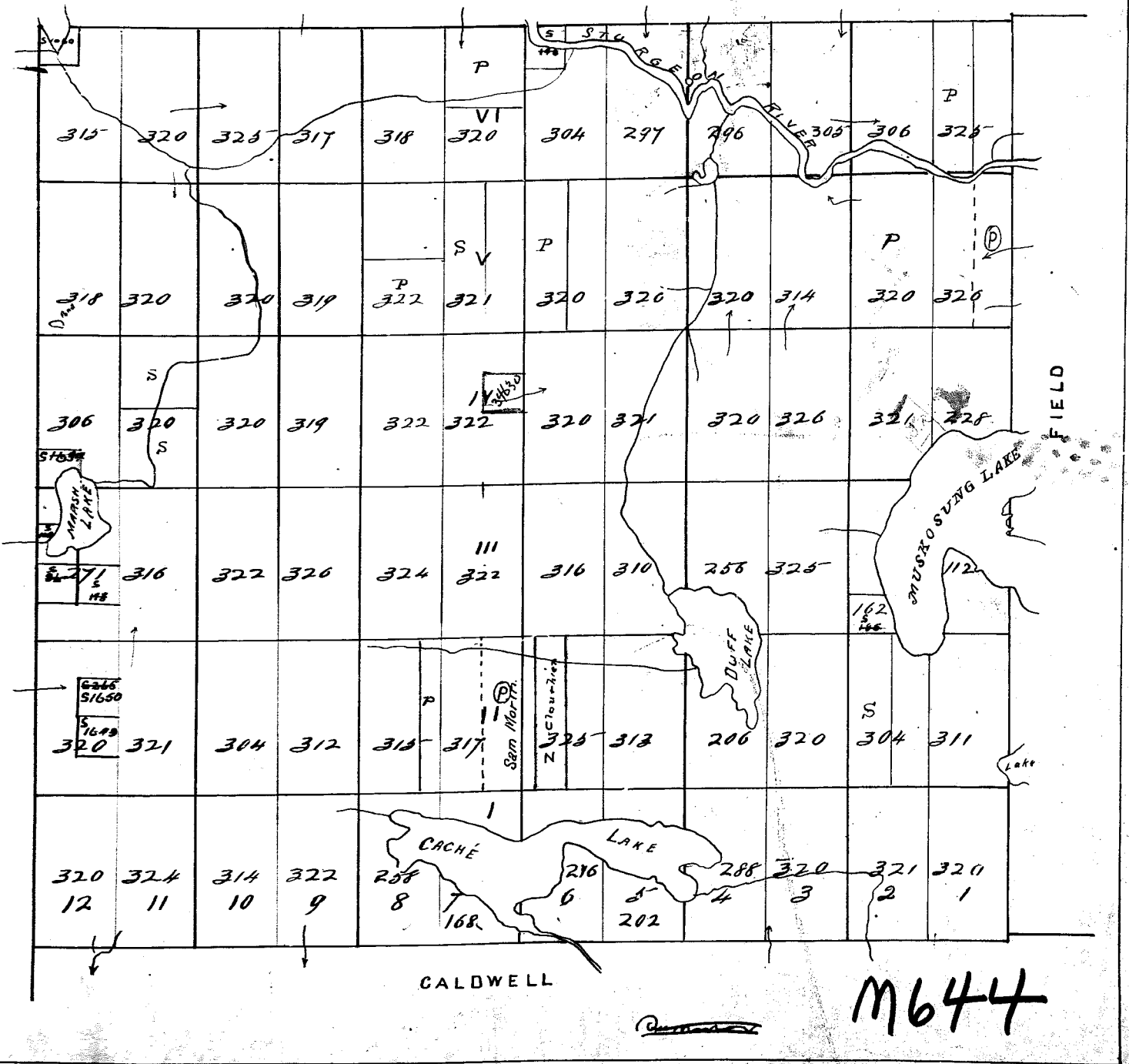

Island in front of lot 1 on 4 Mushosung Lake
 sold to Dr R. F. Madsen Oct 31st 1933. 1.2 acres



INDEX TO LAND DISPOSITION

PLAN
G-2902
 TOWNSHIP
BADGEROW

M.N.R. ADMINISTRATIVE DISTRICT
NORTH BAY
 MINING DIVISION
SUDBURY
 LAND TITLES/REGISTRY DIVISION
NIPISSING

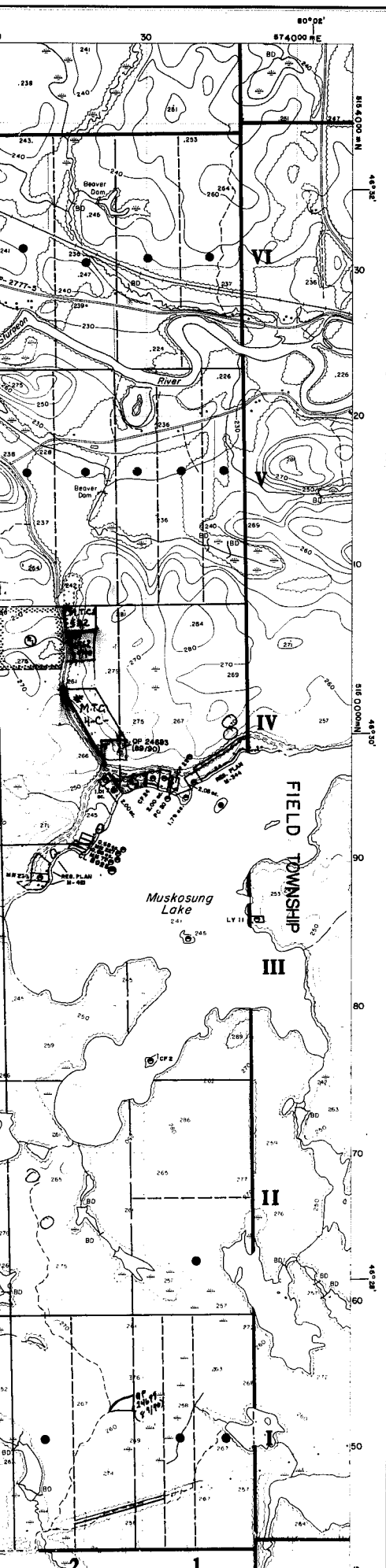
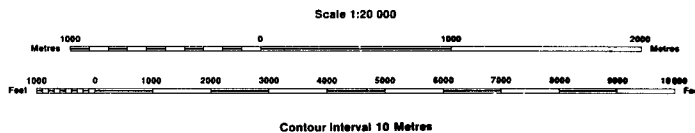

AREAS WITHDRAWN FROM DISPOSITION

MRO - Mining Rights Only
 SRO - Surface Rights Only
 M + S - Mining and Surface Rights

Description	Order No.	Date	Disposition	File
① SEC. 43/70	49/74	19/9/74	SRO	12856
② RESERVED FOR PUBLIC USE SEC. 394 R.S.O. 1950.			SRO	44466
③ RESERVED FOR PUBLIC USE			SRO	31480
④ RESERVED FOR PUBLIC USE			SRO	32730

SYMBOLS

Boundary	—
Township, Mer: Jinn, Baseline	—
Road allowance: surveyed	—
shoreline	—
Lot/Concession; surveyed	—
unsurveyed	—
Parcel; surveyed	—
unsurveyed	—
Right-of-way; road	—
railway	—
utility	—
Reservation	—
Cliff, Pit, Pile	—
Contour	—
Interpolated	—
Approximate	—
Depression	—
Control point (horizontal)	—
Flooded land	—
Mine head frame	—
Pipeline (above ground)	—
Railway; single track	—
double track	—
abandoned	—
Road; highway, county, township	—
access	—
trail, bush	—
Shoreline (original)	—
Transmission line	—
Wooded area	—

DATE OF ISSUE
 17 1974
 SUDBURY
 MINING RECORDER'S OFFICE

* M.T.C. Pit 532
 * M.T.C. Pit 4-C

DISPOSITION OF CROWN LANDS

Patent	●
Surface & Mining Rights	●
Surface Rights Only	○
Mining Rights Only	○
Lease	■
Surface & Mining Rights	■
Surface Rights Only	■
Mining Rights Only	■
Licence of Occupation	▼
Order-in-Council	○
Cancelled	○
Reservation	○
Sand & Gravel	○

THE INFORMATION THAT APPEARS ON THIS MAP HAS BEEN COMPILED FROM VARIOUS SOURCES, AND ACCURACY IS NOT GUARANTEED. THOSE WISHING TO STAKE MINING CLAIMS SHOULD CONSULT WITH THE MINING RECORDER, MINISTRY OF NORTHERN DEVELOPMENT AND MINES, FOR ADDITIONAL INFORMATION ON THE STATUS OF THE LANDS SHOWN HEREON

DATE OF ISSUE
 APR 21 1975
 SUDBURY
 MINING RECORDER'S OFFICE

BADGEROW TWP

G-5805

OFFICE USE ONLY

Gibbons Twp.

THE TOWNSHIP OF
OF
BADGEROW
DISTRICT OF NIPISSING
SUDBURY
MINING DIVISION
SCALE: 1-INCH=40 CHAINS

Hugel Twp.

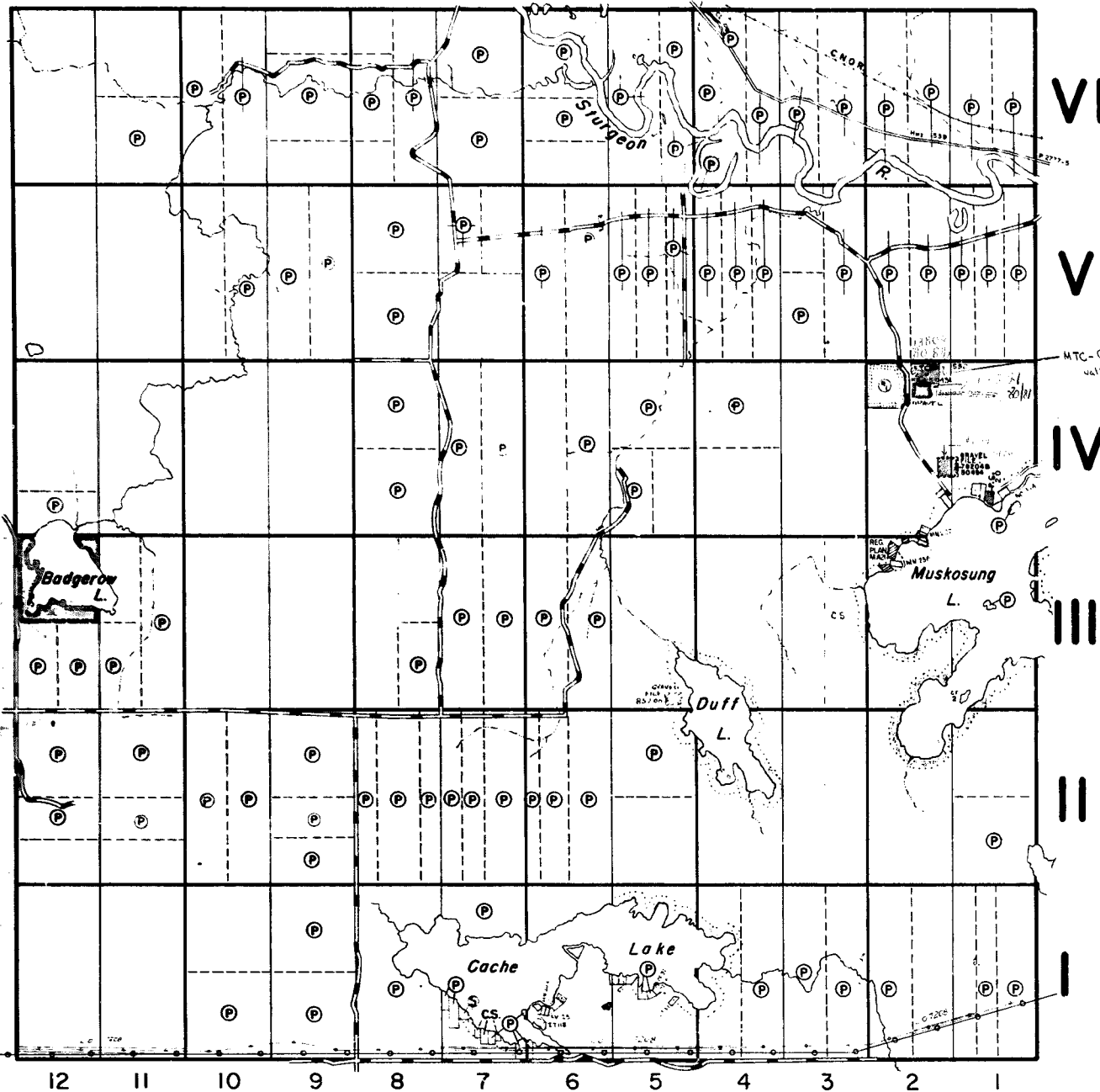

LEGEND

PATENTED LAND	(P)
CROWN LAND SALE	CS
LEASES	(L)
LOCATED LAND	Loc.
LICENSE OF OCCUPATION	L.O.
ROADS	—
IMPROVED ROADS	—
RAILWAYS	—
POWER LINES	—
MARSH OR MUSKEG	—

NOTES

400' Surface Rights Reservation around all Lakes and Rivers.

SURFACE RIGHTS ONLY WITHDRAWN FROM STAKING IN AREA SHOWN THUS ~~UNDER~~ Res. 2011 of L.A.P. Sec. 39(d) of the Mining Act. File: 49455

Area withdrawn from staking under Section 43 of the Mining Act. 15 50 1976

File	Date	Disposition
4574 18655	1-19-74	S.W.O.
L.A.P. CO. REG. (L.A.P. REG. 4) CO. REG. (REG. 362-4116) Hugel, 359		

DATE OF ISSUE
FEB 21 1979

BADGEROW
PLAN NO. - M-644

MINISTRY OF NATURAL RESOURCES

Caldwell Twp.

Gibbons Twp.

THE TOWNSHIP
OF

BADGEROW

DISTRICT OF
NIPISSING
SUDBURY

MINING DIVISION

SCALE: 1-INCH=40 CHAINS

Hugel Twp.

VI

V

IV

III

II

Field Twp.

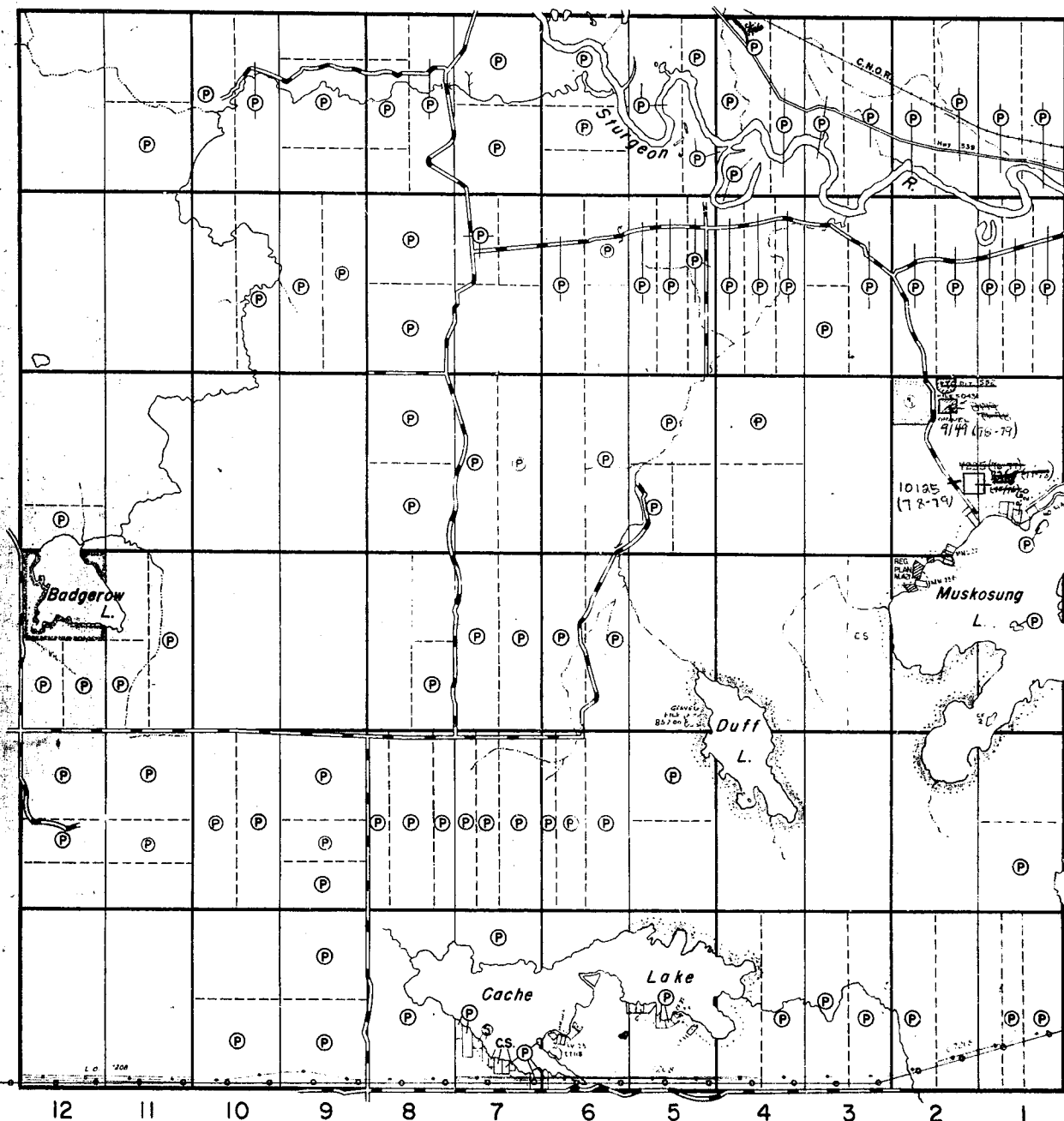

LEGEND

- PATENTED LAND Ⓟ
- CROWN LAND SALE CS
- LEASES Ⓛ
- LOCATED LAND Loc.
- LICENSE OF OCCUPATION L.O.
- ROADS ———
- IMPROVED ROADS ———
- RAILWAYS ———
- POWER LINES ———
- MARSH OR MUSKEG ———

NOTES

400' Surface Rights Reservation around all Lakes and Rivers.

SURFACE RIGHTS ONLY WITHDRAWN FROM STAKING IN AREA SHOWN. THE MINING ACT REG. DEPT. OF M. & P. sec. 39(2) of the Mining Act, File 4-55.

Areas withdrawn from staking under Section 43 of the Mining Act, 453 1970.

File	Date	Disposition



BADGEROW

PLAN NO. - M-643

MINISTRY OF NATURAL RESOURCES

Caldwell Twp.

BADGEROW

40 Chains = 1 Inch

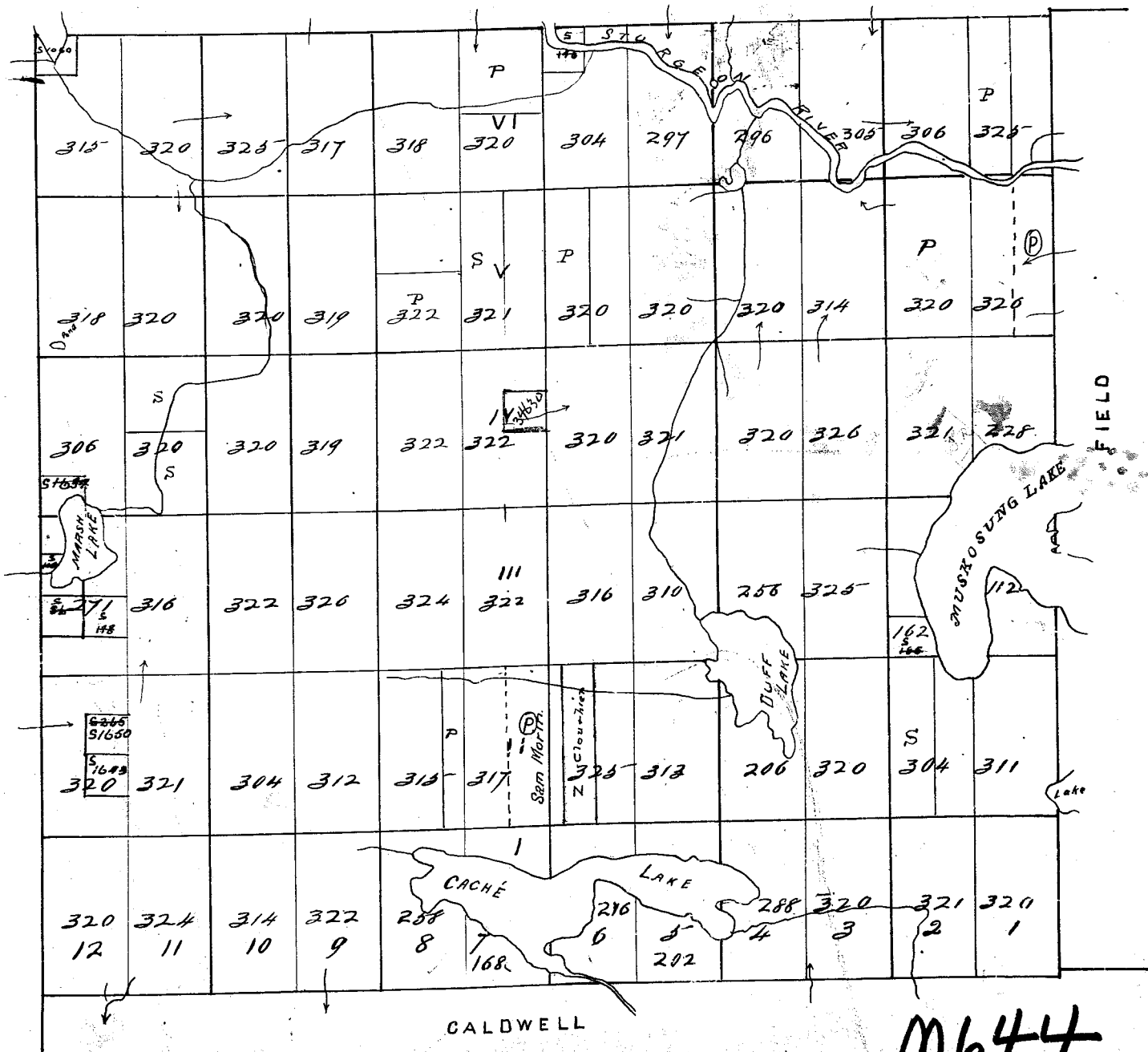

Island in front of lot 1 on 4 Muskegon Lake
 sold to Dr R. F. Wale Oct 31st 1933. 1.2 acres

