

PLAN OF
TWP. 28. R. 19.
LAKE SUPERIOR PROVINCIAL PARK.
DISTRICT OF ALGOMA.
SAULT STE. MARIE MINING DIVISION
 Scale: 40 chains to an inch.

BARNES TR.
 M. 1532
OFFICE MAP

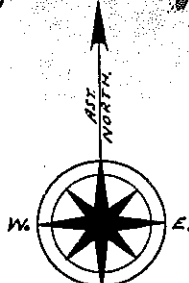

TWP. 28. R. 20.

Ref. by O.L.S. W Beatty 1901

Twp. 29. R. 19.
 Run by O.L.S. W Beatty 1901

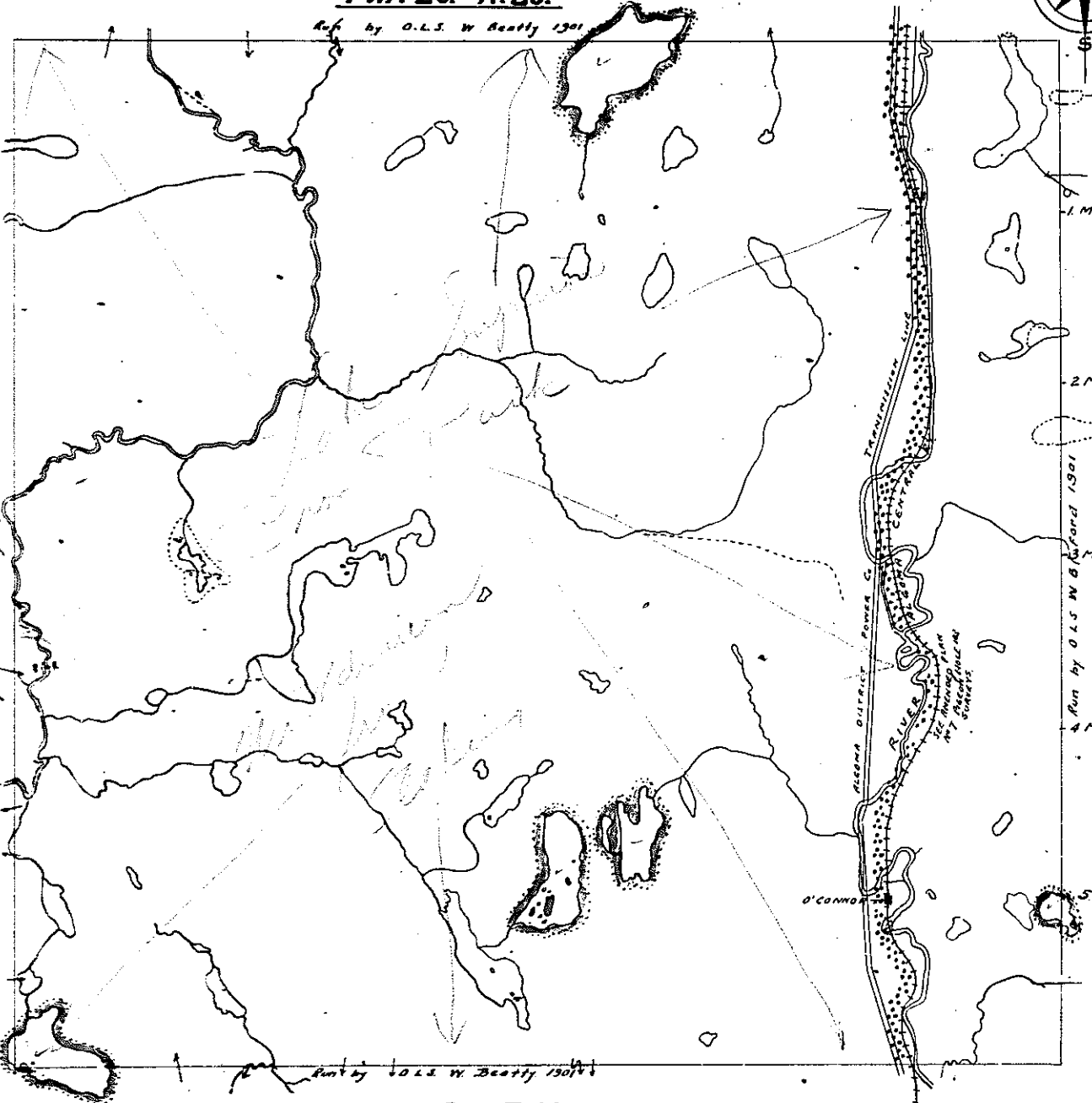

Run by O.L.S. W Beatty 1901

TWP. 27. R. 19.

TWP. 28. R. 18.

Twp. 28. R. 19. West of the R. of Way of The Algoma Central and Hudson Bay Railway, - except granted Crown Lands - forms part of the Lake Superior Provincial Park by O.L.C. dated 13th Jan'y 1944. File 125864. East Bdy. of Park area shown 200'-200'

Surface reservations 200' wide by Dept of L. & R. shown hereon thru-

**PLAN OF
TWP. 28. R. 19.**

LAKE SUPERIOR PROVINCIAL PARK.

DISTRICT OF ALGOMA

SAULT STE. MARIE MINING DIVISION

Scale: 40 chains to an inch.

BARNES TP.

M. 1532

OFFICE MAP

TWP. 28. R. 20.

Ref. by O.L.S. W Beatty 1901

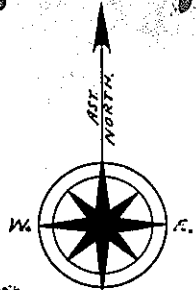

TWP. 29. R. 19.

Run by O.L.S. W Beatty 1901

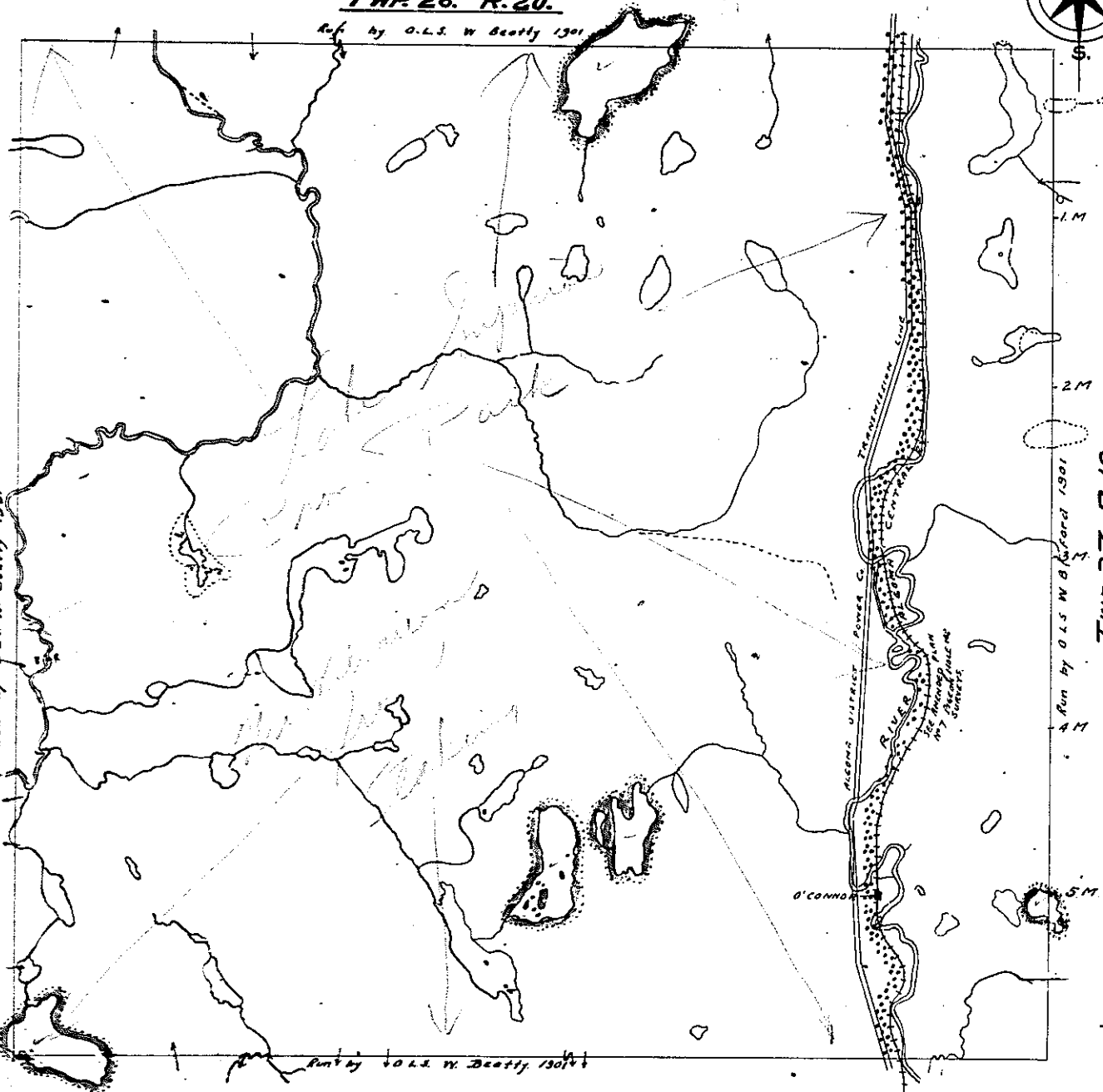

TWP. 27. R. 19.

Run by O.L.S. W Beatty 1901

TWP. 28. R. 18.

Run by O.L.S. W Beatty 1901

Twp. 28. R. 19. West of the R. of Way of The Algoma Central and Hudson Bay Railway, - except granted Crown Lands - forms part of the Lake Superior Provincial Park by O.L.C. dated 13th Jan'y 1944. File 125864. East Bdy. of Park area shown 2x2:22

Surface reservations 200' wide by Dept of L. & R. shown hereon thus: ~~XXXXXXXXXX~~

BARNES

ONTARIO

MINISTRY OF NATURAL RESOURCES
SURVEYS AND MAPPING BRANCH

LAKE SUPERIOR DISTRICT
SAULT STE. MARIE MINING DIVISION
Scale: 40 chains to an inch.

STONEYP. TP. M. 1533

Ref. by O.L.S. W. Beatty 1901



BARAGER TP. M. 1544

Run by O.L.S. W. Beatty 1901

LAKE SUPERIOR
PROVINCIAL PARK

BEAUDIN TP. M. 1519

Run by O.L.S. W. Beatty 1901

BULLOCK TP.

TWR. 28. R. 19. West of the Rl. of Way of The Algoma Central and Hudson Bay Railway, - except granted Crown Lands-forms part of the Lake Superior Provincial Park by O.L.C. dated 13th Jan'y 1944. File 125864. East Bdy. of Park area shown 3:1-3:6

AREA WITHIN THE LAKE SUPERIOR PROVINCIAL PARK WITHDRAWN FROM STAKING

400' Reserve around Lakes and Rivers to Dept. of Lands & Forests.

ALGOMA CENTRAL RIVERS
TRANSMISSION LINE
ALGOMA CENTRAL
O'CONNOR

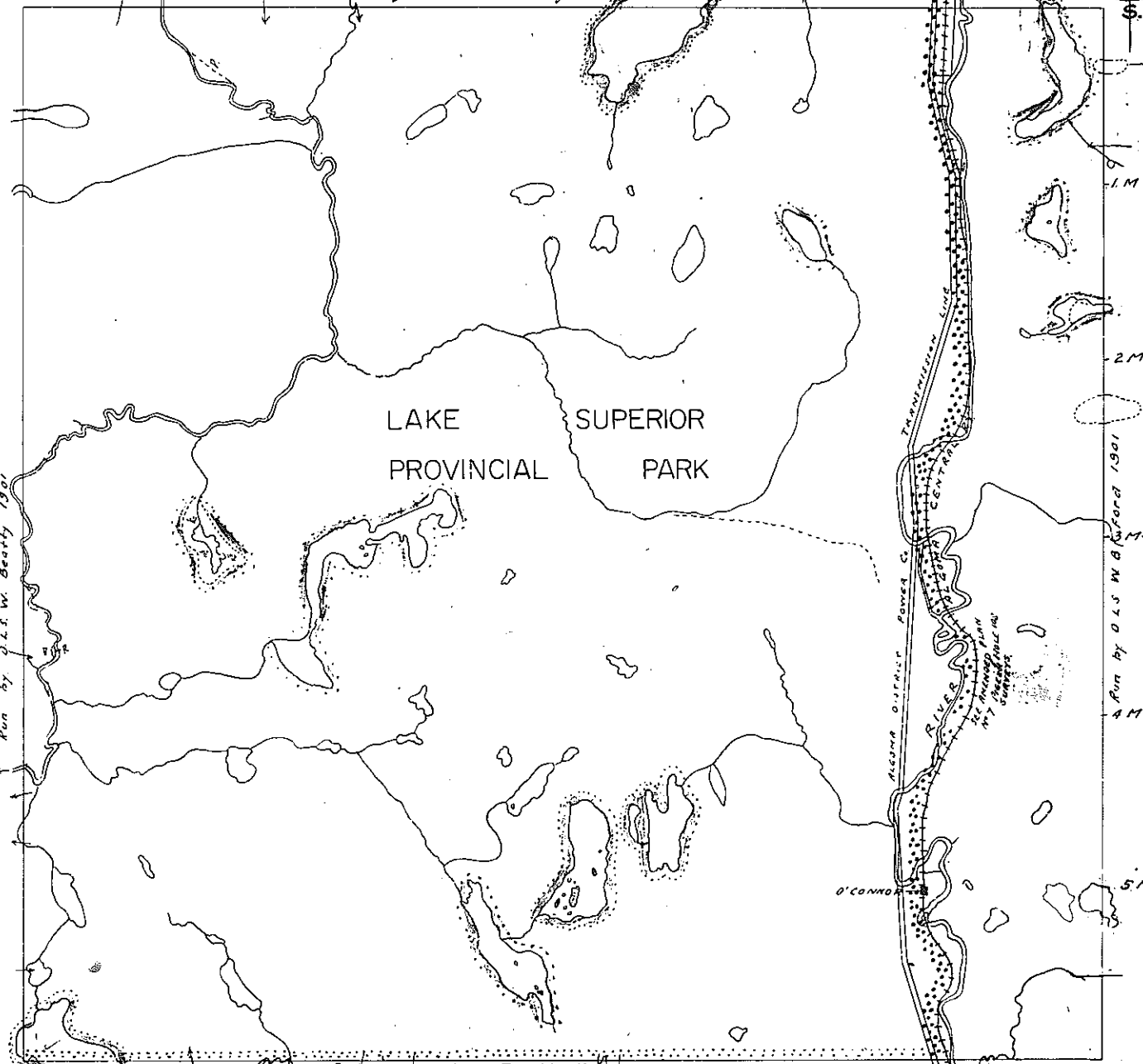

6 4 2 1 2 4 6

DATE OF ISSUE
APR 15, 1975

BARNES TP

(Tp. 28, R. 19)

LAKE SUPERIOR PROVINCIAL PARK

DISTRICT OF ALGOMA

SAULT STE. MARIE MINING DIVISION

Scale: 40 chains to an inch.

G.2408

M.1532

ONTARIO

MINISTRY OF NATURAL RESOURCES

SURVEYS AND MAPPING BRANCH



STONEY TP. M.1533

Ref. by O.L.S. W. Beatty 1901

BARAGER TP. M. 1544

Run by O.L.S. W. Beatty 1901

LAKE SUPERIOR PROVINCIAL PARK

BEAUDIN TP. M. 1519

Run by O.L.S. W. Beatty 1901

BULLOCK TP.

Run by O.L.S. W. Beatty 1901

Twa 28. R. 19. West of the Rt. of Way of The Algoma Central and Hudson Bay Railway, - except granted Crown Lands - forms part of the Lake Superior Provincial Park by O.L.C. dated 13th July 1944. File 125864. East Bay of Park area shown hatched.

AREA WITHIN THE LAKE SUPERIOR PROVINCIAL PARK WITHDRAWN FROM STAKING.

400' Reserve around all Lakes and Rivers to Dept. of Lands & Forests.

