

Methuen Twp. M.126

THE TOWNSHIP

OF

**BELMONT**

COUNTY OF  
PETERBOROUGH

SOUTHERN ONTARIO  
MINING DIVISION

SCALE: 1-INCH = 40 CHAINS

**LEGEND**

- FATENTED LAND
- CROWN LAND SALE
- LEASES
- LOCATED LAND
- LICENSE OF OCCUPATION
- MINING RIGHTS ONLY
- SURFACE RIGHTS ONLY
- ROADS
- IMPROVED ROADS
- KINGS HIGHWAYS
- RAILWAYS
- POWER LINES
- MARSH OR MUSKOG
- MINES
- PATENTED LAND-S.R.O.

**NOTES**

This Map is Not To Be Used  
FOR SURVEY PURPOSES

400' Surface Rights Reservation along  
the shores of all lakes and rivers

Original shoreline shown thus: ———  
F.R. shoreline shown thus: - - - - -  
Potents Map shoreline shown thus: ~ ~ ~ ~ ~

For details of Islands in this Township  
visit to Ministry of Natural Resources  
Records

Four Islands in Crowe Lake opposite Lots  
8 & 9 - 300' Reserved for Public Use.  
File: 146610.

**BELMONT LAKE ONLY.**  
PRESENT SHORELINE SHOWN THUS: ———  
ORIGINAL SHORELINE SHOWN THUS: - - - - -

AREA SHOWN THUS: IS A REVISION OF  
PORTION OF THE ORIGINAL TOWNSHIP PLAN  
AND HAS BEEN COMPILED FROM RESURVEYS AS  
AUTHORIZED BY THE SURVEYOR GENERAL. 52446

DATE OF ISSUE

1971 - 1974

SOUTHERN ONTARIO  
MINING DIVISION

THE INFORMATION THAT  
APPEARS ON THIS MAP  
HAS BEEN COMPILED  
FROM VARIOUS SOURCES  
AND ACCURACY IS NOT  
GUARANTEED. THEREFORE  
WARNING TO STAKEHOLDERS  
AND CLAIMS SHOULD CON-  
SULT WITH THE MINING  
RECORDS DIVISION OF  
NORTHERN DEVELOP-  
MENT AND MINES FOR AC-  
DITIONAL INFORMATION  
ON THE STATUS OF THE  
LANDS SHOWN HEREON

PLAN NO. M.53

ONTARIO

MINISTRY OF NATURAL RESOURCES  
SURVEYS AND MAPPING BRANCH

Dummer Twp.

Marmora Twp. M.122

Asphodel Twp.

Seymour Twp. M.149

**BELMONT**COUNTY OF  
PETERBOROUGH**SOUTHERN ONTARIO  
MINING DIVISION**

SCALE: 1-INCH = 40 CHAINS

**LEGEND**

FATIGUED LAND  
CROWN LAND S.E.  
LEASES  
LOCATED LAND  
LICENSE OF OCCUPATION  
MINING RIGHTS ONLY  
SURFACE RIGHTS ONLY  
IMPROVED ROADS  
KINGS HIGHWAYS  
RAILWAYS  
POWER LINES  
MARSH OR MUSKEG  
MINES  
PATENTED LAND-S.R.O.

**NOTES**

This Map is Not To Be Used  
FOR SURVEY PURPOSES—

400' Surface Rights Reservation along  
the shores of all lakes and rivers

Original shoreline shown thus: —  
F.R.I. shoreline shown thus: —  
Patents Map shoreline shown thus: —

For sites of Islands in this Township  
refer to Ministry of Natural Resources  
142262

Four islands in Crowe Lake opposite Lots  
9 & 9 Con.J Reserved for Public Use.  
File 146610.

**BELMONT LAKE ONLY.**  
PRESENT SHORELINE SHOWN THUS:  
ORIGINAL SHORELINE SHOWN THUS:  
AREA SHOWN THUS IS A REVISION OF  
PORTION OF THE ORIGINAL TOWNSHIP PLAN  
AND HAS BEEN COMPILED FROM RESURVEYS AS  
AUTHORIZED BY THE SURVEYOR GENERAL. 52446

**DATE OF ISSUE**

JUL 27 1995

SOUTHERN ONTARIO  
MINING DIVISION

THE INFORMATION THAT  
APPEARS ON THIS MAP  
HAS BEEN COMPILED  
AND ACCURACY IS NOT  
GUARANTEED. THOSE  
WHO CLAIM SHOULD  
CONSULT WITH THE MINING  
RECORDS, MINISTRY OF  
NORTHERN DEVELOPMENT  
AND MINES FOR ADDITIONAL  
INFORMATION ON THE STATUS OF THE  
LANDS SHOWN HEREON.

PLAN NO.-M.53

ONTARIO  
MINISTRY OF NATURAL RESOURCES  
SURVEYS AND MAPPING BRANCH

Dummer Twp.

Asphodel Twp.

Marmora Twp. M. 122

Seymour Twp. M. 149



**BELMONT**COUNTY OF  
PETERBOROUGHSOUTHERN ONTARIO  
MINING DIVISION

SCALE: 1-INCH = 40 CHAINS

**LEGEND**

- FATENTED LAND OF C.S.  
CROWN LAND SALE C.S.  
LEASES L.O.  
LOCATED LAND L.O.  
LICENSE OF OCCUPATION L.O.  
MINING RIGHTS ONLY M.R.O.  
SURFACE RIGHTS ONLY S.R.O.  
ROADS S.R.O.  
IMPROVED ROADS S.R.O.  
KINGS HIGHWAYS S.R.O.  
RAILWAYS S.R.O.  
POWER LINES S.R.O.  
MARSH OR MUSKOG S.R.O.  
MINES S.R.O.  
PATENTED LAND - S.R.O. S.R.O.

**NOTES**

This Map is Not To Be Used  
FOR SURVEY PURPOSES—

400' Surface Rights Reservation along  
the shores of all lakes and rivers

Original shoreline shown thus:   
F.R.I. shoreline shown thus:   
Patented shoreline shown thus:

For status of lands in this Township  
refer to Ministry of Natural Resources  
records

Four islands in Crow Lake opposite Lots  
8 & 9 Con. I. Reserve for Public Use.  
File: 146610.

**BELMONT LAKE ONLY.**

PRESENT SHORELINE SHOWN THUS   
ORIGINAL SHORELINE SHOWN THUS

AREA SHOWN THIS MAP IS A REVISION OF  
PORTION OF THE ORIGINAL TOWNSHIP PLAN  
AND HAS BEEN COMPILED FROM RESURVEYS AS  
AUTHORIZED BY THE SURVEYOR GENERAL. 12-1-16

**DATE OF ISSUE**

JUN 24 1938

PROVINCIAL RECORDING  
OFFICE-SUDBURY

THE INFORMATION THAT  
APPEARS ON THIS MAP  
HAS BEEN COMPILED  
FROM VARIOUS SOURCES  
AND ACCURACY IS NOT  
GUARANTEED. THOSE  
WHO WISH TO MAKE  
MINING CLAIMS SHOULD  
CONSULT WITH THE  
RECORDS, MINISTRY OF  
NATURAL RESOURCES  
AND MINES FOR  
ADDITIONAL INFORMATION  
ON THE STATUS OF THE  
LANDS SHOWN HEREON.

PLAN NO. - M.53

ONTARIO  
MINISTRY OF NATURAL RESOURCES  
SURVEYS AND MAPPING BRANCH

Dummer Twp.

Asphodel Twp.

Marmora Twp. M. 122

Seymour Twp. M. 149



**BELMONT**COUNTY OF  
PETERBOROUGHSOUTHERN ONTARIO  
MINING DIVISION

SCALE: 1-INCH = 40 CHAINS

**LEGEND**

FATENTED LAND  
CROWN LAND SALE  
LEASES  
LOCATED LAND  
LICENSE OF OCCUPATION  
MINING RIGHTS ONLY  
SURFACE RIGHTS ONLY  
ROADS  
IMPROVED ROADS  
KINGS HIGHWAYS  
RAILWAYS  
POWER LINES  
MARSH OR MUSKEG  
MINES  
PATENTED LAND-S.R.O.

**NOTES**

This Map Is Not To Be Used  
FOR SURVEY PURPOSES—

400' Surface Rights Retention along  
the shores of all lakes and rivers

Original shoreline shown thus: ———

F.R.I. shoreline shown thus: ———

Patented shoreline shown thus: ———

For status of lands in this Township  
refer to Ministry of Natural Resources  
records

For islands in Crowe Lake opposite Lots  
8 & 9 Con. 1 Reserved for Public Use.  
File: 146610.

**BELMONT LAKE ONLY.**

PRESENT SHORELINE SHOWN THUS: ———  
ORIGINAL SHORELINE SHOWN THUS: ———

AREA SHOWN THIS SIDE IS A REVISION OF  
PORTION OF THE ORIGINAL TOWNSHIP PLAN  
AND HAS BEEN COMPILED FROM RESURVEYS AS  
AUTHORIZED BY THE SURVEYOR GENERAL. 12-1-96

THE INFORMATION THAT  
APPEARS ON THIS MAP  
HAS BEEN COMPILED  
FROM VARIOUS SOURCES  
AND ACCURACY IS NOT  
GUARANTEED. THOSE  
WISHING TO STAKE  
MINING CLAIMS SHOULD  
CONSULT WITH THE MINING  
RECORDS, MINISTRY OF  
NORTHERN DEVELOPMENT  
AND MINES FOR ADDITIONAL  
INFORMATION ON THE STATUS OF THE  
LANDS SHOWN HEREON.

PLAN NO.-M.53

ONTARIO  
MINISTRY OF NATURAL RESOURCES  
SURVEYS AND MAPPING BRANCH

Dummer Twp.

Asphodel Twp.

Marmora Twp. M. 122



THE TOWNSHIP  
OF  
**BELMONT**  
COUNTY OF  
PETERBOROUGH

EASTERN ONTARIO  
MINING DIVISION

SCALE: 1-INCH = 40 CHAINS

LEGEND

UNDEVELOPED LAND  
GRASS, LAND, LAKE  
LEASES  
LOCALITY AND  
LOCALITY OF OCCUPATION  
MINING RIGHTS ONLY  
SURFACE RIGHTS ONLY  
RAILROADS  
KINGS HIGHWAYS  
RAILWAYS  
POWER LINES  
MARSH OR MUSKIE  
MINES

NOTES

This Map is Not To Be Used  
FOR SURVEY PURPOSES

400' Surface Rights Reservation around  
Lakes & Rivers

Original Shading of this  
P.R. is shown on this  
PotentiMap showing them thus.

For status of lands in this place  
contact with the Forests

Four islands in Crane Lake opposite  
E.B. 9 Cont. Reserved for Public use  
File 146610.

BELMONT LAKE ONLY  
PRESENT SHORELINE SHOWN THIS  
ORIGINAL SHORELINE SHOWN THIS

AREA SHOWN THIS IS A REVISION OF  
PORTION OF THE ORIGINAL TOWNSHIP PLAN  
AND HAS BEEN COMPILED FROM RESURVEYS AS  
AUTHORIZED BY THE SURVEYOR GENERAL

MINING LANDS  
DATE OF ISSUE  
MAY 17 1974  
MINISTRY  
OF NATURAL RESOURCES

PLAN NO. M-53

ONTARIO  
MINISTRY OF NATURAL RESOURCES  
SURVEYS AND MAPPING BRANCH

Dummer Twp.

Asphodel Twp.

Marmora Twp.

Seymour Twp.

40 41 42 43 44 45 46 47 48 49 50 51 52 53 54 55 56 57 58 59 60 61 62 63 64 65 66 67 68 69 70 71 72 73 74 75 76 77 78 79 80 81 82 83 84 85 86 87 88 89 90 91 92 93 94 95 96 97 98 99 100 101 102 103 104 105 106 107 108 109 110

**BELMONT**COUNTY OF  
PETERBOROUGHEASTERN ONTARIO  
MINING DIVISION

SCALE: 1-INCH = 40 CHAINS

**LEGEND**

FATENTED LAND	⊙
CROWN LAND SALE	C.S.
LEASES	L.S.
LOCATED LAND	L.O.C.
LICENSE OF OCCUPATION	L.O.
MINING RIGHTS ONLY	M.R.O.
SURFACE RIGHTS ONLY	S.R.O.
IMPROVED ROADS	—
KINDS HIGHWAYS	—
RAILWAYS	—
POWER LINES	—
MARSH OR MUSKEG	—
MINES	*

**NOTES**

This Map Is Not To Be Used  
FOR SURVEY PURPOSES—

400' Surface Right Reservation along  
the shores of all lakes and rivers

Original shoreline shown thus: —

F.R.L. shoreline shown thus: —

PatentsMap shoreline shown thus: —

For status of islands in this Township  
refer to Ministry of Natural Resources  
FILES

Four Islands in Crowe Lake opposite Lots  
8 & 9 Con. I Reserved for Public Use.  
File: 146610.

**BELMONT LAKE ONLY.**

PRESENT SHORELINE SHOWN THUS —

ORIGINAL SHORELINE SHOWN THUS —

AREA SHOWN THUS IS A REVISION OF  
PORTION OF THE ORIGINAL TOWNSHIP PLAN  
AND HAS BEEN COMPILED FROM RESURVEYS AS  
AUTHORIZED BY THE SURVEYOR GENERAL.

MINING LANDS  
DATE OF ISSUE  
JAN - 9 1975  
MINISTRY OF NATURAL RESOURCES

PLAN NO. **M.53**

ONTARIO  
MINISTRY OF NATURAL RESOURCES  
SURVEYS AND MAPPING BRANCH

Dummer Twp.

Marmora Twp. M. 122

Asphodel Twp.

**BELMONT**COUNTY OF  
PETERBOROUGHEASTERN ONTARIO  
MINING DIVISION

SCALE: 1-INCH = 40 CHAINS

**LEGEND**

FATENTED LAND	⊙
CROWN LAND SALE	⊙
LEASES	⊙
LOCATED LAND	⊙
LICENSE OF OCCUPATION	⊙
MINING RIGHTS ONLY	⊙
SURFACE RIGHTS ONLY	⊙
ROADS	—
IMPROVED ROADS	—
KINGS HIGHWAYS	—
RAILWAYS	—
POWER LINES	—
MARSH OR MUSKEG	—
MINES	⊙

**NOTES****This Map is Not To Be Used  
FOR SURVEY PURPOSES**400' Surface Rights Reservation along  
the shores of all lakes and riversOriginal shoreline shown thus: —  
F.R.I. shoreline shown thus: —  
Patents Map shoreline shown thus: —For status of islands in this Township  
refer to Ministry of Natural Resources  
1202/02Four islands in Crowe Lake opposite Lots  
8 & 9 Cont. Reserved for Public Use.  
File: 146610.**BELMONT LAKE ONLY.**  
PRESENT SHORELINE SHOWN THUS —  
ORIGINAL SHORELINE SHOWN THUS —AREA SHOWN THUS — IS A REVISION OF  
PORTION OF THE ORIGINAL TOWNSHIP PLAN  
AND HAS BEEN COMPILED FROM RESURVEYS AS  
AUTHORIZED BY THE SURVEYOR GENERAL.MINING LANDS -  
DATE OF ISSUE  
SEP - 8 1975  
MINISTRY  
OF NATURAL RESOURCES

PLAN NO. - M.53

ONTARIO

MINISTRY OF NATURAL RESOURCES  
SURVEYS AND MAPPING BRANCH

Dummer Twp.

Marmora Twp. M.122

Asphodel Twp.



## BELMONT

COUNTY OF  
PETERBOROUGHEASTERN ONTARIO  
MINING DIVISION

SCALE: 1-INCH = 40 CHAINS

## LEGEND

FATENTED LAND	⊙
CROWN LAND SALE	⊙ S.
LEASES	⊙ L.
LOCATED LAND	⊙ Loc.
LICENSE OF OCCUPATION	⊙ L.O.
MINING RIGHTS ONLY	⊙ M.R.O.
SURFACE RIGHTS ONLY	⊙ S.R.O.
ROADS	—
IMPROVED ROADS	—
KINGS HIGHWAYS	—
RAILWAYS	—
POWER LINES	—
MARSH OR MUSKES	—
MINES	—

## NOTES

This Map Is Not To Be Used  
FOR SURVEY PURPOSES—

400' Surface Rights Reservation along  
the shores of all lakes and rivers

Original shoreline shown thus: —  
F.R.L. shoreline shown thus: —  
Patents Map shoreline shown thus: —

For status of Islands in this Township  
refer to Ministry of Natural Resources  
File # 146610.

Four Islands in Crowe Lake opposite Lots  
8 & 9 Con. I Reserved for Public Use.  
File # 146610.

BELMONT LAKE ONLY.  
PRESENT SHORELINE SHOWN THUS: —  
ORIGINAL SHORELINE SHOWN THUS: —

AREA SHOWN THUS: — IS A REVISION OF  
PORTION OF THE ORIGINAL TOWNSHIP PLAN  
AND HAS BEEN COMPILED FROM RESURVEYS AS  
AUTHORIZED BY THE SURVEYOR GENERAL.

MINING LANDS -  
DATE OF ISSUE  
NOV - 3 1915  
MINISTRY  
OF NATURAL RESOURCES

PLAN NO. - M.53

Dummer Twp.

Asphodel Twp.

Marmora Twp. M. 122

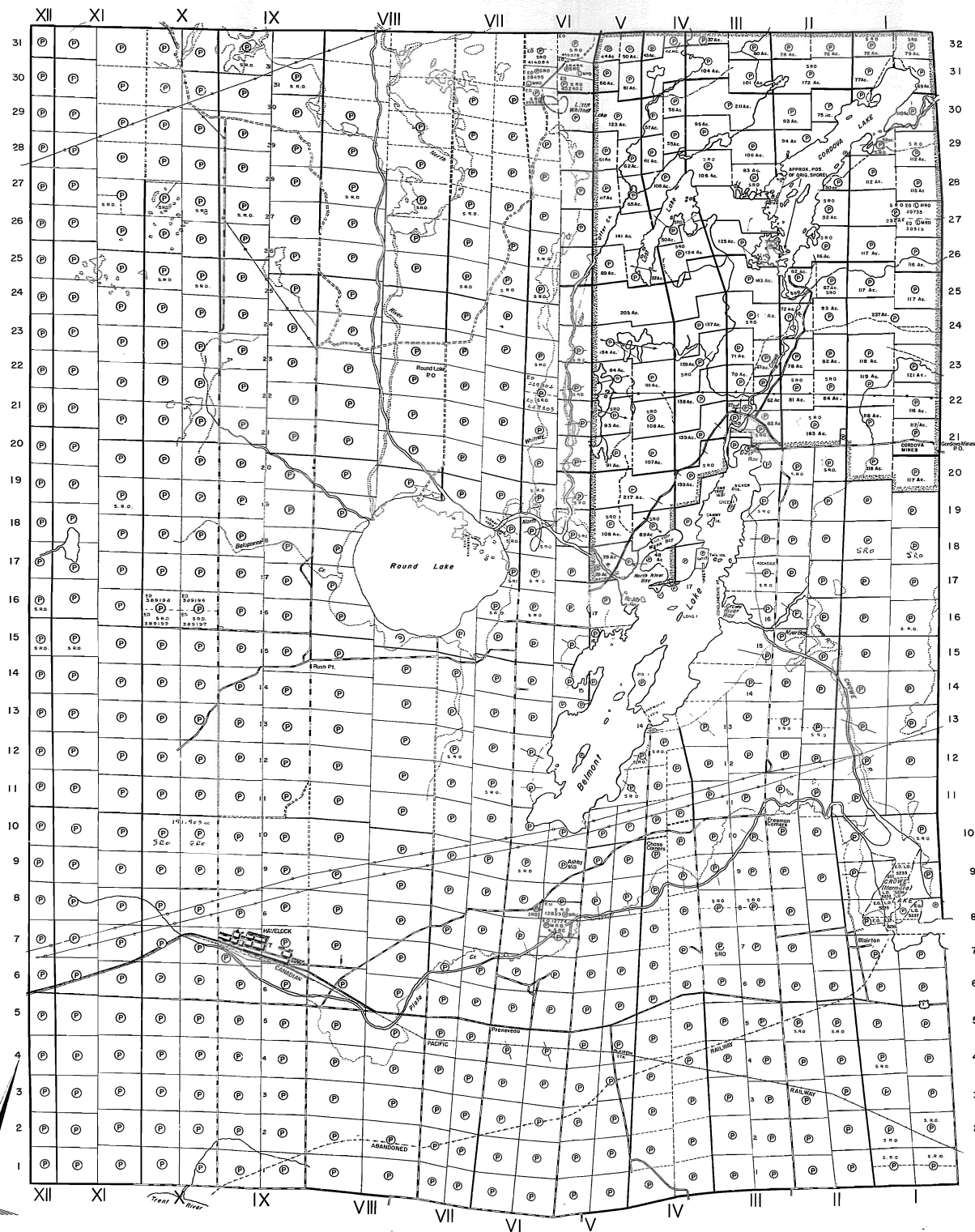

COUNTY OF  
PETERBOROUGHEASTERN ONTARIO  
MINING DIVISION

SCALE: 1-INCH = 40 CHAINS

## LEGEND

- PATENTED LAND (P)  
 CROWN LAND SALE (C.S.)  
 LEASES (L)  
 LOCATED LAND (L.O.)  
 LICENSE OF OCCUPATION (L.O.)  
 MINING RIGHTS ONLY (M.R.O.)  
 SURFACE RIGHTS ONLY (S.R.O.)  
 ROADS (R)  
 IMPROVED ROADS (R.I.)  
 KINGS HIGHWAYS (K.H.)  
 RAILWAYS (R.L.)  
 POWER LINES (P.L.)  
 MARSH OR MUSKIE (M.M.)  
 MINES (M)

## NOTES

This Map is Not To Be Used  
FOR SURVEY PURPOSES—

400' Surface Rights Reservation along  
the shores of all lakes and rivers

Original shoreline shown thus: ————  
F.R.I. shoreline shown thus: ————  
PatentsMap shoreline shown thus: ————

For status of islands in this Township  
refer to Ministry of Natural Resources  
records.

Four Islands in Crow Lake opposite Lots  
8, 9, 10, 11 Reserved for Public Use.  
File: 146610.

**BELMONT LAKE ONLY.**  
PRESENT SHORELINE SHOWN THUS: ————  
ORIGINAL SHORELINE SHOWN THUS: ————  
AREA SHOWN THUS: ———— IS A REVISION OF  
PORTION OF THE ORIGINAL TOWNSHIP PLAN  
AND HAS BEEN COMPILED FROM RESURVEYS AS  
AUTHORIZED BY THE SURVEYOR GENERAL.

DATE OF ISSUE  
MAY 28 1976  
SURVEYS AND MAPPING  
BRANCH

PLAN NO. M.53

ONTARIO

MINISTRY OF NATURAL RESOURCES

Dummer Twp.

Asphodel Twp.

Marmora Twp. M. 122

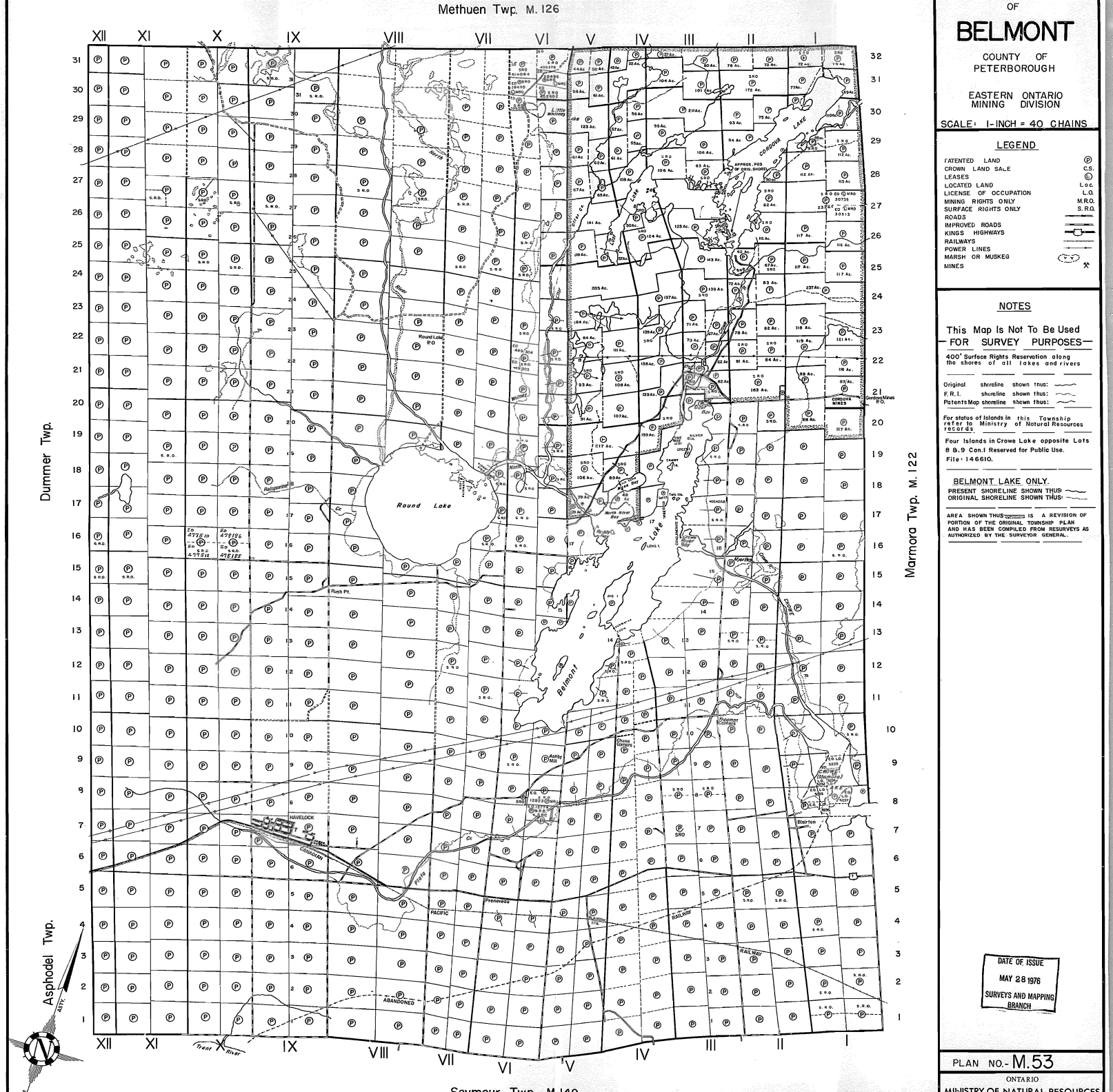

**BELMONT**COUNTY OF  
PETERBOROUGHEASTERN ONTARIO  
MINING DIVISION

SCALE: 1-INCH = 40 CHAINS

**LEGEND**

PATENTED LAND	● or ⊙
CROWN LAND SALE	○ S.
LEASES	○ L.
LOCATED LAND	○ Loc.
LICENSE OF OCCUPATION	○ L.O.
MINING RIGHTS ONLY	○ M.R.O.
SURFACE RIGHTS ONLY	○ S.R.O.
ROADS	—
IMPROVED ROADS	—
KINGS HIGHWAYS	—
RAILWAYS	—
POWER LINES	—
MARSH OR MUSKES	—
MINES	—
PATENTED LAND - S.R.O.	—

**NOTES****This Map Is Not To Be Used  
FOR SURVEY PURPOSES—**400' Surface Rights Reservation along  
the shores of all lakes and riversOriginal shoreline shown thus: —  
F.R.I. shoreline shown thus: —  
Patents Map shoreline shown thus: —For status of Islands in this Township  
refer to Ministry of Natural Resources  
recordsFour Islands in Crowe Lake opposite Lots  
8 & 9 Con. I Reserved for Public Use.  
File: 146610.**BELMONT LAKE ONLY.**PRESENT SHORELINE SHOWN THUS: —  
ORIGINAL SHORELINE SHOWN THUS: —AREA SHOWN THUS: — IS A REVISION OF  
PORTION OF THE ORIGINAL TOWNSHIP PLAN  
AND HAS BEEN COMPILED FROM RESURVEYS AS  
AUTHORIZED BY THE SURVEYOR GENERAL.**DATE OF ISSUE**

JUN 10 1976

**SURVEYS AND MAPPING  
BRANCH**

Dummer Twp.

Asphodel Twp.

Marmora Twp. M. 122

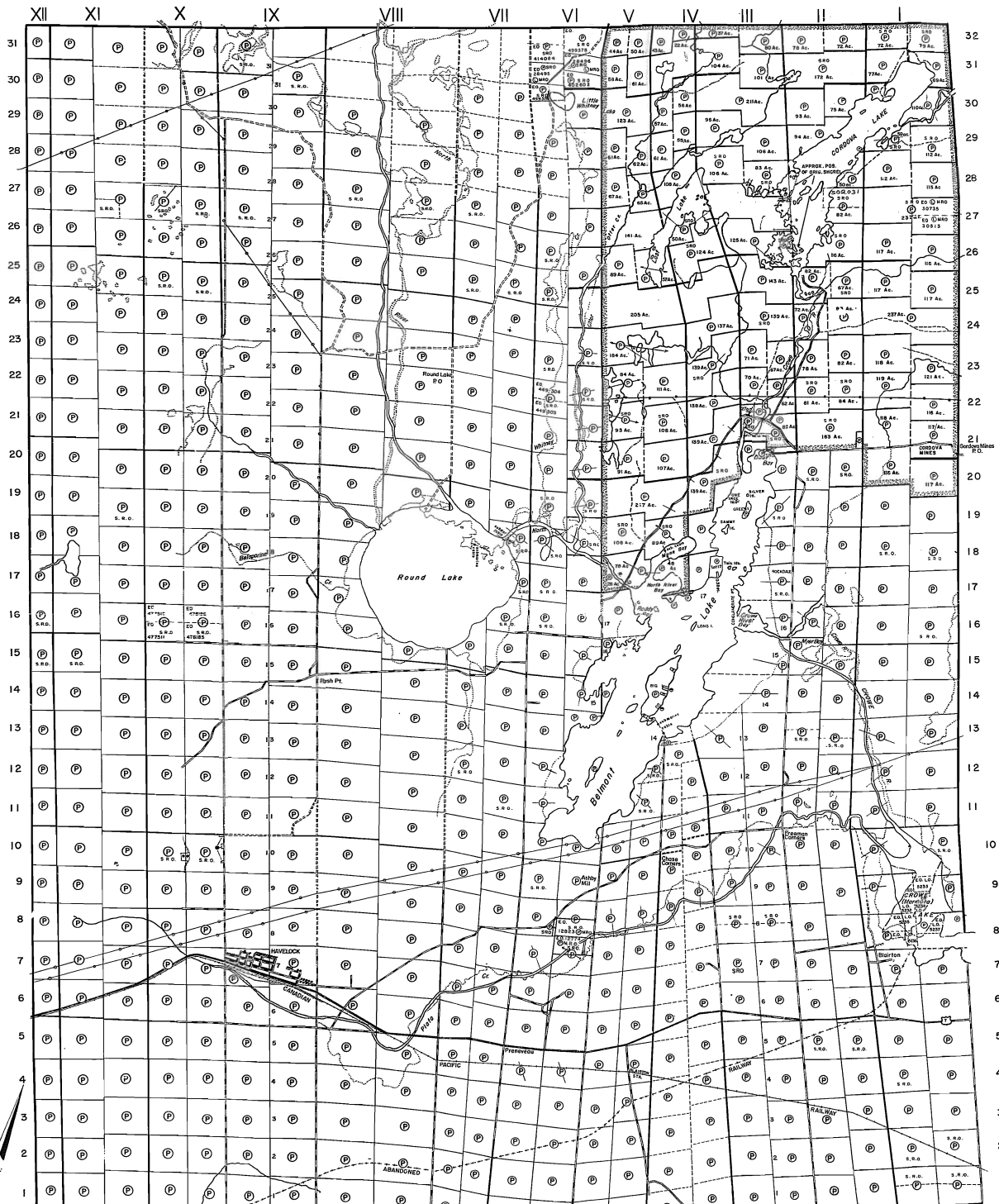



## BELMONT

COUNTY OF  
PETERBOROUGHEASTERN ONTARIO  
MINING DIVISION

SCALE: 1-INCH = 40 CHAINS

## LEGEND

- FATENTED LAND  
CROWN LAND SALE  
LEASES  
LOCATED LAND  
LICENSE OF OCCUPATION  
MINING RIGHTS ONLY  
SURFACE RIGHTS ONLY  
ROADS  
IMPROVED ROADS  
KINGS' HIGHWAYS  
RAILWAYS  
POWER LINES  
MARSH OR MUSKIEG  
MINES  
PATENTED LAND-S.R.O.
- or (P)  
C.S.  
L.O.C.  
L.O.  
M.R.O.  
S.R.O.

## NOTES

This Map Is Not To Be Used  
FOR SURVEY PURPOSES

400' Surface Rights Reservation along  
the shores of all lakes and rivers

Original shoreline shown thus: —  
F.R.I. shoreline shown thus: —  
Patents Map shoreline shown thus: —

For status of Islands in this Township  
refer to Ministry of Natural Resources  
# 25 01 23.  
Four Islands in Crowe Lake opposite Lots  
# 9, 9 Con. I Reserved for Public Use.  
File: 146610.

BELMONT LAKE ONLY.  
PRESENT SHORELINE SHOWN THUS  
ORIGINAL SHORELINE SHOWN THUS: —

AREA SHOWN THUS: — IS A REVISION OF  
PORTION OF THE ORIGINAL TOWNSHIP PLAN  
AND HAS BEEN COMPILED FROM RESURVEYS AS  
AUTHORIZED BY THE SURVEYOR GENERAL.

DATE OF ISSUE

NOV - 2 1977

SURVEYS AND MAPPING

BRANCH

PLAN NO.-M.53

ONTARIO  
MINISTRY OF NATURAL RESOURCES

Dummer Twp.

Asphodel Twp.

Marmora Twp. M.122

## BELMONT

COUNTY OF *Central*  
PETERBOROUGH  
*D.M. Lindsay*EASTERN ONTARIO  
MINING DIVISION

SCALE: 1-INCH = 40 CHAINS

## LEGEND

- FATENTED LAND ● or ⊙
- CROWN LAND SALE
- LEASES ⊙
- LOCATED LAND L.C.
- LICENSE OF OCCUPATION L.O.
- MINING RIGHTS ONLY M.R.O.
- SURFACE RIGHTS ONLY S.R.O.
- ROADS
- IMPROVED ROADS
- KINGS HIGHWAYS
- RAILWAYS
- POWER LINES
- MARSH OR MUSKOG ⊙
- MINES ⊙
- PATENTED LAND - S.R.O. ⊙

## NOTES

This Map Is Not To Be Used  
FOR SURVEY PURPOSES400' Surface Rights Reservation along  
the shores of all lakes and riversOriginal shoreline shown thus: —  
F.R.I. shoreline shown thus: —  
Patents Map shoreline shown thus: —For status of Islands in this Township  
refer to Ministry of Natural Resources  
RESOURCESFour Islands in Crowe Lake opposite Lots  
8 & 9 Con. I Reserved for Public Use.  
File: 146610.

## BELMONT LAKE ONLY.

PRESENT SHORELINE SHOWN THUS: —  
ORIGINAL SHORELINE SHOWN THUS: —AREA SHOWN THUS — IS A REVISION OF  
PORTION OF THE ORIGINAL TOWNSHIP PLAN  
AND HAS BEEN COMPILED FROM RESURVEYS AS  
AUTHORIZED BY THE SURVEYOR GENERAL.

Dummer Twp.

Asphodel Twp.

Marmora Twp. M. 122

DATE OF ISSUE

JUN 18 1900

SURVEYS AND MAPPING  
BRANCH

BELMONT

COUNTY OF  
PETERBOROUGHEASTERN ONTARIO  
MINING DIVISION

SCALE: 1-INCH = 40 CHAINS

## LEGEND

(P) TENTED LAND  
 (C) CROWN LAND SALE  
 (L) LEASES  
 (O) LOCATED LAND  
 (S) LICENSE OF OCCUPATION  
 (M) MINING RIGHTS ONLY  
 (R) SURFACE RIGHTS ONLY  
 (I) ROADS  
 (D) IMPROVED ROADS  
 (K) KINGS HIGHWAYS  
 (R) RAILWAYS  
 (P) POWER LINES  
 (M) MARSH OR MUSKIEG  
 (M) MINES  
 (P) PATENTED LAND - S.R.O.

## NOTES

**This Map Is Not To Be Used  
FOR SURVEY PURPOSES**

400' Surface Rights Reservation along  
the shores of all lakes and rivers

Original shoreline shown thus: ———  
 F.R.I. shoreline shown thus: - - -  
 Patents Map shoreline shown thus: ———

For status of Islands in this Township  
 refer to Ministry of Natural Resources  
 File: 146610.

## BELMONT LAKE ONLY.

PRESENT SHORELINE SHOWN THUS: ———  
 ORIGINAL SHORELINE SHOWN THUS: - - -

AREA SHOWN THUS: ——— IS A REVISION OF  
 PORTION OF THE ORIGINAL TOWNSHIP PLAN  
 AND HAS BEEN COMPILED FROM RECENT SURVEYS AS  
 AUTHORIZED BY THE SURVEYOR GENERAL.

DATE OF ISSUE

JUN - 9 1962

Ministry of Natural Resources  
TORONTO

Dummer Twp.

Asphodel Twp.

Marmora Twp. M. 122

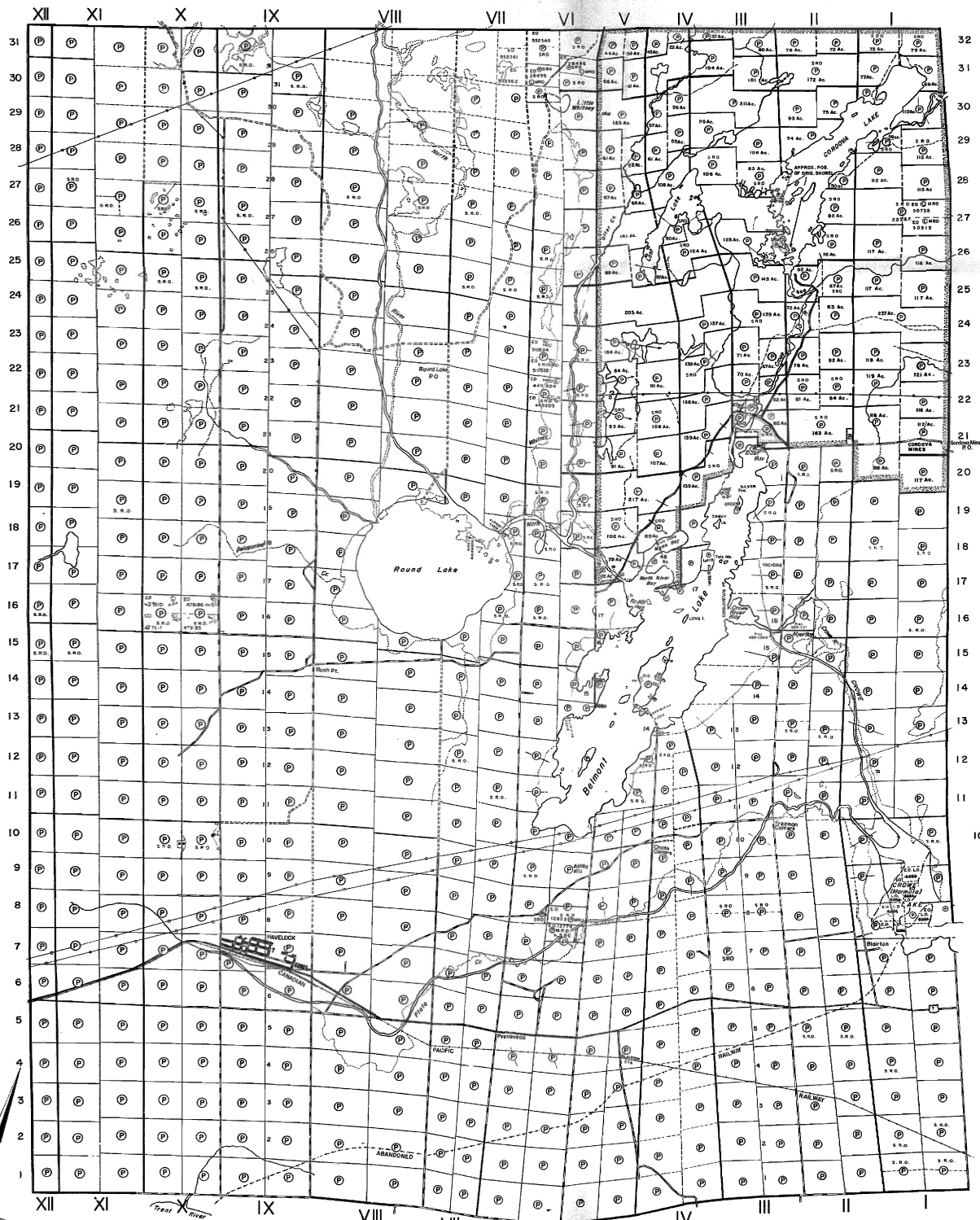



COUNTY OF  
PETERBOROUGH

EASTERN ONTARIO  
MINING DIVISION

SCALE: 1-INCH = 40 CHAINS

### LEGEND

FATENTED LAND  
CROWN LAND SALE  
LEASES  
LOCATED LAND  
LICENSE OF OCCUPATION  
MINING RIGHTS ONLY  
SURFACE RIGHTS ONLY  
ROADS  
IMPROVED ROADS  
KINSS HIGHWAYS  
RAILWAYS  
POWER LINES  
MARSH OR MUSKEG  
MINES  
PATENTED LAND-S.R.O.

## NOTES

This Map Is Not To Be Used  
— FOR SURVEY PURPOSES —

400' Surface Rights Reservation along the shores of all lakes and rivers

Original	shoreline	shown thus:
F. R. I.	shoreline	shown thus:
Patents Map	shoreline	shown thus:

For status of Islands in this Township  
refer to Ministry of Natural Resources  
records

Four Islands in Crowe Lake opposite Lots  
8 & 9 Con.1 Reserved for Public Use.  
File: 146610.

**BELMONT LAKE ONLY.**

PRESENT SHORELINE SHOWN THUS:  
ORIGINAL SHORELINE SHOWN THUS:

AREA SHOWN THUS ~~REVISION~~ IS A REVISION OF  
PORTION OF THE ORIGINAL TOWNSHIP PLAN  
AND HAS BEEN COMPILED FROM RESURVEYS AS  
AUTHORIZED BY THE SURVEYOR GENERAL. F394

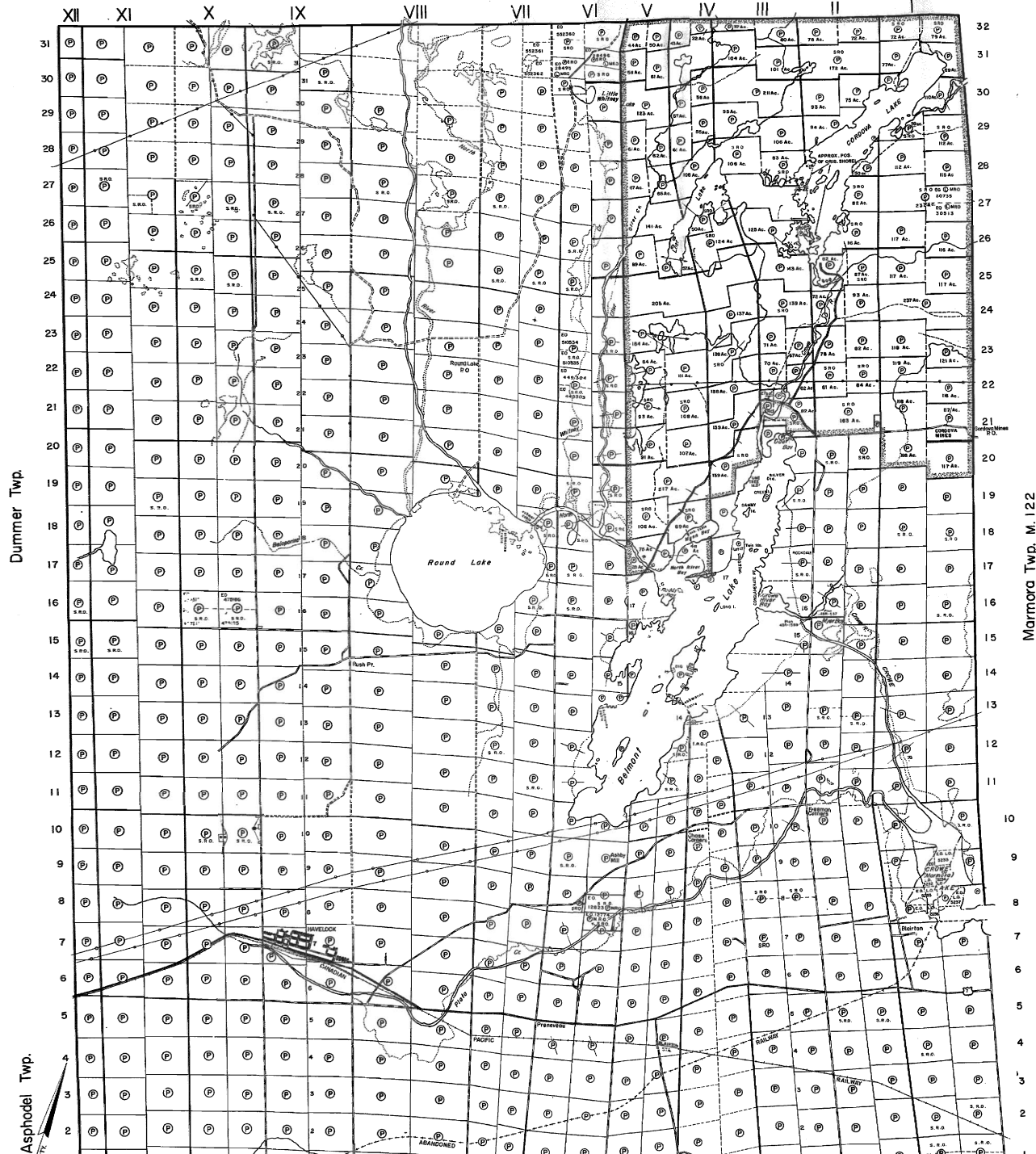

Marmora Twp. M. 122

DATE OF ISSUE  
JUL - 6 1982

## BELMONT

COUNTY OF  
PETERBOROUGH  
D.M. LINDSAY  
EASTERN ONTARIO  
MINING DIVISION

SCALE: 1-INCH = 40 CHAINS

## LEGEND

FATENTED LAND  
CROWN LAND SALE  
LEASES  
LOCATED LAND  
LICENSE OF OCCUPATION  
MINING RIGHTS ONLY  
SURFACE RIGHTS ONLY  
ROADS  
IMPROVED ROADS  
KINGS HIGHWAYS  
RAILWAYS  
POWER LINES  
MARSH OR MUSKEG  
MINES  
PATENTED LAND - S.R.O.



## NOTES

This Map Is Not To Be Used  
FOR SURVEY PURPOSES—

400' Surface Rights Reservation along  
the shores of all lakes and rivers

Original shoreline shown thus: —  
P.R.I. shoreline shown thus: —  
PatentsMap shoreline shown thus: —  
For status of islands in this Township  
refer to Ministry of Natural Resources  
records

Four Islands in Crowe Lake opposite Lots  
8 & 9 Cont. Reserved for Public Use.  
File: 146610.

BELMONT LAKE ONLY.  
PRESENT SHORELINE SHOWN THUS: —  
ORIGINAL SHORELINE SHOWN THUS: —

AREA SHOWN THUS: — is a REVISION OF  
PORTION OF THE ORIGINAL TOWNSHIP PLAN  
AND HAS BEEN COMPILED FROM RESURVEYS AS  
AUTHORIZED BY THE SURVEYOR GENERAL. P2446

DATE OF ISSUE

JUN 22 1983

Ministry of Natural Resources  
TORONTO

Dummer Twp.

Asphodel Twp.

Marmora Twp. M. 122

# BELMONT

LINDSAY DISTRICT  
COUNTY OF  
PETERBOROUGH  
RESIDENT GEOLOGIST-TWENTY  
SOUTHERN ONTARIO  
MINING DIVISION

SCALE: 1-INCH = 40 CHAINS

## LEGEND

- PATENTED LAND ● or ⊙
- CROWN LAND SALE C.S.
- LEASES L.O.
- LOCATED LAND Loc.
- LICENSE OF OCCUPATION L.O.O.
- MINING RIGHTS ONLY M.R.O.
- SURFACE RIGHTS ONLY S.R.O.
- ROADS
- IMPROVED ROADS
- KINGS HIGHWAYS
- RAILWAYS
- POWER LINES
- MARSH OR MUSKEG
- MINES
- PATENTED LAND-S.R.O.

## NOTES

This Map Is Not To Be Used  
FOR SURVEY PURPOSES

400' Surface Rights Reservation along  
the shores of all lakes and rivers

Original shoreline shown thus: ———  
F.R.I. shoreline shown thus: ———  
Patents Map shoreline shown thus: ———

For status of islands in this Township  
refer to Ministry of Natural Resources

Four islands in Crowe Lake opposite Lots  
8 & 9 Con. I Reserved for Public Use.  
File: 146610.

BELMONT LAKE ONLY.  
PRESENT SHORELINE SHOWN THIS: ———  
ORIGINAL SHORELINE SHOWN THIS: ———

AREA SHOWN THIS: ——— IS A REVISION OF  
PORTION OF THE ORIGINAL TOWNSHIP PLAN  
AND HAS BEEN COMPILED FROM RESURVEYS AS  
AUTHORIZED BY THE SURVEYOR GENERAL. 72946

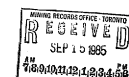

PLAN No. M.53

ONTARIO  
MINISTRY OF NATURAL RESOURCES  
SURVEYS AND MAPPING BRANCH

Dummer Twp.

Marmora Twp. M.122

Asphodel Twp.

Seymour Twp. M.149



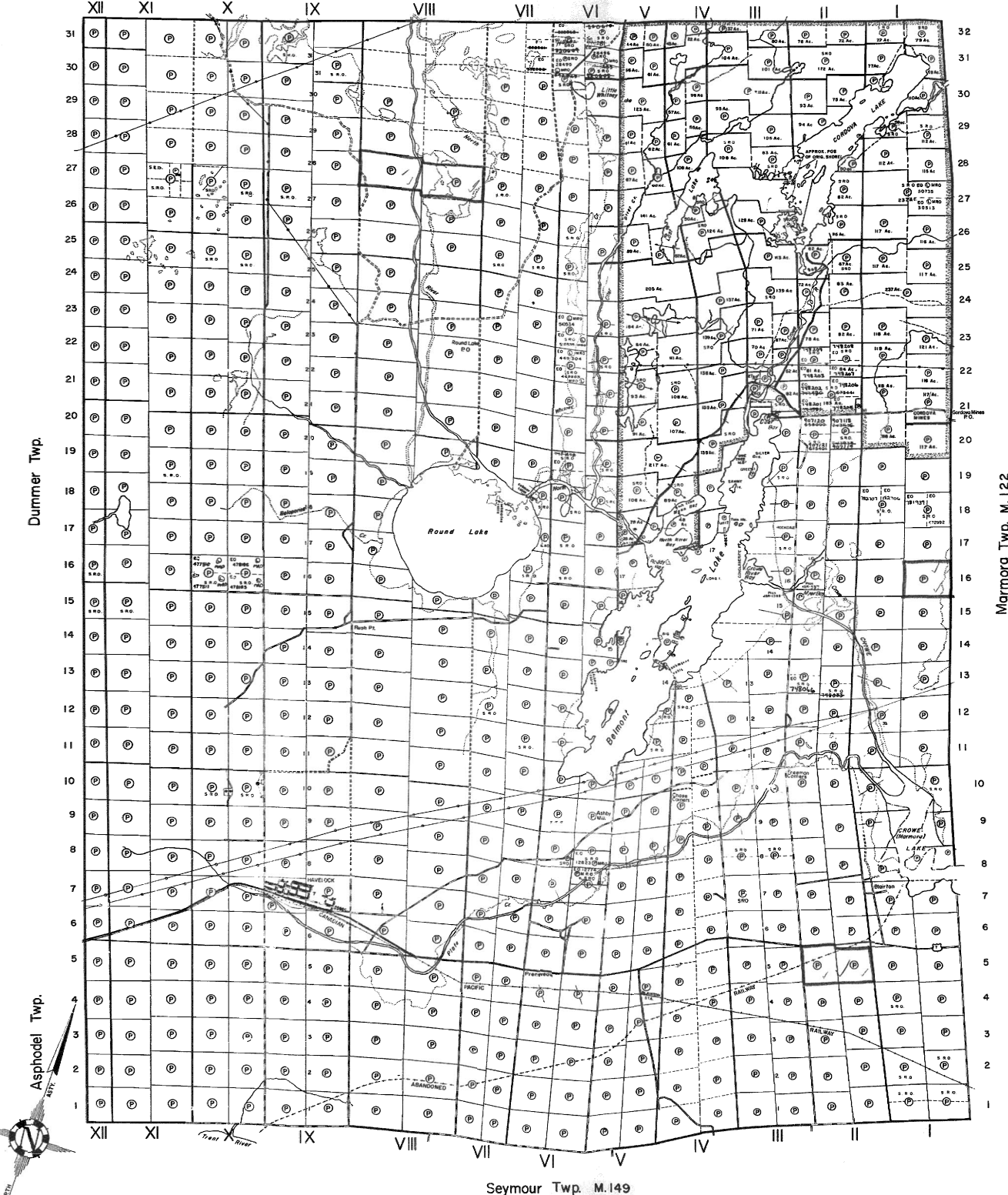

# BELMONT LAKE ONLY

COUNTY OF  
PETERBOROUGH

SOUTHERN ONTARIO  
MINING DIVISION

SCALE: 1-INCH = 40 CHAINS

## LEGEND

- PATENTED LAND
- CROWN LAND SALE
- LEASES
- LOCATED LAND
- LICENSE OF OCCUPATION
- WINNING RIGHTS ONLY
- SURFACE RIGHTS ONLY
- ROADS
- IMPROVED ROADS
- KINGS HIGHWAYS
- RAILWAYS
- POWER LINES
- MARSH OR MUSKOG
- MINES
- PATENTED LAND - S.R.O.

## NOTES

This Map Is Not To Be Used  
FOR SURVEY PURPOSES

400' Surface Rights Reservation along  
the shores of all lakes and rivers

Original shoreline shown thus:   
F.R.I. shoreline shown thus:   
Patents Map shoreline shown thus:

For status of islands in this Township  
refer to Ministry of Natural Resources  
File: 146610.

Four islands in Crowe Lake opposite Lots  
8 & 9 Cont. Reserved for Public Use.  
File: 146610.

BELMONT LAKE ONLY.  
PRESENT SHORELINE SHOWN THUS:   
ORIGINAL SHORELINE SHOWN THUS:

AREA SHOWN THUS: IS A REVISION OF  
PORTION OF THE ORIGINAL TOWNSHIP PLAN  
AND HAS BEEN COMPILED FROM RESURVEYS AS  
AUTHORIZED BY THE SURVEYOR GENERAL. P. 146

DATE OF ISSUE  
JULY 01 1988  
SOUTHERN ONTARIO  
MINING DIVISION

PLAN NO. - M.53

ONTARIO  
MINISTRY OF NATURAL RESOURCES  
SURVEYS AND MAPPING BRANCH

**BELMONT**COUNTY OF  
PETERBOROUGHSOUTHERN ONTARIO  
MINING DIVISION

SCALE: 1-INCH = 40 CHAINS

**LEGEND**

FATENTED LAND	● or ⊙
CROWN LAND SALE	○ C.S.
LEASES	○ L.O.
LOCATED LAND	○ L.O.
LICENSE OF OCCUPATION	○ M.R.O.
MINING RIGHTS ONLY	○ S.R.O.
SURFACE RIGHTS ONLY	○ S.R.O.
ROADS	—
IMPROVED ROADS	—
KINGS HIGHWAYS	—
RAILWAYS	—
POWER LINES	—
MARSH OR MUSKES	—
MINES	—
PATENTED LAND - S.R.O.	—

**NOTES**This Map Is Not To Be Used  
FOR SURVEY PURPOSES—400' Surface Rights Reservation along  
the shores of all lakes and riversOriginal shoreline shown thus: —  
F.R.I. shoreline shown thus: —  
Parents Map shoreline shown thus: —For status of islands in this Township  
refer to Ministry of Natural Resources  
recordsFour islands in Crowe Lake opposite Lots  
8 & 9 Con. I Reserved for Public Use.  
File: 146610.**BELMONT LAKE ONLY.**  
PRESENT SHORELINE SHOWN THUS  
ORIGINAL SHORELINE SHOWN THUSAREA SHOWN THUS IS A REVISION OF  
PORTION OF THE ORIGINAL TOWNSHIP PLAN  
AND HAS BEEN COMPILED FROM RESURVEYS AS  
AUTHORIZED BY THE SURVEYOR GENERAL 72446

Dummer Twp.

Marmora Twp. M. 122

Asphodel Twp.

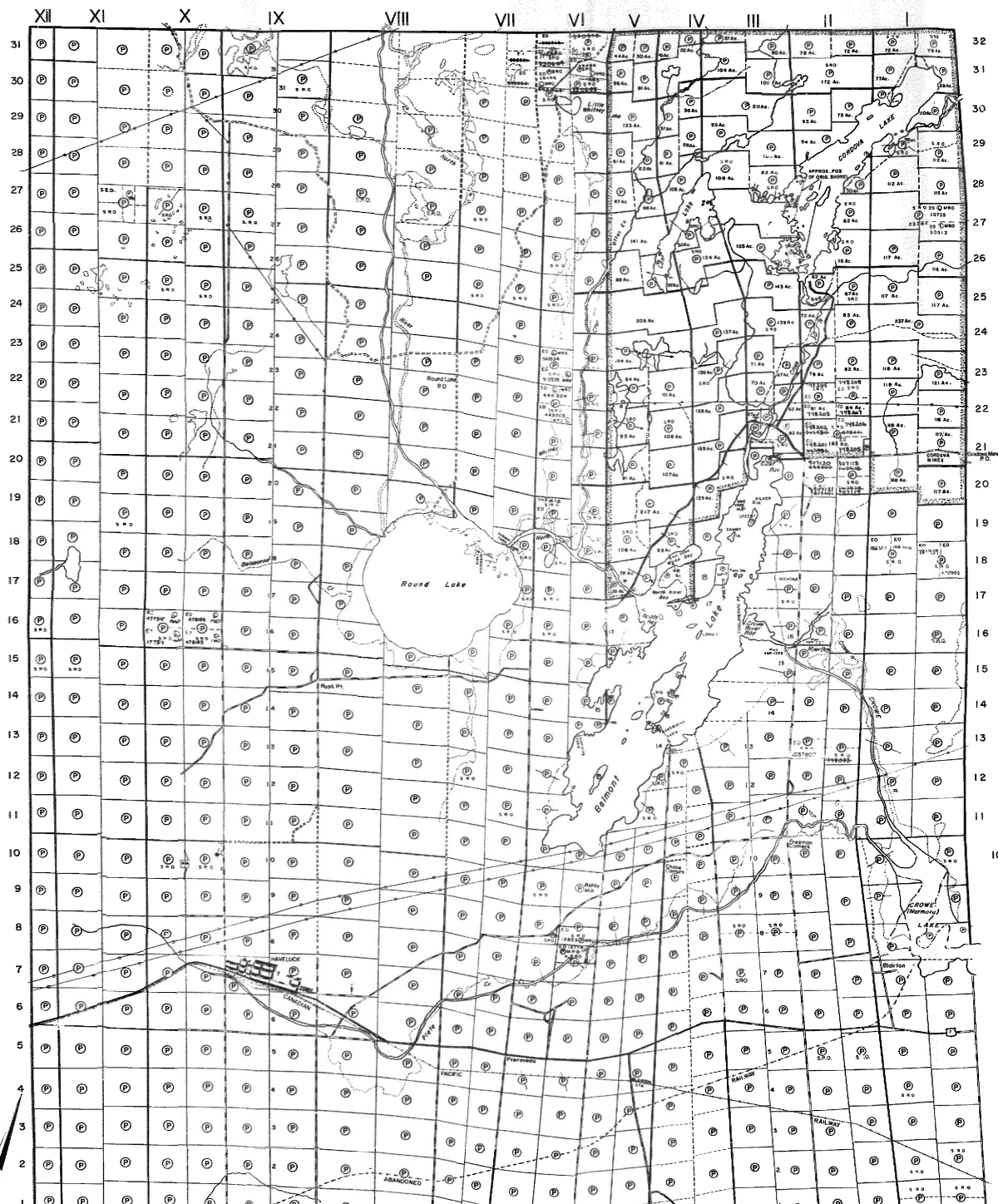

DATE OF ISSUE

NOV - 8 1938

COUNTY OF  
PETERBOROUGH**SOUTHERN ONTARIO**  
MINING DIVISION

SCALE: 1-INCH = 40 CHAINS

**LEGEND**

- PATENTED LAND   
 CROWN LAND SALE   
 LEASES   
 LOCATED LAND   
 LICENSE OF OCCUPATION   
 MINING RIGHTS ONLY   
 SURFACE RIGHTS ONLY   
 ROADS   
 IMPROVED ROADS   
 KINGS HIGHWAYS   
 RAILWAYS   
 POWER LINES   
 MATCH OR MUSKES   
 KINGS   
 PATENTED LAND-S.R.O.

**NOTES**

This Map Is Not To Be Used  
FOR SURVEY PURPOSES

400' Surface Rights Reservation along the shores of all lakes and rivers

Original shoreline shown thus:   
 F.R.I. shoreline shown thus:   
 Patents Map shoreline shown thus:

For status of islands in this Township refer to Ministry of Natural Resources records

Four islands in Crowe Lake opposite Lots 8 & 9 Con. I Reserved for Public Use. File: 146610.

**BELMONT LAKE ONLY.**

PRESENT SHORELINE SHOWN THUS:   
 ORIGINAL SHORELINE SHOWN THUS:

AREA SHOWN THUS:  IS A REVISION OF PORTION OF THE ORIGINAL TOWNSHIP PLAN AND HAS BEEN COMPILED FROM RESURVEYS AS AUTHORIZED BY THE SURVEYOR GENERAL. **1988**

DATE OF ISSUE

NOV 29 1988

SOUTHERN ONTARIO  
MINING DIVISION

PLAN NO.-M.53

 ONTARIO  
 MINISTRY OF NATURAL RESOURCES  
 SURVEYS AND MAPPING BRANCH

Dummer Twp.

Asphodel Twp.

Marmora Twp. M. 122

Seymour Twp. M.149

## BELMONT

COUNTY OF  
PETERBOROUGHSOUTHERN ONTARIO  
MINING DIVISION

SCALE: 1-INCH = 40 CHAINS

## LEGEND

FATENTED LAND	● or ○
CROWN LAND SALE	○
LEASES	○
LOCATED LAND	○
LICENSE OF OCCUPATION	○
MINING RIGHTS ONLY	○
SURFACE RIGHTS ONLY	○
ROADS	—
IMPROVED ROADS	—
KINGS HIGHWAYS	—
RAILWAYS	—
POWER LINES	—
MARSH OR MUSKOG	—
NINES	—
PATENTED LAND - S.R.O.	○

## NOTES

This Map Is Not To Be Used  
FOR SURVEY PURPOSES—

400' Surface Rights Reservation along  
the shores of all lakes and rivers

Original shoreline shown thus: —  
F.R.I. shoreline shown thus: —  
Patents Map shoreline shown thus: —

For status of islands in this Township  
refer to Ministry of Natural Resources  
records

Four islands in Crowe Lake opposite Lots  
8 & 9, Con. I Reserved for Public Use.  
File: 146610.

BELMONT LAKE ONLY.  
PRESENT SHORELINE SHOWN THUS —  
ORIGINAL SHORELINE SHOWN THUS —

AREA SHOWN THUS IS A REVISION OF  
PORTION OF THE ORIGINAL TOWNSHIP PLAN  
AND HAS BEEN COMPILED FROM RESOURCES AS  
AUTHORIZED BY THE SURVEYOR GENERAL. 75946

DATE OF ISSUE

AUG 15 1959

ACQUISITION CONTROLLED  
SURVEY DIVISION

PLAN NO.-M.53

ONTARIO

MINISTRY OF NATURAL RESOURCES

SURVEYS AND MAPPING BRANCH

Dummer Twp.

Asphodel Twp.

Marmora Twp. M.122

Seymour Twp. M.149



**BELMONT**COUNTY OF  
PETERBOROUGH**SOUTHERN ONTARIO**  
MINING DIVISION

SCALE: 1-INCH = 40 CHAINS

**LEGEND**

PATENTED LAND	● of C.
CROWN LAND SALE	○ of C.
LEASES	○ of C.
LOCATED LAND	○ of C.
LICENSE OF OCCUPATION	○ of C.
MINING RIGHTS ONLY	○ of C.
SURFACE RIGHTS ONLY	○ of C.
ROADS	—
IMPROVED ROADS	—
KINGS HIGHWAYS	—
RAILWAYS	—
POWER LINES	—
MARSH OR MUSKOG	—
MINES	—
PATENTED LAND - S.R.O.	—

**NOTES****This Map is Not To Be Used  
FOR SURVEY PURPOSES—**400' Surface Rights Reservation along  
the shores of all lakes and rivers

Original shoreline shown thus: —

F.R.I. shoreline shown thus: —

PatentsMap shoreline shown thus: —

For status of islands in this Township  
refer to Ministry of Natural Resources  
recordsFour islands in Crowe Lake opposite Lots  
8 B. 9 Cont. Reserved for Public Use.  
File: 146610.**BELMONT LAKE ONLY.**

PRESENT SHORELINE SHOWN THUS: —

ORIGINAL SHORELINE SHOWN THUS: —

AREA SHOWN THUS: — IS A REVISION OF  
PORTION OF THE ORIGINAL TOWNSHIP PLAN  
AND HAS BEEN COMPILED FROM SURVEYS AS  
AUTHORIZED BY THE SURVEYOR GENERAL. **2446**DATE OF ISSUE  
DEC 27 1990  
SOUTH OF THE  
TOWNSHIPTHE INFORMATION THAT  
APPEARS ON THIS MAP  
HAS BEEN COMPILED  
FROM VARIOUS SOURCES  
AND ACCURACY IS NOT  
GUARANTEED. THERE  
MAY BE CHANGES IN  
LANDS OWNERSHIP  
SINCE THE MAP WAS  
PREPARED. MINISTRY OF  
NATURAL RESOURCES  
WILL BE RESPONSIBLE FOR  
ANY CHANGES IN  
THE INFORMATION  
ON THE MAPS OF THE  
TOWNSHIP SHOWN HEREON.PLAN NO. **M.53**ONTARIO  
MINISTRY OF NATURAL RESOURCES  
SURVEYS AND MAPPING BRANCH

Dummer Twp.

Marmora Twp. M. 122

Asphodel Twp.

**BELMONT**COUNTY OF  
PETERBOROUGH**SOUTHERN ONTARIO  
MINING DIVISION**

SCALE: 1-INCH = 40 CHAINS

**LEGEND**

- FATENTED LAND
- CROWN LAND SALE
- LEASES
- LOCATED LAND
- LICENSE OF OCCUPATION
- MINING RIGHTS ONLY
- SURFACE RIGHTS ONLY
- ROADS
- IMPROVED ROADS
- KINGS HIGHWAYS
- RAILWAYS
- POWER LINES
- MARSH OR MUSKES
- MINES
- PATENTED LAND - S.R.O.

**NOTES**

This Map is Not To Be Used  
FOR SURVEY PURPOSES

400' Surface Rights Reservation along  
the shores of all lakes and rivers

Original shoreline shown thus: —  
F.R.I. shoreline shown thus: —  
Patents Map shoreline shown thus: —

For status of Islands in this Township  
refer to Ministry of Natural Resources  
records

Four Islands in Crowe Lake opposite Lots  
8 B.9 Cont. Reserved for Public Use.  
File: 146610.

**BELMONT LAKE ONLY.**  
PRESENT SHORELINE SHOWN THIS  
ORIGINAL SHORELINE SHOWN THIS:

AREA SHOWN THIS IS A REVISION OF  
PORTION OF THE ORIGINAL TOWNSHIP PLAN  
AND HAS BEEN COMPILED FROM RESURVEYS AS  
AUTHORIZED BY THE SURVEYOR GENERAL. 12-14-6

DATE OF ISSUE

1927

SOUTHERN ONTARIO  
MINING DIVISION

THE INFORMATION THAT  
APPEARS ON THIS MAP  
HAS BEEN COMPILED  
FROM VARIOUS SOURCES  
AND ACCURACY IS NOT  
GUARANTEED SHOULD  
WISHERS TO STATE NON-  
WARRANTED CLAIMS  
CONSULT WITH THE MINING  
RECORDS MINISTRY OF  
NORTHERN DEVELOPMENT  
AND MINES FOR ADDI-  
TIONAL INFORMATION  
ON THE STATUS OF THE  
LANDS SHOWN HEREON

PLAN NO.-M.53

ONTARIO  
MINISTRY OF NATURAL RESOURCES  
SURVEYS AND MAPPING BRANCH

Dummer Twp.

Asphodel Twp.

Marmora Twp. M. 122

Seymour Twp. M.149

Methuen Twp.

LINCOLN, GUILDFORD,  
DUNDAS & QUARTZ  
MAPS, RECORDS  
WITHDRAWN FROM STAKING  
DURING THE YEAR 1904 BY THE  
S.M. SERVICE

THE TOWNSHIP  
OF**BELMONT**COUNTY OF  
PETERBOROUGHEASTERN ONTARIO  
MINING DIVISION

SCALE: 1-INCH = 40 CHAINS

## LEGEND

PATENTS, LAND  
DEEDS, LAND, E.C.  
LAKES  
ADULTS, LAND  
EVIDENCE OF OCCUPATION  
MINING RIGHTS ONLY  
SURFACE RIGHTS ONLY  
RAILS  
WATERLAIN ROAD  
KINGS HIGHWAYS  
RAILWAYS  
POWER LINES  
WATERS OR WATERS  
KINGS

## NOTES

This Map Is Not To Be Used  
FOR SURVEY PURPOSES—

400' Surface Rights Reservation around all  
Lakes & Rivers

Original shoreline shown thus  
P.R. 11 shoreline shown thus  
Patents Map shoreline shown thus

For status of islands in this Map please  
contact the Lands & Forests.

Four islands in Crow Lake opposite Lots  
8 & 9 Cont. Reserved for Public Use  
File: 146610.

BELMONT LAKE ONLY.  
PRESENT SHORELINE SHOWN THUS  
ORIGINAL SHORELINE SHOWN THUS

AREA SHOWN THUS IS A REVISION OF  
PORTION OF THE ORIGINAL TOWNSHIP PLAN  
AND HAS BEEN COMPILED FROM RESURVEYS AS  
AUTHORIZED BY THE SURVEYOR GENERAL.

Dummer Twp.

Marmora Twp.

Asphodel Twp.

Seymour Twp.

PLAN NO.-M.53

DEPARTMENT OF MINES

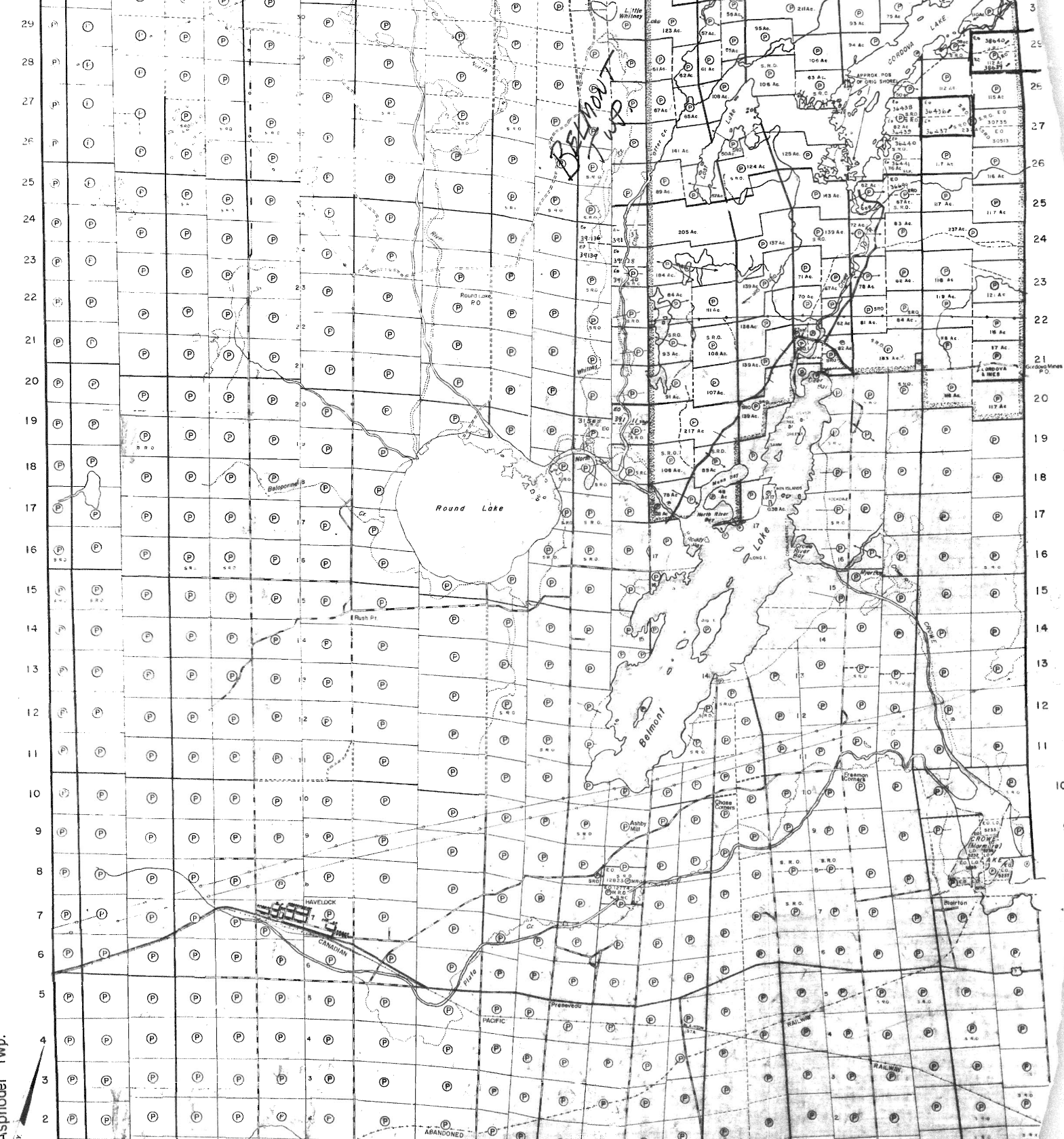



Methuen Twp.

LIMESTONE, DOLOMITE,  
SANDSTONE & QUARTZ  
SANDS, PEBBLES  
WINDING RIVER STONE  
7/10/1887 & 8/10/1887

THE TOWNSHIP

OF

**BELMONT**COUNTY OF  
PETERBOROUGHEASTERN ONTARIO  
MINING DIVISION

SCALE: 1-INCH = 40 CHAINS

## LEGEND

PATENTED LAND	⊙
CROWN LAND SALE	CS.
LEASES	○
LOCATED LAND	Loc.
LICENSE OF OCCUPATION	L.O.
MINING RIGHTS ONLY	M.R.O.
SURFACE RIGHTS ONLY	S.R.O.
ROADS	—
IMPROVED ROADS	—
KING'S HIGHWAYS	—
RAILWAYS	—
POWER LINES	—
MARSH OR MUSKEG	—
MINES	—

## NOTES

This Map is Not To Be Used  
FOR SURVEY PURPOSES—400' Surface Rights Reservation around all  
Lakes & Rivers.Original shoreline shown thus: —  
F.R.I. shoreline shown thus: —  
Patents Map shoreline shown thus: —For status of islands in this map  
contact Dept. of Lands & Forests. pleaseFour islands in Crowe Lake opposite Lots  
8 & 9 Cont. Reserved for Public Use.  
File: 146610.BELMONT LAKE ONLY.  
PRESENT SHORELINE SHOWN THIS  
ORIGINAL SHORELINE SHOWN THIS

Marmora Twp.

Dummer Twp.

Asphodel Twp.



Seymour Twp.

PLAN NO.-M.53

DEPARTMENT OF MINES

Methuen Twp.

THE TOWNSHIP  
OF  
**BELMONT**  
COUNTY OF  
PETERBOROUGH

EASTERN ONTARIO  
MINING DIVISION

SCALE: 1-INCH = 40 CHAINS

**LEGEND**

- |                       |        |
|-----------------------|--------|
| PATENTED LAND         | CS.    |
| CROWN LAND SALE       | CS.    |
| LEASES                | CS.    |
| LOCATED LAND          | LOC.   |
| LICENSE OF OCCUPATION | L.O.   |
| MINING RIGHTS ONLY    | M.R.O. |
| SURFACE RIGHTS ONLY   | S.R.O. |
| ROADS                 |        |
| IMPROVED ROADS        |        |
| KINGS' HIGHWAYS       |        |
| RAILWAYS              |        |
| POWER LINES           |        |
| MARSH OR MUSKOG       |        |
| MINES                 |        |

**NOTES**

This Map is Not To Be Used  
FOR SURVEY PURPOSES—

400' Surface Rights Reservation around all  
Lakes & Rivers.

Original shoreline shown thus: —  
F.R.I. shoreline shown thus: —  
Potents Map shoreline shown thus: —

For status of islands in this Twp. please  
contact Dept. of Lands & Forests.

Four Islands in Crow Lake opposite Lots  
8 & 9 Con'l Reserved for Public Use.  
File: 146610.

**BELMONT LAKE ONLY.**  
PRESENT SHORELINE SHOWN THUS: —  
ORIGINAL SHORELINE SHOWN THUS: —

ONT. DEPT. OF MINES  
MINING LANDS BR.  
THIS MAP FOR CHECKING  
PURPOSES ONLY — MUST  
NOT BE SOLD.

DATE OF ISSUE  
OCT 10 1962  
ONTARIO DEPT. OF MINES

PLAN NO. M-53

DEPARTMENT OF MINES  
— ONTARIO —

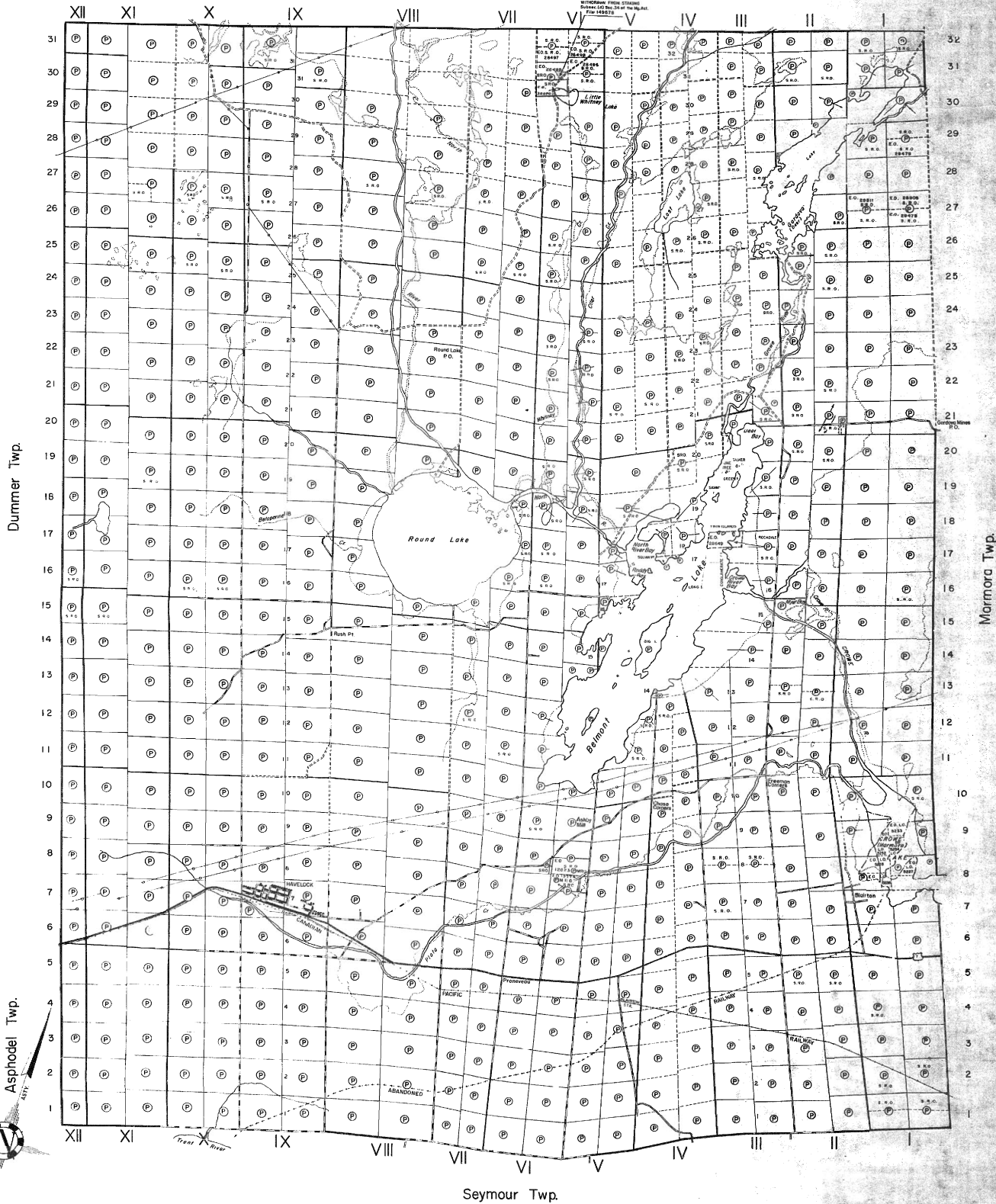

Seymour Twp.

Dummer Twp.

Marmora Twp.

Asphodel Twp.

Methuen Twp.

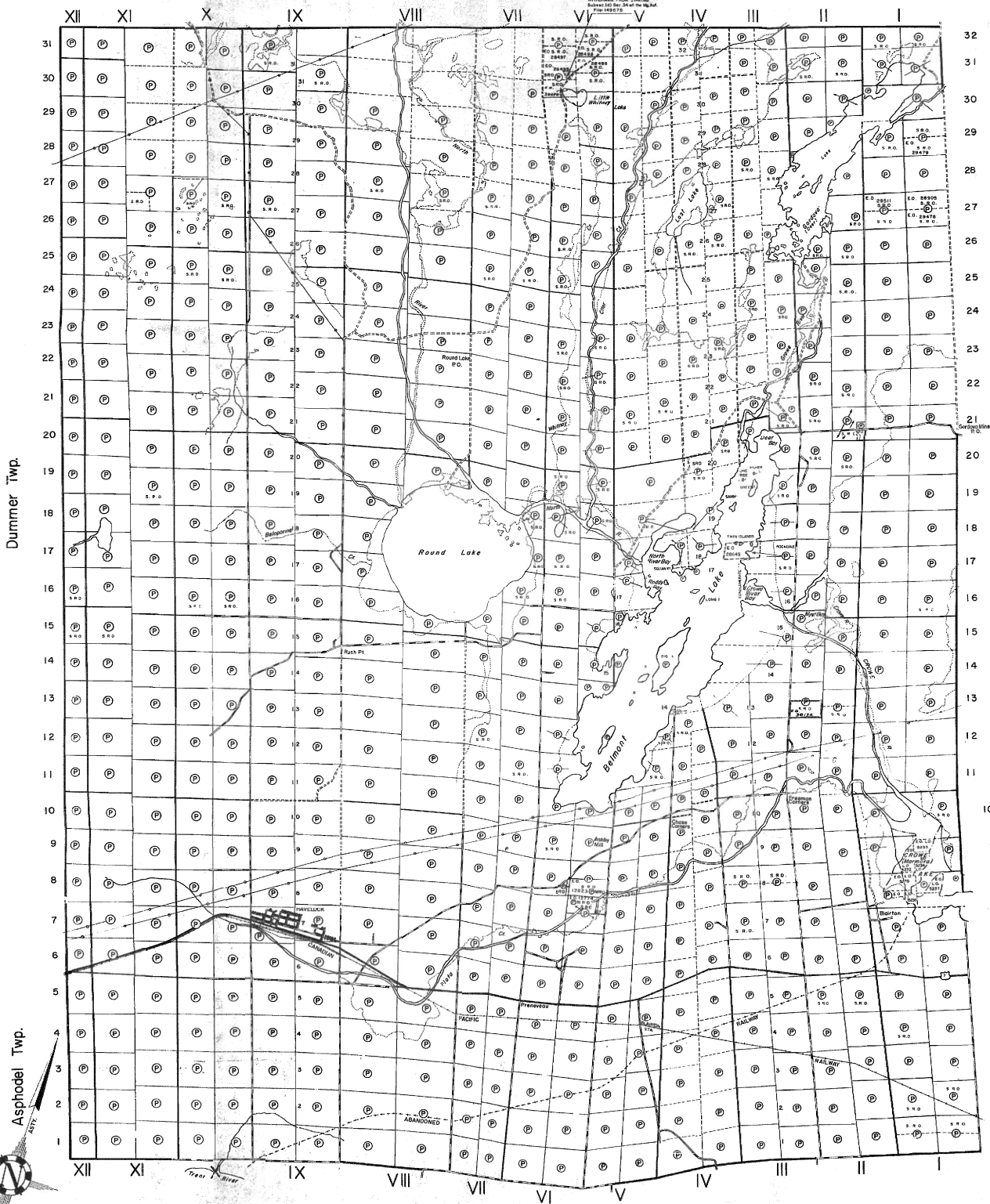
SARIEL RESERVE  
VICTIM'S FISH STATION  
FILE 186278

THE TOWNSHIP

OF

**BELMONT**COUNTY OF  
PETERBOROUGHEASTERN ONTARIO  
MINING DIVISION

SCALE: 1-INCH = 40 CHAINS

**LEGEND**

PATENTED LAND	P
CROWN LAND SALE	C.S.
LEASES	Loc.
LOCATED LAND	I.O.
LICENCES OF OCCUPATION	M.R.O.
MINING RIGHTS ONLY	S.R.O.
SURFACE RIGHTS ONLY	R.O.
ROADS	I.R.O.
IMPROVED ROADS	K.H.
KINGS HIGHWAYS	R.L.
RAILWAYS	P.L.
POWER LINES	M.O.
MARSH OR MUSKEG	M.
MINES	

**NOTES**

This Map is Not To Be Used  
FOR SURVEY PURPOSES—

400' Surface Rights Reservation around all  
Lakes & Rivers.

Original shoreline shown thus: —  
P.R.I. shoreline shown thus: —  
PatentsMap shoreline shown thus: —

For status of islands in this Twp. please  
contact Dept. of Lands & Forests.

Four islands in Crowe Lake opposite Lots  
8 & 9 Con. I Reserved for Public Use.  
File: 146610.

BELMONT LAKE ONLY.  
PRESENT SHORELINE SHOWN THIS  
ORIGINAL SHORELINE SHOWN THIS:

ONT. DEPT. OF MINES  
MINING LANDS BR.  
THIS MAP FOR CHECKING  
PURPOSES ONLY — MUST  
NOT BE SOLD.

DATE OF ISSUE

OCT 29 1962

ONTARIO DEPT. OF MINES

PLAN NO. - M.53

DEPARTMENT OF MINES

Methuen Twp.

THE TOWNSHIP  
OF**BELMONT**COUNTY OF  
PETERBOROUGHEASTERN ONTARIO  
MINING DIVISION

SCALE: 1-INCH = 40 CHAINS

**LEGEND**

PATENTED LAND	(P)
CROWN LAND SALE	C.S.
LEASES	(L)
LOCATED LAND	L.O.
LICENSE OF OCCUPATION	L.O.
MINING RIGHTS ONLY	M.R.O.
SURFACE RIGHTS ONLY	S.R.O.
IMPROVED ROADS	—
KINGS HIGHWAYS	—
RAILWAYS	—
POWER LINES	—
MAFISH OR MUSKOG	—
MINES	—

**NOTES**

This Map Is Not To Be Used  
FOR SURVEY PURPOSES—

400' Surface Rights Reservation around all  
Lakes & Rivers.

Original shoreline shown thus: —  
F.R.I. shoreline shown thus: —  
Patents Map shoreline shown thus: —

For status of Islands in this Twp. please  
contact Dept. of Lands & Forests.

Four Islands in Crowe Lake opposite Lots  
8 & 9 Con. I Reserved for Public Use.  
File: 146610.

BELMONT LAKE ONLY.  
PRESENT SHORELINE SHOWN THUS  
ORIGINAL SHORELINE SHOWN THUS

ONT. DEPT. OF MINES  
MINING LANDS BR.  
THIS MAP FOR CHECKING  
PURPOSES ONLY — MUST  
NOT BE SOLD.

**DATE OF ISSUE**

JAN 25 1900

ONTARIO DEPT. OF MINES

PLAN NO. - M.53

DEPARTMENT OF MINES

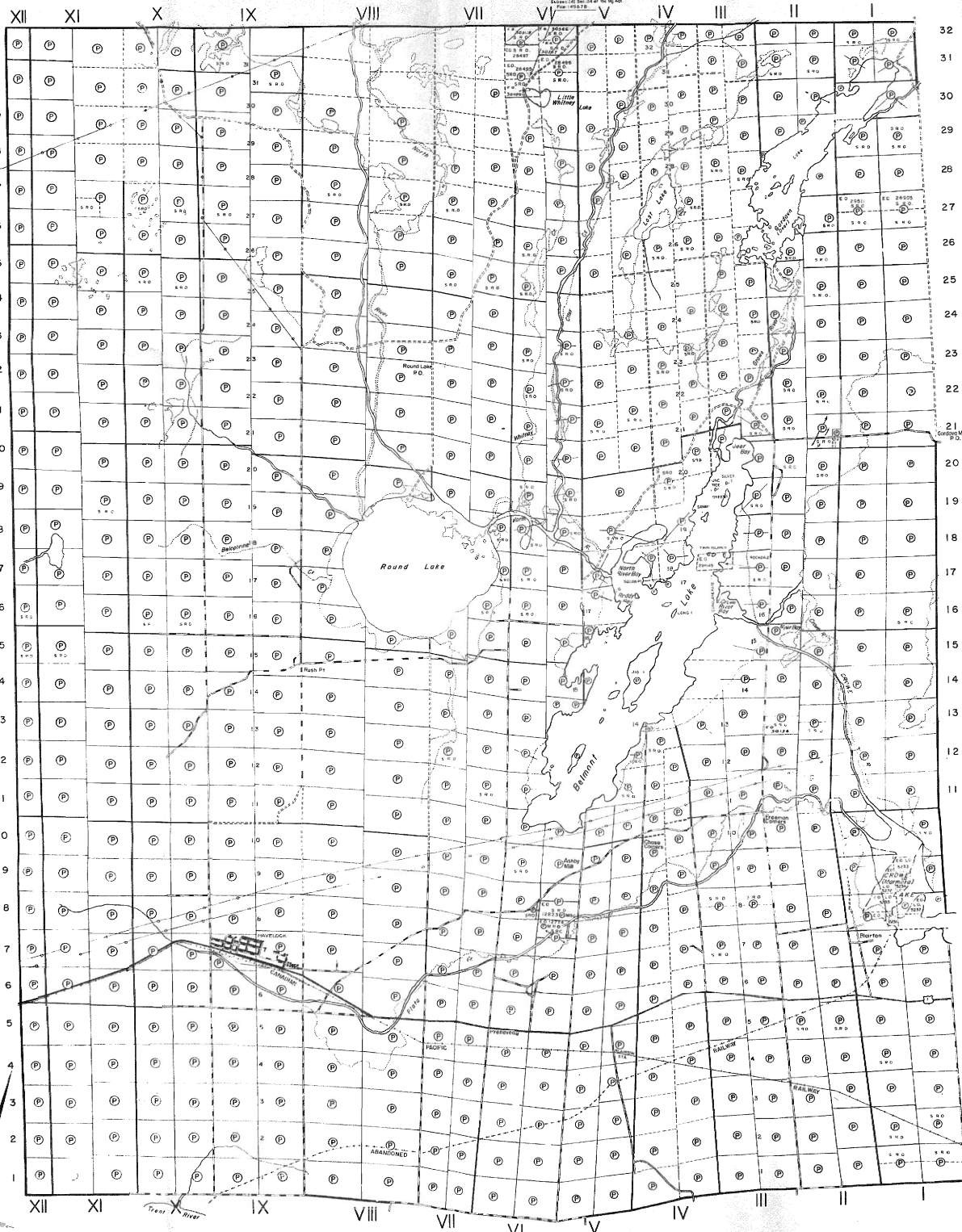

Asphodel Twp.





THE TOWNSHIP  
OF  
**BELMONT**  
COUNTY OF  
PETERBOROUGH  
EASTERN ONTARIO  
MINING DIVISION

SCALE: 1-INCH = 40 CHAINS

**LEGEND**

PATENTED LAND	(P)
CROWN LAND SALE	(C.S.)
LEASES	(L)
LOCATED LAND	(L.O.)
LICENSE OF OCCUPATION	(L.O.)
MINING RIGHTS ONLY	(M.R.O.)
SURFACE RIGHTS ONLY	(S.R.O.)
ROADS	(R)
IMPROVED ROADS	(I.R.)
KINGS HIGHWAYS	(K.H.)
RAILWAYS	(R.L.)
POWER LINES	(P.L.)
MARSH OR MUSKOG	(M.O.)
MINES	(M)

**NOTES**

This Map Is Not To Be Used  
FOR SURVEY PURPOSES—  
400' Surface Rights Reservation around all  
Lakes & Rivers.

Original shoreline shown thus: ———  
F.R.I. shoreline shown thus: ———  
Patents Map shoreline shown thus: ———  
For status of islands in this Twp. please  
contact Dept. of Lands & Forests.  
Four islands in Crowe Lake opposite Lots  
8 & 9 Cont. Reserved for Public Use.  
File: 146610.

BELMONT LAKE ONLY.  
PRESENT SHORELINE SHOWN THUS: ———  
ORIGINAL SHORELINE SHOWN THUS: ———

ONT. DEPT. OF MINES  
MINING LANDS BR.  
THIS MAP FOR CHECKING  
PURPOSES ONLY — MUST  
NOT BE SOLD.

**DATE OF ISSUE**

JUN 3 1963

ONTARIO DEPT. OF MINES

PLAN NO. **M.53**

DEPARTMENT OF MINES  
ONTARIO

Methuen Twp.

MINING RIGHTS  
RESERVED FOR THE  
CROWN OF CANADA  
BY THE  
MINING ACT  
R.S.O. 1960  
C. 28  
S. 10  
S. 11  
S. 12  
S. 13  
S. 14  
S. 15  
S. 16  
S. 17  
S. 18  
S. 19  
S. 20  
S. 21  
S. 22  
S. 23  
S. 24  
S. 25  
S. 26  
S. 27  
S. 28  
S. 29  
S. 30  
S. 31  
S. 32

Dummer Twp.

Marmora Twp.

Asphodel Twp.

Seymour Twp.

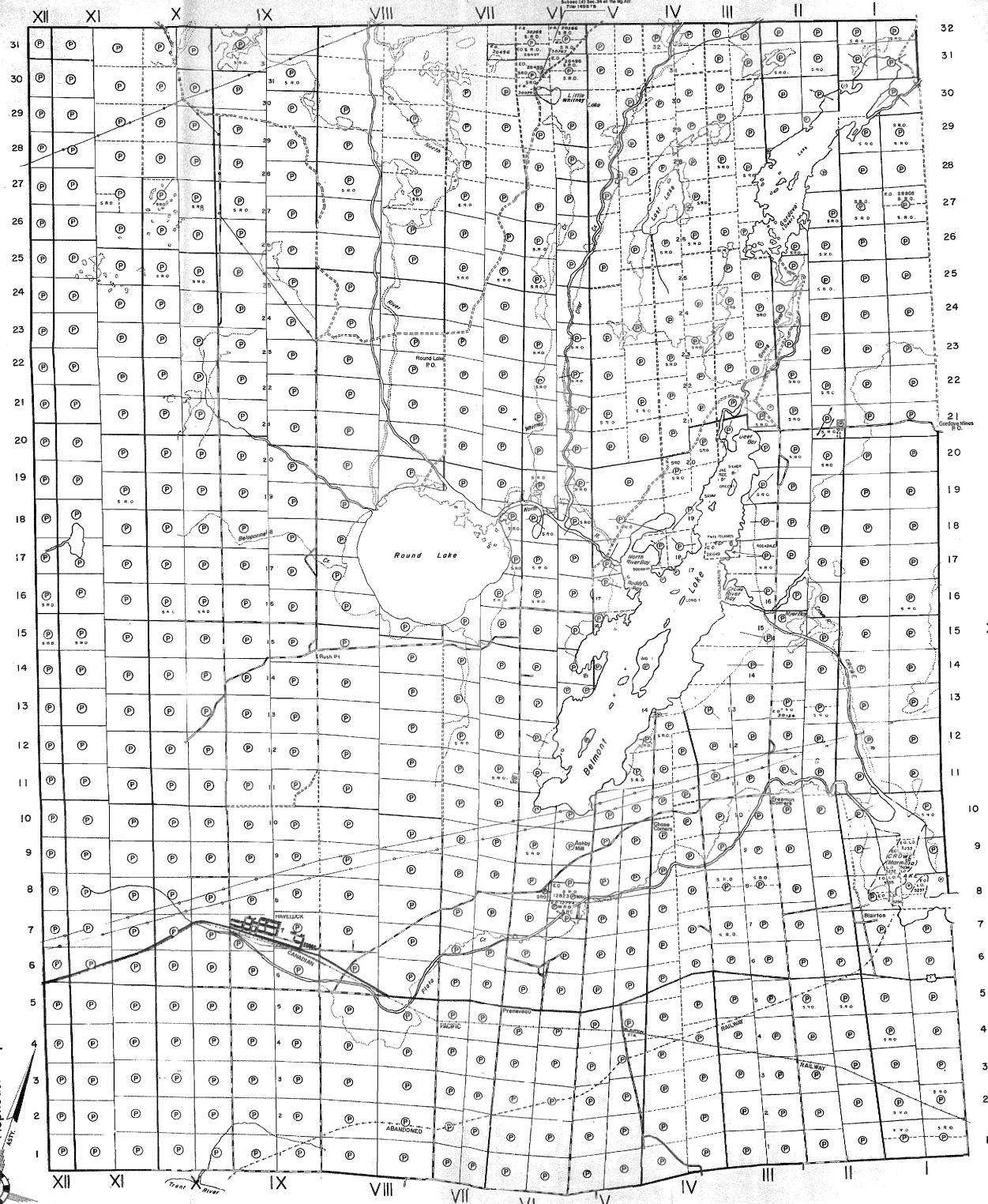

Methuen Twp.

THE TOWNSHIP

OF

BELMONT

COUNTY OF  
PETERBOROUGHEASTERN ONTARIO  
MINING DIVISION

SCALE: 1-INCH = 40 CHAINS

## LEGEND

PATENTED LAND (P)  
CROWN LAND SALE (C)  
LEASES (L)  
LOCATED LAND (L.C.)  
LICENSE OF OCCUPATION (L.O.)  
MINING RIGHTS ONLY (M.R.O.)  
SURFACE RIGHTS ONLY (S.R.O.)  
ROADS (R)  
IMPROVED ROADS (I.R.)  
KINGS HIGHWAYS (K.H.)  
RAILWAYS (R.L.)  
POWER LINES (P.L.)  
MARSH OR MUSKIEG (M.)  
MINES (M.N.)

## NOTES

This Map is Not To Be Used  
FOR SURVEY PURPOSES—

400' Surface Rights Reservation around all  
Lakes & Rivers.

Original shoreline shown thus: —  
F.R.I. shoreline shown thus: —  
Patents Map shoreline shown thus: —

For status of islands in this Twp. please  
contact Capt. of Lands & Forests.

Four Islands in Crowe Lake opposite Lots  
8 & 9 Cont'd Reserved for Public Use.  
File: 14660.

BELMONT LAKE ONLY.  
PRESENT SHORELINE SHOWN THUS: —  
ORIGINAL SHORELINE SHOWN THUS: —

## DATE OF ISSUE

DEC 3 1963

ONTARIO DEPT. OF MINES

ONT. DEPT. OF MINES  
MINING LANDS BR.  
THIS MAP FOR CHECKING  
PURPOSES ONLY — MUST  
NOT BE SOLD.

PLAN NO. M.53

DEPARTMENT OF MINES

Dummer Twp.

Asphodel Twp.

Marmora Twp.

Seymour Twp.

Methuen Twp.

LIMESTONE, DOLOMITE,  
SILICEOUS QUARTZ,  
GNEISS, GRANITE,  
METAMORPHIC ROCKS  
BASED ON Sec. 24 of the Reg. Act  
1907-1908

THE TOWNSHIP

OF

BELMONT

COUNTY OF  
PETERBOROUGHEASTERN ONTARIO  
MINING DIVISION

SCALE: 1-INCH = 40 CHAINS

## LEGEND

PATENTED LAND	⊙
CROWN LAND SALE	⊙
LEASES	⊙
LOCATED LAND	⊙
LICENSE OF OCCUPATION	⊙
MINING RIGHTS ONLY	⊙
SURFACE RIGHTS ONLY	⊙
ROADS	—
IMPROVED ROADS	—
KINGS, HIGHWAYS	—
RAILWAYS	—
POWER LINES	—
MARSH OR MUSKES	—
MINES	—

## NOTES

This Map Is Not To Be Used  
FOR SURVEY PURPOSES—  
400' Surface Rights Reservation around all  
Lakes & Rivers.

Original shoreline shown thus: —  
F.R.I. shoreline shown thus: —  
Patents Map shoreline shown thus: —

For status of islands in this Township place

Four islands in Crowe Lake opposite Lots  
8 & 9 Cont Reserved for Public Use.  
File: 146610.

BELMONT LAKE ONLY.  
PRESENT SHORELINE SHOWN THUS —  
ORIGINAL SHORELINE SHOWN THUS —

ONT. DEPT. OF MINES  
MINING LANDS BR.  
THIS MAP FOR CHECKING  
PURPOSES ONLY - MUST  
NOT BE SOLD.

DATE OF ISSUE  
APR 17 1964  
ONTARIO DEPT. OF MINES

PLAN NO. - M.53

DEPARTMENT OF MINES  
ONTARIO

Dummer Twp.

Asphodel Twp.

Marmora Twp.

Seymour Twp.

Methuen Twp.

LITHOLOGY: GOLF LINKS  
LAKES & RIVERS  
METHUEN TWP. (1910)  
SCALE: 1 INCH = 40 CHAINS

THE TOWNSHIP  
OF  
**BELMONT**  
COUNTY OF  
PETERBOROUGH

EASTERN ONTARIO  
MINING DIVISION

SCALE: 1-INCH = 40 CHAINS

**LEGEND**

- |                       |          |
|-----------------------|----------|
| PATENTED LAND         | (P)      |
| CROWN LAND SALE       | (C.S.)   |
| LEASES                | (L)      |
| LOCATED LAND          | (Loc.)   |
| LICENSE OF OCCUPATION | (L.O.)   |
| MINING RIGHTS ONLY    | (M.R.C.) |
| SURFACE RIGHTS ONLY   | (S.R.O.) |
| ROADS                 | (—)      |
| IMPROVED ROADS        | (—)      |
| KINGS' HIGHWAYS       | (—)      |
| RAILWAYS              | (—)      |
| POWER LINES           | (—)      |
| MARSH OR MUSKEG       | (—)      |
| MINES                 | (—)      |

**NOTES**

This Map Is Not To Be Used  
FOR SURVEY PURPOSES—

400' Surface Rights Reservation around all  
Lakes & Rivers.

Original shoreline shown thus: (—)  
P.R.I. shoreline shown thus: (—)  
PotentsMap shoreline shown thus: (—)

For status of Islands in this Twp.  
contact Dept. of Lands & Forests. please

Four Islands in Crowe Lake opposite Lots  
8 & 9 Con.1 Reserved for Public Use.  
File: 146610.

BELMONT LAKE ONLY.  
PRESENT SHORELINE SHOWN THUS (—)  
ORIGINAL SHORELINE SHOWN THUS (—)

ONT. DEPT. OF MINES  
MINING LANDS BR.  
THIS MAP FOR CHECKING  
PURPOSES ONLY — MUST  
NOT BE SOLD.

**DATE OF ISSUE**

MAY 6 1964

ONTARIO DEPT. OF MINES

Dummer Twp.

Marmora Twp.

Asphodel Twp.







Methuen Twp.

THE TOWNSHIP

OF

**BELMONT**

COUNTY OF  
PETERBOROUGH

EASTERN ONTARIO  
MINING DIVISION

SCALE: 1-INCH = 40 CHAINS

LEGEND

PATENTED LAND  
DEPT. LAND SALE  
LEASES  
LOCATED LAND  
LICENSED OCCUPATION  
MINING RIGHTS ONLY  
SURFACE RIGHTS ONLY  
PLACED  
RAILROADS  
RAILWAYS  
RAILWAY LINES  
WATER OR MUCKS  
MINES

NOTES

This Map Is Not To Be Used  
FOR SURVEY PURPOSES

400 Surface Rights Reservation around a  
Lakes & Rivers

Original 1871 plan of the  
P.R.I. 1871 plan of the  
Parents Map shown thus

For status of lands in this map please  
contact the Dept. of Mines

Four islands in Crow Lake opposite to  
B & S. Cont. Reserved for Public Use  
File: 146610.

BELMONT LAKE ONLY  
PRESENT SHORELINE SHOWN THIS  
ORIGINAL SHORELINE SHOWN THUS

AREA SHOWN THIS MAP IS A REVISION OF  
PORTION OF THE ORIGINAL TOWNSHIP PLAN  
AND HAS BEEN COMPILED FROM RESURVEYS AS  
AUTHORIZED BY THE SURVEYOR GENERAL.

ONT. DEPT. OF MINES  
MINING LANDS BR.  
THIS MAP FOR CHECKING  
PURPOSES ONLY - MUST  
NOT BE SOLD.

DATE OF ISSUE

OCT 12 1965

ONTARIO DEPT. OF MINES

PLAN NO. M.53

DEPARTMENT OF MINES  
- ONTARIO -

Dummer Twp.

Asphodel Twp.

Marmora Twp.

Seymour Twp.



Methuen Twp.

THE TOWNSHIP

OF

BELMONT

COUNTY OF  
PETERBOROUGHEASTERN ONTARIO  
MINING DIVISION

SCALE: 1-INCH = 40 CHAINS

## LEGEND

DOTTED LINE  
 CRUISE LINE, 1915  
 CRUISE LINE, 1916  
 CRUISE LINE, 1917  
 CRUISE LINE, 1918  
 CRUISE LINE, 1919  
 CRUISE LINE, 1920  
 CRUISE LINE, 1921  
 CRUISE LINE, 1922  
 CRUISE LINE, 1923  
 CRUISE LINE, 1924  
 CRUISE LINE, 1925  
 CRUISE LINE, 1926  
 CRUISE LINE, 1927  
 CRUISE LINE, 1928  
 CRUISE LINE, 1929  
 CRUISE LINE, 1930  
 CRUISE LINE, 1931  
 CRUISE LINE, 1932  
 CRUISE LINE, 1933  
 CRUISE LINE, 1934  
 CRUISE LINE, 1935  
 CRUISE LINE, 1936  
 CRUISE LINE, 1937  
 CRUISE LINE, 1938  
 CRUISE LINE, 1939  
 CRUISE LINE, 1940  
 CRUISE LINE, 1941  
 CRUISE LINE, 1942  
 CRUISE LINE, 1943  
 CRUISE LINE, 1944  
 CRUISE LINE, 1945  
 CRUISE LINE, 1946  
 CRUISE LINE, 1947  
 CRUISE LINE, 1948  
 CRUISE LINE, 1949  
 CRUISE LINE, 1950  
 CRUISE LINE, 1951  
 CRUISE LINE, 1952  
 CRUISE LINE, 1953  
 CRUISE LINE, 1954  
 CRUISE LINE, 1955  
 CRUISE LINE, 1956  
 CRUISE LINE, 1957  
 CRUISE LINE, 1958  
 CRUISE LINE, 1959  
 CRUISE LINE, 1960  
 CRUISE LINE, 1961  
 CRUISE LINE, 1962  
 CRUISE LINE, 1963  
 CRUISE LINE, 1964  
 CRUISE LINE, 1965  
 CRUISE LINE, 1966  
 CRUISE LINE, 1967  
 CRUISE LINE, 1968  
 CRUISE LINE, 1969  
 CRUISE LINE, 1970  
 CRUISE LINE, 1971  
 CRUISE LINE, 1972  
 CRUISE LINE, 1973  
 CRUISE LINE, 1974  
 CRUISE LINE, 1975  
 CRUISE LINE, 1976  
 CRUISE LINE, 1977  
 CRUISE LINE, 1978  
 CRUISE LINE, 1979  
 CRUISE LINE, 1980  
 CRUISE LINE, 1981  
 CRUISE LINE, 1982  
 CRUISE LINE, 1983  
 CRUISE LINE, 1984  
 CRUISE LINE, 1985  
 CRUISE LINE, 1986  
 CRUISE LINE, 1987  
 CRUISE LINE, 1988  
 CRUISE LINE, 1989  
 CRUISE LINE, 1990  
 CRUISE LINE, 1991  
 CRUISE LINE, 1992  
 CRUISE LINE, 1993  
 CRUISE LINE, 1994  
 CRUISE LINE, 1995  
 CRUISE LINE, 1996  
 CRUISE LINE, 1997  
 CRUISE LINE, 1998  
 CRUISE LINE, 1999  
 CRUISE LINE, 2000

## NOTES

This Map Is Not To Be Used  
FOR SURVEY PURPOSES

400' Surface Rights Reservation around  
Lakes & Rivers

Original Shoreline shown this  
for  
Parents Map showing shown this

For status of lands in this map  
contact with the  
Parents Map showing shown this

Four islands in Crow Lake, opposite  
P. & O. Cont. Reserved for Public Use  
File 146610.

BEAUMONT LAKE ONLY  
PRESENT SHORELINE SHOWN THIS  
ORIGINAL SHORELINE SHOWN THIS

AREA SHOWN THIS MAP IS A REVISION OF  
PORTION OF THE ORIGINAL COMPASS PLAN  
AND HAS BEEN COMPILED FROM RECONNAISSANCE  
AUTHORIZED BY THE SURVEY GENERAL

ONT. DEPT. OF MINES  
MINING LANDS BR.  
THIS MAP FOR CHECKING  
PURPOSES ONLY - MUST  
NOT BE SOLD

DATE OF ISSUE

JUN 17 1966

ONTARIO DEPT. OF MINES

PLAN NO. - M.53

DEPARTMENT OF MINES  
— ONTARIO —

Dummer Twp.

Marmora Twp.

Asphodel Twp.

Seymour Twp.

Methuen Twp.

THE TOWNSHIP  
OF

**BELMONT**

COUNTY OF  
PETERBOROUGH

EASTERN ONTARIO  
MINING DIVISION

SCALE: 1-INCH = 40 CHAINS

**LEGEND**

PATENTED LAND  
CROWN LAND SALE  
LEASES  
LOCATED LAND  
LICENSE OF OCCUPATION  
MINING RIGHTS ONLY  
SURFACE RIGHTS ONLY  
FENCES  
IMPROVED ROADS  
KINGS HIGHWAYS  
RAILWAYS  
POWER LINES  
MARSH OR MUSKES  
MINES

**NOTES**

This Map Is Not To Be Used  
FOR SURVEY PURPOSES—

400' Surface Rights Reservation around all  
Lakes & Rivers

Original shoreline shown thus  
P.R.I. shoreline shown thus  
Patent Map shoreline shown thus

For status of islands in 1914 see  
contact List of Lands & Forests

Four islands in Crowe Lake opposite Lots  
8 & 9 Cont'd Reserved for Public use  
File 146610.

**BELMONT LAKE ONLY**  
PRESENT SHORELINE SHOWN THUS  
ORIGINAL SHORELINE SHOWN THUS

AREA SHOWN THUS IS A REVISION OF  
PORTION OF THE ORIGINAL TOWNSHIP PLAN  
AND HAS BEEN COMPILED FROM RESURVEYS AS  
AUTHORIZED BY THE SURVEYOR GENERAL.

**DATE OF ISSUE**

JUN 7 1967

ONTARIO DEPT. OF MINES

ONT. DEPT. OF MINES  
ON MINING LANDS BR.  
THIS MAP FOR CHECKING  
THROUGHS ONLY - MUST  
NOT BE SOLD

Dummer Twp.

Marmora Twp.

Asphodel Twp.

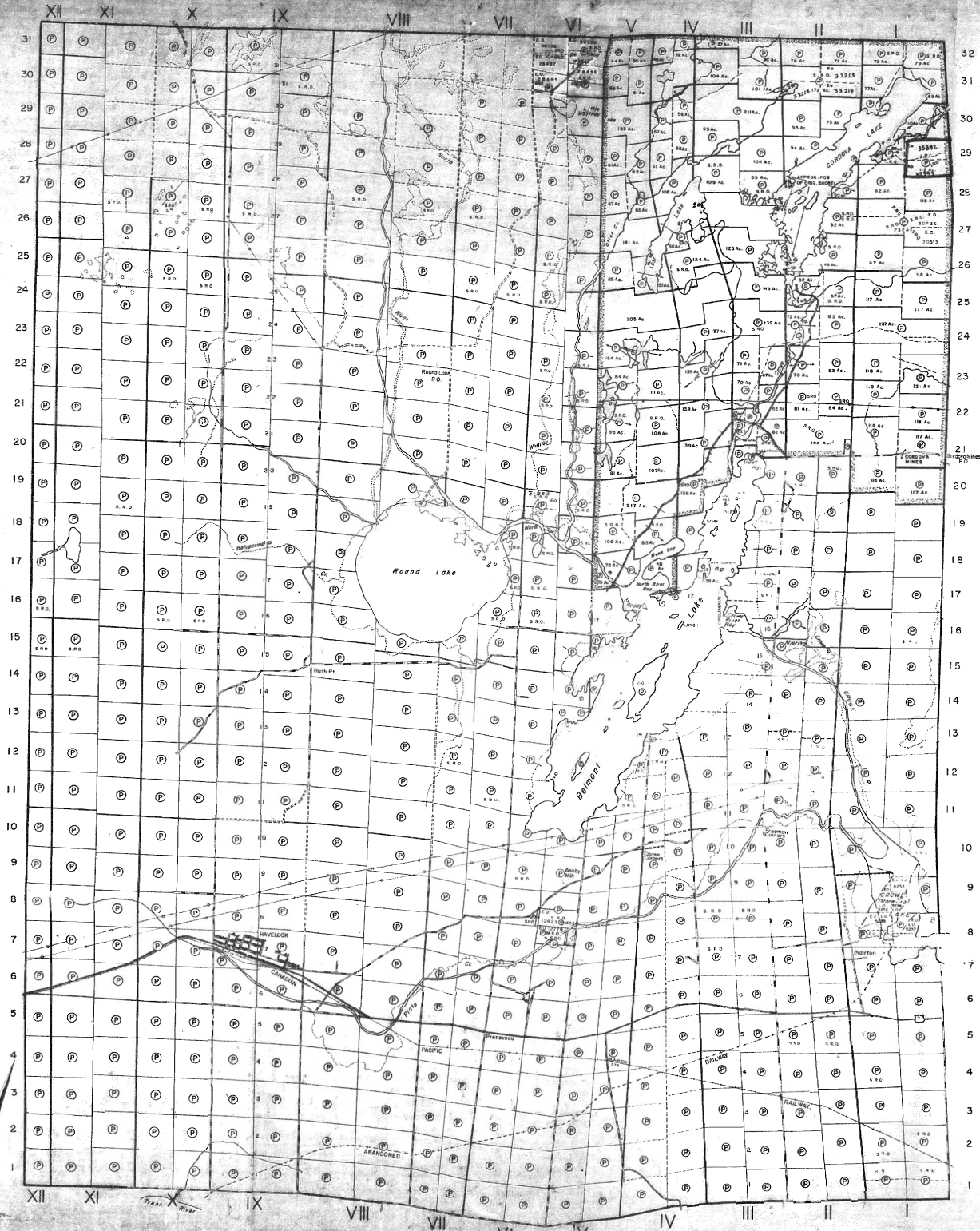



**BELMONT**COUNTY OF  
PETERBOROUGHEASTERN ONTARIO  
MINING DIVISION

SCALE: 1-INCH = 40 CHAINS

**LEGEND**

(P) PATENT  
 (C) CROWN LAND SALE  
 (L) LAKES  
 (S) SURFACE RIGHTS ONLY  
 (M) MINING RIGHTS ONLY  
 (R) RAILROADS  
 (H) HIGHWAYS  
 (F) FERRY LINES  
 (M) MARSH OR MUSKIE  
 (M) MINES

**NOTES**

**This Map Is Not To Be Used  
FOR SURVEY PURPOSES**

400' Surface Rights Reservation around  
Lakes & Rivers

Original Boundary shown thus  
Present Map boundary shown thus

For status of lands in this township please  
contact Mining Lands & Forests

Four islands in Crewe Lake opposite west  
E & S Cont. Reserved for Public Use  
File 146610.

**BELMONT LAKE ONLY**  
PRESENT SHORELINE SHOWN THUS  
ORIGINAL SHORELINE SHOWN THUS

AREA SHOWN THUS IS A REVISION OF  
PORTION OF THE ORIGINAL TOWNSHIP PLAN  
AND HAS BEEN COMPILED FROM RESURVEYS AS  
AUTHORIZED BY THE SURVEYOR GENERAL

ONT. DEPT. OF MINES  
MINING LANDS BR.  
THIS MAP FOR CHECKING  
PURPOSES ONLY - MUST  
NOT BE SOLD.

DATE OF ISSUE  
AUG 21 1967  
ONTARIO DEPT. OF MINES

PLAN NO. - **M.53**DEPARTMENT OF MINES  
— ONTARIO —

Methuen Twp.

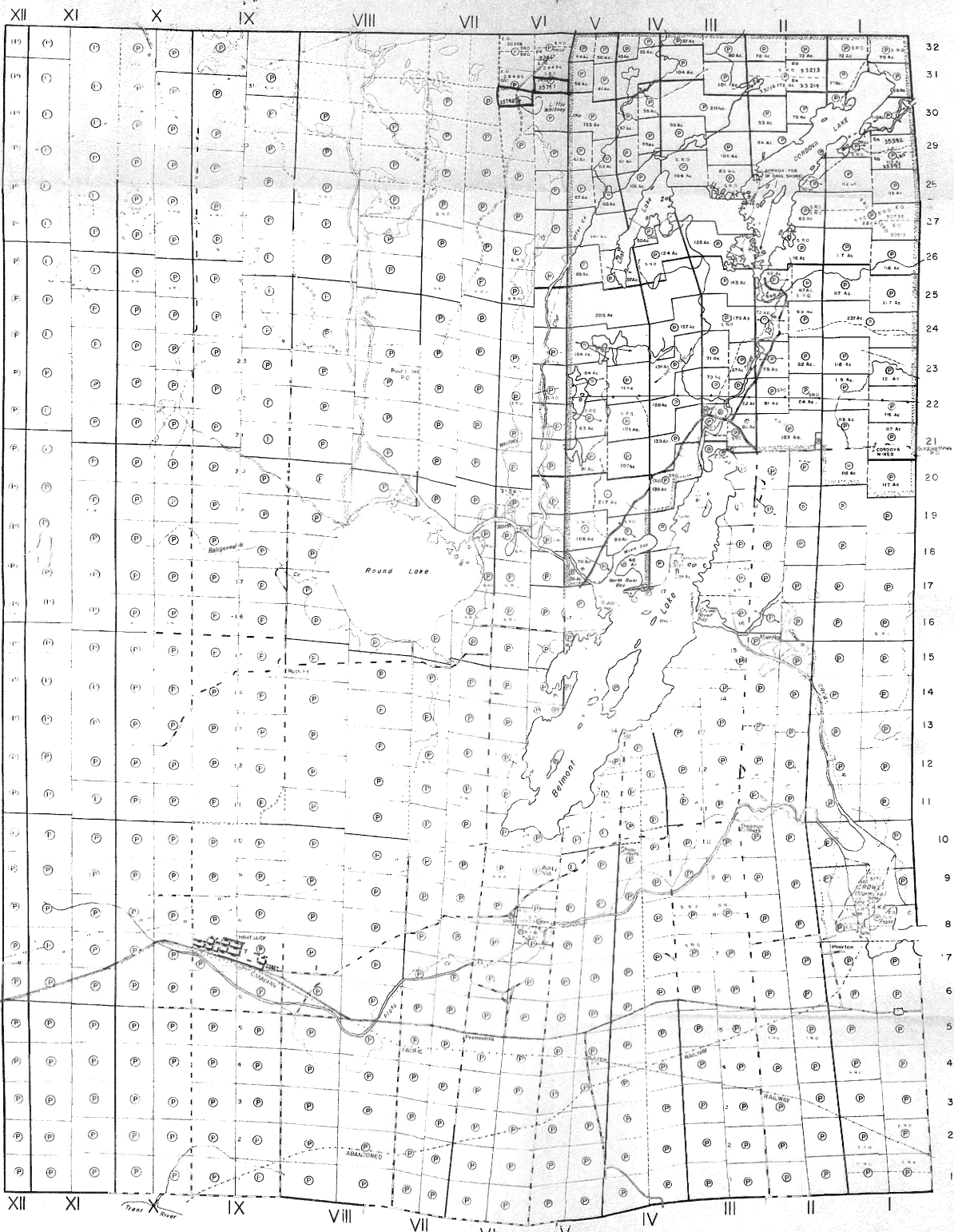

Dummer Twp.

Marmora Twp.

Asphodel Twp.

Seymour Twp.



Methuen Twp.

OF

BELMONT

COUNTY OF  
PETERBOROUGHEASTERN ONTARIO  
MINING DIVISION

SCALE: 1-INCH = 40 CHAINS

## LEGEND

PATENT  
 CROWN LANDS  
 LAKES  
 QUARTERS AND  
 LICENSES OF OCCUPATION  
 MINING RIGHTS ONLY  
 SURFACE RIGHTS ONLY  
 RIVERS  
 RAILWAYS  
 POWER LINES  
 MARSH OR MUCKED  
 MINES

## NOTES

This Map is Not To Be Used  
FOR SURVEY PURPOSES

400 Surface Rights Reservation around  
Lakes B. Rivers

Original British Survey  
P. R. 11 June 1864  
Patent Map shown thus

For status of Islands in this Twp  
contact 111-111-111-111

Four islands in Crow Lake opposite Lot  
P. B. 9 Cent. Reserved for Public Use  
File 146610

BELMONT LAKE ONLY  
PRESENT SHORELINE SHOWN THIS  
ORIGINAL SHORELINE SHOWN THIS

AREA SHOWN THIS IS A REVISION OF  
PORTION OF THE ORIGINAL TOWNSHIP PLAN  
AND HAS BEEN COMPILED FROM RESURVEYS AS  
AUTHORIZED BY THE SURVEY GENERAL

DATE OF ISS.

NOV 28 1957

ONTARIO DEPT. OF MINES

ONT. DEPT. OF MINES  
MINING LANDS BR.  
THIS MAP FOR CHECKING  
PURPOSES ONLY - MUST  
NOT BE SOLD.

PLAN NO. - M.53

DEPARTMENT OF MINES  
- ONTARIO -

Dummer Twp.

Marmora Twp.

Asphodel Twp.

Seymour Twp.

**BELMONT**

COUNTY OF  
PETERBOROUGH

EASTERN ONTARIO  
MINING DIVISION

SCALE: 1-INCH = 40 CHAINS

LEGEND

WHITE  
 BROWN LAND  
 WHITE  
 BROWN LAND  
 LICENSE OF OCCUPATION  
 WHITE  
 SURFACE  
 POWER  
 MINERAL  
 KINGS  
 RAILWAYS  
 POWER LINES  
 VARIOUS  
 MINING

## NOTES

This Map Is Not To Be Used  
— FOR SURVEY PURPOSES —

### 400' Surface Rights Reservation around Lakes & Rivers

Original	showing	shown thus
F.R.I.	showing	shown thus
Patents Map	showing	shown thus

For status of islands in this list, please  
contact U.S. Fish & Wildlife Service.

Four islands in Crowe Lake opposite Wolf  
# 8.9 Cont. Reserved for Public Use  
File 146610.

BELMONT LAKE ONLY.  
PRESENT SHORELINE SHOWN THUS  
ORIGINAL SHORELINE SHOWN THUS

AREA SHOWN THU ~~1900~~ 1910 A REVISION OF  
PORTION OF THE ORIGINAL TOWNSHIP PLAN  
AND HAS BEEN COMPILED FROM RESURVEYS AS  
AUTHORIZED BY THE SURVEYOR GENERAL

ONT. DEPT. OF MINES  
MINING LANDS BR.  
THIS MAP FOR CHECKING  
PURPOSES ONLY - MUST  
NOT BE SOLD.

DATE OF ISSUE

JAN 3 1 1968

ONTARIO DEPT. OF MINE

PLAN NO.- M.53

DEPARTMENT OF MINES

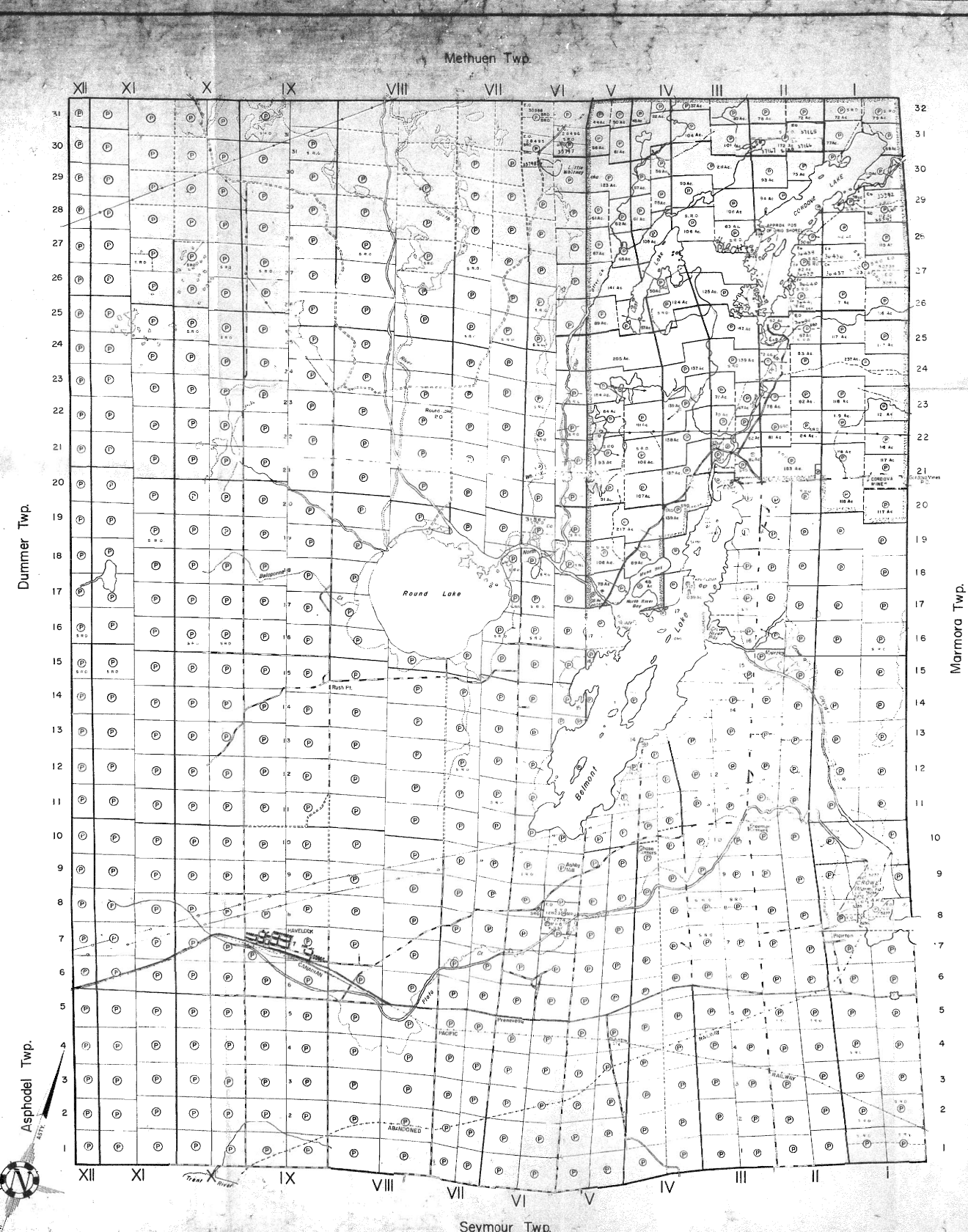

## LEGEND

PATENTED LAND  
CROWN LAND SALE  
LEASES  
LOCATED LAND  
LICENSE OF OCCUPATION  
MINING RIGHTS ONLY  
SURFACE RIGHTS ONLY  
R.R. ROADS  
IMPROVED ROADS  
KINGS HIGHWAYS  
RAILWAYS  
POWER LINES  
MARSH OR MUSKES  
MINES

## NOTES

This Map Is Not To Be Used  
FOR SURVEY PURPOSES—

400' Surface Rights Reservation around all  
Lakes & Rivers

Original shoreline shown thus  
P.R. shoreline shown thus  
Patents Map shoreline shown thus.

For status of islands in the lake please  
contact Dept. of Lands & Forests

Four islands in Crowe Lake opposite Lots  
8 & 9 Con I Reserved for Public Use  
File: 146610.

BELMONT LAKE ONLY.  
PRESENT SHORELINE SHOWN THUS  
ORIGINAL SHORELINE SHOWN THUS

AREA SHOWN TWO-TENTHS (20%) A REVISION OF  
PORTION OF THE ORIGINAL TOWNSHIP PLAN  
AND HAS BEEN COMPILED FROM RESURVEYS AS  
AUTHORIZED BY THE SURVEYOR GENERAL

## DATE OF ISSUE

FEB 12 1968

ONTARIO DEPT. OF MINES

ONT. DEPT. OF MINES  
MINING LANDS BR.THIS MAP FOR CHECKING  
PURPOSES ONLY — MUST  
NOT BE SOLD.

PLAN NO. M.53

DEPARTMENT OF MINES

—ONTARIO—

Dummer Twp.

Marmora Twp.

Asphodel Twp.

Seymour Twp.

THE TOWNSHIP  
OF  
**BELMONT**  
COUNTY OF  
PETERBOROUGH

EASTERN ONTARIO  
MINING DIVISION

SCALE: 1-INCH = 40 CHAINS

LEGEND

100' FEET  
ORDINARY LOCAL SCALE  
LARGER  
LOCATED LAND  
LARGER, 1/2" OCCUPATION  
MINING RIGHTS ONLY  
SURFACE 40' TO 100' ONLY  
MINING RIGHTS ONLY  
KINGS HIGHWAYS  
RAILWAYS  
PUSH LINES  
MADON - M. M. M. S.  
MINING

NOTES

This Map Is Not To Be Used  
FOR SURVEY PURPOSES

400' Surface Rights Reservation around Lakes & Rivers

Original Surveyors' Plans  
P. M. I. Surveyors' Plans  
Potentially Map showing known thus

For status of lands in this map  
contact with Lands & Forests

Four islands in Crowe Lake opposite lots  
B & C. Contained for Public use  
File 146610

BELMONT LAKE ONLY  
PRESENT SHORELINE SHOWN THIS  
ORIGINAL SHORELINE SHOWN THIS

AREA SHOWN THIS IS A REVISION OF  
PORTION OF THE ORIGINAL TOWNSHIP PLAN  
AND HAS BEEN COMPILED FROM SURVEYS AS  
AUTHORIZED BY THE SURVEYOR GENERAL

DATE OF ISSUE

SEP 17 1910

ONTARIO DEPT. OF MINES

PLAN NO. M.53

DEPARTMENT OF MINES

Dummer Twp.

Marmora Twp.

Asphodel Twp.

Seymour Twp.



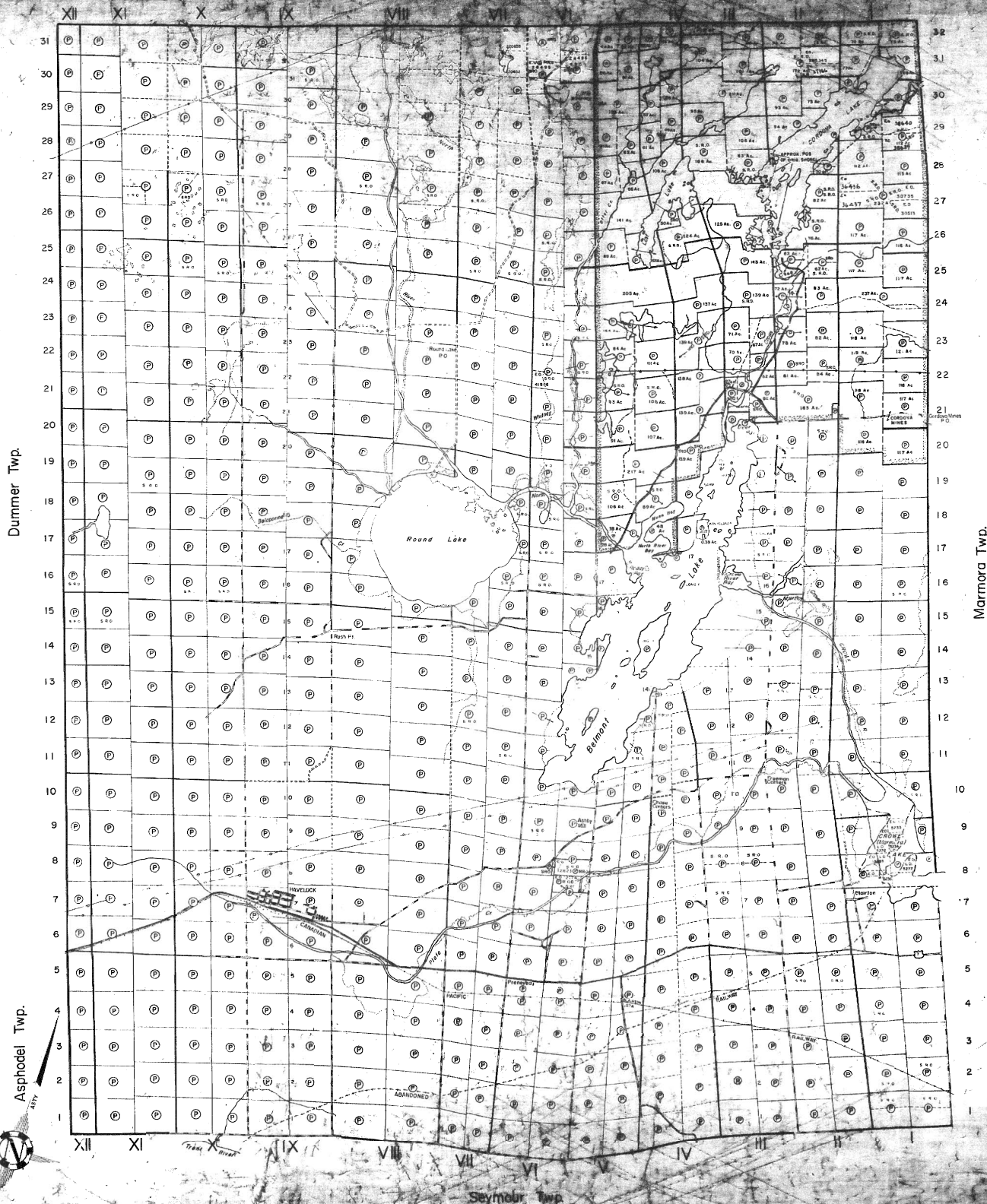



TOWNSHIP  
OF  
**BELMONT**  
COUNTY OF  
PETERBOROUGH

EASTERN ONTARIO  
MINING DIVISION

SCALE: 1-INCH = 40 CHAINS

LEGEND

PATENT, LAND  
CROWN LAND SALE  
LEASES  
LOCATED LAND  
LICENSES OF OCCUPATION  
MINING RIGHTS ONLY  
SURFACE RIGHTS ONLY  
RAILS  
RAILROADS  
KINGS HIGHWAYS  
RAILWAYS  
POWER LINES  
WATERS OR WATERS  
MINED

NOTES

This Map Is Not To Be Used  
FOR SURVEY PURPOSES  
400' Surface Rights Reservation around  
Lakes & Rivers

Original shoreline shown thus  
P.R. 11 shoreline shown thus  
Patents Map shoreline shown thus

For status of lands in this map  
contact Dept. of Lands & Forests

Four islands in Crow Lake opposite north  
R.B. 9 Cont. Reserved for Public Use  
File 146610.

BELMONT LAKE ONLY  
PRESENT SHORELINE SHOWN THIS  
ORIGINAL SHORELINE SHOWN THIS  
AREA SHOWN THIS IS A REVISION OF  
PORTION OF THE ORIGINAL TOWNSHIP PLAN  
AND HAS BEEN COMPILED FROM RESURVEYS AS  
AUTHORIZED BY THE SURVEYOR GENERAL

DATE OF ISSUE

JUN 1 1972

ONT. DEPT. OF MINES  
AND NORTHERN AFFAIRS

PLAN NO. M-53

ONTARIO  
DEPARTMENT OF MINES  
AND NORTHERN AFFAIRS

Dummer Twp.

Marmora Twp.

Asphodel Twp.

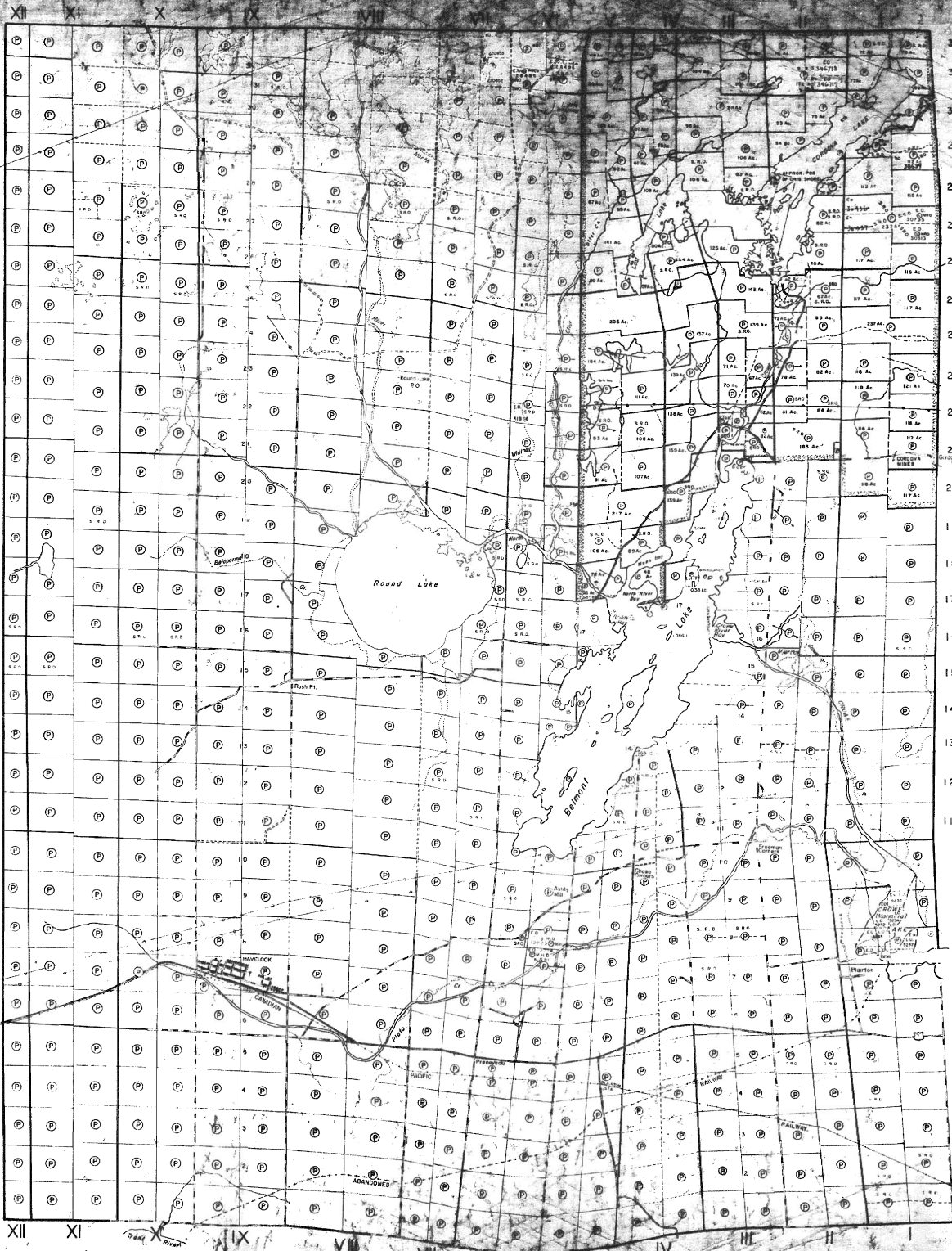

THE TOWNSHIP  
OF

**BELMONT**

COUNTY OF  
PETERBOROUGH

EASTERN ONTARIO  
MINING DIVISION

SCALE: 1-INCH = 40 CHAINS

**LEGEND**

PATENTED LAND  
 GRANT LAND  
 LEASES  
 LOCATED LAND  
 LICENSES OF OCCUPATION  
 MINING RIGHTS ONLY  
 SURFACES RIGHTS ONLY  
 RAILROADS  
 KINGS HIGHWAYS  
 RAILWAYS  
 POWER LINES  
 WOODEN OR WOVEN  
 MINES

**NOTES**

This Map Is Not To Be Used  
FOR SURVEY PURPOSES

401 Surface Rights Reservation and  
Lakes & Rivers

UNITED STATES LAND  
 1/4 SECTION 10, T10N, R10E, E1/2  
 1/4 SECTION 10, T10N, R10E, E1/2  
 1/4 SECTION 10, T10N, R10E, E1/2  
 1/4 SECTION 10, T10N, R10E, E1/2

For Status of the area in this  
containing the Lakes & Rivers

Four shares in Dredge Lake 10000 ft. 100 ft.  
E & N. Cont. Reserved for Public Use  
File 146610.

**BELMONT LAKE ONLY**  
PRESENT SHORELINE SHOWN THIS  
ORIGINAL SHORELINE SHOWN THIS

AREA SHOWN THIS IS A REVISION OF  
PORTION OF THE ORIGINAL TOWNSHIP PLAN  
AND HAS BEEN COMPILED FROM REQUISITES AS  
AUTHORIZED BY THE SURVEYOR GENERAL

DATE OF ISSUE  
 SEP 30 1971  
 ONT. DEPT. OF MINES  
 AND NORTHERN AFFAIRS

PLAN NO. M.53

ONTARIO  
 DEPARTMENT OF MINES

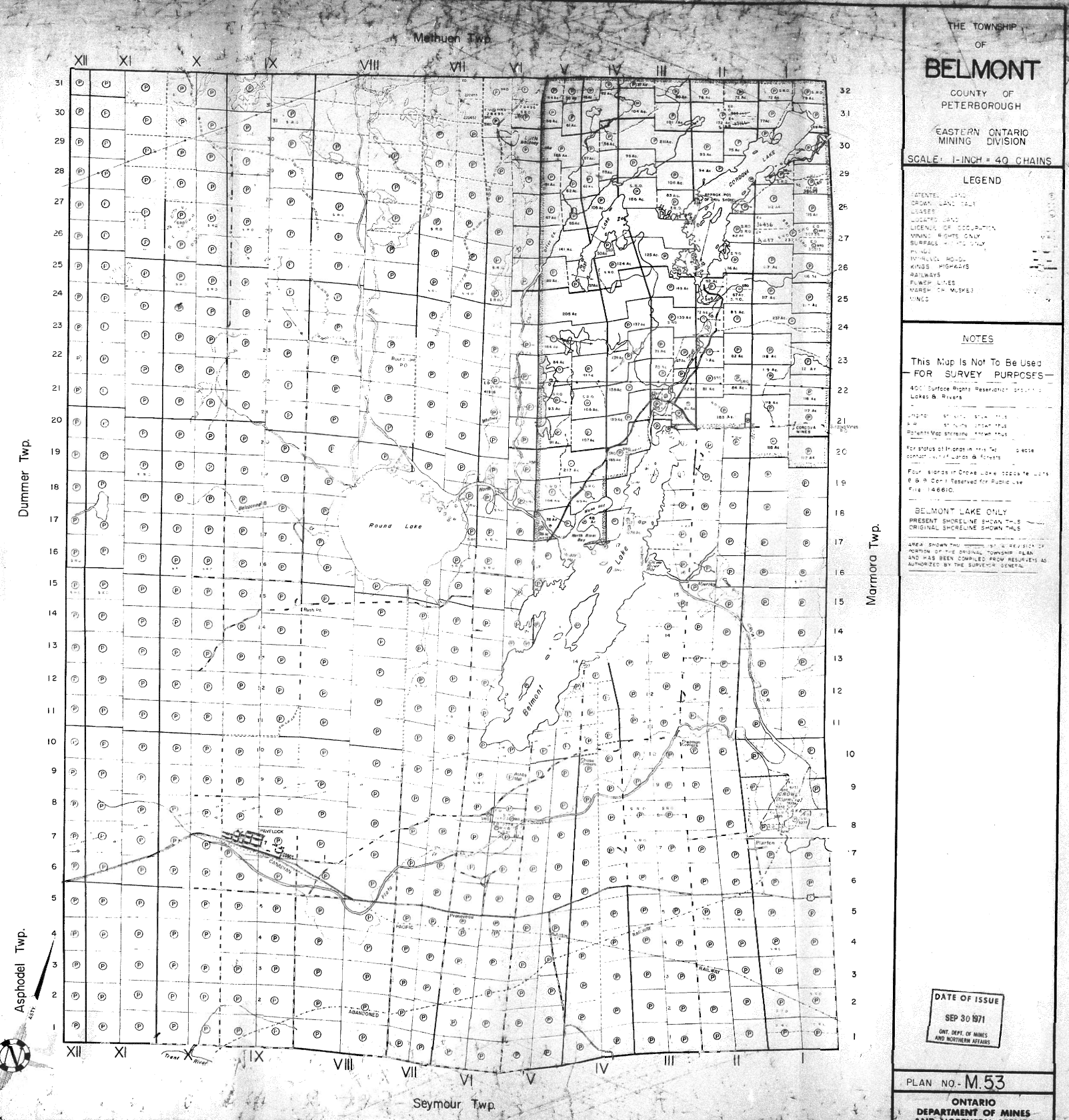

# BELMONT

COUNTY OF  
PETERBOROUGH

EASTERN ONTARIO  
MINING DIVISION

SCALE: 1-INCH = 40 CHAINS

## LEGEND

PATENTS, LEASES  
 CROWN LAND SALE  
 LOCATED LAND  
 LICENSES OF OCCUPATION  
 MINING RIGHTS ONLY  
 SURFACE RIGHTS ONLY  
 RAILROADS  
 KINGS, HIGHWAYS  
 RAILWAYS  
 POWER LINES  
 WATERS OF COURSE  
 MINES

## NOTES

This Map Is Not To Be Used  
FOR SURVEY PURPOSES

400' Surface Rights Reservation around  
Lakes & Rivers

(Original) 1871, 1872, 1873, 1874  
 F.R. 1, 1871, 1872, 1873, 1874  
 Patent Map showing known thus

For status of lands in this map  
contact with the Lands & Forests  
Department

Four islands in Crowe Lake opposite Lot 1  
 & 2, 3, 4, 5, 6, 7, 8, 9, 10, 11, 12, 13, 14, 15, 16, 17, 18, 19, 20, 21, 22, 23, 24, 25, 26, 27, 28, 29, 30, 31, 32  
 File 146610

BELMONT LAKE ONLY  
 PRESENT SHORELINE SHOWN THIS  
 ORIGINAL SHORELINE SHOWN THIS

AREA SHOWN THIS IS A REVISION OF  
 PORTION OF THE ORIGINAL TOWNSHIP PLAN  
 AND HAS BEEN COMPILED FROM RESURVEYS AS  
 AUTHORIZED BY THE SURVEYOR GENERAL

MINING LANDS  
 DATE OF ISSUE  
 SEP 11 1973  
 MINISTRY  
 OF NATURAL RESOURCES

PLAN NO. M.53

ONTARIO

Dummer Twp.

Marmora Twp.

Asphodel Twp.

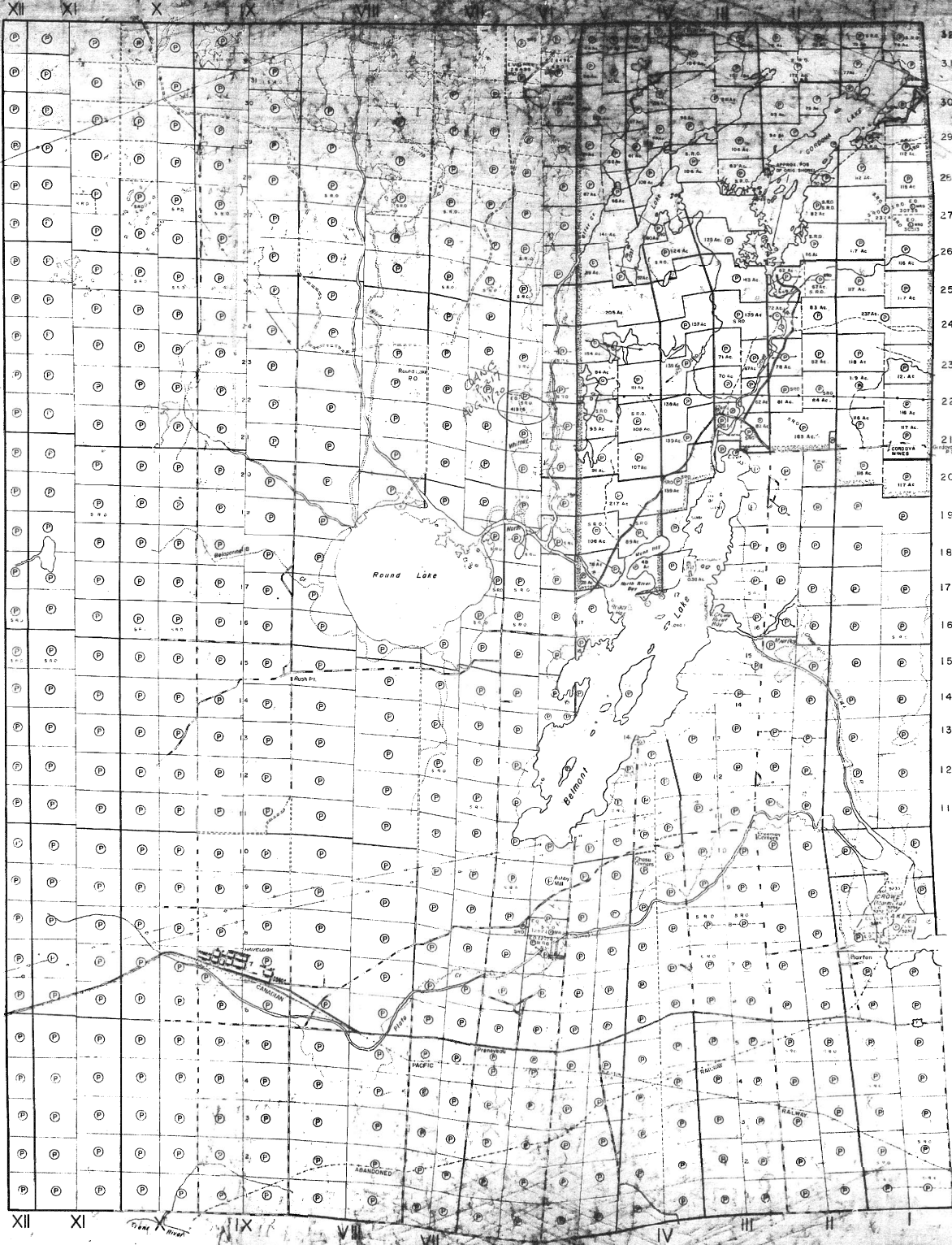

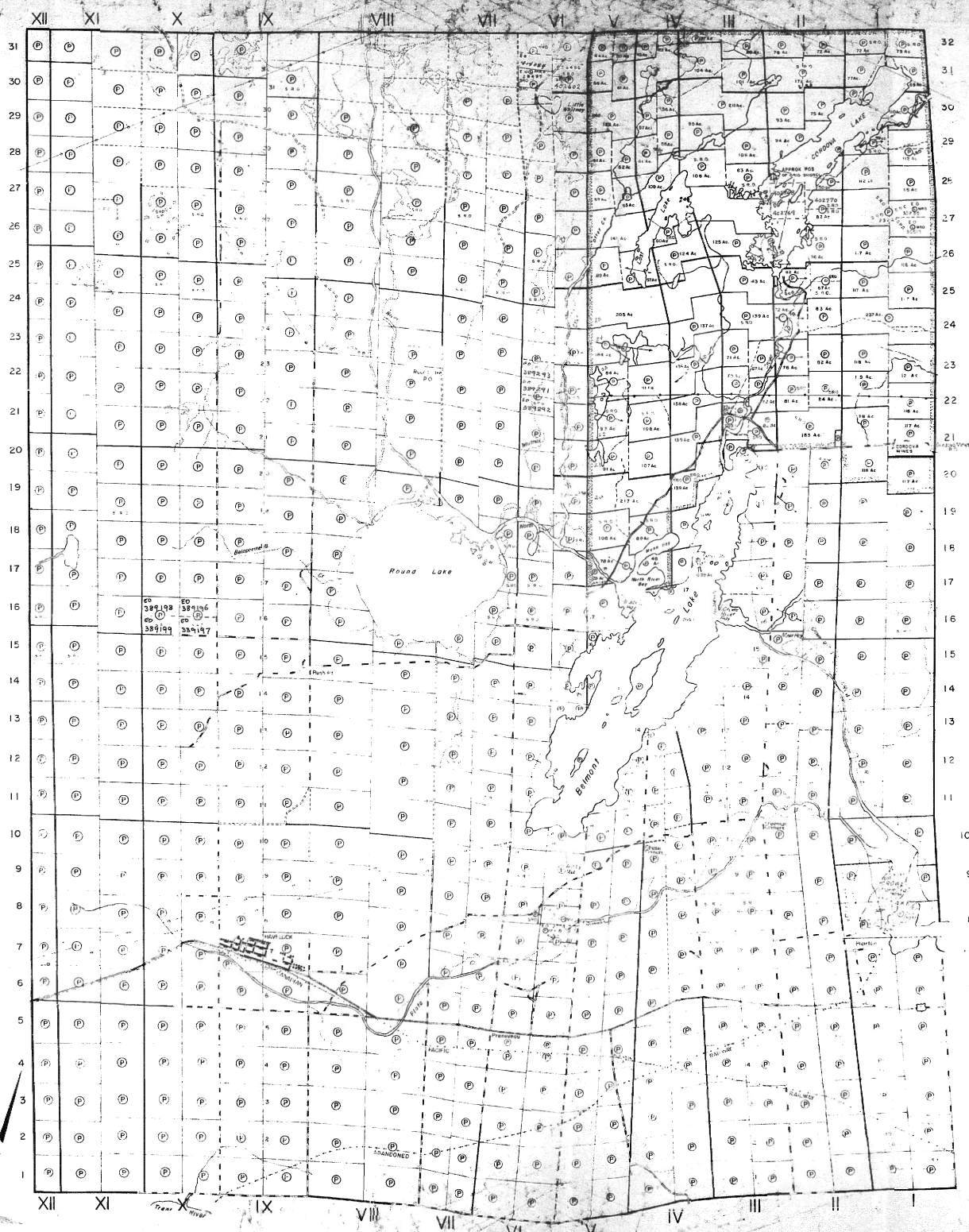



# BELMONT

COUNTY OF  
PETERBOROUGH

EASTERN ONTARIO  
MINING DIVISION

SCALE: 1-INCH = 40 CHAINS

## LEGEND

WATER, AND  
CROWN LAND SALE  
LEASES  
LOCATED AND  
LICENSES OF OCCUPATION  
MINING RIGHTS ONLY  
SURFACE RIGHTS ONLY  
RAILWAYS  
FLOWER LINES  
MADEH OF MOUNTAINS  
MINES

## NOTES

This Map Is Not To Be Used  
FOR SURVEY PURPOSES

400' Surface Rights Reservation shown as  
Locket & Rivers

Original Survey Map  
P.R. 1. Shading shown thus  
Parent Map shown thus

For status of lands in this map, please  
contact Land & Forests

Four signs in Crowe Lake opposite Locket  
& Rivers Reserved for Public Use  
File 146610.

BELMONT LAKE ONLY  
PRESENT SHORELINE SHOWN THIS  
ORIGINAL SHORELINE SHOWN THIS

AREA SHOWN THIS IS A REVISION OF  
PORTION OF THE ORIGINAL TOWNSHIP PLAN  
AND HAS BEEN COMPILED FROM RESURVEYS AS  
AUTHORIZED BY THE SURVEYOR GENERAL

MINING LANDS  
DATE OF ISSUE  
APR 17 1974  
MINISTRY  
OF NATURAL RESOURCES

PLAN NO. M-53

ONTARIO  
MINISTRY OF NATURAL RESOURCES  
SURVEYS AND MAPPING BRANCH

Dummer Twp.

Asphodel Twp.

Marmora Twp.

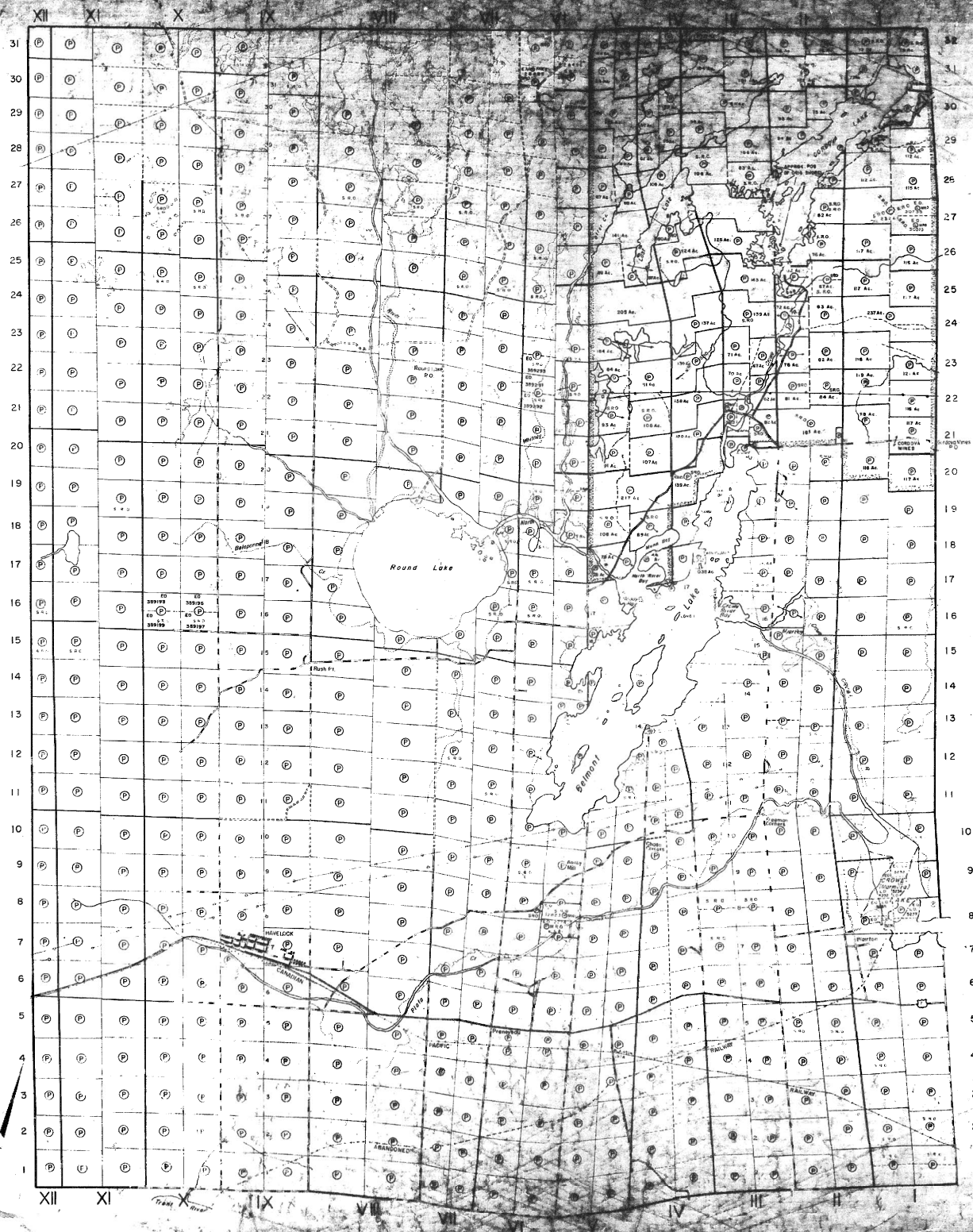

## BELMONT

COUNTY OF  
PETERBOROUGHEASTERN ONTARIO  
MINING DIVISION

SCALE: 1-INCH = 40 CHAINS

## LEGEND

PATENTED LAND  
CROWN LAND SALE  
LEASES  
LOCATED LAND  
LICENSE OF OCCUPATION  
MINING RIGHTS ONLY  
SURFACE RIGHTS ONLY  
ROADS  
IMPROVED ROADS  
KINGS HIGHWAYS  
RAILWAYS  
POWER LINES  
MARSH OR MUSKES  
MINES  
PATENTED LAND-S.R.O.

## NOTES

This Map is Not To Be Used  
FOR SURVEY PURPOSES—

400' Surface Rights Reservation along  
the shores of all lakes and rivers

Original shoreline shown thus: —  
P.R.L. shoreline shown thus: —  
Patents Map shoreline shown thus: —

For status of Islands in this Township  
refer to Ministry of Natural Resources  
records

Four Islands in Crowe Lake opposite Lots  
8 & 9 Con. I Reserved for Public Use.  
File: 146610.

BELMONT LAKE ONLY.  
PRESENT SHORELINE SHOWN THUS:  
ORIGINAL SHORELINE SHOWN THUS: —

AREA SHOWN THUS: — IS A REVISION OF  
PORTION OF THE ORIGINAL TOWNSHIP PLAN  
AND HAS BEEN COMPILED FROM RESURVEYS AS  
AUTHORIZED BY THE SURVEYOR GENERAL.

DATE OF ISSUE

FEB 8/1978

SURVEYS AND MAPPING  
BRANCH

Dummer Twp.

Marmora Twp. M. 122

Asphodel Twp.

