

PLAN OF CHALET TWP.

PORCUPINE - MINING DIVISION.
 DISTRICT OF SUDBURY

DATE OF ISSUE
 JUL 4 1975

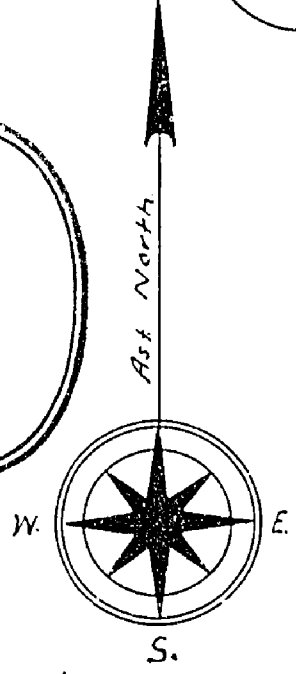

NOTE
 400' Surface Rights Reservation
 around all Lakes and Rivers.

— Scale 40 chains to an inch. —

ARDEN TWP.

RECEIVED
 JUL 14 1975
 AM 7 18 19 10 11 12 1 2 13 14 15 16 PM

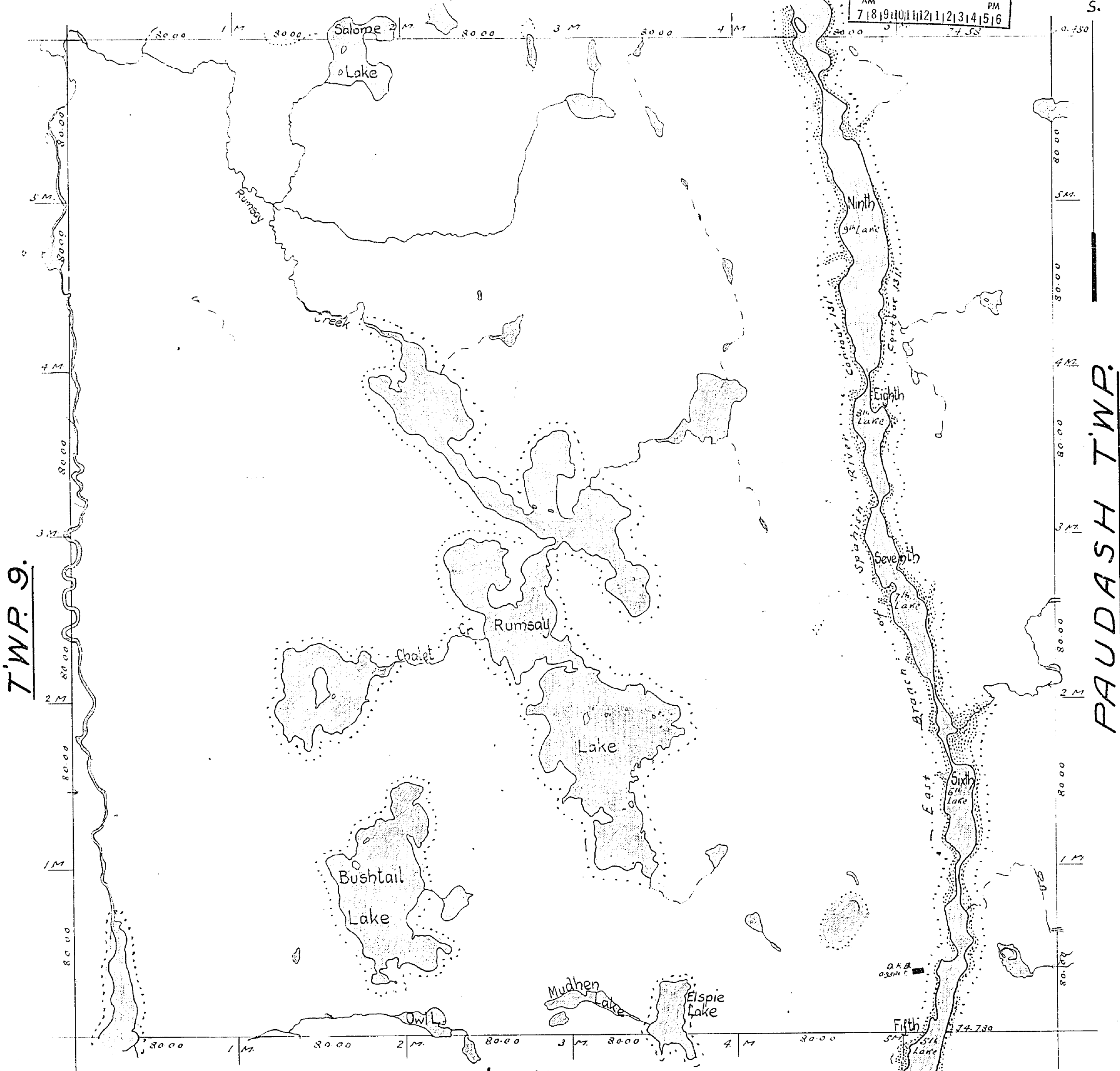

Notes

Railways shown	-----	Flooded Lands
Paved Highways	=====	Bridges	—
Gravel Roads	=====	Buildings	■
Other Roads	-----	Stamps	⊙
Trails & Paths	-----	Areas marked ⊙ are Patented	
Highway Route Nos	-----	⊙ are Leased.	
Telegraph & Telephone Lines	-----	⊙ are held under	
Electric Power Lines	-----	License of Occupation	
Non-perennial streams	-----		

Contour 131'

TWP. 7.

TWP. 9.

PAUDASH TWP.

ONTARIO
MINISTRY OF NATURAL RESOURCES
SURVEYS AND MAPPING BRANCH

M.711

PLAN OF CHALET TWP. PORCUPINE - MINING DIVISION. DISTRICT OF SUDBURY.

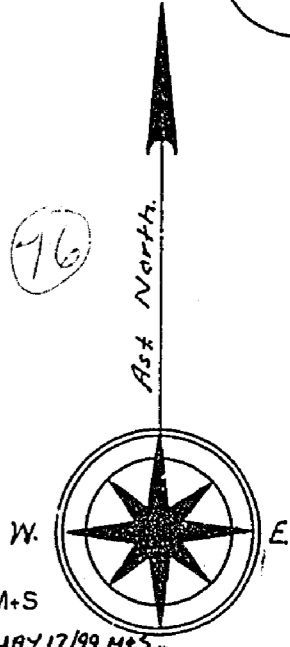

NOTE

400' Surface Rights Reservation
around all Lakes and Rivers.

F₁ SUBJECT TO FORESTRY ACTIVITY IN 1994/95
1995/96

— Scale 40 chains to an inch. —

ARDEN TWP.

SEC 35 W-LL-PI572/99 ONT MAY15/99 M+S

SEC 35 W-LL-PI92/99 ONT MAY17/99 M+S

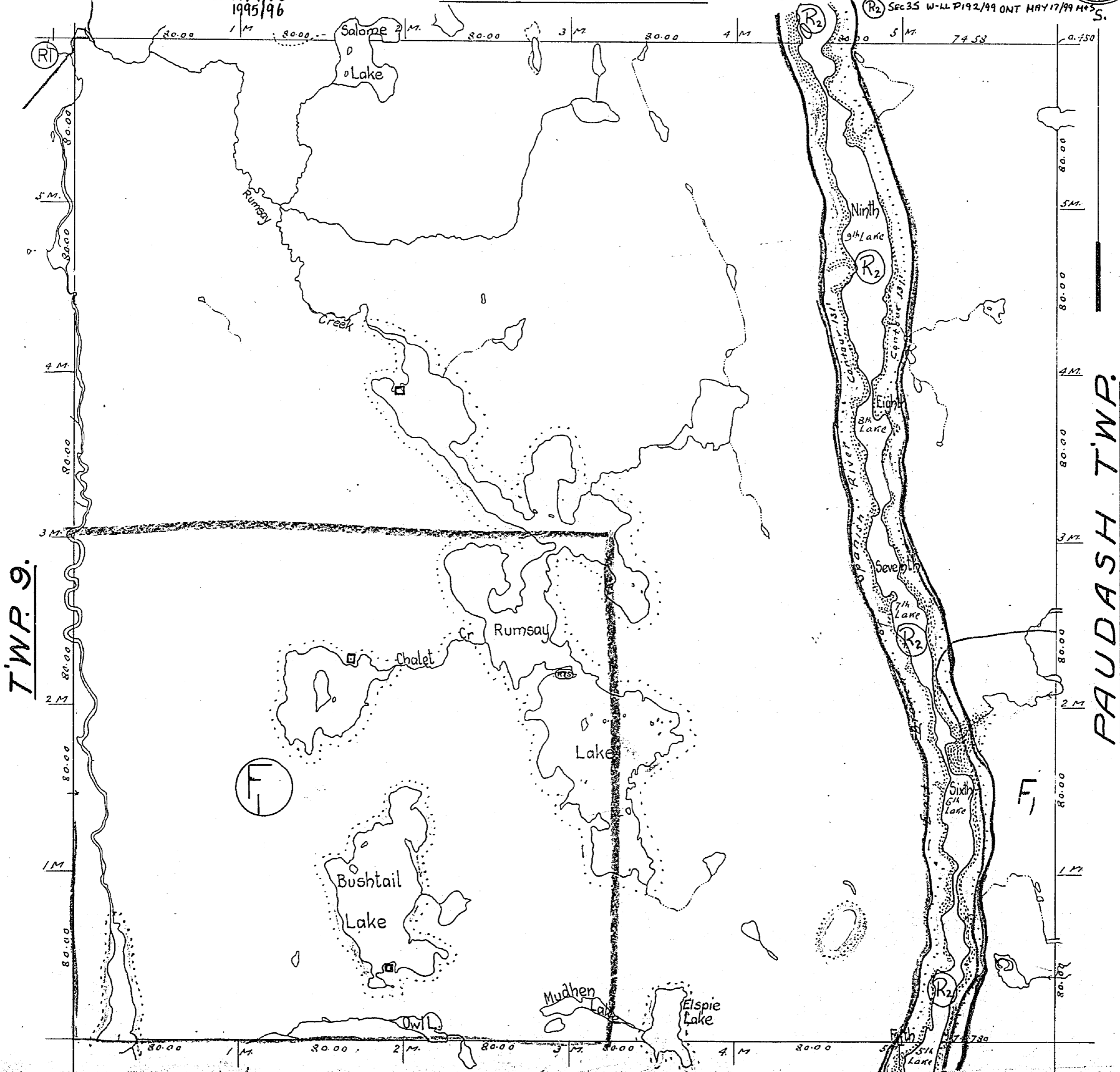

Notes

Railways shown	Flooded Areas
Paved Highways	Wetlands
Gravel	Wetlands
Other Roads	Wetlands
Trail Paths	Wetlands
Highway Route Nos.	Wetlands
Telephone Lines	Wetlands
Power Lines	Wetlands
Residential Streams	Wetlands

Contour 151'

REMOTE TOURIST CAMP

THE INFORMATION THAT APPEARS ON THIS MAP HAS BEEN COMPILED FROM VARIOUS SOURCES AND ACCURACY IS NOT GUARANTEED. THOSE WISHING TO STAKE MINING CLAIMS SHOULD CONSULT WITH THE MINING RECORDER, MINISTRY OF NORTHERN DEVELOPMENT AND MINES FOR ADDITIONAL INFORMATION ON THE STATUS OF THE LANDS SHOWN HEREON.

James W. [Signature]