

AREAS WITHDRAWN FROM DISPOSITION

M.R.O. - MINING RIGHTS ONLY
 S.R.O. - SURFACE RIGHTS ONLY
 M.S. - MINING AND SURFACE RIGHTS

Description	Order No.	Date	Disposition	File

Received Aug. 17/83

LEGEND

- HIGHWAY AND ROUTE No.
- OTHER ROADS
- TRAILS
- SURVEYED LINES:
 - TOWNSHIPS, BASE LINES, ETC.
 - LOTS, MINING CLAIMS, PARCELS, ETC.
- UNSURVEYED LINES:
 - LOT LINES
 - PARCEL BOUNDARY
 - MINING CLAIMS ETC.
- RAILWAY AND RIGHT OF WAY
- UTILITY LINES
- NON-PERENNIAL STREAM
- FLOODING OR FLOODING RIGHTS
- SUBDIVISION OR COMPOSITE PLAN
- RESERVATIONS
- ORIGINAL SHORELINE
- MARSH OR MUSKEG
- MINES
- TRAVERSE MONUMENT

DISPOSITION OF CROWN LANDS

TYPE OF DOCUMENT	SYMBOL
PATENT, SURFACE & MINING RIGHTS	
" SURFACE RIGHTS ONLY	
" MINING RIGHTS ONLY	
LEASE, SURFACE & MINING RIGHTS	
" SURFACE RIGHTS ONLY	
" MINING RIGHTS ONLY	
LICENCE OF OCCUPATION	
ORDER-IN-COUNCIL	
RESERVATION	
CANCELLED	
SAND & GRAVEL	

NOTE: MINING RIGHTS IN PARCELS PATENTED PRIOR TO MAY 6, 1913, VESTED IN ORIGINAL PATENTEE BY THE PUBLIC LANDS ACT, R.S.O. 1970, CHAP. 380, SEC. 63, SUBSEC. 1.

SCALE: 1 INCH = 40 CHAINS

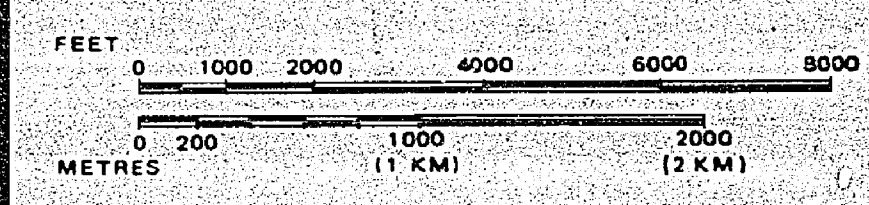

TOWNSHIP:
DePENCIER
 M.N.R. ADMINISTRATIVE DISTRICT
MOOSONEE
 MINING DIVISION
PORCUPINE
 LAND TITLES / REGISTRY DIVISION
COCHRANE

Ministry of Natural Resources / Land Management Branch
 Ontario

Date: JANUARY, 1985
 Number: **G-1416**

DYER TWP. G-1418

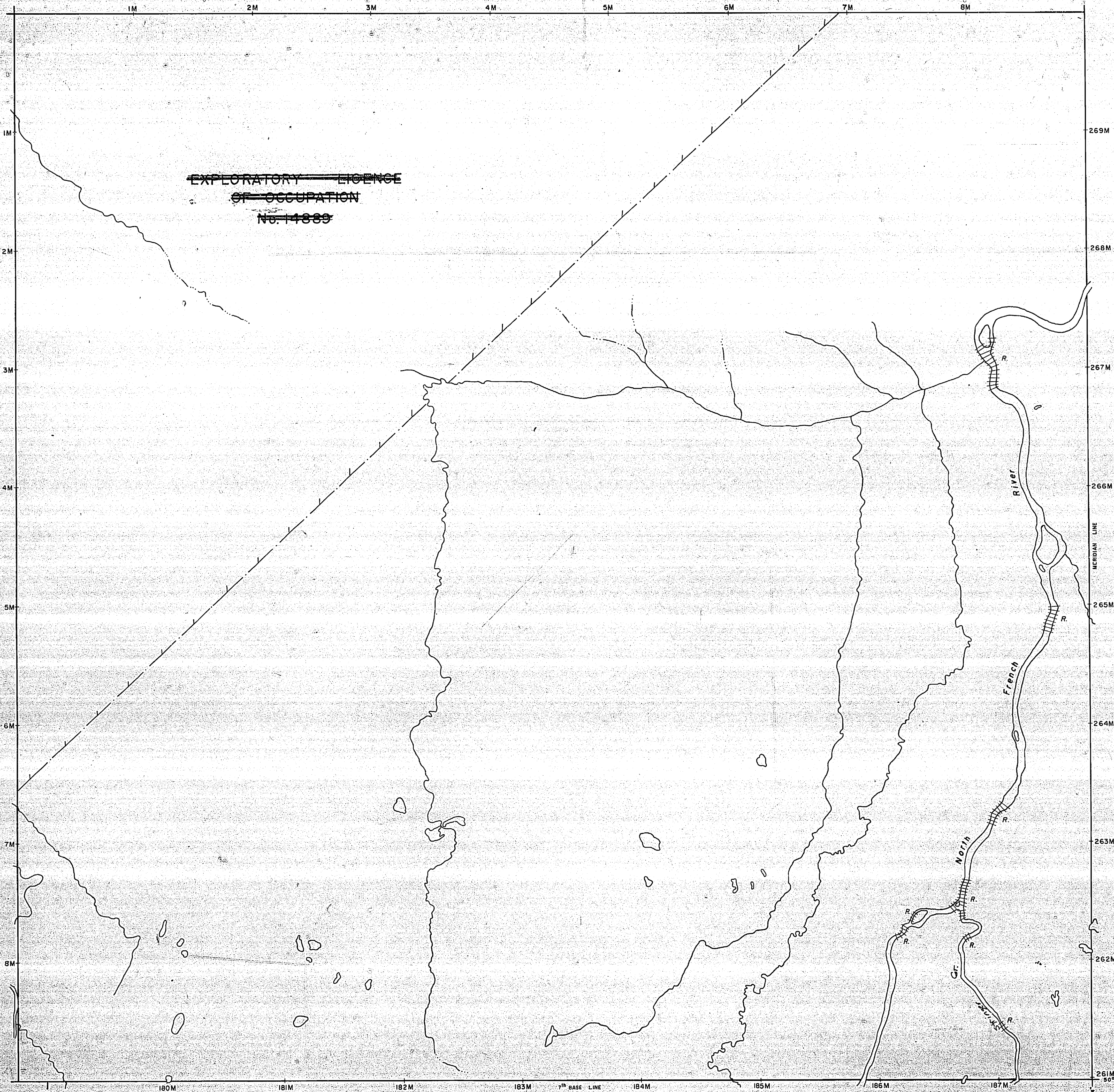

~~EXPLORATORY LICENCE~~
~~OF OCCUPATION~~
 No. 14889

LEGEND

PATENTED LAND	⊙
CROWN LAND SALE	C.S.
LEASES	⊙
LOCATED LAND	Loc
LICENSE OF OCCUPATION	L.O.
MINING RIGHTS ONLY	M.R.O.
SURFACE RIGHTS ONLY	S.R.O.
ROADS	—
IMPROVED ROADS	—
KING'S HIGHWAYS	—
RAILWAYS	—
POWER LINES	—
MARSH OR MUSKEG	—
MINES	—
CANCELLED	—

NOTES

400' surface rights reservation along the shores of all lakes and rivers.

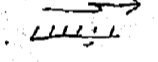
④3 MAR. 10/75 Sr. & M.R. 

DYER TWP. M.467

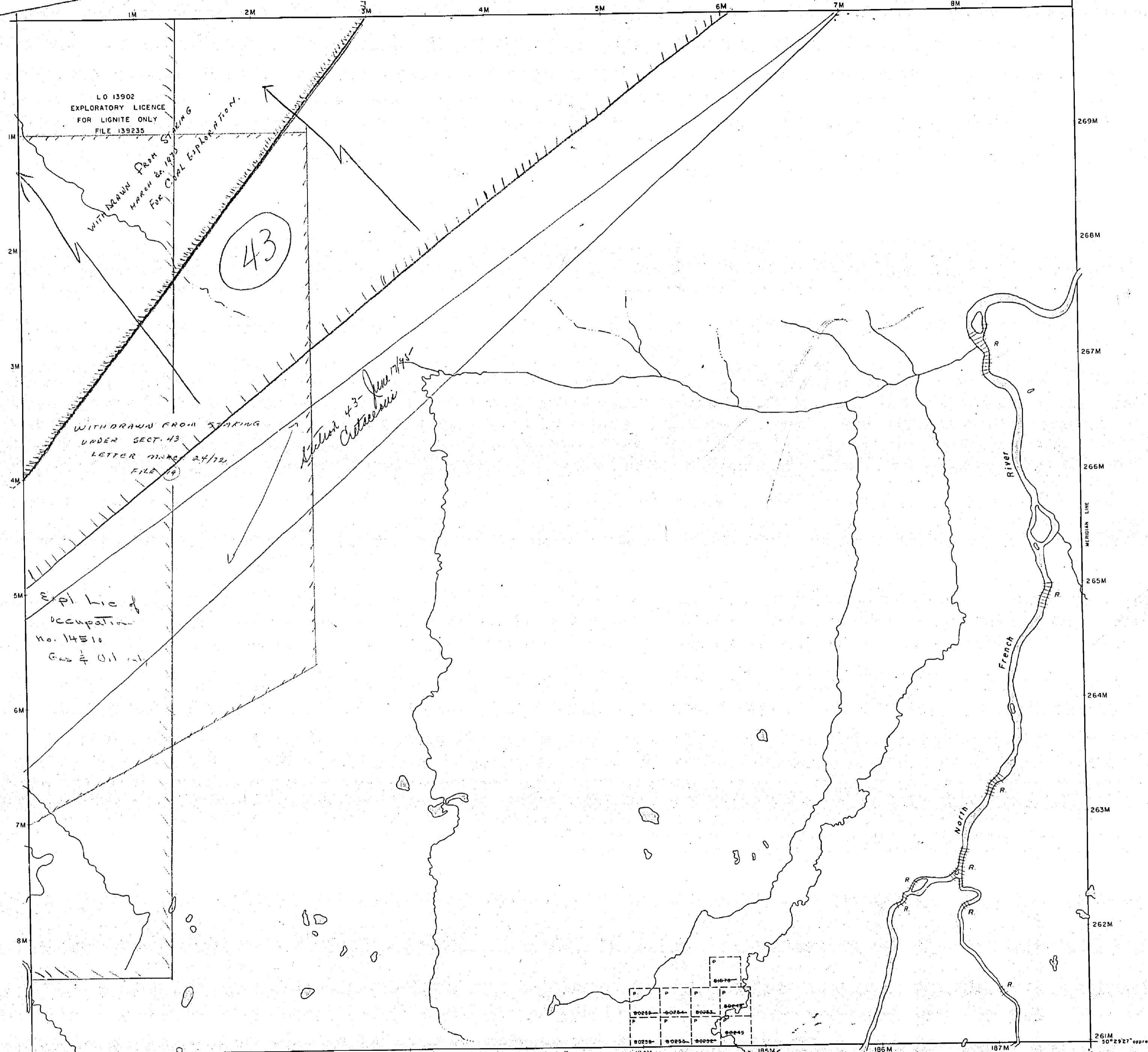

PORCUPINE
 MINING DIV.
RECEIVED
 MAY 21 1969
 AM 7:00 10:11 12:12 3:00 4:00 5:00 PM

PLAN NO. - M.464

DePENCIER

DISTRICT OF COCHRANE

PORCUPINE MINING DIVISION

SCALE: 1-INCH = 40 CHAINS

LEGEND

PATENTED LAND	Ⓟ
CROWN LAND SALE	C.S.
LEASES	Ⓞ
LOCATED LAND	Loc.
LICENSE OF OCCUPATION	L.O.
MINING RIGHTS ONLY	M.R.O.
SURFACE RIGHTS ONLY	S.R.O.
ROADS	—
IMPROVED ROADS	—
KING'S HIGHWAYS	—
RAILWAYS	—
POWER LINES	—
MARSH OR MUSKEG	—
MINES	ⓧ
CANCELLED	C.

Received Jan. 9/82

Replaced Aug. 17/83

NOTES

400' surface rights reservation along the shores of all lakes and rivers.

DYER TWP. M.467

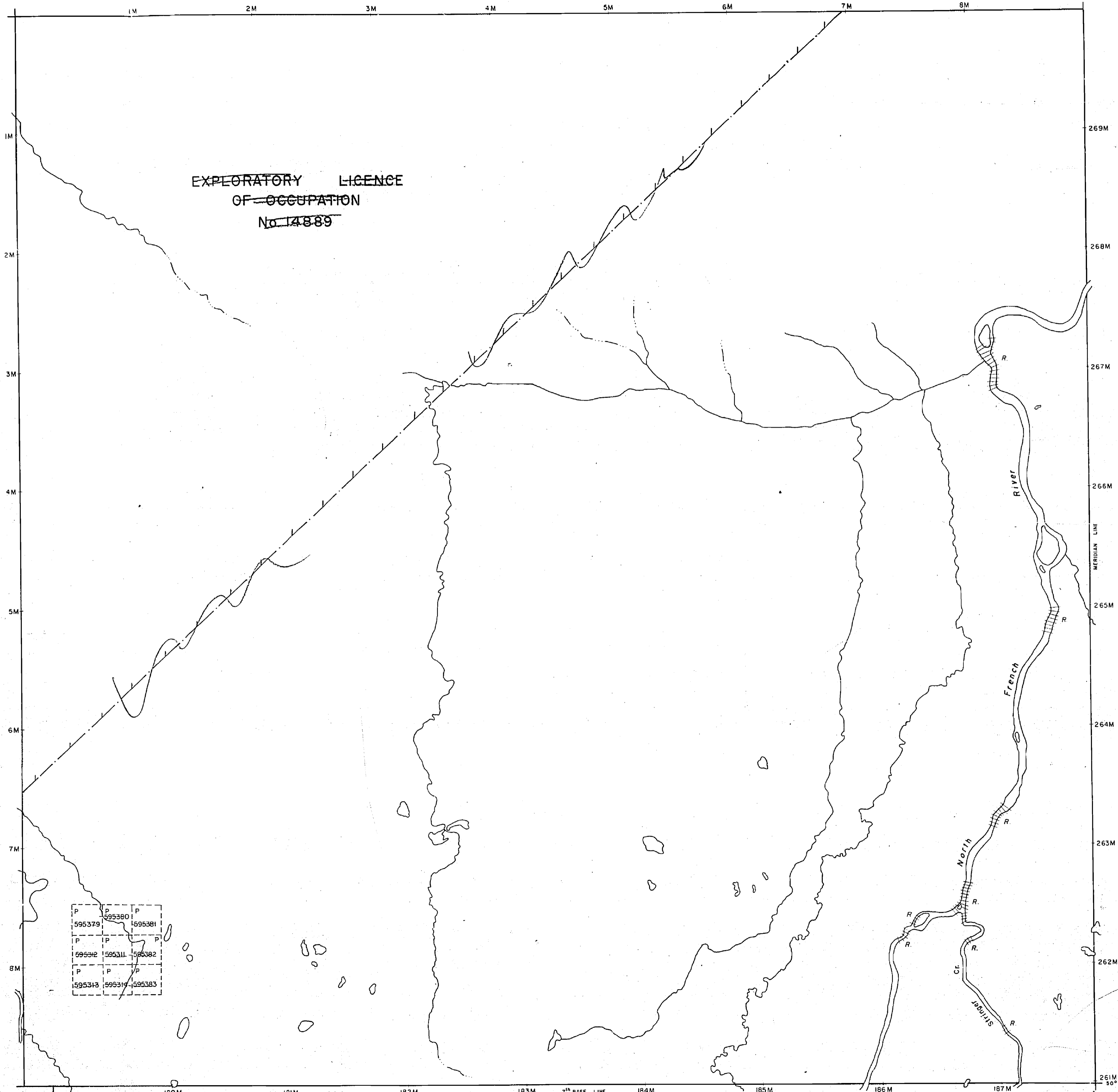

AREA OF
**EAST OF
 DE PENCIER TWP.**
 DISTRICT OF
 COCHRANE
 (PORCUPINE)
 LARDER LAKE
 MINING DIVISION

SCALE: 1-INCH = 40 CHAINS

LEGEND

PATENTED LAND	Ⓢ
CROWN LAND SALE	C.S.
LEASES	Ⓞ
LOCATED LAND	Loc.
LICENSE OF OCCUPATION	L.O.
MINING RIGHTS ONLY	M.R.O.
SURFACE RIGHTS ONLY	S.R.O.
ROADS	—
IMPROVED ROADS	—
KING'S HIGHWAYS	—
RAILWAYS	—
POWER LINES	—
MARSH OR MUSKEG	—
MINES	⌘
CANCELLED	C.

NOTES

400' Surface Rights Reservation around all lakes and rivers.

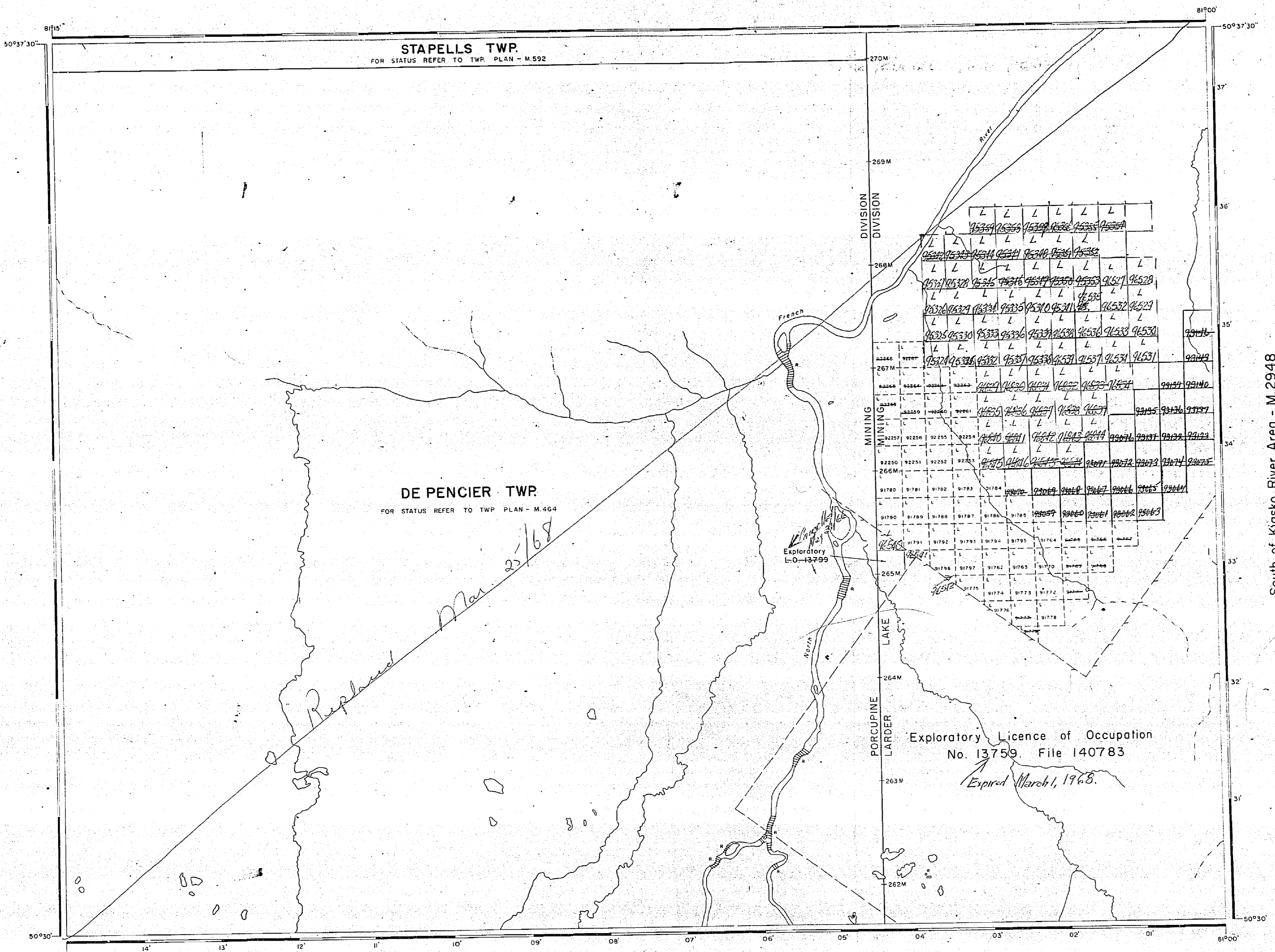

South of Kiasko River Area - M.2948

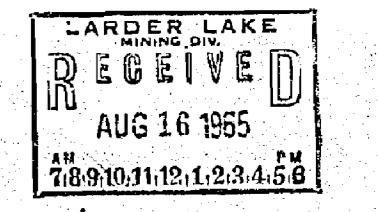

PLAN NO. **M.2969**

DEPARTMENT OF MINES
 — ONTARIO —

464

PLAN OF D. E. PENCIER TWP. TIMISKAMING MINING DIVISION. T. 464 DISTRICT OF COCHRANE.

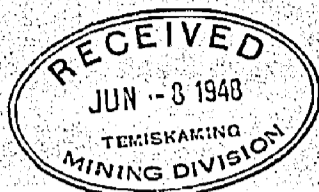

Scale 40 chains to an inch.

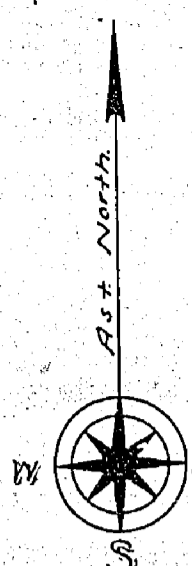

STAPELLS TWP

Withdrawn from
open 3/5/48 staking
Approx. Area
5,200 ac.

DYER TWP.

CARSS TWP.

Not Surveyed.

Note. Lines of French River and tributaries are not from survey.

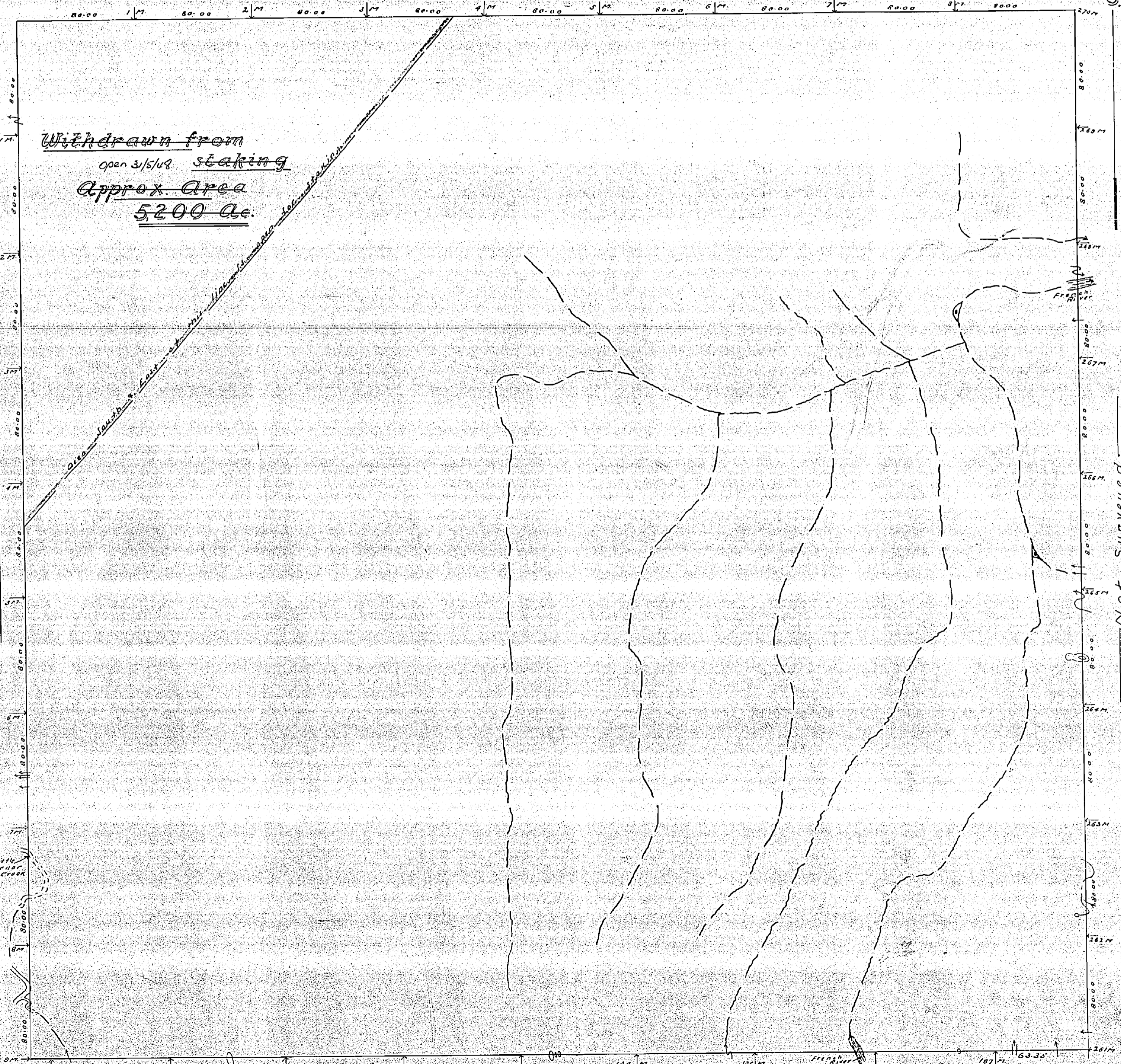

DePENCIER

DISTRICT OF COCHRANE

PORCUPINE MINING DIVISION

SCALE: 1-INCH = 40 CHAINS

M 464 B 5

LEGEND

PATENTED LAND	Ⓟ
CROWN LAND SALE	C.S.
LEASES	Ⓞ
LOCATED LAND	Loc.
LICENSE OF OCCUPATION	L.O.
MINING RIGHTS ONLY	M.R.O.
SURFACE RIGHTS ONLY	S.R.O.
ROADS	—
IMPROVED ROADS	—
KING'S HIGHWAYS	—
RAILWAYS	—
POWER LINES	—
MARSH OR MUSKEG	—
MINES	—
CANCELLED	—

NOTES

400' surface rights reservation along the shores of all lakes and rivers.

④3 MAR. 10/75 Sr. & Me. *will*

DYER TWP. M.467

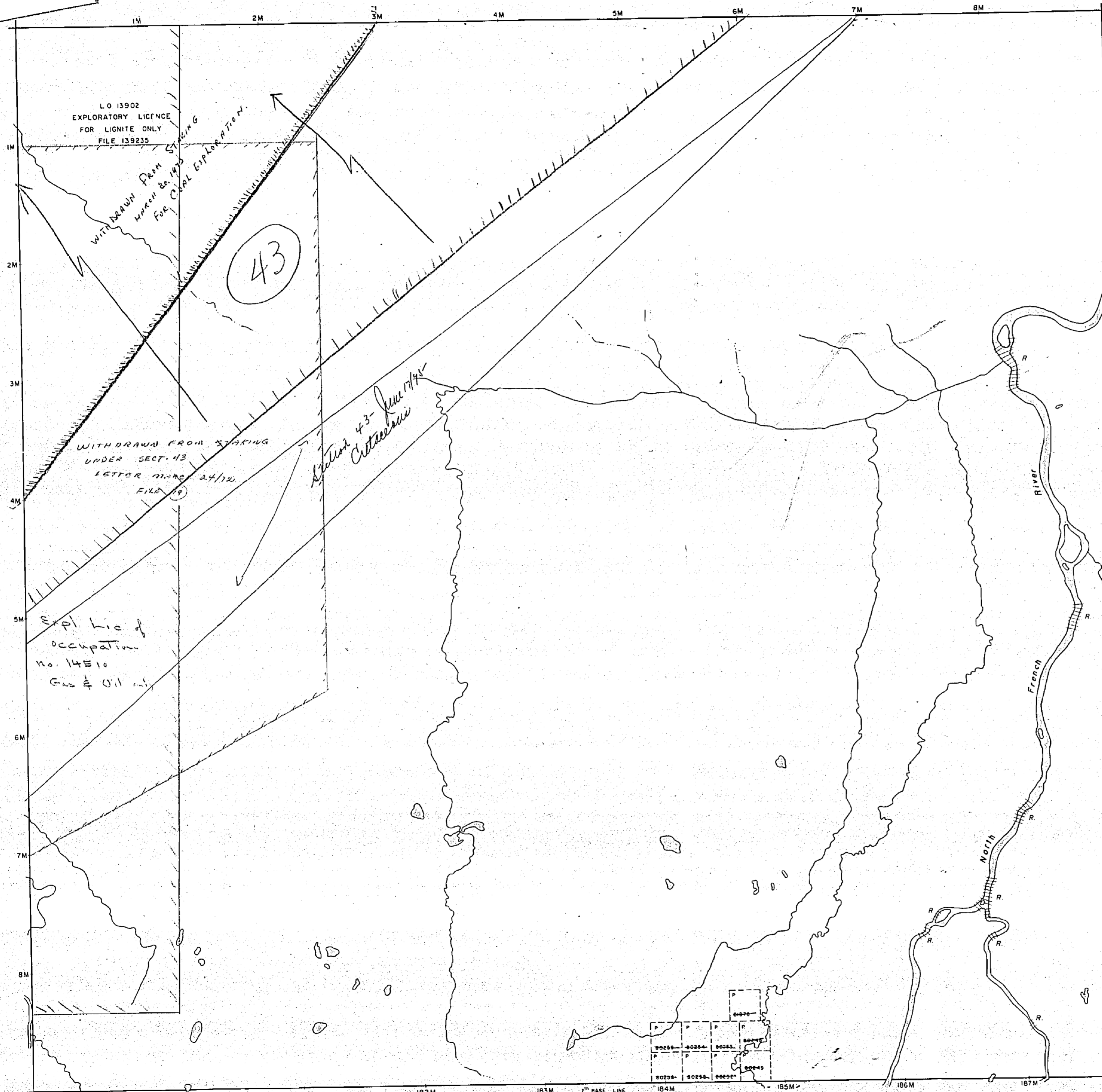

PORCUPINE MINING DIV.
RECEIVED
 MAY 21 1969
 AM 7:8 9:10 11:12 1:2 3:4 5:6 PM

PLAN NO.- M.464

DEPARTMENT OF MINES - ONTARIO -

DePENCIER

DISTRICT OF COCHRANE

PORCUPINE MINING DIVISION

SCALE: 1-INCH = 40' CHAINS

LEGEND

PATENTED LAND	Ⓟ
CROWN LAND SALE	C.S.
LEASES	Ⓞ
LOCATED LAND	Loc.
LICENSE OF OCCUPATION	L.O.
MINING RIGHTS ONLY	M.R.O.
SURFACE RIGHTS ONLY	S.R.O.
ROADS	—
IMPROVED ROADS	—
KING'S HIGHWAYS	—
RAILWAYS	—
POWER LINES	—
MARSH OR MUSKEG	—
MINES	—
CANCELLED	—

NOTES

400' surface rights reservation along the shores of all lakes and rivers.

DATE OF ISSUE
JUL 15 1975

RECEIVED
JUL 22 1975
AM 7 18 19 10 11 12 1 12 1 3 4 15 16 PM

PLAN NO. M.464

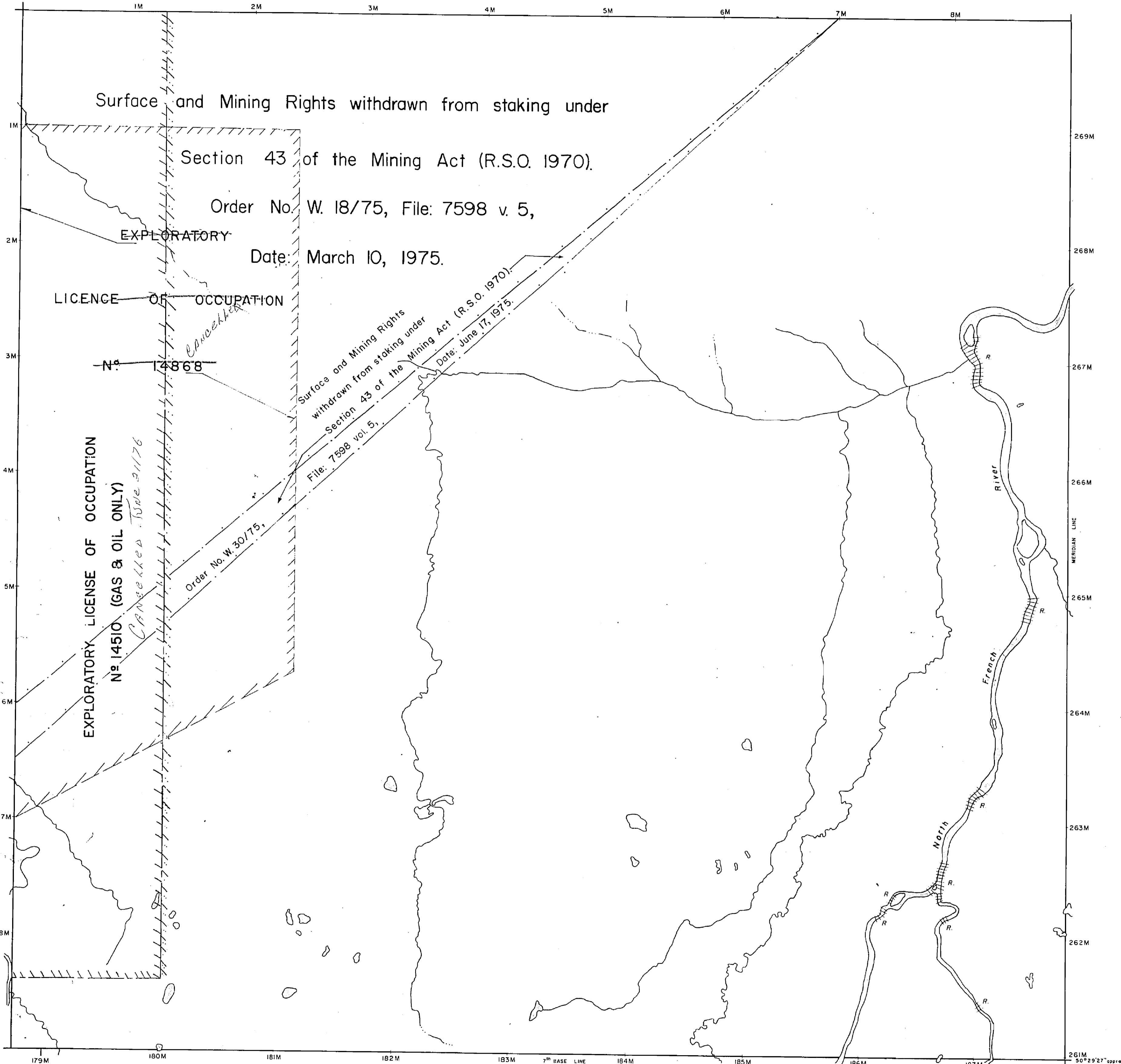

DYER TWP M.467

DePENCIER

DISTRICT OF COCHRANE

PORCUPINE MINING DIVISION

SCALE: 1-INCH = 40 CHAINS

LEGEND

PATENTED LAND	Ⓟ
CROWN LAND SALE	C.S.
LEASES	Ⓞ
LOCATED LAND	Loc.
LICENSE OF OCCUPATION	L.O.
MINING RIGHTS ONLY	M.R.O.
SURFACE RIGHTS ONLY	S.R.O.
ROADS	—
IMPROVED ROADS	—
KING'S HIGHWAYS	—
RAILWAYS	—
POWER LINES	—
MARSH OR MUSKEG	—
MINES	—
CANCELLED	—

NOTES

400' surface rights reservation along the shores of all lakes and rivers.

MICROFILM

01 JAN 1984

Received March 1980

PLAN NO. **M.464**

Re-opened (Exploratory licence # 14889)
~~Surface and Mining Rights withdrawn from staking under~~

~~Section 43 of the Mining Act (R.S.O. 1970)~~

~~Order No. W. 18/75, File: 183199,~~

~~Date: March 10, 1975.~~

*Surface and Mining Rights
withdrawn from staking under
Section 43 of the Mining Act (R.S.O. 1970)
File: 7598 vol. 5,
Date: June 17, 1975.*

Order No. W. 30/75,

595379	595380	595381
595382	595383	595384
595385	595386	595387

DYER TWP. M.467

100424
50°29'27" approx.

464

PLAN OF D. E. PENCIER TWP. M. 464

PORCUPINE MINING DIVISION

DISTRICT OF COCHRANE

Scale, 40 chains to an inch.

STAPELLS TWP

WATERED FROM SOURCE
R 1/57
D.P.M. AUG. 15/43



EXCLUSIVE OF LIGNITE

DYER TWP.

Not Surveyed

93802	93801	93800	93809	93808
93803	93804	93805	93806	93807

93085	93083
93086	93084

**CANCELLED MAY 31/66
OPEN JUNE 1/66**

All minerals other than petroleum and natural gas in that part of this Township outlined in red, covered by Exploratory License #13799, dated June 1, 1965.

93091	93092	93094
93090	93093	93095

90882	90881	90870	90871	90872	90873	90874	90875	90876	90877	90878	90879	90880
90883	90884	90885	90886	90887	90888	90889	90890	90891	90892	90893	90894	90895
90896	90897	90898	90899	90900	90901	90902	90903	90904	90905	90906	90907	90908
90909	90910	90911	90912	90913	90914	90915	90916	90917	90918	90919	90920	90921
90922	90923	90924	90925	90926	90927	90928	90929	90930	90931	90932	90933	90934
90935	90936	90937	90938	90939	90940	90941	90942	90943	90944	90945	90946	90947
90948	90949	90950	90951	90952	90953	90954	90955	90956	90957	90958	90959	90960

84209	84208	84207	84206	84205
84204	84203	84202	84201	84200
84199	84198	84197	84196	84195
84194	84193	84192	84191	84190
84189	84188	84187	84186	84185
84184	84183	84182	84181	84180
84179	84178	84177	84176	84175
84174	84173	84172	84171	84170
84169	84168	84167	84166	84165
84164	84163	84162	84161	84160
84159	84158	84157	84156	84155
84154	84153	84152	84151	84150
84149	84148	84147	84146	84145
84144	84143	84142	84141	84140
84139	84138	84137	84136	84135
84134	84133	84132	84131	84130
84129	84128	84127	84126	84125
84124	84123	84122	84121	84120
84119	84118	84117	84116	84115
84114	84113	84112	84111	84110
84109	84108	84107	84106	84105
84104	84103	84102	84101	84100
84099	84098	84097	84096	84095
84094	84093	84092	84091	84090
84089	84088	84087	84086	84085
84084	84083	84082	84081	84080
84079	84078	84077	84076	84075
84074	84073	84072	84071	84070
84069	84068	84067	84066	84065
84064	84063	84062	84061	84060
84059	84058	84057	84056	84055
84054	84053	84052	84051	84050
84049	84048	84047	84046	84045
84044	84043	84042	84041	84040
84039	84038	84037	84036	84035
84034	84033	84032	84031	84030
84029	84028	84027	84026	84025
84024	84023	84022	84021	84020
84019	84018	84017	84016	84015
84014	84013	84012	84011	84010
84009	84008	84007	84006	84005
84004	84003	84002	84001	84000

EXPLORATORY LICENSE 13799
ISSUED 1965
MAY 11/66

THIS TOWNSHIP IS NOT SURVEYED
THE TOTAL REMAINING IS COMPLETELY UNLOCATED

CARSS TWP.

Note: Lines of French River and tributaries are not from survey.

464

PLAN OF
D. E. PENCIER TWP.
TIMISKAMING MINING DIVISION. 71-464
DISTRICT OF COCHRANE.



Scale, 40 chains to an inch.

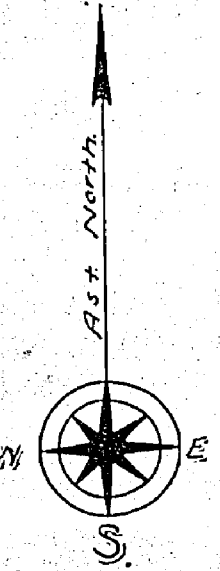

STAPELLS TWP.

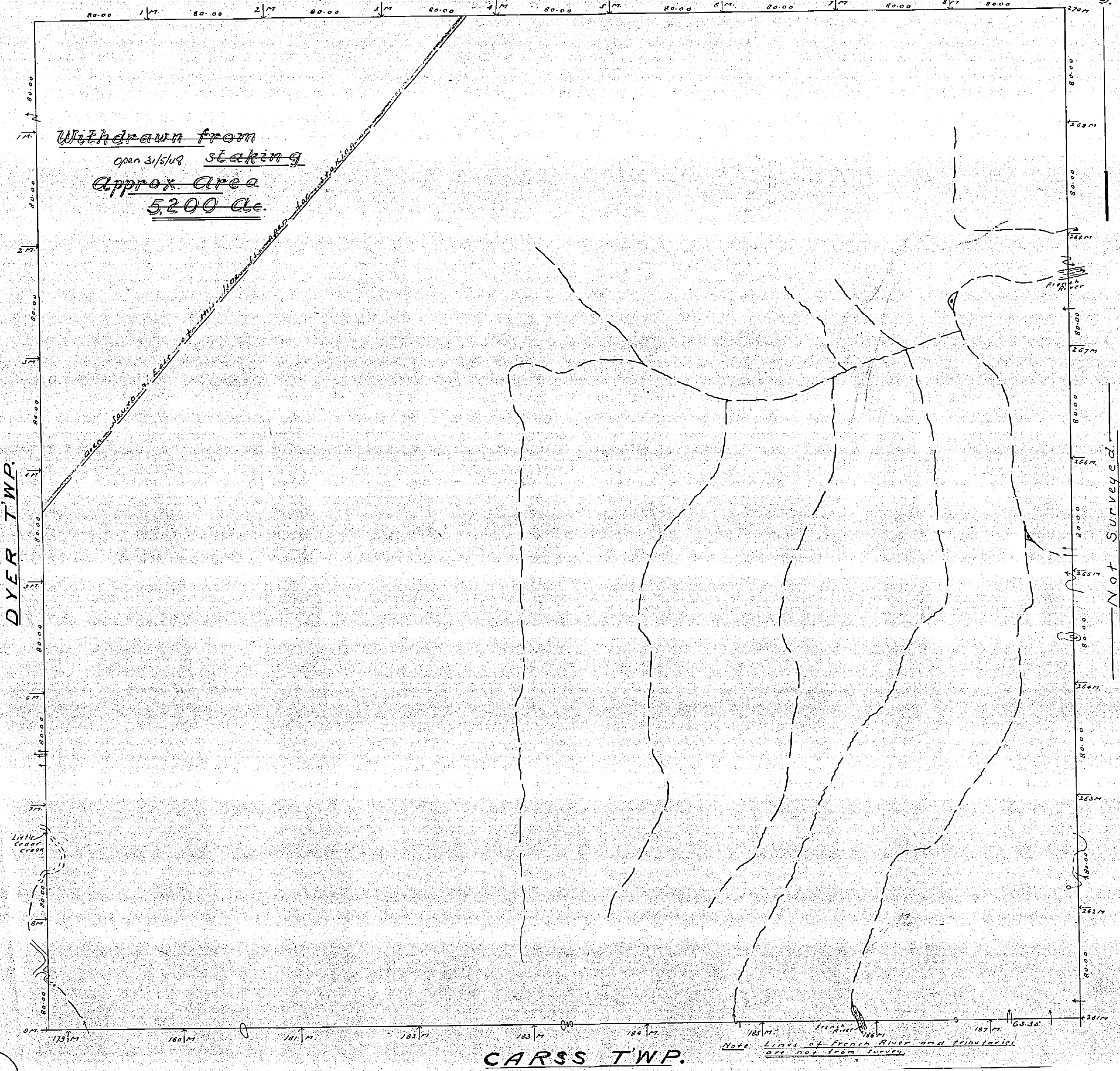

Withdrawn from
open 31/5/48 staking
Approx. Area
5,200 ac.

Not Surveyed.

Note. Lines of French River and tributaries are not from survey.

CARSS TWP.

DePENCIER

DISTRICT OF COCHRANE

PORCUPINE MINING DIVISION

SCALE: 1-INCH = 40 CHAINS

LEGEND

PATENTED LAND	⊙
CROWN LAND SALE	C.S.
LEASES	⊖
LOCATED LAND	Loc.
LICENSE OF OCCUPATION	L.O.
MINING RIGHTS ONLY	M.R.O.
SURFACE RIGHTS ONLY	S.R.O.
ROADS	—
IMPROVED ROADS	—
KING'S HIGHWAYS	—
RAILWAYS	—
POWER LINES	—
MARSH OR MUSKEG	—
MINES	—
CANCELLED	—

NOTES

400' surface rights reservation along the shores of all lakes and rivers.

MICROFILM

01 JAN 1984

Received May 1880

PLAN NO. **M.464**

ONTARIO
MINISTRY OF NATURAL RESOURCES
SURVEYS AND MAPPING BRANCH

Re-opened (Exploratory Licence # 14889)
~~Surface and Mining Rights withdrawn from staking under~~

~~Section 43 of the Mining Act (R.S.O.1970)~~

~~Order No. W. 18/75, File: 183199,~~

~~Date: March 10, 1975.~~

*Surface and Mining Rights
withdrawn from staking under
Section 43 of the Mining Act (R.S.O.1970)
Date: June 17, 1975.
File: 7598 vol. 5.*

Order No. W. 30/75.

DYER TWP M.467

595379	595380	595381
595312	595311	595382
595313	595314	595383

464

PLAN OF D. E. PENCIER TWP.

M. 464

PORCUPINE MINING DIVISION

DISTRICT OF COCHRANE

Scale 40 chains to an inch.

Withdrawn from Schedule
R 7/59
OPEN AUG. 15/63

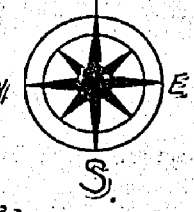

STAPELLS TWP.

EXCLUSIVE OF LIGHTS

DYER TWP.

CARSS TWP.

93802	93804	93806	93808	93810
93803	93805	93807	93809	93811

93085	93083
93086	93084

CANCELLED MAY 31/66
OPEN JUNE 1/66
 All minerals other than petroleum and natural gas in that part of this Township outlined in red, covered by Exploratory License #13799, dated June 1, 1965.

90888	90889	90890	90891	90892	90893	90894	90895	90896	90897
90898	90899	90900	90901	90902	90903	90904	90905	90906	90907
90897	90900	90901	90902	90903	81878	93124	93125		
90904	90905	90259	90254	90253	90248	93125	93127		
93129	93127	90258	90255	90252	90249	93126	93123		

93091	93092	93094
93090	93093	93095

9419	9420	9421	9422
9423	9424	9425	9426
9427	9428	9429	9430
9431	9432	9433	9434
9435	9436	9437	9438
9439	9440	9441	9442
9443	9444	9445	9446
9447	9448	9449	9450
9451	9452	9453	9454
9455	9456	9457	9458
9459	9460	9461	9462
9463	9464	9465	9466
9467	9468	9469	9470
9471	9472	9473	9474
9475	9476	9477	9478
9479	9480	9481	9482
9483	9484	9485	9486
9487	9488	9489	9490
9491	9492	9493	9494
9495	9496	9497	9498
9499	9500	9501	9502
9503	9504	9505	9506
9507	9508	9509	9510
9511	9512	9513	9514
9515	9516	9517	9518
9519	9520	9521	9522
9523	9524	9525	9526
9527	9528	9529	9530
9531	9532	9533	9534
9535	9536	9537	9538
9539	9540	9541	9542
9543	9544	9545	9546
9547	9548	9549	9550
9551	9552	9553	9554
9555	9556	9557	9558
9559	9560	9561	9562
9563	9564	9565	9566
9567	9568	9569	9570
9571	9572	9573	9574
9575	9576	9577	9578
9579	9580	9581	9582
9583	9584	9585	9586
9587	9588	9589	9590
9591	9592	9593	9594
9595	9596	9597	9598
9599	9600	9601	9602
9603	9604	9605	9606
9607	9608	9609	9610
9611	9612	9613	9614
9615	9616	9617	9618
9619	9620	9621	9622
9623	9624	9625	9626
9627	9628	9629	9630
9631	9632	9633	9634
9635	9636	9637	9638
9639	9640	9641	9642
9643	9644	9645	9646
9647	9648	9649	9650
9651	9652	9653	9654
9655	9656	9657	9658
9659	9660	9661	9662
9663	9664	9665	9666
9667	9668	9669	9670
9671	9672	9673	9674
9675	9676	9677	9678
9679	9680	9681	9682
9683	9684	9685	9686
9687	9688	9689	9690
9691	9692	9693	9694
9695	9696	9697	9698
9699	9700	9701	9702
9703	9704	9705	9706
9707	9708	9709	9710
9711	9712	9713	9714
9715	9716	9717	9718
9719	9720	9721	9722
9723	9724	9725	9726
9727	9728	9729	9730
9731	9732	9733	9734
9735	9736	9737	9738
9739	9740	9741	9742
9743	9744	9745	9746
9747	9748	9749	9750
9751	9752	9753	9754
9755	9756	9757	9758
9759	9760	9761	9762
9763	9764	9765	9766
9767	9768	9769	9770
9771	9772	9773	9774
9775	9776	9777	9778
9779	9780	9781	9782
9783	9784	9785	9786
9787	9788	9789	9790
9791	9792	9793	9794
9795	9796	9797	9798
9799	9800	9801	9802
9803	9804	9805	9806
9807	9808	9809	9810
9811	9812	9813	9814
9815	9816	9817	9818
9819	9820	9821	9822
9823	9824	9825	9826
9827	9828	9829	9830
9831	9832	9833	9834
9835	9836	9837	9838
9839	9840	9841	9842
9843	9844	9845	9846
9847	9848	9849	9850
9851	9852	9853	9854
9855	9856	9857	9858
9859	9860	9861	9862
9863	9864	9865	9866
9867	9868	9869	9870
9871	9872	9873	9874
9875	9876	9877	9878
9879	9880	9881	9882
9883	9884	9885	9886
9887	9888	9889	9890
9891	9892	9893	9894
9895	9896	9897	9898
9899	9900	9901	9902
9903	9904	9905	9906
9907	9908	9909	9910
9911	9912	9913	9914
9915	9916	9917	9918
9919	9920	9921	9922
9923	9924	9925	9926
9927	9928	9929	9930
9931	9932	9933	9934
9935	9936	9937	9938
9939	9940	9941	9942
9943	9944	9945	9946
9947	9948	9949	9950
9951	9952	9953	9954
9955	9956	9957	9958
9959	9960	9961	9962
9963	9964	9965	9966
9967	9968	9969	9970
9971	9972	9973	9974
9975	9976	9977	9978
9979	9980	9981	9982
9983	9984	9985	9986
9987	9988	9989	9990
9991	9992	9993	9994
9995	9996	9997	9998
9999	10000	10001	10002

Not Surveyed.

EXPLORATORY LICENSE 13799
MAY 31/66
THIS LICENSE IS COMPLETELY CANCELLED BY M. L. D. & S.

Note: Lines of French River and tributaries are not from survey.