

**INDEX TO LAND DISPOSITION**

PLAN  
G-3423  
TOWNSHIP  
**DELHI**

M.M.L. ADMINISTRATIVE DISTRICT  
**TEMAGAMI**  
MINERAL DIVISION  
**SUDBURY**  
LAND TITLES/REGISTRY DIVISION  
**SUDBURY**

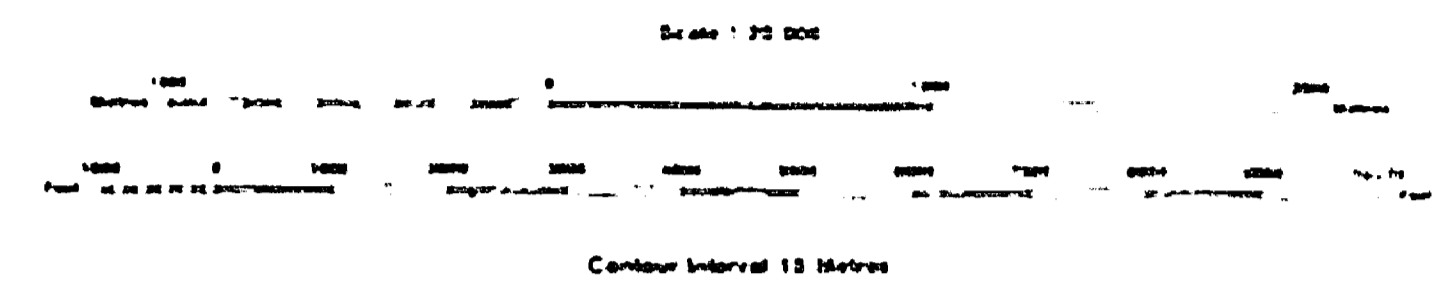

**AREAS WITHDRAWN FROM DISPOSITION**

- MRJ - Mining Rights Only
- SRO - Surface Rights Only
- M+S - Mining and Surface Rights

Disposition	Plan No.	Date	Disposition	Plan No.
REG 349/98	W-9-70/86	08/11/98	REG 349/98	W-9-70/86
REG 349/98	W-9-70/86	08/11/98	REG 349/98	W-9-70/86
REG 349/98	W-9-70/86	08/11/98	REG 349/98	W-9-70/86

**SYMBOLS**

Boundary	.....	
Township, Meridian, Baseline	.....	
Road allowance, surveyed	.....	
shoreline	.....	
Lot/Concession, surveyed	.....	
unsurveyed	.....	
Parcel, surveyed	.....	
unsurveyed	.....	
Right-of-way, road	.....	
railway	.....	
utility	.....	
Reservation	.....	
Cliff, Pit, Pale	.....	
Contour	.....	
Interpolated	.....	
Approximate	.....	
Depression	.....	
Control point (horizontal)	.....	
Flooded land	.....	
Mine head frame	.....	
Pipeline (above ground)	.....	
Railway: single track	.....	
double track	.....	
abandoned	.....	
Road: highway, county, township	.....	
access	.....	
trail, bush	.....	
Shoreline (original)	.....	
Transmission line	.....	
Wooded area	.....	

THE INFORMATION THAT APPEARS ON THIS MAP HAS BEEN COMPILED FROM VARIOUS SOURCES, AND ACCURACY IS NOT GUARANTEED. THOSE WISHING TO STAKE MINING CLAIMS SHOULD CONSULT WITH THE MINING RECORDER, MINISTRY OF NORTHERN DEVELOPMENT AND MINES, FOR ADDITIONAL INFORMATION ON THE STATUS OF THE LANDS SHOWN HEREON.

**OBABIKA RIVER PROVINCIAL PARK**  
ONTARIO REGULATION NO. 296/89 SCHEDULE 10.02  
NOTE - THE LIMITS OF THE PARK ARE POSITIONED 100 METERS IN PERPENDICULAR DISTANCE FROM THE HIGH WATER MARK UNLESS OTHERWISE STATED ON THE SCHEDULE.

**NOTES**

- W AREA DEEMED IN NEED OF PROTECTION BY THE CROWN AND WILL REMAIN WITHDRAWN INDEFINITELY.
- W AREA DEEMED IN NEED OF PROTECTION BY THE CROWN AND WILL REMAIN WITHDRAWN INDEFINITELY.

**DISPOSITION OF CROWN LANDS**

Patent	.....	
Surface & Mining Rights	.....	
Surface Rights Only	.....	
Mining Rights Only	.....	
Lease	.....	
Surface & Mining Rights	.....	
Surface Rights Only	.....	
Mining Rights Only	.....	
Licence of Occupation	.....	
Order-in-Council	.....	
Cancelled	.....	
Reservation	.....	
Sand & Gravel	.....	
LAND USE PERMIT	.....	

THIS TOWNSHIP FALLS WITHIN THE TEMAGAMI COMPREHENSIVE PLANNING AREA. SPECIAL WORKING CONDITIONS MAY APPLY TO EXPLORATION ACTIVITIES. FOR MORE DETAILS PLEASE CONTACT:  
DISTRICT MANAGER,  
NORTH BAY DISTRICT  
MINISTRY, NATURAL RESOURCES

REG 349/98

**NOTICE**  
WORK PERMITS FOR MINERAL EXPLORATION ACTIVITY  
EFFECTIVE September 15<sup>th</sup> 1998  
The area outlined as W on this map will be subject to Ontario's Regulation 349 made under the Public Lands Act. Depending on the type and timing of your exploration work, you may require a Work Permit. For further information, please contact Gerhard Meyer, Regional Resident Geologist at (705) 567-5242 or Jim Ireland, Regional Manager at (705) 235-1612.

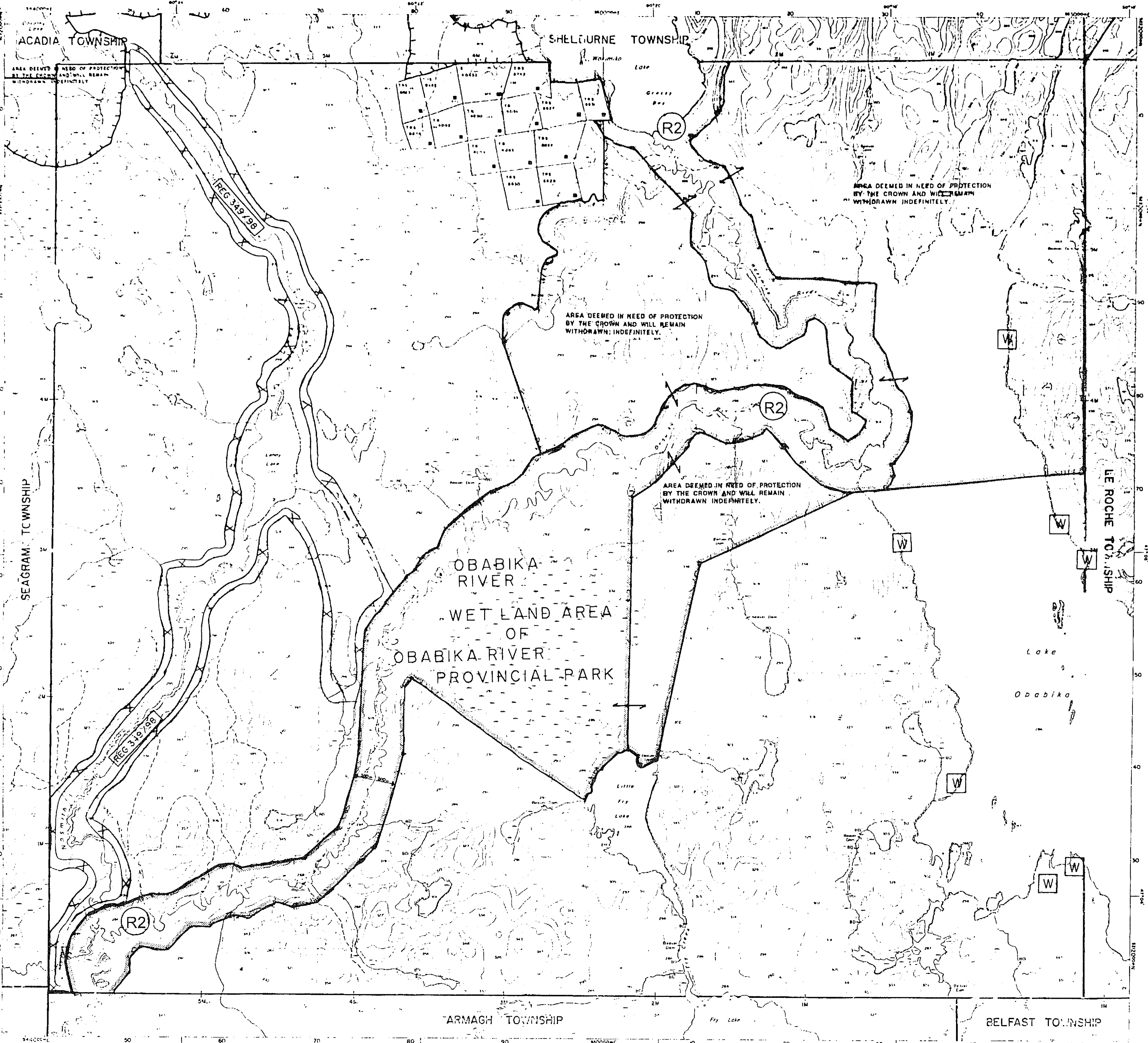

# DELHI

TINAGAMI PROVINCIAL FOREST

SUDBURY MINING DIVISION

DISTRICT OF SUDBURY

SCALE:- 40 CHAINS=1 INCH

## SHELBURNE



ACADIA

Wakimika Lake

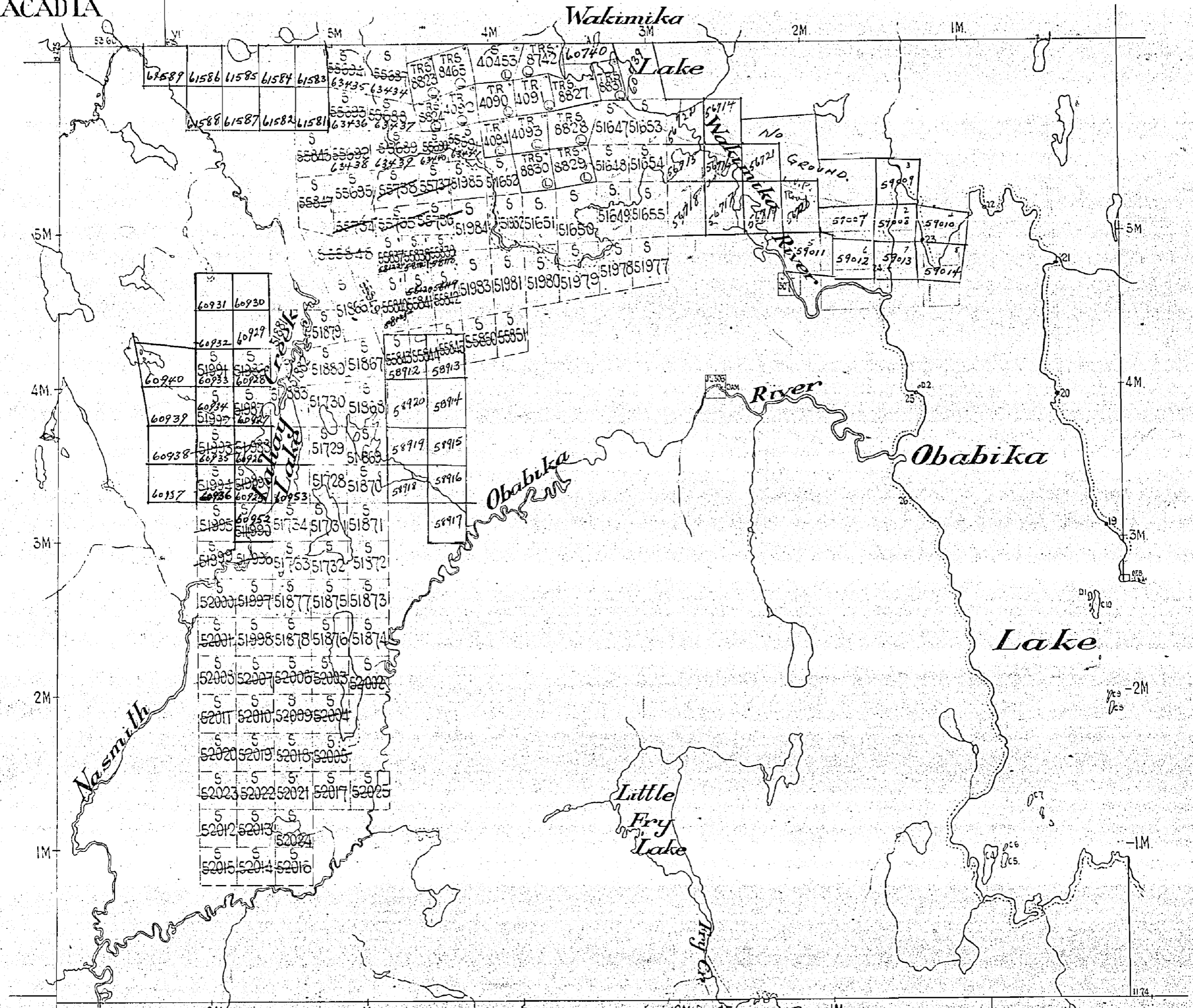

SEAGRAM

LE ROCHE

ARMAGH

BELFAST





# DELHI

TIMAGAMI PROVINCIAL FOREST

SUDBURY MINING DIVISION

DISTRICT OF SUDBURY

SCALE:- 40 CHAINS = 1 INCH

\* Township closed to staking effective March 16, 1984 Section 36 of the Mining Act.

\* TOWNSHIP CLOSED TO STAKING EFFECTIVE MAY 8, 1978 SECTION 38(r) THE MINING ACT

**NOTE**

400' Surface Rights Reservation around all Lakes and Rivers.

SHELBURNE

SUDBURY MINING DIV. RECEIVED JUN 22 1970 P.M. 7,8,9,10,11,12,13,14,15,16

North Ast

ACADIA

SEAGRAM

LE ROCHE

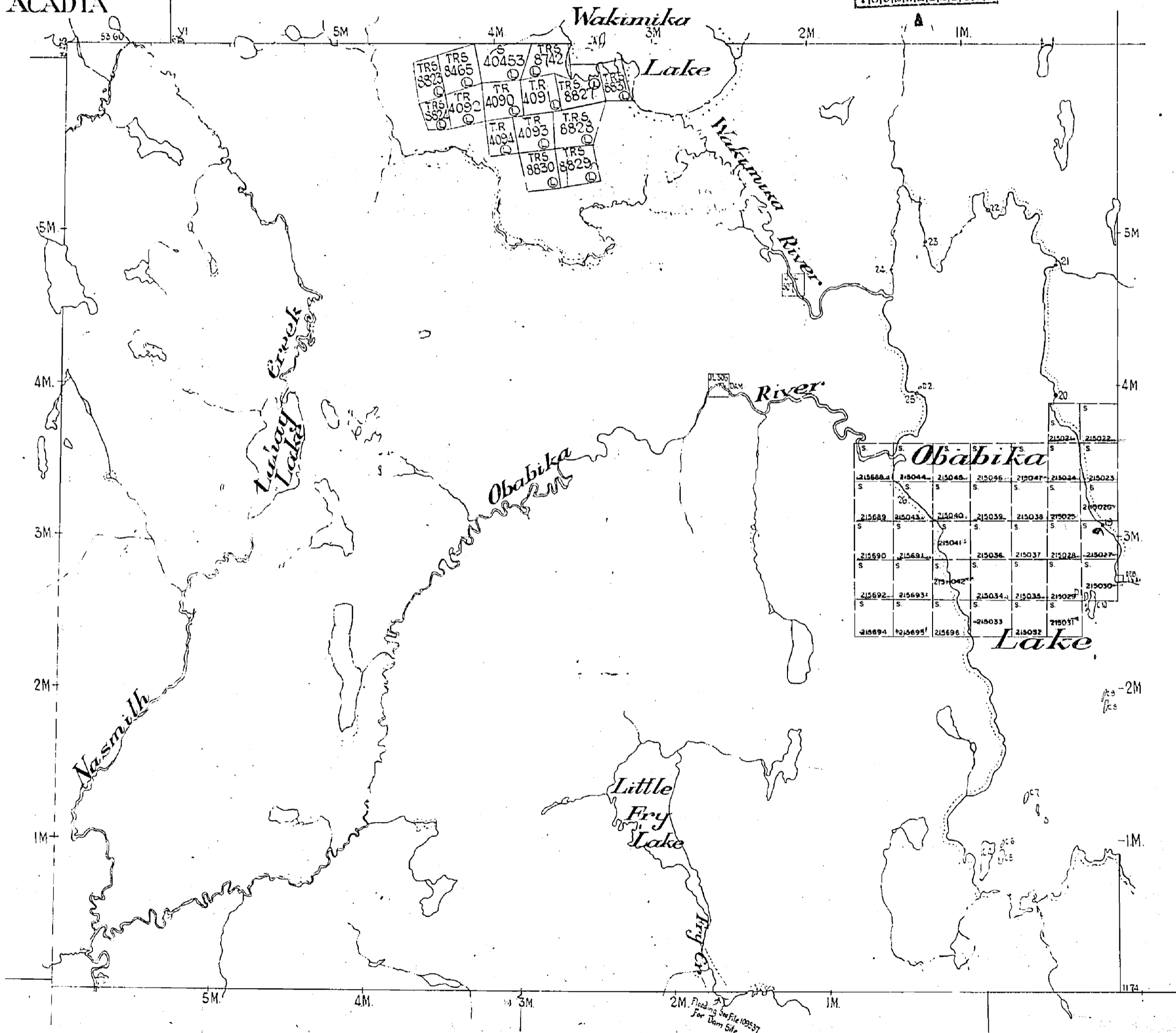

ARMAGH

BELFAST

OFFICE USE ONLY

DELHI

# DELHI

ONTARIO  
MINISTRY OF NATURAL RESOURCES  
SURVEYS AND MAPPING BRANCH

M. 754

## TIMAGAMI PROVINCIAL FOREST

### SUDBURY MINING DIVISION

#### DISTRICT OF SUDBURY

SCALE:- 40 CHAINS=1 INCH

**NOTE**

400' Surface Rights Reservation  
around all Lakes and Rivers.

Township closed to staking effective May 8/78,  
Section 38(f) of the Mining Act.

### SHELBURNE

ACADIA

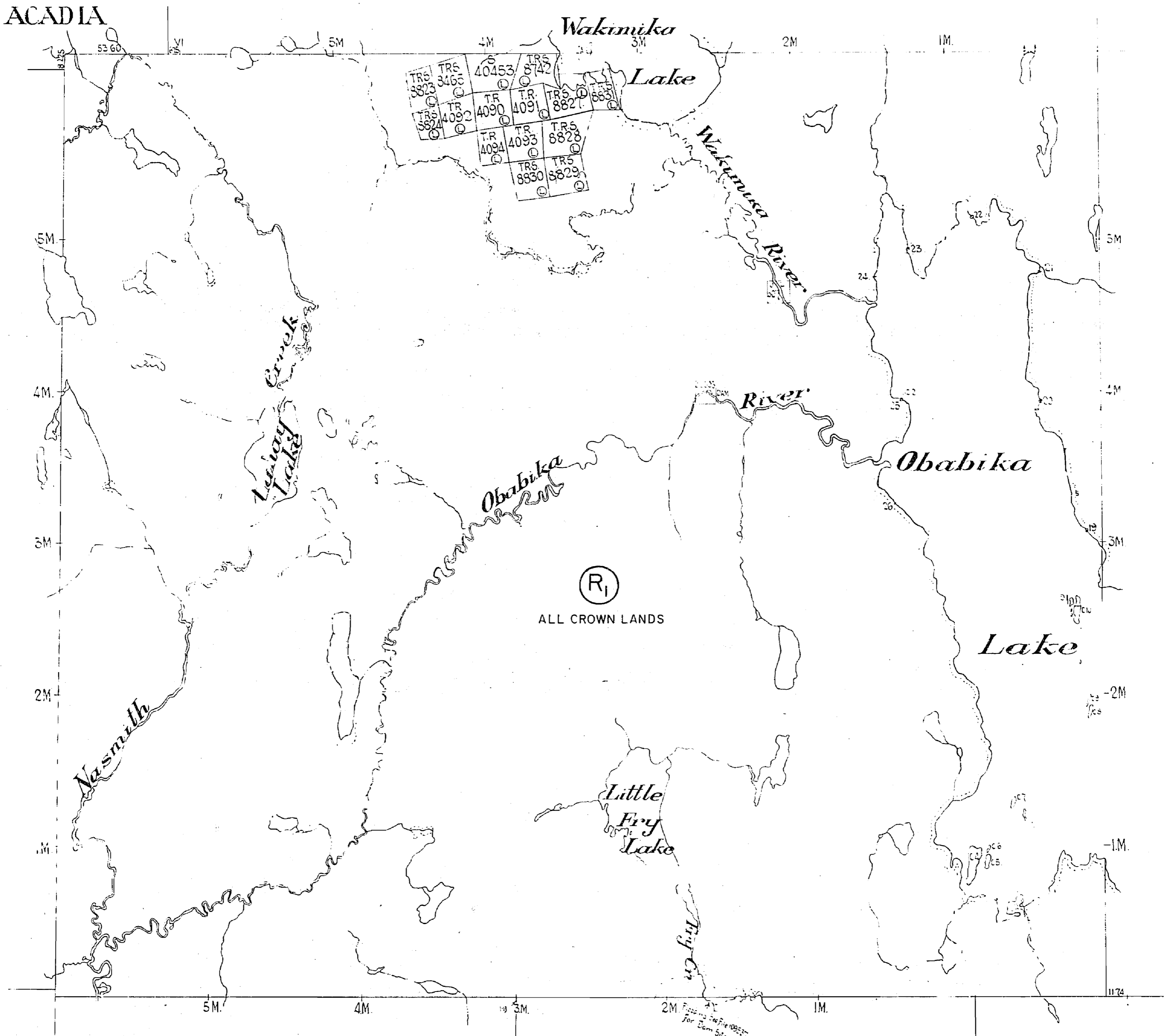

**AREAS WITHDRAWN FROM DISPOSITION**

- M.R.O. - MINING RIGHTS ONLY
- S.R.O. - SURFACE RIGHTS ONLY
- M.+S. - MINING AND SURFACE RIGHTS

Description	Order No.	Date	Disposition	File
Sec. 36/80	W.2/84	16/3/84	M. & S.	188540

ARMAGH

BELFAST

DELHI



**INDEX TO LAND DISPOSITION**

PLAN  
G-3423  
TOWNSHIP  
**DELHI**

M.N.R. ADMINISTRATIVE DISTRICT  
**TEMAGAMI**  
MINING DIVISION  
SUBDIVISION  
LAND TITLES/REGISTRY DIVISION  
SUDBURY

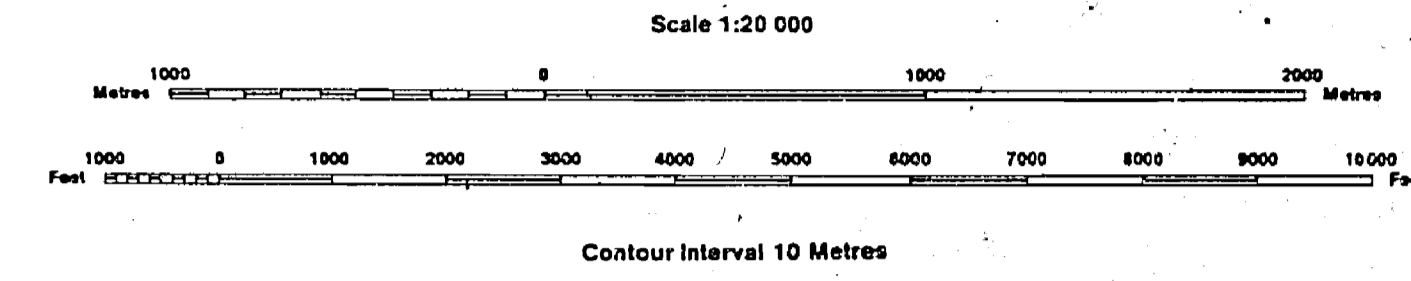

**AREAS WITHDRAWN FROM DISPOSITION**

Description	Order No.	Date	Disposition	File
SEC. 36/90	W.2/84	16/03/84	M + S	185540
OBABIKA RIVER PROVINCIAL PARK				ONTARIO REGULATION NO. 256/88 MAY 8, 1989 SCHEDULE NO. 225

**SYMBOLS**

- Boundary
- Township, Meridian, Baseline
- Road allowance; surveyed
- shoreline
- Lot/Concession; surveyed
- unsurveyed
- Parcel; surveyed
- unsurveyed
- Right-of-way; road
- railway
- utility
- Reservation
- Cliff, Pit, Pile
- Contour
- Interpolated
- Approximate
- Depression
- Control point (horizontal)
- Flooded land
- Mine head frame
- Pipeline (above ground)
- Railway; single track
- double track
- abandoned
- Road; highway, county, township
- access
- trail, bush
- Shoreline (original)
- Transmission line
- Wooded area

DATE OF ISSUE  
JAN 13 1984  
SUDBURY  
LANDING RECORDERS OFFICE

THE INFORMATION THAT APPEARS ON THIS MAP HAS BEEN COMPILED FROM VARIOUS SOURCES, AND ACCURACY IS NOT GUARANTEED. THOSE WISHING TO STAKE MINING CLAIMS SHOULD CONSULT WITH THE MINING RECORDER, MINISTRY OF NORTHERN DEVELOPMENT AND MINES, FOR ADDITIONAL INFORMATION ON THE STATUS OF THE LANDS SHOWN HEREON.

ANY MINING CLAIMS STAKED WITHIN THIS AREA, MAY HAVE SPECIAL OPERATING CONDITIONS APPLIED TO THE WORK PERMIT /JCM 1991/08 09.

**DISPOSITION OF CROWN LANDS**

- Patent
- Surface & Mining Rights
- Surface Rights Only
- Mining Rights Only
- Lease
- Surface & Mining Rights
- Surface Rights Only
- Mining Rights Only
- Licence of Occupation
- Order-in-Council
- Cancelled
- Reservation
- Sand & Gravel

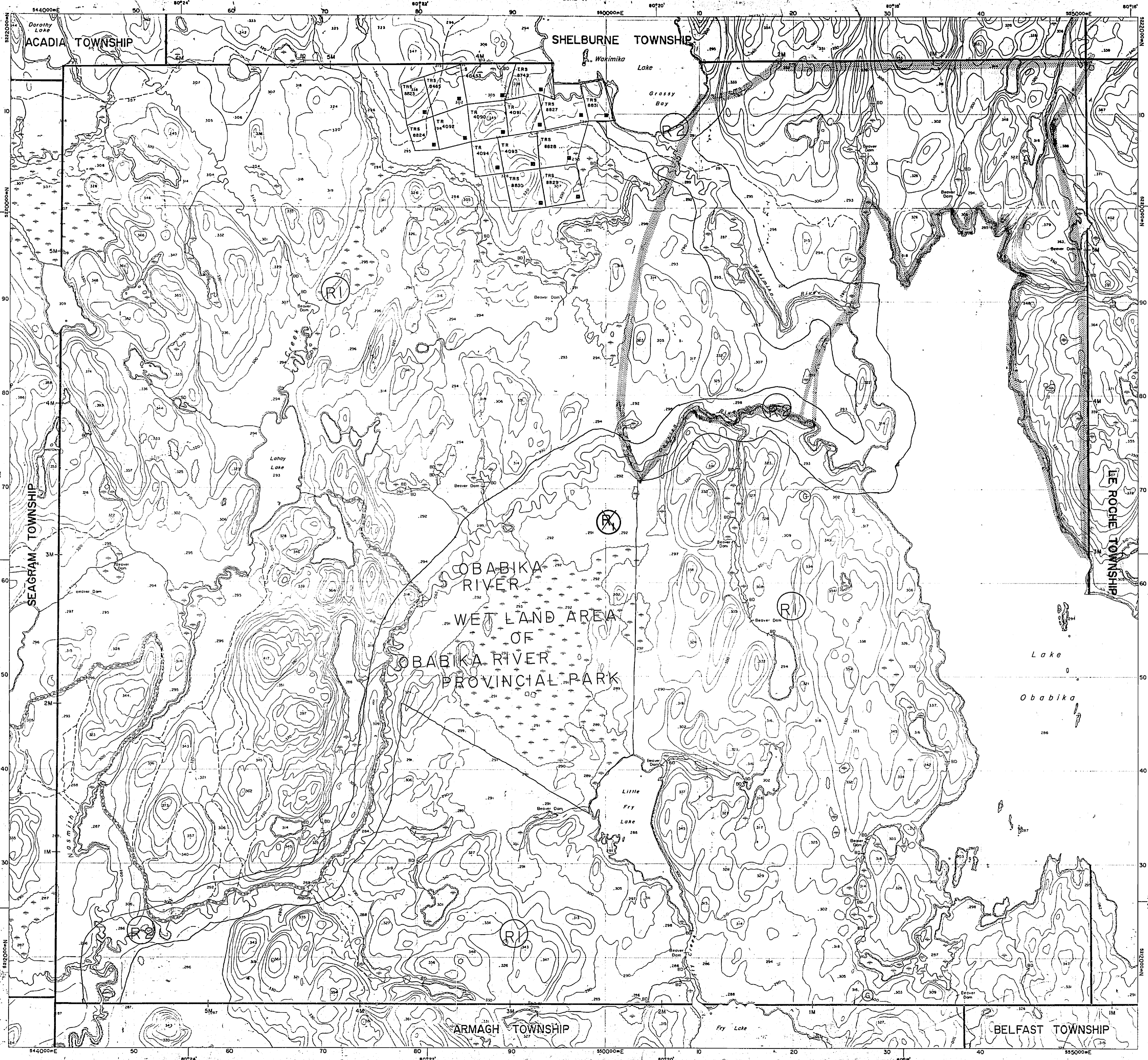



**INDEX TO LAND DISPOSITION**

PLAN  
**G-3423**

TOWNSHIP  
**DELHI**

M.N.D. ADMINISTRATIVE DISTRICT  
**TEMAGAMI**  
 MINING DIVISION  
**SUDBURY**  
 LAND TITLES/REGISTRY DIVISION  
**SUDBURY**

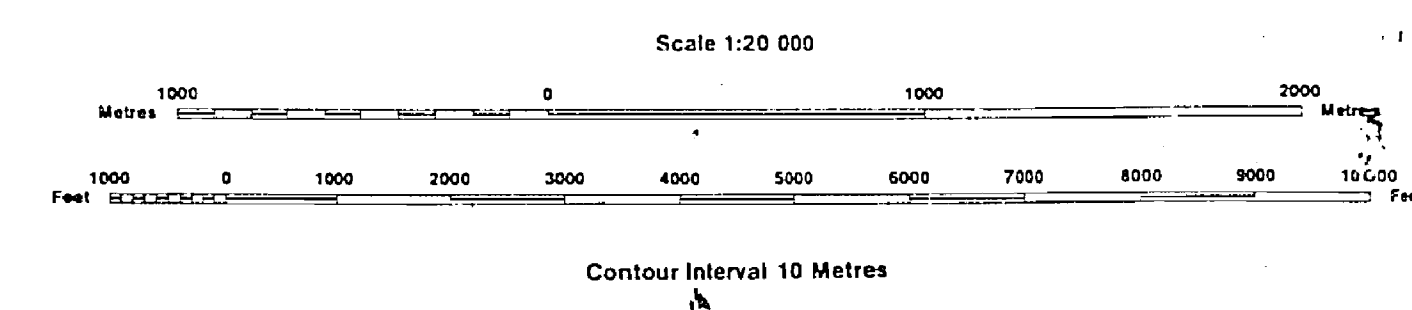

**AREAS WITHDRAWN FROM DISPOSITION**

MRO - Mining Rights Only  
 SRO - Surface Rights Only  
 M + S - Mining and Surface Rights

Description	Order No.	Date	Disposition	File
SEC. 36/60	W.2/84	16/03/84	M + S	188340
OBABIKA RIVER PROVINCIAL PARK				ONTARIO REGULATION NO. 256/85 MAY 6, 1989 SCHEDULE NO. 225

- SYMBOLS**
- Boundary
  - Township, Meridian, Baseline
  - Road allowance; surveyed
  - shoreline
  - Lot/Concession; surveyed
  - unsurveyed
  - Parcel; surveyed
  - unsurveyed
  - Right-of-way; road
  - railway
  - utility
  - Reservation
  - Cliff, Pit, Pile
  - Contour
  - Interpolated
  - Approximate
  - Depression
  - Control point (horizontal)
  - Flooded land
  - Mine head frame
  - Pipeline (above ground)
  - Railway; single track
  - double track
  - abandoned
  - Road; highway, county, township
  - access
  - trail, bush
  - Shoreline (original)
  - Transmission line
  - Wooded area

THE INFORMATION THAT APPEARS ON THIS MAP HAS BEEN COMPILED FROM VARIOUS SOURCES, AND ACCURACY IS NOT GUARANTEED. THOSE WISHING TO STAKE MINING CLAIMS SHOULD CONSULT WITH THE MINING RECORDER, MINISTRY OF NORTHERN DEVELOPMENT AND MINES, FOR ADDITIONAL INFORMATION ON THE STATUS OF THE LANDS SHOWN HEREON.

**NOTES**

AREA DEEMED IN NEED OF PROTECTION BY THE CROWN AND WILL REMAIN WITHDRAWN INDEFINITELY.

**DISPOSITION OF CROWN LANDS**

- |                         |                      |
|-------------------------|----------------------|
| Patent                  |                      |
| Surface & Mining Rights | ○                    |
| Surface Rights Only     | ○                    |
| Mining Rights Only      | ○                    |
| Lease                   |                      |
| Surface & Mining Rights | ■                    |
| Surface Rights Only     | ■                    |
| Mining Rights Only      | ■                    |
| Licence of Occupation   | DATE OF ISSUE        |
| Order-in-Council        | OC                   |
| Cancelled               | DATE OF CANCELLATION |
| Reservation             | SUBJECT TO           |
| Sand & Gravel           | DATE OF ISSUE        |

DATE OF ISSUE  
 JUN 27 1988  
 SUDBURY  
 MINING RECORDS DIVISION

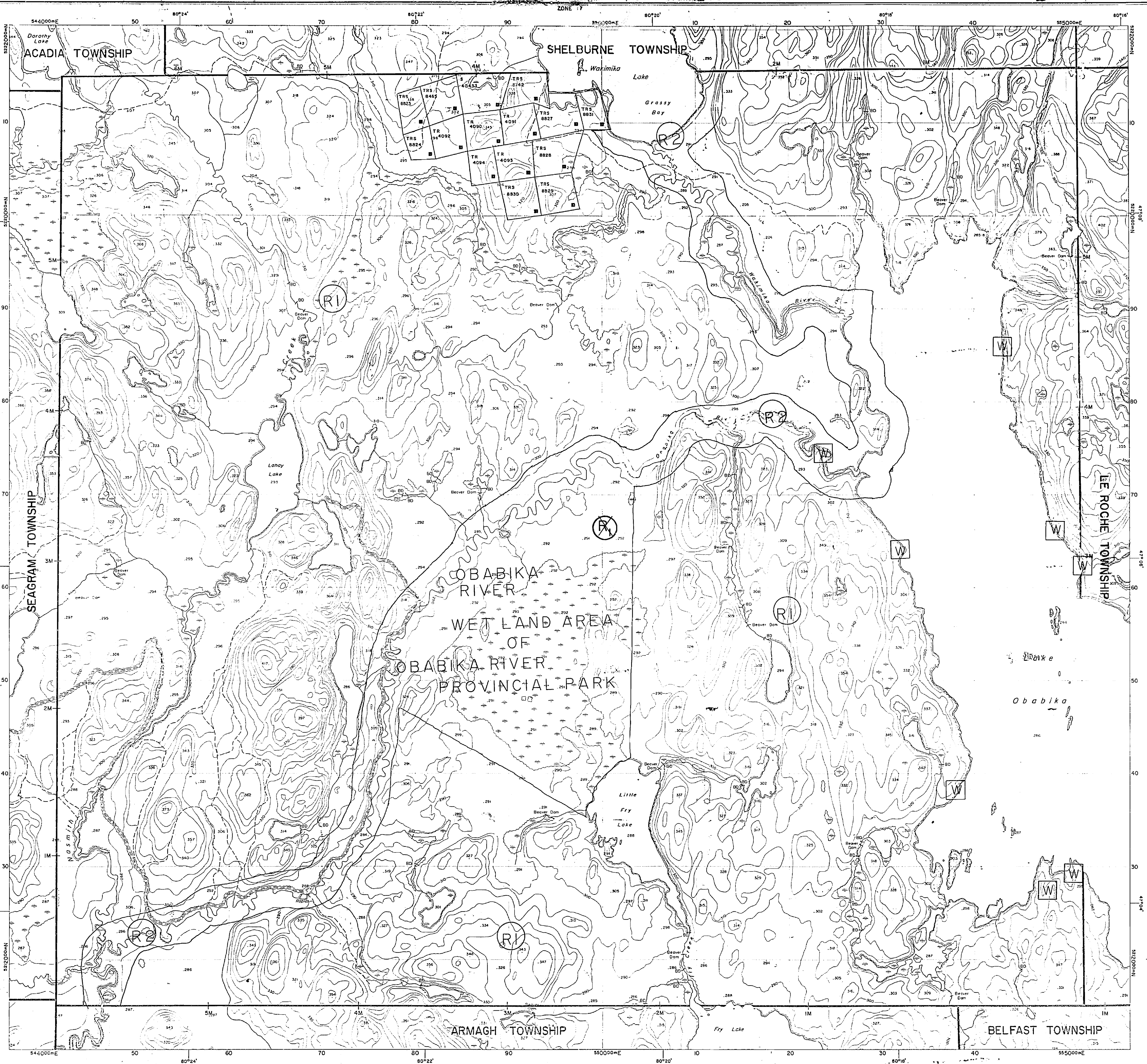



**INDEX TO LAND DISPOSITION**

PLAN  
**G-3423**  
 TOWNSHIP  
**DELHI**

M.N.R. ADMINISTRATIVE DISTRICT  
**TEMAGAMI**  
 MINING DIVISION  
**SUBBURY**  
 LAND TITLES/REGISTRY DIVISION  
**SUBBURY**

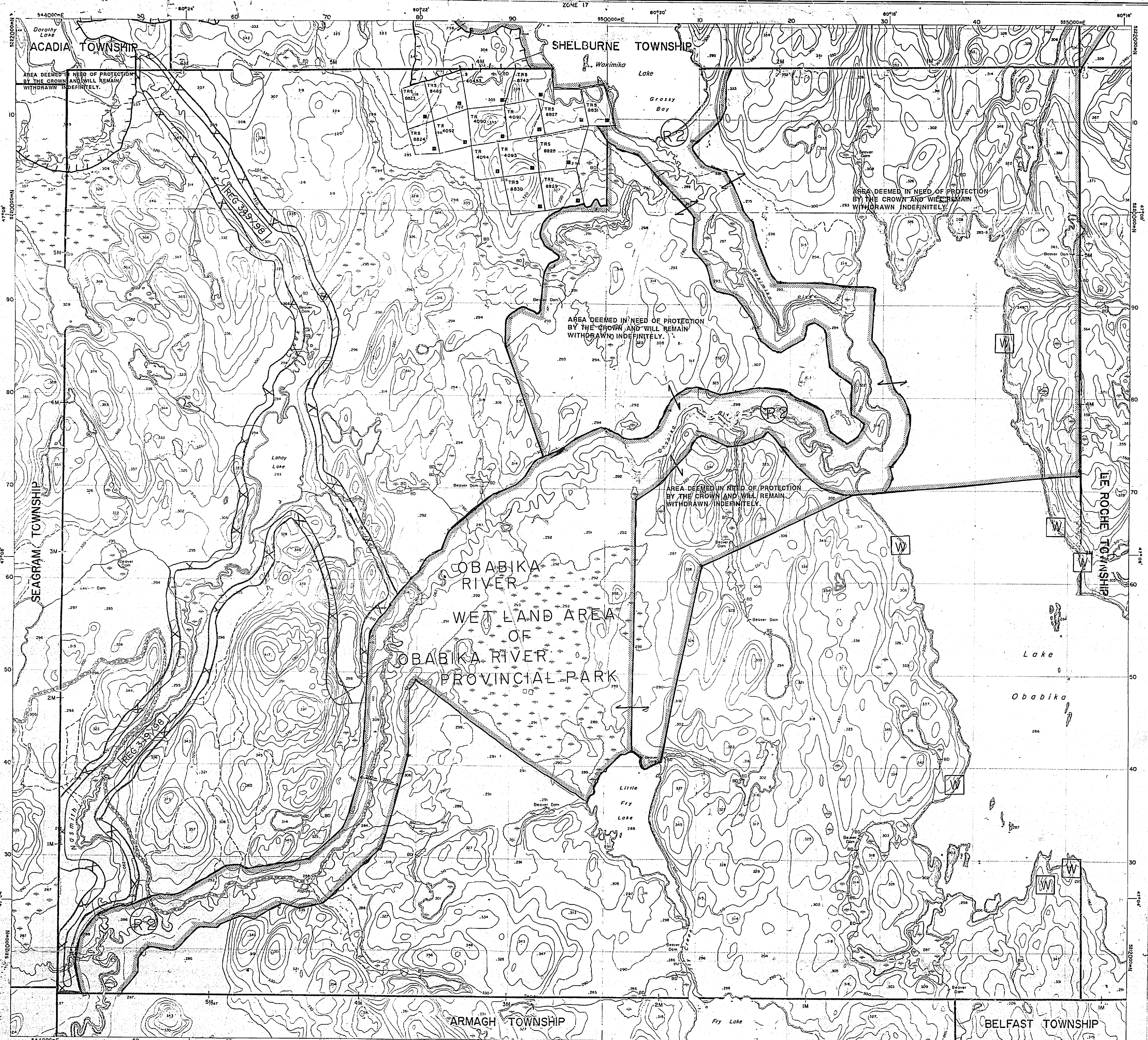
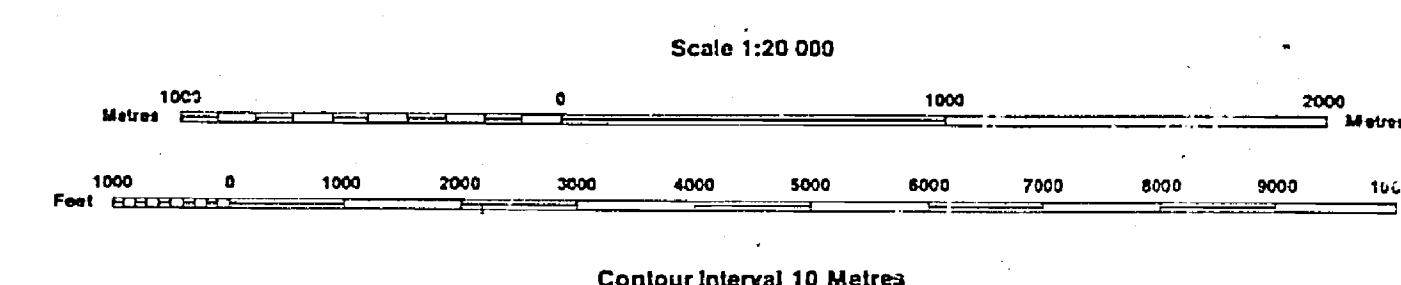

**AREAS WITHDRAWN FROM DISPOSITION**

MRO - Mining Rights Only  
 SRO - Surface Rights Only  
 M + S - Mining and Surface Rights

Description	Order No.	Date	Disposition	File No.
SEC.35/90	W-3-70/96	03/15/96	M & S	19510
OBABIKA RIVER PROVINCIAL PARK	ONTARIO REGULATION NO.225			
SEC.35/90	W-3-70/96	03/15/96	M & S	19510
SEC.35/90	W-3-70/96	03/15/96	M & S	19510
SEC.35/90	W-3-70/96	03/15/96	M & S	19510

**SYMBOLS**

- Boundary
- Road allowance; surveyed
- shoreline
- Lot/Concession; surveyed
- unsurveyed
- Parcel; surveyed
- unsurveyed
- Right-of-way; road
- railway
- utility
- Reservation
- Cliff, Pit, Pile
- Contour
- Interpolated
- Approximate
- Depression
- Control point (horizontal)
- Flooded land
- Mine head frame
- Pipeline (above ground)
- Railway; single track
- double track
- abandoned
- Road; highway, county, township
- access
- trail, bush
- Shoreline (original)
- Transmission line
- Wooded area

OBABIKA RIVER PROVINCIAL PARK  
 ONTARIO REGULATION NO.225  
 SCHEDULE NO.225  
 NOTE - THE LIMITS OF THE PARK ARE POSITION 200 METERS IN PERPENDICULAR DISTANCE FROM THE HIGH WATER MARK UNLESS OTHERWISE STATED ON THE SCHEDULE.

**NOTES**

- W AREA DEEMED IN NEED OF PROTECTION BY THE CROWN AND WILL REMAIN WITHDRAWN INDEFINITELY.
- R AREA DEEMED IN NEED OF PROTECTION BY THE CROWN AND WILL REMAIN WITHDRAWN INDEFINITELY.

**DISPOSITION OF CROWN LANDS**

- Patent
- Surface & Mining Rights
- Surface Rights Only
- Mining Rights Only
- Lease
- Surface & Mining Rights
- Surface Rights Only
- Mining Rights Only
- Licence of Occupation
- Order-in-Council
- Cancelled
- Reservation
- Sand & Gravel

REG 349/98

**NOTICE**  
 WORK PERMITS FOR MINERAL EXPLORATION ACTIVITY  
 EFFECTIVE September 15<sup>th</sup> 1998  
 The area outlined as XX on this map will be subject to Ontario Regulation 349/98 made under the Public Lands Act. Depending on the type and timing of your exploration work you may require a Work Permit. For further information please contact Gerhard Meyer, Regional Resident Geologist at (705) 557-5242 or Jim Inelund, Regional Manager at (705) 235-1612.

THIS TOWNSHIP FALLS WITHIN THE TEMAGAMI COMPREHENSIVE PLANNING AREA. SPECIAL WORKING CONDITIONS MAY APPLY TO EXPLORATION ACTIVITIES. FOR MORE DETAILS PLEASE CONTACT:  
 DISTRICT MANAGER,  
 NORTH BAY DISTRICT,  
 MINISTRY, NATURAL RESOURCES



**INDEX TO LAND DISPOSITION**

PLAN  
**G-3423**

TOWNSHIP  
**DELHI**

M.N.R. ADMINISTRATIVE DISTRICT  
**TEMAGAMI**

MINING DIVISION  
**SUBBURY**

LAND TITLES/REGISTRY DIVISION  
**SUBBURY**

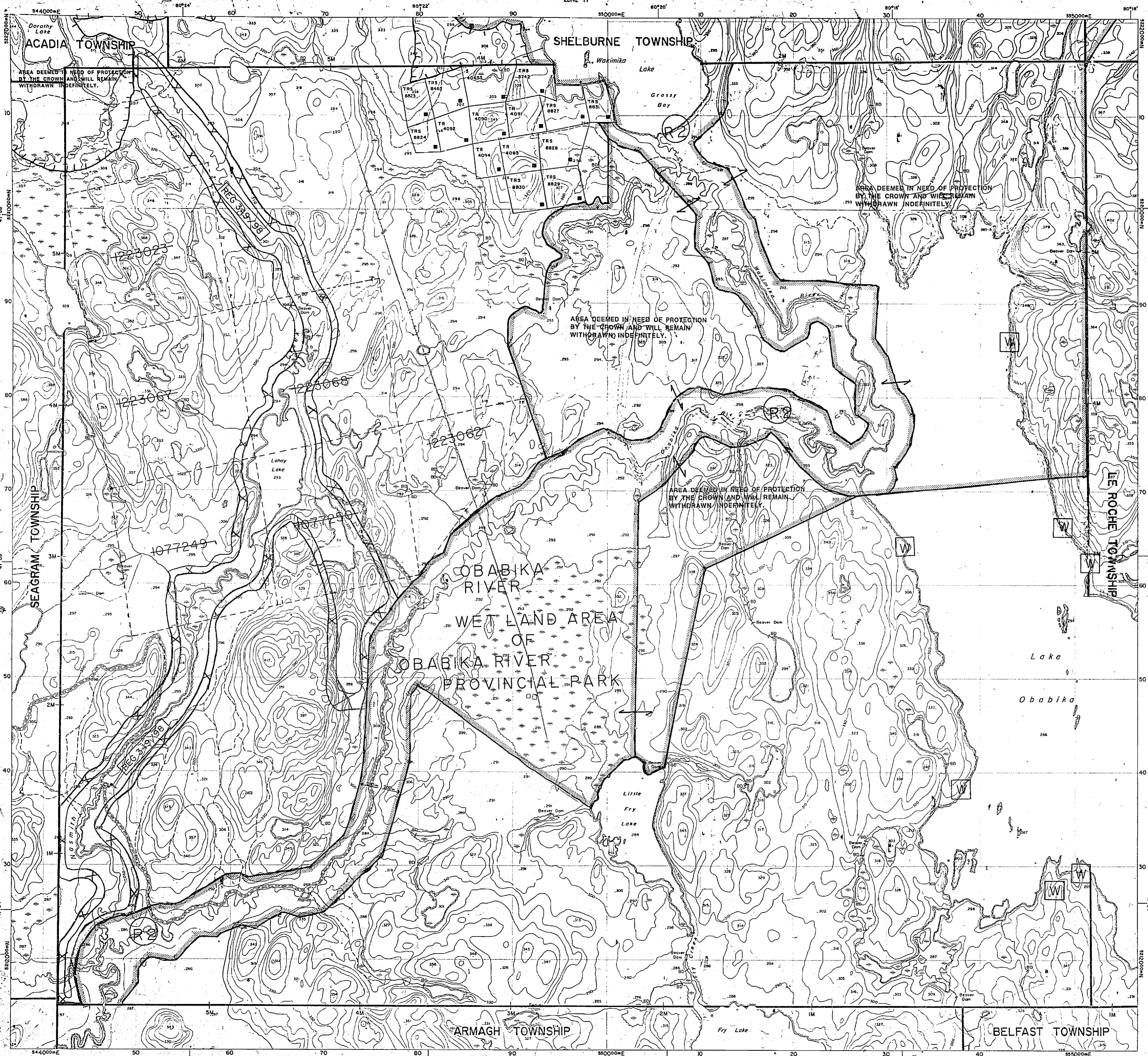
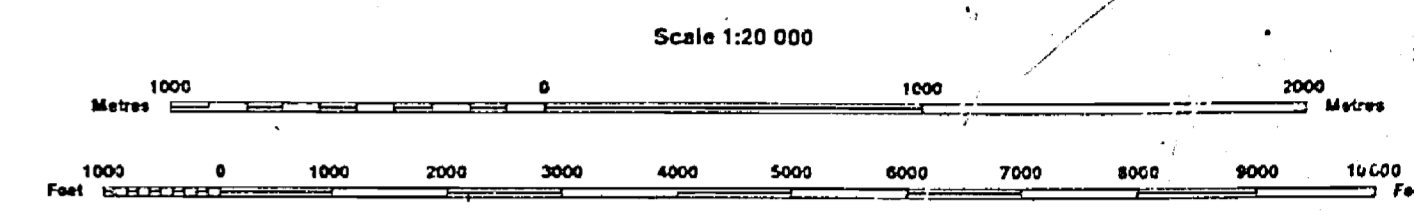

**AREAS WITHDRAWN FROM DISPOSITION**

MRO - Mining Rights Only  
 SRO - Surface Rights Only  
 M+S - Mining and Surface Rights

Description	Disposition	Date	Disposition	File
SEC.35/90 SEC.36/90	W-2-70/96	09/15/96	M & S	195150
SEC.35/90	W-3-70/96	09/15/96	M & S	195150
SEC.35/90	W-3-30/96	09/15/96	M & S	195150
SEC.35/90	W-3-63/96	09/15/96	M & S	195150
SEC.35/90	W-3-36/96	09/15/96	M & S	195150

**SYMBOLS**

- Boundary
- Township, Meridian, Baseline
- Road allowance; surveyed
- shoreline
- Lot/Concession; surveyed
- unsurveyed
- Parcel; surveyed
- unsurveyed
- Right-of-way; road
- railway
- utility
- Reservation
- Cliff, Pit, Pile
- Contour
- Interpolated
- Approximate
- Depression
- Control point (horizontal)
- Flooded land
- Mine head frame
- Pipeline (above ground)
- Railway; single track
- double track
- abandoned
- Road; highway, county, township
- access
- trail, bush
- Shoreline (original)
- Transmission line
- Wooded area

THE INFORMATION THAT APPEARS ON THIS MAP HAS BEEN COMPILED FROM VARIOUS SOURCES, AND ACCURACY IS NOT GUARANTEED. THOSE WISHING TO STAKE MINING CLAIMS SHOULD CONSULT WITH THE MINING RECORDER, MINISTRY OF NORTHERN DEVELOPMENT AND MINES, FOR ADDITIONAL INFORMATION ON THE STATUS OF THE LANDS SHOWN HEREON.

OBABIKA RIVER PROVINCIAL PARK  
 ONTARIO REGULATION NO.256/89 SCHEDULE NO.225  
 NOTE - THE LIMITS OF THE PARK ARE POSITION 200 METERS IN PERPENDICULAR DISTANCE FROM THE HIGH WATER MARK UNLESS OTHERWISE STATED ON THE SCHEDULE.

**NOTES**

- W AREA DEEMED IN NEED OF PROTECTION BY THE CROWN AND WILL REMAIN WITHDRAWN INDEFINITELY.
- W AREA DEEMED IN NEED OF PROTECTION BY THE CROWN AND WILL REMAIN WITHDRAWN INDEFINITELY.

**DISPOSITION OF CROWN LANDS**

- Patent
- Surface & Mining Rights
- Surface Rights Only
- Mining Rights Only
- Lease
- Surface & Mining Rights
- Surface Rights Only
- Mining Rights Only
- Licence of Occupation
- Order-in-Council
- Cancelled
- Reservation
- Sand & Gravel

**DATE OF ISSUE**  
 OCT 22 1998  
 PROVINCIAL RECORDING OFFICE - SUBBURY

REG 349/98

**NOTICE**  
 WORK PERMITS FOR MINERAL EXPLORATION ACTIVITY  
 EFFECTIVE September 15<sup>th</sup> 1998  
 The area outlined as 'X' on this map will be subject to Ontario Regulation 349/98 made under the Public Lands Act. Depending on the type and timing of your exploration work you may require a Work Permit. For further information please contact Gerhard Meyer, Regional Resident Geologist at (705) 567-5243 or Jim Ireland, Regional Manager at (705) 235-1612



754

# DELHI

TIMAGAMI PROVINCIAL FOREST

SUDBURY MINING DIVISION

DISTRICT OF SUDBURY

SCALE: - 40 CHAINS - 1 INCH

## SHELBURNE

*TEM. Res.*

North Ast

SEAGRAM

LE ROCHE

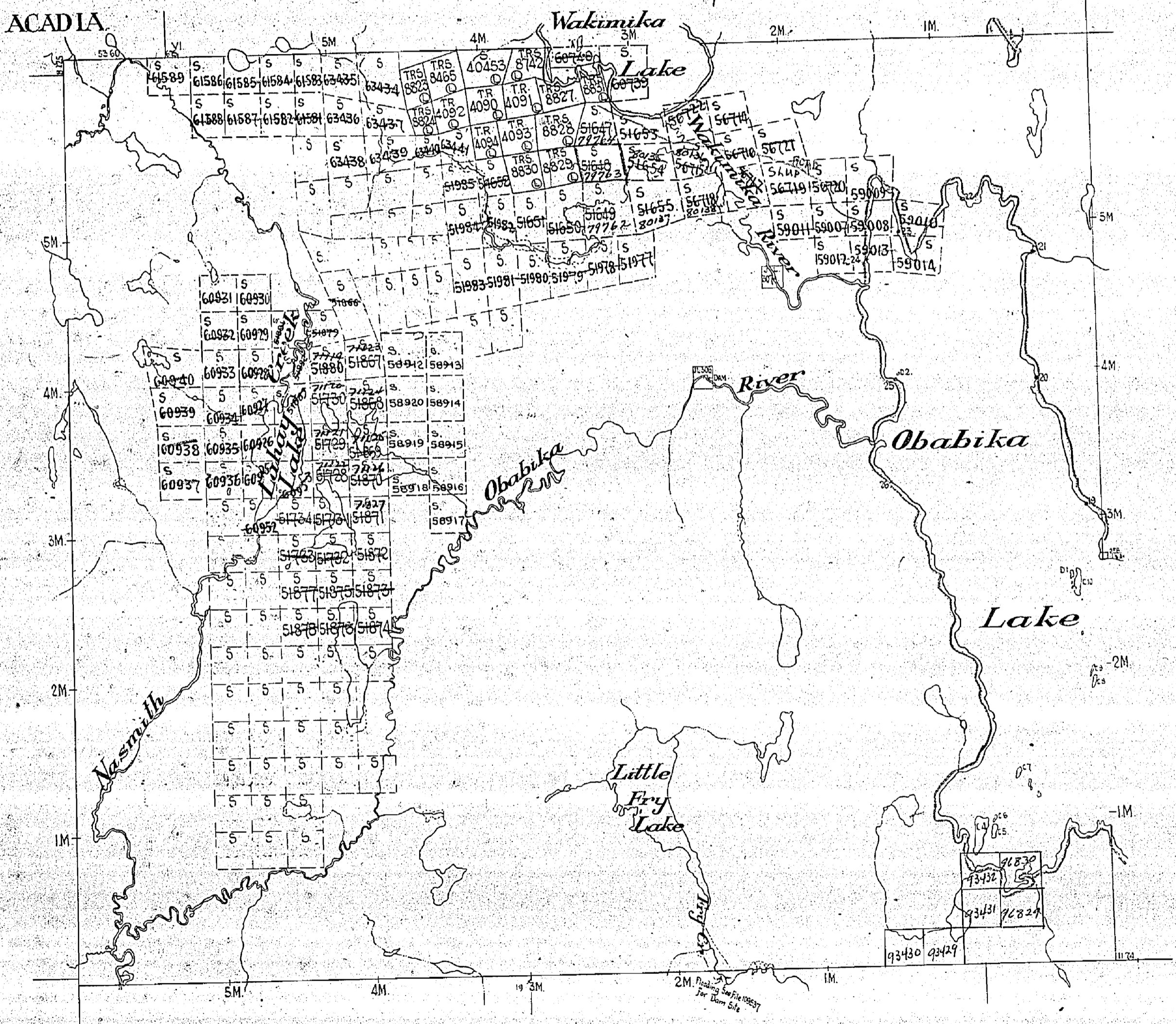

ARMAGH

BELFAST  
**M 754**

DELHI  
Top



In Service: March 31, 1988

**INDEX TO LAND DISPOSITION**

PLAN  
 G-3423  
 TOWNSHIP  
**DELHI**

M.N.D. ADMINISTRATIVE DISTRICT  
**TEMAGAMI**  
 MINING DIVISION  
**SUDBURY**  
 LAND TITLES/REGISTRY DIVISION  
**SUDBURY**

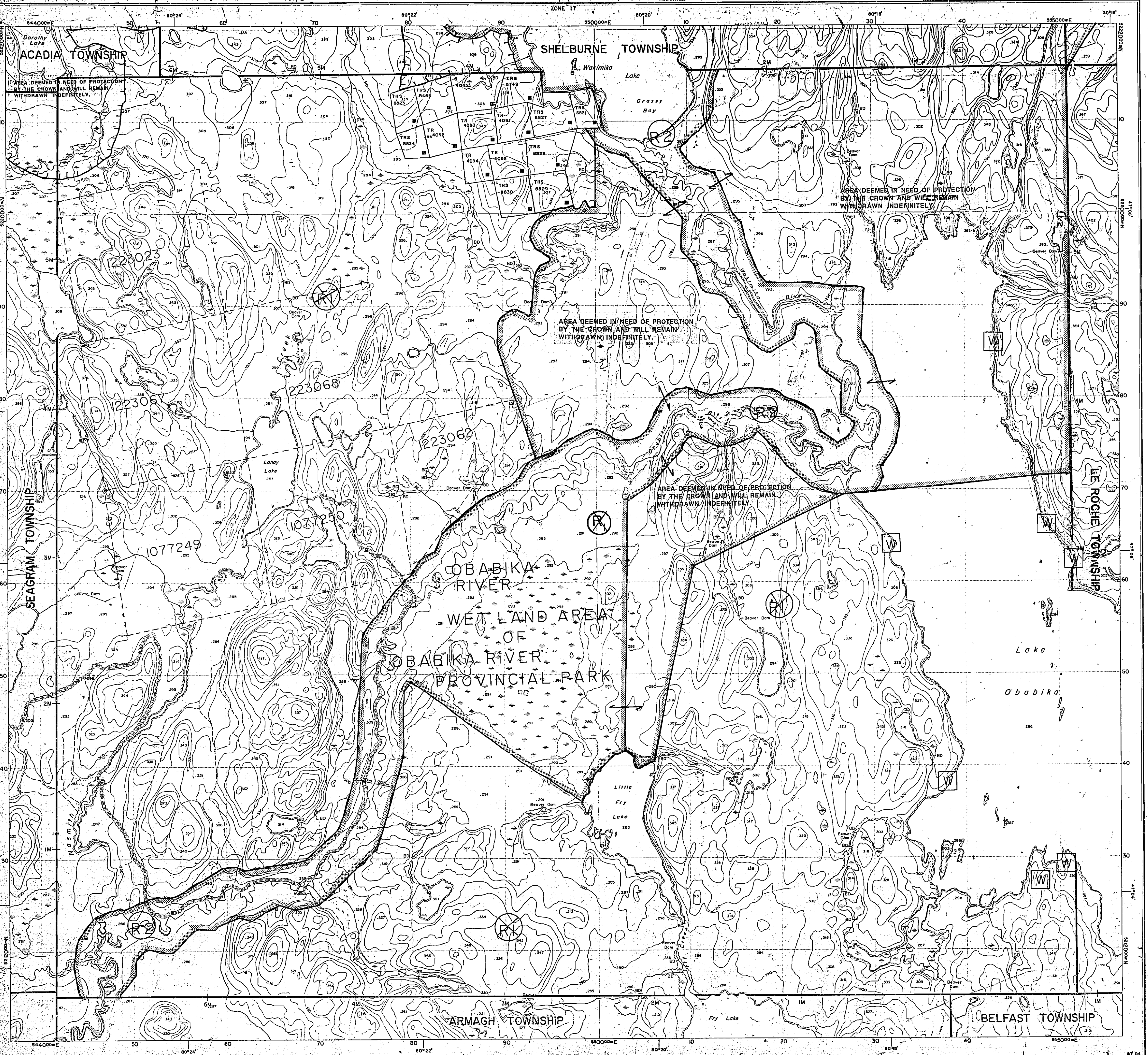
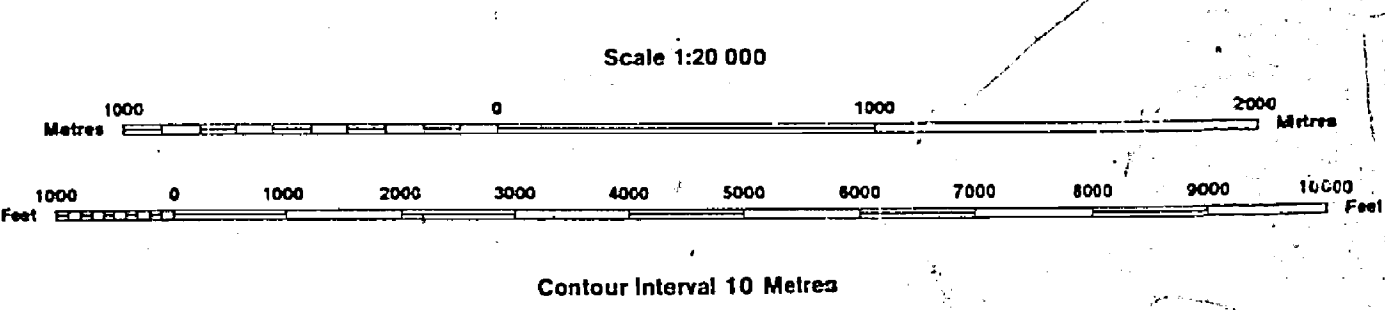

**AREAS WITHDRAWN FROM DISPOSITION**

MRO - Mining Rights Only  
 SRO - Surface Rights Only  
 M + S - Mining and Surface Rights

Description	Original Date	Date	Disposition	File
SEC.35/90	03/25/79	09/05/86	M 8 3	19510
SEC.35/90	03/25/79	16/03/84	M 8 3	19510
SEC.35/90	W-3-78/86	03/15/86	M 8 3	19510
SEC.35/90	W-3-70/86	09/13/86	MAY 8, 1989	SCHEDULE NO. 25
SEC.35/90	W-3-20/86	09/18/86	M 8 3	19510
SEC.35/90	W-3-63/86	09/13/86	M 8 3	19510
SEC.35/90	W-3-36/86	09/18/86	M 8 3	19510

**SYMBOLS**

Boundary	Township, Meridian, Baseline	—
Road allowance; surveyed	shoreline	—
Lot/Concession; surveyed	unsurveyed	—
Parcel; surveyed	unsurveyed	—
Right-of-way; road	railway	—
	utility	—
Reservation		—
Cliff, Pit, Pile		—
Contour	Interpolated	—
Approximate	Depression	—
Control point (horizontal)		—
Flooded land		—
Mine head frame		—
Pipeline (above ground)		—
Railway; single track	double track	—
	abandoned	—
Road; highway, county, township	access	—
	trail, bush	—
Shoreline (original)		—
Transmission line		—
Wooded area		—

THE INFORMATION THAT APPEARS ON THIS MAP HAS BEEN COMPILED FROM VARIOUS SOURCES, AND ACCURACY IS NOT GUARANTEED. THOSE WISHING TO STAKE MINING CLAIMS SHOULD CONSULT WITH THE MINING RECORDER, MINISTRY OF NORTHERN DEVELOPMENT AND MINES, FOR ADDITIONAL INFORMATION ON THE STATUS OF THE LANDS SHOWN HEREON.

**DATE OF ISSUE**  
 JUN 15 1988

**PROVINCIAL RECORDING OFFICE - SUDBURY**

OBABIKA RIVER PROVINCIAL PARK  
 ONTARIO REGULATION NO. 256/89 SCHEDULE NO. 25  
 NOTE - THE LIMITS OF THE PARK ARE POSITION 200 METERS IN PERPENDICULAR DISTANCE FROM THE HIGH WATER MARK UNLESS OTHERWISE STATED ON THE SCHEDULE.

**NOTES**

W AREA DEEMED IN NEED OF PROTECTION BY THE CROWN AND WILL REMAIN WITHDRAWN INDEFINITELY.

W AREA DEEMED IN NEED OF PROTECTION BY THE CROWN AND WILL REMAIN WITHDRAWN INDEFINITELY.

**DISPOSITION OF CROWN LANDS**

Patent	
Surface & Mining Rights	●
Surface Rights Only	○
Mining Rights Only	○
Lease	
Surface & Mining Rights	■
Surface Rights Only	□
Mining Rights Only	□
Licence of Occupation	▽
Order-in-Council	○
Cancelled	○
Reservation	○
Sand & Gravel	○

THIS TOWNSHIP FALLS WITHIN THE TEMAGAMI COMPREHENSIVE PLANNING AREA. SPECIAL WORKING CONDITIONS MAY APPLY TO EXPLORATION ACTIVITIES. FOR MORE DETAILS PLEASE CONTACT:  
 DISTRICT MANAGER  
 NORTH BAY DISTRICT  
 MINISTRY, NATURAL RESOURCES



# DELHI

TIMAGAMI PROVINCIAL FOREST

SUDBURY MINING DIVISION

DISTRICT OF SUDBURY

SCALE:- 40 CHAINS = 1 INCH

## SHELBURNE

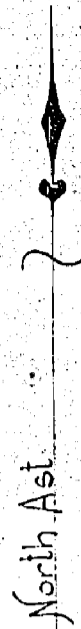

ACADIA

Wakimika

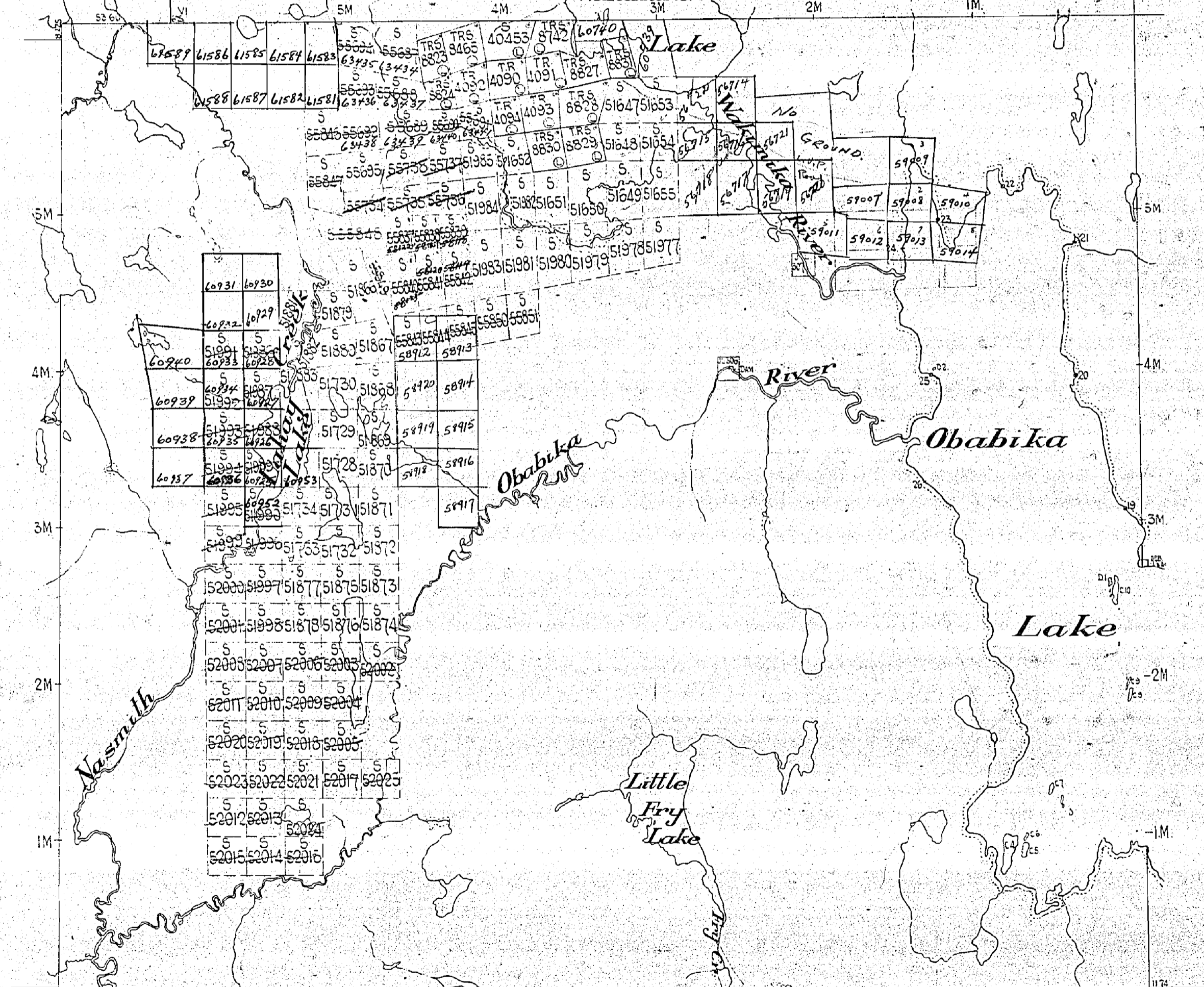

SEAGRAM

LE ROCHE

ARMAGH

BELFAST

# M754



# DELHI

TIMAGAMI PROVINCIAL FOREST

SUDBURY MINING DIVISION

DISTRICT OF SUDBURY

SCALE:- 40 CHAINS=1 INCH

SHELBURNE

North Ast

ACADIA

Wakimika

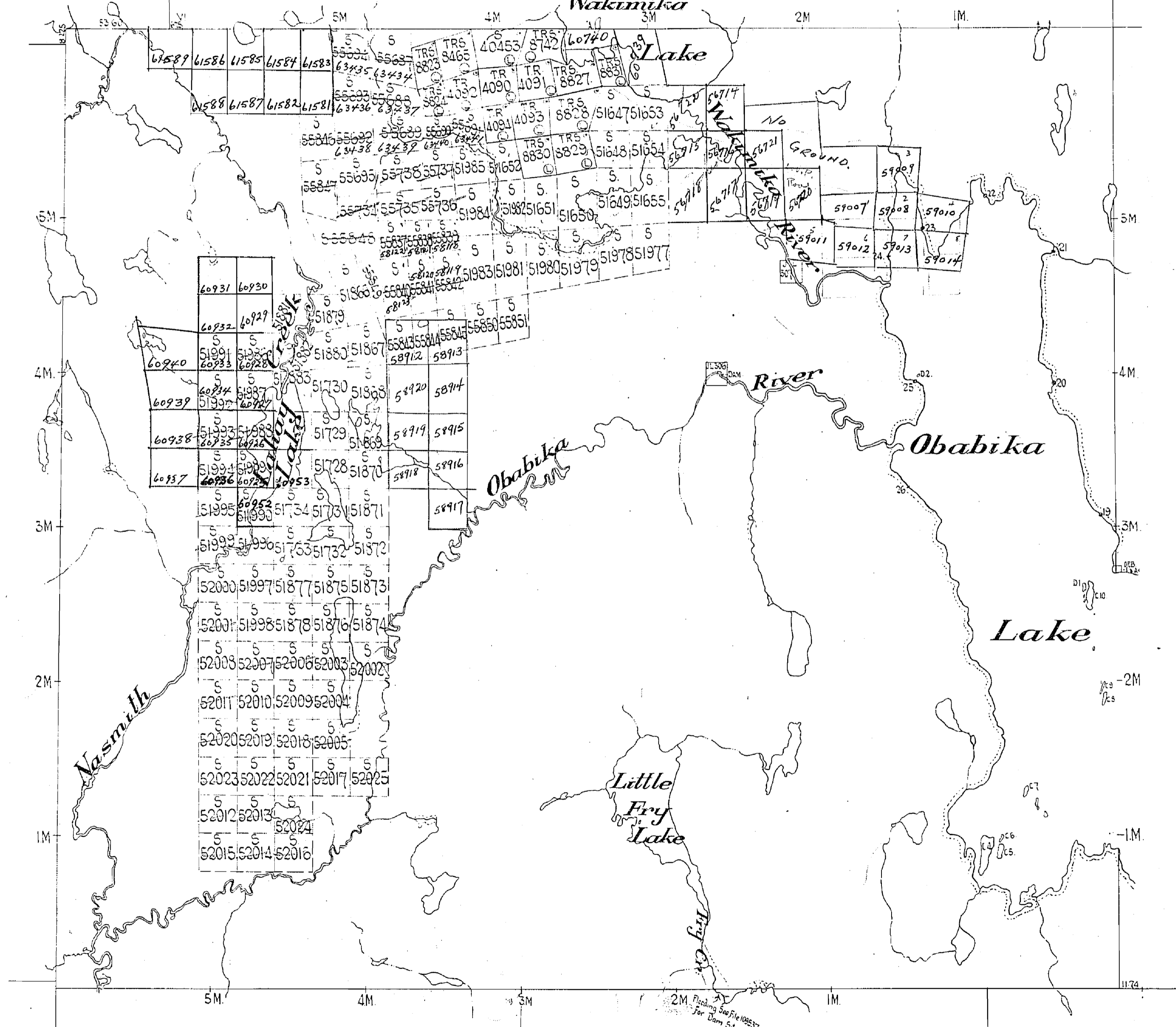

SEAGRAM

LE ROCHE

ARMAGH

BELFAST

M754



# DELHI

TIMAGAMI PROVINCIAL FOREST

SUDBURY MINING DIVISION

DISTRICT OF SUDBURY

SCALE:- 40 CHAINS = 1 INCH

*TEM. Pass.*

North Ast

## SHELBURNE

*400' R*

ACADIA

SEAGRAM

LE ROCHE

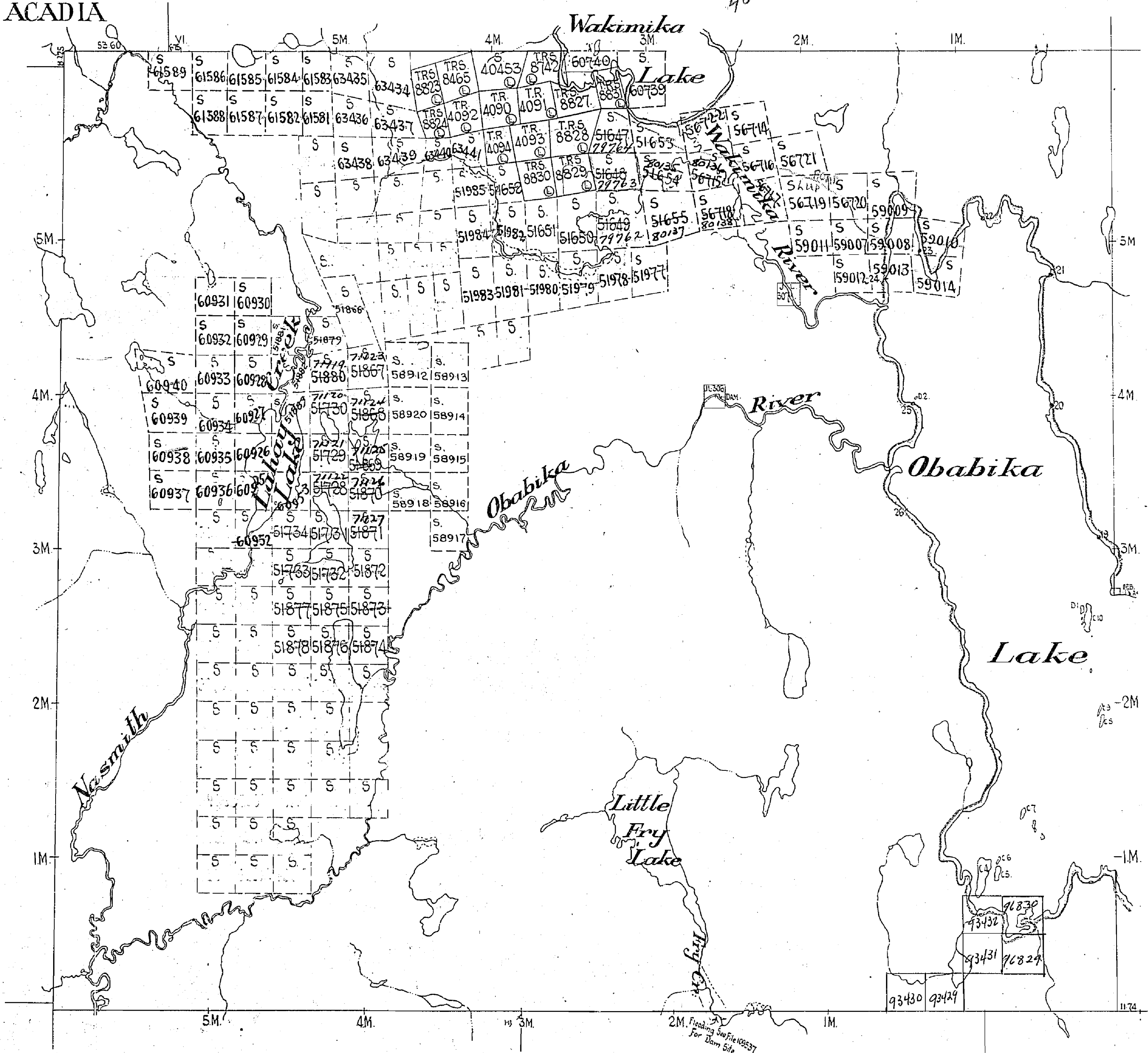

ARMAGH

BELFAST

# M 754