

MACAULAY TOWNSHIP

LEGEND

HIGHWAY AND ROUTE No.	
OTHER ROADS	
TRAILS	
SURVEYED LINES:	
TOWNSHIPS, BASE LINES, ETC.	
LOTS, MINING CLAIMS, PARCELS, ETC.	
UNSURVEYED LINES:	
LOT LINES	
PARCEL BOUNDARY	
MINING CLAIMS ETC.	
RAILWAY AND RIGHT OF WAY	
UTILITY LINES	
NON-PERENNIAL STREAM	
FLOODING OR FLOODING RIGHTS	
SUBDIVISION OR COMPOSITE PLAN	
RESERVATIONS	
ORIGINAL SHORELINE	
MARSH OR MUSKEG	
MINES	
TRAVERSE MONUMENT	

DISPOSITION OF CROWN LANDS

TYPE OF DOCUMENT	SYMBOL
PATENT, SURFACE & MINING RIGHTS	
" SURFACE RIGHTS ONLY	
" MINING RIGHTS ONLY	
LEASE, SURFACE & MINING RIGHTS	
" SURFACE RIGHTS ONLY	
" MINING RIGHTS ONLY	
LICENCE OF OCCUPATION	
ORDER-IN-COUNCIL	
RESERVATION	
CANCELLED	
SAND & GRAVEL	
ACQUIRED LAND	

SCALE: 1 INCH = 40 CHAINS

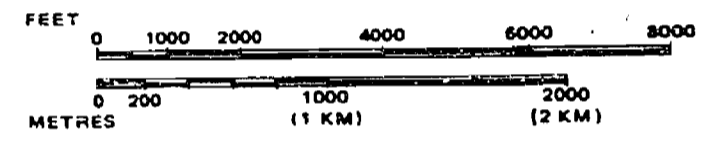

AREAS WITHDRAWN FROM DISPOSITION

- M.R.O. - MINING RIGHTS ONLY
 - S.R.O. - SURFACE RIGHTS ONLY
 - M.+S. - MINING AND SURFACE RIGHTS
- | Description | Order No. | Date | Disposition | File |
|-------------|-----------|------|-------------|------|
| | | | | |

THE INFORMATION THAT APPEARS ON THIS MAP HAS BEEN COMPILED FROM VARIOUS SOURCES, AND ACCURACY IS NOT GUARANTEED. THOSE WISHING TO STAKE MINING CLAIMS SHOULD CONSULT WITH THE MINING RECORDER, MINISTRY OF NORTHERN DEVELOPMENT AND MINES, FOR ADDITIONAL INFORMATION ON THE STATUS OF THE LANDS SHOWN HEREON.

NOTE: LOT 18 CON. III, LOT 19 CON. IV, AND PART OF LOT 19 CON. V REQUIRED FOR A.R.D.A. (NOT OPEN FOR STAKING)

TOWNSHIP
DRAPER
M.N.R. ADMINISTRATIVE DISTRICT
BRACEBRIDGE
MINING DIVISION
SOUTHERN ONTARIO
LAND TITLES / REGISTRY DIVISION
MUSKOKA

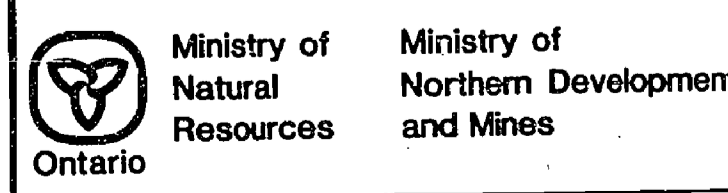

Date OCTOBER / 1988 Number G-2432



MUSKOKA TOWNSHIP

OAKLEY TOWNSHIP

RYDE TOWNSHIP

MACAULAY TOWNSHIP

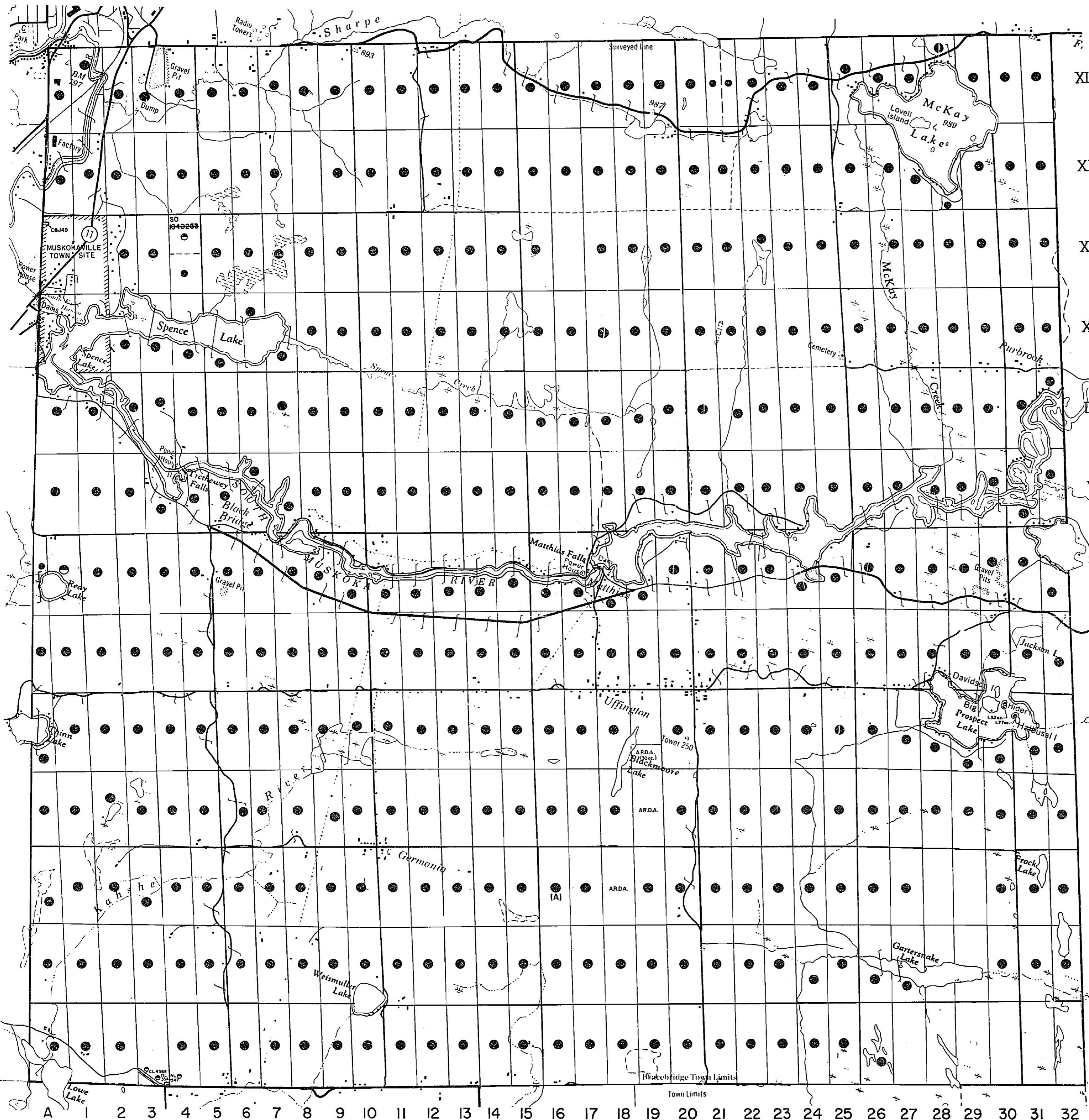

LEGEND

HIGHWAY AND ROUTE No.

 OTHER ROADS

 TRAILS

 SURVEYED LINES:

- TOWNSHIPS, BASE LINES, ETC.
- LOTS, MINING CLAIMS, PARCELS, ETC.

 UNSURVEYED LINES:

- LOT LINES
- PARCEL BOUNDARY
- MINING CLAIMS ETC.
- RAILWAY AND RIGHT OF WAY
- UTILITY LINES
- NON-PERENNIAL STREAM
- FLOODING OR FLOODING RIGHTS
- SUBDIVISION OR COMPOSITE PLAN
- RESERVATIONS
- ORIGINAL SHORELINE
- MARSH OR MUSKEG
- MINES
- TRAVERSE MONUMENT

DISPOSITION OF CROWN LANDS

TYPE OF DOCUMENT	SYMBOL
PATENT, SURFACE & MINING RIGHTS	
" SURFACE RIGHTS ONLY	
" MINING RIGHTS ONLY	
LEASE, SURFACE & MINING RIGHTS	
" SURFACE RIGHTS ONLY	
" MINING RIGHTS ONLY	
LICENCE OF OCCUPATION	
ORDER-IN-COUNCIL	
RESERVATION	
CANCELLED	
SAND & GRAVEL	
ACQUIRED LAND	

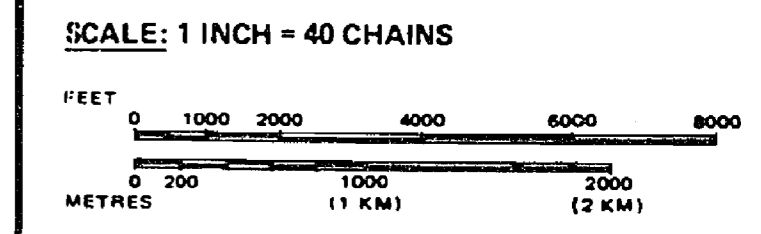

AREAS WITHDRAWN FROM DISPOSITION

M.R.O. - MINING RIGHTS ONLY
 S.R.O. - SURFACE RIGHTS ONLY
 M.+S. - MINING AND SURFACE RIGHTS

Description	Order No.	Date	Disposition	File

THE INFORMATION THAT APPEARS ON THIS MAP HAS BEEN COMPILED FROM VARIOUS SOURCES, AND ACCURACY IS NOT GUARANTEED. THOSE WISHING TO STAKE MINING CLAIMS SHOULD CONSULT WITH THE MINING RECORDER, MINISTRY OF NORTHERN DEVELOPMENT AND MINES, FOR ADDITIONAL INFORMATION ON THE STATUS OF THE LANDS SHOWN HEREON.

NOTE: LOT 18 CON. III, LOT 19 CON. IX, AND PART OF LOT 19 CON. X REQUIRED FOR AR.D.A. - (NOT OPEN FOR STAKING)

TOWNSHIP
DRAPER
 M.N.R. ADMINISTRATIVE DISTRICT
 BRACEBRIDGE
 MINING DIVISION,
 SOUTHERN ONTARIO
 LAND TITLES / REGISTRY DIVISION
 MUSKOKA

Ministry of Natural Resources
 Ministry of Northern Development and Mines

MUSKOKA TOWNSHIP

OAKLEY TOWNSHIP

RYDE TOWNSHIP