

38-57-10"

CERTIFICATE

THE SUBDIVISION AS SHOWN WITHIN THE BOUNDARIES STIPPLED HEREON OF THE TOWNSHIP OF BURPEE BY DAVID BEATTY P.L.S. AS SHOWN ON PLAN DATED 4 MAY 1887 IS HEREBY ANNULLED UNDER AUTHORITY OF SUBSECTION 1, OF SECTION 10, OF THE PUBLIC LANDS ACT, AND THIS AMENDED PLAN IS HEREBY LODGED AT THE LAND TITLES OFFICE AT PARRY SOUND, ONTARIO PURSUANT TO SUBSECTION 2 OF SAID SECTION.

TORONTO, ONTARIO.
Dec. 23rd, 1963.

F.A. MacDougall.
F.A. MACDOUGALL
DEPUTY MINISTER
LANDS AND FORESTS

EAST BURPEE

BILL 108-1967

DISTRICT OF PARRY SOUND

Scale: 40 chains to an inch

CERTIFICATE

SURVEYS PERFORMED HENCEFORTH WITHIN THE ANNULLED PORTION OF THE TOWNSHIP OF BURPEE, SHALL BE CLASSIFIED AS BEING IN UNSURVEYED TERRITORY, WHICH MEANS THAT EACH SURVEYED PARCEL MUST BE DESIGNATED BY ITS MINING CLAIM NUMBER, OR IF NOT A MINING CLAIM, THEN BY THE SURVEYOR'S OFFICIAL LETTERS AND NUMBERS. EACH SURVEY MADE IN ANY OTHER UNSURVEYED AREA, OR UNSUBDIVIDED TOWNSHIP.

TORONTO, ONTARIO
Dec. 23rd, 1963.

Robert G. Code
ROBERT G. CODE
SURVEYOR GENERAL
LANDS AND FORESTS

DATE OF ISSUE

OCT 13 1971

ONT. DEPT. OF MINES
AND NORTHERN AFFAIRS

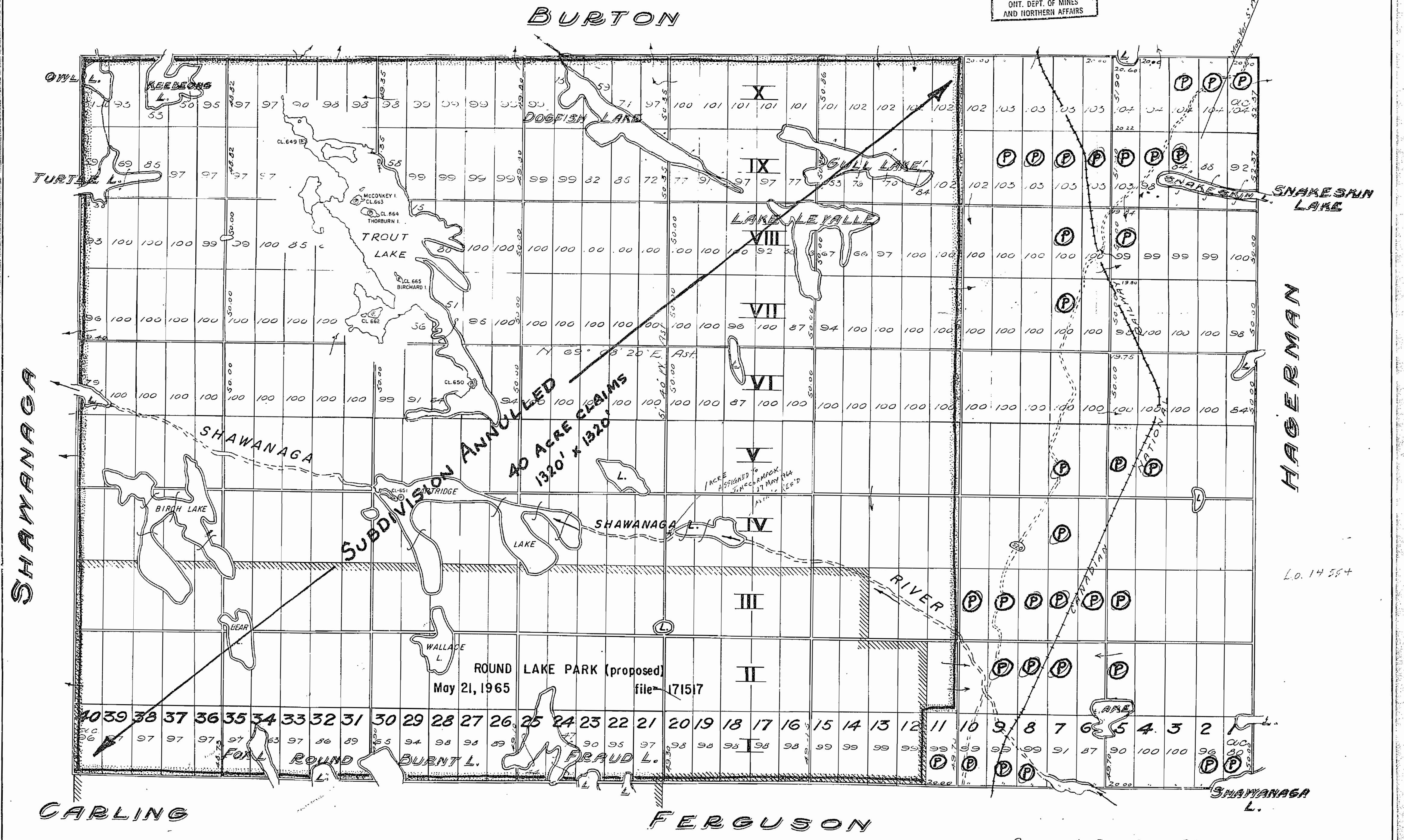
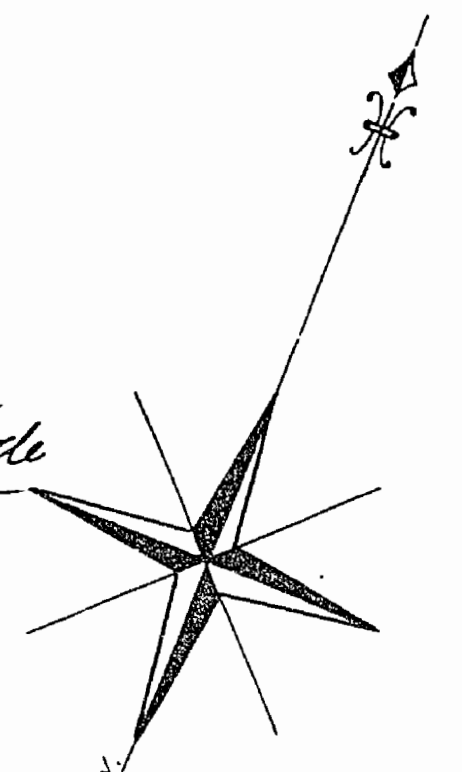

Surveyed by David Beatty, P.L.S.
Toronto May 4th, 1877.

CERTIFICATE

THE SUBDIVISION AS SHOWN WITHIN THE BOUNDARIES STIPPLED HEREON OF THE TOWNSHIP OF BURPEE BY DAVID BEATTY P.L.S. AS SHOWN ON PLAN DATED 4 MAY 1967 IS HEREBY ANNULLED, UNDER AUTHORITY OF SUBSECTION 11, OF SECTION 10, OF THE PUBLIC LANDS ACT, AND THIS AMENDED PLAN IS HEREBY LODGED AT THE LAND TITLES OFFICE AT PARRY SOUND, ONTARIO PURSUANT TO SUBSECTION 2 OF SAID SECTION.

TORONTO, ONTARIO,
Dec. 22nd, 1963.

F.A. MacDougall

F.A. MACDOUGALL
DEPUTY MINISTER
LANDS AND FORESTS

EAST BURPEE

DISTRICT OF PARRY SOUND

Scale: 40 chains to an inch

CERTIFICATE

SURVEYS PERFORMED HENCEFORTH WITHIN THE ANNULLED PORTION OF THE TOWNSHIP OF BURPEE, SHALL BE CLASSIFIED AS BEING IN UNSURVEYED TERRITORY, WHICH MEANS THAT EACH SURVEYED PARCEL MUST BE DESIGNATED BY ITS MINING CLAIM NUMBER, OR IF NOT A MINING CLAIM, THEN BY THE SURVEYOR'S OFFICIAL LETTERS AND NUMBERS. EACH SURVEY MADE MUST ADHERE TO THE FORM OF SURVEYS MADE IN ANY OTHER UNSURVEYED AREA, OR UNSUBDIVIDED TOWNSHIP.

TORONTO, ONTARIO,
Dec. 23rd, 1963.

A. Minnie

ROBERT G. CODE
SURVEYOR GENERAL
LANDS AND FORESTS

ONTARIO
MINISTRY OF NATURAL RESOURCES
SURVEYS AND MAPPING BRANCH

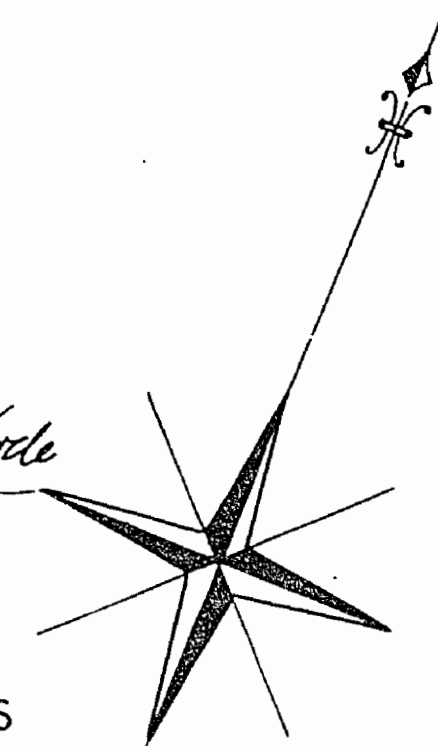

BURTON

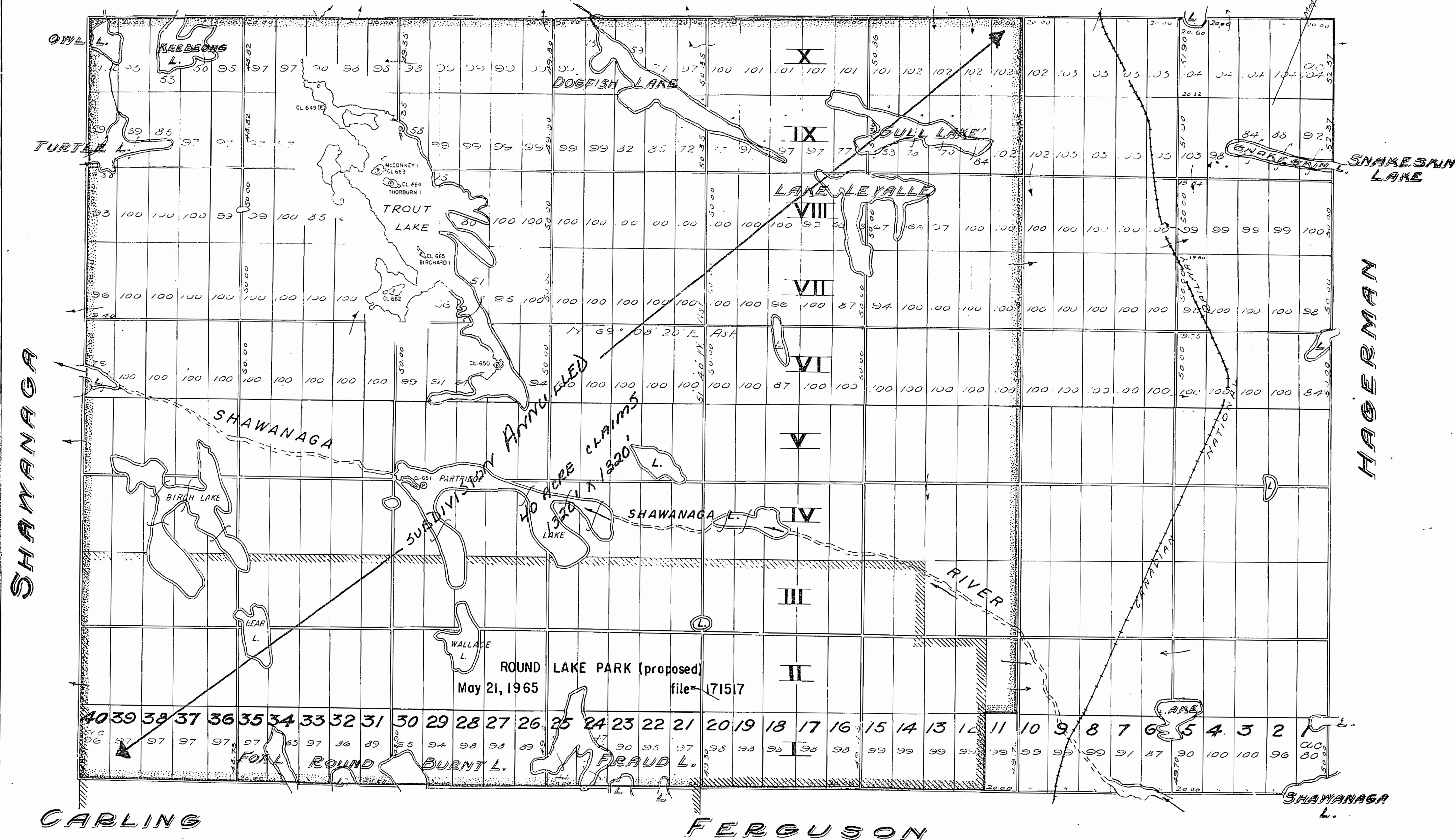

Surveyed by David Beatty P.L.S.
Toronto May 21st, 1967.

D.M.
Parry
Sound

"A"

EAST BURPEE

DISTRICT OF PARRY SOUND

Scale: 40 chains to an inch

CERTIFICATE

THE SUBDIVISION AS SHOWN WITHIN THE BOUNDARIES STIPPLED HEREON OF THE TOWNSHIP OF BURPEE BY DAVID BEATTY P.L.S. AS SHOWN ON PLAN DATED 4 MAY 1887 IS HEREBY ANNULLED, UNDER AUTHORITY OF SUBSECTION 1, OF SECTION 10, OF THE PUBLIC LANDS ACT, AND THIS AMENDED PLAN IS HEREBY LODGED AT THE LAND TITLES OFFICE AT PARRY SOUND, ONTARIO PURSUANT TO SUBSECTION 2 OF SAID SECTION.

TORONTO, ONTARIO
Dec. 23rd 1963.

F.A. MacDougall
DEPUTY MINISTER
LANDS AND FORESTS

CERTIFICATE

SURVEYS PERFORMED HENCEFORTH WITHIN THE ANNULLED PORTION OF THE TOWNSHIP OF BURPEE, SHALL BE CLASSIFIED AS BEING IN UNSURVEYED TERRITORY, WHICH MEANS THAT EACH SURVEYED PARCEL MUST BE DESIGNATED BY ITS MINING CLAIM NUMBER, OR IF NOT A MINING CLAIM, THEN BY THE SURVEYOR'S OFFICIAL LETTERS AND NUMBERS. EACH SURVEY MADE MUST ADHERE TO THE FORM OF SURVEYS MADE IN ANY OTHER UNSURVEYED AREA, OR UNSUBDIVIDED TOWNSHIP.

TORONTO, ONTARIO
Dec. 23rd 1963.

Robert G. Code
SURVEYOR GENERAL
LANDS AND FORESTS

ONTARIO
MINISTRY OF NATURAL RESOURCES
SURVEYS AND MAPPING BRANCH

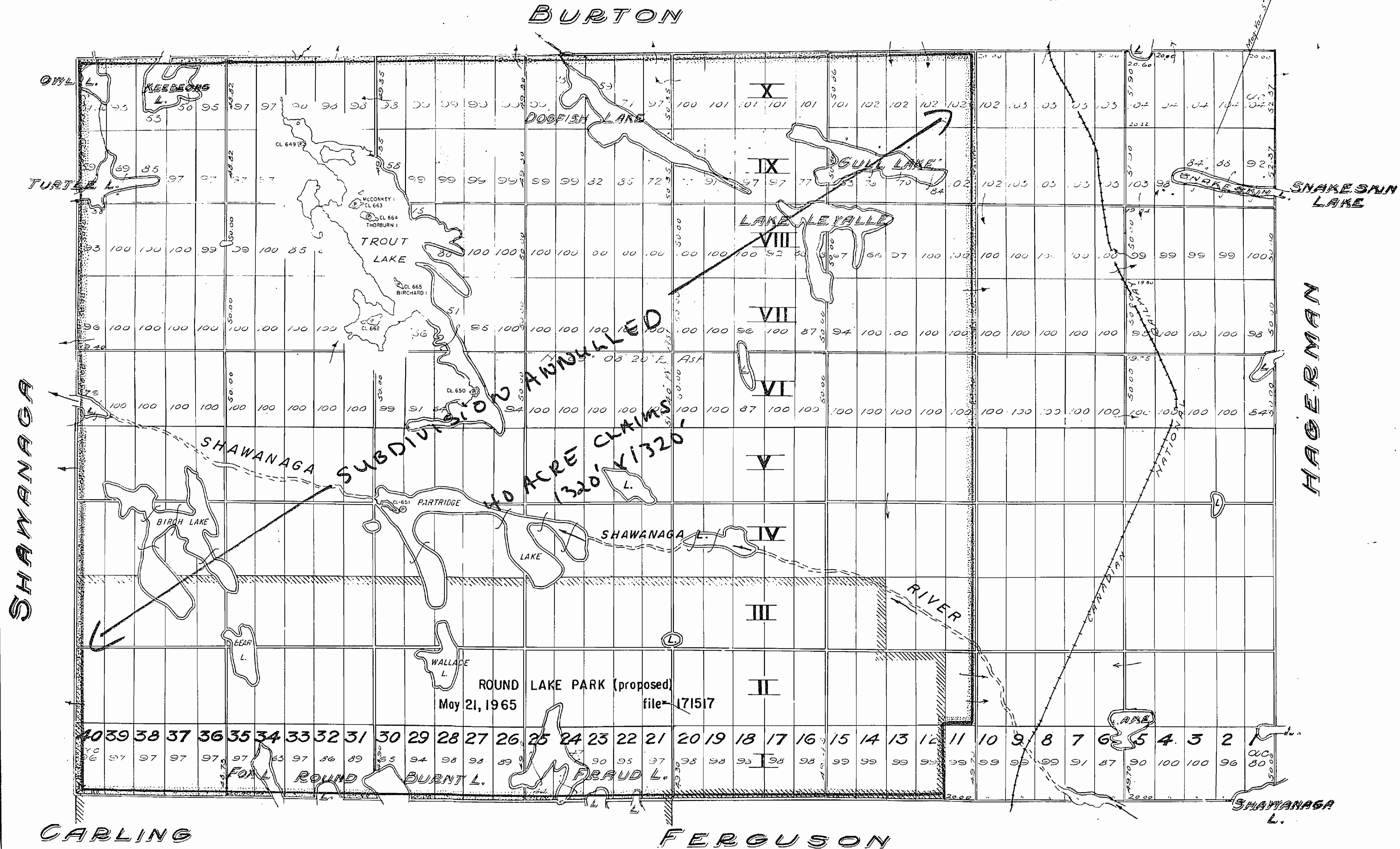
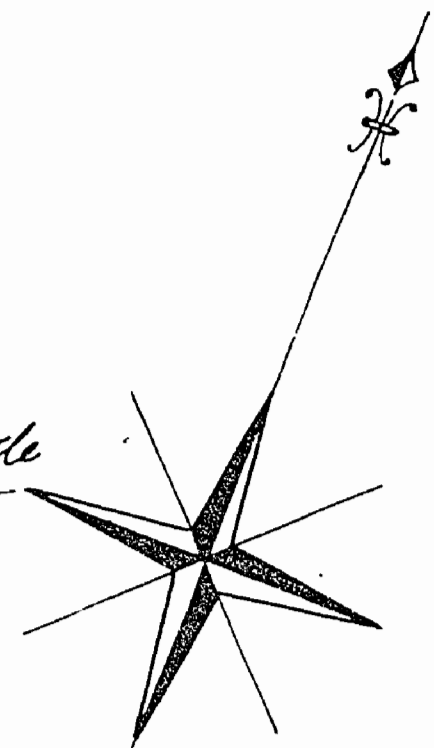

Surveyed by David Beatty P.L.S.
Toronto May 4th 1877.