

L. F. FONGE W-155
M. 1722
ONTARIO

MINISTRY OF NATURAL RESOURCES
SURVEYS AND MAPPING BRANCH

AREA EAST OF HEATHCOTE

[NOW FURLONGE TP.]

DISTRICT OF THUNDER BAY.

PATRICIA MINING DIVISION
Scale: 40 Chains = 1 Inch.

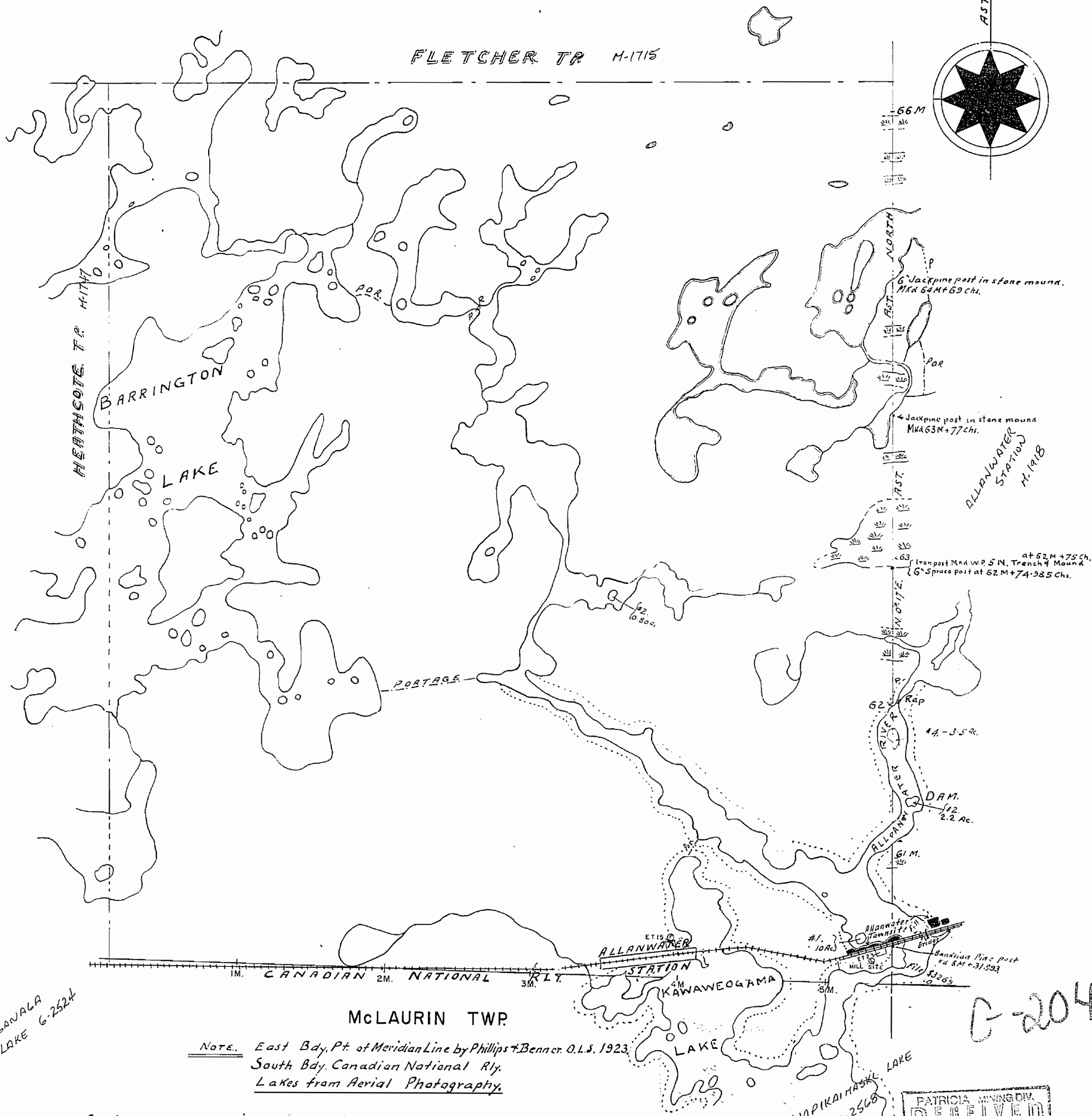
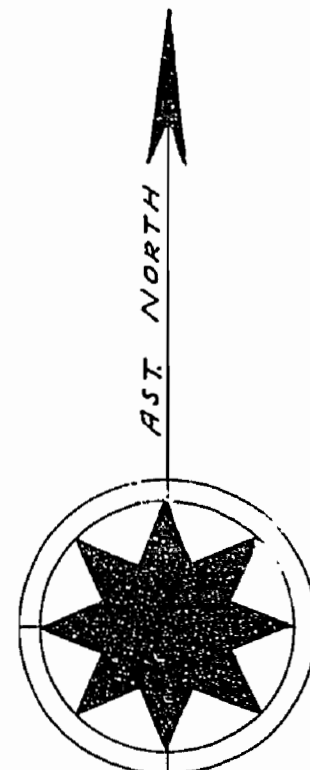

M-1722

AREA EAST OF HEATHCOTE

[NOW FURLONGE TP.]

DISTRICT OF THUNDER BAY.

Scale: 40 Chains = 1 Inch.

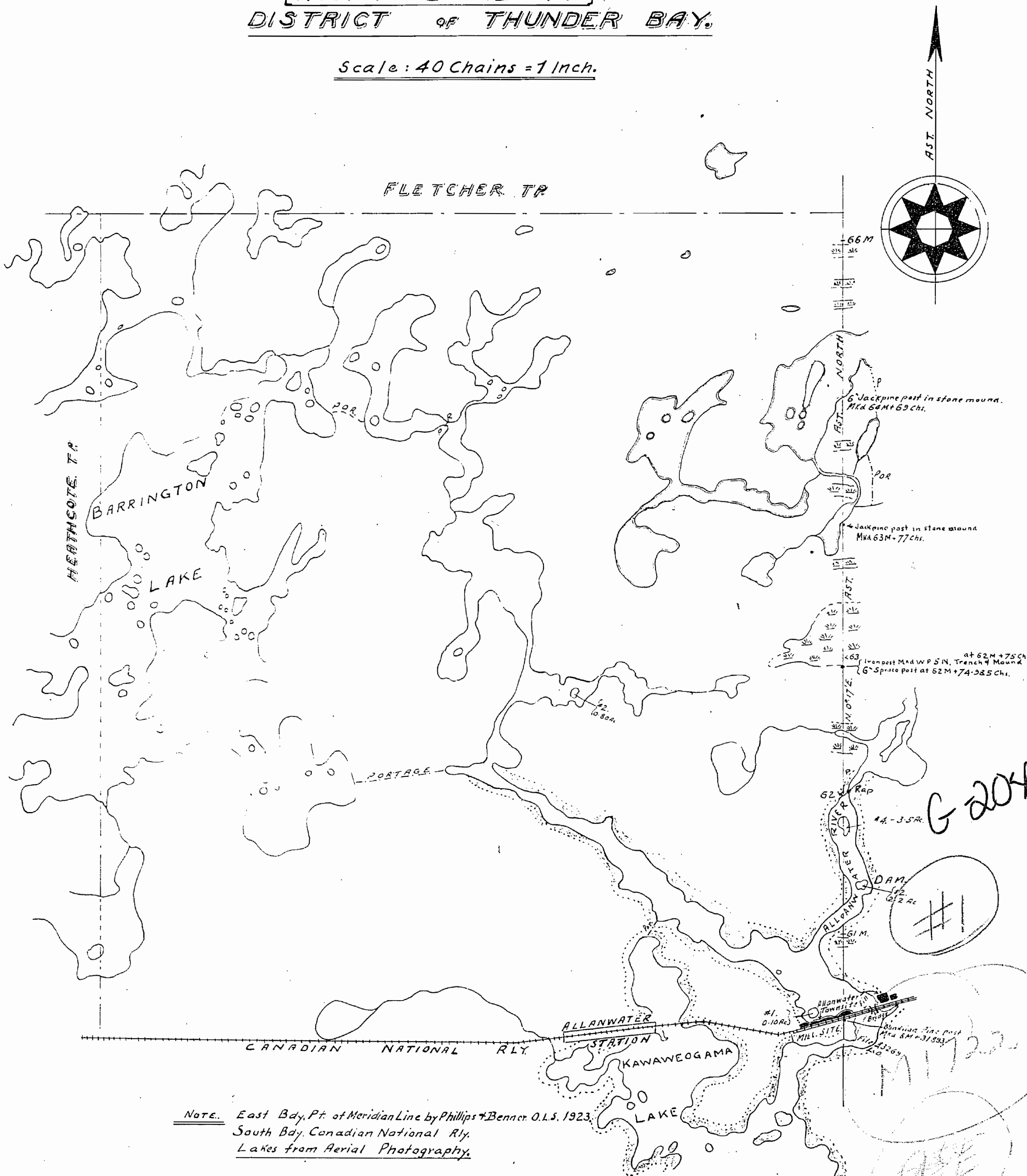

NOTE. East Bdy. Pt. of Meridian Line by Phillips & Benner O.L.S. 1923.
South Bdy. Canadian National Rly.
Lakes from Aerial Photography.

Surface reservations 400' wide by Dept. of L. & E.
Shewn hereon thus