

AREA OF  
**ENGLISH LAKE**  
DISTRICT OF  
KENORA  
KENORA  
MINING DIVISION

SCALE: 1-INCH = 40 CHAINS

**LEGEND**

- PATENTED LAND P or
- PATENTED FOR SURFACE RIGHTS ONLY L
- LEASES C.S.
- LICENSE OF OCCUPATION Loc.
- CROWN LAND SALE C
- LOCATED LAND M.R.O.
- CANCELLED S.R.O.
- MINING RIGHTS ONLY (17)
- SURFACE RIGHTS ONLY ---
- HIGHWAY & ROUTE No ---
- ROADS ---
- TRAILS ---
- RAILWAYS ---
- POWER LINES ---
- MARSH OR MUSKEG ---
- MINES X

\*used only with summer resort locations or when space is limited

**NOTES**

400' Surface Rights Reservation Around the Shores of All Lakes and Rivers

Areas withdrawn from staking under Section 43 of the Mining Act. (R.S.O. 1970)

File	Date	Disposition
(42)	182170	18/10/71 S.R.O.

PASS LAKE M.2018

3305

PALETTE LAKE M.3276

CAIRO LAKE M.3304

English Lake M.3305

NATIONAL TOPOGRAPHIC SERIES 52G11

PLAN NO. M.3305

MINISTRY OF  
NATURAL RESOURCES  
ONTARIO

496911

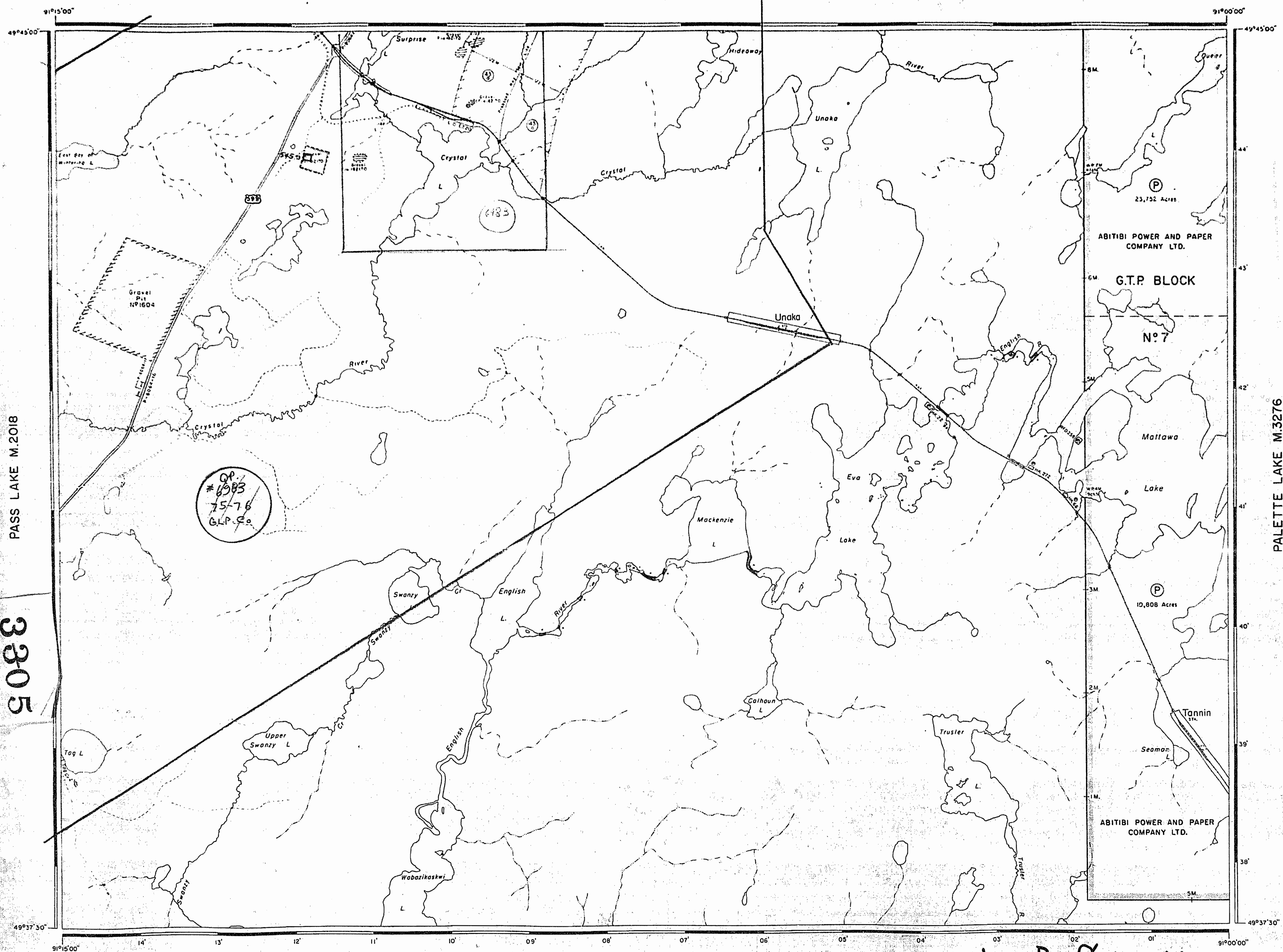

VALORA LAKE M.2052

AREA OF  
ENGLISH  
LAKE  
DISTRICT OF  
KENORA  
KENORA  
MINING DIVISION

M-3305

SCALE: 1-INCH = 40 CHAINS

LEGEND

- PATENTED LAND Ⓟ or Ⓢ
- PATENTED FOR SURFACE RIGHTS ONLY Ⓟ or Ⓢ
- LEASES L.O.
- LICENSE OF OCCUPATION L.O.
- CROWN LAND SALE C.S.
- LOCATED LAND Loc.
- CANCELLED C.
- MINING RIGHTS ONLY M.R.O.
- SURFACE RIGHTS ONLY S.R.O.
- HIGHWAY & ROUTE No. 17
- ROADS ---
- TRAILS ---
- RAILWAYS ---
- POWER LINES ---
- MARSH OR MUSKEG ---
- MINES X

\*used only with summer resort locations or when space is limited

NOTES

400' Surface Rights Reservation Around the Shores of All Lakes and Rivers

Areas withdrawn from staking under Section 43 of the Mining Act. (R.S.O. 1970)

File	Date	Disposition
Ⓢ 182170	18/10/71	S.R.O.

*Obadiah Sept. 11/84*

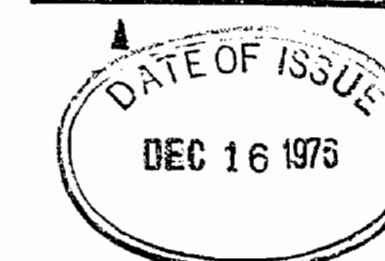
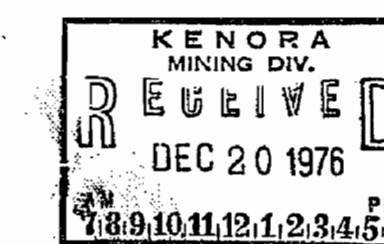

NATIONAL TOPOGRAPHIC SERIES 52611

PLAN NO. M.3305

ONTARIO  
MINISTRY OF NATURAL RESOURCES  
SURVEYS AND MAPPING BRANCH

PASS LAKE M.2018

PALETTE LAKE M.3276

CAIRO LAKE M.3304

ENGLISH Lk 3305 496911

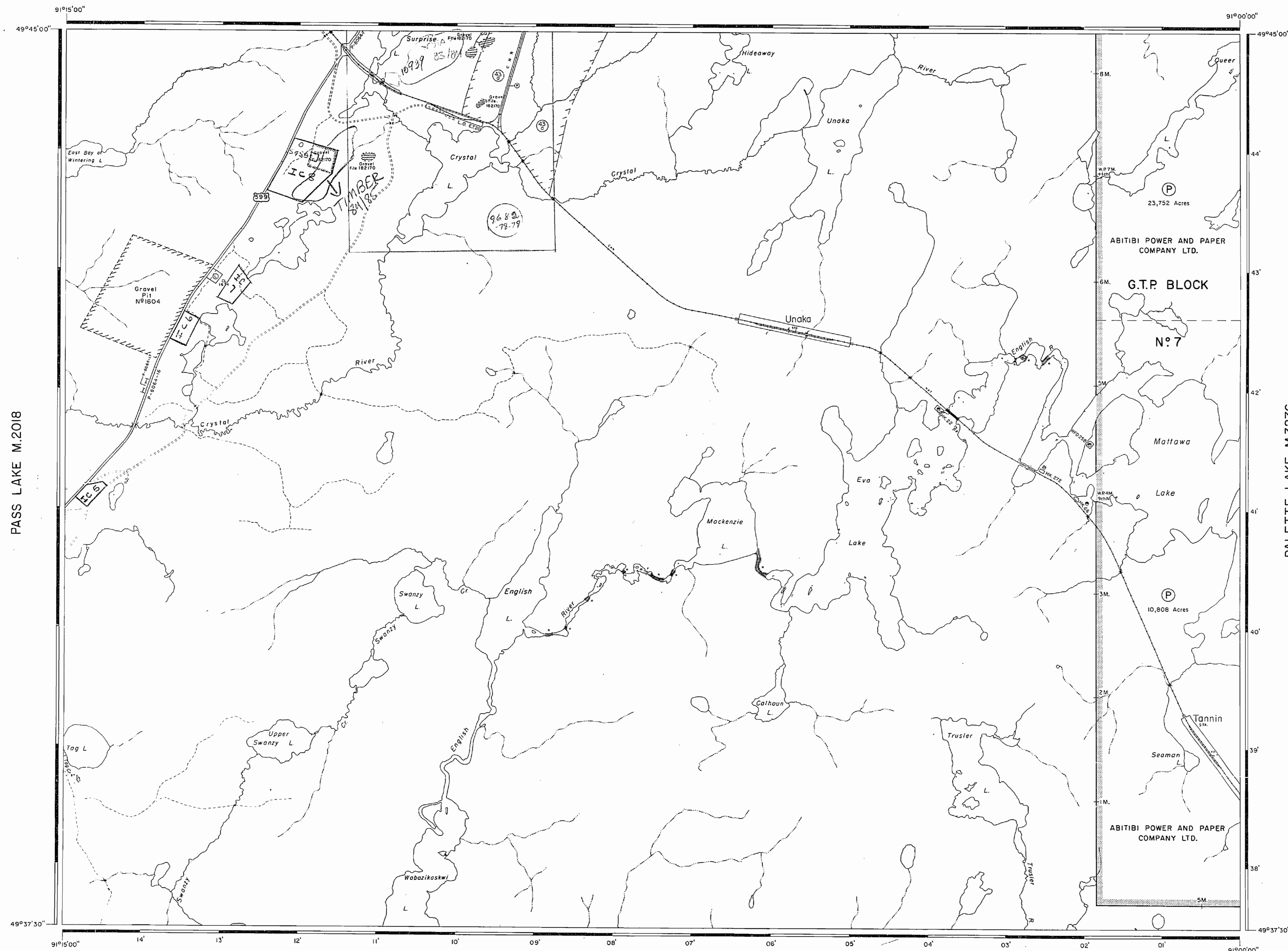

VALORA LAKE G-2565

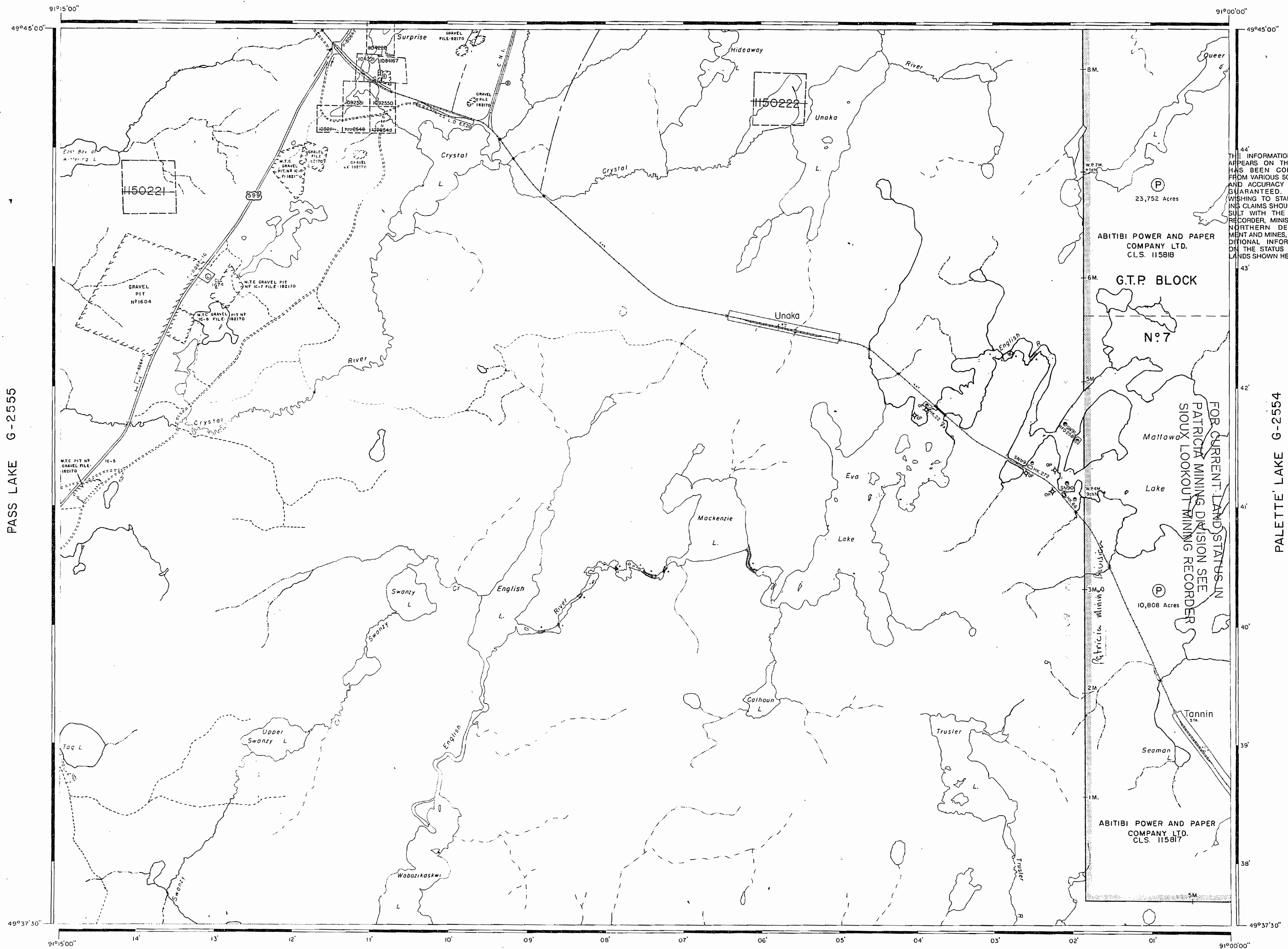

LEGEND

- HIGHWAY AND ROUTE No.
- OTHER ROADS
- TRAILS
- SURVEYED LINES:
  - TOWNSHIPS, BASE LINES, ETC.
  - LOTS, MINING CLAIMS, PARCELS, ETC.
- UNSURVEYED LINES:
  - LOT LINES
  - PARCEL BOUNDARY
  - MINING CLAIMS ETC.
- RAILWAY AND RIGHT OF WAY
- UTILITY LINES
- NON-PERENNIAL STREAM
- FLOODING OR FLOODING RIGHTS
- SUBDIVISION OR COMPOSITE PLAN RESERVATIONS
- ORIGINAL SHORELINE
- MARSH OR MUSKEG
- MINES
- TRAVERSE MONUMENT
- TOURIST CAMPS (OP - OUTPOST)

DISPOSITION OF CROWN LANDS

TYPE OF DOCUMENT	SYMBOL
PATENT, SURFACE & MINING RIGHTS	
" SURFACE RIGHTS ONLY	
" MINING RIGHTS ONLY	
LEASE, SURFACE & MINING RIGHTS	
" SURFACE RIGHTS ONLY	
" MINING RIGHTS ONLY	
LICENCE OF OCCUPATION	
ORDER-IN-COUNCIL	
RESERVATION	
CANCELLED	
SAND & GRAVEL	

NOTE: MINING RIGHTS IN PARCELS PATENTED PRIOR TO MAY 6, 1913, VESTED IN ORIGINAL PATENTEE BY THE PUBLIC LANDS ACT, R.S.O. 1970, CHAP. 380, SEC. 63, SUBSEC. 1

REFERENCES

AREAS WITHDRAWN FROM DISPOSITION

M.R.O. - MINING RIGHTS ONLY  
 S.R.O. - SURFACE RIGHTS ONLY  
 M.+S. - MINING AND SURFACE RIGHTS

Description	Order No.	Date	Disposition	File
SECT 43c		13/10/71	S.R.O.	192170

SAND AND GRAVEL

QUARRY PERMIT

NOTE

SOUTH PART OF THE WEST PART OF G.T.P. BLOCK 7, ORIGINALLY IN THE DISTRICT OF RAINY RIVER PATENTED TO THE GRAND TRUNK PACIFIC CO., MARCH 31, 1909, REFERENCE 13928 AA, WAS AMENDED BY O.C. 2403/51 DATED NOVEMBER 1, 1951 (REFERENCE 103392) AND GRANTED BY QUIT CLAIM DEED DATED AUGUST 2, 1961, TO THE ABITIBI POWER AND PAPER CO. LTD. REFERENCE 115817 PARCELS PREVIOUSLY SOLD BY GRAND TRUNK (PACIFIC RAILWAY CO AND EXCEPTED FROM THE QUIT CLAIM ARE UNDER THE ORIGINAL PATENT 13928AA

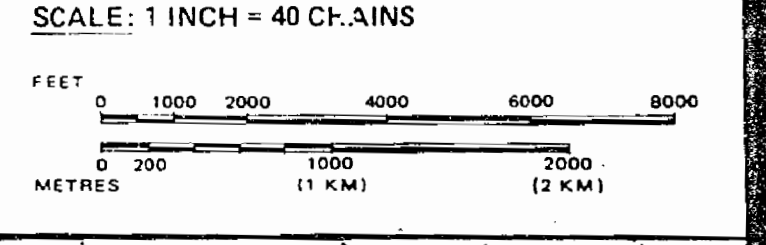

AREA **ENGLISH LAKE**

M.N.R. ADMINISTRATIVE DISTRICT  
 IGNACE  
 MINING DIVISION  
 KENORA  
 LAND TITLES / REGISTRY DIVISION  
 KENORA

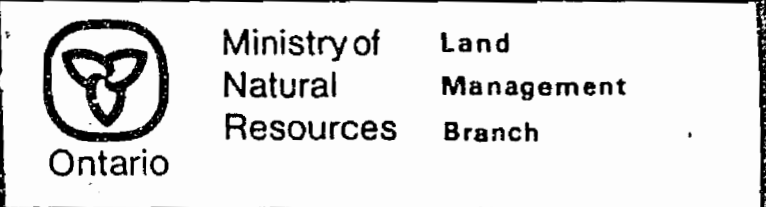

Date: JANUARY, 1984 Number  
 M-3305 **G-2540**

CAIRO LAKE G-2535

PASS LAKE G-2555

PALETTE LAKE G-2554

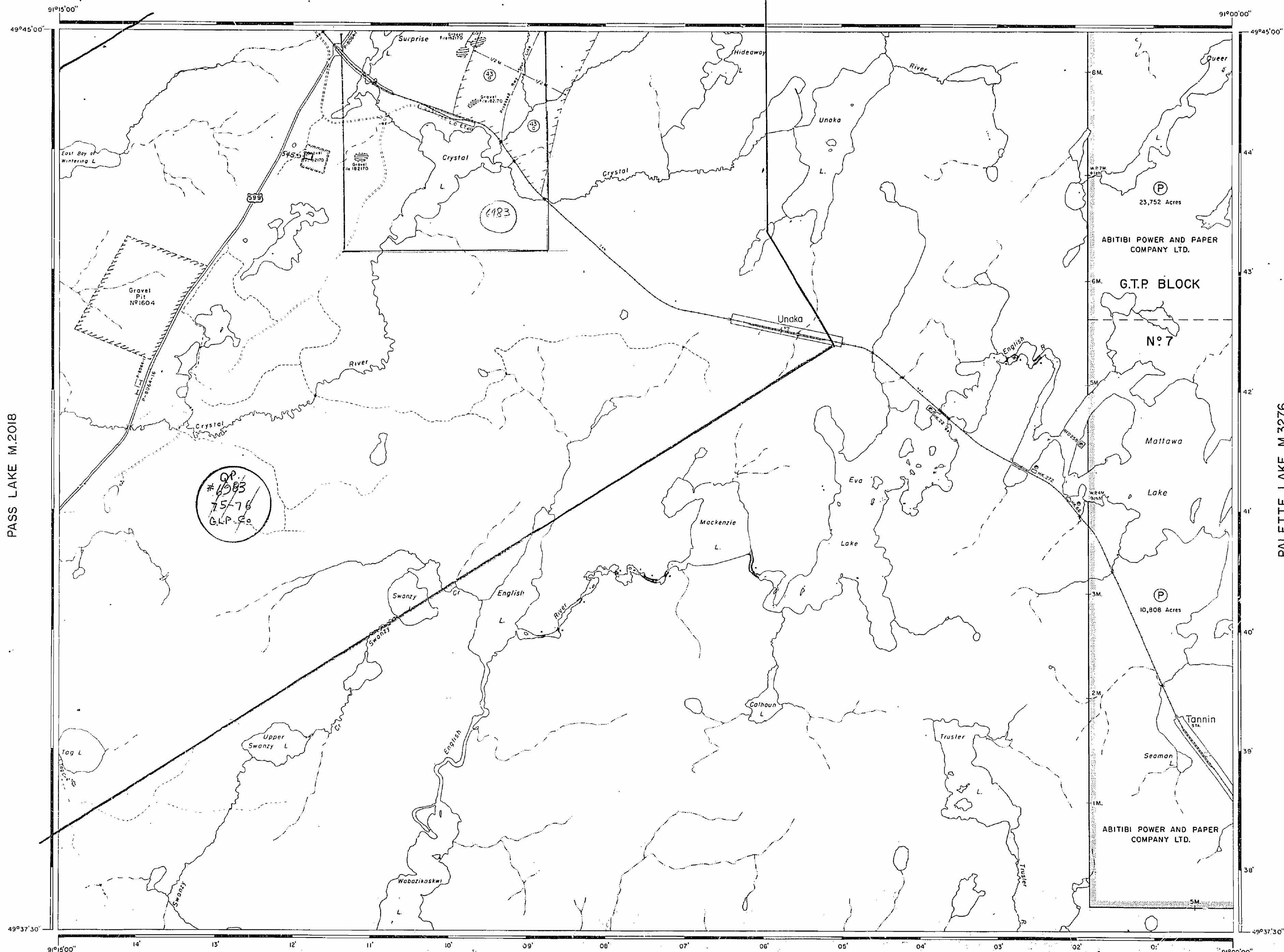

PASS LAKE M.2018

PALETTE LAKE M.3276

AREA OF  
ENGLISH  
LAKE  
DISTRICT OF  
KENORA  
KENORA  
MINING DIVISION

SCALE: 1-INCH = 40 CHAINS

LEGEND

- PATENTED LAND (P or O)
- PATENTED FOR SURFACE RIGHTS ONLY (P or O)
- LEASES (L)
- LICENSE OF OCCUPATION (L.O.)
- CROWN LAND SALE (C.S.)
- LOCATED LAND (Loc.)
- CANCELLED (C)
- MINING RIGHTS ONLY (M.R.O.)
- SURFACE RIGHTS ONLY (S.R.O.)
- HIGHWAY & ROUTE No. (17)
- ROADS (—)
- TRAILS (---)
- RAILWAYS (—+—)
- POWER LINES (—+—)
- MARSH OR MUSKEG (wavy lines)
- MINES (X)

\*used only with summer resort locations or when space is limited

NOTES

400' Surface Rights Reservation Around the Shores of All Lakes and Rivers

Areas withdrawn from staking under Section 43 of the Mining Act. (R.S.O. 1970)

File	Date	Disposition
(43)	182170	18/10/71 S. O.

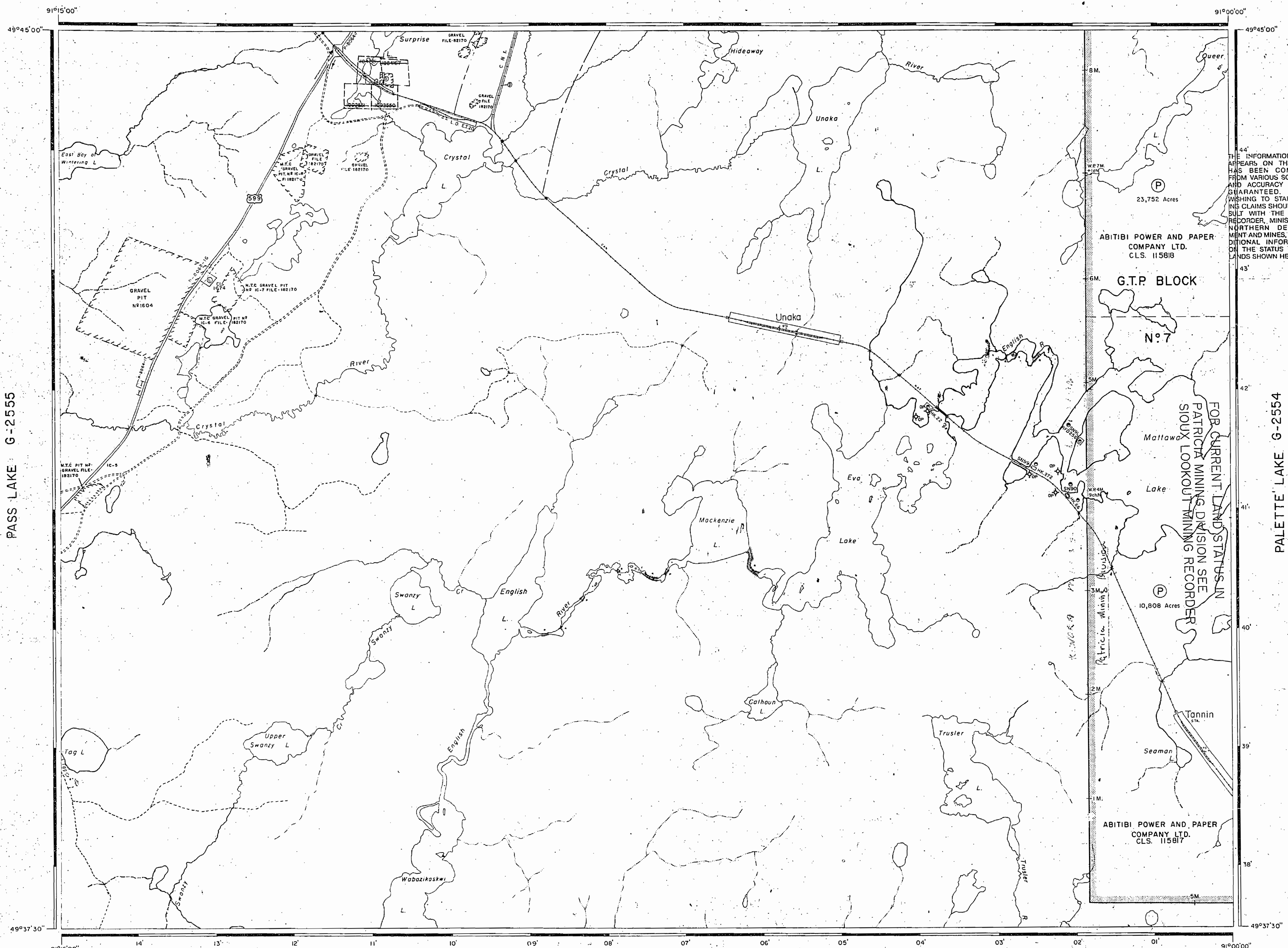

LEGEND

- HIGHWAY AND ROUTE No.
- OTHER ROADS
- TRAILS
- SURVEYED LINES:
  - TOWNSHIPS, BASE LINES, ETC.
  - LOTS, MINING CLAIMS, PARCELS, ETC.
- UNSURVEYED LINES:
  - LOT LINES
  - PARCEL BOUNDARY
  - MINING CLAIMS ETC.
- RAILWAY AND RIGHT OF WAY
- UTILITY LINES
- NON-PERENNIAL STREAM
- FLOODING OR FLOODING RIGHTS
- SUBDIVISION OR COMPOSITE PLAN
- RESERVATIONS
- ORIGINAL SHORELINE
- MARSH OR MUSKEG
- MINES
- TRAVERSE MONUMENT
- TOURIST CAMPS (CP - OUTPOST)

DISPOSITION OF CROWN LANDS

TYPE OF DOCUMENT	SYMBOL
PATENT, SURFACE & MINING RIGHTS	
" SURFACE RIGHTS ONLY	
" MINING RIGHTS ONLY	
LEASE, SURFACE & MINING RIGHTS	
" SURFACE RIGHTS ONLY	
" MINING RIGHTS ONLY	
LICENCE OF OCCUPATION	
ORDER-IN-COUNCIL	
RESERVATION	
CANCELLED	
SAND & GRAVEL	

NOTE: MINING RIGHTS IN PARCELS PATENTED PRIOR TO MAY 6, 1913, VESTED IN ORIGINAL PATENTEE BY THE PUBLIC LANDS ACT, R.S.O. 1970, CHAP. 380, SEC. 63, SUBSEC. 1.

REFERENCES

AREAS WITHDRAWN FROM DISPOSITION

Description	Order No.	Date	Disposition	File
M.R.O. - MINING RIGHTS ONLY				
S.R.O. - SURFACE RIGHTS ONLY				
M.+S. - MINING AND SURFACE RIGHTS				
SECT.43 c		18/10/71	S.R.O.	192170

SAND AND GRAVEL

QUARRY PERMIT

NOTE: SOUTH PART OF THE WEST PART OF G.T.P. BLOCK 7, ORIGINALLY IN THE DISTRICT OF RAINY RIVER PATENTED TO THE GRAND TRUNK PACIFIC CO. MARCH 31, 1909, REFERENCE 15928 AA, WAS AMENDED BY O.C. 2403/51 DATED NOVEMBER 1, 1951 (REFERENCE 103352) AND GRANTED BY QUIT CLAIM DEED DATED AUGUST 2, 1961 TO THE ABITIBI POWER AND PAPER CO. LTD. REFERENCE 115817. PARCELS PREVIOUSLY SOLD BY GRAND TRUNK PACIFIC RAILWAY CO. AND EXCEPTED FROM THE QUIT CLAIM ARE UNDER THE ORIGINAL PATENT 15928AA.

SCALE: 1 INCH = 40 CHAINS

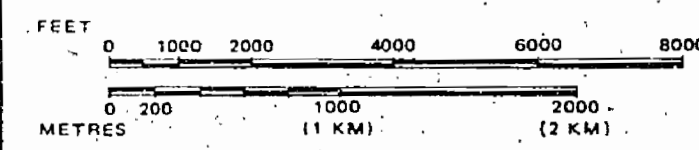

AREA ENGLISH LAKE

M.N.R. ADMINISTRATIVE DISTRICT  
 IGNACE DATE OF ISSUE  
 MINING DIVISION SEP 24 1998  
 KENORA PROVINCIAL RECORDING OFFICE - SUDBURY  
 LAND TITLES / REGISTRY DIVISION  
 KENORA

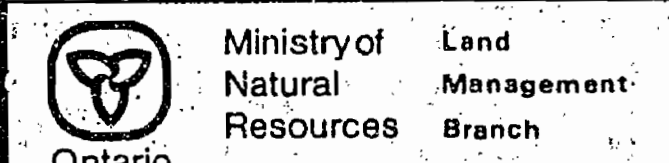

Date: JANUARY, 1984  
 Number: M-3305 G-2540

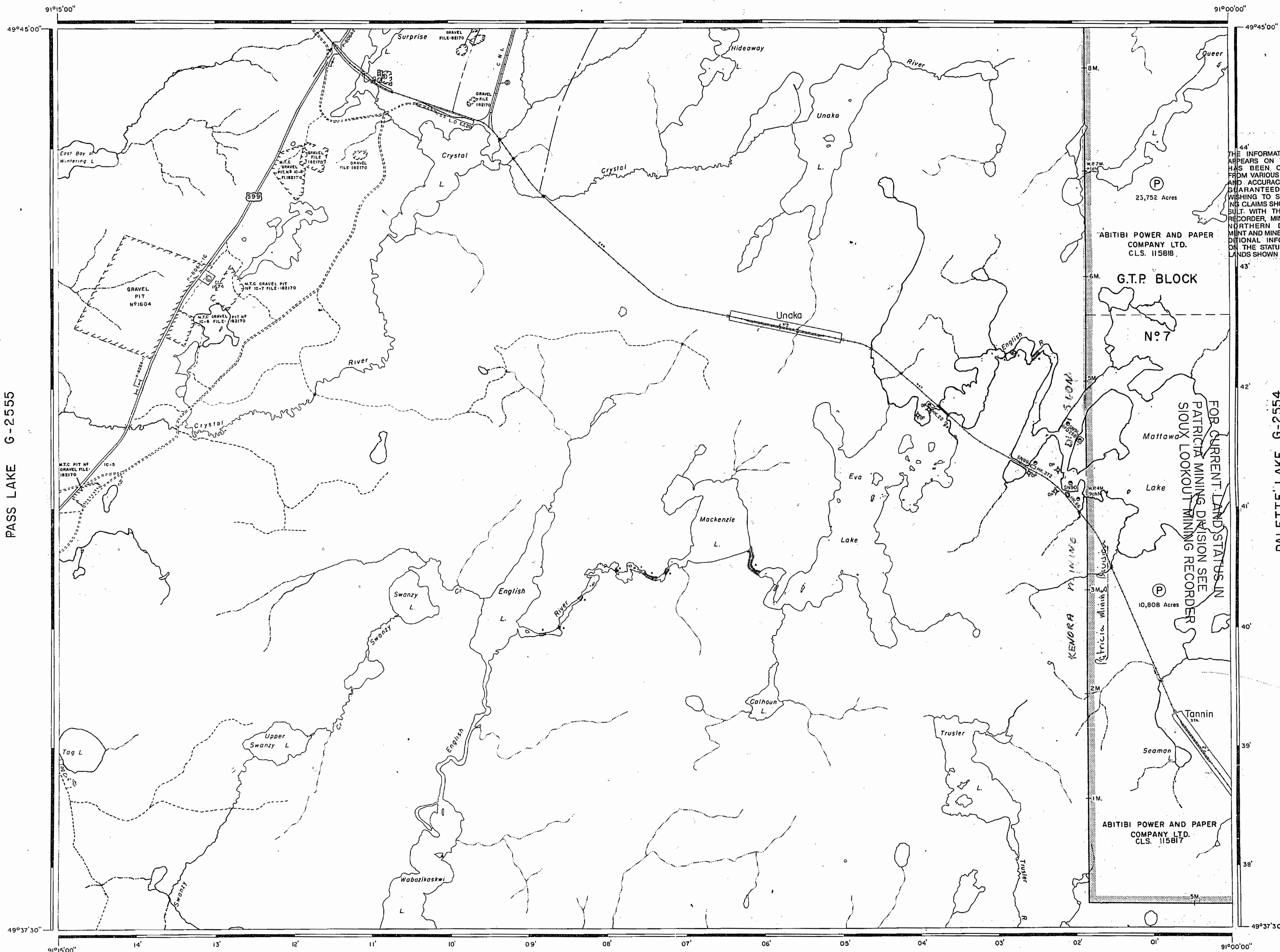

**LEGEND**

- HIGHWAY AND ROUTE No.
- OTHER ROADS
- TRAILS
- SURVEYED LINES:
  - TOWNSHIPS, BASE LINES, ETC.
  - LOTS, MINING CLAIMS, PARCELS, ETC.
- UNSURVEYED LINES:
  - LOT LINES
  - PARCEL BOUNDARY
  - MINING CLAIMS ETC.
- RAILWAY AND RIGHT OF WAY
- UTILITY LINES
- NON-PERENNIAL STREAM
- FLOODING OR FLOODING RIGHTS
- SUBDIVISION OR COMPOSITE PLAN
- RESERVATIONS
- ORIGINAL SHORELINE
- MARSH OR MUSKEG
- MINES
- TRAVERSE MONUMENT
- TOURIST CAMPS (OP - OUTPOST)

**DISPOSITION OF CROWN LANDS**

TYPE OF DOCUMENT	SYMBOL
PATENT, SURFACE & MINING RIGHTS	
SURFACE RIGHTS ONLY	
MINING RIGHTS ONLY	
LEASE, SURFACE & MINING RIGHTS	
SURFACE RIGHTS ONLY	
MINING RIGHTS ONLY	
LICENCE OF OCCUPATION	
ORDER-IN-COUNCIL	
RESERVATION	
CANCELLED	
SAND & GRAVEL	

NOTE: MINING RIGHTS IN PARCELS PATENTED PRIOR TO MAY 6, 1915, VESTED IN ORIGINAL PATENTEE BY THE PUBLIC LANDS ACT, R.S.O. 1970, CHAP. 380, SEC. 65, SUBSEC. 1.

**REFERENCES**

**AREAS WITHDRAWN FROM DISPOSITION**

M.R.O. - MINING RIGHTS ONLY  
 S.R.O. - SURFACE RIGHTS ONLY  
 M.+S. - MINING AND SURFACE RIGHTS

Description	Order No.	Date	Disposition	File
SECT.43 a	21/5	18/10/71	S.R.O.	182170

**SAND AND GRAVEL**

QUARRY PERMIT

*Effective as shown*

**NOTE**  
 SOUTH PART OF THE WEST PART OF G.T.P. BLOCK 7, ORIGINALLY IN THE DISTRICT OF RAINY RIVER PATENTED TO THE GRAND TRUNK PACIFIC CO. MARCH 31, 1909, REFERENCE 13928 AA, WAS AMENDED BY O.C. 2403/51 DATED NOVEMBER 1, 1951 (REFERENCE 10352) AND GRANTED BY QUIT CLAIM DEED DATED AUGUST 2, 1951, TO THE ABITIBI POWER AND PAPER CO. LTD. REFERENCE 115817 PARCELS PREVIOUSLY SOLD BY GRAND TRUNK PACIFIC RAILWAY CO. AND EXCEPTED FROM THE QUIT CLAIM ARE UNDER THE ORIGINAL PATENT 13928AA

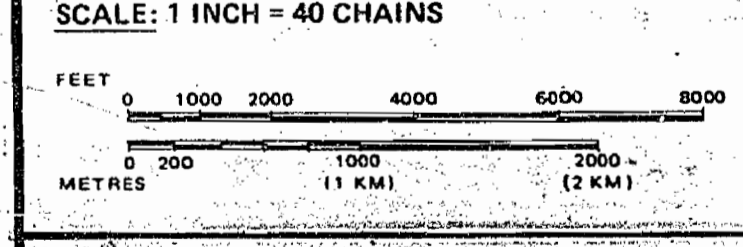

**AREA ENGLISH LAKE**

M.N.R. ADMINISTRATIVE DISTRICT  
**IGNACE**  
 MINING DIVISION  
**KENORA**  
 LAND TITLES / REGISTRY DIVISION  
**KENORA**

Ministry of Natural Resources  
 Land Management Branch  
 Ontario

Date: JANUARY 1994  
 Number: **G-2540**  
 17-3305

PASS LAKE G-2555

PALETTE LAKE G-2554

ENGLISH LAKE AREA G 2540

AREA OF  
**ENGLISH  
LAKE**

DISTRICT OF  
KENORA

KENORA  
MINING DIVISION

SCALE: 1-INCH = 40 CHAINS

**LEGEND**

- PATENTED LAND PATENTED FOR SURFACE RIGHTS ONLY Ⓟ or Ⓠ
- LEASES Ⓛ
- LICENSE OF OCCUPATION L.O.
- CROWN LAND SALE C.S.
- LOCATED LAND Loc.
- CANCELLED C
- MINING RIGHTS ONLY M.R.O.
- SURFACE RIGHTS ONLY S.R.O.
- HIGHWAY & ROUTE No. 17
- ROADS —
- TRAILS - - - - -
- RAILWAYS =
- POWER LINES —
- MARSH OR MUSKEG ~
- MINES \*

\*used only with summer resort locations or when space is limited

**NOTES**

400' Surface Rights Reservation Around the Shores of All Lakes and Rivers.

Areas withdrawn from staking under Section 43 of the Mining Act. (R.S.O. 1970)

File	Date	Disposition
43	182170	18/10/71 S.R.O.

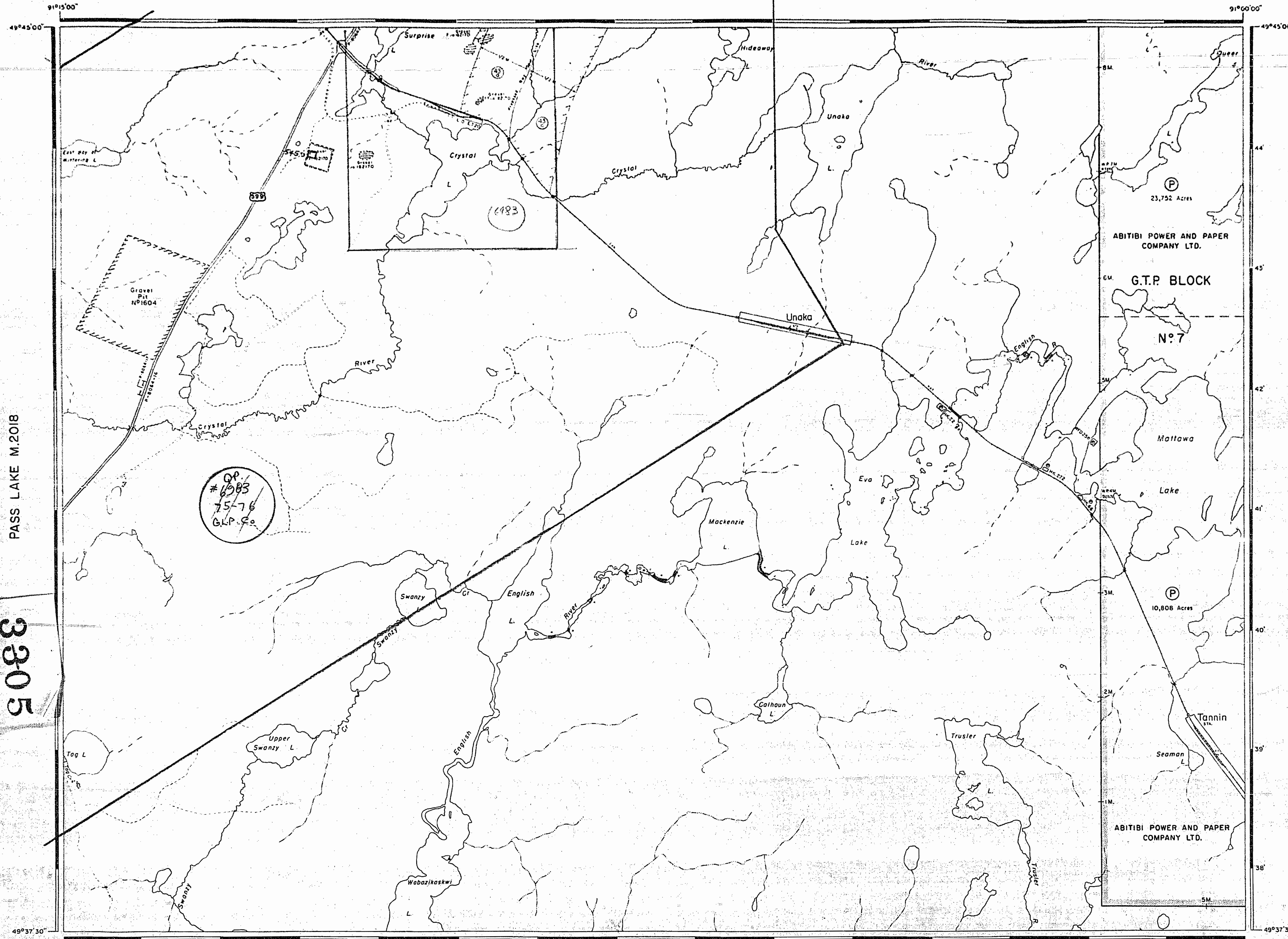

PASS LAKE M.2018

3305

PALETTE LAKE M.3276

English Lake M.3305

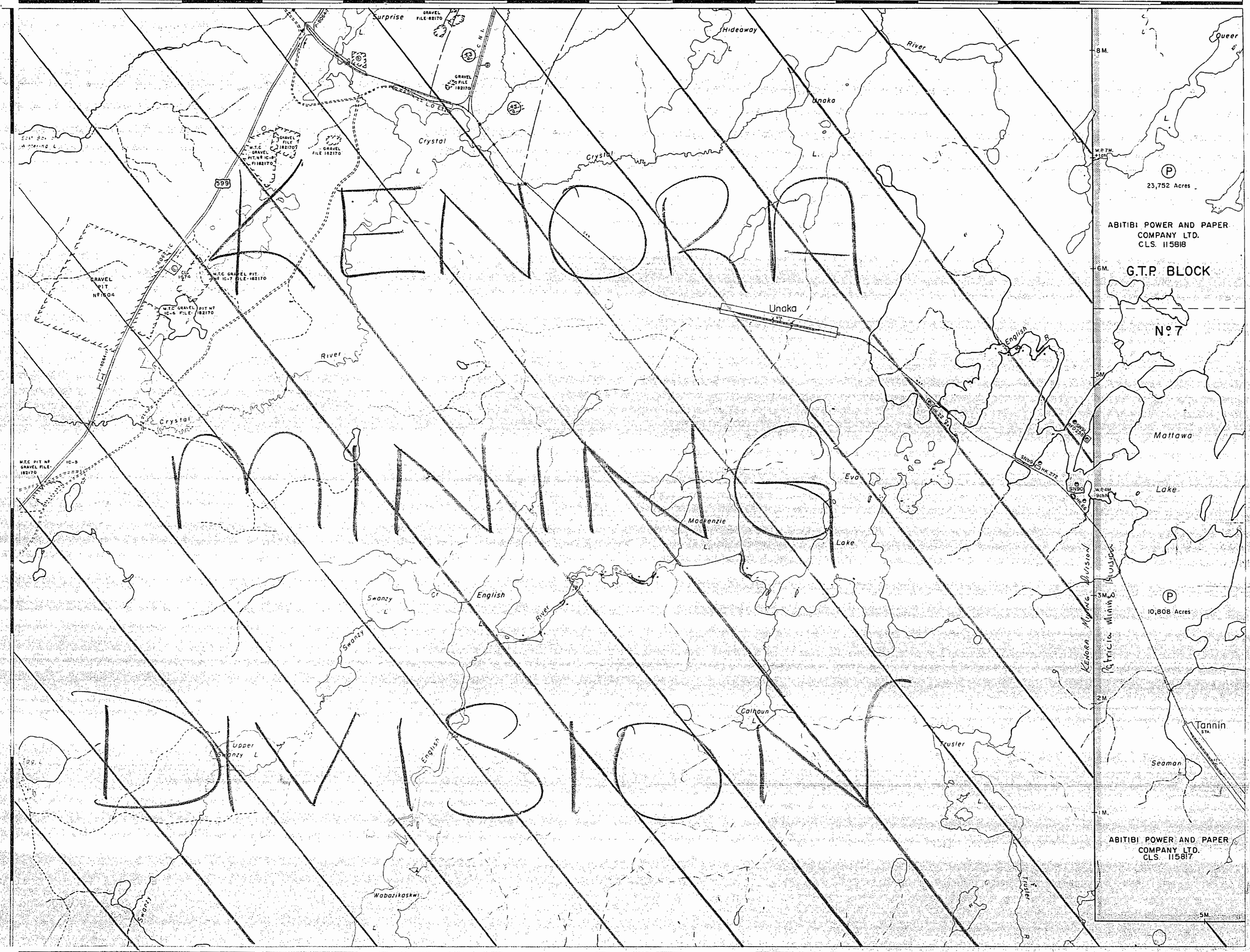

**LEGEND**

- HIGHWAY AND ROUTE No.
- OTHER ROADS
- TRAILS
- SURVEYED LINES:
  - TOWNSHIPS, BASE LINES, ETC.
  - LOTS, MINING CLAIMS, PARCELS, ETC.
- UNSURVEYED LINES:
  - LOT LINES
  - PARCEL BOUNDARY
  - MINING CLAIMS ETC.
- RAILWAY AND RIGHT OF WAY
- UTILITY LINES
- NON-PERENNIAL STREAM
- FLOODING OR FLOODING RIGHTS
- SUBDIVISION OR COMPOSITE PLAN RESERVATIONS
- ORIGINAL SHORELINE
- MARSH OR MUSKEG
- MINES
- TRAVERSE MONUMENT

**DISPOSITION OF CROWN LANDS**

TYPE OF DOCUMENT	SYMBOL
PATENT, SURFACE & MINING RIGHTS	
" SURFACE RIGHTS ONLY	
" MINING RIGHTS ONLY	
LEASE, SURFACE & MINING RIGHTS	
" SURFACE RIGHTS ONLY	
" MINING RIGHTS ONLY	
LICENCE OF OCCUPATION	
ORDER-IN-COUNCIL	
RESERVATION	
CANCELLED	
SAND & GRAVEL	

NOTE: MINING RIGHTS IN PARCELS PATENTED PRIOR TO MAY 6, 1913, VESTED IN ORIGINAL PATENTEE BY THE PUBLIC LANDS ACT, R.S.O. 1970, CHAP. 380, SEC. 63, SUBSEC. 1.

**REFERENCES**

**AREAS WITHDRAWN FROM DISPOSITION**

- M.R.O. - MINING RIGHTS ONLY
- S.R.O. - SURFACE RIGHTS ONLY
- M+S. - MINING AND SURFACE RIGHTS

Description	Order No.	Date	Disposition	File

**SAND AND GRAVEL**

QUARRY PERMIT RECEIVED  
 ENHORA PERMITTING DIV.  
 JAN 28 1987  
 78910119123458

NOTE: SOUTH PART OF THE WEST PART OF G.T.P. BLOCK 7, ORIGINALLY IN THE DISTRICT OF RAINY RIVER PATENTED TO THE GRAND TRUNK PACIFIC CO. MARCH 31, 1909, REFERENCE 13928 AA, WAS AMENDED BY O.C. 2403/51 DATED NOVEMBER 1, 1951 (REFERENCE 10332) AND GRANTED BY OUI CLAIM DEED DATED AUGUST 2, 1961, TO THE ABITIBI POWER AND PAPER CO. LTD. REFERENCE 11587. PARCELS PREVIOUSLY SOLD BY GRAND TRUNK PACIFIC RAILWAY CO. AND EXCEPTED FROM THE OUI CLAIM ARE UNDER THE ORIGINAL PATENT 13928AA.

SCALE: 1 INCH = 40 CHAINS

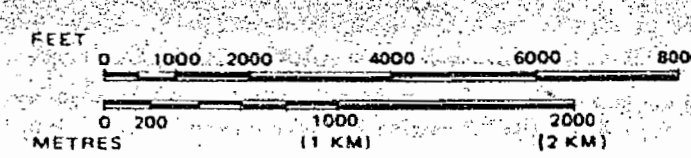

**AREA ENGLISH LAKE**  
 M.N.R. ADMINISTRATIVE DISTRICT  
 IGNACE  
 MINING DIVISION  
 KENORA  
 LAND TITLES / REGISTRY DIVISION  
 KENORA

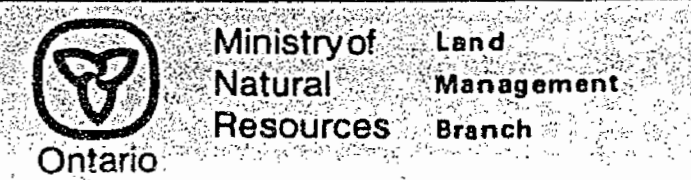

Date: JANUARY 1984  
 Number: G-2540  
 M-3305

THE APPEAL HAS TO BE MADE WITHIN 60 DAYS OF THE DATE OF THE DECISION ON THE APPEAL.



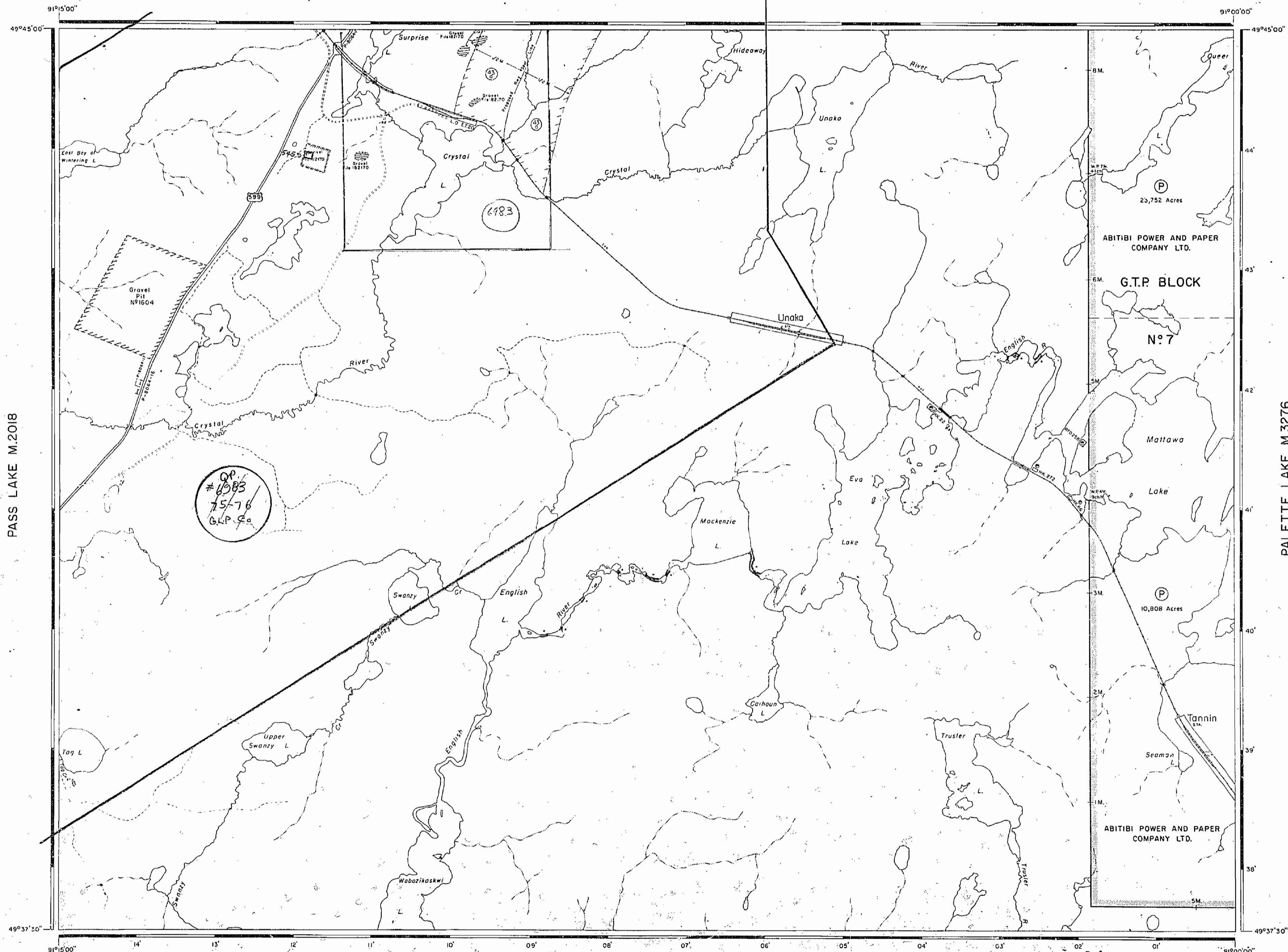

AREA OF  
**ENGLISH LAKE**  
 DISTRICT OF KENORA  
 KENORA MINING DIVISION  
 SCALE: 1-INCH = 40 CHAINS

**LEGEND**

- PATENTED LAND PATENTED FOR SURFACE RIGHTS ONLY LEASES LICENSE OF OCCUPATION CROWN LAND SALE LOCATED LAND CANCELLED MINING RIGHTS ONLY SURFACE RIGHTS ONLY HIGHWAY & ROUTE No. ROADS TRAILS RAILWAYS POWER LINES MARSH OR MUSKEG MINES

\*used only with summer resort locations or when space is limited

**NOTES**

400' Surface Rights Reservation Around the Shores of All Lakes and Rivers.

Areas withdrawn from staking under Section 43 of the Mining Act. (R.S.O. 1970)

File	Date	Disposition
42 C	182170	18/10/71 S. R. O.

NATIONAL TOPOGRAPHIC SERIES 52G11  
**PLAN NO. M.3305**  
 MINISTRY OF NATURAL RESOURCES ONTARIO

PASS LAKE M.2018

PALETTE LAKE M.3276