

Favourable Lake (North part) G-1774

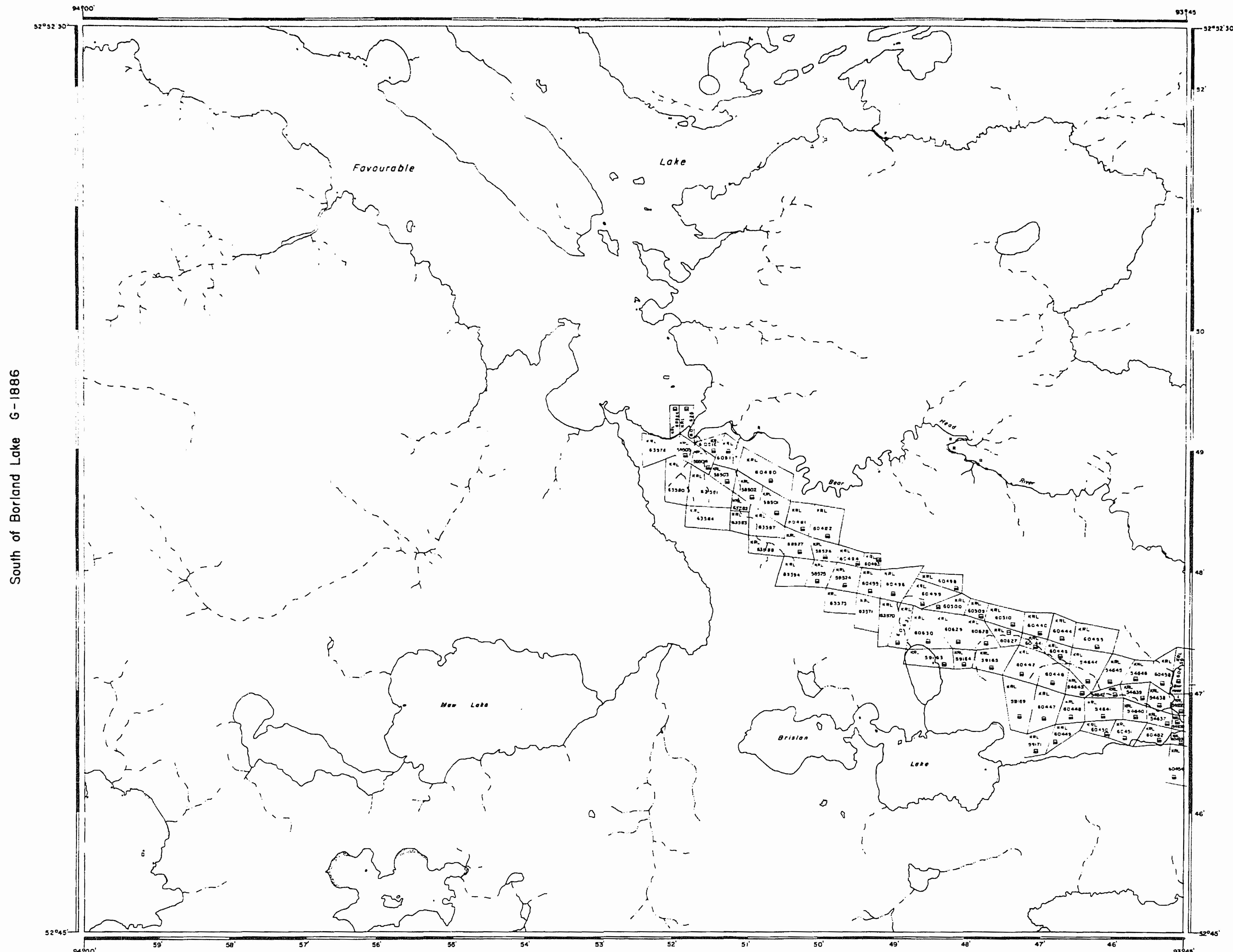

South of Borland Lake G-1886

Setting Net Lake G-1879

Deer Lake G 1768

REFERENCES

AREAS WITHDRAWN FROM DISPOSITION

M.R.O. - MINING RIGHTS ONLY
 S.R.O. - SURFACE RIGHTS ONLY
 M.S. - MINING AND SURFACE RIGHTS

Description	Order No.	Date	Disposition	Fee

LEGEND

HIGHWAY AND ROUTE No.	
OTHER ROADS	
TRAILS	
SURVEYED LINES	
TOWNSHIPS, BASE LINES ETC.	
LOTS, MINING CLAIMS PARCELS ETC.	
UNSURVEYED LINES	
LOT LINES	
PARCEL BOUNDARY	
MINING CLAIMS ETC.	
RAILWAY AND RIGHT OF WAY	
UTILITY LINES	
NON-PERENNIAL STREAM	
FLOODING OR FLOODING RIGHTS	
SUBDIVISION OR COMPOSITE PLAN	
RESERVATIONS	
ORIGINAL SHORELINE	
MARSH OR MUSKEG	
MINES	
TRAVERSE MONUMENT	

DISPOSITION OF CROWN LANDS

TYPE OF DOCUMENT	SYMBOL
PATENT, SURFACE & MINING RIGHTS	
- SURFACE RIGHTS ONLY	
- MINING RIGHTS ONLY	
LEASE, SURFACE & MINING RIGHTS	
- SURFACE RIGHTS ONLY	
- MINING RIGHTS ONLY	
LICENCE OF OCCUPATION	
ORDER-IN-COUNCIL	
RESERVATION	
CANCELLED	
SAND & GRAVEL	

NOTE: MINING RIGHTS IN PARCELS PATENTED PRIOR TO MAY 8 1912 VESTED IN ORIGINAL PATENTEES BY THE PUBLIC LANDS ACT R.S.O. 1970 CAP. 306 SEC. 62. PUBLIC.

SCALE: 1 INCH = 40 CHAINS

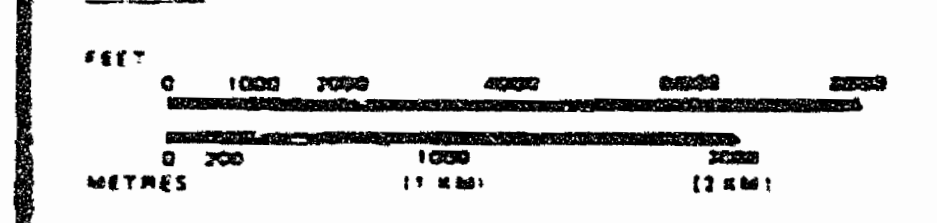

AREA
FAVOURABLE LAKE (SOUTH PART)

M.S.B. ADMINISTRATIVE DISTRICT
 RED LAKE
 BIDDING DIVISION
 RED LAKE
 LAND TITLES / REGISTRY DIVISION
 KENORA / PATRICIA

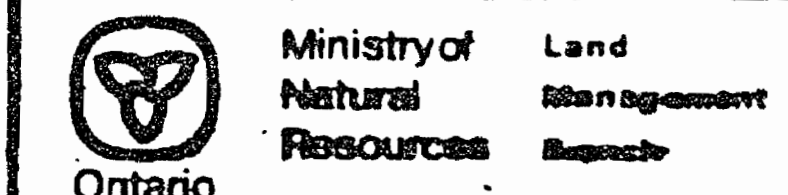

DATE: FEBRUARY 14, 1983
 DRAWN: G-1775

THE INFORMATION APPEARS ON THIS HAS BEEN COPIED FROM VARIOUS SOURCES AND ACCURACY IS NOT GUARANTEED. IF YOU WISH TO STAKE CLAIMS YOU SHOULD CONSULT WITH THE RECORDS, MINISTRY OF NORTHERN DEVELOPMENT AND MINES FOR ADDITIONAL INFORMATION ON THE STATUS OF LANDS SHOWN HERE.

2881

Favourable Lake (North part) - M.2880

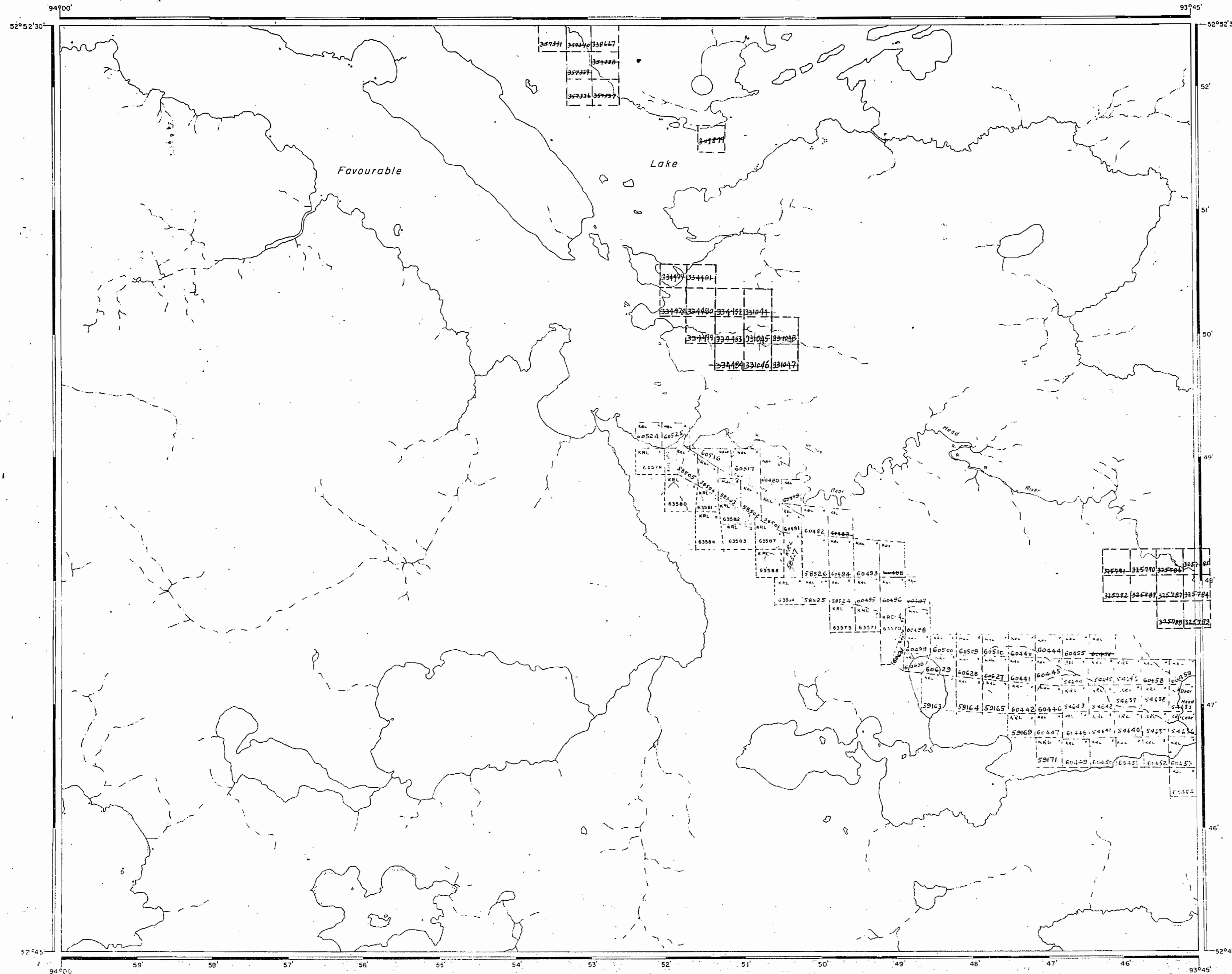

South of Borland Lake - M.2882

M.2199

AREA OF
FAVOURABLE LAKE
 SOUTH PART

DISTRICT OF
 KENORA
 PATRICIA PORTION

RED LAKE
 MINING DIVISION

SCALE: 1-INCH = 40 CHAINS

LEGEND

- PATENTED LAND Ⓟ
- CROWN LAND SALE C.S.
- LEASES Ⓛ
- LOCATED LAND Loc.
- LICENSE OF OCCUPATION L.O.
- MINING RIGHTS ONLY M.R.O.
- SURFACE RIGHTS ONLY S.R.O.
- ROADS —
- IMPROVED ROADS —
- KING'S HIGHWAYS —
- RAILWAYS —
- POWER LINES —
- MARSH OR MUSKEG —
- MINES —
- CANCELLED C.

NOTES

400' Surface Rights Reservation around
 all lakes and rivers.



NATIONAL TOPOGRAPHIC SERIES 53 C

PLAN NO. **M.2881**

ONTARIO
 DEPARTMENT OF MINES
 AND NORTHERN AFFAIRS

G-1112

FAVOURABLE LAKE (SOUTH PART)

G-1112

G-1112

FAVOURABLE LAKE (SOUTH PART)

G-1112

Favourable Lake (North part) G-1774

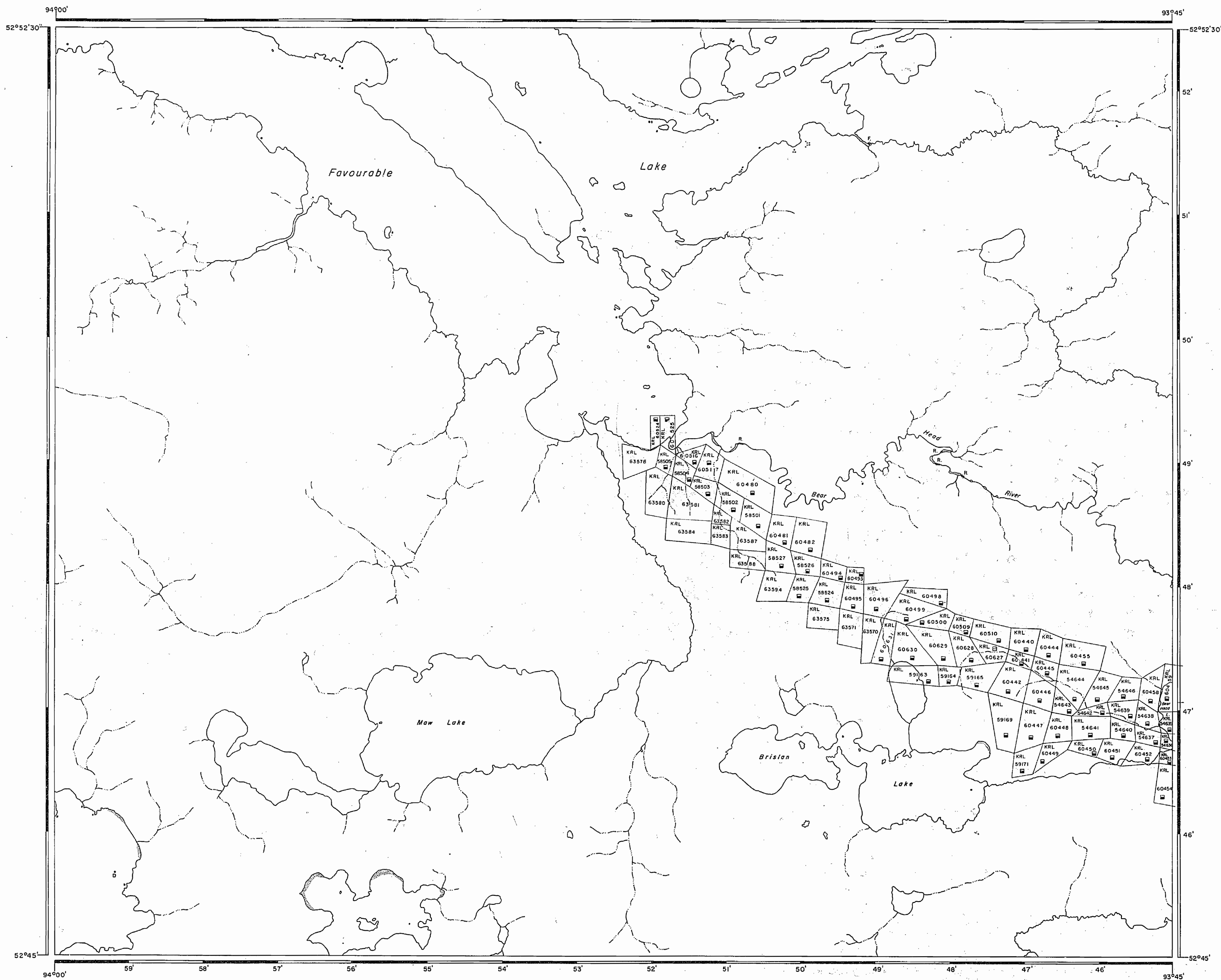

South of Borland Lake G-1886

Setting Net Lake G-1879

Deer Lake G 1768

527934

TRIM LINE

TRIM LINE

REFERENCES

AREAS WITHDRAWN FROM DISPOSITION

- M.R.O. - MINING RIGHTS ONLY
- S.R.O. - SURFACE RIGHTS ONLY
- M.+S. - MINING AND SURFACE RIGHTS

Description	Order No.	Date	Disposition	File

LEGEND

- HIGHWAY AND ROUTE No.
- OTHER ROADS
- TRAILS
- SURVEYED LINES:
 - TOWNSHIPS, BASE LINES, ETC.
 - LOTS, MINING CLAIMS, PARCELS, ETC.
- UNSURVEYED LINES:
 - LOT LINES
 - PARCEL BOUNDARY
 - MINING CLAIMS ETC.
- RAILWAY AND RIGHT OF WAY
- UTILITY LINES
- NON-PERENNIAL STREAM
- FLOODING OR FLOODING RIGHTS
- SUBDIVISION OR COMPOSITE PLAN
- RESERVATIONS
- ORIGINAL SHORELINE
- MARSH OR MUSKEG
- MINES
- TRAVERSE MONUMENT

DISPOSITION OF CROWN LANDS

TYPE OF DOCUMENT	SYMBOL
PATENT, SURFACE & MINING RIGHTS	
SURFACE RIGHTS ONLY	
MINING RIGHTS ONLY	
LEASE, SURFACE & MINING RIGHTS	
SURFACE RIGHTS ONLY	
MINING RIGHTS ONLY	
LICENCE OF OCCUPATION	
ORDER-IN-COUNCIL	
RESERVATION	
CANCELLED	
SAND & GRAVEL	

NOTE: MINING RIGHTS IN PARCELS PATENTED PRIOR TO MAY 6, 1913, VESTED IN ORIGINAL PATENTEE BY THE PUBLIC LANDS ACT, R.S.O. 1970, CHAP. 280, SEC. 63, SUBSEC. 1.

SCALE: 1 INCH = 40 CHAINS

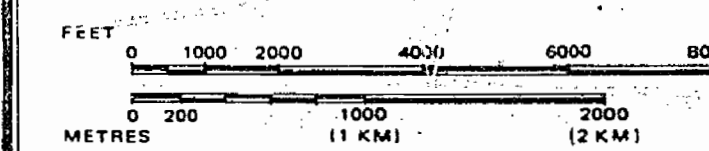

AREA
FAVOURABLE LAKE (SOUTH PART)

M.N.R. ADMINISTRATIVE DISTRICT

RED LAKE

MINING DIVISION

RED LAKE

LAND TITLES / REGISTRY DIVISION

KENORA/PATRICIA



Date FEBRUARY 14, 1983

Number G-1775

THE INFORMATION THAT APPEARS ON THIS MAP HAS BEEN COMPILED FROM VARIOUS SOURCES, AND ACCURACY IS NOT GUARANTEED. THOSE WISHING TO STAKE MINING CLAIMS SHOULD CONSULT WITH THE MINING RECORDER, MINISTRY OF NORTHERN DEVELOPMENT AND MINES, FOR ADDITIONAL INFORMATION ON THE STATUS OF THE LANDS SHOWN HEREON.

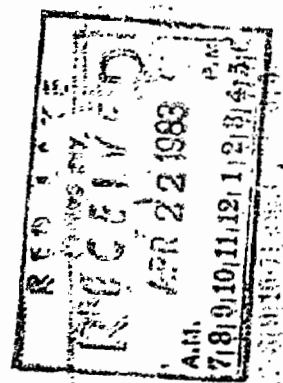

2199

Favourable Lake (North part) - M.2880

AREA OF
FAVOURABLE LAKE
SOUTH PART

DISTRICT OF
KENORA
PATRICIA PORTION

RED LAKE
MINING DIVISION

SCALE: 1-INCH = 40-CHAINS

LEGEND

- PATENTED LAND Ⓢ
- CROWN LAND SALE C.S.
- LEASES L
- LOCATED LAND Loc.
- LICENSE OF OCCUPATION L.O.
- MINING RIGHTS-ONLY M.R.O.
- SURFACE RIGHTS ONLY S.R.O.
- ROADS —
- IMPROVED ROADS —
- KING'S HIGHWAYS —
- RAILWAYS —
- POWER LINES —
- MARSH OR MUSKEG —
- MINES *
- CANCELLED C.

NOTES

400' Surface Rights Reservation around
all lakes and rivers.

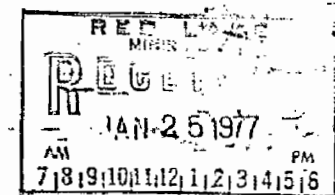

NATIONAL TOPOGRAPHIC SERIES: 53 C

PLAN NO. M.2881

ONTARIO
MINISTRY OF NATURAL RESOURCES
SURVEYS AND MAPPING BRANCH

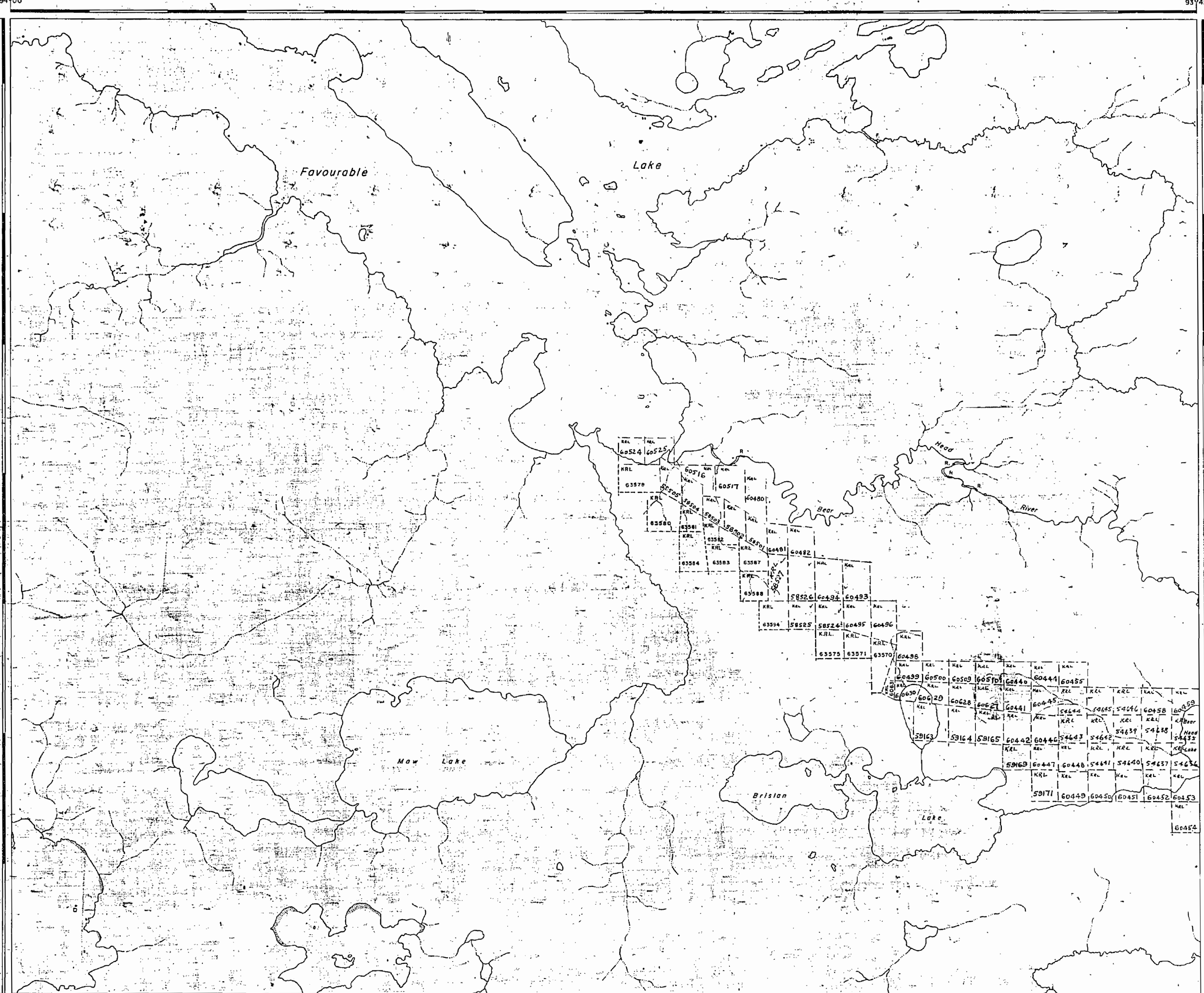

South of Borland Lake - M.2882

Favourable Lake (North part) - M.2880

AREA OF
FAVOURABLE LAKE
SOUTH PART

DISTRICT OF
KENORA
PATRICIA PORTION

RED LAKE
MINING DIVISION

SCALE: 1-INCH = 40 CHAINS

LEGEND

- PATENTED LAND Ⓟ
- CROWN LAND SALE C.S.
- LEASES Ⓛ
- LOCATED LAND Loc.
- LICENSE OF OCCUPATION L.O.
- MINING RIGHTS ONLY M.R.O.
- SURFACE RIGHTS ONLY S.R.O.
- ROADS —
- IMPROVED ROADS —
- KING'S HIGHWAYS —
- RAILWAYS —
- POWER LINES —
- MARSH OR MUSKEG —
- MINES Ⓜ
- CANCELLED C.

NOTES

400' Surface Rights Reservation around
all lakes and rivers.

M2199

M 3052

South of Borland Lake - M.2882

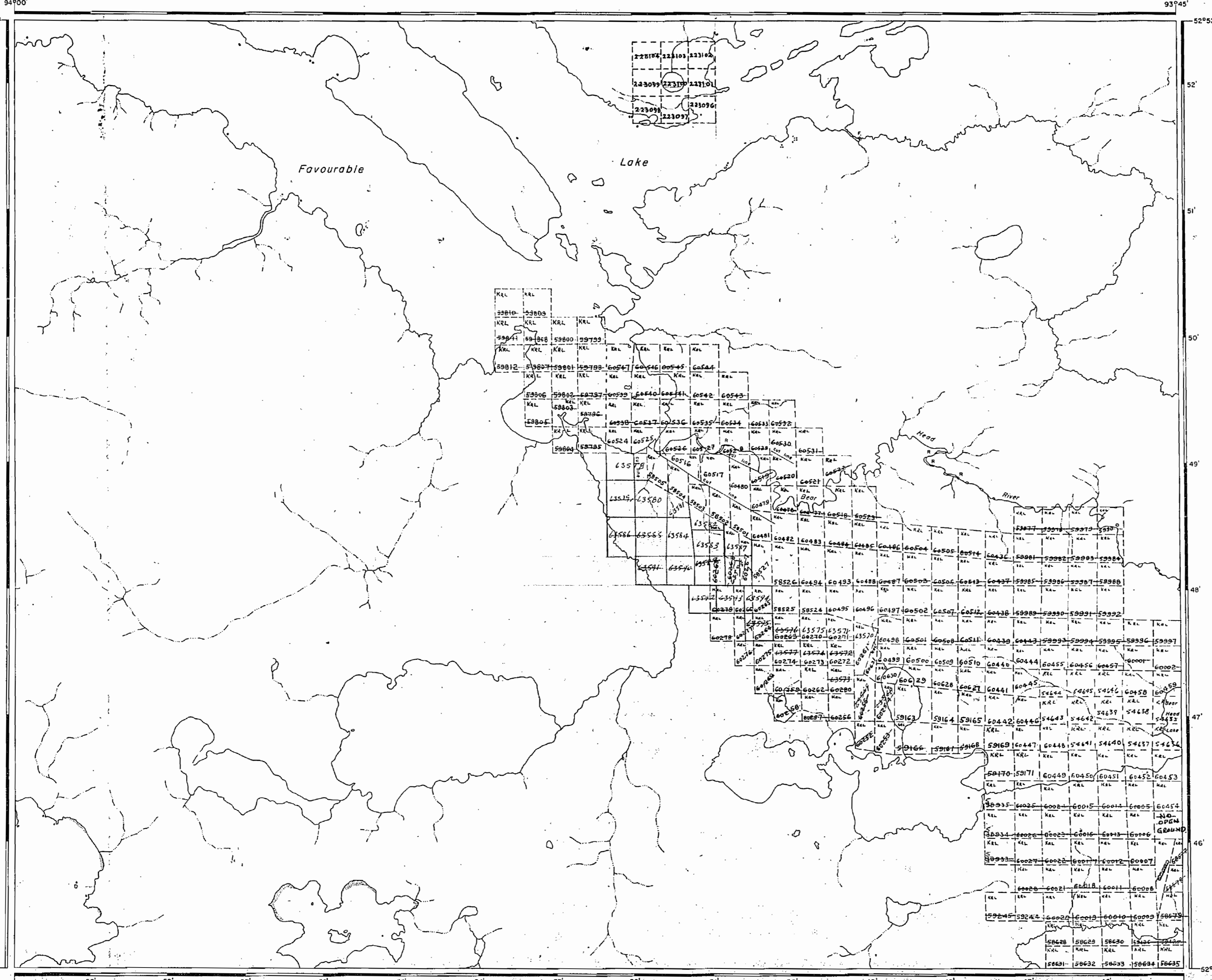

PLAN NO. M.2881

DEPARTMENT OF MINES
— ONTARIO —

2881

Favourable Lake (North part) - M.2880

AREA OF
**FAVOURABLE LAKE
SOUTH PART**

DISTRICT OF
KENORA
PATRICIA PORTION

RED LAKE
MINING DIVISION

SCALE: 1-INCH = 40 CHAINS

LEGEND

- PATENTED LAND Ⓟ
- CROWN LAND SALE- C.S.
- LEASES Ⓛ
- LOCATED LAND Loc.
- LICENSE OF OCCUPATION L.O.
- MINING RIGHTS ONLY M.R.O.
- SURFACE RIGHTS ONLY S.R.O.
- ROADS —
- IMPROVED ROADS —
- KING'S HIGHWAYS —
- RAILWAYS —
- POWER LINES —
- MARSH OR MUSKEG —
- MINES —
- CANCELLED C.

NOTES

400' Surface Rights Reservation around
all lakes and rivers.

South of Borland Lake - M.2882

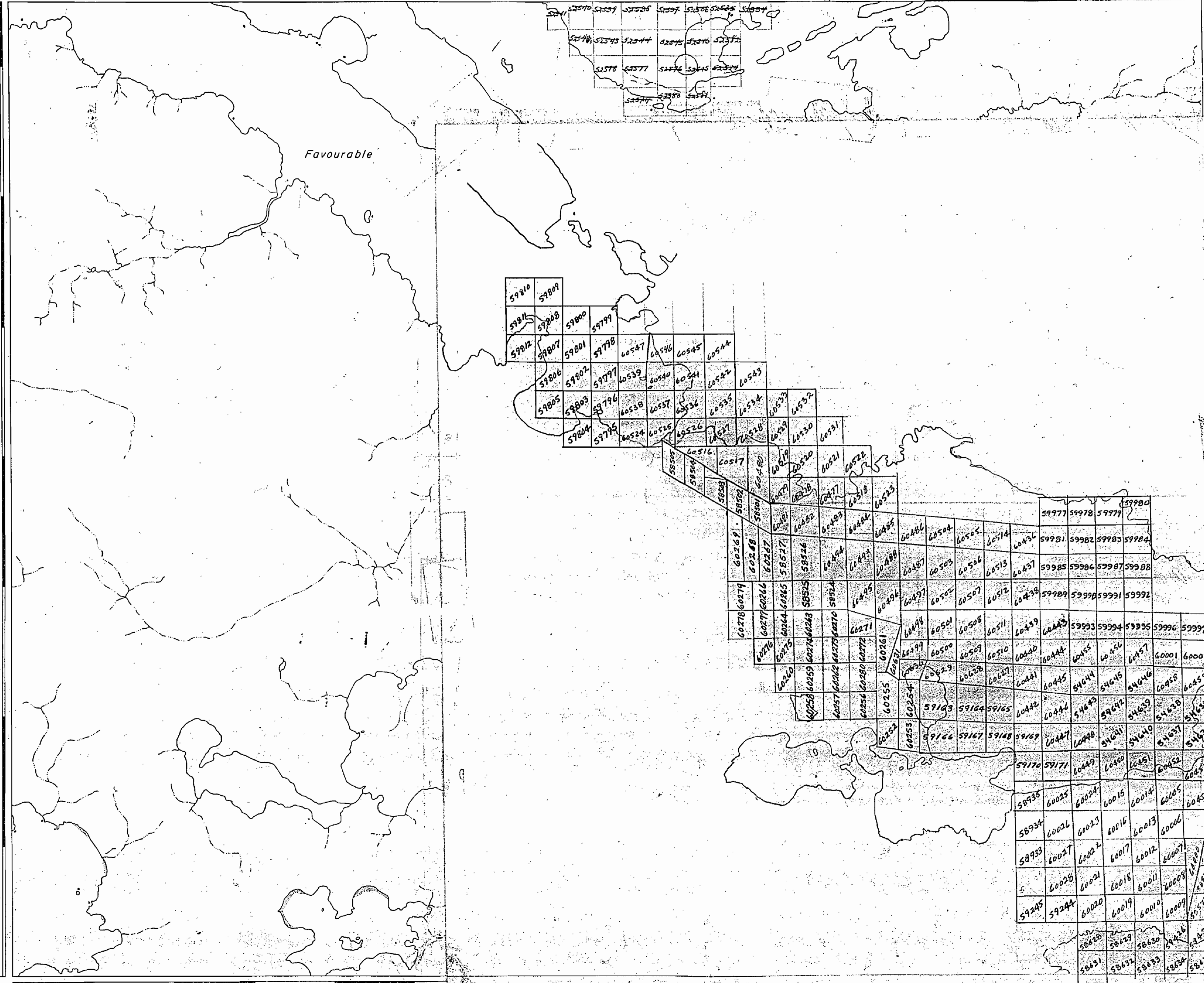

Apr 30/1963

PLAN NO. **M.2881**

DEPARTMENT OF MINES
— ONTARIO —

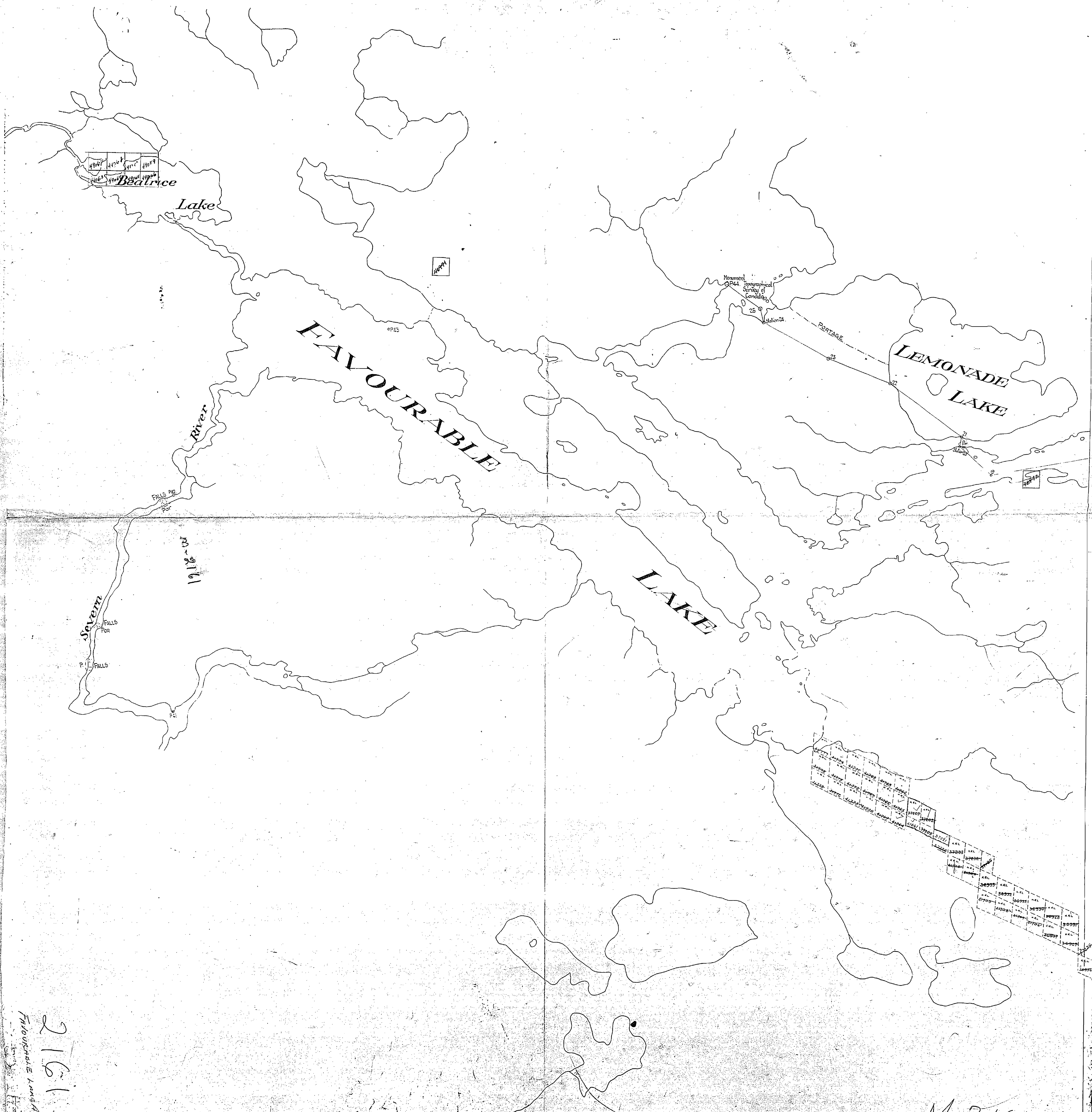

2161
 FAVOURABLE LAKE
 1918-1919

M 2161

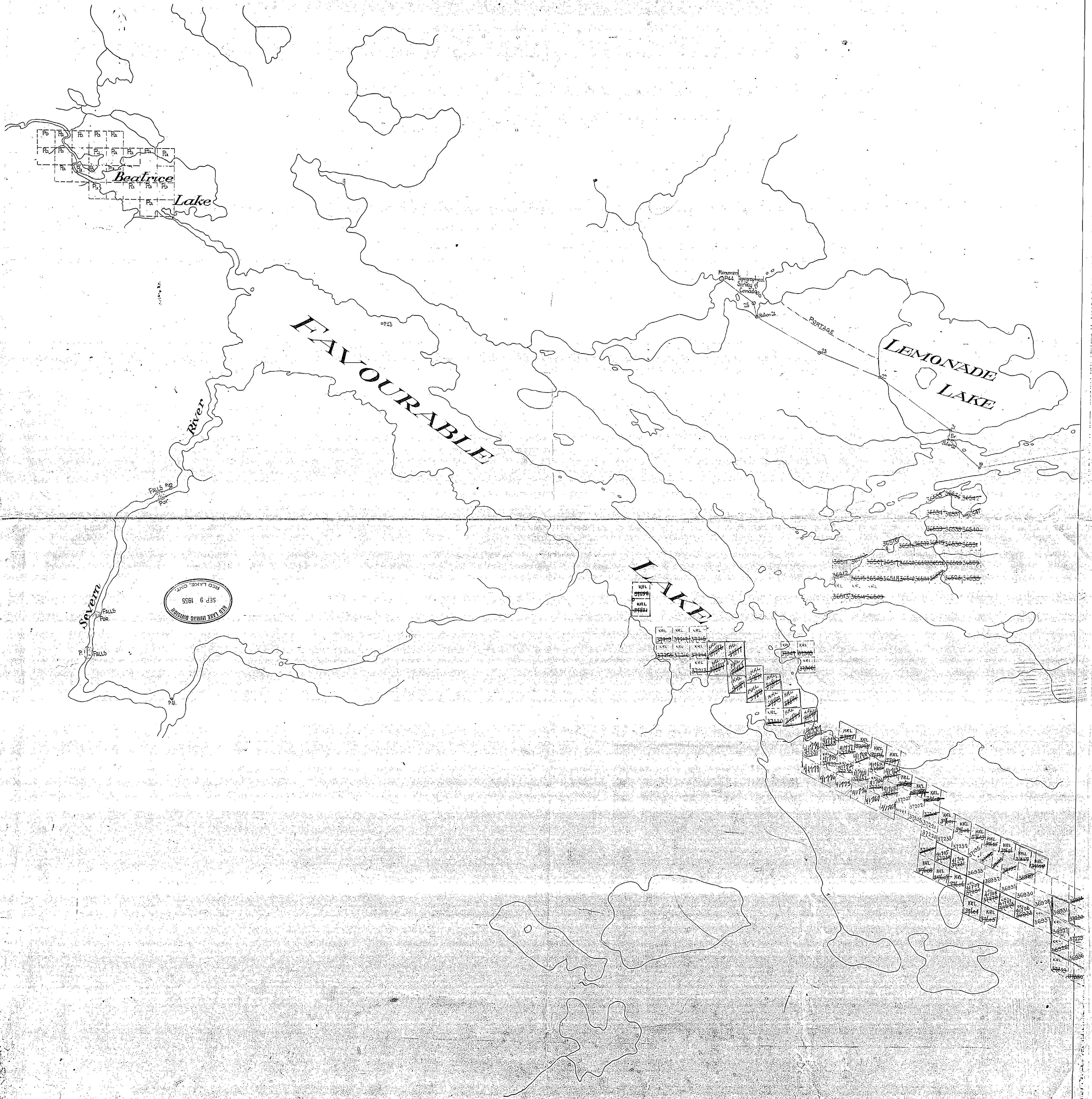

5107	5114	5119	5122	5127	5132	5137
5139	5145	5146	5157	5162	5167	5170
50275	50276	50277	50278	50279	50280	50281
50282	50283	50284	50285	50286	50287	50288
50289	50290	50291	50292	50293	50294	50295
50296	50297	50298	50299	50300	50301	50302
50303	50304	50305	50306	50307	50308	50309
50310	50311	50312	50313	50314	50315	50316
50317	50318	50319	50320	50321	50322	50323
50324	50325	50326	50327	50328	50329	50330
50331	50332	50333	50334	50335	50336	50337
50338	50339	50340	50341	50342	50343	50344
50345	50346	50347	50348	50349	50350	50351
50352	50353	50354	50355	50356	50357	50358
50359	50360	50361	50362	50363	50364	50365
50366	50367	50368	50369	50370	50371	50372
50373	50374	50375	50376	50377	50378	50379
50380	50381	50382	50383	50384	50385	50386
50387	50388	50389	50390	50391	50392	50393
50394	50395	50396	50397	50398	50399	50400

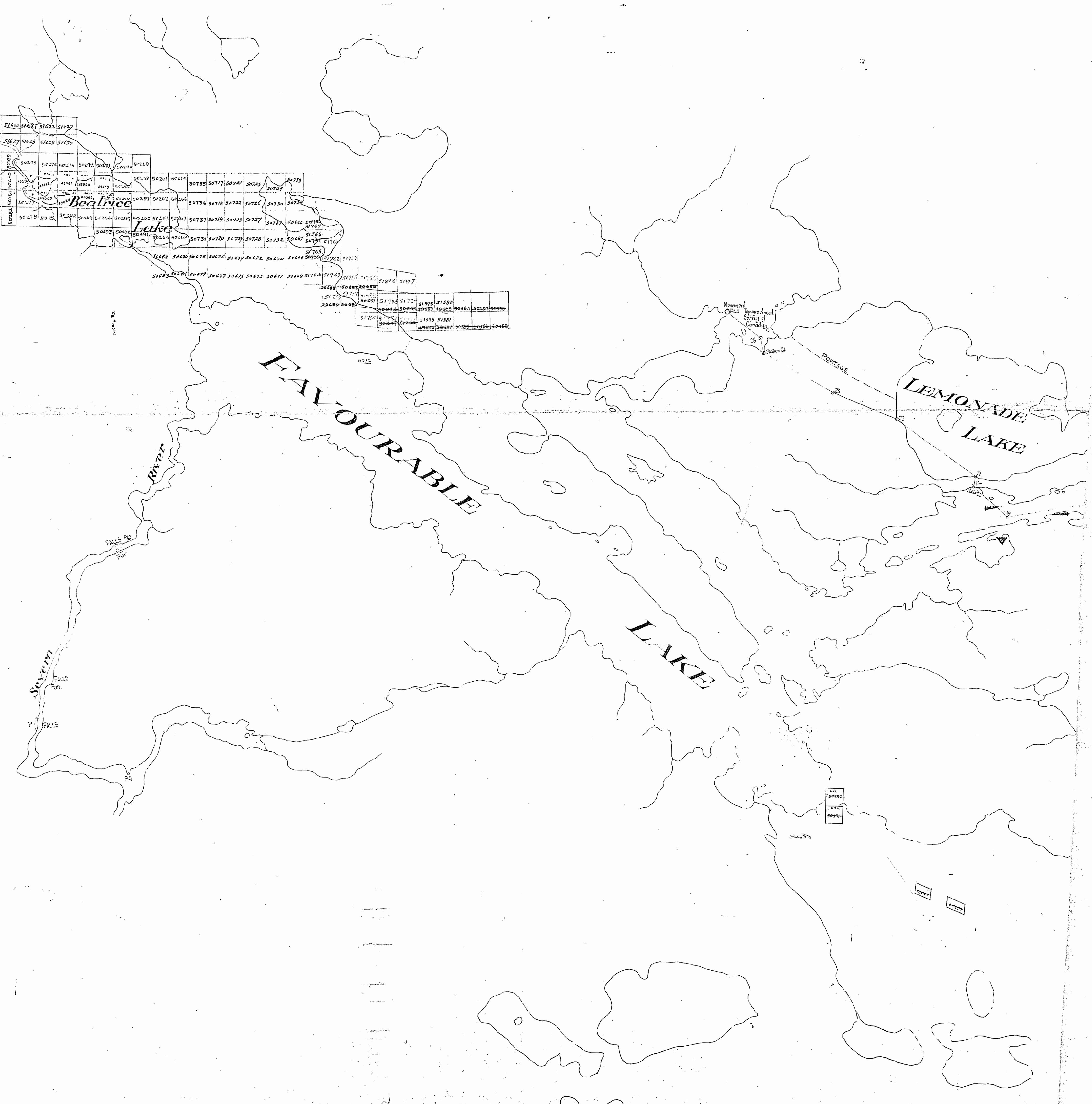

RED LAKE HINING DIVISION
 APR 6 1981
 RED LAKE, ONT.

FAVOURABLE LAKE AREA
 M-2161

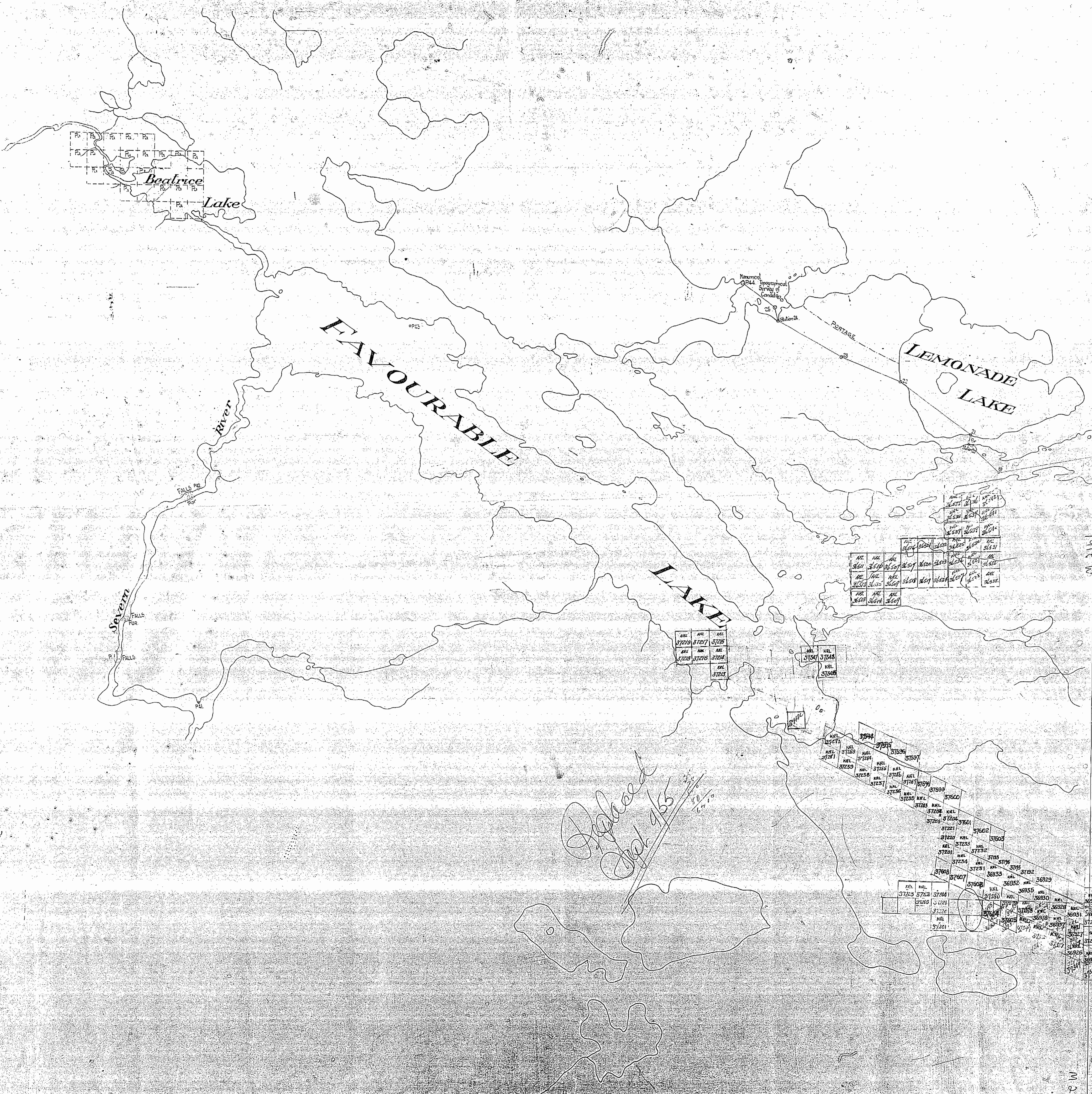

3718	3719	3720	3721	3722
3723	3724	3725	3726	3727
3728	3729	3730	3731	3732
3733	3734	3735	3736	3737
3738	3739	3740	3741	3742
3743	3744	3745	3746	3747
3748	3749	3750	3751	3752
3753	3754	3755	3756	3757
3758	3759	3760	3761	3762
3763	3764	3765	3766	3767
3768	3769	3770	3771	3772
3773	3774	3775	3776	3777
3778	3779	3780	3781	3782
3783	3784	3785	3786	3787
3788	3789	3790	3791	3792
3793	3794	3795	3796	3797
3798	3799	3800	3801	3802
3803	3804	3805	3806	3807
3808	3809	3810	3811	3812
3813	3814	3815	3816	3817
3818	3819	3820	3821	3822
3823	3824	3825	3826	3827
3828	3829	3830	3831	3832
3833	3834	3835	3836	3837
3838	3839	3840	3841	3842
3843	3844	3845	3846	3847
3848	3849	3850	3851	3852
3853	3854	3855	3856	3857
3858	3859	3860	3861	3862
3863	3864	3865	3866	3867
3868	3869	3870	3871	3872
3873	3874	3875	3876	3877
3878	3879	3880	3881	3882
3883	3884	3885	3886	3887
3888	3889	3890	3891	3892
3893	3894	3895	3896	3897
3898	3899	3900	3901	3902
3903	3904	3905	3906	3907
3908	3909	3910	3911	3912
3913	3914	3915	3916	3917
3918	3919	3920	3921	3922
3923	3924	3925	3926	3927
3928	3929	3930	3931	3932
3933	3934	3935	3936	3937
3938	3939	3940	3941	3942
3943	3944	3945	3946	3947
3948	3949	3950	3951	3952
3953	3954	3955	3956	3957
3958	3959	3960	3961	3962
3963	3964	3965	3966	3967
3968	3969	3970	3971	3972
3973	3974	3975	3976	3977
3978	3979	3980	3981	3982
3983	3984	3985	3986	3987
3988	3989	3990	3991	3992
3993	3994	3995	3996	3997
3998	3999	4000	4001	4002

37219	37217	37215
37213	37211	37209
37207	37205	37203

37541	37543
37545	37547

36911	36913	36915	36917	36919
36921	36923	36925	36927	36929
36931	36933	36935	36937	36939
36941	36943	36945	36947	36949
36951	36953	36955	36957	36959
36961	36963	36965	36967	36969
36971	36973	36975	36977	36979
36981	36983	36985	36987	36989
36991	36993	36995	36997	36999

37594	37596	37598	37600	37602	37604	37606	37608	37610	37612	37614	37616	37618	37620	37622	37624	37626	37628	37630	37632	37634	37636	37638	37640	37642	37644	37646	37648	37650	37652	37654	37656	37658	37660	37662	37664	37666	37668	37670	37672	37674	37676	37678	37680	37682	37684	37686	37688	37690	37692	37694	37696	37698	37700	37702	37704	37706	37708	37710	37712	37714	37716	37718	37720	37722	37724	37726	37728	37730	37732	37734	37736	37738	37740	37742	37744	37746	37748	37750	37752	37754	37756	37758	37760	37762	37764	37766	37768	37770	37772	37774	37776	37778	37780	37782	37784	37786	37788	37790	37792	37794	37796	37798	37800	37802	37804	37806	37808	37810	37812	37814	37816	37818	37820	37822	37824	37826	37828	37830	37832	37834	37836	37838	37840	37842	37844	37846	37848	37850	37852	37854	37856	37858	37860	37862	37864	37866	37868	37870	37872	37874	37876	37878	37880	37882	37884	37886	37888	37890	37892	37894	37896	37898	37900	37902	37904	37906	37908	37910	37912	37914	37916	37918	37920	37922	37924	37926	37928	37930	37932	37934	37936	37938	37940	37942	37944	37946	37948	37950	37952	37954	37956	37958	37960	37962	37964	37966	37968	37970	37972	37974	37976	37978	37980	37982	37984	37986	37988	37990	37992	37994	37996	37998	38000
-------	-------	-------	-------	-------	-------	-------	-------	-------	-------	-------	-------	-------	-------	-------	-------	-------	-------	-------	-------	-------	-------	-------	-------	-------	-------	-------	-------	-------	-------	-------	-------	-------	-------	-------	-------	-------	-------	-------	-------	-------	-------	-------	-------	-------	-------	-------	-------	-------	-------	-------	-------	-------	-------	-------	-------	-------	-------	-------	-------	-------	-------	-------	-------	-------	-------	-------	-------	-------	-------	-------	-------	-------	-------	-------	-------	-------	-------	-------	-------	-------	-------	-------	-------	-------	-------	-------	-------	-------	-------	-------	-------	-------	-------	-------	-------	-------	-------	-------	-------	-------	-------	-------	-------	-------	-------	-------	-------	-------	-------	-------	-------	-------	-------	-------	-------	-------	-------	-------	-------	-------	-------	-------	-------	-------	-------	-------	-------	-------	-------	-------	-------	-------	-------	-------	-------	-------	-------	-------	-------	-------	-------	-------	-------	-------	-------	-------	-------	-------	-------	-------	-------	-------	-------	-------	-------	-------	-------	-------	-------	-------	-------	-------	-------	-------	-------	-------	-------	-------	-------	-------	-------	-------	-------	-------	-------	-------	-------	-------	-------	-------	-------	-------	-------	-------	-------	-------	-------	-------	-------	-------	-------	-------	-------	-------	-------	-------	-------	-------	-------	-------	-------	-------	-------

*Placed
Oct 9/5*

M 216

M 2161

2881

Favourable Lake (North part) - M.2880

AREA OF
FAVOURABLE LAKE
SOUTH PART

DISTRICT OF
KENORA
PATRICIA PORTION

RED LAKE
MINING DIVISION

SCALE: 1-INCH = 40 CHAINS

LEGEND

- PATENTED LAND Ⓟ
- CROWN LAND SALE C.S.
- LEASES Ⓛ
- LOCATED LAND Loc.
- LICENSE OF OCCUPATION L.O.
- MINING RIGHTS ONLY M.R.O.
- SURFACE RIGHTS ONLY S.R.O.
- ROADS —
- IMPROVED ROADS —
- KING'S HIGHWAYS —
- RAILWAYS —
- POWER LINES —
- MARSH OR MUSKEG —
- MINES ⚡
- CANCELLED C

NOTES

400' Surface Rights Reservation around
all lakes and rivers

M.2199

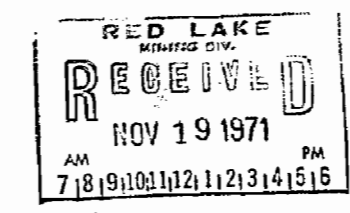

NATIONAL TOPOGRAPHIC SERIES 53 C

PLAN NO. M.2881

ONTARIO
DEPARTMENT OF MINES
AND NORTHERN AFFAIRS

527934

South of Borland Lake - M.2882

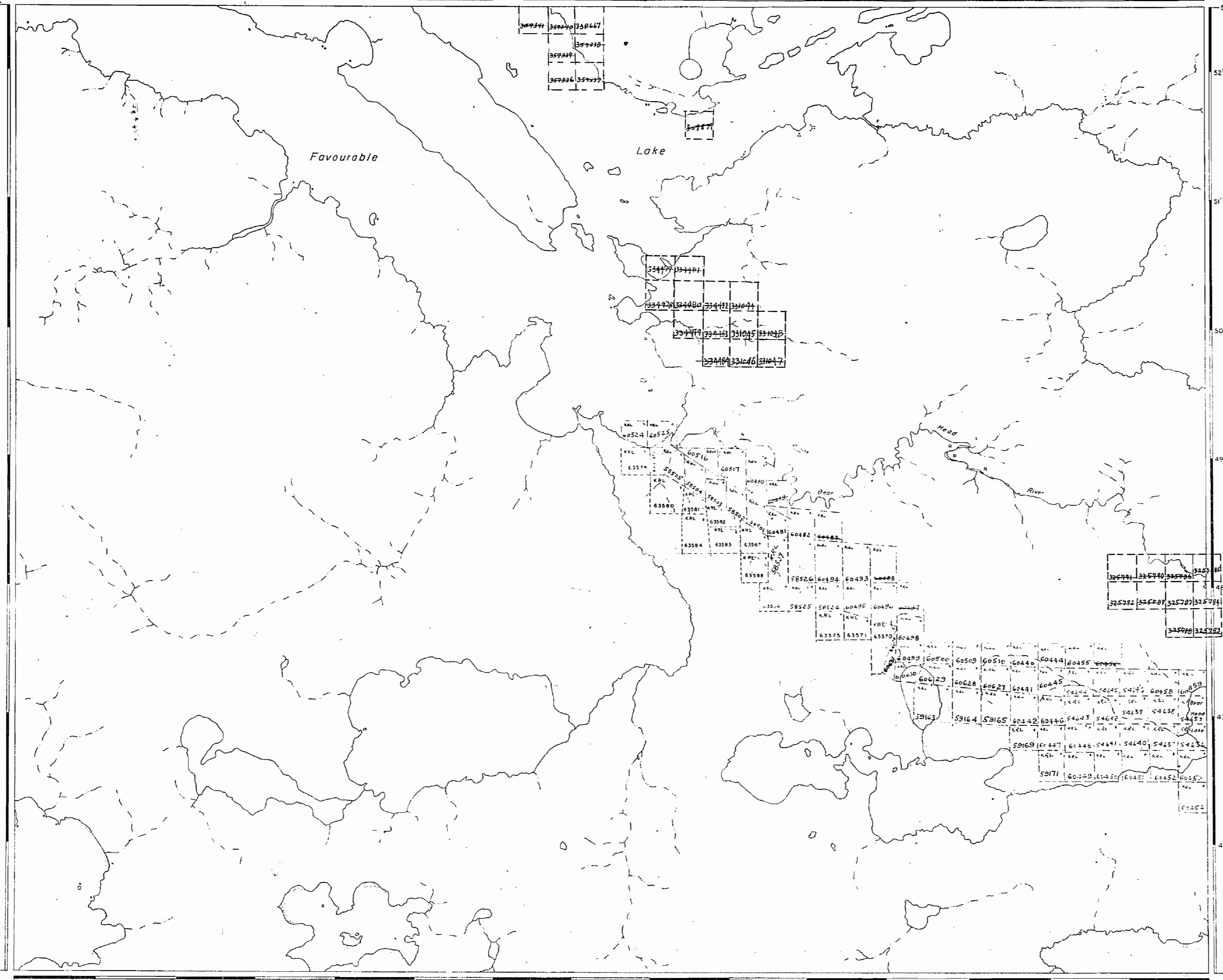

2881

Favourable Lake (North part) - M.2880

AREA OF

FAVOURABLE LAKE SOUTH PART

DISTRICT OF KENORA
PATRICIA PORTION

RED LAKE MINING DIVISION

SCALE: 1-INCH = 40 CHAINS

LEGEND

- PATENTED LAND Ⓢ
- CROWN LAND SALE C.S.
- LEASES Ⓛ
- LOCATED LAND Loc.
- LICENSE OF OCCUPATION L.O.
- MINING RIGHTS ONLY M.R.O.
- SURFACE RIGHTS ONLY S.R.O.
- ROADS — — — — —
- IMPROVED ROADS — — — — —
- KING'S HIGHWAYS — — — — —
- RAILWAYS — — — — —
- POWER LINES — — — — —
- MARSH OR MUSKEG — — — — —
- MINES Ⓜ
- CANCELLED C.

NOTES

400' Surface Rights Reservation around all lakes and rivers.

South of Borland Lake - M.2882

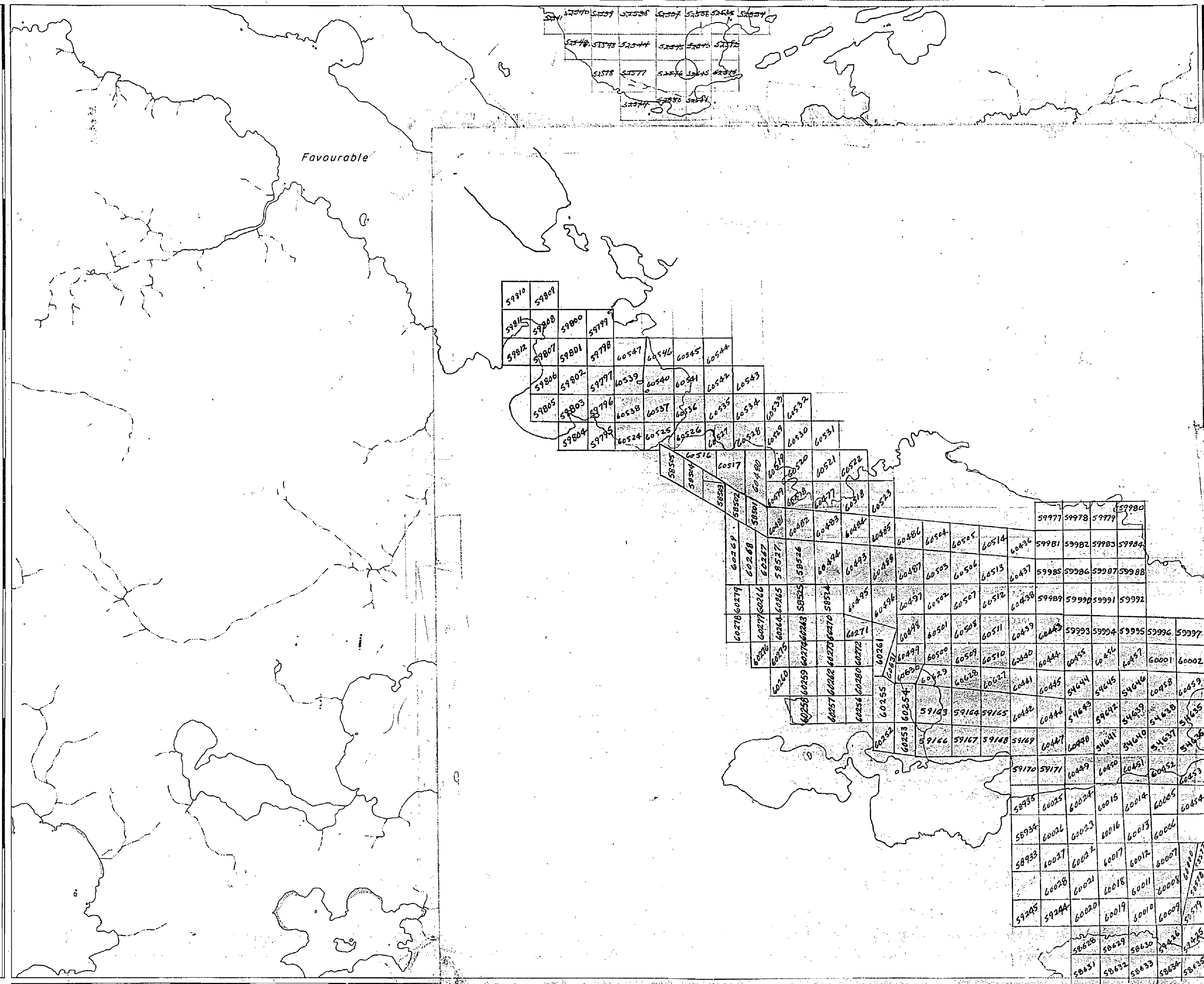

Apr 20/1963

PLAN NO. M.2881

DEPARTMENT OF MINES
— ONTARIO —

AREA OF
**FAVOURABLE LAKE
SOUTH PART**

DISTRICT OF
KENORA
PATRICIA PORTION

RED LAKE
MINING DIVISION

SCALE: 1-INCH = 40 CHAINS

LEGEND

- PATENTED LAND Ⓟ
- CROWN LAND SALE C.S.
- LEASES Ⓞ
- LOCATED LAND Loc.
- LICENSE OF OCCUPATION L.O.
- MINING RIGHTS ONLY M.R.O.
- SURFACE RIGHTS ONLY S.R.O.
- ROADS —
- IMPROVED ROADS —
- KING'S HIGHWAYS —
- RAILWAYS —
- POWER LINES —
- MARSH OR MUSKIEG —
- MINES ⚡
- CANCELLED C.

NOTES

400' Surface Rights Reservation around
all lakes and rivers.

South of Borland Lake - M.2882

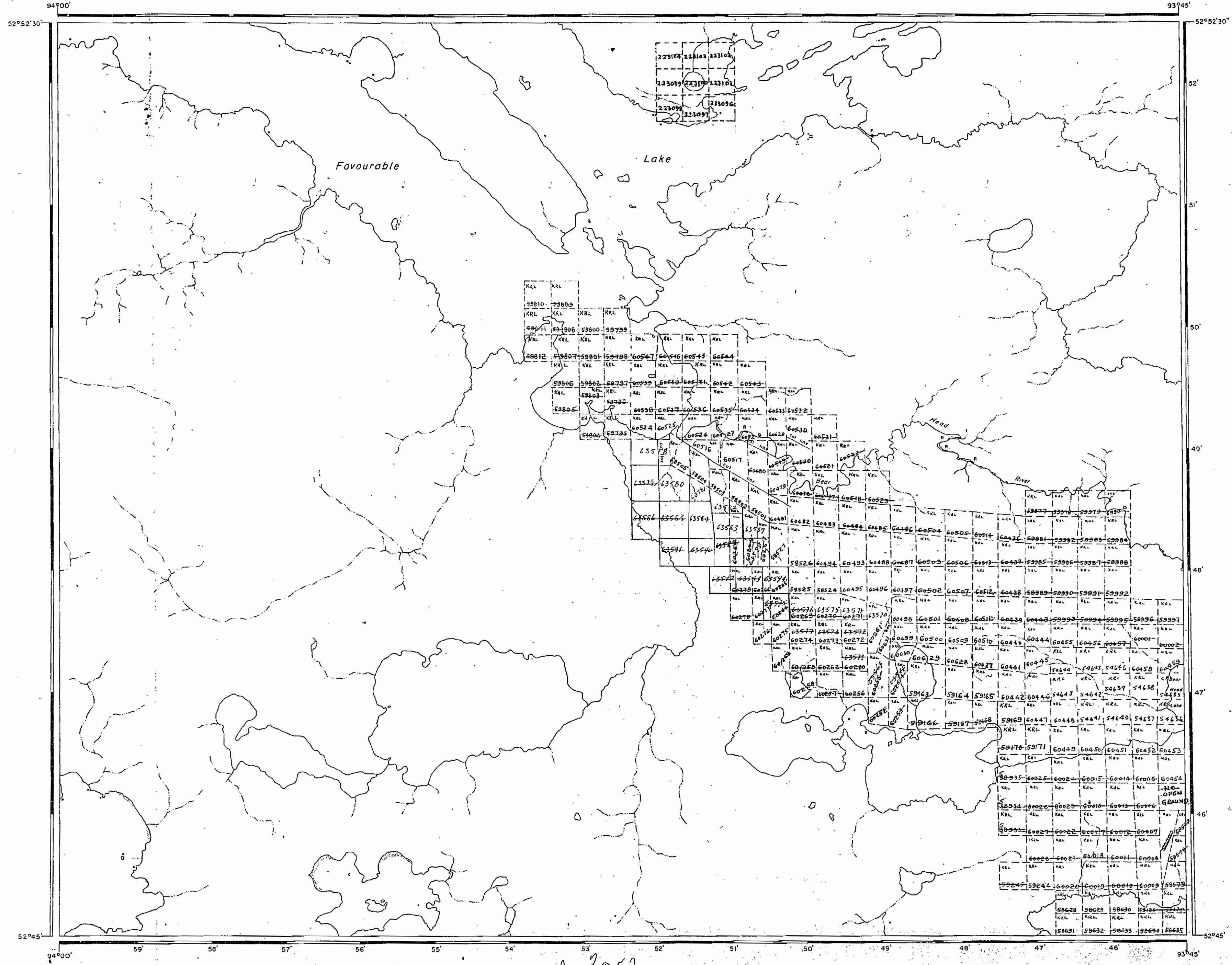

M 2199

M 3052

PLAN NO. **M.2881**

DEPARTMENT OF MINES

— ONTARIO —

2199

Favourable Lake (North part) - M.2880

AREA OF
FAVOURABLE LAKE
SOUTH PART

DISTRICT OF
KENORA
PATRICIA, PORTION

RED LAKE
MINING DIVISION

SCALE: 1-INCH = 40-CHAINS

LEGEND

- PATENTED LAND Ⓢ
- CROWN LAND SALE C.S.
- LEASES L.
- LOCATED LAND Loc.
- LICENSE OF OCCUPATION L.O.
- MINING RIGHTS ONLY M.R.O.
- SURFACE RIGHTS ONLY S.R.O.
- ROADS —
- IMPROVED ROADS —
- KING'S HIGHWAYS —
- RAILWAYS —
- POWER LINES —
- MARSH OR MUSKEG —
- MINES *
- CANCELLED C.

NOTES

400' Surface Rights Reservation around all lakes and rivers.

REG. MINING
REG.
 14H-2 5 1977
 AM 7 18 9 10 11 12 1 2 3 4 5 6 PM



NATIONAL TOPOGRAPHIC SERIES 53 C

PLAN NO. **M.2881**

ONTARIO
MINISTRY OF NATURAL RESOURCES
SURVEYS AND MAPPING BRANCH

527934

South of Borland Lake - M.2882

