

AREA OF
FISHER LAKE
 DISTRICT OF
 KENORA
 KENORA
 MINING DIVISION
 SCALE: 1-INCH = 40 CHAINS

LEGEND

PATENTED LAND	(P)
CROWN LAND SALE	C5
LEASES	(L)
LOCATED LAND	Loc
LICENSE OF OCCUPATION	LO
MINING RIGHTS ONLY	MRO
SURFACE RIGHTS ONLY	SRO
ROADS	—
IMPROVED ROADS	—
KING'S HIGHWAYS	—
RAILWAYS	—
POWER LINES	—
MARSH OR MUSKEG	—
MINES	X
CANCELLED	C

NOTES
 400' Reserve around all lakes & rivers to
 Dept of Lands & Forests

July 16/1
Feb 11/19
March 7/07
May 5/07
Sept 21/71
Oct 18/71

RECEIVED
 OCT 17 1960
 KENORA MINING DIV.

PLAN NO. **M.2696**

DEPARTMENT OF MINES
 — ONTARIO —

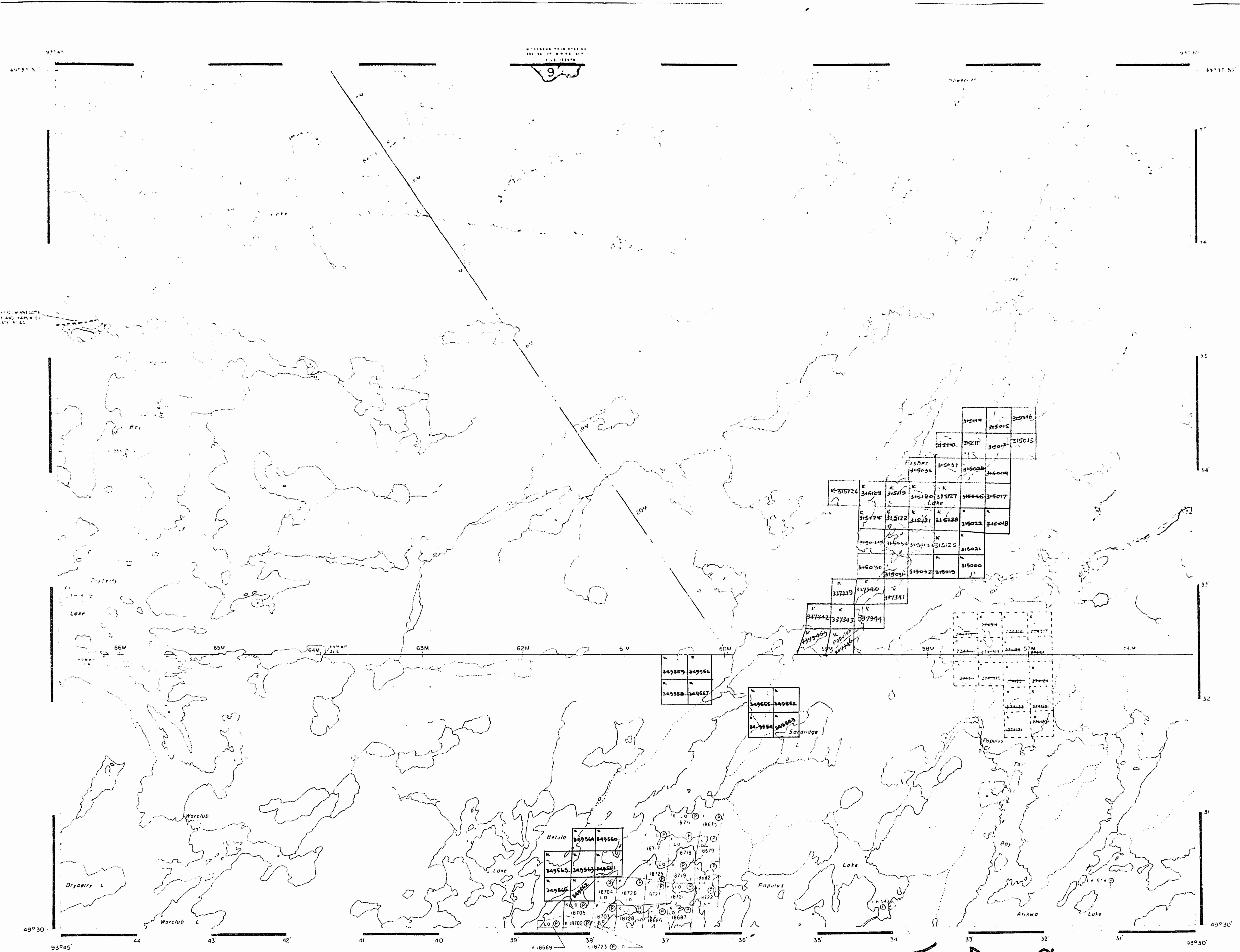

AREA OF
FISHER LAKE

DISTRICT OF
KENORA

KENORA
MINING DIVISION

SCALE: 1-INCH = 40 CHAINS

LEGEND

PATENTED LAND	CS
CROWN LAND SALE	CS
LEASES	LO
LOCATED LAND	LO
LICENSE OF OCCUPATION	LO
MINING RIGHTS ONLY	MRO
SURFACE RIGHTS ONLY	SRO
ROADS	
IMPROVED ROADS	
KING'S HIGHWAYS	
RAILWAYS	
POWER LINES	
MARSH OR MUSKEG	
MINES	
CANCELLED	

NOTES

400' Reserve around all lakes & rivers to Dept. of Lands & Forests

Roads indicated Ontario-Minnesota Pulp and Paper Co. are private roads but may be used by prospectors on after permission is obtained from the above mentioned Co. in Kenora.

KENORA
FILED
RECEIVED
RECEIPT NO.
MINING DIVISION

Sept 1/72
Oct 11/72
Oct 13/72
Nov 10/72
Feb 13/73
Sept 13/73
Oct 29/73
Apr 1/74
Apr 15/74

NATIONAL TOPOGRAPHIC SERIES 52 F 12

PLAN NO. **M.2696**

ONTARIO
DEPARTMENT OF MINES
AND NORTHERN AFFAIRS

Fisher Lake

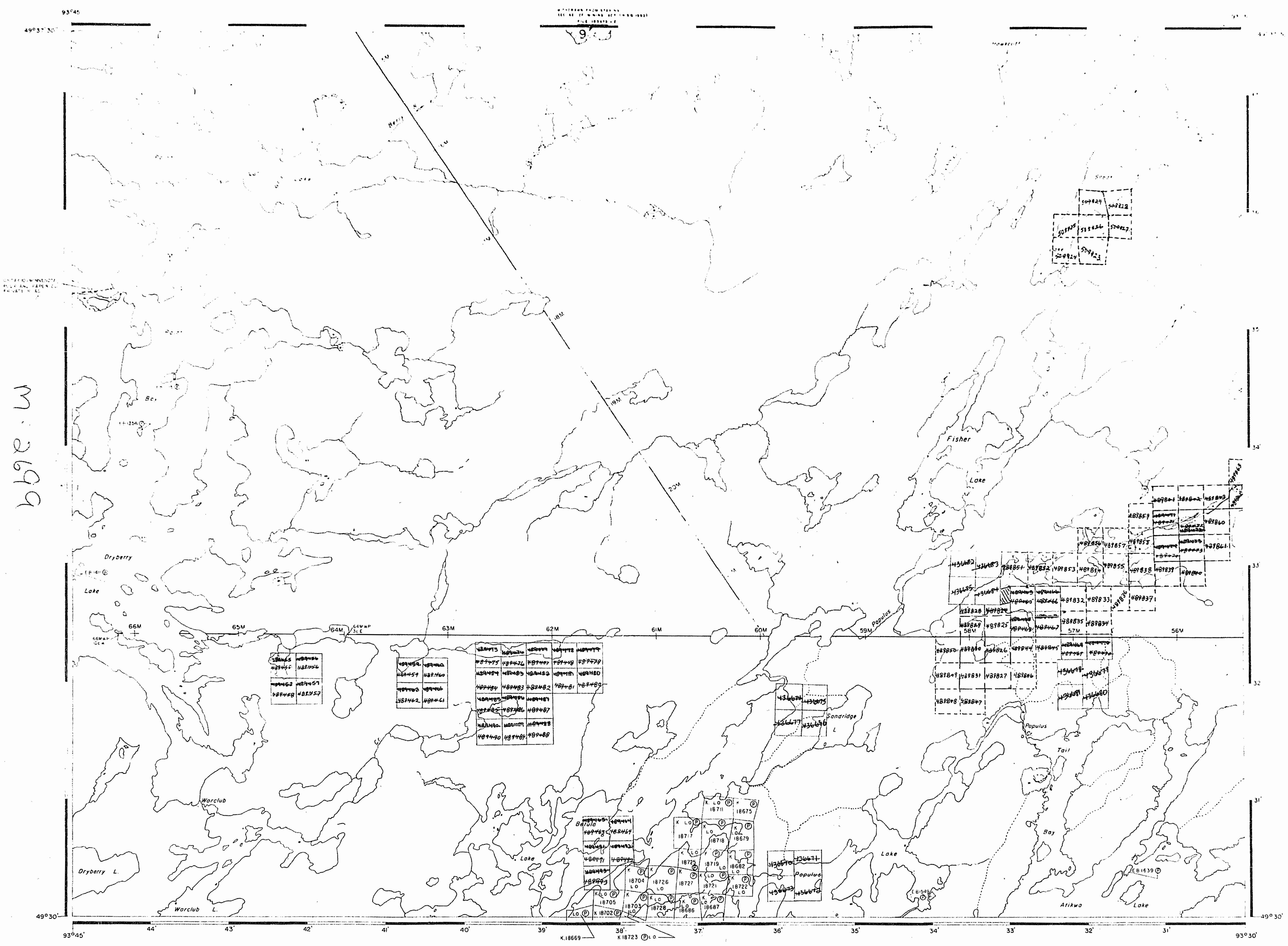

M. 2696

AREA OF
FISHER LAKE
 DISTRICT OF
 KENORA
 MINING DIVISION
 SCALE: 1-INCH = 40 CHAINS

LEGEND

PATENTED LAND	CS
CROWN LAND SALE	CS
LEASES	Loc
LOCATED LAND	LO
LICENSE OF OCCUPATION	MRO
MINING RIGHTS ONLY	SRO
SURFACE RIGHTS ONLY	SRO
ROADS	—
IMPROVED ROADS	—
KING'S HIGHWAYS	—
RAILWAYS	—
POWER LINES	—
MARSH OR MUSKEG	—
MINES	⊗
CANCELLED	C

NOTES

400' Reserve around all lakes & rivers to Dept of Lands & Forests.

ROADS INDICATED ONTARIO-MINNESOTA PULP AND PAPER CO ARE PRIVATE ROADS BUT MAY BE USED BY INSPECTORS ON AFTER PERMISSION IS OBTAINED FROM THE ABOVE MENTIONED CO IN KENORA

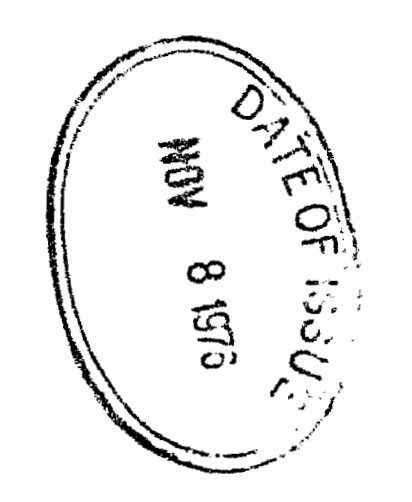
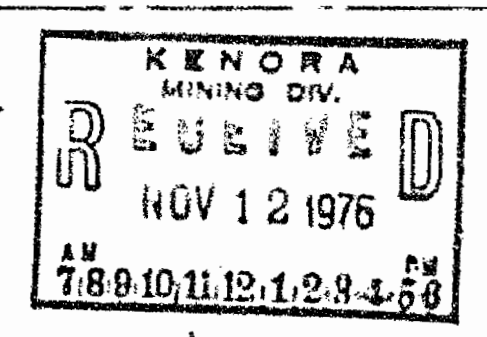

#1

NATIONAL TOPOGRAPHIC SERIES 52 F12
PLAN NO. M.2696
 MINISTRY OF NATURAL RESOURCES
 SURVEYS AND MAPPING BRANCH

485933

FISHER LK

WITHDRAWN FROM STAKING
SEC. 42 OF MINING ACT (R.S.O. 1980)
FILE 18472-1-2

AREA OF
FISHER LAKE
DISTRICT OF
KENORA
KENORA
MINING DIVISION
SCALE: 1-INCH = 40 CHAINS

LEGEND

- PATENTED LAND Ⓢ
- CROWN LAND SALE C.S.
- LEASES Ⓞ
- LOCATED LAND Loc.
- LICENSE OF OCCUPATION L.O.
- MINING RIGHTS ONLY M.R.O.
- SURFACE RIGHTS ONLY S.R.O.
- ROADS —
- IMPROVED ROADS —
- KING'S HIGHWAYS —
- RAILWAYS —
- POWER LINES —
- MARSH OR MUSKEG —
- MINES —
- CANCELLED —

NOTES

400' Reserve around all lakes & rivers is Dept. of Lands & Forests.

ROADS INDICATED ON TARIO-MINNESOTA PULP AND PAPER CO. ARE PRIVATE ROADS BUT MAY BE USED BY PROSPECTORS ONLY AFTER PERMISSIONS OBTAINED FROM THE ABOVE MENTIONED CO. IN KENORA.

DATE OF ISSUE
JUL 10 1981

Kenora Mining Division
Toronto

RECEIVED
JUL 22 1981

AM 7 8 9 10 11 12 1 2 3 4 5 6 PM #2

NATIONAL TOPOGRAPHIC SERIES 52-E12

PLAN NO. **M.2696**

ONTARIO
MINISTRY OF NATURAL RESOURCES
SURVEYS AND MAPPING BRANCH

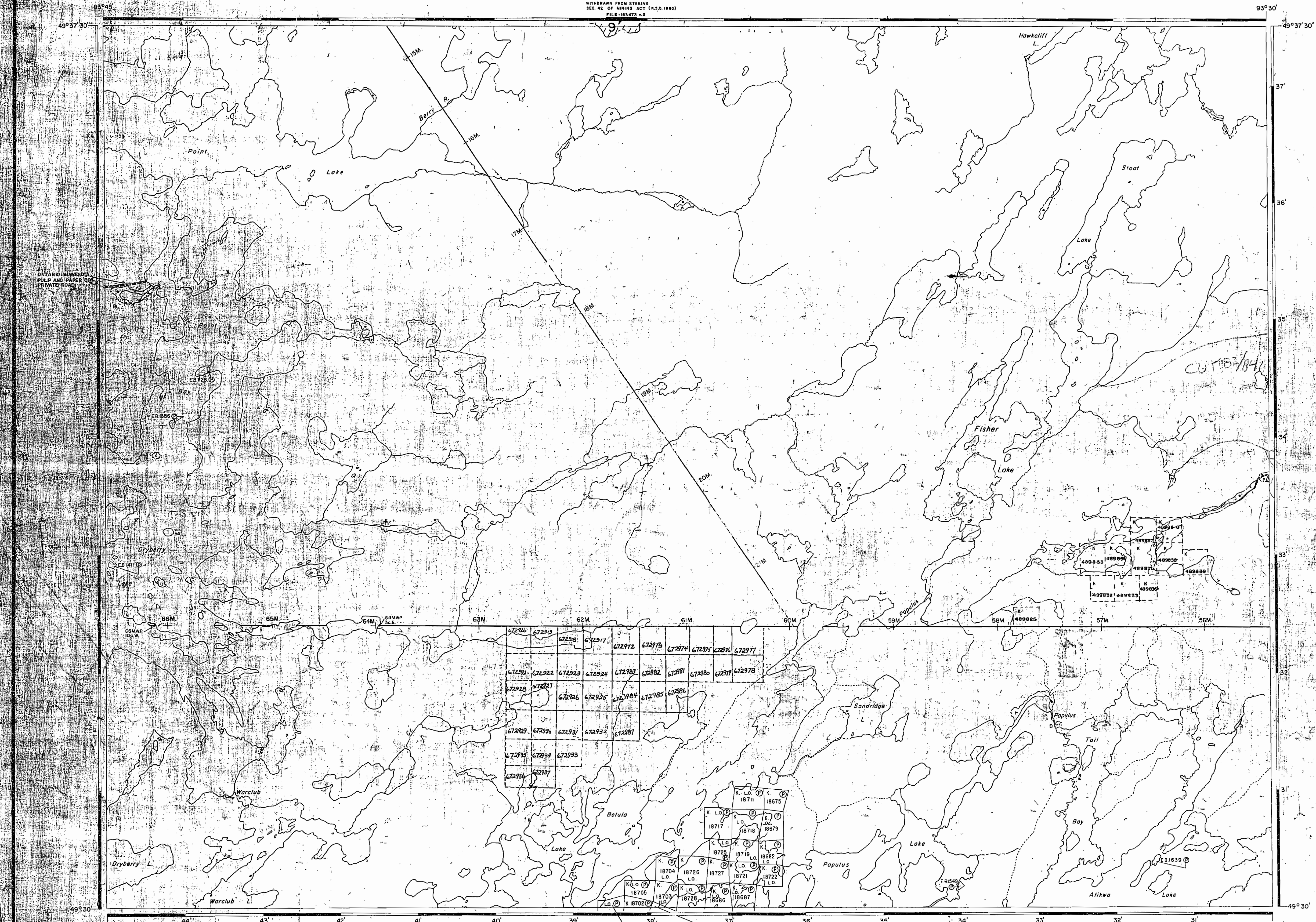

62594 TEGGAJ LAKE

WITHDRAWN FROM STAMPS
SEC. 42 OF MINING ACT (R.S.O. 1960)
FILE 183473-1

LEGEND

- HIGHWAY AND ROUTE No.
- OTHER ROADS
- TRAILS
- SURVEYED LINES:
 - TOWNSHIPS, BASE LINES, ETC.
 - LOTS, MINING CLAIMS, PARCELS, ETC.
- UNSURVEYED LINES:
 - LOT LINES
 - PARCEL BOUNDARY
 - MINING CLAIMS ETC.
- RAILWAY AND RIGHT OF WAY
- UTILITY LINES
- NON-PERENNIAL STREAM
- FLOODING OR FLOODING RIGHTS
- SUBDIVISION OR COMPOSITE PLANS
- RESERVATIONS
- ORIGINAL SHORELINE
- MARSH OR MUSKEG
- MINES
- TRAVERSE MONUMENT
- TOURIST CAMPS

DISPOSITION OF CROWN LANDS

TYPE OF DOCUMENT	SYMBOL
PATENT, SURFACE & MINING RIGHTS	
SURFACE RIGHTS ONLY	
MINING RIGHTS ONLY	
LEASE, SURFACE & MINING RIGHTS	
SURFACE RIGHTS ONLY	
MINING RIGHTS ONLY	
LICENCE OF OCCUPATION	
ORDER-IN-COUNCIL	
RESERVATION	
CANCELLED	
SAND & GRAVEL	

NOTE: MINING RIGHTS IN PARCELS PATENTED PRIOR TO MAY 6, 1913, VESTED IN ORIGINAL PATENTEES BY THE PUBLIC LANDS ACT, R.S.O. 1970, CHAP. 320, SEC. 63, SUBSEC. 1.

REFERENCES

AREAS WITHDRAWN FROM DISPOSITION

- M.R.O. - MINING RIGHTS ONLY
- S.R.O. - SURFACE RIGHTS ONLY
- M. + S. - MINING AND SURFACE RIGHTS

Description	Order No.	Date	Disposition	File

THE INFORMATION THAT APPEARS ON THIS MAP HAS BEEN COMPILED FROM VARIOUS SOURCES AND ACCURACY IS NOT GUARANTEED. THOSE WISHING TO STAKE MINING CLAIMS SHOULD CONSULT WITH THE MINING RECORDER, MINISTRY OF NORTHERN DEVELOPMENT AND MINES FOR ADDITIONAL INFORMATION ON THE STATUS OF THE LANDS SHOWN HEREON.

DATE OF ISSUE

SEP 24 1988

PROVINCIAL RECORDING
ROADS INDICATED ON THIS MAP ARE PRIVATE ROADS, BUT MAY BE USED BY PROSPECTORS ONLY AFTER PERMISSION IS OBTAINED FROM THE ABOVE MENTIONED CO. IN KENORA.

SCALE: 1 INCH = 40 CHAINS

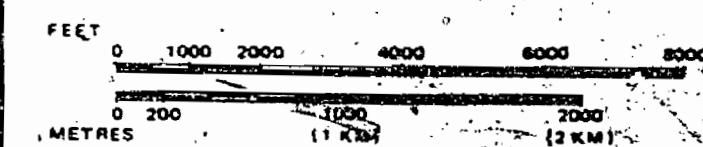

AREA
FISHER LAKE
M.N.R. ADMINISTRATIVE DISTRICT
KENORA / DRYDEN
MINING DIVISION
KENORA
LAND TITLES / REGISTRY DIVISION
KENORA

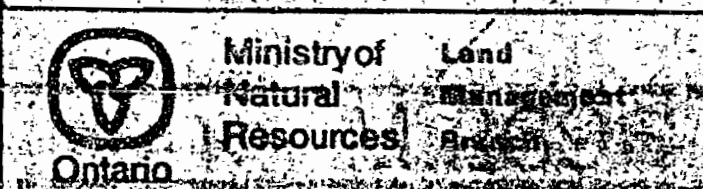

Date FEBRUARY 1989
G-2617

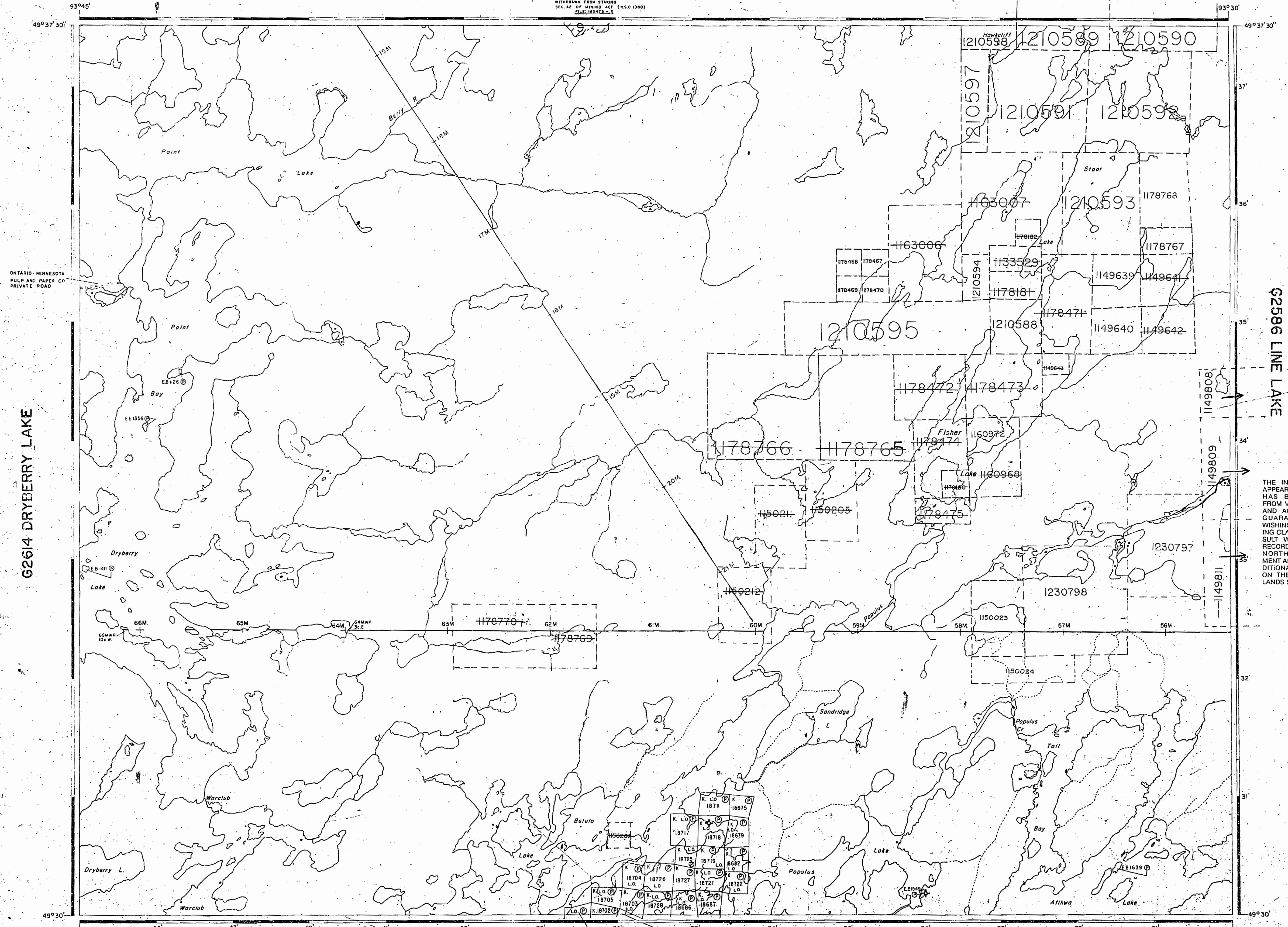

62603 ATIKWA LAKE

62614 DRYBERRY LAKE

62586 LINE LAKE

AREA OF

FISHER LAKE

DISTRICT OF
KENORA

KENORA
MINING DIVISION

SCALE: 1-INCH = 40 CHAINS

LEGEND

PATENTED LAND	⊙
CROWN LAND SALE	C.S.
LEASES	⊖
LOCATED LAND	Loc.
LICENSE OF OCCUPATION	L.O.
MINING RIGHTS ONLY	M.R.O.
SURFACE RIGHTS ONLY	S.R.O.
ROADS	—
IMPROVED ROADS	—
KING'S HIGHWAYS	—
RAILWAYS	—
POWER LINES	—
MARSH OR MUSKEG	—
MINES	—
CANCELLED	C.

NOTES

400' Reserve around all lakes & rivers to
Dept. of Lands & Forests.

ROADS INDICATED ONTARIO-MINNESOTA PULP AND
PAPER CO. ARE PRIVATE ROADS BUT MAY BE USED
BY PROSPECTORS ONLY AFTER PERMISSION IS
OBTAINED FROM THE ABOVE MENTIONED CO IN
KENORA.

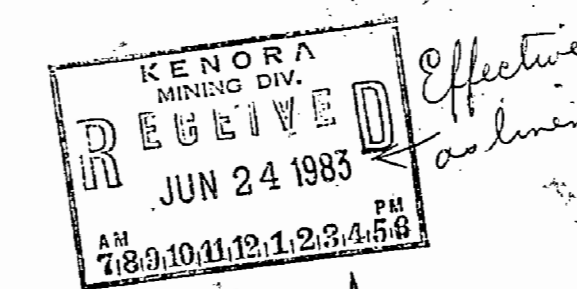

DATE OF ISSUE

JUN 17 1983

Ministry of Natural Resources
TORONTO

NATIONAL TOPOGRAPHIC SERIES 52 F12

PLAN NO. **M.2696**

ONTARIO
MINISTRY OF NATURAL RESOURCES
SURVEYS AND MAPPING BRANCH

495933

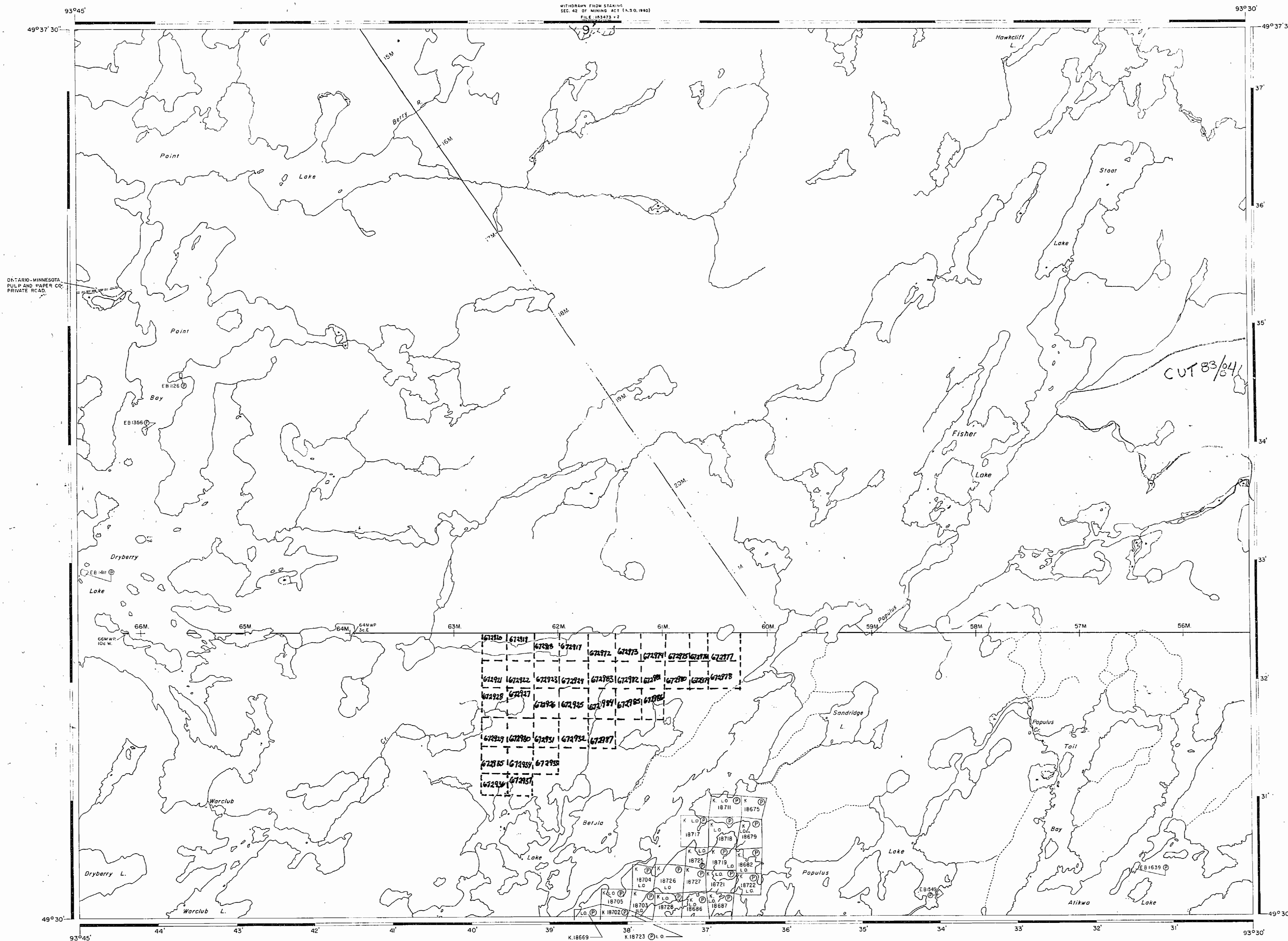

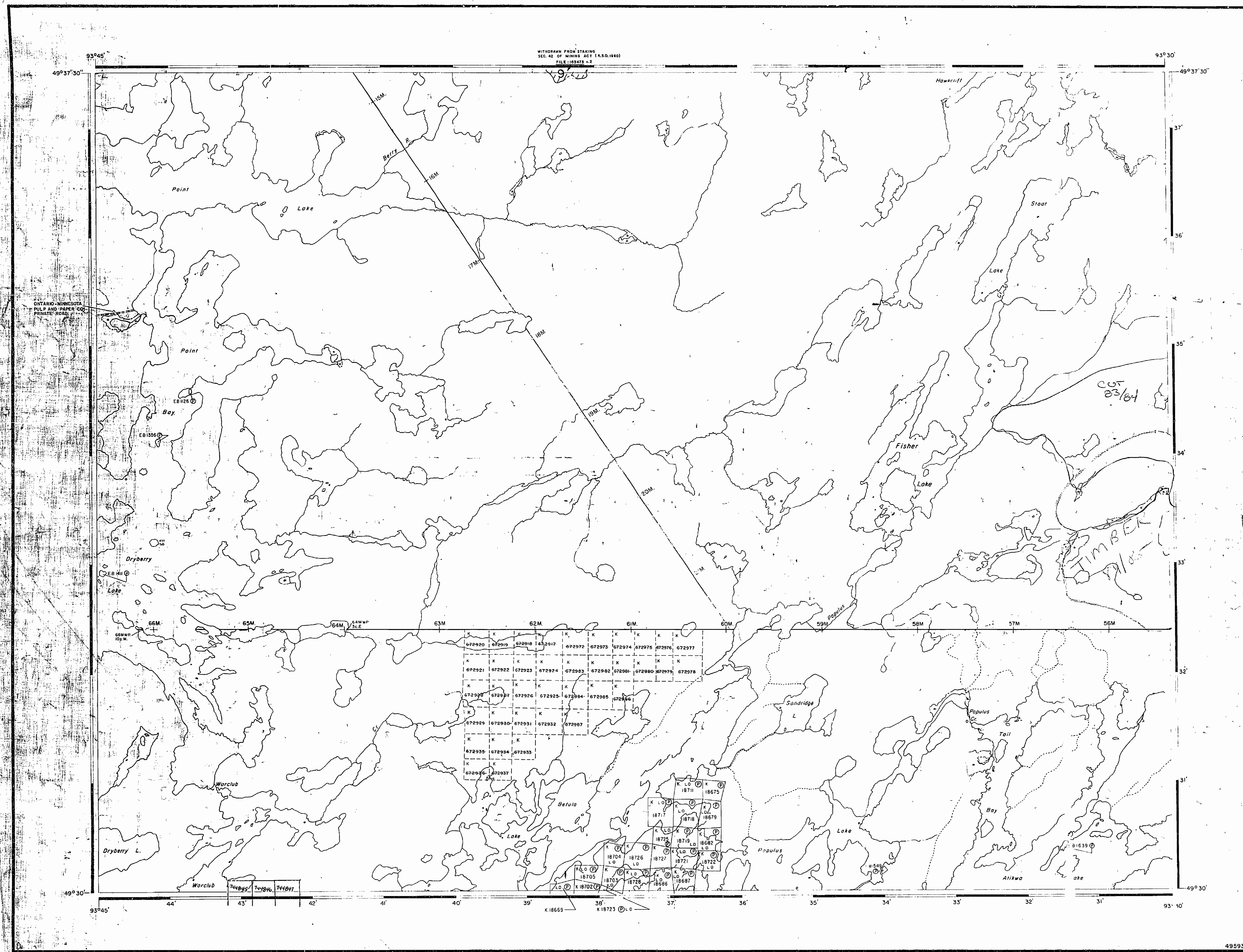

AREA OF
FISHER LAKE
 DISTRICT OF
 KENORA
 KENORA
 MINING DIVISION
 SCALE: 1-INCH = 40 CHAINS

LEGEND

PATENTED LAND	⊙
CROWN LAND SALE	⊙
LEASES	⊙
LOCATED LAND	⊙
LICENSE OF OCCUPATION	⊙
MINING RIGHTS ONLY	M.R.O.
SURFACE RIGHTS ONLY	S.R.O.
ROADS	—
IMPROVED ROADS	—
KING'S HIGHWAYS	—
RAILWAYS	—
POWER LINES	—
MARSH OR MUSKEG	—
MINES	—
CANCELLED	—

NOTES

400' Reserve around all lakes & rivers to Dept. of Lands & Forests.

ROADS INDICATED ONTARIO-MINNESOTA PULP AND PAPER CO. ARE PRIVATE ROADS BUT MAY BE USED BY PROSPECTORS ONLY AFTER PERMISSION IS OBTAINED FROM THE ABOVE MENTIONED CO. IN KENORA.

0210-741

RECORDED
 RECEIVED
 OFF 16 1983
 7:80.10.11.12.1.2.3

NATIONAL TOPOGRAPHIC SERIES 52 F 12
 PLAN NO. **M.2696**
 ONTARIO
 MINISTRY OF NATURAL RESOURCES
 SURVEYS AND MAPPING BRANCH

WITHDRAWN FROM STAMEN
SEC 42 OF MINES ACT
FILE 183425

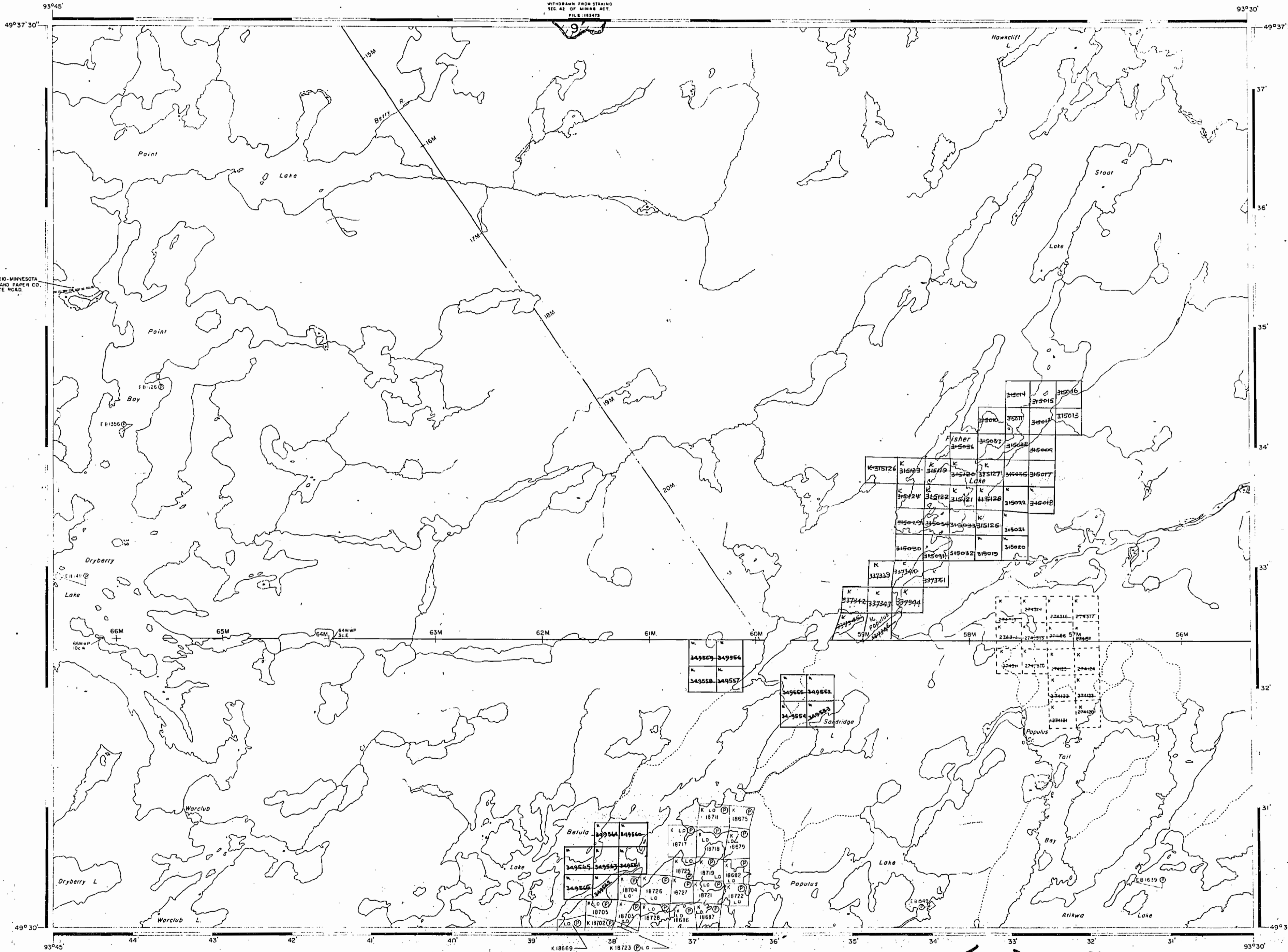

AREA OF
FISHER LAKE

DISTRICT OF
KENORA

KENORA
MINING DIVISION

SCALE: 1-INCH = 40 CHAINS

LEGEND

- PATENTED LAND Ⓟ
- CROWN LAND SALE C.S.
- LEASES Ⓞ
- LOCATED LAND Loc.
- LICENSE OF OCCUPATION L.O.
- MINING RIGHTS ONLY M.R.O.
- SURFACE RIGHTS ONLY S.R.O.
- ROADS —
- IMPROVED ROADS —
- KING'S HIGHWAYS —
- RAILWAYS —
- POWER LINES —
- MARSH OR MUSKOG —
- MINES Ⓜ
- CANCELLED C.

NOTES

400' Reserve around all lakes & rivers to Dept. of Lands & Forests.

ROADS INDICATED ONTARIO-MINNESOTA PULP AND PAPER CO. ARE PRIVATE ROADS BUT MAY BE USED BY PROSPECTORS ONLY AFTER PERMISSION IS OBTAINED FROM THE ABOVE MENTIONED CO IN KENORA.

KENORA

FILED:
REC'D. DEC - 7 1971
RECEIPT No.
MINING DIVISION

Sept 1/72
Oct. 11/72
Oct. 13/72
Nov. 10/72
Feb 13/73
Sept. 12/73
Oct. 29/73
Mar. 13/74
Sept. 10/74

NATIONAL TOPOGRAPHIC SERIES 52 F 12

PLAN NO. **M.2696**

ONTARIO
DEPARTMENT OF MINES
AND NORTHERN AFFAIRS

Fisher Lake

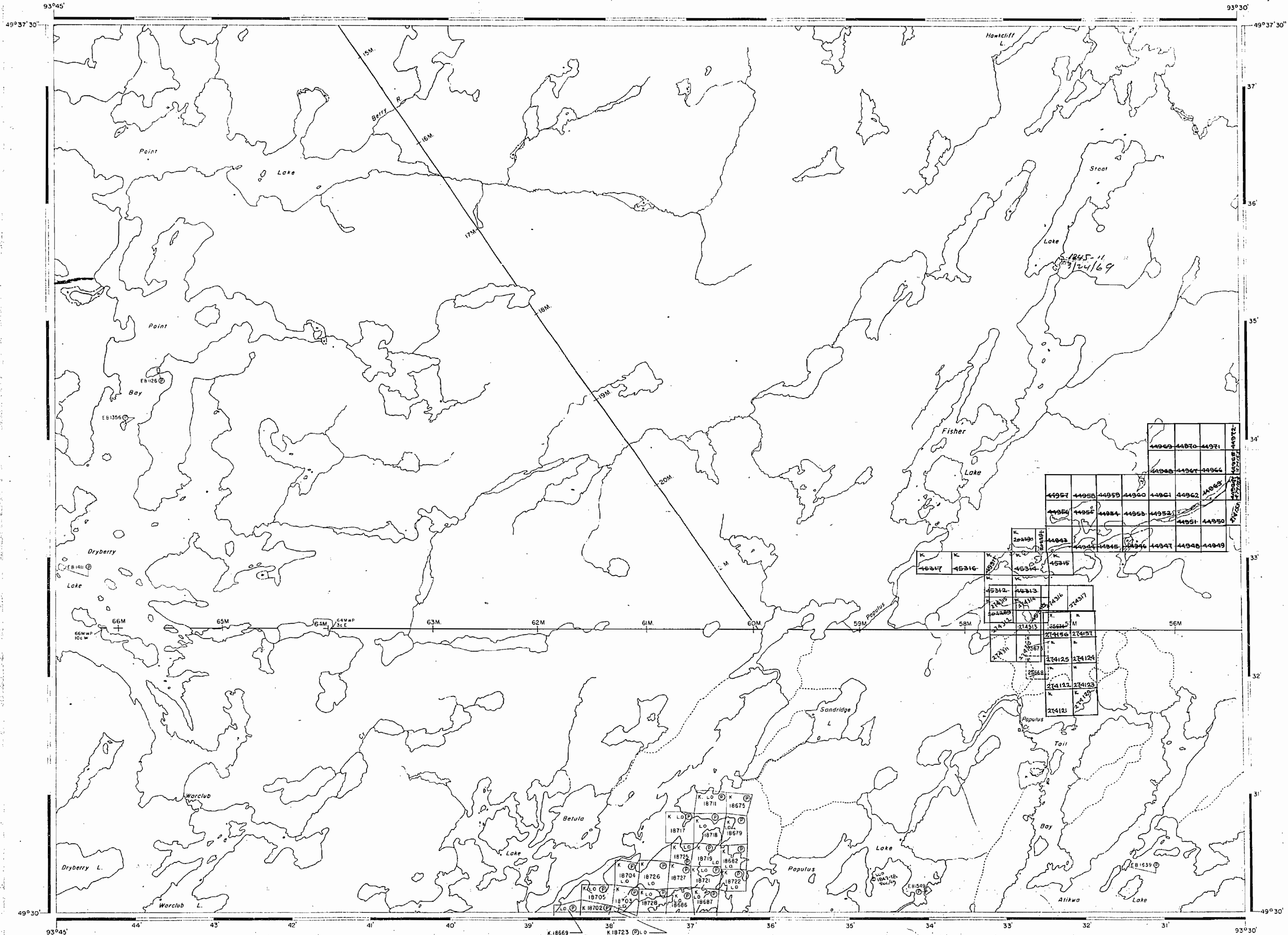

AREA OF
FISHER LAKE
 DISTRICT OF
 KENORA
 KENORA
 MINING DIVISION
 SCALE: 1-INCH = 40 CHAINS

LEGEND

- PATENTED LAND Ⓟ
- CROWN LAND SALE Ⓢ
- LEASES Ⓛ
- LOCATED LAND Ⓛoc
- LICENSE OF OCCUPATION L.O.
- MINING RIGHTS ONLY M.R.O.
- SURFACE RIGHTS ONLY S.R.O.
- ROADS —
- IMPROVED ROADS —
- KING'S HIGHWAYS —
- RAILWAYS —
- POWER LINES —
- MARSH OR MUSKEG —
- MINES *
- CANCELLED C.

NOTES

400' Reserve around all lakes & rivers to
 Dept. of Lands & Forests.

July 5/61
FEB 11 1869
March 7/69
May 5/70
July 15/70
Sept 21/71
Oct 25/71



PLAN NO. **M.2696**

DEPARTMENT OF MINES
 — ONTARIO —

TWP 39

TWP 38

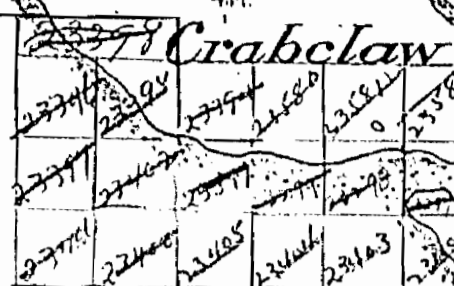

Crabclaw Lake

Lake

Eagle Lake

Northwest Arm

Teggau Lake

Lake

749

1729

Blind Bay

Brook

Hawkcliff Lake

Diskegamang

Lake

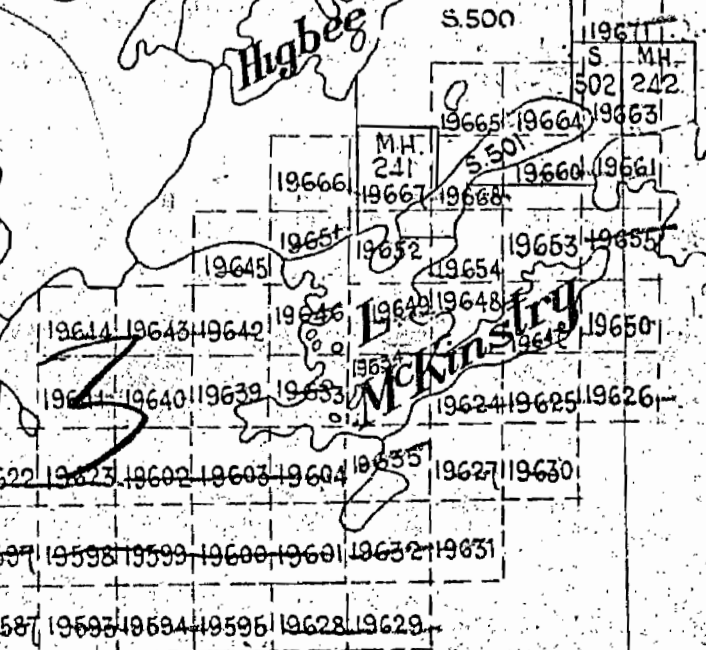
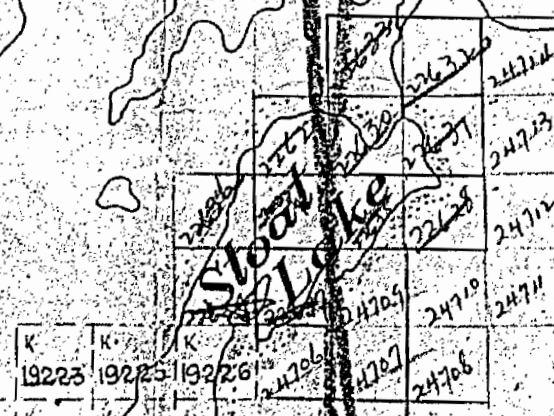

17M

16C37

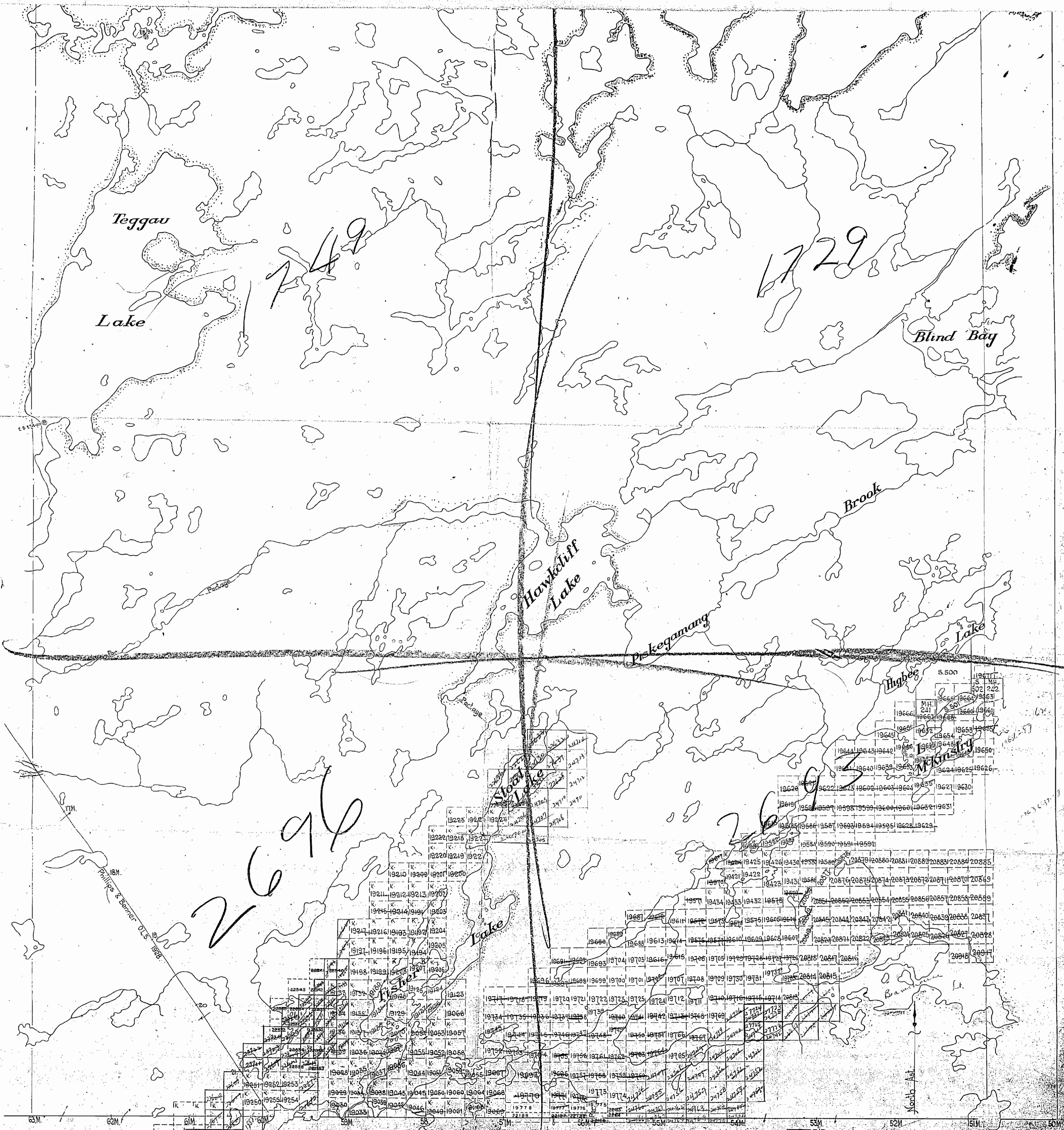

63M. 62M. 61M. 60M. 59M. 58M. 57M. 56M. 55M. 54M. 53M. 52M. 51M. 50M.

KENORA LAKE MG. DIV.
Scale: 40 Chains = 1 Inch

reservations 400 wide by Dept of L & F 500000
This reservation to apply to all
The shorelines of all islands lying within the 200
defined above.

Map 2046

G2594 TEGGAU LAKE.

WITHDRAWN FROM STAKES
SEC. 42 OF MINING ACT (R.S.O. 1960)
FILE 183413-1-1

LEGEND

- HIGHWAY AND ROUTE No.
- OTHER ROADS
- TRAILS
- SURVEYED LINES:
 - TOWNSHIPS, BASE LINES, ETC.
 - LOTS, MINING CLAIMS, PARCELS, ETC.
- UNSURVEYED LINES:
 - LOT LINES
 - PARCEL BOUNDARY
 - MINING CLAIMS ETC.
- RAILWAY AND RIGHT OF WAY
- UTILITY LINES
- NON-PERENNIAL STREAM
- FLOODING OR FLOODING RIGHTS
- SUBDIVISION OR COMPOSITE CLAIM
- RESERVATIONS
- ORIGINAL SHORELINE
- MARSH OR MUSKEG
- MINES
- TRAVERSE MONUMENT
- TOURIST CAMPS

DISPOSITION OF CROWN LANDS

TYPE OF DOCUMENT	SYMBOL
PATENT, SURFACE & MINING RIGHTS	
" SURFACE RIGHTS ONLY	
" MINING RIGHTS ONLY	
LEASE, SURFACE & MINING RIGHTS	
" SURFACE RIGHTS ONLY	
" MINING RIGHTS ONLY	
LICENCE OF OCCUPATION	
ORDER-IN-COUNCIL	
RESERVATION	
CANCELLED	
SAND & GRAVEL	

NOTE: MINING RIGHTS IN PARCELS PATENTED PRIOR TO MAY 6, 1913, VESTED IN ORIGINAL PATENTEES BY THE PUBLIC LANDS ACT, R.S.O. 1970, CHAP. 200, SEC. 63, SUBSEC. 1.

REFERENCES

AREAS WITHDRAWN FROM DISPOSITION

- M.R.O. - MINING RIGHTS ONLY
- S.R.O. - SURFACE RIGHTS ONLY
- M.+S. - MINING AND SURFACE RIGHTS

Description	Order No.	Date	Disposition	File

THE INFORMATION THAT APPEARS ON THIS MAP HAS BEEN COMPILED FROM VARIOUS SOURCES, AND ACCURACY IS NOT GUARANTEED. THOSE WISHING TO STAKE MINING CLAIMS SHOULD CONSULT WITH THE MINING RECORDER, MINISTRY OF NORTHERN DEVELOPMENT AND MINES FOR ADDITIONAL INFORMATION ON THE STATUS OF THE LANDS SHOWN HEREON.

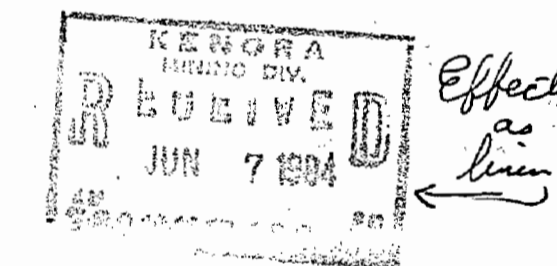

ROADS INDICATED ONTARIO - MINNESOTA PULP AND PAPER CO. ARE PRIVATE ROADS BUT MAY BE USED BY PROSPECTORS ONLY AFTER PERMISSION IS OBTAINED FROM THE ABOVE MENTIONED CO. IN KENORA.

SCALE: 1 INCH = 40 CHAINS

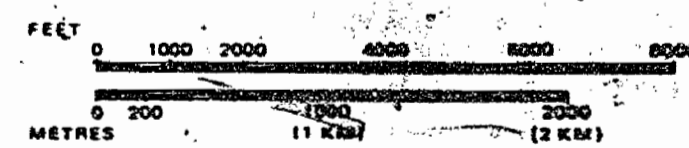

AREA
FISHER LAKE
M.N.R. ADMINISTRATIVE DISTRICT
KENORA / DRYDEN
MINING DIVISION
KENORA
LAND TITLES / REGISTRY DIVISION
KENORA

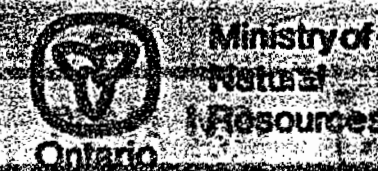

G-2696 ONT G-2617

495933

G2603 ATIKWA LAKE

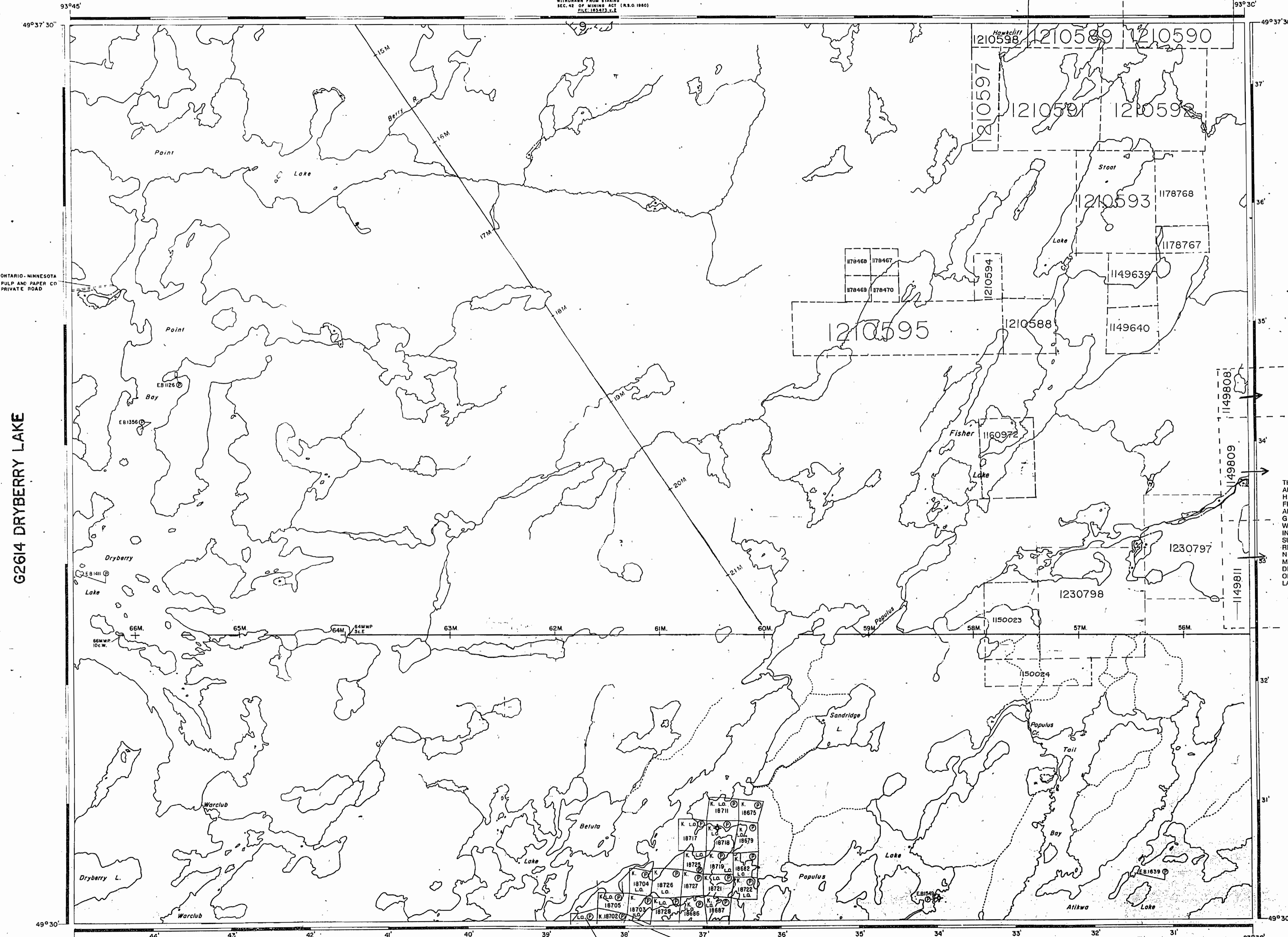

ONTARIO - MINNESOTA PULP AND PAPER CO. PRIVATE ROAD

FISHER LAKE AREA G 2617

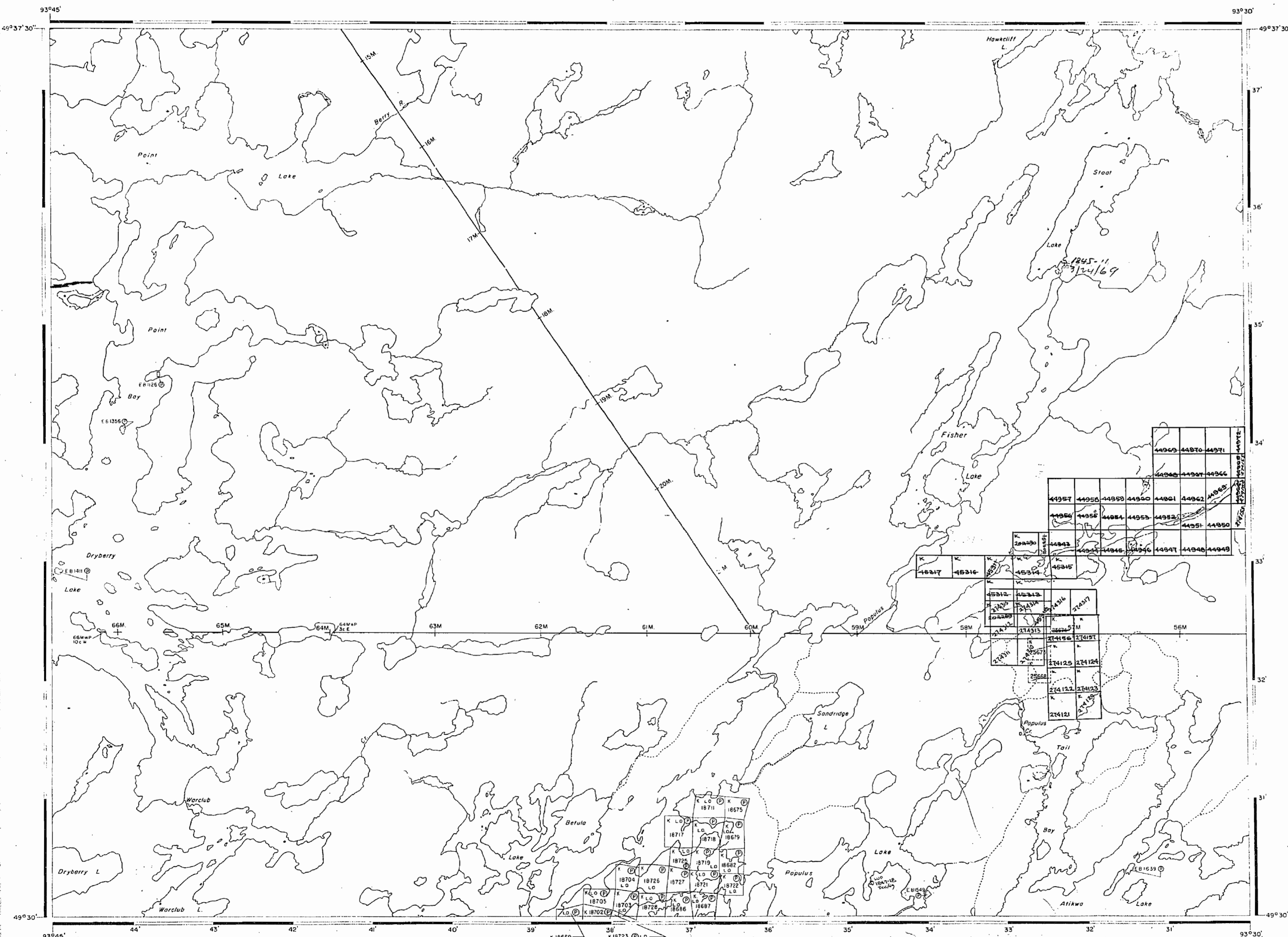

AREA OF
FISHER LAKE
 DISTRICT OF
 KENORA
 KENORA
 MINING DIVISION
 SCALE: 1-INCH = 40 CHAINS

LEGEND

PATENTED LAND	Ⓟ
CROWN LAND SALE	C.S.
LEASES	Ⓛ
LOCATED LAND	Loc.
LICENSE OF OCCUPATION	L.O.
MINING RIGHTS ONLY	M.R.O.
SURFACE RIGHTS ONLY	S.R.O.
ROADS	—
IMPROVED ROADS	—
KING'S HIGHWAYS	—
RAILWAYS	—
POWER LINES	—
MARSH OR MUSKEG	—
MINES	Ⓧ
CANCELLED	C.

NOTES
 400' Reserve around all lakes & rivers to
 Dept. of Lands & Forests.

July 1/61
Feb. 11/69
March 7/69
May 5/70
July 15/70
Sept. 21/71
Oct. 15/71



PLAN NO. **M.2696**

DEPARTMENT OF MINES
 — ONTARIO —

2696

WITHDRAWN FROM STATING
SEC 42 OF MINING ACT
FILE 183473

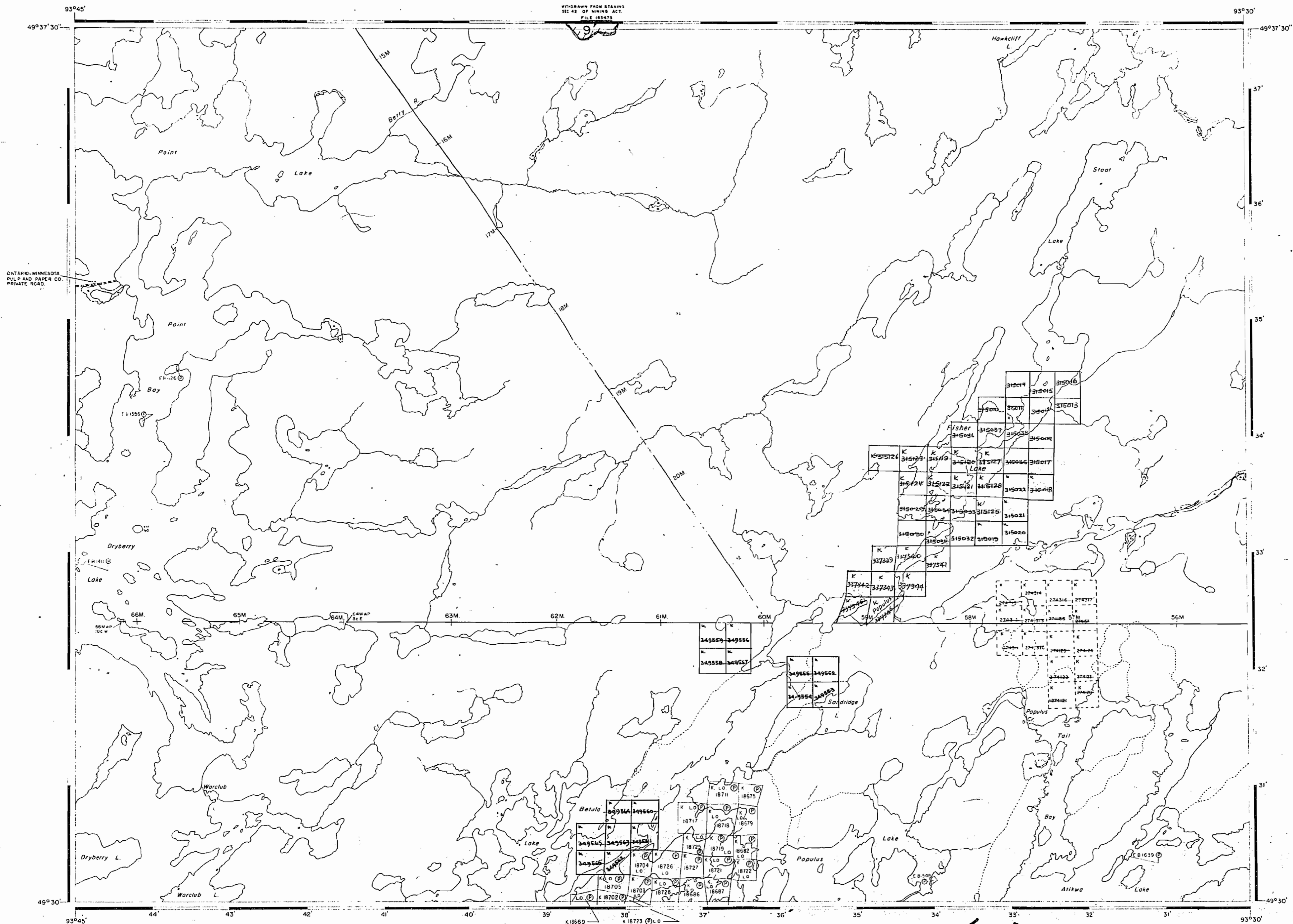

AREA OF
FISHER LAKE

DISTRICT OF
KENORA

KENORA
MINING DIVISION

SCALE: 1-INCH = 40 CHAINS

LEGEND

- PATENTED LAND ⊙
- CROWN LAND SALE C.S.
- LEASES ⊖
- LOCATED LAND L.O.
- LICENSE OF OCCUPATION L.O.
- MINING RIGHTS ONLY M.R.O.
- SURFACE RIGHTS ONLY S.R.O.
- ROADS —
- IMPROVED ROADS —
- KING'S HIGHWAYS —
- RAILWAYS —
- POWER LINES —
- MARSH OR MUSKEG —
- MINES *
- CANCELLED C.

NOTES

400' Reserve around all lakes & rivers to
Dept. of Lands & Forests.

ROADS INDICATED ONTARIO-MINNESOTA PULP AND
PAPER CO. ARE PRIVATE ROADS BUT MAY BE USED
BY "PROSPECTORS ONLY" AFTER PERMISSION IS
OBTAINED FROM THE ABOVE MENTIONED CO IN
KENORA.

KENORA

FILED:
REC'D. DEC - 7 1911
RECEIPT No.
MINING DIVISION

Sept 1/72
Oct. 11/72
Oct. 13/72
Nov. 10/72
Feb 13/73
Sept. 12/73
Oct. 29/73
Mar. 13/74
Sept. 10/74

NATIONAL TOPOGRAPHIC SERIES 52 F12

PLAN NO. **M.2696**

ONTARIO
DEPARTMENT OF MINES
AND NORTHERN AFFAIRS

Fisher Lake

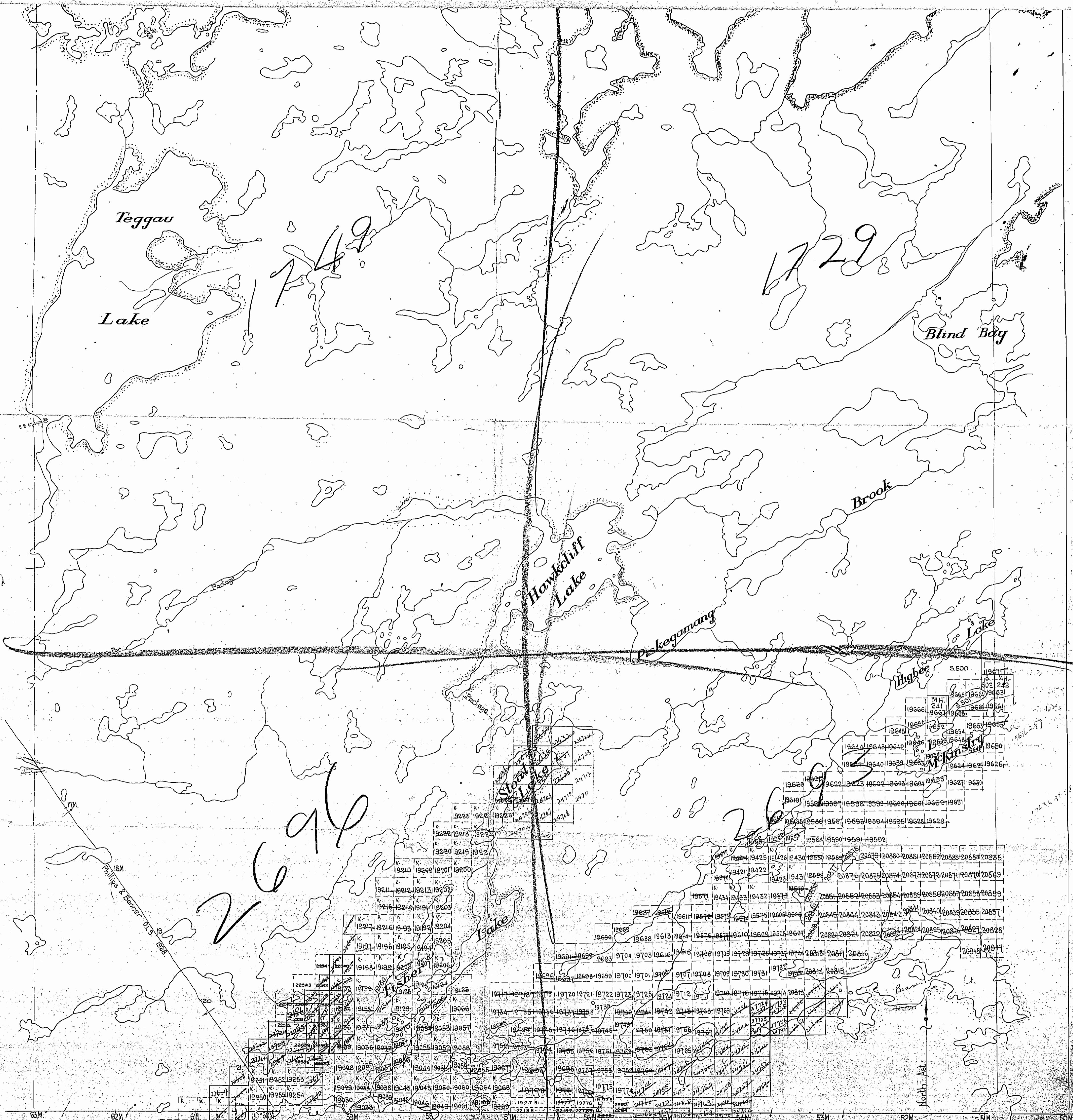

KENORA LAKE MG. DIV.
 Scale - 40 Chains = 1 Inch

Surface reservation 400' wide by Dept of L. & S. ...
 This reservation to apply only to ...
 No other lines of all islands lying within the ...
 defined above.

Map 2046

TWP 39

TWP 38

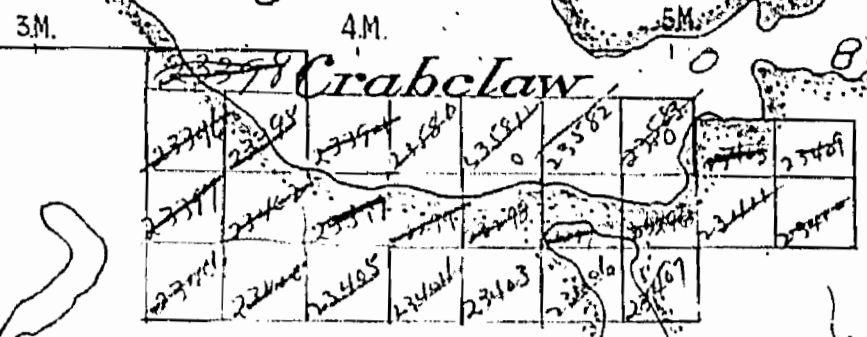

Crabclaw

Lake

Eagle Lake

Northwest Arm

Teggau

Lake

749

1729

Blind Bay

Hawkliff Lake

Brook

Lake

Hughes

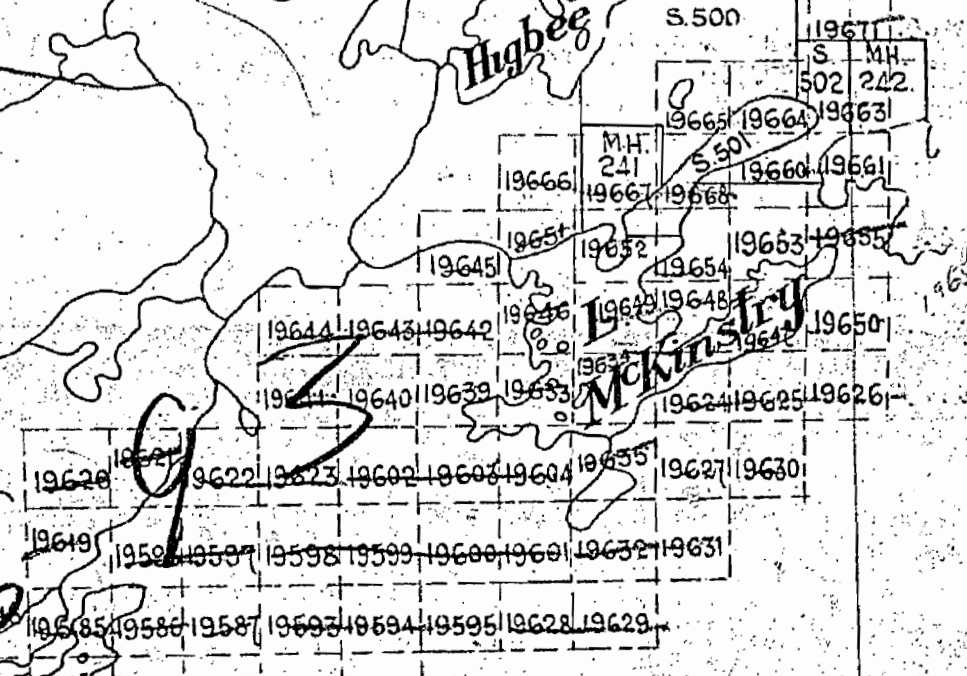
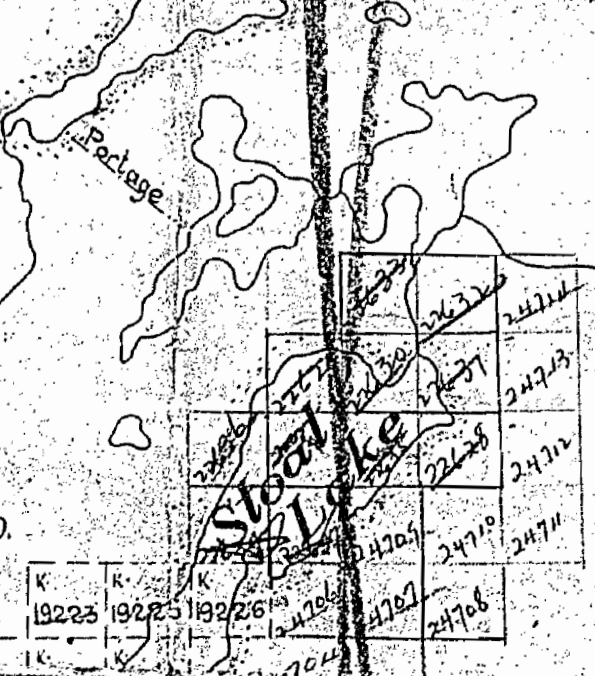

19611	19612	19613	19614	19615
19616	19617	19618	19619	19620
19621	19622	19623	19624	19625
19626	19627	19628	19629	19630
19631	19632	19633	19634	19635
19636	19637	19638	19639	19640
19641	19642	19643	19644	19645
19646	19647	19648	19649	19650
19651	19652	19653	19654	19655
19656	19657	19658	19659	19660
19661	19662	19663	19664	19665
19666	19667	19668	19669	19670
19671	19672	19673	19674	19675
19676	19677	19678	19679	19680
19681	19682	19683	19684	19685
19686	19687	19688	19689	19690
19691	19692	19693	19694	19695
19696	19697	19698	19699	19700

Handwritten scribble

Handwritten scribble