

FITZSIMMONS TP.

(Tp. 22, R. 18)

ONTARIO **M. 1466**
MINISTRY OF NATURAL RESOURCES
SURVEYS AND MAPPING BRANCH

6-2875

PORCUPINE - MINING DIVISION. DISTRICT OF SUDBURY.

Scale, 40 chains to an inch.

BLACKBURN TP. M. 1467

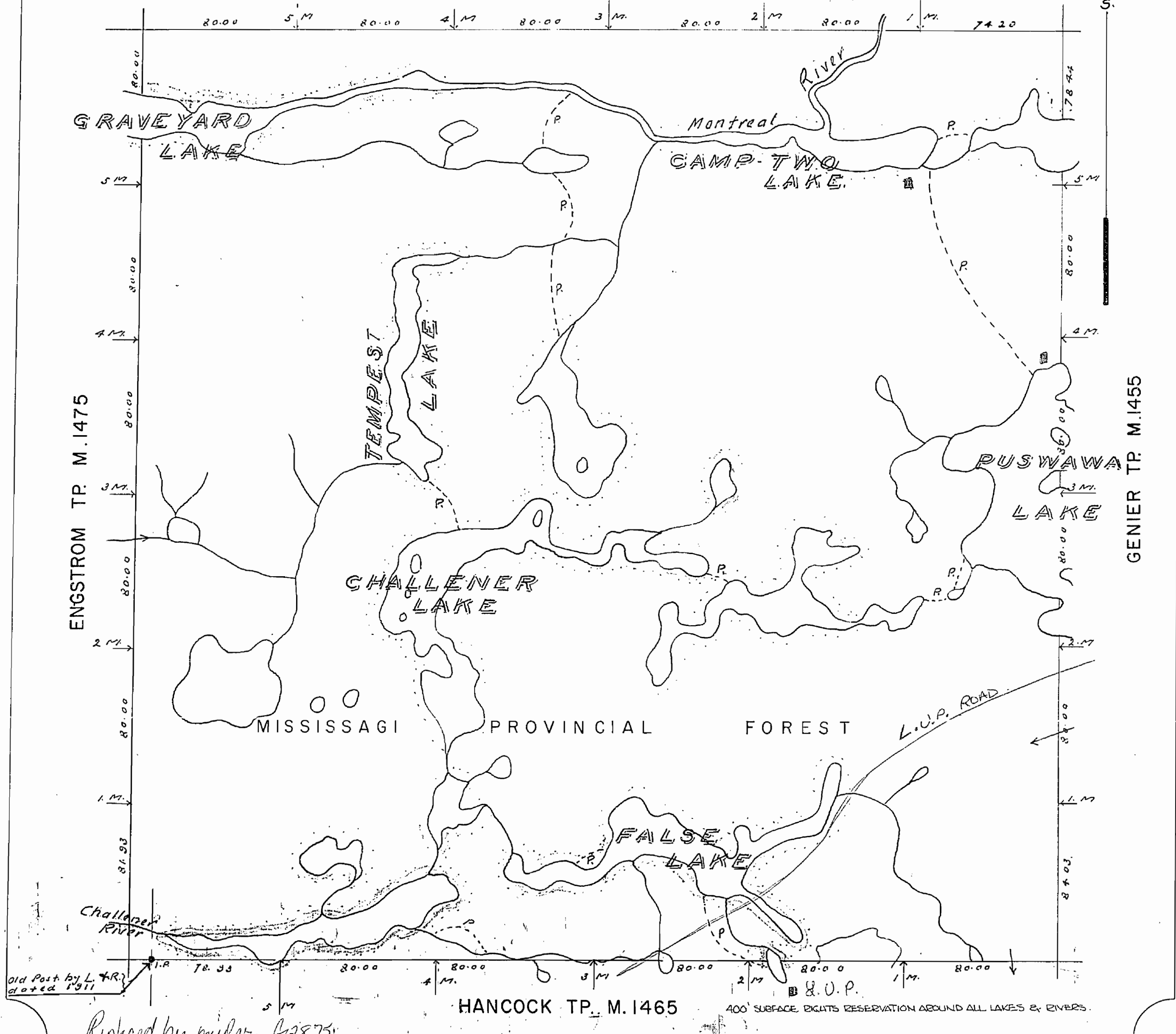
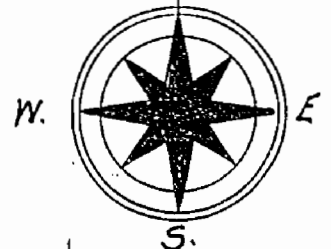

Old Post by L. & R. dated 1911

Replotted by map No. 62875

Twp. 22 R. 18 M. 1466

HANCOCK TP. M. 1465

400' SURFACE RIGHTS RESERVATION AROUND ALL LAKES & RIVERS.

2785-0

9WT 2NOMMISTIF

0-5812

REFERENCES

AREAS WITHDRAWN FROM DISPOSITION

- M.R.O. - MINING RIGHTS ONLY
- S.R.O. - SURFACE RIGHTS ONLY
- M.+S. - MINING AND SURFACE RIGHTS

Description Order No. Date Disposition File
 (R) Sec. 35 W-LL-C1534/99 ONT May 14/99 M+S

THE INFORMATION THAT APPEARS ON THIS MAP HAS BEEN COMPILED FROM VARIOUS SOURCES, AND ACCURACY IS NOT GUARANTEED. THOSE WISHING TO STAKE MINING CLAIMS SHOULD CONSULT WITH THE MINING RECORDER, MINISTRY OF NORTHERN DEVELOPMENT AND MINES, FOR ADDITIONAL INFORMATION ON THE STATUS OF THE LANDS SHOWN HEREON.

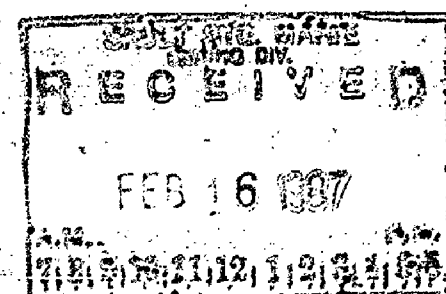

BLACKBURN TWP G-2876

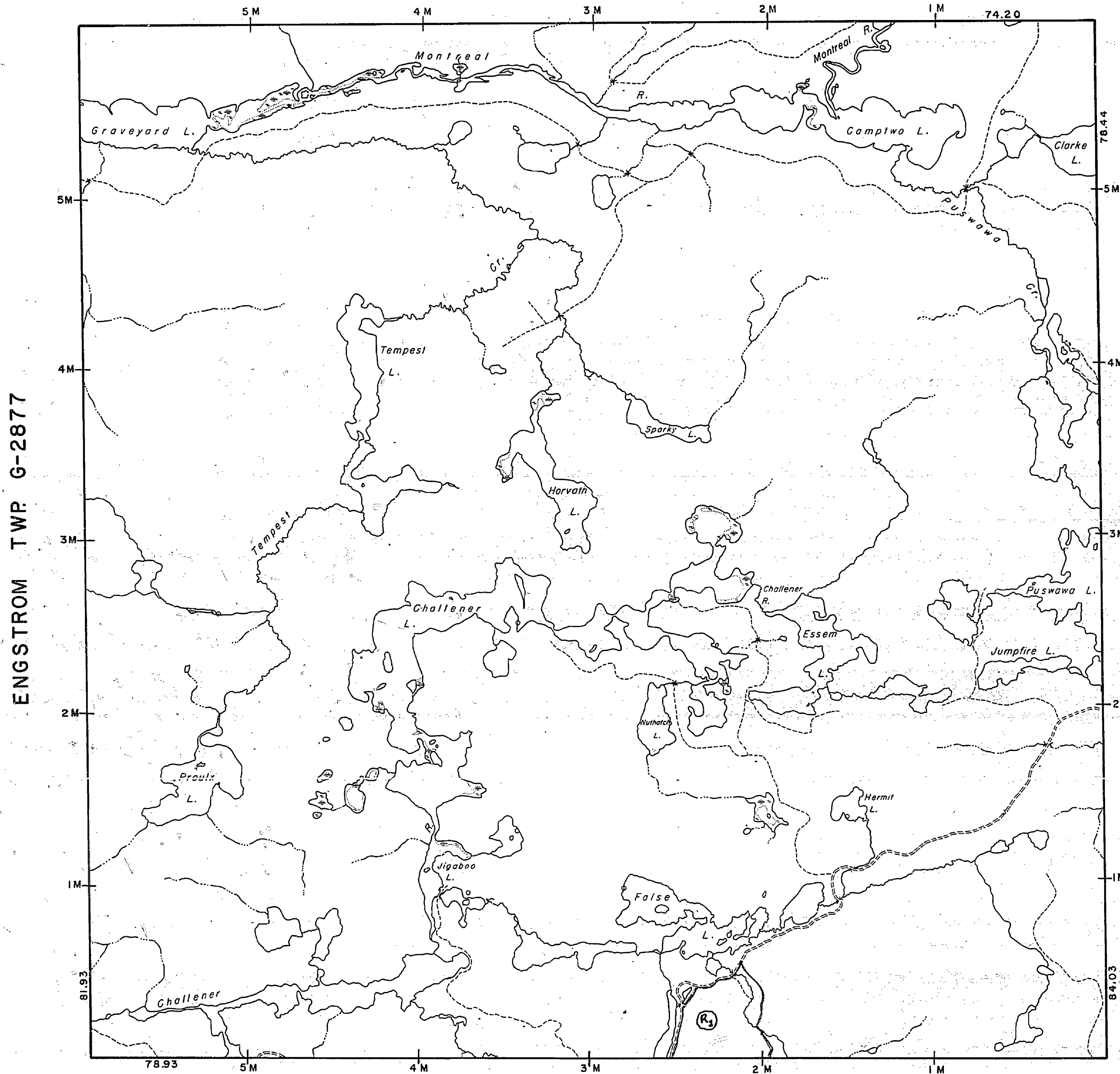

HANCOCK TWP G-2878

LEGEND

- HIGHWAY AND ROUTE No.
- OTHER ROADS
- TRAILS
- SURVEYED LINES:
 - TOWNSHIPS; BASE LINES, ETC.
 - LOTS; MINING CLAIMS, PARCELS, ETC.
- UNSURVEYED LINES:
 - LOT LINES
 - PARCEL BOUNDARY
 - MINING CLAIMS ETC.
- RAILWAY AND RIGHT OF WAY
- UTILITY LINES
- NON-PERENNIAL STREAM
- FLOODING OR FLOODING RIGHTS
- SUBDIVISION OR COMPOSITE PLAN
- RESERVATIONS
 - ORIGINAL SHORELINE
 - MARSH OR MUSKEG
 - MINES
 - TRAVERSE MONUMENT

DISPOSITION OF CROWN LANDS

TYPE OF DOCUMENT	SYMBOL
PATENT, SURFACE & MINING RIGHTS	
SURFACE RIGHTS ONLY	
MINING RIGHTS ONLY	
LEASE, SURFACE & MINING RIGHTS	
SURFACE RIGHTS ONLY	
MINING RIGHTS ONLY	
LICENCE OF OCCUPATION	
ORDER-IN-COUNCIL	
RESERVATION	
CANCELLED	
SAND & GRAVEL	

NOTE: MINING RIGHTS IN PARCELS PATENTED PRIOR TO MAY 6, 1913, VESTED IN ORIGINAL PATENTEE BY THE PUBLIC LANDS ACT, R.S.O. 1970, CHAP. 380, SEC. 63, SUBSEC. 1.

SCALE: 1 INCH = 40 CHAINS

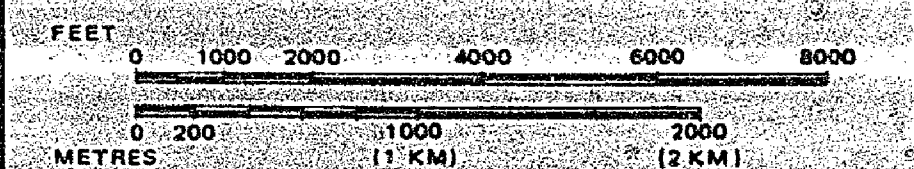

TOWNSHIP

FITZSIMMONS

M.N.R. ADMINISTRATIVE DISTRICT

CHAPLEAU

MINING DIVISION

SAULT STE. MARIE

LAND TITLES / REGISTRY DIVISION

SUBBURY

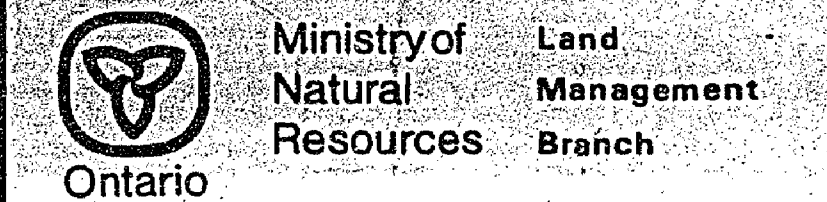

Date: MARCH 1984

Number:

Rec'd May 31/84

G-2875

2785-0

9WT 2NOMMISTIF

0-5812

FITZSIMMONS TP.

(Tp. 22, R. 18)

ONTARIO M. 1466
MINISTRY OF NATURAL RESOURCES
SURVEYS AND MAPPING BRANCH

6-2875

PORCUPINE - MINING DIVISION.
DISTRICT OF SUDBURY.

Scale, 40 chains to an inch.

BLACKBURN TP. M. 1467

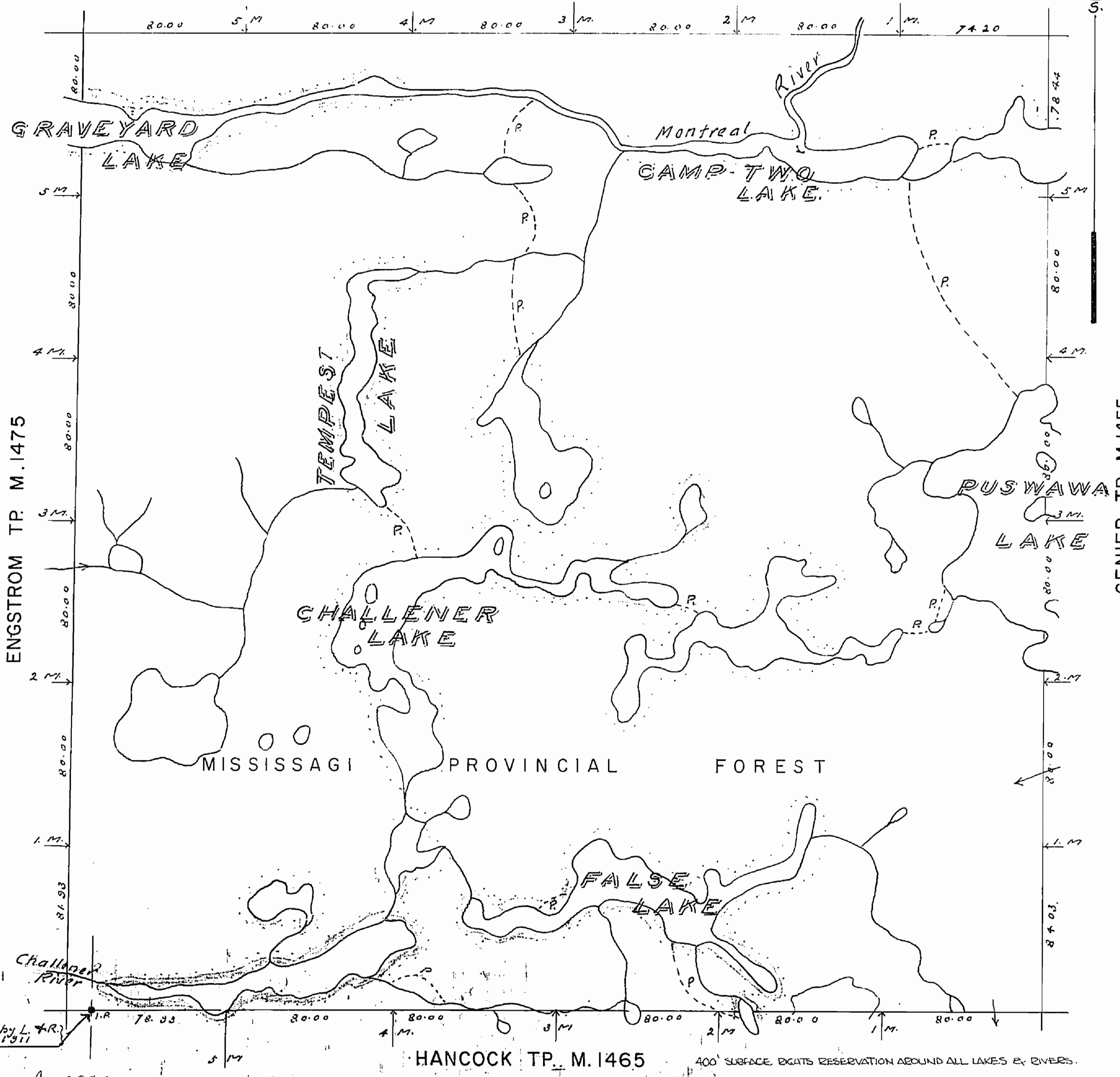
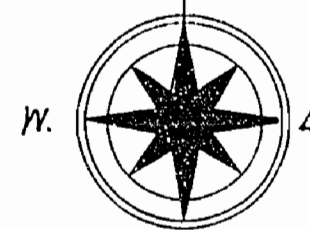

ENGSTROM TP. M. 1475

GENIER TP. M. 1455

HANCOCK TP. M. 1465

Old Post by L. & R. dated 1911

6-2875

TWP. 22 R. 18 M. 1466

8 6 4 2 1 2 4 6 8

m-1466

PLAN OF FITZSIMMONS TWP. 22. R. 18.

SAULT STE MARIE MINING DIVISION. DISTRICT OF SUDBURY.

Scale, 40 chains to an inch.

TWP. 22. - R. 19.

DATE OF ISSUE
SEP 24 1958
SAULT STE MARIE
MINE REGISTRY OFFICE
7420

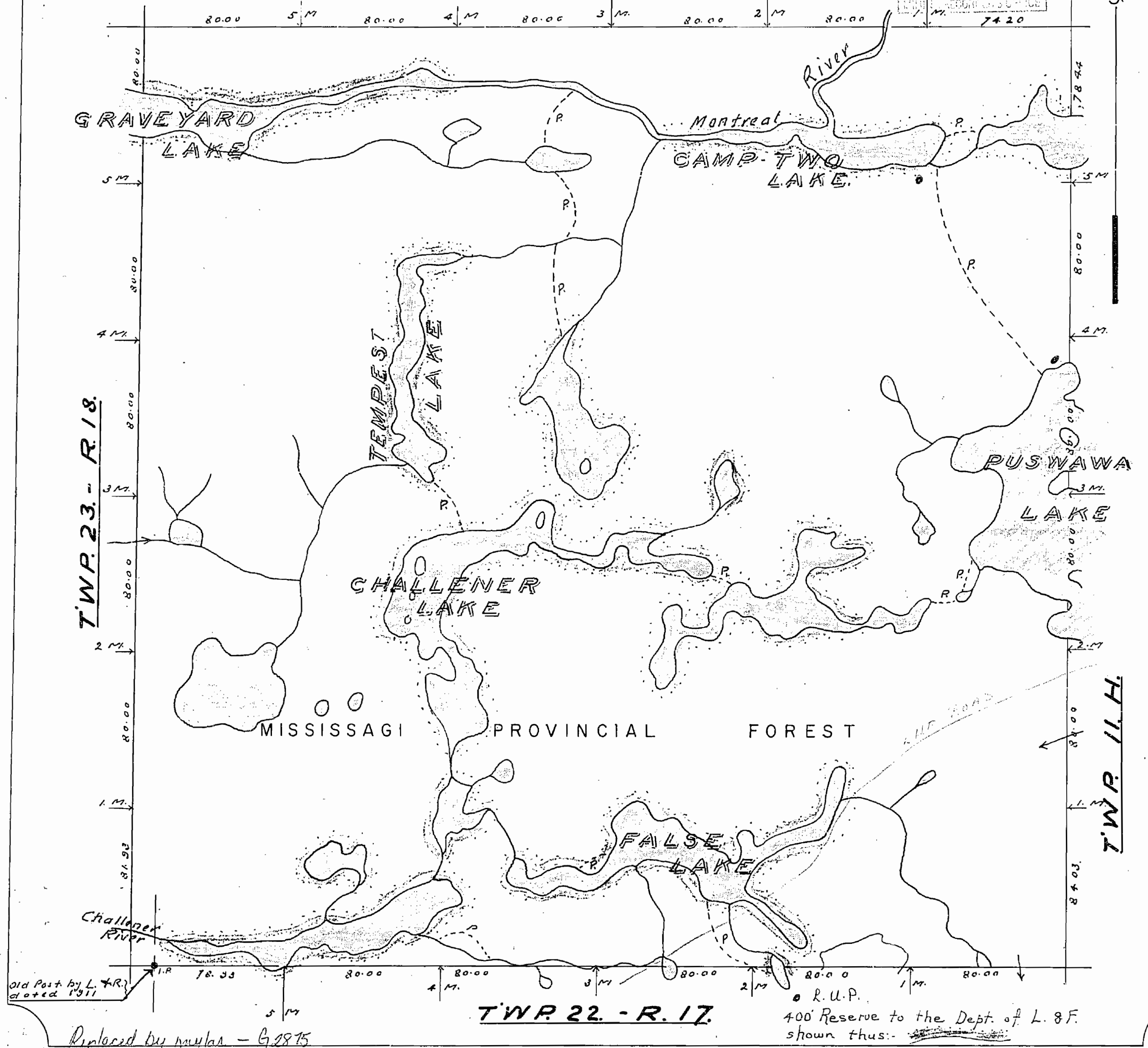
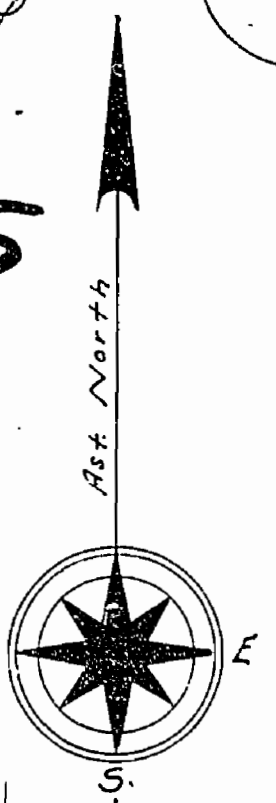

Old Post by L. & R. dated 1911

Replaced by mylar - G. 2875

TWP. 22. - R. 17.

400 Reserve to the Dept. of L. & F. shown thus:

TWP. 22. R. 18. M. 1466