

M-1715

#1

FLETCHER

DISTRICT OF THUNDER BAY

SCALE: 40 CHAINS = 1 INCH

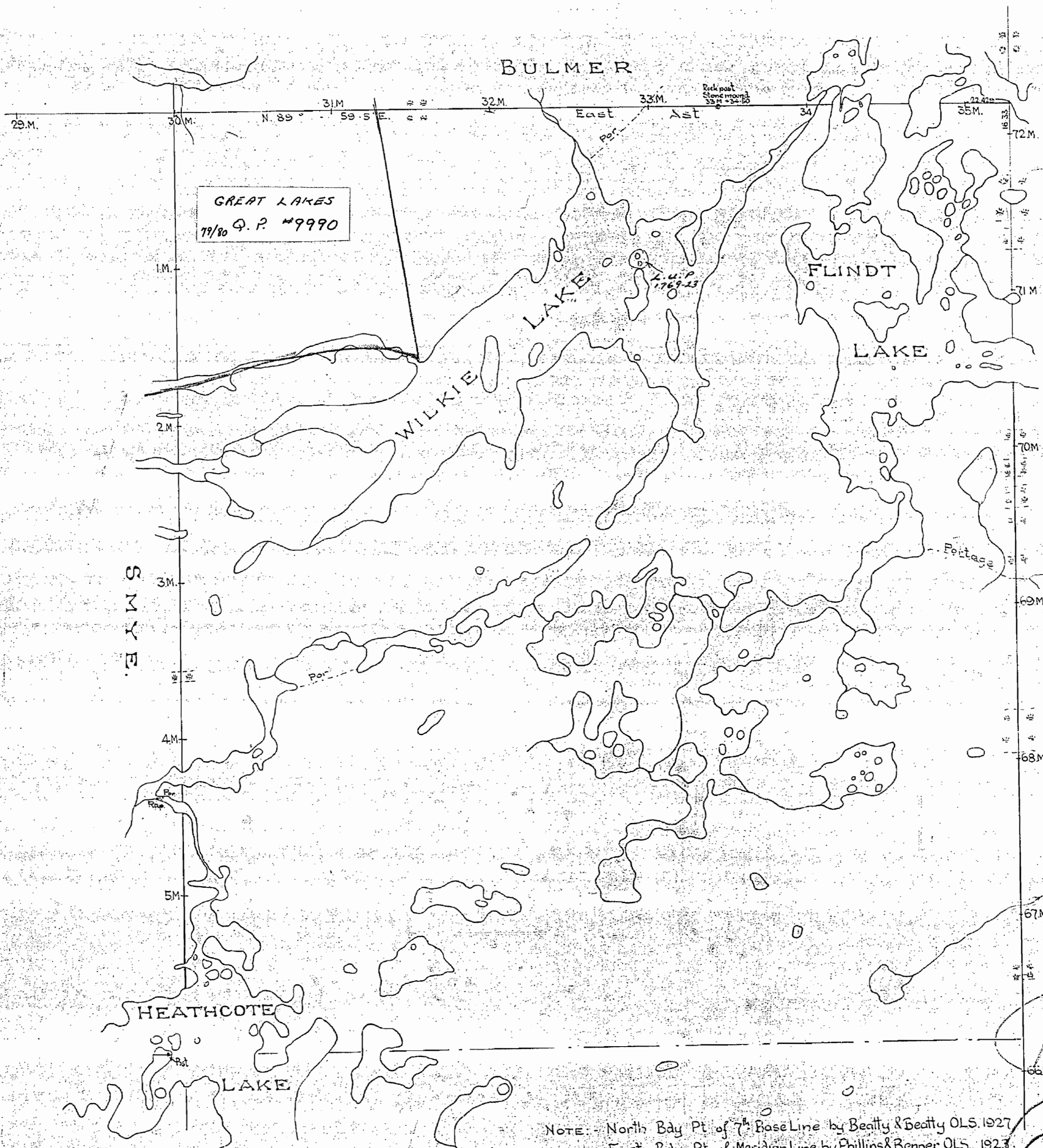

GREAT LAKES
77/80 Q.P. #9990

Rail post
Stone road
22.47

2.4 P
1769-23

23381

M1715

92

NOTE: North Bay Pt. of 7th Base Line by Beatty & Beatty OLS. 1927.
East Bay Pt. of Meridian Line by Phillips & Benner OLS. 1923.
West Bay by Sutcliffe OLS. 1927.
Lakes from Aerial Photography

PORT ARTHUR
RECEIVED
OCT 23 1940
MINING DIVISION

DATE OF ISSUE
OCT 21 1940

Department of Surveys
Parliament Buildings Toronto

T.P. OF FLETCHER

DISTRICT OF THUNDER BAY.

Scale: 40 Chains = 1 Inch.
PATRICIA MINING DIVISION

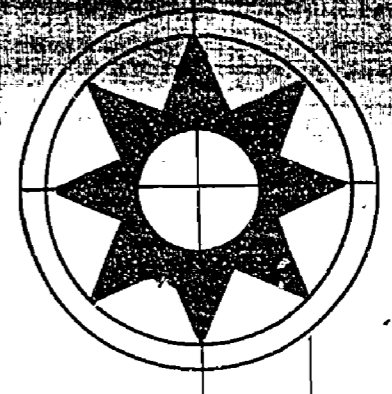

PATRICIA MINING DIV.
RECEIVED
NOV 16 1933
A.M. P.M.
7 8 9 10 11 12 1 2 3 4 5 6

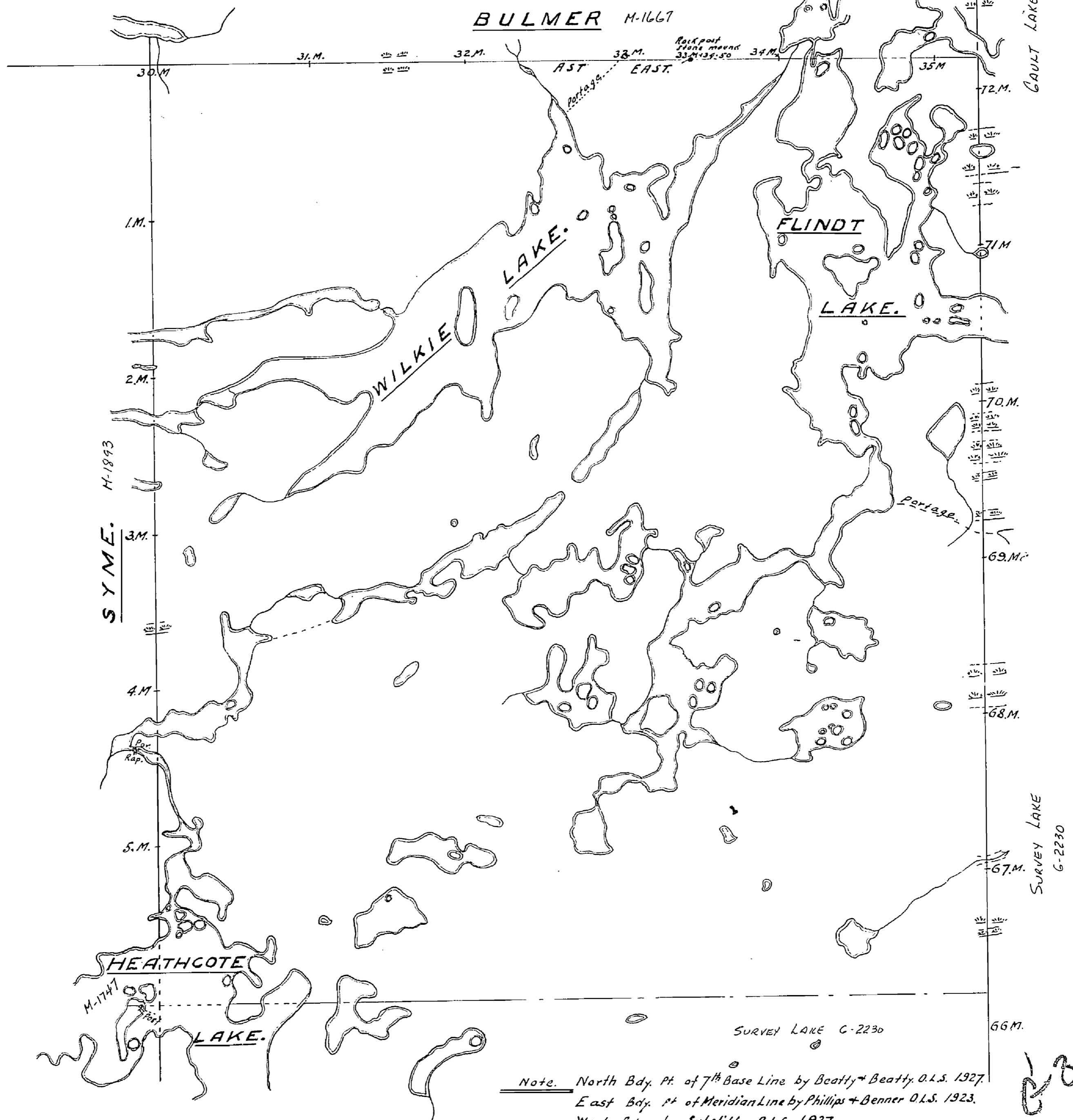

Note. North Bdy. Pt. of 7th Base Line by Beatty & Beatty O.L.S. 1927.
East Bdy. Pt. of Meridian Line by Phillips & Denner O.L.S. 1923.
West Bdy. by Sutcliffe O.L.S. 1927.
Lakes from Aerial Photography.

Dept. of Surveys,
Parliament Buildings
Toronto. April 23rd 1931.

G-3381

FLETCHER TWP

G-3381

AREAS WITHDRAWN FROM DISPOSITION

M.R.O. - MINING RIGHTS ONLY
 S.R.O. - SURFACE RIGHTS ONLY
 M.+S. - MINING AND SURFACE RIGHTS

| Description | Order No. | Date | Disposition | File |
|-------------|-----------|------|-------------|------|
| | | | | |

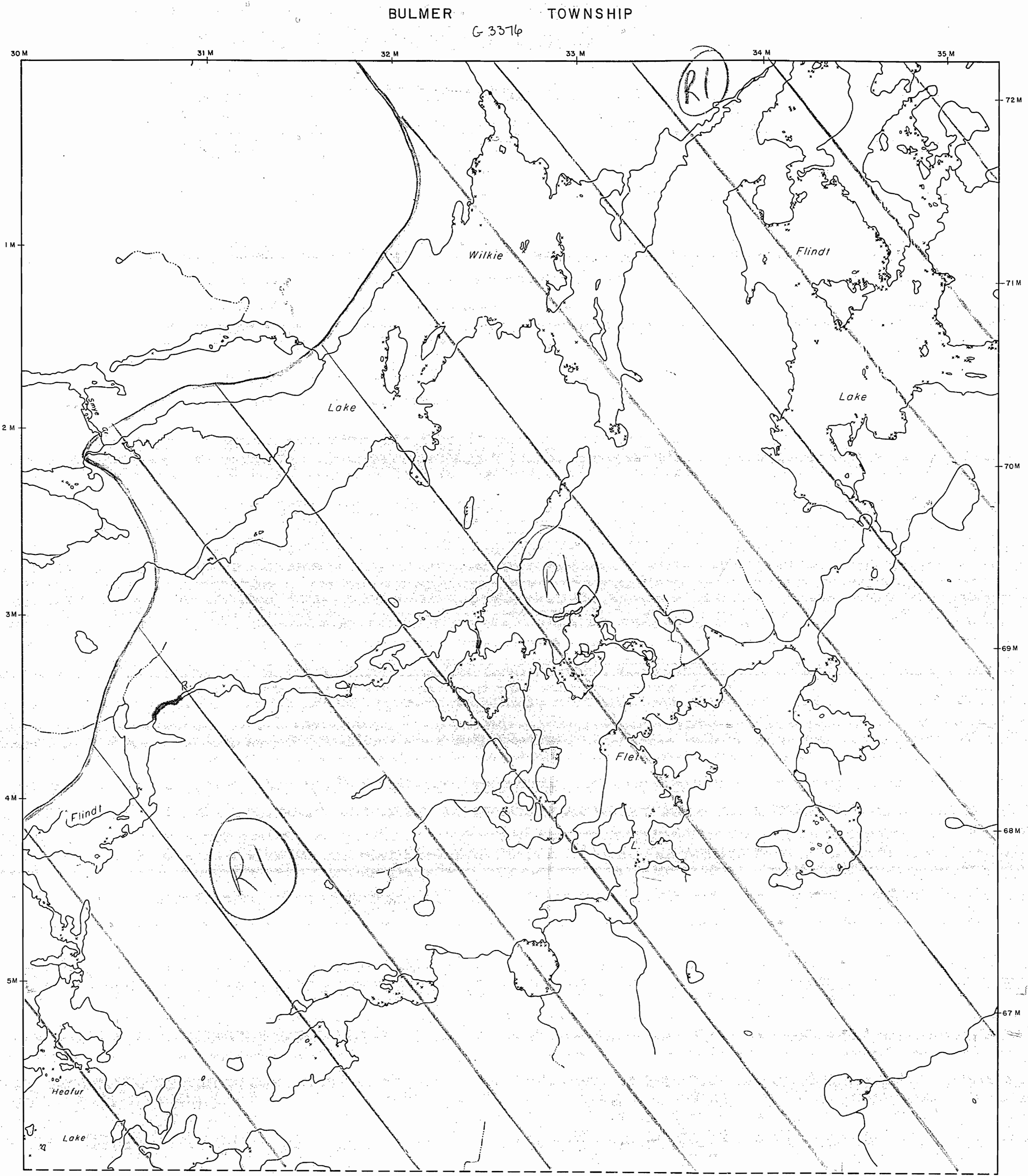

LEGEND

- HIGHWAY AND ROUTE No.
- OTHER ROADS
- TRAILS
- SURVEYED LINES
- TOWNSHIPS, BASE LINES, ETC.
- LOTS, MINING CLAIMS, PARCELS, ETC.
- UNSURVEYED LINES
- LOT LINES
- PARCEL BOUNDARY
- MINING CLAIMS ETC.
- RAILWAY AND RIGHT OF WAY
- UTILITY LINES
- NON PERENNIAL STREAM
- FLOODING OR FLOODING RIGHTS
- SUBDIVISION OR COMPOSITE PLAN
- RESERVATIONS
- ORIGINAL SHORELINE
- MARSH OR MUSKEG
- MINES
- TRAVERSE MONUMENT

DISPOSITION OF CROWN LANDS

| TYPE OF DOCUMENT | SYMBOL |
|---------------------------------|--------|
| PATENT, SURFACE & MINING RIGHTS | |
| SURFACE RIGHTS ONLY | |
| MINING RIGHTS ONLY | |
| LEASE, SURFACE & MINING RIGHTS | |
| SURFACE RIGHTS ONLY | |
| MINING RIGHTS ONLY | |
| LICENCE OF OCCUPATION | |
| ORDER IN COUNCIL | |
| RESERVATION | |
| CANCELLED | |
| SAND & GRAVEL | |

NOTE: MINING RIGHTS IN PARCELS PATENTED PRIOR TO MAY 6, 1913 VESTED IN ORIGINAL PATENTEE BY THE PUBLIC LANDS ACT R.S.O. 1970 CHAP. 380, SEC. 63, SUBSEC. 1

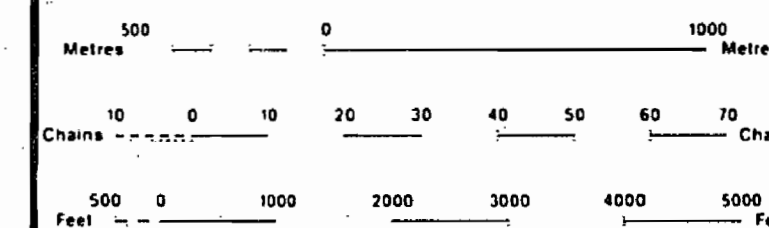

SCALE 1:20 000

EXPLORATIONISTS STAKING CLAIMS IN THE VICINITY OF THE AREAS WITHDRAWN BY ORDERS W-PA-4895 NNR AND W-PA-4975 NNR (COPIES ATTACHED) SHOULD CONSULT THE ATTACHED OFFICIAL PLAN OF WABAKIMI PROVINCIAL PARK TO ESTABLISH THE OFFICIAL BOUNDARY OF THE PARK THAT CAME INTO REGULATION JULY 4, 1997.

W-PA-4895 NNR - M+S

FOREST ACTIVITY INFORMATION
 THIS TOWNSHIP/AREA FALLS WITHIN THE
CARIBOU EAST FOREST-MGT. UNIT
 AND MAY BE SUBJECT TO FORESTRY OPERATIONS.
 THE M.N.R. UNIT FORESTER FOR THIS AREA CAN BE CONTACTED AT:
 P.O. BOX 309
 SIOUX LOOKOUT, ONTARIO P0V 2T0
 (807) 737-1140

THE INFORMATION THAT APPEARS ON THIS MAP HAS BEEN COMPILED FROM VARIOUS SOURCES AND ACCURACY IS NOT GUARANTEED. THOSE WISHING TO STAKE MINING CLAIMS SHOULD CONSULT WITH THE MINING RECORDER, MINISTRY OF NORTHERN DEVELOPMENT AND MINES, FOR ADDITIONAL INFORMATION ON THE STATUS OF THE LANDS SHOWN HEREON.

TOWNSHIP
FLETCHER
 M.N.R. ADMINISTRATIVE DISTRICT
SIOUX LOOKOUT
 MINING DIVISION
PATRICIA
 LAND TITLES / REGISTRY DIVISION
THUNDER BAY

Ministry of Natural Resources
 Ministry of Northern Development and Mines
 Ontario

Date: AUGUST 1986
 Number: **G-3381**

FURLONGE TOWNSHIP

G-2040

BULMER TOWNSHIP

G-3376

SMYE TOWNSHIP

G-3370

Thunder Bay Division

G-3381

FLETCHER TWP

G-3381