

C-5040

FURLONGE TWP.

C-5040

AREAS WITHDRAWN FROM DISPOSITION

- M.R.O. - MINING RIGHTS ONLY
- S.R.O. - SURFACE RIGHTS ONLY
- M+S - MINING AND SURFACE RIGHTS

Description	Order No.	Date	Disposition	File
77 Jun 19 (c. 441)				

**FOREST ACTIVITY INFORMATION**  
 THIS TOWNSHIP/AREA FALLS WITHIN THE  
**CARIBOU EAST FOREST MGT. UNIT**  
 AND MAY BE SUBJECT TO FORESTRY OPERATIONS.  
 THE M.N.R. UNIT FORESTER FOR THIS AREA CAN BE  
 CONTACTED AT:  
 P.O. BOX 329  
 SIOUX LOOKOUT, ONTARIO P0V 2T0  
 (807) 737-1140

FLETCHER TWP. G3381

HEATHCOTE TWP. G3383

SURVEY LAKE G-2830

ALLANWATER STATION G-2824

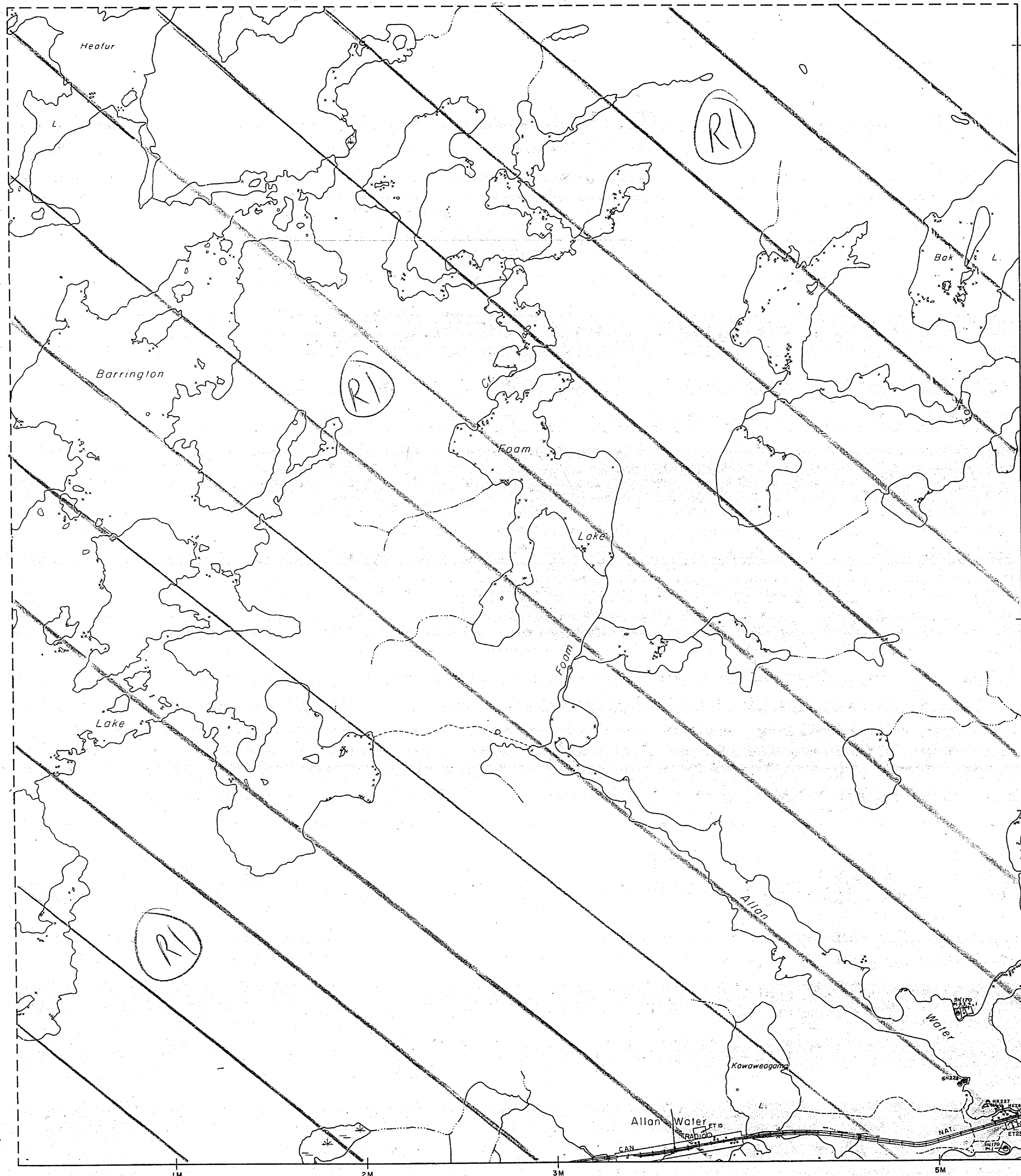

McLAURIN TWP.

LEGEND

- HIGHWAY AND ROUTE No. [Symbol]
- OTHER ROADS [Symbol]
- TRAILS [Symbol]
- SURVEYED LINES [Symbol]
- TOWNSHIPS, BASE LINES, ETC. [Symbol]
- LOTS, MINING CLAIMS, PARCELS, ETC. [Symbol]
- UNSURVEYED LINES [Symbol]
- LOT LINES [Symbol]
- PARCEL BOUNDARY [Symbol]
- MINING CLAIMS ETC. [Symbol]
- RAILWAY AND RIGHT OF WAY [Symbol]
- UTILITY LINES [Symbol]
- NON PERENNIAL STREAM [Symbol]
- FLOODING OR FLOODING RIGHTS [Symbol]
- SUBDIVISION OR COMPOSITE PLAN [Symbol]
- RESERVATIONS [Symbol]
- ORIGINAL SHORELINE [Symbol]
- MARSH OR MUSKEG [Symbol]
- MINES [Symbol]
- TRAVERSE MONUMENT [Symbol]

DISPOSITION OF CROWN LANDS

TYPE OF DOCUMENT	SYMBOL
PATENT, SURFACE & MINING RIGHTS	●
" SURFACE RIGHTS ONLY	○
" MINING RIGHTS ONLY	○
LEASE, SURFACE & MINING RIGHTS	■
" SURFACE RIGHTS ONLY	■
" MINING RIGHTS ONLY	■
LICENCE OF OCCUPATION	▼
ORDER-IN-COUNCIL	OC
RESERVATION	○
CANCELLED	○
SAND & GRAVEL	○

NOTE: MINING RIGHTS IN PARCELS PATENTED PRIOR TO MAY 8, 1913, VESTED IN ORIGINAL PATENTEE BY THE PUBLIC LANDS ACT, R.S.O. 1910, CHAP. 300, SEC. 63, SUBSEC. 1.

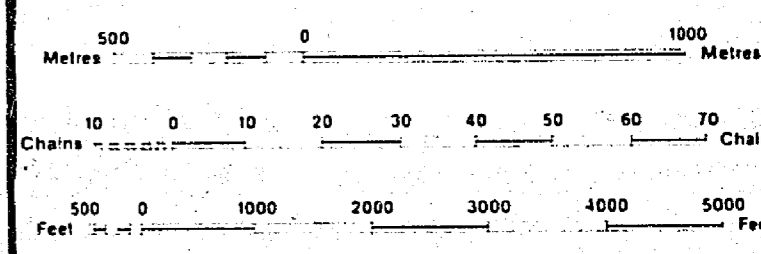

SCALE 1:20 000

April 19/90  
 June 27/90  
 (RI) W-PA-48195 NWR M+S

EXPLORATION STAKING CLAIMS IN THE VICINITY OF THE AREAS WITHDRAWN BY ORDERS W-PA-48195 NWR AND W-PA-48197 NWR (COPIES ATTACHED) SHOULD CONSULT THE ATTACHED OFFICIAL PLAN OF WABAKIMI PROVINCIAL PARK TO ESTABLISH THE OFFICIAL BOUNDARY OF THE PARK THAT CAME INTO REGULATION JULY 4, 1997.

THE INFORMATION THAT APPEARS ON THIS MAP HAS BEEN COMPILED FROM VARIOUS SOURCES, AND ACCURACY IS NOT GUARANTEED. THOSE WISHING TO STAKE MINING CLAIMS SHOULD CONSULT WITH THE MINING RECORDER, MINISTRY OF NORTHERN DEVELOPMENT AND MINES, FOR ADDITIONAL INFORMATION ON THE STATUS OF THE LANDS SHOWN HEREON.

TOWNSHIP  
**FURLONGE**  
 M.N.R. ADMINISTRATIVE DISTRICT  
**SIOUX LOOKOUT**  
 MINING DIVISION  
**PATRICIA**  
 LAND TITLES / REGISTRY DIVISION  
**THUNDER BAY**

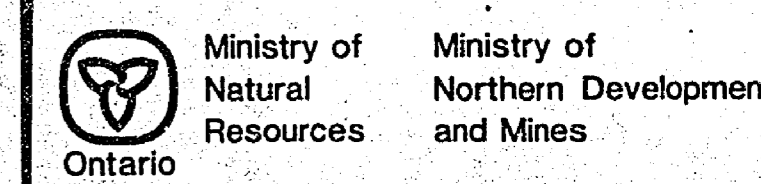

Date: AUGUST, 1986  
 Number: **G-2040**

C-5040

FURLONGE TWP.

C-5040

L.A. FONGE W-155

W-155  
M-1722  
C-2040

M-1722

ONTARIO  
MINISTRY OF NATURAL RESOURCES  
SURVEYS AND MAPPING BRANCH

# AREA EAST OF HEATHCOTE

[NOW FURLONGE TP.]

DISTRICT OF THUNDER BAY.

PATRICIA MINING DIVISION  
Scale: 40 Chains = 1 Inch.

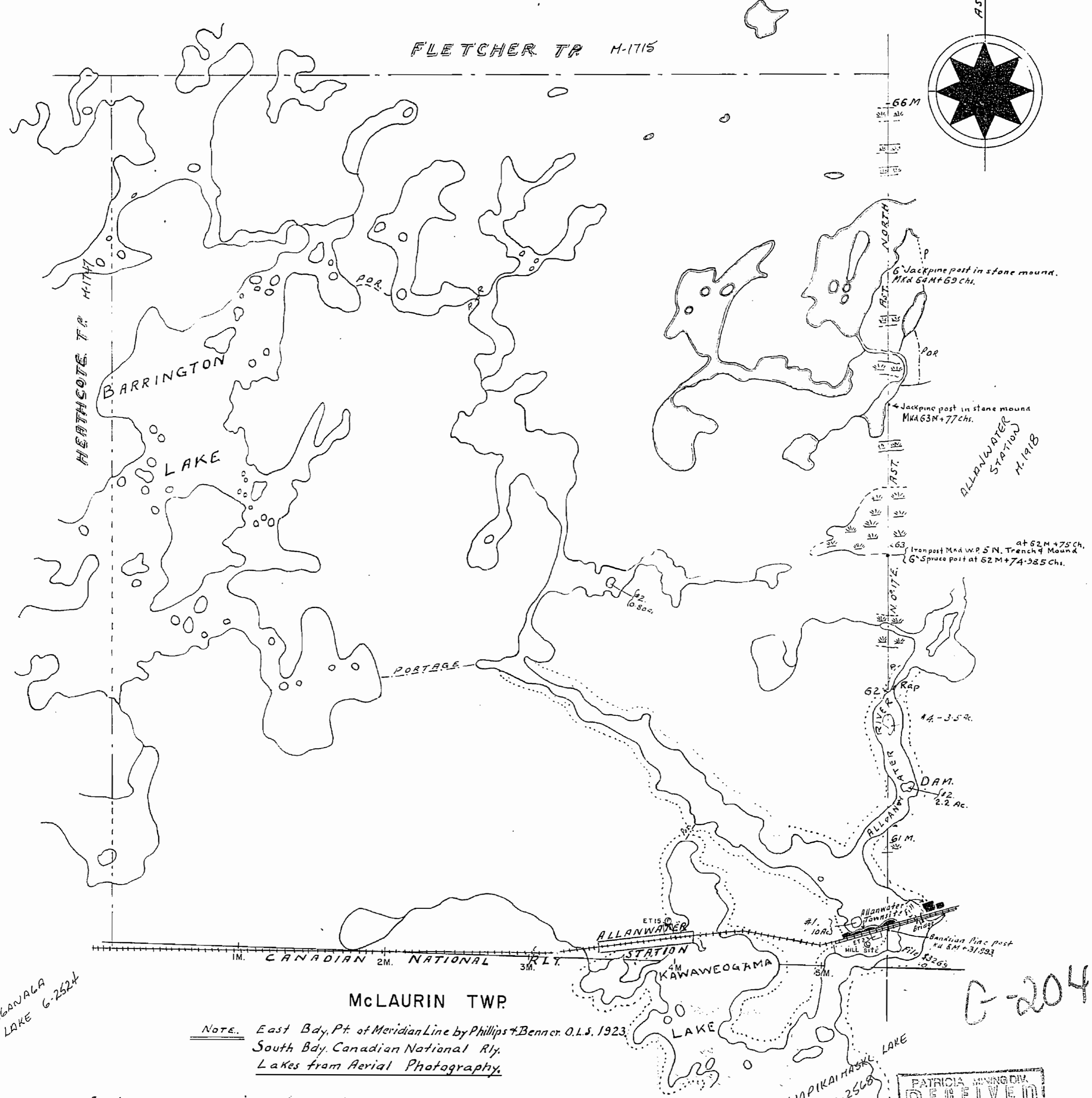
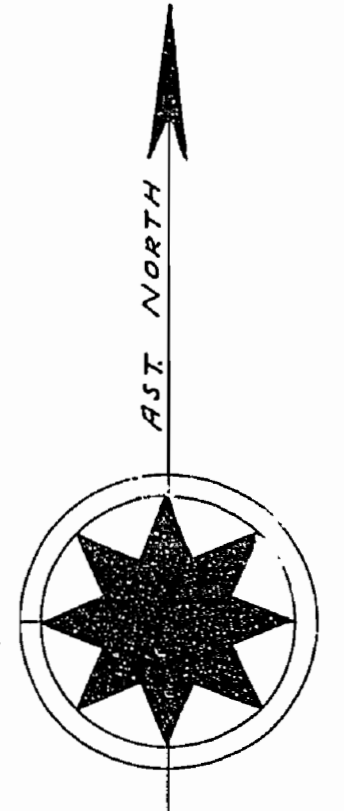

SESEGANAGA LAKE 6-2524

Note. East Bay, Pt. of Meridian Line by Phillips & Bennet. O.L.S. 1923.  
South Bay, Canadian National Ry.  
Lakes from Aerial Photography.

Surface reservations 400' wide by Dept. of L. & F.  
shown hereon thus

PATRICIA MINING DIV.  
**RECEIVED**  
AUG 17 1931  
A.M. 7:30 10:11:12: 1:2:3:4:5:6: P.M.

Department of Surveys,  
Parliament Buildings Toronto April 28<sup>th</sup> 1931.

FURLONGE



M-1722

# AREA EAST OF HEATHCOTE

[NOW FURLONGE TP.]

DISTRICT OF THUNDER BAY.

Scale: 40 Chains = 1 Inch.

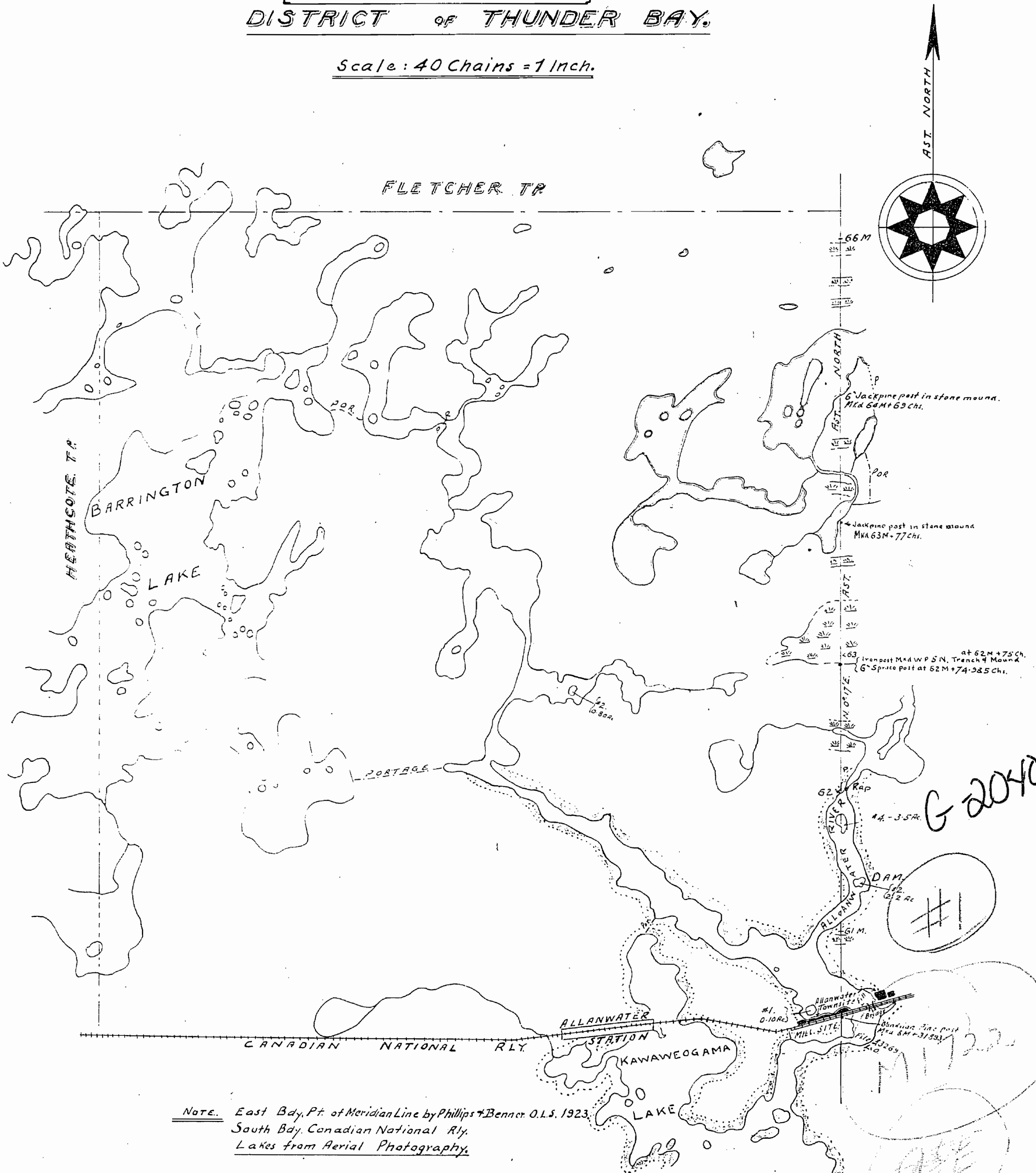

NOTE. East Bdy. Pt. of Meridian Line by Phillips & Benner O.L.S. 1923.  
 South Bdy. Canadian National Rly.  
 Lakes from Aerial Photography.

Surface reservations 400' wide by Dept. of L. & F.  
 Shown hereon thus ~~~~~