

E87W

North Part Gillies Limit (M.484)

THE TOWNSHIP OF
GILLIES LIMIT
(SOUTH PART)
DISTRICT OF
TIMISKAMING
LARDER LAKE
MINING DIVISION
SCALE: 1 INCH = 20 CHAINS

LEGEND

PATENTED LAND	C.S.
CROWN LAND SALE	LOC.
LEASES	L.O.
LOCATED LAND	M.R.O.
LICENSE OF OCCUPATION	S.R.O.
MINING RIGHTS ONLY	ROADS
SURFACE RIGHTS ONLY	IMPROVED ROADS
	KINGS HIGHWAYS
	RAILWAYS
	POWER LINES
	MARSH OR MUSKOG
	MINES

NOTES

This Twp. Lies Within The
TIMAGAMI PROVINCIAL FOREST.

400' Surface Rights Reservation Around All
Lakes And Rivers

Mining Claims Accepted Subject To Sec. 53
Of The Mining Act.

L.O. 7558 Covers Flooding Rights On Montreal
River Upstream From The Upper Notch Power
Site To Contour Elevation 785.5'
M.E.P.C. File: 20994 Vol. 3.

RESERVE FLOODING RIGHTS TO M.E.P.C. (PROPOSED)
TO CONTOUR 965' G.S.C.

Brigstocke Twp. (M. 429)

Lorrain Twp. (M. 536)

South Lorrain Twp. (M. 591)

Best Twp. (M. 417)

Best Twp. (M. 417)

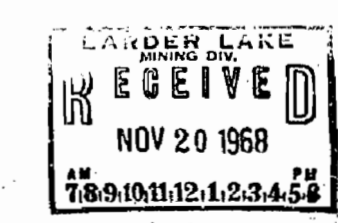

GILLIES LIMIT(S)
PLAN NO.-M. 483
DEPARTMENT OF MINES
-ONTARIO-

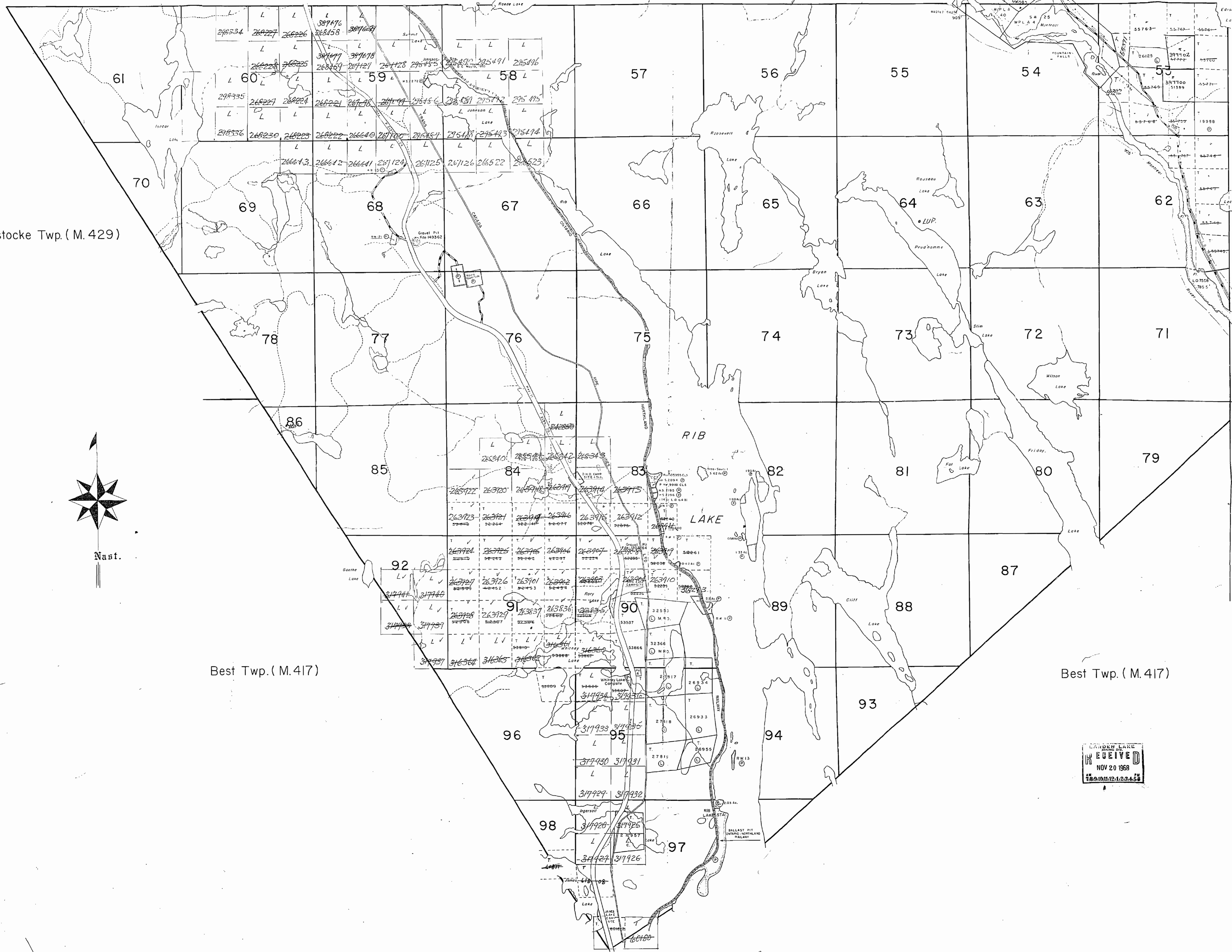

1/25/82

geology reference-COBALT

North Part Gillies Limit (M.484)

THE TOWNSHIP OF
 OF
GILLIES LIMIT
 (SOUTH PART)
 DISTRICT OF
 TIMISKAMING
 LARDER LAKE
 MINING DIVISION
 SCALE: 1 INCH = 20 CHAINS

LEGEND

PATENTED LAND	CS.
CROWN LAND SALE	C.S.
LEASES	LOC.
LOCATED LAND	L.O.
LICENSE OF OCCUPATION	M.R.O.
MINING RIGHTS ONLY	S.R.O.
SURFACE RIGHTS ONLY	S.R.O.
ROADS	
IMPROVED ROADS	
KINGS HIGHWAYS	
RAILWAYS	
POWER LINES	
MARSH OR MUSKOG	
MINES	

NOTES

400' Surface Rights Reservation along the shores of all lakes and rivers.

Mining Claims Accepted Subject To Sec.54 Of The Mining Act (R.S.O. 1970).

L.O. 7556 Covers Flooding Rights On Montreal River Upstream From The Upper Notch Power Site To Contour: Elevation 785.5' H.E.P.C. File: 20994 Vol.3.

Reserve Flooding rights to contour 805' S.E.C. 19 Order No. 1427.

WITHDRAWN from STAKING
 ORDER No. W 3/82 NOV 5/82

Areas withdrawn from staking under Section 63 of the Mining Act (R.S.O. 1970)

Order No.	File	Date	Disposition
23779	18540	2/2/79	S.R.O.
23782	18540	1/10/82	S.R.O.

NOTICE OF FORESTRY ACTIVITY

THIS TOWNSHIP 1 AREA FALLS WITHIN THE (TOWNSHIP) MANAGEMENT UNIT, AND MAY BE SUBJECT TO FORESTRY OPERATIONS. THE UNIT FORESTER FOR THIS AREA CAN BE CONTACTED AT: P.O. BOX 28, LAKESHORE DRIVE, TEMAGAMI, ONT. P0H 2H0, TEL: 869-3622.

THE INFORMATION THAT APPEARS ON THIS MAP HAS BEEN COMPILED FROM VARIOUS SOURCES AND ACCURACY IS NOT GUARANTEED. THOSE DESIRING TO STAKE MINING CLAIMS SHOULD CONSULT WITH THE MINING RECORDER, MINISTRY OF NORTHERN DEVELOPMENT AND MINES FOR ADDITIONAL INFORMATION ON THE STATUS OF THE LANDS SHOWN HEREON.

DATE OF ISSUE
 MAR 26 1982
 LARDER LAKE
 MINING RECORDER'S OFFICE

PLAN NO: M 483
 MINISTRY OF NATURAL RESOURCES
 SURVEY AND MAPPING BRANCH

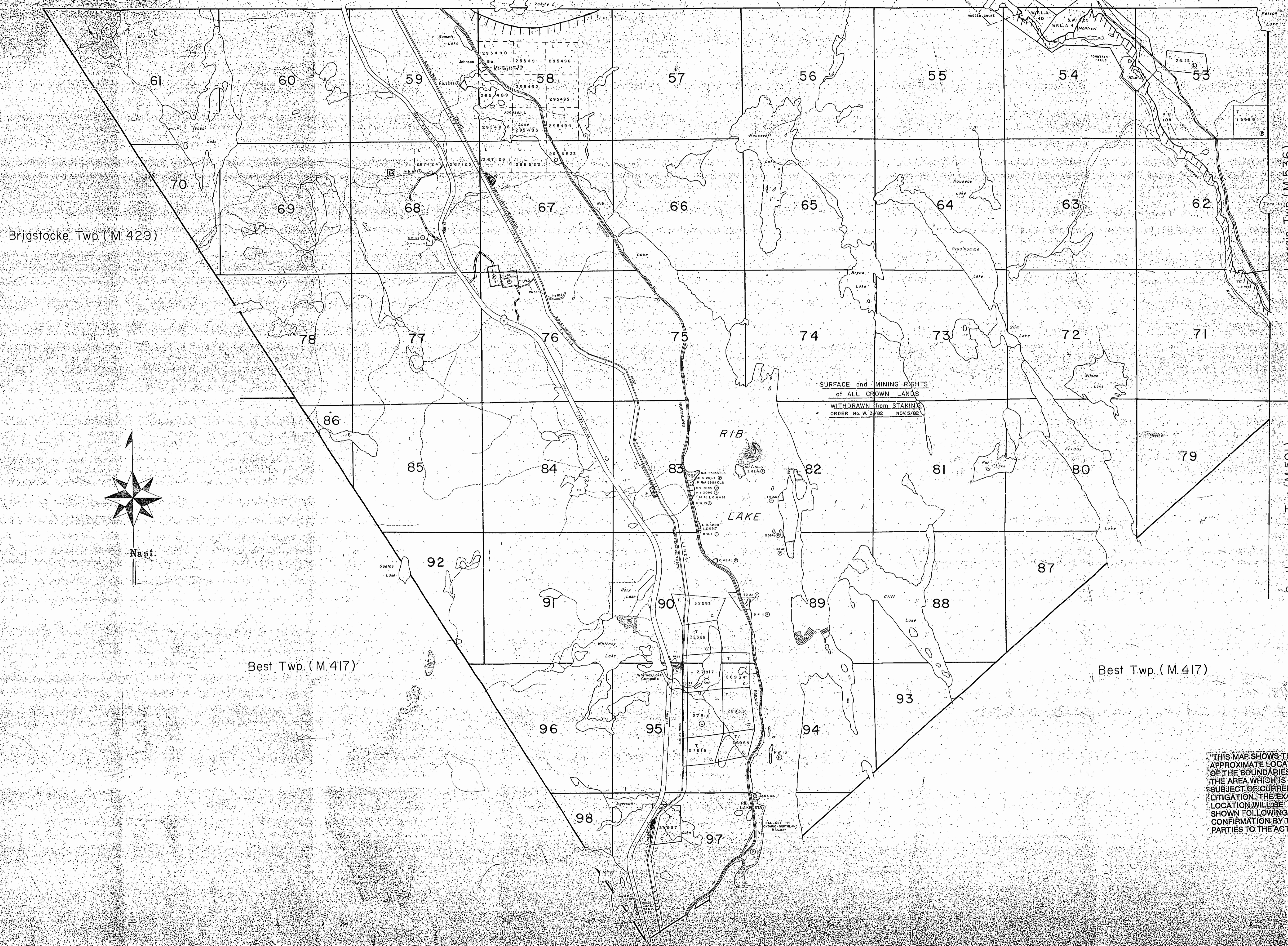

THIS MAP SHOWS THE APPROXIMATE LOCATION OF THE BOUNDARIES OF THE AREA WHICH IS THE SUBJECT OF CURRENT LITIGATION. THE EXACT LOCATION WILL BE SHOWN FOLLOWING CONFIRMATION BY THE PARTIES TO THE ACTION.

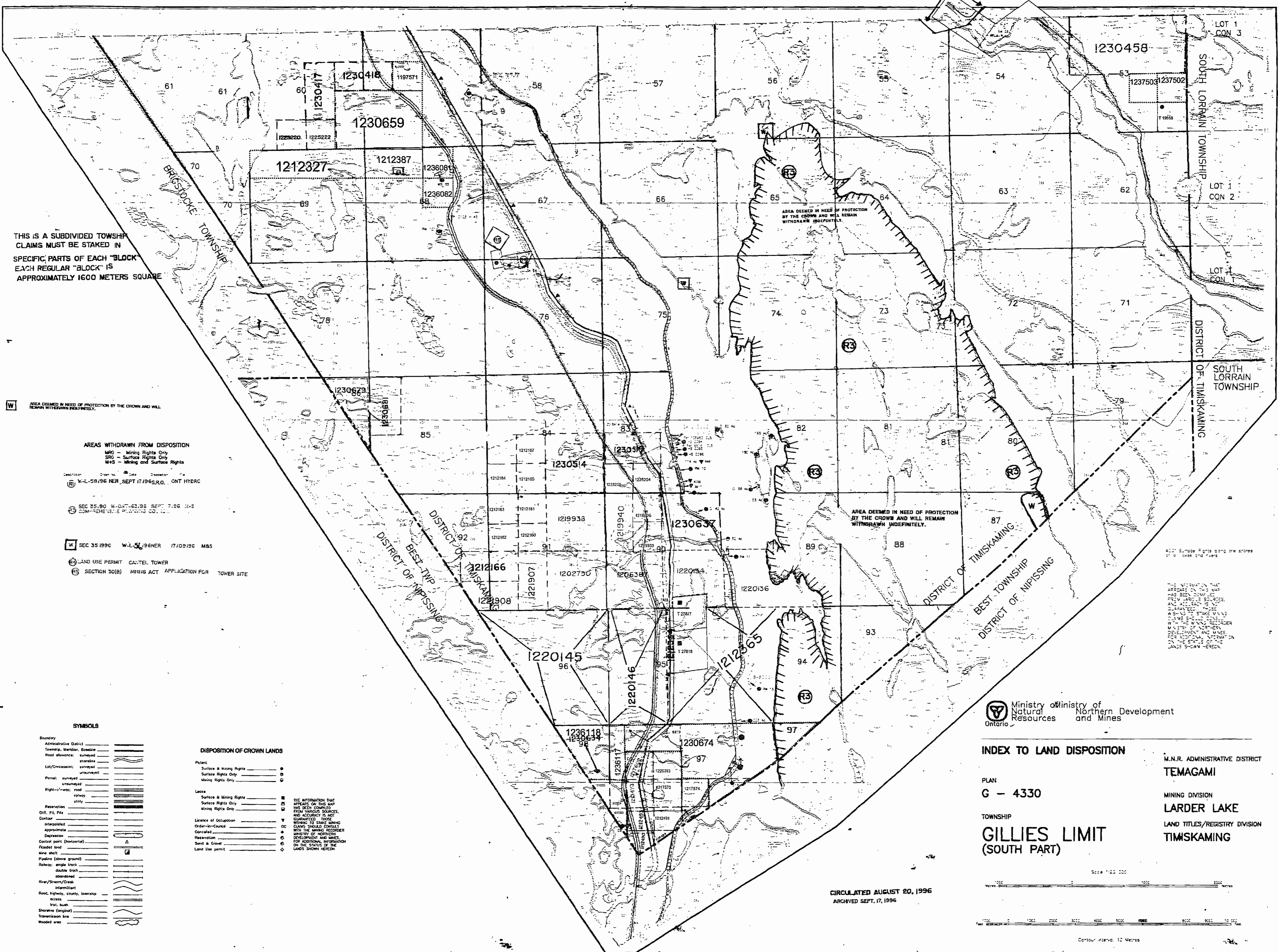

THIS IS A SUBDIVIDED TOWNSHIP CLAIMS MUST BE STAKED IN SPECIFIC PARTS OF EACH "BLOCK" EACH REGULAR "BLOCK" IS APPROXIMATELY 1600 METERS SQUARE

W AREA DEEMED IN NEED OF PROTECTION BY THE CROWN AND WILL REMAIN WITHDRAWN INDEFINITELY.

AREAS WITHDRAWN FROM DISPOSITION
 MRD - Mining Rights Only
 SRG - Surface Rights Only
 M+S - Mining and Surface Rights

- W-L-59/96 NER SEPT 17/96, R.O. ONT HYDR
- SEC 35.90 W-ONT-62.96 SEPT 7.96 M+S COMPREHENSIVE PLANNING CO. LTD.
- W SEC 35 1990 W-L-5/9ENER 17/09/96 M+S
- LAND USE PERMIT CAPEL TOWER
- SECTION 30(B) MINING ACT APPLICATION FOR TOWER SITE

SYMBOLS

- Boundary
- Administrative District
- Township, Meridian, Baseline
- Road advance: surveyed
- stakeless
- Lot/Concession: surveyed
- unsurveyed
- Parcel: surveyed
- unsurveyed
- Right-of-way: road
- railway
- slidy
- Reservation
- Chf, P.A, P.E
- Contour
- Interpolated
- approximate
- Depression
- Control point (horizontal)
- Flooded land
- Mine shaft
- Pipeline (above ground)
- Railway: single track
- double track
- abandoned
- River/Stream/Creek
- intermittent
- Road, highway, county, township
- access
- trap, bush
- Shoreline (original)
- Transmission line
- Wooded area

DISPOSITION OF CROWN LANDS

- Patent
- Surface & Mining Rights
- Surface Rights Only
- Mining Rights Only
- Lease
- Surface & Mining Rights
- Surface Rights Only
- Mining Rights Only
- Licence of Occupation
- Order-in-Council
- Cancelled
- Reservation
- Sand & Gravel
- Land Use permit

THE INFORMATION THAT APPEARS ON THIS MAP HAS BEEN COMPILED FROM VARIOUS SOURCES, AND ACCURACY IS NOT GUARANTEED. THOSE HOLDING OLD CLAIMS SHOULD CONSULT WITH THE MINING RECORDER, MINISTRY OF NORTHERN DEVELOPMENT AND MINES, FOR ADDITIONAL INFORMATION ON THE STATUS OF THE LANDS SHOWN HEREON.

400' Surface Rights along the shores of all lakes and rivers.
 THE INFORMATION THAT APPEARS ON THIS MAP HAS BEEN COMPILED FROM VARIOUS SOURCES, AND ACCURACY IS NOT GUARANTEED. THOSE HOLDING OLD CLAIMS SHOULD CONSULT WITH THE MINING RECORDER, MINISTRY OF NORTHERN DEVELOPMENT AND MINES, FOR ADDITIONAL INFORMATION ON THE STATUS OF THE LANDS SHOWN HEREON.

Ministry of Natural Resources Ontario / Ministry of Northern Development and Mines

INDEX TO LAND DISPOSITION

PLAN G - 4330

TOWNSHIP GILLIES LIMIT (SOUTH PART)

M.N.R. ADMINISTRATIVE DISTRICT TEMAGAMI
 MINING DIVISION LARDER LAKE
 LAND TITLES/REGISTRY DIVISION TIMSKAMING

CIRCULATED AUGUST 20, 1996
 ARCHIVED SEPT. 17, 1996

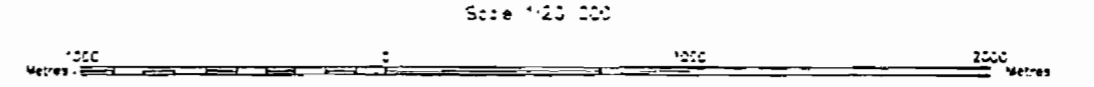

Contour Interval: 10 Metres

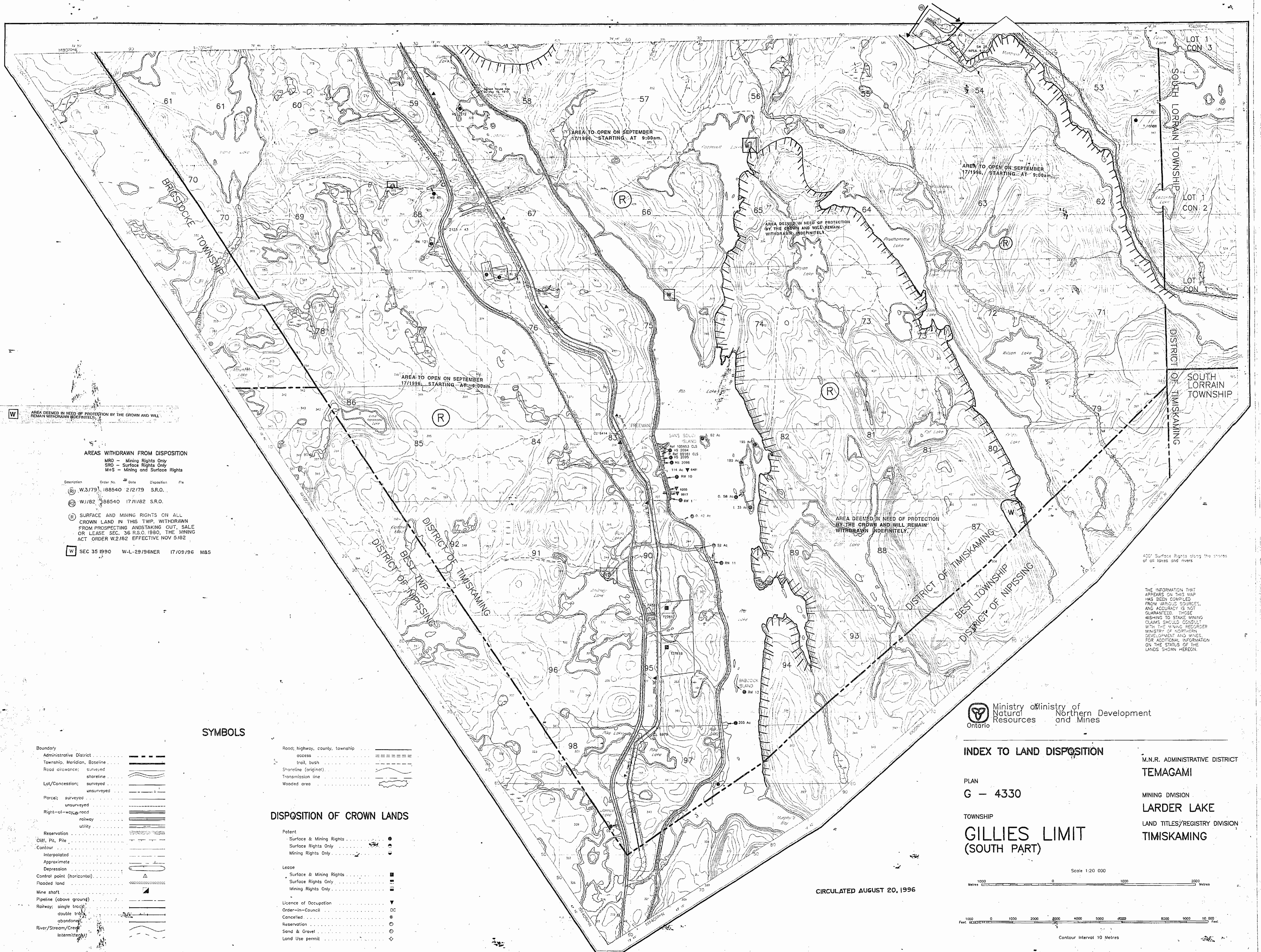

W AREA DEEMED IN NEED OF PROTECTION BY THE CROWN AND WILL REMAIN WITHDRAWN INDEFINITELY.

AREAS WITHDRAWN FROM DISPOSITION
 MRO - Mining Rights Only
 SRO - Surface Rights Only
 M+S - Mining and Surface Rights

Description	Order No.	Date	Disposition	File
(R)	W.3/779	188540	2/2/79	S.R.O.
(R)	W.1/82	188540	17/11/82	S.R.O.
(R)	SURFACE AND MINING RIGHTS ON ALL CROWN LAND IN THIS TWP. WITHDRAWN FROM PROSPECTING AND STAKING OUT, SALE OR LEASE SEC. 36 R.S.O. 1980, THE MINING ACT ORDER W.2/82 EFFECTIVE NOV 5/82			
(W)	SEC 35 1990	W-L-29/96NER	17/09/96	M+S

SYMBOLS

Boundary	
Administrative District	-----
Township, Meridian, Baseline	-----
Road allowance: surveyed	-----
unsurveyed	-----
Lot/Concession: surveyed	-----
unsurveyed	-----
Parcel: surveyed	-----
unsurveyed	-----
Right-of-way: road	-----
railway	-----
utility	-----
Reservation	-----
Cliff, Pit, Pile	-----
Contour	-----
Interpolated	-----
Approximate	-----
Control point (horizontal)	-----
Flooded land	-----
Mine shaft	-----
Pipeline (above ground)	-----
Railway: single track	-----
double track	-----
abandoned	-----
River/Stream/Creek	-----
intermittent	-----

Road: highway, county, township	-----
access	-----
trail, bush	-----
Shoreline (original)	-----
Transmission line	-----
Wooded area	-----

DISPOSITION OF CROWN LANDS

Patent	
Surface & Mining Rights	●
Surface Rights Only	○
Mining Rights Only	○
Lease	
Surface & Mining Rights	■
Surface Rights Only	□
Mining Rights Only	□
Licence of Occupation	
Order-in-Council	OC
Cancelled	○
Reservation	○
Sand & Gravel	○
Land Use permit	◇

Ministry of Natural Resources Ontario
 Ministry of Northern Development and Mines

INDEX TO LAND DISPOSITION

PLAN
G - 4330
 TOWNSHIP
GILLIES LIMIT (SOUTH PART)

M.N.R. ADMINISTRATIVE DISTRICT
TEMAGAMI
 MINING DIVISION
LARDER LAKE
 LAND TITLES/REGISTRY DIVISION
TIMISKAMING

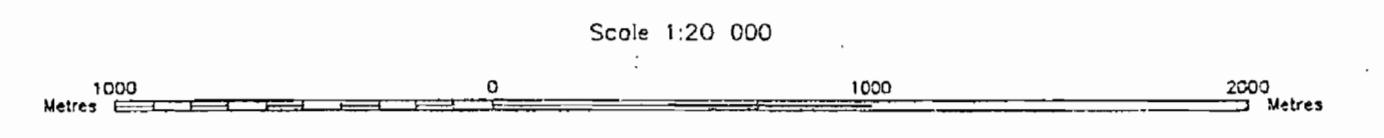

CIRCULATED AUGUST 20, 1996

VING NUMBER

Gillies Limit (South part)
 Sept 17/96

DRAWING NUMBER

DRAWING 1

North Part Gillies Limit (M.484)

geology reference-COBALT

THE TOWNSHIP OF GILLIES LIMIT (SOUTH PART) DISTRICT OF TIMISKAMING LARDER LAKE MINING DIVISION SCALE: 1 INCH = 20 CHAINS

LEGEND

- Patented Land, Crown Land Sale, Leases, Licensed Land, License of Occupation, Mining Rights Only, Surface Rights Only, Roads, Improved Roads, Kings Highways, Railways, Power Lines, Marsh or Muskeg, Mines.

NOTES

400' Surface Rights Reservation along the shores of all lakes and rivers. Mining Claims Accepted Subject to Sec. 54 of The Mining Act (R.S.O. 1970). L.O. 7558 Covers Flooding Rights On Montreal River Upstream From The Upper Notch Power Site to Contour Elevation 785.5' M.E.P.C. File: 20994 Vol. 3.

Reserve flooding rights to contour 905' G.S.G. to Ontario Hydro.

Table with columns: Sand & Gravel, Gravel Pit File, and Disposition. Includes entries for files 149362, 120363, 120364, and 26581.

Table with columns: Areas withdrawn from staking under Section 43 of the Mining Act (R.S.O. 1970), Order No., Date, and Disposition. Includes entries for orders 2775, 2776, and 1792.

Surface and Mining Rights on all Crown Land in this township withdrawn from prospecting, staking out, sale or lease Section 26 R.S.O. 1970, The Mining Act, Order N 27 of effective NOV. 5, 1982.

Part of order N 2702 RE-OPENED by order 2800/82 effective April 5, 1980 at 7:00 AM EST.

AREA DEEMED IN NEED OF PROTECTION BY THE CROWN AND WILL REMAIN WITHDRAWN INDEFINITELY.

NOTICE OF FORESTRY ACTIVITY THIS TOWNSHIP / AREA FALLS WITHIN THE LATCHFORD MANAGEMENT UNIT AND MAY BE SUBJECT TO FORESTRY OPERATIONS. THE MNR UNIT FORESTER FOR THIS AREA CAN BE CONTACTED AT: PO BOX 30 LAKESHORE DRIVE TENINGHAM, ONT. POB 240 705-563-3622

THE INFORMATION THAT APPEARS ON THIS MAP HAS BEEN COMPILED FROM VARIOUS SOURCES AND ACCURACY IS NOT GUARANTEED. THOSE WISHING TO STAKE MINING CLAIMS SHOULD CONSULT WITH THE MINING RECORDER, MINISTRY OF NORTHERN DEVELOPMENT AND MINES FOR ADDITIONAL INFORMATION ON THE STATUS OF THE LANDS SHOWN HEREIN.

Surface Right Withdrawn under Sec. 56. The Mining Act R.S.O. 1970, ORDER NO. 2800/82 (Town Grants Pipeline Right of Way and Buffer Zone per Section 42.25 meters or 138 ft on either side of centre line of right of way)

THIS MAP SHOWS THE APPROXIMATE LOCATION OF THE BOUNDARIES OF THE AREA WHICH IS THE SUBJECT OF CURRENT LITIGATION. THE EXACT LOCATION WILL BE SHOWN FOLLOWING CONFIRMATION BY THE PARTIES TO THE ACTION. REPLACED AUGUST 20, 1996. PLAN NO-M.483 ONTARIO MINISTRY OF NATURAL RESOURCES SURVEYS AND MAPPING BRANCH

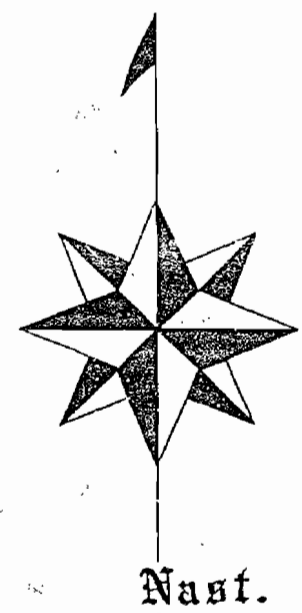
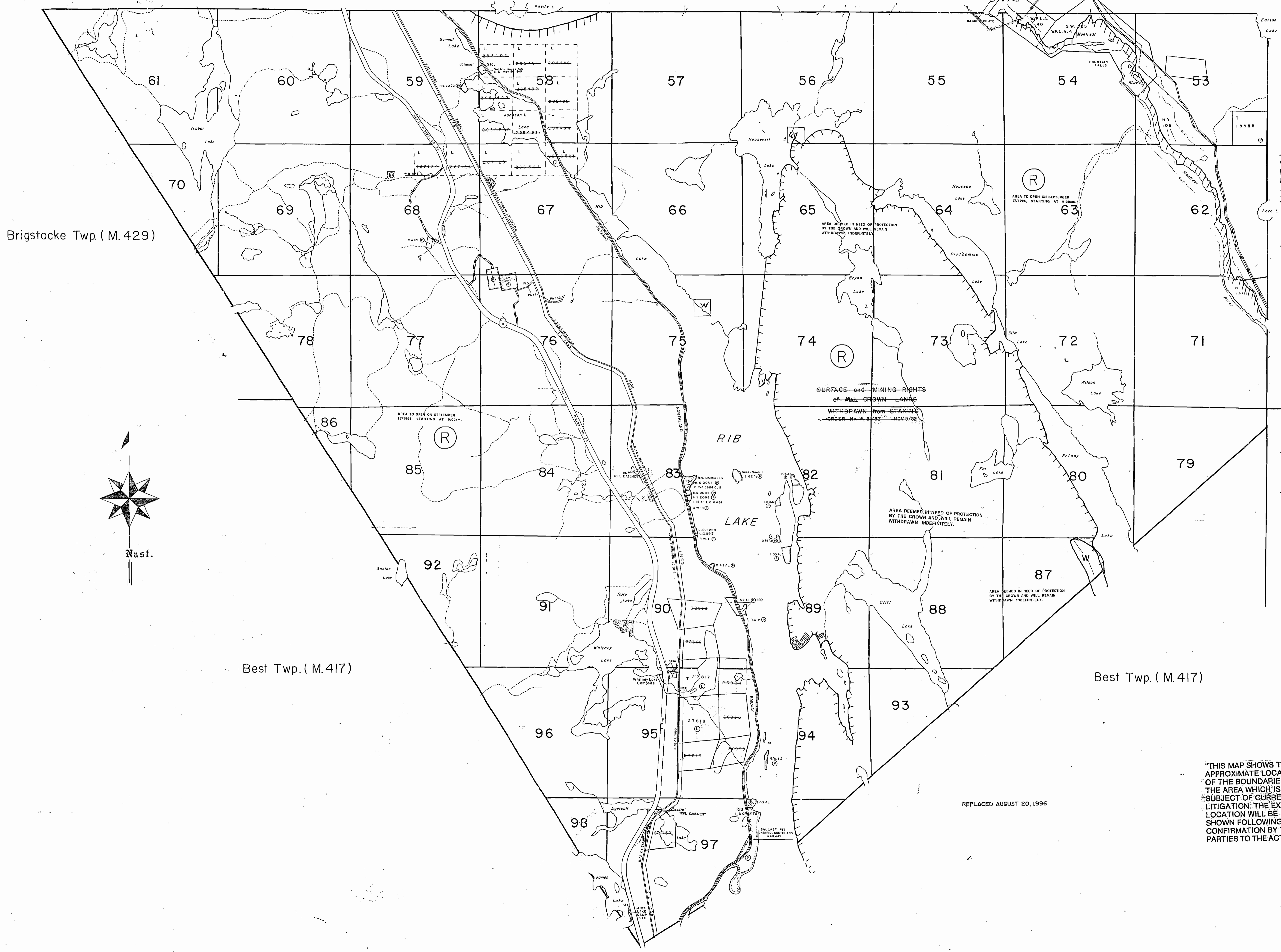

Brigstocke Twp. (M.429)

Lorrain Twp. (M.536)

South Lorrain Twp. (M.591)

Best Twp. (M.417)

Best Twp. (M.417)

REPLACED AUGUST 20, 1996

SOUTH PART GILLIES LIMIT

COBALT REFERENCE

EB+W

North Part Gillies Limit (M.484)

THE TOWNSHIP OF
GILLIES LIMIT
(SOUTH PART)
DISTRICT OF
TIMISKAMING

LARDER LAKE
MINING DIVISION

SCALE: 1 INCH = 20 CHAINS

483

LEGEND

PATENTED LAND	⊙
CROWN LAND SALE	⊙
LEASES	⊙
LOCATED LAND	⊙
LICENSE OF OCCUPATION	⊙
MINING RIGHTS ONLY	⊙
SURFACE RIGHTS ONLY	⊙
ROADS	—
IMPROVED ROADS	—
KINGS HIGHWAYS	—
RAILWAYS	—
POWER LINES	—
MARSH OR MUSKEG	—
MINES	—

NOTES

This Twp. Lies Within The
TIMAGAMI PROVINCIAL FOREST.

400' Surface Rights Reservation Around All
Lakes And Rivers

Mining Claims Accepted Subject To Sec. 53
Of The Mining Act

L.O. 7558 Covers Flooding Rights On Montreal
River Upstream From The Upper Notch Power
Site To Contour Elevation 785.5'
N.E.P.C. File - 20994 Vol 3.

RESERVE FLOODING RIGHTS TO HE PC (PROPOSED)
TO CONTOUR 905' G.S.C.

Brigstocke Twp. (M. 429)

Lorrain Twp. (M. 536)

South Lorrain Twp. (M. 591)

Best Twp. (M. 417)

Best Twp. (M. 417)

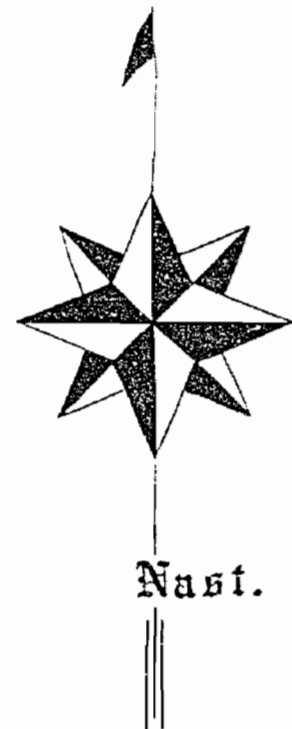

Nast.

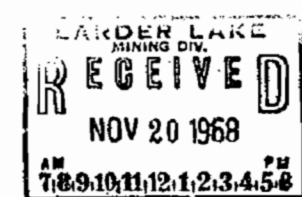

GILLIES LIMIT(S)
PLAN NO.-M. 483

DEPARTMENT OF MINES
—ONTARIO—

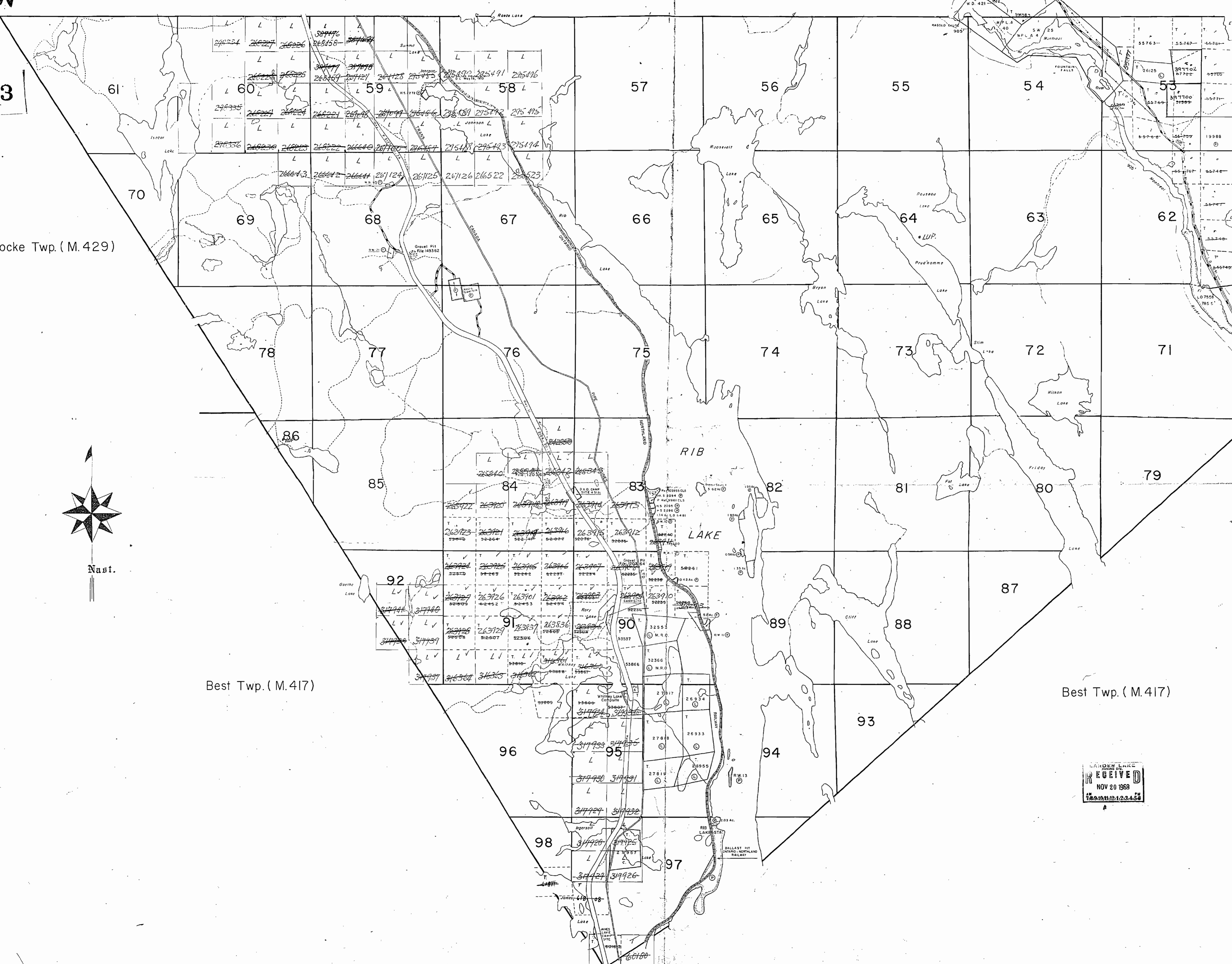

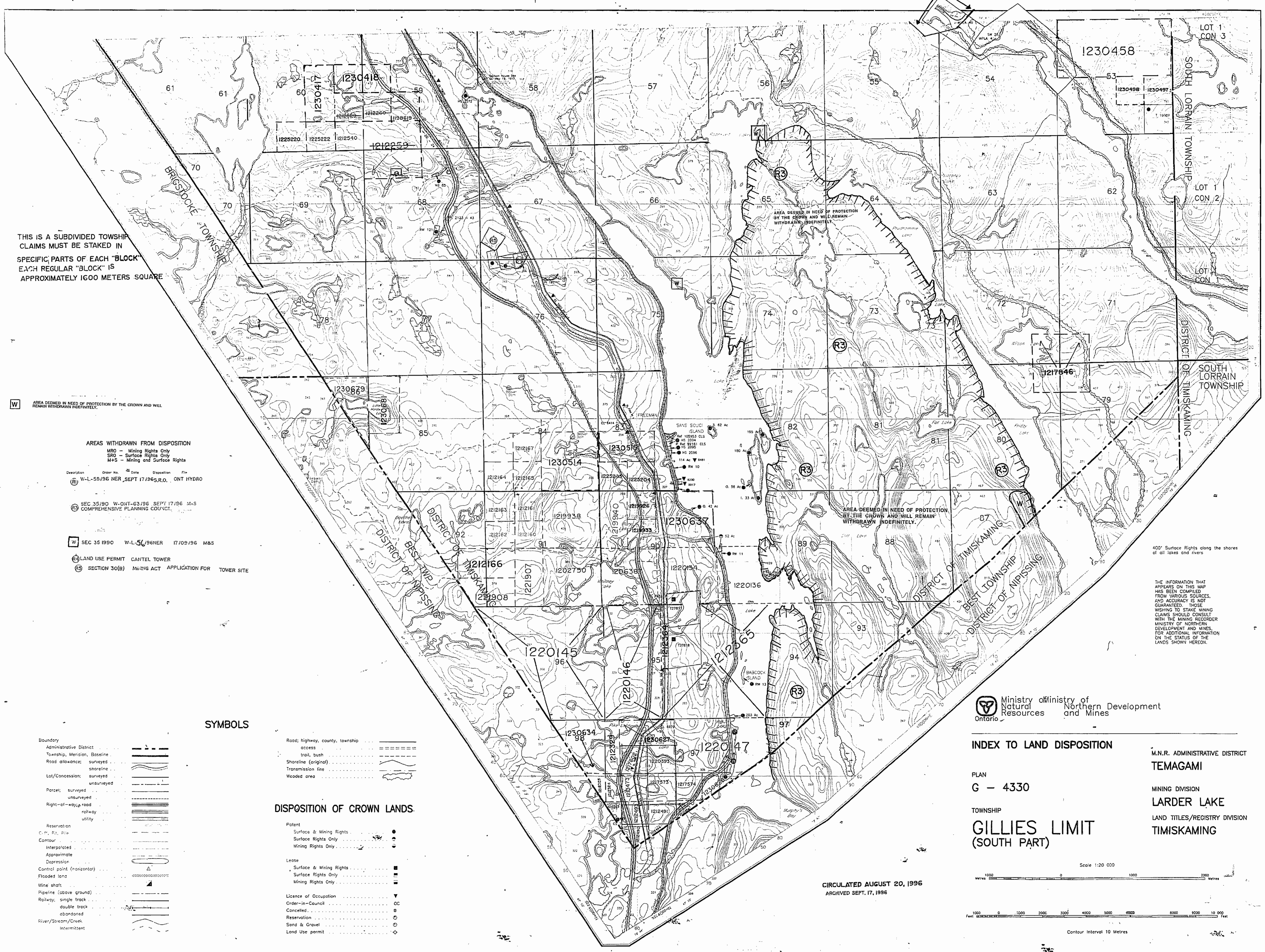

THIS IS A SUBDIVIDED TOWNSHIP CLAIMS MUST BE STAKED IN SPECIFIC PARTS OF EACH "BLOCK" EACH REGULAR "BLOCK" IS APPROXIMATELY 1600 METERS SQUARE

AREA DEEMED IN NEED OF PROTECTION BY THE CROWN AND WILL REMAIN WITHDRAWN INDEFINITELY

AREAS WITHDRAWN FROM DISPOSITION
 MRO - Mining Rights Only
 SRO - Surface Rights Only
 M+S - Mining and Surface Rights

Order No. Date Disposition File
 W-L-55/96 NER SEPT 17/96 S.R.O. ONT HYDRO

SEC 35/90 W-ONT-63/96 SEPT 17/96 M+S COMPREHENSIVE PLANNING COUNCIL

SEC 35 1990 W-L-5/96NER 17/09/96 M+S

LAND USE PERMIT CANTEL TOWER
 SECTION 30(6) MINING ACT APPLICATION FOR TOWER SITE

400' Surface Rights along the shores of all lakes and rivers

THE INFORMATION THAT APPEARS ON THIS MAP HAS BEEN COMPILED FROM VARIOUS SOURCES AND ACCURACY IS NOT GUARANTEED. THOSE WISHING TO STAKE MINING CLAIMS SHOULD CONSULT WITH THE MINING RECORDER, MINISTRY OF NORTHERN DEVELOPMENT AND MINES, FOR ADDITIONAL INFORMATION ON THE STATUS OF THE LANDS SHOWN HEREOF.

SYMBOLS

- Boundary
- Administrative District
- Township, Meridian, Baseline
- Road allowance, surveyed
- Lot/Concession, surveyed
- Parcel, surveyed
- Right-of-way, road
- Right-of-way, utility
- Reservation
- C.M., B.L., E.L.
- Contour
- Interpolated
- Appropriate
- Depression
- Control point (horizontal)
- Flooded land
- Mine shaft
- Pipeline (above ground)
- Railway, single track
- abandoned
- River/Stream/Creek, intermittent

- Road, highway, county, township
- access
- trail, bush
- Shoreline (original)
- Transmission line
- Wooded area

DISPOSITION OF CROWN LANDS

- Patent
- Surface & Mining Rights
- Surface Rights Only
- Mining Rights Only
- Lease
- Surface & Mining Rights
- Surface Rights Only
- Mining Rights Only
- Licence of Occupation
- Order-in-Council
- Cancelled
- Reservation
- Sand & Gravel
- Land Use permit

Ministry of Natural Resources Ontario / Ministry of Northern Development and Mines

INDEX TO LAND DISPOSITION

PLAN
 G - 4330
 TOWNSHIP
GILLIES LIMIT (SOUTH PART)

M.N.R. ADMINISTRATIVE DISTRICT
TEMAGAMI
 MINING DIVISION
LARDER LAKE
 LAND TITLES/REGISTRY DIVISION
TIMISKAMING

CIRCULATED AUGUST 20, 1996
 ARCHIVED SEPT. 17, 1996

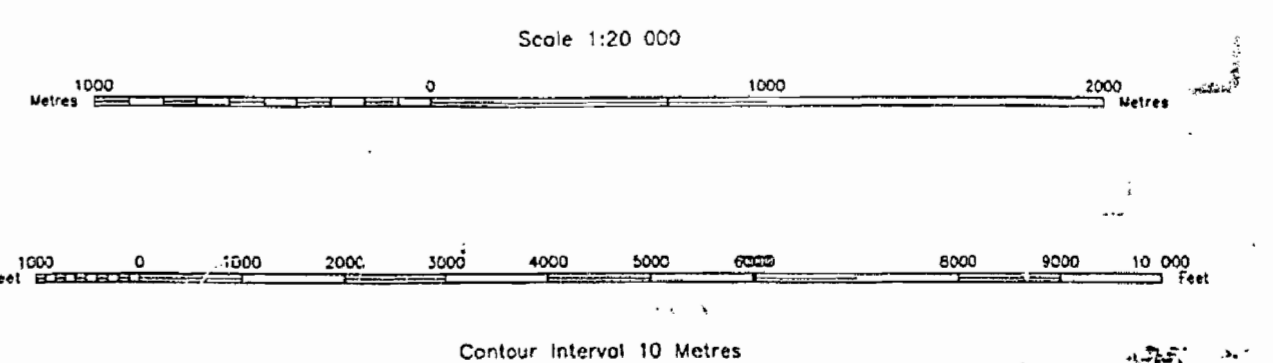

North Part Gillies Limit (M.484)

THE TOWNSHIP OF
GILLIES LIMIT
 (SOUTH PART)
 DISTRICT OF
 TIMISKAMING-NIPISSING
 TIMISKAMING
 MINING DIVISION
 SCALE: 1 INCH = 20 CHAINS

LEGEND

PATENTED LAND	CS
CROWN LAND SALE	CO
LEASES	LO
LOCATED LAND	LC
LICENSE OF OCCUPATION	LO
MINING RIGHTS ONLY	M.O.
SURFACE RIGHTS ONLY	S.R.O.
ROADS	RD
IMPROVED ROADS	IR
KINGS HIGHWAYS	KH
RAILWAYS	RL
POWER LINES	PL
MARSH OR MUSKEG	MS
MINES	MI

NOTES

This Twp. Lies Within The
 TIMAGAMI PROVINCIAL FOREST.

400' Surface Rights Reservation Around All
 Lakes And Rivers

Mining Claims Accepted Subject To Sec. 53
 Of The Mining Act.

L.O.7558 Covers Flooding Rights On Montreal
 River Upstream From The Upper Notch Power
 Site To Contour Elevation 785.5'
 N.E.C. File: 20994 Vol. 3.

RESERVE FLOODING RIGHTS TO HELP
 (PROPOSED) TO CONTOUR 905' E.S.C.



SUB TO
 SECTION 53

PLAN NO.-M.483
 DEPARTMENT OF MINES
 -ONTARIO-

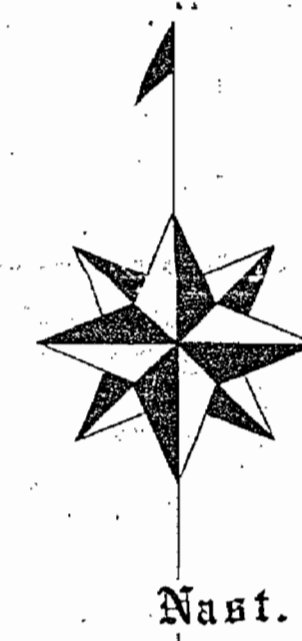
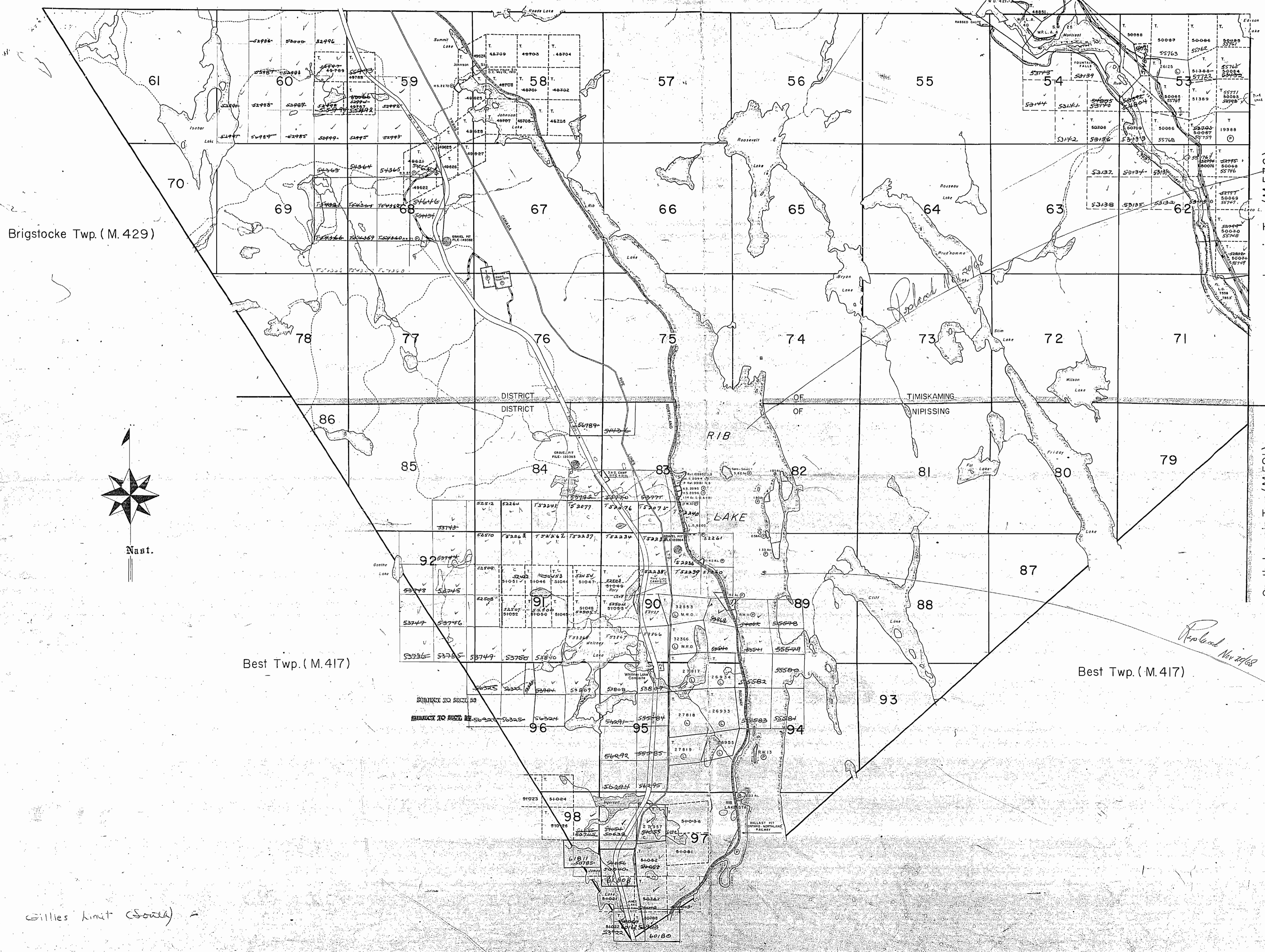

Best Twp. (M.417)

Best Twp. (M.417)

Gillies limit (south)

Lorrain Twp. (M.536)

South Lorrain Twp. (M.591)

SOUTH PART GILLIES LIMIT

SOUTH PART GILLIES LIMIT

M.483

M.483

EB+W

North Part Gillies Limit (M.484)

THE TOWNSHIP OF
GILLIES LIMIT
(SOUTH PART)
DISTRICT OF
TIMISKAMING
LARDER LAKE
MINING DIVISION

SCALE: 1 INCH = 20 CHAINS

LEGEND

- PATENTED LAND Ⓢ
- CROWN LAND SALE Ⓞ
- LEASES Ⓜ
- LOCATED LAND Ⓛ
- LICENSE OF OCCUPATION Ⓛ.O.
- MINING RIGHTS ONLY M.R.O.
- SURFACE RIGHTS ONLY S.R.O.
- ROADS —
- IMPROVED ROADS —
- KINGS HIGHWAYS —
- RAILWAYS —
- POWER LINES —
- MARSH OR MUSKOG —
- MINES *

NOTES

This Twp. Lies Within The
TIMAGAMI PROVINCIAL FOREST.

400' Surface Rights Reservation Around All
Lakes And Rivers

Mining Claims Accepted Subject To Sec. 53
Of The Mining Act.

L.O. 755B Covers Flooding Rights On Montreal
River Upstream From The Upper Notch Power
Site To Contour Elevation 785.5'
M.E.P.C. File: 20994 Vol 3.

RESERVE FLOODING RIGHTS TO M.E.P.C. (PROPOSED)
TO CONTOUR 805' G.S.C.

Brigstocke Twp. (M.429)

Lorrain Twp. (M.536)

South Lorrain Twp. (M.591)

Best Twp. (M.417)

Best Twp. (M.417)

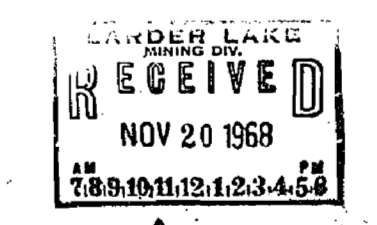
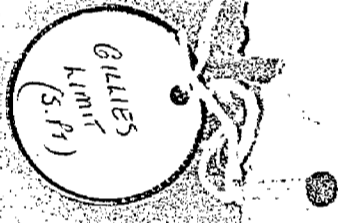
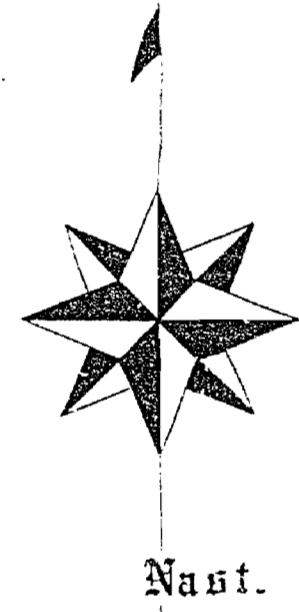

GILLIES LIMIT(S)
PLAN NO.-M.483
DEPARTMENT OF MINES
—ONTARIO—

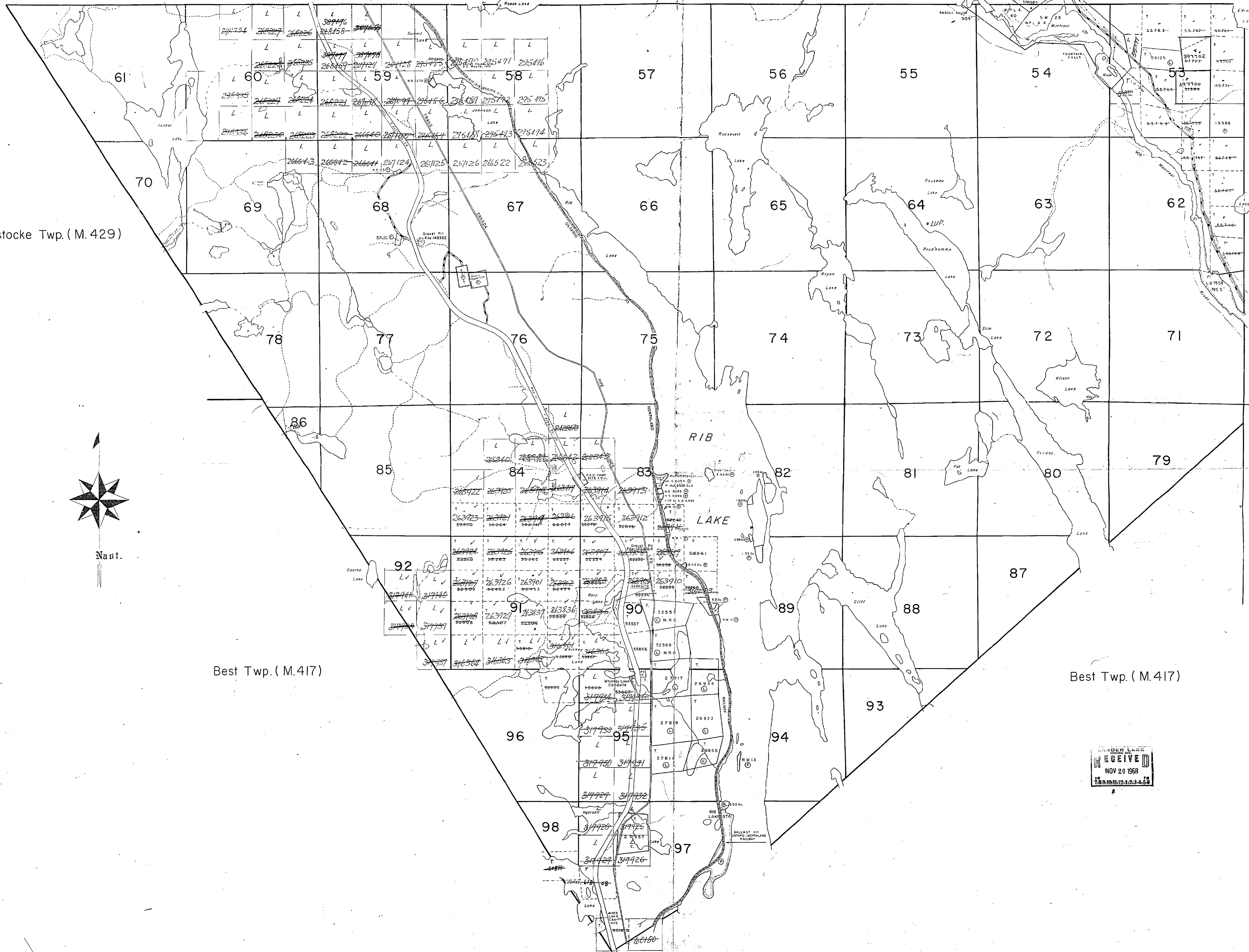

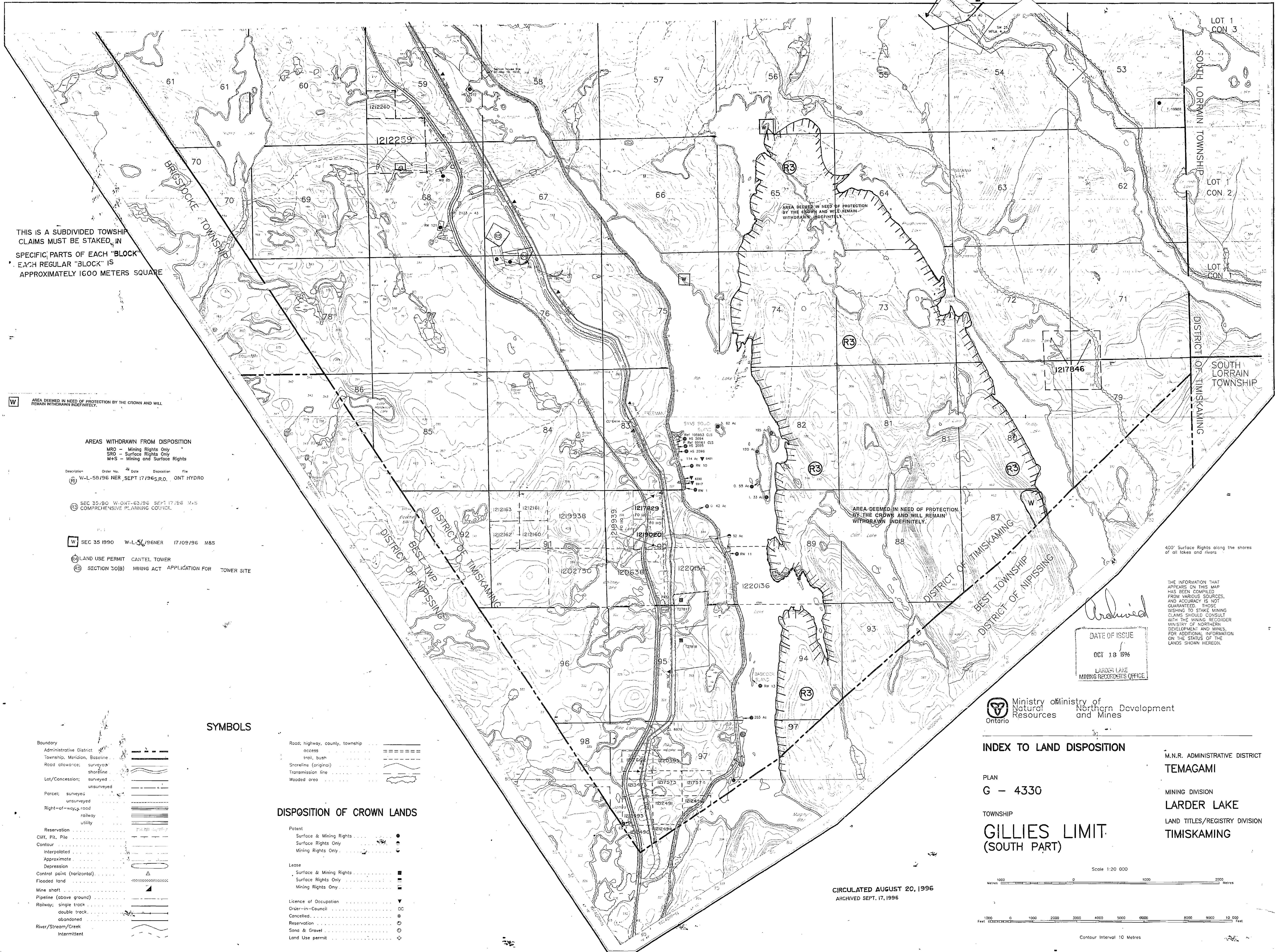

THIS IS A SUBDIVIDED TOWNSHIP
CLAIMS MUST BE STAKED IN
SPECIFIC PARTS OF EACH "BLOCK"
EACH REGULAR "BLOCK" IS
APPROXIMATELY 1600 METERS SQUARE

W AREA DEEMED IN NEED OF PROTECTION BY THE CROWN AND WILL REMAIN WITHDRAWN INDEFINITELY.

- AREAS WITHDRAWN FROM DISPOSITION**
 MRO - Mining Rights Only
 SRO - Surface Rights Only
 M+S - Mining and Surface Rights
- | Description | Order No. | Date | Disposition | File |
|--------------------------|----------------|-----------------|-------------|--------------------------------|
| R W-L-58/96 | NER | SEPT 17/1965 | R.O. | ONT HYDRO |
| R SEC 33, 80 | W-ONT-63/96 | SEPT 17/1968 | M+S | COMPREHENSIVE PLANNING COUNCIL |
| W SEC 35 | 1990 W-L-56/96 | NER 17/108/96 | MBS | |
| R LAND USE PERMIT | CANVEL TOWER | | | |
| R SECTION 30(b) | MINING ACT | APPLICATION FOR | TOWER SITE | |

SYMBOLS

- | | |
|---|---|
| <p>Boundary</p> <ul style="list-style-type: none"> Administrative District Township, Meridian, Baseline Road allowance, surveyed shoreline Lot/Concession, surveyed unsurveyed Parcel, surveyed unsurveyed Right-of-way, road railway utility Reservation Cliff, Pit, Pile Contour Interpolated Approximate Depression Control point (horizontal) Flooded land Mine shaft Pipeline (above ground) Railway, single track double track abandoned River/Stream/Creek intermittent | <p>Road; highway, county, township</p> <ul style="list-style-type: none"> access trail, bush Shoreline (original) Transmission line Wooded area <p>DISPOSITION OF CROWN LANDS</p> <ul style="list-style-type: none"> Patent Surface & Mining Rights Surface Rights Only Mining Rights Only Lease Surface & Mining Rights Surface Rights Only Mining Rights Only Licence of Occupation Order-in-Council Cancelled Reservation Sand & Gravel Land Use permit |
|---|---|

Archieved
 DATE OF ISSUE
 OCT 18 1996
 LARLER LAKE
 MINING RECORDER'S OFFICE

Ministry of Natural Resources
 Ontario
 Ministry of Northern Development and Mines

INDEX TO LAND DISPOSITION

PLAN
 G - 4330
 TOWNSHIP
 GILLIES LIMIT
 (SOUTH PART)

M.N.R. ADMINISTRATIVE DISTRICT
 TEMAGAMI
 MINING DIVISION
 LARLER LAKE
 LAND TITLES/REGISTRY DIVISION
 TIMISKAMING

CIRCULATED AUGUST 20, 1996
 ARCHIVED SEPT. 17, 1996

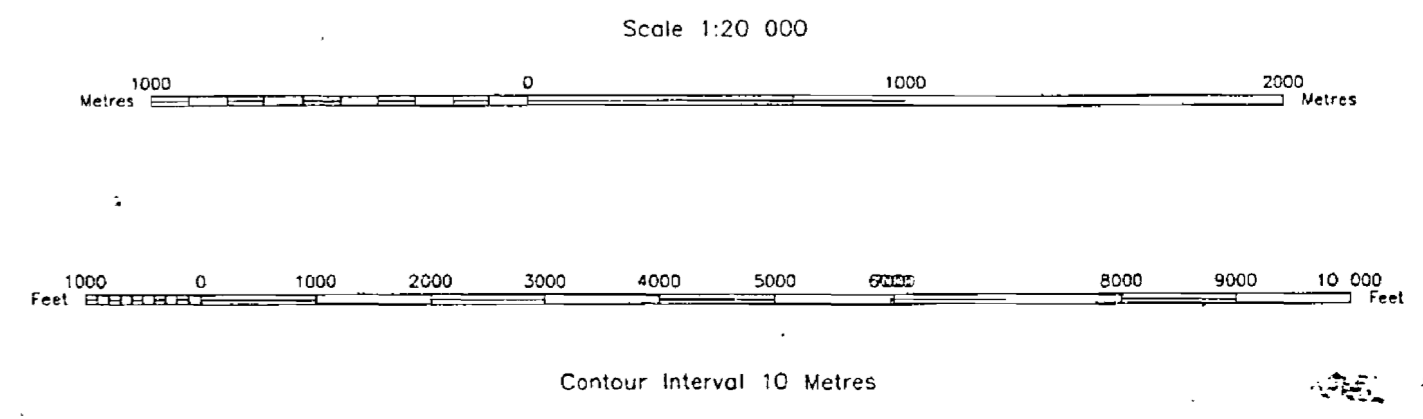

Gillies Limit
 G-4330
 Oct 18 1996

DRAWING NUMBER

DRAWING