

1542

1895 M22 22W 50E 17

TOWNSHIP 29 RANGE 17
 LAKE SUPERIOR PROVINCIAL PARK. OFFICE MAP
 SAULT STE. MARIE MINING DIVISION
 DISTRICT OF ALGOMA.

Scale 40ch = 1inch
 (GOODWILLIE)
 M. 1542
 TWP. 29 RANGE 18

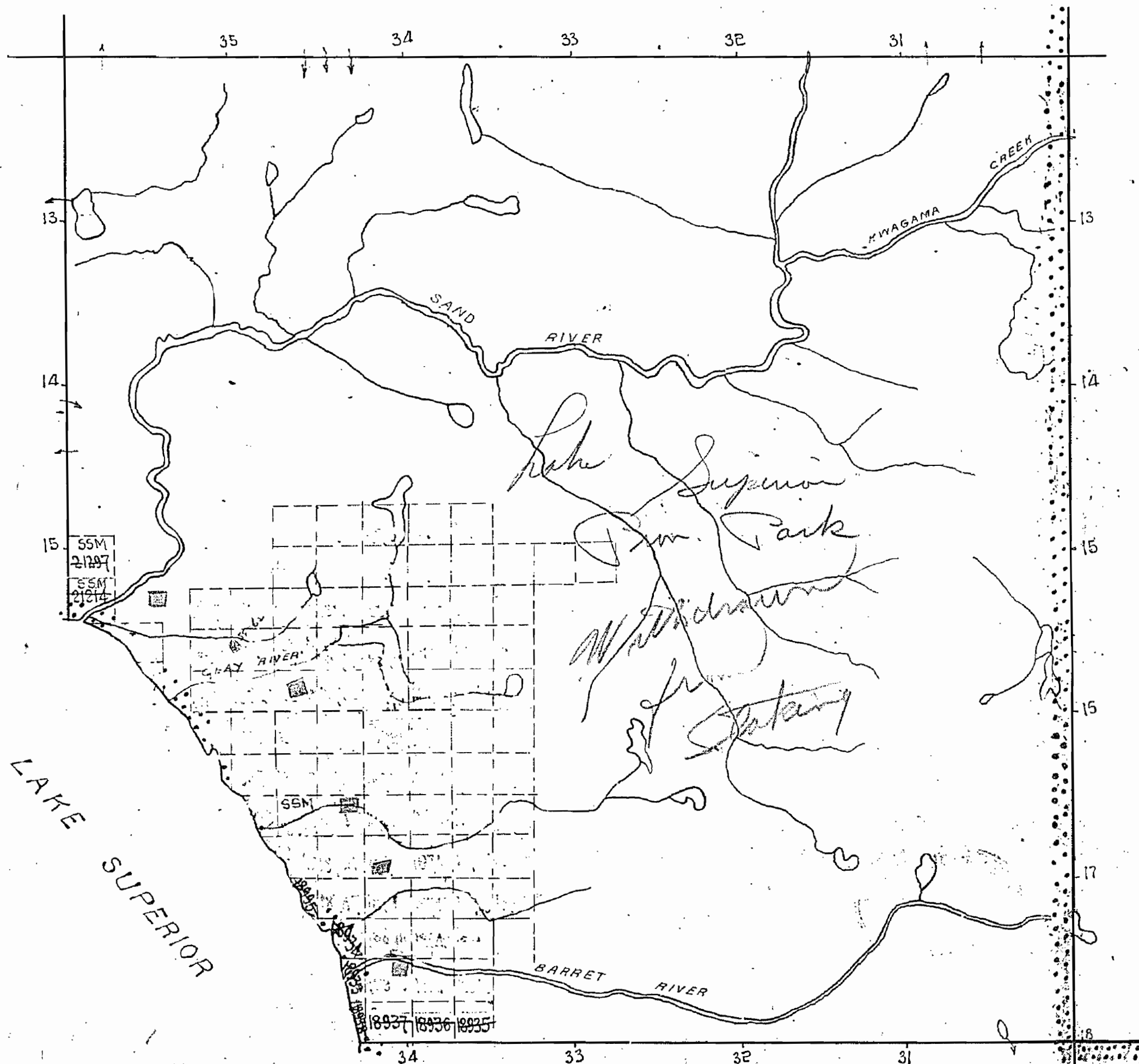

TWP. 28 RANGE 17

TWP. 29 RANGE 16

Denotes boundary of Lake Superior Provincial Park.

DEPT. HIGHWAYS GRANT PERMITS SHOWN THUS 56-155

M22

M22

1542

1M 58' B' 11' 22W

TOWNSHIP 29 RANGE 17

LAKE SUPERIOR PROVINCIAL PARK.

SAULT STE. MARIE MINING DIVISION

DISTRICT OF ALGOMA.

Scale 40ch = 1inch

(GOODWILLIE)
M. 1542
OFFICE MAP

TWP. 29 RANGE 18

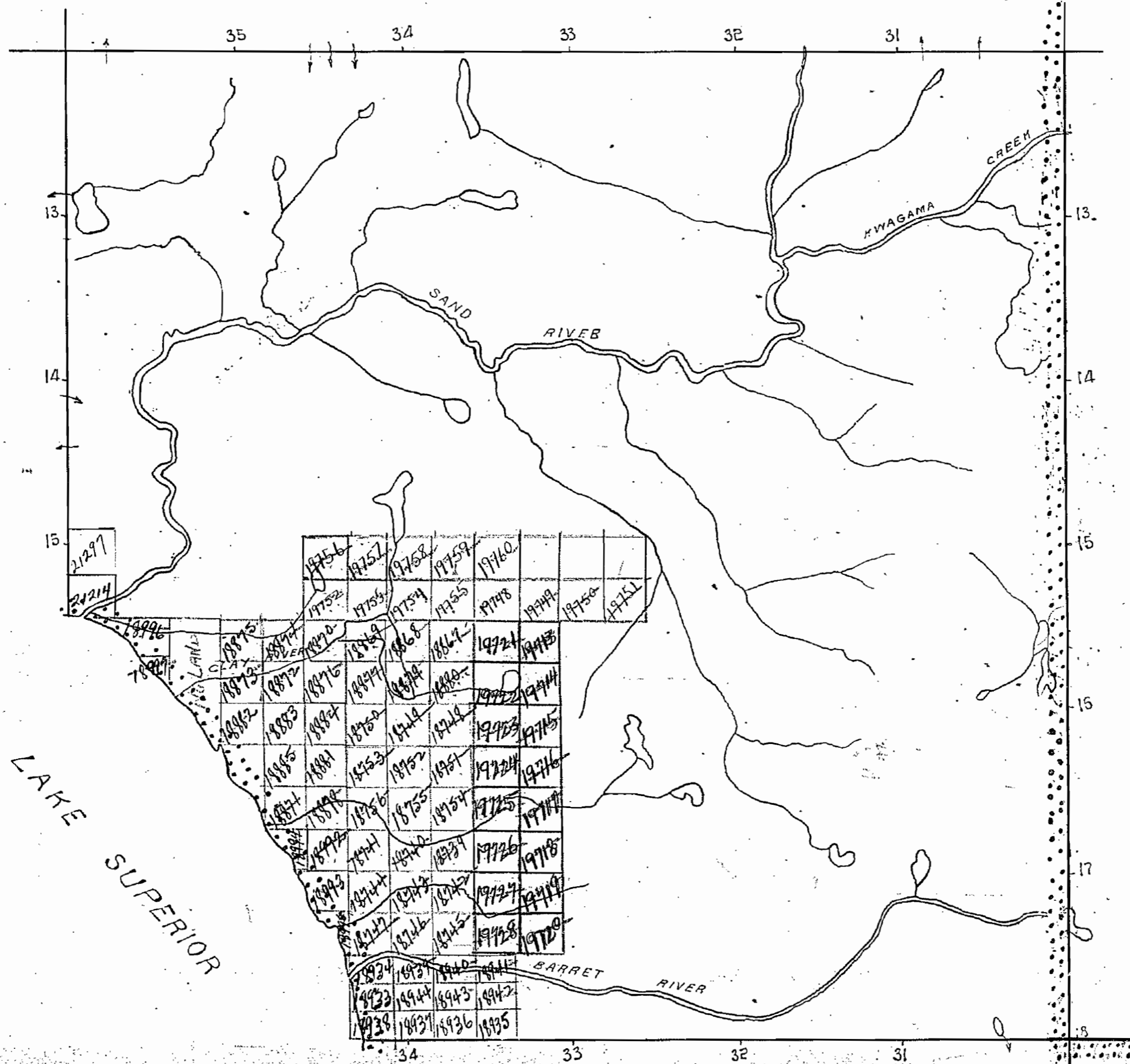

TWP. 28. RANGE 17

TWP. 29 RANGE 16

Denotes boundary of Lake Superior Provincial Park.

M2

1542

MB 58 16 11 W 12 15

OFFICE MAP TOWNSHIP 29 RANGE 17 (GOODWILLIE)
 LAKE SUPERIOR PROVINCIAL PARK. M. 1542
 SAULT STE. MARIE MINING DIVISION
 DISTRICT OF ALGOMA. OFFICE MAP
 Scale 40ch = 1inch

TWP. 29 RANGE 18

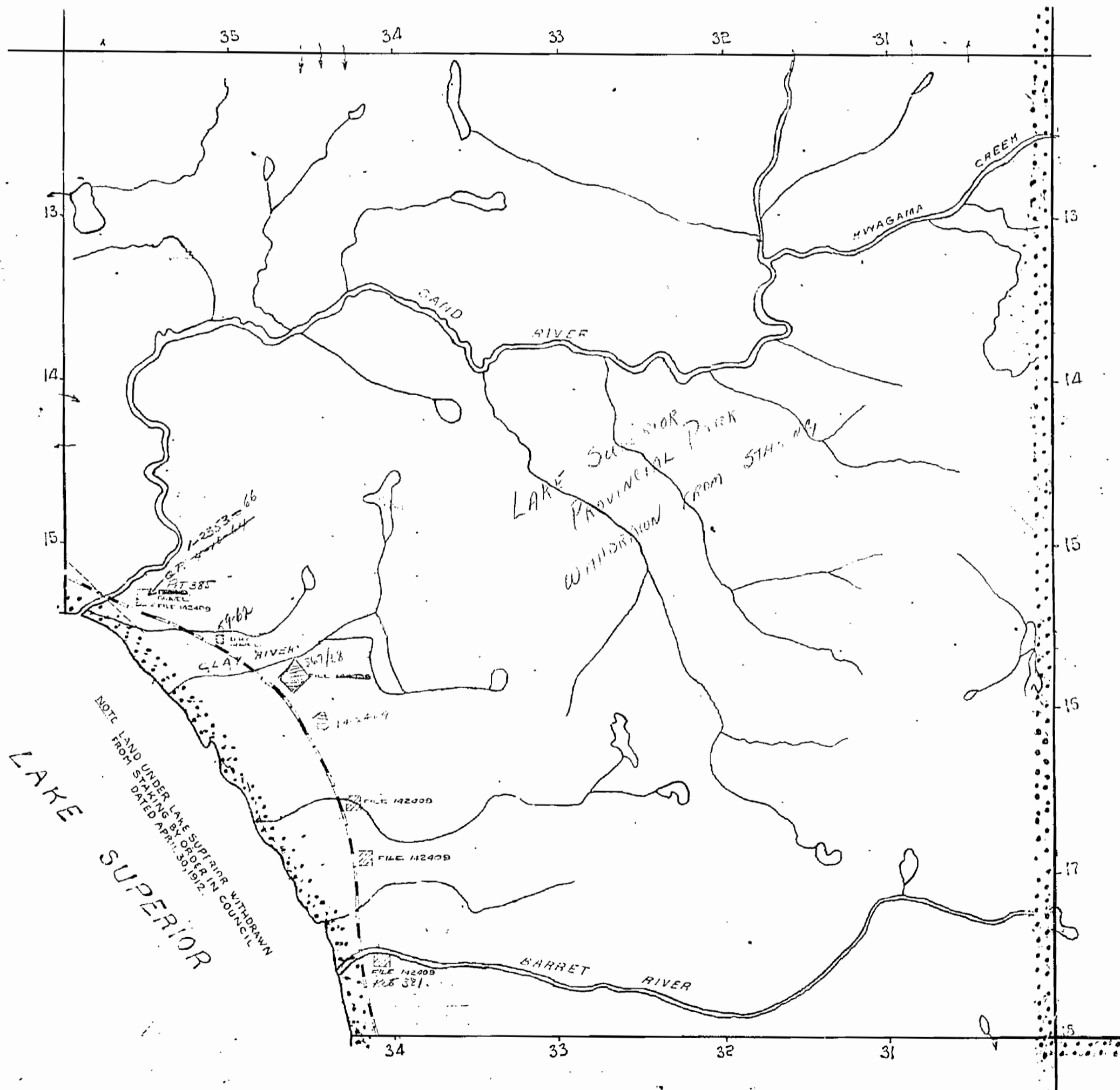

TWP. 29 RANGE 16

OFFICE MAP

Denotes boundary of Lake Superior Provincial Park

DEPARTMENT OF HIGHWAYS GRAVEL PIT'S SHOWN THUS

400' Road. b. Dept. of W. F. shown here

OFFICE MAP

mea

1542

IMB 58 B1A 23

TOWNSHIP 29 RANGE 17

29-17

LAKE SUPERIOR PROVINCIAL PARK.

SAULT STE. MARIE MINING DIVISION

(GOODWILLE)

DISTRICT OF ALGOMA.

M.1542

Scale 40ch = 1inch

TWP. 29 RANGE 18

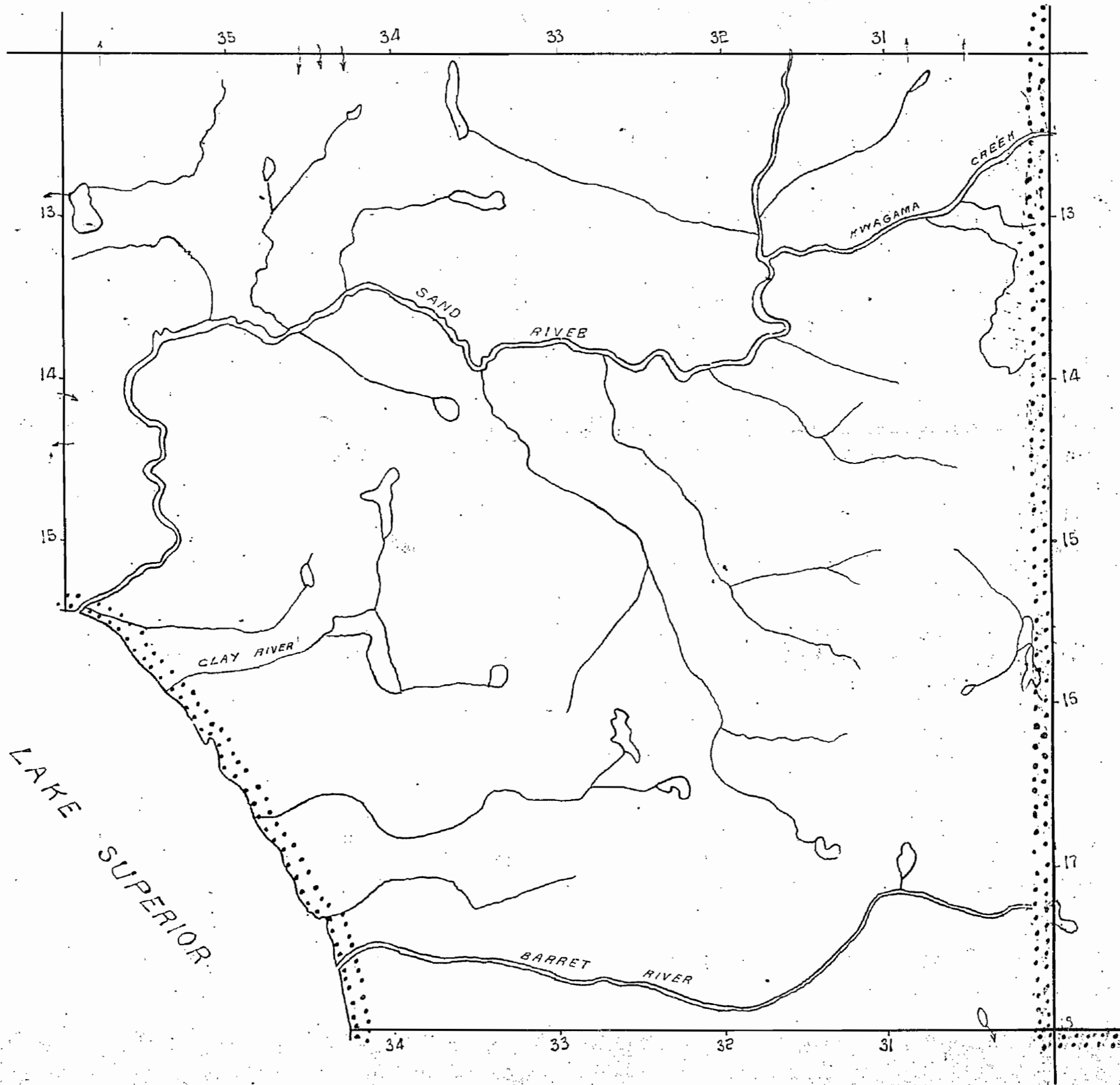

TWP. 28 RANGE 17

LAKE SUPERIOR

TWP. 29 RANGE 16

..... Denotes boundary of Lake Superior Provincial Park

GOODWILLIE TP

M.1542

ONTARIO

MINISTRY OF NATURAL RESOURCES

SURVEYS AND MAPPING BRANCH

LAKE SUPERIOR PROVINCIAL PARK
SAULT STE MARIE MINING DIVISION
DISTRICT OF ALGOMA

Scale 40ch = 1inch

MAR 18 1975
DATE OF ISSUE
6-2764

BROOME TP. M.1543.

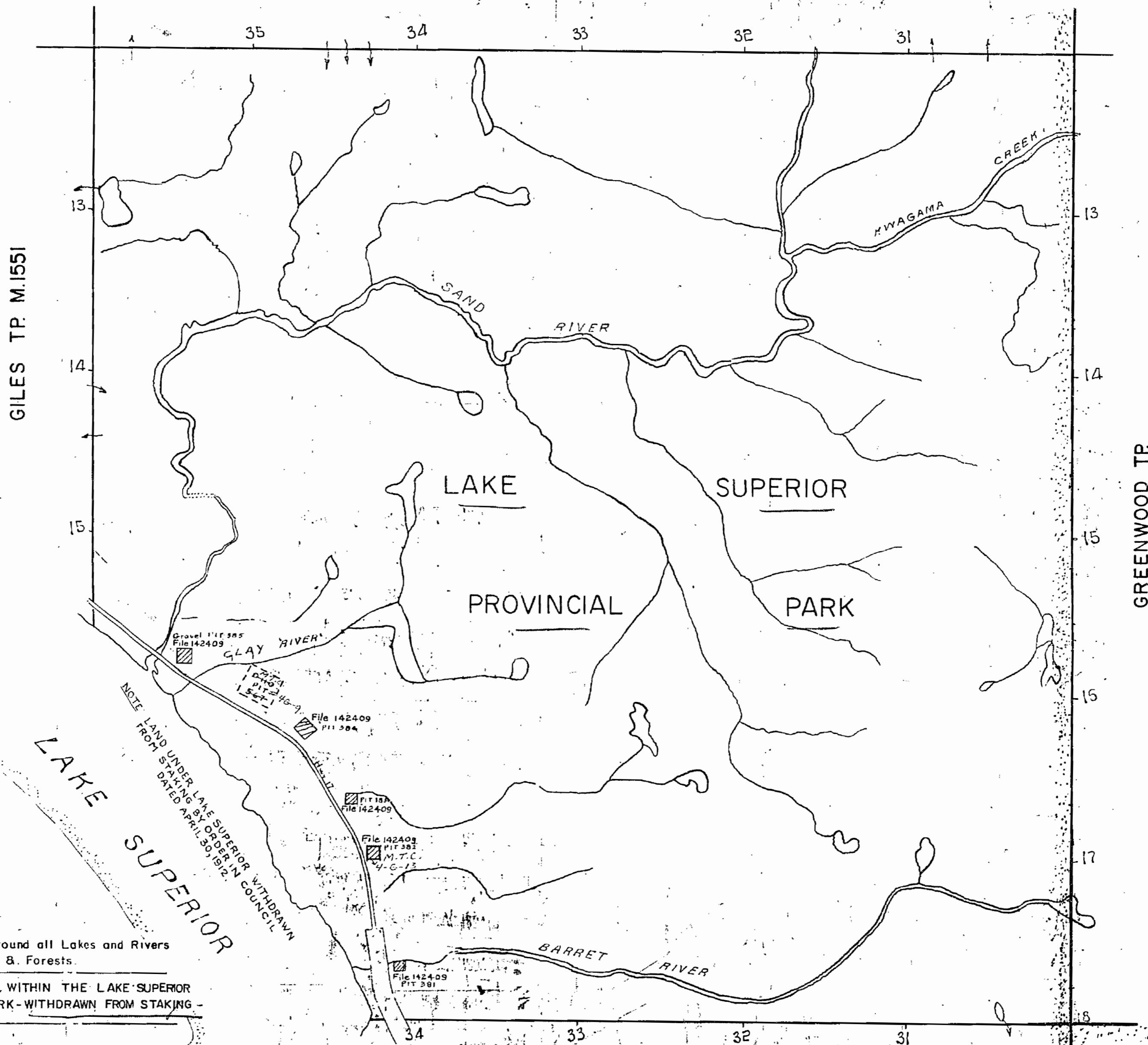

400' Reserve around all Lakes and Rivers to Dept. of Lands & Forests.

THIS TWP LIES WITHIN THE LAKE SUPERIOR PROVINCIAL PARK - WITHDRAWN FROM STAKING -

LABELLE TP. M.1541

Denotes boundary of Lake Superior Provincial Park
DEPARTMENT OF HIGHWAYS GRAVEL PITS - SHOWN THIS WAY

Roadbed by m.p.d. Aug. 130/74

REFERENCES

AREAS WITHDRAWN FROM DISPOSITION

- M.R.O. - MINING RIGHTS ONLY
- S.R.O. - SURFACE RIGHTS ONLY
- M.+S. - MINING AND SURFACE RIGHTS

Description	Order No.	Date	Disposition	File

BROOME TWP

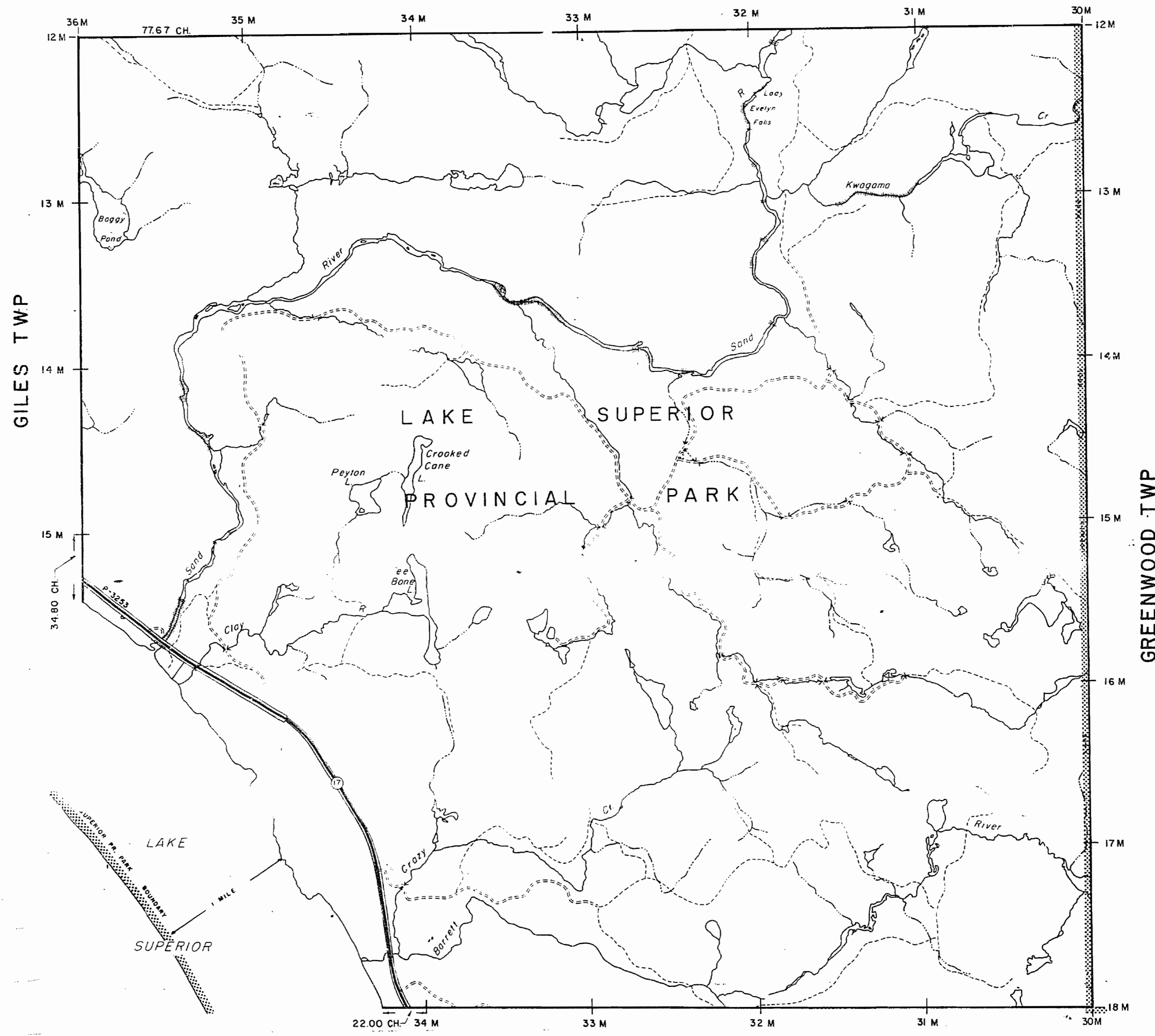

LEGEND

- HIGHWAY AND ROUTE No.
- OTHER ROADS
- TRAILS
- SURVEYED LINES:
 - TOWNSHIPS, BASE LINES, ETC.
 - LOTS, MINING CLAIMS, PARCELS, ETC.
- UNSURVEYED LINES:
 - LOT LINES
 - PARCEL BOUNDARY
 - MINING CLAIMS ETC.
- RAILWAY AND RIGHT OF WAY
- UTILITY LINES
- NON-PERENNIAL STREAM
- FLOODING OR FLOODING RIGHTS
- SUBDIVISION OR COMPOSITE PLAN RESERVATIONS
- ORIGINAL SHORELINE
- MARSH OR MUSKEG
- MINES
- TRAVERSE MONUMENT

DISPOSITION OF CROWN LANDS

TYPE OF DOCUMENT	SYMBOL
PATENT SURFACE & MINING RIGHTS	
SURFACE RIGHTS ONLY	
MINING RIGHTS ONLY	
LEASE, SURFACE & MINING RIGHTS	
SURFACE RIGHTS ONLY	
MINING RIGHTS ONLY	
LICENCE OF OCCUPATION	
ORDER-IN-COUNCIL	
RESERVATION	
CANCELLED	
SAND & GRAVEL	

NOTE: MINING RIGHTS IN PARCELS PATENTED PRIOR TO MAY 6, 1913, VESTED IN ORIGINAL PATENTEE BY THE PUBLIC LANDS ACT, R.S.O. 1970, CHAP. 380, SEC. 63, SUBSEC. 1

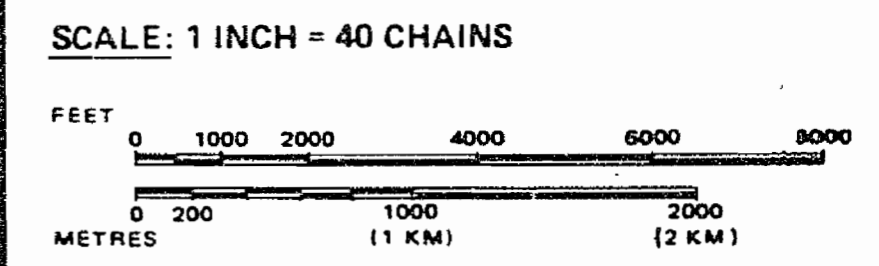

TOWNSHIP
GOODWILLIE
 M.N.R. ADMINISTRATIVE DISTRICT
WAWA
 MINING DIVISION
SAULT STE. MARIE
 LAND TITLES / REGISTRY DIVISION
ALGOMA

Ministry of Natural Resources
 Ministry of Northern Development and Mines

Date: DECEMBER, 1986
 Number: **G-2764**

The 1980 Magnetic Bearing
 Approx. 6' W Annual Change
 To increasing 6'

THE INFORMATION THAT APPEARS ON THIS MAP HAS BEEN COMPILED FROM VARIOUS SOURCES, AND ACCURACY IS NOT GUARANTEED. THOSE WISHING TO STAKE MINING CLAIMS SHOULD CONSULT WITH THE MINING RECORDER, MINISTRY OF NORTHERN DEVELOPMENT AND MINES, FOR ADDITIONAL INFORMATION ON THE STATUS OF THE LANDS SHOWN HEREON.

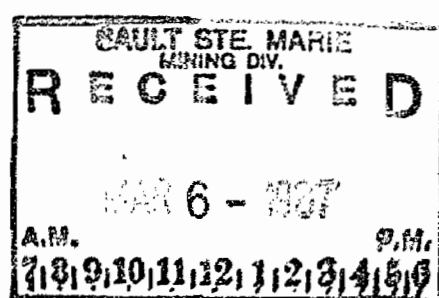

LABELLE TWP

4975-0 GOODWILLIE LMB G-5164

1542

TWP 29 R 17

TOWNSHIP 29 RANGE 17
 LAKE SUPERIOR PROVINCIAL PARK. OFFICE MAP
 SAULT STE. MARIE MINING DIVISION
 DISTRICT OF ALGOMA.

Scale 40ch = 1inch
 (GOODWILLIE)
 M. 1542
 TWP. 29 RANGE 18

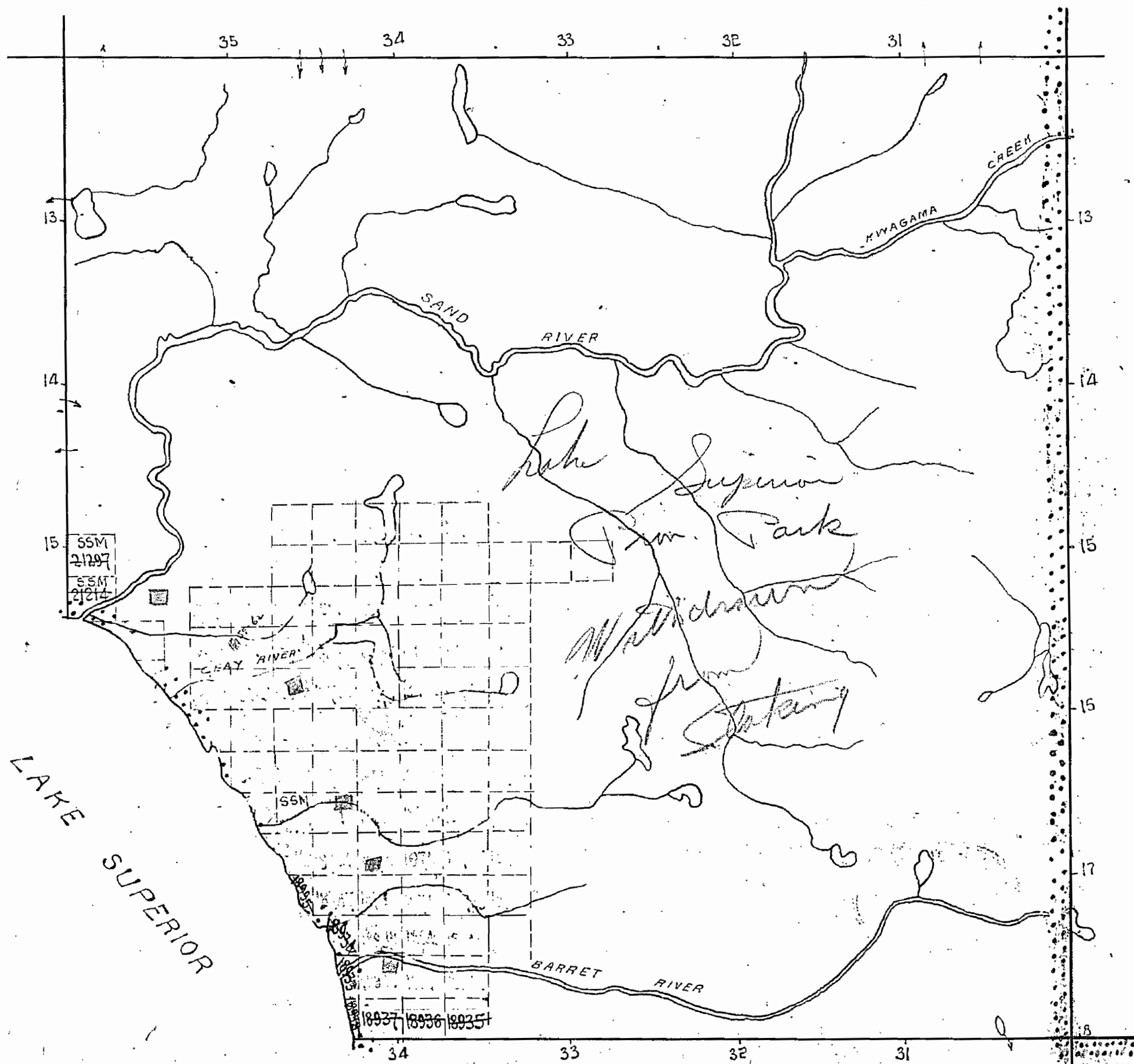

TWP. 28 RANGE 17

LAKE SUPERIOR

TWP. 29 RANGE 16

Denotes boundary of Lake Superior Provincial Park.

DEPT. HIGHWAYS GRAVEL PERMITS SHOWN THUS 56-155

1542

TOWNSHIP 29 RANGE 17

LAKE SUPERIOR PROVINCIAL PARK. (GOODWILLIE)
SAULT STE. MARIE MINING DIVISION
DISTRICT OF ALGOMA.

M. 1542
OFFICE MAP

Scale 40ch = 1inch

TWP. 29 RANGE 18

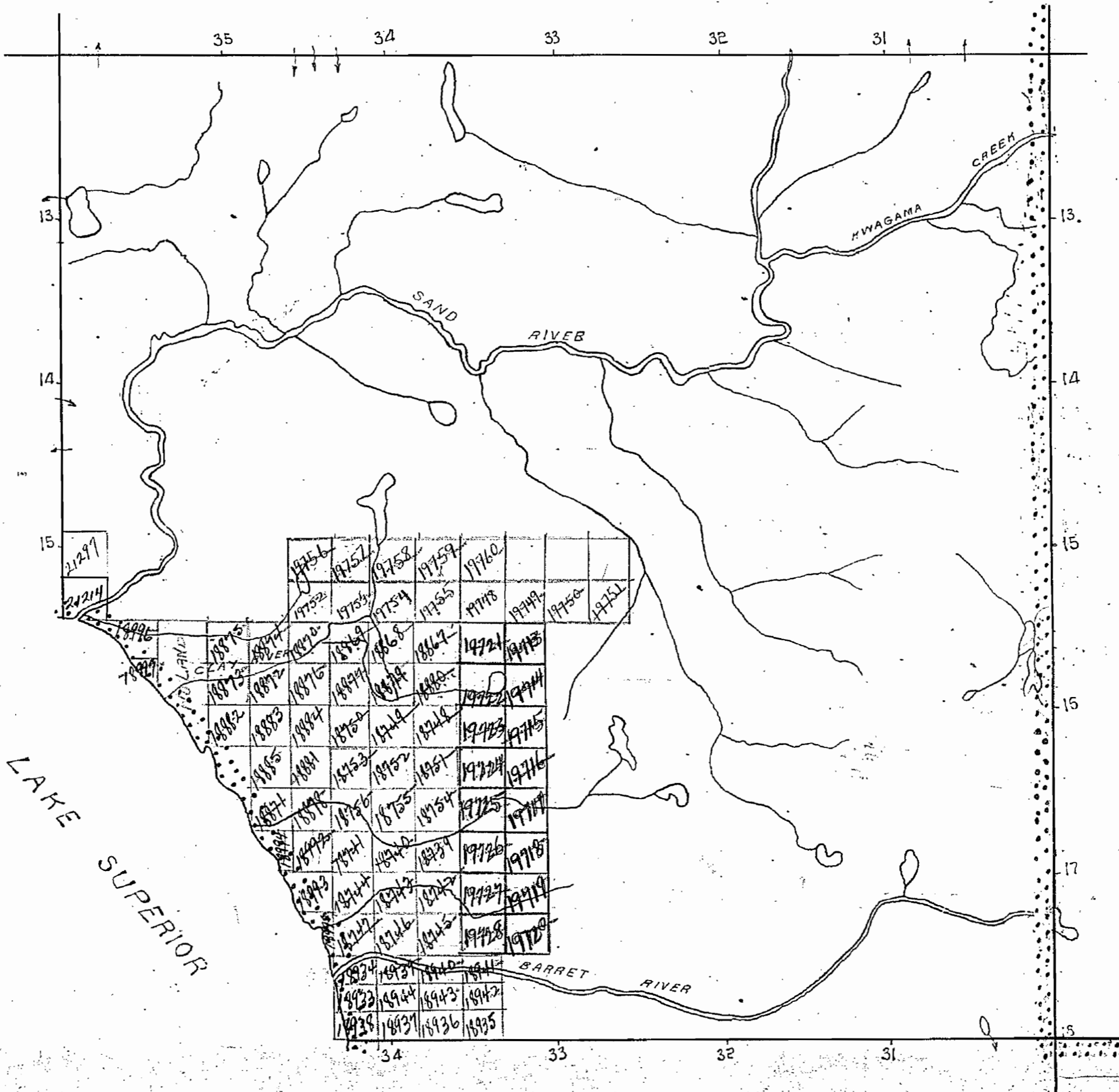

LAKE SUPERIOR

TWP. 28. RANGE 17

TWP. 29 RANGE 16

Denotes boundary of Lake Superior Provincial Park.

1542

IMB 58 B15 28

TOWNSHIP 29 RANGE 17

29-17

LAKE SUPERIOR PROVINCIAL PARK.

SAULT STE. MARIE MINING DIVISION

(GOODWILLE)

DISTRICT OF ALGOMA.

M.1542

Scale 40ch = 1inch

TWP. 29 RANGE 18

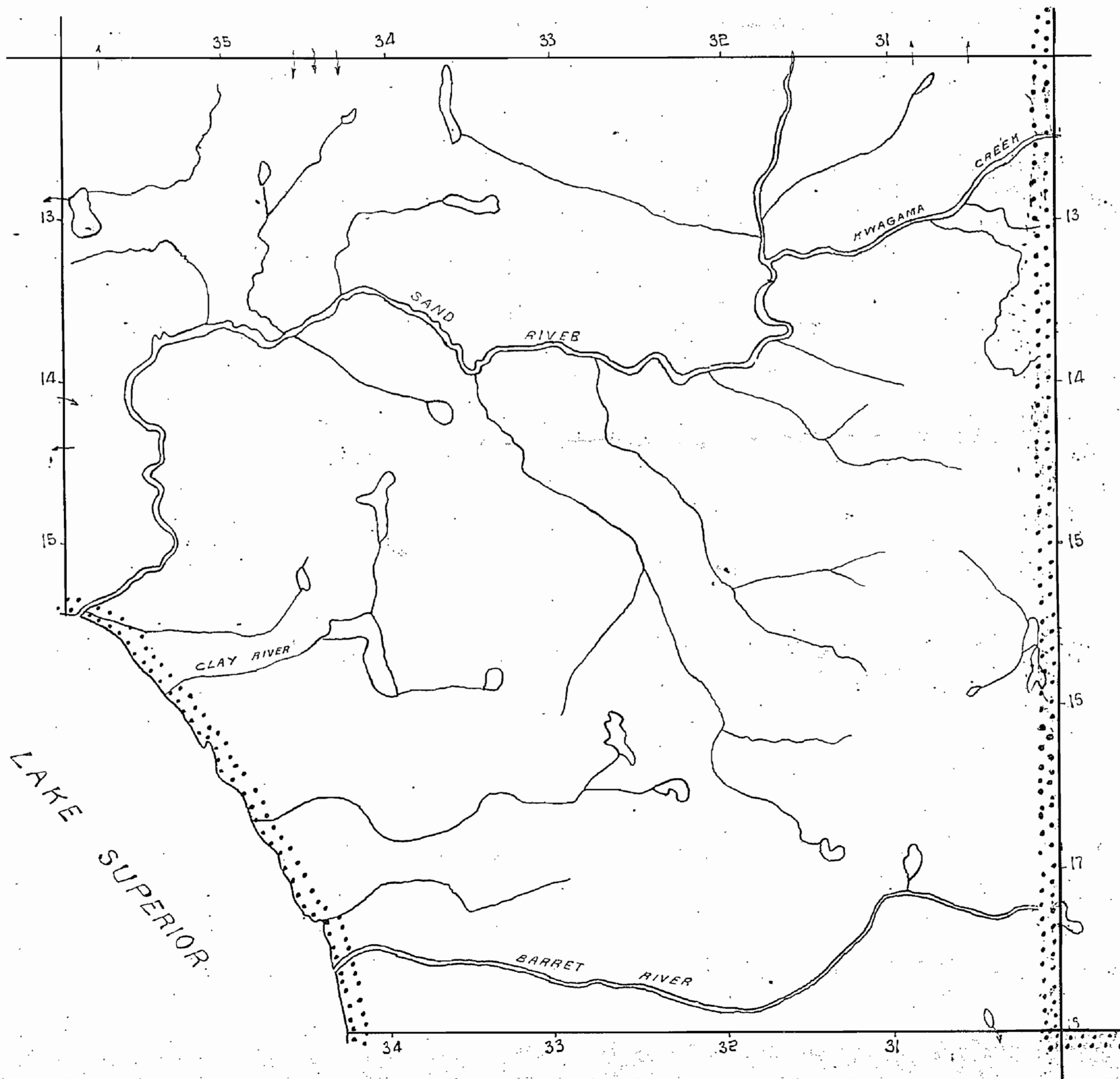

TWP. 28 RANGE 17

LAKE SUPERIOR

TWP. 29 RANGE 16

Denotes boundary of Lake Superior Provincial Park

