

*Aug 84*

THE TOWNSHIP  
OF  
**GOUGH**  
DISTRICT OF  
SUDBURY  
SUDBURY  
MINING DIVISION

SCALE: 1-INCH=40 CHAINS

LEGEND

- PATENTED LAND Ⓟ
- CROWN LAND SALE C.S.
- LEASES Ⓞ
- LOCATED LAND Loc.
- LICENSE OF OCCUPATION L.O.
- ROADS —
- IMPROVED ROADS —
- KING'S HIGHWAY —
- RAILWAYS —
- POWER LINES —
- MARSH OR MUSKEG —
- MINES —
- PATENTED FOR S.R.O. —

NOTES

400' Surface Rights Reservation around all Lakes and Rivers.

Sand & Gravel on all unpatented mining claims in this Township reserved to the Crown

S.R. 10044  
S.R. 10470  
S.R. 10503

**GOUGH**

PLAN NO. - M-890

ONTARIO  
MINISTRY OF NATURAL RESOURCES  
SURVEYS AND MAPPING BRANCH

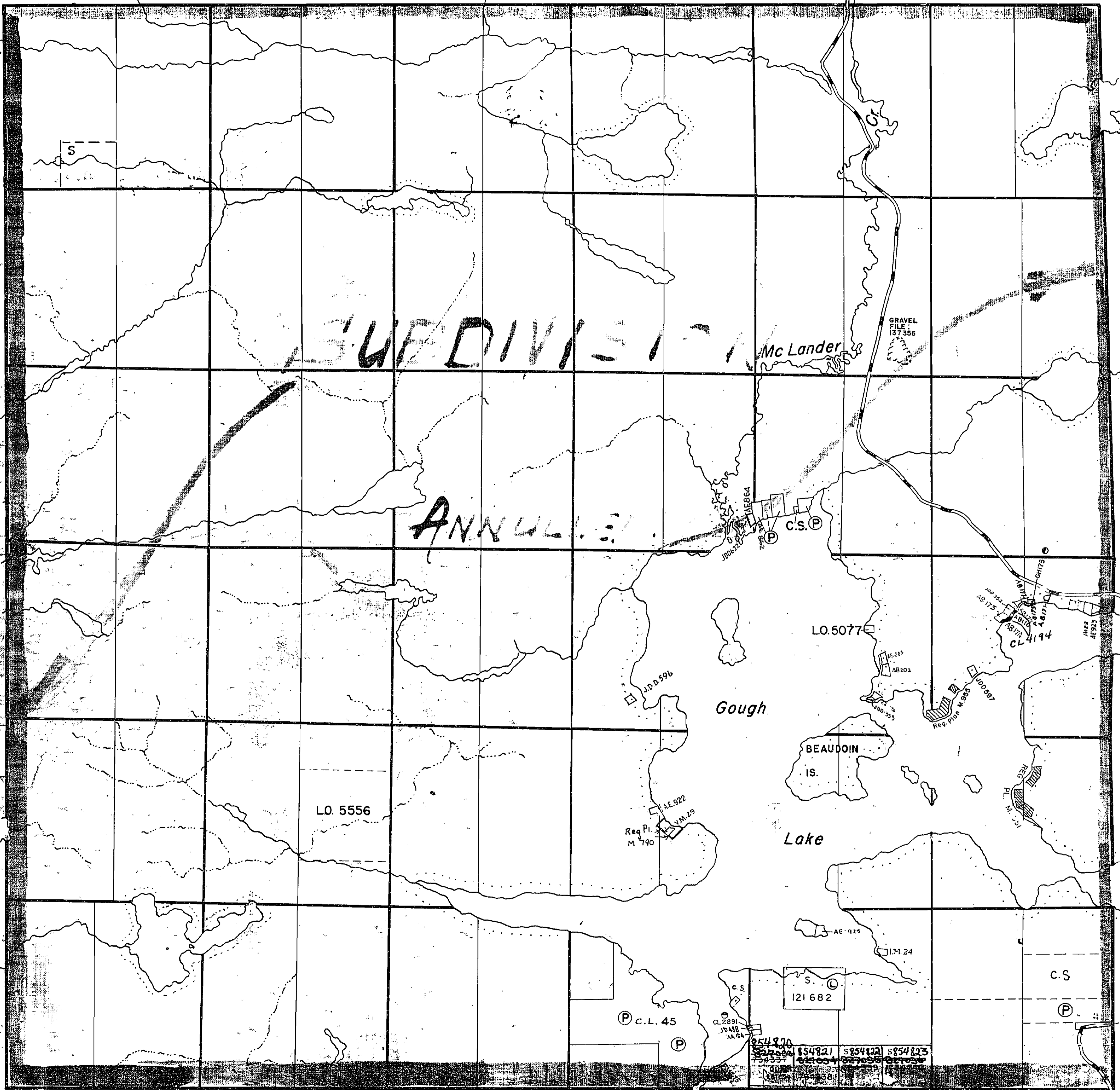

VI

V

IV

III

II

I

Shakespeare Twp.

Tennyson Twp.

May Twp.

Taken out of Use January 23, 1986 / Jm

OFFICE USE ONLY

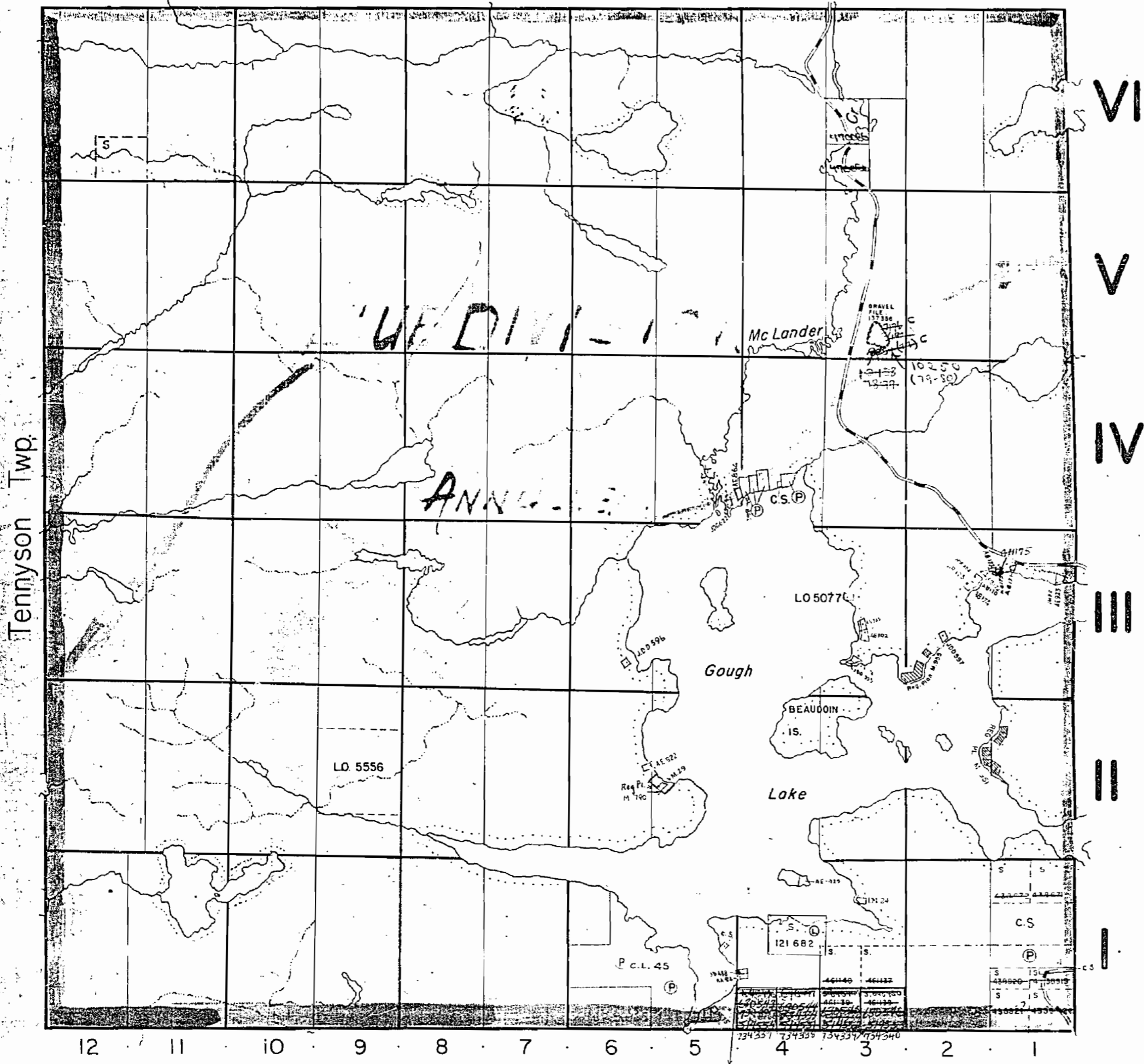

THE TOWNSHIP  
OF  
**GOUGH**  
DISTRICT OF  
SUDBURY  
SUDBURY  
MINING DIVISION  
SCALE: 1-INCH=40 CHAINS

**LEGEND**

PATENTED LAND	Ⓟ
CROWN LAND SALE	C.S.
LEASES	Ⓛ
LOCATED LAND	Loc.
LICENSE OF OCCUPATION	L.O.
ROADS	—
IMPROVED ROADS	—
KING'S HIGHWAY	—
RAILWAYS	—
POWER LINES	—
MARSH OR MUSKEG	—
MINES	X

**NOTES**

400' Surface Rights Reservation around all Lakes and Rivers.

Sand & Gravel on all unpatented mining claims in this Township reserved to the Crown.

BLANKET QUARRY PERMIT # 10334  
COVERS PART OF GOUGH TWP.  
(See Dunlop Land Roll)

**DATE OF ISSUE**  
AUG 3 - 1976

**GOUGH**  
PLAN NO - M-890  
ONTARIO  
MINISTRY OF NATURAL RESOURCES  
SURVEYS AND MAPPING BRANCH

(Plan 532-9505)  
CL 2891  
See Land Roll

THE TOWNSHIP  
OF

**GOUGH**

DISTRICT OF  
SUDBURY

SUDBURY  
MINING DIVISION

SCALE: 1-INCH=40 CHAINS

LEGEND

PATENTED LAND	Ⓟ
CROWN LAND SALE	C.S.
LEASES	Ⓞ
LOCATED LAND	Loc.
LICENSE OF OCCUPATION	L.O.
ROADS	—
IMPROVED ROADS	—
KING'S HIGHWAY	—
RAILWAYS	—
POWER LINES	—
MARSH OR MUSKEG	—
MINES	X

NOTES

400' Reserve to Dept. of Lands & Forests shown thus: 

Sand & Gravel on all unpatented mining claims in this Township reserved to the Crown.

BLANKET QUARRY  
PERMIT #7068  
COVERS PART OF  
GOUGH TWP

**GOUGH**

PLAN NO. — M-890

DEPARTMENT OF MINES  
—ONTARIO—

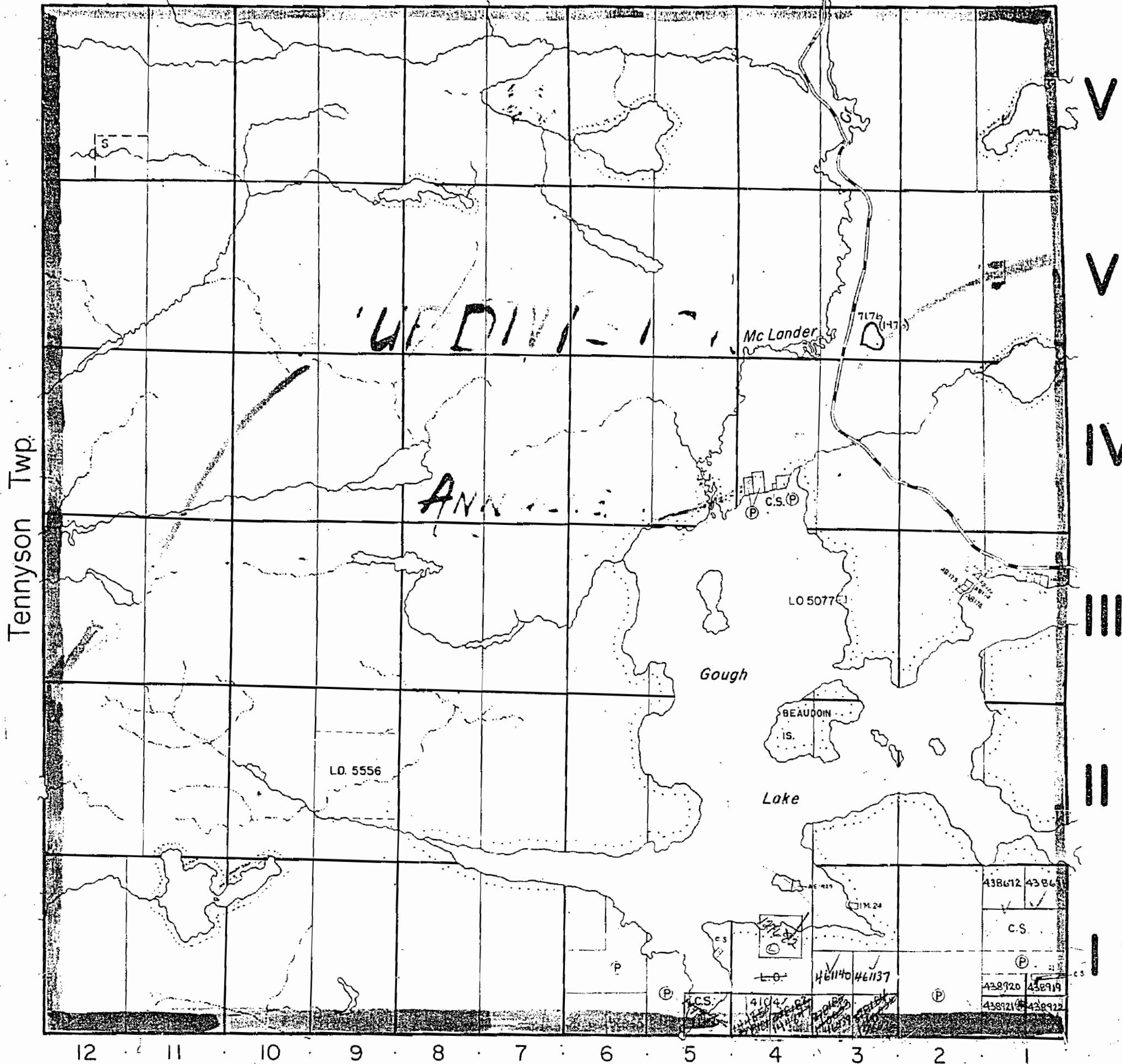

May Twp.

C-5888

GOUCH HWY

885-C

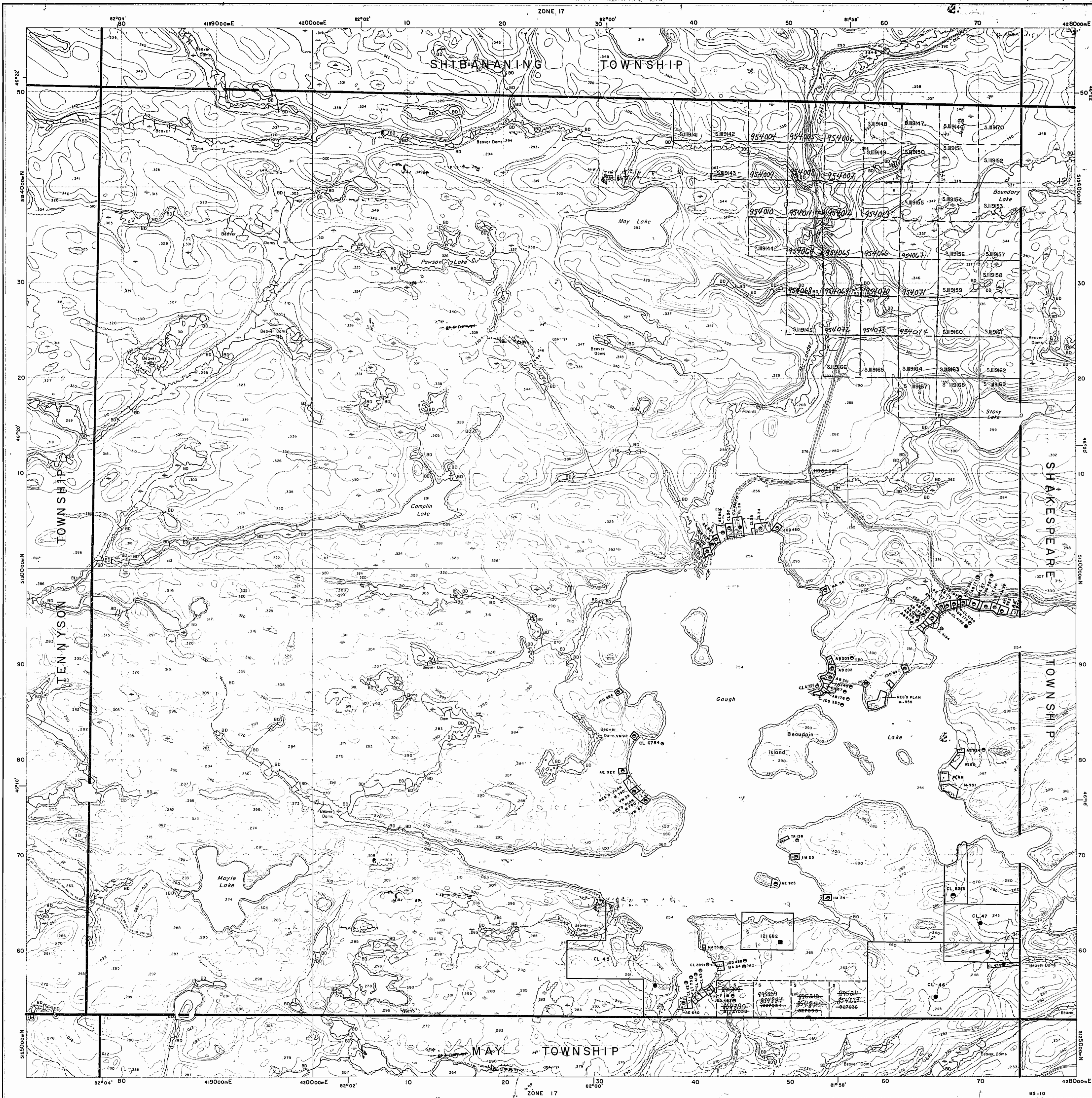

Ministry of Natural Resources and Mines  
 Ministry of Northern Affairs and Mines

January 1986

**INDEX TO LAND DISPOSITION**

PLAN  
 G-2889  
 TOWNSHIP

M.N.R. ADMINISTRATIVE DISTRICT  
**ESPANOLA**  
 MINING DIVISION  
**SUDBURY**  
 LAND TITLES/REGISTRY DIVISION  
**SUDBURY**

**GOUCH**

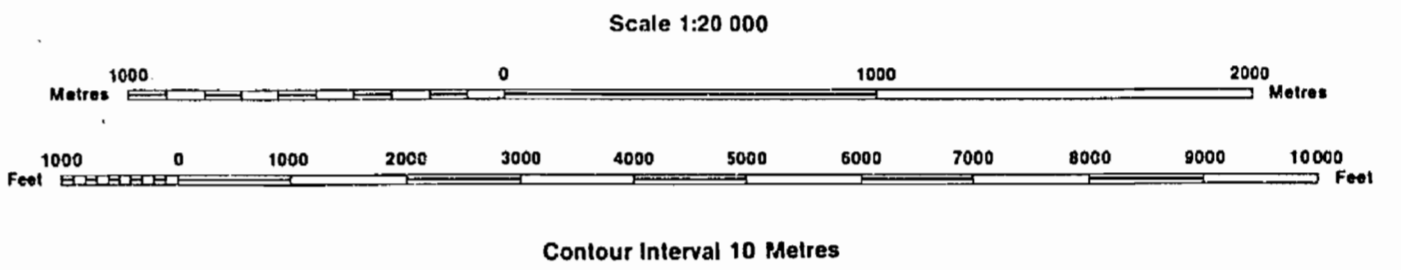

**AREAS WITHDRAWN FROM DISPOSITION**

- MRO - Mining Rights Only
- SRO - Surface Rights Only
- M+S - Mining and Surface Rights

Description	Order No.	Date	Disposition	File

**SYMBOLS**

- Boundary
  - Township, Meridian, Baseline
  - Road allowance; surveyed
  - shoreline
  - Lot/Concession; surveyed
  - unsurveyed
  - Parcel; surveyed
  - unsurveyed
  - Right-of-way; road
  - railway
  - utility
  - Reservation
  - Chff, Pit, Pile
  - Contour
    - Interpolated
    - Approximate
    - Depression
  - Control point (horizontal)
  - Flooded land
  - Mine head frame
  - Pipeline (above ground)
  - Railway; single track
  - double track
  - abandoned
  - Road; highway, county, township
  - access
  - trail, bush
  - Shoreline (original)
  - Transmission line
  - Wooded area

**NOTES**

The subdivision of this Township into Lots and Concessions was annulled on May 14th, 1953.

**DISPOSITION OF CROWN LANDS**

- Patent
  - Surface & Mining Rights
  - Surface Rights Only
  - Mining Rights Only
- Lease
  - Surface & Mining Rights
  - Surface Rights Only
  - Mining Rights Only
- Licence of Occupation
- Order-in-Council
- Cancelled
- Reservation
- Sand & Gravel

THE INFORMATION THAT APPEARS ON THIS MAP HAS BEEN COMPILED FROM VARIOUS SOURCES, AND ACCURACY IS NOT GUARANTEED. THOSE WISHING TO STAKE MINING CLAIMS SHOULD CONSULT WITH THE MINING RECORDER, MINISTRY OF NORTHERN DEVELOPMENT AND MINES, FOR ADDITIONAL INFORMATION ON THE STATUS OF THE LANDS SHOWN HEREON.

Map base and land disposition drafting by Surveys and Mapping Branch, Ministry of Natural Resources.

The disposition of land, location of lot fabric and parcel boundaries on this index was compiled for administrative purposes only.

885-C

GOUCH HWY

885-C

C-5880 GOUCH TMB GOUCH TWT C-5880

January 1986

INDEX TO LAND DISPOSITION

PLAN G-2889 TOWNSHIP GOUGH

M.N.R. ADMINISTRATIVE DISTRICT ESPANOLA MINING DIVISION SUDBURY LAND TITLES/REGISTRY DIVISION SUDBURY

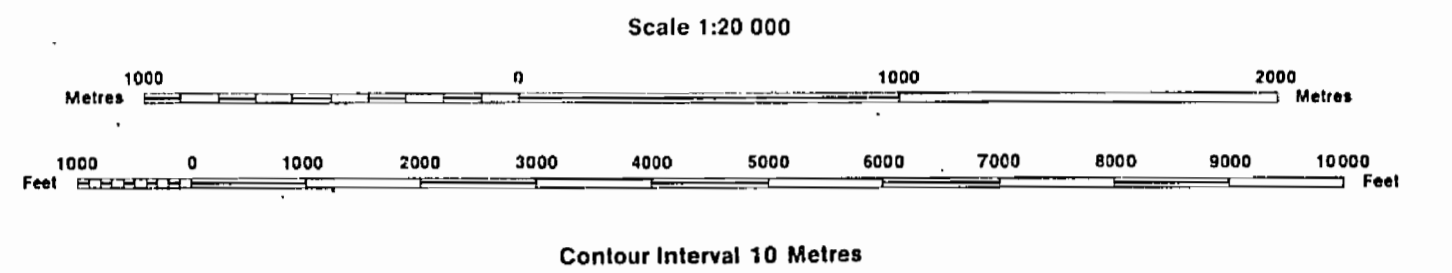

AREAS WITHDRAWN FROM DISPOSITION

- MRO - Mining Rights Only
SRO - Surface Rights Only
M+S - Mining and Surface Rights

SYMBOLS

- Boundary: Township, Meridian, Baseline
Road allowance, surveyed, shoreline
Lot/Concession, surveyed, unsurveyed
Parcel, surveyed, unsurveyed
Right-of-way, road, railway, utility
Reservation
Cliff, Pit, Pile
Contour: Interpolated, Approximate, Depression
Control point (horizontal)
Flooded land
Mine head frame
Pipeline (above ground)
Railway: single track, double track, abandoned
Road, highway, county, township access, trail, bush
Shoreline (original)
Transmission line
Wooded area

NOTES

The subdivision of this Township into Lots and Concessions was annulled on May 14th, 1953.

DA: NOV 17 1998 PROVINCIAL RECORDING OFFICE - SUDBURY

DISPOSITION OF CROWN LANDS

- Patent: Surface & Mining Rights, Surface Rights Only, Mining Rights Only
Lease: Surface & Mining Rights, Surface Rights Only, Mining Rights Only
Licence of Occupation
Order-in-Council
Cancelled
Reservation
Sand & Gravel

THE INFORMATION THAT APPEARS ON THIS M.C.P. HAS BEEN COMPILED FROM VARIOUS SOURCES, AND ACCURACY IS NOT GUARANTEED. THOSE WISHING TO STAKE MINING CLAIMS SHOULD CONSULT WITH THE MINING RECORDER, MINISTRY OF NORTHERN DEVELOPMENT AND MINES, FOR ADDITIONAL INFORMATION ON THE STATUS OF THE LANDS SHOWN HEREON.

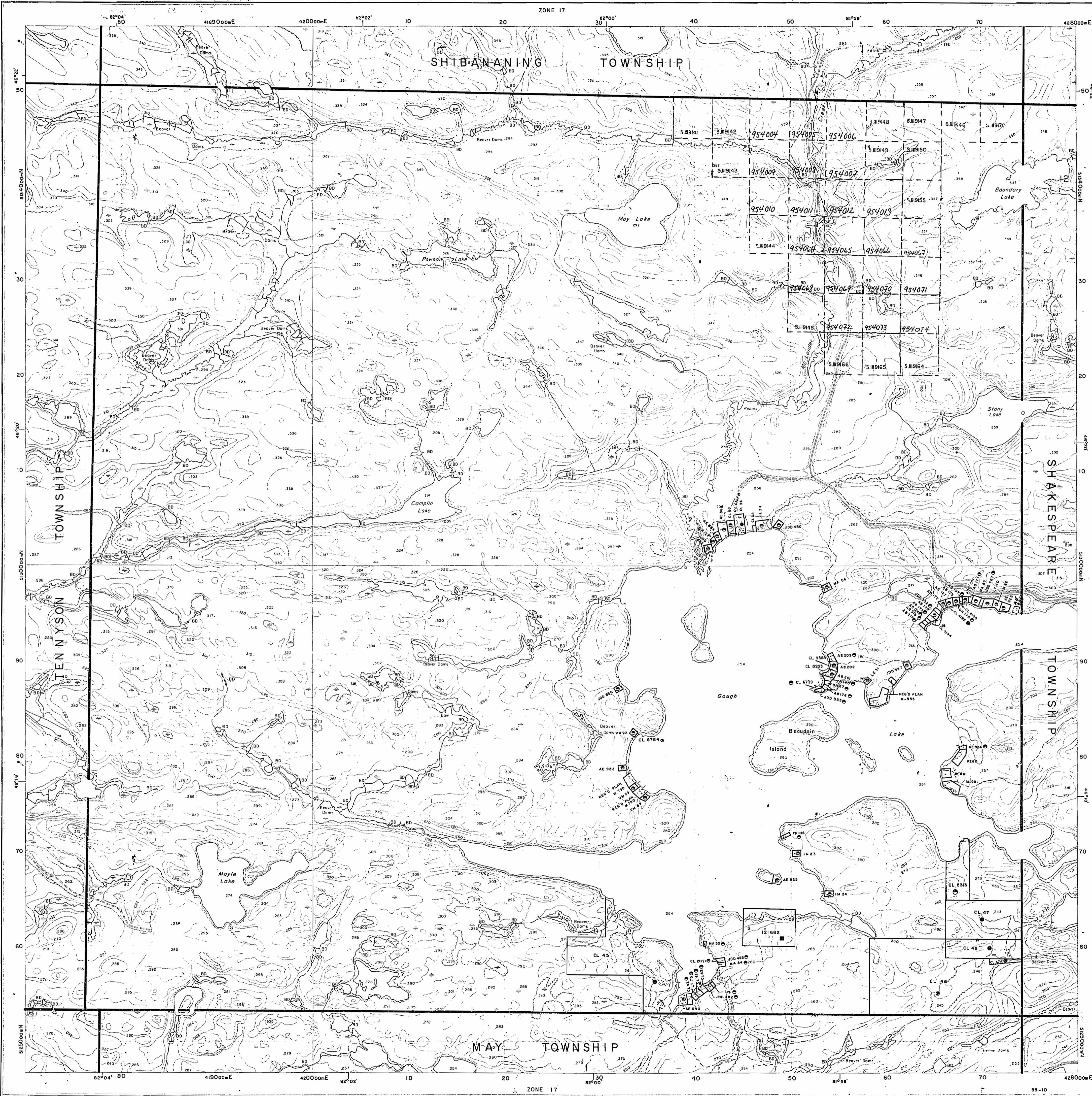

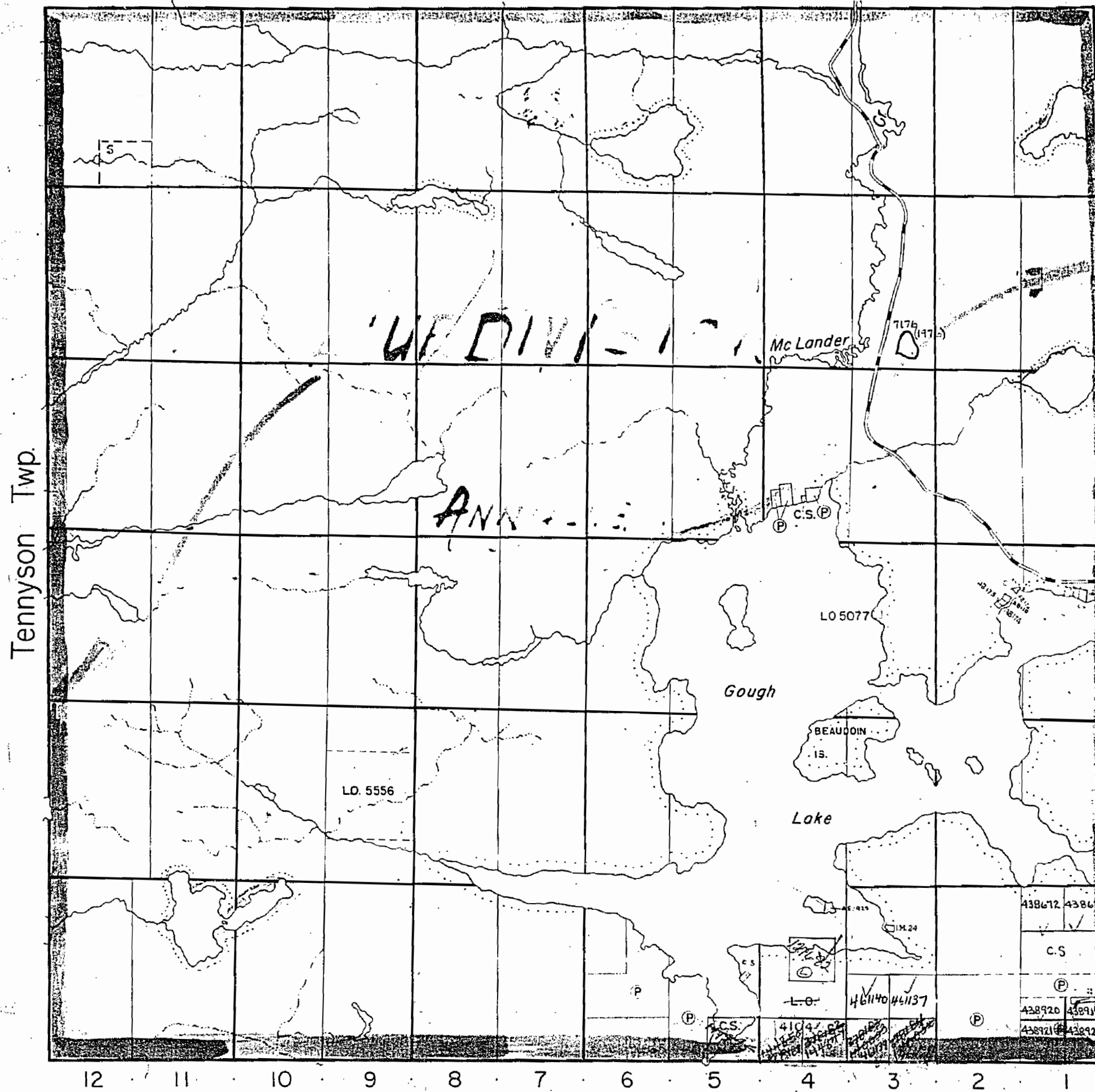

THE TOWNSHIP  
OF

# GOUGH

DISTRICT OF  
SUDBURY

SUDBURY  
MINING DIVISION

SCALE: 1-INCH=40 CHAINS

### LEGEND

PATENTED LAND	Ⓟ
CROWN LAND SALE	C.S.
LEASES	Ⓞ
LOCATED LAND	Loc.
LICENSE OF OCCUPATION	L.O.
ROADS	— — — — —
IMPROVED ROADS	— — — — —
KING'S HIGHWAY	— — — — —
RAILWAYS	— — — — —
POWER LINES	— — — — —
MARSH OR MUSKEG	— — — — —
MINES	X

### NOTES

400' Reserve to Dept. of Lands & Forests shown thus: — — — — —

Sand & Gravel on all unpatented mining claims in this Township reserved to the Crown.

BLANKET QUARRY  
PERMIT #7068  
COVERS PART OF  
GOUGH TWP

## GOUGH

PLAN NO. — Mi-890

DEPARTMENT OF MINES  
— ONTARIO —

May 1984

THE TOWNSHIP OF  
OF  
**GOUGH**

DISTRICT OF  
SUDBURY

SUDBURY  
MINING DIVISION

SCALE: 1-INCH=40 CHAINS

LEGEND

PATENTED LAND	P
CROWN LAND SALE	S
LEASES	L
LOCATED LAND	L.C.
LICENSE OF OCCUPATION	L.O.
ROADS	—
IMPROVED ROADS	—
KING'S HIGHWAY	—
RAILWAYS	—
POWER LINES	—
MARSH OR MUSKEG	—
MINES	X

NOTES

400' Surface Rights Reservation around all Lakes and Rivers.

Sand & Gravel on all unpatented mining claims in this Township reserved to the Crown.

**GOUGH**

PLAN NO. — M-890

MINISTRY OF NATURAL RESOURCES  
SURVEYS AND MAPPING BRANCH

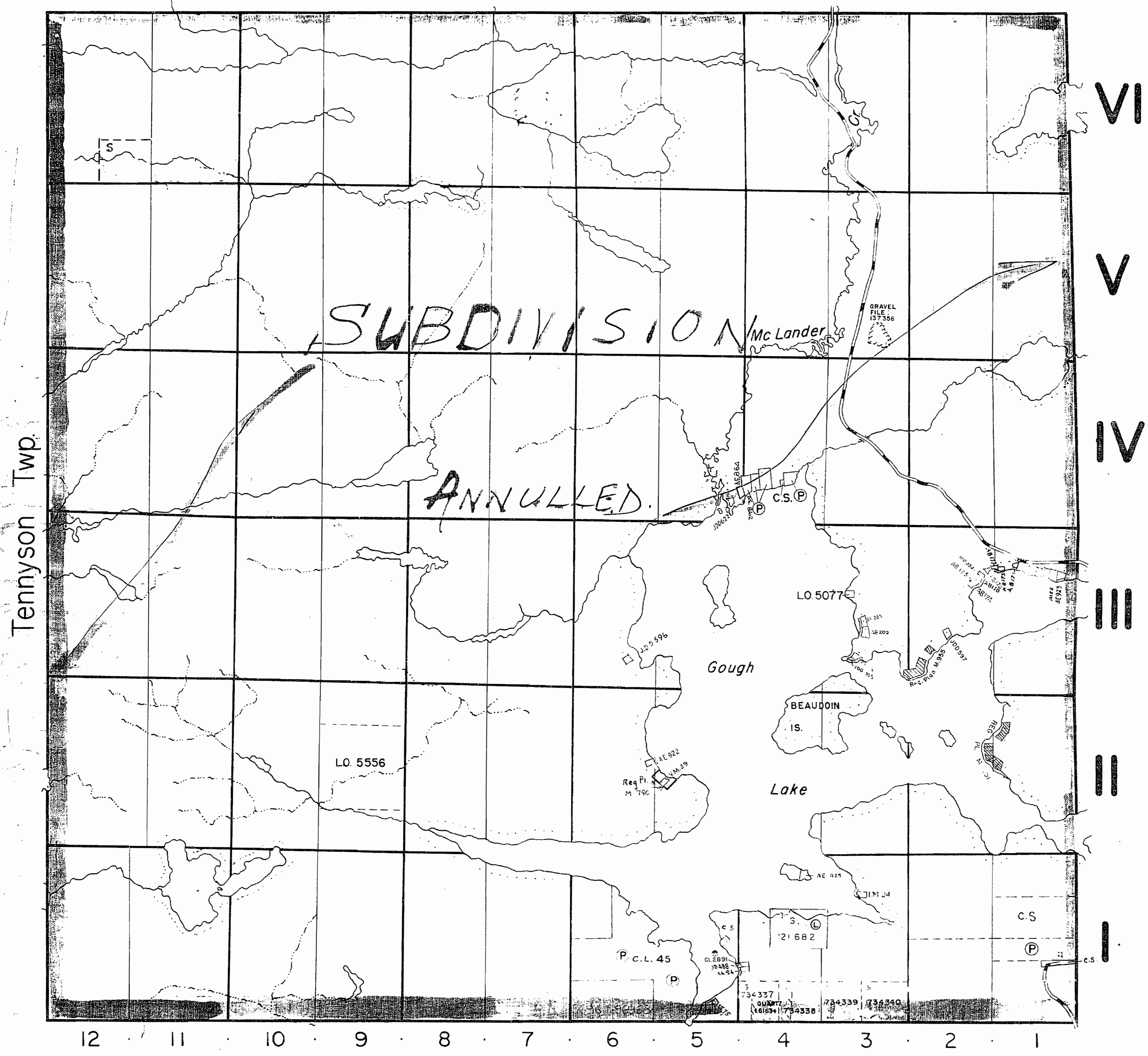

C-5888  
GOUCH TWP  
GOUCH HUC03  
C-5888



January 1986

**INDEX TO LAND DISPOSITION**

PLAN  
 G-2889  
 TOWNSHIP

M.N.R. ADMINISTRATIVE DISTRICT  
 ESPANOLA  
 MINING DIVISION  
 SUDBURY  
 LAND TITLES/REGISTRY DIVISION  
 SUDBURY

**GOUGH**

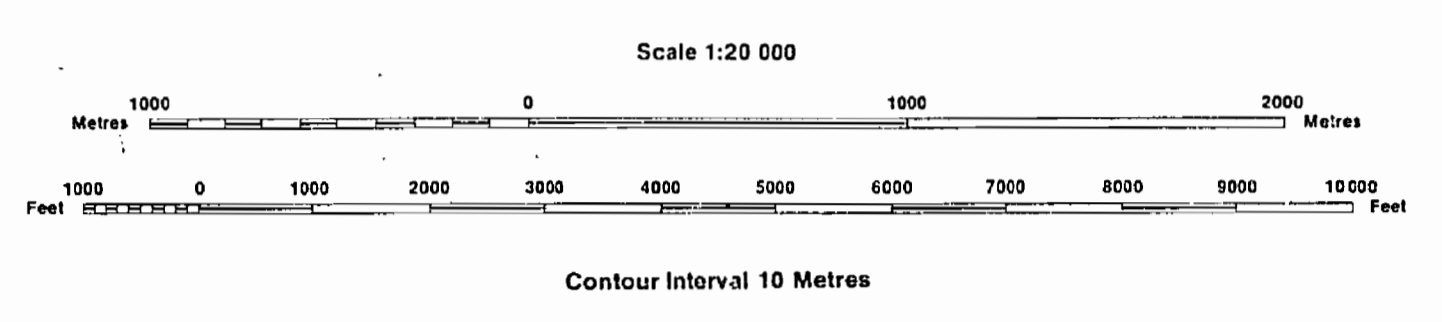

**AREAS WITHDRAWN FROM DISPOSITION**

MRO - Mining Rights Only  
 SRO - Surface Rights Only  
 M+S - Mining and Surface Rights

**SYMBOLS**

Boundary	Township, Meridian, Baseline	—
Road allowance; surveyed	shoreline	—
Lot/Concession; surveyed	unsurveyed	—
Parcel; surveyed	unsurveyed	—
Right-of-way; road	railway	—
utility	—	—
Reservation	—	—
Cliff, Pit, Pile	—	—
Contour	Interpolated	—
Approximate	Depression	—
Control point (horizontal)	—	—
Flooded land	—	—
Mine head frame	—	—
Pipeline (above ground)	—	—
Railway; single track	double track	—
abandoned	—	—
Road; highway, county, township	access	—
trail, bush	—	—
Shoreline (original)	—	—
Transmission line	—	—
Wooded area	—	—

**NOTES**

The subdivision of this Township into Lots and Concessions was annulled on May 14th 1953.

**DATE OF ISSUE**

JUN 17 1998

PROVINCIAL RECORDING  
 OFFICE - SUDBURY

**DISPOSITION OF CROWN LANDS**

Patent	Surface & Mining Rights	●
Surface Rights Only	—	○
Mining Rights Only	—	○
Lease	Surface & Mining Rights	■
Surface Rights Only	—	□
Mining Rights Only	—	□
Licence of Occupation	—	▼
Order-in-Council	—	OC
Cancelled	—	⊙
Reservation	—	⊙
Sand & Gravel	—	⊙

THE INFORMATION THAT APPEARS ON THIS MAP HAS BEEN COMPILED FROM VARIOUS SOURCES, AND ACCURACY IS NOT GUARANTEED. THOSE WISHING TO STAKE MINING CLAIMS SHOULD CONSULT WITH THE MINING RECORDER, MINISTRY OF NORTHERN DEVELOPMENT AND MINES, FOR ADDITIONAL INFORMATION ON THE STATUS OF THE LANDS SHOWN HEREON.

Map base and land disposition drafting by Surveys and Mapping Branch, Ministry of Natural Resources.

The disposition of land, location of lot fabric and parcel boundaries on this index was compiled for administrative purposes only.

C-5888  
GOUCH TWP  
GOUCH HUC03  
C-5888



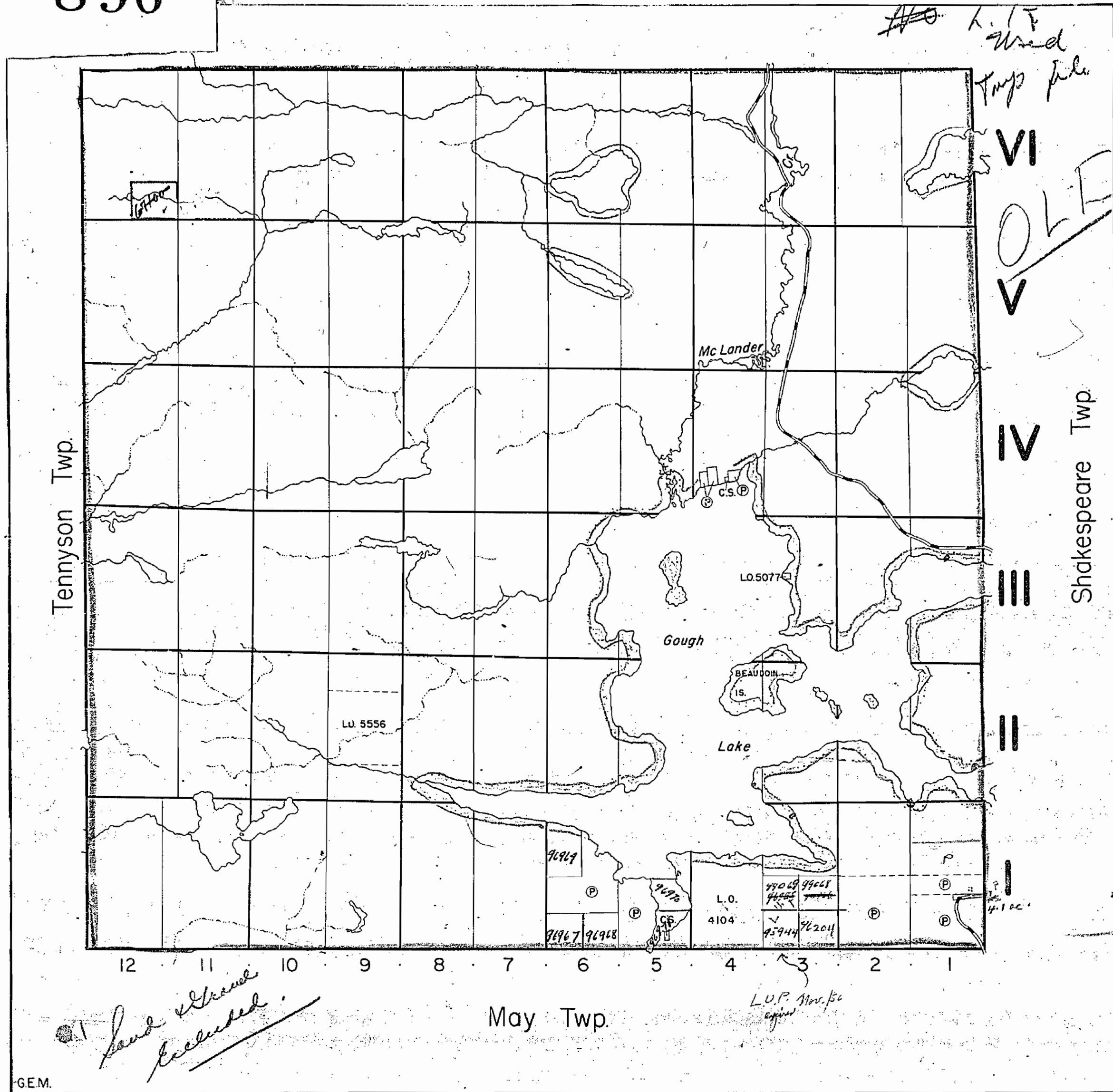

THE TOWNSHIP  
OF  
**GOUGH**  
DISTRICT OF  
SUDBURY  
SUDBURY  
MINING DIVISION  
SCALE: 1-INCH=40 CHAINS

LEGEND

PATENTED LAND	Ⓟ
CROWN LAND SALE	C.S.
LEASES	Ⓛ
LOCATED LAND	LOC.
LICENSE OF OCCUPATION	L.O.
ROADS	—
IMPROVED ROADS	—
KING'S HIGHWAY	—
RAILWAYS	—
POWER LINES	—
MARSH OR MUSKEG	—
MINES	—

NOTES

200' Reserve to Dept. of Lands & Forests shown thus: —

M890

PLAN NO. — S.211

DEPARTMENT OF MINES  
—ONTARIO—

# COUCH.

Scale 40 Chains to 1 Inch.

118

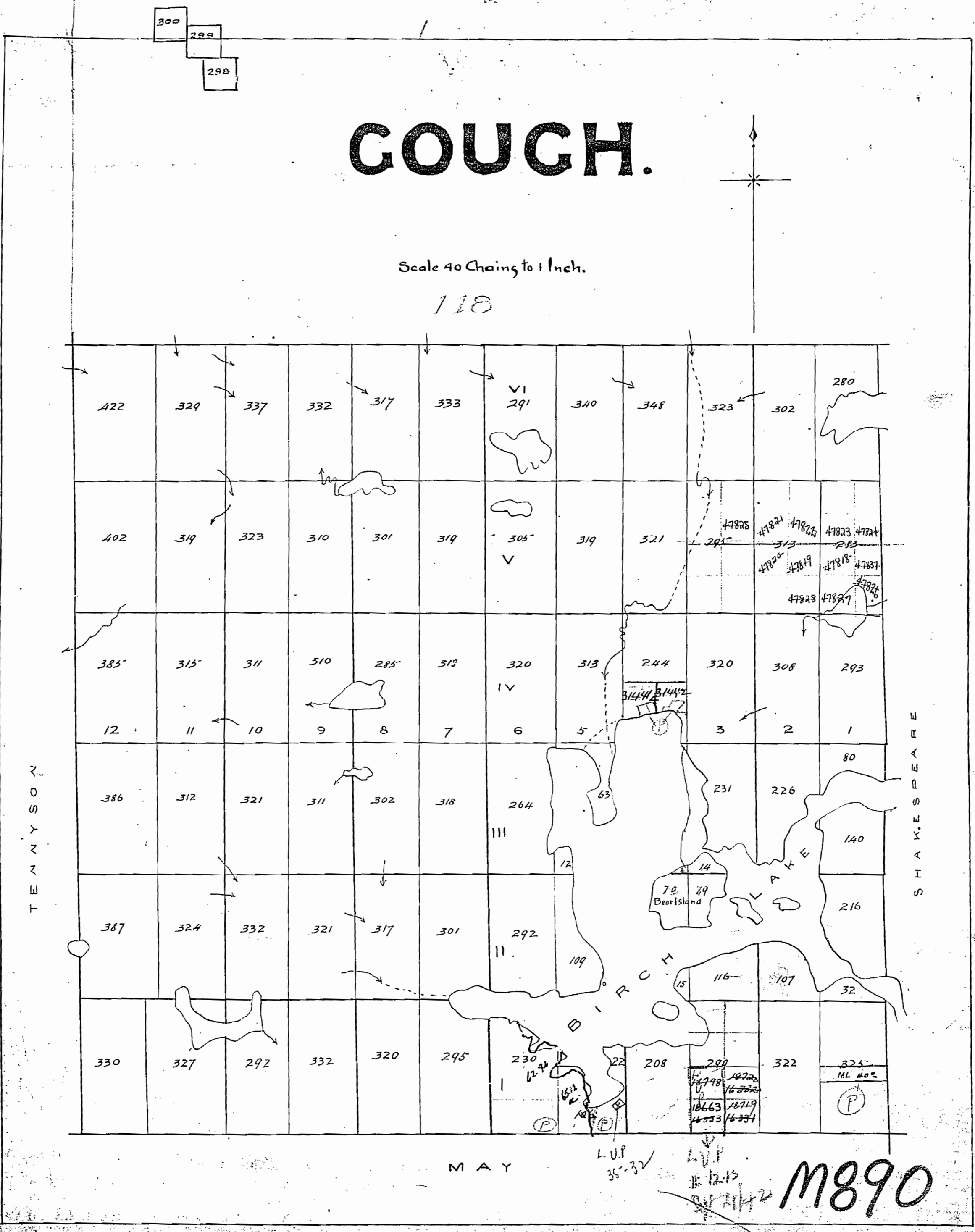

C-5888 GOUCH TWP TOWNSHIPS TENNYSON SHIBANANING MAY

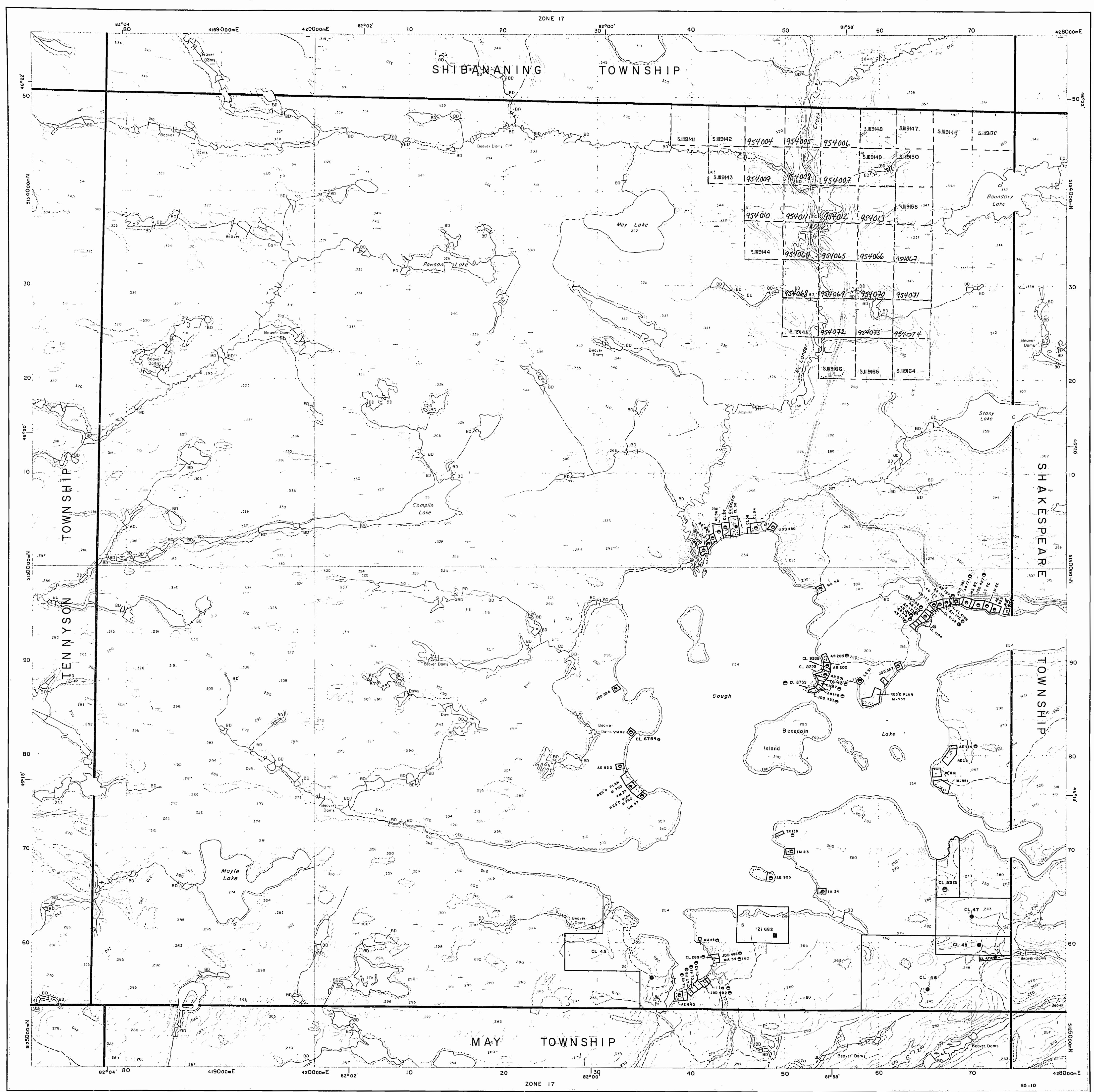

January 1986

INDEX TO LAND DISPOSITION

PLAN G-2889 TOWNSHIP GOUGH

M.N.R. ADMINISTRATIVE DISTRICT ESPANOLA MINING DIVISION SUDBURY LAND TITLES/REGISTRY DIVISION SUDBURY

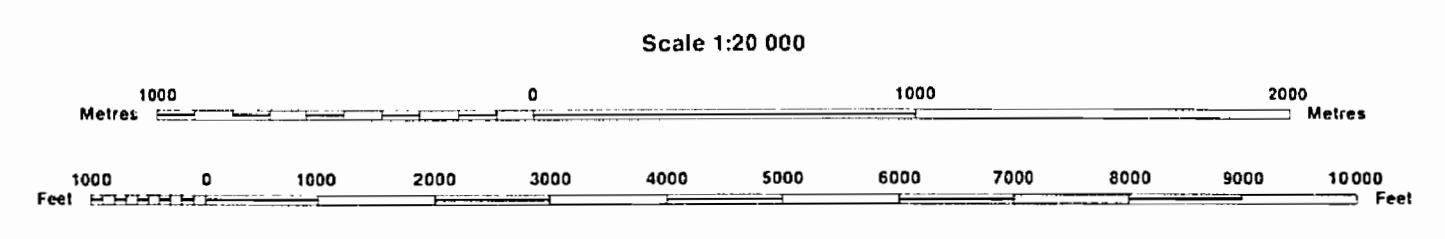

AREAS WITHDRAWN FROM DISPOSITION

- MRO - Mining Rights Only
SRO - Surface Rights Only
M + S - Mining and Surface Rights

SYMBOLS

- Boundary Township, Meridian, Baseline
Road allowance; surveyed
Lot/Concession; surveyed
Parcel; surveyed
Right-of-way; road
Reservation
Cliff, Pit, Pile
Contour
Control point (horizontal)
Flooded land
Mine head frame
Pipeline (above ground)
Railway; single track
Road; highway, county, township
Shoreline (original)
Transmission line
Wooded area

NOTES
The subdivision of this Township into Lots and Concessions was annulled on May 14th 1953.

DISPOSITION OF CROWN LANDS

- Patent Surface & Mining Rights
Lease Surface & Mining Rights
Licence of Occupation
Order-in-Council
Cancelled
Reservation
Sand & Gravel

THE INFORMATION THAT APPEARS ON THIS MAP HAS BEEN COMPILED FROM VARIOUS SOURCES, AND ACCURACY IS NOT GUARANTEED. THOSE WISHING TO STAKE MINING CLAIMS SHOULD CONSULT WITH THE MINING RECORDER, MINISTRY OF NORTHERN DEVELOPMENT AND MINES, FOR ADDITIONAL INFORMATION ON THE STATUS OF THE LANDS SHOWN HEREON.

C-5888 GOUCH TWP TOWNSHIPS SHAKESPEARE

THE TOWNSHIP  
OF  
**GOUGH**

DISTRICT OF  
SUDBURY

SUDBURY  
MINING DIVISION

SCALE: 1-INCH=40 CHAINS

LEGEND

PATENTED LAND	Ⓟ
CROWN LAND SALE	C.S.
LEASES	Ⓛ
LOCATED LAND	Loc.
LICENSE OF OCCUPATION	L.O.
ROADS	—
IMPROVED ROADS	—
KING'S HIGHWAY	—
RAILWAYS	—
POWER LINES	—
MARSH OR MUSKEG	—
MINES	Ⓧ

NOTES

400' Reserve to Dept. of Lands & Forests shown thus: —

Sand & Gravel on all unpatented mining claims in this Township reserved to the Crown.

BLANKET QUARRY  
PERMIT #7068  
COVERS PART OF  
GOUGH TWP.

**GOUGH**

PLAN NO. — M-890

DEPARTMENT OF MINES  
—ONTARIO—

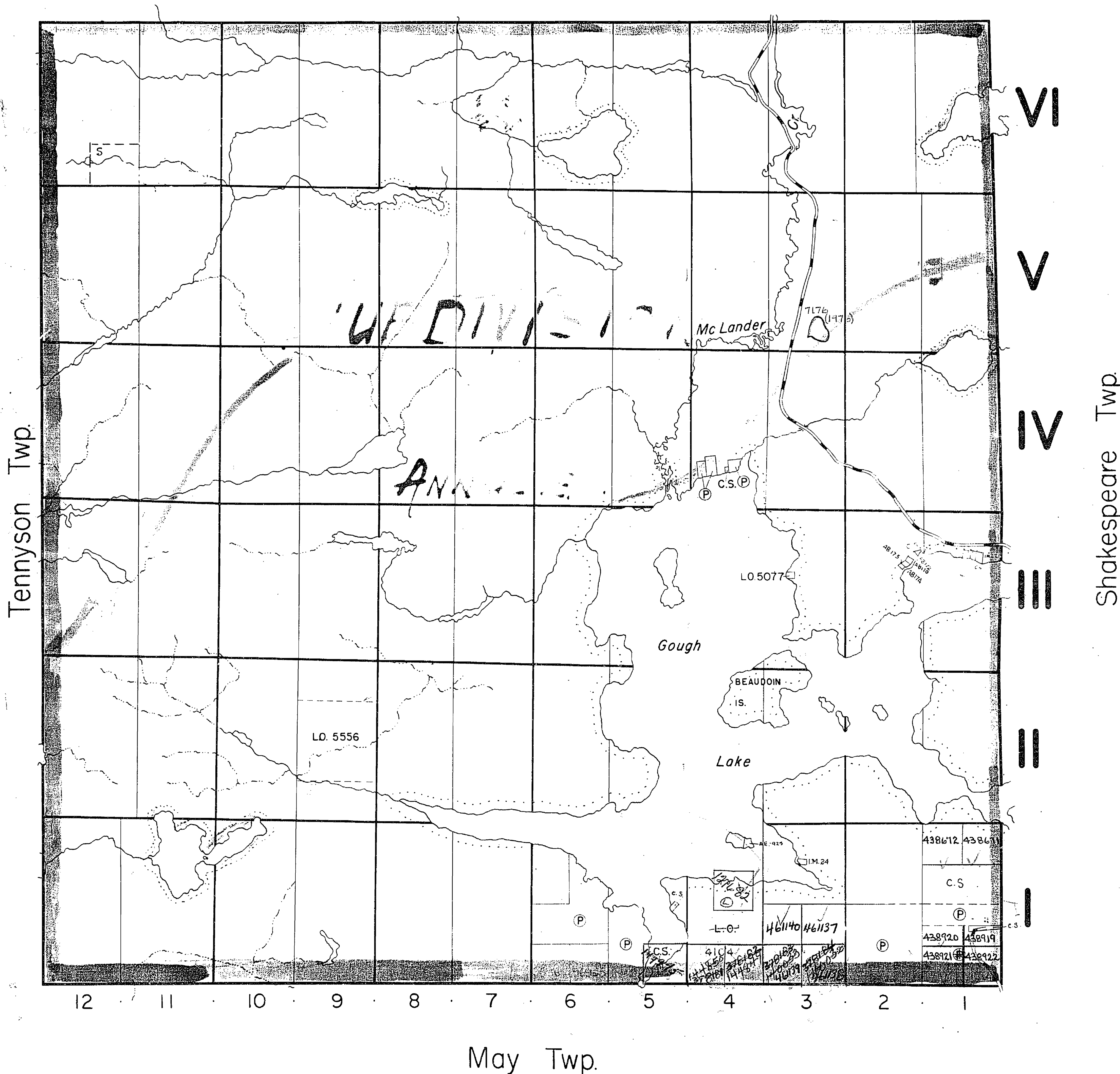

#0 k. l. v. used  
Twp. file

THE TOWNSHIP OF  
OF  
**GOUGH**

DISTRICT OF  
SUDBURY  
SUDBURY  
MINING DIVISION

SCALE: 1-INCH=40 CHAINS

LEGEND

PATENTED LAND	Ⓟ
CROWN LAND SALE	C.S.
LEASES	Ⓛ
LOCATED LAND	Loc.
LICENSE OF OCCUPATION	L.O.
ROADS	— — — — —
IMPROVED ROADS	— — — — —
KING'S HIGHWAY	— — — — —
RAILWAYS	— — — — —
POWER LINES	— — — — —
MARSH OR MUSKEG	— — — — —
MINES	— — — — —

NOTES

200' Reserve to Dept. of Lands & Forests  
shown thus: — — — — —

ALL CLAIMS  
SUBJECT TO  
SECT. 53  
GOUGH TWP

400' Reserve  
**M890**

PLAN NO. — S.211

DEPARTMENT OF MINES  
— ONTARIO —

VI  
OLD  
V

IV

III

II

I

Shakespeare Twp.

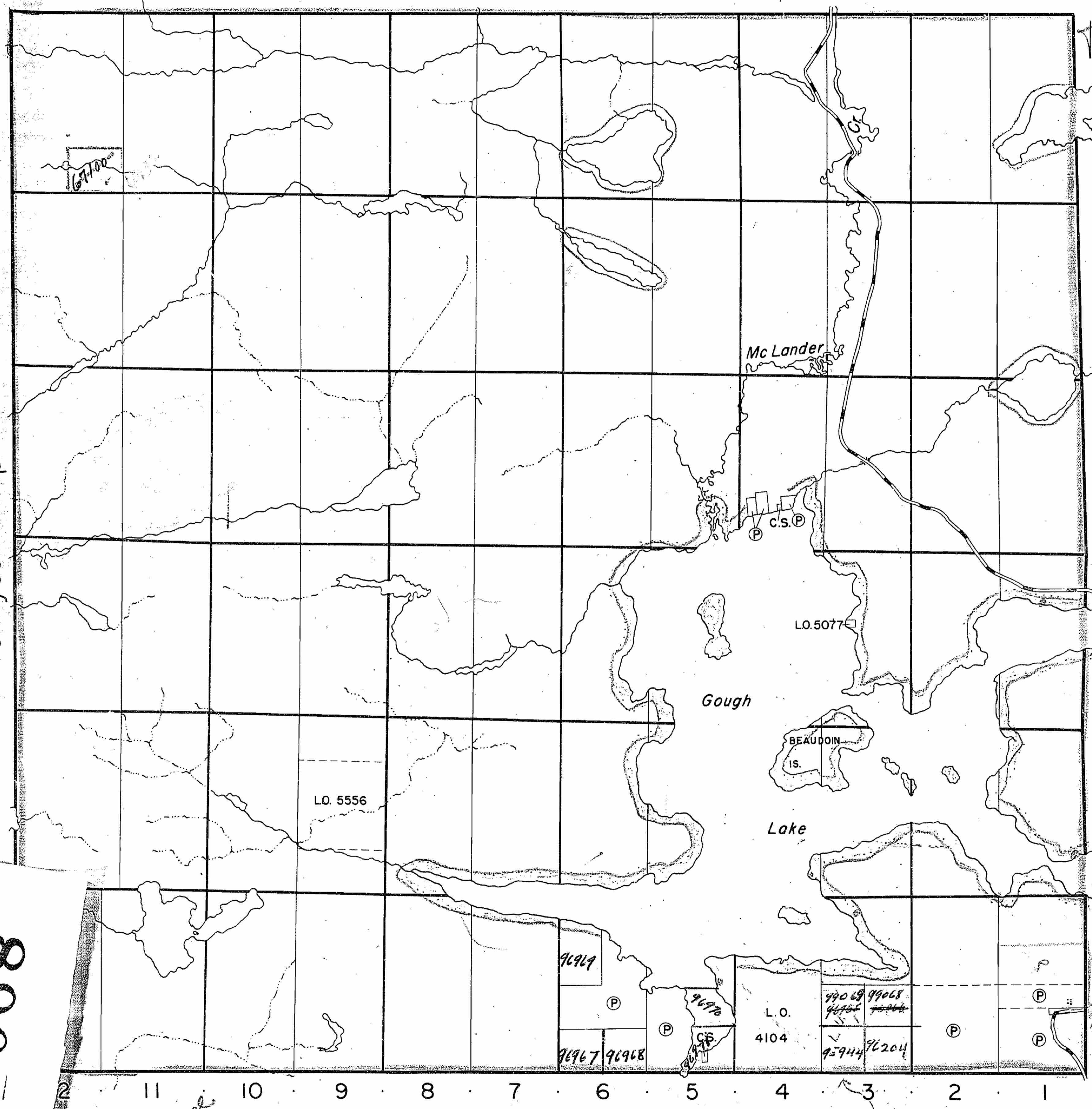

Tennyson Twp.

May Twp.