



M I N N E S O T A  
U. S. A.

Cypress Lake - G-521

Icarus Lake - G-734

**LEGEND**

- HIGHWAY AND ROUTE No.
- OTHER ROADS
- TRAILS
- SURVEYED LINES:
  - TOWNSHIPS, BASE LINES, ETC.
  - LOTS, MINING CLAIMS, PARCELS, ETC.
- UNSURVEYED LINES:
  - LOT LINES
  - PARCEL BOUNDARY
  - MINING CLAIMS ETC.
- RAILWAY AND RIGHT OF WAY
- UTILITY LINES
- NON-PERENNIAL STREAM
- FLOODING OR FLOODING RIGHTS
- SUBDIVISION OR COMPOSITE PLAN
- RESERVATION
- ORIGINAL SHORELINE
- MARSH OR MUSKEG
- MINES
- TRAVERSE MONUMENT

**DISPOSITION OF CROWN LANDS**

TYPE OF DOCUMENT	SYMBOL
PATENT, SURFACE & MINING RIGHTS	
" SURFACE RIGHTS ONLY	
" MINING RIGHTS ONLY	
LEASE, SURFACE & MINING RIGHTS	
" SURFACE RIGHTS ONLY	
" MINING RIGHTS ONLY	
LICENCE OF OCCUPATION	
ORDER-IN-COUNCIL	
RESERVATION	
CANCELLED	
SAND & GRAVEL	
LAND USE PERMITS FOR COMMERCIAL TOURISM/OUTPOST CAMPS	

NOTE: MINING RIGHTS IN PARCELS PATENTED PRIOR TO MAY 6, 1912, VESTED IN ORIGINAL PATENTEES BY THE PUBLIC LANDS ACT, R.S.O. 1970, CHAP. 380, SEC. 63, SUBSEC. 1.

**REFERENCES**

**AREAS WITHDRAWN FROM DISPOSITION**

M.R.O. - MINING RIGHTS ONLY  
S.R.O. - SURFACE RIGHTS ONLY  
M.+S. - MINING AND SURFACE RIGHTS

Description	Order No.	Date	Disposition	File
1111 43	W.71/83	18 / 8 / 73	S.R.O.M.R.	187402
1111 43	W.71/83	27 / 9 / 83	S.R.M.	188542
1111 43	W.10/83		S.R.O.	188542
1111 43	W.12/83	14 / 7 / 83	S.R.O.M.R.	187402

*ALL STRIP WITHDRAWN*

THE INFORMATION THAT APPEARS ON THIS MAP HAS BEEN COMPILED FROM VARIOUS SOURCES, AND ACCURACY IS NOT GUARANTEED. THOSE WISHING TO STAKE MINING CLAIMS SHOULD CONSULT WITH THE MINING RECORDER, MINISTRY OF NORTHERN DEVELOPMENT AND MINES, FOR ADDITIONAL INFORMATION ON THE STATUS OF THE LANDS SHOWN HEREON.

**FLOODING**

Flooding rights reserved to contour elev. 1437' on lands bordering on Saganaga Lake. File: 4922

SCALE: 1 INCH = 40 CHAINS

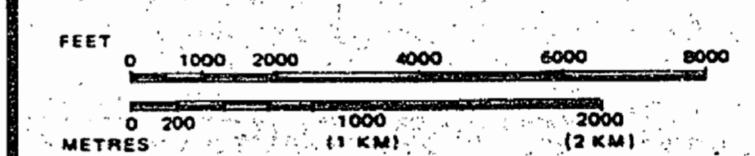

**AREA**  
**GRANITE LAKE**  
M.N.R. ADMINISTRATIVE DISTRICT  
**THUNDER BAY**  
MINING DIVISION  
**THUNDER BAY**  
LAND TITLES / REGISTRY DIVISION  
**RAINY RIVER-THUNDER BAY**

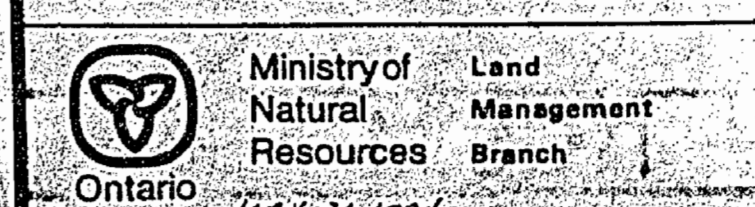

Date: JANUARY, 1984  
Number: **G-2518**

3071

Saganagons Lake - M.3067

AREA OF  
**GRANITE LAKE**

DISTRICT OF  
RAINY RIVER-THUNDER BAY

THUNDER BAY  
MINING DIVISION

SCALE: 1-INCH = 40 CHAINS

**LEGEND**

- PATENTED LAND
- CROWN LAND SALE LEASES
- LOCATED LAND
- LICENSE OF OCCUPATION
- MINING RIGHTS ONLY
- SURFACE RIGHTS ONLY
- ROADS
- IMPROVED ROADS
- KING'S HIGHWAYS
- RAILWAYS
- POWER LINES
- MARSH OR MUSKEGE
- M'NES
- CANCELLED

**NOTES**

400' surface rights reservation around all lakes and rivers.

Summer resort locations patented for surface rights only shown thus.

**Flooding**  
Flooding rights reserved to contour elev. 427.5 on lands bordering on Saganago Lake. File: 4922

Areas withdrawn from staking under section 43 of the Mining Act (R.S.O. 1970):

File	Date	Disposition
43 187602	18/5/73	SR&M
Order N <sup>o</sup> : W. 22/73		
W 62/74	185216	28 Nov 74 3 R/O

M I N N E S O T A  
U . S . A .

Icarus Lake - M.3072

1977

AMERICAN  
THUNDER BAY DIST. APR 20 1977  
NATIONAL TOPOGRAPHIC SERIES 52 B 2

PLAN NO. M.3071

ONTARIO  
MINISTRY OF NATURAL RESOURCES  
SURVEYS AND MAPPING BRANCH



Cypress Lake - M.2379

482904  
481904

3071

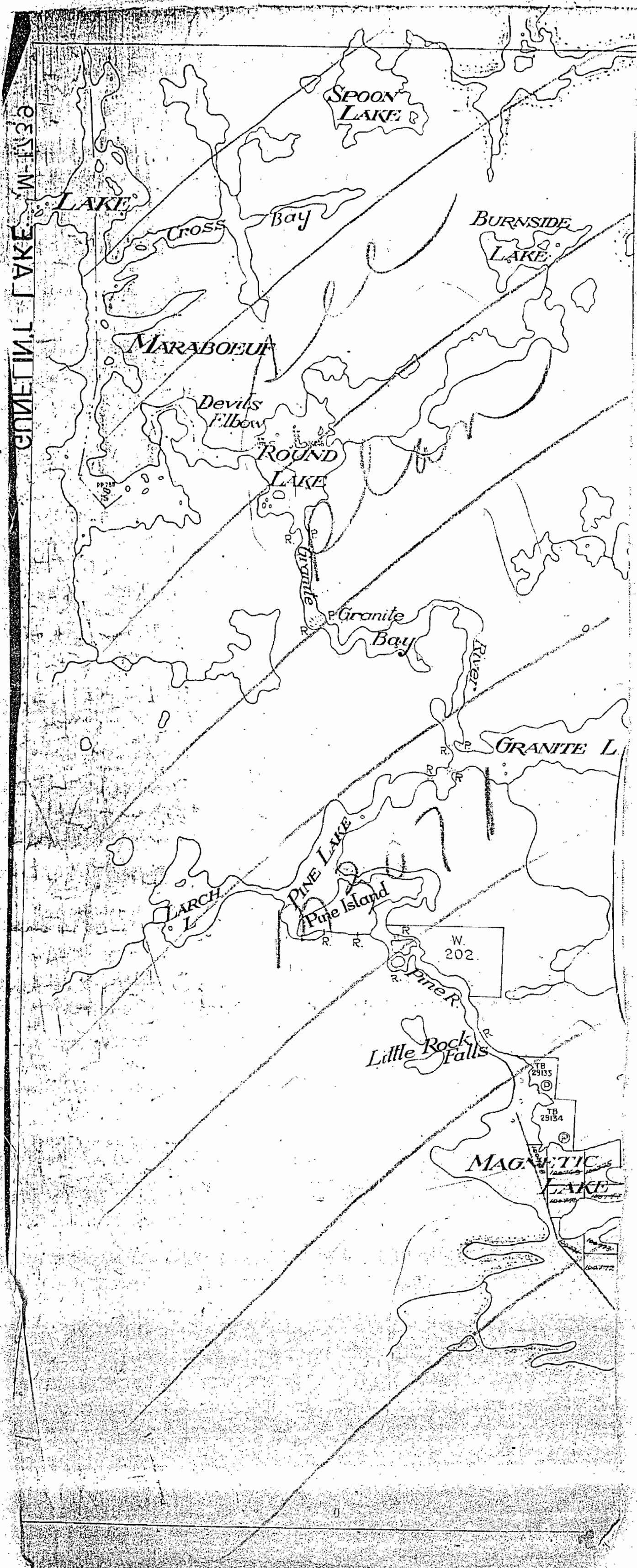

LEGEND

- PATENTED LAND
- CROWN LAND SALE
- LEASES
- LOCATED LAND
- LICENSE OF OCCUPATION
- MINING RIGHTS ONLY
- SURFACE RIGHTS ONLY
- ROADS
- IMPROVED ROADS
- KING'S HIGHWAYS
- RAILWAYS
- POWER LINES
- MARSH OR MUSKEG
- MINES
- CANCELLED

NOTES

400' surface rights reservation around all lakes and rivers.

Summer resort locations patented for surface rights only shown thus 

**Flooding**  
Flooding rights reserved to contour elev. 1437 on lands bordering on Saganago Lake. File: 4922

Areas withdrawn from staking under Section 43 of the Mining Act (R.S.O. 1970)

File No.	Date	Disposition
(43) 187602	18/5/73	SRBM
Order N°: W. 22/73		
(43) W. 52/74	18/5/73	SRBM
(43) W. 52/74	18/5/73	SRBM

① SURFACE RIGHTS RESERVED  
W. 52/74



M I N N E S O T A (NARROW STRIP 256' wide)  
U. S. A.

Cypress Lake - M.2379

Icarus Lake - M.3072

ANTICAN  
THUNDER BAY DIST. APR 20/77  
NATIONAL TOPOGRAPHIC SERIES 52 B 2

PLAN NO. M.3071

ONTARIO  
MINISTRY OF NATURAL RESOURCES  
SURVEYS AND MAPPING BRANCH

RECEIVED  
THUNDER BAY  
MINING DIVISION  
\*90 JUN 26 AM 11 12

Saganagons Lake - G-2518

LEGEND

HIGHWAY AND ROUTES	—+—+—+—
OTHER ROADS	—+—+—
TRAILS	- - - - -
SURVEY LINES	—+—+—
TOWNSHIP, RANGE LINES, ETC.	—+—+—
LOT, MINING CLAIM, PARCELS, ETC.	—+—+—
UNSURVEYED LINES	—+—+—
LOT LINES	—+—+—
PARCELS, BOUNDARY	—+—+—
MINING CLAIMS	—+—+—
RAILWAY AND RAILWAY	—+—+—
UTILITY LINES	—+—+—
NON-PERMANENT STREAM	—+—+—
FLOODING - FLOODING RIGHTS	—+—+—
SUBDIVISION OF EMPHATIC PLAN	—+—+—
RESERVATION	—+—+—
ORIGINAL SHORELINE	—+—+—
MARSH OR MUSKOG	—+—+—
MINES	—+—+—
TRAVERSE MONUMENT	—+—+—

DISPOSITION OF CROWN LANDS

TYPE OF DOCUMENT	SYMBOL
PATENT SURFACE & MINING RIGHTS	—+—+—
SURFACE RIGHTS ONLY	—+—+—
MINING RIGHTS ONLY	—+—+—
LEASE SURFACE & MINING RIGHTS	—+—+—
SURFACE RIGHTS ONLY	—+—+—
MINING RIGHTS ONLY	—+—+—
LICENCE OF OCCUPATION	—+—+—
ORDER IN COUNCIL	—+—+—
RESERVATION	—+—+—
CANCELLED	—+—+—
SAND & GRAVEL	—+—+—

NOTE: MINING RIGHTS IN PARCELS PATENTED PRIOR TO MAY 4 1877 VESTED IN ORIGINAL PATENTEES BY THE PUBLIC LANDS ACT (R.S.O. 1940 CHAP. 380 SEC. 43 SUBSEC. 1)

REFERENCES

AREAS WITHDRAWN FROM DISPOSITION

Disposition	Order No.	Date	Disposition	File
M.R.O.			MINING RIGHTS ONLY	
S.R.O.			SURFACE RIGHTS ONLY	
M+S			MINING AND SURFACE RIGHTS	

FLOODING  
Flooding rights reserved to contour elev. 1437' on lands bordering on Saganago Lake  
File 4922

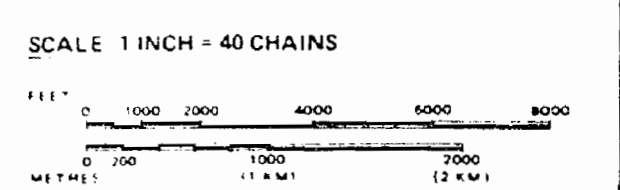

AREA  
**GRANITE LAKE**  
M.N.R. ADMINISTRATIVE DISTRICT  
THUNDER BAY  
MINING DIVISION  
THUNDER BAY  
LAND TITLES / REGISTRY DIVISION  
RAINY RIVER - THUNDER BAY

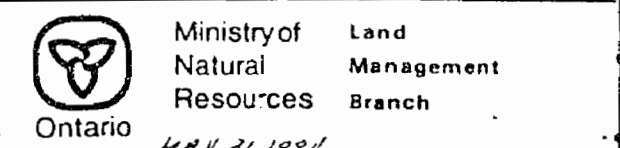

Date: JANUARY, 1984  
Number: **G-2518**



M I N N E S O T A  
U. S. A.

Cypress Lake - G-521

Icarus Lake - G-734

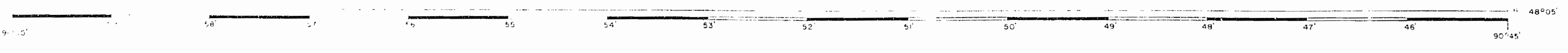

482904  
481904

# GRANITE LAKE

DISTRICT OF  
RAINY RIVER-THUNDER BAY

THUNDER BAY  
MINING DIVISION

SCALE: 1-INCH = 40 CHAINS

### LEGEND

- PATENTED LAND
- CROWN LAND SALE
- LEASES
- LOCATED LAND
- LICENSE OF OCCUPATION
- MINING RIGHTS ONLY
- SURFACE RIGHTS ONLY
- ROADS
- IMPROVED ROADS
- KING'S HIGHWAYS
- RAILWAYS
- POWER LINES
- MARSH OR MUSKEG
- MINES
- CANCELLED

### NOTES

400' surface rights reservation around all lakes and rivers

Summer resort locations patented for surface rights only shown thus

#### Flooding

Flooding rights reserved to contour elev. 437 on lands bordering on Saganago Lake.

Areas withdrawn from staking under Section 43 of the Mining Act (R.S.O. 1970)

File	Date	Disposition
43 187602	18/5/73	SRB MP
Order N <sup>o</sup> : W. 22/73		
5 W 62/74 185216	29 Nov 74	S. R/O

M I N N E S O T A  
U. S. A.

Cypress Lake - M. 2379

Icarus Lake - M. 3072

1977

THUNDER BAY DISTRICT  
NATIONAL TOPOGRAPHIC SERIES 52 B 2

PLAN NO. M. 3071

ONTARIO  
MINISTRY OF NATURAL RESOURCES  
SURVEYS AND MAPPING BRANCH

3071

Saganagons Lake - M.3067

AREA OF

GRANITE LAKE

DISTRICT OF RAINY RIVER-THUNDER BAY

THUNDER BAY MINING DIVISION

SCALE: 1-INCH = 40 CHAINS

LEGEND

- PATENTED LAND
- CROWN LAND SALE LEASES
- LOCATED LAND
- LICENSE OF OCCUPATION
- MINING RIGHTS ONLY
- SURFACE RIGHTS ONLY
- ROADS
- IMPROVED ROADS
- KING'S HIGHWAYS
- RAILWAYS
- POWER LINES
- MARSH OR MUSKIE
- MINES
- CANCELLED

NOTES

400' surface rights reservation around lakes and rivers.

Summer resort locations patented for surface rights only shown thus

Flooding

Flooding rights reserved to contour elev 1437 on lands bordering on Saganago Lake.

File: 4922

Areas withdrawn from staking under section 43 of the Mining Act (R.S.O. 1970)

File	Date	Disposition
43 187602	18/5/73	SRBM
Order N.W. 22/73		
6 62/74	185216	28 Nov 74 SRFO

APR 20 1977 THUNDER BAY DIST. NATIONAL TOPOGRAPHIC SERIES 52 B 2

PLAN NO. M.3071

ONTARIO MINISTRY OF NATURAL RESOURCES SURVEYS AND MAPPING BRANCH



MINNESOTA U.S.A.

Cypress Lake - M.2379

Icarus Lake - M.3072

1977

482904 481904

3071

SPINELAKE W-1130

