

Burt Twp.

Flavelle Twp.

VI

IV

III

II

I

Blain Twp.

THE TOWNSHIP OF

GROSS

DISTRICT OF TIMISKAMING

MONTREAL RIVER MINING DIVISION

SCALE: 1-INCH=40 CHAINS

LEGEND

PATENTED LAND	(P)
CROWN LAND SALE	C.S.
LEASES	(L)
LOCATED LAND	Loc.
LICENSE OF OCCUPATION	L.O.
MINING RIGHTS ONLY	M.R.O.
SURFACE RIGHTS ONLY	S.R.O.
ROADS	— — — — —
IMPROVED ROADS	— — — — —
KING'S HIGHWAYS	— — — — —
RAILWAYS	— — — — —
POWER LINES	— — — — —
MARSH OR MUSKEG	— — — — —
MINES	X
CANCELLED	C

NOTES

400' Surface rights reservation around all lakes and rivers.

Flooding Rights Reserved To Contour 38. File: 1788 Vol.2.

S.R.O. Withdrawn.
This parcel is required to provide access points to adjacent named bodies of water.

Replaced Feb 6/80

PLAN NO.- M.487

DEPARTMENT OF MINES

— ONTARIO —

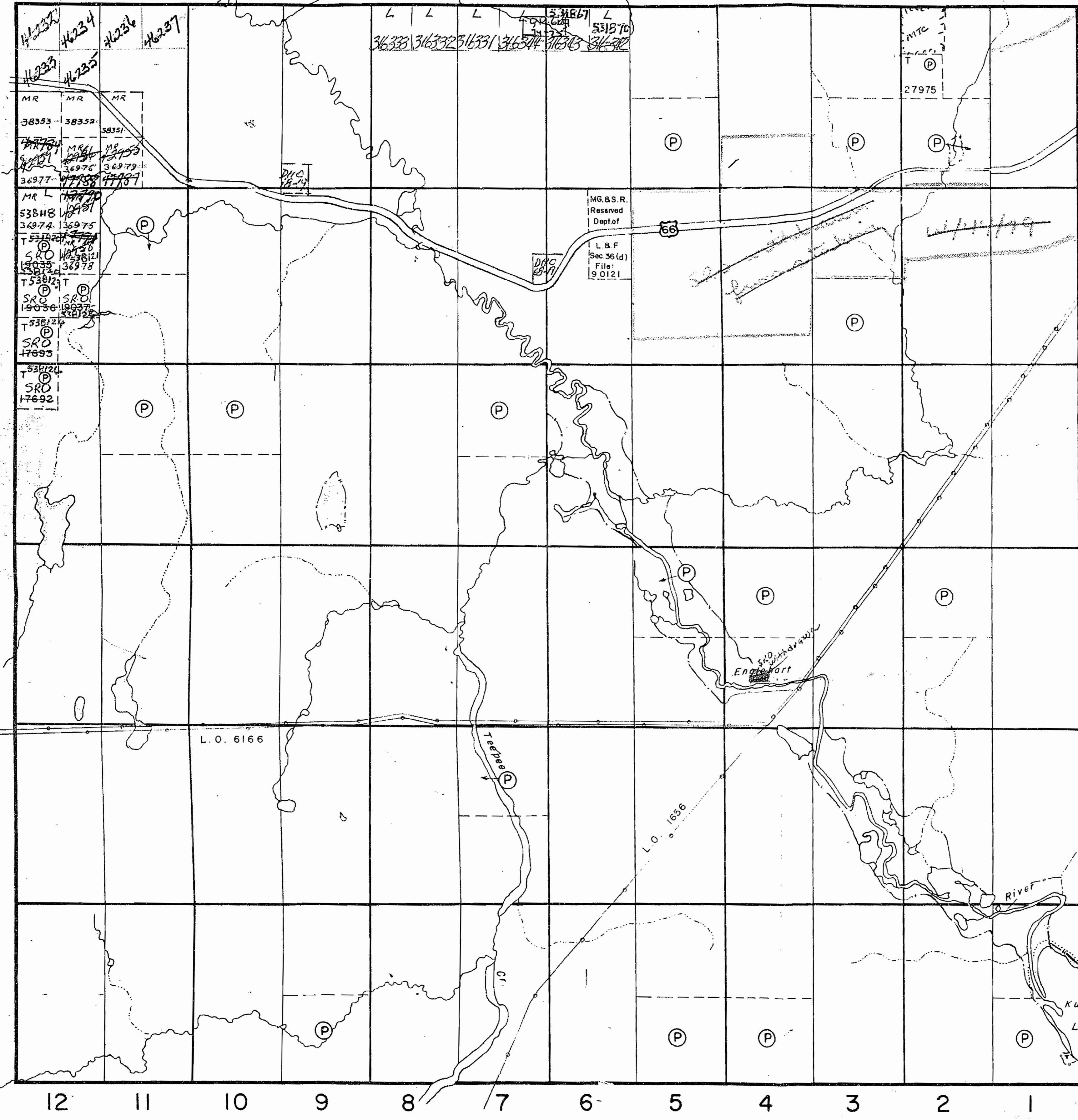

Burt Twp.

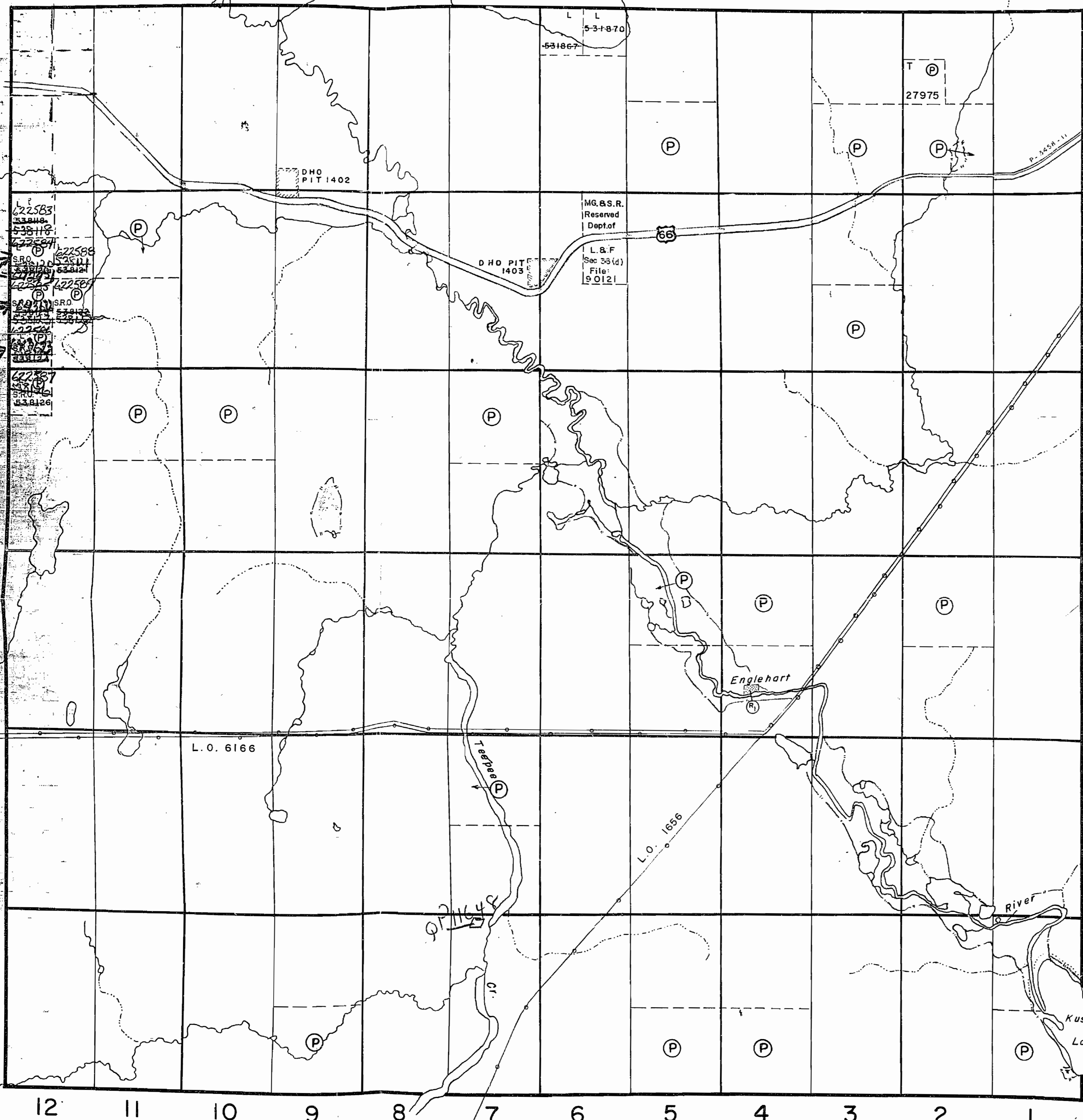

Davidson Twp.

THE TOWNSHIP OF

GROSS

DISTRICT OF TIMISKAMING

LARDER LAKE MINING DIVISION

SCALE: 1-INCH=40 CHAINS

LEGEND

PATENTED LAND	(P)
CROWN LAND SALE	C.S.
LEASES	(L)
LOCATED LAND	Loc.
LICENSE OF OCCUPATION	L.O.
MINING RIGHTS ONLY	M.R.O.
SURFACE RIGHTS ONLY	S.R.O.
ROADS	—
IMPROVED ROADS	—
KING'S HIGHWAYS	—
RAILWAYS	—
POWER LINES	—
MARSH OR MUSKEG	—
MINES	—
CANCELLED	—

NOTES

400' Surface rights reservation around all lakes and rivers.

Flooding Rights Reserved To Contour 38. File: 1788-Vol.2

Areas withdrawn from staking under Section 43 of the Mining Act (R.S.O. 1970).

Order No.	File	Date	Disposition
(R) W.43/76	188552	14/1/76	S.R.O.

Map Replaced
Sept 24 / 82
(Signature)

PLAN NO.- M.487

ONTARIO
MINISTRY OF NATURAL RESOURCES
SURVEYS AND MAPPING BRANCH

Burt Twp.

THE TOWNSHIP OF
OF

GROSS

DISTRICT OF
TIMISKAMING

LARDER LAKE
MINING DIVISION

SCALE: 1-INCH=40 CHAINS

LEGEND

PATENTED LAND	Ⓟ
CROWN LAND SALE	C.S.
LEASES	Ⓛ
LOCATED LAND	Loc.
LICENSE OF OCCUPATION	L.O.
MINING RIGHTS ONLY	M.R.O.
SURFACE RIGHTS ONLY	S.R.O.
ROADS,	—
IMPROVED ROADS	—
KING'S HIGHWAYS	—
RAILWAYS	—
POWER LINES	—
MARSH OR MUSKEG	—
MINES	—
CANCELLED	—

NOTES

400' Surface rights reservation around all lakes and rivers.

Flooding Rights Reserved To Contain 38' File 1788 Vol 2

Areas withdrawn from staking under Section 13 of the Mining Act (R.S.O. 1970).

Order No.	File	Date	Disposition
188522		4/2/80	S.R.O. - Resurveyed 1980 37.30

NOTICE OF FORESTRY ACTIVITY

THIS TOWNSHIP / AREA FALLS WITHIN THE PLONSKI FOREST MANAGEMENT UNIT

AND MAY BE SUBJECT TO FORESTRY OPERATIONS. THE MNR UNIT FORESTER FOR THIS AREA CAN BE

CONTACTED AT: P.O. BOX 129
SWASTIKA, ONT.
POK ITO
705-642-3222

PLAN NO.- M.487

ONTARIO
MINISTRY OF NATURAL RESOURCES

SURVEYS AND MAPPING BRANCH

Flavelle Twp.

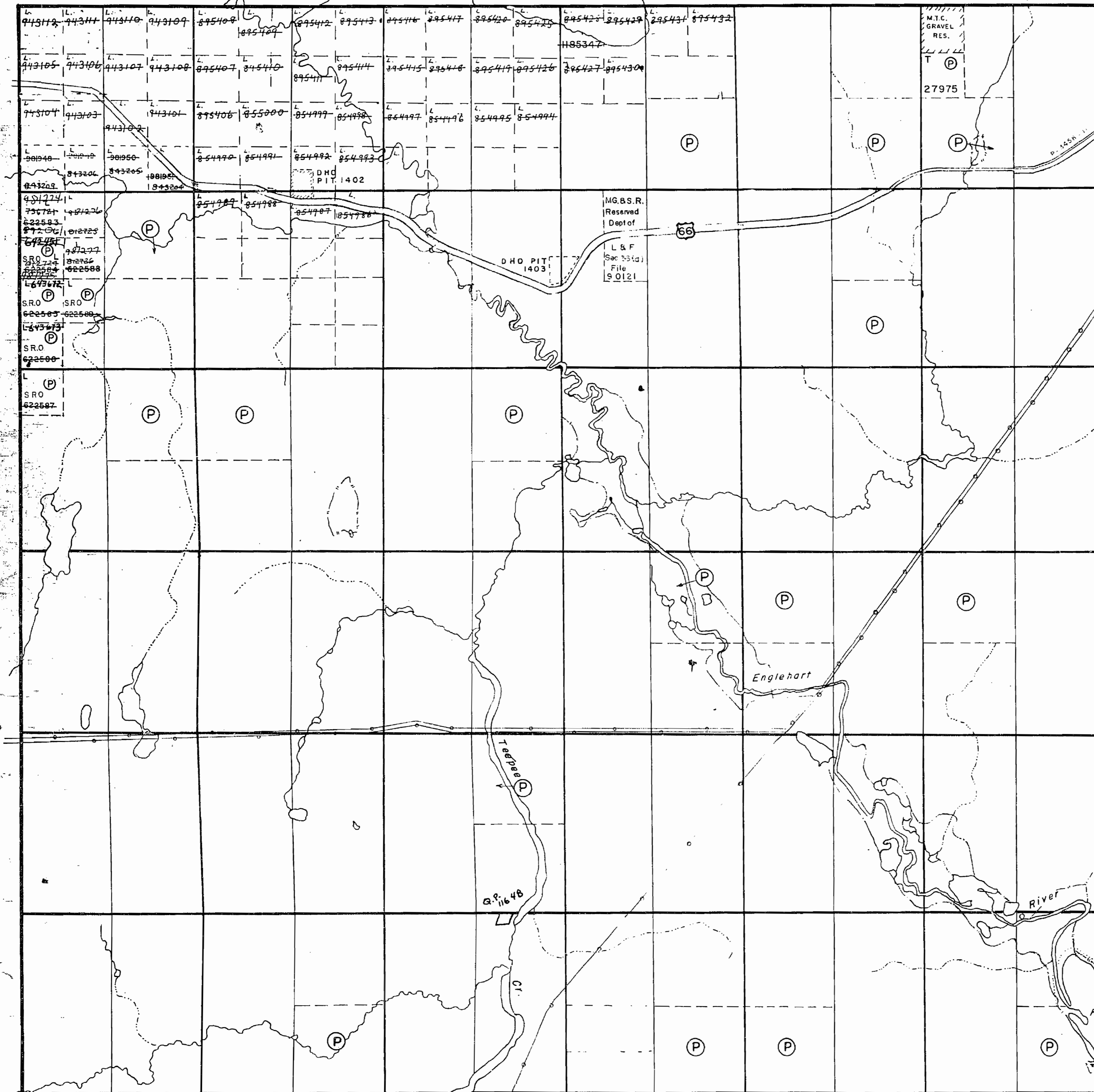

VI

V

IV

III

II

I

Blain Twp.

12 11 10 9 8 7 6 5 4 3 2 1

Davidson Twp.

THE INFORMATION THAT APPEARS ON THIS MAP HAS BEEN COMPILED FROM VARIOUS SOURCES, AND ACCURACY IS NOT GUARANTEED. THOSE WISHING TO STAKE MINING CLAIMS SHOULD CONSULT WITH THE MINING RECORDER, MINISTRY OF NORTHERN DEVELOPMENT AND MINES, FOR ADDITIONAL INFORMATION ON THE STATUS OF THE LANDS SHOWN HEREON.

Burt Twp.

THE TOWNSHIP OF

GROSS

DISTRICT OF
TIMISKAMING

LARDER LAKE
MINING DIVISION

SCALE: 1-INCH=40 CHAINS

LEGEND

PATENTED LAND	Ⓟ
CROWN LAND SALE	C.S.
LEASES	Ⓞ
LOCATED LAND	Loc.
LICENSE OF OCCUPATION	L.O.
MINING RIGHTS ONLY	M.R.O.
SURFACE RIGHTS ONLY	S.R.O.
ROADS	—
IMPROVED ROADS	—
KING'S HIGHWAYS	—
RAILWAYS	—
POWER LINES	—
MARSH OR MUSKEG	—
MINES	ⓧ
CANCELLED	C

NOTES

400' Surface rights reservation around all lakes and rivers.

Flooding Rights Reserved To Contour 38 File: 1788 Vol. 2

Areas withdrawn from staking under Section 43 of the Mining Act (R.S.O. 1970).

Order No.	File	Date	Disposition
(R) W-L-58/95NER		AUGUST 2/95	M.S.

NOTICE OF FORESTRY ACTIVITY

THIS TOWNSHIP / AREA FALLS WITHIN THE
PLONSKI FOREST MANAGEMENT UNIT

AND MAY BE SUBJECT TO FORESTRY OPERATIONS.
THE MNR UNIT FORESTER FOR THIS AREA CAN BE
CONTACTED AT: P.O. BOX 129
SWASTIKA, ONT.
POK ITO
705-642-3222

PLAN NO.- M.487

ONTARIO
MINISTRY OF NATURAL RESOURCES

SURVEYS AND MAPPING BRANCH

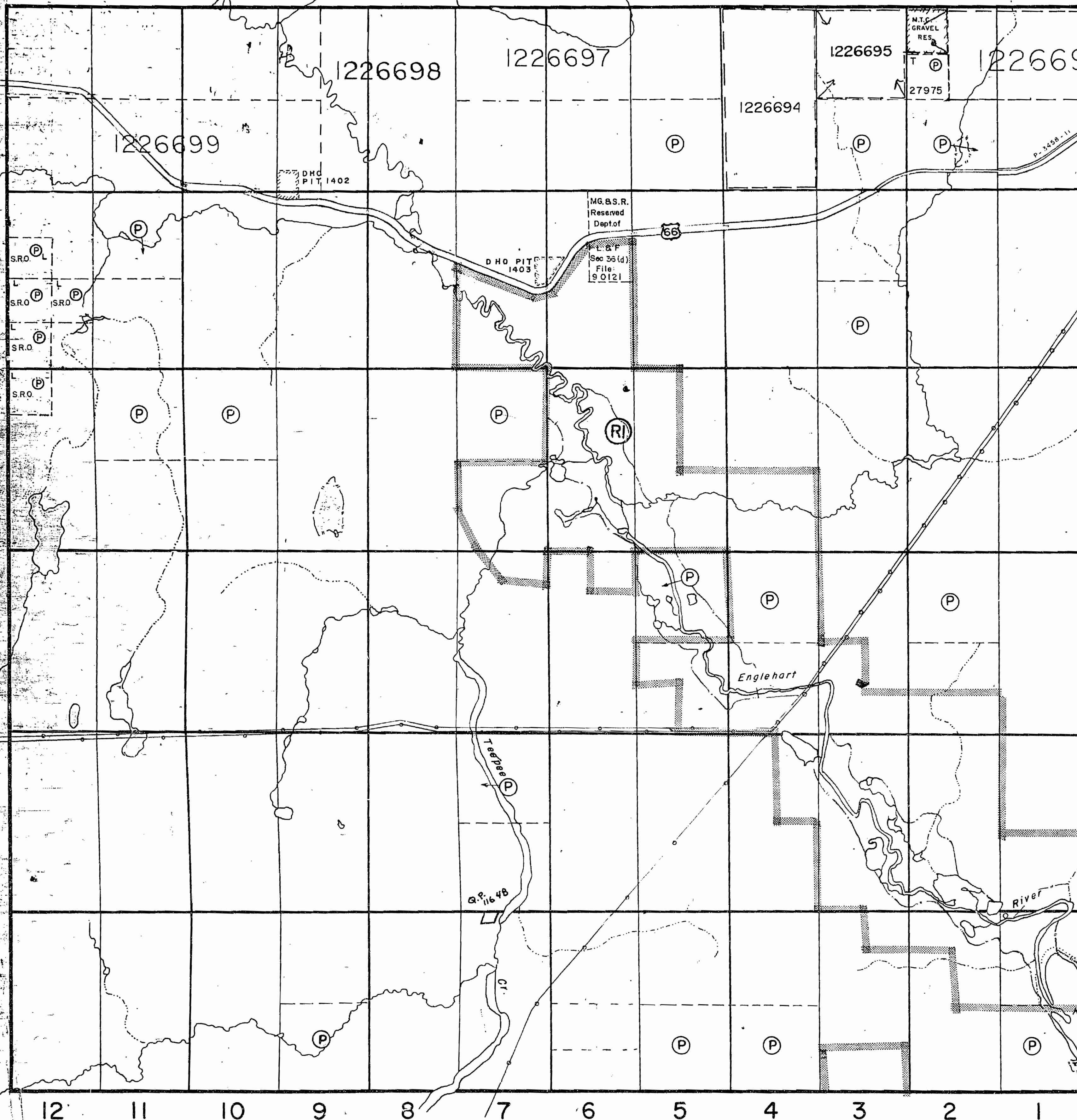

VI

V

IV

III

II

I

Blain Twp.

Davidson Twp.

THE INFORMATION THAT APPEARS ON THIS MAP HAS BEEN COMPILED FROM VARIOUS SOURCES, AND ACCURACY IS NOT GUARANTEED. THOSE WISHING TO STAKE MINING CLAIMS SHOULD CONSULT WITH THE MINING RECORDER, MINISTRY OF NORTHERN DEVELOPMENT AND MINES, FOR ADDITIONAL INFORMATION ON THE STATUS OF THE LANDS SHOWN HEREON.

ARCHIVED AUGUST 03,1995

3

BURT

THE TOWNSHIP OF
OF

GROSS

DISTRICT OF
TIMISKAMING
TIMISKAMING
MINING DIVISION

SCALE: ONE INCH TO 40 CHAINS

LEGEND

- PATENTED LAND P
- CROWN LAND SALE S
- LOCATED LAND Loc.
- LICENCE OF OCCUPATION L.O.
- OFB TOWER SITE B
- POWER TRANSMISSION LINE ———

NOTES



M-487

DEPARTMENT OF MINES
ONTARIO

VI

V

IV

III

II

I

BLAIN

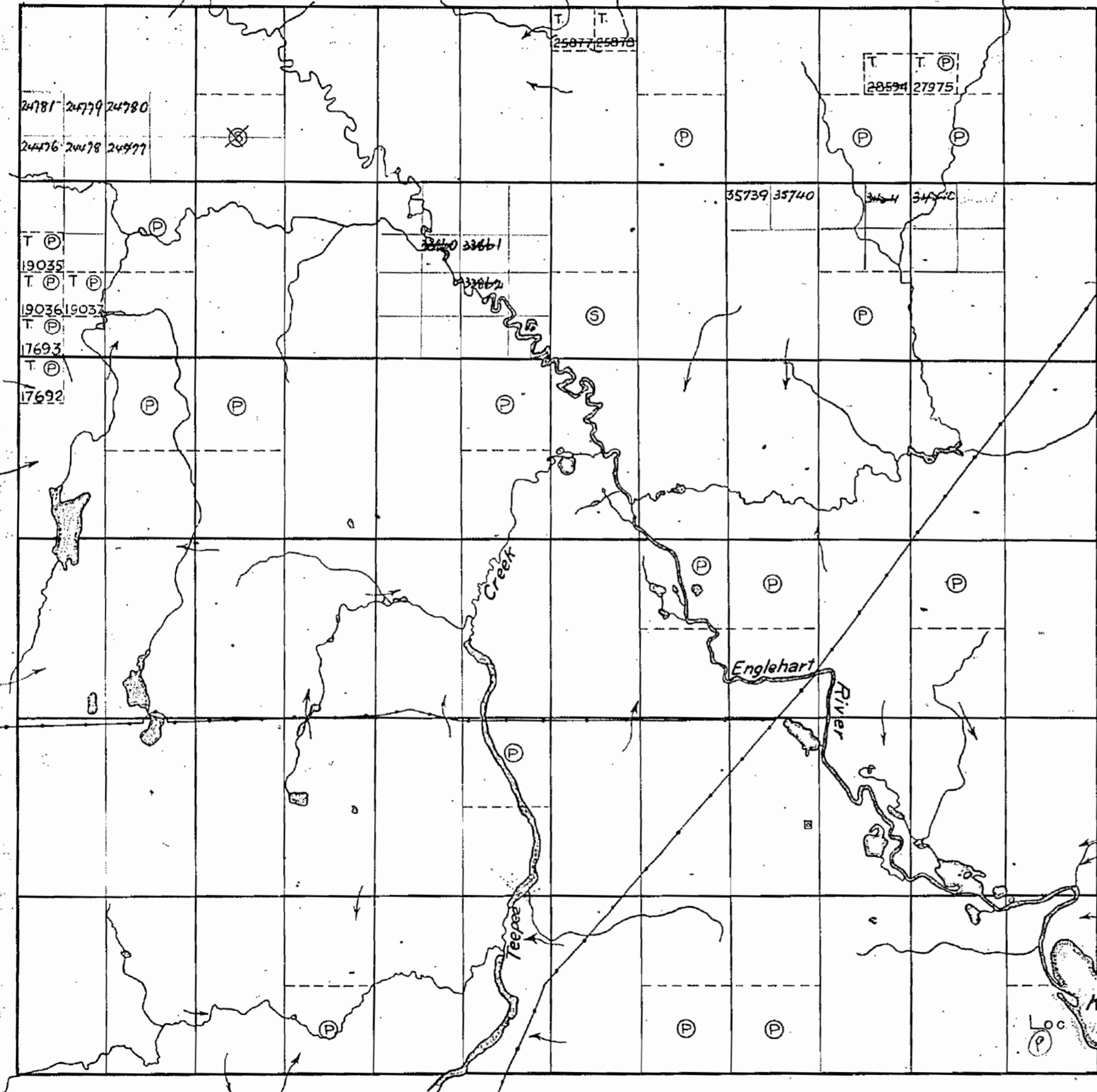

12 11 10 9 8 7 6 5 4 3 2 1

DAVIDSON

FLAVELLE

Burt Twp.

THE TOWNSHIP OF
OF

GROSS

DATE OF ISSUE

APR 1998

PROVINCIAL RECORDING
OFFICE TORONTO

DISTRICT OF
TIMISKAMING

LARDER LAKE
MINING DIVISION

SCALE: 1-INCH=40 CHAINS

LEGEND

PATENTED LAND	Ⓟ
CROWN LAND SALE	C.S.
LEASES	Ⓛ
LOCATED LAND	Loc.
LICENSE OF OCCUPATION	L.O.
MINING RIGHTS ONLY	M.R.O.
SURFACE RIGHTS ONLY	S.R.O.
ROADS	—
IMPROVED ROADS	—
KING'S HIGHWAYS	—
RAILWAYS	—
POWER LINES	—
MARSH OR MUSKEG	—
MINES	Ⓜ
CANCELLED	C.

NOTES

400' Surface rights reservation around all lakes and rivers.

Flooding Rights Reserved To Contour 38 File 1788 Vol 2

Areas withdrawn from staking under Section 13 of the Mining Act (R.S.O. 1970).

Order No.	File	Date	Disposition
(R) W-L-58/95NER		AUGUST 2/95	M.S.

NOTICE OF FORESTRY ACTIVITY

THIS TOWNSHIP / AREA FALLS WITHIN THE PLONSKI FOREST MANAGEMENT UNIT AND MAY BE SUBJECT TO FORESTRY OPERATIONS. THE MNR UNIT FORESTER FOR THIS AREA CAN BE CONTACTED AT: P.O. BOX 129 SWASTIKA, ONT. POK ITO 705-642-3222

PLAN NO.- M.487

ONTARIO
MINISTRY OF NATURAL RESOURCES
SURVEYS AND MAPPING BRANCH

Flavelle Twp.

Blain Twp.

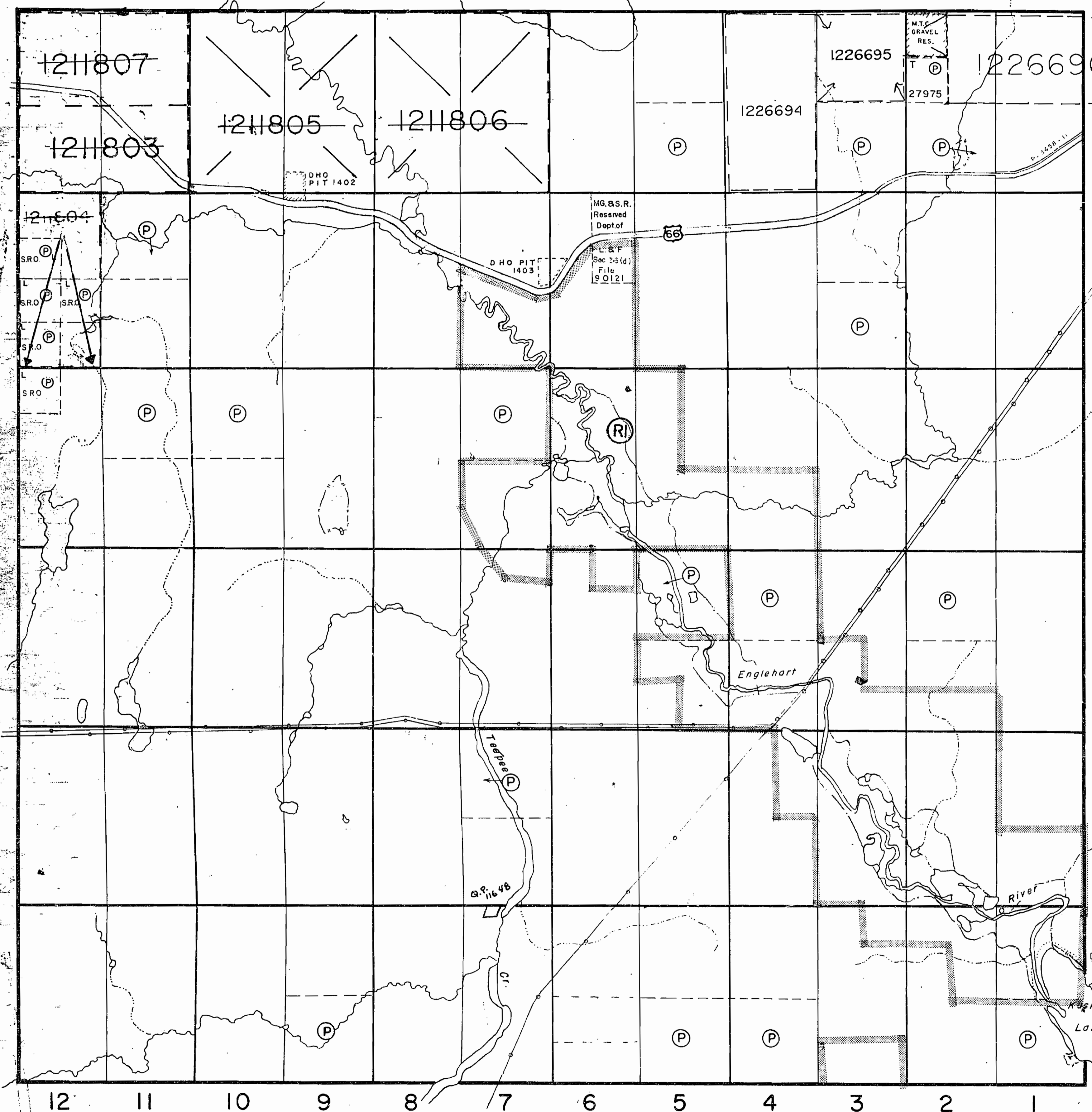

VI
V
IV
III
II
I

12 11 10 9 8 7 6 5 4 3 2 1

Davidson Twp.

THE INFORMATION THAT APPEARS ON THIS MAP HAS BEEN COMPILED FROM VARIOUS SOURCES, AND ACCURACY IS NOT GUARANTEED. THOSE WISHING TO STAKE MINING CLAIMS SHOULD CONSULT WITH THE MINING RECORDER, MINISTRY OF NORTHERN DEVELOPMENT AND MINES, FOR ADDITIONAL INFORMATION ON THE STATUS OF THE LANDS SHOWN HEREON.

ARCHIVED AUGUST 03,1995

487

GROSS

SCALE 40 CHAINS = INCH.

M-487
checked

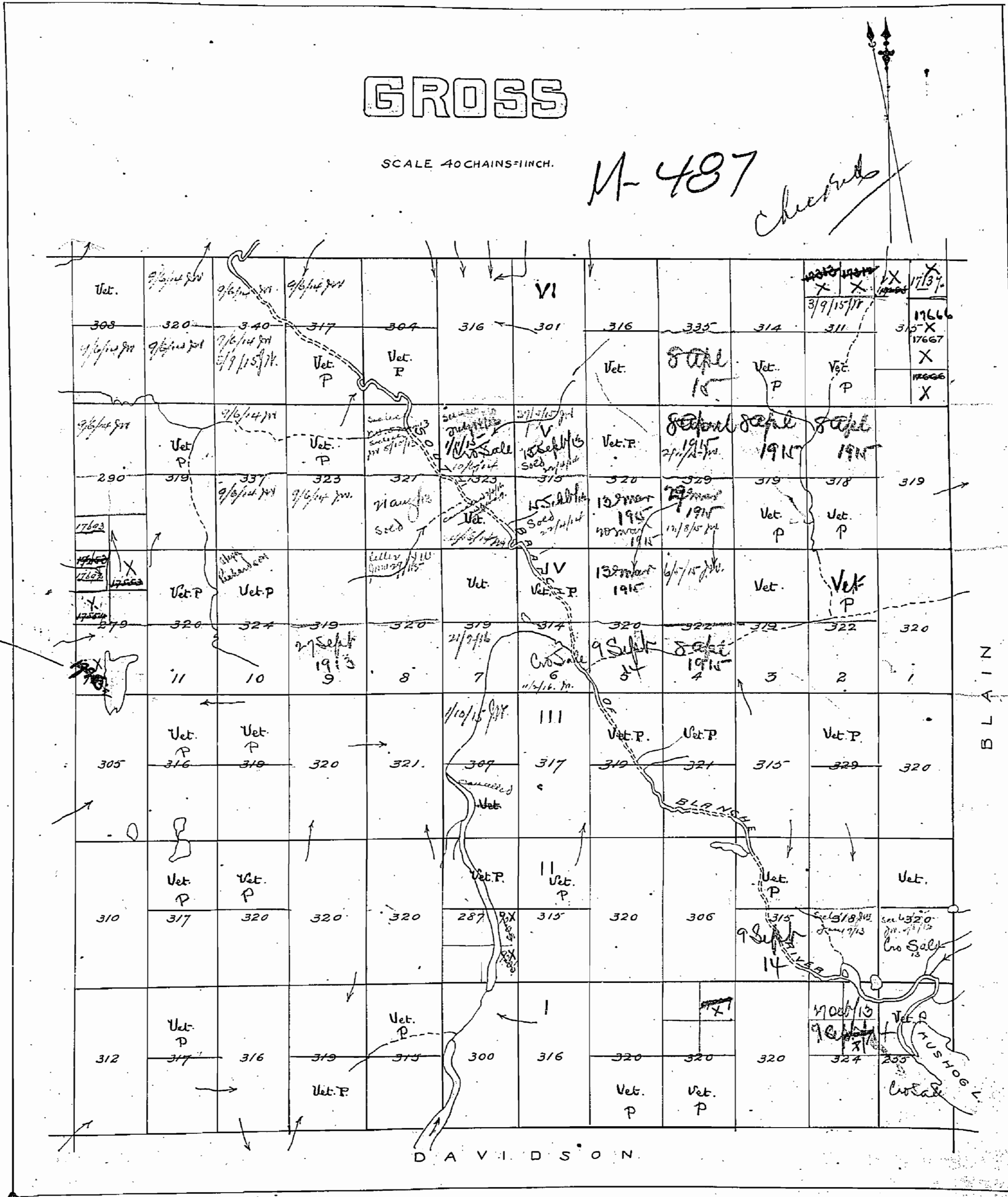

~~1925~~

BLAIN

DAVIDSON

487

Transferred to Montreal Leds May 24
APRIL 1956

GROSS

(2)

TEMISKAMING MINING DIVISION

Scale 40 Chains = 1 inch

M-487

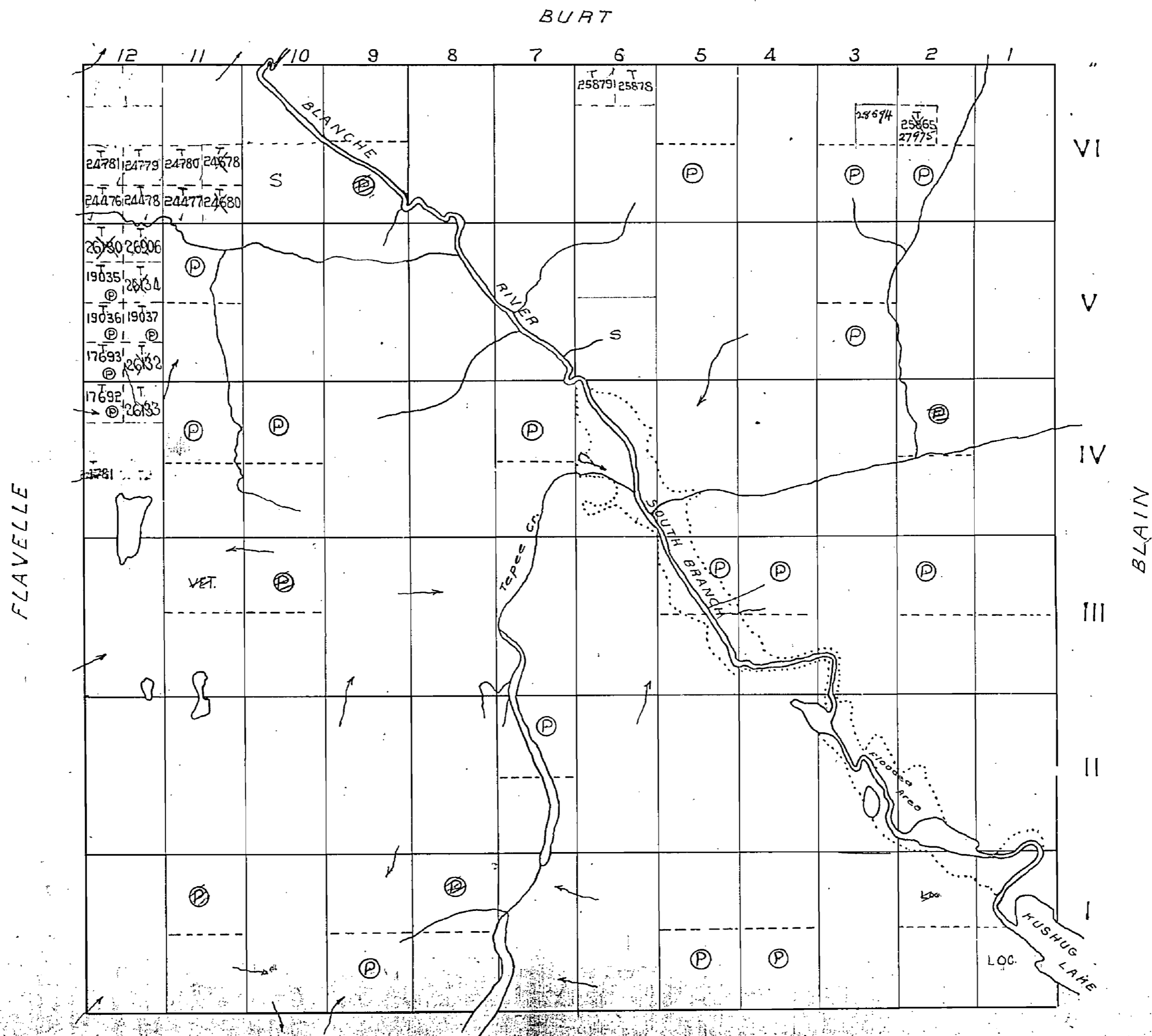

FLAVELLE

BLAIN

DAVIDSON

New Sheet 26 Aug 48



T. 28 Gross

Burt Twp.

Flavelle Twp.

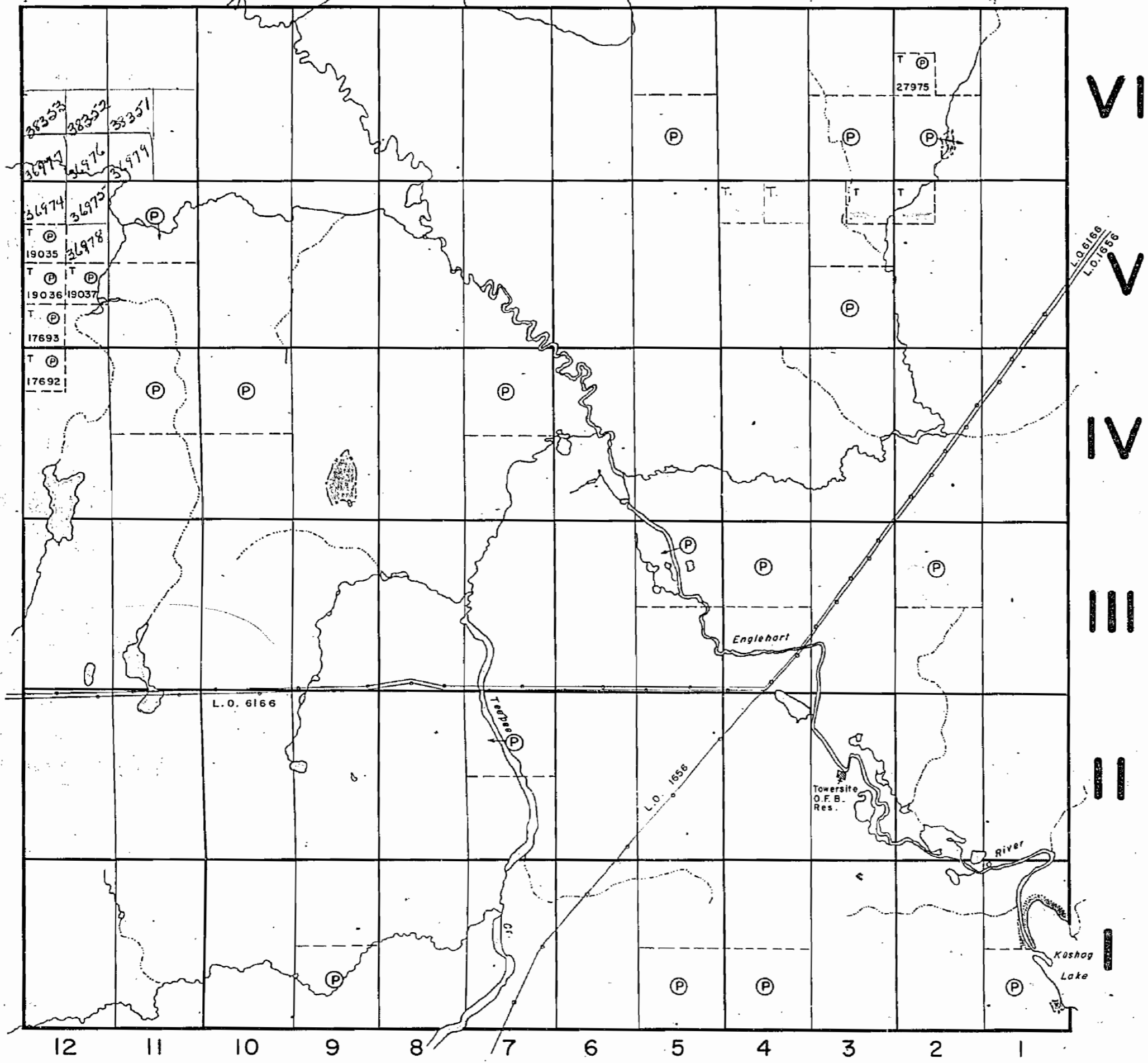

Davidson Twp.

THE TOWNSHIP OF

GROSS

DISTRICT OF
TIMISKAMING

MONTREAL RIVER
MINING DIVISION

SCALE: 1-INCH=40 CHAINS

LEGEND

PATENTED LAND	Ⓟ
CROWN LAND SALE	C.S.
LEASES	Ⓛ
LOCATED LAND	Loc.
LICENSE OF OCCUPATION	L.O.
MINING RIGHTS ONLY	M.R.O.
SURFACE RIGHTS ONLY	S.R.O.
ROADS	—
IMPROVED ROADS	—
KING'S HIGHWAYS	—
RAILWAYS	—
POWER LINES	—
MARSH OR MUSKEG	—
MINES	Ⓧ
CANCELLED	C.

NOTES

400' Reserved To Department Of Land & Forest Shown Thus:

PLAN NO.- M.487

DEPARTMENT OF MINES

— ONTARIO —

Burt Twp.

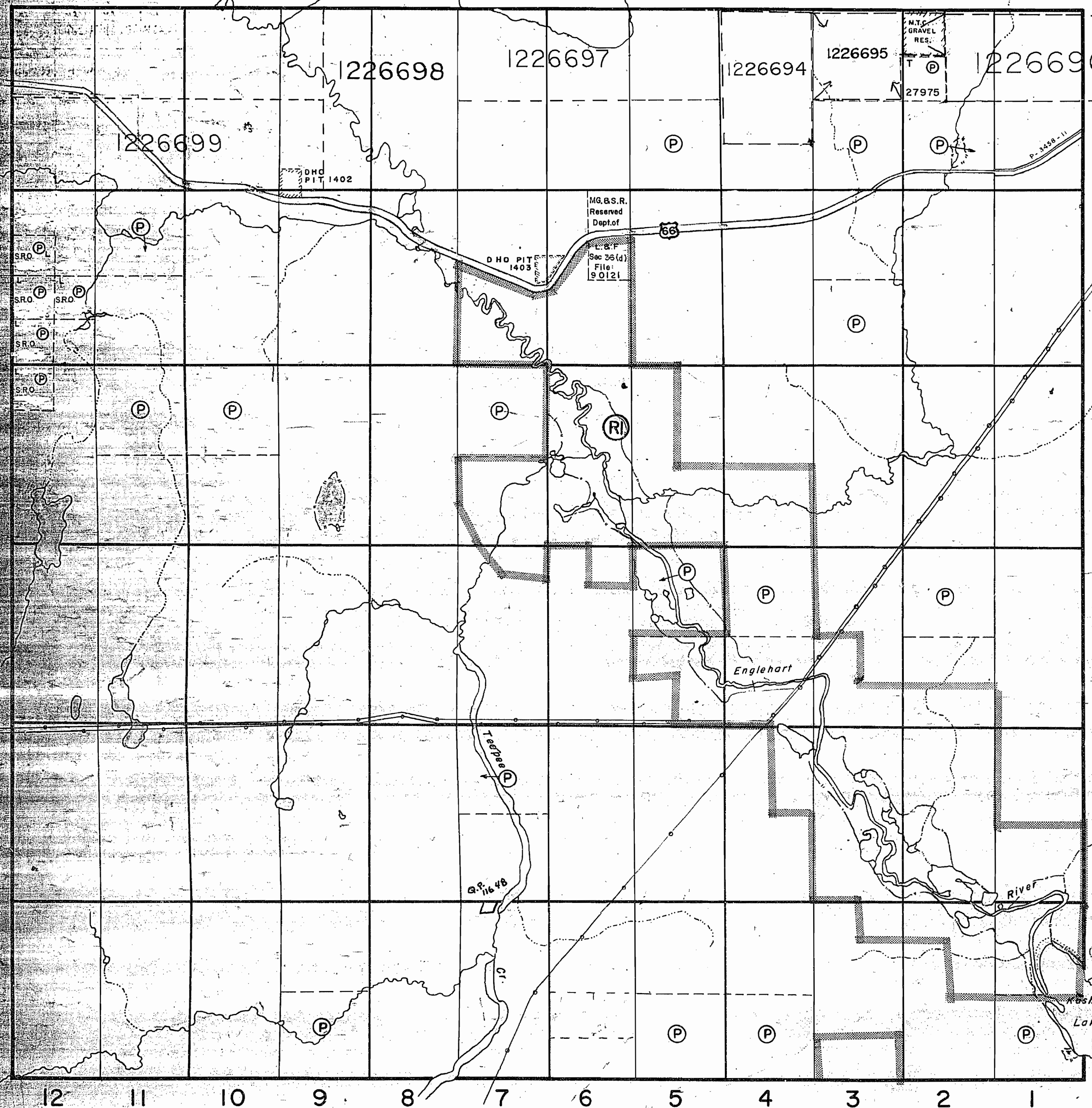

THE TOWNSHIP OF

GROSS

DISTRICT OF
TIMISKAMING

LARDER LAKE
MINING DIVISION

SCALE: 1-INCH=40 CHAINS

LEGEND

PATENTED LAND	Ⓟ
CROWN LAND SALE	C.S.
LEASES	L
LOCATED LAND	Loc.
LICENSE OF OCCUPATION	L.O.
MINING RIGHTS ONLY	M.R.O.
SURFACE RIGHTS ONLY	S.R.O.
ROADS	—
IMPROVED ROADS	—
KING'S HIGHWAYS	—
RAILWAYS	—
POWER LINES	—
MARSH OR MUSKEG	—
MINES	—
CANCELLED	—

NOTES

400' Surface rights reservation around all lakes and rivers.

Flooding Rights Reserved To Contour 38. File 1788 Vol. 2

Areas withdrawn from staking under Section 13 of the Mining Act (R.S.O. 1970).

Order No.	File	Date	Disposition
(R) W-L-58/95NER		AUGUST 2/95	M.S.

NOTICE OF FORESTRY ACTIVITY

THIS TOWNSHIP / AREA FALLS WITHIN THE PLONSKI FOREST MANAGEMENT UNIT AND MAY BE SUBJECT TO FORESTRY OPERATIONS. THE MNR UNIT FORESTER FOR THIS AREA CAN BE CONTACTED AT: P.O. BOX 129 SWASTIKA, ONT. L0K 1T0 705-642-3222

THE INFORMATION THAT APPEARS ON THIS MAP HAS BEEN COMPILED FROM VARIOUS SOURCES, AND ACCURACY IS NOT GUARANTEED. THOSE WISHING TO STAKE MINING CLAIMS SHOULD CONSULT WITH THE MINING RECORDER, MINISTRY OF NORTHERN DEVELOPMENT AND MINES, FOR ADDITIONAL INFORMATION ON THE STATUS OF THE LANDS SHOWN HEREON.

Davidson Twp.

Blain Twp.

ARCHIVED AUGUST 03, 1995

PLAN NO. - M 487

ONTARIO
MINISTRY OF NATURAL RESOURCES
SURVEYS AND MAPPING BRANCH