

2169

PLAN OF HALVORSEN LAKE AREA

RED LAKE MINING DIVISION, M. 2169
DISTRICT OF KENORA.

Scale: 40 chains to an inch.

GOLDPINES AREA.

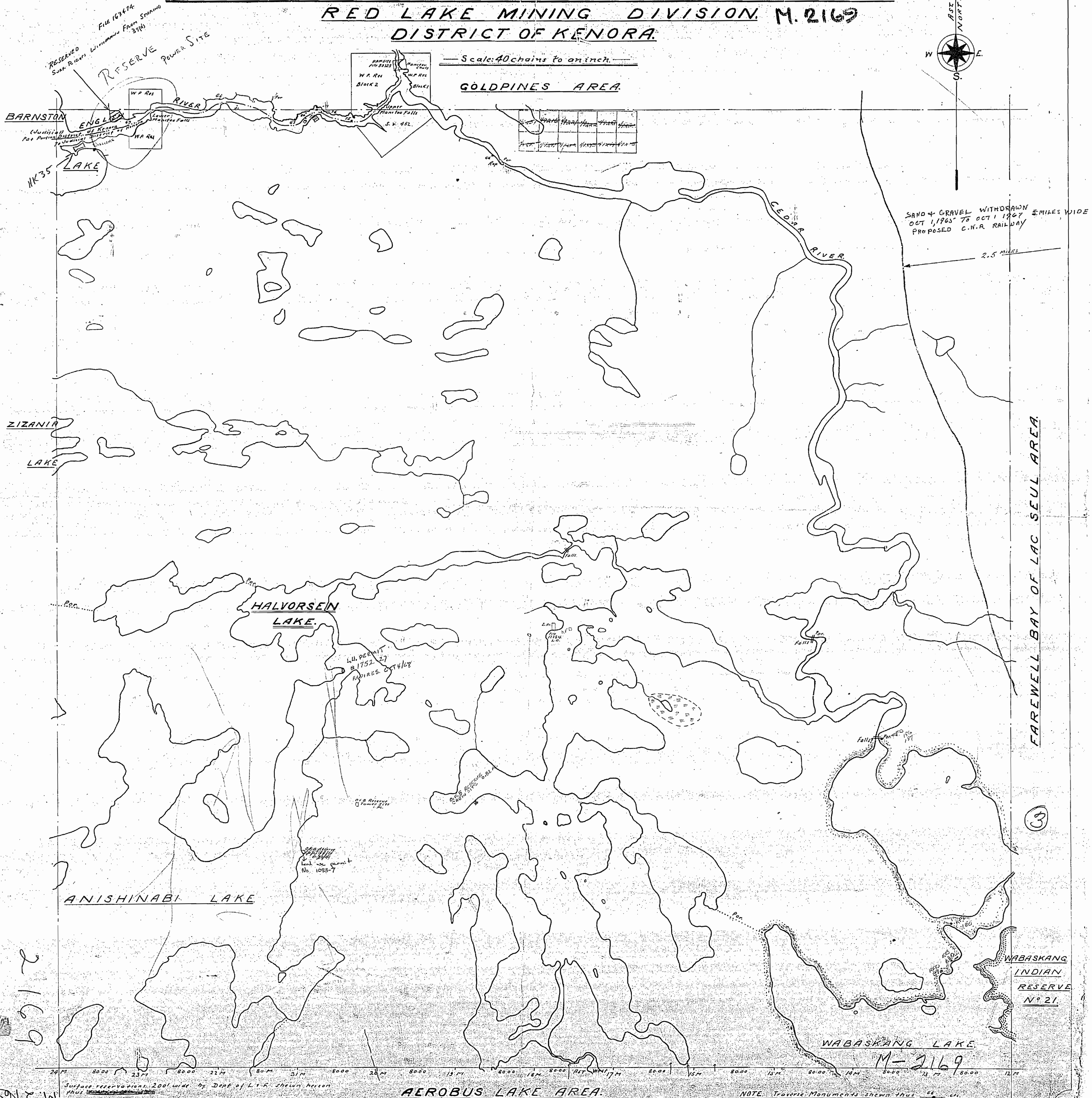
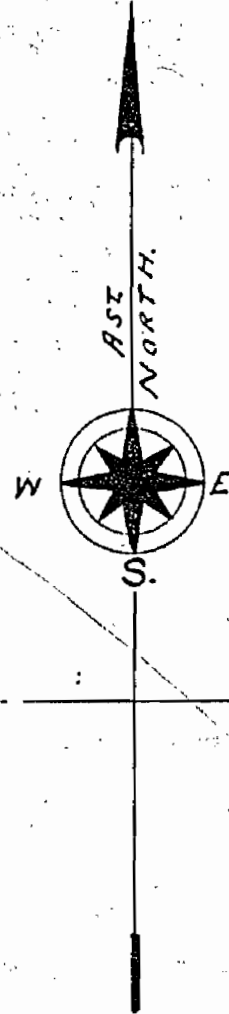

SAND & GRAVEL WITHDRAWN
OCT 1, 1965 TO OCT 1, 1967
PROPOSED C.N.R. RAILWAY

2.5 MILES

FAREWELL BAY OF LAC SEUL AREA.

(3)

WABASKANG INDIAN RESERVE N° 21.

WABASKANG LAKE

M-2169

AEROBUS LAKE AREA.

NOTE: Traverse Monuments shown thus - 66 - etc.

Surface reservation, 200' wide, by Dept. of L.V.K. Shelton Nelson
plus 100' wide on each side

2169

M. 2169

M. 2169