

LEGEND

HIGHWAY AND ROUTE No.	
OTHER ROADS	
TRAILS	
SURVEYED LINES	
TOWNSHIPS, BASE LINES, ETC.	
LOTS, MINING CLAIMS, PARCELS, ETC.	
UNSURVEYED LINES	
LOT LINES	
PARCEL BOUNDARY	
MINING CLAIMS ETC.	
RAILWAY AND RIGHT OF WAY	
UTILITY LINES	
NON PERENNIAL STREAM	
FLOODING OR FLOODING RIGHTS	
SUBDIVISION OR COMPOSITE PLAN	
RESERVATIONS	
ORIGINAL SHORELINE	
MARSH OR MUSKEG	
MINES	
TRAVERSE MONUMENT	

DISPOSITION OF CROWN LANDS

TYPE OF DOCUMENT	SYMBOL
PATENT, SURFACE & MINING RIGHTS	
SURFACE RIGHTS ONLY	
MINING RIGHTS ONLY	
LEASE SURFACE & MINING RIGHTS	
SURFACE RIGHTS ONLY	
MINING RIGHTS ONLY	
LICENCE OF OCCUPATION	
ORDER-IN-COUNCIL	
RESERVATION	
CANCELLED	
SAND & GRAVEL	

NOTE: MINING RIGHTS IN PARCELS PATENTED PRIOR TO MAY 6 1913, VESTED IN ORIGINAL PATENTEES BY THE PUBLIC LANDS ACT R.S.O. 1970, CHAP. 380, SEC. 43 SUBSEC. 1

NOTES

400' surface rights reservation along the shores of all lakes and rivers.

Area withdrawn from staking under Section 43 of the Mining Act, (R.S.O. 1970)
Order No. File Date Disposition
62/78 10399 2/10/76 Surface and Mining Rights

Pzw 10/84 *Re-opened N.R.O. 4/85*
MAP REPLACED AUGUST 18, 1992 BY D.C.

THE INFORMATION THAT APPEARS ON THIS MAP HAS BEEN COMPILED FROM VARIOUS SOURCES, AND ACCURACY IS NOT GUARANTEED. THOSE WISHING TO STAKE MINING CLAIMS SHOULD CONSULT WITH THE MINING RECORDER, MINISTRY OF NORTHERN DEVELOPMENT AND MINES, FOR ADDITIONAL INFORMATION ON THE STATUS OF THE LANDS SHOWN HEREON.

SCALE: 1 INCH = 40 CHAINS

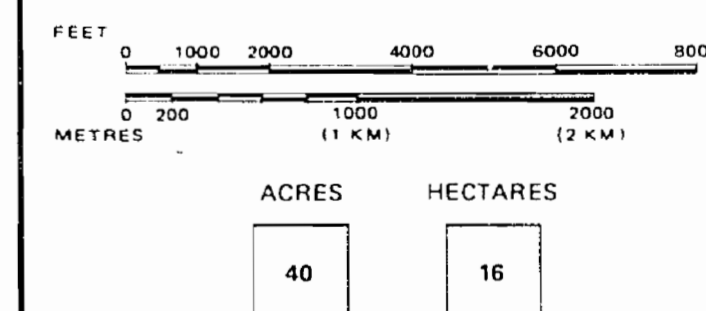

TOWNSHIP OF
HAMBLY
DISTRICT
COCHRANE
MINING DIVISION
PORCUPINE
Rec'd Jan. 8/82

Ministry of Natural Resources
Ontario
Surveys and Mapping Branch

Date FEB / 1982
National Topographic Series
Plan No.
M-912

S1E-M

HAMBLY TWP

S1E-M

S1E-M

HAMBLY TWP

S1E-M

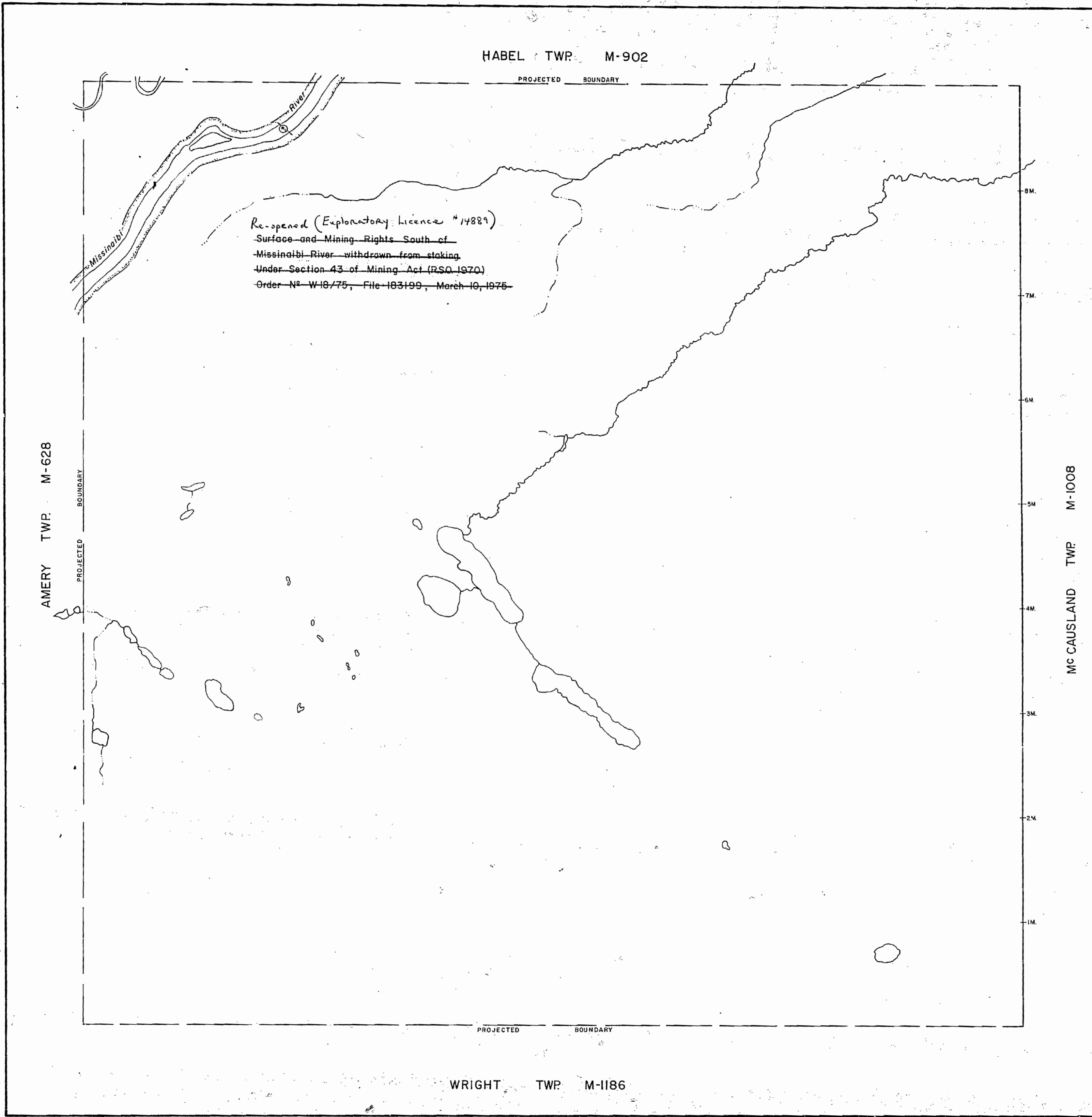

LEGEND

HIGHWAY AND ROUTE No.	
OTHER ROADS	
TRAILS	
SURVEYED LINES:	
TOWNSHIPS, BASE LINES, ETC.	
LOTS, MINING CLAIMS, PARCELS, ETC.	
UNSURVEYED LINES:	
LOT LINES	
PARCEL BOUNDARY	
MINING CLAIMS ETC.	
RAILWAY AND RIGHT OF WAY	
UTILITY LINES	
NON-PERENNIAL STREAM	
FLOODING OR FLOODING RIGHTS	
SUBDIVISION OR COMPOSITE PLAN	
RESERVATIONS	
ORIGINAL SHORELINE	
MARSH OR MUSKEG	
MINES	
TRAVERSE MONUMENT	

DISPOSITION OF CROWN LANDS

TYPE OF DOCUMENT	SYMBOL
PATENT, SURFACE & MINING RIGHTS	
" SURFACE RIGHTS ONLY	
" MINING RIGHTS ONLY	
LEASE SURFACE & MINING RIGHTS	
" SURFACE RIGHTS ONLY	
" MINING RIGHTS ONLY	
LICENCE OF OCCUPATION	
ORDER-IN-COUNCIL	
RESERVATION	
CANCELLED	
SAND & GRAVEL	

NOTE: MINING RIGHTS IN PARCELS PATENTED PRIOR TO MAY 6, 1913, VESTED IN ORIGINAL PATENTEE BY THE PUBLIC LANDS ACT, R.S.O. 1970, CHAP. 380, SEC. 63, SUBSEC. 1.

NOTES-
 400' surface rights reservation along the shores of all lakes and rivers.

Area withdrawn from staking under Section 43 of the Mining Act, (R.S.O. 1970)

Order N°	File	Date	Disposition
W62/75	183199	2/10/76	Surface and Mining Rights

01 JAN 1984

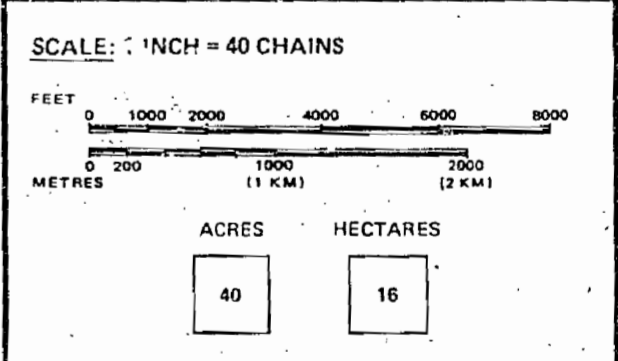

TOWNSHIP OF
HAMBLY

DISTRICT
 COCHRANE

MINING DIVISION
 PORCUPINE

Revised May 8/80

Ministry of Natural Resources Ontario

Surveys and Mapping Branch

Date FEB /80 Plan No. **M-912**

National Topographic Series

184

HAMBLY TWP
YJMBFG

AMERY TWP
PROJECTED BOUNDARY

HABEL TWP
PROJECTED BOUNDARY

WRIGHT TWP
PROJECTED BOUNDARY

MC CAUSLAND TWP
PROJECTED BOUNDARY

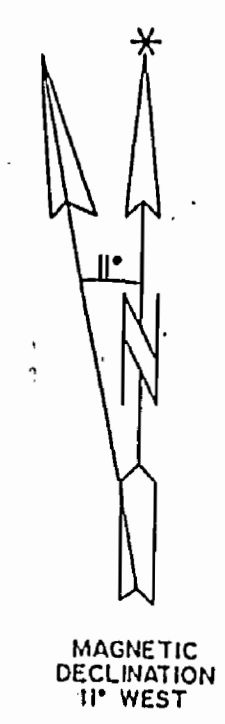
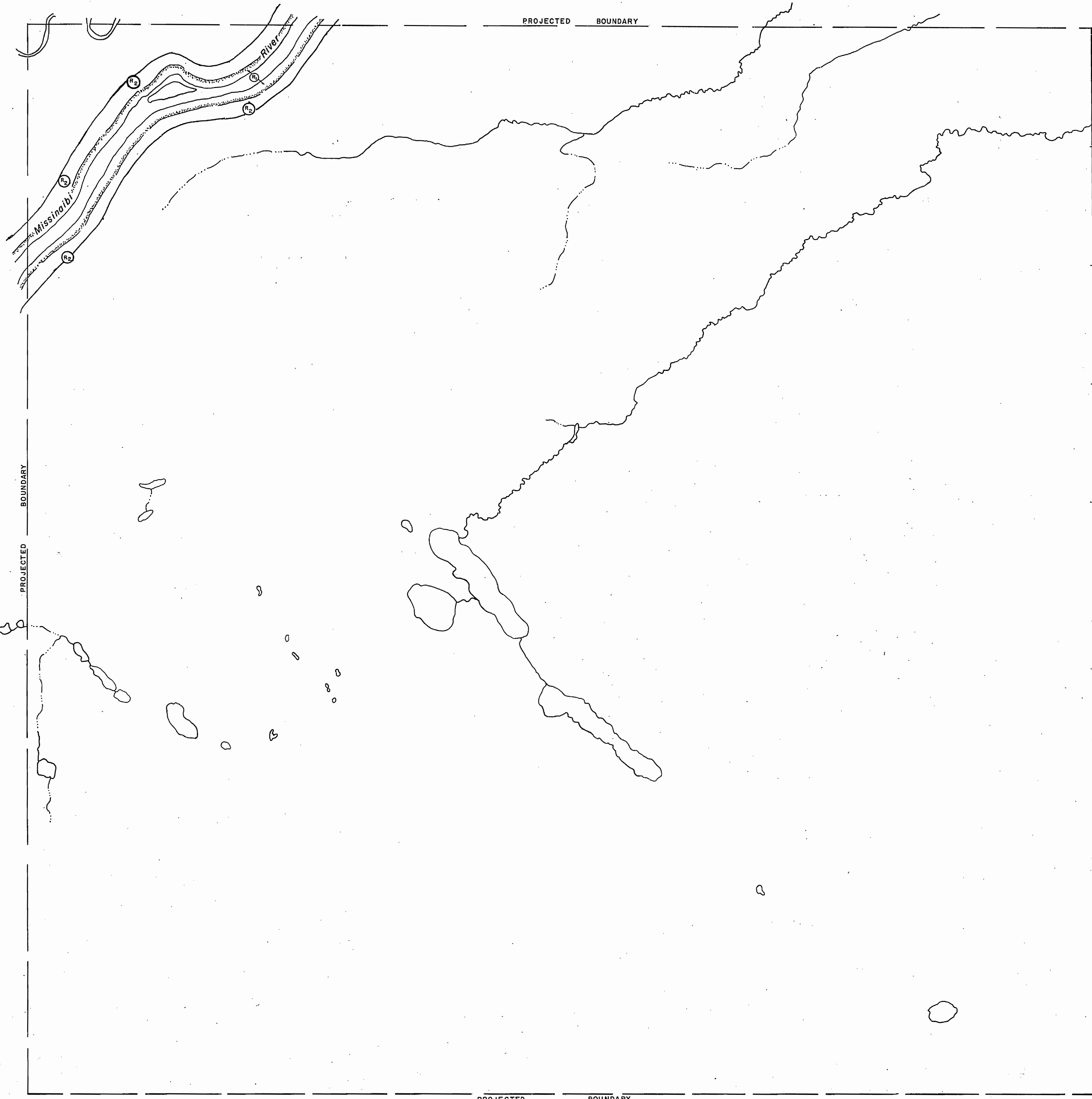

LEGEND

- HIGHWAY AND ROUTE No.
- OTHER ROADS
- TRAILS
- SURVEYED LINES:
 - TOWNSHIPS, BASE LINES, ETC.
 - LOTS, MINING CLAIMS, PARCELS, ETC.
- UNSURVEYED LINES:
 - LOT LINES
 - PARCEL BOUNDARY
 - MINING CLAIMS ETC.
- RAILWAY AND RIGHT OF WAY
- UTILITY LINES
- NON-PERENNIAL STREAM
- FLOODING OR FLOODING RIGHTS
- SUBDIVISION OR COMPOSITE PLAN
- RESERVATIONS
- ORIGINAL SHORELINE
- MARSH OR MUSKEG
- MINES
- TRAVERSE MONUMENT

DISPOSITION OF CROWN LANDS

TYPE OF DOCUMENT	SYMBOL
PATENT, SURFACE & MINING RIGHTS	●
" SURFACE RIGHTS ONLY	○
" MINING RIGHTS ONLY	○
LEASE, SURFACE & MINING RIGHTS	■
" SURFACE RIGHTS ONLY	■
" MINING RIGHTS ONLY	■
LICENCE OF OCCUPATION	▼
ORDER-IN-COUNCIL	OC
RESERVATION	⊙
CANCELLED	⊙
SAND & GRAVEL	⊙

NOTE: MINING RIGHTS IN PARCELS PATENTED PRIOR TO MAY 6, 1915, VESTED IN ORIGINAL PATENTEE BY THE PUBLIC LANDS ACT, R.S.O. 1970, CHAP. 300, SEC. 63, SUBSEC. 1.

NOTES

400' surface rights reservation along the shores of all lakes and rivers.

Area withdrawn from staking under Section 43 of the Mining Act, (R.S.O. 1970)

Order No.	File	Date	Disposition
W62/76	183199	2/10/76	Surface and Mining Rights

PROPOSED MISSINAIBI PARK BOUNDARY EXPANSION
NOTICE RECEIVED JULY 4, 1991
MISSINAIBI PROVINCIAL PARK

SCALE: 1 INCH = 40 CHAINS

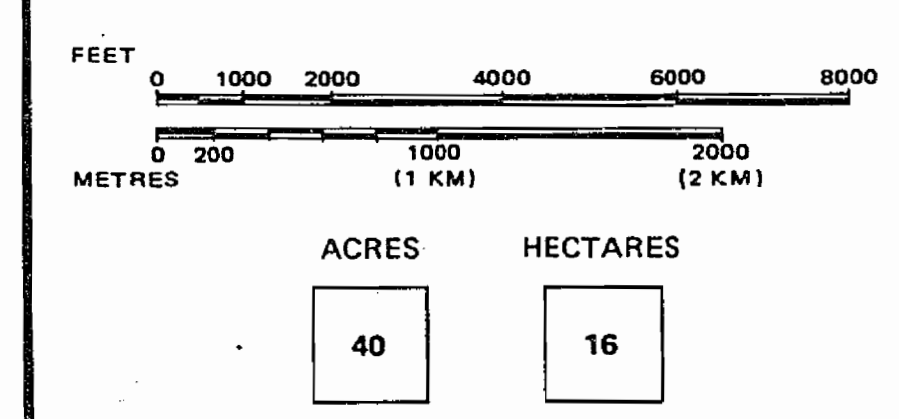

TOWNSHIP
HAMBLY
M.N.R. ADMINISTRATIVE DISTRICT
HEARST
MINING DIVISION
PORCUPINE
LAND TITLES / REGISTRY DIVISION
COCHRANE

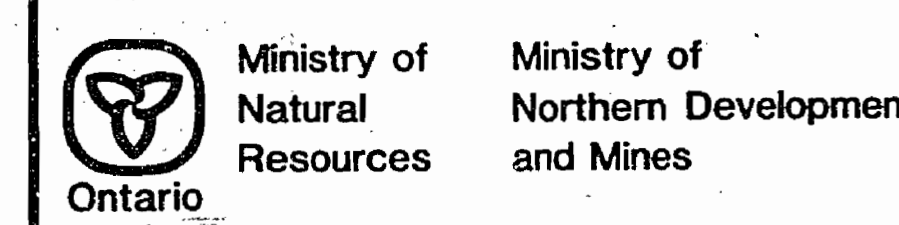

Date MAY, 1992
ACTIVATED AUGUST 16, 1992 BY O.C.
Number
G-886

THE INFORMATION THAT APPEARS ON THIS MAP HAS BEEN COMPILED FROM VARIOUS SOURCES AND ACCURACY IS NOT GUARANTEED. THOSE WISHING TO STAKE MINING CLAIMS SHOULD CONSULT WITH THE MINING RECORDER, MINISTRY OF NORTHERN DEVELOPMENT AND MINES, FOR ADDITIONAL INFORMATION ON THE STATUS OF THE LANDS SHOWN HEREON.

REGISTERED PROFESSIONAL SURVEYOR

REGISTERED PROFESSIONAL SURVEYOR

REGISTERED PROFESSIONAL SURVEYOR

REGISTERED PROFESSIONAL SURVEYOR

REEMLIN SHAWARD

Hambly Township
M-912

Se. DATE
 (43) Mar. 10/75 Sr. & Mr. W. H. & F. T. P. of Missinabi R. with terms from staking
 (43) S.R. & M.R. Withdrawn Oct. 21/76.
 (Missinabi R.)

**TOWNSHIP OF
 HAMBLY
 DISTRICT of COCHRANE**

Cancelled Dec. 12/73
 Under Section 42 of the Mining Act, and by Order of The Minister of Mines, dated November 25, 1964, all deposits of clays, silica sand, gypsum, marl and iron in that part of this township, outlined in red, are withdrawn from prospecting, staking out, sale or lease. **ALL TOWNSHIP WITHDRAWN FROM STAKING MAR 10/73 Repealed July 30/73**

M-912

PORCUPINE MINING DIVISION

Scale, 40 chains to an inch.

HABEL TWP.

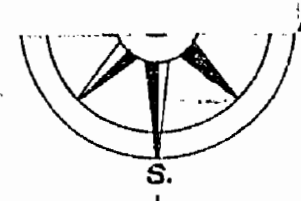

Received June 25, 1956

MAHONY TWP.

Cancelled Dec. 12/73
 EXHODE - KAKIK
 FIRE CLAY
 BALL CLAY
 SILICA SAND
 R/S from 1/1/54
 Head the Permit 66' wide - 35 miles NW
 430
 43
 45
 46
 47
 48
 49
 50
 51
 52
 53
 54
 55
 56
 57
 58
 59
 60
 61
 62
 63
 64
 65
 66
 67
 68
 69
 70
 71
 72
 73
 74
 75
 76
 77
 78
 79
 80
 81
 82
 83
 84
 85
 86
 87
 88
 89
 90
 91
 92
 93
 94
 95
 96
 97
 98
 99
 100

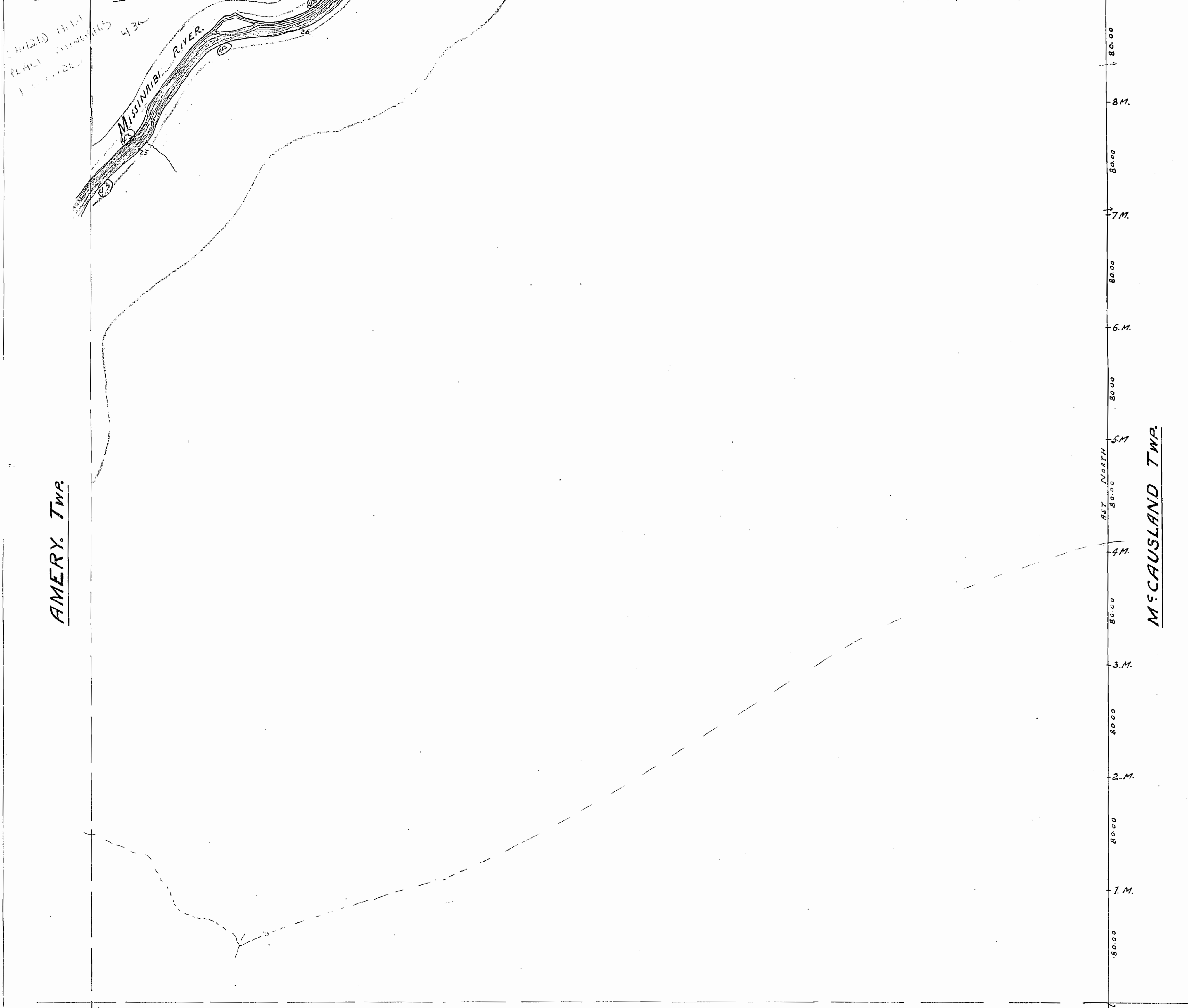

**GARDEN
 TWP.**

WRIGHT TWP.

**ACRES
 TWP.**

East Boundary surveyed by H.W. Sutcliffe O.L.S. 1925.
 Missinabi River surveyed by C.R. Kenny O.L.S. 1922.
 Traverse monuments shown thus 
 Parcels marked "P" are patented
 "L" leased.
 "L.O." License of Occupation.

Surveys Branch,
 Dept. of Lands & Forests,
 Ontario Provincial Government,
 Toronto, Ontario - May 1939.