

AREA OF
HANSON LAKE

DISTRICT OF
THUNDER BAY

PORT ARTHUR
MINING DIVISION

SCALE: 1-INCH = 40 CHAINS

LEGEND

- PATENTED LAND
- CROWN LAND SALE
- LEASES
- LOCATED LAND
- LICENSE OF OCCUPATION
- MINING RIGHTS ONLY
- SURFACE RIGHTS ONLY
- ROADS
- IMPROVED ROADS
- KING'S HIGHWAYS
- RAILWAYS
- POWER LINES
- MARSH OR MUSKEG
- MINES
- CANCELLED

NOTES

400' Reserve around all lakes and rivers to Dept. of Lands & Rivers.

Eddy of Dept. of Hwys. Parksite shown thus: L.O. 4881 within the Limits of above Park Site is to become part of the above Park upon cancellation of said L.O. File: 36367.

Area North & West of Line Shown Thus: Lies Within The NIPIGON PROVINCIAL FOREST.

SURFACE RIGHTS ONLY reserved on land indicated thus: to the Anaconda Iron Ore (Ont) Ltd. File 165414

1965

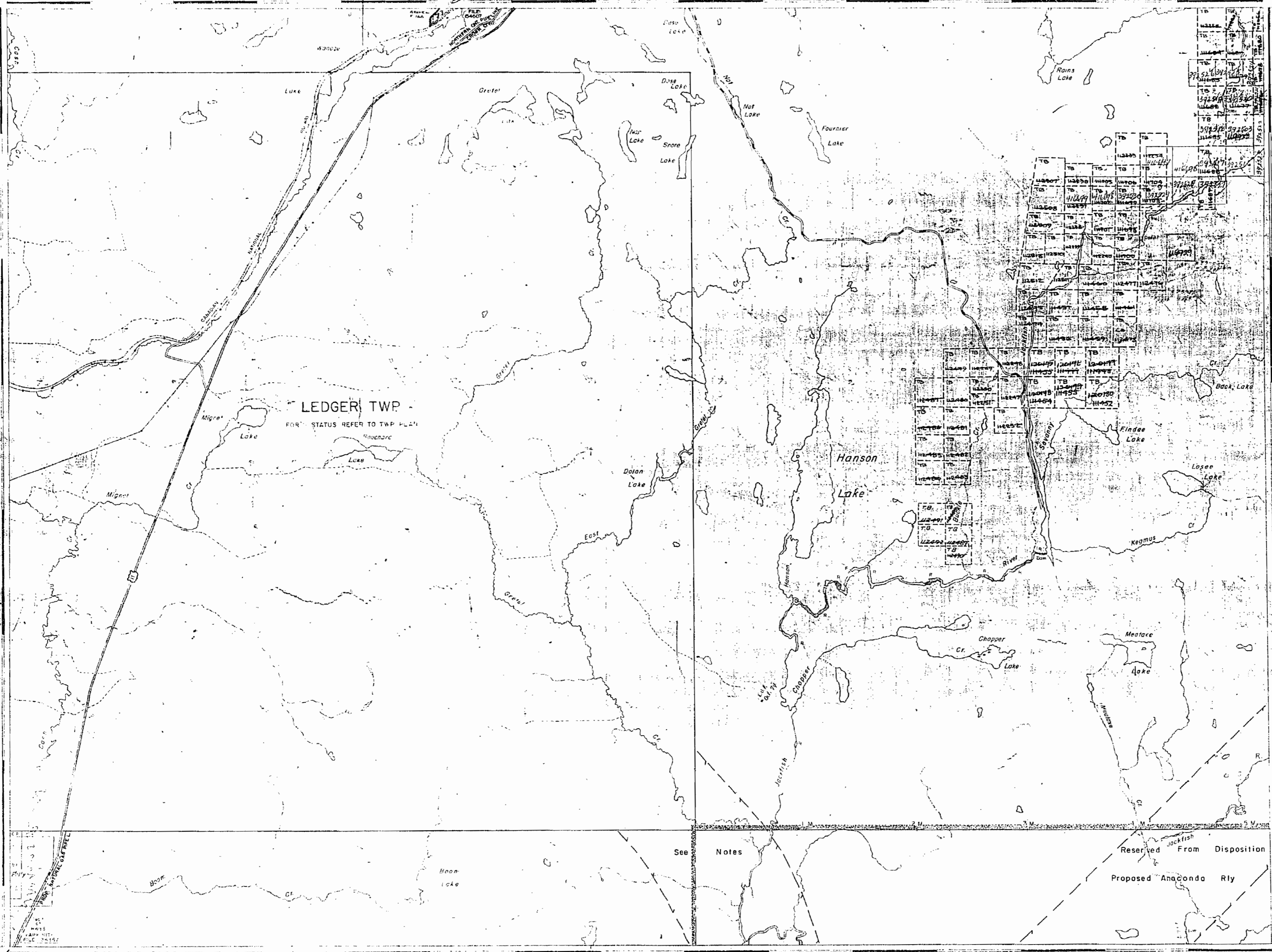

See Notes

Reserved From Disposition
Proposed Anaconda Rly

PLAN NO. **M. 2565**

DEPARTMENT OF MINES
- ONTARIO

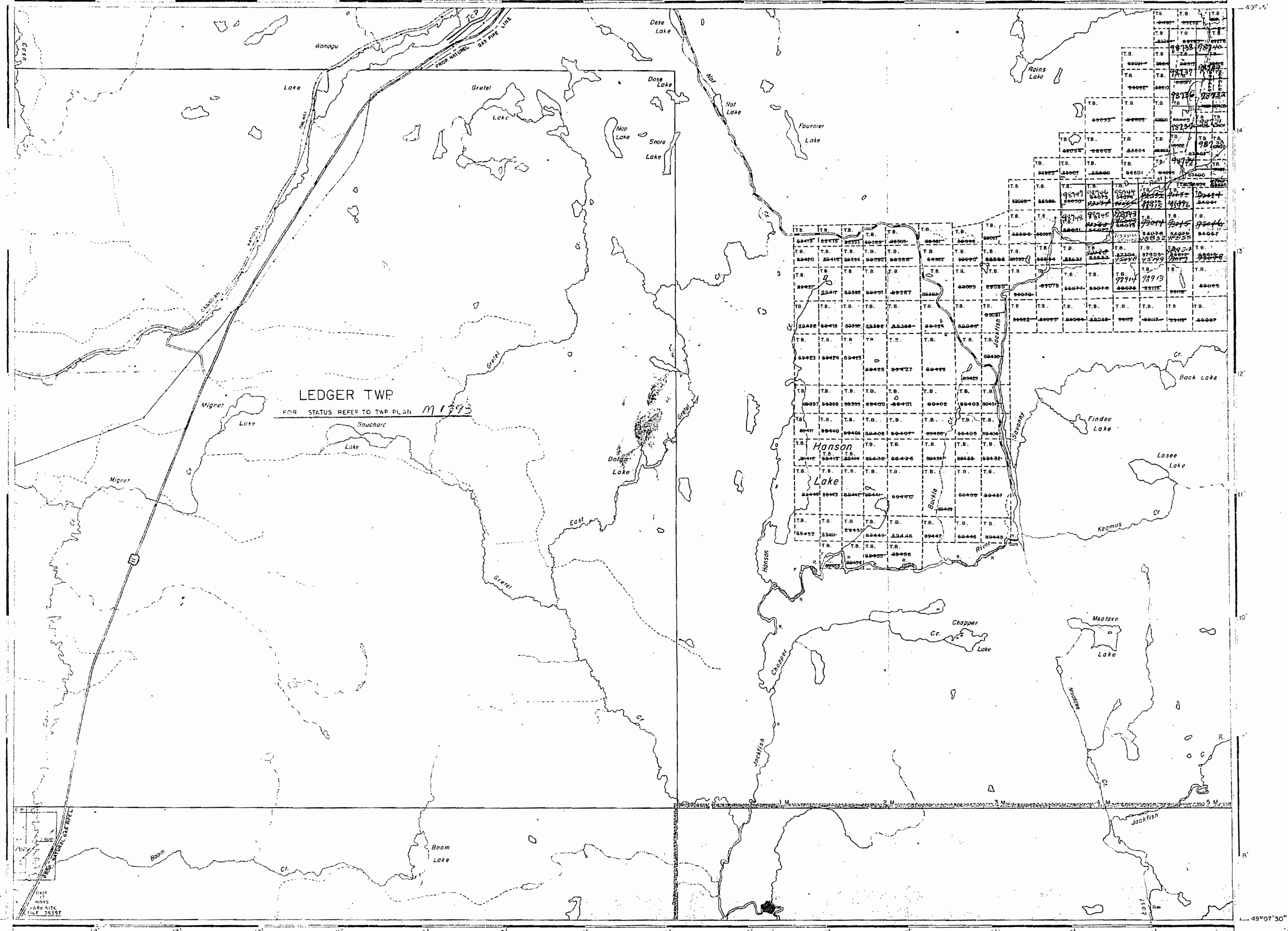

AREA OF
HANSON LAKE
N.P. 70
 DISTRICT OF
 THUNDER BAY

PORT ARTHUR
 MINING DIVISION
 SCALE: 1-INCH = 40 CHAINS

- LEGEND
- PATENTED LAND
 - CROWN LAND SALE
 - LEASES
 - LOCATED LAND
 - LICENSE OF OCCUPATION
 - MINING RIGHTS ONLY
 - SURFACE RIGHTS ONLY
 - ROADS
 - IMPROVED ROADS
 - KING'S HIGHWAYS
 - RAILWAYS
 - POWER LINES
 - MARSH OR MUSKEG
 - MINES
 - CANCELLED

NOTES

400' Reserve around all lakes and rivers to Dept of Lands & Rivers.

Body of Dept of Hwys Parksite shown thus L.O. 4881 within the Limits of above Park Site is to become part of the above Park upon cancellation of said L.O. File 36367.

Area North & West Of Line Shown Thus: ~~4881~~ Lies Within The NIPIGON PROVINCIAL FOREST.

1958



PLAN NO. **M. 2565**

DEPARTMENT OF MINES
 ONTARIO

2565

Rains Lake

Doze L.

Not L.

Fournier Lake

Snore Lake

89091	89092	89093	89094	89095	89096	89097	89098	89099	89100
76087	76088	76089	76090	76091	76092	76093	76094	76095	76096
88605	88606	88607	88608	88609	88610	88611	88612	88613	88614
88615	88616	88617	88618	88619	88620	88621	88622	88623	88624
88625	88626	88627	88628	88629	88630	88631	88632	88633	88634
88635	88636	88637	88638	88639	88640	88641	88642	88643	88644
88645	88646	88647	88648	88649	88650	88651	88652	88653	88654
88655	88656	88657	88658	88659	88660	88661	88662	88663	88664
88665	88666	88667	88668	88669	88670	88671	88672	88673	88674
88675	88676	88677	88678	88679	88680	88681	88682	88683	88684
88685	88686	88687	88688	88689	88690	88691	88692	88693	88694
88695	88696	88697	88698	88699	88700	88701	88702	88703	88704
88705	88706	88707	88708	88709	88710	88711	88712	88713	88714
88715	88716	88717	88718	88719	88720	88721	88722	88723	88724
88725	88726	88727	88728	88729	88730	88731	88732	88733	88734
88735	88736	88737	88738	88739	88740	88741	88742	88743	88744
88745	88746	88747	88748	88749	88750	88751	88752	88753	88754
88755	88756	88757	88758	88759	88760	88761	88762	88763	88764
88765	88766	88767	88768	88769	88770	88771	88772	88773	88774
88775	88776	88777	88778	88779	88780	88781	88782	88783	88784
88785	88786	88787	88788	88789	88790	88791	88792	88793	88794
88795	88796	88797	88798	88799	88800	88801	88802	88803	88804
88805	88806	88807	88808	88809	88810	88811	88812	88813	88814
88815	88816	88817	88818	88819	88820	88821	88822	88823	88824
88825	88826	88827	88828	88829	88830	88831	88832	88833	88834
88835	88836	88837	88838	88839	88840	88841	88842	88843	88844
88845	88846	88847	88848	88849	88850	88851	88852	88853	88854
88855	88856	88857	88858	88859	88860	88861	88862	88863	88864
88865	88866	88867	88868	88869	88870	88871	88872	88873	88874
88875	88876	88877	88878	88879	88880	88881	88882	88883	88884
88885	88886	88887	88888	88889	88890	88891	88892	88893	88894
88895	88896	88897	88898	88899	88900	88901	88902	88903	88904
88905	88906	88907	88908	88909	88910	88911	88912	88913	88914
88915	88916	88917	88918	88919	88920	88921	88922	88923	88924
88925	88926	88927	88928	88929	88930	88931	88932	88933	88934
88935	88936	88937	88938	88939	88940	88941	88942	88943	88944
88945	88946	88947	88948	88949	88950	88951	88952	88953	88954
88955	88956	88957	88958	88959	88960	88961	88962	88963	88964
88965	88966	88967	88968	88969	88970	88971	88972	88973	88974
88975	88976	88977	88978	88979	88980	88981	88982	88983	88984
88985	88986	88987	88988	88989	88990	88991	88992	88993	88994
88995	88996	88997	88998	88999	89000	89001	89002	89003	89004

LEDGER TWP.

Greta Cr.

NO OPEN GROUND

Savanny

Cree Back

Findee L.

Losee Lake

Kegmus Creek

Hanson

Chopper Creek

Mealaxe L.

Mealaxe Creek

East

1.M. 2.M. 3.M. 4.M. 5.M.

400 Reserve to the Dept. of L. & S. shown thus: 110

REFERENCE

SURVEYS

Ledger Twp. Subdivided by T.B. Speight O.L.S. 1894 Field Note Bk. No. 1394
 Base Line Surveyed By Phillips & Denner, O.L.S. 1916. Field Note Book No. 2474.

RAILWAYS

Canadian National Railways (Surveyed as Canadian Northern Ontario Railroad) by R.M. Gourlay O.L.S. 1912, Ref. 59322 CLS. and E. Fitzgerald O.L.S. 1919, Ref. 67558 CLS. Plan in Dr. No. L2-12

ROADS

Kings Highway No. 11 from Dept. of Highways Plan No. P2544-16, P2544-19 and P2544-1
 200' W. By order in Council Dated Nov. 9th and Dec. 6th 1939.
 100 Ft. on each side of the centre line of the Highway is vested in the Dept. of Highways

RESERVATIONS

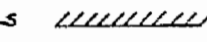
Bdry of Dept. of Hwys. Park Site File 36567
 Shown Thus 
 L.O. 4881 Within the Limits of above Park Site is to become part of the above Park upon cancellation of said L.O.

THE INFORMATION THAT APPEARS ON THIS MAP HAS BEEN COMPILED FROM VARIOUS SOURCES, AND ACCURACY IS NOT GUARANTEED. THOSE WISHING TO STAKE MINING CLAIMS SHOULD CONSULT WITH THE MINING RECORDER, MINISTRY OF NORTHERN DEVELOPMENT AND MINES, FOR ADDITIONAL INFORMATION ON THE STATUS OF THE LANDS SHOWN HEREON.



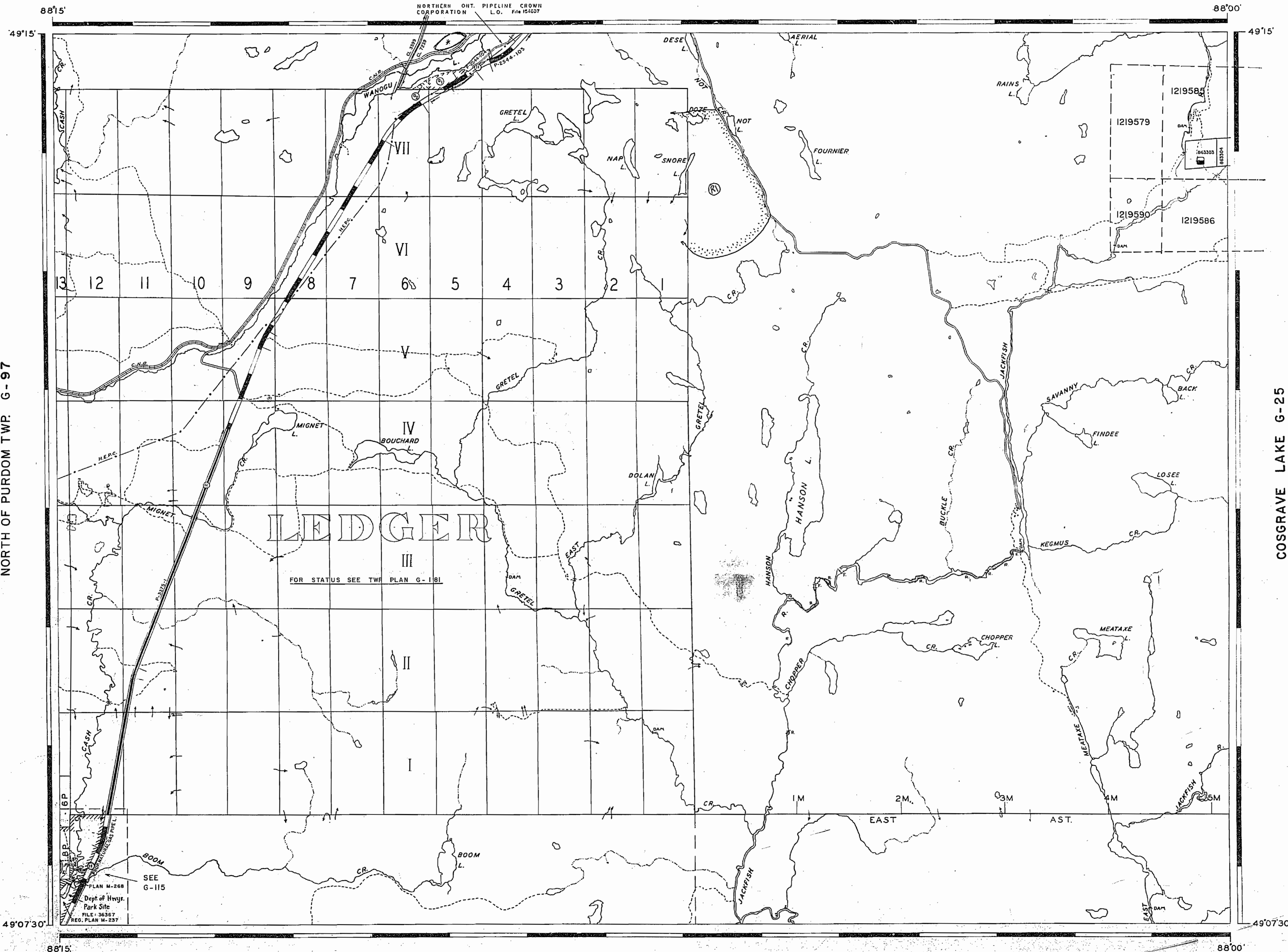







KEEMLE LAKE G-63

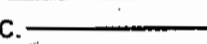

SAND AND GRAVEL

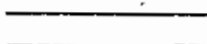
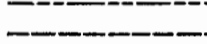
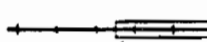
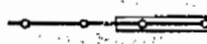
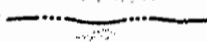
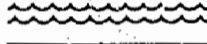
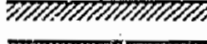
- Ⓜ M.T.C. RESERVE FILE 119801
- Ⓜ M.T.C. PIT 20-43 FILE 119801
- * CN QUARRY
- Ⓜ Mining Rights Withdrawn from Staking order W-18-09/96, NWR Proposed Conservation Reserve. Nov. 26/96

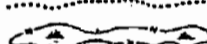
LEGEND

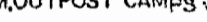
- HIGHWAY AND ROUTE No. 
- OTHER ROADS 
- TRAILS 
- SURVEYED LINES: TOWNSHIPS, BASE LINES, ETC. 
- LOTS, MINING CLAIMS, PARCELS, ETC. 
- UNSURVEYED LINES: LOT LINES 
- PARCEL BOUNDARY, MINING CLAIMS ETC. 
- RAILWAY AND RIGHT OF WAY 
- UTILITY LINES 
- NON-PERENNIAL STREAM 
- FLOODING OR FLOODING RIGHTS 
- SUBDIVISION OR COMPOSITE PLAN 
- RESERVATIONS 
- ORIGINAL SHORELINE 
- MARSH OR MUSKEG 
- MINES 
- TRAVERSE MONUMENT 
- LAND USE PERMITS FOR COMMERCIAL TOURISM/OUTPOST CAMPS 

DISPOSITION OF CROWN LANDS

TYPE OF DOCUMENT	SYMBOL
PATENT, SURFACE & MINING RIGHTS	●
" SURFACE RIGHTS ONLY	○
" MINING RIGHTS ONLY	⊙
LEASE, SURFACE & MINING RIGHTS	■
" SURFACE RIGHTS ONLY	□
" MINING RIGHTS ONLY	▣
LICENCE OF OCCUPATION	▼
ORDER-IN-COUNCIL	OC
RESERVATION	⊖
CANCELLED	⊕
SAND & GRAVEL	⊙

NOTE: MINING RIGHTS IN PARCELS PATENTED PRIOR TO MAY 6, 1913, VESTED IN ORIGINAL PATENTEES BY THE PUBLIC LANDS ACT, R.S.O. 1970, CHAP. 380, SEC. 62, SUBSEC. 1.
See status of pipeline upon Ledger

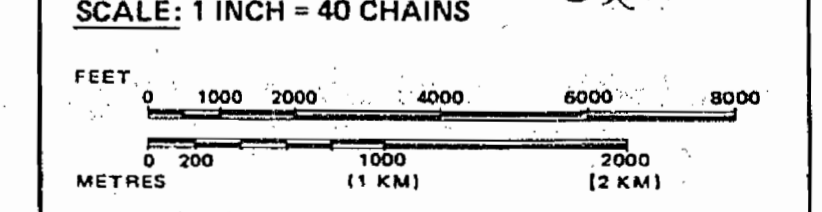

AREA
HANSON LAKE
 M.N.R. ADMINISTRATIVE DISTRICT
NIPIGON
 MINING DIVISION
THUNDER BAY
 LAND TITLES / REGISTRY DIVISION
THUNDER BAY

Ministry of Natural Resources Ontario
 Land Management Branch
 Date: FEBRUARY, 1981
 Number: Apr 3/81

G-47

MILLER LAKE G-86

COSGRAVE LAKE G-25

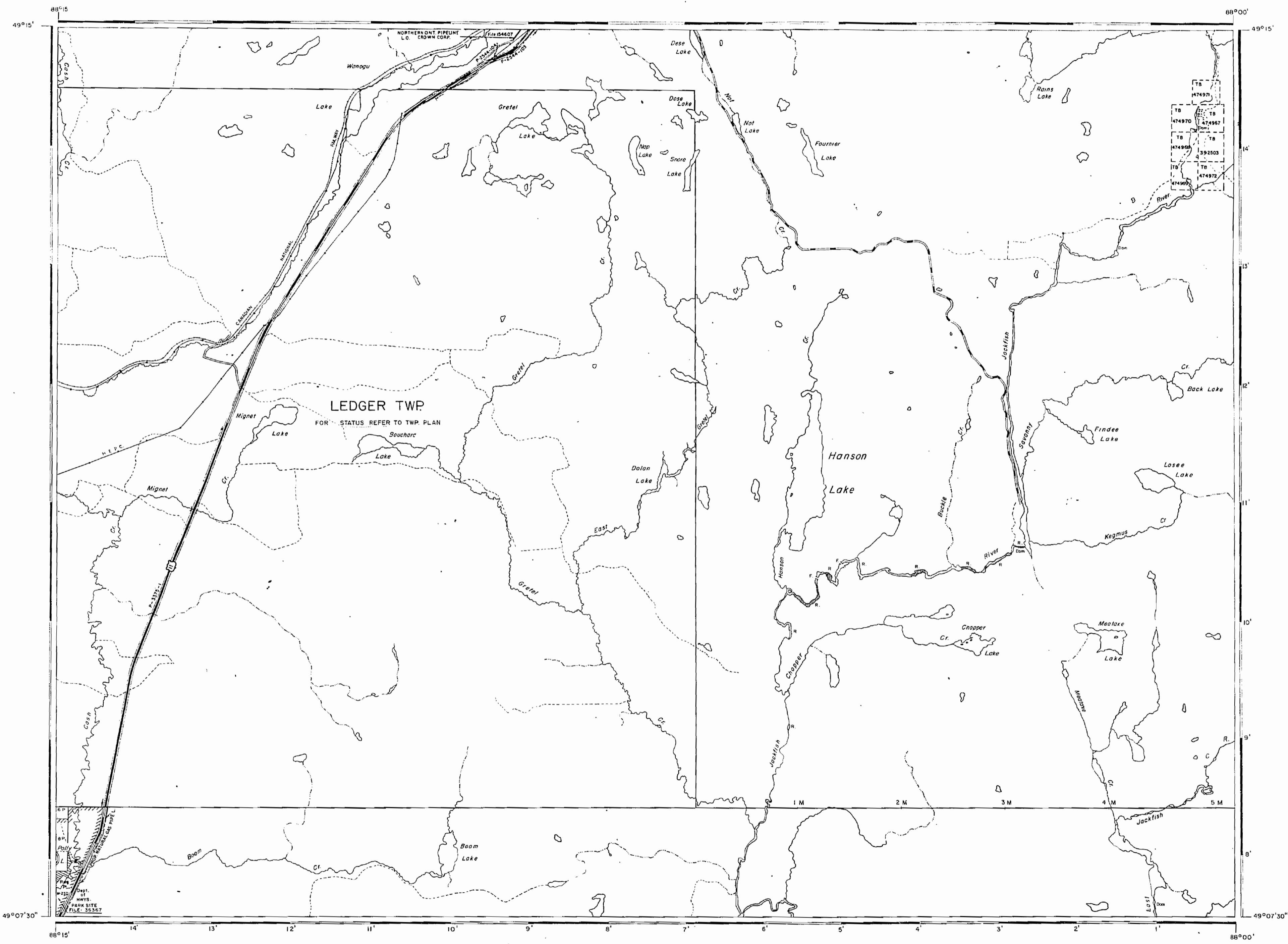

AREA OF
HANSON LAKE
 DISTRICT OF
 THUNDER BAY
 THUNDER BAY
 MINING DIVISION
 SCALE: 1-INCH 40 CHAINS

LEGEND

PATENTED LAND	(P)
CROWN LAND SALE	C.S.
LEASES	L.
LOCATED LAND	L.C.
LICENSE OF OCCUPATION	L.O.
MINING RIGHTS ONLY	M.R.O.
SURFACE RIGHTS ONLY	S.R.O.
ROADS	—
IMPROVED ROADS	—
KING'S HIGHWAYS	—
RAILWAYS	—
POWER LINES	—
MARSH OR MUSKEG	—
MINES	—
CANCELLED	—

NOTES

400' Reserve around all lakes and rivers to Dept. of Lands & Rivers.

Barry of Dept. of Hwys Parksite shown thus: LO 4881 within the Limits of above Park Site is to become part of the above Park upon cancellation of said L.O. File: 36367.

AREAS WITHDRAWN FROM STAKING

S.R. - SURFACE RIGHTS		M.R. - MINING RIGHTS	
Section	Order No.	Date	Disposition File

SAND and GRAVEL

⊙ GRAVEL F166

1977

NIDIGON DIST AUG 11/77

PLAN NO. **M. 2565**

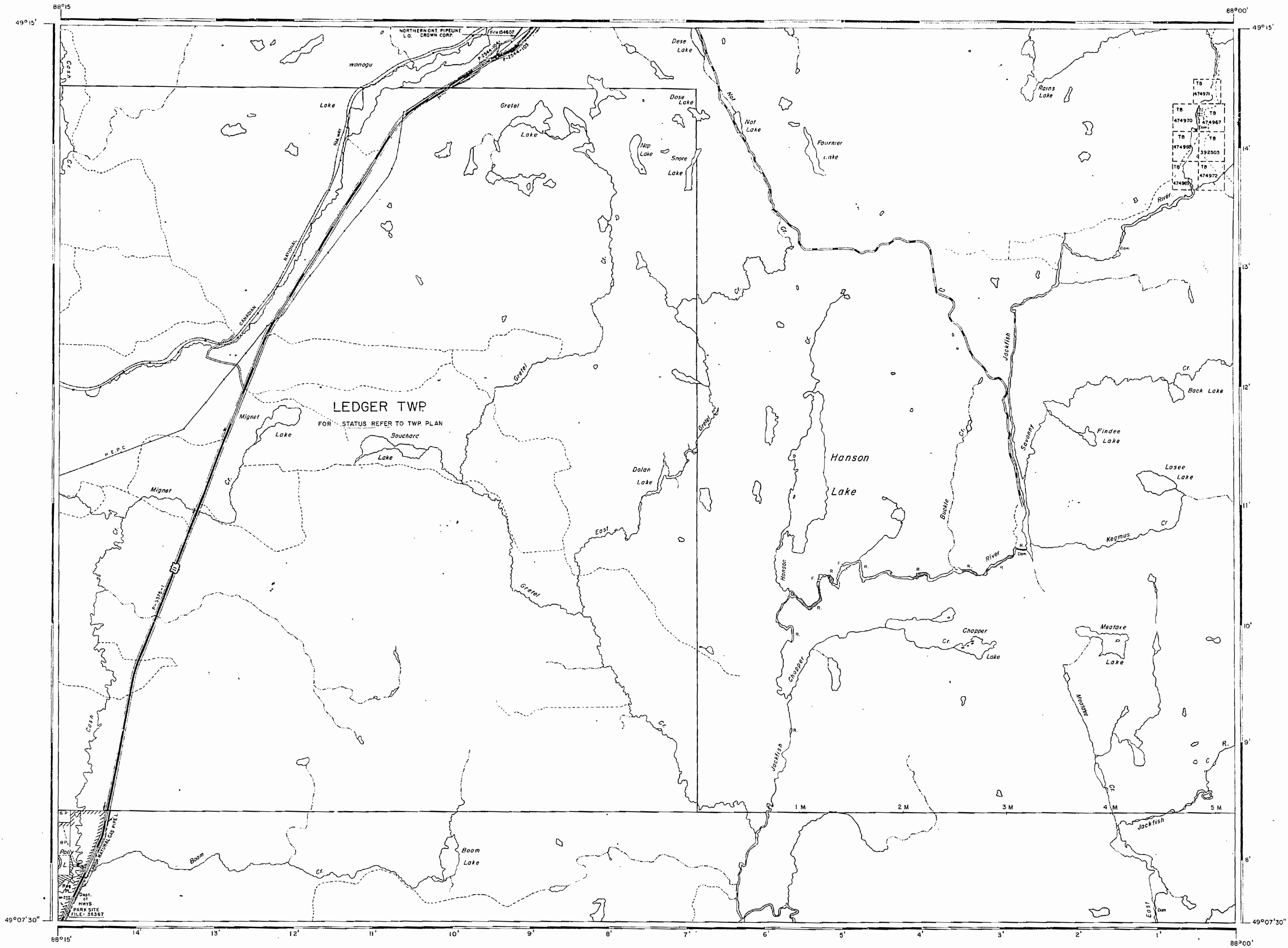

AREA OF
HANSON LAKE

DISTRICT OF
THUNDER BAY

THUNDER BAY
MINING DIVISION

SCALE: 1-INCH = 40 CHAINS

LEGEND

- PATENTED LAND (P)
- CROWN LAND SALE (C.S.)
- LEASES (L)
- LOCATED LAND (Lx)
- LICENSE OF OCCUPATION (L.O.)
- MINING RIGHTS ONLY (M.R.)
- SURFACE RIGHTS ONLY (S.R.)
- ROADS (— — — — —)
- IMPROVED ROADS (— — — — —)
- KING'S HIGHWAYS (— — — — —)
- RAILWAYS (— — — — —)
- POWER LINES (— — — — —)
- MARSH OR MUSKEG (— — — — —)
- MINES (X)
- CANCELLED (— — — — —)

NOTES

400' Reserve around all lakes and rivers to Dept. of Lands & Rivers.
Bdry. of Dept. of Hwys. Parksite shown thus: L.O.4881 within the Limits of above Park Site is to become part of the above Park upon cancellation of said L.O. File: 36367.

AREAS WITHDRAWN FROM STAKING

Section	Order No.	Date	Disposition	File

SAND and GRAVEL

GRAVEL F166

1977

NIPICOM DIST AUG 11/77
PLAN NO. **M.2565**

ONTARIO
MINISTRY OF NATURAL RESOURCES
SURVEYS AND MAPPING BRANCH

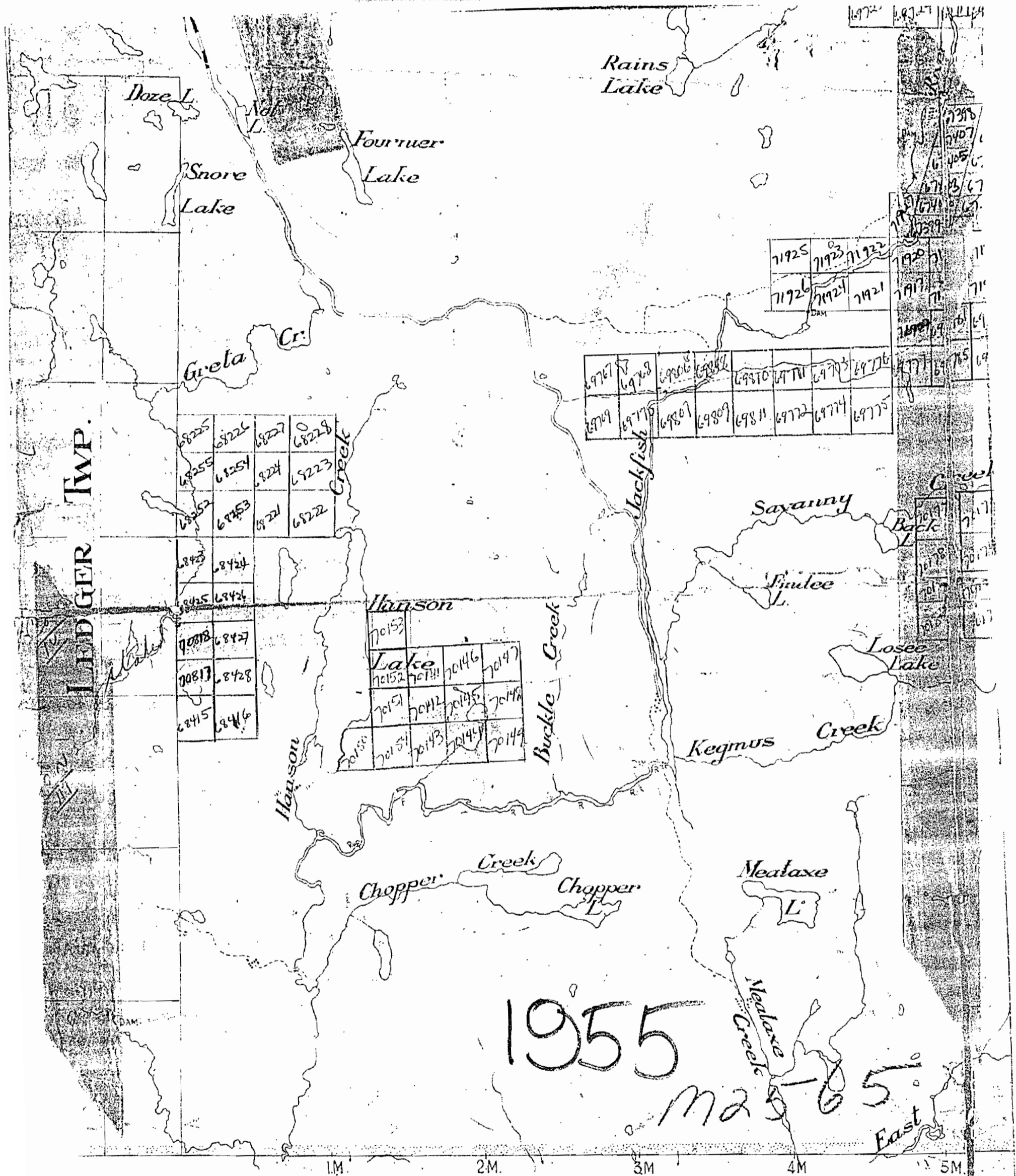

400 Reserve to the Dept. of L. & F. shown thus:

OFFICE M.A.

AREA OF

HANSON LAKE

No. P. 70
DISTRICT OF
THUNDER BAY

PORT ARTHUR
MINING DIVISION

SCALE: 1-INCH = 40 CHAINS

LEGEND

- PATENTED LAND
- CROWN LAND SALE
- LEASES
- LOCATED LAND
- LICENSE OF OCCUPATION
- MINING RIGHTS ONLY
- SURFACE RIGHTS ONLY
- ROADS
- IMPROVED ROADS
- KING'S HIGHWAYS
- RAILWAYS
- POWER LINES
- MARSH OR MUSKEG
- MINES
- CANCELLED

NOTES

400' Reserve around all lakes and rivers to Dept of Lands & Rivers.

Body of Dept of Hwys. Parksite shown thus LO 4881 within the Limits of above Park Site is to become part of the above Park upon cancellation of said L.O. File 36367.

Area North & West Of Line Shown Thus: Lies Within The NIPIGON PROVINCIAL FOREST.

1958

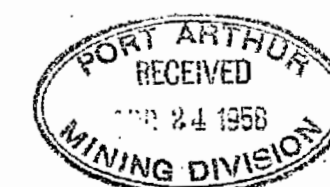

PLAN NO. **M. 2565**

DEPARTMENT OF MINES
ONTARIO

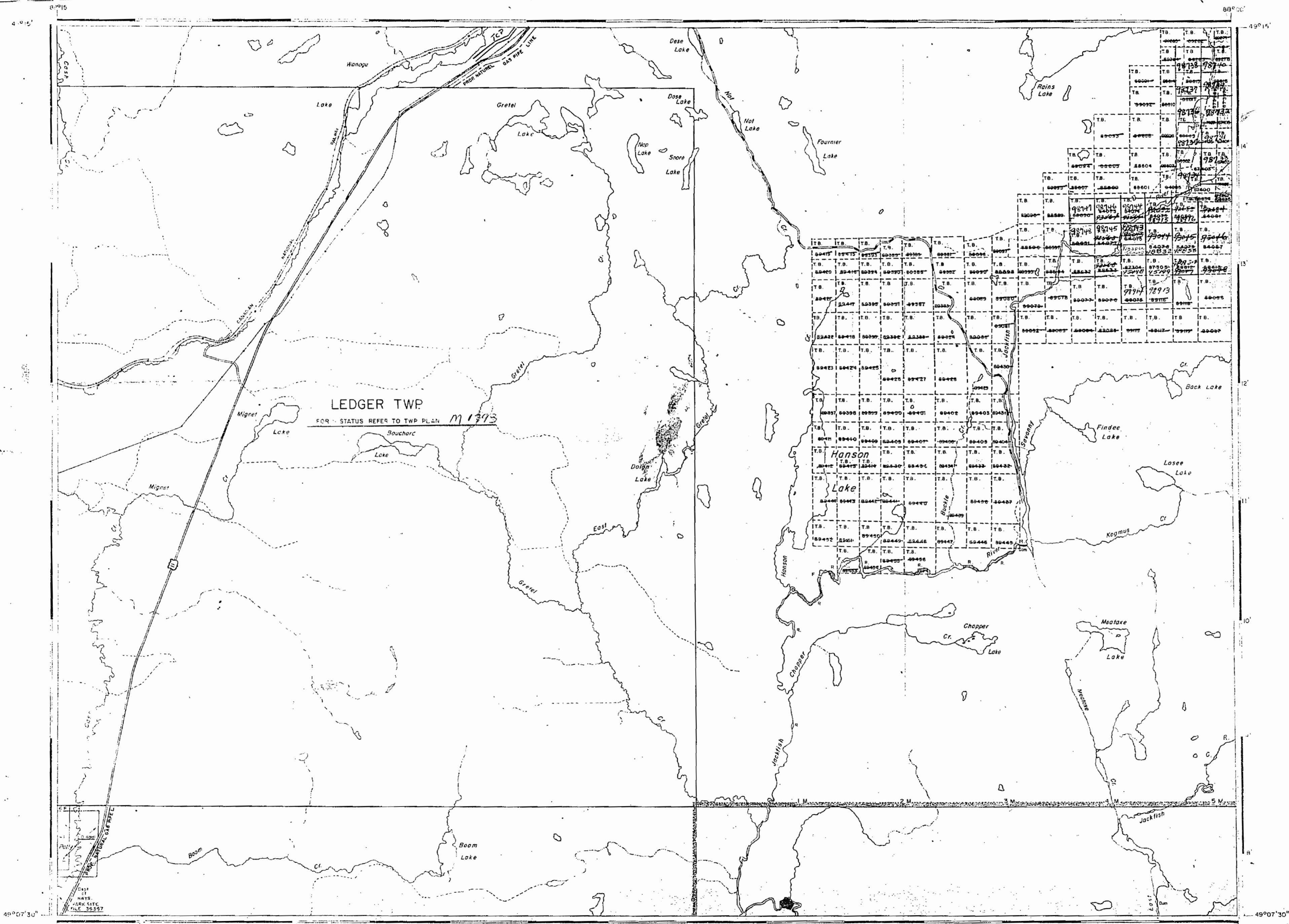

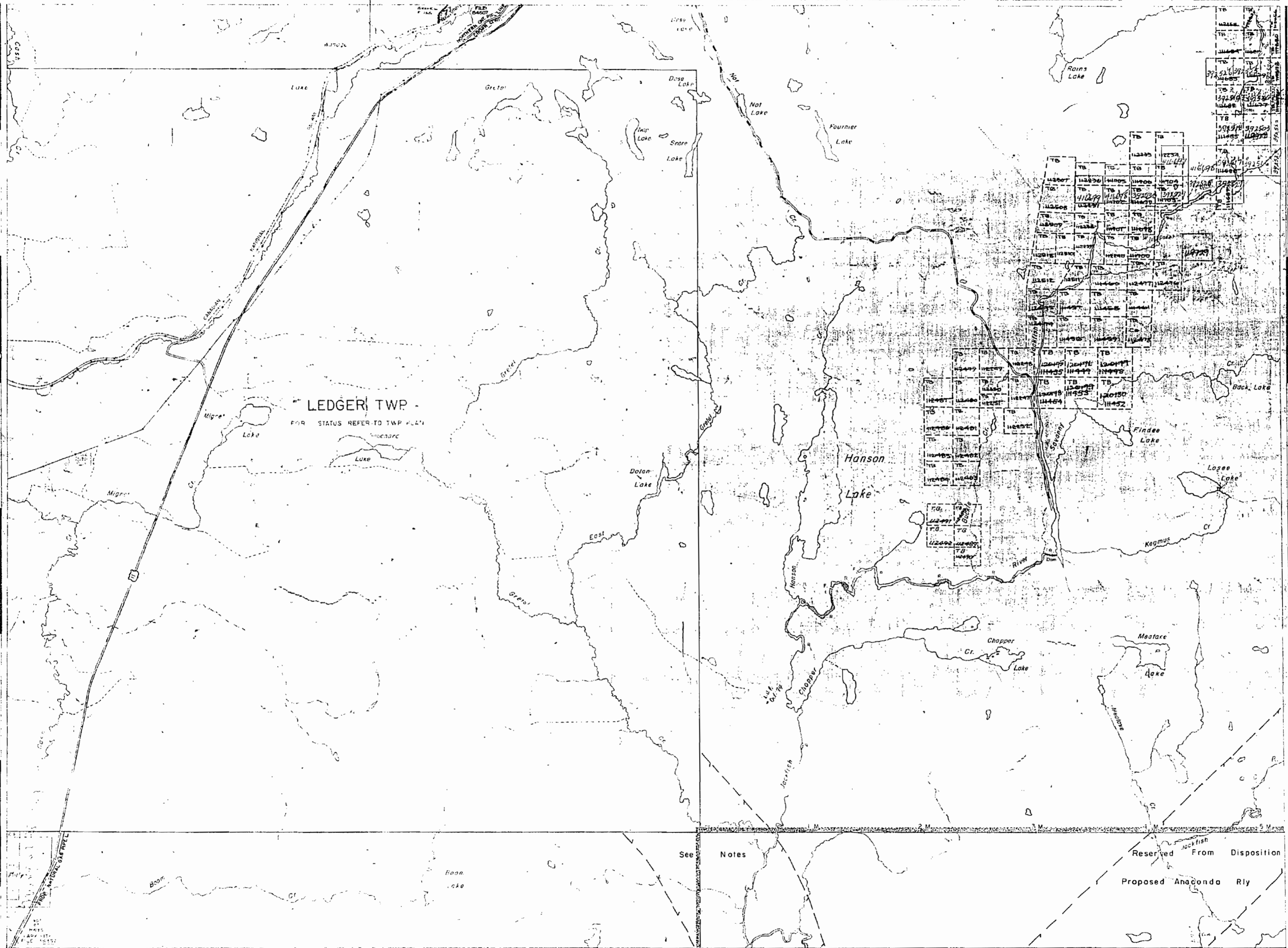

AREA OF
HANSON LAKE
 DISTRICT OF
 THUNDER BAY
 PORT ARTHUR
 MINING DIVISION
 SCALE: 1-INCH = 40 CHAINS

LEGEND

PATENTED LAND	P
CROWN LAND SALE	CS
LEASES	L
LOCATED LAND	Lo
LICENSE OF OCCUPATION	L.O.
MINING RIGHTS ONLY	M.R.O.
SURFACE RIGHTS ONLY	S.R.O.
ROADS	R
IMPROVED ROADS	IR
KING'S HIGHWAYS	K.H.
RAILWAYS	RW
POWER LINES	PL
MARSH OR MUSKEG	M
MINES	MN
CANCELLED	C

NOTES

400' Reserve around all lakes and rivers to Dept. of Lands & Rivers.

Bdry. of Dept. of Hwys. Parksite shown thus: L.O. 4891 within the Limits of above Park Site is to become part of the above Park upon cancellation of said L.O. File: 36367.

Area North & West of Line Shown Thus: Lies Within The NIPIGON PROVINCIAL FOREST.

SURFACE RIGHTS ONLY reserved on land indicated thus to the Anaconda Iron Ore (Ont) Ltd. File 165414

1965

PLAN NO. **M. 2565**
 DEPARTMENT OF MINES
 ONTARIO

2565

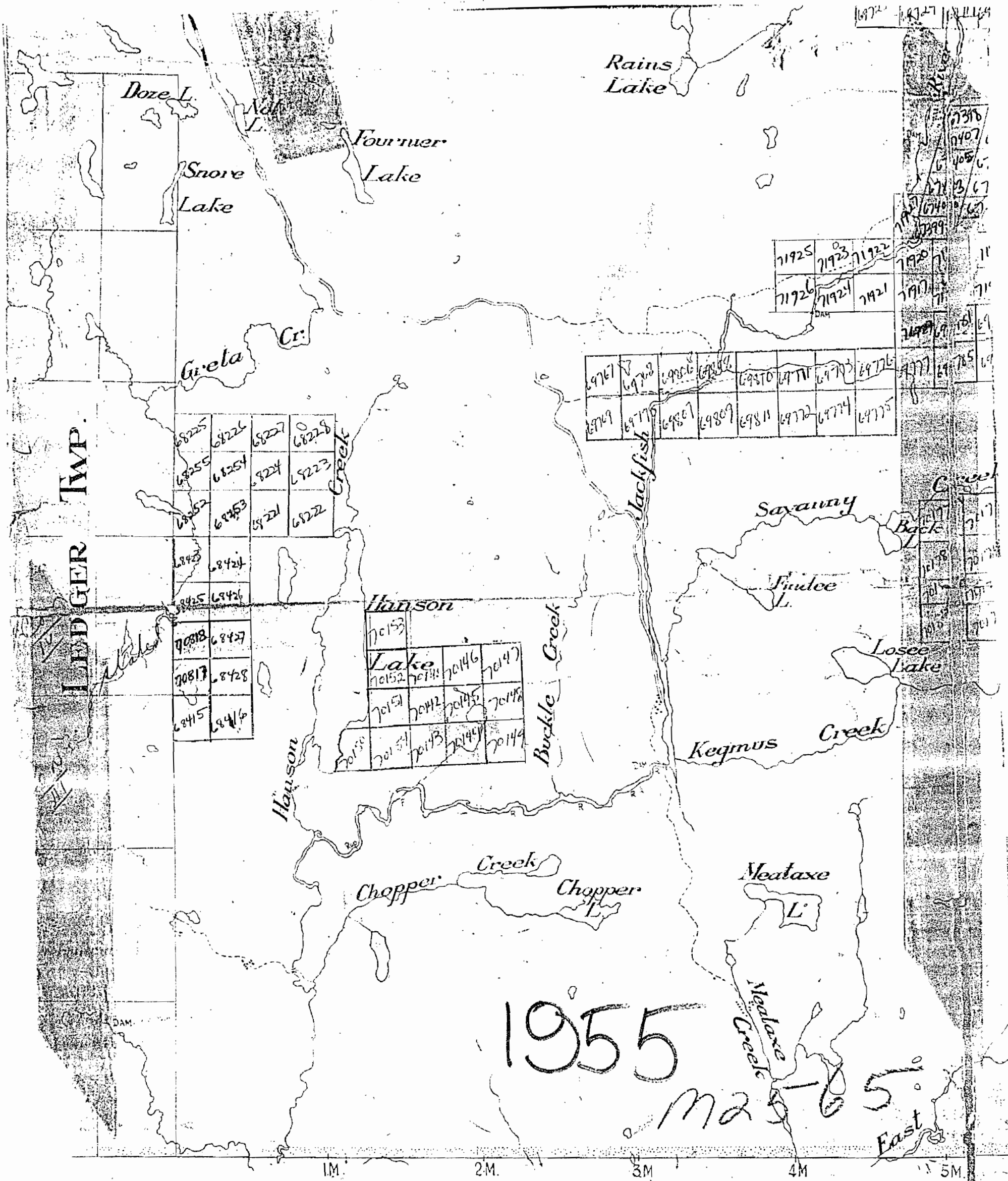

400 Reserve to the Dept. of L. & F. shown thus:

OFFICE MIA

2565

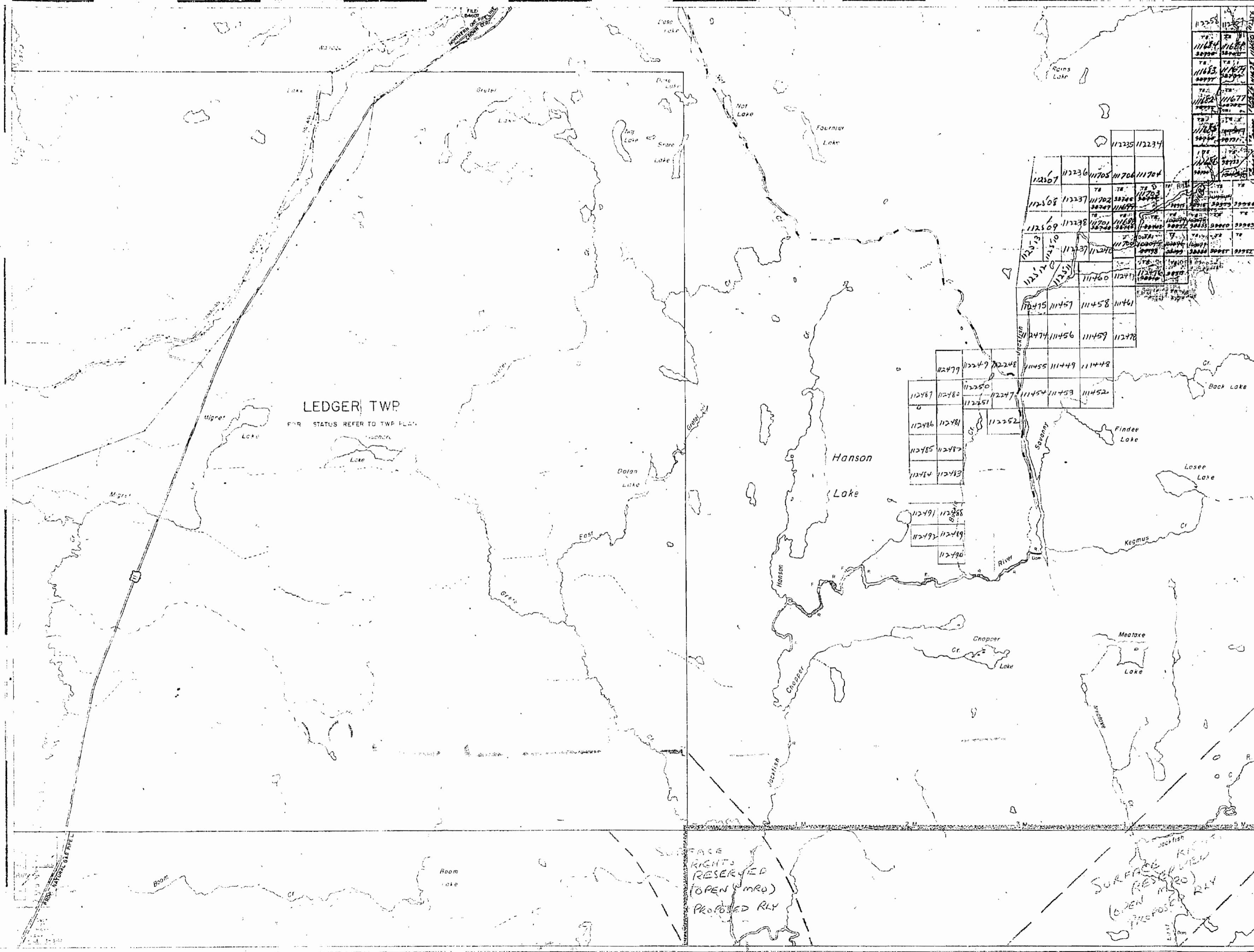

AREA C
HANSON LAKE

DISTRICT
 THUNDER BAY
 PORT ARTHUR
 MINING DIVISION
 SCALE: 1 INCH = 40 FEET

- LEG -
- PATENTED LAND
 - CROWN LAND SALE
 - LEASES
 - LOCATED LAND
 - LICENSE OF OCCUPATION
 - MINING RIGHTS ONLY
 - SURFACE RIGHTS ONLY
 - ROADS
 - IMPROVED ROADS
 - KINGS HIGHWAYS
 - RAILWAYS
 - POWER LINES
 - MARSH OR MUSKIE
 - MINES
 - CANCELLED

400' Reserve around all lakes and rivers to Dept of Lands & Rivers.
 Body of Dept of H&W Parksites show this LO 4881 within the limits of above Park Site is to become part of the above Park upon cancellation of said LO File 36367.
 Area North & West Of Line Shown Thus: ~~Reserved~~
 Lies Within The NIPIGON PROVINCIAL FOREST.

1960



PLAN NO. **M. 2565**

DEPARTMENT OF

2565

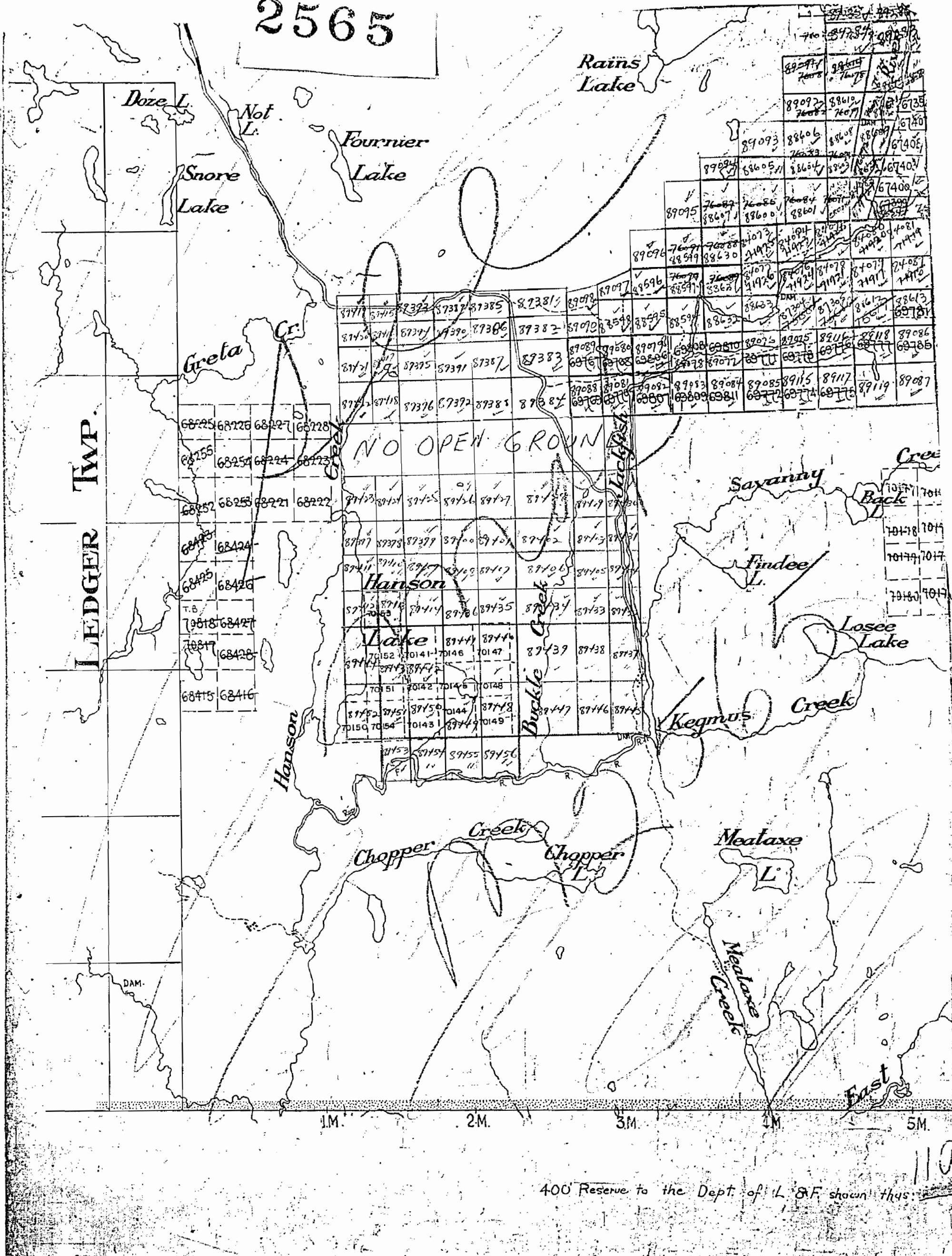

400 Reserve to the Dept. of L. & F. shown thus

119

HANSON LAKE

D. ST. R.
THUNDER BAY

PORT ARTHUR
MINING DIVISION

SCALE: 1 INCH = 40 FEET

LEGEND

- PATENTED LAND
- CROWN LAND SALE
- LEASES
- LOCATED LAND
- LICENSE OF OCCUPATION
- MINING RIGHTS ONLY
- SURFACE RIGHTS ONLY
- ROADS
- IMPROVED ROADS
- KING'S HIGHWAYS
- RAILWAYS
- POWER LINES
- MARSH OR MUSKES
- MINES
- CANCELLED

400' Reserve around all lakes and rivers to Dept of Lands & Rivers.

Body of Dept of Hws Parks shown thus LO 4881 within the Limits of above Park Site is to become part of the above Park upon cancellation of said LO File: 36367.

Area North & West of Line Shown Thus: Lies Within The NIPIGON PROVINCIAL FOREST.

1960



PLAN M. 2565

DEPARTMENT

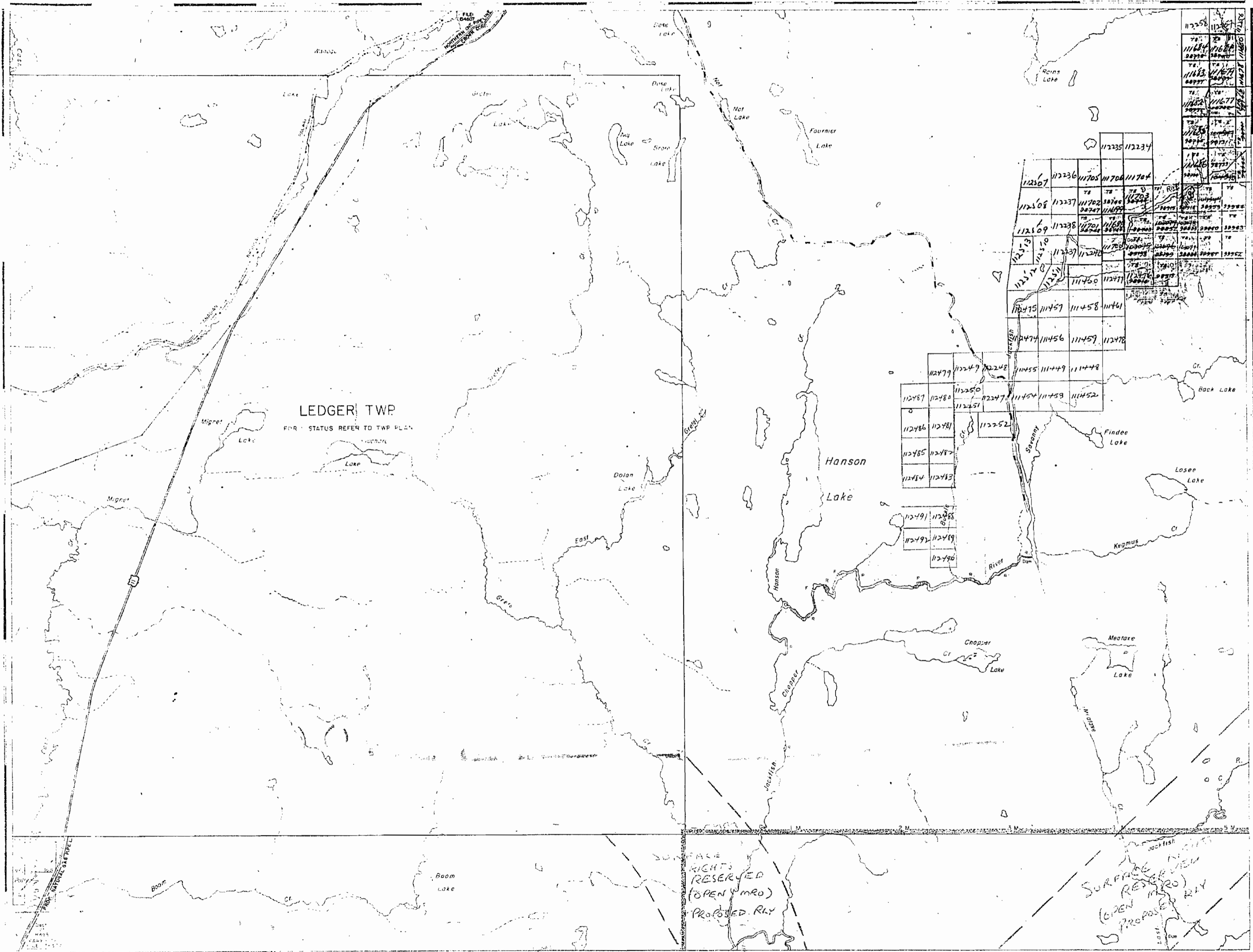

FACE RIGHTS RESERVED (OPEN MRO) PROPOSED RLY

SURFACE RIGHTS RESERVED (OPEN MRO) PROPOSED RLY