

925

NEWTON TWP.

THE TOWNSHIP OF  
HEENAN

DISTRICT OF  
SUDBURY

PORCUPINE  
MINING DIVISION

SCALE: 1-INCH 40 CHAINS

LEGEND

- PATENTED LAND ⊙
- CROWN LAND SALE C.S.
- LEASES ⊖
- LOCATED LAND Loc
- LICENSE OF OCCUPATION L.O.
- MINING RIGHTS ONLY M.R.O.
- SURFACE RIGHTS ONLY S.R.O.
- ROADS —
- IMPROVED ROADS —
- KING'S HIGHWAYS —
- RAILWAYS —
- POWER LINES —
- MARSH OR MUSKEG —
- MINES ⊕
- CANCELLED c

NOTES

400' Surface rights reservation around the shores of all lakes and rivers.  
 • L.U.P.

PORCUPINE MINING DIVISION  
**RECEIVED**  
 JUN 7 1974  
 AM 7 18 19 10 11 12 1 11 21 3 14 15 16 PM

DATE OF ISSUE  
 JUN 5 1974

PLAN NO. M-925

ONTARIO  
 MINISTRY OF NATURAL RESOURCES  
 SURVEYS AND MAPPING BRANCH

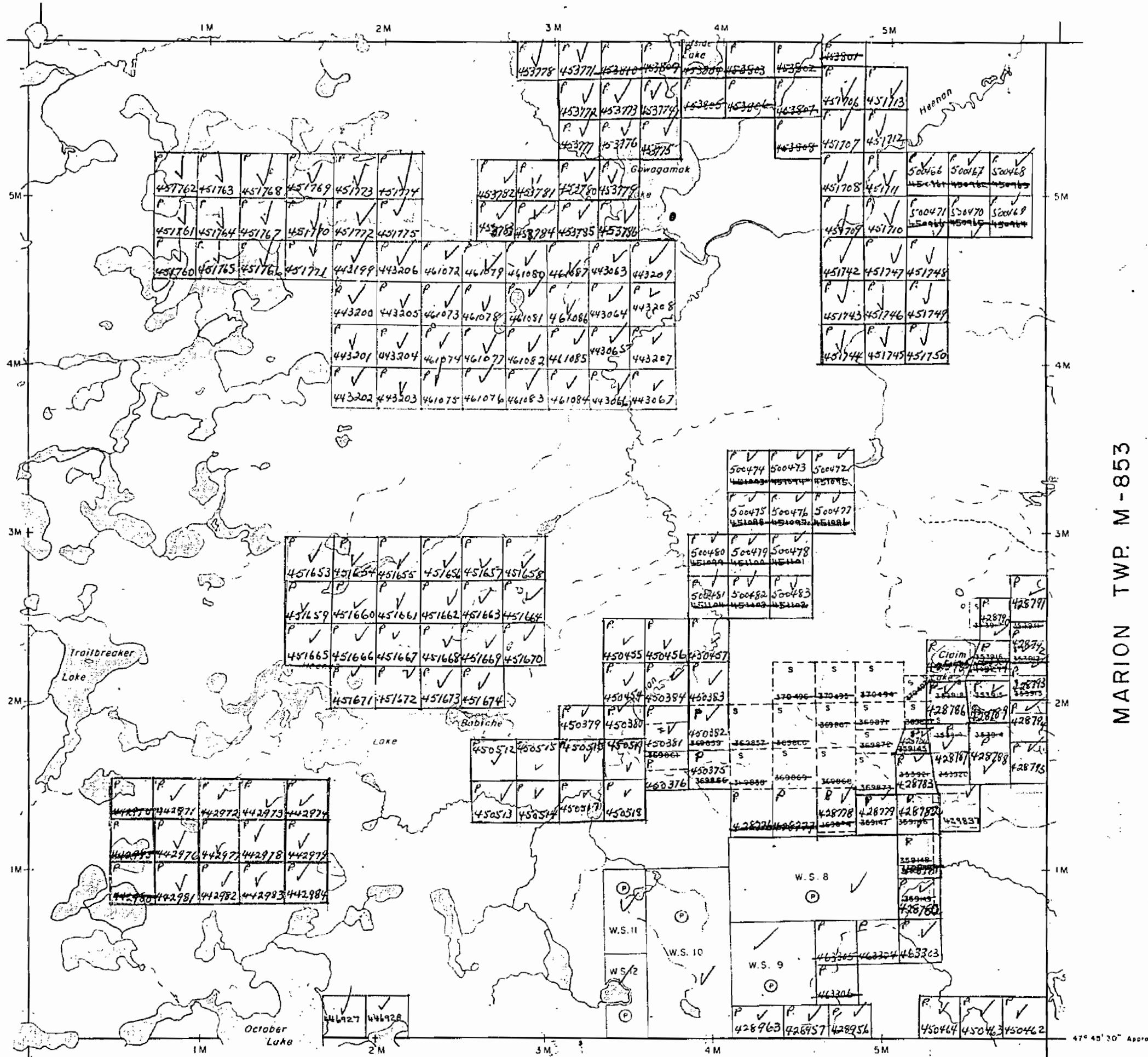

BENTON TWP. M-659

47° 45' 30" Approx  
82° 20' 45"

925

M-925

# HEENAN

DISTRICT OF SUDBURY

Scale - 40 Chams - 1 Inch.

*J. J. J.*  
400

North Ast

NEWTON

DORE

MARION

Trailbreaker L.

Heenan L.

Babiche L.

October Lake

Claim

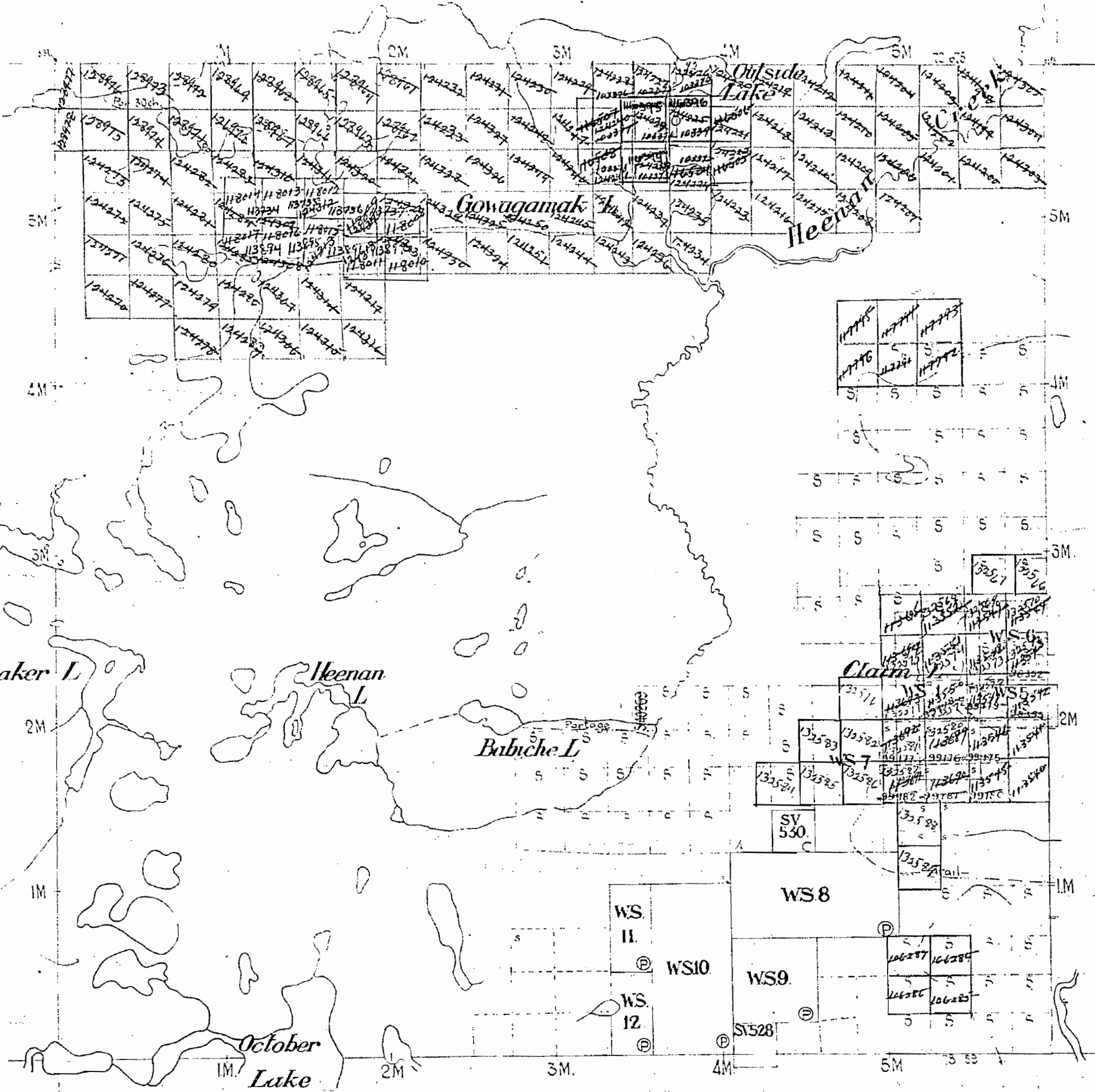

BENTON

925

# HEENAN

M-925

DISTRICT OF SUDBURY

Scale - 40 Chains - 1 Inch

NEWTON

**NOTE**

400' Surface Rights Reservation  
around all Lakes and Rivers.

DORE

MARION

Trailbreaker L.

Heenan

Babiche L.

Claim L.

October Lake

Outside Lake

Heenan Creek

BENTON

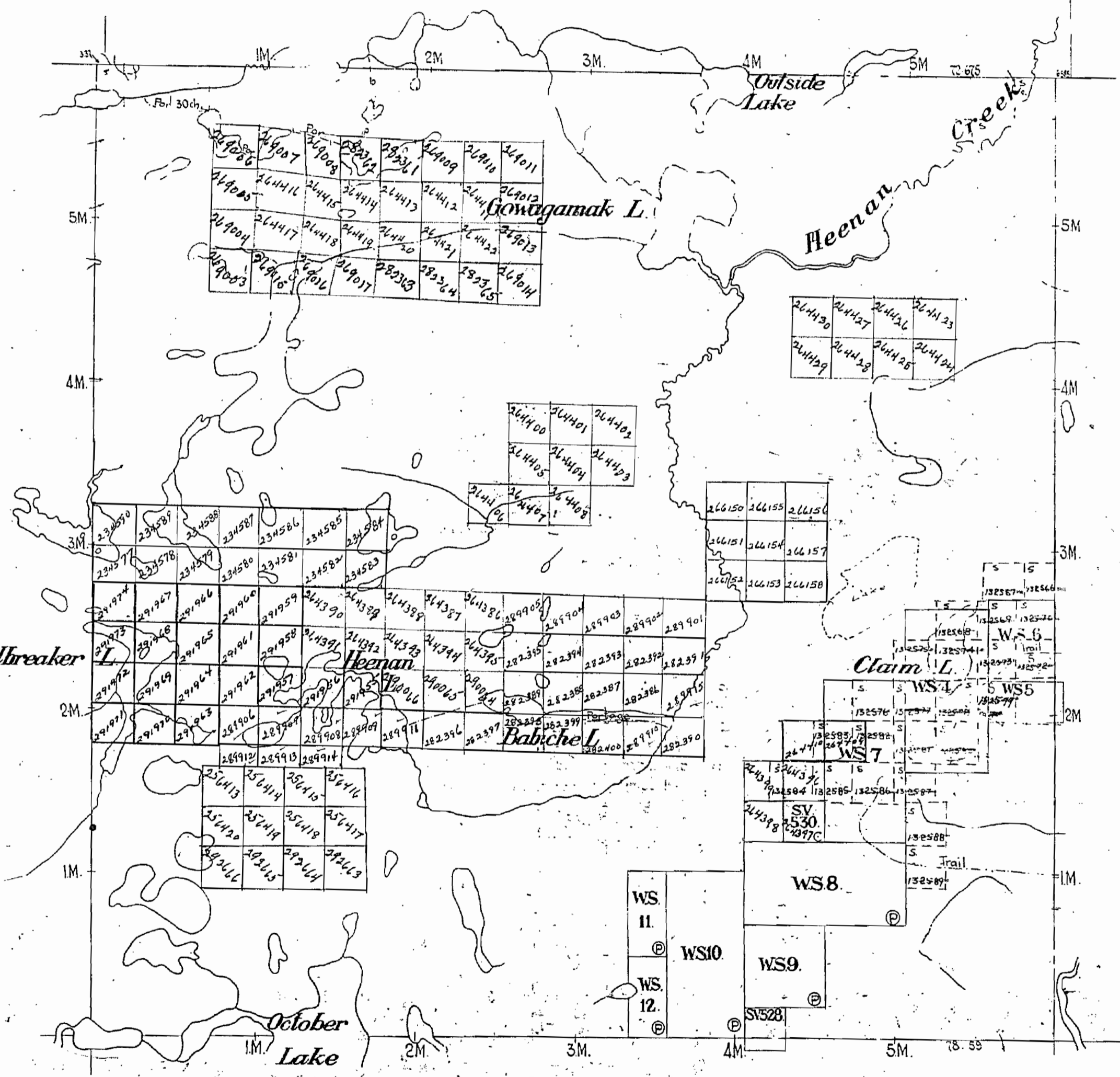

# HEENAN

## DISTRICT OF SUDBURY

Scale - 40 Chains - 1 Inch

*Old*

**NOTE**  
400' Surface Rights Reservation  
around all Lakes and Rivers.

NEWTON

North Ast.

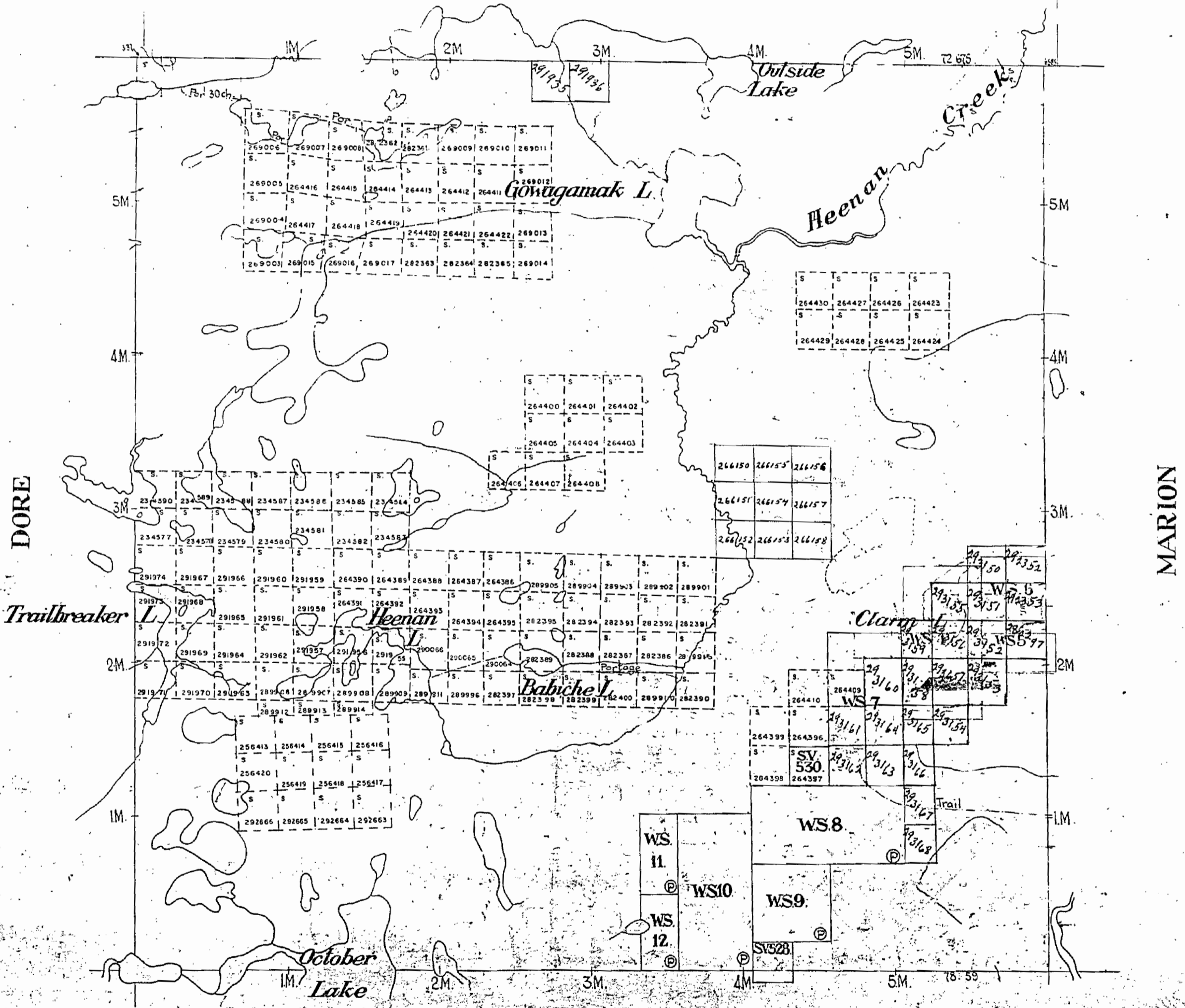

MARION

BENTON

DORE

925

# HEENAN

DISTRICT OF SUDBURY

Scale - 40 Chains - 1 Inch

M 925

OLD  
Hoo's

NEWTON

North Ast

DORE

MARION

Trailbreaker L.

Heenan L.

Babiche L.

October Lake

BENTON

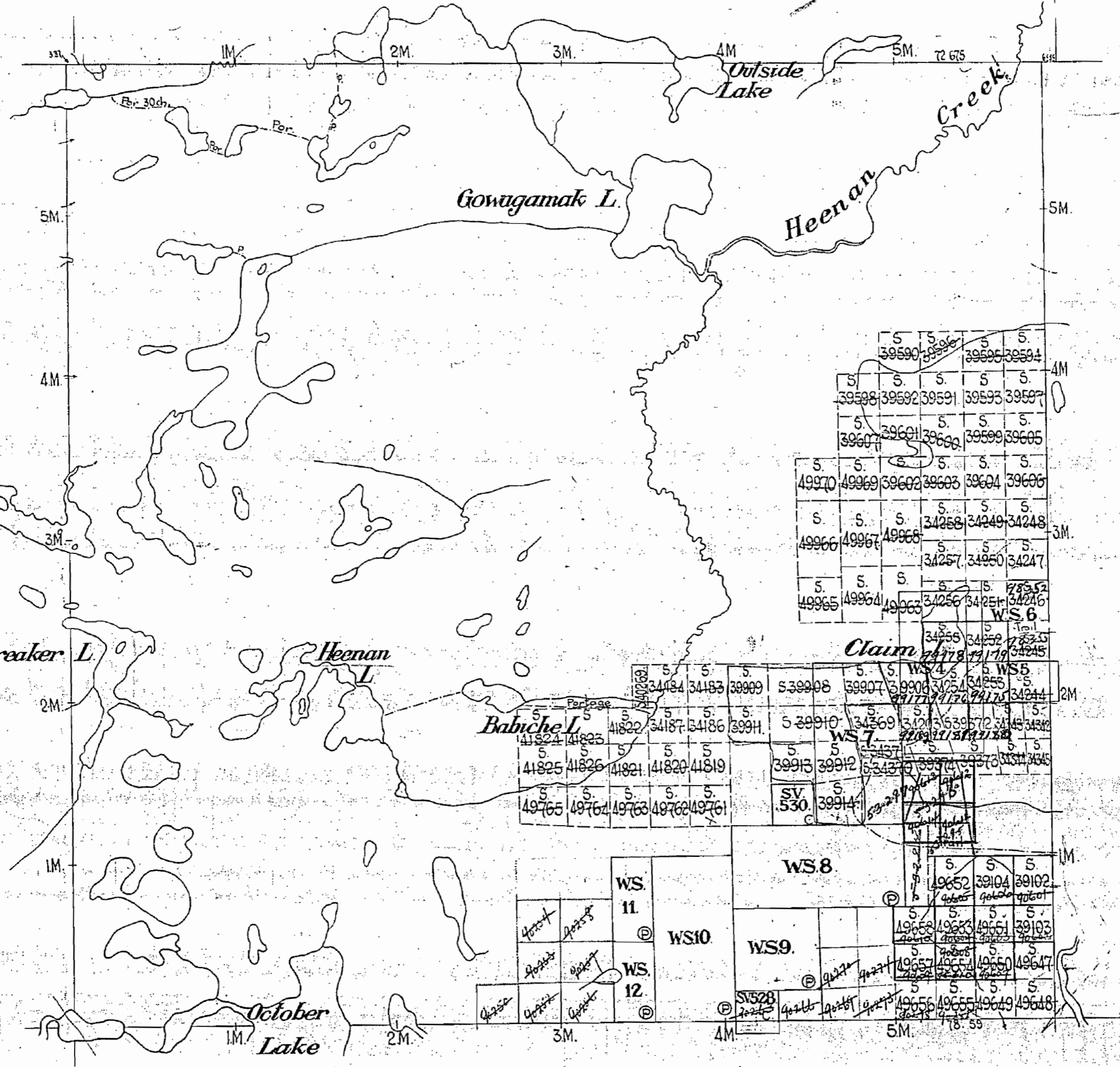

925

# HEENAN

DISTRICT OF SUDBURY

Scale - 40 Chains - 1. Inch

NEWTON

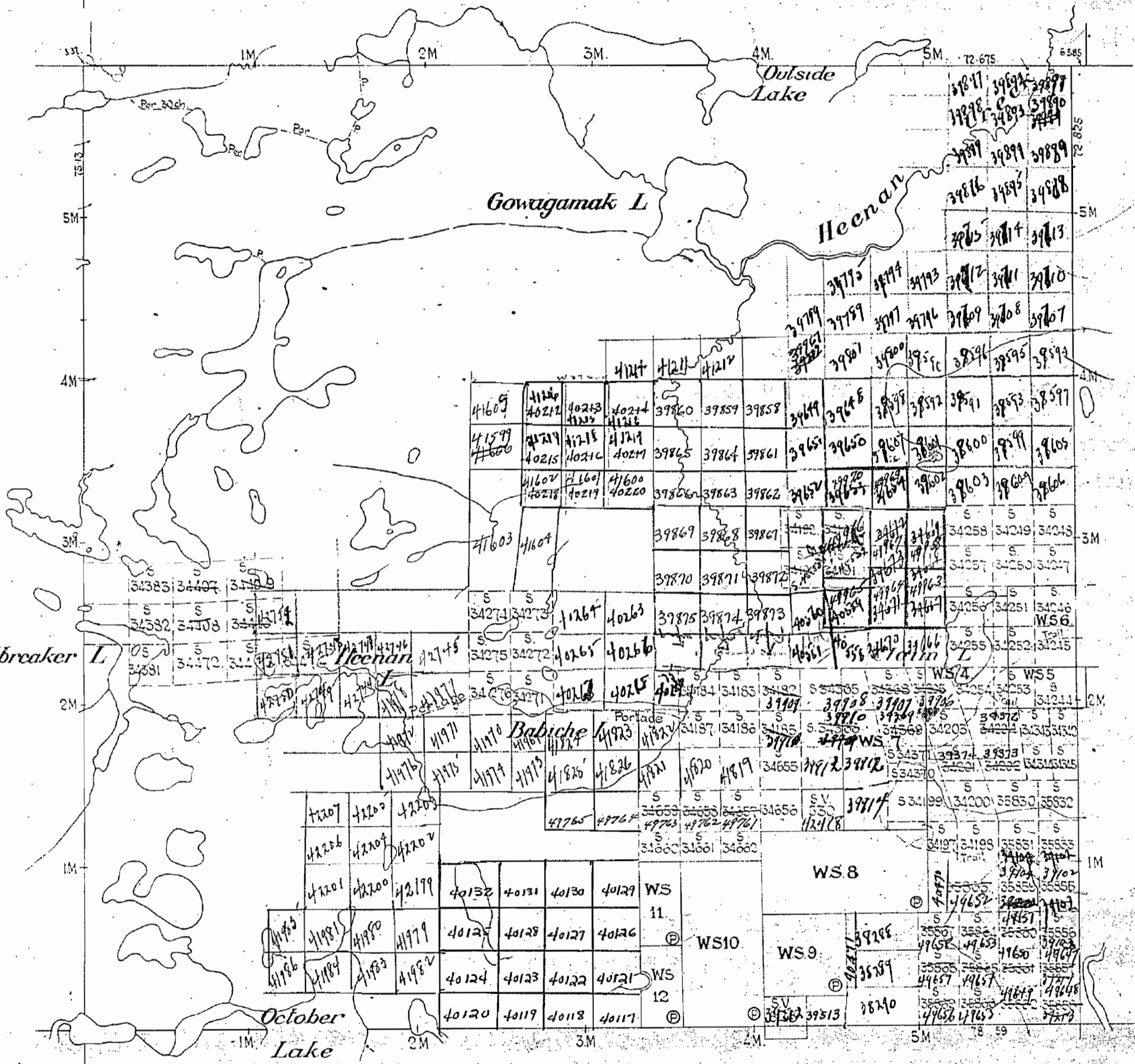

DORE

MARION

BENTON

M 925

DATE OF ISSUE  
 JAN 23 1942

NEWTON TWP.

SUDBURY  
Mining Div.  
**RECEIVED**  
Dec 1 1970  
A.M. 7,8,9,10,11,12,1,2,3,4,5,6 P.M.

THE TOWNSHIP  
OF  
**HEENAN**

DISTRICT OF  
SUDBURY

SUDBURY  
MINING DIVISION

SCALE: 1-INCH 40 CHAINS

**LEGEND**

- PATENTED LAND Ⓢ
- CROWN LAND SALE C.S.
- LEASES Ⓞ
- LOCATED LAND Loc.
- LICENSE OF OCCUPATION L.O.
- MINING RIGHTS ONLY M.R.O.
- SURFACE RIGHTS ONLY S.R.O.
- ROADS —
- IMPROVED ROADS —
- KING'S HIGHWAYS —
- RAILWAYS —
- POWER LINES —
- MARSH OR MUSKEG —
- MINES Ⓜ
- CANCELLED C.

**NOTES**

400' Surface rights reservation around the shores of all lakes and rivers.

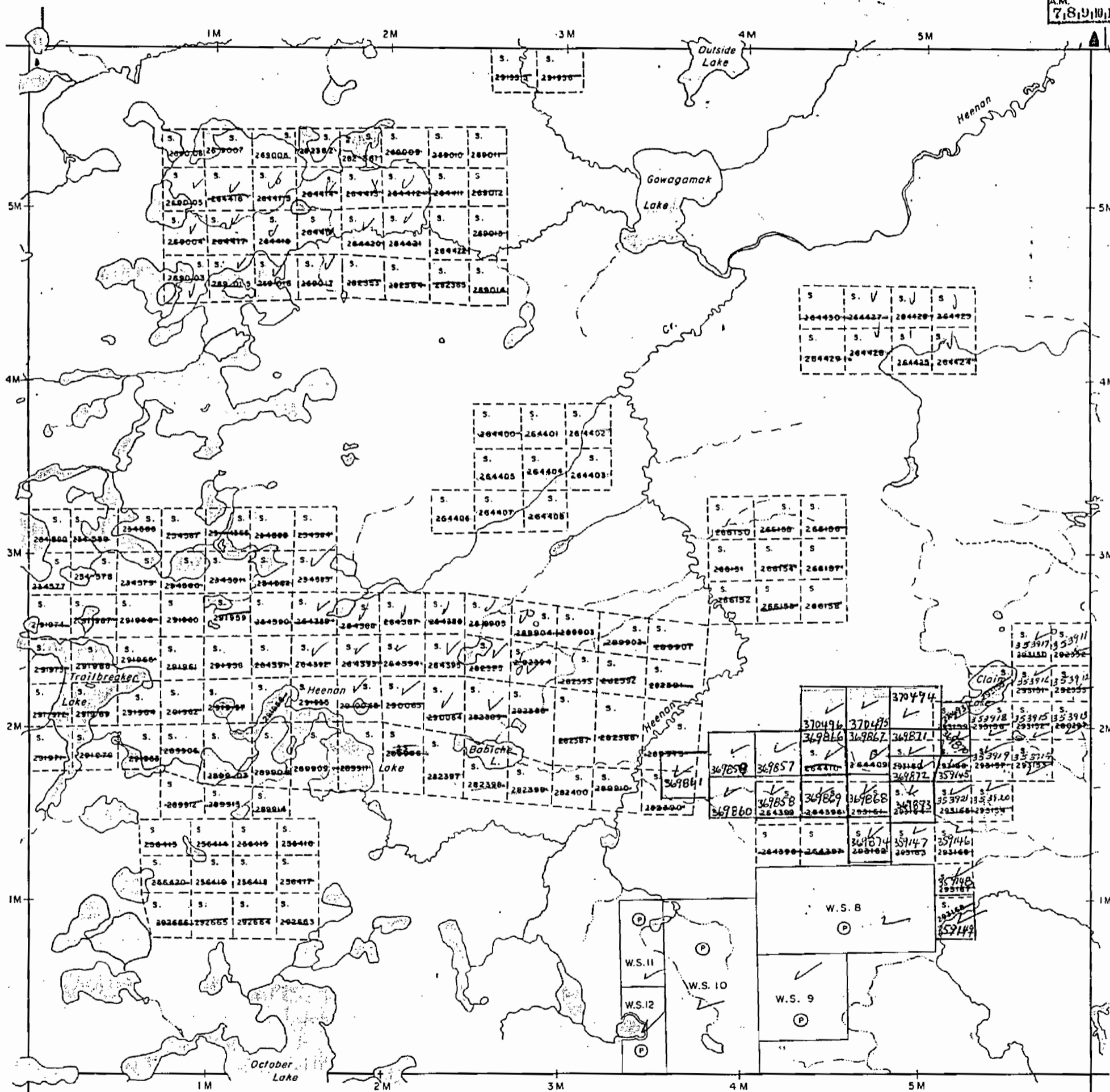

MARION TWP. M - 853

DORE TWP. M - 763

HEENAN TWP.

HEENAN TWP.

BENTON TWP. M - 659

PLAN NO. **M-925**

**ONTARIO  
DEPARTMENT OF MINES  
AND NORTHERN AFFAIRS**

925

NEWTON TWP.

THE TOWNSHIP OF  
HEENAN

DISTRICT OF  
SUDBURY

PORCUPINE  
MINING DIVISION

SCALE: 1-INCH 40 CHAINS

LEGEND

- PATENTED LAND Ⓟ
- CROWN LAND SALE C.S
- LEASES Ⓛ
- LOCATED LAND Loc
- LICENSE OF OCCUPATION L.O
- MINING RIGHTS ONLY M.R.O
- SURFACE RIGHTS ONLY S.R.O
- ROADS —
- IMPROVED ROADS —
- KING'S HIGHWAYS —
- RAILWAYS —
- POWER LINES —
- MARSH OR MUSKEG —
- MINES Ⓜ
- CANCELLED C

NOTES

400' Surface rights reservation around the shores of all lakes and rivers.  
 • L.U.P.

PORCUPINE MINING DIVISION  
**RECEIVED**  
 JUN 7 1974  
 AM 7 18 19 10 11 12 1 2 3 4 5 6 PM

DATE OF ISSUE  
 JUN 5 1974

PLAN NO. **M-925**

ONTARIO  
 MINISTRY OF NATURAL RESOURCES  
 SURVEYS AND MAPPING BRANCH

DORE TWP. M-763

MARION TWP. M-853

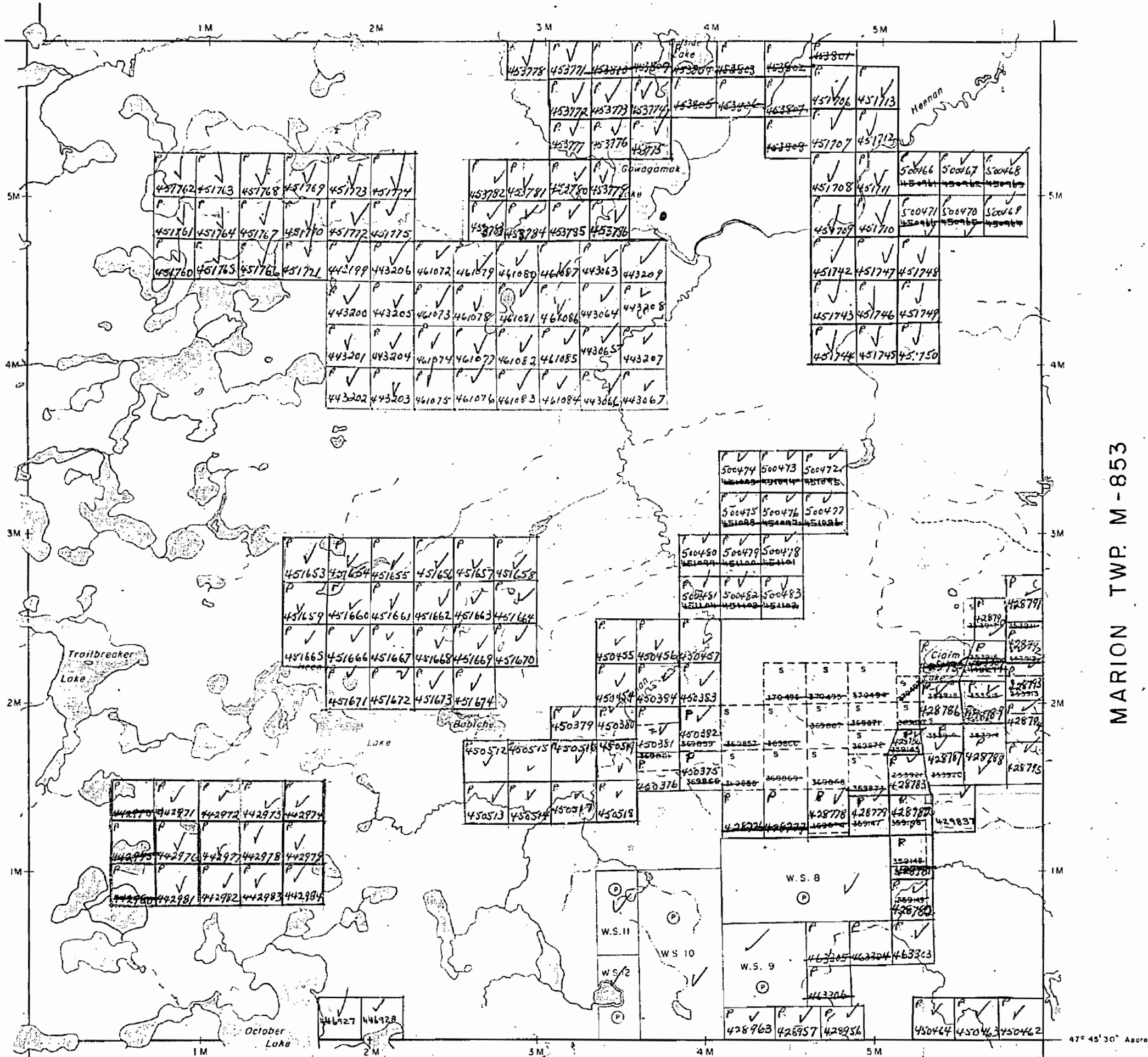

BENTON TWP. M-659

47° 45' 30" Approx  
82° 20' 45"



NEWTON TWP.

THE TOWNSHIP OF  
OF  
**HEENAN**

DISTRICT OF  
SUDBURY

PORCUPINE  
MINING DIVISION

SCALE: 1-INCH 40 CHAINS

LEGEND

- PATENTED LAND Ⓟ
- CROWN LAND SALE C.S.
- LEASES Ⓛ
- LOCATED LAND Loc
- LICENSE OF OCCUPATION L.O.
- MINING RIGHTS ONLY M.R.O.
- SURFACE RIGHTS ONLY S.R.O.
- ROADS —
- IMPROVED ROADS —
- KING'S HIGHWAYS —
- RAILWAYS —
- POWER LINES —
- MARSH OR MUSKEG —
- MINES —
- CANCELLED —

NOTES

400' Surface rights reservation around the shores of all lakes and rivers.

DATE OF ISSUE  
JUL 15 1977

**RECEIVED**

JUL 18 1977

AM 7 18 19 10 11 12 1 2 3 4 5 16 PM

PLAN NO. **M-925**

ONTARIO  
MINISTRY OF NATURAL RESOURCES  
SURVEYS AND MAPPING BRANCH

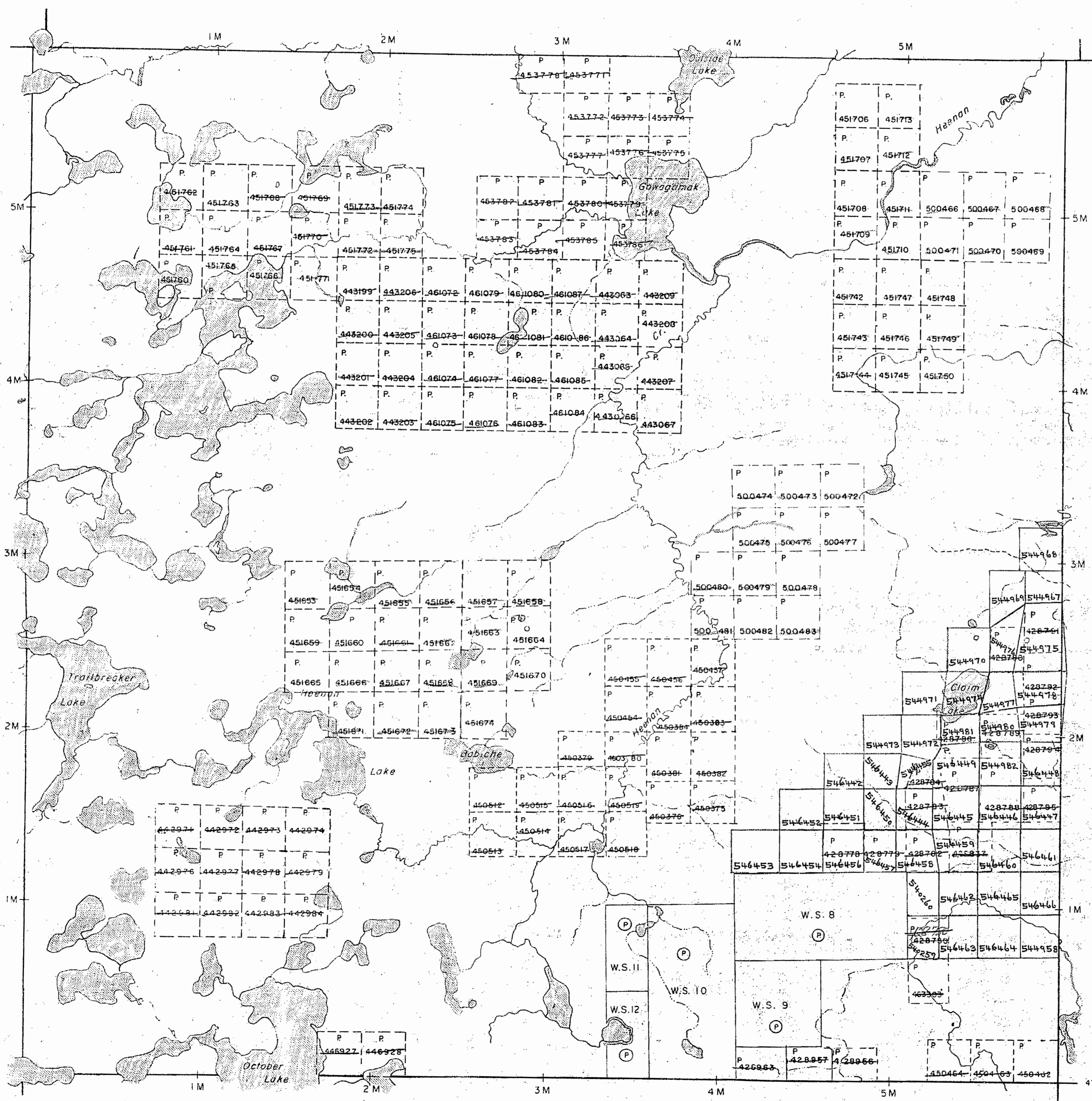

DORE TWP. M-763

MARION TWP. M-853

BENTON TWP. M-659

47° 45' 30" Approx.  
82° 20' 45"

NEWTON TWP.

THE TOWNSHIP OF HEENAN

DISTRICT OF SUDBURY

PORCUPINE MINING DIVISION

SCALE: 1-INCH 40 CHAINS

LEGEND

- PATENTED LAND Ⓟ
- CROWN LAND SALE C.S.
- LEASES Ⓛ
- LOCATED LAND Loc.
- LICENSE OF OCCUPATION L.O.
- MINING RIGHTS ONLY M.R.O.
- SURFACE RIGHTS ONLY S.R.O.
- ROADS —
- IMPROVED ROADS —
- KING'S HIGHWAYS —
- RAILWAYS —
- POWER LINES —
- MARSH OR MUSKEG —
- MINES ⚡
- CANCELLED C.

NOTES

400' Surface rights reservation around the shores of all lakes and rivers.

The Mining and Surface Rights of the former Mining Claims P-554702, P-554703, P-554704 are withdrawn from staking by ORDER NRW 5/87

Rec. Feb 11/80 OUT OF SERVICE OCT. 24/89

PLAN NO. M-925

ONTARIO MINISTRY OF NATURAL RESOURCES SURVEYS AND MAPPING BRANCH

DORE TWP. M-763

MARION TWP. M-853

BENTON TWP. M-659

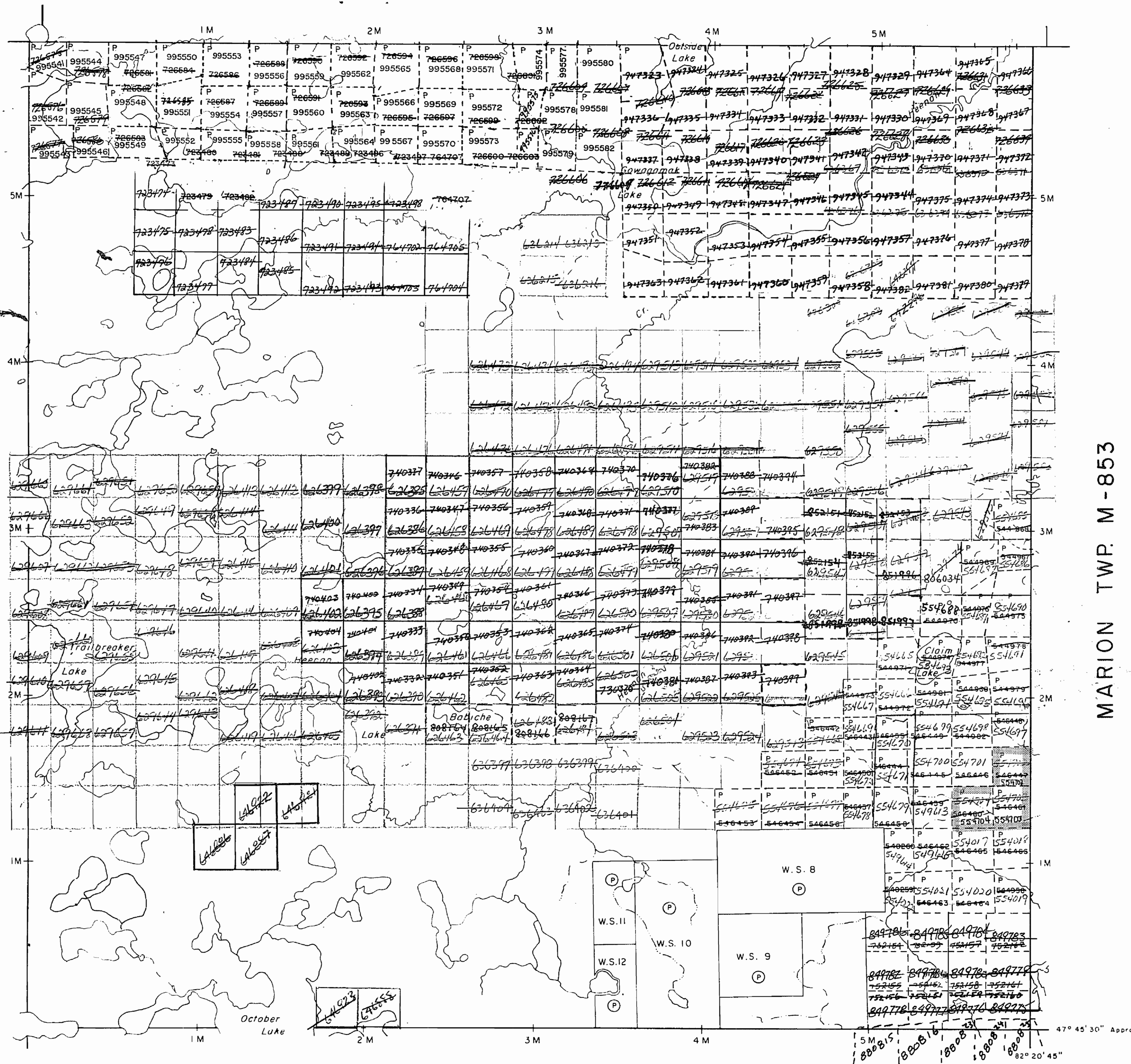

47° 45' 30" Approx.  
 82° 20' 45"

NEWTON TWP.

THE TOWNSHIP OF  
OF  
HEENAN

DATE OF ISSUE

OCT 07 1997 DISTRICT OF  
SUDBURY

PROVINCIAL RECORDING  
OFFICE - SUDBURY PORCUPINE

MINING DIVISION

SCALE: 1-INCH = 40 CHAINS

LEGEND

PATENTED LAND	(P)
CROWN LAND SALE	C.S.
LEASES	(L)
LOCATED LAND	Loc.
LICENSE OF OCCUPATION	L.O.
MINING RIGHTS ONLY	M.R.O.
SURFACE RIGHTS ONLY	S.R.O.
ROADS	—
IMPROVED ROADS	—
KING'S HIGHWAYS	—
RAILWAYS	—
POWER LINES	—
MARSH OR MUSKEG	—
MINES	⊗
CANCELLED	c.

NOTES

- 400' Surface rights reservation around the shores of all lakes and rivers.
- (M) MINING AND SURFACE RIGHTS WITHDRAWN FROM STAKING UNDER SECTION 36 OF THE MINING ACT R.S.O. 1990 ORDER NO. W50786 DATED 86-MAY-21
- (M) MINING AND SURFACE RIGHTS WITHDRAWN FROM STAKING UNDER SECTION 36 OF THE MINING ACT R.S.O. 1990 ORDER NO. W1197 (LOCAL FILE NRW 5197) DATED 87-FEB-03
- THIS TWP IS SUBJECT TO FOREST ACTIVITIES IN 1992/93. FURTHER INFORMATION AVAILABLE ON FILE.
- (R) SURFACE AND MINING RIGHTS RE-OPENED TO PROSPECTING, STAKING OUT, SALE OR LEASE UNDER SECTION 35 OF THE MINING ACT RSO 1990 EFFECTIVE 92-MAY-05 AT 7:00 AM E.S.T. ORDER NO. O.P.-11/92 NER DATED 92-APR-15
- (F2) THIS TWP. IS SUBJECT TO FOREST ACTIVITIES IN 1995/96 FURTHER INFORMATION AVAILABLE ON FILE
- THE INFORMATION THAT APPEARS ON THIS MAP HAS BEEN COMPILED FROM VARIOUS SOURCES, AND ACCURACY IS NOT GUARANTEED. THOSE WISHING TO STAKE MINING CLAIMS SHOULD CONSULT WITH THE MINING RECORDER, MINISTRY OF NORTHERN DEVELOPMENT AND MINES, FOR ADDITIONAL INFORMATION ON THE STATUS OF THE LANDS SHOWN HEREON.

CHECKED BY D. CHOLETTE  
IN SERVICE OCT. 24/89

PLAN NO. G-1139

DEPT. OF MINES  
DEPARTMENT OF MINES  
AND NORTHERN AFFAIRS

DORE TWP. M-763

MARION TWP. M-853

BENTON TWP. M-659

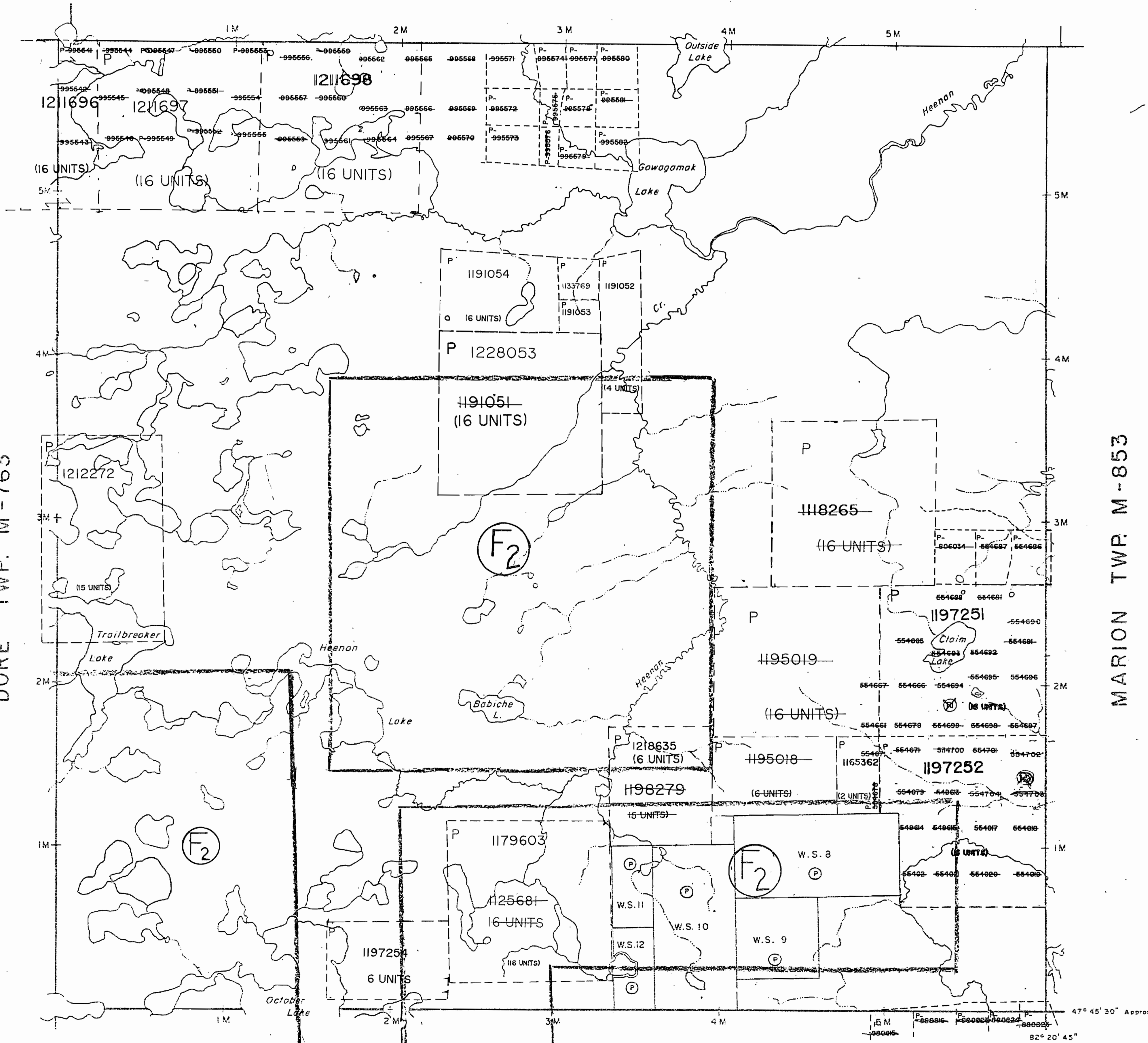

NEWTON TWP.

THE TOWNSHIP OF  
OF  
**HEENAN**

DATE OF ISSUE

MAY 14 1998

PROVINCIAL RECORDING  
OFFICE - SUDBURY

DISTRICT OF  
SUDBURY

PORCUPINE

MINING DIVISION

SCALE: 1-INCH = 40 CHAINS

**LEGEND**

PATENTED LAND	(P)
CROWN LAND SALE	C.S.
LEASES	(L)
LOCATED LAND	Loc.
LICENSE OF OCCUPATION	L.O.
MINING RIGHTS ONLY	M.R.O.
SURFACE RIGHTS ONLY	S.R.O.
ROADS	—
IMPROVED ROADS	—
KING'S HIGHWAYS	—
RAILWAYS	—
POWER LINES	—
MARSH OR MUSKEG	—
MINES	⊗
CANCELLED	C.

**NOTES**

400' Surface rights reservation around the shores of all lakes and rivers.

(1) MINING AND SURFACE RIGHTS WITHDRAWN FROM STAKING UNDER SECTION 36 OF THE MINING ACT R.S.O. 1980 ORDER NO. W30786 DATED 86-MAY-21.

(2) MINING AND SURFACE RIGHTS WITHDRAWN FROM STAKING UNDER SECTION 36 OF THE MINING ACT R.S.O. 1980 ORDER NO. W1197 (LOCAL FILE NRW 5197) DATED 87-FEB-03.

THIS TWP. IS SUBJECT TO FOREST ACTIVITIES IN 1992/93. FURTHER INFORMATION AVAILABLE ON FILE.

(3) SURFACE AND MINING RIGHTS RE-OPENED TO PROSPECTING, STAKING OUT, SALE OR LEASE UNDER SECTION 35 OF THE MINING ACT RSO 1990 EFFECTIVE 92-MAY-05 AT 7:00 AM E.S.T. ORDER NO. O-P-11/92 NR DATED 92-APR-15.

(4) THIS TWP. IS SUBJECT TO FOREST ACTIVITIES IN 1995/96 FURTHER INFORMATION AVAILABLE ON FILE.

THE INFORMATION THAT APPEARS ON THIS MAP HAS BEEN COMPILED FROM VARIOUS SOURCES, AND ACCURACY IS NOT GUARANTEED. THOSE WISHING TO STAKE MINING CLAIMS SHOULD CONSULT WITH THE MINING RECORDER, MINISTRY OF NORTHERN DEVELOPMENT AND MINES, FOR ADDITIONAL INFORMATION ON THE STATUS OF THE LANDS SHOWN HEREON.

CHECKED BY D. CHOLETTE  
IN SERVICE OCT. 24/89

PLAN NO. **G-1139**

ONTARIO  
DEPARTMENT OF MINES  
AND NORTHERN AFFAIRS

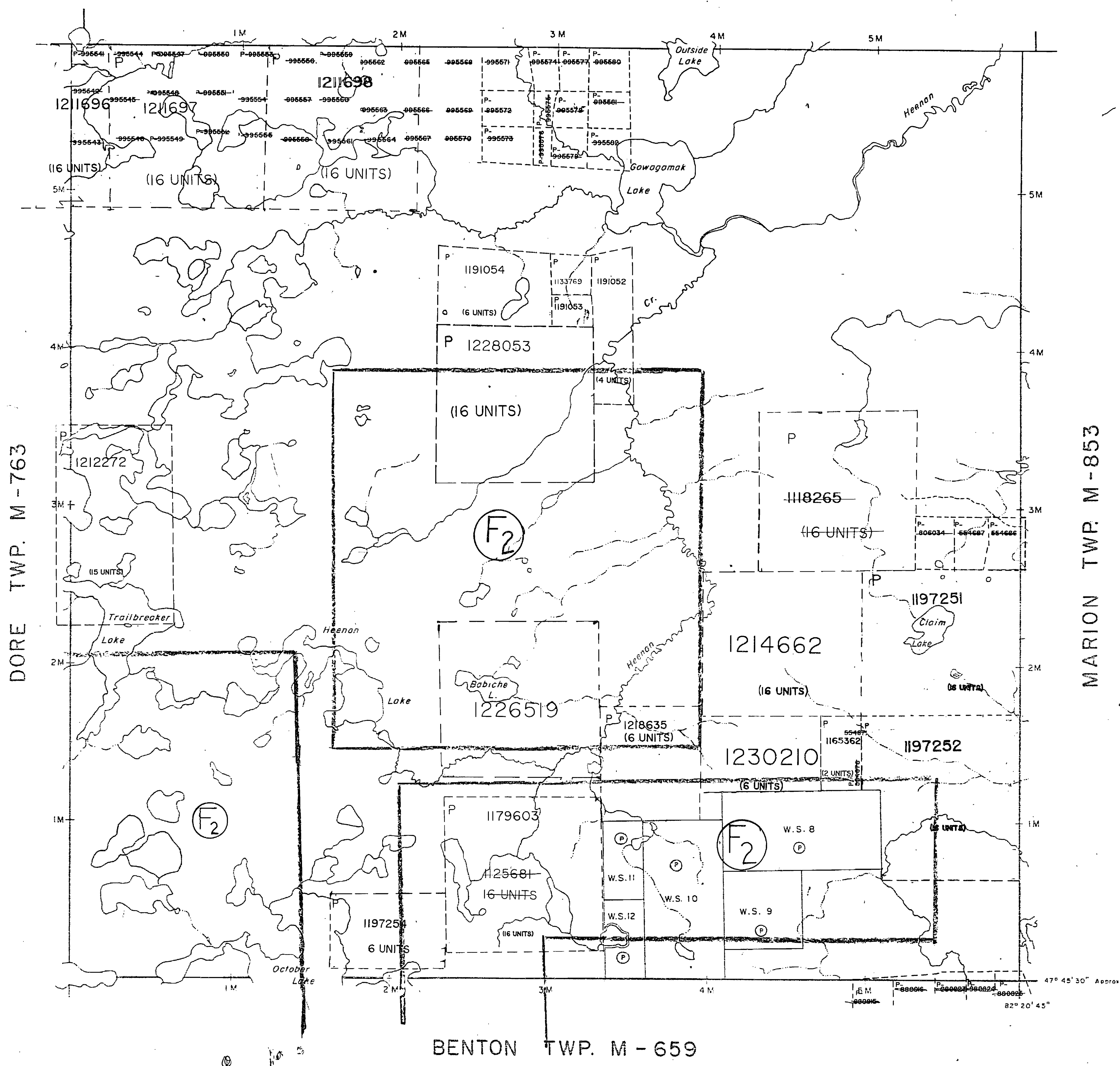

DORE TWP. M-763

MARION TWP. M-853

BENTON TWP. M-659

NEWTON TWP.

THE TOWNSHIP  
OF  
**HEENAN**

DISTRICT OF  
SUDBURY  
PORCUPINE  
MINING DIVISION

SCALE: 1-INCH = 40 CHAINS

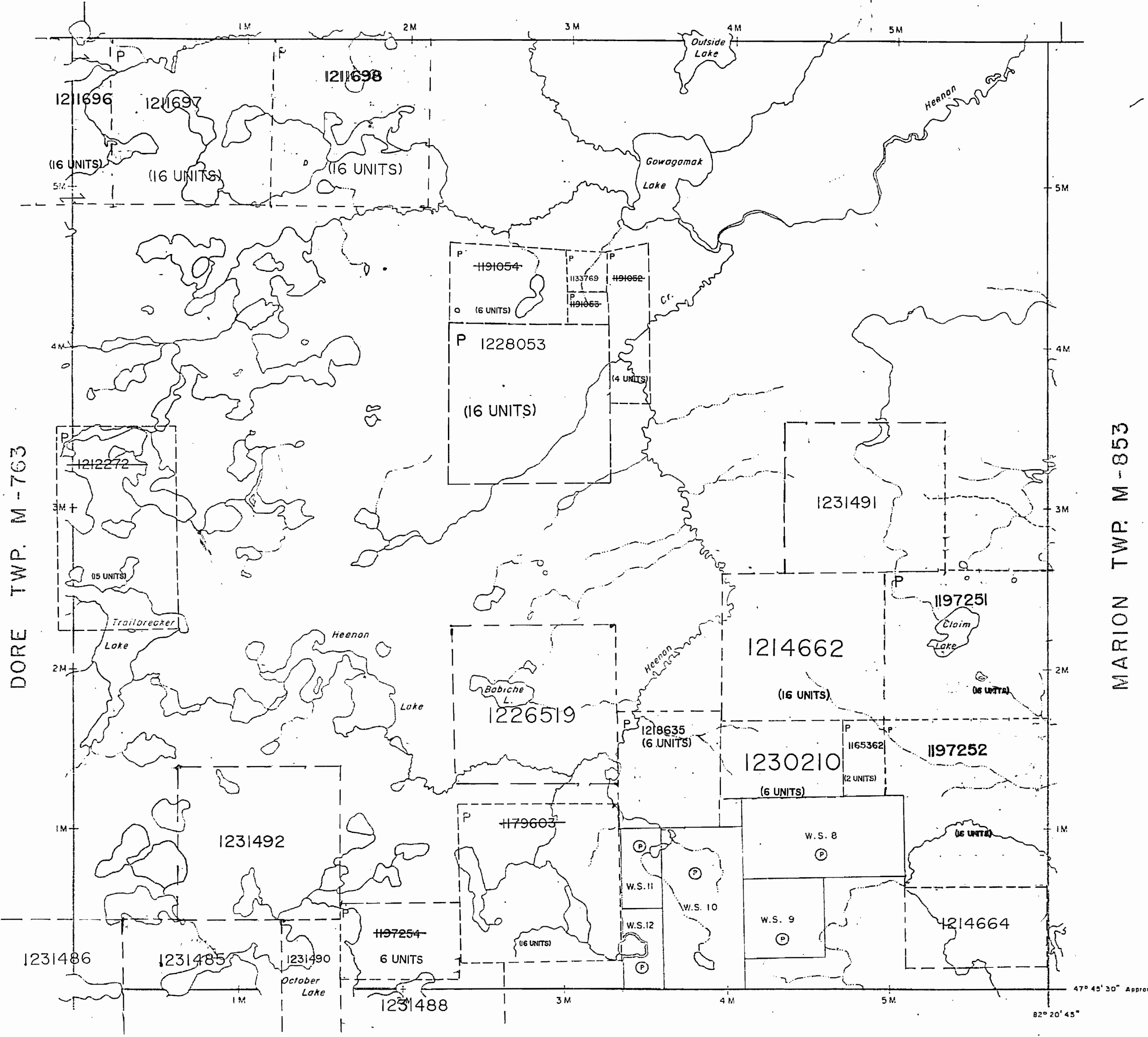

DORE TWP. M-763

MARION TWP. M-853

BENTON TWP. M-659

**LEGEND**

PATENTED LAND	Ⓟ
CROWN LAND SALE	C.S.
LEASES	Ⓛ
LOCATED LAND	Loc.
LICENSE OF OCCUPATION	L.O.
MINING RIGHTS ONLY	M.R.O.
SURFACE RIGHTS ONLY	S.R.O.
ROADS	—
IMPROVED ROADS	—
KING'S HIGHWAYS	—
RAILWAYS	—
POWER LINES	—
MARSH OR MUSKEG	—
MINES	Ⓜ
CANCELLED	C.

**NOTES**

400' Surface rights reservation around the shores of all lakes and rivers.

Ⓟ SURFACE AND MINING RIGHTS RE-OPENED TO PROSPECTING, STAKING OUT, SALE OR LEASE UNDER SECTION 35 OF THE MINING ACT RSO 1990 EFFECTIVE 92-MAY-05 AT 7:00 AM E.S.T. ORDER NO. O-P-8/92 NER DATED 92-APR-15

THE INFORMATION THAT APPEARS ON THIS MAP HAS BEEN COMPILED FROM VARIOUS SOURCES, AND ACCURACY IS NOT GUARANTEED. THOSE WISHING TO STAKE MINING CLAIMS SHOULD CONSULT WITH THE MINING RECORDER, MINISTRY OF NORTHERN DEVELOPMENT AND MINES, FOR ADDITIONAL INFORMATION ON THE STATUS OF THE LANDS SHOWN HEREON.

CHECKED BY D. CHOLETTE  
IN SERVICE OCT. 24/89

PLAN NO. **G-1139** 88

DEPT. OF MINES  
**DEPARTMENT OF MINES  
AND NORTHERN AFFAIRS**

925

# HEENAN

DISTRICT OF SUDBURY

Scale - 40 Chains - 1 Inch

M. 925

OLD  
400' res.

NEWTON

North Ast.

DORE

MARION

Trailbreaker L.

Heenan L.

Babiche L.

October Lake

Outside Lake

Gowagamak L.

Heenan Creek

5	5	5	5	5
39590	39591	39592	39593	39594
5	5	5	5	5
39598	39599	39600	39601	39602
5	5	5	5	5
39607	39608	39609	39610	39611
5	5	5	5	5
49970	49971	49972	49973	49974
5	5	5	5	5
49966	49967	49968	49969	49970
5	5	5	5	5
34258	34259	34260	34261	34262
5	5	5	5	5
34257	34258	34259	34260	34261
5	5	5	5	5
49965	49966	49967	49968	49969

Claim

5	5	5	5	5	5	5	5	5	5
34184	34185	34186	34187	34188	34189	34190	34191	34192	34193
5	5	5	5	5	5	5	5	5	5
41824	41825	41826	41827	41828	41829	41830	41831	41832	41833
5	5	5	5	5	5	5	5	5	5
41825	41826	41827	41828	41829	41830	41831	41832	41833	41834
5	5	5	5	5	5	5	5	5	5
49765	49766	49767	49768	49769	49770	49771	49772	49773	49774

WS 11	WS 10	WS 9	WS 8	WS 7	WS 6
19652	19653	19654	19655	19656	19657
19658	19659	19660	19661	19662	19663
19664	19665	19666	19667	19668	19669
19670	19671	19672	19673	19674	19675
19676	19677	19678	19679	19680	19681
19682	19683	19684	19685	19686	19687
19688	19689	19690	19691	19692	19693
19694	19695	19696	19697	19698	19699
19700	19701	19702	19703	19704	19705

BENTON

925

M-925

# HEENAN

DISTRICT OF SUBBURY

Scale - 40 Chans -- 1 Inch.

*J. J. J.*

*400' over*

North Ast

NEWTON

DORE

MARION

BENTON

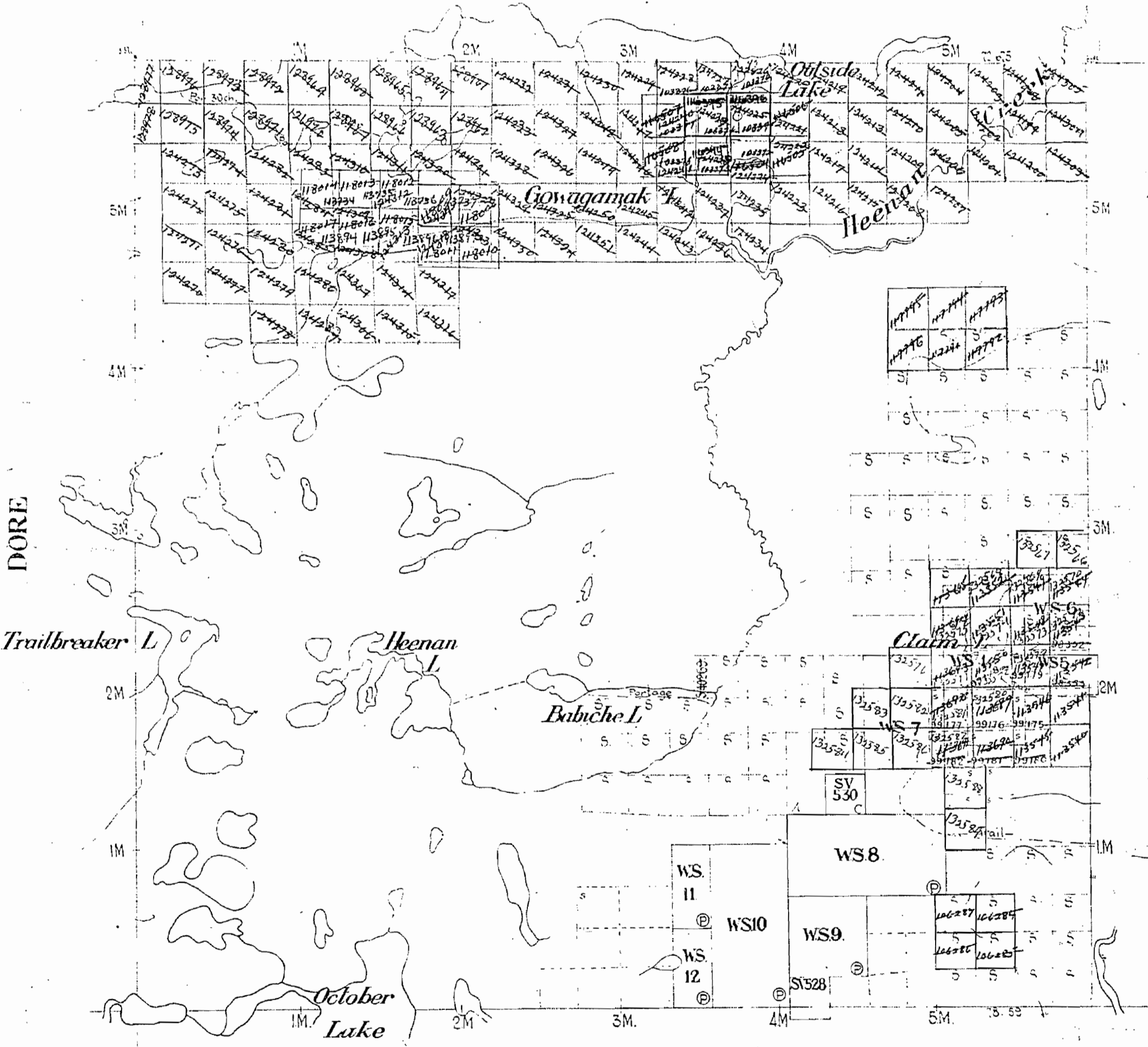

925

M-925

# HEENAN

DISTRICT OF SUDBURY

Scale - 40 Chains - 1 Inch

NOTE  
400' Surface Rights Reservation  
around all Lakes and Rivers.

NEWTON

North Ast

DORE

MARION

Trailbreaker L.

Claim L.

October Lake

BENTON

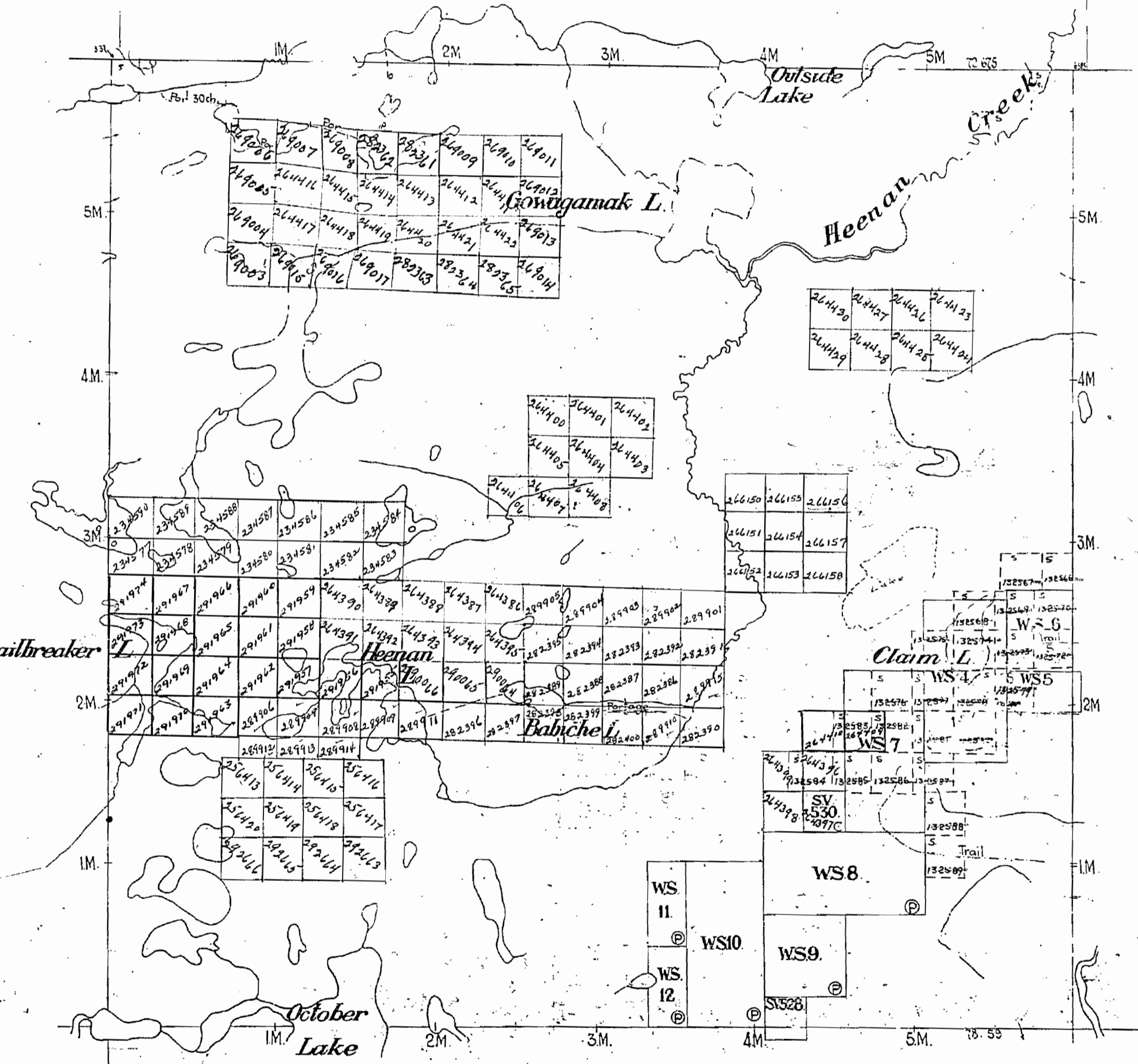



925

# HEENAN

DISTRICT OF SUDBURY

M-925

Scale - 40 Chains - 1 Inch

**NOTE**

400' Surface Rights Reservation  
around all Lakes and Rivers.

NEWTON

North Ast

DORE

MARION

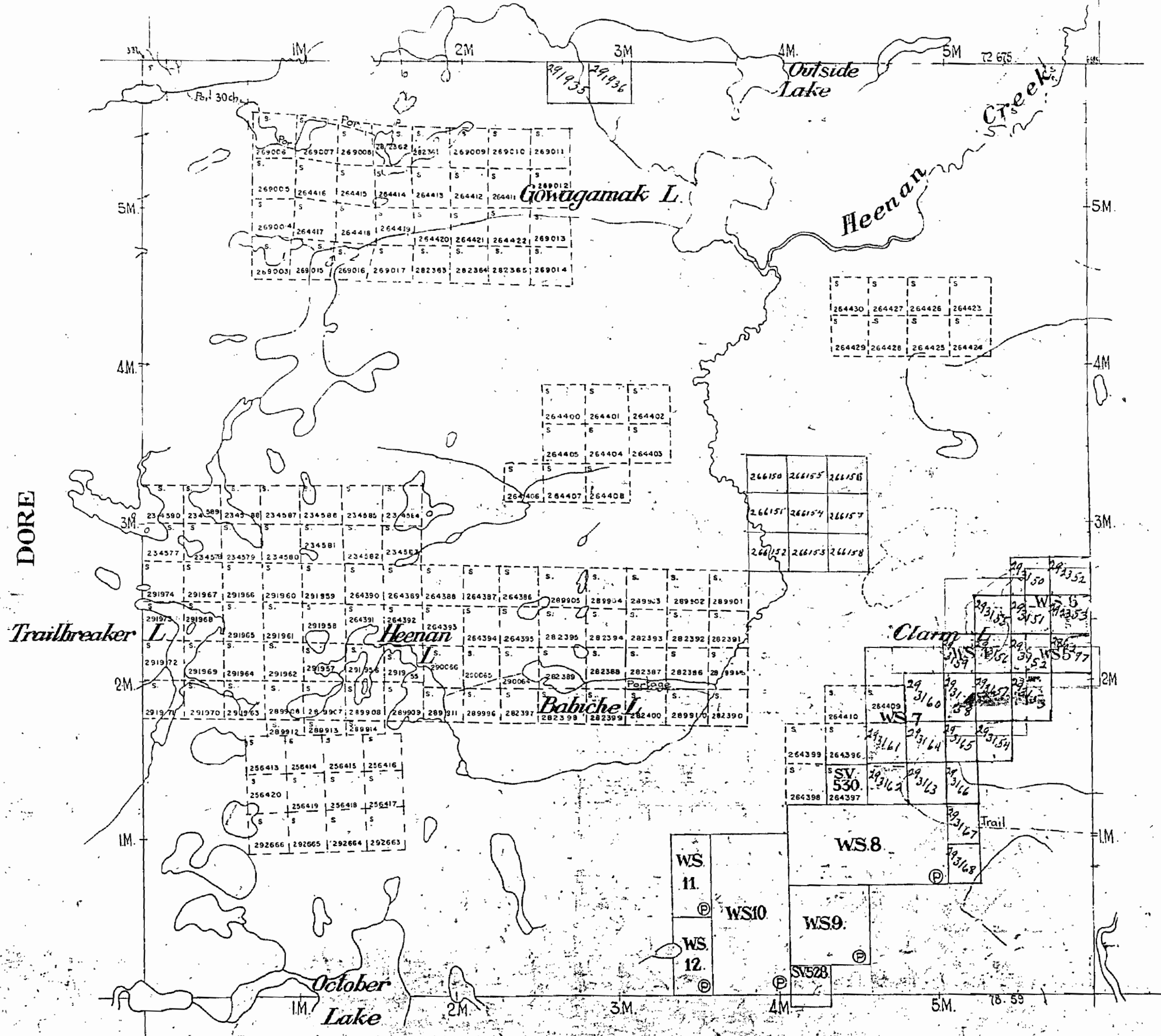

BENTON

925

# HEENAN

## DISTRICT OF SUDBURY

Scale - 40 Chains - 1 Inch

### NEWTON

North Ast

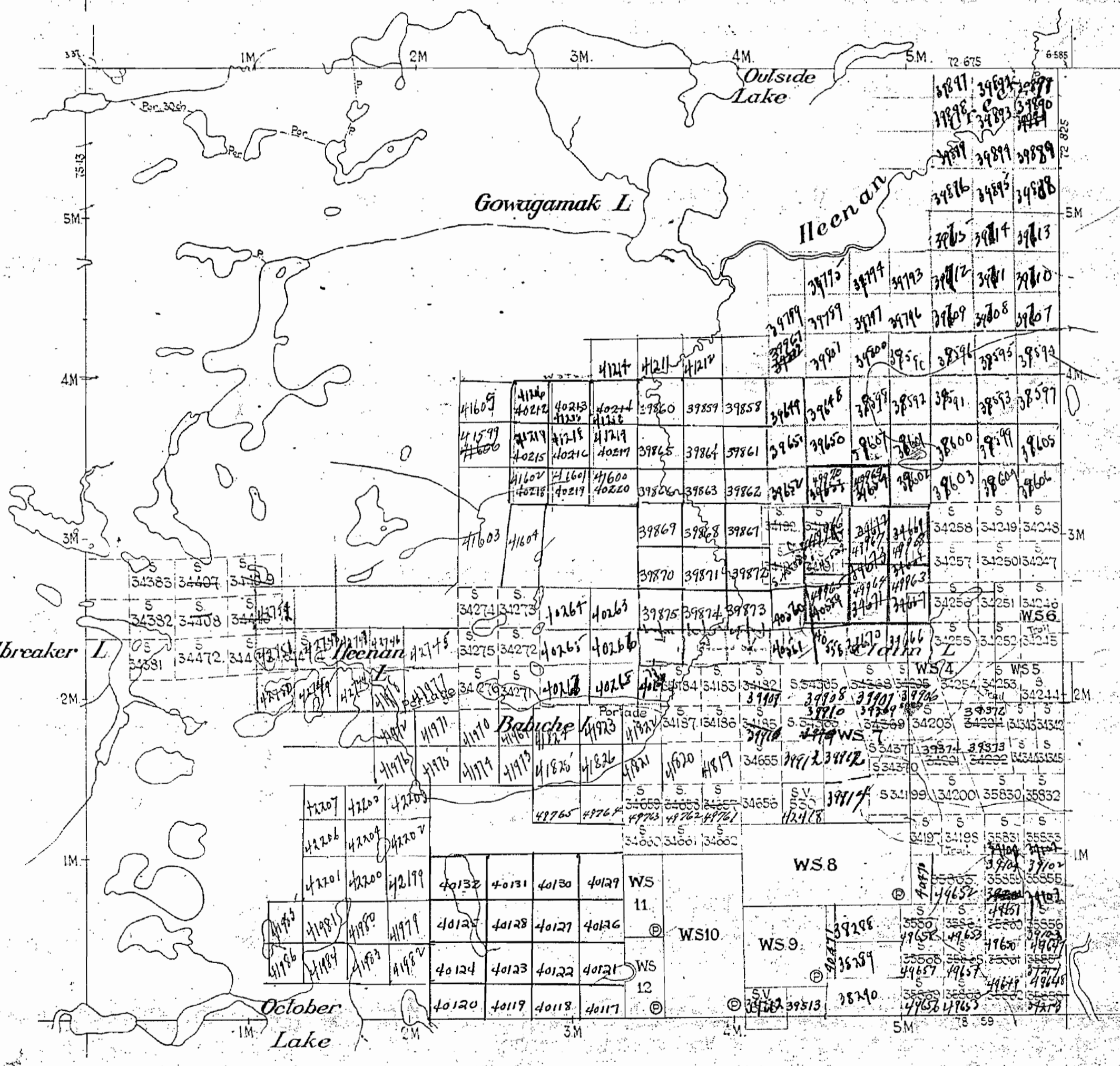

DORE

MARION

### BENTON

# M 925

DATE OF ISSUE  
 JAN 23 1942

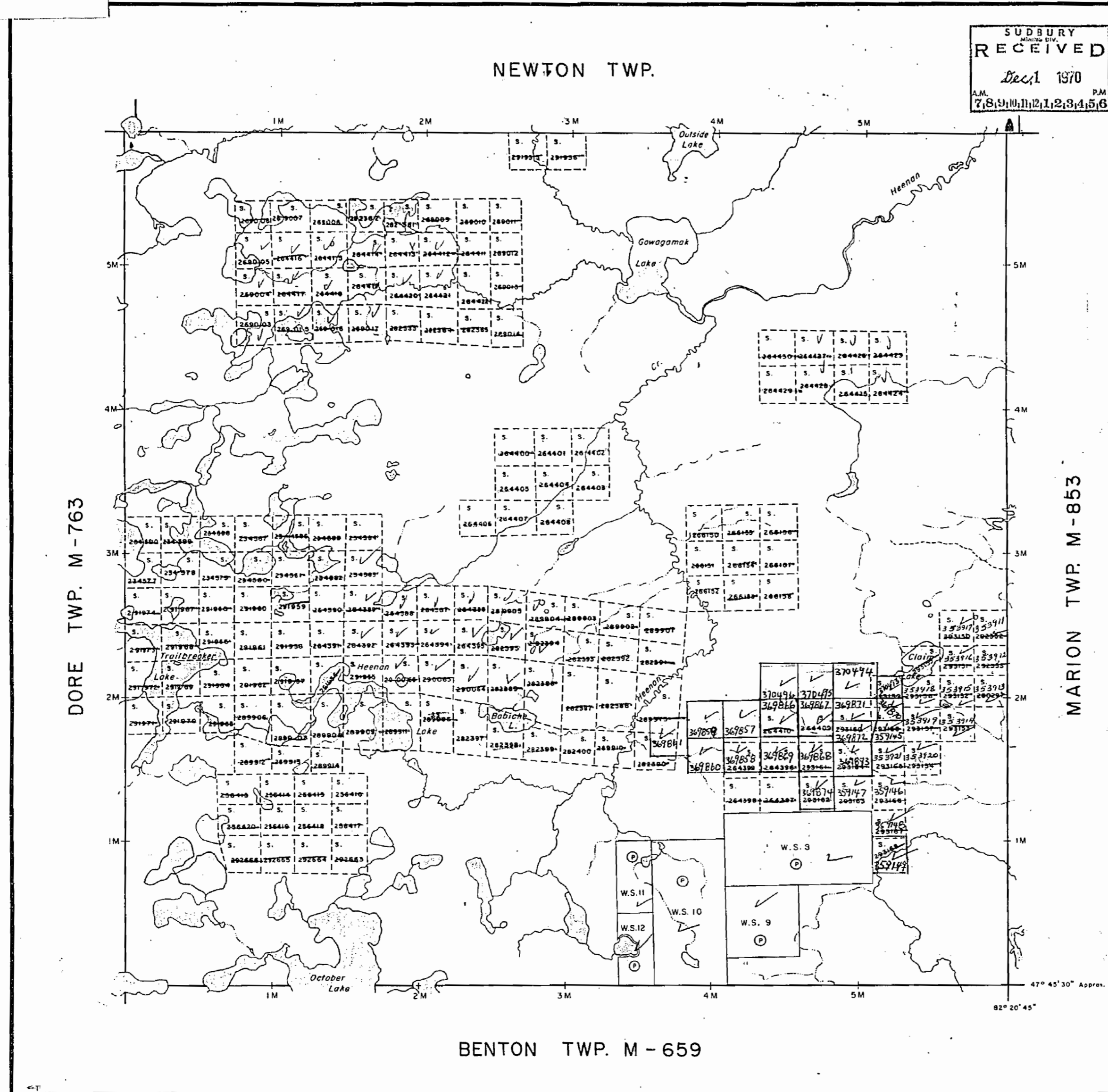

THE TOWNSHIP  
OF  
**HEENAN**

DISTRICT OF  
SUBBURY

SUBBURY  
MINING DIVISION

SCALE: 1-INCH 40 CHAINS

**LEGEND**

PATENTED LAND	(P)
CROWN LAND SALE	(C.S.)
LEASES	(L)
LOCATED LAND	(Loc.)
LICENSE OF OCCUPATION	(L.O.)
MINING RIGHTS ONLY	(M.R.O.)
SURFACE RIGHTS ONLY	(S.R.O.)
ROADS	(---)
IMPROVED ROADS	(=)
KING'S HIGHWAYS	(=)
RAILWAYS	(=)
POWER LINES	(=)
MARSH OR MUSKEG	(=)
MINES	(X)
CANCELLED	(C)

**NOTES**

400' Surface rights reservation around the shores of all lakes and rivers.

PLAN NO. **M-925**

**ONTARIO  
DEPARTMENT OF MINES  
AND NORTHERN AFFAIRS**