

INDEX TO LAND DISPOSITION

PLAN
G-3105
 TOWNSHIP

M.N.R. ADMINISTRATIVE DISTRICT
SAULT STE. MARIE
 MINING DIVISION
SAULT STE. MARIE
 LAND TITLES/REGISTRY DIVISION
ALGOMA

HERRICK

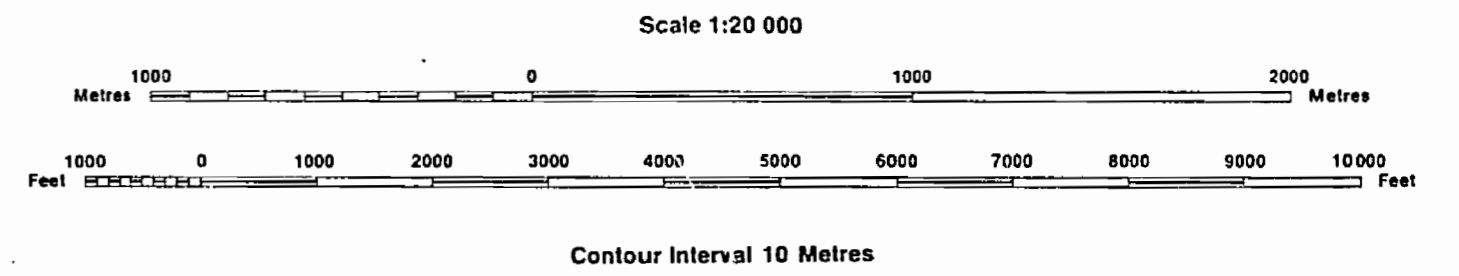

AREAS WITHDRAWN FROM DISPOSITION

- MRO - Mining Rights Only
- SRO - Surface Rights Only
- M + S - Mining and Surface Rights

Description	Order No.	Date	Disposition	File

SYMBOLS

- Boundary
- Township, Meridian, Baseline
- Road allowance; surveyed
- shoreline
- Lot/Concession; surveyed
- unsurveyed
- Parcel; surveyed
- unsurveyed
- Right-of-way; road
- railway
- utility
- Reservation
- Cliff, Pit, Pile
- Contour
- Interpolated
- Approximate
- Depression
- Control point (horizontal)
- Flooded land
- Mine head frame
- Pipeline (above ground)
- Railway; single track
- double track
- abandoned
- Road; highway, county, township
- access
- trail, bush
- Shoreline (original)
- Transmission line
- Wooded area

NOTES

- (A) Surface and Mining Rights controlled by the Crown (Canada).
 - (G.S.) Gold and Silver only controlled by the Crown (Canada).
 - (M) All Mining Rights controlled by the Crown (Canada).
- Enquiries regarding (A), (G.S.) and (M), should be Directed to the Director Lands, Revenues and Trusts, Ontario Region, Department of Indian and Northern Affairs.

Land under Lake Superior withdrawn from Staking by Order in Council dated 30th April, 1912.

DISPOSITION OF CROWN LANDS

- Patent
- Surface & Mining Rights
- Surface Rights Only
- Mining Rights Only
- Lease
- Surface & Mining Rights
- Surface Rights Only
- Mining Rights Only
- Licence of Occupation
- Order-in-Council
- Cancelled
- Reservation
- Sand & Gravel

THE INFORMATION THAT APPEARS ON THIS MAP HAS BEEN COMPILED FROM VARIOUS SOURCES AND ACCURACY IS NOT GUARANTEED. THOSE WISHING TO STAKE MINING CLAIMS SHOULD CONSULT WITH THE MINING RECORDER, MINISTRY OF NORTHERN DEVELOPMENT AND MINES, FOR ADDITIONAL INFORMATION ON THE STATUS OF THE LANDS SHOWN HEREON.

The 1925 Magnetic Bearings
 Approx. 12' Annual Change
 10' Crossing 10'

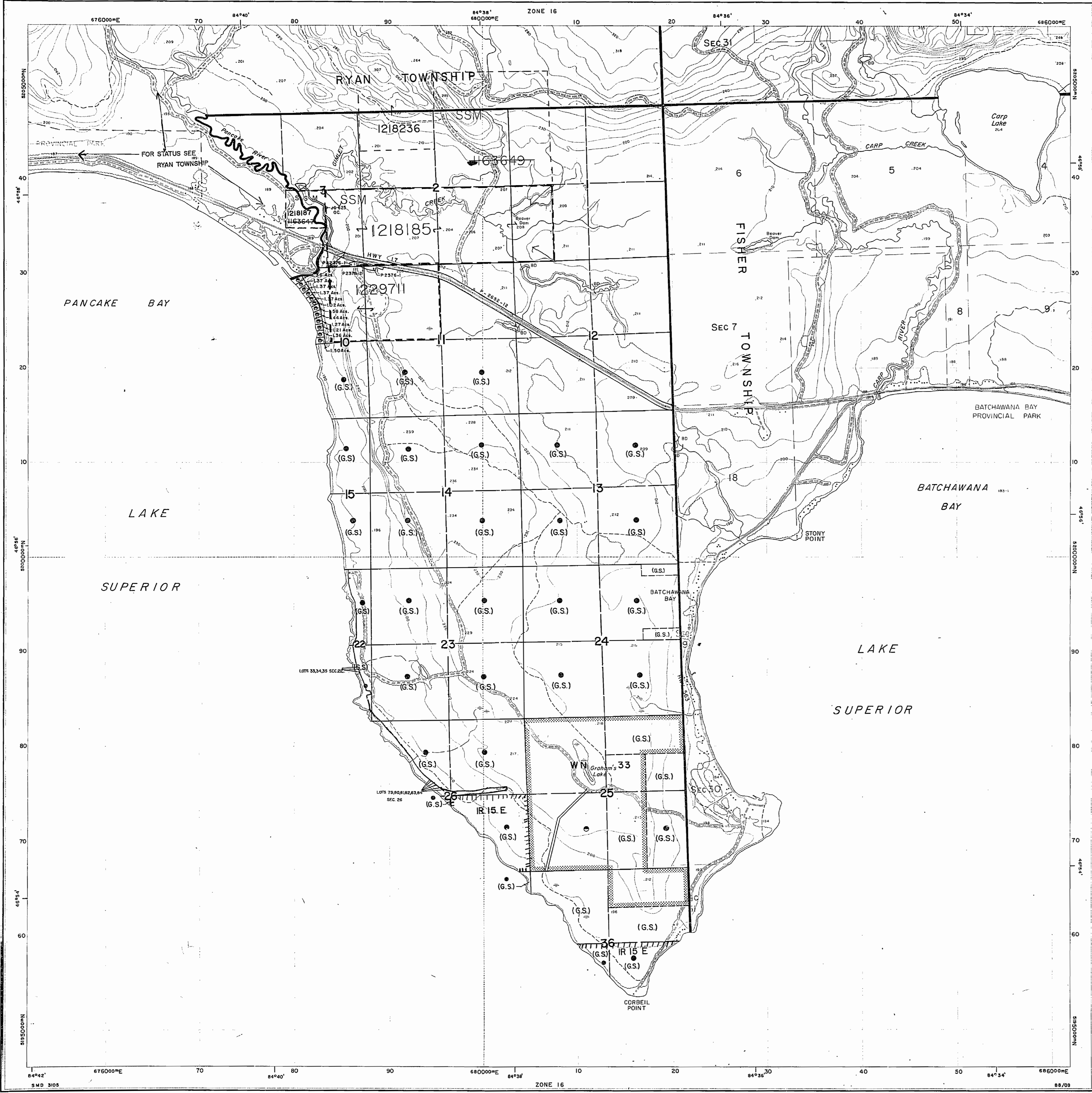
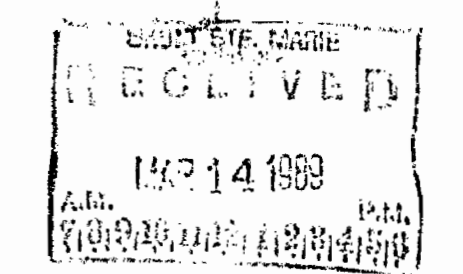

C-3102

HERBICK TWP

C-3102

C-3102

HERBICK TWP

C-3102

REFERENCES

AREAS WITHDRAWN FROM DISPOSITION

- M.R.O. - MINING RIGHTS ONLY
- S.R.O. - SURFACE RIGHTS ONLY
- M.+S. - MINING AND SURFACE RIGHTS

Description	Order No.	Date	Disposition	File

NOTES

- (A) - Surface & Mining Rights controlled by the Crown (Canada)
 - (G.S.) - Gold & Silver only controlled by the Crown (Canada).
 - (M) All mining rights controlled by the Crown (Canada).
- Enquiries regarding (A), (G.S.) & (M), should be directed to The Chief, Reserves and Trusts, Indian Affairs Branch Dept. of Citizenship and Immigration, Ottawa.

Land under Lake Superior withdrawn from staking by Order in Council dated 30th April, 1912

600 feet on each side of the centre line of hwy. 17 reserved from disposition by Order in Council dated 9 Nov., 1939.

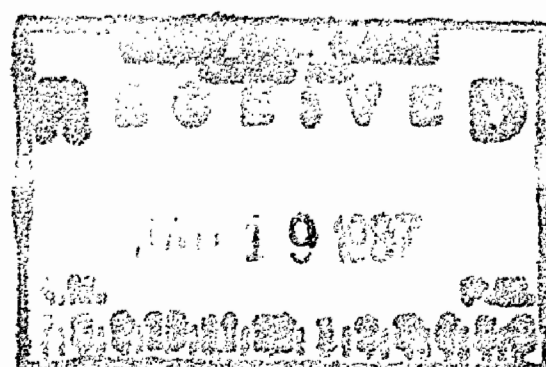

RYAN TWP.

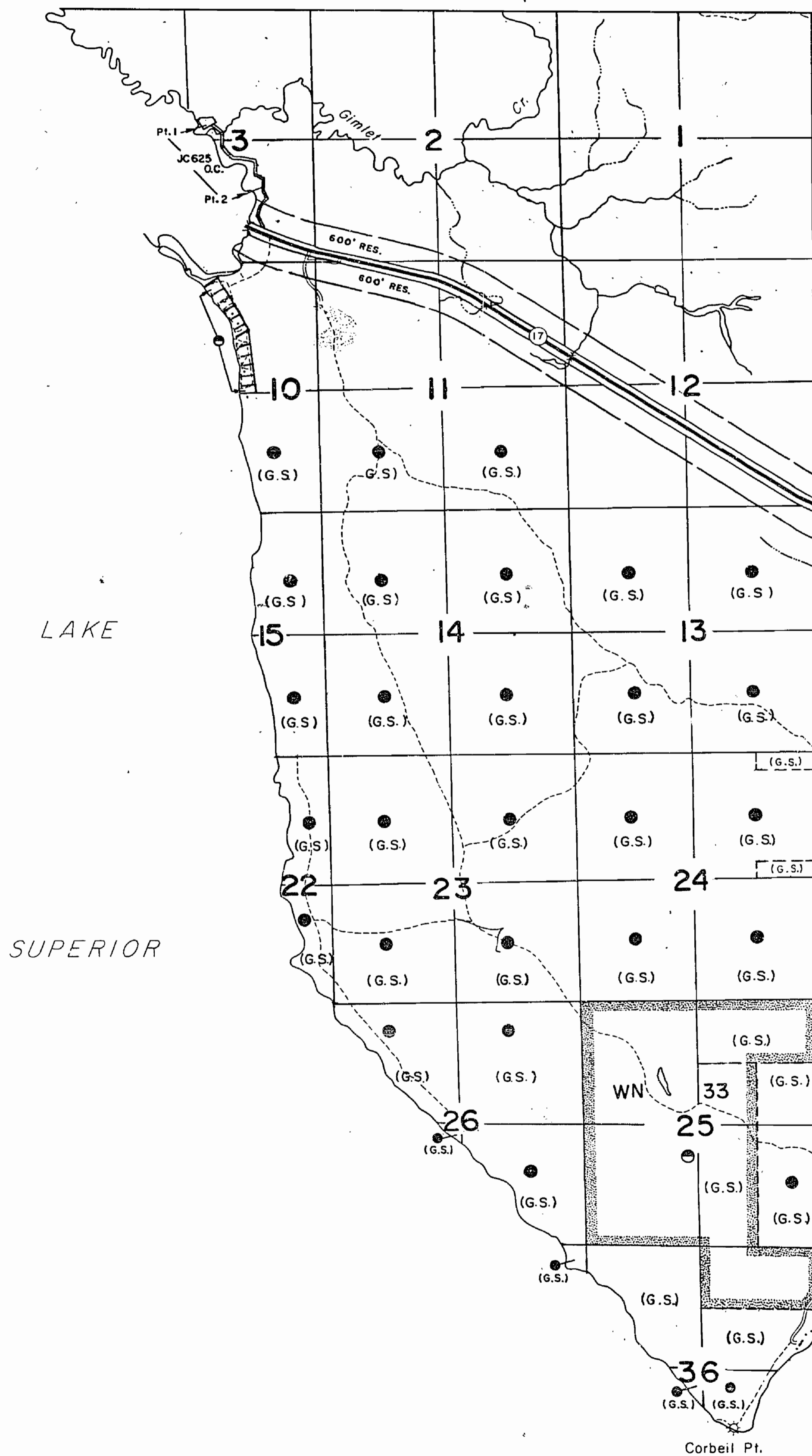

LEGEND

- HIGHWAY AND ROUTE No.
- OTHER ROADS
- TRAILS
- SURVEYED LINES:
 - TOWNSHIPS, BASE LINES, ETC.
 - LOTS, MINING CLAIMS, PARCELS, ETC.
- UNSURVEYED LINES:
 - LOT LINES
 - PARCEL BOUNDARY
 - MINING CLAIMS ETC.
- RAILWAY AND RIGHT OF WAY
- UTILITY LINES
- NON-PERENNIAL STREAM
- FLOODING OR FLOODING RIGHTS
- SUBDIVISION OR COMPOSITE PLAN
- RESERVATIONS
- ORIGINAL SHORELINE
- MARSH OR MUSKEG
- MINES
- TRAVERSE MONUMENT

DISPOSITION OF CROWN LANDS

TYPE OF DOCUMENT	SYMBOL
PATENT, SURFACE & MINING RIGHTS	
" SURFACE RIGHTS ONLY	
" MINING RIGHTS ONLY	
LEASE, SURFACE & MINING RIGHTS	
" SURFACE RIGHTS ONLY	
" MINING RIGHTS ONLY	
LICENCE OF OCCUPATION	
ORDER-IN-COUNCIL	OC
RESERVATION	
CANCELLED	
SAND & GRAVEL	

NOTE: MINING RIGHTS IN PARCELS PATENTED PRIOR TO MAY 6, 1913, VESTED IN ORIGINAL PATENTEE BY THE PUBLIC LANDS ACT, R.S.O. 1970, CHAP. 380, SEC. 63, SUBSEC 1.

SCALE: 1 INCH = 40 CHAINS

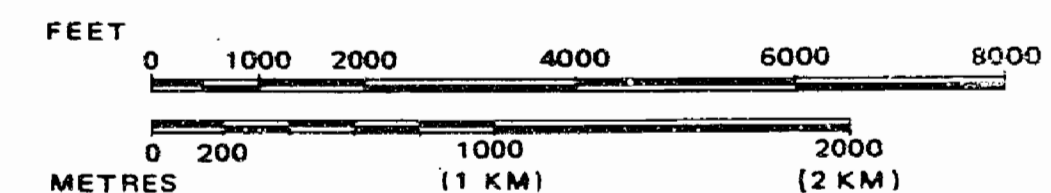

TOWNSHIP

HERRICK

M.N.R. ADMINISTRATIVE DISTRICT
SAULT STE. MARIE
MINING DIVISION

SAULT STE. MARIE
LAND TITLES / REGISTRY DIVISION
ALGOMA

Ministry of Natural Resources
Ministry of Northern Development and Mines

Date NOVEMBER, 1966

Number
G-3105

replaced by OBM - March 14/89 PP.