

NOTES

400' surface rights reservation along the shores of all lakes and rivers.

934

FAWN TWP. M.804

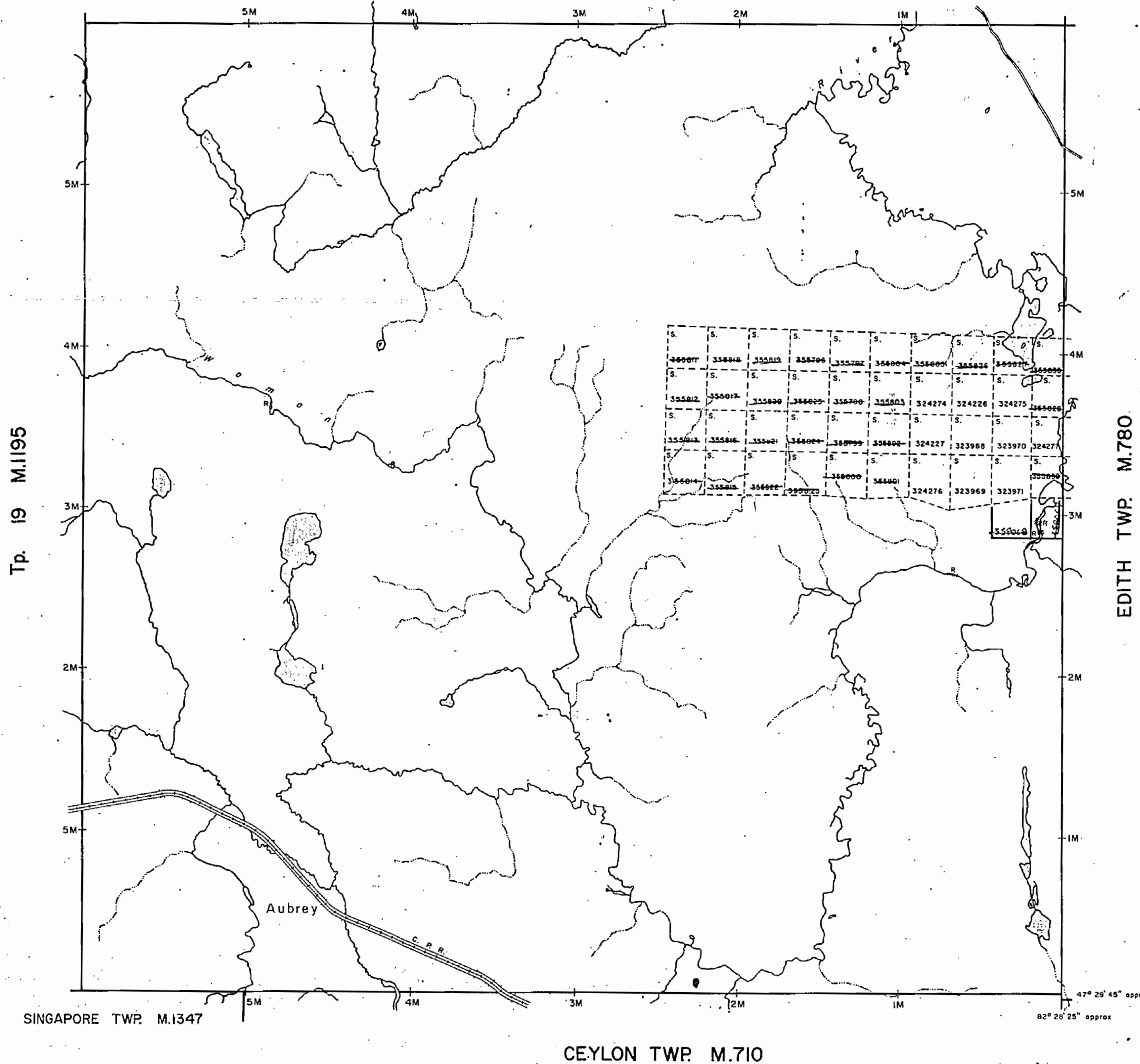

LEGEND

- HIGHWAY AND ROUTE No.
- OTHER ROADS
- TRAILS
- SURVEYED LINES:
  - TOWNSHIPS, BASE LINES, ETC
  - LOTS, MINING CLAIMS, PARCELS, ETC
- UNSURVEYED LINES:
  - LOT LINES
  - PARCEL BOUNDARY
  - MINING CLAIMS ETC
- RAILWAY AND RIGHT OF WAY
- UTILITY LINES
- NON-PERENNIAL STREAM
- FLOODING OR FLOODING RIGHTS
- SUBDIVISION
- ORIGINAL SHORELINE
- MARSH OR MUSKEL
- MINES

DISPOSITION OF CROWN LANDS

| TYPE OF DOCUMENT                | SYMBOL |
|---------------------------------|--------|
| PATENT, SURFACE & MINING RIGHTS |        |
| " SURFACE RIGHTS ONLY           |        |
| " MINING RIGHTS ONLY            |        |
| LEASE, SURFACE & MINING RIGHTS  |        |
| " SURFACE RIGHTS ONLY           |        |
| " MINING RIGHTS ONLY            |        |
| LICENCE OF OCCUPATION           |        |
| CROWN LAND SALE                 | CS     |
| ORDER-IN-COUNCIL                | OC     |
| RESERVATION                     |        |
| CANCELLED                       |        |
| SAND & GRAVEL                   |        |
| L.U.P.                          |        |

SCALE: 1 INCH = 40 CHAINS

FEET 0 500 1000 2000 4000 8000

METRES 0 200 400 600 800 1400 2800

| ACRES | HECTARES |
|-------|----------|
| 40    | 16       |

TOWNSHIP

**HONG KONG**

DISTRICT

SUDBURY

MINING DIVISION *Porcupine*

~~SUDBURY~~

ONTARIO

MINISTRY OF NATURAL RESOURCES

SURVEYS AND MAPPING BRANCH

DATE OCTOBER 1972 PLAN No. M.934

WHITNEY BLOCK QUEEN'S PARK, TORONTO

RH

934

# HONGKONG TWP. M 1934 FORMERLY TWP 18

## DISTRICT OF SUDBURY. SUDBURY MINING DIVISION.



**NOTE**

400' Surface Rights Reservation  
around all Lakes and Rivers.

Scale: 40 chains to an inch.

### FAWN TWP.

Run by O.L.S. McRuslan & Anderson 1921.  
4 M AST 3 M WEST 2 M

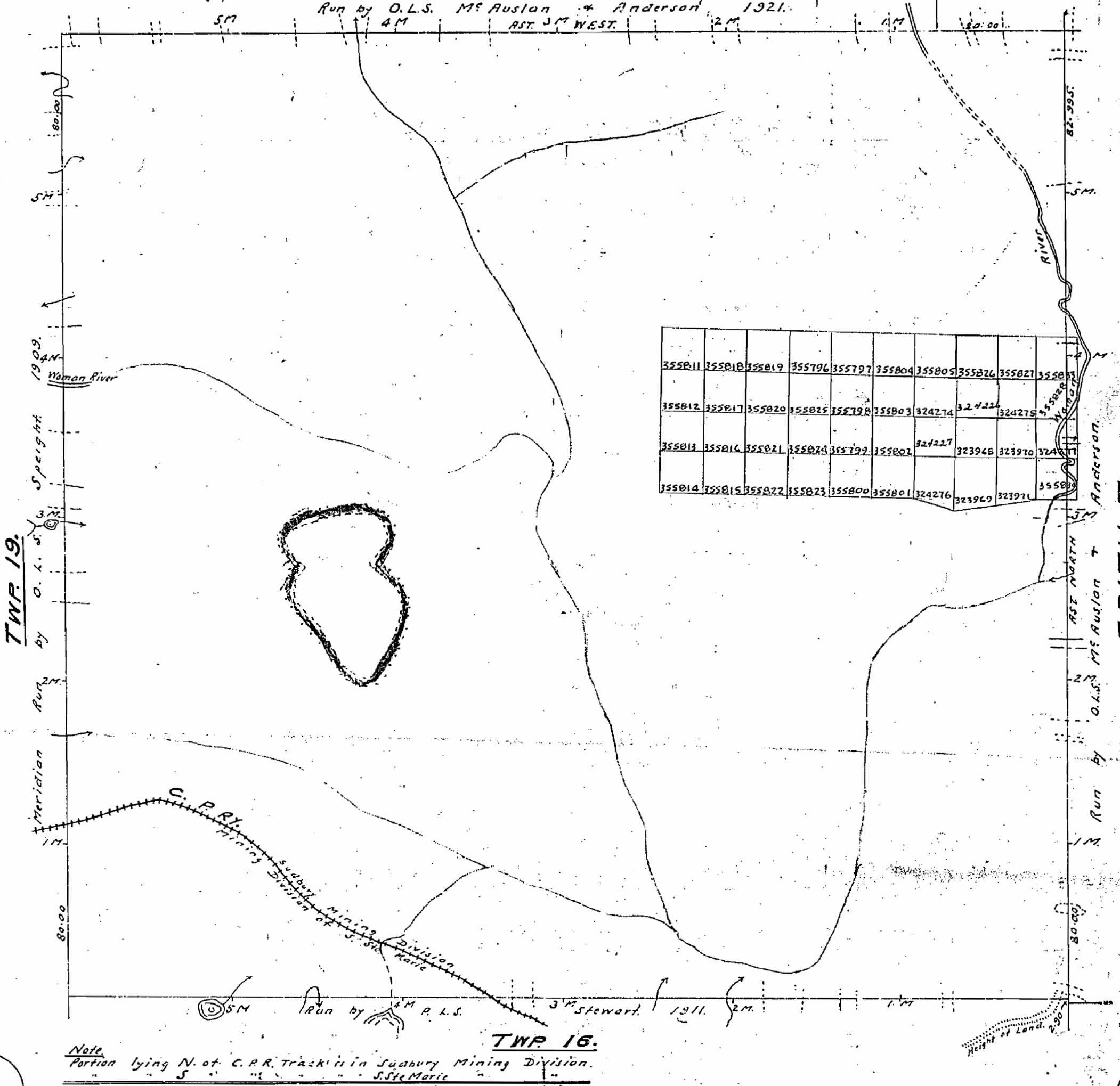

|        |        |        |        |        |        |        |        |        |        |
|--------|--------|--------|--------|--------|--------|--------|--------|--------|--------|
| 355811 | 355818 | 355819 | 355796 | 355797 | 355804 | 355805 | 355826 | 355821 | 355813 |
| 355812 | 355817 | 355820 | 355825 | 355798 | 355803 | 324274 | 324224 | 324275 | 355822 |
| 355813 | 355816 | 355821 | 355824 | 355799 | 355802 | 324227 | 323948 | 323970 | 324276 |
| 355814 | 355815 | 355822 | 355823 | 355800 | 355801 | 324276 | 323949 | 323971 | 355823 |

TWP 19.

Run by O.L.S. Speight 1909.

1909.

Woman River

Meridian

1 M

80.00

C.P.R. Mining Division  
Sudbury Mining Division  
of S. Ste Marie

Run by O.L.S. Ste Marie

3 M Stewart 1911 2 M

TWP 16.

Note: Portion lying N. of C.P.R. Tracks is in Sudbury Mining Division.  
S. Ste Marie

EDITH TWP.

Run by O.L.S. McRuslan & Anderson.

AST NORTH

2 M

1 M

80.00

Height of Land 450

NOTES

400' surface rights reservation along the shores of all lakes and rivers.

FAWN TWP. M.804

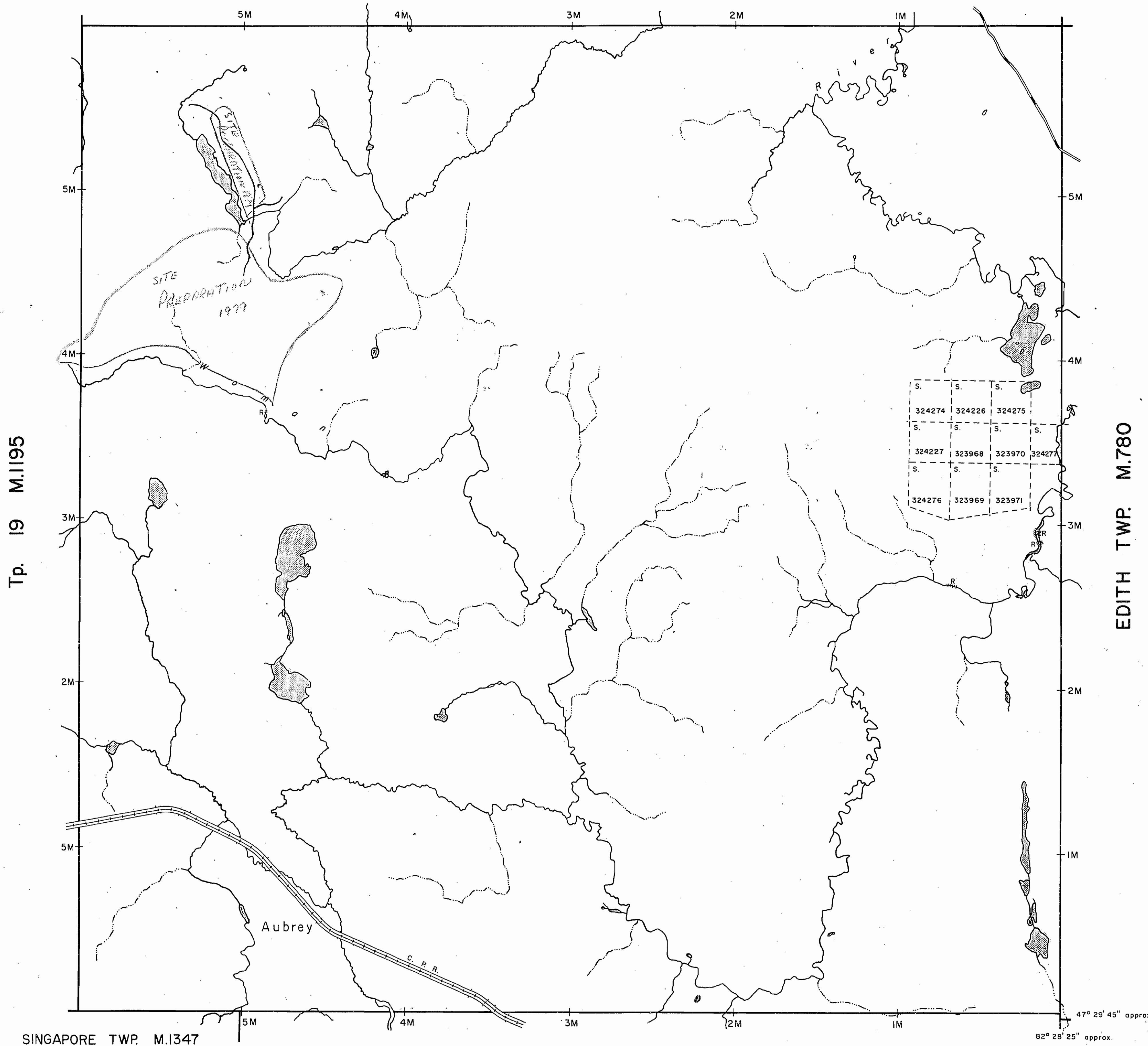

LEGEND

- HIGHWAY AND ROUTE No.
- OTHER ROADS
- TRAILS
- SURVEYED LINES:
  - TOWNSHIPS, BASE LINES, ETC
  - LOTS, MINING CLAIMS, PARCELS, ETC
- UNSURVEYED LINES:
  - LOT LINES
  - PARCEL BOUNDARY
  - MINING CLAIMS ETC
- RAILWAY AND RIGHT OF WAY
- UTILITY LINES
- NON-PERENNIAL STREAM
- FLOODING OR FLOODING RIGHTS
- SUBDIVISION
- ORIGINAL SHORELINE
- MARSH OR MUSKEG
- MINES

DISPOSITION OF CROWN LANDS

- | TYPE OF DOCUMENT                | SYMBOL |
|---------------------------------|--------|
| PATENT, SURFACE & MINING RIGHTS |        |
| " SURFACE RIGHTS ONLY           |        |
| " MINING RIGHTS ONLY            |        |
| LEASE, SURFACE & MINING RIGHTS  |        |
| " SURFACE RIGHTS ONLY           |        |
| " MINING RIGHTS ONLY            |        |
| LICENCE OF OCCUPATION           |        |
| CROWN LAND SALE                 | CS     |
| ORDER-IN-COUNCIL                | OC     |
| RESERVATION                     |        |
| CANCELLED                       |        |
| SAND & GRAVEL                   |        |

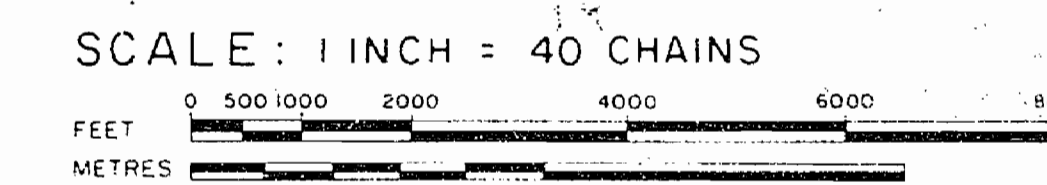
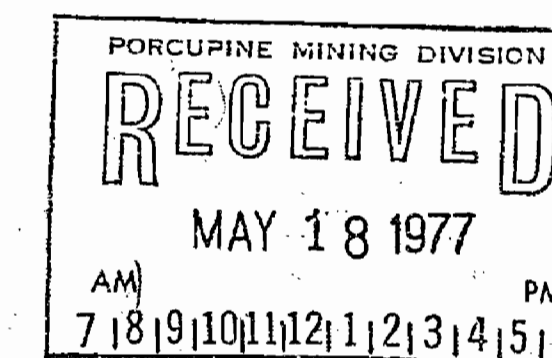

| ACRES | HECTARES |
|-------|----------|
| 40    | 16       |

TOWNSHIP  
**HONG KONG**  
 DISTRICT  
 SUDBURY  
 MINING DIVISION  
 PORCUPINE

ONTARIO  
 MINISTRY OF NATURAL RESOURCES  
 SURVEYS AND MAPPING BRANCH

DATE OCTOBER 1972 PLAN No. **M.934**  
 WHITNEY BLOCK QUEEN'S PARK, TORONTO

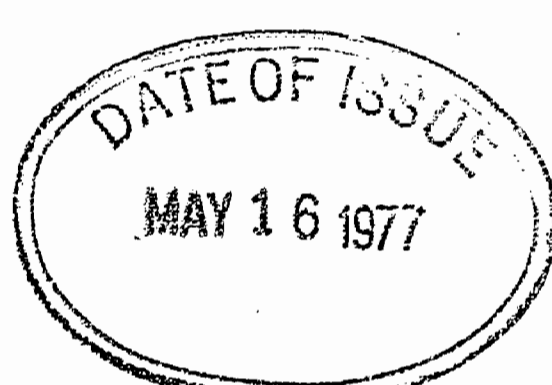

NOTES

400' surface rights reservation along the shores of all lakes and rivers.

SAND AND GRAVEL

Ⓞ QUARRY PERMIT

DATE OF ISSUE

MAY 14 1998

PROVINCIAL RECORDING OFFICE - SUDBURY

THE INFORMATION THAT APPEARS ON THIS MAP HAS BEEN COMPILED FROM VARIOUS SOURCES, AND ACCURACY IS NOT GUARANTEED. THOSE WISHING TO STAKE MINING CLAIMS SHOULD CONSULT WITH THE MINING RECORDER, MINISTRY OF NORTHERN DEVELOPMENT AND MINES, FOR ADDITIONAL INFORMATION ON THE STATUS OF THE LANDS SHOWN HEREON.

FAWN TWP. M.804

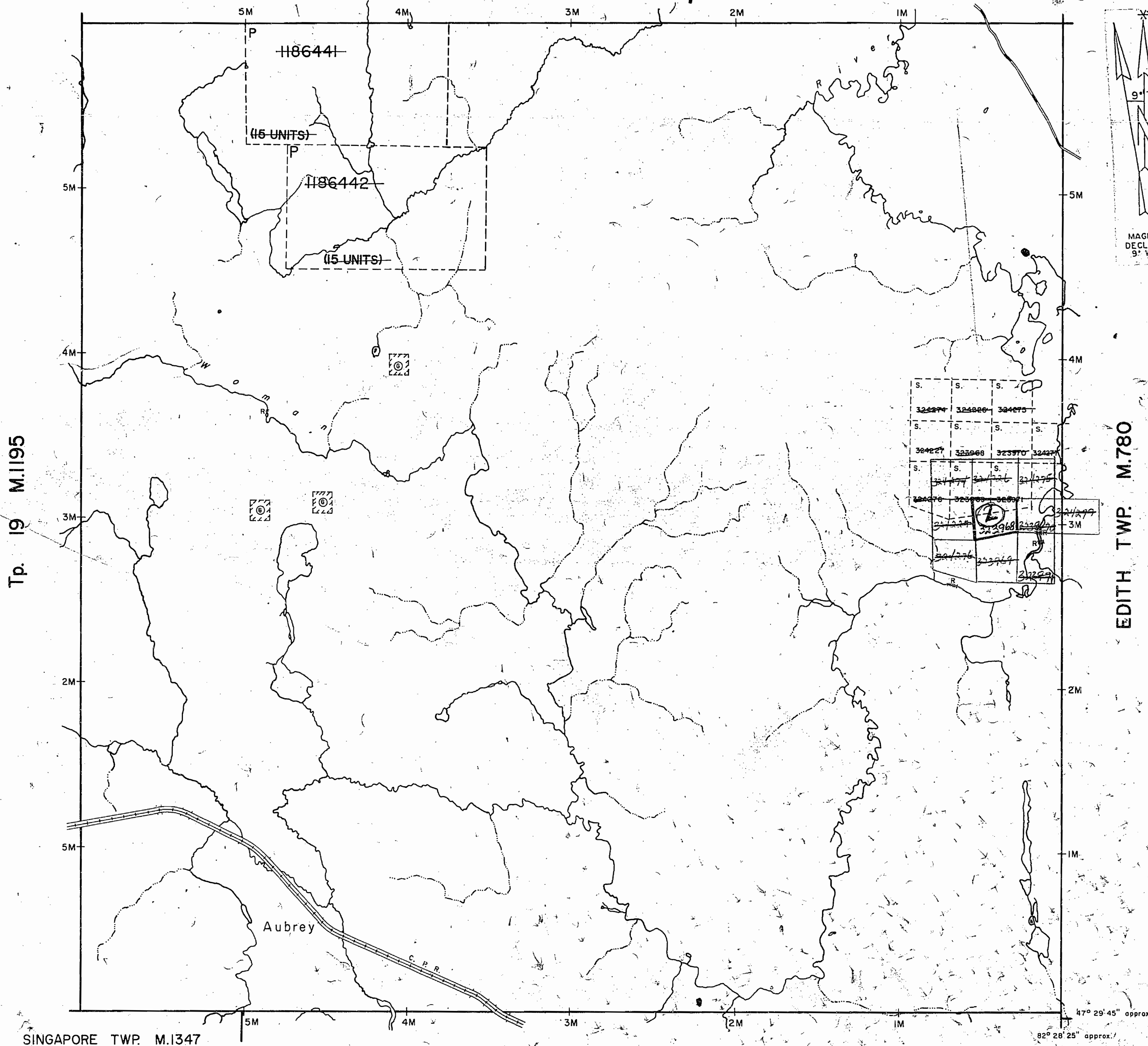

SINGAPORE TWP. M.1347

CEYLON TWP. M.710

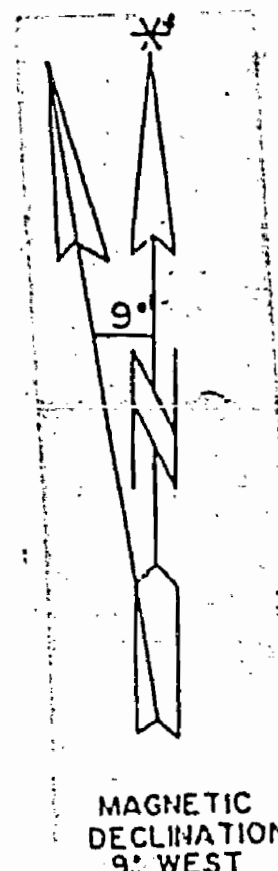

EDITH TWP. M.780

LEGEND

- HIGHWAY AND ROUTE No.
- OTHER ROADS
- TRAILS
- SURVEYED LINES:
  - TOWNSHIPS, BASE LINES, ETC.
  - LOTS, MINING CLAIMS, PARCELS, ETC.
- UNSURVEYED LINES:
  - LOT LINES
  - PARCEL BOUNDARY
  - MINING CLAIMS ETC.
- RAILWAY AND RIGHT OF WAY
- UTILITY LINES
- NON-PERENNIAL STREAM
- FLOODING OR FLOODING RIGHTS
- SUBDIVISION
- ORIGINAL SHORELINE
- MARSH OR MUSKEG
- MINES

DISPOSITION OF CROWN LANDS

| TYPE OF DOCUMENT                | SYMBOL |
|---------------------------------|--------|
| PATENT, SURFACE & MINING RIGHTS |        |
| " SURFACE RIGHTS ONLY           |        |
| " MINING RIGHTS ONLY            |        |
| LEASE, SURFACE & MINING RIGHTS  |        |
| " SURFACE RIGHTS ONLY           |        |
| " MINING RIGHTS ONLY            |        |
| LICENCE OF OCCUPATION           |        |
| CROWN LAND SALE                 | C.S.   |
| ORDER-IN-COUNCIL                | O.C.   |
| RESERVATION                     |        |
| CANCELLED                       |        |
| SAND & GRAVEL                   |        |

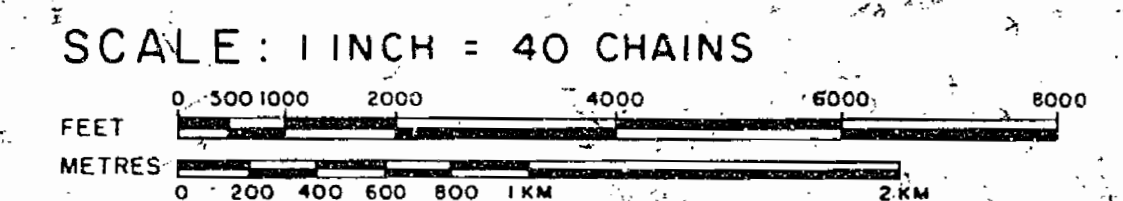

|       |          |
|-------|----------|
| ACRES | HECTARES |
| 40    | 16       |

TOWNSHIP  
**HONG KONG**  
 DISTRICT  
 SUDBURY  
 MINING DIVISION  
 PORCUPINE

Rec. Feb 11/80  
 ONTARIO  
 MINISTRY OF NATURAL RESOURCES  
 SURVEYS AND MAPPING BRANCH

DATE OCTOBER 1972 PLAN No. G-1144  
 WHITNEY BLOCK QUEEN'S PARK, TORONTO

430.M

HONG KONG TWP

430.M

NOTES

400' surface rights reservation along the shores of all lakes and rivers.

SAND AND GRAVEL

⊙ QUARRY PERMIT

THE INFORMATION THAT APPEARS ON THIS MAP HAS BEEN COMPILED FROM VARIOUS SOURCES, AND ACCURACY IS NOT GUARANTEED. THOSE WISHING TO STAKE MINING CLAIMS SHOULD CONSULT WITH THE MINING RECORDER, MINISTRY OF NORTHERN DEVELOPMENT AND MINES, FOR ADDITIONAL INFORMATION ON THE STATUS OF THE LANDS SHOWN HEREON.

FAWN TWP. M.804

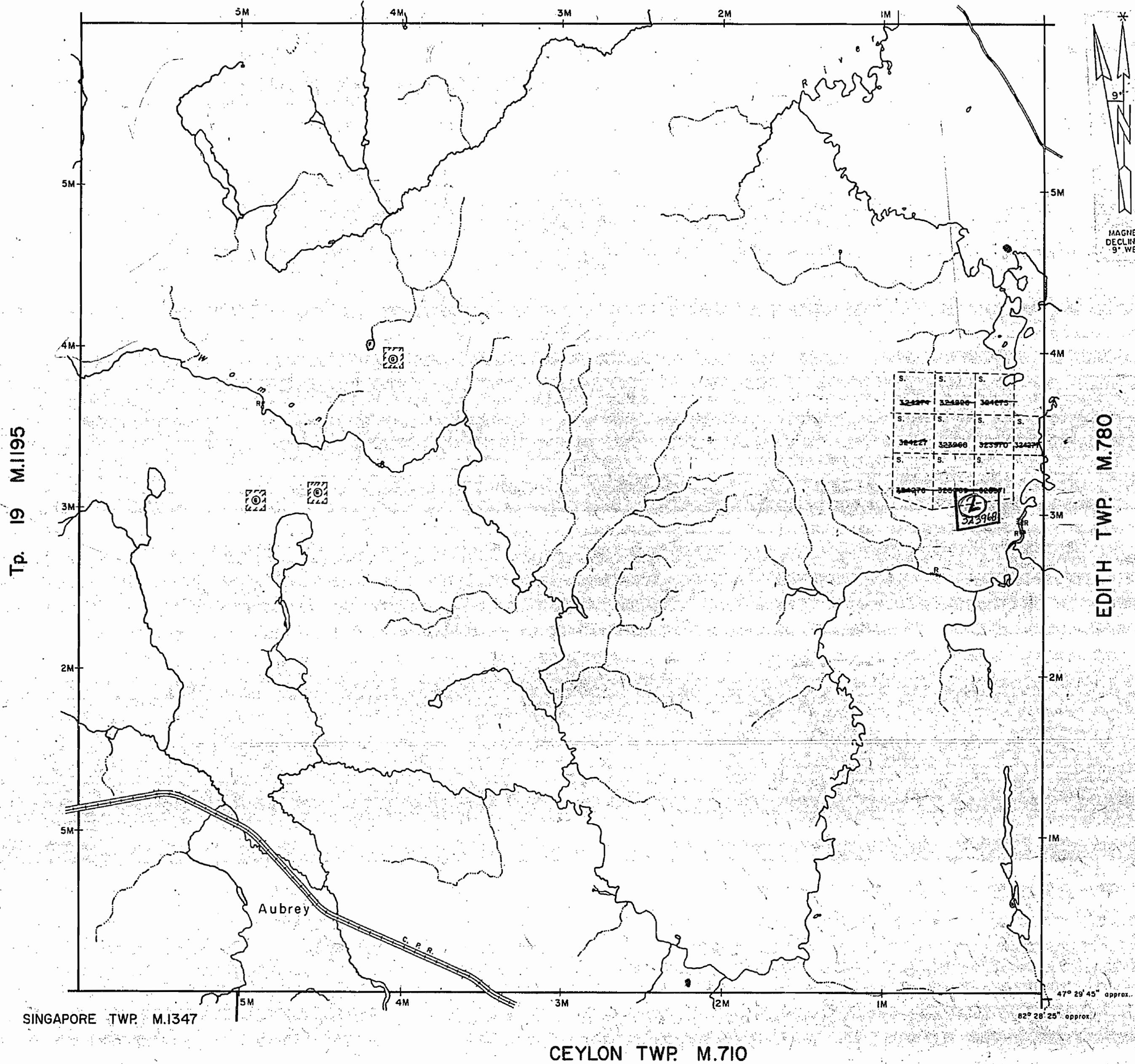

LEGEND

- HIGHWAY AND ROUTE No.
- OTHER ROADS
- TRAILS
- SURVEYED LINES:
  - TOWNSHIPS, BASE LINES, ETC
  - LOTS, MINING CLAIMS, PARCELS, ETC
- UNSURVEYED LINES:
  - LOT LINES
  - PARCEL BOUNDARY
  - MINING CLAIMS ETC
- RAILWAY AND RIGHT OF WAY
- UTILITY LINES
- NON-PERENNIAL STREAM
- FLOODING OR FLOODING RIGHTS
- SUBDIVISION
- ORIGINAL SHORELINE
- MARSH OR MUSKEG
- MINES

DISPOSITION OF CROWN LANDS

| TYPE OF DOCUMENT                | SYMBOL |
|---------------------------------|--------|
| PATENT, SURFACE & MINING RIGHTS |        |
| " SURFACE RIGHTS ONLY           |        |
| " MINING RIGHTS ONLY            |        |
| LEASE, SURFACE & MINING RIGHTS  |        |
| " SURFACE RIGHTS ONLY           |        |
| " MINING RIGHTS ONLY            |        |
| LICENCE OF OCCUPATION           |        |
| CROWN LAND SALE                 | C.S.   |
| ORDER-IN-COUNCIL                | .OC    |
| RESERVATION                     |        |
| CANCELLED                       |        |
| SAND & GRAVEL                   |        |

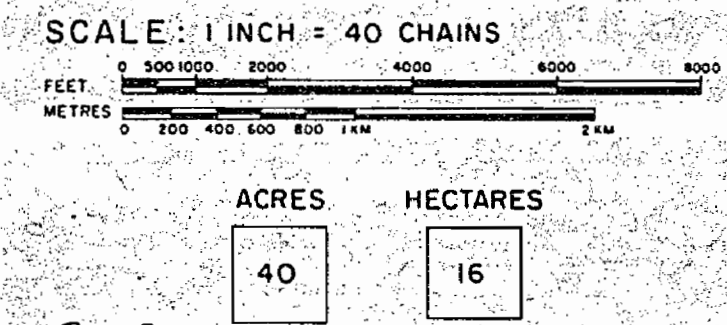

TOWNSHIP  
**HONG KONG**  
 DISTRICT  
 SUDBURY 91  
 MINING DIVISION  
 PORCUPINE

DATE: OCTOBER, 1972  
 PLAN No. **G-1144**  
 WHITNEY-BLOCK  
 QUEEN'S PARK, TORONTO

430.M

HONG KONG TWP

430.M

934

# HONGKONG TWP. M 934

## FORMERLY TWP 18.

DISTRICT OF SUDBURY.  
SUDBURY MINING DIVISION.



NOTE  
400' Surface Rights Reservation  
around all Lakes and Rivers.

Scale: 40 chains to an inch.

**FAWN TWP.**

Run by O.L.S. McAuslan & Anderson, 1921.  
4 M AST. 3 M WEST. 2 M

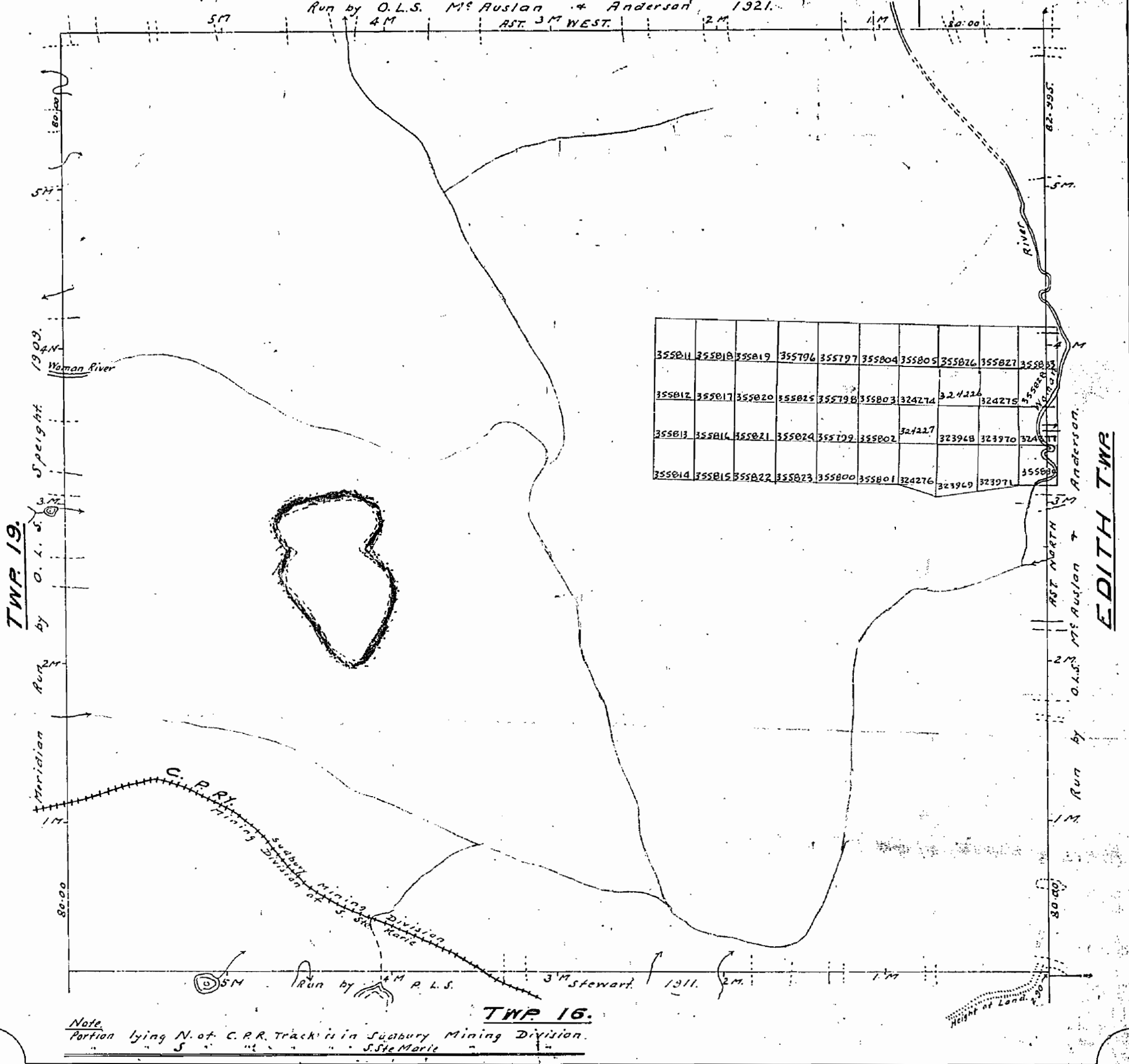

|        |        |        |        |        |        |        |        |        |        |
|--------|--------|--------|--------|--------|--------|--------|--------|--------|--------|
| 355811 | 355818 | 355819 | 355796 | 355797 | 355804 | 355805 | 355876 | 355827 | 355833 |
| 355812 | 355817 | 355820 | 355825 | 355798 | 355803 | 324274 | 324226 | 324275 | 355834 |
| 355813 | 355816 | 355821 | 355824 | 355799 | 355802 | 324227 | 323948 | 323970 | 324276 |
| 355814 | 355815 | 355822 | 355823 | 355800 | 355801 | 324276 | 323949 | 323971 | 355835 |

**TWP 19.**  
by O.L.S. Speight, 1909.

**EDITH TWP.**  
Run by O.L.S. McAuslan & Anderson, 1921.

**TWP 16.**

Note: Portion lying N. of C.P.R. Tracks is in Sudbury Mining Division.  
Run by O.L.S. Ste Marie, 1911.

NOTES

400' surface rights reservation along the shores of all lakes and rivers.

934

FAWN TWP. M.804

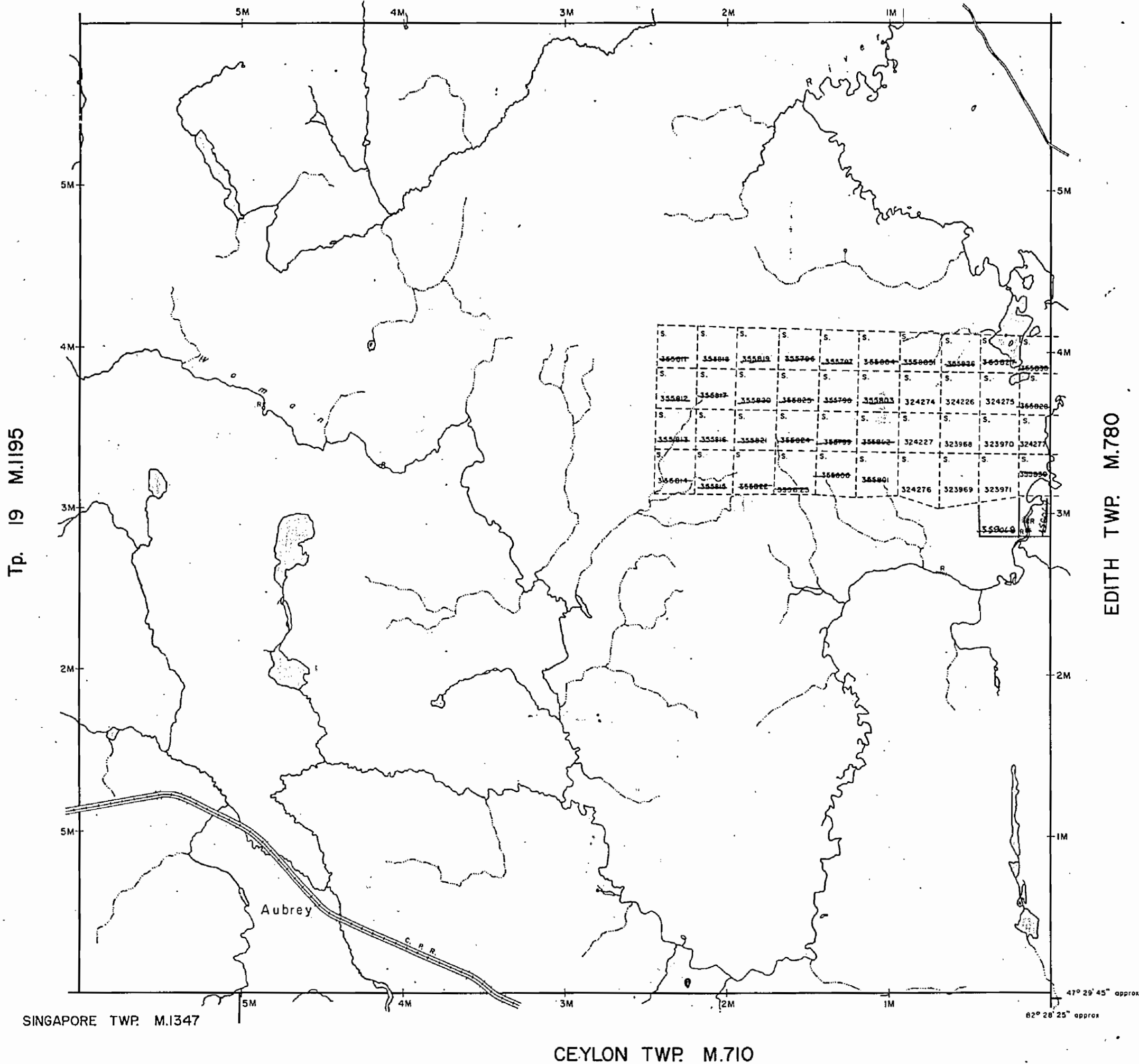

LEGEND

- HIGHWAY AND ROUTE No.
- OTHER ROADS
- TRAILS
- SURVEYED LINES:
  - TOWNSHIPS, BASE LINES, ETC
  - LOTS, MINING CLAIMS, PARCELS, ETC
- UNSURVEYED LINES:
  - LOT LINES
  - PARCEL BOUNDARY
  - MINING CLAIMS ETC
- RAILWAY AND RIGHT OF WAY
- UTILITY LINES
- NON-PERENNIAL STREAM
- FLOODING OR FLOODING RIGHTS
- SUBDIVISION
- ORIGINAL SHORELINE
- MARSH OR MUSHEG
- MINES

DISPOSITION OF CROWN LANDS

- | TYPE OF DOCUMENT                | SYMBOL |
|---------------------------------|--------|
| PATENT, SURFACE & MINING RIGHTS |        |
| " SURFACE RIGHTS ONLY           |        |
| " MINING RIGHTS ONLY            |        |
| LEASE, SURFACE & MINING RIGHTS  |        |
| " SURFACE RIGHTS ONLY           |        |
| " MINING RIGHTS ONLY            |        |
| LICENCE OF OCCUPATION           |        |
| CROWN LAND SALE                 | C.S    |
| ORDER-IN-COUNCIL                | OC     |
| RESERVATION                     |        |
| CANCELLED                       |        |
| SAND & GRAVEL                   |        |
| • L.U.P.                        |        |

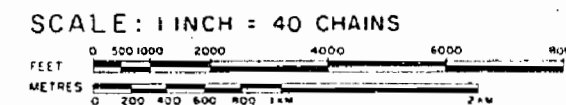

|       |          |
|-------|----------|
| ACRES | HECTARES |
| 40    | 16       |

TOWNSHIP  
**HONG KONG**  
 DISTRICT  
 SUDBURY  
 MINING DIVISION *Porcupine*  
~~SUDBURY~~

ONTARIO  
 MINISTRY OF NATURAL RESOURCES  
 SURVEYS AND MAPPING BRANCH

DATE OCTOBER 1972 PLAN No  
 WHITNEY BLOCK QUEEN'S PARK, TORONTO **M.934**

EDITH TWP. M.780

RH