

507

Cockshutt Twp.

THE TOWNSHIP OF
OF
HOWELLS

DISTRICT OF
COCHRANE

PORCUPINE
MINING DIVISION

SCALE: 1-INCH=40 CHAINS

LEGEND

- PATENTED LAND Ⓟ
- CROWN LAND SALE C.S.
- LEASES Ⓛ
- LOCATED LAND Loc.
- LICENSE OF OCCUPATION L.O.
- MINING RIGHTS ONLY M.R.O.
- SURFACE RIGHTS ONLY S.R.O.
- ROADS — — — — —
- IMPROVED ROADS = = = = =
- KING'S HIGHWAYS — — — — —
- RAILWAYS — — — — —
- POWER LINES — — — — —
- MARSH OR MUSKEG [Symbol]
- MINES X
- CANCELLED C.

NOTES

400' Reserve To Department of Lands & Forests
Shown thus: [Symbol]

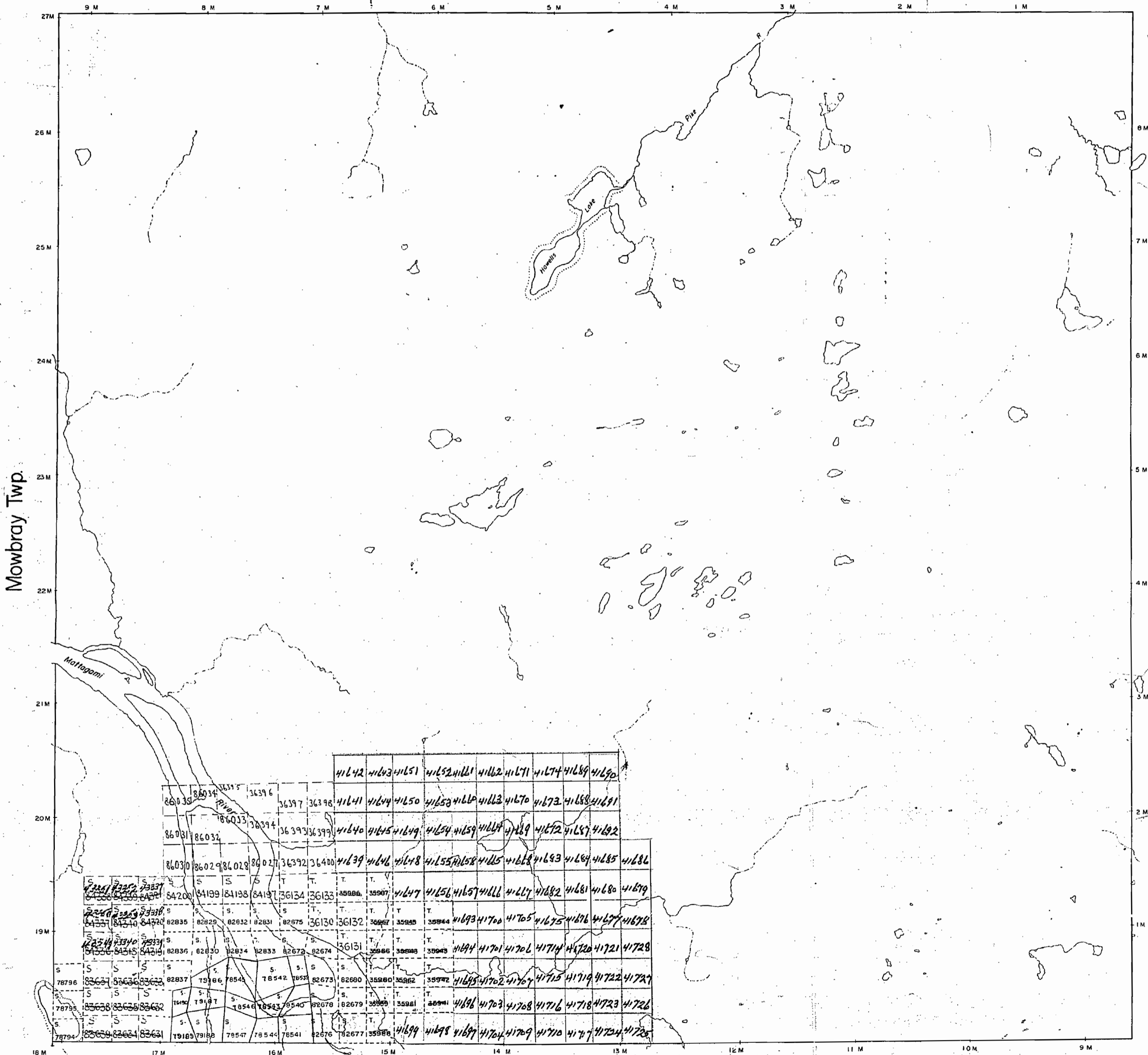

Mowbray Twp.

Sheldon Twp.

Clay Twp.

PLAN NO. **M.507**

DEPARTMENT OF MINES
— ONTARIO —

507

HOWELLS

COCHRANE DISTRICT

M-507

Scale 40 Chains = 1 Inch

COCKSHUTT

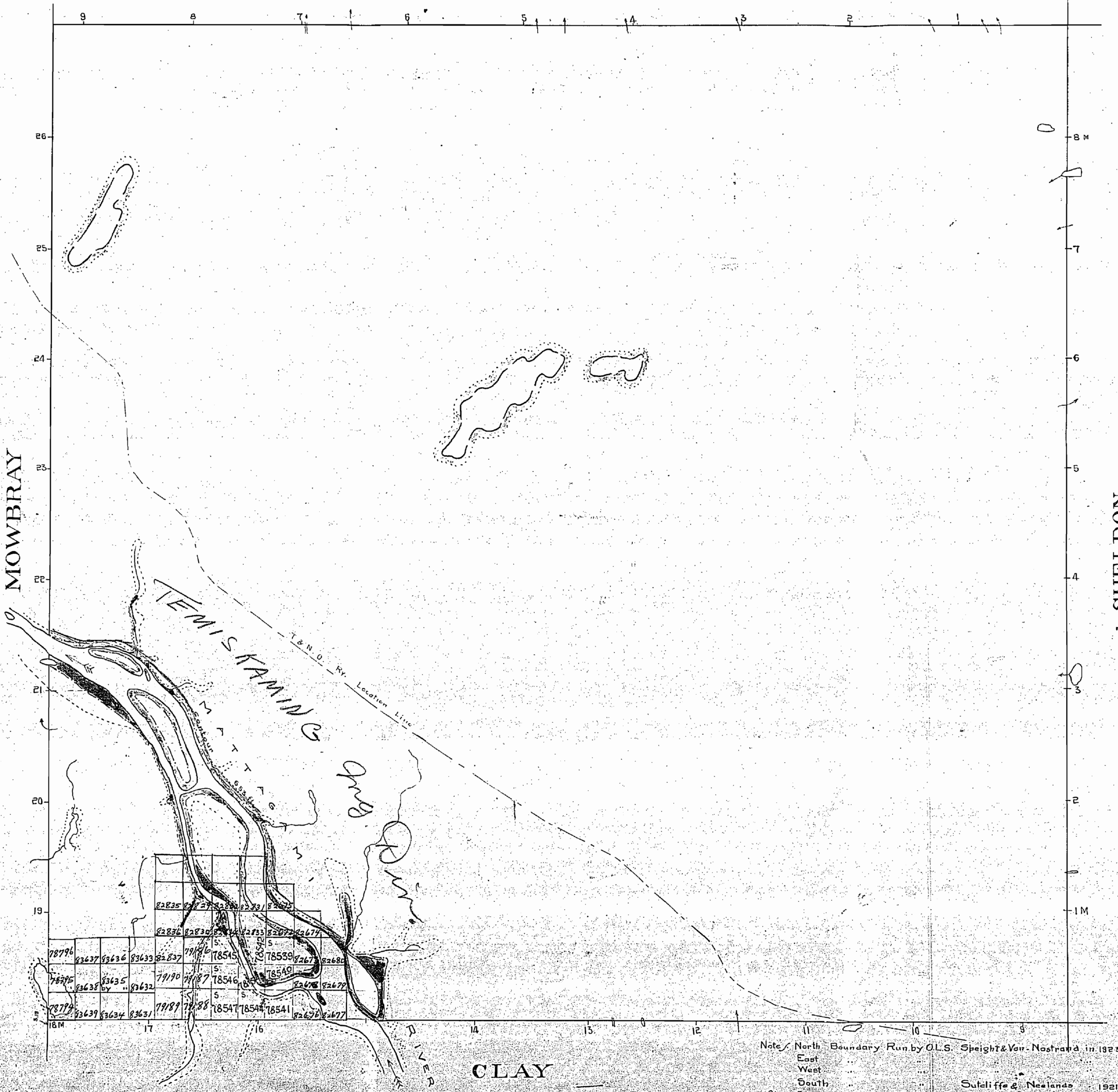

Surface reservations 400' wide by Dept. of L. & F. shown hereon thus

Note: North Boundary Run by O.L.S. Speight & Ver. Nostrand in 1875
 East
 West
 South
 River Traverse & Contour 553 shown thus by O.L.S. H.W. Sutchffe April 12th 1926

Sutcliffe & Neelands 1921

640

507

HOWELLS

COCHRANE DISTRICT

M-507

Scale 40 Chains = 1 Inch

COCKSHUTT

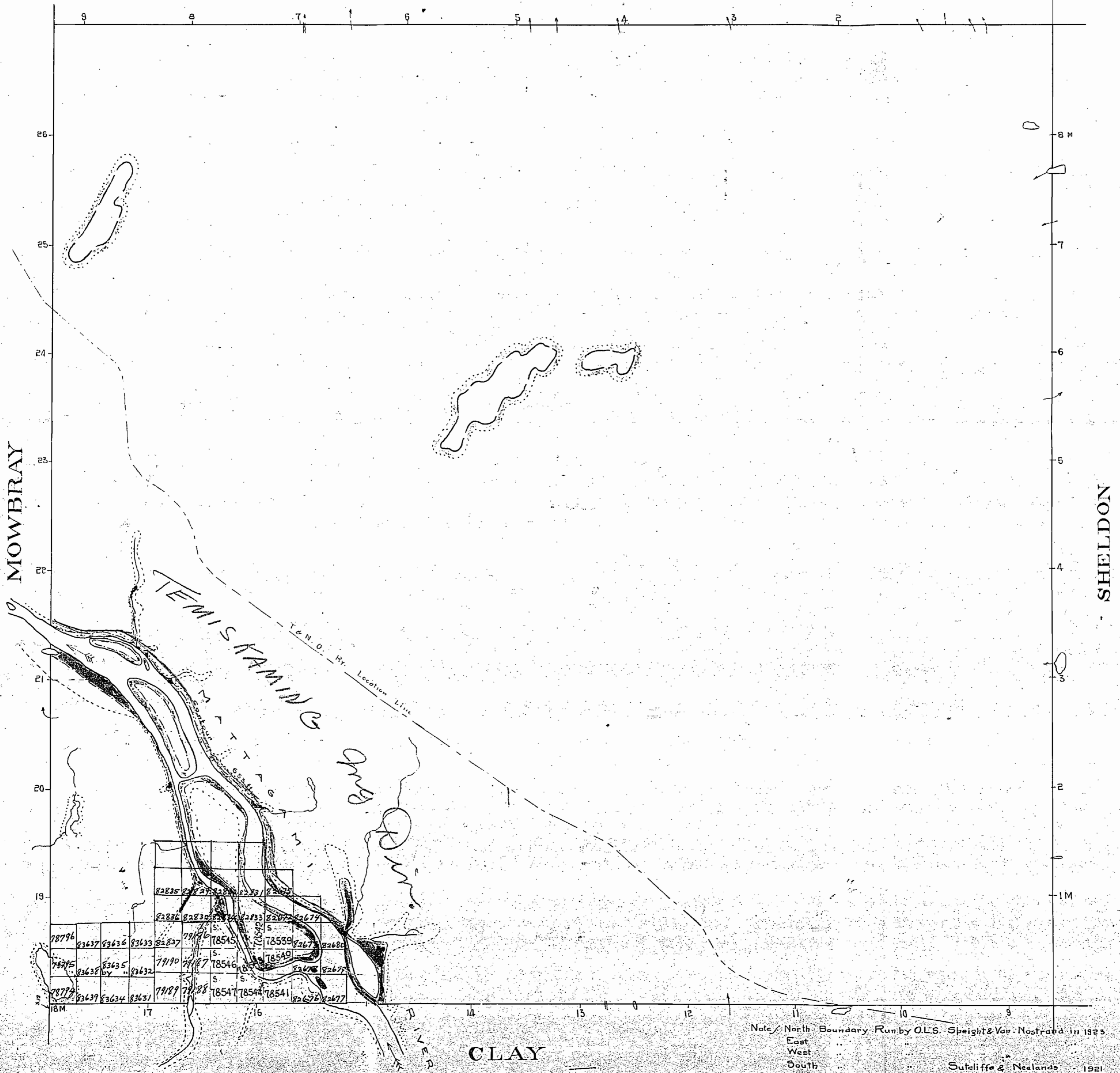

Surface elevations 400 wide by Dept of L & F shown hereon thus

Note: North Boundary Run by O.L.S. Speight & Van Nostrand in 1925.
East West South by Sutcliffe & Neelands 1921.
River Traverse & Contour 655 shown thus by O.L.S. H.W. Sutcliffe April 12th 1926 640

Cockshutt Twp.

THE TOWNSHIP OF

HOWELLS

DISTRICT OF COCHRANE

PORCUPINE MINING DIVISION

SCALE: 1-INCH=40 CHAINS

LEGEND

PATENTED LAND	Ⓢ
CROWN LAND SALE	C.S.
LEASES	Ⓛ
LOCATED LAND	Loc.
LICENSE OF OCCUPATION	L.O.
MINING RIGHTS ONLY	M.R.O.
SURFACE RIGHTS ONLY	S.R.O.
ROADS	—
IMPROVED ROADS	—
KING'S HIGHWAYS	—
RAILWAYS	—
POWER LINES	—
MARSH OR MUSKEG	—
MINES	Ⓜ
CANCELLED	C.

NOTES

400' Reserve To Department of Lands & Forests Shown thus: —

Flooding to contour 665' withdrawn from staking under Sec 39 (d) Mining Act File 145889

AREA 2000 FEET WIDE ON EITHER SIDE OF THE MATTAGAMI RIVER WITHDRAWN-I STAKING-SEC-36(d)-OF-THE-MINING ACT FILE 145889 SUBJECT TO FURTHER NOTICE

Ⓢ THIS TWP IS SUBJECT TO FOREST ACTIVITIES IN 1990. FURTHER INFORMATION AVAILABLE ON FILE.

Map Replaced Sept. 15/92 By D.C.

THE INFORMATION THAT APPEARS ON THIS MAP HAS BEEN COMPILED FROM VARIOUS SOURCES, AND ACCURACY IS NOT GUARANTEED. THOSE WISHING TO STAKE MINING CLAIMS SHOULD CONSULT WITH THE MINING RECORDER, MINISTRY OF NORTHERN DEVELOPMENT AND MINES, FOR ADDITIONAL INFORMATION ON THE STATUS OF THE LANDS SHOWN HEREON.

PLAN NO.-M.507

DEPARTMENT OF MINES — ONTARIO —

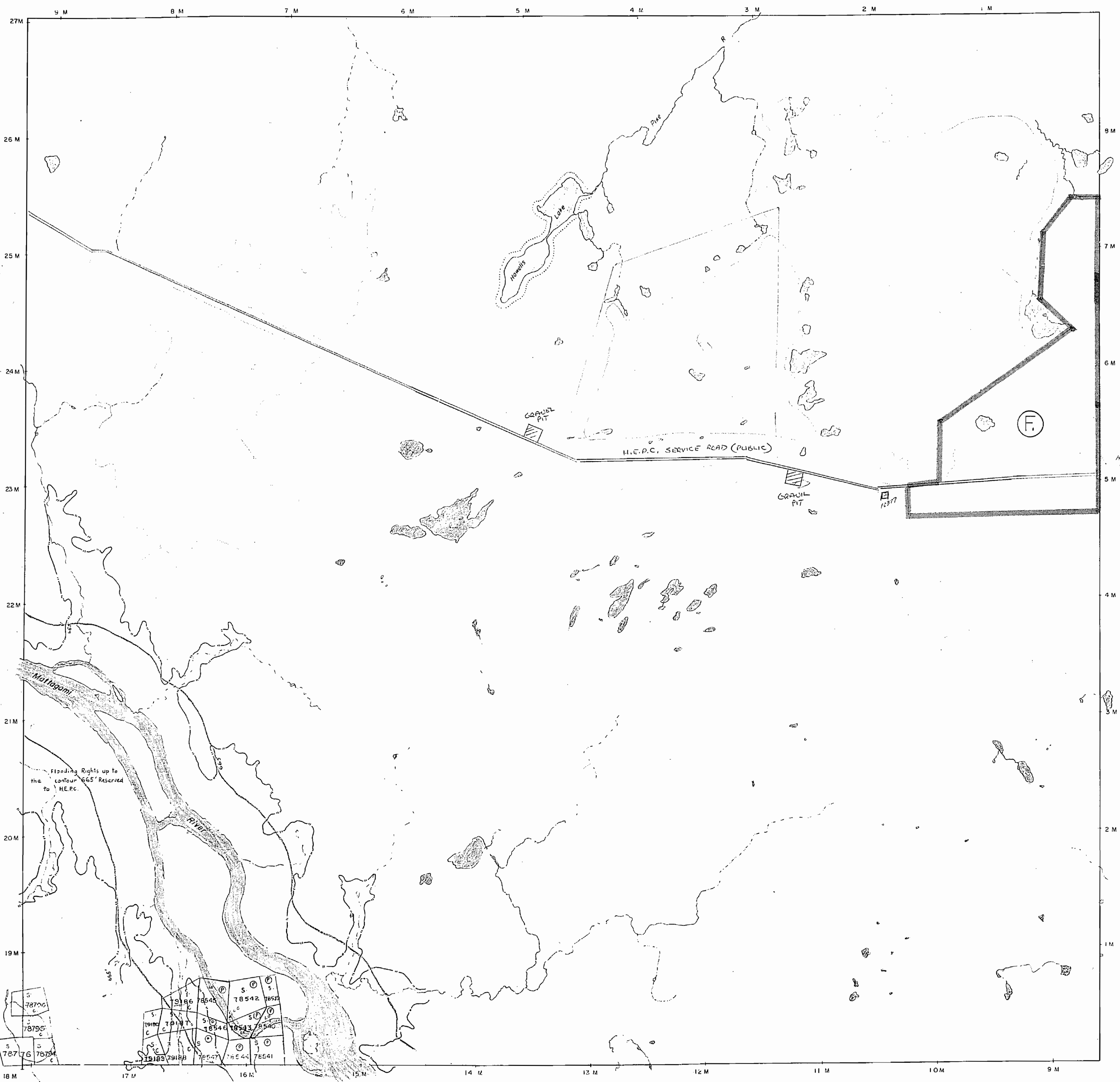

Mowbray Twp.

Sheldon Twp.

Clay Twp.



INDEX TO LAND DISPOSITION

PLAN
 G-894
 TOWNSHIP

M.N.R. ADMINISTRATIVE DISTRICT
 KAPUSKASING
 MINING DIVISION
 PORCUPINE
 LAND TITLES/REGISTRY DIVISION
 COCHRANE

HOWELLS

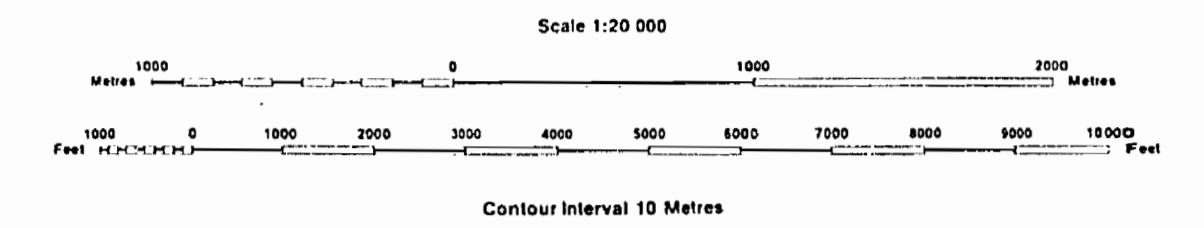

SYMBOLS

Boundary
Township, Meridian, Baseline
Road allowance; surveyed, shoreline
Lot/Concession; surveyed, unsurveyed
Parcel; surveyed, unsurveyed
Right-of-way; road, railway, utility
Reservation
Cliff, Pit, Pile
Contour
Interpolated
Approximate
Depression
Control point (horizontal)
Flooded land
Mine head frame
Pipeline (above ground)
Railway; single track, double track, abandoned
Road; highway, county, township access, trail, bush
Shoreline (original)
Transmission line
Wooded area

AREAS WITHDRAWN FROM DISPOSITION

MRO - Mining Rights Only
 SRO - Surface Rights Only
 M+S - Mining and Surface Rights

Description	Order No.	Date	Disposition	File

X - SUBJECT TO FORESTRY ACTIVITY IN 1994/95

(F2) THIS TWP. IS SUBJECT TO FOREST ACTIVITY IN 1995/96. FURTHER INFORMATION AVAILABLE ON FILE.

DISPOSITION OF CROWN LANDS

Patent
Surface & Mining Rights
Surface Rights Only
Mining Rights Only
Lease
Surface & Mining Rights
Surface Rights Only
Mining Rights Only
Licence of Occupation
Order-in-Council
Cancelled
Reservation
Sand & Gravel

Land Use Permit L.U.P.

NOTES

CROWN LANDS LYING BELOW THE NATURAL HIGH WATER COURSE OF THE BED OF THE MATAGAMI RIVER FROM THE MAIN DAM UPSTREAM TO CYPRUS FALLS, THE BED OF THE KAPUSKASING RIVER UP TO CONFLUENCE WITH THE MATAGAMI RIVER UPSTREAM TO THE OF THE LOST RIVER, THE BED OF THE GROUNDHOUS RIVER FROM CONFLUENCE WITH THE MATAGAMI RIVER UPSTREAM SIX MILES THE BED OF THE REAR RIVER FROM ITS CONFLUENCE WITH THE KAPUSKASING RIVER UPSTREAM SIX MILES +/- TOGETHER WITH LANDS UP TO CONTOUR 450' C.S. DATUM ADJACENT TO AND WITH THESE LIMITS, GRANTED TO H.E.P.C. OF ONTARIO.
 W.P.L. No. 104 FILE: 145889

THE INFORMATION THAT APPEARS ON THIS MAP HAS BEEN COMPILED FROM VARIOUS SOURCES AND ACCURACY IS NOT GUARANTEED. THOSE WISHING TO STAKE MINING CLAIMS SHOULD CONSULT WITH THE MINING RECORDER, MINISTRY OF NORTHERN DEVELOPMENT AND MINES FOR ADDITIONAL INFO ON THE STATUS OF LANDS SHOWN.

ACTIVATED SEPTEMBER 15, 1992
 BY D.C.
 CHECKED BY B.A.

507

Cockshutt Twp.

THE TOWNSHIP OF
OF
HOWELLS

DISTRICT OF
COCHRANE

SUDBURY—TIMISKAMING
MINING DIVISION

SCALE: 1-INCH=40 CHAINS

LEGEND

- PATENTED LAND Ⓟ
- CROWN LAND SALE C.S.
- LEASES Ⓛ
- LOCATED LAND Loc.
- LICENSE OF OCCUPATION L.O.
- MINING RIGHTS ONLY M.R.O.
- SURFACE RIGHTS ONLY S.R.O.
- ROADS
- IMPROVED ROADS
- KING'S HIGHWAYS
- RAILWAYS
- POWER LINES
- MARSH OR MUSKEG
- MINES
- CANCELLED

NOTES

400' Reserve To Department of Lands & Forests
Shown thus:

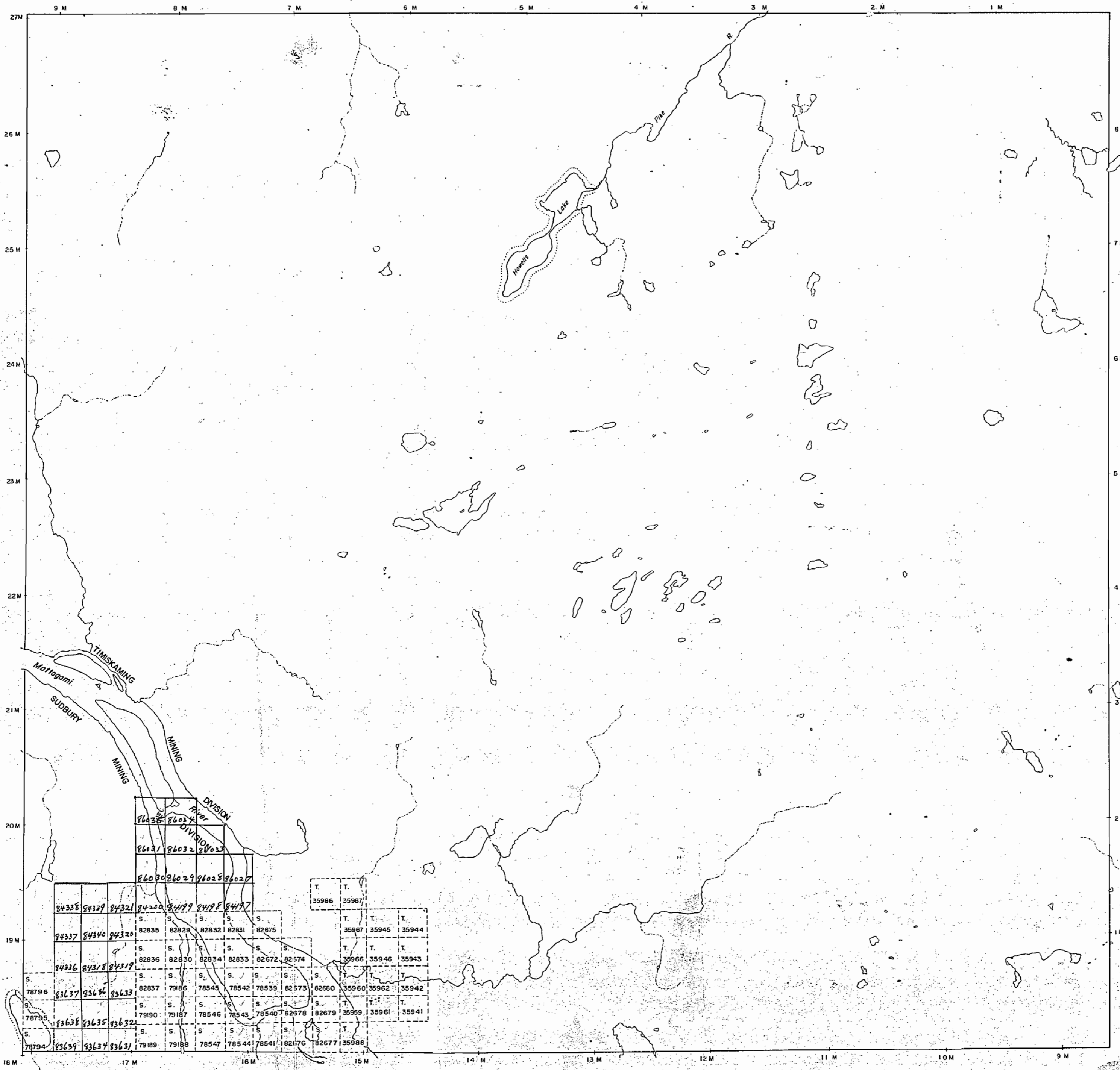

Mowbray Twp.

Sheldon Twp.

Clay Twp.

507

Cockshutt Twp.

THE TOWNSHIP OF
OF
HOWELLS

DISTRICT OF
COCHRANE

PORCUPINE
MINING DIVISION

SCALE: 1-INCH=40 CHAINS

LEGEND

PATENTED LAND	Ⓟ
CROWN LAND SALE	C.S.
LEASES	Ⓛ
LOCATED LAND	Loc.
LICENSE OF OCCUPATION	L.O.
MINING RIGHTS ONLY	M.R.O.
SURFACE RIGHTS ONLY	S.R.O.
ROADS	—
IMPROVED ROADS	—
KING'S HIGHWAYS	—
RAILWAYS	—
POWER LINES	—
MARSH OR MUSKEG	—
MINES	Ⓜ
CANCELLED	C.

NOTES

400' Reserve To Department of Lands & Forests
Shown thus: —

*SUBJECT TO FLOODING RISKS
TO H.E.P.C. WITHIN COMPENSATION
BOUNDARIES*

Mowbray Twp.

Sheldon Twp.

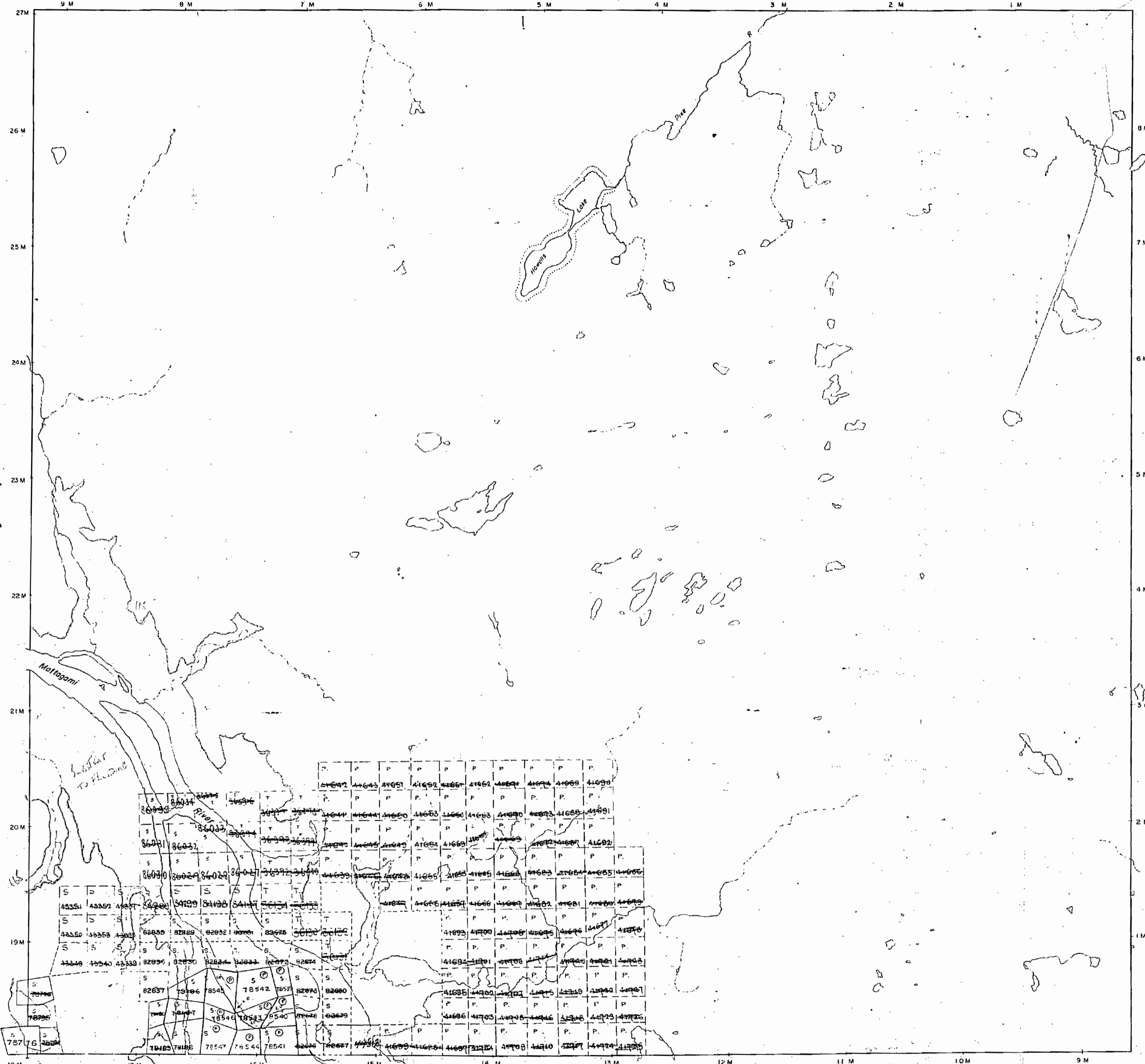

Clay Twp.

PLAN NO. **M.507**

DEPARTMENT OF MINES

— ONTARIO —

507

Cockshutt Twp.

THE TOWNSHIP OF
HOWELLS

DISTRICT OF
COCHRANE

PORCUPINE
MINING DIVISION

SCALE: 1-INCH=40 CHAINS

LEGEND

- PATENTED LAND Ⓟ
- CROWN LAND SALE C.S.
- LEASES Ⓛ
- LOCATED LAND Loc.
- LICENSE OF OCCUPATION L.O.
- MINING RIGHTS ONLY M.R.O.
- SURFACE RIGHTS ONLY S.R.O.
- ROADS —
- IMPROVED ROADS —
- KING'S HIGHWAYS —
- RAILWAYS —
- POWER LINES —
- MARSH OR MUSKEG —
- MINES Ⓜ
- CANCELLED C.

NOTES

400' Reserve To Department of Lands & Forests
Shown thus: —

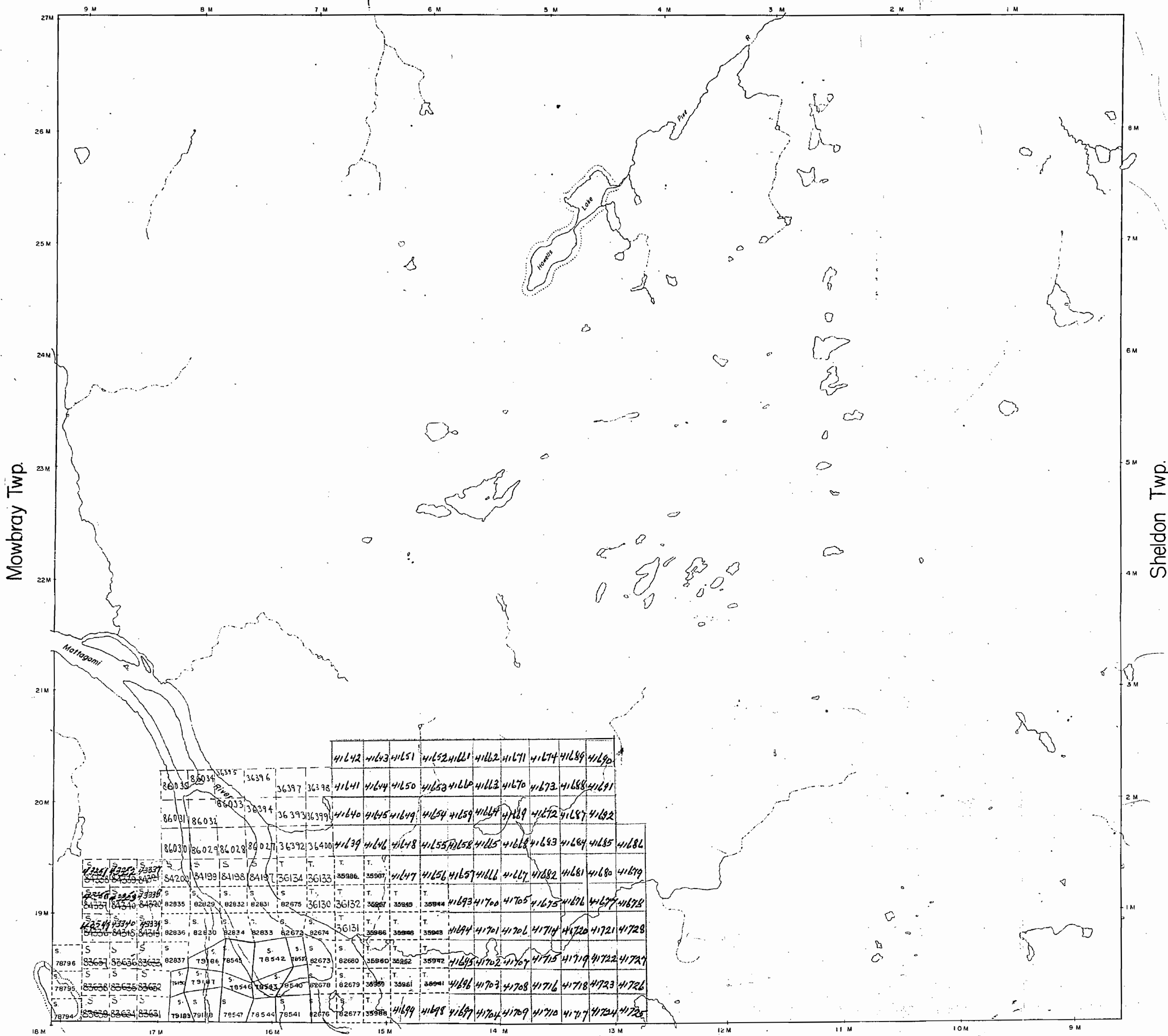

Mowbray Twp.

Sheldon Twp.

Clay Twp.

PLAN NO. **M.507**

DEPARTMENT OF MINES
— ONTARIO —

507

Cockshutt Twp.

THE TOWNSHIP OF

HOWELLS

DISTRICT OF COCHRANE

SUDBURY-TIMISKAMING MINING DIVISION

SCALE: 1-INCH=40 CHAINS

LEGEND

- PATENTED LAND Ⓟ
- CROWN LAND SALE C.S.
- LEASES Ⓛ
- LOCATED LAND Loc.
- LICENSE OF OCCUPATION L.O.
- MINING RIGHTS ONLY M.R.O.
- SURFACE RIGHTS ONLY S.R.O.
- ROADS
- IMPROVED ROADS
- KING'S HIGHWAYS
- RAILWAYS
- POWER LINES
- MARSH OR MUSKEG
- MINES
- CANCELLED

NOTES

400' Reserve To Department of Lands & Forests
Shown thus:

Mowbray Twp.

Sheldon Twp.

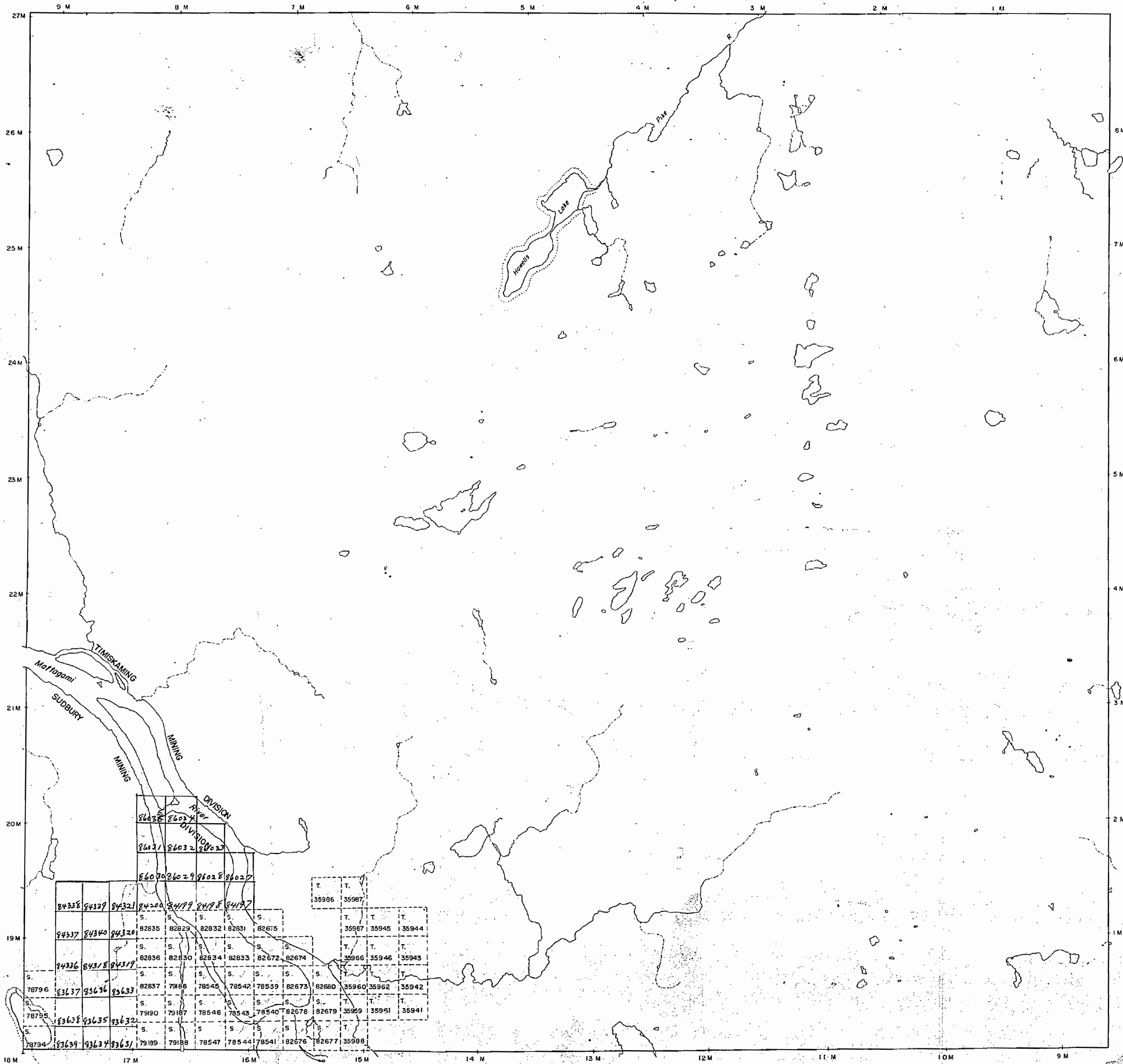

Clay Twp.

507

Cockshutt Twp.

THE TOWNSHIP OF

HOWELLS

DISTRICT OF COCHRANE

PORCUPINE MINING DIVISION

SCALE: 1-INCH=40 CHAINS

LEGEND

PATENTED LAND	⊕
CROWN LAND SALE	C.S.
LEASES	⊙
LOCATED LAND	Loc.
LICENSE OF OCCUPATION	L.O.
MINING RIGHTS ONLY	M.R.O.
SURFACE RIGHTS ONLY	S.R.O.
ROADS	—
IMPROVED ROADS	—
KING'S HIGHWAYS	—
RAILWAYS	—
POWER LINES	—
MARSH OR MUSKEG	—
MINES	⊗
CANCELLED	C.

NOTES

400' Reserve To Department of Lands & Forests
Shown thus: —

*SUBJECT TO FLOODING RIGHTS
TO H.E.P.C. WITHOUT COMPENSATION
BOOK 665*

Mowbray Twp.

Sheldon Twp.

Clay Twp.

PLAN NO. M.507

DEPARTMENT OF MINES

— ONTARIO —

