

Areas withdrawn from staking under Section 42 of the Mining Act.

M.939

(R) Sec. 35 File W-LL P2381990NT. Date May 17/99 Disposition MTS

PLAN OF

# HUBBARD TWP.

PORCUPINE — MINING DIVISION.

DISTRICT OF SUDBURY

**NOTE**

400' Surface Rights Reservation around all Lakes and Rivers.

— Scale, 40 chains to an inch. —

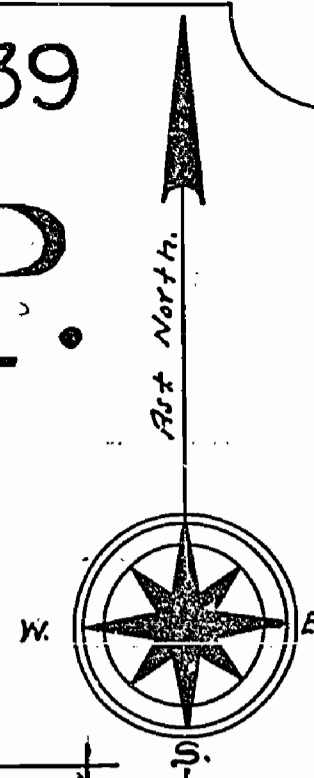

THE INFORMATION THAT APPEARS ON THIS MAP HAS BEEN COMPILED FROM VARIOUS SOURCES, AND ACCURACY IS NOT GUARANTEED. THOSE WISHING TO STAKE MINING CLAIMS SHOULD CONSULT WITH THE MINING RECORDER, MINISTRY OF NORTHERN DEVELOPMENT AND MINES, FOR ADDITIONAL INFORMATION ON THE STATUS OF THE LANDS SHOWN HEREON.

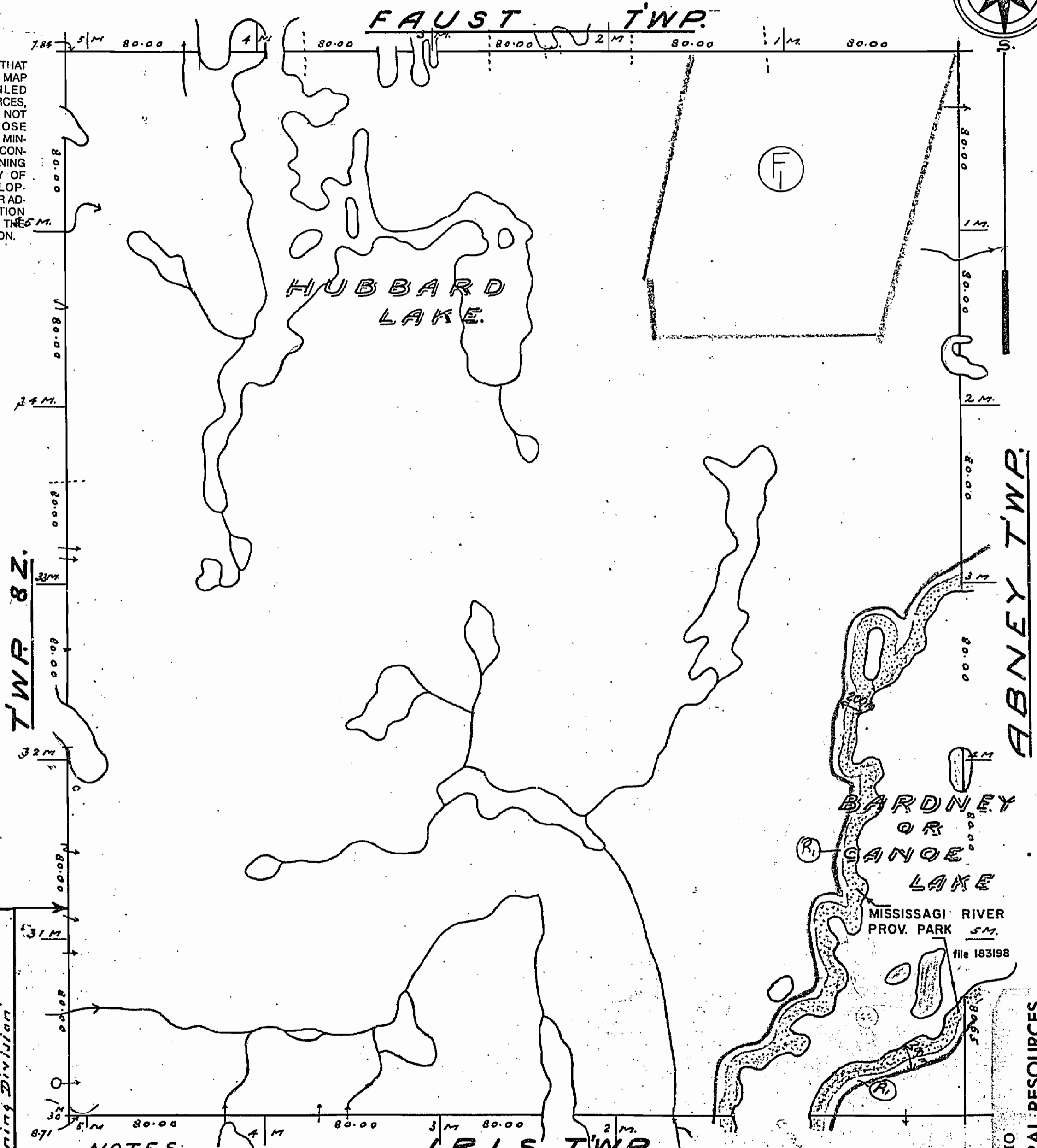

**NOTES:**

- |                             |                                     |                                             |                                     |
|-----------------------------|-------------------------------------|---------------------------------------------|-------------------------------------|
| Railways shown thus         | —+—+—+—+—+—+—+—+—+—                 | Non-perennial streams                       | — · — · — · — · — · — · — · — · — · |
| Paved Highways              | —=—=—=—=—=—=—=—=—=                  | Bridges                                     | —+—+—+—+—+—+—+—+—+—                 |
| Gravel                      | —=—=—=—=—=—=—=—=—=                  | Buildings                                   | —+—+—+—+—+—+—+—+—+—                 |
| Other Roads                 | —=—=—=—=—=—=—=—=—=                  | Swamps                                      | —+—+—+—+—+—+—+—+—+—                 |
| Highway Route Nos.          | —=—=—=—=—=—=—=—=—=                  | Areas marked (R) are Patented               |                                     |
| Trails & Paths              | — · — · — · — · — · — · — · — · — · | " (L) are Leased                            |                                     |
| Telephone & Telegraph Lines | — · — · — · — · — · — · — · — · — · | " (LO) are held under License of Occupation |                                     |
| Electric Power Lines        | — · — · — · — · — · — · — · — · — · |                                             |                                     |

400' Reserve to the East of the Lake. THIS TWP. IS SUBJECT TO FOREST ACTIVITY IN 1995/96. FURTHER INFORMATION AVAILABLE ON FILE.

Western boundary of Sudbury Mining Division & Eastern boundary of Sault Ste. Marie Mining Division

TWP. 82. TWP. 83. TWP. 84. TWP. 85.

ONTARIO  
MINISTRY OF NATURAL RESOURCES  
SURVEYS AND MAPPING BRANCH