

Scale:-40 Chains-1Inch

m-509

NOTE

400' Surface Rights Reservation around
all Lakes and Rivers.
--- L.U.P. (private road)

AGATE

North Asty

95

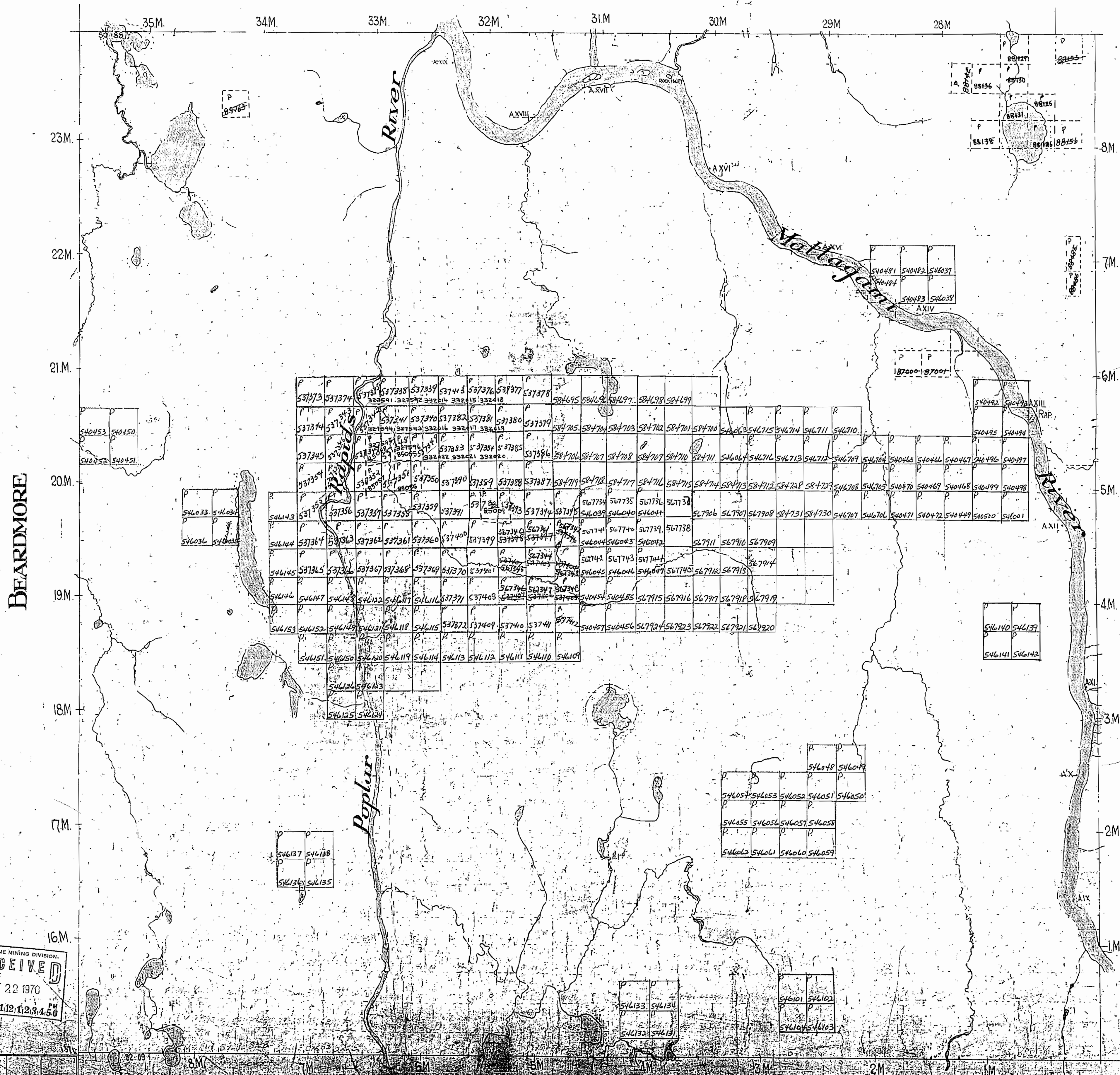

PORCUPINE MINING DIVISION
RECEIVED
 OCT 22 1970
 AM 7 8 9 10 11 12 1 2 3 4 5 6 PM

ADANAC

REFERENCES

AREAS WITHDRAWN FROM DISPOSITION

M.R.O. - MINING RIGHTS ONLY
S.R.O. - SURFACE RIGHTS ONLY
M.+S. - MINING AND SURFACE RIGHTS

Description	Order No.	Date	Disposition	File

FLOODING

Flooding rights along Mattagami River to contour elevation 700 ft. reserved to Ontario Hydro.

TWP. OF AGATE G-3008

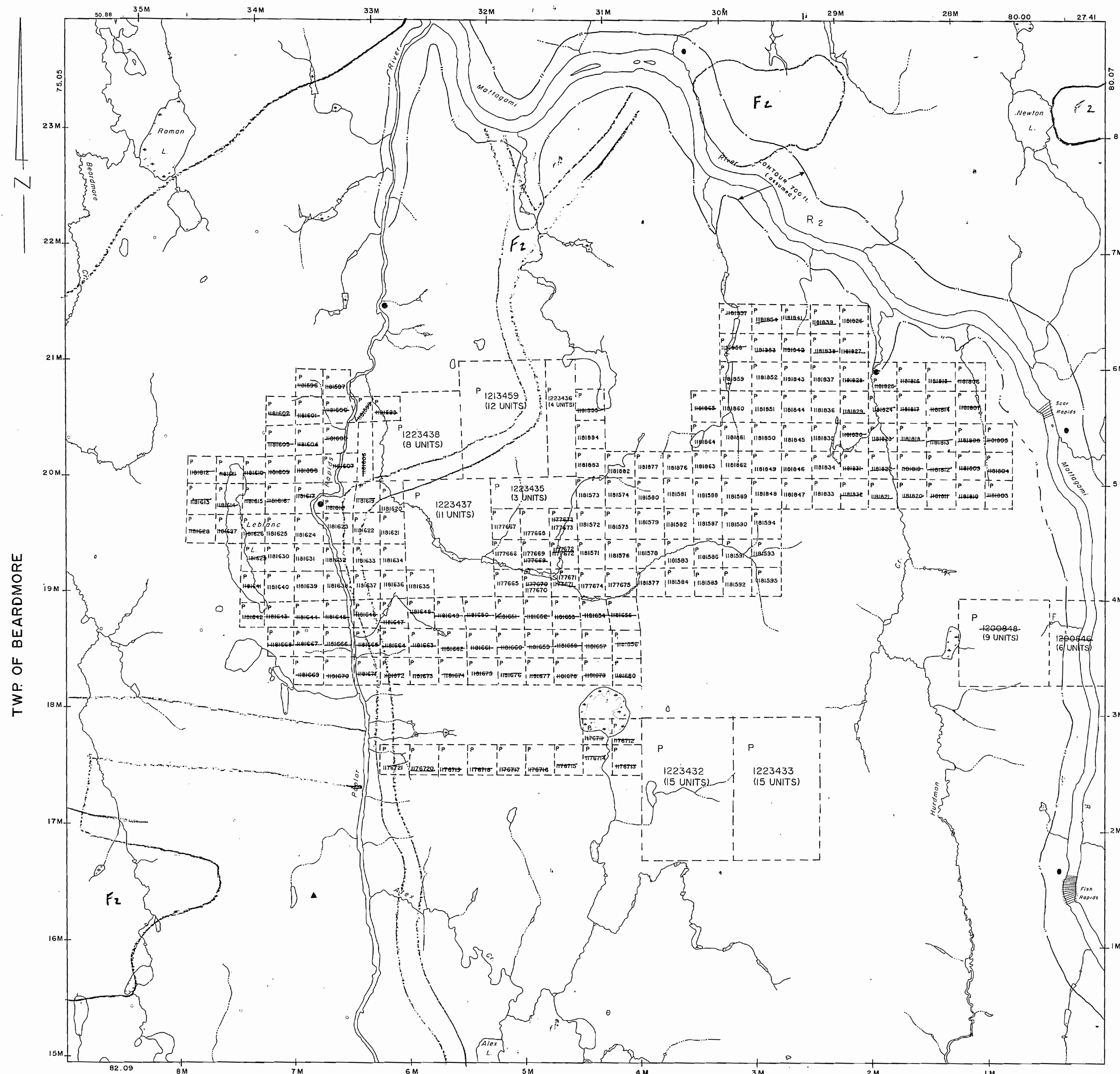

TWP. OF ALEXANDRA

LEGEND

HIGHWAY AND ROUTE No.

OTHER ROADS

TRAILS

SURVEYED LINES:

TOWNSHIPS, BASE LINES, ETC.

LOTS, MINING CLAIMS, PARCELS, ETC.

UNSURVEYED LINES:

LOT LINES

PARCEL BOUNDARY

MINING CLAIMS ETC.

RAILWAY AND RIGHT OF WAY

UTILITY LINES

NON-PERENNIAL STREAM

FLOODING OR FLOODING RIGHTS

SUBDIVISION OR COMPOSITE PLAN

RESERVATIONS

ORIGINAL SHORELINE

MARSH OR MUSKEG

MINES

TRAVERSE MONUMENT

DISPOSITION OF CROWN LANDS

TYPE OF DOCUMENT	SYMBOL
PATENT, SURFACE & MINING RIGHTS	
" SURFACE RIGHTS ONLY	
" MINING RIGHTS ONLY	
LEASE, SURFACE & MINING RIGHTS	
" SURFACE RIGHTS ONLY	
" MINING RIGHTS ONLY	
LICENCE OF OCCUPATION	
ORDER-IN-COUNCIL	
RESERVATION	
CANCELLED	
SAND & GRAVEL	

NOTE: MINING RIGHTS IN PARCELS PATENTED PRIOR TO MAY 6, 1913, VESTED IN ORIGINAL PATENTEE BY THE PUBLIC LANDS ACT, R.S.O. 1970, CHAP. 380, SEC. 63, SUBSEC. 1.

THIS TOWNSHIP SUBJECT TO FORESTRY ACTIVITY IN 1995/96. FURTHER INFORMATION ON FILE.

APPROXIMATE ROAD LOCATION

TRAPLINE CABIN

LAND USE PERMIT

DATE OF ISSUE

MAY 14 1998

PROVINCIAL RECORDING
OFFICE - SUDBURY

SCALE: 1 INCH = 40 CHAINS

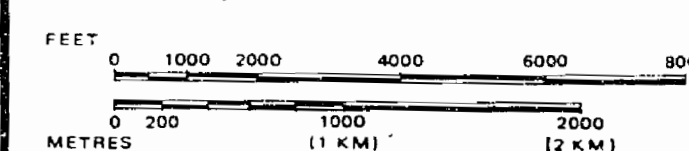

TOWNSHIP
HURDMAN
M.N.R. ADMINISTRATIVE DISTRICT
COCHRANE
MINING DIVISION
PORCUPINE
LAND TITLES / REGISTRY DIVISION
COCHRANE

Ministry of Natural Resources
Land Management Branch
Ontario

Date: MARCH 1984.

Number

ACTIVATED BY: D.J. NOV. 14/96
CHECKED BY: D.C.

G-3016

THE INFORMATION THAT APPEARS ON THIS MAP HAS BEEN COMPILED FROM VARIOUS SOURCES, AND ACCURACY IS NOT GUARANTEED. THOSE WISHING TO STAKE MINING CLAIMS SHOULD CONSULT WITH THE MINING RECORDER, MINISTRY OF NORTHERN DEVELOPMENT AND MINES, FOR ADDITIONAL INFORMATION ON THE STATUS OF THE LANDS SHOWN HEREON.

NOTES

400' surface rights reservation along the shores of all lakes and rivers.

THE INFORMATION THAT APPEARS ON THIS MAP HAS BEEN COMPILED FROM VARIOUS SOURCES, AND ACCURACY IS NOT GUARANTEED. THOSE WISHING TO STAKE MINING CLAIMS SHOULD CONSULT WITH THE MINING RECORDER, MINISTRY OF NORTHERN DEVELOPMENT AND MINES, FOR ADDITIONAL INFORMATION ON THE STATUS OF THE LANDS SHOWN HEREON.

TWP. OF AGATE (M-1686)

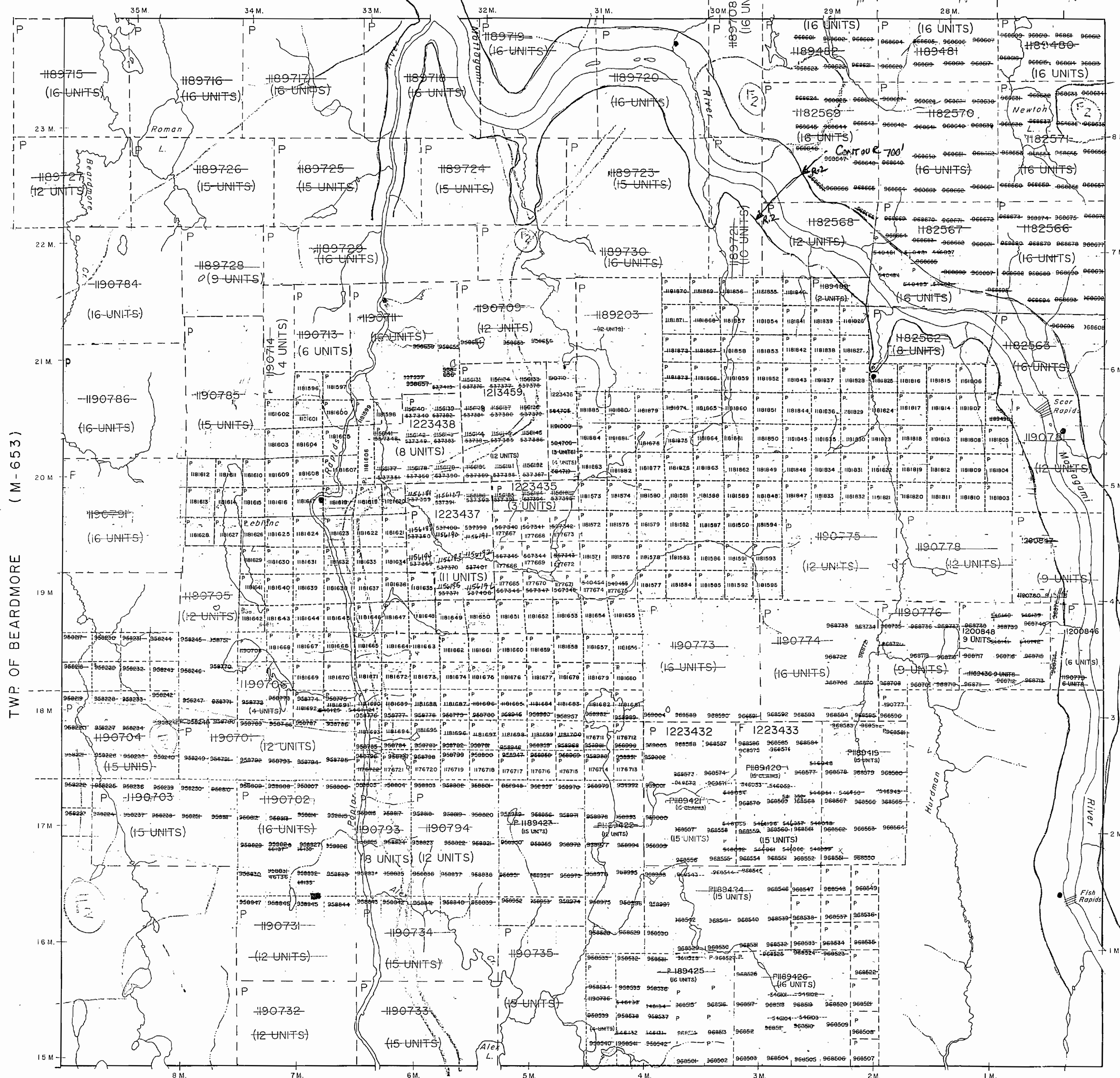

TWP. OF ALEXANDRA (M-1867)

LEGEND

- HIGHWAY AND ROUTE No.
- OTHER ROADS
- TRAILS
- SURVEYED LINES:
 - TOWNSHIPS, BASE LINES, ETC.
 - LOTS, MINING CLAIMS, PARCELS, ETC.
- UNSURVEYED LINES:
 - LOT LINES
 - PARCEL BOUNDARY
 - MINING CLAIMS ETC.
- RAILWAY AND RIGHT OF WAY
- UTILITY LINES
- NON-PERENNIAL STREAM
- FLOODING OR FLOODING RIGHTS
- SUBDIVISION OR COMPOSITE PLAN
- RESERVATIONS
- ORIGINAL SHORELINE
- MARSH OR MUSKEG
- MINES
- TRAVERSE MONUMENT

DISPOSITION OF CROWN LANDS

TYPE OF DOCUMENT	SYMBOL
PATENT, SURFACE & MINING RIGHTS	
" SURFACE RIGHTS ONLY	
" MINING RIGHTS ONLY	
LEASE, SURFACE & MINING RIGHTS	
" SURFACE RIGHTS ONLY	
" MINING RIGHTS ONLY	
LICENCE OF OCCUPATION	
ORDER-IN-COUNCIL	
RESERVATION	
CANCELLED	
SAND & GRAVEL	

NOTE: MINING RIGHTS IN PARCELS PATENTED PRIOR TO MAY 6, 1913, VESTED IN ORIGINAL PATENTEE BY THE PUBLIC LANDS ACT, R.S.O. 1970, CHAP. 380, SEC. 63, SUBSEC. 1.

R2 FLOODING RESERVATION ALONG MATTAGAMI RIVER TO CONTOUR ELEVATION 700 FT. RESERVED TO ONTARIO HYDRO.

20 U.P.

7 - SUBJECT TO FOREST ACTIVITY IN 1994/95

● TRAPLINE CABINS

F2 THIS TWP. IS SUBJECT TO FOREST ACTIVITY IN 1995/96. FURTHER INFORMATION AVAILABLE ON FILE.

— Approximate Pond Location

REMOVED FROM ACTIVE FILE NOVEMBER 14, 1996 BY: D.C.

SCALE: 1 INCH = 40 CHAINS

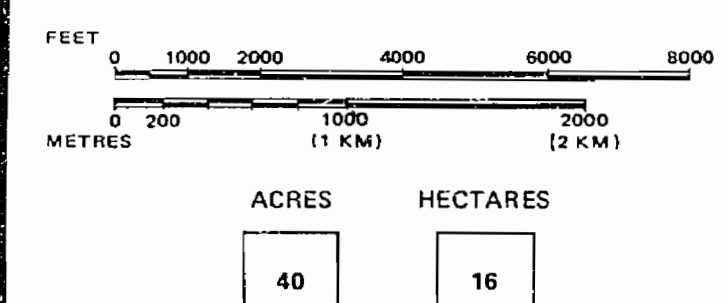

Received Oct 22, 1980

TOWNSHIP OF G-3016

HURDMAN

DISTRICT

COCHRANE

MINING DIVISION

PORCUPINE



Ministry of Natural Resources
Surveys and Mapping Branch

Date OCT. 10th 1980

File No.

National Topographic Series

REFERENCES

AREAS WITHDRAWN FROM DISPOSITION

- M.R.O. - MINING RIGHTS ONLY
- S.R.O. - SURFACE RIGHTS ONLY
- M.+S. - MINING AND SURFACE RIGHTS

FLOODING

Flooding rights along Mattagami River to contour elevation 700 ft. reserved to Ontario Hydro.

TWP. OF AGATE G-3008

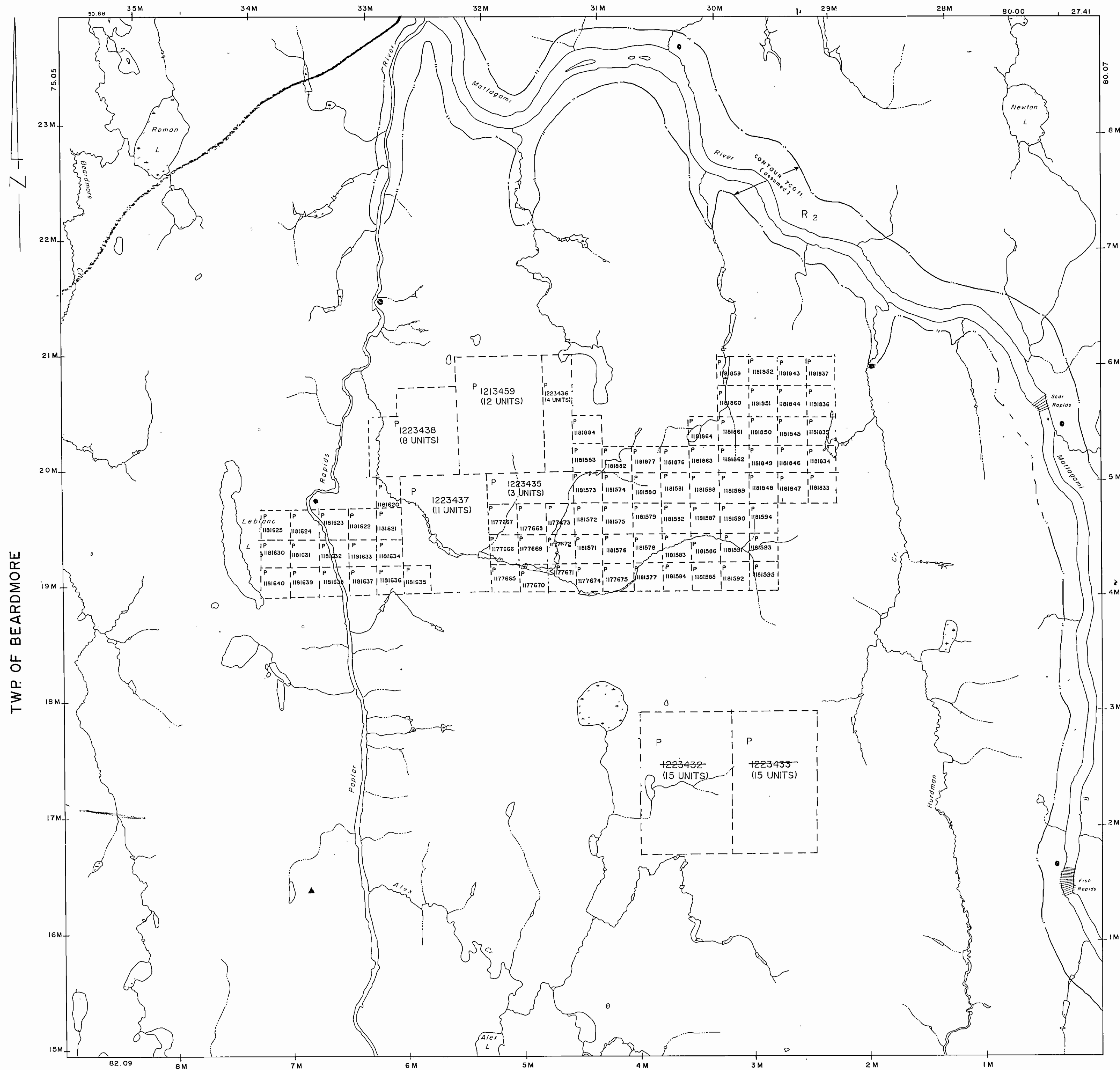

TWP. OF ALEXANDRA

LEGEND

- HIGHWAY AND ROUTE No.
- OTHER ROADS
- TRAILS
- SURVEYED LINES:
 - TOWNSHIPS, BASE LINES, ETC.
 - LOTS, MINING CLAIMS, PARCELS, ETC.
- UNSURVEYED LINES:
 - LOT LINES
 - PARCEL BOUNDARY
 - MINING CLAIMS ETC.
- RAILWAY AND RIGHT OF WAY
- UTILITY LINES
- NON-PERENNIAL STREAM
- FLOODING OR FLOODING RIGHTS
- SUBDIVISION OR COMPOSITE PLAN
- RESERVATIONS
- ORIGINAL SHORELINE
- MARSH OR MUSKEG
- MINES
- TRAVERSE MONUMENT

DISPOSITION OF CROWN LANDS

TYPE OF DOCUMENT	SYMBOL
PATENT, SURFACE & MINING RIGHTS	●
" SURFACE RIGHTS ONLY	○
" MINING RIGHTS ONLY	○
LEASE, SURFACE & MINING RIGHTS	■
" SURFACE RIGHTS ONLY	■
" MINING RIGHTS ONLY	■
LICENCE OF OCCUPATION	▼
ORDER-IN-COUNCIL	OC
RESERVATION	○
CANCELLED	○
SAND & GRAVEL	○

NOTE: MINING RIGHTS IN PARCELS PATENTED PRIOR TO MAY 6, 1913, VESTED IN ORIGINAL PATENTEE BY THE PUBLIC LANDS ACT, R.S.O. 1970, CHAP. 380, SEC. 83, SUBSEC. 1

THIS TOWNSHIP SUBJECT TO FORESTRY ACTIVITY IN 1995/96. FURTHER INFORMATION ON FILE.

APPROXIMATE ROAD LOCATION

● TRAPLINE CABIN

▲ LAND USE PERMIT

SCALE: 1 INCH = 40 CHAINS

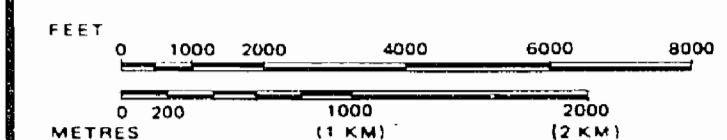

TOWNSHIP

HURDMAN

M.N.R. ADMINISTRATIVE DISTRICT

COCHRANE

MINING DIVISION

PORCUPINE

LAND TITLES / REGISTRY DIVISION

COCHRANE



Date MARCH 1984.

Number

ACTIVATED BY: D.M. NOV. 14/96

CHECKED BY: D.C.

G-3016

THE INFORMATION THAT APPEARS ON THIS MAP HAS BEEN COMPILED FROM VARIOUS SOURCES, AND ACCURACY IS NOT GUARANTEED. THOSE WISHING TO STAKE MINING CLAIMS SHOULD CONSULT WITH THE MINING RECORDER, MINISTRY OF NORTHERN DEVELOPMENT AND MINES, FOR ADDITIONAL INFORMATION ON THE STATUS OF THE LANDS SHOWN HEREON.

Surface Reservations 430' wide by Dept. of L & S
Sheldon Nelson & his associates

509

HURDMAN

PORCUPINE MINING DIVISION

COCHRANE DISTRICT

Scale: 40 Chains - 1 inch

m-509

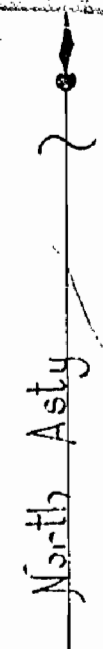

AGATE

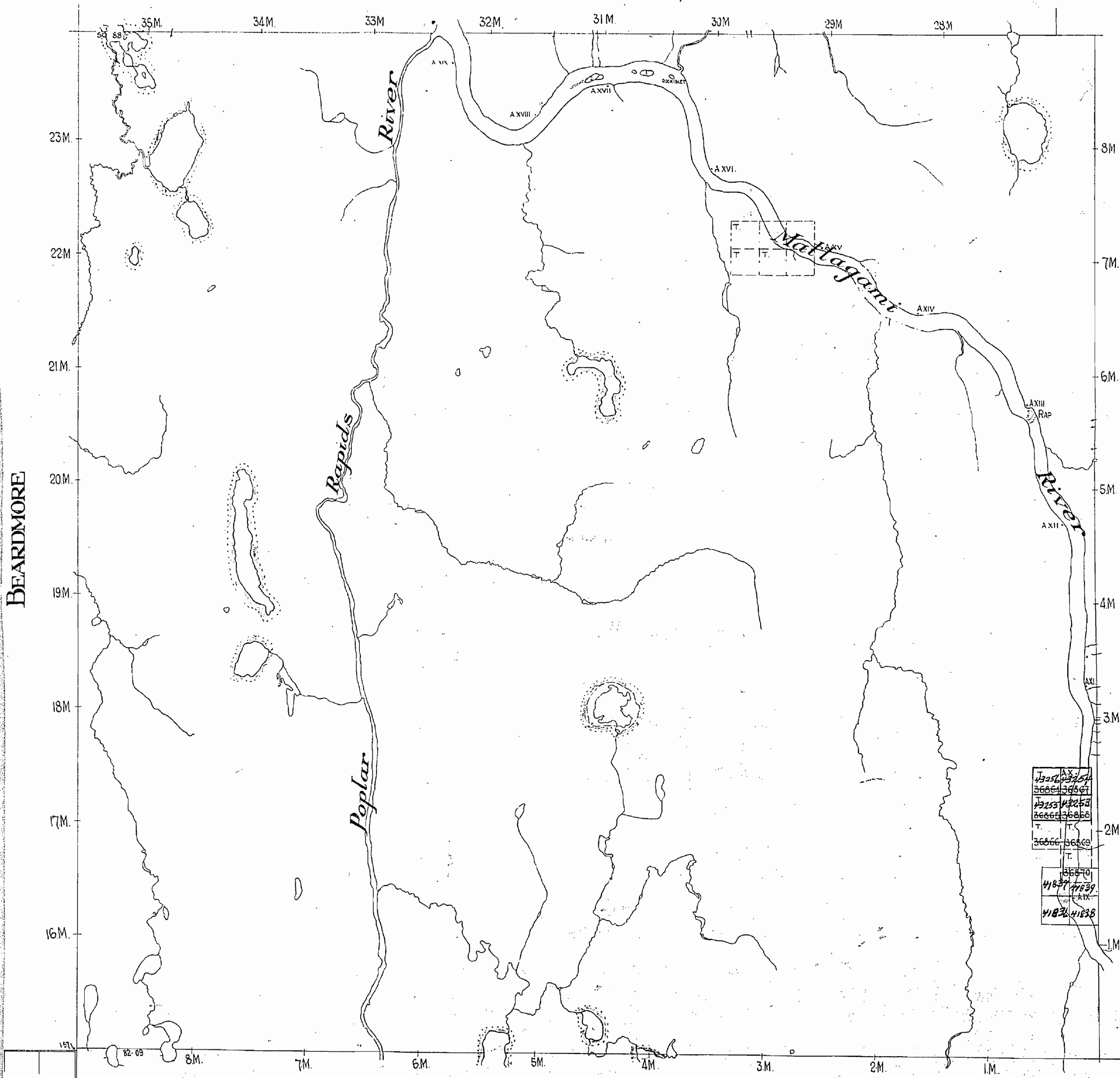

BEARDMORE

ADANAC

ALEXANDRA

Surface reservations 400' wide by Dept. of L. & E.
shown hereon + hui

509

HURDMAN

PORCUPINE MINING DIVISION

COCHRANE DISTRICT

Scale: -40 Chains - 1 Inch

m 509

AGATE

North Arrow

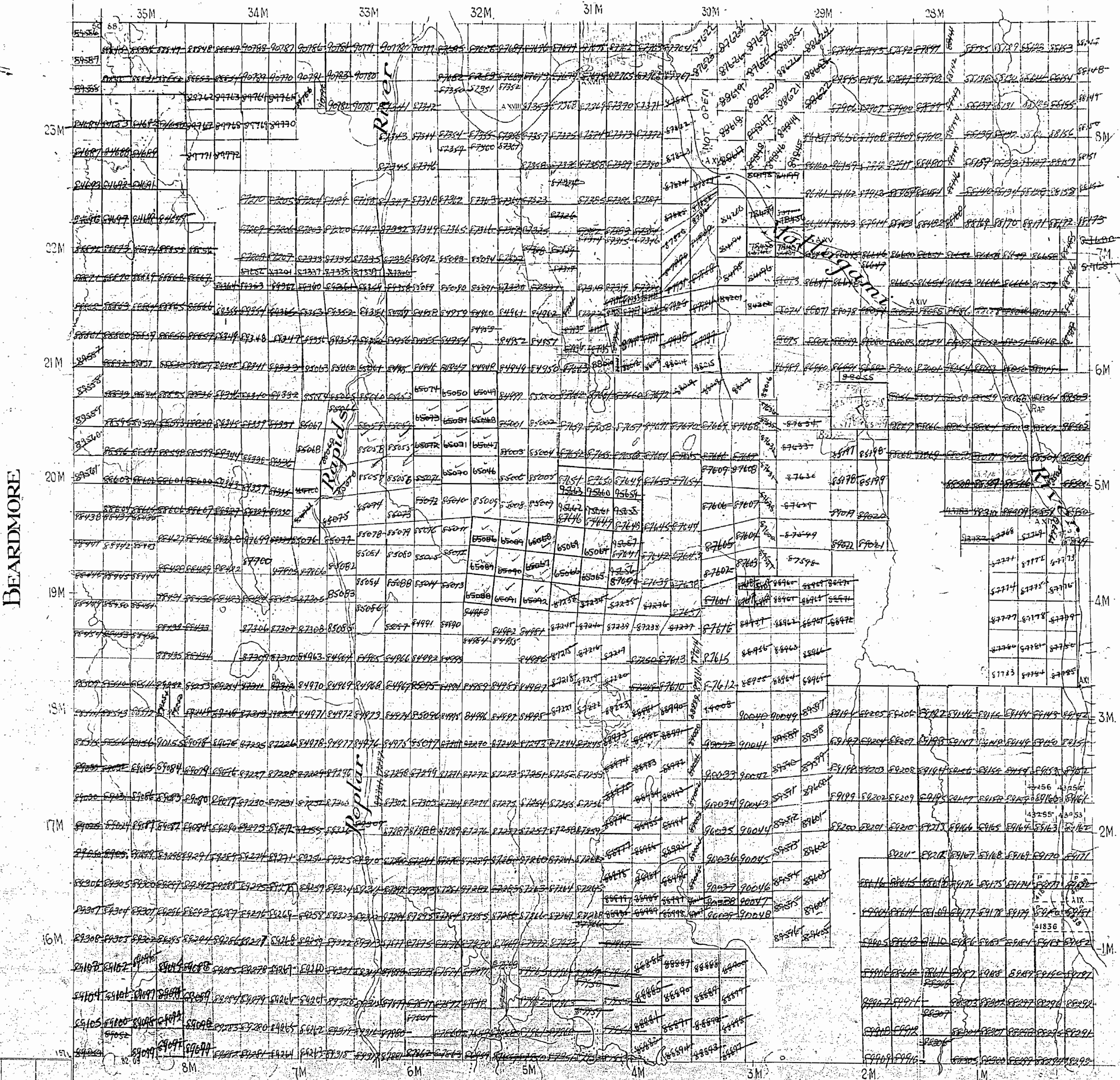

ALEXANDRA

Replaced
Oct 22/70

Surface reservations 400 wide by Dept. of L. & C.
Shawn Nelson - Aug. 1910

509

HURDMAN

PORCUPINE MINING DIVISION

COCHRANE DISTRICT

Scale: 40 Chains - 1 inch

M-509

North Arrow

AGATE

