

OF HYNDMAN

DISTRICT OF
KENORA

KENORA
MINING DIVISION

SCALE: 1-INCH=40 CHAINS

LEGEND

PATENTED LAND	⊙
CROWN LAND SALE	C.S.
LEASES	⊙
LOCATED LAND	Loc.
LICENSE OF OCCUPATION	L.O.
MINING RIGHTS ONLY	M.R.O.
SURFACE RIGHTS ONLY	S.R.O.
ROADS	—
IMPROVED ROADS	—
KING'S HIGHWAYS	—
RAILWAYS	—
POWER LINES	—
MARSH OR MUSKEG	—
MINES	⊙
CANCELLED	C

NOTES

400' Reserve around all lakes & rivers to Dept. of Lands & Forests.

July 17/60
May 27/63
Sept. 20/63
June 19/66
May 29/68
Oct. 21/69
Nov 24/70
May 3/71

July 15/61
RECEIVED
OCT 31 1960
 KENORA MINING DIV.

PLAN NO. **M.1990**

DEPARTMENT OF MINES

— ONTARIO —

REVELL TWP.

HODGSON TWP

HYNDMAN

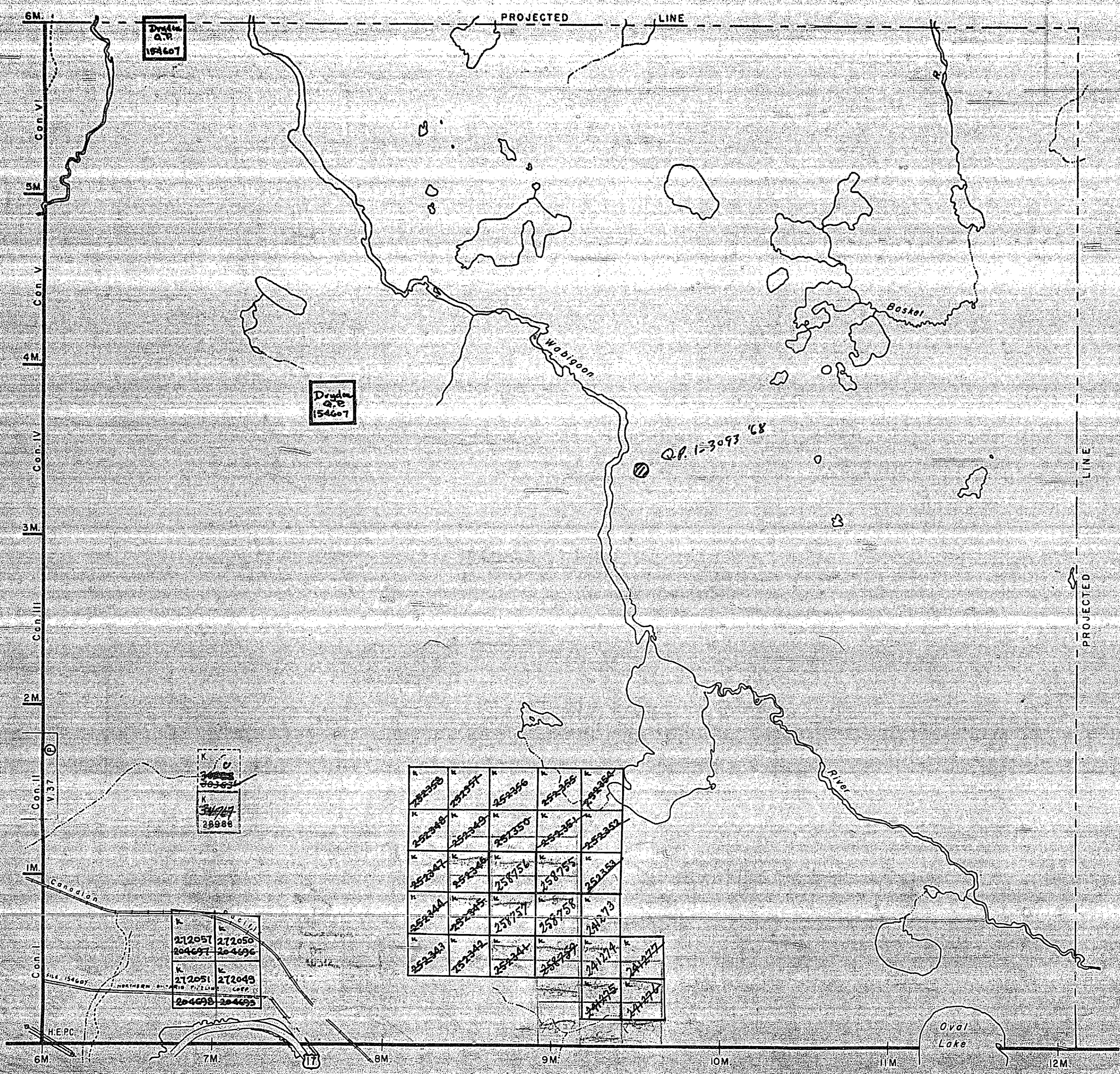

6M
5M
4M
3M
2M
1M
6M
7M
8M
9M
10M
11M
12M

Dredge
Q.P.
154607

Dredge
Q.P.
154607

Q.P. 123093 '68

K
20388
20389
20390
20391
20392
20393
20394
20395
20396
20397
20398
20399
20400
20401
20402
20403
20404
20405
20406
20407
20408
20409
20410
20411
20412
20413
20414
20415
20416
20417
20418
20419
20420
20421
20422
20423
20424
20425
20426
20427
20428
20429
20430
20431
20432
20433
20434
20435
20436
20437
20438
20439
20440
20441
20442
20443
20444
20445
20446
20447
20448
20449
20450
20451
20452
20453
20454
20455
20456
20457
20458
20459
20460
20461
20462
20463
20464
20465
20466
20467
20468
20469
20470
20471
20472
20473
20474
20475
20476
20477
20478
20479
20480
20481
20482
20483
20484
20485
20486
20487
20488
20489
20490
20491
20492
20493
20494
20495
20496
20497
20498
20499
20500

K
212051
212052
212053
212054
212055
212056
212057
212058
212059
212060
212061
212062
212063
212064
212065
212066
212067
212068
212069
212070
212071
212072
212073
212074
212075
212076
212077
212078
212079
212080
212081
212082
212083
212084
212085
212086
212087
212088
212089
212090
212091
212092
212093
212094
212095
212096
212097
212098
212099
212100

K
252358
252359
252360
252361
252362
252363
252364
252365
252366
252367
252368
252369
252370
252371
252372
252373
252374
252375
252376
252377
252378
252379
252380
252381
252382
252383
252384
252385
252386
252387
252388
252389
252390
252391
252392
252393
252394
252395
252396
252397
252398
252399
252400
252401
252402
252403
252404
252405
252406
252407
252408
252409
252410
252411
252412
252413
252414
252415
252416
252417
252418
252419
252420
252421
252422
252423
252424
252425
252426
252427
252428
252429
252430
252431
252432
252433
252434
252435
252436
252437
252438
252439
252440
252441
252442
252443
252444
252445
252446
252447
252448
252449
252450
252451
252452
252453
252454
252455
252456
252457
252458
252459
252460
252461
252462
252463
252464
252465
252466
252467
252468
252469
252470
252471
252472
252473
252474
252475
252476
252477
252478
252479
252480
252481
252482
252483
252484
252485
252486
252487
252488
252489
252490
252491
252492
252493
252494
252495
252496
252497
252498
252499
252500

REFERENCES

LEGEND

HIGHWAY AND ROUTE No.	
OTHER ROADS	
TRAILS	
SURVEYED LINES:	
TOWNSHIPS, BASE LINES, ETC.	
LOTS, MINING CLAIMS, PARCELS, ETC.	
UNSURVEYED LINES:	
LOT LINES	
PARCEL BOUNDARY	
MINING CLAIMS ETC.	
RAILWAY AND RIGHT OF WAY	
UTILITY LINES	
NON-PERENNIAL STREAM	
FLOODING OR FLOODING RIGHTS	
SUBDIVISION OR COMPOSITE PLAN	
RESERVATIONS	
ORIGINAL SHORELINE	
MARSH OR MUSKEG	
MINES	
TRAVERSE MONUMENT	

DISPOSITION OF CROWN LANDS

TYPE OF DOCUMENT	SYMBOL
PATENT, SURFACE & MINING RIGHTS	
" SURFACE RIGHTS ONLY	
" MINING RIGHTS ONLY	
LEASE, SURFACE & MINING RIGHTS	
" SURFACE RIGHTS ONLY	
" MINING RIGHTS ONLY	
LICENCE OF OCCUPATION	
ORDER-IN-COUNCIL	
RESERVATION	
CANCELLED	
SAND & GRAVEL	

SCALE: 1 INCH = 40 CHAINS

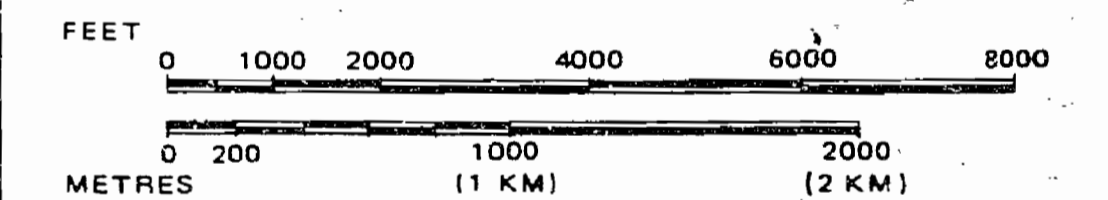

TOWNSHIP

HYNDMAN

M.N.R. ADMINISTRATIVE DISTRICT

DRYDEN

MINING DIVISION

KENORA

LAND TITLES & REGISTRY DIVISION

KENORA

THE INFORMATION APPEARS ON THIS MAP AS BEING CORRECT FROM VARIOUS SOURCES AND ACCURACY IS NOT GUARANTEED. WISHING TO STATE CLAIMS SHOULD BE FILED WITH THE RECORDS, MINES AND TECHNICAL INFORMATION DIVISION OF THE DEPARTMENT OF LANDS AND FORESTRY.



Ministry of Natural Resources

Ministry of Northern Development and Mines

Date NOVEMBER /92

Number

G-1314

DATE OF ISSUE

JAN 29 1998

PROVINCIAL RECORDING OFFICE - SUDBURY

REVELL TWP.

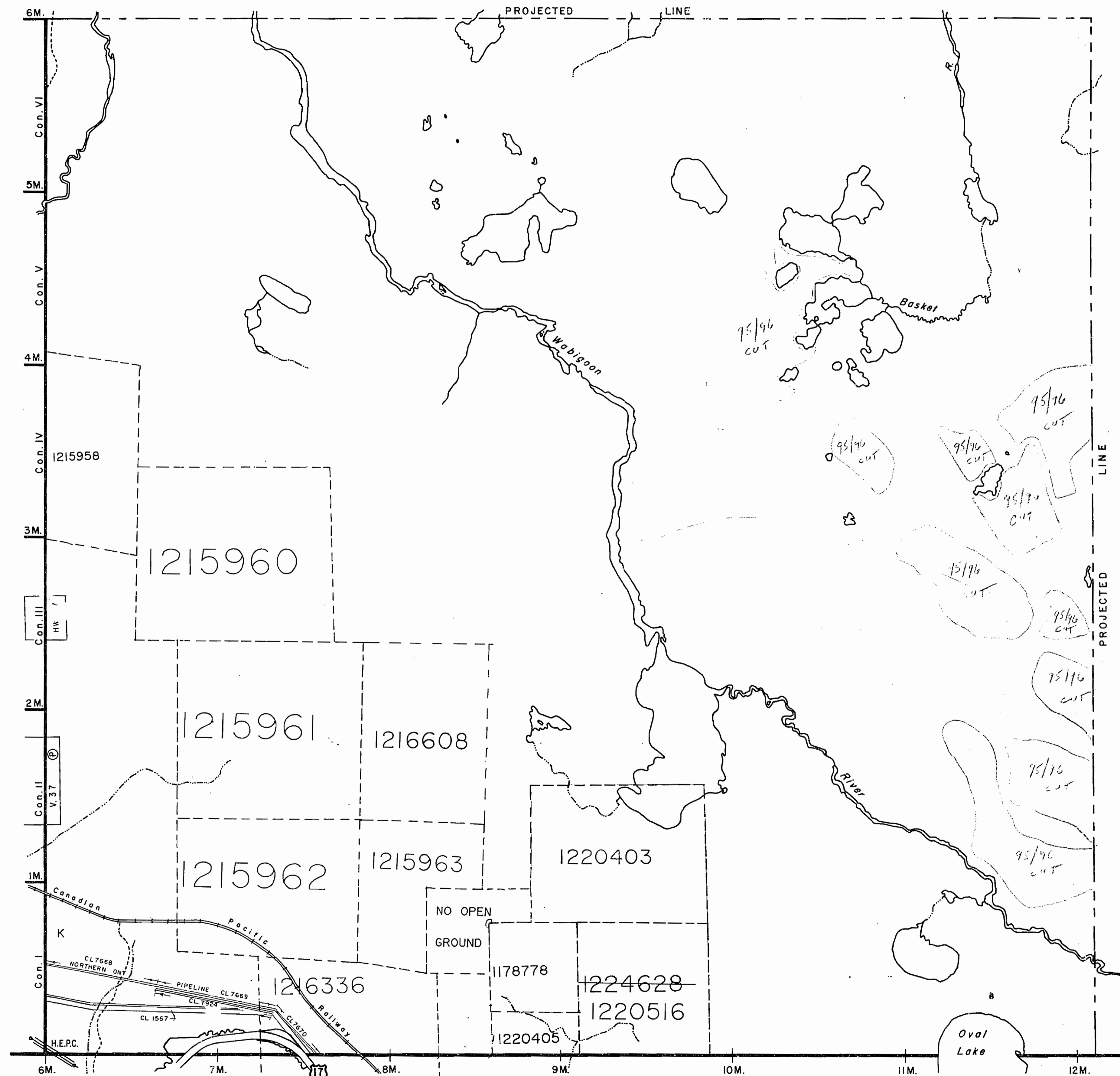

HODGSON TWP.

NOW HYNDEMAN TWP.

PLAN OF TOWNSHIP 27 & AREA EAST ADJOINING.

DISTRICT OF KENORA,
KENORA MINING DIVISION.

Scale: 40 chains to an inch.

M-1990

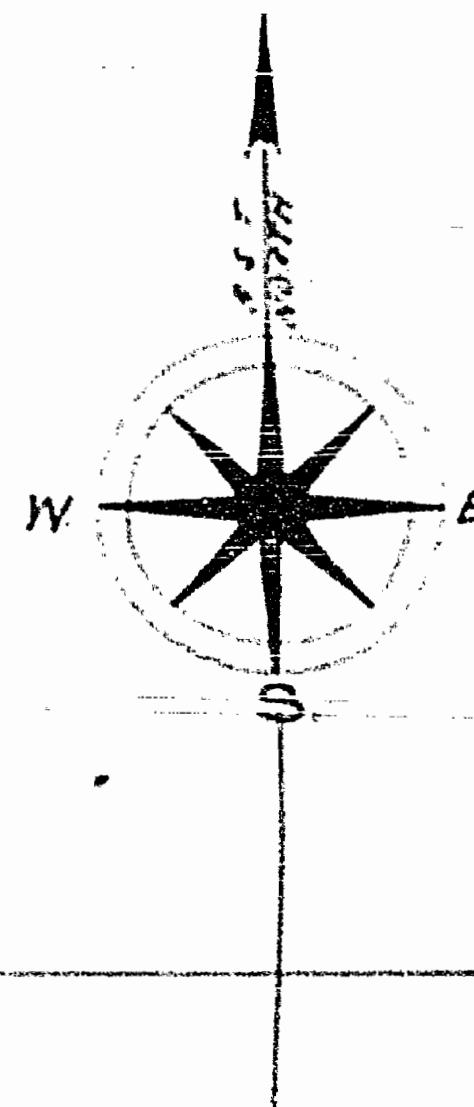

TOWNSHIP 27

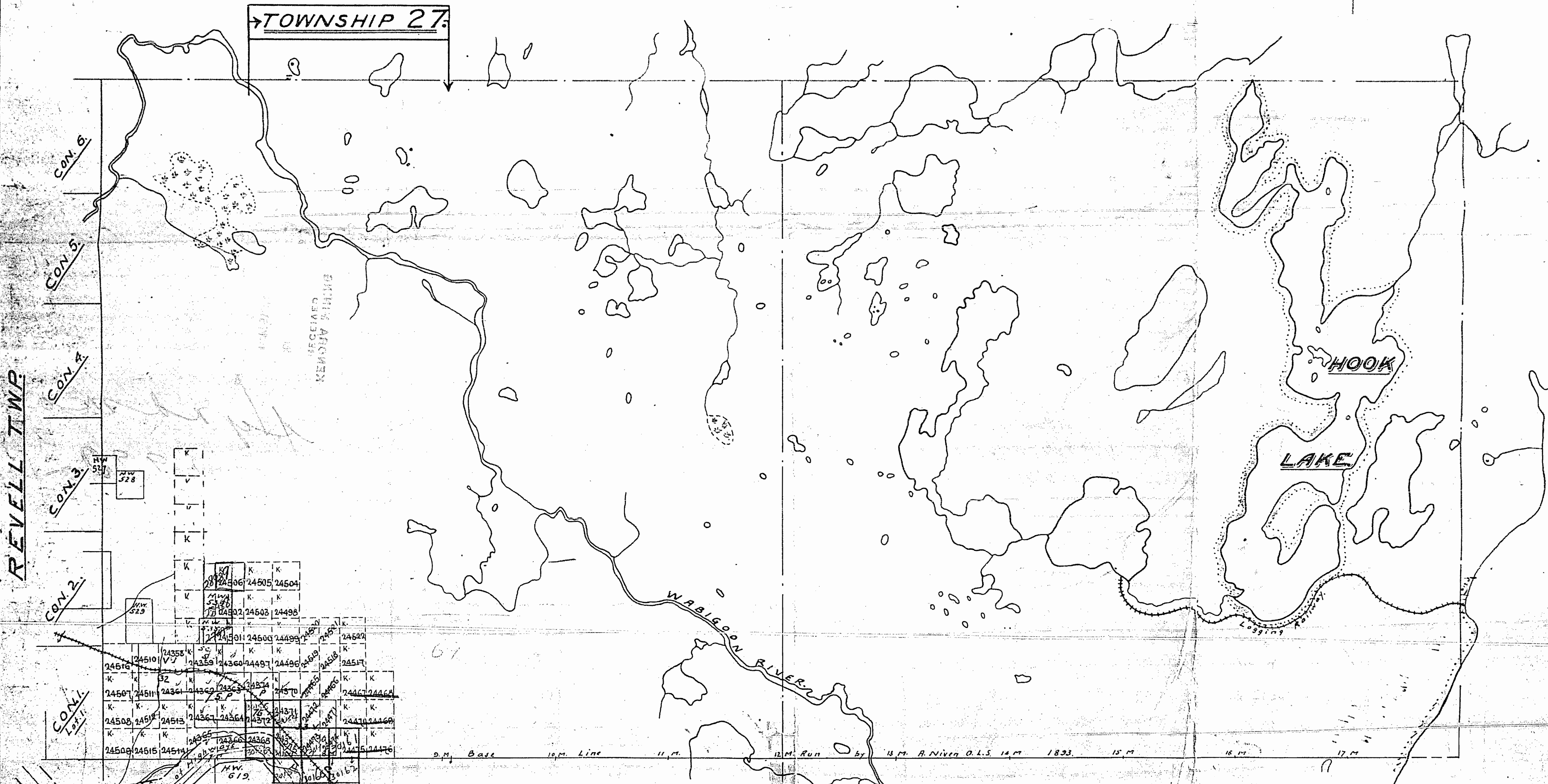

REV. 1874 Act 104
S. 1911 Act 104
- Northern Well

REV. 1874 Act 104
S. 1911 Act 104
- Northern Well

CON. 6

CON. 5

CON. 4

CON. 3

CON. 2

CON. 1

24501	24502	24503	24504	24505	24506	24507	24508	24509	24510
24511	24512	24513	24514	24515	24516	24517	24518	24519	24520
24521	24522	24523	24524	24525	24526	24527	24528	24529	24530
24531	24532	24533	24534	24535	24536	24537	24538	24539	24540
24541	24542	24543	24544	24545	24546	24547	24548	24549	24550

TWP. 26: Now HODGSON TWP.

TWP. 25: Now ILLSLEY TWP.

Surface reservations 400' wide by Dept. of L & F shown hereon
This reservation to apply only to the lands
shown on this plan.

NOW HYNDMAN TWP.

PLAN OF TOWNSHIP 27 & AREA EAST ADJOINING.

DISTRICT OF KENORA.
KENORA MINING DIVISION.

Scale: 40 chains to an inch.

M-1990

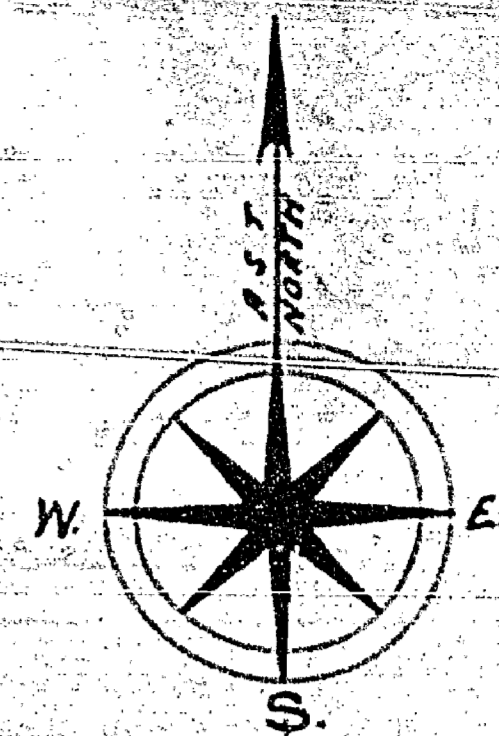

TOWNSHIP 27

REVELL TWP.

CON. 6

CON. 5

CON. 4

CON. 3

CON. 2

CON. 1



24510	24511	24512	24513	24514	24515	24516	24517	24518	24519
24520	24521	24522	24523	24524	24525	24526	24527	24528	24529
24530	24531	24532	24533	24534	24535	24536	24537	24538	24539
24540	24541	24542	24543	24544	24545	24546	24547	24548	24549
24550	24551	24552	24553	24554	24555	24556	24557	24558	24559

TWP. 26: Now HODGSON TWP.

TWP. 25: Now ALLSLEY TWP.

Surface reservations 400' wide by Dept. of L. & F. Spec. Heron
This reservation to apply also along the
Wabigoon River.

THE TOWNSHIP OF
OF
HYNDMAN
(1990)
DISTRICT OF
KENORA

KENORA
MINING DIVISION
SCALE: 1-INCH=40 CHAINS

LEGEND

- PATENTED LAND Ⓟ
- CROWN LAND SALE C.S.
- LEASES Ⓞ
- LOCATED LAND Loc.
- LICENSE OF OCCUPATION L.O.
- MINING RIGHTS ONLY M.R.O.
- SURFACE RIGHTS ONLY S.R.O.
- ROADS —
- IMPROVED ROADS —
- KING'S HIGHWAYS —
- RAILWAYS —
- POWER LINES —
- MARSH OR MUSKEG —
- MINES R
- CANCELLED C

NOTES

400' Reserve around all lakes & rivers to
Dept. of Lands & Forests.

KENORA
FILED:
REC'D. DEC - 7 1971
RECEIPT No.
MINING DIVISION

4/18/72
Sept. 26/72
June 7/73
Oct. 29/73
July 31/74
Feb 28/75

PLAN NO. - M.1990

ONTARIO
DEPARTMENT OF MINES
AND NORTHERN AFFAIRS

OP
6584
75-76
GLPCo.

PROJECTED LINE

GRAVEL
FILE
154607

6-395

403573	403574	403575	403576
403577	403578	403579	403580
403581	403582	403583	403584
403585	403586	403587	403588

REVELL TWP.

HODGSON TWP.

Hyndman Twp

ST WARDEN
OPPI

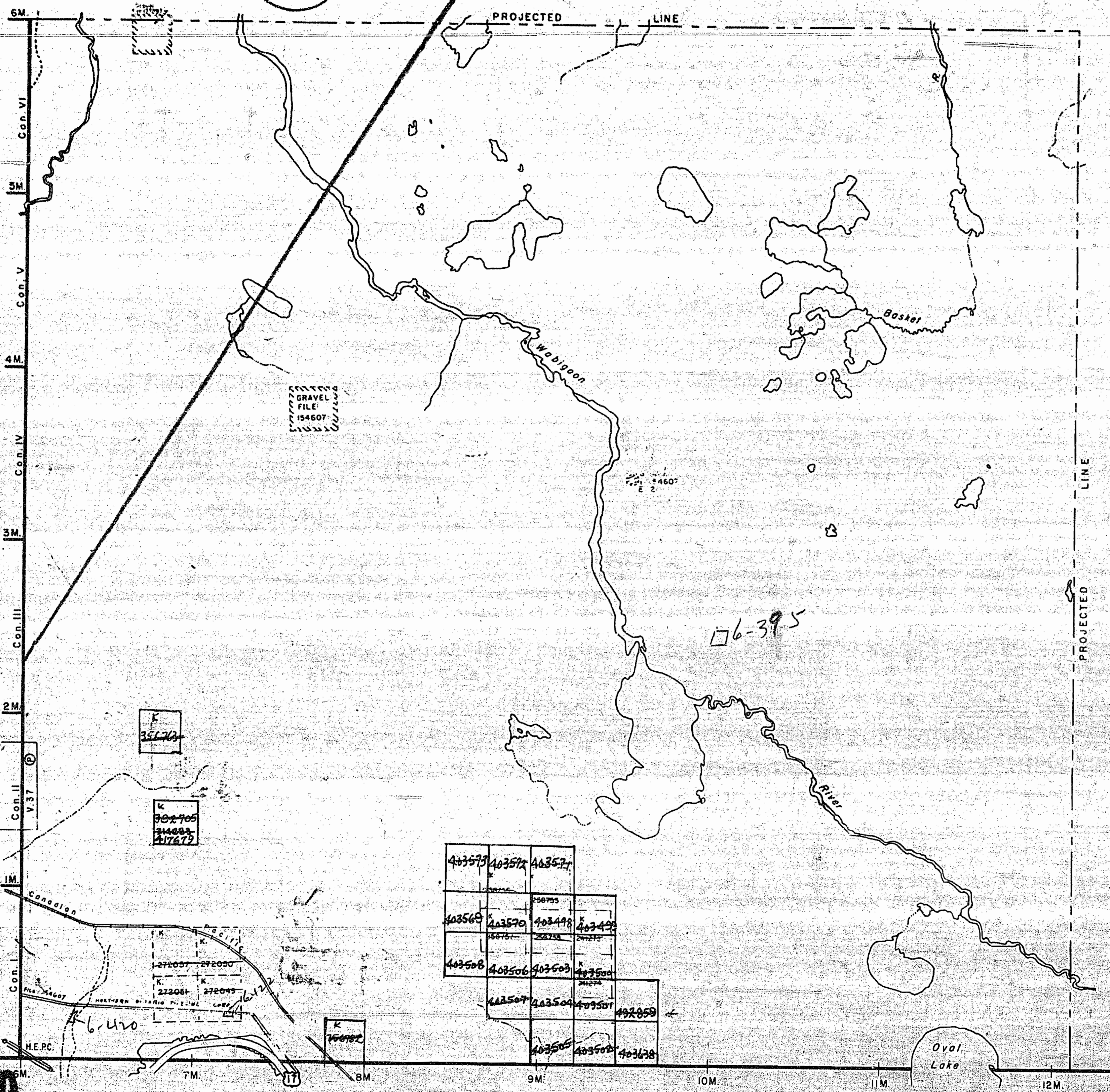

OF HYNDMAN

DISTRICT OF
KENORA

KENORA
MINING DIVISION

SCALE: 1 INCH = 40 CHAINS

LEGEND

PATENTED LAND	⊙
CROWN LAND SALE	⊙
LEASES	⊙
LOCATED LAND	⊙
LICENSE OF OCCUPATION	⊙
MINING RIGHTS ONLY	M.R.O.
SURFACE RIGHTS ONLY	S.R.O.
ROADS	—
IMPROVED ROADS	—
KING'S HIGHWAYS	—
RAILWAYS	—
POWER LINES	—
MARSH OR MUSKEG	⊙
MINES	⊙
CANCELLED	⊙

NOTES

400 Reserves shown on maps & rivers in
Dept. of Lands & Forests

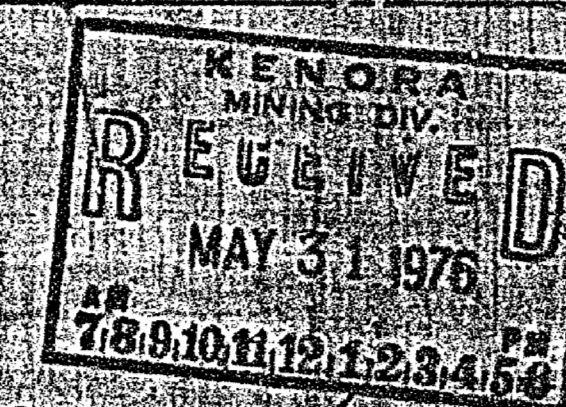

PLAN NO. M.1990

MINISTRY OF NATURAL RESOURCES

REVELL TWP.

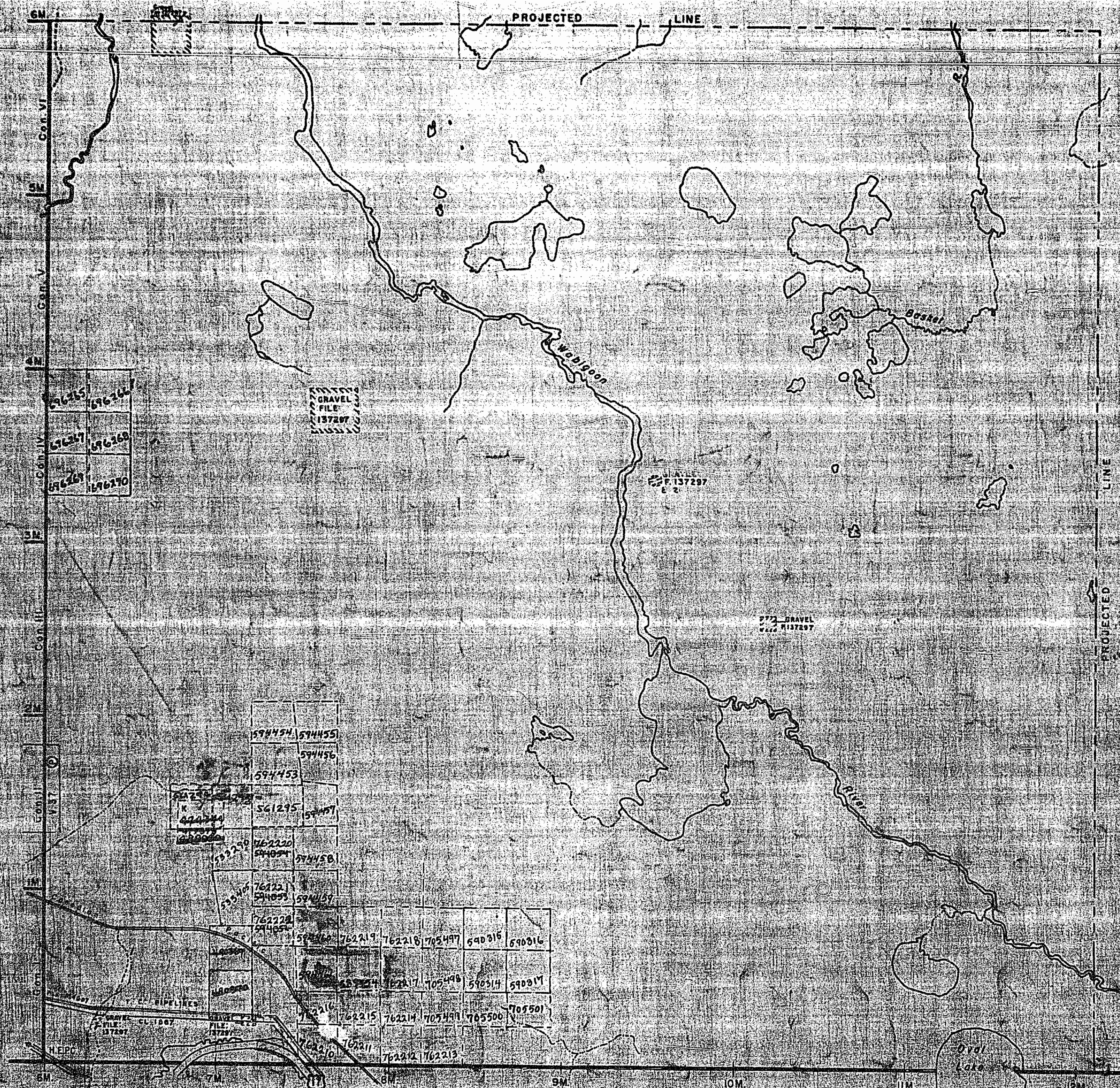

THE TOWNSHIP OF
OF
HYNDMAN

DISTRICT OF
KENORA
KENORA
MINING DIVISION

SCALE: 1-INCH=40 CHAINS

LEGEND

PATENTED LAND	Ⓟ
CROWN LAND SALE	C.S.
LEASES	Ⓛ
LOCATED LAND	Loc.
LICENSE OF OCCUPATION	L.O.
MINING RIGHTS ONLY	M.R.O.
SURFACE RIGHTS ONLY	S.R.O.
ROADS	—
IMPROVED ROADS	—
KING'S HIGHWAYS	—
RAILWAYS	—
POWER LINES	—
MARSH OR MUSKEG	—
MINES	X
CANCELLED	C.

NOTES

400' Surface Rights Reservation along the shores of all lakes and rivers.

Effective as of
Linen →

KENORA
MINING DIV.
RECEIVED
JUN 9 1983
AH 789 10 11 12 13 14 56 PM

DATE OF ISSUE
MAY 30 1983
SAND & GRAVEL

Ⓟ GRAVEL Ministry of Natural Resources TORONTO File: 137297
Ⓛ GRAVEL E 21 File: 137297

PLAN NO.- **M.1990**

ONTARIO
MINISTRY OF NATURAL RESOURCES
SURVEYS AND MAPPING BRANCH

REVELL TWP.

HODGSON TWP.

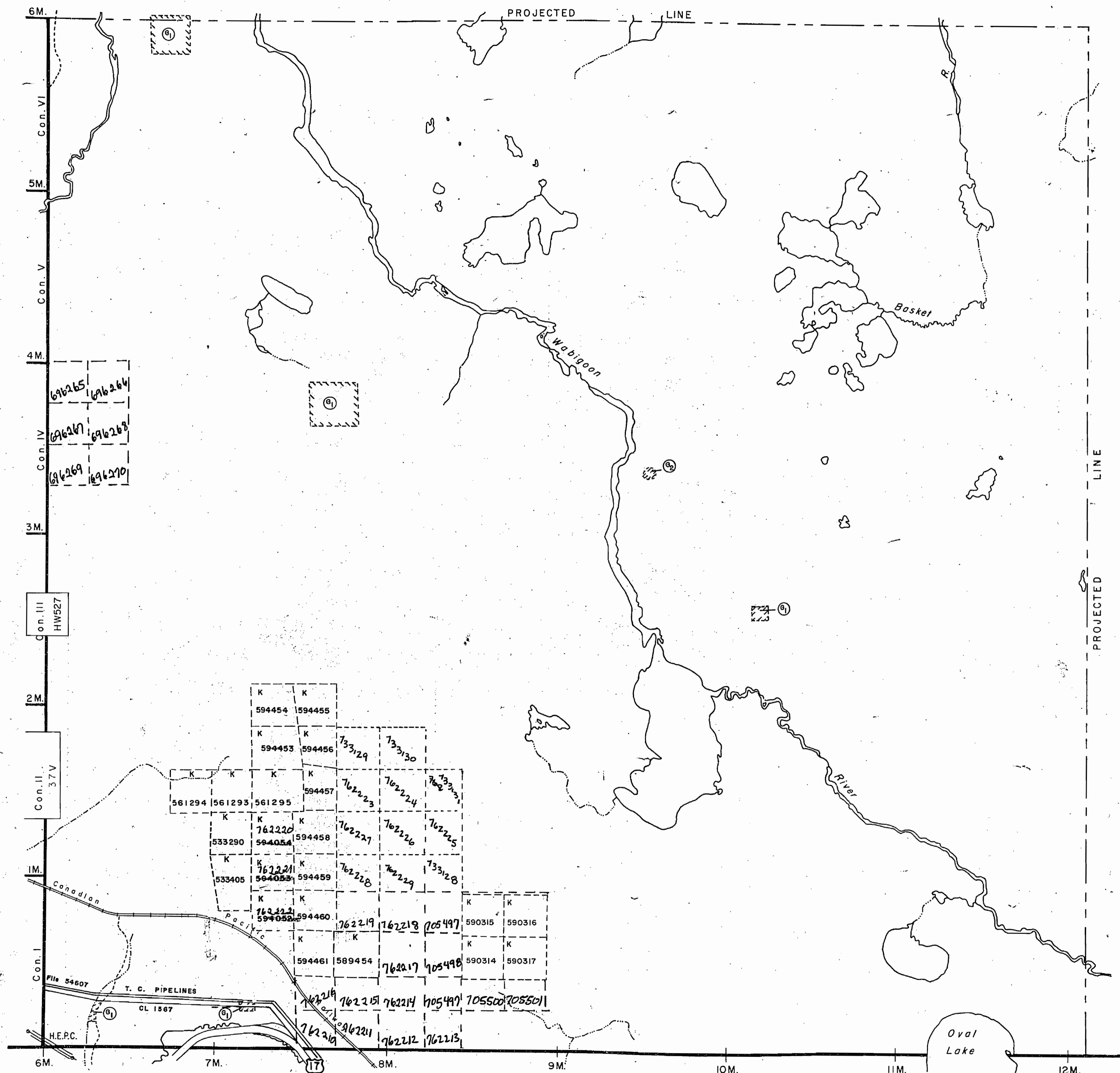

REFERENCES

LEGEND

HIGHWAY AND ROUTE No.	
OTHER ROADS	
TRAILS	
SURVEYED LINES:	
TOWNSHIPS, BASE LINES, ETC.	
LOTS, MINING CLAIMS, PARCELS, ETC.	
UNSURVEYED LINES:	
LOT LINES	
PARCEL BOUNDARY	
MINING CLAIMS ETC.	
RAILWAY AND RIGHT OF WAY	
UTILITY LINES	
NON-PERENNIAL STREAM	
FLOODING OR FLOODING RIGHTS	
SUBDIVISION OR COMPOSITE PLAN	
RESERVATIONS	
ORIGINAL SHORELINE	
MARSH OR MUSKEG	
MINES	
TRAVERSE MONUMENT	

DISPOSITION OF CROWN LANDS

TYPE OF DOCUMENT	SYMBOL
PATENT, SURFACE & MINING RIGHTS	
" SURFACE RIGHTS ONLY	
" MINING RIGHTS ONLY	
LEASE, SURFACE & MINING RIGHTS	
" SURFACE RIGHTS ONLY	
" MINING RIGHTS ONLY	
LICENCE OF OCCUPATION	
ORDER-IN-COUNCIL	
RESERVATION	
CANCELLED	
SAND & GRAVEL	

SCALE: 1 INCH = 40 CHAINS

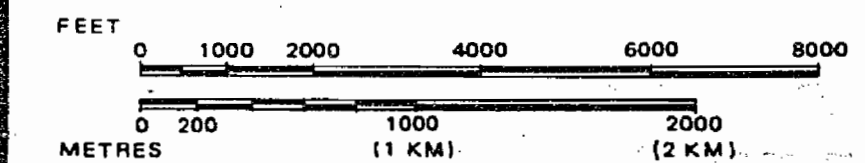

TOWNSHIP

HYNDMAN

M.N.R. ADMINISTRATIVE DISTRICT

DRYDEN

MINING DIVISION

KENORA

LAND TITLES / REGISTRY DIVISION

KENORA

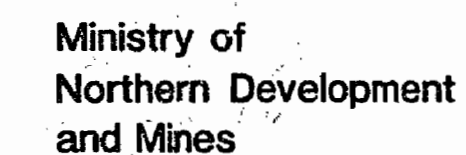
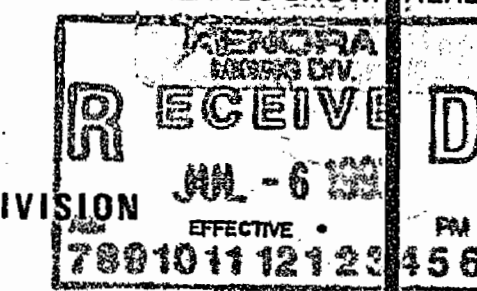

Date NOVEMBER /92

Number G-1314

REVELL TWP.

HODGSON TWP.

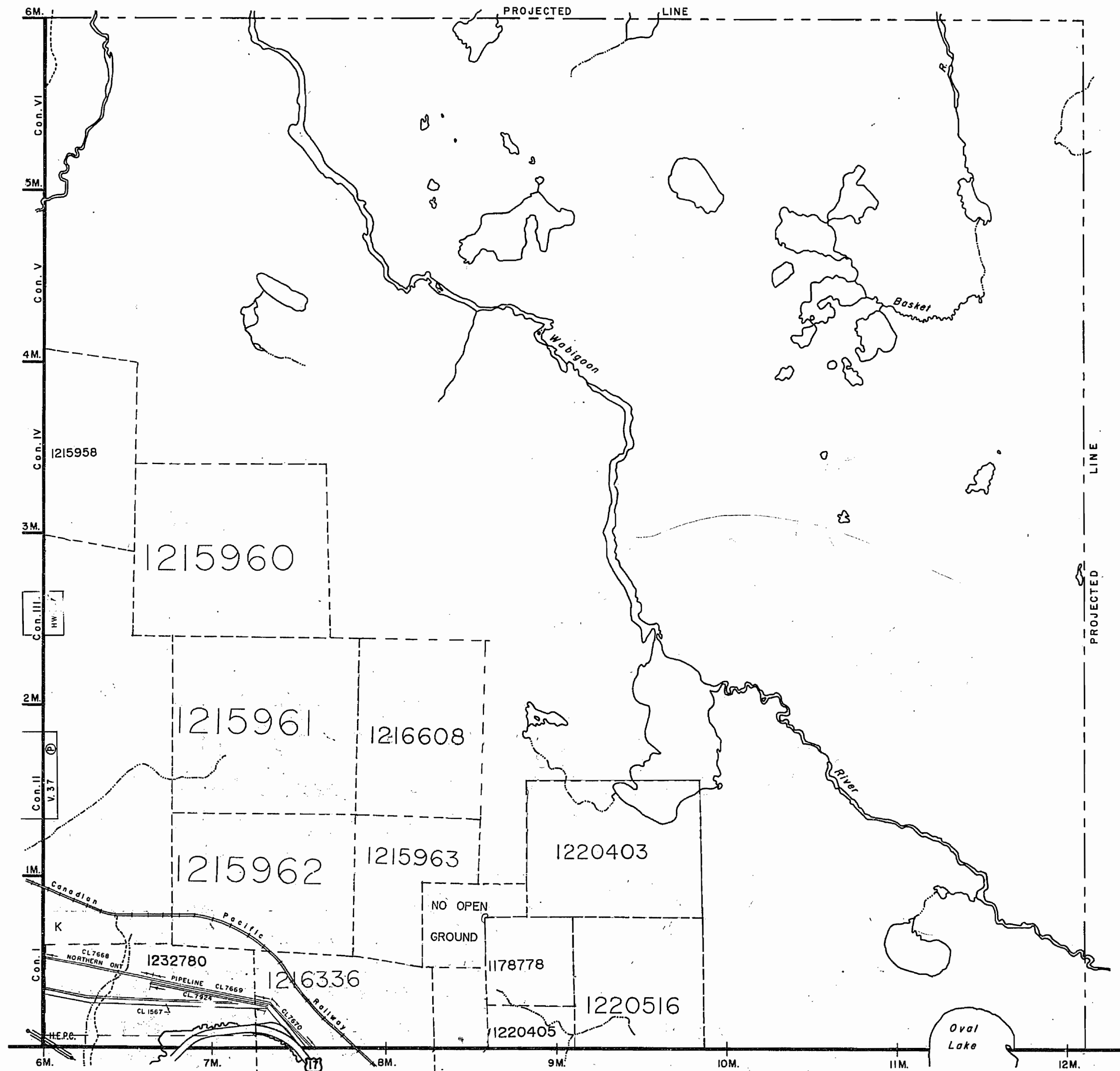

TRIM LINE

THE TOWNSHIP OF OF HYNDMAN

DISTRICT OF
KENORA

KENORA
MINING DIVISION

SCALE: 1-INCH=40 CHAINS

LEGEND

PATENTED LAND	⊙
CROWN LAND SALE	CS
LEASES	⊙
LOCATED LAND	Loc
LICENSE OF OCCUPATION	L.O.
MINING RIGHTS ONLY	M.R.O.
SURFACE RIGHTS ONLY	S.R.O.
ROADS	—
IMPROVED ROADS	—
KING'S HIGHWAYS	—
RAILWAYS	—
POWER LINES	—
MARSH OR MUSKEG	—
MINES	R
CANCELLED	C

NOTES

400' Reserve around all lakes & rivers to
Dept. of Lands & Forests.

PLAN NO. - M.1990

DEPARTMENT OF MINES

— ONTARIO —

REVELL TWP.

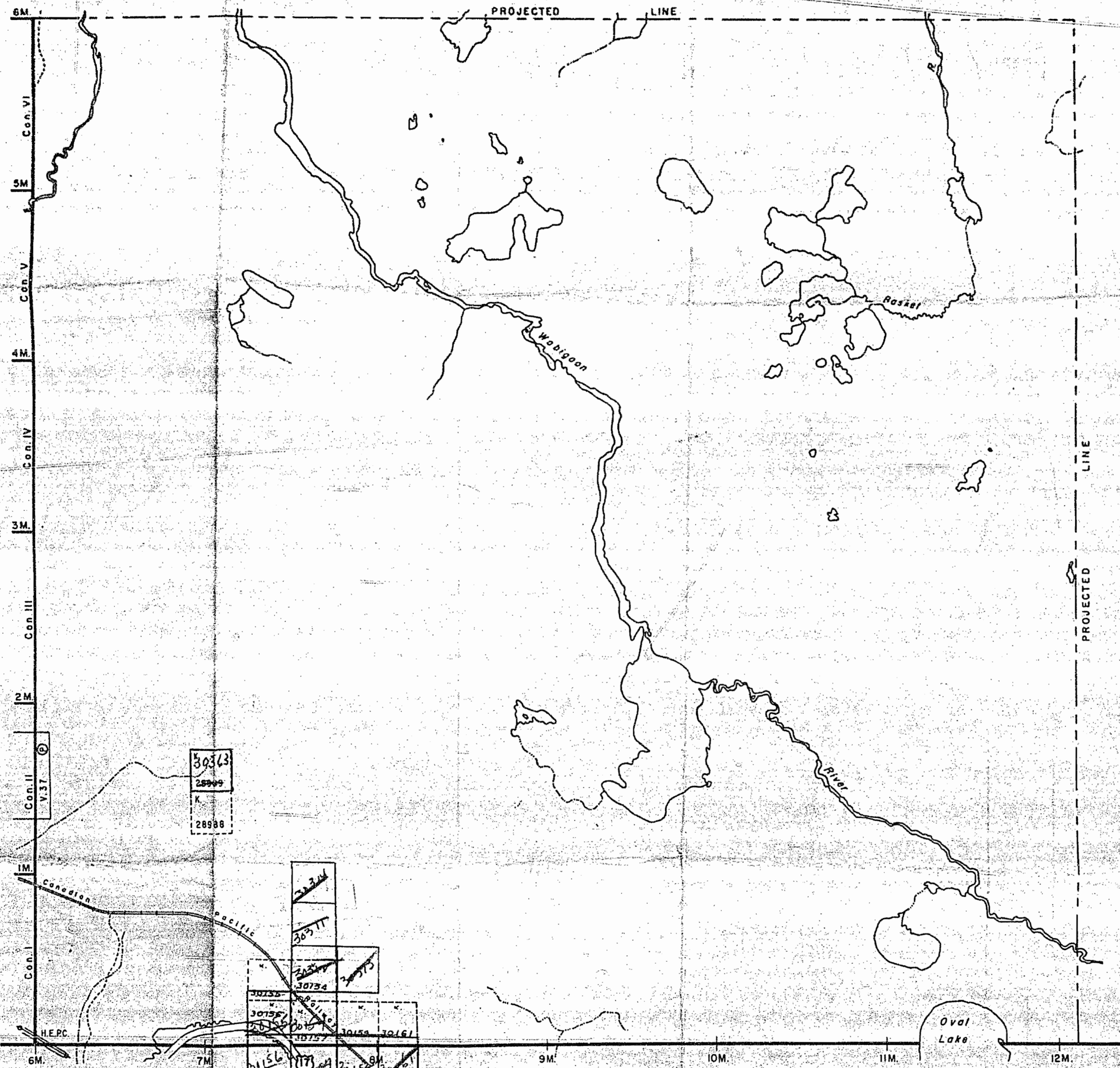

HODGSON TWP.

TRIM LINE

HYNDMAN 1990

HYNDMAN TWP.

1990

THE TOWNSHIP
OF
HYNDMAN

DISTRICT OF
KENORA

KENORA
MINING DIVISION

SCALE: 1-INCH=40 CHAINS

LEGEND

PATENTED LAND	—————
CROWN LAND SALE	—————
LEASES	—————
LOCATED LAND	—————
LICENSE OF OCCUPATION	—————
MINING RIGHTS ONLY	M.R.O.
SURFACE RIGHTS ONLY	S.R.O.
ROADS	—————
IMPROVED ROADS	—————
KING'S HIGHWAYS	—————
RAILWAYS	—————
POWER LINES	—————
MARSH OR MUSKEG	—————
MINES	—————
CANCELLED	—————

NOTES

400' Reserve around all lakes & rivers to Dept. of Lands & Forests.

KENORA
MINING DIV.
RECEIVED
MAY 31 1976
AM 7 8 9 10 11 12 1 2 3 4 5 6 PM

May 29 1976

PLAN NO. **M.1990**

ONTARIO
MINISTRY OF NATURAL RESOURCES

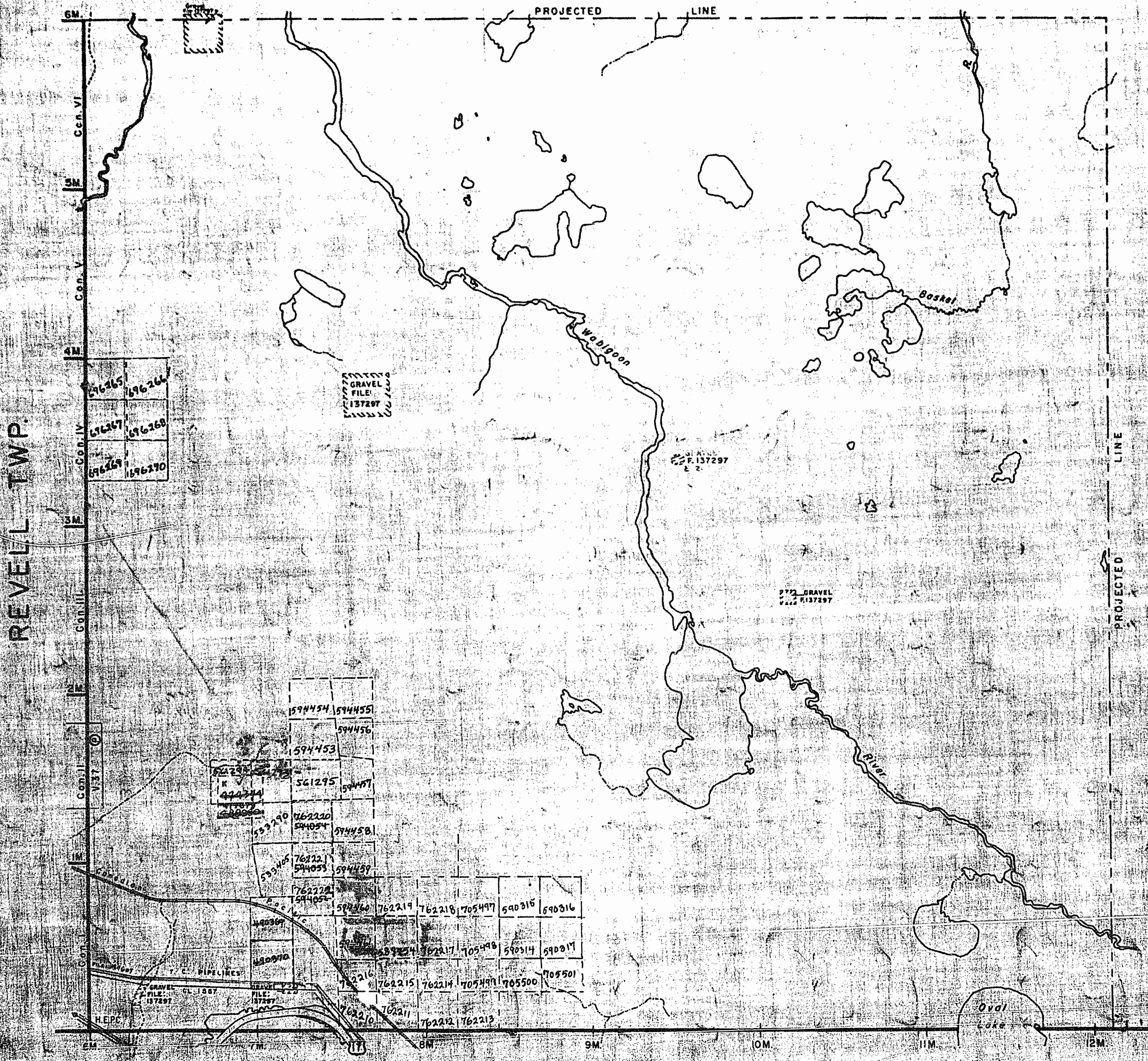

REVELL TWP.

HODGSON TWP.

G2562SUZANNE LAKE

THE TOWNSHIP OF
OF
HYNDMAN

DISTRICT OF
KENORA

KENORA
MINING DIVISION

SCALE: 1-INCH=40 CHAINS

LEGEND

PATENTED LAND	Ⓟ
CROWN LAND SALE	C.S.
LEASES	Ⓛ
LOCATED LAND	Loc.
LICENSE OF OCCUPATION	L.O.
MINING RIGHTS ONLY	M.R.O.
SURFACE RIGHTS ONLY	S.R.O.
ROADS	—
IMPROVED ROADS	—
KING'S HIGHWAYS	—
RAILWAYS	—
POWER LINES	—
MARSH OR MUSKEG	* *
MINES	X
CANCELLED	C.

NOTES

400' Surface Rights Reservation along the shores of all lakes and rivers.

THE INFORMATION THAT APPEARS ON THIS MAP HAS BEEN COMPILED FROM VARIOUS SOURCES, AND ACCURACY IS NOT GUARANTEED. THOSE WISHING TO STAKE MINING CLAIMS SHOULD CONSULT WITH THE MINING RECORDER, MINISTRY OF NORTHERN DEVELOPMENT AND MINES, FOR ADDITIONAL INFORMATION ON THE STATUS OF THE LANDS SHOWN HEREON.

KENORA MINING DIV.	
RECEIVED	RECEIVED
JUL 7 1983	JUL - 6 1983
AM 7 8 9 10 11 12 1 2 3 4 5 6	PM 10 11 12 1 2 3 4 5 6
OBSOLETE	

SAND & GRAVEL

Ⓢ	GRAVEL	File: 137297
Ⓢ	GRAVEL E 21	File: 137297

G-1314

PLAN NO. **M.1990**

ONTARIO
MINISTRY OF NATURAL RESOURCES
SURVEYS AND MAPPING BRANCH

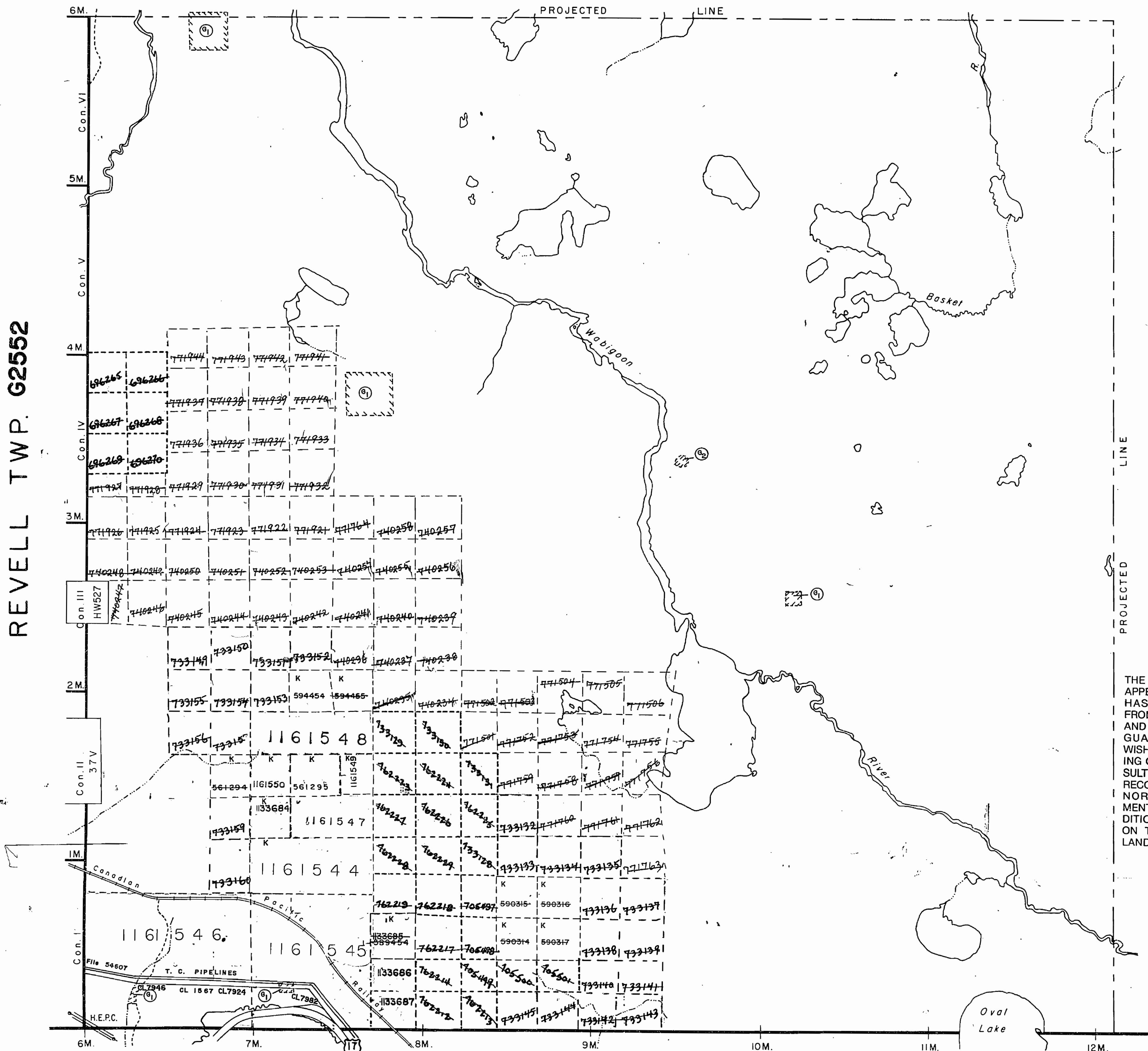

REVELL TWP. G2552

G2547 HOOK LAKE

HODGSON TWP. G1313

1990

QP
6384
75-76
GLPCo.

THE TOWNSHIP OF
OF
HYNDMAN
(1990)
DISTRICT OF
KENORA
KENORA
MINING DIVISION

SCALE: 1-INCH=40 CHAINS

LEGEND

- PATENTED LAND Ⓟ
- CROWN LAND SALE C.S.
- LEASES Ⓛ
- LOCATED LAND Loc.
- LICENSE OF OCCUPATION L.O.
- MINING RIGHTS ONLY M.R.O.
- SURFACE RIGHTS ONLY S.R.O.
- ROADS — — — — —
- IMPROVED ROADS — — — — —
- KING'S HIGHWAYS — — — — —
- RAILWAYS — — — — —
- POWER LINES — — — — —
- MARSH OR MUSKEG * * *
- MINES ⚡
- CANCELLED C.

NOTES

400' Reserve around all lakes & rivers to Dept. of Lands & Forests.

KENORA
FILED:
REC'D. DEC - 7 1971
RECEIPT No.
MINING DIVISION

4/18/72
Sept. 26/72
Jan 7/73
Oct. 29/73
July 31/74
Feb 28/75

PLAN NO. - M.1990

ONTARIO
DEPARTMENT OF MINES
AND NORTHERN AFFAIRS

REVELL TWP.

HODGSON TWP.

Hyndman Twp

1990
Hyndman Twp

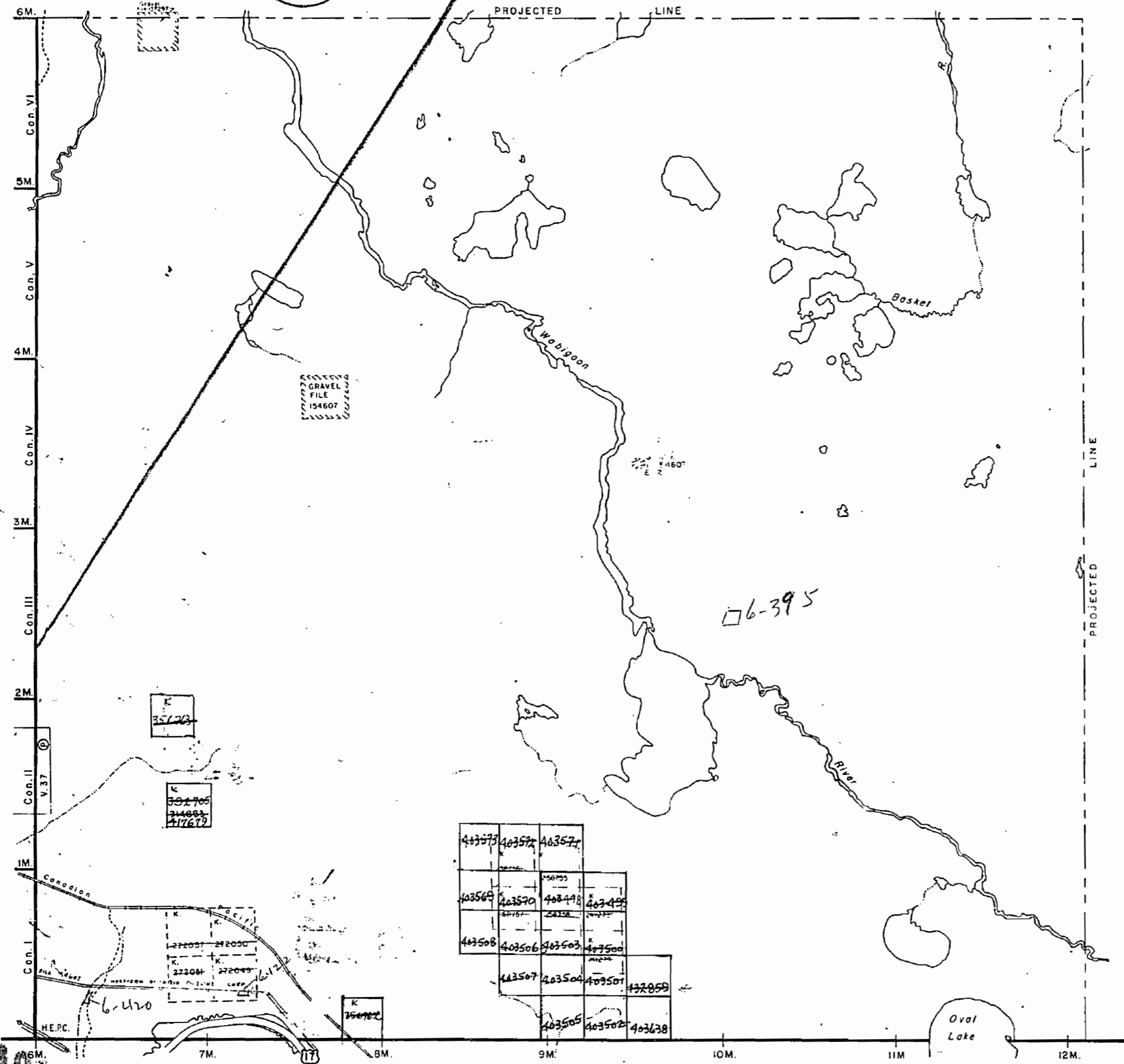

THE TOWNSHIP
OF
HYNDMAN

DISTRICT OF
KENORA

KENORA
MINING DIVISION

SCALE: 1-INCH=40 CHAINS

LEGEND

PATENTED LAND	Ⓟ
CROWN LAND SALE	C.S.
LEASES	Ⓛ
LOCATED LAND	Loc.
LICENSE OF OCCUPATION	L.O.
MINING RIGHTS ONLY	M.R.O.
SURFACE RIGHTS ONLY	S.R.O.
ROADS	—
IMPROVED ROADS	—
KING'S HIGHWAYS	—
RAILWAYS	—
POWER LINES	—
MARSH OR MUSKEG	—
MINES	ⓧ
CANCELLED	C

NOTES

400' Reserve around all lakes & rivers to
Dept. of Lands & Forests.

July 11/61
May 27/63
Sept. 20/63
June 19/66
May 29/68
Oct. 21/69
Apr. 1/70
Nov. 24/70
May 3/71

July 15/61
RECEIVED
OCT 31 1960
KENORA MINING DIV.

PLAN NO. **M.1990**

DEPARTMENT OF MINES

ONTARIO

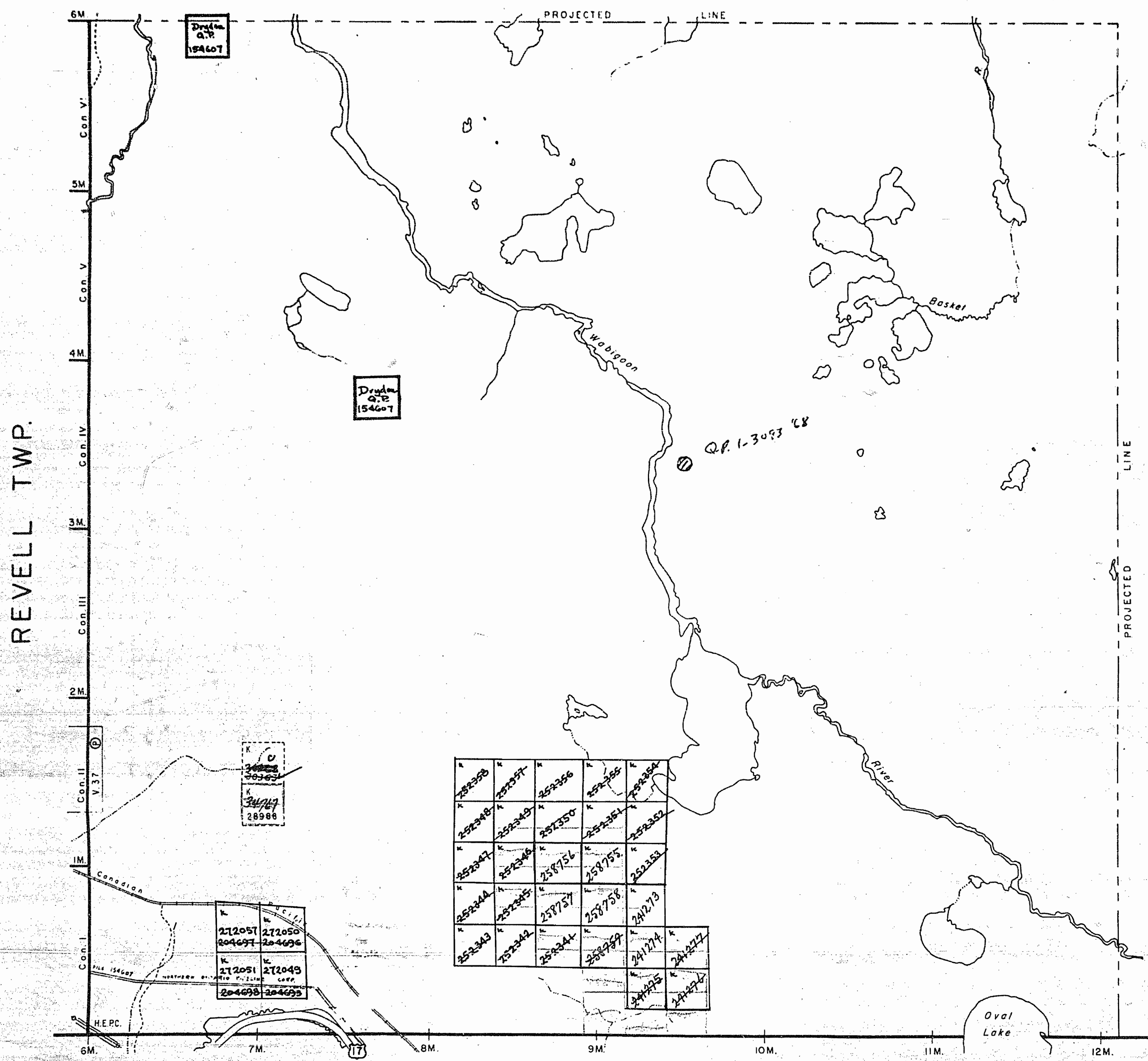

HODGSON TWP.

0001.M

REV. TWP. HODGSON

0001.M

1990

TRIM LINE

0001.M

REV. TWP. HODGSON

0001.M

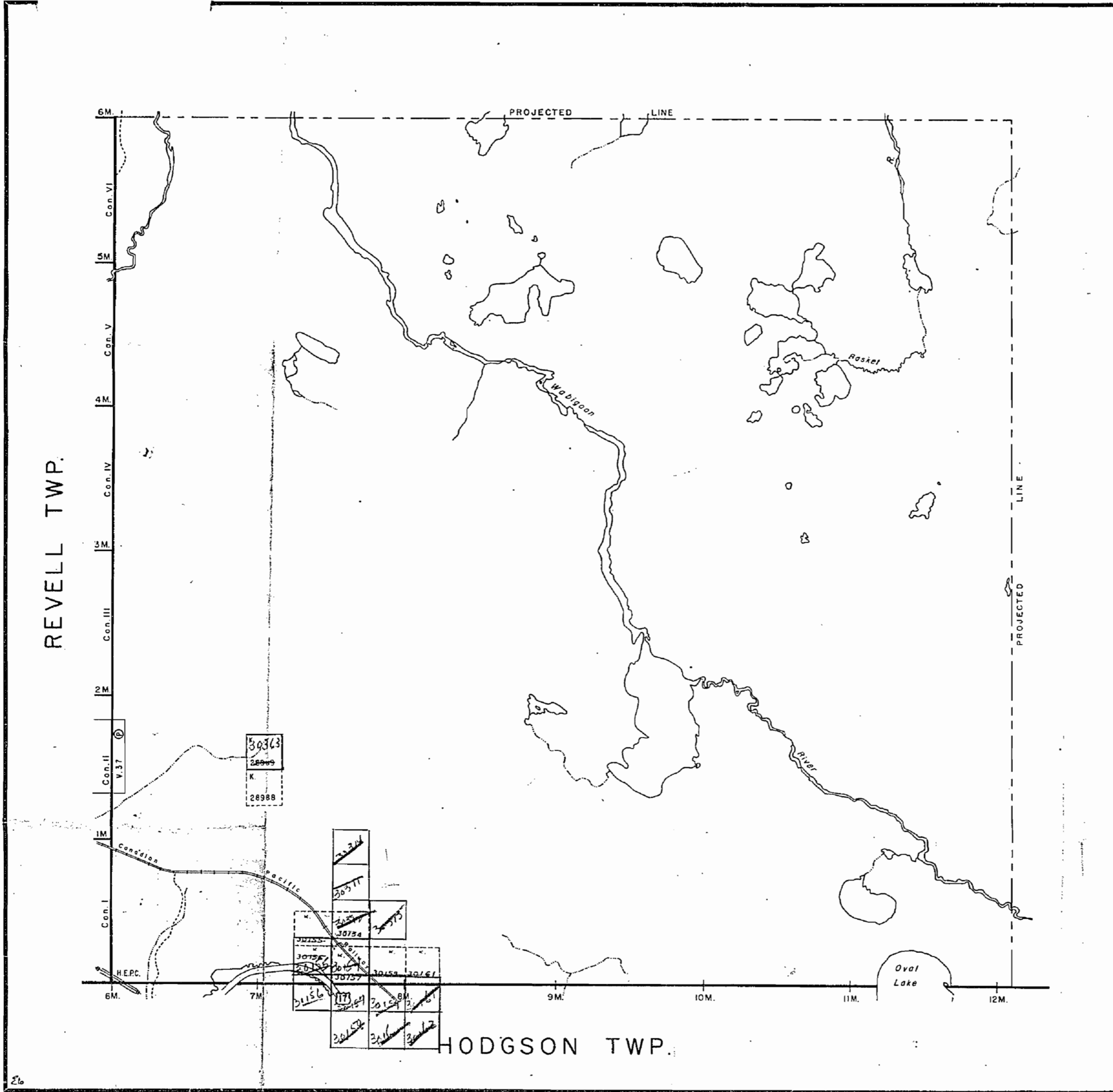

THE TOWNSHIP OF
 OF
HYNDMAN
 DISTRICT OF
 KENORA
 KENORA
 MINING DIVISION
 SCALE: 1-INCH=40 CHAINS

LEGEND

PATENTED LAND	Ⓟ
CROWN LAND SALE	C.S.
LEASES	Ⓞ
LOCATED LAND	Loc.
LICENSE OF OCCUPATION	L.O.
MINING RIGHTS ONLY	M.R.O.
SURFACE RIGHTS ONLY	S.R.O.
ROADS	—
IMPROVED ROADS	—
KING'S HIGHWAYS	—
RAILWAYS	—
POWER LINES	—
MARSH OR MUSKEG	—
MINES	✕
CANCELLED	C.

NOTES
 400' Reserve around all lakes & rivers to
 Dept. of Lands & Forests.

PLAN NO.- **M.1990**
 DEPARTMENT OF MINES
 — ONTARIO —

92
6854

HYNDMAN 1990

THE TOWNSHIP
OF
HYNDMAN
(1990)
DISTRICT OF
KENORA

KENORA
MINING DIVISION

SCALE: 1-INCH=40 CHAINS

LEGEND

- PATENTED LAND Ⓟ
- CROWN LAND SALE C.S.
- LEASES Ⓞ
- LOCATED LAND Loc.
- LICENSE OF OCCUPATION L.O.
- MINING RIGHTS ONLY M.R.O.
- SURFACE RIGHTS ONLY S.R.O.
- ROADS —
- IMPROVED ROADS —
- KING'S HIGHWAYS —
- RAILWAYS —
- POWER LINES —
- MARSH OR MUSKEG *
- MINES X
- CANCELLED C

NOTES

400' Reserve around all lakes & rivers to
Dept. of Lands & Forests.

KENORA
FILED:
REC'D. DEC - 7 1971
RECEIPT No.
MINING DIVISION

4/18/72
Sept. 26/72
June 7/73
Oct. 29/73
July 3/74
Feb 28/75

PLAN NO. - **M.1990**

ONTARIO
DEPARTMENT OF MINES
AND NORTHERN AFFAIRS

REVELL TWP.

HODGSON TWP.

Hyndman Twp

OP
6384
75-76
GLPC

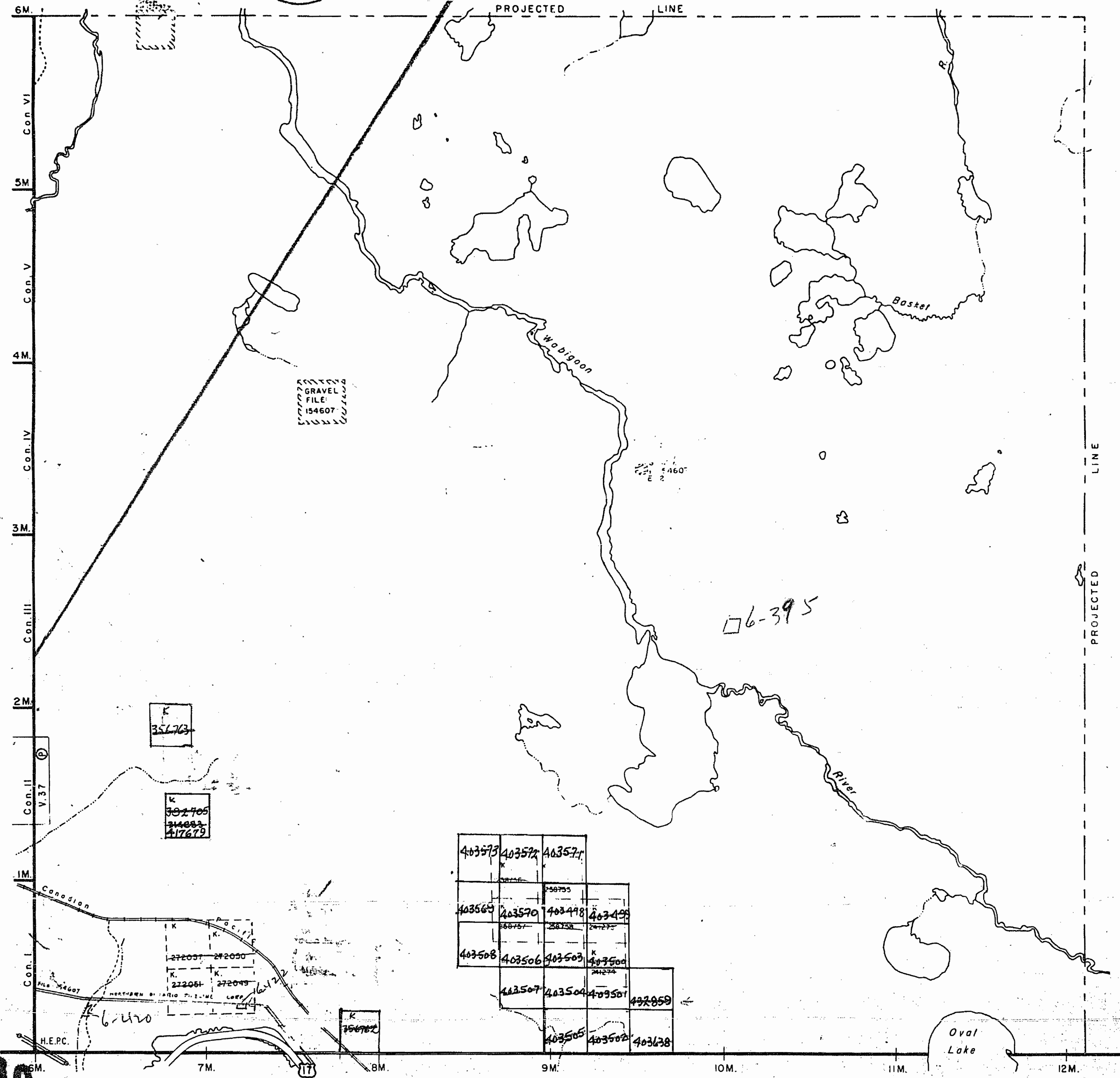

*OPPI
ST. NARROW*

2221-M. J. G. S. 1890. T. S. 1891. - Now HODGSON TWP.

NOW HYNDMAN TWP.

PLAN OF TOWNSHIP 27 & AREA EAST ADJOINING.

DISTRICT OF KENORA.
KENORA MINING DIVISION.

M-1990

Scale: 40 chains to an inch.

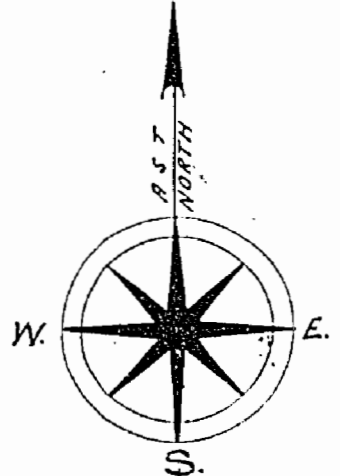

TOWNSHIP 27.

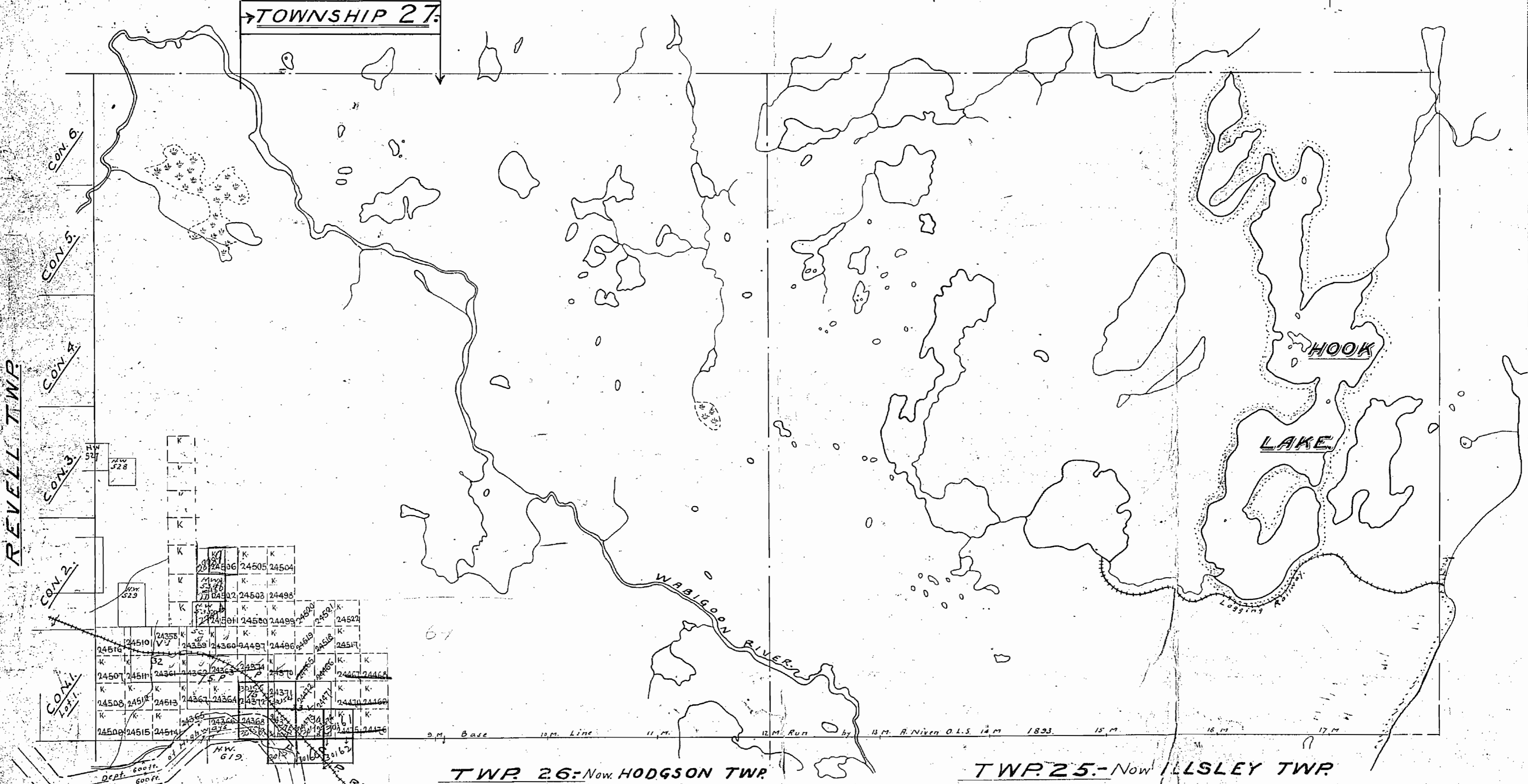

REVELL TWP.

TWP. 26:- Now HODGSON TWP.

TWP. 25:- Now ILLSLEY TWP.

Surface reservations 400' wide by Dept. of L & F shown hereon
This reservation to apply also along the
shores of all islands lying within the areas delineated above.

THE TOWNSHIP OF
OF
HYNDMAN
(1990)
DISTRICT OF
KENORA

KENORA
MINING DIVISION

SCALE: 1-INCH=40 CHAINS

LEGEND

- | | |
|-----------------------|--------|
| PATENTED LAND | Ⓟ |
| CROWN LAND SALE | C.S. |
| LEASES | Ⓞ |
| LOCATED LAND | Loc. |
| LICENSE OF OCCUPATION | L.O. |
| MINING RIGHTS ONLY | M.R.O. |
| SURFACE RIGHTS ONLY | S.R.O. |
| ROADS | — |
| IMPROVED ROADS | — |
| KING'S HIGHWAYS | — |
| RAILWAYS | — |
| POWER LINES | — |
| MARSH OR MUSKEG | — |
| MINES | ⓧ |
| CANCELLED | C. |

NOTES

400' Reserve around all lakes & rivers to
Dept. of Lands & Forests.

KENORA
FILED:
REC'D. DEC - 7 1971
RECEIPT No.
MINING DIVISION

4/18/72
Sept. 26/72
June 7/73
Oct. 29/73
July 3/74
Feb 28/75

PLAN NO. - M.1990

ONTARIO
DEPARTMENT OF MINES
AND NORTHERN AFFAIRS

REVELL TWP.

HODGSON TWP.

Hyndman Twp

OP
6384
75-76
GLP Co.

6-395

GRAVEL
FILE
154607

K
35773

K
302405
314883
417673

403573	403572	403571	
		256755	
403569	403570	403498	403499
	28758	28757	
403508	403506	403503	403504
		241274	
403507	403504	403501	403502
			403503
	403505	403502	403628

272037 272050
272041 272049

6-420

K
350782

Oval
Lake

OP
Hyndman Twp

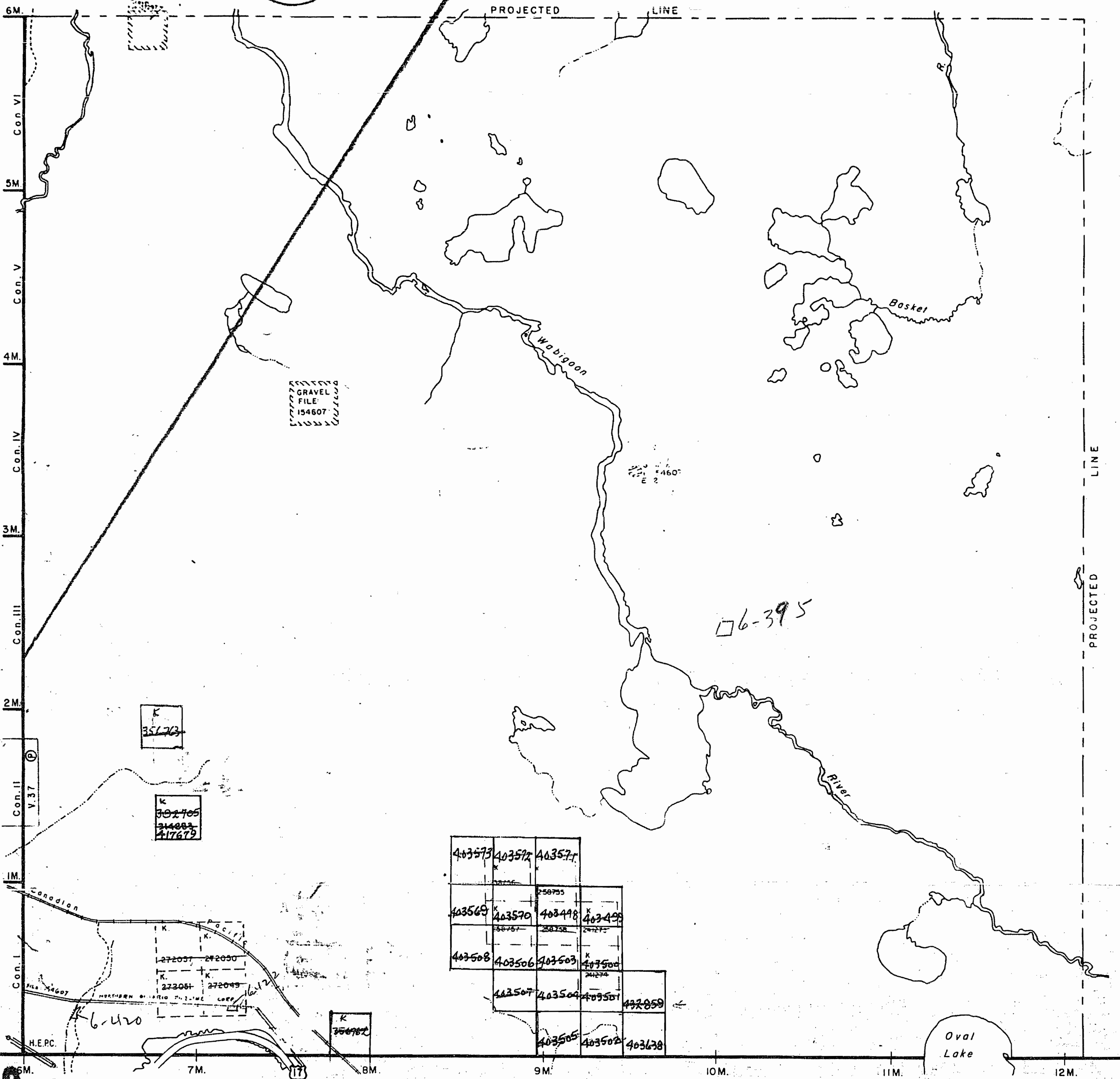

1990

REVELL TWP.

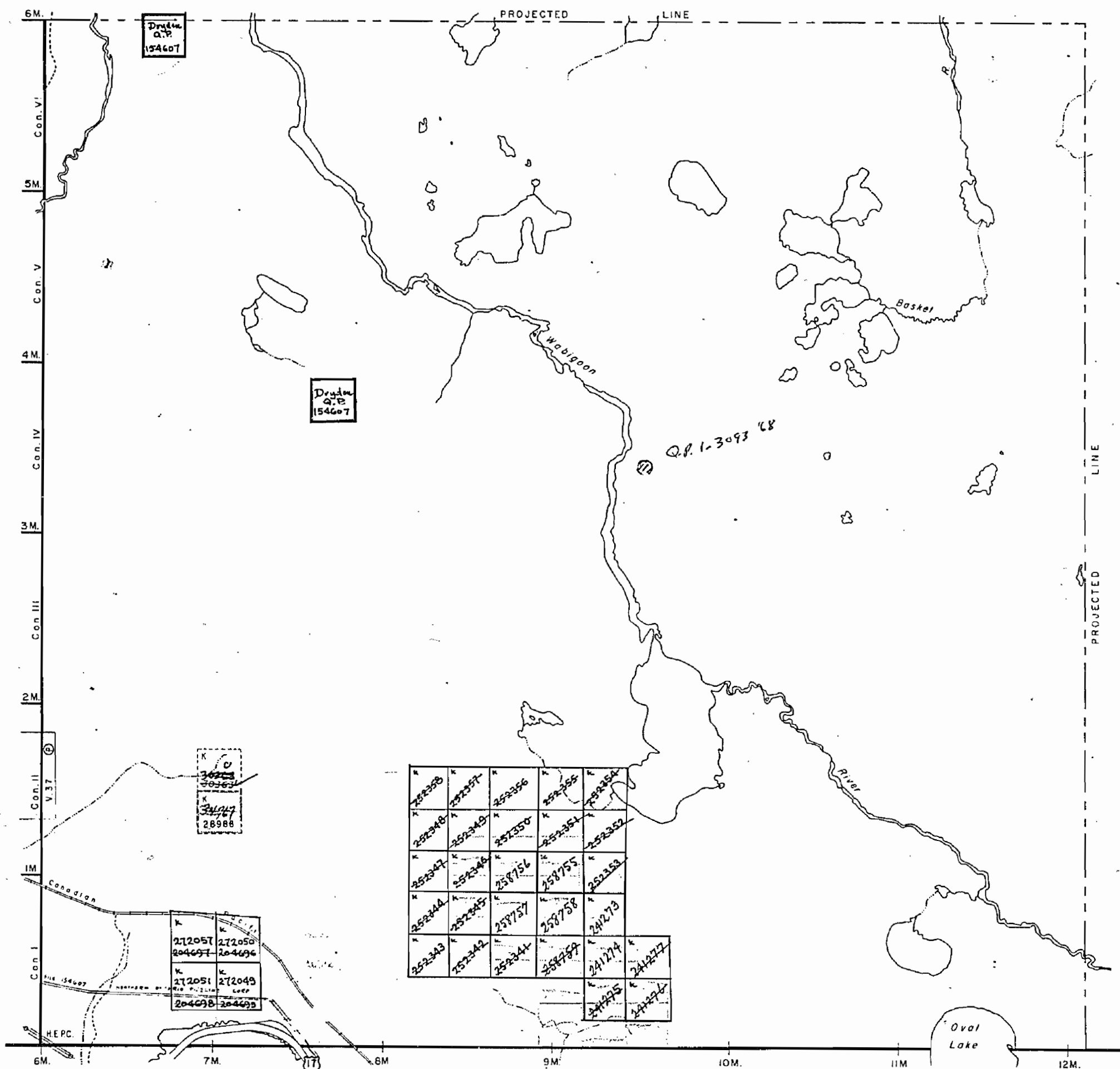

HODGSON TWP.

HYNDMAN

THE TOWNSHIP OF
OF
HYNDMAN

DISTRICT OF
KENORA

KENORA
MINING DIVISION

SCALE: 1-INCH=40 CHAINS

LEGEND

PATENTED LAND	Ⓟ
CROWN LAND SALE	C.S.
LEASES	Ⓞ
LOCATED LAND	Loc.
LICENSE OF OCCUPATION	L.O.
MINING RIGHTS ONLY	M.R.O.
SURFACE RIGHTS ONLY	S.R.O.
ROADS	—
IMPROVED ROADS	—
KING'S HIGHWAYS	—
RAILWAYS	—
POWER LINES	—
MARSH OR MUSKEG	—
MINES	ⓧ
CANCELLED	C.

NOTES

400' Reserve around all lakes & rivers to
Dept. of Lands & Forests.

July 11/61
May 27/63
Sept. 20/63
June 19/66
May 25/68
Oct 21/69
April 1/70
Nov 24/70
May 3/71

July 15/61
RECEIVED
OCT 31 1960
KENORA MINING DIV.

PLAN NO. **M.1990**

DEPARTMENT OF MINES

— ONTARIO —

THE TOWNSHIP OF
OF
HYNDMAN

DISTRICT OF
KENORA

KENORA
MINING DIVISION

SCALE: 1-INCH=40 CHAINS

LEGEND

PATENTED LAND	Ⓟ
CROWN LAND SALE	C.S.
LEASES	Ⓛ
LOCATED LAND	Loc.
LICENSE OF OCCUPATION	L.O.
MINING RIGHTS ONLY	M.R.O.
SURFACE RIGHTS ONLY	S.R.O.
ROADS	—
IMPROVED ROADS	—
KING'S HIGHWAYS	—
RAILWAYS	—
POWER LINES	—
MARSH OR MUSKEG	—
MINES	⌘
CANCELLED	C.

NOTES

400' Reserve around all lakes & rivers to
Dept. of Lands & Forests.

REVELL TWP.

HODGSON TWP.

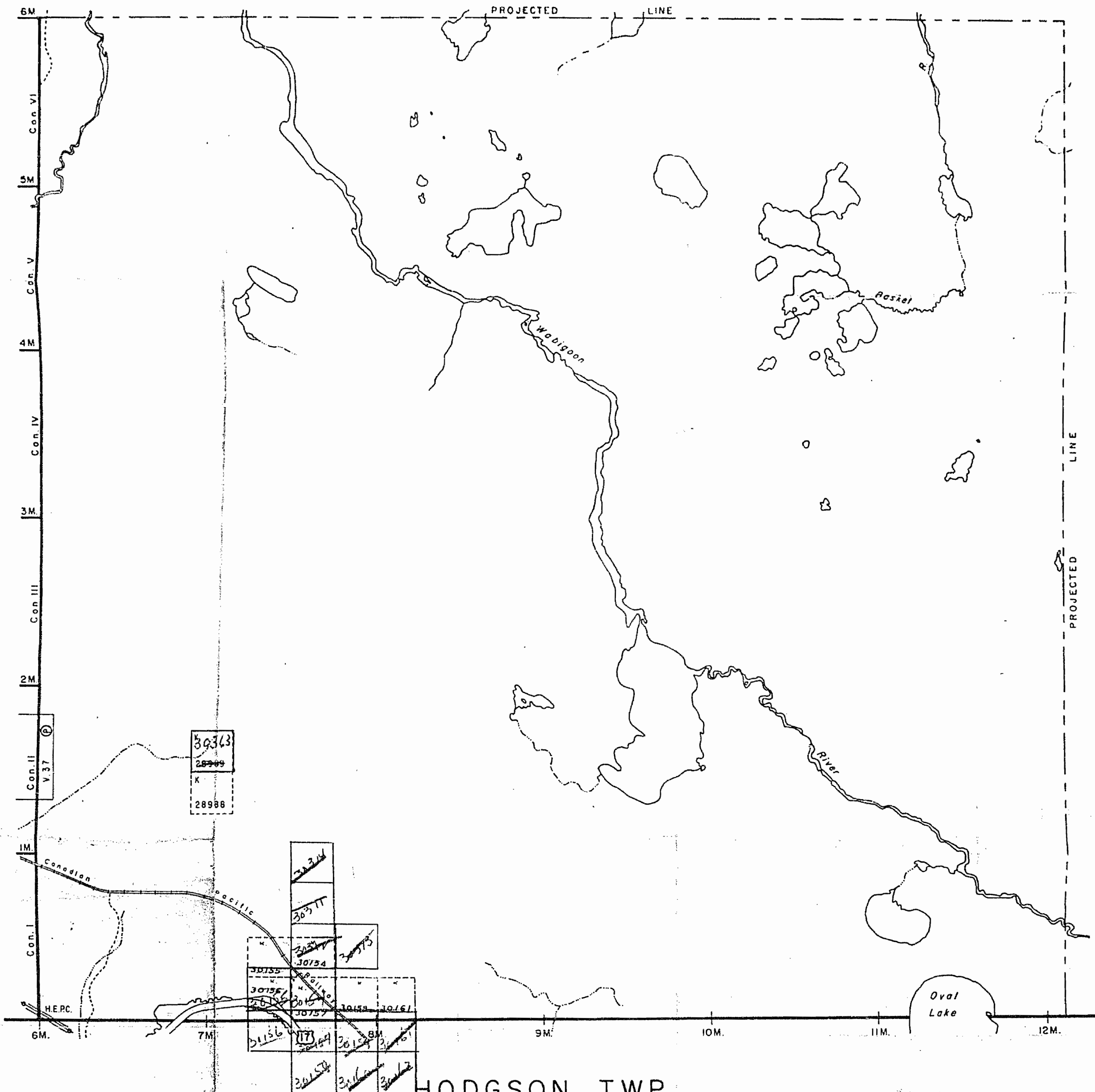

PLAN NO. **M.1990**

DEPARTMENT OF MINES

— ONTARIO —

THE TOWNSHIP
OF
HYNDMAN

DISTRICT OF
KENORA

KENORA
MINING DIVISION

SCALE: 1-INCH=40 CHAINS

LEGEND

PATENTED LAND	⊙
CROWN LAND SALE	C.S.
LEASES	⊕
LOCATED LAND	Loc.
LICENSE OF OCCUPATION	L.O.
MINING RIGHTS ONLY	M.R.O.
SURFACE RIGHTS ONLY	S.R.O.
ROADS	—
IMPROVED ROADS	—
KING'S HIGHWAYS	—
RAILWAYS	—
POWER LINES	—
MARSH OR MUSKEG	—
MINES	⊗
CANCELLED	c

NOTES

400' Reserve around all lakes & rivers to
Dept. of Lands & Forests.

PLAN NO.- **M.1990**

DEPARTMENT OF MINES

— ONTARIO —

REVELL TWP.

HODGSON TWP.

