

# Now, IGNACE TWP. TOWNSHIP 22

M.1991

KENORA M.G. DIV.

DISTRICT OF KENORA

ONTARIO  
MINISTRY OF NATURAL RESOURCES  
SURVEYS AND MAPPING BRANCH

**NOTES**

Areas withdrawn from staking under Section 42 of the Mining Act, 1945 (1960) and 43 (1970)

| File   | Date      | Disposition |
|--------|-----------|-------------|
| 179240 | Feb 17/71 | S.R.O.      |
| 91307  |           | S.R.O.      |

Sept 4/74

Scale: - 40 Chains = 1 Inch

DATE OF ISSUE  
OCT 1 1974

RECEIVED  
OCT 10 1974  
AM 7:00 10:11 12:12 3:45 PM

GOURM-1983  
TWP. 23.

OP. 5502  
74-75  
G.A.P. Co.

PROVINCIAL PARK  
"SANDIAR LAKE"  
WITHDRAWN FROM STAKING  
SEC. 42 OF THE MINING ACT.  
FILE: 171523

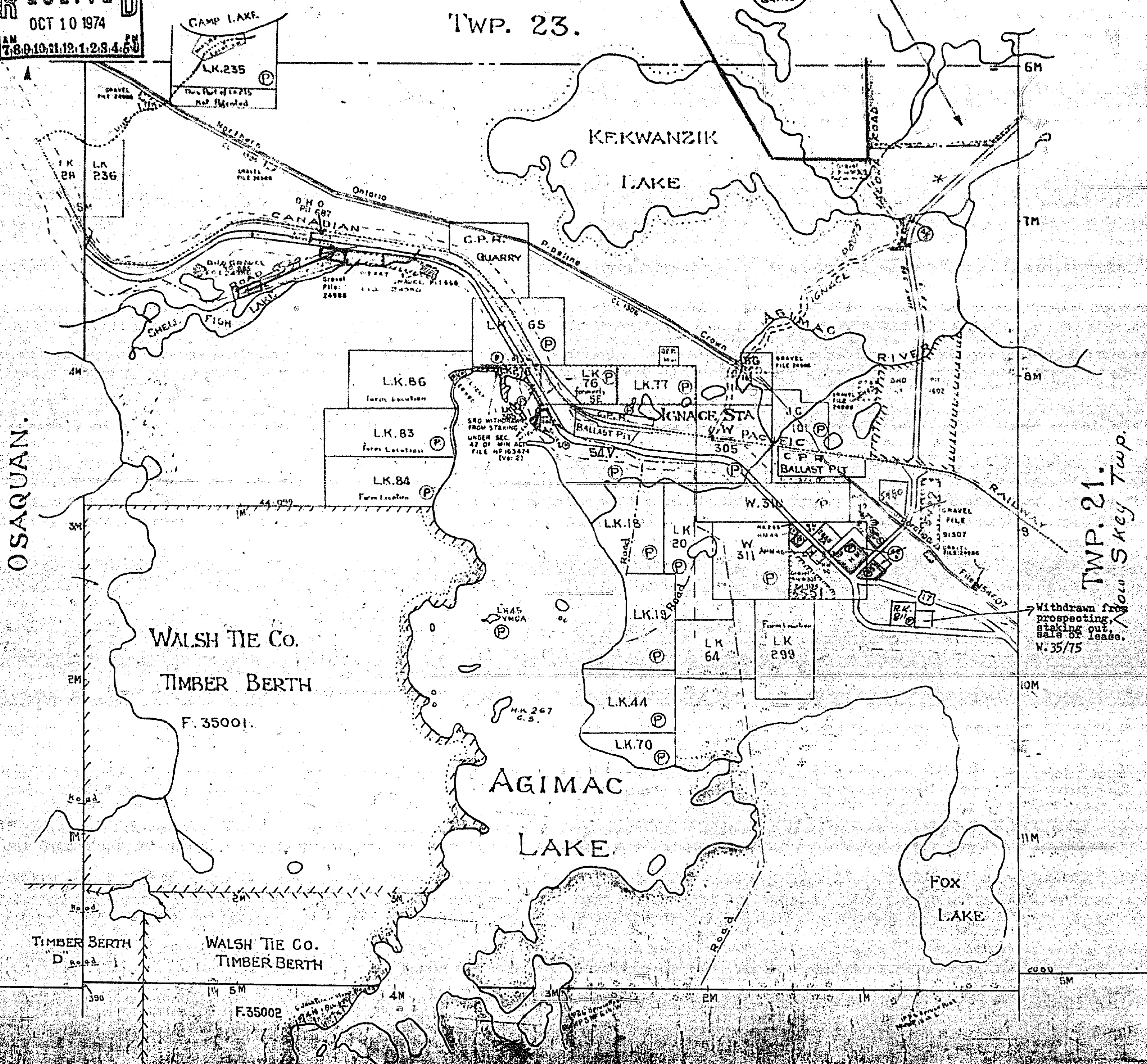

Withdrawn from prospecting, staking out, sale of lease. W. 35/75

TWP. 21.  
Now Skeg Twp.

INDICATES UNDER PATENT  
1974-1991

DATE OF ISSUE  
AUG 19 1975

# Now, IGNACE TWP. TOWNSHIP 22

RECEIVED  
AUG 22 1975

M.1991

KENORA DISTRICT  
MG. DIV.  
DISTRICT OF KENORA

ONTARIO  
MINISTRY OF NATURAL RESOURCES  
SURVEYS AND MAPPING BRANCH

**NOTES**  
Areas withdrawn from staking under Section  
42 of the Mining Act, (R.S.O. (1960) c. 43 (S.O. 1970))  
File 179740 Date Feb. 17/71 Disposition S.R.O. Order No.  
1885-2 23/2/72 S.R.O. 14775

Scale: 40 Chains = 1 Inch

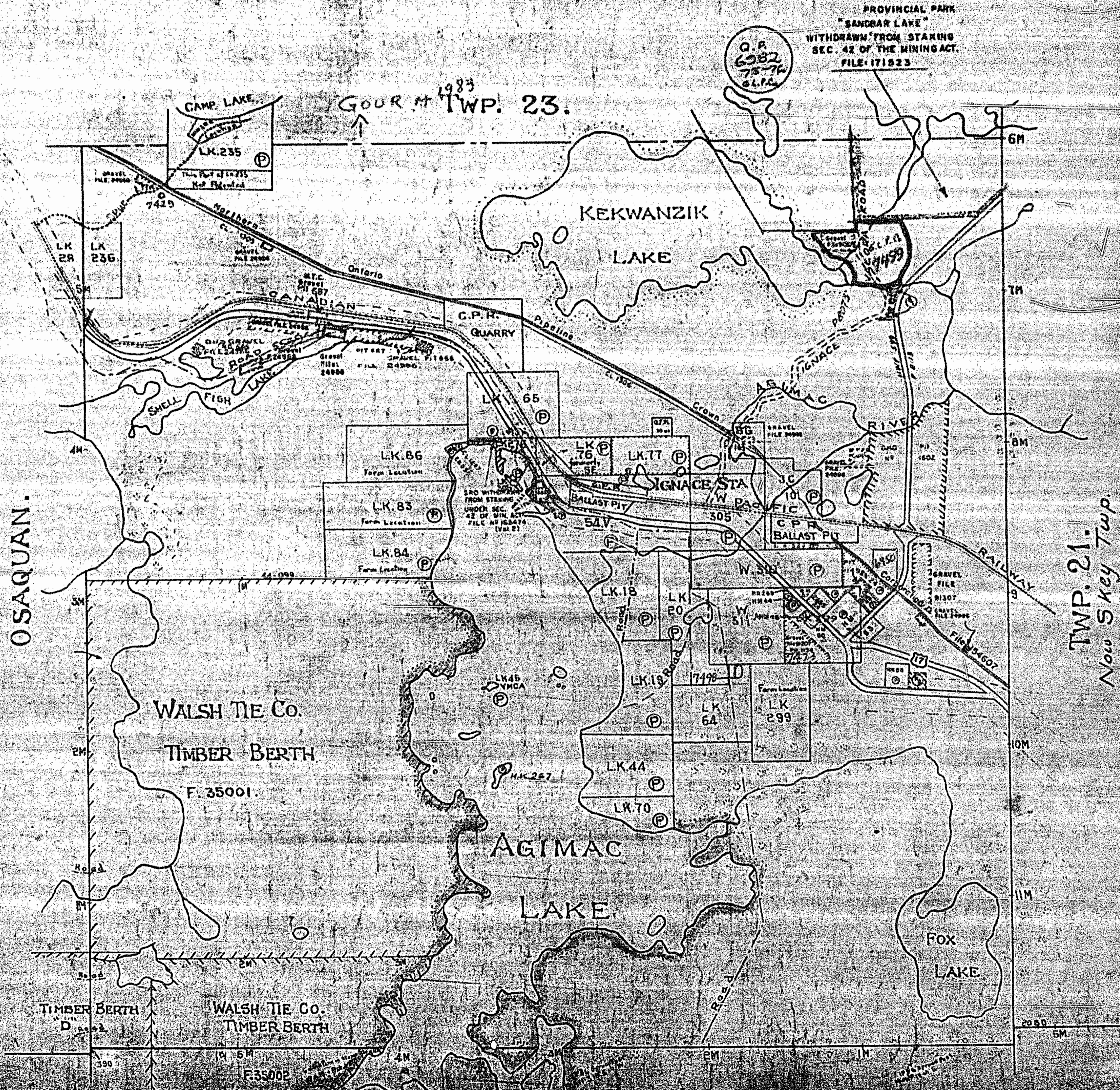

GOURM<sup>1983</sup> TWP. 23.

O.P.  
6982  
75-76  
61.P.C.

PROVINCIAL PARK  
"SANDBAR LAKE"  
WITHDRAWN FROM STAKING  
SEC. 42 OF THE MINING ACT.  
FILE: 171523

OSAQUAN.

TWP. 21.  
Now S Key Twp.

WALSH TIE CO.  
TIMBER BERTH  
F. 35001

TIMBER BERTH  
D 2002

WALSH TIE CO.  
TIMBER BERTH  
F. 35002

AGIMAC  
LAKE

FOX  
LAKE

**NOTES**

**AREAS WITHDRAWN FROM DISPOSITION**

- M.R.O. - MINING RIGHTS ONLY
- S.R.O. - SURFACE RIGHTS ONLY
- M.+S. - MINING AND SURFACE RIGHTS

| Description   | Order No. | Date     | Disposition | File   |
|---------------|-----------|----------|-------------|--------|
| R1 SEC. 43/70 |           | 25/7/75  | S.R.O.      | 188519 |
| R2 Sect. 36   | W 56/86   | 17/07/86 | S+M.R.      | 188555 |
| R3 Sec. 36    | W-5/87    | 08/01/87 | S+M.R.      | 188555 |

**SAND and GRAVEL**

- Q QUARRY PERMIT
- G1 GRAVEL FILE 24986
- G2 GRAVEL FILE 91307
- G3 GRAVEL PIT 666
- G4 GRAVEL PIT 667
- G5 GRAVEL PIT 687

NOTICE: THE SURFACE RIGHTS LYING WITHIN 40.25m OF THE CENTRE LINE OF THE TRANSCANADA PIPELINE RIGHT OF WAY ARE WITHDRAWN FROM STAKING OUT, PROSPECTING, SALE OR LEASE BY ORDER W.O.191 ONT. DATED SEPT. 30, 1991. SECTION 122 OF THE NATIONAL ENERGY BOARD ACT APPLIES.

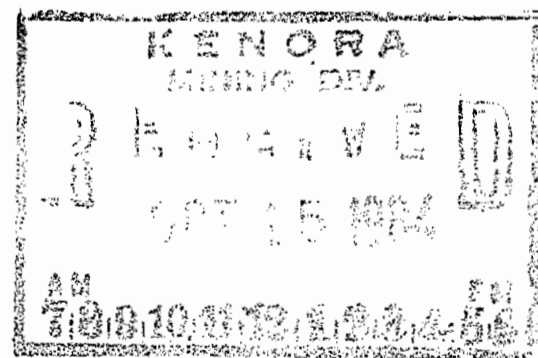

Effective as shown

**G1311**  
GOUR TP. ~~M.1983~~

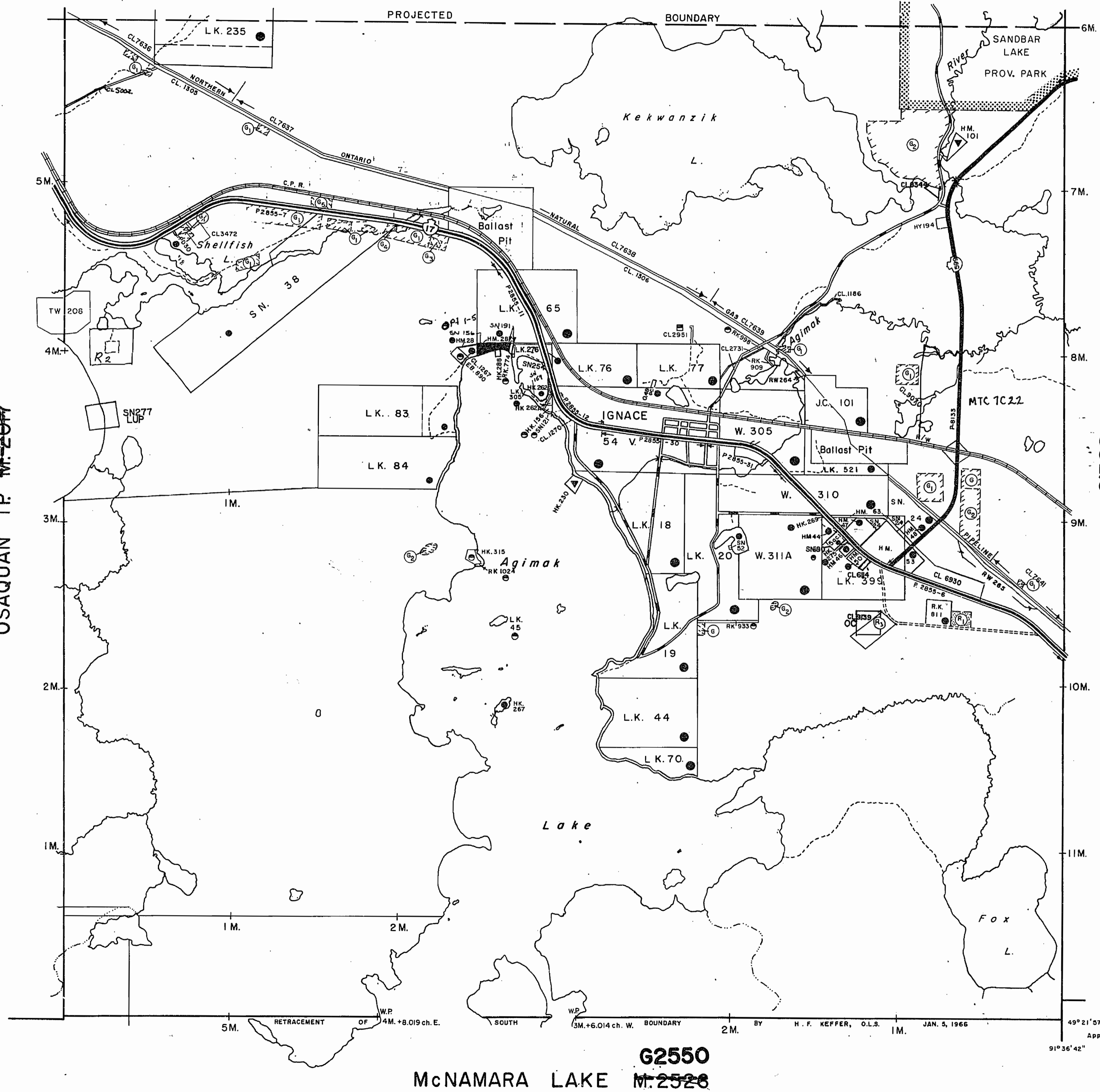

**LEGEND**

- HIGHWAY AND ROUTE No.
- OTHER ROADS
- TRAILS
- SURVEYED LINES:
  - TOWNSHIPS, BASE LINES, ETC.
  - LOTS, MINING CLAIMS, PARCELS, ETC.
- UNSURVEYED LINES:
  - LOT LINES
  - PARCEL BOUNDARY
  - MINING CLAIMS ETC.
- RAILWAY AND RIGHT OF WAY
- UTILITY LINES
- NON-PERENNIAL STREAM
- FLOODING OR FLOODING RIGHTS
- SUBDIVISION
- ORIGINAL SHORELINE
- MARSH OR MUSKEG
- MINES

**DISPOSITION OF CROWN LANDS**

| TYPE OF DOCUMENT                | SYMBOL |
|---------------------------------|--------|
| PATENT, SURFACE & MINING RIGHTS |        |
| " SURFACE RIGHTS ONLY           |        |
| " MINING RIGHTS ONLY            |        |
| LEASE, SURFACE & MINING RIGHTS  |        |
| " SURFACE RIGHTS ONLY           |        |
| " MINING RIGHTS ONLY            |        |
| LICENCE OF OCCUPATION           |        |
| CROWN LAND SALE                 |        |
| ORDER-IN-COUNCIL                |        |
| RESERVATION                     |        |
| CANCELLED                       |        |
| SAND & GRAVEL LAND USE PERMIT   |        |

THE INFORMATION THAT APPEARS ON THIS MAP HAS BEEN COMPILED FROM VARIOUS SOURCES AND ACCURACY IS NOT GUARANTEED. THOSE WISHING TO STAKE MINING CLAIMS SHOULD CONSULT WITH THE MINING RECORDER, MINISTRY OF NORTHERN DEVELOPMENT AND MINES, FOR ADDITIONAL INFORMATION ON THE STATUS OF THE LANDS SHOWN HEREON.

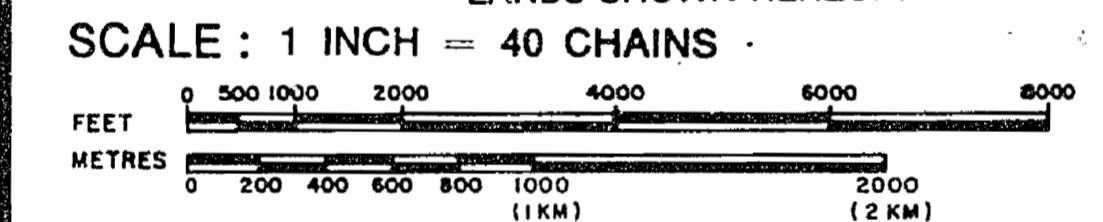

TOWNSHIP  
**IGNACE**

M.N.R. ADMINISTRATIVE DISTRICT  
**IGNACE**

MINING DIVISION  
**KENORA**

LAND TITLES / REGISTRY DIVISION  
**KENORA**

Ministry of Land Management  
Natural Resources Branch  
Ontario

Date SEPTEMBER, 1984  
Number **G-3169**

M-1991

IGNACE G 3169

**G2550**  
McNAMARA LAKE **M.2528**

91° 36' 42" Approx.

1991

# Now, IGNACE TWP. TOWNSHIP 22

KENORA LAKE MG. DIV.

DISTRICT OF KENORA

Scale: - 40 Chains = 1 Inch

RECEIVED  
MAY 1 1951  
KENORA DISTRICT

TWP. 23.

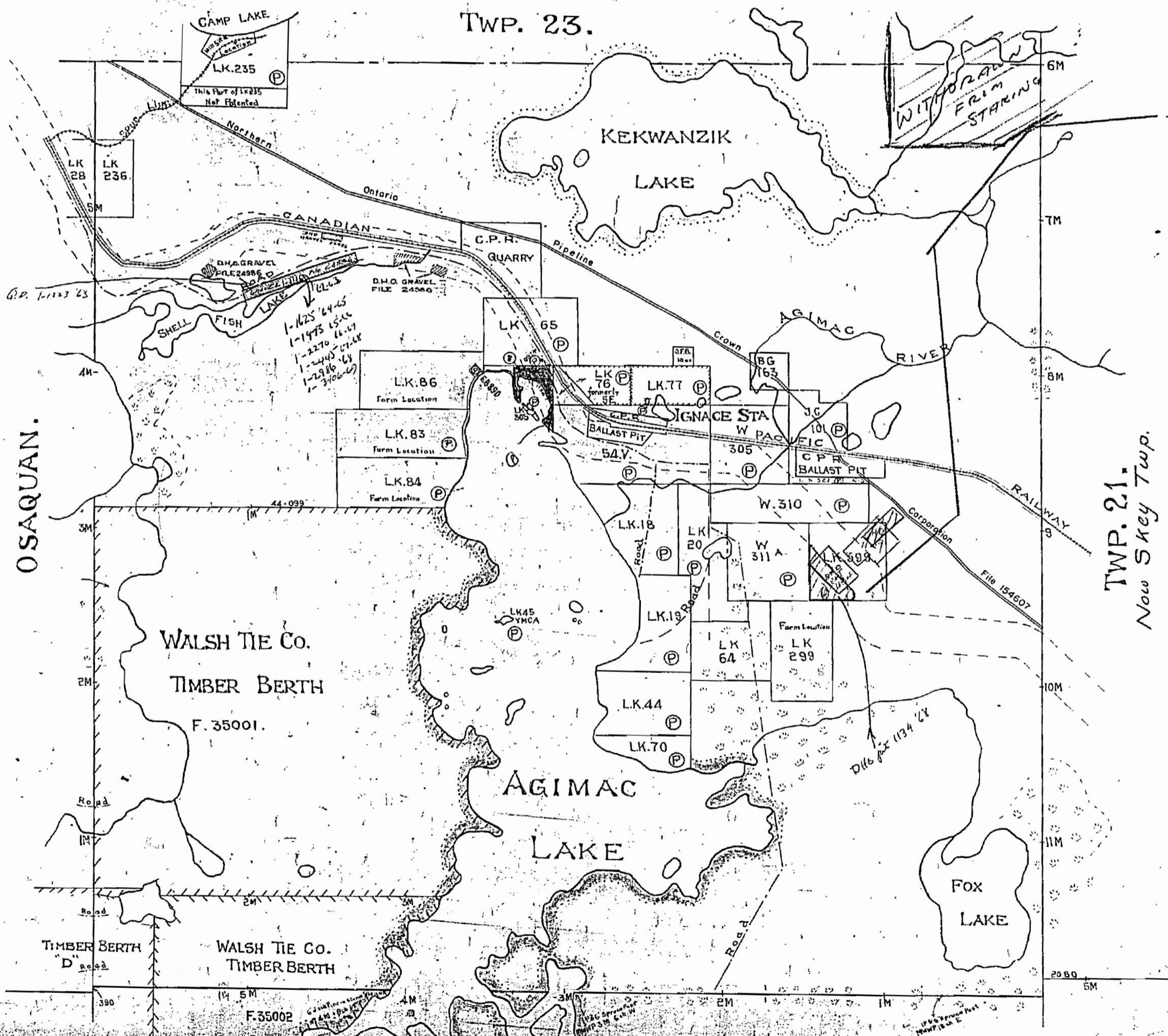

OSAQUAN.

TWP. 21.  
Now Skeg Twp.

ARTS OF E & W BOUNDARIES SOUTH OF RAILWAY RUN BY PHILIPS & BENNER OLS 1922  
 SOUTH BOUNDARY  
 TIMBER BERTH LINES  
 PART OF EAST BOUNDARY NORTH OF RAILWAY RUN BY ANVEN OLS 1923  
 WEST ESTIMATED

Surface area of 400 acres by Dept of L & F shown  
 heaped & piled in the excavation to  
 be used for the construction of all islands lying  
 in the lake area.

INDICATES UNDER PATENT  
 SOLD (BUT NOT YET PATENTED)

IGNACE TWP. 1991

1991

# Now, IGNACE TWP. TOWNSHIP 22

M.1991

### NOTES

Areas withdrawn from staking under Section 42 of the Mining Act. (R.S.O. 1960) & Sec. 43 (R.S.O. 1970)

| File   | Date       | Disposition |
|--------|------------|-------------|
| 179740 | Feb. 17/71 | S.R.O.      |
| 91307  |            | S.A.C.M.A.  |

Sept 7/74

## DISTRICT OF KENORA

ONTARIO  
MINISTRY OF NATURAL RESOURCES  
SURVEYS AND MAPPING BRANCH

Scale: - 40 Chams = 1 Inch

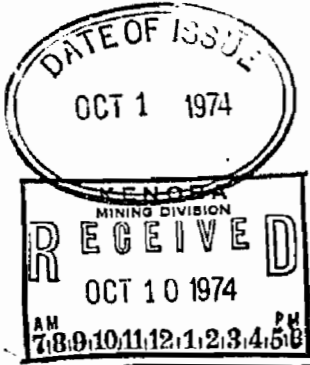

GOUR M-1983  
TWP. 23.

QP. 5502  
74-75.  
G.L.P. Co.

PROVINCIAL PARK  
"SANDBAR LAKE"  
WITHDRAWN FROM STAKING  
SEC. 42 OF THE MINING ACT.  
FILE: 171523

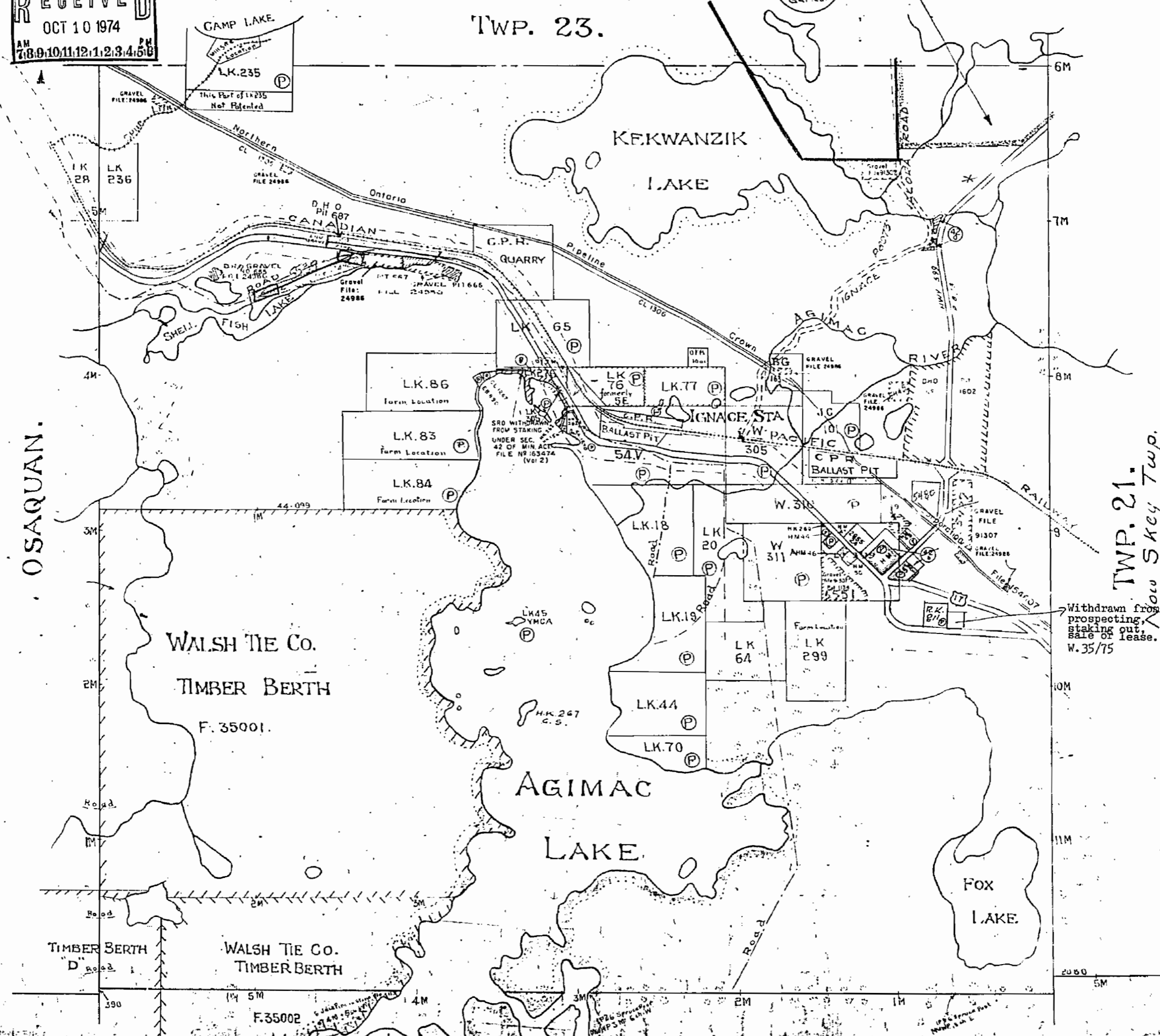

OSAQUAN.

TWP. 21.  
Now Skey Twp.

Withdrawn from prospecting staking out. Sale of lease. W. 35/75

PARTS OF E&N BOUNDARIES SOUTH OF RAILWAY TRUN BY PHILIP WENNER ON 5/18/22  
SOUTH BOUNDARY  
TIMBER BERTH LINES  
PART OF EAST BOUNDARY NORTH OF RAILWAY TRUN BY ANVEN OLSEN ON 5/18/22  
WEST BOUNDARY

INDICATES UNDER PATENT  
SOLD (BUT NOT YET PATENTED)

IGNACE-1991



**NOTES**

400' surface rights reservation along the shores of all lakes and rivers.

**SAND and GRAVEL**

- Gravel Pit, L. 4396
- Gravel Pit 81307
- M.T.C. Pit 1605
- M.T.C. Pit 1145
- Gravel Pit 1184 File 91307
- Gravel Pit 888
- Gravel Pit 887
- Gravel Pit 887

**IGNACE TWP-M.1991**

**AREAS WITHDRAWN FROM STAKING**

| Section        | Order No. | Date       | Disposition | File     |
|----------------|-----------|------------|-------------|----------|
| 42(R.S.O.1960) |           | FEB.17/71  | S.R.        | 179740   |
| 42(R.S.O.1960) |           | JULY 25/75 | SR          | 188519   |
| 42(R.S.O.1960) |           | MAY 17/70  | SR          | 163474-8 |
| M.N.R. Res.    |           | MAY 19/30  | SR          | 77094-11 |

D. W/80 R3 OPENED DEC 22/80

DATE OF ISSUE  
SEP 16 1976

KENORA MINING DIV.  
**RECEIVED**  
SEP 20 1976  
AW 7 8 9 10 11 12 1 2 3 4 5 6 PW

**GOUR TP M.1983**

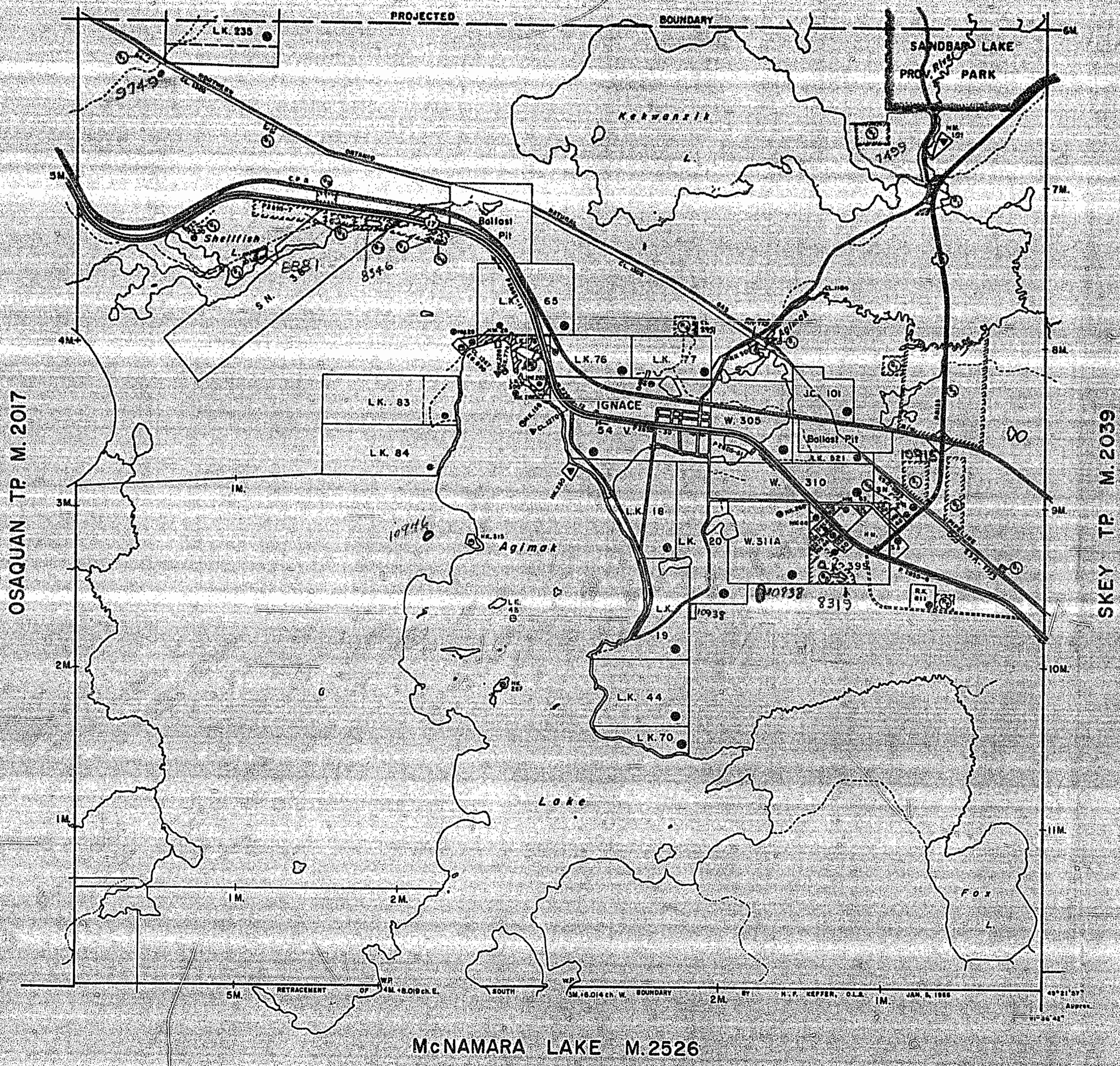

**LEGEND**

- HIGHWAY AND ROUTE NO.
- OTHER ROADS
- TRAILS
- SURVEYED LINES:
  - TOWNSHIP, BASE LINES, ETC.
  - LOTS, MINING CLAIMS, PARCELS, ETC.
- UNSURVEYED LINES:
  - LOT LINES
  - PARCEL BOUNDARY
  - MINING CLAIMS ETC.
- RAILWAY AND RIGHT OF WAY
- UTILITY LINES
- NON-PERMANENT STREAM
- FLOODING OR FLOODING RIGHTS
- SUBDIVISION
- ORIGINAL SHORELINE
- MARSH OR MUSKEG
- MINES

**DISPOSITION OF CROWN LANDS**

| TYPE OF DOCUMENT                | SYMBOL |
|---------------------------------|--------|
| PATENT, SURFACE & MINING RIGHTS |        |
| SURFACE RIGHTS ONLY             |        |
| MINING RIGHTS ONLY              |        |
| LEASE SURFACE & MINING RIGHTS   |        |
| SURFACE RIGHTS ONLY             |        |
| MINING RIGHTS ONLY              |        |
| LICENCE OF OCCUPATION           |        |
| CROWN LAND SALE                 |        |
| ORDER-IN-COUNCIL                |        |
| RESERVATION                     |        |
| CANCELLED                       |        |
| SAND & GRAVEL                   |        |

SCALE: 1 INCH = 40 CHAINS

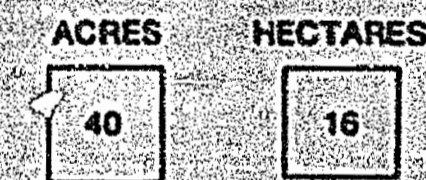

TOWNSHIP

**IGNACE**

DISTRICT

KENORA #4

MINING DIVISION

KENORA

Ministry of Natural Resources  
Ontario Surveys and Mapping Branch

Date MAY '76  
Whitney Block  
Queen's Park, Toronto

Plan No.  
**M. 1991**

McNAMARA LAKE M.2526

**NOTES**

400' surface rights reservation along the shores of all lakes and rivers.

**SAND and GRAVEL**

- ④ Gravel File 24986
- ④ Gravel File 91307

- ④ Gravel Pit 666
- ④ Gravel Pit 667
- ④ Gravel Pit 687
- ④ Gravel File 91307 Vol. 2
- ④ QUARRY PERMIT

**AREAS WITHDRAWN FROM STAKING**

S.R. - SURFACE RIGHTS      M.R. - MINING RIGHTS

| Section | Order No.       | Date       | Disposition | File   |
|---------|-----------------|------------|-------------|--------|
| ④       | 42 (R.S.O 1960) | JULY 25/75 | S.R.        | 188519 |

**GOUR TP. M.1983**

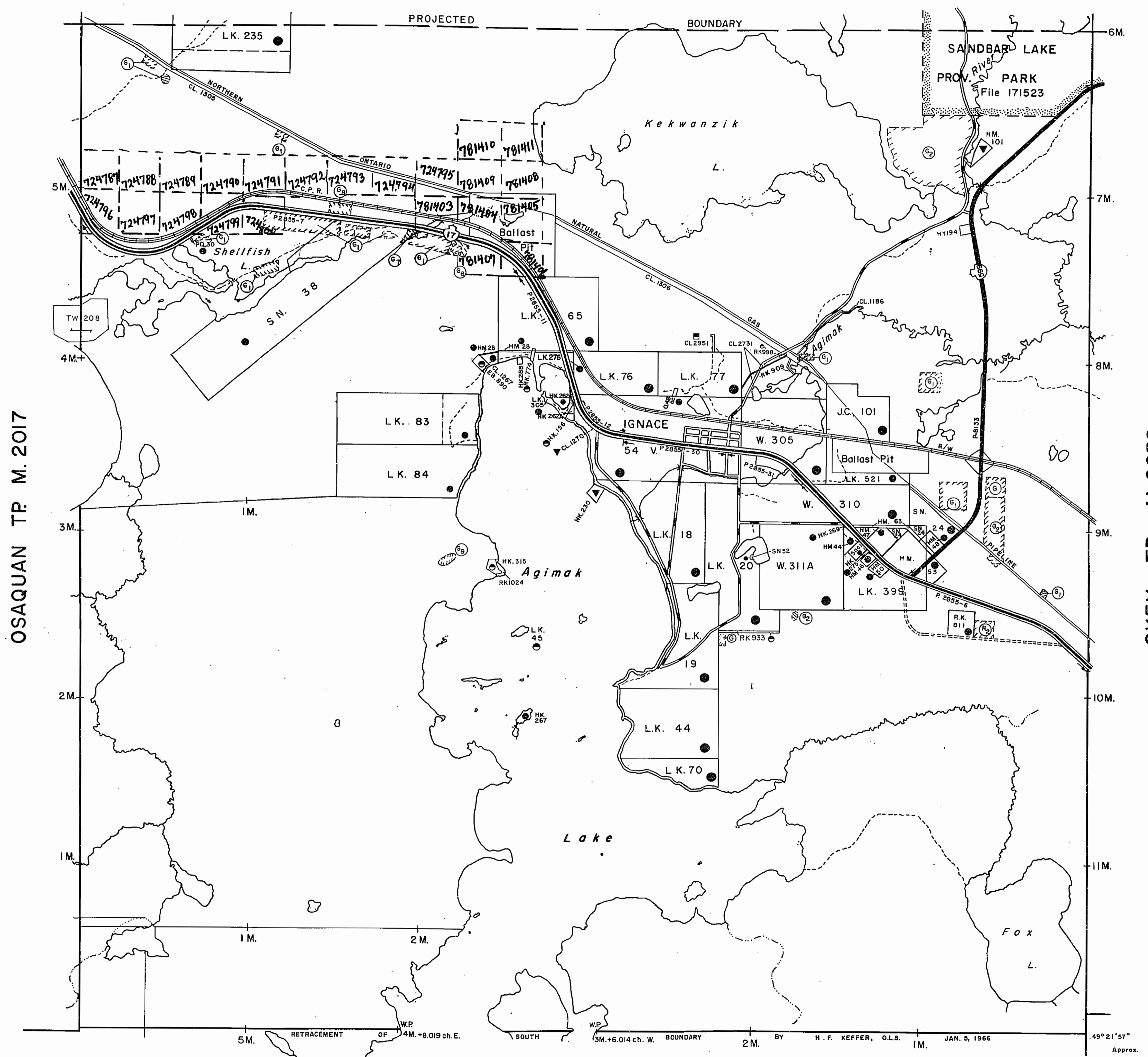

**LEGEND**

- HIGHWAY AND ROUTE No.
- OTHER ROADS
- TRAILS
- SURVEYED LINES:
  - TOWNSHIPS, BASE LINES, ETC.
  - LOTS, MINING CLAIMS, PARCELS, ETC.
- UNSURVEYED LINES:
  - LOT LINES
  - PARCEL BOUNDARY
  - MINING CLAIMS ETC.
- RAILWAY AND RIGHT OF WAY
- UTILITY LINES
- NON-PERENNIAL STREAM
- FLOODING OR FLOODING RIGHTS
- SUBDIVISION
- ORIGINAL SHORELINE
- MARSH OR MUSKEG
- MINES

**DISPOSITION OF CROWN LANDS**

| TYPE OF DOCUMENT                | SYMBOL |
|---------------------------------|--------|
| PATENT, SURFACE & MINING RIGHTS | ●      |
| " SURFACE RIGHTS ONLY           | ○      |
| " MINING RIGHTS ONLY            | ◐      |
| LEASE, SURFACE & MINING RIGHTS  | ■      |
| " SURFACE RIGHTS ONLY           | ◼      |
| " MINING RIGHTS ONLY            | ◻      |
| LICENCE OF OCCUPATION           | ▼      |
| CROWN LAND SALE                 | CS     |
| ORDER-IN-COUNCIL                | OC     |
| RESERVATION                     | ⊙      |
| CANCELLED                       | ⊖      |
| SAND & GRAVEL                   | ⊕      |

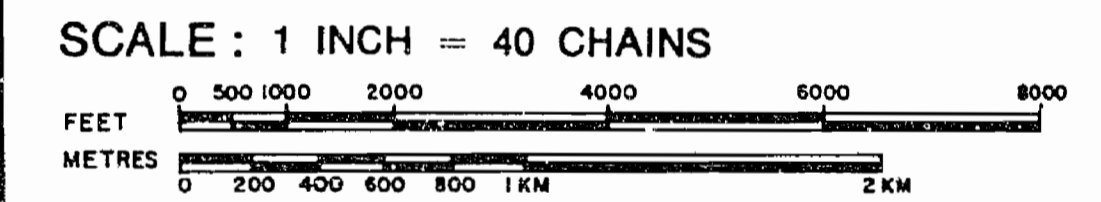

| ACRES | HECTARES |
|-------|----------|
| 40    | 16       |

TOWNSHIP  
**IGNACE**  
DISTRICT  
KENORA  
MINING DIVISION  
KENORA

**Ministry of Natural Resources**  
Ontario Surveys and Mapping Branch  
Date **MAY '76** Plan No. **M.1991**  
Whitney Block  
Queen's Park, Toronto

*Absolute Aug. 29/84*

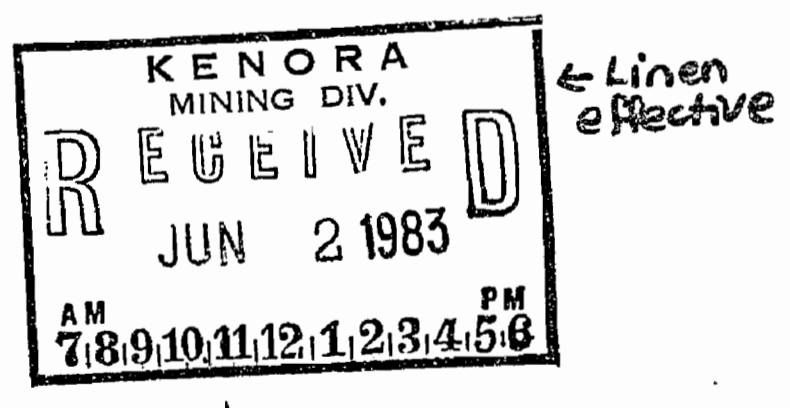

DATE OF ISSUE  
**MAY 30 1983**  
Ministry of Natural Resources  
TORONTO

**McNAMARA LAKE M.2526**



**NOTES**

400' surface rights reservation along the shores of all lakes and rivers.

**SAND and GRAVEL**

- ④ Gravel Pit 24986
- ④ Gravel File 91307

- ④ Gravel Pit 666
- ④ Gravel Pit 667
- ④ Gravel Pit 667
- ④ Gravel File 91307 Vol. 2
- ④ QUARRY PERMIT

**AREAS WITHDRAWN FROM STAKING**

S.R. - SURFACE RIGHTS M.R.-MINING RIGHTS

| Section | Order No.       | Date       | Disposition | File   |
|---------|-----------------|------------|-------------|--------|
| ④       | 42 (R.S.O.1960) | JULY 25/75 | SR.         | 188519 |

④ 42 (R.S.O.1960) JULY 25/75 SR. 188519

OSAGUAN TR. M.2017

SKEY TR. M.2039

**GOUR TR. M.1983**

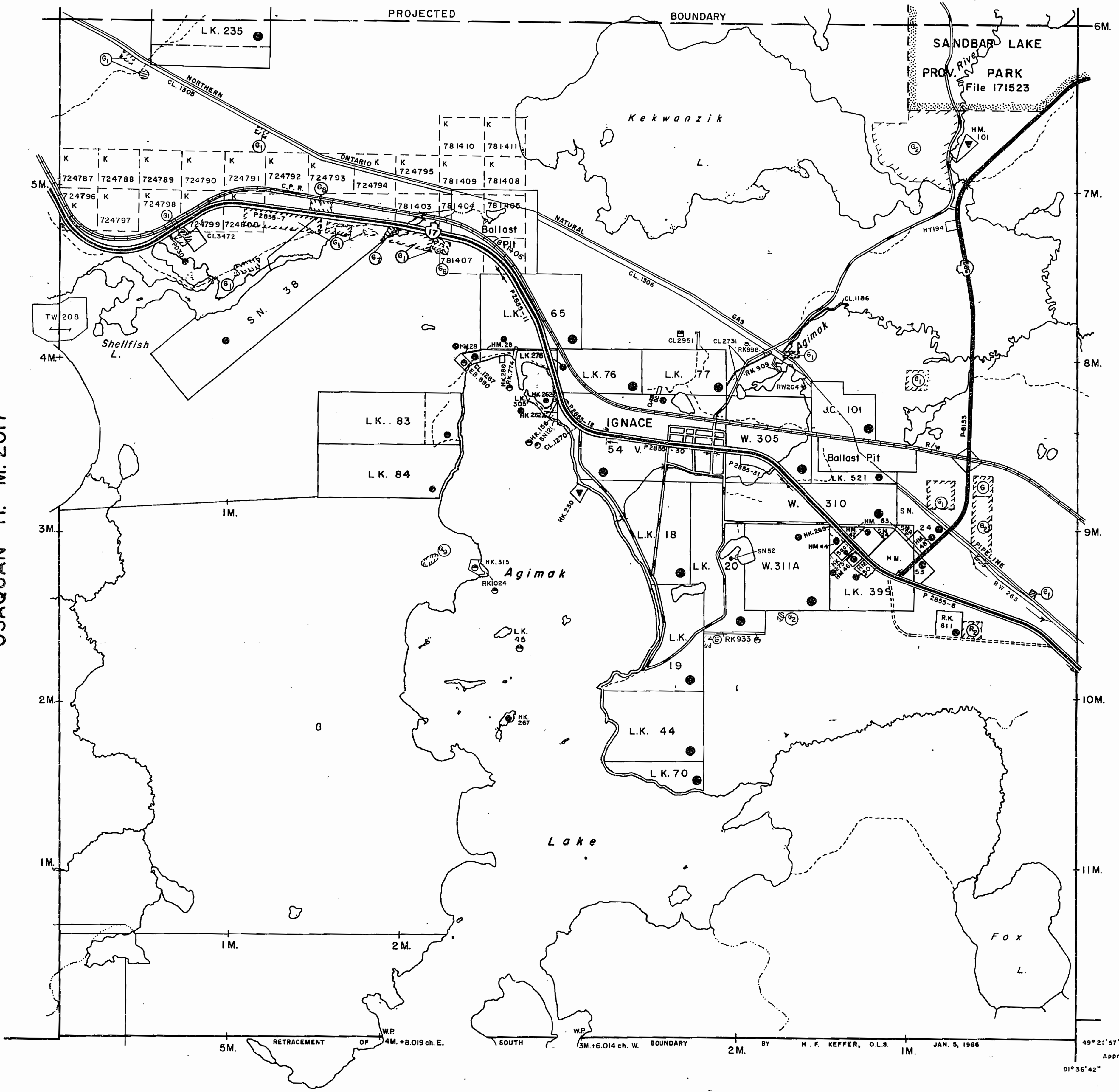

**McNAMARA LAKE M.2526**

**LEGEND**

- HIGHWAY AND ROUTE No.
- OTHER ROADS
- TRAILS
- SURVEYED LINES:
  - TOWNSHIPS, BASE LINES, ETC.
  - LOTS, MINING CLAIMS, PARCELS, ETC.
- UNSURVEYED LINES:
  - LOT LINES
  - PARCEL BOUNDARY
  - MINING CLAIMS ETC.
- RAILWAY AND RIGHT OF WAY
- UTILITY LINES
- NON-PERENNIAL STREAM
- FLOODING OR FLOODING RIGHTS
- SUBDIVISION
- ORIGINAL SHORELINE
- MARSH OR MUSKEG
- MINES

**DISPOSITION OF CROWN LANDS**

| TYPE OF DOCUMENT                | SYMBOL |
|---------------------------------|--------|
| PATENT, SURFACE & MINING RIGHTS |        |
| " SURFACE RIGHTS ONLY           |        |
| " MINING RIGHTS ONLY            |        |
| LEASE, SURFACE & MINING RIGHTS  |        |
| " SURFACE RIGHTS ONLY           |        |
| " MINING RIGHTS ONLY            |        |
| LICENCE OF OCCUPATION           |        |
| CROWN LAND SALE                 | C.S.   |
| ORDER-IN-COUNCIL                | OC     |
| RESERVATION                     |        |
| CANCELLED                       |        |
| SAND & GRAVEL                   |        |

SCALE: 1 INCH = 40 CHAINS

FEET 0 500 1000 2000 4000 6000 8000

METRES 0 200 400 600 800 1KM 2KM

| ACRES | HECTARES |
|-------|----------|
| 40    | 16       |

TOWNSHIP

**IGNACE**

DISTRICT

KENORA

MINING DIVISION

KENORA

Ministry of Natural Resources

Ontario Surveys and Mapping Branch

Date MAY '76 Plan No. M.1991

Whitney Block Queen's Park, Toronto

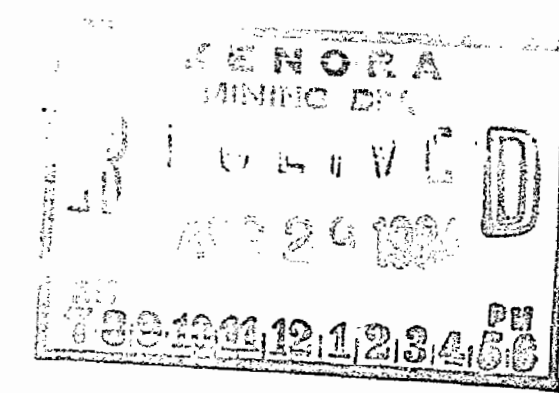

Effective as lined  
Aug. 29/84

*H. F. Keffer*

RETRACEMENT OF 4M.+8.019 ch. E. SOUTH 5M. BY H. F. KEFFER, O.L.S. 1M. JAN. 5, 1966

49° 21' 57" 51° 56' 42" Approx.

Now, **IGNACE TWP.**  
**TOWNSHIP 22**  
KENORA LAKE MG. DIV.

DISTRICT OF KENORA

Scale: 40 Chains = 1 inch

RECEIVED  
MAY 1 1951  
KENORA MINING CO.

TWP. 23.

KEKWANZIK  
LAKE

AGIMAC  
RIVER

AGIMAC  
LAKE

FOX  
LAKE

WALSH TIE CO.  
TIMBER BERTH  
F. 35001.

TIMBER BERTH  
D. 3022

WALSH TIE CO.  
TIMBER BERTH  
F. 35002

Ⓟ INDICATES UNDER PATENT

Ⓢ SOLD (BUT NOT YET PATENTED)

TWP. 21.

OSAGUAN

Now Ignace Twp

WITHDRAWN  
FROM  
STAKING

CAMP LAKE  
L.K. 235

LK 28  
LK 236

Ontario

C.P.R.  
QUARRY

SHELL FISH  
LAKE

LK 86  
Farm Location

LK 83  
Farm Location

LK 84  
Farm Location

LK 65

LK 76

LK 77

BG 763

IGNACE STA  
W PACIFIC

C.P.R.  
BALLAST PIT

W. 310

LK 18

LK 20

W. 311A

LK 45  
YMCA

LK 19

Farm Location  
LK 299

LK 44

LK 70

D.K. 134/21

Road

Road

Road

Road

Road

Road

Road

Road

Road

Road

Road

Road

TIMBER BERTH LINES

20 60  
5M

20 60  
5M

20 60  
5M

20 60  
5M

20 60  
5M

20 60  
5M