

# JACKMAN

Not. 17/65

July 13/67

Sept. 23/70

KENORA MINING DIVISION

DISTRICT OF KENORA

Scale - 40 Chains - 1 Inch

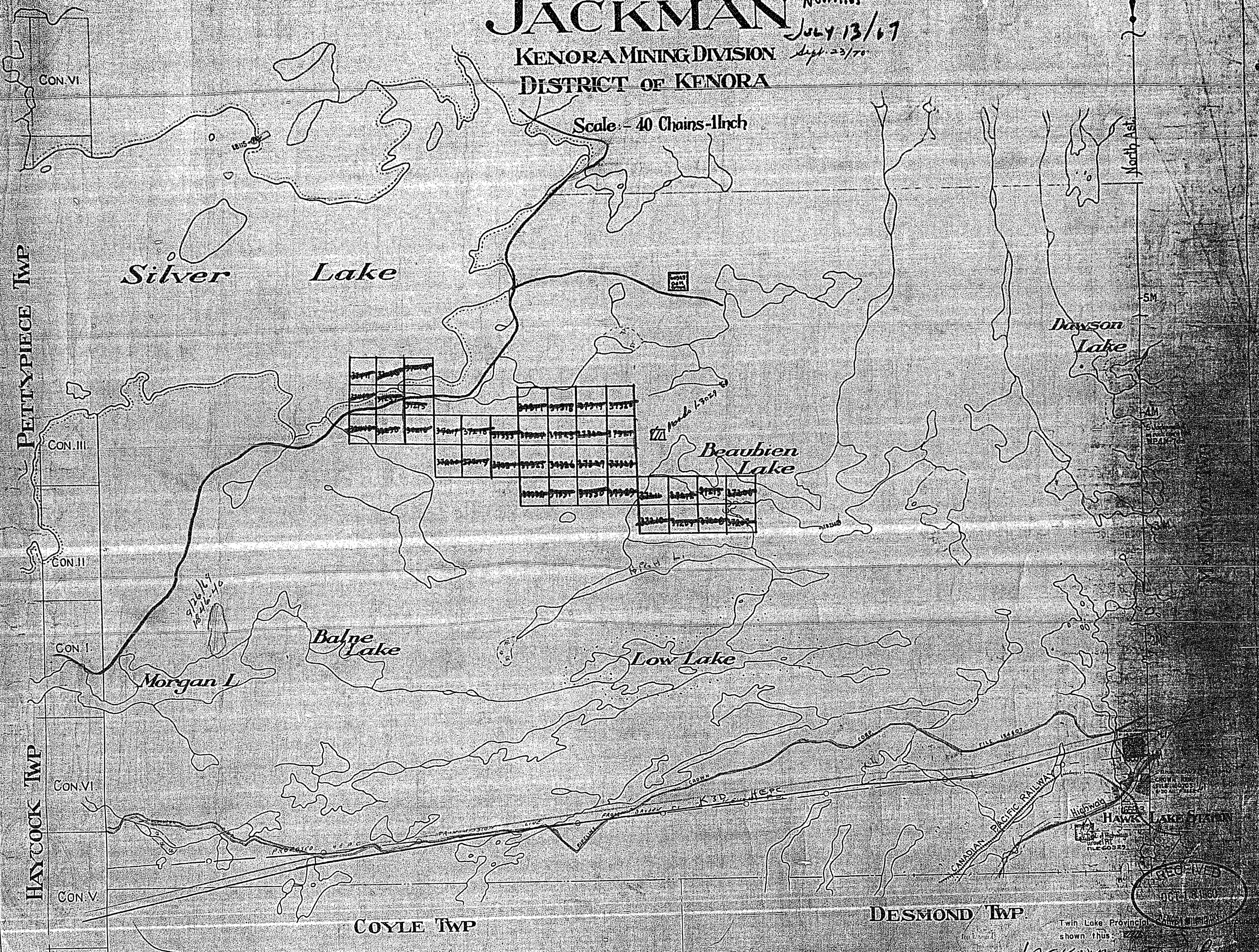

Surface reservation 400 ft wide by Department of Lands and Forests. Shown thus. This reservation to apply also along the shore lines of all islands lying within the delineated areas

RECEIVED  
OCT 12 1960  
JACKMAN TWP

JACKMAN TWP  
M 1993



NOTES

400' surface rights reservation along the shores of all lakes and rivers

RESERVES

- ④ 400' reservation for surface rights to MNR pursuant to Section 3 of Public Lands Act file. 163013
- ⑤ reserved for park use (Twin Lake provincial camp and picnic grounds) file 163013

SAND and GRAVEL

- ④ M.T.C. Gravel Pit 613
- ⑤ " " " 614
- ⑥ " " " 712
- ⑦ Gravel file. 60329

AREAS WITHDRAWN FROM STAKING

S.R. - Surface Rights		M.R. - Mining Rights	
Section	Order No.	Date	Disposition
④	431 R.S.O. 1970	W.65/76	15/11/76 S.R.
⑤	36 (R.S.O. 1980)	W.61/82	23/11/82 S.R. & M.R.
⑥	SECT.35 W-K-60/95	JULY 25/95	S&M 195150

NOTICE: THE SURFACE RIGHTS LYING WITHIN 40.25m OF THE CENTRE LINE OF THE TRANSCANADA PIPELINE RIGHT OF WAY ARE WITHDRAWN FROM STAKING OUT, PROSPECTING, SALE OR LEASE BY ORDER W.0151 ONT. DATED SEPT. 30, 1991. SECTION 122 OF THE NATIONAL ENERGY BOARD ACT APPLIES.

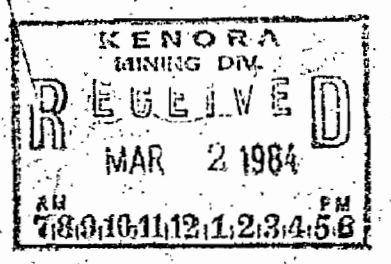

G 2629  
 MARK LAKE M-2065

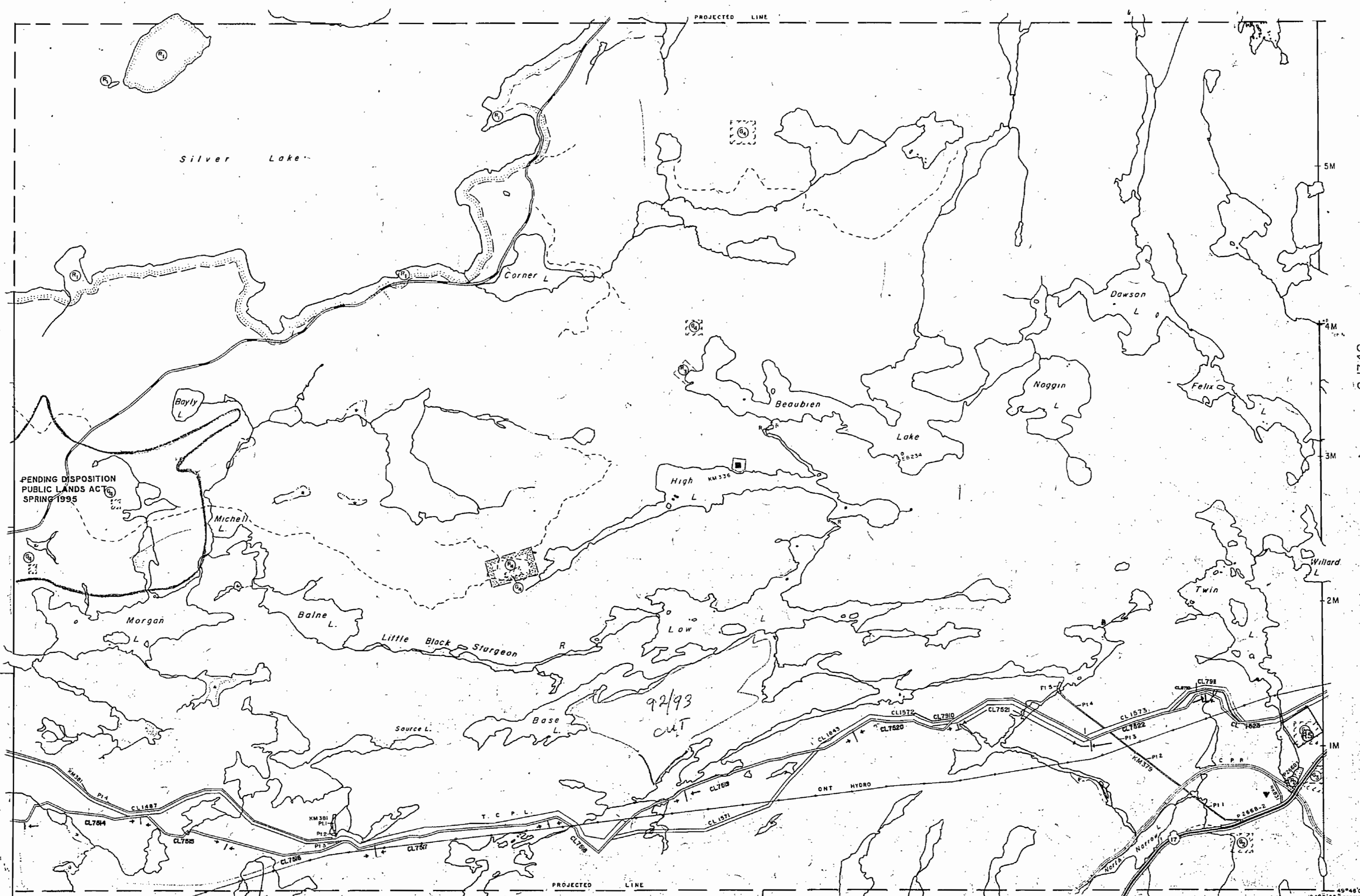

LEGEND

- HIGHWAY AND ROUTE No.
- OTHER ROADS
- TRAILS
- SURVEYED LINES: TOWNSHIPS, BASE LINES, ETC.
- UNSURVEYED LINES: LOT LINES, MINING CLAIMS, PARCELS, ETC.
- RAILWAY AND RIGHT OF WAY
- UTILITY LINES
- NON-PERENNIAL STREAM
- FLOODING OR FLOODING RIGHTS
- SUBDIVISION
- ORIGINAL SHORELINE
- MARSH OR MUSKEG
- MINES

DISPOSITION OF CROWN LANDS

TYPE OF DOCUMENT	SYMBOL
PATENT, SURFACE & MINING RIGHTS	●
SURFACE RIGHTS ONLY	○
MINING RIGHTS ONLY	◐
LEASE, SURFACE & MINING RIGHTS	◑
SURFACE RIGHTS ONLY	◒
MINING RIGHTS ONLY	◓
LICENCE OF OCCUPATION	◔
CROWN LAND SALE	◕
ORDER-IN-COUNCIL	◖
RESERVATION	◗
CANCELLED	◘
SAND & GRAVEL	◙

THE INFORMATION THAT APPEARS ON THIS MAP HAS BEEN COMPILED FROM VARIOUS SOURCES, AND ACCURACY IS NOT GUARANTEED. THOSE WISHING TO STAKE MINING CLAIMS SHOULD CONSULT WITH THE MINING RECORDER, MINISTRY OF NORTHERN DEVELOPMENT AND MINES, FOR ADDITIONAL INFORMATION ON THE STATUS OF THE LANDS SHOWN HEREON.

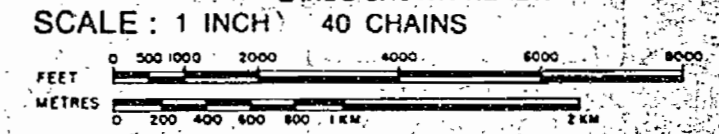

TOWNSHIP  
**JACKMAN**  
 DISTRICT  
 KENORA  
 MINING DIVISION  
 KENORA

Ministry of Natural Resources  
 Ontario Surveys and Mapping Branch

Date: 16-98  
 Whitney Block  
 Queen's Park, Toronto  
**M-1993**

G-1337



NOTE

Roads indicated Ontario - Minnesota Pulp & Paper Company Private Road, may be used by prospectors, only after permission is obtained from the Company at Kenora, Ontario.

# JACKMAN

## KENORA MINING DIVISION DISTRICT OF KENORA

ONTARIO  
DEPARTMENT OF MINES  
AND NORTHERN AFFAIRS

Scale: - 40 Chains = 1 Inch

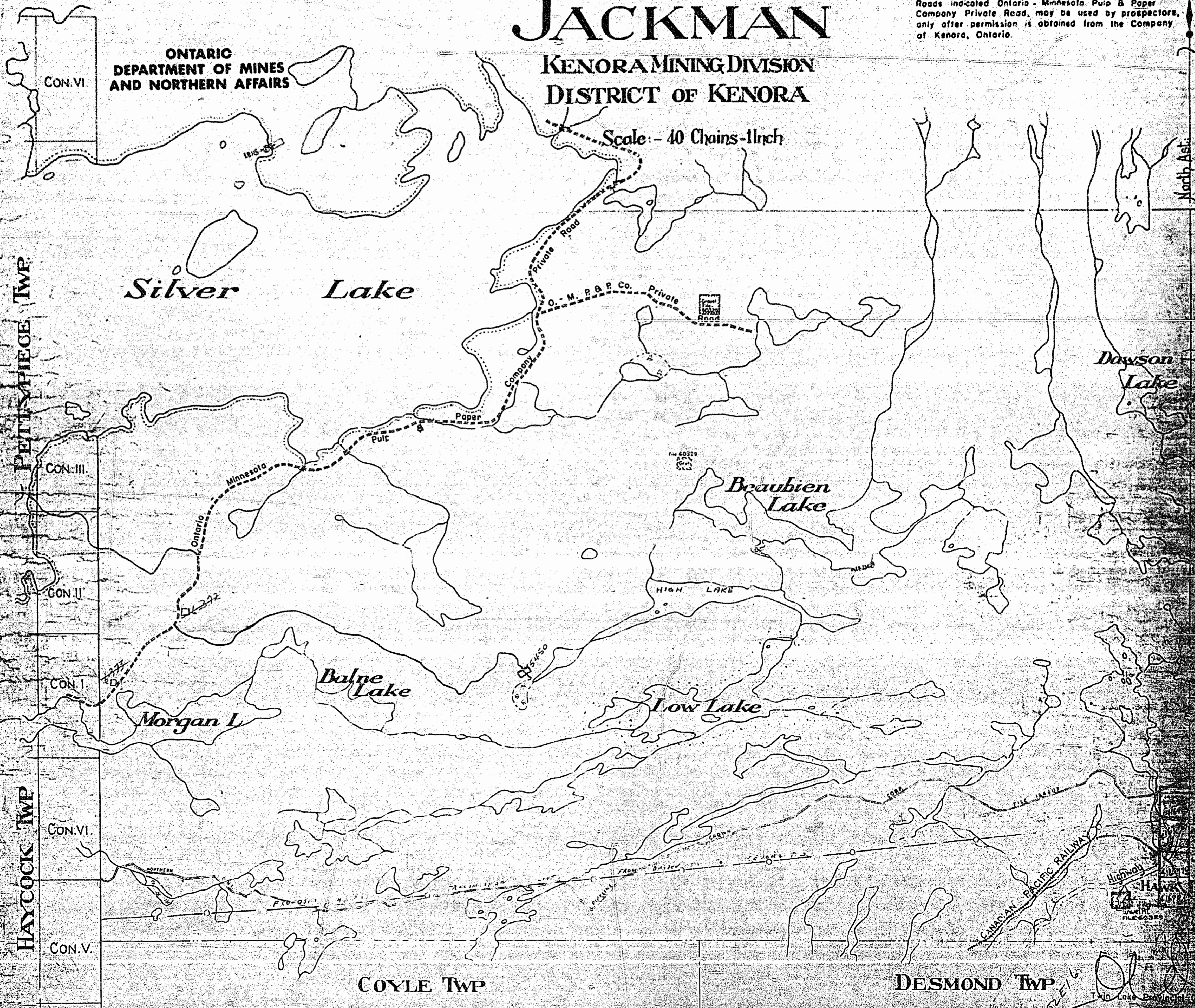

Surface reservation 400 ft wide by Department of Lands and Forests shown thus. This reservation to apply also along the shore lines of all islands lying within the delineated areas

JACKMAN



# DISTRICT OF KENORA

Scale: - 40 Chains-Inch

North Ast.

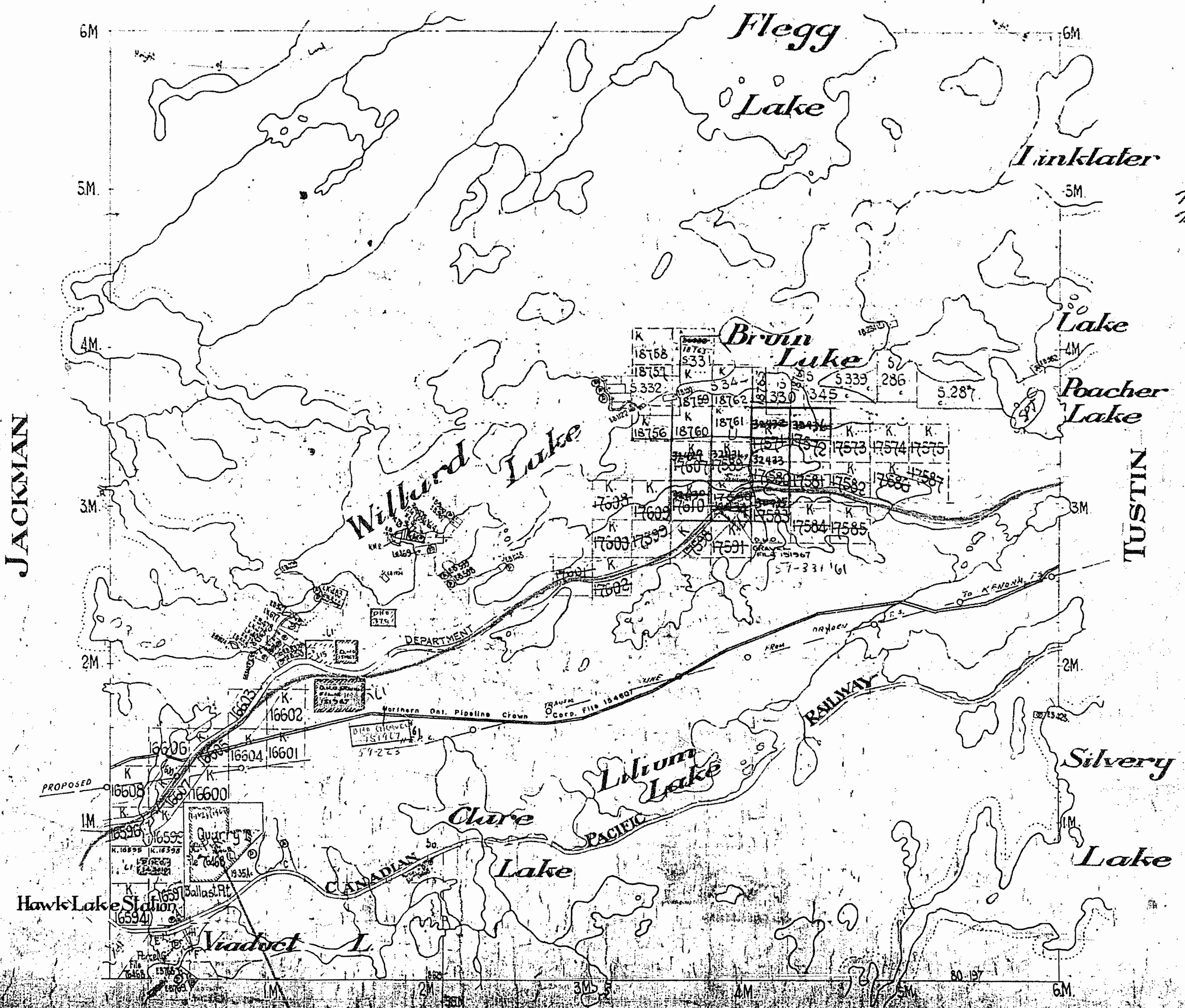

Nov 23/10  
M.A.H.

DEPT. OF LANDS & SURVEY  
ONTARIO

M.A.H. 1100 L  
11200



**NOTES**

400' surface rights reservation along the shores of all lakes and rivers.

**RESERVES**

- ① 400' reservation for surface rights to MNR pursuant to Section 3 of Public Lands Act file 163013
- ② reserved for park use (Twin Lake provincial camp and picnic grounds) file 163013
- ③ *DEPT. of (SOM) W. 6/76 R/1/76 JRO*
- ④ *WNR 6/1/82 S&M Rt. 1700.23/82.*

**SAND and GRAVEL**

- ① M.T.C. Gravel Pit 613
- ② " " " 614
- ③ " " " 712
- ④ Gravel file 60329 (5450 tons/75 more reserved.)

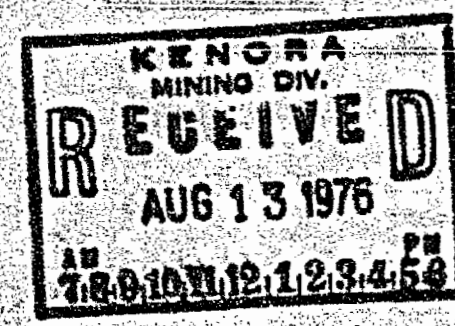

**MARK LAKE M.2065**

PETTYPIECE Tp. M.2022

HAYCOCK Tp. M.1987

MacNICOL Tp. M.2002

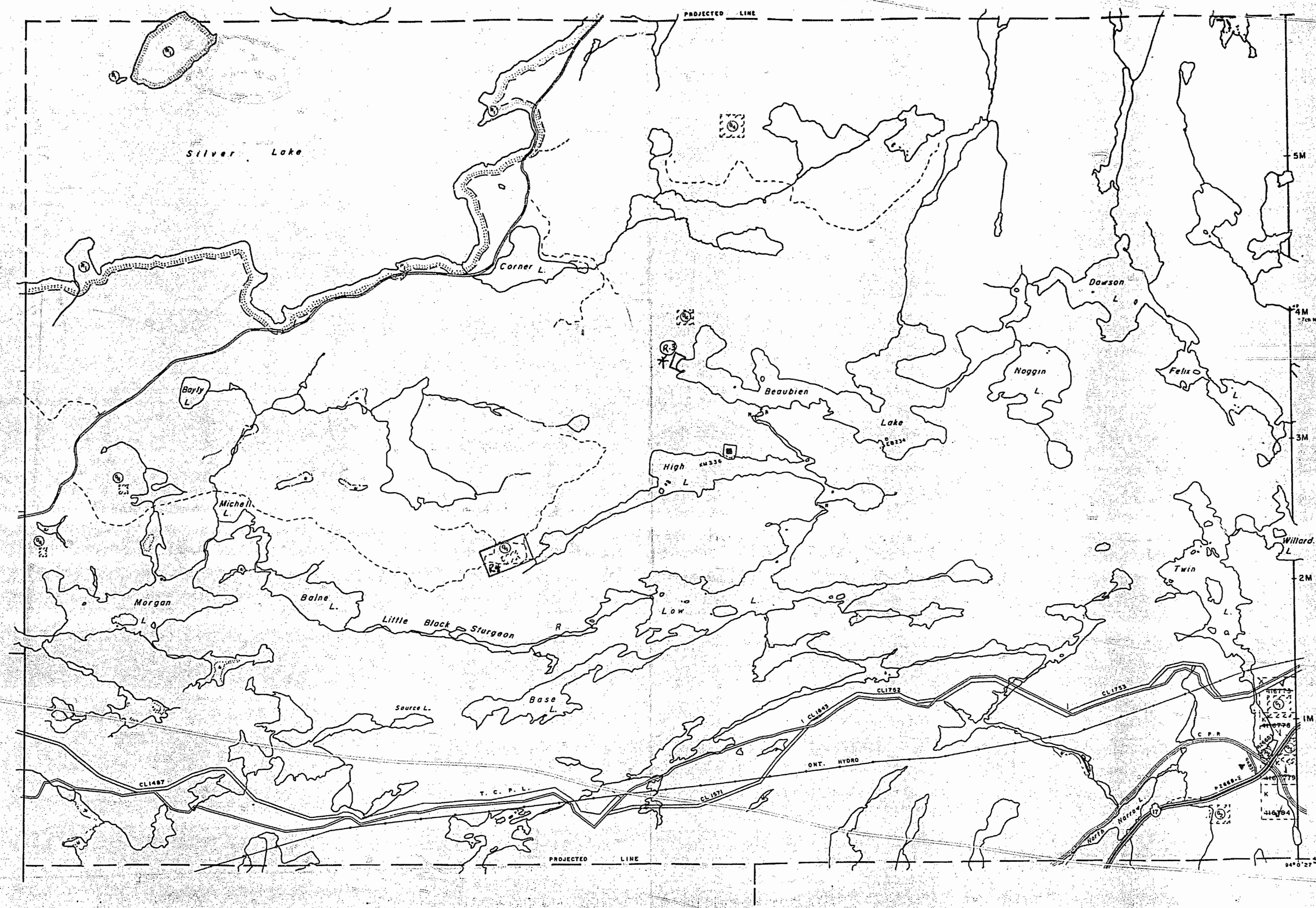

COYLE Tp. M.1970

DESMOND Tp. M.2117

**LEGEND**

- HIGHWAY AND ROUTE No.
- OTHER ROADS
- TRAILS
- SURVEYED LINES:
  - TOWNSHIPS, BASE LINES, ETC.
  - LOTS, MINING CLAIMS, PARCELS, ETC.
- UNSURVEYED LINES:
  - LOT LINES
  - PARCEL BOUNDARY
  - MINING CLAIMS ETC.
- RAILWAY AND RIGHT OF WAY
- UTILITY LINES
- NON-PERENNIAL STREAM
- FLOODING OR FLOODING RIGHTS
- SUBDIVISION
- ORIGINAL SHORELINE
- MARSH OR MUSKEG
- MINES

**DISPOSITION OF CROWN LANDS**

TYPE OF DOCUMENT	SYMBOL
PATENT, SURFACE & MINING RIGHTS	
- SURFACE RIGHTS ONLY	
- MINING RIGHTS ONLY	
LEASE, SURFACE & MINING RIGHTS	
- SURFACE RIGHTS ONLY	
- MINING RIGHTS ONLY	
LICENCE OF OCCUPATION	
CROWN LAND SALE	
ORDER-IN-COUNCIL	
RESERVATION	
CANCELLED	
SAND & GRAVEL	
* SURFACE RIGHTS ONLY WITHDRAWN FROM PROSPECTING, SALE OR LEASE, STAKING OUT - ORDER NO. W.65/76	

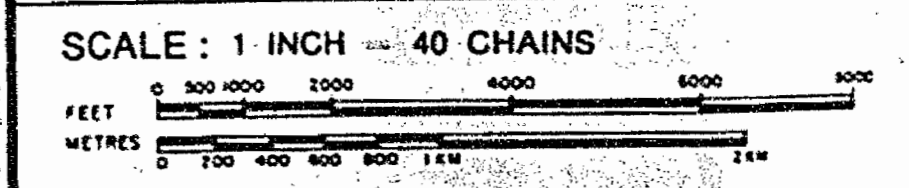

ACRES	HECTARES
40	16

TOWNSHIP  
**JACKMAN**  
 DISTRICT  
 KENORA  
 MINING DIVISION  
 KENORA

Ministry of Natural Resources  
 Ontario Surveys and Mapping Branch  
 Date 6-76 Plan No. **M-1993**  
 Whitney Block Queen's Park, Toronto



# TWP. 41

## DISTRICT OF KENORA. KENORA MINING DIVISION.

Scale: 40 chains to an inch.

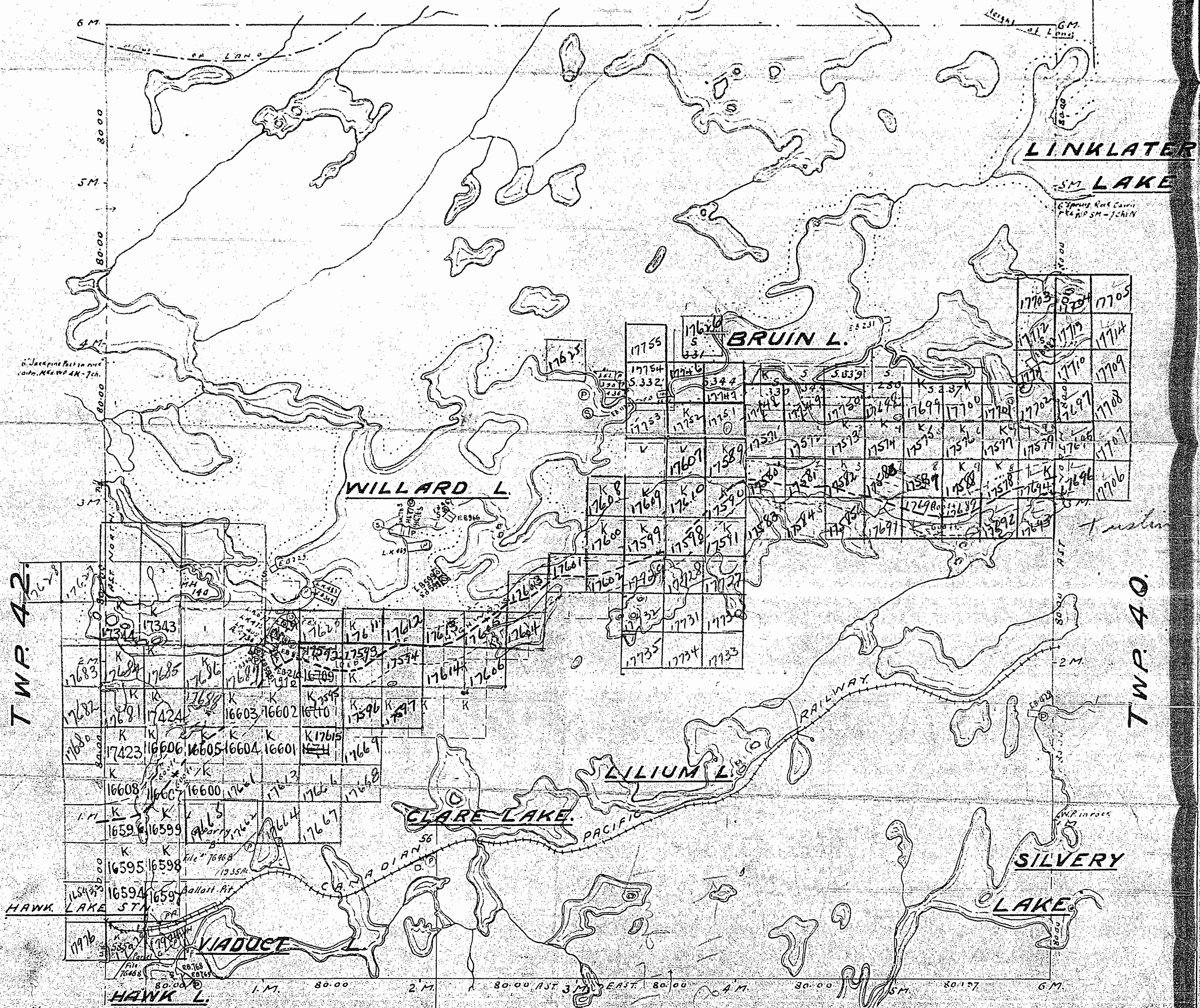

### NOTES

Position of Two Bays established from traverse of C.P.Ry. by E. Stewart P.L.S. 1836.  
 E. S. & W. Bays surveyed by R.S. Kirkup O.L.S. 1938.  
 Meridian to Clare Lake surveyed by A. NIVEN P.L.S. 1895.  
 C.P.Ry. from R/W plan by J.S.W. Caddy P.L.S. 1897. R/W 13211 from Niven's  
 meridian to the E. Bay, and from plan by D. G. Townsend O.L.S. 1929.  
 R/W 13211 from W. Bay to Niven's meridian line. File 76468.  
 Trans. Can. Hwy. surveyed by R.S. Kirkup O.L.S. 1935.  
 Lakes & Rivers from Dom. Topographical Survey Aerial Map, Dryden sheet 1330.  
 Kings Hwy. 1200ft reservation from Dept. of Hways Plan No. P.2667. Shown hereon  
 of record in the Surveys D. Room See O.C. dated Nov 9th & Dec 4th 1939. File 121757

Surface reservations 200' wide by Dept of L. & F.  
 shown hereon thus

M-2002



# JACKMAN

KENORA MINING DIVISION  
DISTRICT OF KENORA

5 map  
1993

Scale - 40 Chains - 1 Inch

79

CON VI  
CON III  
CON II  
CON I  
CON VI  
CON V

PETTYPIECE TWP

HAYCOCK TWP

Silver Lake

Morgan I.

Balne Lake

Beaubien Lake

Low Lake

Dawson Lake

North Ast.

MACNICOL TWP

JACKMAN TWP

JACKMAN 1993



COYLE TWP

DESMON

HAWK LAKE STATION

MINING

FIELD

3M

4M

5M

North Ast.

1



# KENORA MINING DIVISION DISTRICT OF KENORA

Scale: - 40 Chains - 1 inch

North Ast



JACKMAN

TUSTIN

Colin Campbell  
Miller  
Stewart

M-2002



# JACKMAN

## KENORA MINING DIVISION DISTRICT OF KENORA

ONTARIO  
DEPARTMENT OF MINES  
AND NORTHERN AFFAIRS

**NOTE**

Roads indicated Ontario - Minnesota Pulp & Paper Company Private Road, may be used by prospectors, only after permission is obtained from the Company at Kenora, Ontario.

Scale: - 40 Chains - 1 Inch

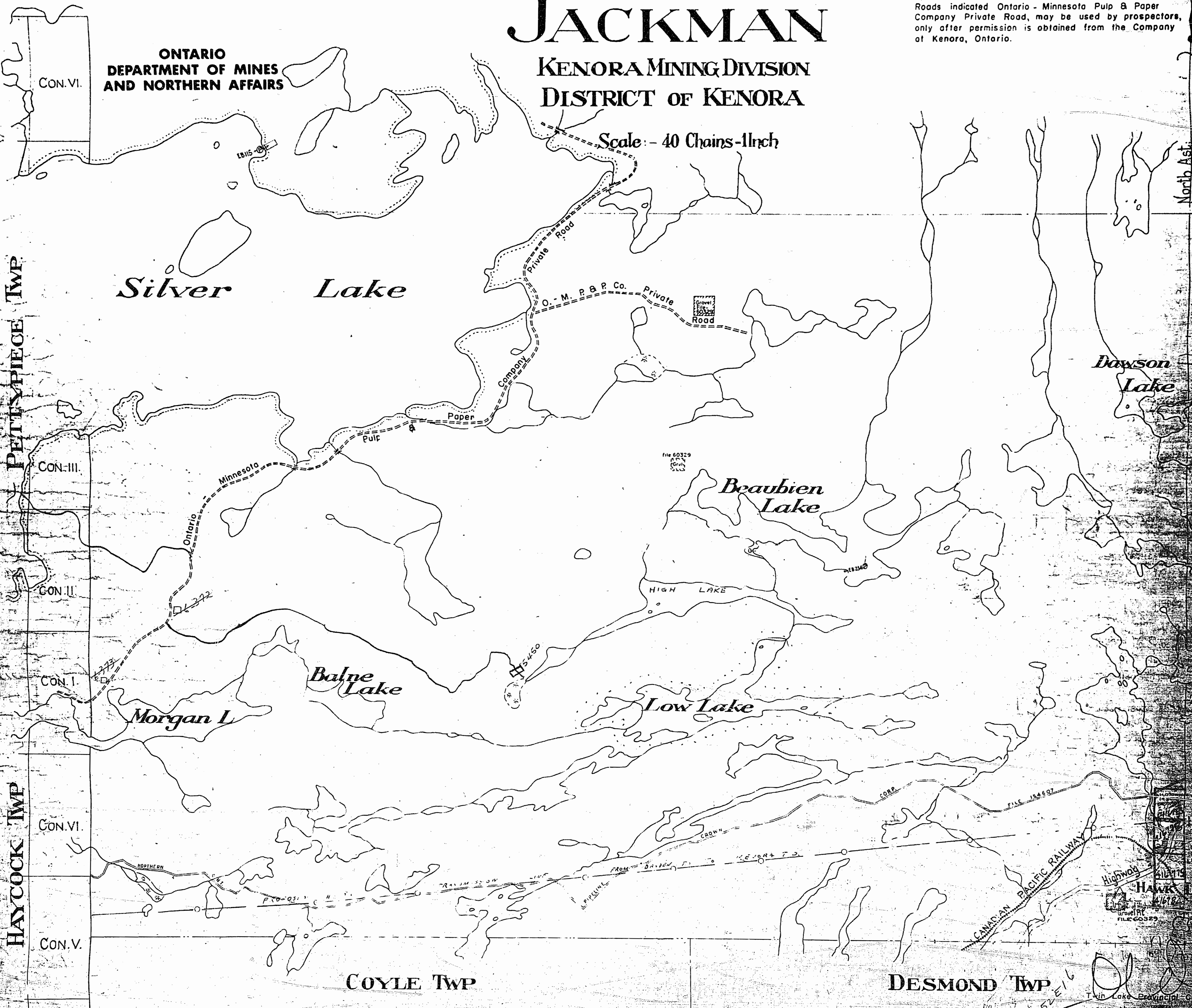

PETTESPIECE TWP

HAYCOCK TWP

COYLE TWP

DESMOND TWP

North Ast.

Surface reservation 400 ft wide by Department of Lands and Forests Shown Thus. This reservation to apply also along the shore lines of all islands lying within the delineated areas

JACKMAN



NOTES

400' surface rights reservation along the shores of all lakes and rivers.

RESERVES

- ① 400' reservation for surface rights to MNR pursuant to Section 3 of Public Lands Act. file. 163013
- ② reserved for park use (Twin Lake provincial camp and picnic grounds) file 163013

SAND and GRAVEL

- ③ M.T.C. Gravel Pit 613
- ④ " " " 614
- ⑤ " " " 712
- ⑥ Gravel file. 60329

AREAS WITHDRAWN FROM STAKING

S.R. - Surface Rights		M.R. - Mining Rights	
Section	Order No.	Date	Disposition
⑦	43 (R.S.O. 1970)	W.65/76	19/11/76 S.R.
⑧	36 (R.S.O. 1980)	W.61/82	23/11/82 S.R. & M.R.
⑨	SECT. 35	W-K-60/95	JULY 25/95 S&M 195150

NOTICE: THE SURFACE RIGHTS LYING WITHIN 40.25m OF THE CENTRE LINE OF THE TRANSCANADA PIPELINE RIGHT OF WAY ARE WITHDRAWN FROM STAKING OUT, PROSPECTING, SALE OR LEASE BY ORDER W.O.191 ONT. DATED SEPT. 30, 1991. SECTION 122 OF THE NATIONAL ENERGY BOARD ACT APPLIES.

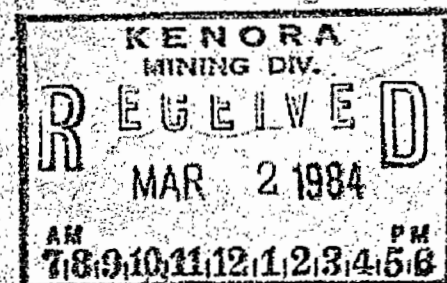

G 2629  
MARK LAKE M-2065

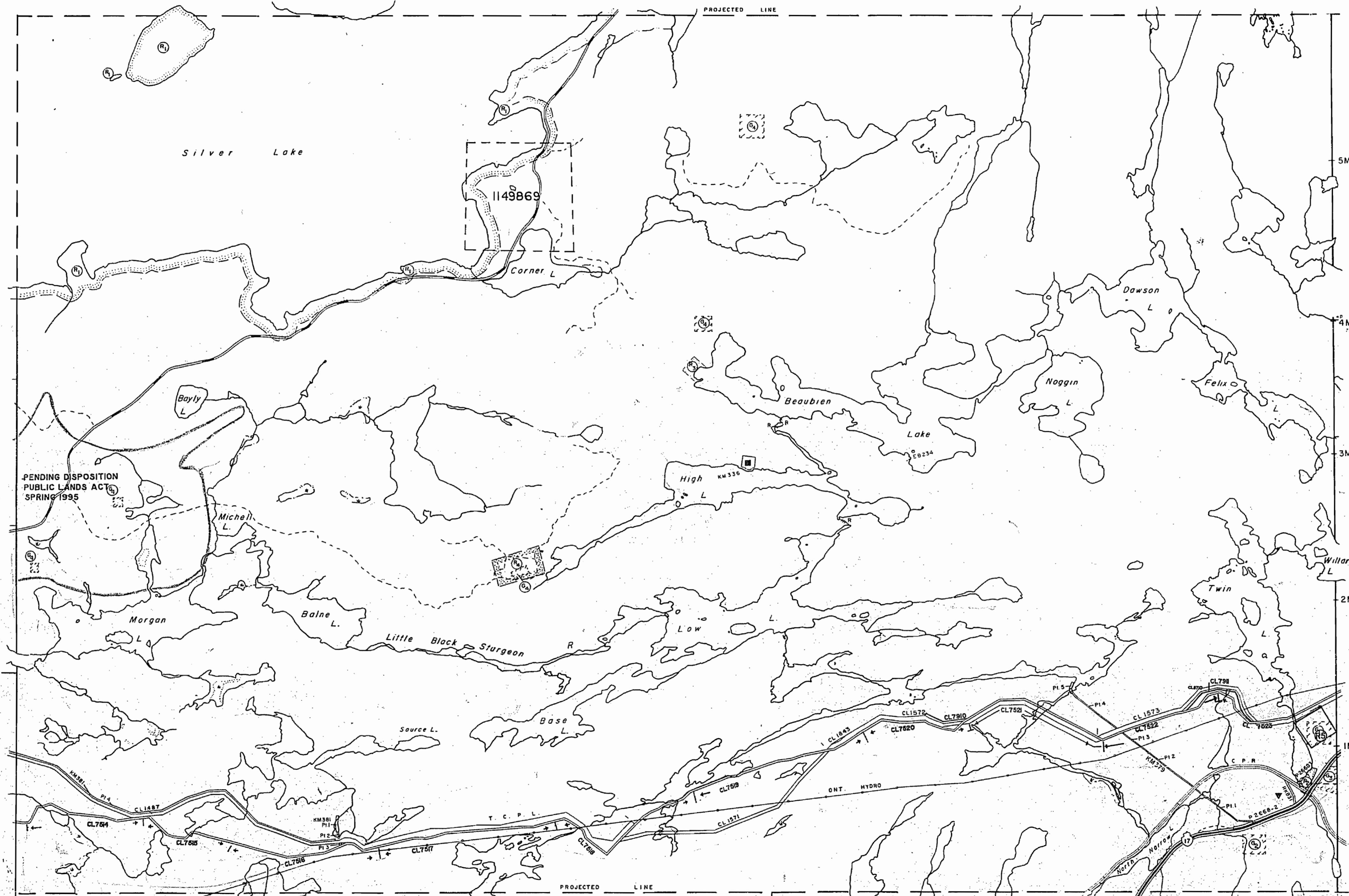

G 1352  
PETTYPIECE Tp. M-2022

G 1336  
HAYCOCK Tp. M-1987

G 1327  
COYLE Tp. M-1970

G 1328  
DESMOND Tp. M-217

LEGEND

- HIGHWAY AND ROUTE No.
- OTHER ROADS
- TRAILS
- SURVEYED LINES: TOWNSHIPS, BASE LINES, ETC.
- LOTS, MINING CLAIMS, PARCELS, ETC.
- UNSURVEYED LINES: LOT LINES
- PARCEL BOUNDARY
- MINING CLAIMS ETC.
- RAILWAY AND RIGHT OF WAY
- UTILITY LINES
- NON-PERENNIAL STREAM
- FLOODING OR FLOODING RIGHTS
- SUBDIVISION
- ORIGINAL SHORELINE
- MARSH OR MUSKEG
- MINES

DISPOSITION OF CROWN LANDS

TYPE OF DOCUMENT	SYMBOL
PATENT, SURFACE & MINING RIGHTS	●
SURFACE RIGHTS ONLY	○
MINING RIGHTS ONLY	◐
LEASE, SURFACE & MINING RIGHTS	■
SURFACE RIGHTS ONLY	□
MINING RIGHTS ONLY	◑
LICENCE OF OCCUPATION	▼
CROWN LAND SALE	CS
ORDER-IN-COUNCIL	OC
RESERVATION	⊙
CANCELLED	⊖
SAND & GRAVEL	⊕

THE INFORMATION THAT APPEARS ON THIS MAP HAS BEEN COMPILED FROM VARIOUS SOURCES, AND ACCURACY IS NOT GUARANTEED. THOSE WISHING TO STAKE MINING CLAIMS SHOULD CONSULT WITH THE MINING RECORDER, MINISTRY OF NORTHERN DEVELOPMENT AND MINES, FOR ADDITIONAL INFORMATION ON THE STATUS OF THE LANDS SHOWN HEREON.

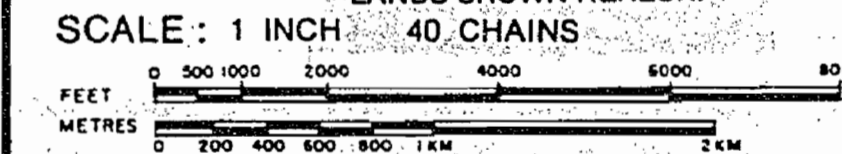

ACRES	HECTARES
40	16

TOWNSHIP  
**JACKMAN**  
DISTRICT  
KENORA  
MINING DIVISION  
KENORA

Ministry of Natural Resources  
Ontario Surveys and Mapping Branch

Date 6-76  
Whitney Block  
Queen's Park, Toronto

Plan No.  
**M-1993**

**G-1337**

JACKMAN G 1337



**NOTES**

400' surface rights reservation along the shores of all lakes and rivers.

**RESERVES**

- ① 400' reservation for surface rights to MHR pursuant to Section 3 of Public Lands Act file 163013
  - ② reserved for park use (Twin Lake provincial camp and picnic grounds) file 163013
  - ③ 400' reservation for surface rights to MHR pursuant to Section 3 of Public Lands Act file 163013
- WINR 61/82 SEM. H. Nov. 23/82.

**SAND and GRAVEL**

- ④ M.T.C. Gravel Pit 613
- ⑤ " " " 614
- ⑥ " " " 712
- ⑦ Gravel file 60329
- (5450 Smalls now reserved)

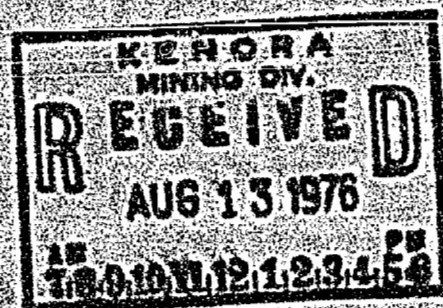

**MARK LAKE M.2065**

PETTYPIECE Tp. M.2022

HAYCOCK Tp. M.1987

MacNICOL Tp. M.2002

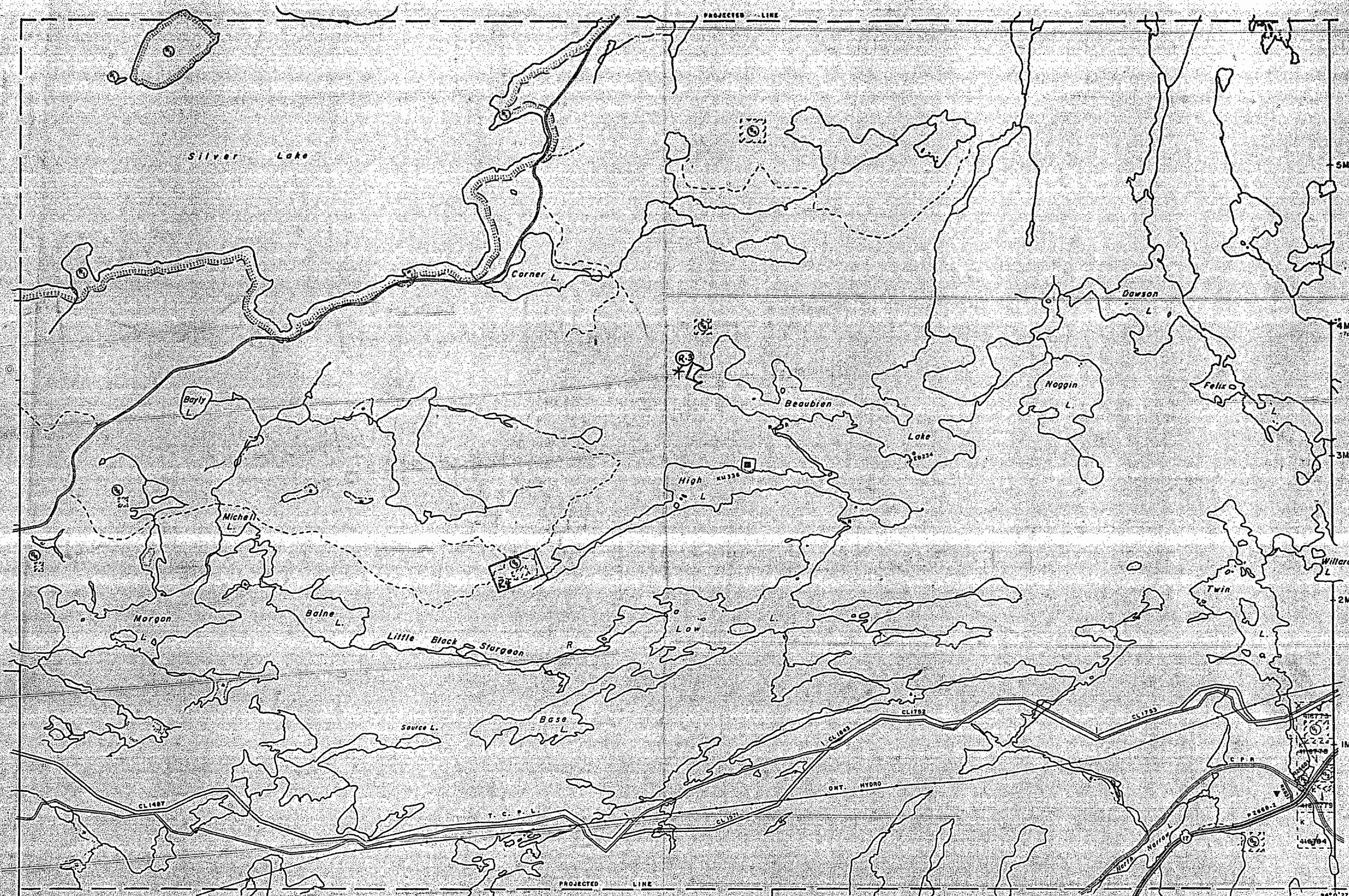

COYLE Tp. M.1970

DESMOND Tp. M.2117

**LEGEND**

- HIGHWAY AND ROUTE No.
- OTHER ROADS
- TRAILS
- SURVEYED LINES:
  - TOWNSHIP'S, BASE LINES, ETC.
  - LOTS, MINING CLAIMS, PARCELS, ETC.
- UNSURVEYED LINES:
  - LOT LINES
  - PARCEL BOUNDARY
  - MINING CLAIMS ETC.
- RAILWAY AND RIGHT OF WAY
- UTILITY LINES
- NON-PERENNIAL STREAM
- FLOODING OR FLOODING RIGHTS SUBDIVISION
- ORIGINAL SHORELINE
- MARSH OR MUSKOG
- MINES

**DISPOSITION OF CROWN LANDS**

TYPE OF DOCUMENT	SYMBOL
PATENT, SURFACE & MINING RIGHTS	●
SURFACE RIGHTS ONLY	○
MINING RIGHTS ONLY	◐
LEASE, SURFACE & MINING RIGHTS	◑
SURFACE RIGHTS ONLY	◒
MINING RIGHTS ONLY	◓
LICENCE OF OCCUPATION	▽
CROWN LAND SALE	CS
ORDER-IN-COUNCIL	⊗
RESERVATION	⊙
CANCELLED	⊖
SAND & GRAVEL	⊙
* SURFACE RIGHTS ONLY WITHDRAWN FROM PROSPECTING, SALE OR LEASE, STAKING OUT - ORDER NO. W.65/76	★

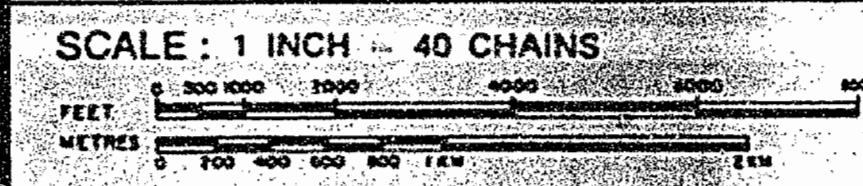

ACRES	HECTARES
40	16

TOWNSHIP  
**JACKMAN**  
DISTRICT  
KENORA  
MINING DIVISION  
KENORA

**Ministry of Natural Resources**  
Ontario Surveys and Mapping Branch  
Date: 8-78 Plan No. M.1993  
Whitney Block Queen's Park, Toronto



# DISTRICT OF KENORA

Scale: - 10 Chains = 1 inch

North Ast

JACKMAN

TUSTIN

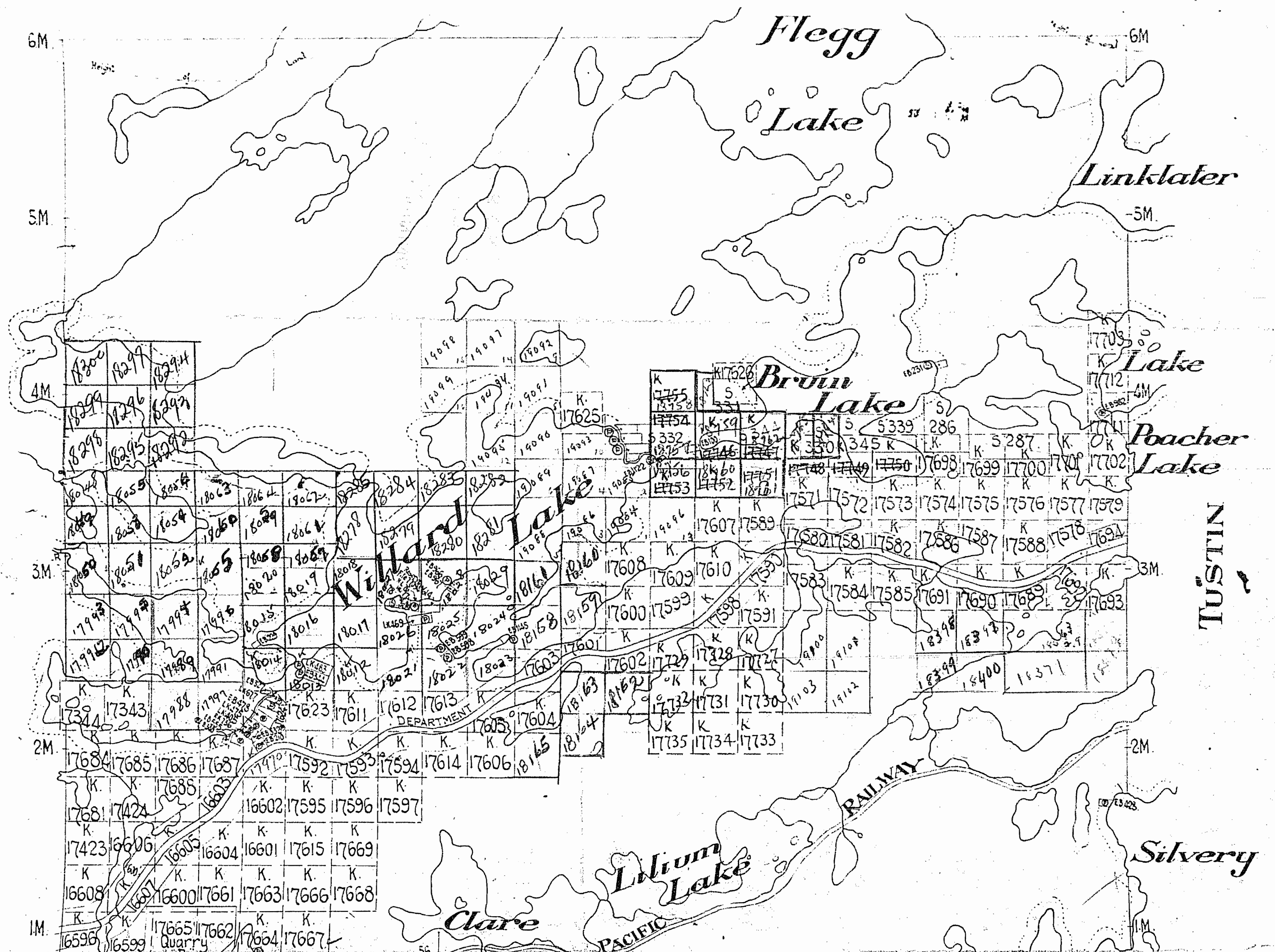



# JACKMAN

Nov. 17/65

July 13/67

KENORA MINING DIVISION

Sept. 23/70

DISTRICT OF KENORA

Scale: - 40 Chains - 1 Inch

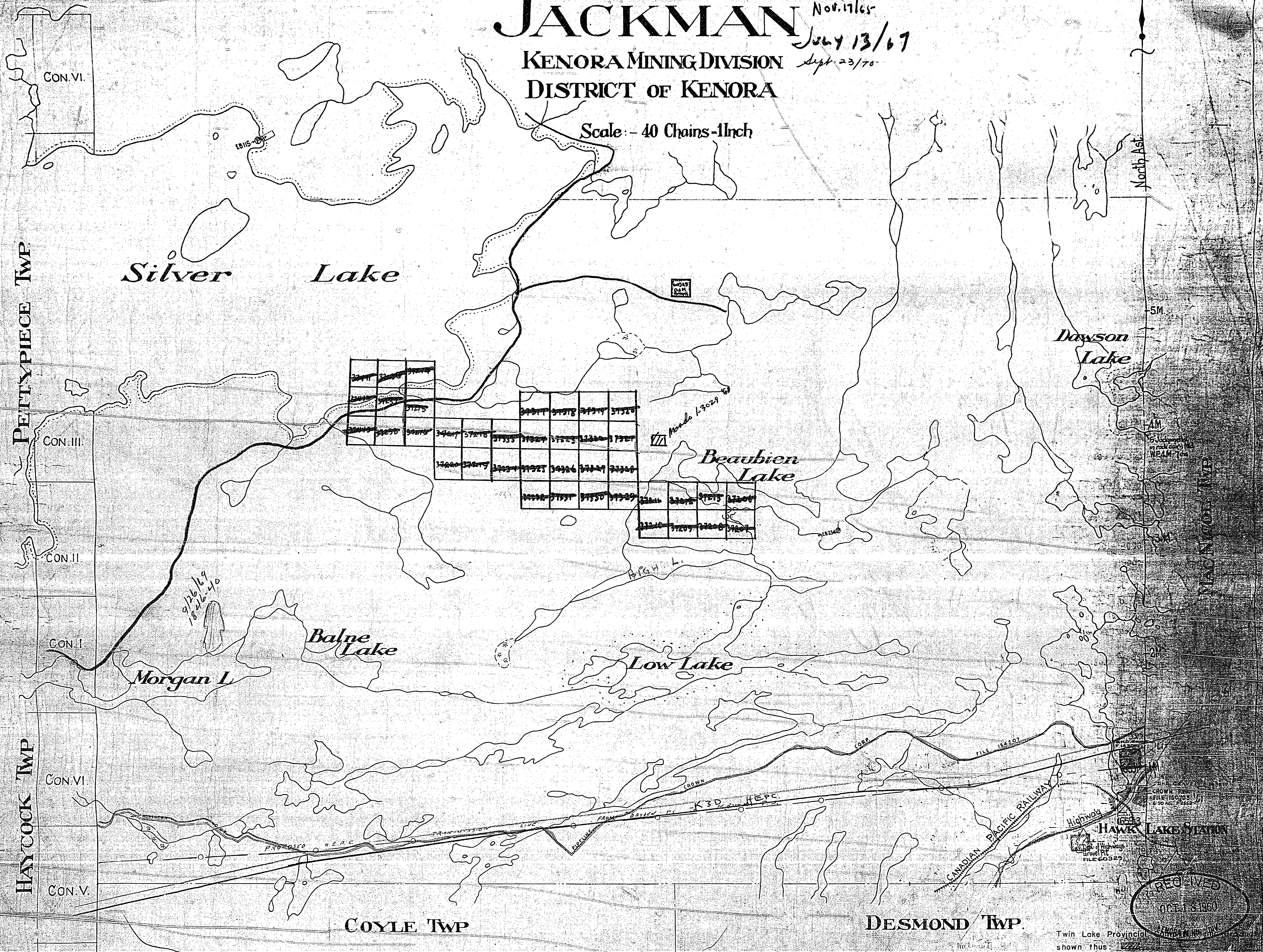

Surface reservation 400 ft wide by Department of Lands and Forests Shown Thus. This reservation to apply also along the shore lines of all islands lying within the delineated areas

RECEIVED  
 OCT 15 1960  
 MINING DIVISION

JACKMAN  
 M 199



1993

# JACKMAN

Map  
1993

KENORA MINING DIVISION  
DISTRICT OF KENORA

Scale - 40 Chains - 1 Inch

179

North Arrow

PETTYPIECE TWP.

HAYCOCK TWP.

MAC NICOL TWP.

COYLE TWP.

JACKMAN  
TWP.

JACKMAN  
1993

CON. VI.  
CON. III.  
CON. II.  
CON. I.  
CON. VI.  
CON. V.

Silver Lake

Morgan I.

Balne Lake

Beaubien Lake

Low Lake

Dawson Lake

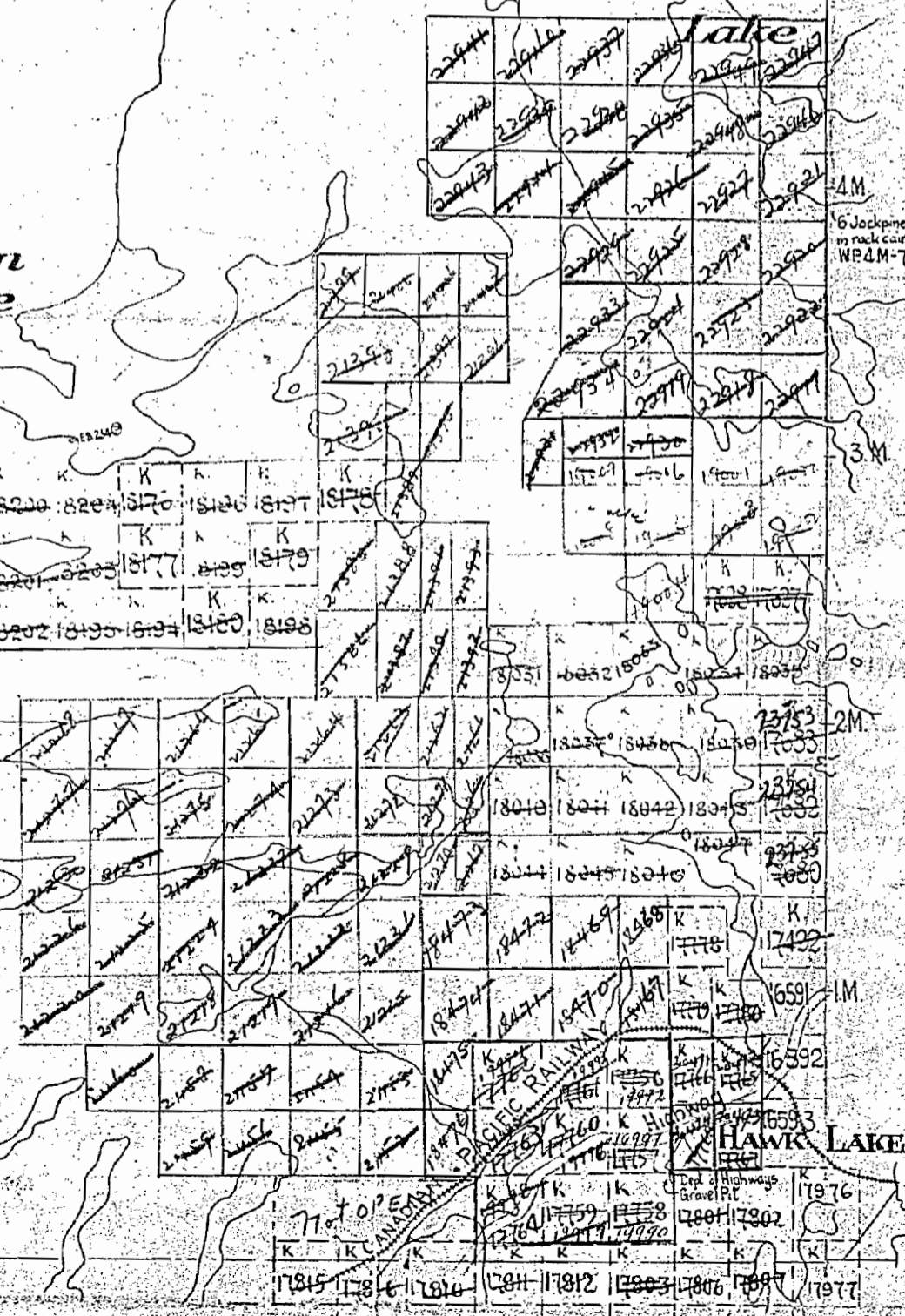

5M

4M

3M

2M

1M

1976

1977

1978

1979

1980

1981

1982

1983

1984

1985

1986

1987

1988

1989

1990

1991

1992

1993

1994

1995

1996

1997

1998

1999

2000

2001

2002

2003

2004

2005

2006

2007

2008

2009

2010

2011

2012

2013

2014

2015

2016

2017

2018

2019

2020

2021

2022

2023

2024

2025

2026

2027

2028

2029

2030

2031

2032

2033

2034

2035

2036

2037

2038

2039

2040

2041

2042

2043

2044

2045

2046

2047

2048

2049

2050

2051

2052

2053

2054

2055

2056

2057

2058

2059

2060

2061

2062

2063

2064

2065

2066

2067

2068

2069

2070

2071

2072

2073

2074

2075

2076

2077

2078

2079

2080

2081

2082

2083

2084

2085

2086

2087

2088

2089

2090

2091

2092

2093

2094

2095

2096

2097

2098

2099

2100

2101

2102

2103

2104

2105

2106

2107

2108

2109

2110

2111

2112

2113

2114

2115

2116

2117

2118

2119

2120

2121

2122

2123

2124

2125

2126

2127

2128

2129

2130

2131

2132

2133

2134

2135

2136

2137

2138

2139

2140

2141

2142

2143

2144

2145

2146

2147

2148

2149

2150

2151

2152

2153

2154

2155

2156

2157

2158

2159

2160

2161

2162

2163

2164

2165

2166

2167

2168

2169

2170

2171

2172

2173

2174

2175

2176

2177

2178

2179

2180

2181

2182

2183

2184

2185

2186

2187

2188

2189

2190

2191

2192

2193

2194

2195

2196

2197

2198

2199

2200

2201

2202

2203

2204

2205

2206

2207

2208

2209

2210

2211

2212

2213

2214

2215

2216

2217

2218

2219

2220

2221

2222

2223

2224

2225

2226

2227

2228

2229

2230

2231

2232

2233

2234

2235

2236

2237

2238

2239

2240

2241

2242

2243

2244

2245

2246

2247

2248

2249

2250

2251

2252

2253

2254

2255

2256

2257



KENORA MINING DIVISION  
DISTRICT OF KENORA

Scale: - 40 Chains - 1 inch

2002

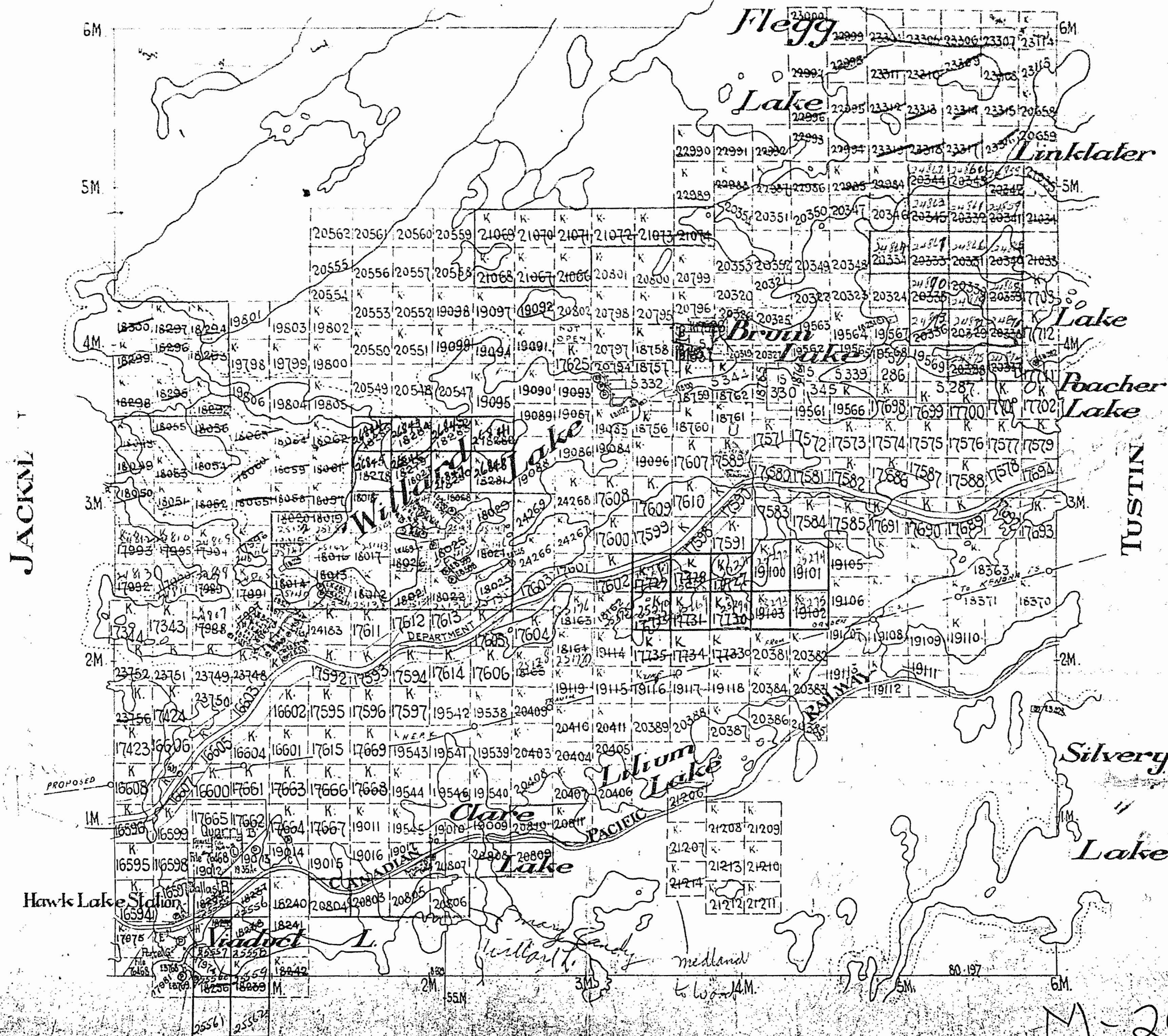

M-2002



# JACKMAN

5 map  
1993

KENORA MINING DIVISION  
DISTRICT OF KENORA

Scale - 40 Chains = 1 Inch

79

PETTYPIECE TWP

HAYCOCK TWP

Silver Lake

Balne Lake

Morgan I.

Low Lake

Beaubien Lake

Dawson Lake

MACNICOL TWP

JACKMAN

JACKMAN 1993

CON. VI

CON. III

CON. II

CON. I

CON. VI

CON. V

COYLE TWP

DESMON

15M

4M

3M

2M

1M

17976

17802

17977

17806

17812

17816

17810

17803

17800

17807

17802

17801

17804

17805

17808

17809

17811

17813

17814

17815

17817

17818

17819

17820

17821

17822

17823

17824

17825

17826

17827

17828

17829

17830

17831

17832

17833

17834

17835

17836

17837

17838

17839

17840

17841

17842

17843

17844

17845

17846

17847

17848

17849

17850

17851

17852

17853

17854

17855

17856

17857

17858

17859

17860

17861

17862

17863

17864

17865

17866

17867

17868

17869

17870

17871

17872

17873

17874

17875

17876

17877

17878

17879

17880

17881

17882

17883

17884

17885

17886

17887

17888

17889

17890

17891

17892

17893

17894

17895

17896

17897

17898

17899

17900

17901

17902

17903

17904

17905

17906

17907

17908

17909

17910

17911

17912

17913

17914

17915

17916

17917

17918

17919

17920

17921

17922

17923

17924

17925

17926

17927

17928

17929

17930

17931

17932

17933

17934

17935

17936

17937

17938

17939

17940

17941

17942

17943

17944

17945

17946

17947

17948

17949

17950

17951

17952

17953

17954

17955

17956

17957

17958

17959

17960

17961

17962

17963

17964

17965

17966

17967

17968

17969

17970

17971

17972

17973

17974

17975

17976

17977

17978

17979

17980

17981

17982

17983

17984

17985

17986

17987

17988

17989

17990

17991

17992

17993

17994

17995

17996

17997

17998

17999

18000

18001

18002

18003

18004

18005

18006

18007

18008

18009

18010

18011

18012

18013

18014

18015

18016

18017

18018

18019

18020

18021

18022

18023

18024

18025

18026

18027

18028

18029

18030

18031

18032

18033

18034

18035

18036

18037

18038

18039

18040

18041

18042

18043

18044

18045

18046

18047

18048

18049

18050

18051

18052

18053

18054

18055

18056

18057

18058

18059

18060

18061

18062

18063

18064

18065

18066

18067

18068

18069

18070

18071

18072

18073

18074

18075

18076

18077

18078

18079



1993

# JACKMAN

Nov. 17/65  
July 13/67  
Sept. 23/70

KENORA MINING DIVISION  
DISTRICT OF KENORA

Scale: - 40 Chains - 1 Inch

PETTYPIECE TWP.

CON. VI.

CON. III.

CON. II.

HAYCOCK TWP.

CON. I.

CON. VI.

CON. V.

Silver Lake

31241	31242	31243	31244	31245	31246	31247	31248	31249	31250
31251	31252	31253	31254	31255	31256	31257	31258	31259	31260
31261	31262	31263	31264	31265	31266	31267	31268	31269	31270
31271	31272	31273	31274	31275	31276	31277	31278	31279	31280
31281	31282	31283	31284	31285	31286	31287	31288	31289	31290
31291	31292	31293	31294	31295	31296	31297	31298	31299	31300

Beaubien Lake

Balne Lake

Low Lake

Morgan I.

Dawson Lake

North Ast.

5M.  
4M.  
3M.  
2M.

MAGNICOY TWP.

JACKMAN TWP. M1993

Surface reservation 400 ft wide by Department of Lands and Forests Shown Thus: ——— This reservation to apply also along the shore lines of all islands lying within the delineated areas

RECEIVED  
OCT 13 1960

JACKMAN TWP  
M 1993

Twin Lake Provincial  
shown thus: [Symbol]

CANADIAN PACIFIC RAILWAY  
Highway  
LAKE STATION

FILE 154607  
K3D HEPC  
16583  
FILE 160705  
FILE 60329



DISTRICT OF YUKON

Scale: - 40 Chains - 1 Inch

2002

North Asi

JACKMAN

TUSTIN

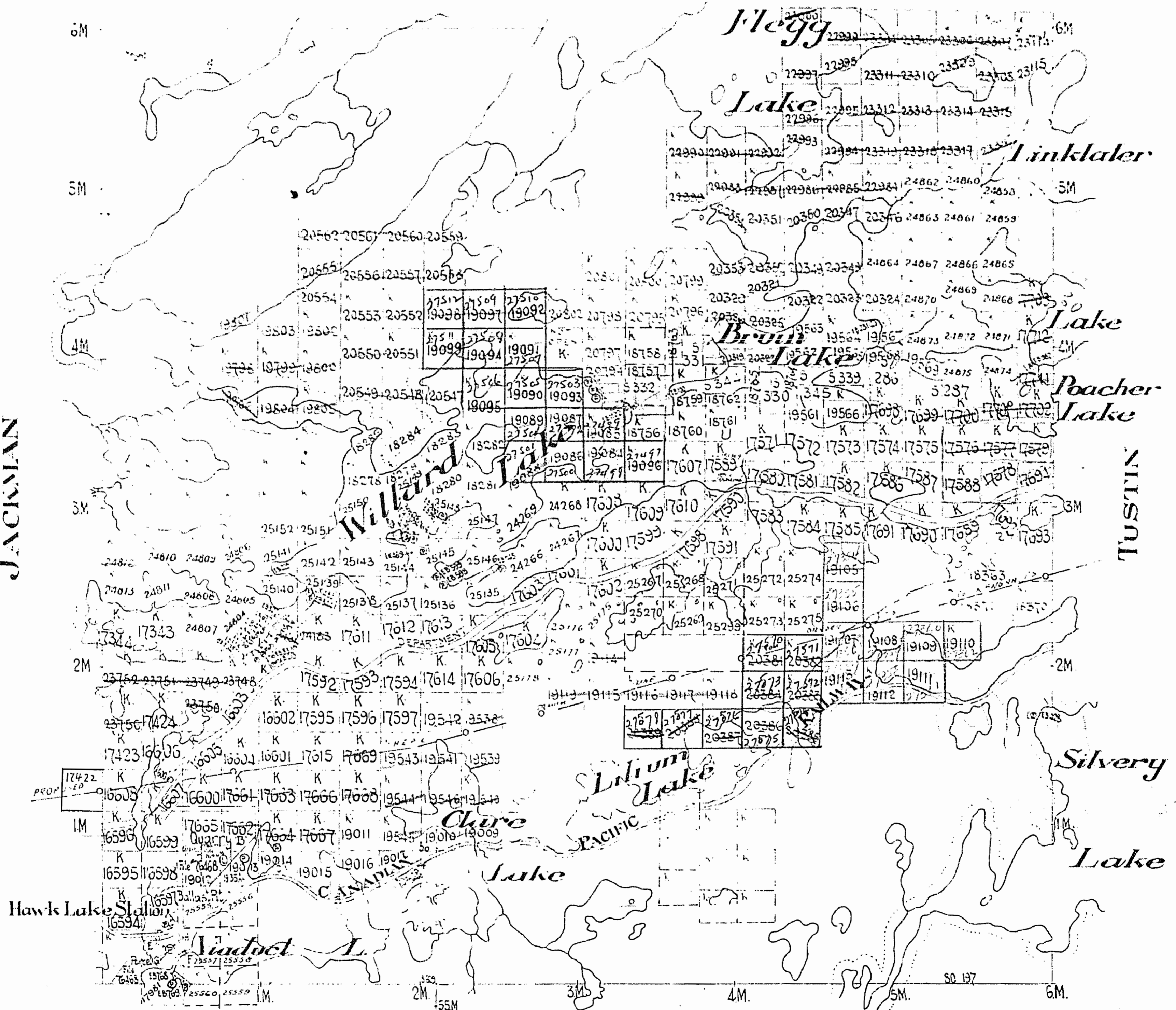

M-2002



1993

M.1993

# JACKMAN

## KENORA MINING DIVISION DISTRICT OF KENORA

**NOTE**

Roads indicated Ontario - Minnesota Pulp & Paper Company Private Road, may be used by prospectors, only after permission is obtained from the Company at Kenora, Ontario.

ONTARIO  
DEPARTMENT OF MINES  
AND NORTHERN AFFAIRS

Scale: - 40 Chains - 1 Inch

PETITPIECE TWP

HAYCOCK TWP

### Silver Lake

### Dawson Lake

### Beaubien Lake

### Balme Lake

### Low Lake

### Morgan I.

COYLE TWP

DESMOND TWP

CON. VI.

CON. III.

CON. II.

CON. I.

CON. VI.

CON. V.

EBIS - 6

Private Road

O. - M. P & P Co. Private Road

Company

Paper

Pulp

Minnesota

Ontario

DL 272

DL 273

FILE 60329

FILE 60329

FILE 154502

FILE 154502

SHAWAN LAKE STATION

Surface reservation 400 ft wide by Department of Lands and Forests shown thus ——— This reservation to apply also along the shore lines of all islands lying within the delineated areas

JACKMAN 19







KENORA MINING DIVISION  
DISTRICT OF KENORA

Scale: - 40 Chains - 1 Inch

K-118

Map-2002

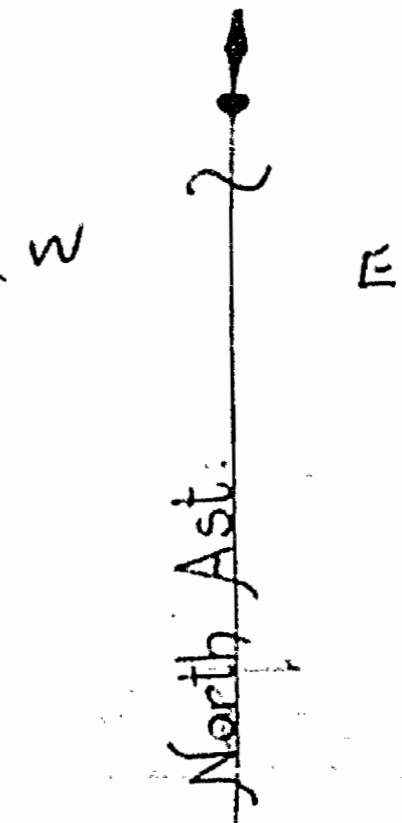

JACKMAN

TUSTIN

