

# JOLLINEAU TP.

(Former TP. 3H)  
MISSISSAGI PROVINCIAL FOREST  
DISTRICT OF ALGOMA

G.2378  
M.1700



Scale 40 Chains = 1 Inch

MENARD TP. M.1418  
(TWP. 4H)

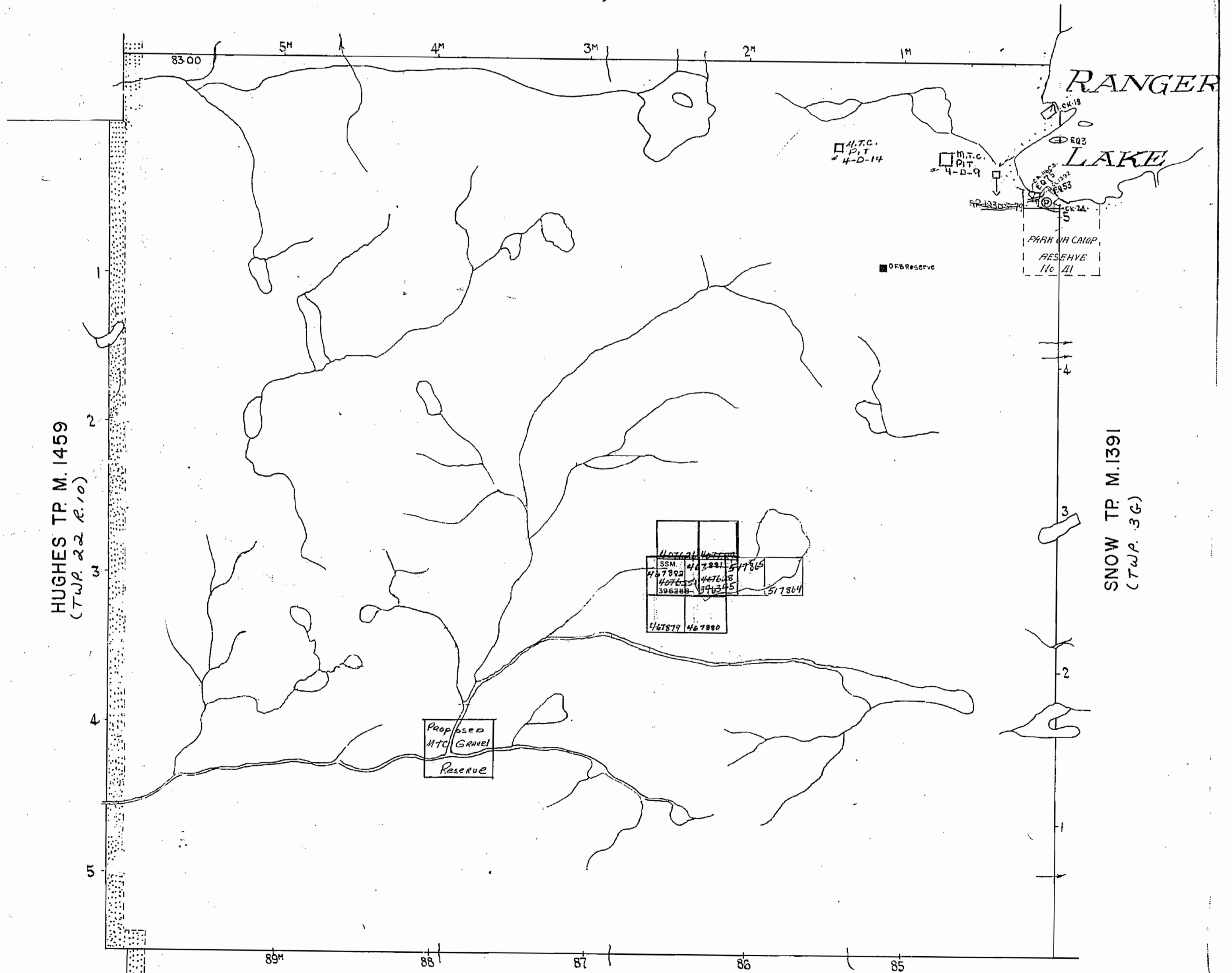

HURLBURT TP. M.1619  
(TWP. 202)

→ LAKES AND RIVERS FROM PUBLISHED MAP NO 32A. 1932  
WEST BOUNDARY OF MISSISSAGI PROVINCIAL FOREST RESERVE

400' SURFACE RIGHTS RESERVATION AROUND ALL LAKES & RIVERS.

NOTE: Part of this Twp. is covered by  
"Unspecified Pit Permit #445 in the name  
of HENRY JOHNSON TIMBER COMPANY - see file  
for details

**JOLLINEAU TP.**  
 (Former TP. 3H)  
 MISSISSAGI PROVINCIAL FOREST  
 DISTRICT OF ALGOMA

~~M. 1392~~  
**G. 2378**

DATE OF ISSUE  
 JAN 28 1980

Scale 40 Chains = 1 Inch

(R) Surface Rights are withdrawn from staking  
 See ORDER # W. 5/32 - Sault Ste. Marie - Feb. 17/32.

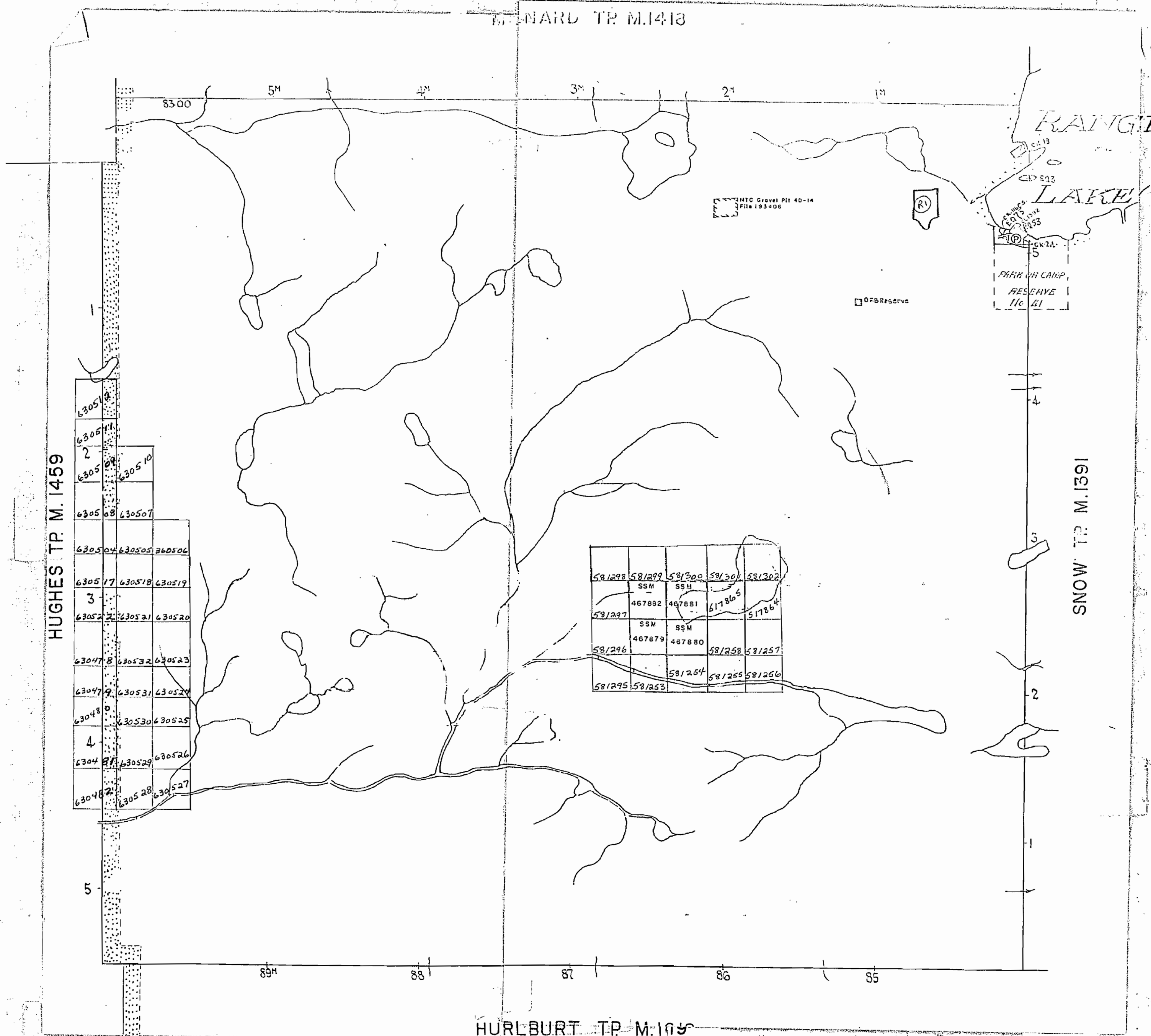

HUGHES TP. M. 1459

SNOW TP. M. 1391

HURLBURT TP. M. 1095

JOLLINEAU TP. M. 1413

→ LAKES AND RIVERS FROM PUBLISHED MAP No 32A 1932  
 → WEST BOUNDARY OF MISSISSAGI PROVINCIAL FOREST RESERVE

400' SURFACE RIGHTS RESERVATION AROUND ALL LAKES & RIVERS.

# JOLLINEAU TP.

(Former TP.3H)  
MISSISSAGI PROVINCIAL FOREST  
DISTRICT OF ALGOMA

~~M.1392~~  
**G.2378**

DATE OF ISSUE  
MAR 24 1982  
Ministry of Natural Resources  
TORONTO

Scale 40 Chains = 1 Inch

Areas withdrawn from staking under Section  
36 of the Mining Act (R.S.O. 1980).

Order No.	File	Date	Disposition
W.5/82	188536	17/2/82	S.R.O.
W.2/83		1/3/83	S.R.O.

MENARD TP. M.1418

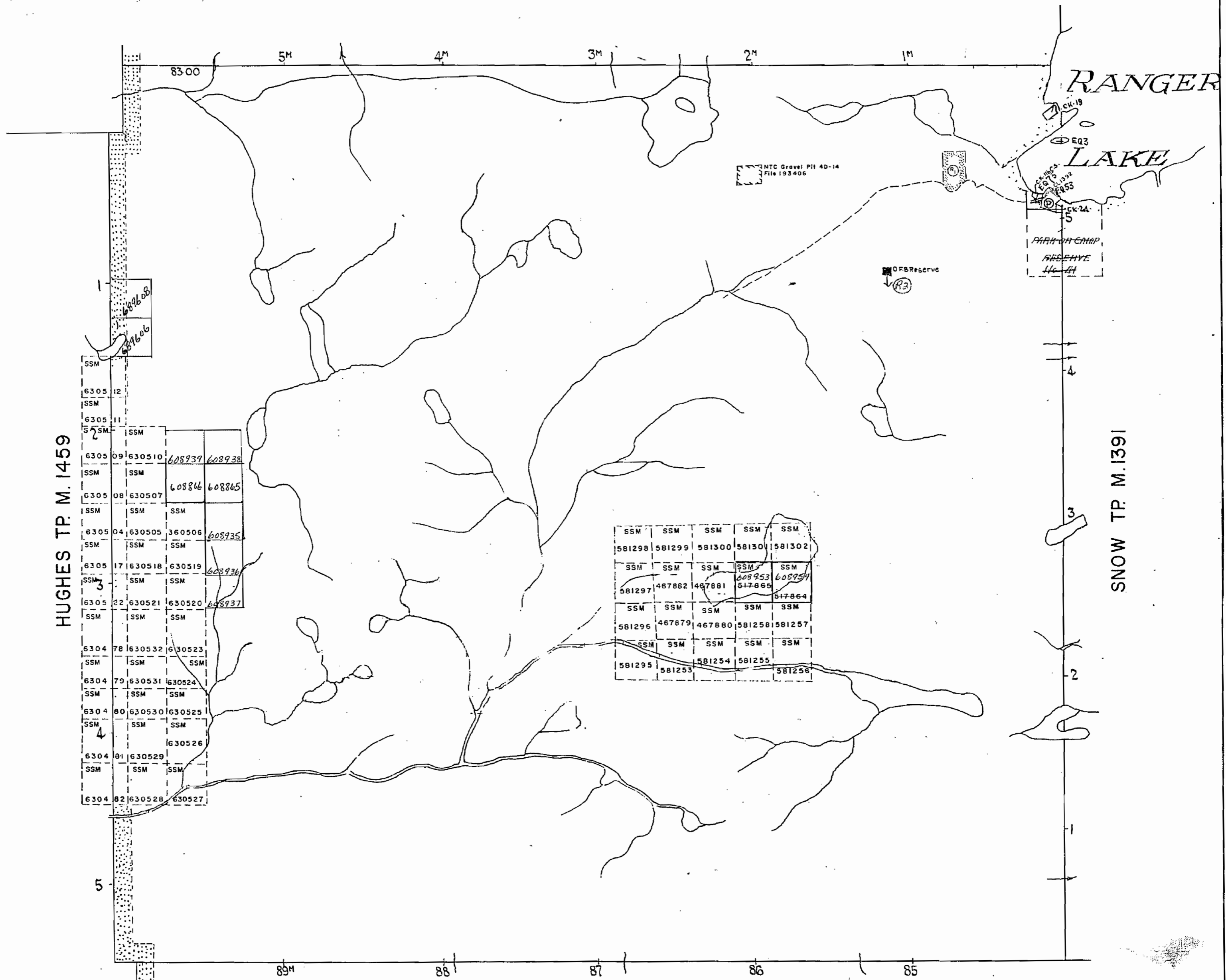

HUGHES TP. M.1459

SNOW TP. M.1391

HURLBURT TP. M.1619

LAKES AND RIVERS FROM PUBLISHED MAP NO 32A-1932  
WEST BOUNDARY OF MISSISSAGI PROVINCIAL FOREST RESERVE

400' SURFACE RIGHTS RESERVATION AROUND ALL LAKES & RIVERS.

Replaced by map June 23/83

**REFERENCES**

**AREAS WITHDRAWN FROM DISPOSITION**

- M.R.O. — MINING RIGHTS ONLY
- S.R.O. — SURFACE RIGHTS ONLY
- M.+S. — MINING AND SURFACE RIGHTS

Description	Order No.	Date	Disposition	File
(1)	W5 82	17/2/82	S.R.O.	188536
(2)	W2/83	7 3 83	S.R.O.	188536

**MENARD TWP.**

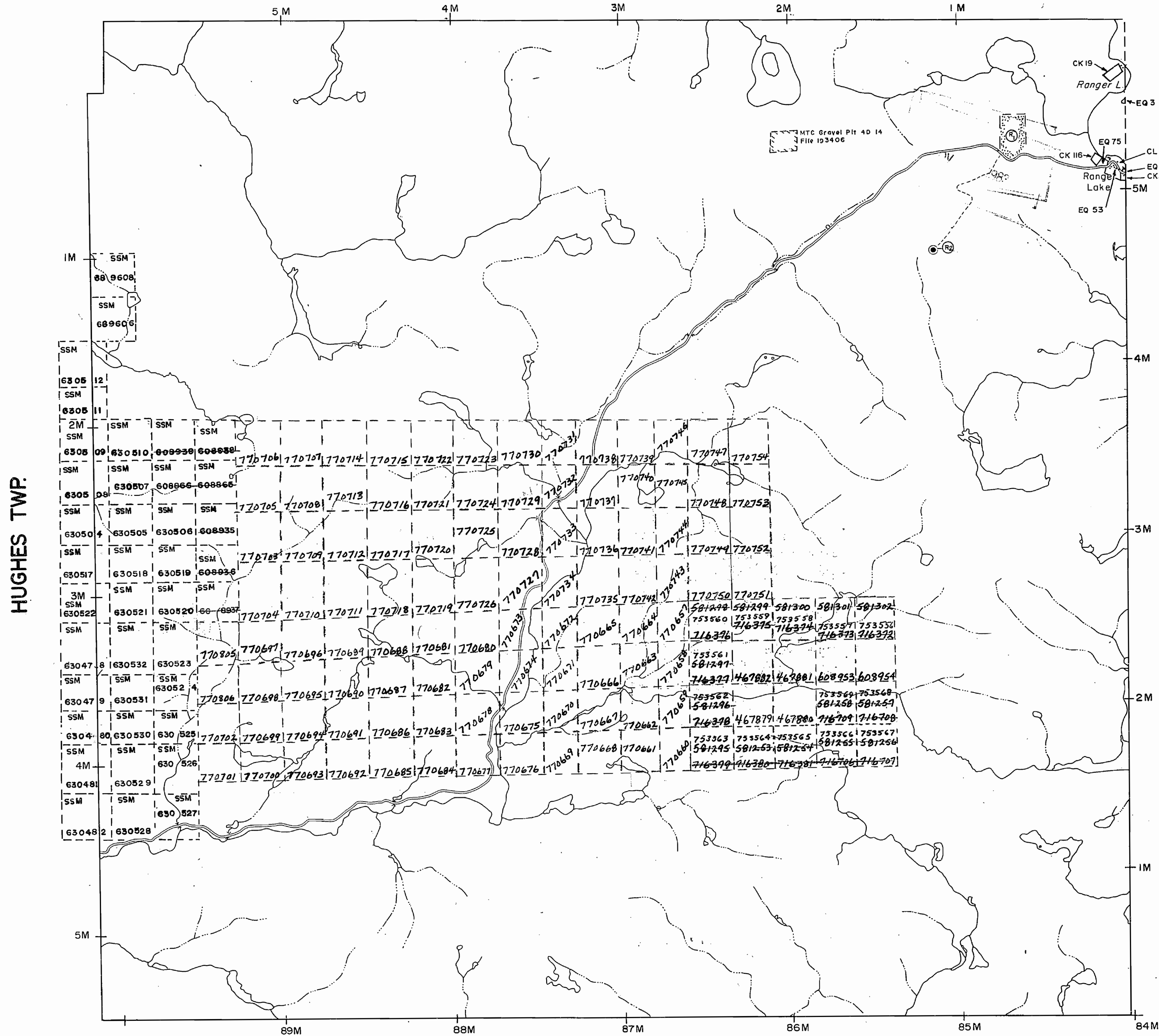

**LEGEND**

- HIGHWAY AND ROUTE No.
- OTHER ROADS
- TRAILS
- SURVEYED LINES:
  - TOWNSHIPS, BASE LINES, ETC.
  - LOTS, MINING CLAIMS, PARCELS, ETC.
- UNSURVEYED LINES:
  - LOT LINES
  - PARCEL BOUNDARY
  - MINING CLAIMS ETC.
- RAILWAY AND RIGHT OF WAY
- UTILITY LINES
- NON-PERENNIAL STREAM
- FLOODING OR FLOODING RIGHTS
- SUBDIVISION OR COMPOSITE PLAN
- RESERVATIONS
- ORIGINAL SHORELINE
- MARSH OR MUSKEG
- MINES
- TRAVERSE MONUMENT

**DISPOSITION OF CROWN LANDS**

TYPE OF DOCUMENT	SYMBOL
PATENT, SURFACE & MINING RIGHTS	
" SURFACE RIGHTS ONLY	
" MINING RIGHTS ONLY	
LEASE, SURFACE & MINING RIGHTS	
" SURFACE RIGHTS ONLY	
" MINING RIGHTS ONLY	
LICENCE OF OCCUPATION	
ORDER-IN-COUNCIL	
RESERVATION	
CANCELLED	
SAND & GRAVEL	

NOTE: MINING RIGHTS IN PARCELS PATENTED PRIOR TO MAY 6, 1913, VESTED IN ORIGINAL PATENTEE BY THE PUBLIC LANDS ACT, R.S.O. 1970, CHAP. 380, SEC. 63, SUBSEC. 1.

SCALE: 1 INCH = 40 CHAINS

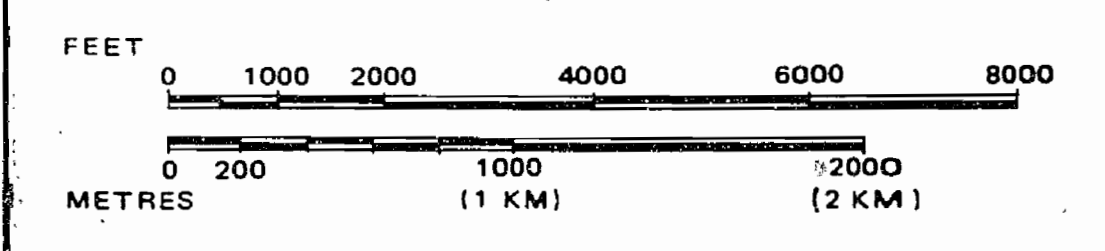

TOWNSHIP  
**JOLLINEAU**  
 M.N.R. ADMINISTRATIVE DISTRICT  
**SAULT STE. MARIE**  
 MINING DIVISION  
**SAULT STE. MARIE**  
 LAND TITLES / REGISTRY DIVISION  
**ALGOMA**

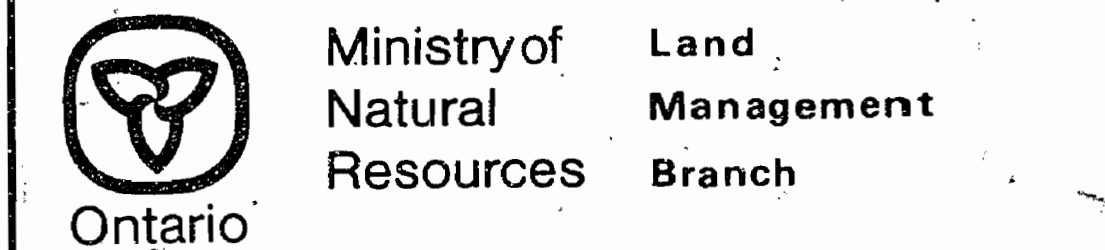

Date MARCH 9, 1983  
 Number  
**G-2378**

SAULT STE. MARIE  
 MINING DIV.  
**RECEIVED**  
 JUN 23 1983  
 A.M. 7:09 10:11:12 1:03 4:56 P.M.

Replaced by nu. m. 10  
 Oct. 31/84

# REFERENCES

## AREAS WITHDRAWN FROM DISPOSITION

- M.R.O. - MINING RIGHTS ONLY
- S.R.O. - SURFACE RIGHTS ONLY
- M.+S. - MINING AND SURFACE RIGHTS

Description	Order No.	Date	Disposition	File
	W5/82	17/2/82	S.R.O.	188536
	W2/83	7/3/83	S.R.O.	188536

# MENARD TWP.

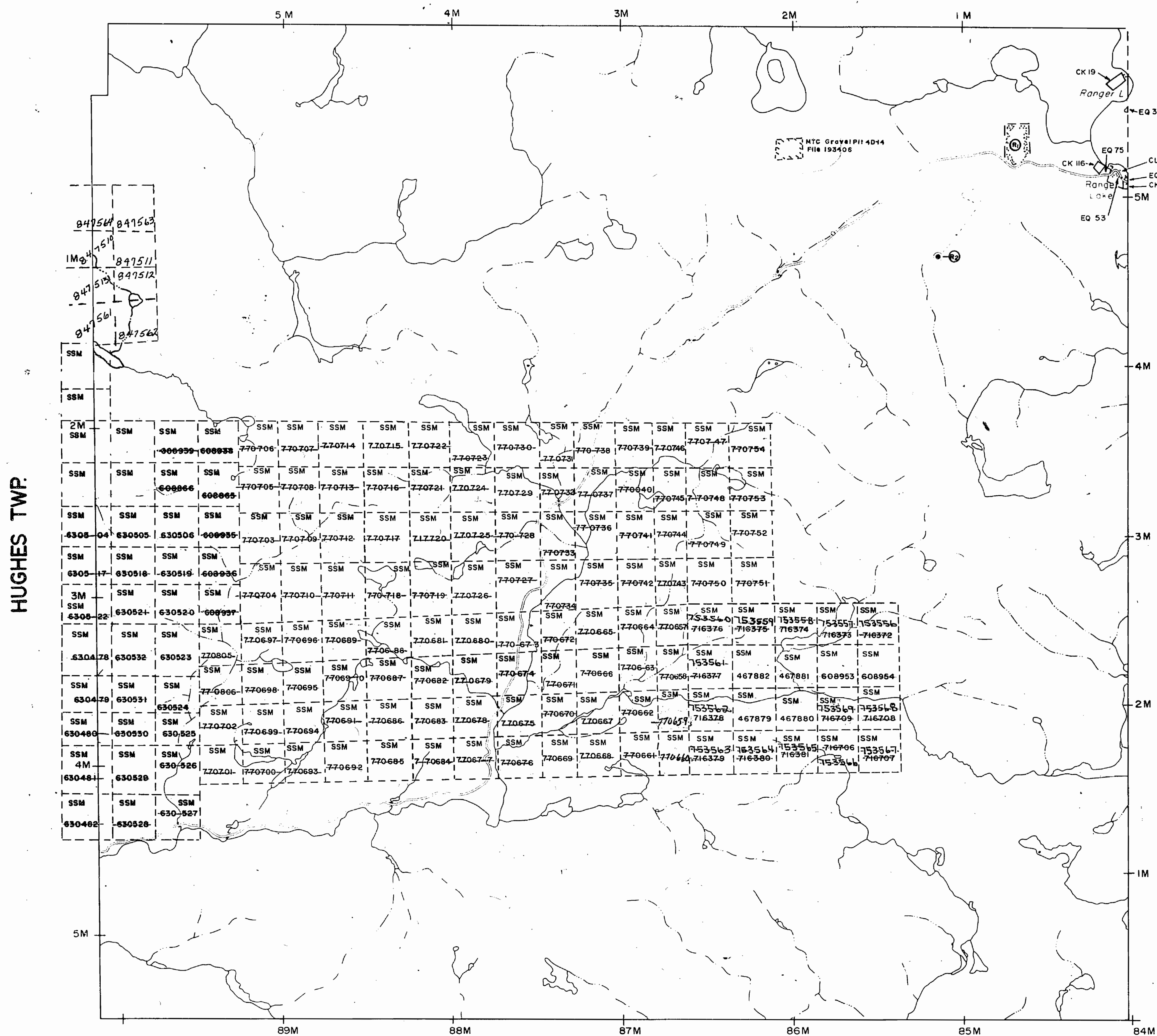

# LEGEND

- HIGHWAY AND ROUTE No.
- OTHER ROADS
- TRAILS
- SURVEYED LINES:
  - TOWNSHIPS, BASE LINES, ETC.
  - LOTS, MINING CLAIMS, PARCELS, ETC.
- UNSURVEYED LINES:
  - LOT LINES
  - PARCEL BOUNDARY
  - MINING CLAIMS ETC.
- RAILWAY AND RIGHT OF WAY
- UTILITY LINES
- NON-PERENNIAL STREAM
- FLOODING OR FLOODING RIGHTS
- SUBDIVISION OR COMPOSITE PLAN RESERVATIONS
- ORIGINAL SHORELINE
- MARSH OR MUSKEG
- MINES
- TRAVERSE MONUMENT

## DISPOSITION OF CROWN LANDS

TYPE OF DOCUMENT	SYMBOL
PATENT, SURFACE & MINING RIGHTS	
" SURFACE RIGHTS ONLY	
" MINING RIGHTS ONLY	
LEASE, SURFACE & MINING RIGHTS	
" SURFACE RIGHTS ONLY	
" MINING RIGHTS ONLY	
LICENCE OF OCCUPATION	
ORDER-IN-COUNCIL	
RESERVATION	
CANCELLED	
SAND & GRAVEL	

NOTE: MINING RIGHTS IN PARCELS PATENTED PRIOR TO MAY 6, 1913, VESTED IN ORIGINAL PATENTEE BY THE PUBLIC LANDS ACT, R.S.O. 1970, CHAP. 380, SEC. 63, SUBSEC. 1.

SCALE: 1 INCH = 40 CHAINS.

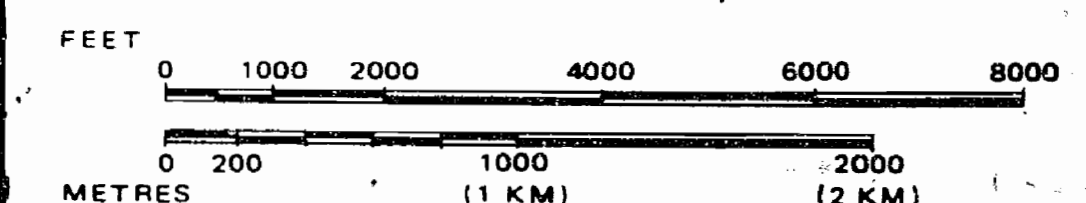

# TOWNSHIP JOLLINEAU

M.N.R. ADMINISTRATIVE DISTRICT  
**SAULT STE. MARIE**  
 MINING DIVISION  
**SAULT STE. MARIE**  
 LAND TITLES / REGISTRY DIVISION  
**ALGOMA**

Ministry of Land  
 Natural Resources Management  
 Ontario Branch

Date MARCH 9, 1983

Number

**G-2378**

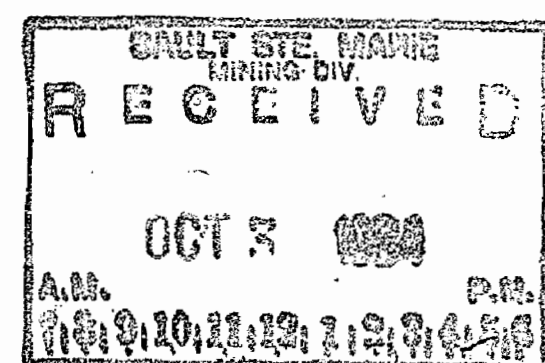

HURLBURT TWP.

*Replaced by new mylar - Dec. 1983*

**REFERENCES**

**AREAS WITHDRAWN FROM DISPOSITION**

- M.R.O. - MINING RIGHTS ONLY
- S.R.O. - SURFACE RIGHTS ONLY
- M.+S. - MINING AND SURFACE RIGHTS

Description	Order No.	Date	Disposition	File

**MENARD TWP.**

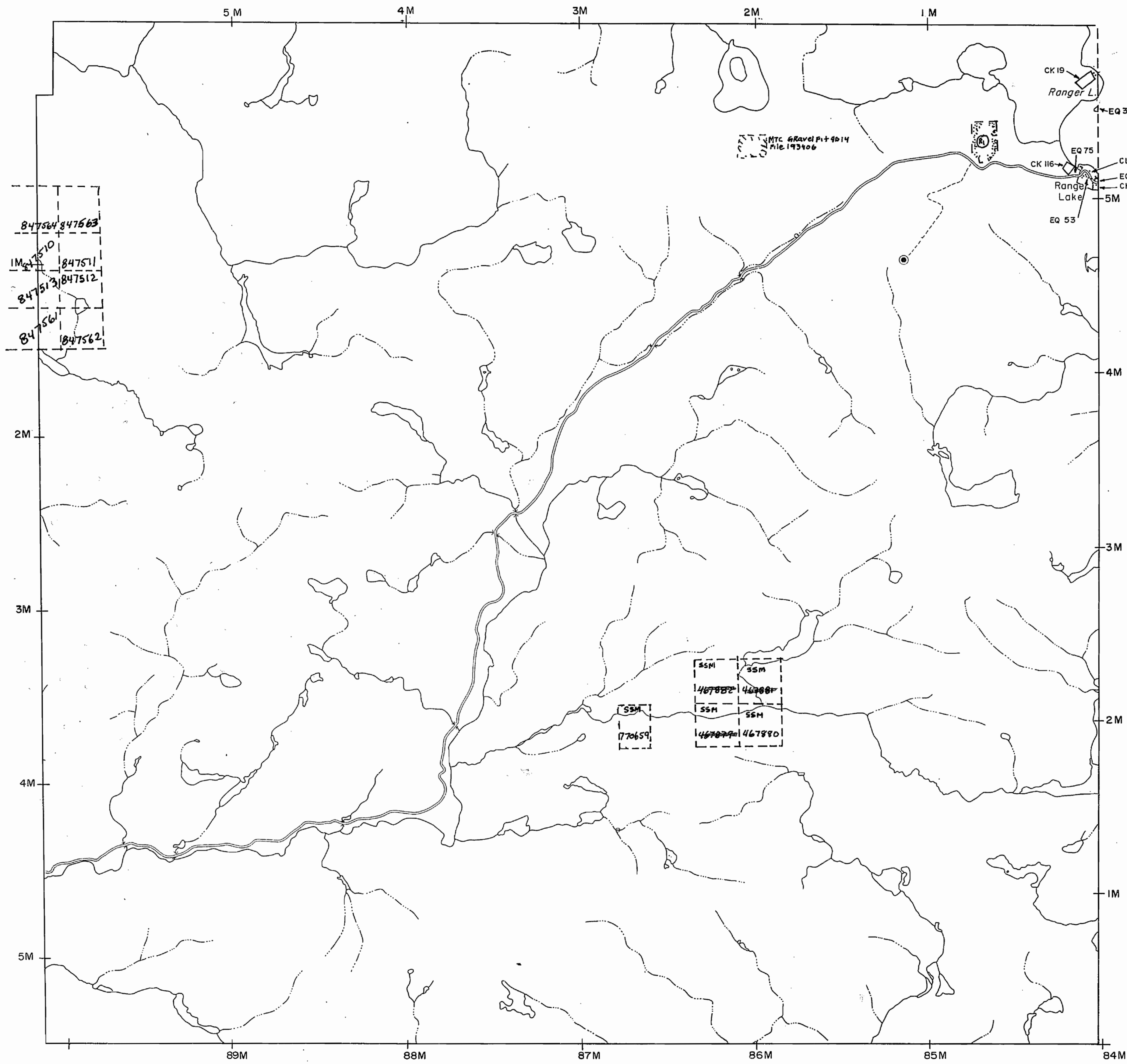

**LEGEND**

- HIGHWAY AND ROUTE No.
- OTHER ROADS
- TRAILS
- SURVEYED LINES:
  - TOWNSHIPS, BASE LINES, ETC.
  - LOTS, MINING CLAIMS, PARCELS, ETC.
- UNSURVEYED LINES:
  - LOT LINES
  - PARCEL BOUNDARY
  - MINING CLAIMS ETC.
- RAILWAY AND RIGHT OF WAY
- UTILITY LINES
- NON-PERENNIAL STREAM
- FLOODING OR FLOODING RIGHTS
- SUBDIVISION OR COMPOSITE PLAN
- RESERVATIONS
- ORIGINAL SHORELINE
- MARSH OR MUSKEG
- MINES
- TRAVERSE MONUMENT

**DISPOSITION OF CROWN LANDS**

TYPE OF DOCUMENT	SYMBOL
PATENT, SURFACE & MINING RIGHTS	
" , SURFACE RIGHTS ONLY	
" , MINING RIGHTS ONLY	
LEASE, SURFACE & MINING RIGHTS	
" , SURFACE RIGHTS ONLY	
" , MINING RIGHTS ONLY	
LICENCE OF OCCUPATION	
ORDER-IN-COUNCIL	OC
RESERVATION	
CANCELLED	
SAND & GRAVEL	

NOTE: MINING RIGHTS IN PARCELS PATENTED PRIOR TO MAY 6, 1913, VESTED IN ORIGINAL PATENTEE BY THE PUBLIC LANDS ACT, R.S.O. 1970, CHAP. 380, SEC. 63, SUBSEC. 1.

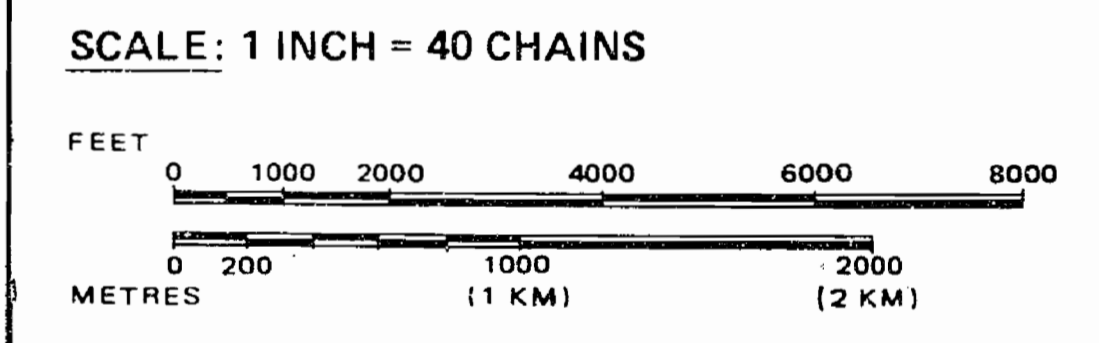

TOWNSHIP  
**JOLLINEAU**  
 M.N.R. ADMINISTRATIVE DISTRICT  
**SAULT STE. MARIE**  
 MINING DIVISION  
**SAULT STE. MARIE**  
 LAND TITLES / REGISTRY DIVISION  
**ALGOMA**

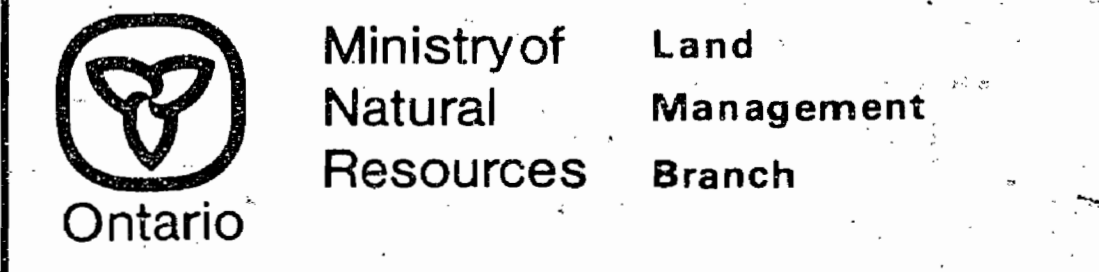

Date MARCH 9, 1983  
 Number **G-2378**

S. C. MARIE  
 MINING DIV.  
**RECEIVED**  
 DEC 19 1985  
 AM 7:50 10, 11, 12, 1, 2, 3, 4, 5, 6 PM

*Replaced by new copy of map Jan. 16/85*

**HURLBURT TWP.**

**REFERENCES**

**AREAS WITHDRAWN FROM DISPOSITION**

- M.R.O. — MINING RIGHTS ONLY
- S.R.O. — SURFACE RIGHTS ONLY
- M.+S. — MINING AND SURFACE RIGHTS

Description	Order No.	Date	Disposition	File
(R1)	W. 5/82	17/2/82	S.R.O.	

**MENARD TWP.**

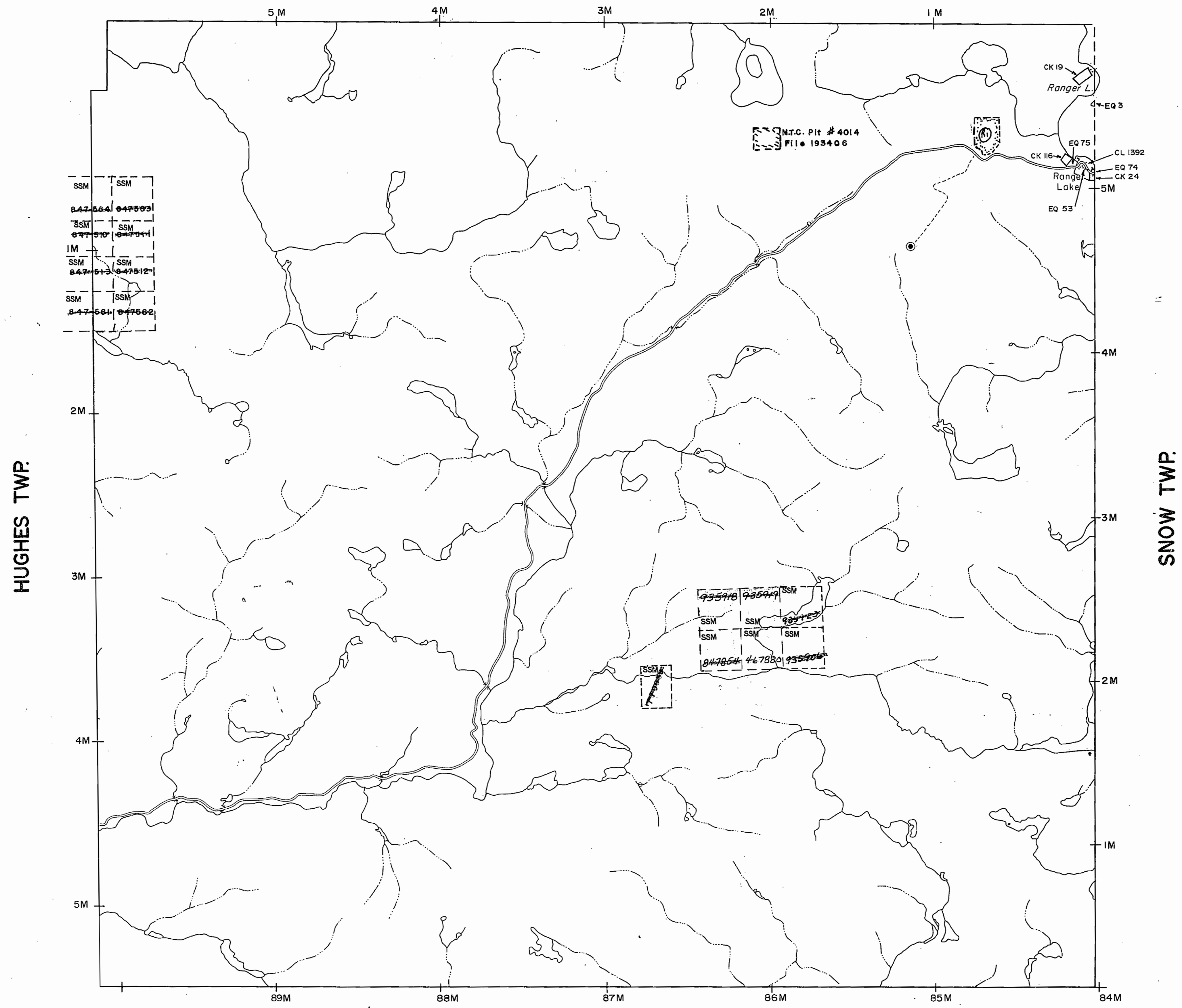

HUGHES TWP.

SNOW TWP.

**HURLBURT TWP.**

**LEGEND**

- HIGHWAY AND ROUTE No.
- OTHER ROADS
- TRAILS
- SURVEYED LINES:
  - TOWNSHIPS, BASE LINES, ETC.
  - LOTS, MINING CLAIMS, PARCELS, ETC.
- UNSURVEYED LINES:
  - LOT LINES
  - PARCEL BOUNDARY
  - MINING CLAIMS ETC.
- RAILWAY AND RIGHT OF WAY
- UTILITY LINES
- NON-PERENNIAL STREAM
- FLOODING OR FLOODING RIGHTS
- SUBDIVISION OR COMPOSITE PLAN
- RESERVATIONS
- ORIGINAL SHORELINE
- MARSH OR MUSKEG
- MINES
- TRAVERSE MONUMENT

**DISPOSITION OF CROWN LANDS**

TYPE OF DOCUMENT	SYMBOL
PATENT, SURFACE & MINING RIGHTS	
" SURFACE RIGHTS ONLY	
" MINING RIGHTS ONLY	
LEASE, SURFACE & MINING RIGHTS	
" SURFACE RIGHTS ONLY	
" MINING RIGHTS ONLY	
LICENCE OF OCCUPATION	
ORDER-IN-COUNCIL	
RESERVATION	
CANCELLED	
SAND & GRAVEL	

**NOTE:** MINING RIGHTS IN PARCELS PATENTED PRIOR TO MAY 6, 1913, VESTED IN ORIGINAL PATENTEE BY THE PUBLIC LANDS ACT, R.S.O. 1970, CHAP. 380, SEC. 63, SUBSEC. 1.

**SCALE: 1 INCH = 40 CHAINS**

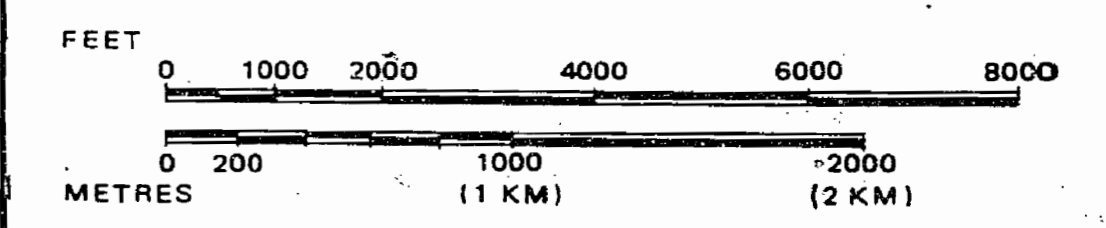

TOWNSHIP  
**JOLLINEAU**

M.N.R. ADMINISTRATIVE DISTRICT  
**SAULT STE. MARIE**

MINING DIVISION  
**SAULT STE. MARIE**

LAND TITLES / REGISTRY DIVISION  
**ALGOMA**

Ministry of Natural Resources  
Land Management Branch

Date MARCH 9, 1983  
Number **G-2378**

S. S. MARIE  
MINING DIV.  
**RECEIVED**  
JAN 16 1983  
7:09 AM 10/11/12/13/14/15/16

*Replaced by G-2378 - Oct. 25/89 CK.*

### INDEX TO LAND DISPOSITION

PLAN  
**G-2378**  
 TOWNSHIP

M.N.R. ADMINISTRATIVE DISTRICT  
**SAULT STE. MARIE**  
 MINING DIVISION  
**SAULT STE. MARIE**  
 LAND TITLES/REGISTRY DIVISION  
**ALGOMA**

## JOLLINEAU

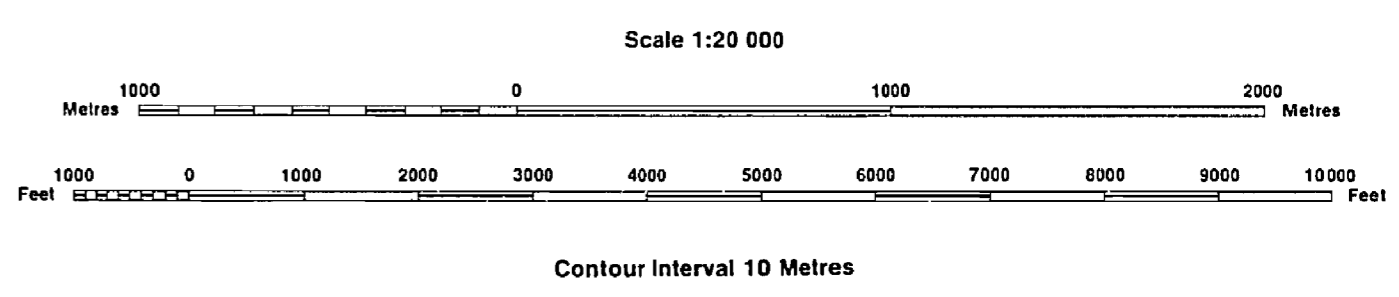

#### AREAS WITHDRAWN FROM DISPOSITION

Description	Order No.	Date	Disposition	File
MRO - Mining Rights Only				
SRO - Surface Rights Only				
M+S - Mining and Surface Rights				

#### SYMBOLS

Boundary	.....
Township, Meridian, Baseline	.....
Road allowance; surveyed	.....
shoreline	.....
Lot/Concession; surveyed	.....
unsurveyed	.....
Parcel; surveyed	.....
unsurveyed	.....
Right-of-way; road	.....
railway	.....
utility	.....
Reservation	.....
Cliff, Pit, Pile	.....
Contour	.....
Interpolated	.....
Approximate	.....
Depression	.....
Control point (horizontal)	.....
Flooded land	.....
Mine head frame	.....
Pipeline (above ground)	.....
Railway; single track	.....
double track	.....
abandoned	.....
Road; highway, county, township	.....
access	.....
trail, bush	.....
Shoreline (original)	.....
Transmission line	.....
Wooded area	.....

#### DISPOSITION OF CROWN LANDS

Patent	.....
Surface & Mining Rights	.....
Surface Rights Only	.....
Mining Rights Only	.....
Lease	.....
Surface & Mining Rights	.....
Surface Rights Only	.....
Mining Rights Only	.....
Licence of Occupation	.....
Order-in-Council	.....
Cancelled	.....
Reservation	.....
Sand & Gravel	.....

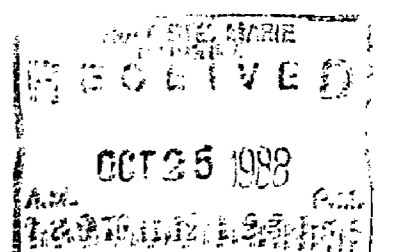

*Approved by survey plan Aug 1989*

Map base and land disposition drafting by Surveys and Mapping Branch, Ministry of Natural Resources. The disposition of land, location of lot fabric and parcel boundaries on this index was compiled for administrative purposes only.







**INDEX TO LAND DISPOSITION**

PLAN  
G-2378  
TOWNSHIP

M.N.R. ADMINISTRATIVE DISTRICT  
SAULT STE. MARIE  
MINING DIVISION  
SAULT STE. MARIE  
LAND TITLES/REGISTRY DIVISION  
ALGOMA

**JOLLINEAU**

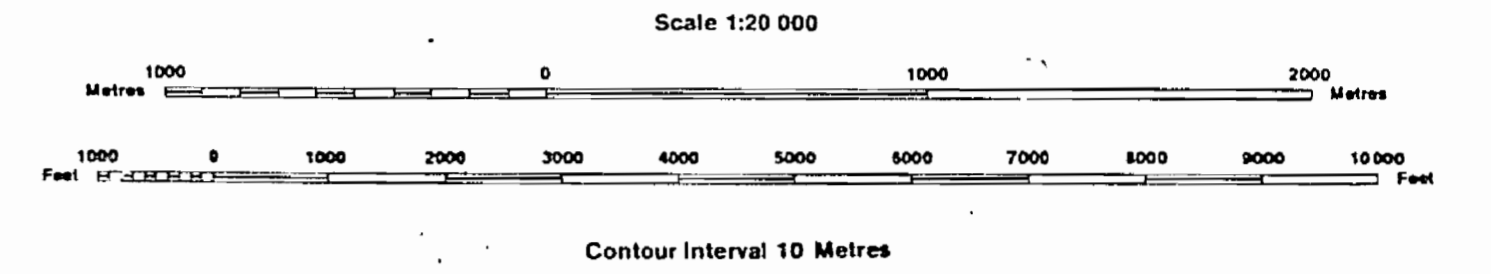

**AREAS WITHDRAWN FROM DISPOSITION**

MRO - Mining Rights Only  
SRO - Surface Rights Only  
M+S - Mining and Surface Rights

Description	Order No.	Date	Disposition	File
(Symbol)	W.5/82	17/2/82	S.R.O.	

**SYMBOLS**

Boundary	
Township, Meridian, Baseline	— — — — —
Road allowance; surveyed	— — — — —
shoreline	~ ~ ~ ~ ~
Lot/Concession; surveyed	— — — — —
unsurveyed	— — — — —
Parcel; surveyed	— — — — —
unsurveyed	— — — — —
Right-of-way; road	— — — — —
railway	— — — — —
utility	— — — — —
Reservation	— — — — —
Cliff, Pit, Pile	— — — — —
Contour	— — — — —
Interpolated	— — — — —
Approximate	— — — — —
Depression	— — — — —
Control point (horizontal)	— — — — —
Flooded land	— — — — —
Mine head frame	— — — — —
Pipeline (above ground)	— — — — —
Railway; single track	— — — — —
double track	— — — — —
abandoned	— — — — —
Road; highway, county, township	— — — — —
access	— — — — —
trail, bush	— — — — —
Shoreline (original)	— — — — —
Transmission line	— — — — —
Wooded area	— — — — —

The 1980 Magnetic Bearing  
Approx. 22' Annual Change  
Increasing 2%

**DISPOSITION OF CROWN LANDS**

Patent	●
Surface & Mining Rights	●
Surface Rights Only	○
Mining Rights Only	○
Lease	■
Surface & Mining Rights	■
Surface Rights Only	■
Mining Rights Only	■
Licence of Occupation	▼
Order-in-Council	OC
Cancelled	⊙
Reservation	⊙
Sand & Gravel	⊙

**TOWNSHIP SUBJECT TO FORESTRY OPERATIONS**

1991-92

THE INFORMATION THAT APPEARS ON THIS MAP HAS BEEN COMPILED FROM VARIOUS SOURCES, AND ACCURACY IS NOT GUARANTEED. THOSE WISHING TO STAKE MINING CLAIMS SHOULD CONSULT WITH THE MINING RECORDER, MINISTRY OF NORTHERN DEVELOPMENT AND MINES, FOR ADDITIONAL INFORMATION ON THE STATUS OF THE LANDS SHOWN HEREON.

RECEIVED  
AUG - 4 1992



JOLLINEAU 1MP

G-2378

1392

# TOWNSHIP 3.H.

MISSISSAGI PROVINCIAL FOREST  
DISTRICT OF ALGOMA

(JOLLINEAU)

## OFFICE MAP

Scale 40 Chains = 1 Inch

M. 1392

TOWNSHIP 4 H.

TOWNSHIP 22  
RANGE 10.

TOWNSHIP 3.G.

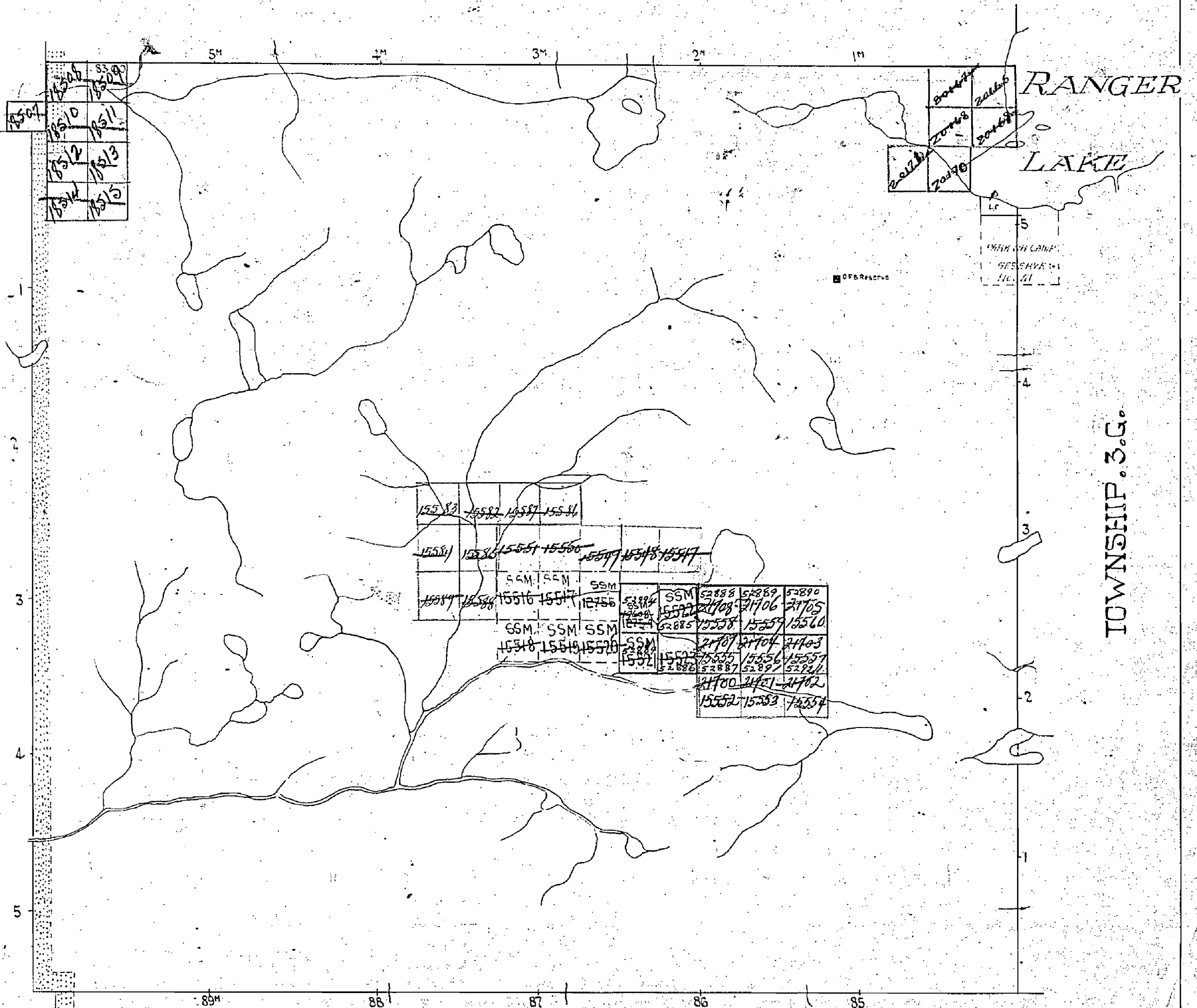

LAKES AND RIVERS FROM PUBLISHED MAP No 329, 1932  
WEST BOUNDARY OF MISSISSAGI PROVINCIAL FOREST RESERVE

TOWNSHIP 202.

1392

# TOWNSHIP 3.H.

MISSISSAGI PROVINCIAL FOREST (JOLINEAU)  
DISTRICT OF ALGOMA

M. 1392

Scale 40 Chains = 1 Inch

TOWNSHIP 4.H.

TOWNSHIP 22  
RANGE 10.

TOWNSHIP 3.G.



LAKE AND RIVERS FROM PUBLISHED MAP NO 32A 1932  
WEST BOUNDARY OF MISSISSAGI PROVINCIAL FOREST RESERVE

TOWNSHIP 202.

400' SURFACE RIGHTS RESERVATION AROUND ALL LAKES & RIVERS.

1392

# TOWNSHIP 3.H.

MISSISSAGI PROVINCIAL FOREST  
DISTRICT OF ALGOMA

(JOLINEAU)

M. 1392

Scale 40 Chains = 1 Inch

TOWNSHIP 4.H.

TOWNSHIP 22  
RANGE 10.

TOWNSHIP 3.G.

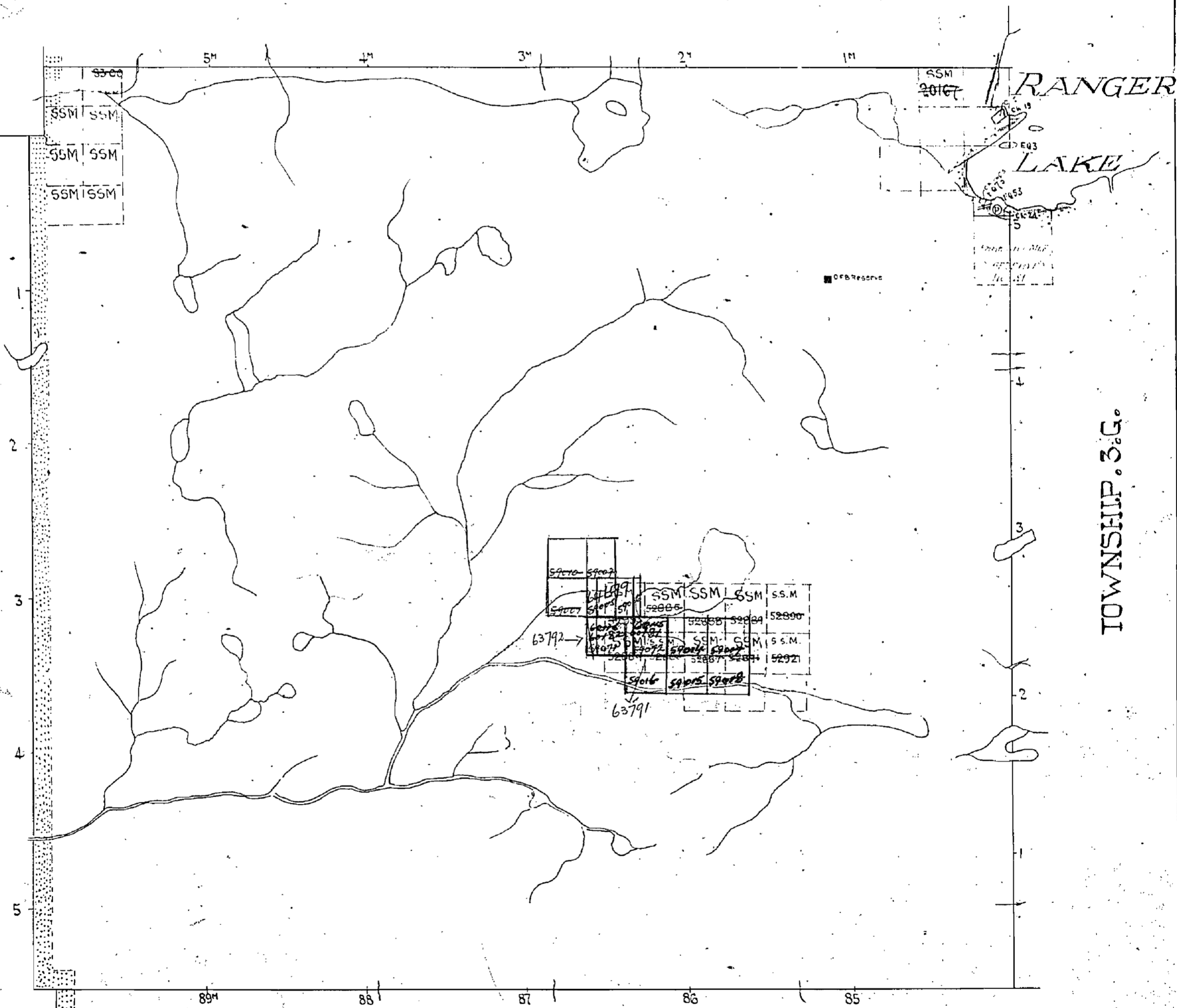

LAKES AND RIVERS FROM PUBLISHED MAP NO. 32, 1932  
WEST BOUNDARY OF MISSISSAGI PROVINCIAL FOREST RESERVE

TOWNSHIP 202.

Surface reservations 400 acres by Dept of L. & F.  
shown hereon thus ~~XXXXXX~~

# TOWNSHIP 3.H.

MISSISSAGI PROVINCIAL FOREST (JOLLIFEAK)  
DISTRICT OF ALGOMA

M. 1392

Scale 40 Chains = 1 Inch

TOWNSHIP 4.H.

TOWNSHIP 22  
RANGE 10.

TOWNSHIP 3.G.

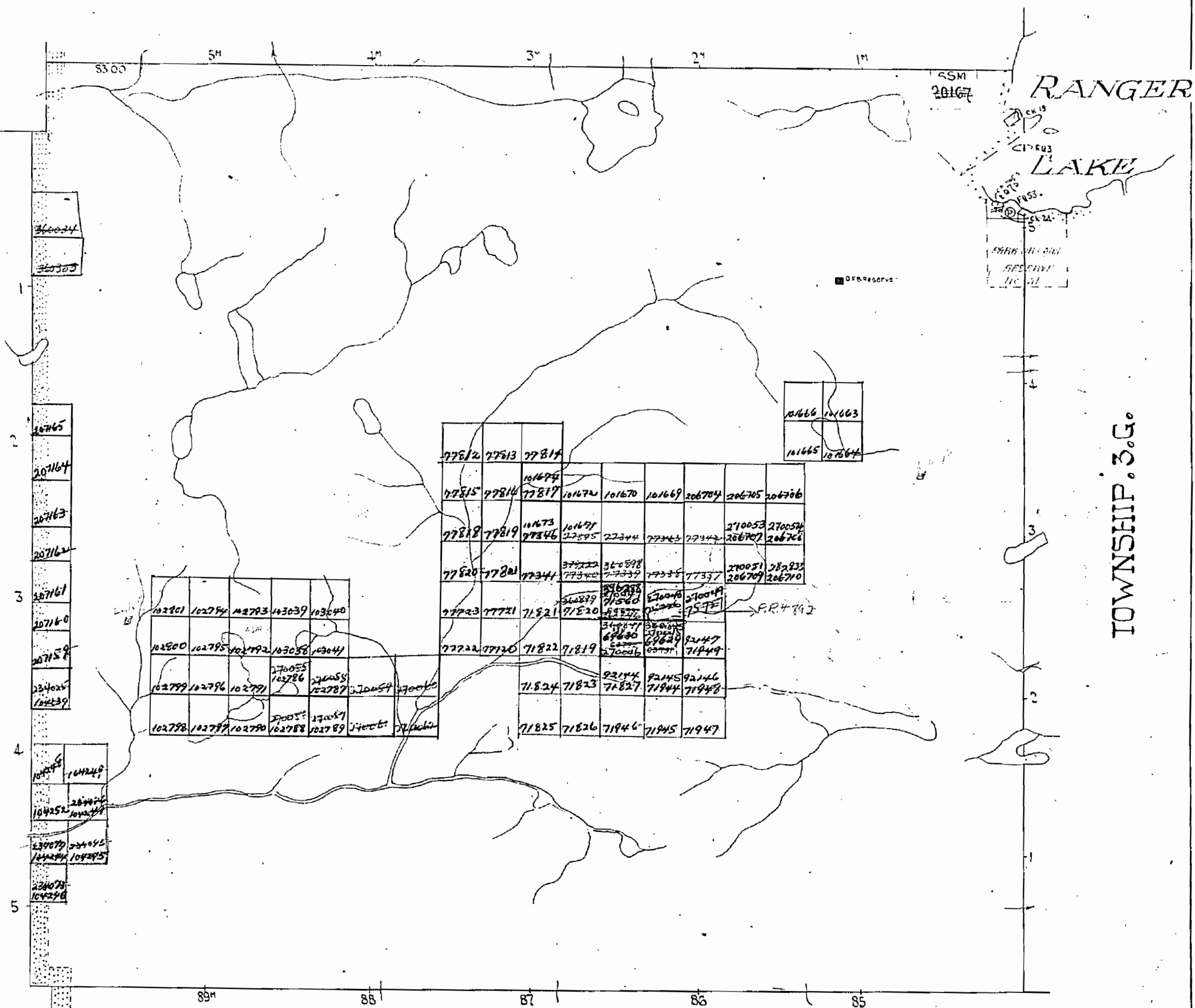

LAKES AND RIVERS FROM PUBLISHED MAP NO 32A 1932  
WEST BOUNDARY OF MISSISSAGI PROVINCIAL FOREST RESERVE

TOWNSHIP 202.

400 SURFACE RIGHTS RESERVATION AROUND ALL LAKES & RIVERS.

1392

# TOWNSHIP 3.H.

MISSISSAGI PROVINCIAL FOREST  
DISTRICT OF ALGOMA

(JOLLIFEAU)

## OFFICE MAP

Scale 40 Chains = 1 Inch

M. 1392

TOWNSHIP 4.H.

TOWNSHIP 22  
RANGE 10.

TOWNSHIP 3.G.

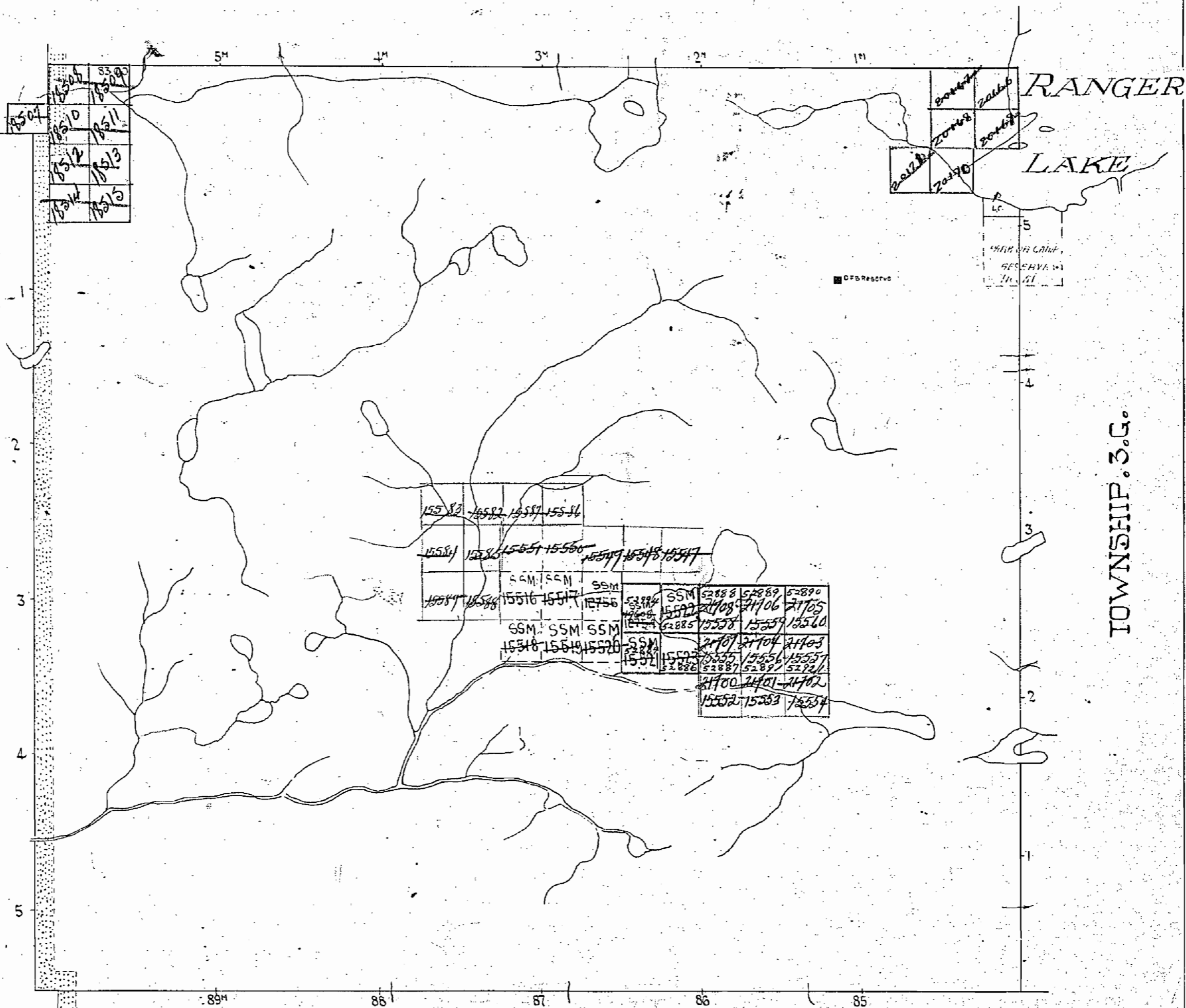

2 → LAKES AND RIVERS FROM PUBLISHED MAP NO 329 1932  
WEST BOUNDARY OF MISSISSAGI PROVINCIAL FOREST RESERVE

TOWNSHIP 202.

1392

# TOWNSHIP 3H.

MISSISSAGI PROVINCIAL FOREST  
DISTRICT OF ALGOMA

(JOLINEAU)

M. 1392

Scale 40 Chains = 1 Inch

TOWNSHIP 4H.

TOWNSHIP 22  
RANGE 10.

TOWNSHIP 30G.

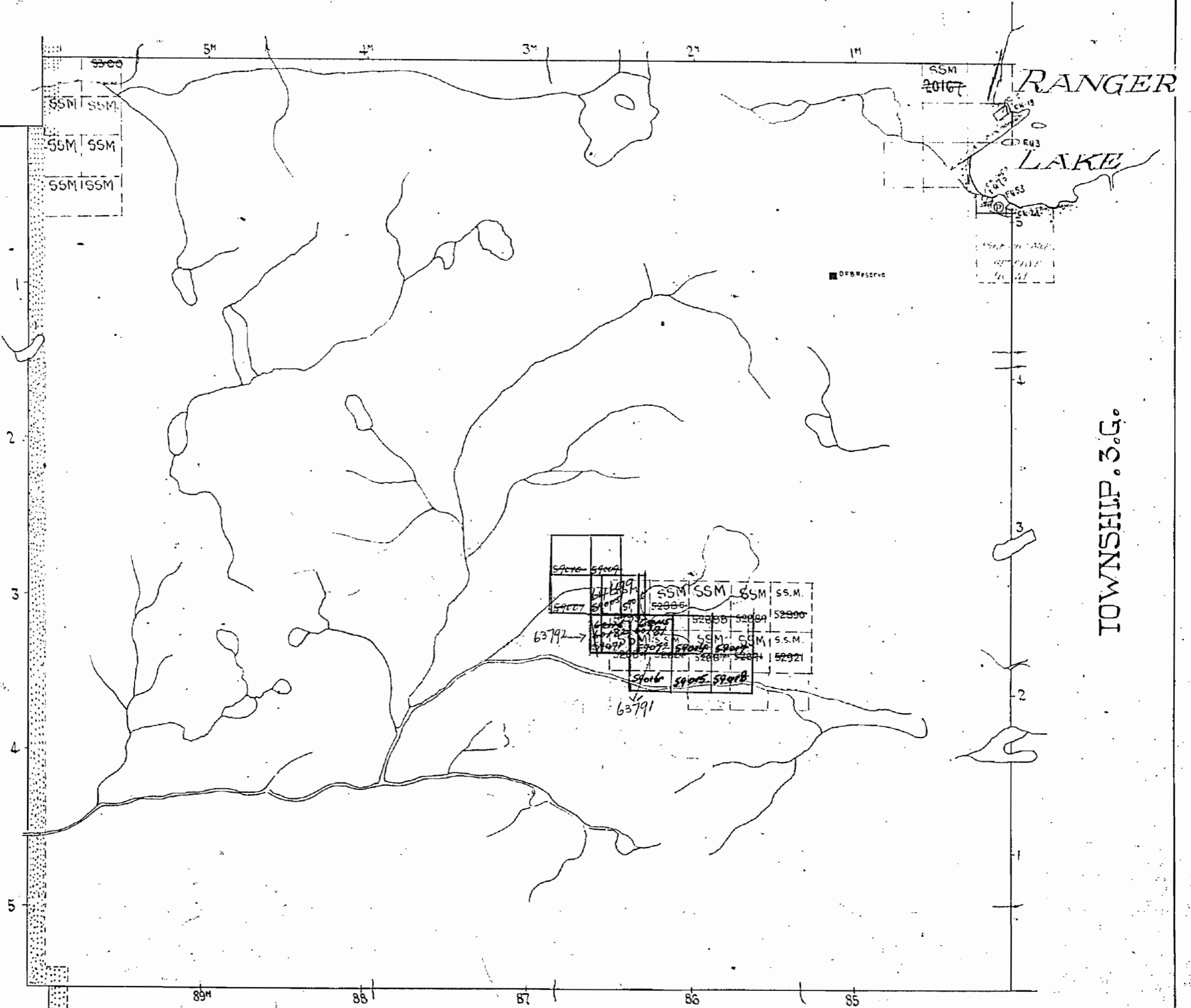

LAKES AND RIVERS FROM PUBLISHED MAP NO 32A 1932  
WEST BOUNDARY OF MISSISSAGI PROVINCIAL FOREST RESERVE

TOWNSHIP 202.

Surface reservations 400 wide by Dept of L & F  
shown hereon thus ~~-----~~