

AREA OF  
**KARL LAKE**  
 DISTRICT OF  
 KENORA  
 (PATRICIA PORTION)  
 PATRICIA  
 MINING DIVISION  
 SCALE: 1-INCH = 40 CHAINS

**LEGEND**

PATENTED LAND	(P)
CROWN LAND SALE	C.S.
LEASES	(L)
LOCATED LAND	Loc.
LICENSE OF OCCUPATION	L.O.
MINING RIGHTS ONLY	M.R.O.
SURFACE RIGHTS ONLY	S.R.O.
ROADS	—
IMPROVED ROADS	—
KING'S HIGHWAYS	—
RAILWAYS	—
POWER LINES	—
MARSH OR MUSKEG	—
MINES	⊗
CANCELLED	C.

**NOTES**  
 400' Reserve around all Lakes & Rivers to Dept. of Lands & Forests:

DO NOT USE TO SUPPLY DATA  
 R1  
 W42/83, Aug 23/83 withdraws surface + mining rights  
 File 7598 V.17. Candidate\*  
 \* Mineral Exploration allowed via  
 Exploratory License of Occupation  
 Feb. 13, 1984

#2

DATE OF ISSUE  
 MAR - 9 1981  
 SURVEYS AND MAPPING  
 BRANCH

6-2082  
 NATIONAL TOPOGRAPHIC SERIES 53 B  
 PLAN NO. M.2718

ONTARIO  
 MINISTRY OF NATURAL RESOURCES  
 SURVEYS AND MAPPING BRANCH

April 11, 1990 c  
 Jan 2/91  
 Feb 11/91  
 March 13/91  
 April 14/91  
 April 14/91  
 June 19/91  
 9/1/91 REC  
 MAY 31/94 REC  
 Feb 24/94 REC

AREA NOT MAPPED

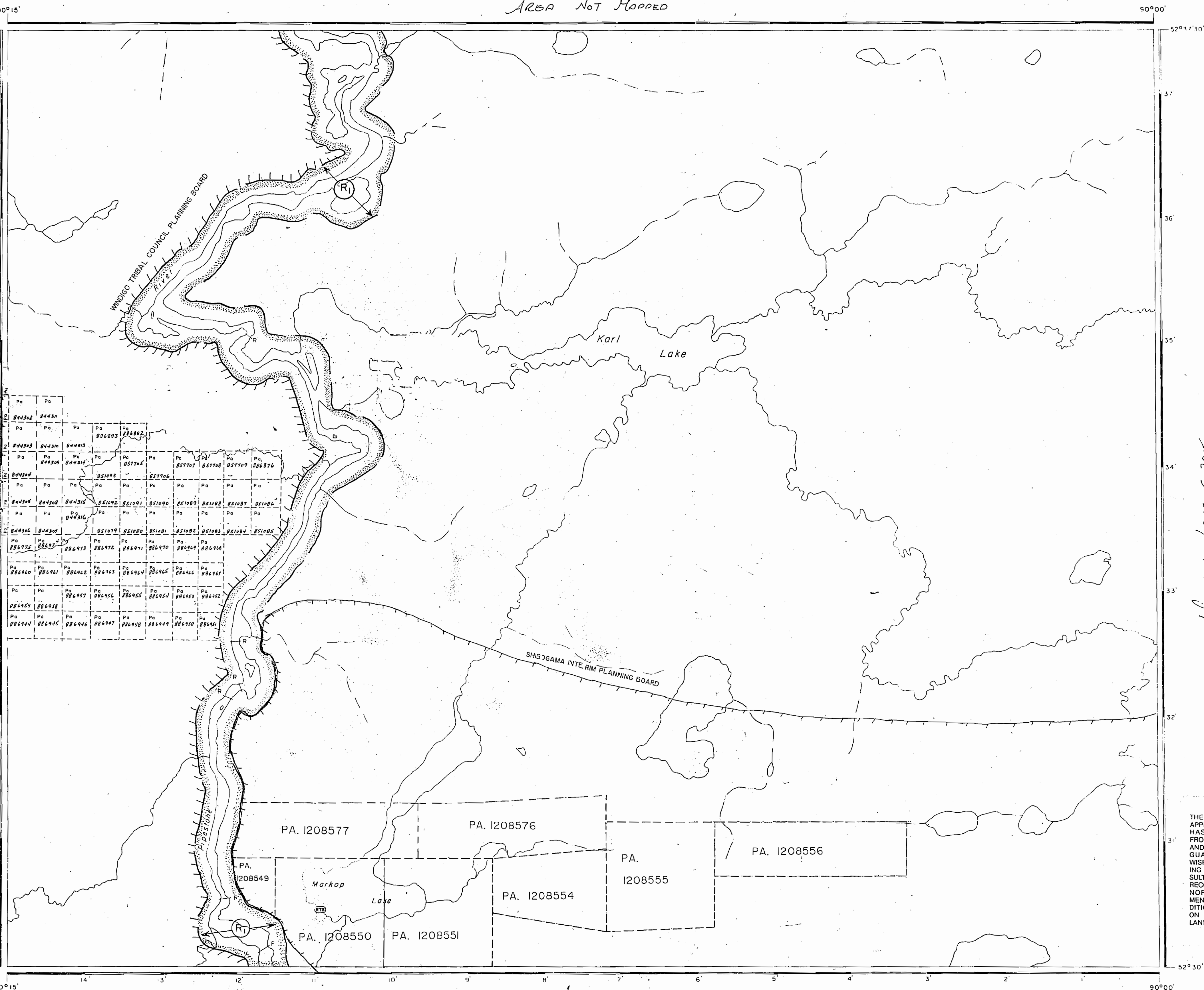

ZEMEL LAKE G-2278

LUSTEN LAKE G-2015

FORESTER LAKE G-2044

PATRICIA, MINISTRY  
 RECORDED  
 MAY 25 1984  
 S.S. 1012345678

**LEGEND**

- HIGHWAY AND ROUTE No
- OTHER ROADS
- TRAILS
- SURVEYED LINES
- TOWNSHIPS, BASE LINES, ETC
- LOTS, MINING CLAIMS, PARCELS, ETC
- UNSURVEYED LINES
- LOT LINES
- PARCEL BOUNDARY
- MINING CLAIMS ETC.
- RAILWAY AND RIGHT OF WAY
- UTILITY LINES
- NON-PERENNIAL STREAM
- FLOODING OR FLOODING RIGHTS
- SUBDIVISION OR COMPOSITE PLAN
- RESERVATIONS
- ORIGINAL SHORELINE
- MARSH OR MUSKEG
- MINES
- TRAVERSE MONUMENT
- REMOTE TOURIST SET-UP.

**DISPOSITION OF CROWN LANDS**

TYPE OF DOCUMENT	SYMBOL
PATENT, SURFACE & MINING RIGHTS	●
" SURFACE RIGHTS ONLY	○
" MINING RIGHTS ONLY	◐
LEASE, SURFACE & MINING RIGHTS	■
" SURFACE RIGHTS ONLY	□
" MINING RIGHTS ONLY	◑
LICENCE OF OCCUPATION	◒
ORDER-IN-COUNCIL	OC
RESERVATION	◎
CANCELLED	⊖
SAND & GRAVEL	⊙

NOTE: MINING RIGHTS IN PARCELS PATENTED PRIOR TO MAY 6, 1913, VESTED IN ORIGINAL PATENTEE BY THE PUBLIC LANDS ACT, R.S.O. 1910, CHAP. 380, SEC. 63, SUBSEC. 1.

**REFERENCES**

- AREAS WITHDRAWN FROM DISPOSITION
- M.R.O. - MINING RIGHTS ONLY
- S.R.O. - SURFACE RIGHTS ONLY
- M.+S. - MINING AND SURFACE RIGHTS

Description	Order No.	Date	Disposition	File
① PARK RESERVE	42/83	02/07/87	M.S.	188528

AREA IN WINDIGO TRIBAL COUNCIL PLANNING BOARD FOR DETAILS CALL 737-1585

AREA IN SHIBOGAMA INTERIM PLANNING BOARD CALL FOR DETAILS 737-2662

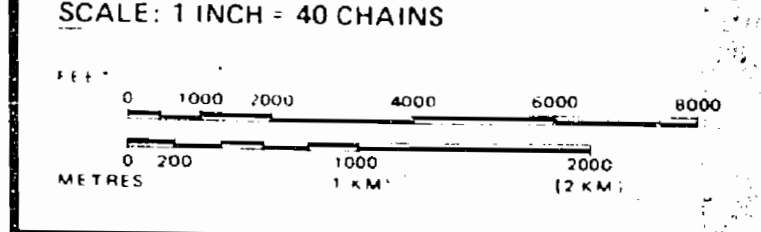

AREA  
**KARL LAKE**  
 M.N.R. ADMINISTRATIVE DISTRICT  
**SIoux LOOKOUT**  
 MINING DIVISION  
**PATRICIA**  
 LAND TITLES / REGISTRY DIVISION  
**KENORA (PATRICIA PORTION)**

THE INFORMATION THAT APPEARS ON THIS MAP HAS BEEN COMPILED FROM VARIOUS SOURCES, AND ACCURACY IS NOT GUARANTEED. THOSE WISHING TO STAKE MINING CLAIMS SHOULD CONSULT WITH THE MINING RECORDER, MINISTRY OF NORTHERN DEVELOPMENT AND MINES, FOR ADDITIONAL INFORMATION ON THE STATUS OF THE LANDS SHOWN HEREON.

Ministry of Natural Resources  
 Land Management Branch  
 Ontario

Date: FEBRUARY, 1984. Number: **G-2082**

Apr 11, 1990 c  
 Jan 2/91  
 Feb 11/91  
 March 13/91  
 April 19/91  
 June 5/91  
 June 13/91  
 June 21/91  
 June 27/91  
 June 30/91

AREA NOT HOODED

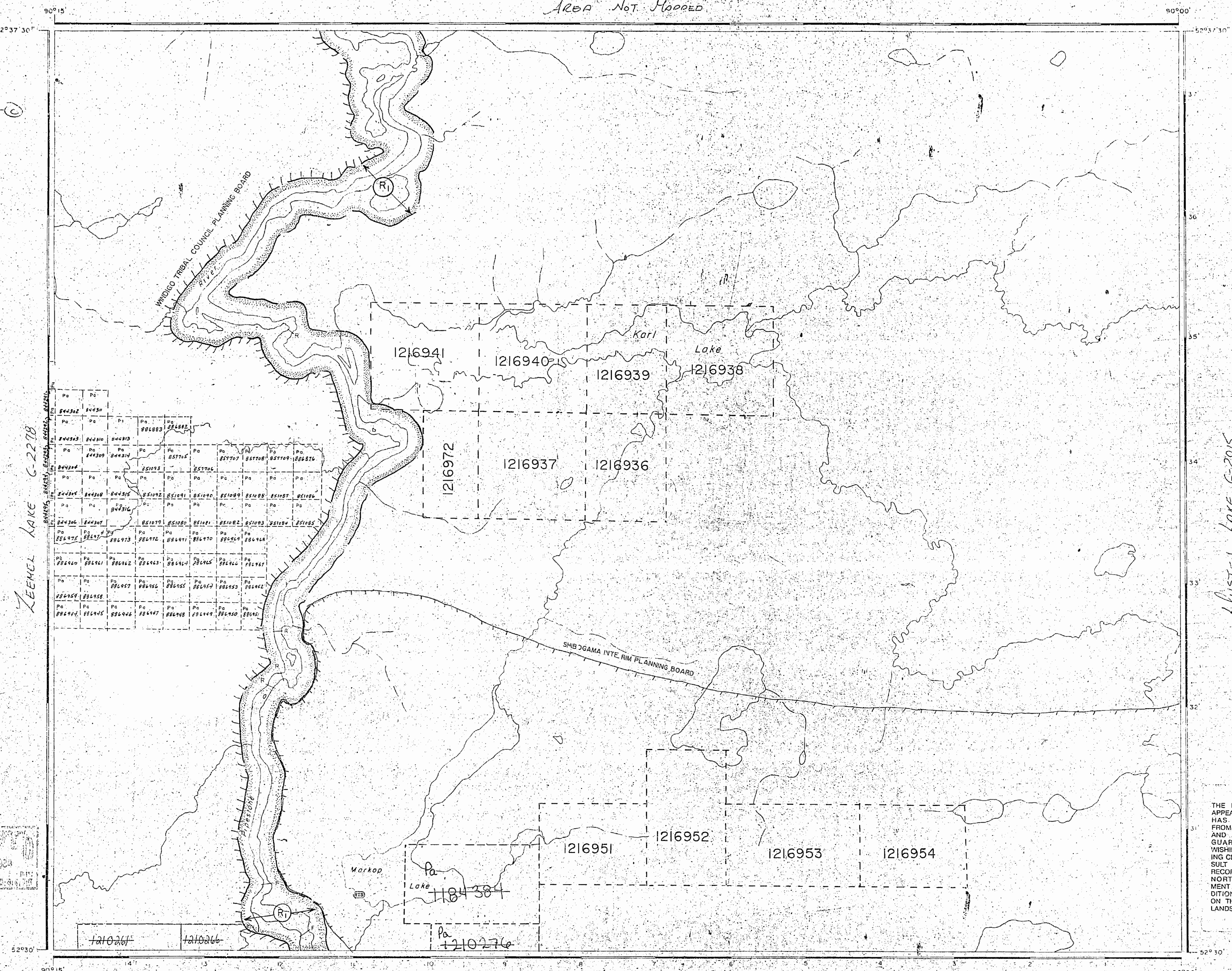

**LEGEND**

HIGHWAY AND ROUTE No	
OTHER ROADS	
TRAILS	
SURVEYED LINES	
TOWNSHIPS, BASE LINES, ETC.	
LOTS, MINING CLAIMS, PARCELS, ETC	
UNSURVEYED LINES	
LOT LINES	
PARCEL BOUNDARY	
MINING CLAIMS ETC	
RAILWAY AND RIGHT OF WAY	
UTILITY LINES	
NON PERENNIAL STREAM	
FLOODING OR FLOODING RIGHTS	
SUBDIVISION OR COMPOSITE PLAN	
RESERVATIONS	
ORIGINAL SHORELINE	
MARSH OR MUSKEG	
MINES	
TRAVERSE MONUMENT	
REMOTE TOURIST SET-UP	

**DISPOSITION OF CROWN LANDS**

TYPE OF DOCUMENT	SYMBOL
PATENT, SURFACE & MINING RIGHTS	
SURFACE RIGHTS ONLY	
MINING RIGHTS ONLY	
LEASE, SURFACE & MINING RIGHTS	
SURFACE RIGHTS ONLY	
MINING RIGHTS ONLY	
LICENCE OF OCCUPATION	
ORDER-IN-COUNCIL	
RESERVATION	
CANCELLED	
SAND & GRAVEL	

NOTE: MINING RIGHTS IN PARCELS PATENTED PRIOR TO MAY 1, 1912, VESTED IN ORIGINAL PATENTEE BY THE PLAIN LANDS ACT, R.S.O. 1970, CHAP. 380, S.C. 63, SUBSEC. 1

**REFERENCES**

AREAS WITHDRAWN FROM DISPOSITION

- M.R.O. - MINING RIGHTS ONLY
- S.R.O. - SURFACE RIGHTS ONLY
- M.+S. - MINING AND SURFACE RIGHTS

Description	Order No.	Date	Disposition	File
1 PARK RESERVE	4-22-78	4-22-78	M.R.	18253

AREA IN WINDIGO TRIBAL COUNCIL PLANNING BOARD  
 FOR DETAILS CALL 737-1555

AREA IN SHIGOGAMA INTERM PLANNING BOARD  
 CALL FOR DETAILS 737 2662

SCALE: 1 INCH = 40 CHAINS

DATE OF ISSUE

AREA SEP 18 1998  
 PROVINCIAL RECORDING OFFICE - SUDBURY  
**KARL LAKE**  
 M.N.R. ADMINISTRATIVE DISTRICT  
 SIOUX LOOKOUT  
 MINING DIVISION  
 PATRICIA  
 LAND TITLES / REGISTRY DIVISION  
 KENORA (PATRICIA PORTION)

THE INFORMATION THAT APPEARS ON THIS MAP HAS BEEN COMPILED FROM VARIOUS SOURCES, AND ACCURACY IS NOT GUARANTEED. THOSE WISHING TO STAKE MINING CLAIMS SHOULD CONSULT WITH THE MINING RECORDER, MINISTRY OF NORTHERN DEVELOPMENT AND MINES, FOR ADDITIONAL INFORMATION ON THE STATUS OF THE LANDS SHOWN HEREON.

Ministry of Natural Resources  
 Land Management Branch  
 Ontario

Date: FEBRUARY, 1984. Number: **G-2082**

ZEHEL LAKE G-2278

MUSTEN LAKE G-2015

FORESTER LAKE G-2044

PATRICIA  
 MAY 25 1984

April 11, 1990 C  
 Jan 2/91  
 Feb 11/91 C  
 March 13/91 C  
 April 19/91 C  
 April 24/91 C  
 June 5/91 C  
 04/11/91 REC  
 MAY 31/91 REC  
 Feb 24/91 C  
 Apr 14/91 C  
 24 May 1991 R  
 June 3/76 C

AREA NOT MAPPED

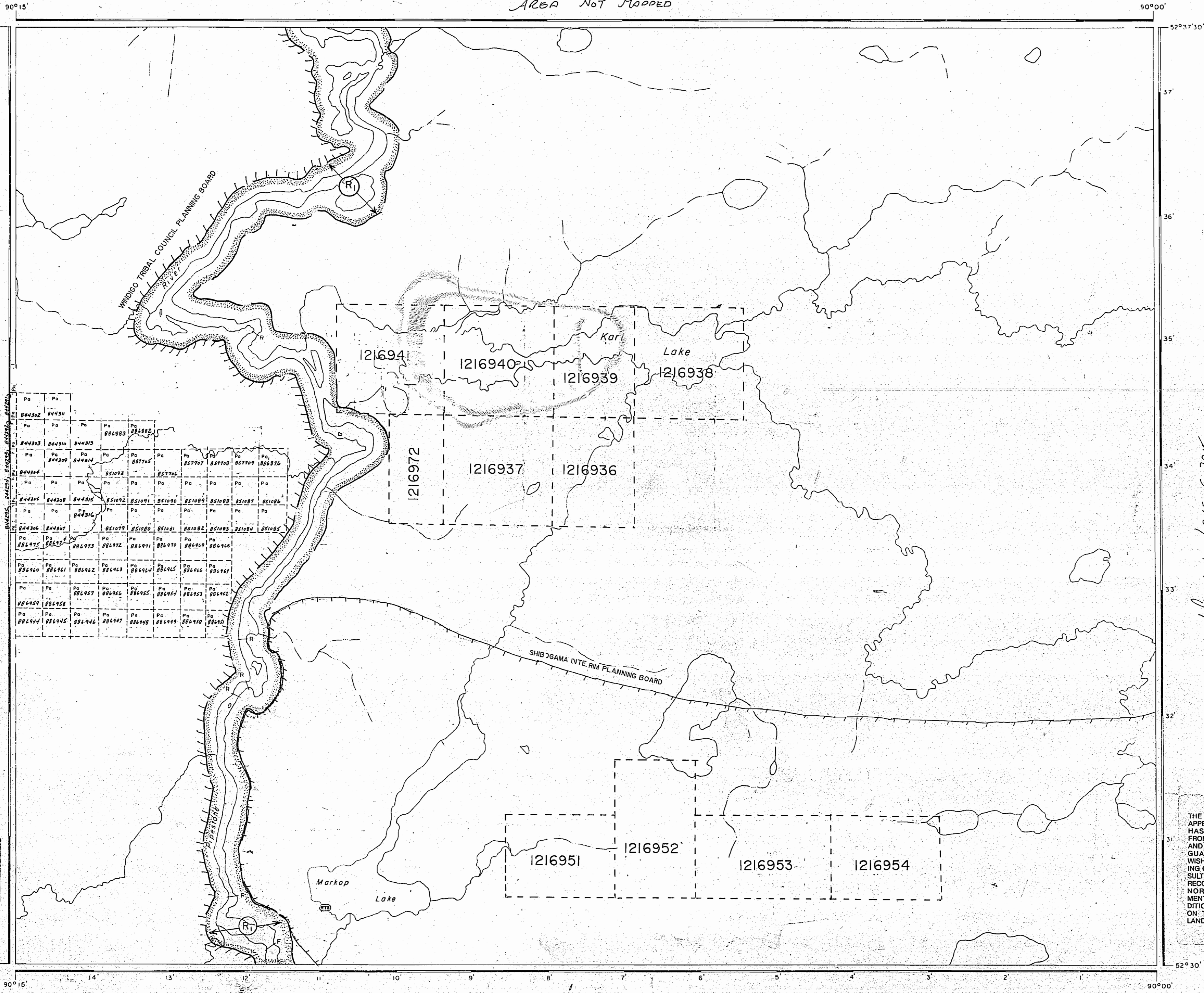

### LEGEND

HIGHWAY AND ROUTE No.	
OTHER ROADS	
TRAILS	
SURVEYED LINES:	
TOWNSHIPS, BASE LINES, ETC.	
LOTS, MINING CLAIMS, PARCELS, ETC.	
UNSURVEYED LINES:	
LOT LINES	
PARCEL BOUNDARY	
MINING CLAIMS ETC.	
RAILWAY AND RIGHT OF WAY	
UTILITY LINES	
NON-PERENNIAL STREAM	
FLOODING OR FLOODING RIGHTS	
SUBDIVISION OR COMPOSITE PLAN	
RESERVATIONS	
ORIGINAL SHORELINE	
MARSH OR MUSKEG	
MINES	
TRAVERSE MONUMENT	
REMOTE TOURIST SET-UP.	

### DISPOSITION OF CROWN LANDS

TYPE OF DOCUMENT	SYMBOL
PATENT, SURFACE & MINING RIGHTS	
" SURFACE RIGHTS ONLY	
" MINING RIGHTS ONLY	
LEASE, SURFACE & MINING RIGHTS	
" SURFACE RIGHTS ONLY	
" MINING RIGHTS ONLY	
LICENCE OF OCCUPATION	
ORDER-IN-COUNCIL	
RESERVATION	
CANCELLED	
SAND & GRAVEL	

NOTE: MINING RIGHTS IN PARCELS PATENTED PRIOR TO MAY 6, 1913, VESTED IN ORIGINAL PATENTEE BY THE PUBLIC LANDS ACT, R.S.O. 1970, CHAP. 380, SEC. 63, SUBSEC. 1.

### REFERENCES

**AREAS WITHDRAWN FROM DISPOSITION**

M.R.O. - MINING RIGHTS ONLY  
 S.R.O. - SURFACE RIGHTS ONLY  
 M.+S. - MINING AND SURFACE RIGHTS

Description	Order No.	Date	Disposition	File
① PARK RESERVE	0-0000	05-14-77	M.R.O.	18858

AREA IN WINDIGO TRIBAL COUNCIL PLANNING BOA  
 FOR DETAILS CALL 737-1585

AREA IN SHIBOGAMA INTERIM PLANNING BOARD  
 CALL FOR DETAILS 737-2662

SCALE: 1 INCH = 40 CHAINS

FEET: 0 1000 2000 4000 6000 8000  
 METRES: 0 1000 2000 4000 6000 8000

THE INFORMATION THAT APPEARS ON THIS MAP HAS BEEN COMPILED FROM VARIOUS SOURCES, AND ACCURACY IS NOT GUARANTEED. THOSE WISHING TO STAKE MINING CLAIMS SHOULD CONSULT WITH THE MINING RECORDER, MINISTRY OF NORTHERN DEVELOPMENT AND MINES, FOR ADDITIONAL INFORMATION ON THE STATUS OF THE LANDS SHOWN HEREON.

AREA  
**KARL LAKE**  
 M.N.R. ADMINISTRATIVE DISTRICT  
**SIoux LOOKOUT**  
 MINING DIVISION  
**PATRICIA**  
 LAND TITLES / REGISTRY DIVISION  
**KENORA (PATRICIA PORTION)**

Ministry of Natural Resources  
 Land Management Branch  
 Ontario

PATRICIA MINING DIV.  
**RECEIVED**  
 MAY 25 1984  
 A.M. 2:18 P.M. 1:13:41

FORESTER LAKE G-2044

Apr 11, 1940  
 Jan 2/91  
 Feb 11/91  
 March 13/91  
 April 19/91  
 April 19/91  
 June 5/91  
 91/10/92 REC  
 MAY 31/94 REC

AREA NOT MAPPED

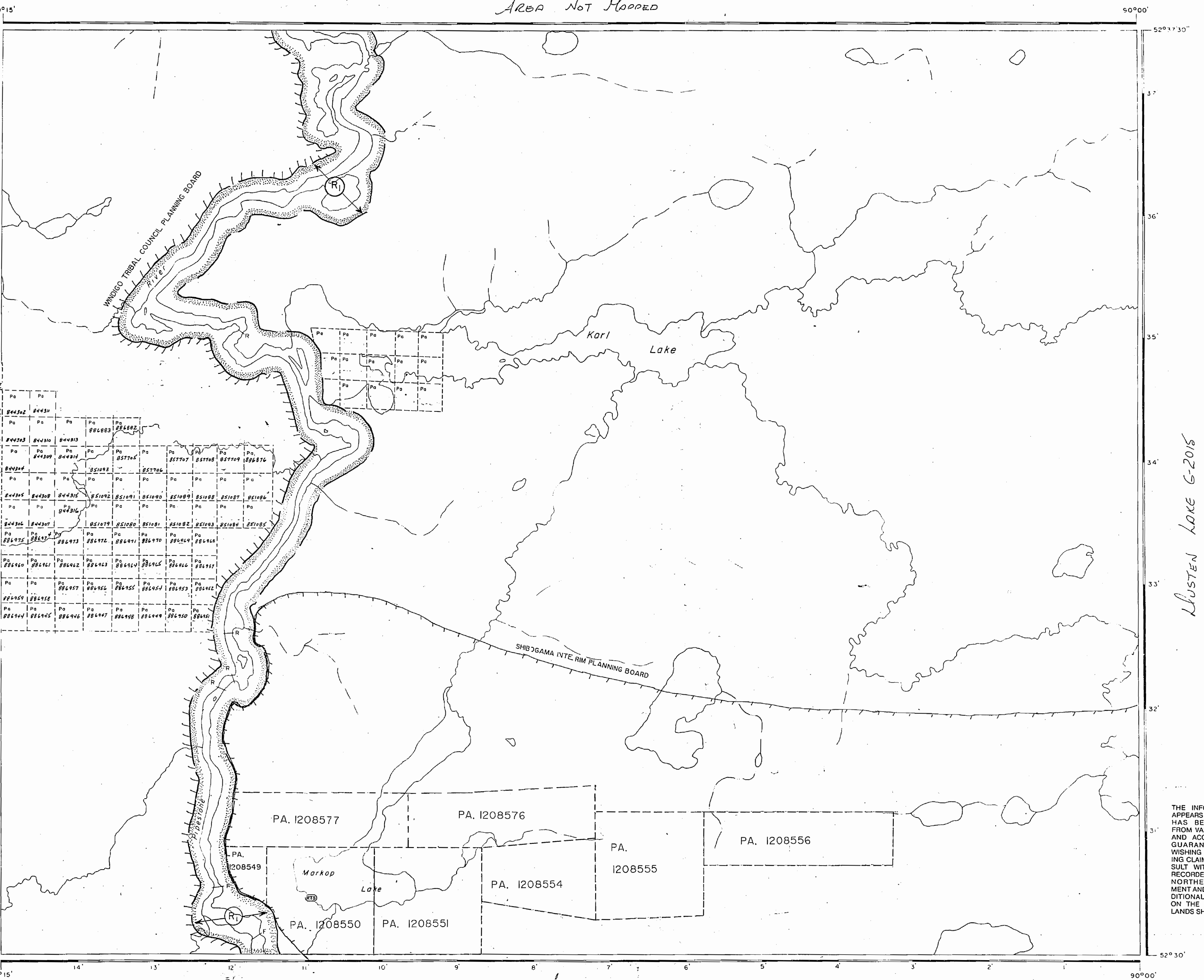

LEEMCL LAKE G-2278

LUSTEN LAKE G-2015

FORESTER LAKE G-2044

PATRICIA MINE  
 RECEIVED  
 MAY 25 1984  
 2:28 PM '84

**LEGEND**

HIGHWAY AND ROUTE No	
OTHER ROADS	
TRAILS	
SURVEYED LINES	
TOWNSHIPS, BASE LINES, ETC	
LOTS, MINING CLAIMS, PARCELS, ETC	
UNSURVEYED LINES	
LOT LINES	
PARCEL BOUNDARY	
MINING CLAIMS ETC	
RAILWAY AND RIGHT OF WAY	
UTILITY LINES	
NON-PERENNIAL STREAM	
FLOODING OR FLOODING RIGHTS	
SUBDIVISION OR COMPOSITE PLAN	
RESERVATIONS	
ORIGINAL SHORELINE	
MARSH OR MUSKEG	
MINES	
TRAVERSE MONUMENT	
REMOTE TOURIST SET-UP	

**DISPOSITION OF CROWN LANDS**

TYPE OF DOCUMENT	SYMBOL
PATENT, SURFACE & MINING RIGHTS	
" SURFACE RIGHTS ONLY	
" MINING RIGHTS ONLY	
LEASE, SURFACE & MINING RIGHTS	
" SURFACE RIGHTS ONLY	
" MINING RIGHTS ONLY	
LICENCE OF OCCUPATION	
ORDER-IN-COUNCIL	
RESERVATION	
CANCELLED	
SAND & GRAVEL	

NOTE: MINING RIGHTS IN PARCELS PATENTED PRIOR TO MAY 6, 1913, VESTED IN ORIGINAL PATENTEE BY THE PUBLIC LANDS ACT, R.S.O. 1970, CHAP. 380, SEC. 63, SUBSEC. 1.

**REFERENCES**

**AREAS WITHDRAWN FROM DISPOSITION**

Description	Order No.	Date	Disposition	File
① PARK RESERVE	100/83	10/20/83	MAS	182538

Feb 22/96 clear

AREA IN WINDIGO TRIBAL COUNCIL PLANNING BOARD FOR DETAILS CALL 737-1585

AREA IN SHIBOGAMA INTERIM PLANNING BOARD CALL FOR DETAILS 737-2662

SCALE: 1 INCH = 40 CHAINS

AREA

**KARL LAKE**

M.N.R. ADMINISTRATIVE DISTRICT  
 SIOUX LOOKOUT  
 MINING DIVISION  
 PATRICIA  
 LAND TITLES / REGISTRY DIVISION  
 KENORA (PATRICIA PORTION)

Ministry of Natural Resources Ontario  
 Land Management Branch

Date FEBRUARY, 1984. Number **G-2082**

THE INFORMATION THAT APPEARS ON THIS MAP HAS BEEN COMPILED FROM VARIOUS SOURCES, AND ACCURACY IS NOT GUARANTEED. THOSE WISHING TO STAKE MINING CLAIMS SHOULD CONSULT WITH THE MINING RECORDER, MINISTRY OF NORTHERN DEVELOPMENT AND MINES, FOR ADDITIONAL INFORMATION ON THE STATUS OF THE LANDS SHOWN HEREON.

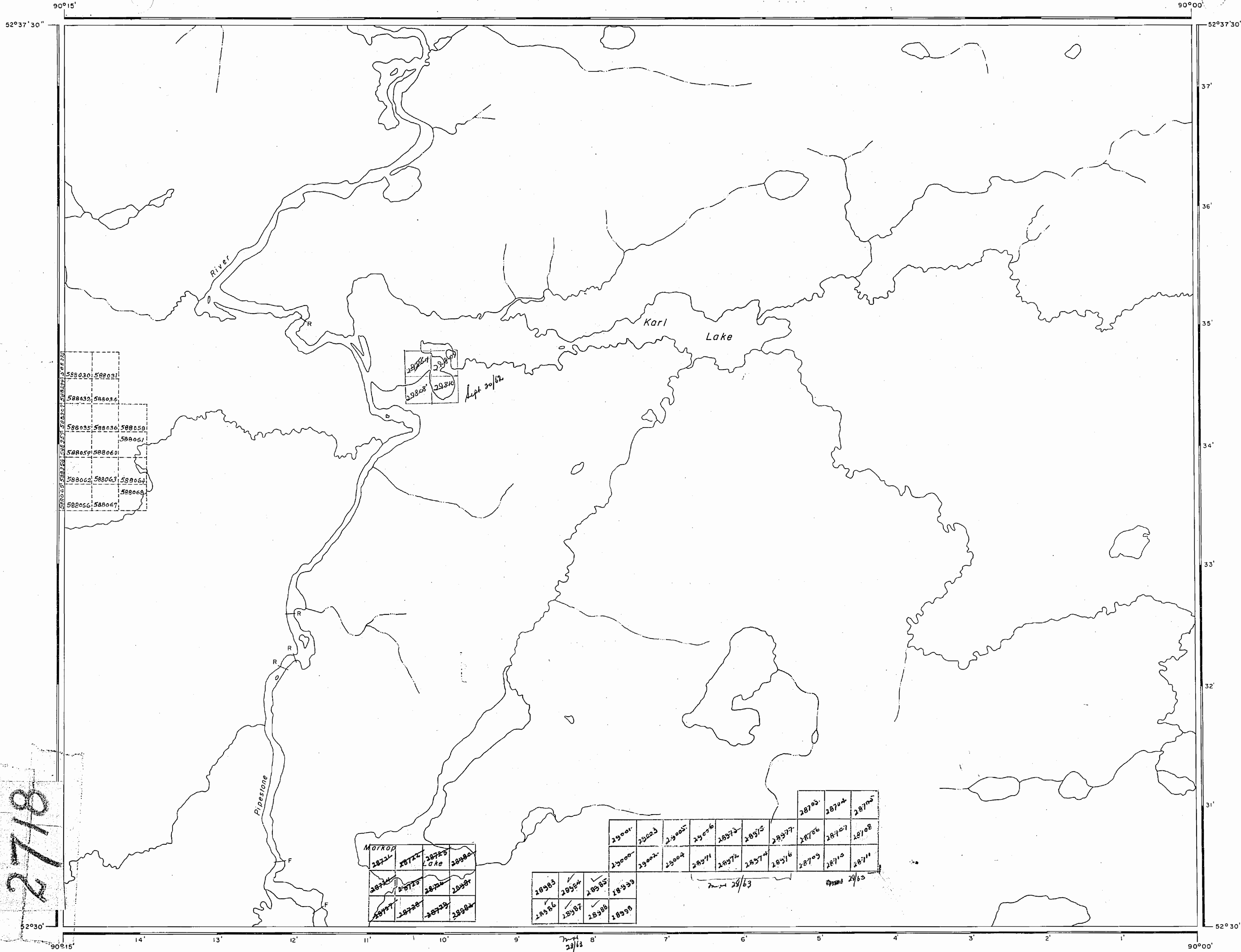

2718

AREA OF  
**KARL LAKE**  
 DISTRICT OF  
 KENORA  
 (PATRICIA PORTION)  
 PATRICIA  
 MINING DIVISION  
 SCALE: 1-INCH = 40 CHAINS

**LEGEND**

PATENTED LAND	Ⓟ
CROWN LAND SALE	C.S.
LEASES	Ⓞ
LOCATED LAND	Loc.
LICENSE OF OCCUPATION	L.O.
MINING RIGHTS ONLY	M.R.O.
SURFACE RIGHTS ONLY	S.R.O.
ROADS	— — — — —
IMPROVED ROADS	— — — — —
KING'S HIGHWAYS	— — — — —
RAILWAYS	— — — — —
POWER LINES	— — — — —
MARSH OR MUSKEG	— — — — —
MINES	X
CANCELLED	C.

**NOTES**  
 400' Reserve around all Lakes & Rivers to Dept. of Lands & Forests:

Mar. 11, 1981



6-2082

PLAN NO. M.2718

DEPARTMENT OF MINES  
 — ONTARIO —

Apr 21 11 1990 c  
 Jan 2/91  
 Feb 11/91  
 March 13/91  
 April 9/91  
 April 14/91  
 June 5/91 c  
 MAY 31 1994 REC  
 Feb 24/94 REC  
 Apr 14/94 c

Area Not Mapped

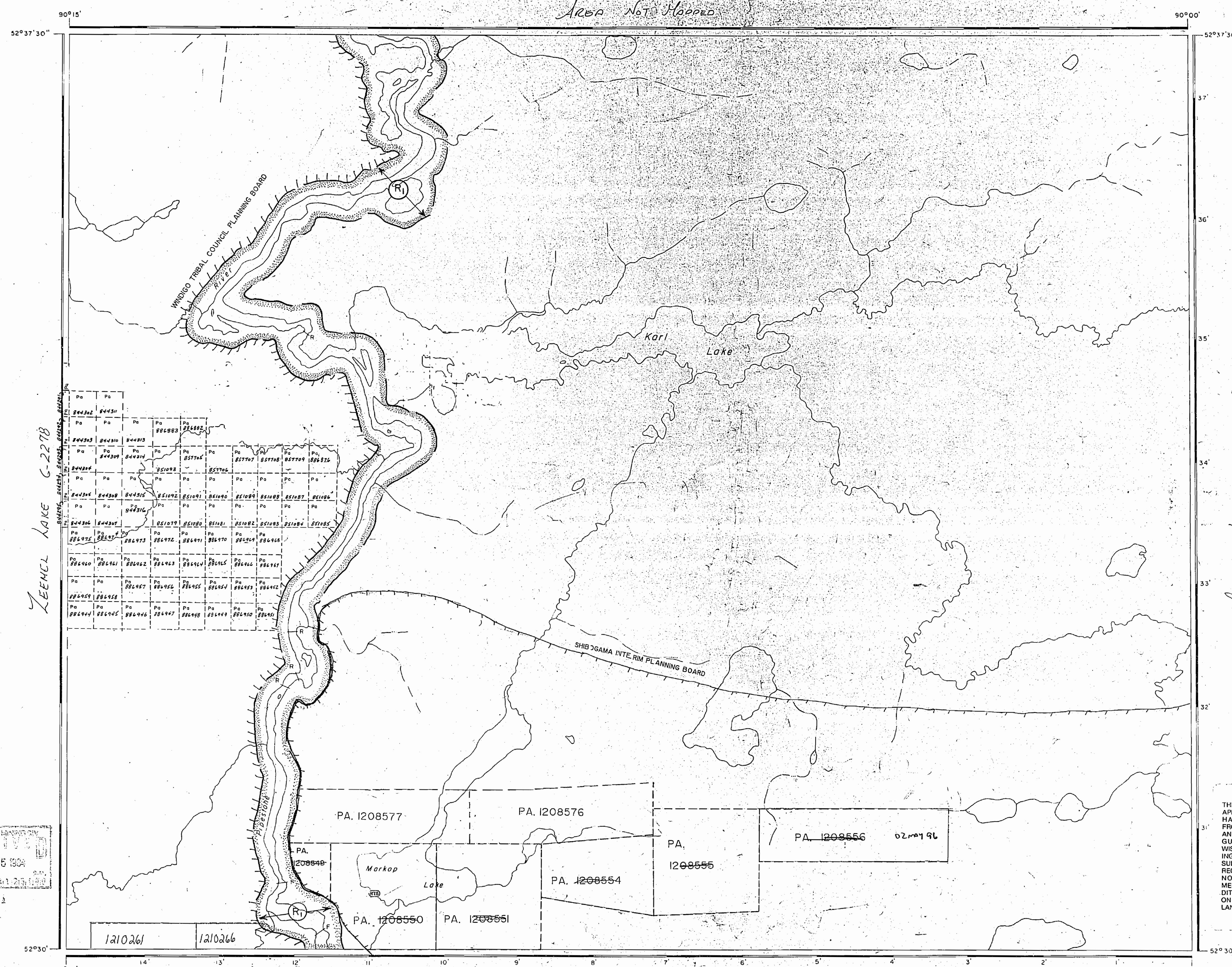

LEECH LAKE G-2278

MUSTEN LAKE G-205

FORESTER LAKE G-2044

**LEGEND**

HIGHWAY AND ROUTE No	
OTHER ROADS	
TRAILS	
SURVEYED LINES	
TOWNSHIPS, BASE LINES, ETC.	
LOTS, MINING CLAIMS, PARCELS, ETC	
UNSURVEYED LINES	
LOT LINES	
PARCEL BOUNDARY	
MINING CLAIMS ETC.	
RAILWAY AND RIGHT OF WAY	
UTILITY LINES	
NON-PERENNIAL STREAM	
FLOODING OR FLOODING RIGHTS	
SUBDIVISION OR COMPOSITE PLAN	
RESERVATIONS	
ORIGINAL SHORELINE	
MARSH OR MUSKEG	
MINES	
TRAVERSE MONUMENT	
REMOTE TOURIST SET-UP	

**DISPOSITION OF CROWN LANDS**

TYPE OF DOCUMENT	SYMBOL
PATENT, SURFACE & MINING RIGHTS	
" SURFACE RIGHTS ONLY	
" MINING RIGHTS ONLY	
LEASE, SURFACE & MINING RIGHTS	
" SURFACE RIGHTS ONLY	
" MINING RIGHTS ONLY	
LICENCE OF OCCUPATION	
ORDER-IN-COUNCIL	
RESERVATION	
CANCELLED	
SAND & GRAVEL	

NOTE: MINING RIGHTS IN PARCELS PATENTED PRIOR TO MAY 6 1913, VESTED IN ORIGINAL PATENTEE BY THE PUBLIC LANDS ACT, R.S.O. 1970, CHAP. 380, SEC. 63, SUBSEC. 1.

**REFERENCES**

**AREAS WITHDRAWN FROM DISPOSITION**

M.R.O. - MINING RIGHTS ONLY  
 S.R.O. - SURFACE RIGHTS ONLY  
 M.+S. - MINING AND SURFACE RIGHTS

Description	Order No.	Date	Disposition	File
PARK RESERVE	42/83	02-03/83	M.R.S.	188538

AREA IN WINDIGO TRIBAL COUNCIL PLANNING BOARD  
 FOR DETAILS CALL 737-1565

AREA IN SHIBOGAMA INTERIM PLANNING BOARD  
 CALL FOR DETAILS 737 2662

SCALE: 1 INCH = 40 CHAINS

AREA  
**KARL LAKE**  
 M.N.R. ADMINISTRATIVE DISTRICT  
 SIOUX LOOKOUT  
 MINING DIVISION  
 PATRICIA  
 LAND TITLES / REGISTRY DIVISION  
 KENORA (PATRICIA PORTION)

THE INFORMATION THAT APPEARS ON THIS MAP HAS BEEN COMPILED FROM VARIOUS SOURCES, AND ACCURACY IS NOT GUARANTEED. THOSE WISHING TO STAKE MINING CLAIMS SHOULD CONSULT WITH THE MINING RECORDER, MINISTRY OF NORTHERN DEVELOPMENT AND MINES, FOR ADDITIONAL INFORMATION ON THE STATUS OF THE LANDS SHOWN HEREON.

Ministry of Natural Resources  
 Land Management Branch  
 Ontario

Date FEBRUARY, 1984. Number **G-2082**

PATRICIA MINISTRY OF NATURAL RESOURCES  
 REGISTRY DIVISION  
 MAY 25 1984

April 11, 1990  
 Jan 2/91  
 Feb 11/91  
 March 13/91  
 April 3/91  
 April 11/91  
 June 3/91

AREA NOT MAPPED

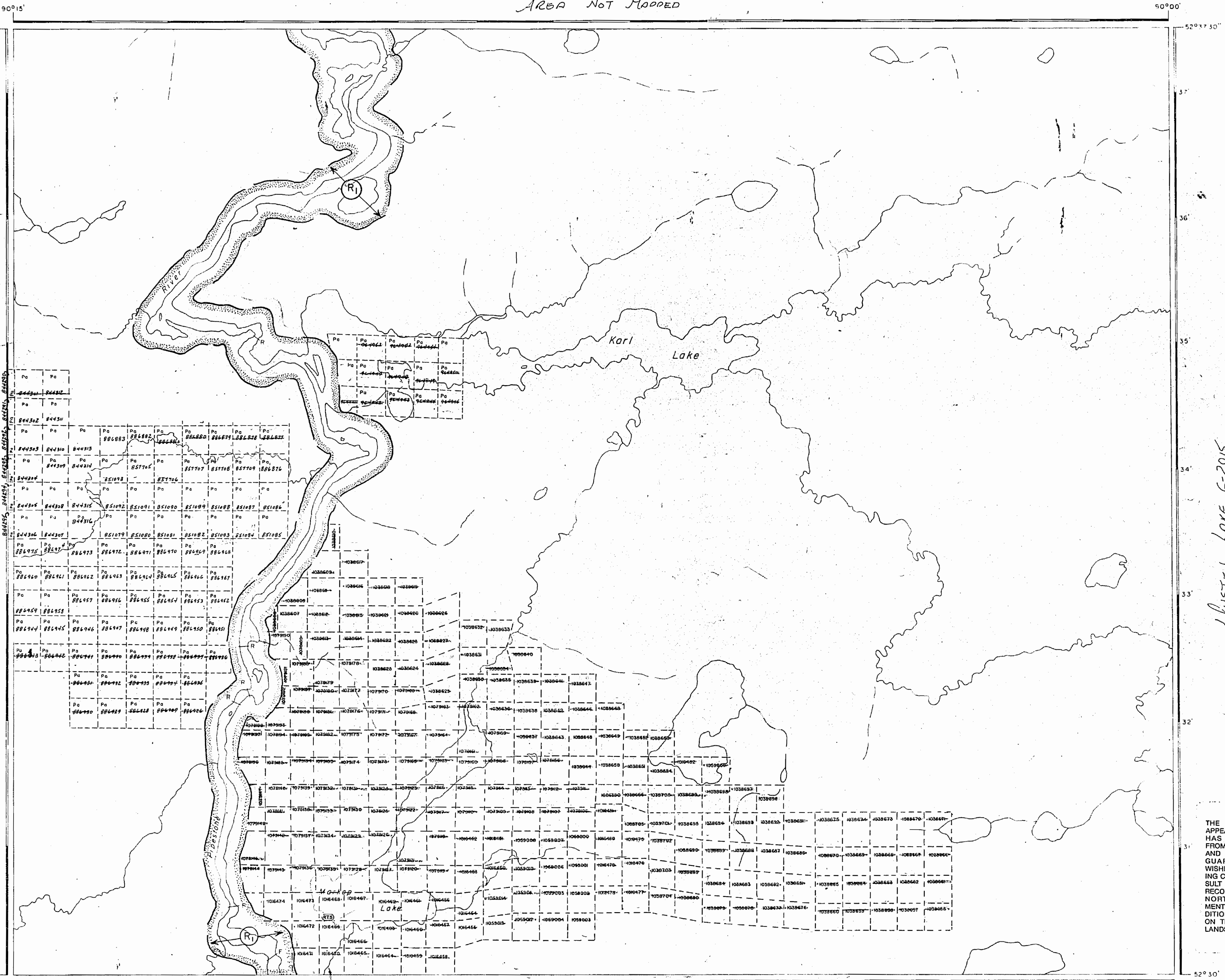

ZEEMEL LAKE G-2278

LUSTEN LAKE G-2015

FORESTER LAKE G-2044

PATRICIA MINISTRY  
**RECEIVED**  
 MAY 25 1984

**LEGEND**

HIGHWAY AND ROUTE No	
OTHER ROADS	
TRAILS	
SURVEYED LINES	
TOWNSHIPS, BASE LINES, ETC	
LOTS, MINING CLAIMS, PARCELS, ETC	
UNSURVEYED LINES	
LOT LINES	
PARCEL BOUNDARY	
MINING CLAIMS ETC.	
RAILWAY AND RIGHT OF WAY	
UTILITY LINES	
NON-PERENNIAL STREAM	
FLOODING OR FLOODING RIGHTS	
SUBDIVISION OR COMPOSITE PLAN	
RESERVATIONS	
ORIGINAL SHORELINE	
MARSH OR MUSKEG	
MINES	
TRAVERSE MONUMENT	
REMOTE TOURIST SET-UP	

**DISPOSITION OF CROWN LANDS**

TYPE OF DOCUMENT	SYMBOL
PATENT, SURFACE & MINING RIGHTS	
" SURFACE RIGHTS ONLY	
" MINING RIGHTS ONLY	
LEASE, SURFACE & MINING RIGHTS	
" SURFACE RIGHTS ONLY	
" MINING RIGHTS ONLY	
LICENCE OF OCCUPATION	
ORDER-IN-COUNCIL	
RESERVATION	
CANCELLED	
SAND & GRAVEL	

NOTE: MINING RIGHTS IN PARCELS PATENTED PRIOR TO MAY 6, 1912, VESTED IN ORIGINAL PATENTEE BY THE PUBLIC LANDS ACT, R.S.O. 1970, CHAP. 380, SEC. 63, SUBSEC. 1.

**REFERENCES**

**AREAS WITHDRAWN FROM DISPOSITION**

Description	Order No.	Date	Disposition	File
① PARK RESERVE	40400	10/23/77	M.B.S.	104338

1/24 1/85  
 Jan 21/86  
 Mar 24/86  
 Feb 21/87  
 MAR. 22/88  
 July 13/89

SCALE: 1 INCH = 40 CHAINS

AREA  
**KARL LAKE**  
 M.N.R. ADMINISTRATIVE DISTRICT  
 SIOUX LOOKOUT  
 MINING DIVISION  
 PATRICIA  
 LAND TITLES / REGISTRY DIVISION  
 KENORA (PATRICIA PORTION)

Ministry of Natural Resources  
 Land Management Branch  
 Ontario

Date: FEBRUARY, 1984. Number: **G-2082**



April 11, 1940  
 Jan 2/91  
 Feb 11/91  
 March 13/91  
 April 14/91  
 April 19/91

AREA NOT MAPPED

**LEGEND**

- HIGHWAY AND ROUTE No.
- OTHER ROADS
- TRAILS
- SURVEYED LINES
- TOWNSHIPS, BASE LINES, ETC.
- LOTS, MINING CLAIMS, PARCELS, ETC.
- UNSURVEYED LINES
- LOT LINES
- PARCEL BOUNDARY
- MINING CLAIMS ETC.
- RAILWAY AND RIGHT OF WAY
- UTILITY LINES
- NON PERENNIAL STREAM
- FLOODING OR FLOODING RIGHTS
- SUBDIVISION OR COMPOSITE PLAN
- RESERVATIONS
- ORIGINAL SHORELINE
- MARSH OR MUSKÉG
- MINES
- TRAVERSE MONUMENT
- REMOTE TOURIST SET-UP

**DISPOSITION OF CROWN LANDS**

TYPE OF DOCUMENT	SYMBOL
PATENT, SURFACE & MINING RIGHTS	●
SURFACE RIGHTS ONLY	○
MINING RIGHTS ONLY	◐
LEASE, SURFACE & MINING RIGHTS	◑
SURFACE RIGHTS ONLY	◒
MINING RIGHTS ONLY	◓
LICENCE OF OCCUPATION	◔
ORDER-IN-COUNCIL	OC
RESERVATION	⊙
CANCELLED	⊘
SAND & GRAVEL	⊚

NOTE: MINING RIGHTS IN PARCELS PATENTED PRIOR TO MAY 6, 1913, VESTED IN ORIGINAL PATENTEE BY THE PUBLIC LANDS ACT, R.S.O. 1970, CHAP. 380, SEC. 63, SUBSEC. 1.

**REFERENCES**

**AREAS WITHDRAWN FROM DISPOSITION**

M.R.O. - MINING RIGHTS ONLY  
 S.R.O. - SURFACE RIGHTS ONLY  
 M.+S. - MINING AND SURFACE RIGHTS

Description	Order No.	Date	Disposition	File
① PARK RESERVE	42488	10-23/87	M&S	188538

MAR 22/88  
 MAR 22/88  
 MAR 22/88  
 MAR 22/88

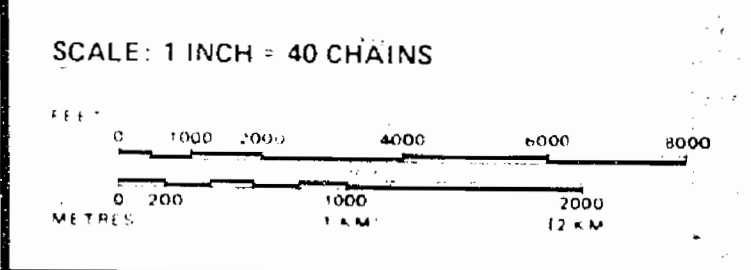

**AREA**

**KARL LAKE**  
 M.N.R. ADMINISTRATIVE DISTRICT  
 SIOUX LOOKOUT  
 MINING DIVISION  
 PATRICIA  
 LAND TITLES / REGISTRY DIVISION  
 KENORA (PATRICIA PORTION)

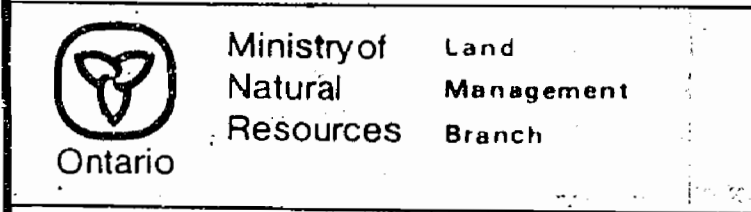

Date: FEBRUARY, 1984. Number: **G-2082**

MUSTEN LAKE G-2015

LEENCL LAKE G-2278

FORESTER LAKE G-2044

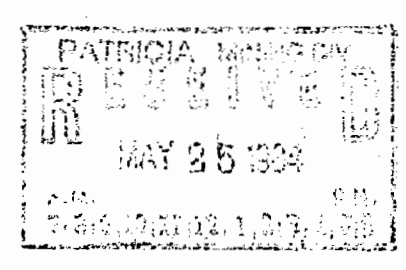

THE INFORMATION THAT APPEARS ON THIS MAP HAS BEEN COMPILED FROM VARIOUS SOURCES, AND ACCURACY IS NOT GUARANTEED. THOSE WISHING TO STAKE MINING CLAIMS SHOULD CONSULT WITH THE MINING RECORDER, MINISTRY OF NORTHERN DEVELOPMENT AND MINES, FOR ADDITIONAL INFORMATION ON THE STATUS OF THE LANDS SHOWN HEREON.

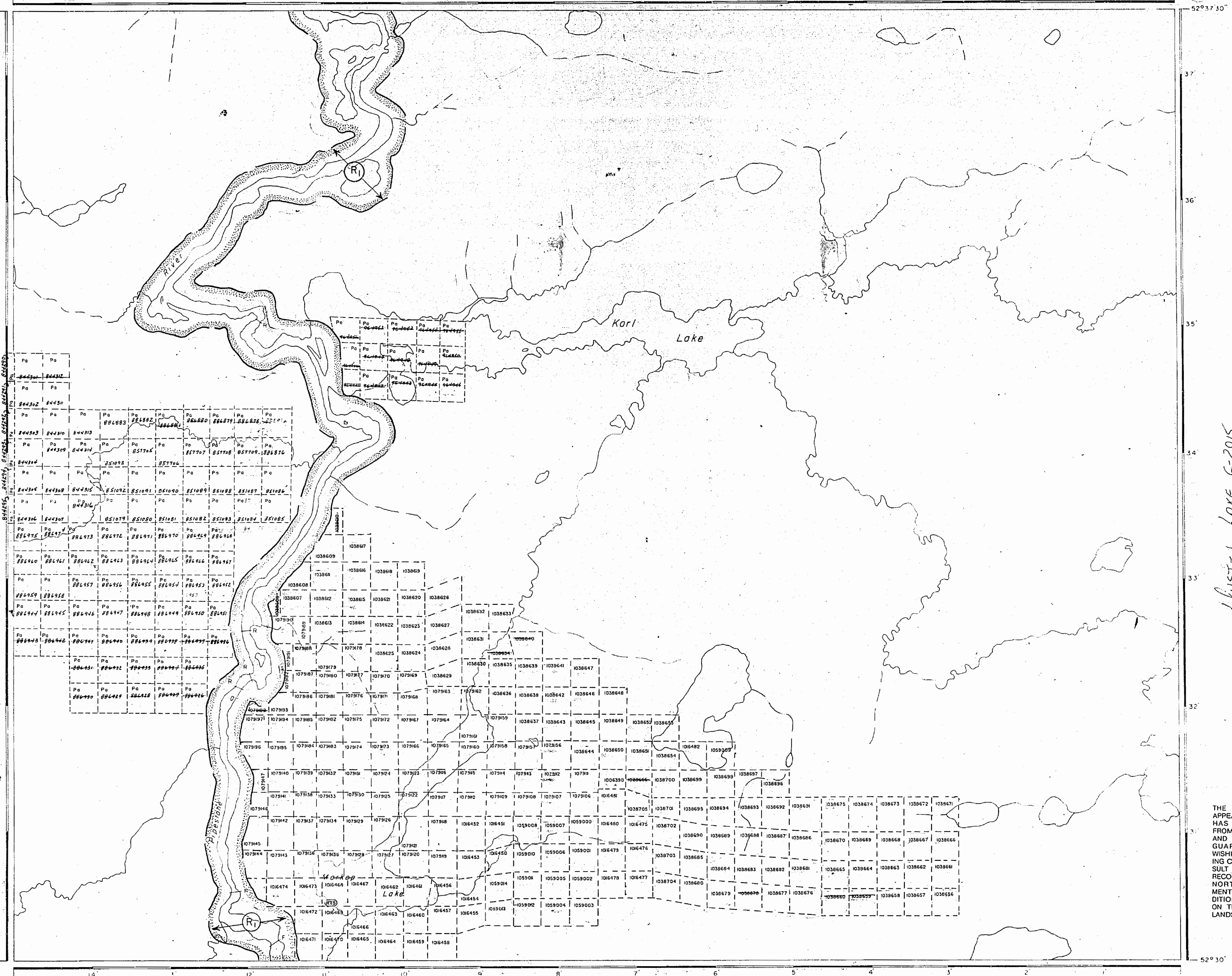

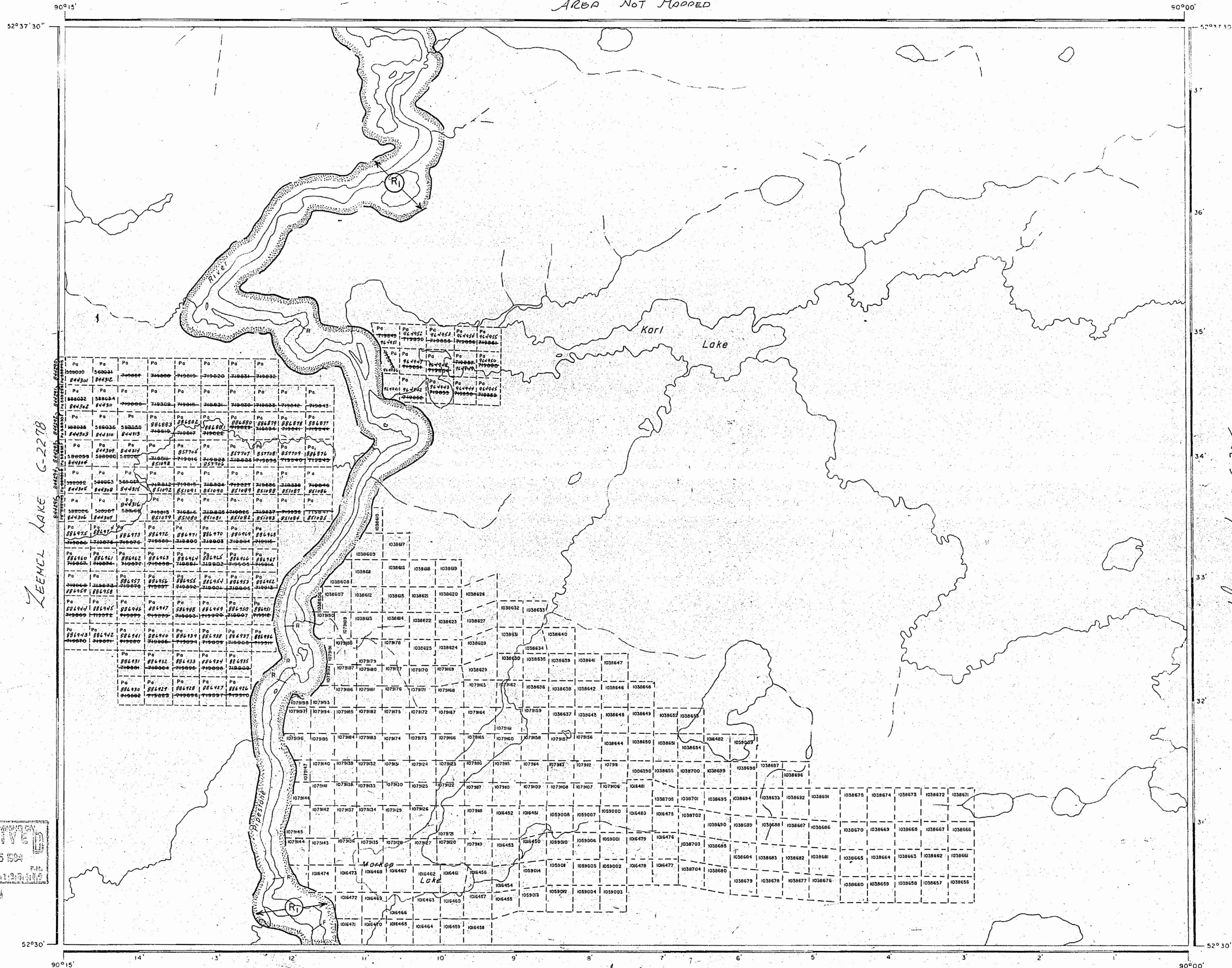

**LEGEND**

- HIGHWAY AND ROUTE No.
- OTHER ROADS
- TRAILS
- SURVEYED LINES
- TOWNSHIPS, BASE LINES, ETC.
- LOTS, MINING CLAIMS, PARCELS, ETC.
- UNSURVEYED LINES
- LOT LINES
- PARCEL BOUNDARY, MINING CLAIMS ETC.
- RAILWAY AND RIGHT OF WAY
- UTILITY LINES
- NON PERENNIAL STREAM
- FLOODING OR FLOODING RIGHTS
- SUBDIVISION OR COMPOSITE PLAN
- RESERVATIONS
- ORIGINAL SHORELINE
- MARSH OR MUSKEG
- MINES
- TRAVERSE MONUMENT

**DISPOSITION OF CROWN LANDS**

TYPE OF DOCUMENT	SYMBOL
PATENT, SURFACE & MINING RIGHTS	●
" SURFACE RIGHTS ONLY	○
" MINING RIGHTS ONLY	○
LEASE, SURFACE & MINING RIGHTS	■
" SURFACE RIGHTS ONLY	■
" MINING RIGHTS ONLY	■
LICENCE OF OCCUPATION	▽
ORDER-IN-COUNCIL	○
RESERVATION	○
CANCELLED	○
SAND & GRAVEL	○

NOTE: MINING RIGHTS IN PARCELS PATENTED PRIOR TO MAY 6, 1913, VESTED IN ORIGINAL PATENTEE BY THE PUBLIC LANDS ACT, R.S.O. 1970, CHAP. 360, SEC. 63, SUBSEC. 1.

**REFERENCES**

**AREAS WITHDRAWN FROM DISPOSITION**

- M.R.O. - MINING RIGHTS ONLY
- S.R.O. - SURFACE RIGHTS ONLY
- M+S. - MINING AND SURFACE RIGHTS

Description	Order No.	Date	Disposition	File
① PARK RESERVE	W. 42/85	8/25/83	MRS	184558
<p>Jan 2 1984            NOV 11 82            Jan 29 86            Mar 24 86            Feb 21 87            MAR. 22/88</p>				

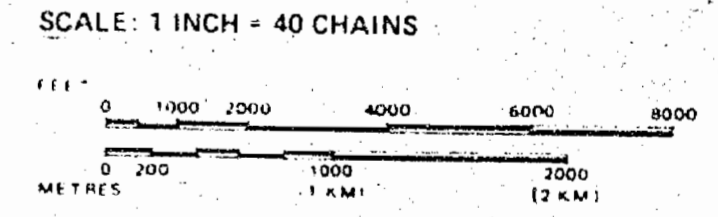

**AREA**

**KARL LAKE**  
 M.N.R. ADMINISTRATIVE DISTRICT  
 SIOUX LOOKOUT  
 MINING DIVISION  
 PATRICIA  
 LAND TITLES / REGISTRY DIVISION  
 KENORA (PATRICIA PORTION)

Ministry of Natural Resources  
 Land Management Branch

Date: FEBRUARY, 1984  
 Number: **G-2082**

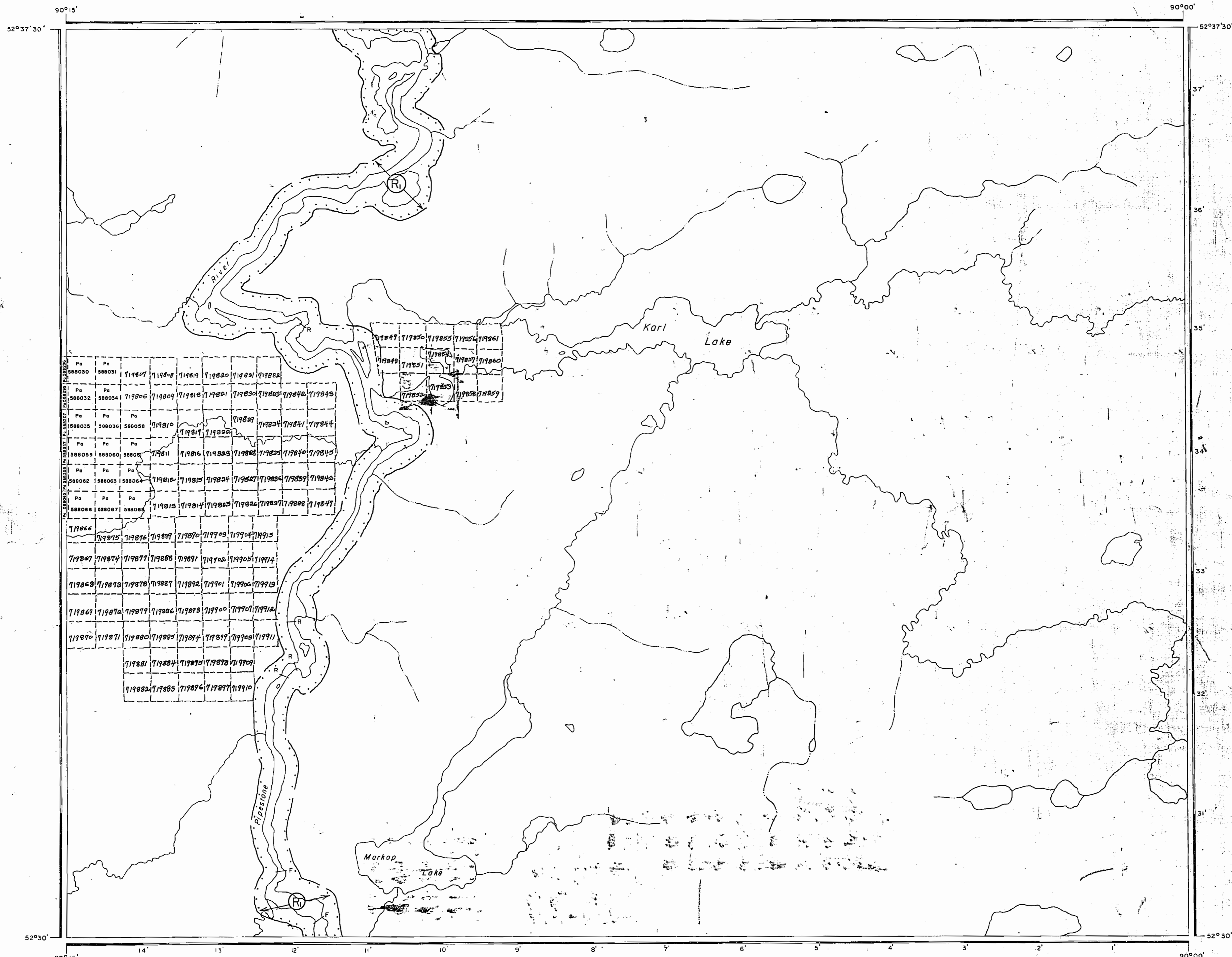

AREA OF

# KARL LAKE

DISTRICT OF  
KENORA  
(PATRICIA PORTION)

PATRICIA  
MINING DIVISION

SCALE: 1 INCH = 40 CHAINS

### LEGEND

- PATENTED LAND
- CROWN LAND SALE
- LEASES
- LOCATED LAND
- LICENSE OF OCCUPATION
- MINING RIGHTS ONLY
- SURFACE RIGHTS ONLY
- ROADS
- IMPROVED ROADS
- KING'S HIGHWAYS
- RAILWAYS
- POWER LINES
- MARSH OR MUSKEG
- MINES
- CANCELLED

### NOTES

400' Reserve around all Lakes & Rivers to Dept. of Lands & Forests

DO NOT USE FOR SURVEY PURPOSES

### AREAS WITHDRAWN FROM DISPOSITION

- M.R.O. - MINING RIGHTS ONLY
- S.R.O. - SURFACE RIGHTS ONLY
- M.+S. - MINING AND SURFACE RIGHTS

Description	Order No.	Date	Disposition	File
PARK RESERVE	W. 42/83	4/23/83	M 88	108538

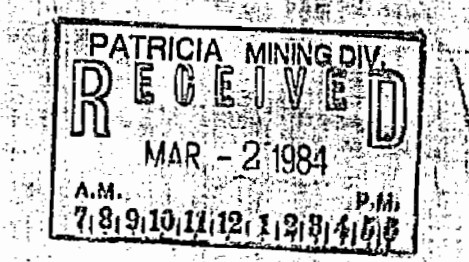

G-2082

NATIONAL TOPOGRAPHIC SERIES '53 B

PLAN NO. M. 2718

ONTARIO  
MINISTRY OF NATURAL RESOURCES

SURVEYS AND MAPPING BRANCH

Apr 28 11, 1950 c  
 Jan 2/91  
 Feb 11/11C  
 March 13/11C  
 April 19/11C  
 April 19/11C  
 June 5/11C  
 PALMISTO REC  
 MAY 31/94 REC  
 Feb 24/11C  
 Apr 14/11C  
 June 3/76 ©

AREA NOT MAPPED

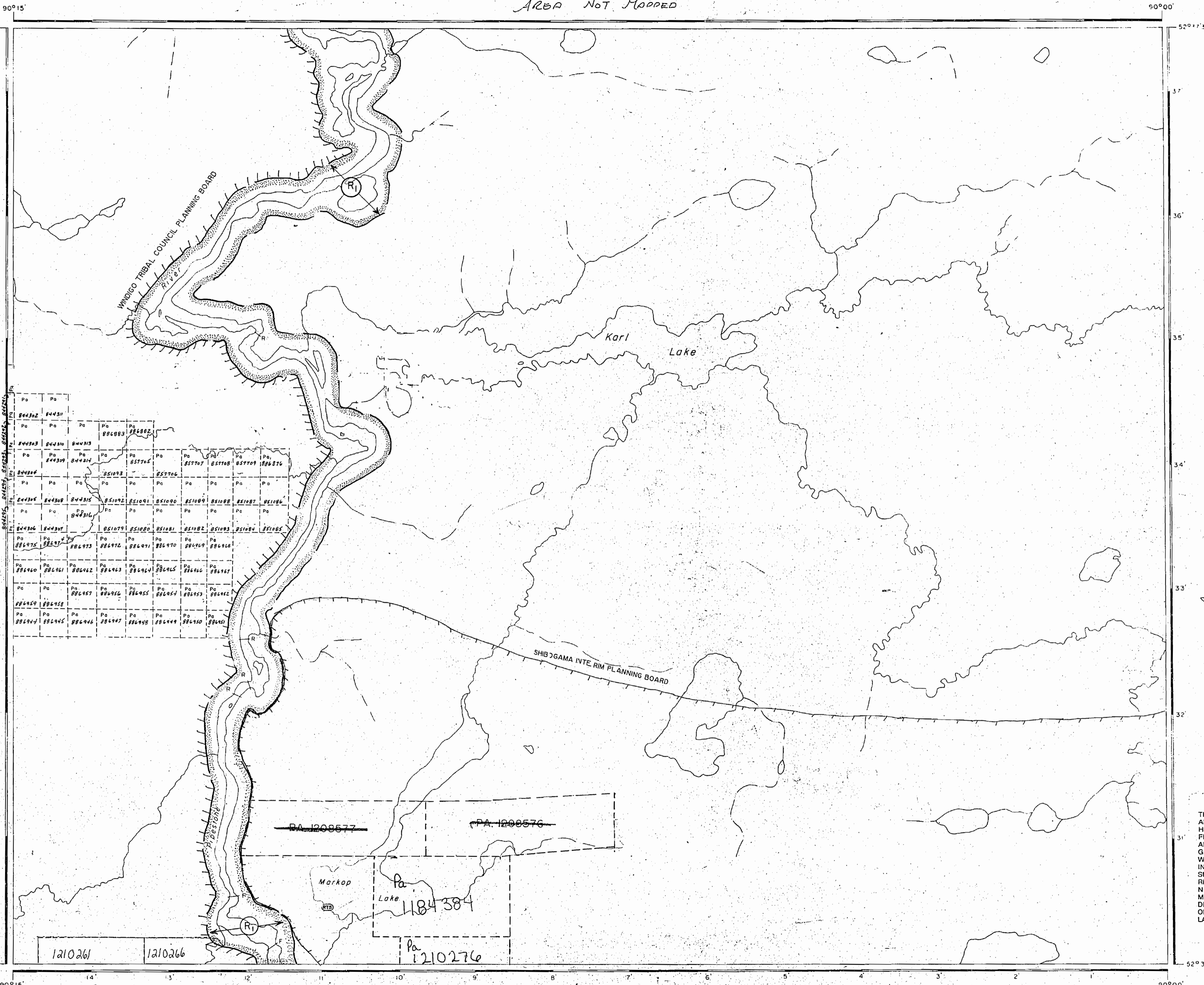

**LEGEND**

HIGHWAY AND ROUTE No	
OTHER ROADS	
TRAILS	
SURVEYED LINES	
TOWNSHIPS, BASE LINES, ETC.	
LOTS, MINING CLAIMS, PARCELS, ETC	
UNSURVEYED LINES	
LOT LINES	
PARCEL BOUNDARY	
MINING CLAIMS ETC.	
RAILWAY AND RIGHT OF WAY	
UTILITY LINES	
NON-PERENNIAL STREAM	
FLOODING OR FLOODING RIGHTS	
SUBDIVISION OR COMPOSITE PLAN	
RESERVATIONS	
ORIGINAL SHORELINE	
MARSH OR MUSKEG	
MINES	
TRAVERSE MONUMENT	
REMOTE TOURIST SET-UP	

**DISPOSITION OF CROWN LANDS**

TYPE OF DOCUMENT	SYMBOL
PATENT, SURFACE & MINING RIGHTS	
" SURFACE RIGHTS ONLY	
" MINING RIGHTS ONLY	
LEASE, SURFACE & MINING RIGHTS	
" SURFACE RIGHTS ONLY	
" MINING RIGHTS ONLY	
LICENCE OF OCCUPATION	
ORDER-IN-COUNCIL	
RESERVATION	
CANCELLED	
SAND & GRAVEL	

NOTE: MINING RIGHTS IN PARCELS PATENTED PRIOR TO MAY 6, 1913, VESTED IN ORIGINAL PATENTEE BY THE PUBLIC LANDS ACT, R.S.O. 1970, CHAP. 360, SEC. 63, SUBSEC. 1.

**REFERENCES**

**AREAS WITHDRAWN FROM DISPOSITION**

M.R.O. - MINING RIGHTS ONLY  
 S.R.O. - SURFACE RIGHTS ONLY  
 M.+S. - MINING AND SURFACE RIGHTS

Description	Order No.	Date	Disposition	File
① PARK RESERVE	10-0208	03/07	M.A.S.	100538

AREA IN WINDIGO TRIBAL COUNCIL PLANNING BOARD FOR DETAILS CALL 737-1585

AREA IN SHIBOGAMA INTERIM PLANNING BOARD CALL FOR DETAILS 737-2662

SCALE: 1 INCH = 40 CHAINS

**KARL LAKE**

M.N.R. ADMINISTRATIVE DISTRICT  
 SIOUX LOOKOUT  
 MINING DIVISION  
 PATRICIA  
 LAND TITLES / REGISTRY DIVISION  
 KENORA (PATRICIA PORTION)

Ministry of Natural Resources  
 Land Management Branch

Date: FEBRUARY, 1984. Number: **G-2082**

MINING RECORDER  
 PATRICIA  
 TRAINING DIVISION

PATRICIA  
 MAY 25 1984

11

FORESTER LAKE G-2044