

SOTHMAN TWP. M.1121

NOTES

400' surface rights reservation along the shores of all lakes and rivers.

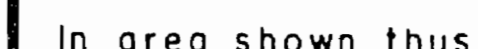

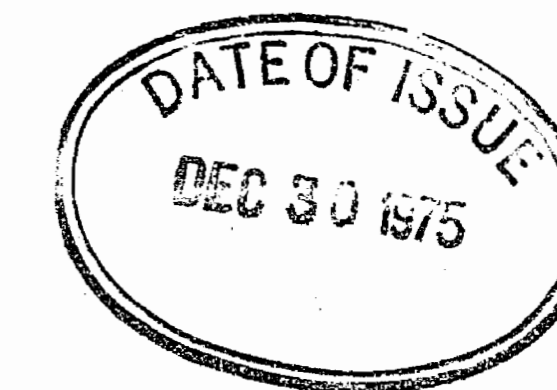







In area shown thus  Mining claims staked after Sept. 13, 1957 - Mining Rights Only. Surface Rights withdrawn for reforestation under Sec. 36(d) of Mining Act. File: 160706.

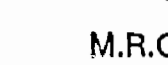
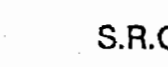

BURROWS TWP. M.691

MOND TWP. M.870

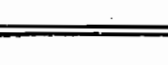
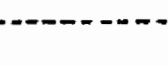
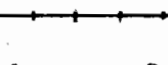
LEGEND

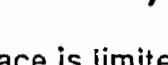
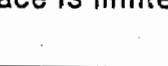
- PATENTED LAND 
- PATENTED FOR SURFACE RIGHTS ONLY 
- LEASE 
- LICENSE OF OCCUPATION 
- CROWN LAND SALES 
- LOCATED LAND 
- CANCELLED 
- MINING RIGHTS ONLY 
- SURFACE RIGHTS ONLY 
- HIGHWAY & ROUTE NO. 
- ROADS 
- TRAILS 
- RAILWAYS 
- POWER LINES 
- MARSH OR MUSKEG 
- MINES 

\*used only with summer resort locations or when space is limited

TOWNSHIP OF

**KEMP**

DISTRICT OF  
**SUDBURY**

**LARDER LAKE**  
MINING DIVISION

SCALE: 1 INCH = 40 CHAINS (1/2 MILE)

#3

DR. K INAMOTO  
DATE JUNE '71

PLAN NO. **M.966**

ONTARIO  
MINISTRY OF NATURAL RESOURCES  
SURVEYS AND MAPPING BRANCH

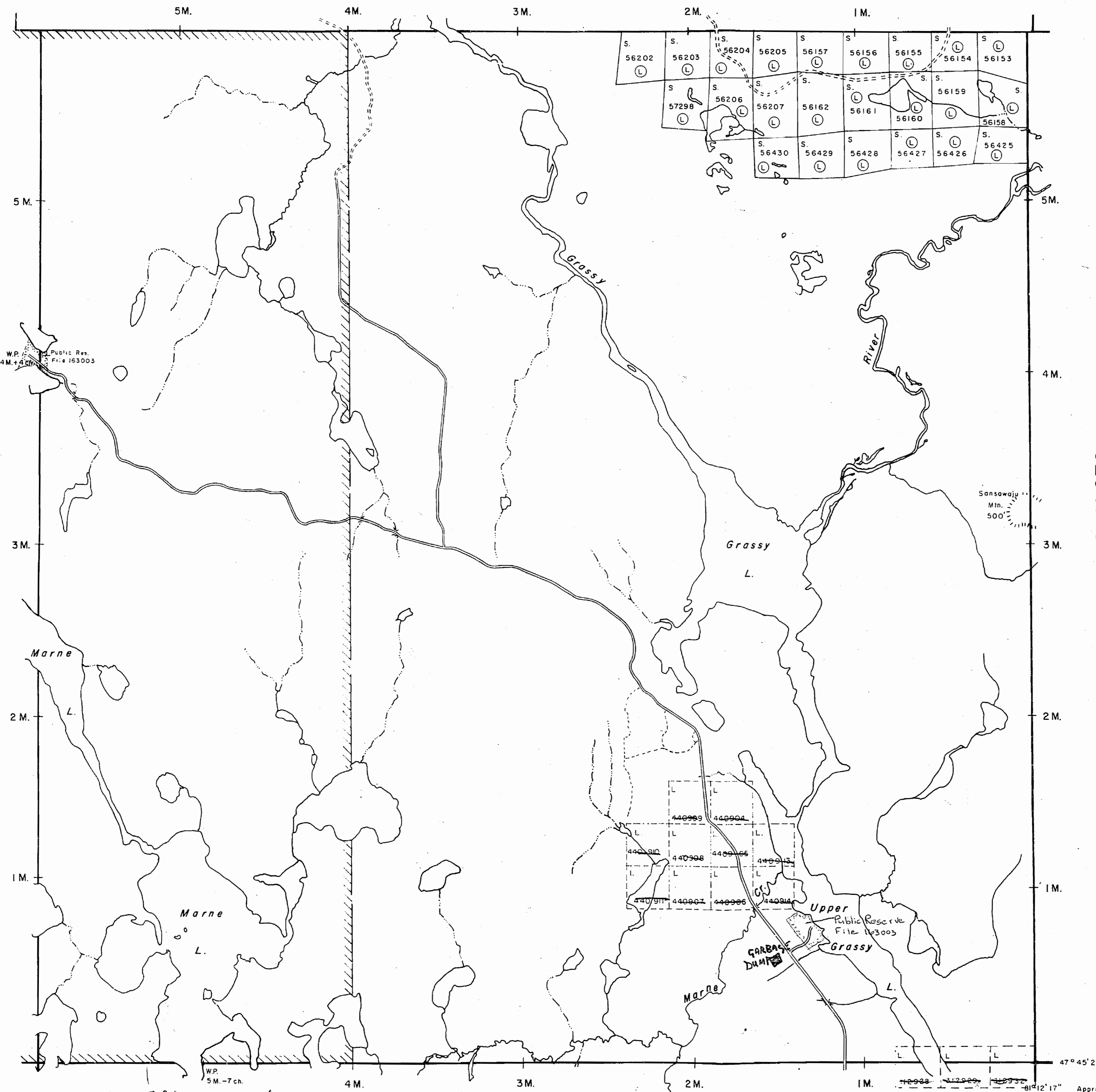

SRO. re-opened  
NRO 12/78

KELVIN TWP. M.964



# geology reference-COBALT

RESIDENT GEO.

SOTHMAN TWP. M.1121

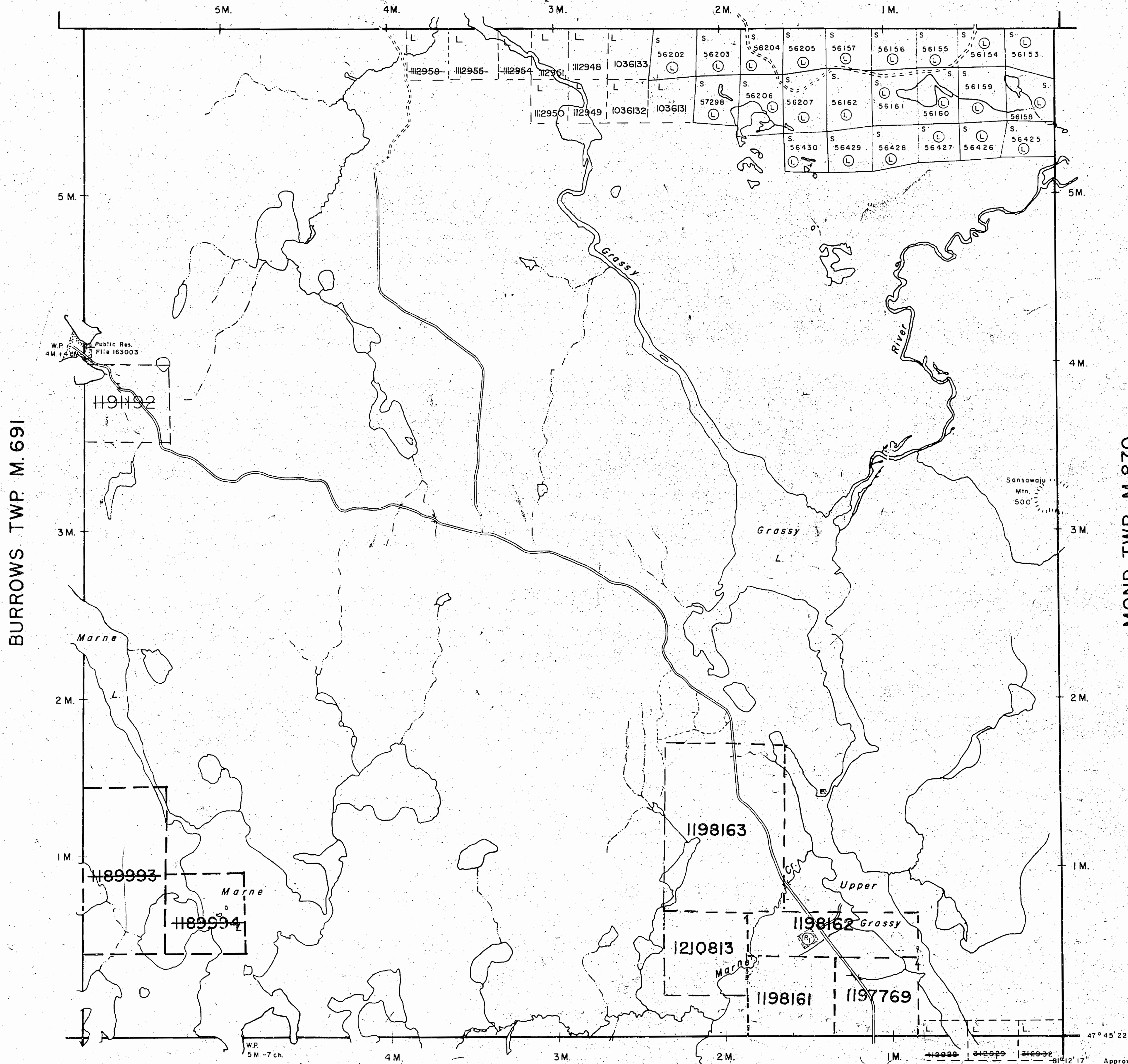

## NOTES

400' surface rights reservation along the shores of all lakes and rivers.

■ Trapline Cabin

Areas withdrawn from staking under Section 43 of the Mining Act, R.S.O. 1970.

Order No.	File	Date	Disposition
(R) W.66/76	188517	19/11/76	S.R.O.

THE INFORMATION THAT APPEARS ON THIS MAP HAS BEEN COMPILED FROM VARIOUS SOURCES, AND ACCURACY IS NOT GUARANTEED. THOSE WISHING TO STAKE MINING CLAIMS SHOULD CONSULT WITH THE MINING RECORDER, MINISTRY OF NORTHERN DEVELOPMENT AND MINES, FOR ADDITIONAL INFORMATION ON THE STATUS OF THE LANDS SHOWN HEREON.

## LEGEND

PATENTED LAND	(P) or (●)*
PATENTED FOR SURFACE RIGHTS ONLY	(○)*
LEASE	(L)
LICENSE OF OCCUPATION	L.O.
CROWN LAND SALES	C.S.
LOCATED LAND	Loc.
CANCELLED	C.
MINING RIGHTS ONLY	M.R.O.
SURFACE RIGHTS ONLY	S.R.O.
HIGHWAY & ROUTE NO.	(17)
ROADS	—
TRAILS	- - -
RAILWAYS	—+—
POWER LINES	—+—+—
MARSH OR MUSKEG	(wavy lines)
MINES	(X)

\*used only with summer resort locations or when space is limited

TOWNSHIP OF

# KEMP

DISTRICT OF  
SUDBURY

LARDER LAKE  
MINING DIVISION

SCALE: 1 INCH = 40 CHAINS (1/2 MILE)

DR. K. INAMOTO

DATE JUNE '71

PLAN NO. G.0984

ONTARIO #3

MINISTRY OF NATURAL RESOURCES  
SURVEYS AND MAPPING BRANCH

KELVIN TWP. M.964

COPY OF THIS MYLAR  
ARCHIVED MAY 15/92  
ARCHIVED NOV 1/96

# geology reference-COBALT

RESIDENT GEO.

SOTHMAN TWP. M.1121

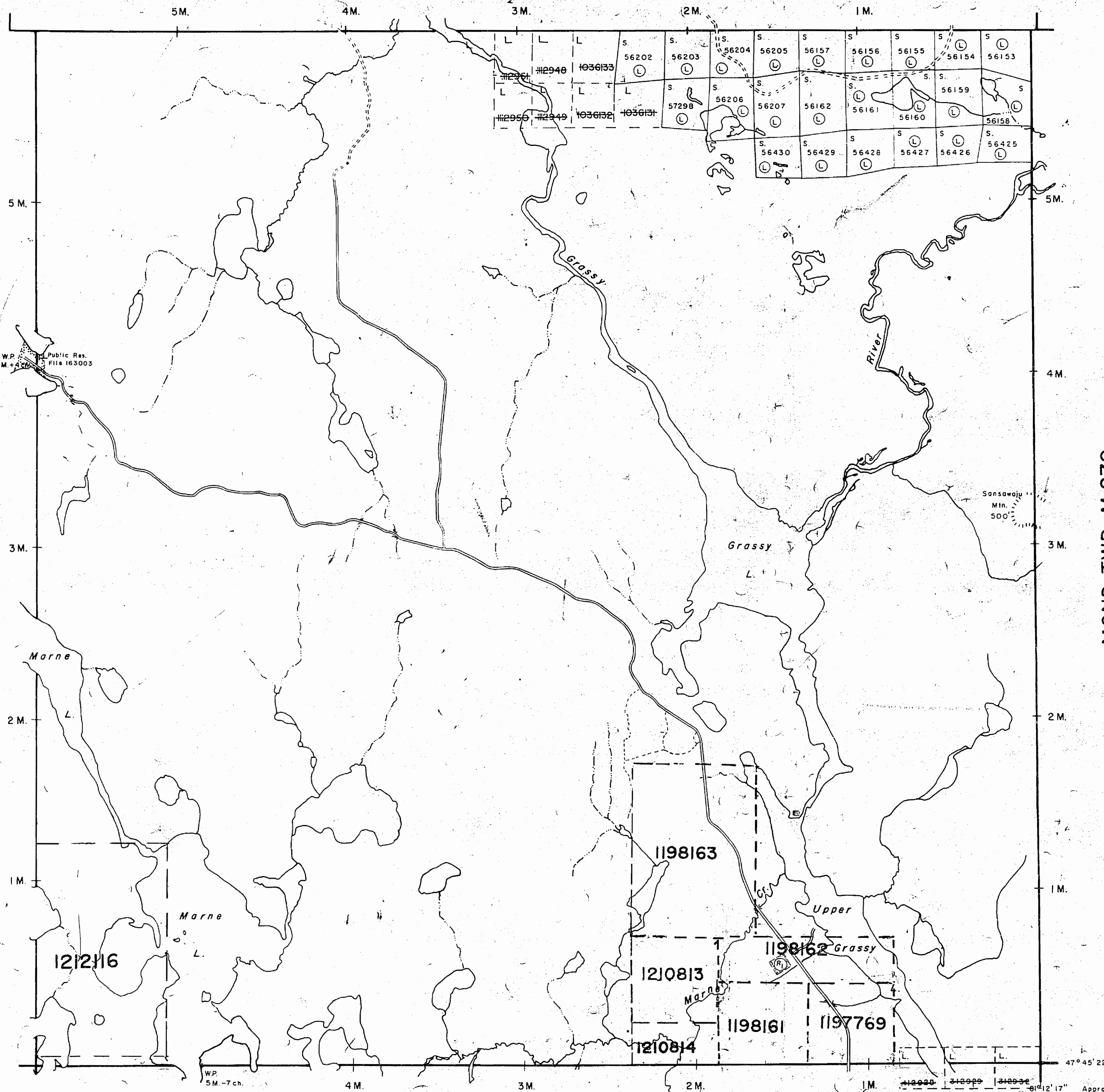

## NOTES

400' surface rights reservation along the shores of all lakes and rivers.

Trapline Cabin

Areas withdrawn from staking under Section 43 of the Mining Act, R.S.O. 1970.

Order No.	File	Date	Disposition
(R) W.66/76	188517	19/11/76	S.R.O.

THE INFORMATION THAT APPEARS ON THIS MAP HAS BEEN COMPILED FROM VARIOUS SOURCES, AND ACCURACY IS NOT GUARANTEED. THOSE WISHING TO STAKE MINING CLAIMS SHOULD CONSULT WITH THE MINING RECORDER, MINISTRY OF NORTHERN DEVELOPMENT AND MINES, FOR ADDITIONAL INFORMATION ON THE STATUS OF THE LANDS SHOWN HEREON.

## LEGEND

- PATENTED LAND P or ●
- PATENTED FOR SURFACE RIGHTS ONLY ●
- LEASE ○
- LICENSE OF OCCUPATION L.O.
- CROWN LAND SALES C.S.
- LOCATED LAND Loc.
- CANCELLED C.
- MINING RIGHTS ONLY M.R.O.
- SURFACE RIGHTS ONLY S.R.O.
- HIGHWAY & ROUTE NO.
- ROADS
- TRAILS
- RAILWAYS
- POWER LINES
- MARSH OR MUSKEG
- MINES

\*used only with summer resort locations or when space is limited

TOWNSHIP OF

# KEMP

DISTRICT OF  
SUDBURY

DATE OF

APR 27 1991

LARDER LAKE  
MINING DIVISION

PROVINCIAL RECORDS  
OFFICE - SUDBURY

SCALE: 1 INCH = 40 CHAINS (1/2 MILE)

DR. K. INAMOTO

DATE: JUNE '71

PLAN NO. G.0984

ONTARIO #3

MINISTRY OF NATURAL RESOURCES

SURVEYS AND MAPPING BRANCH

KELVIN TWP. M.964

COPY OF THIS MYLAR  
ARCHIVED MAY 15/92  
ARCHIVED NOV 1/96

SOTHMAN

Scale 40 Chains = 1 Inch

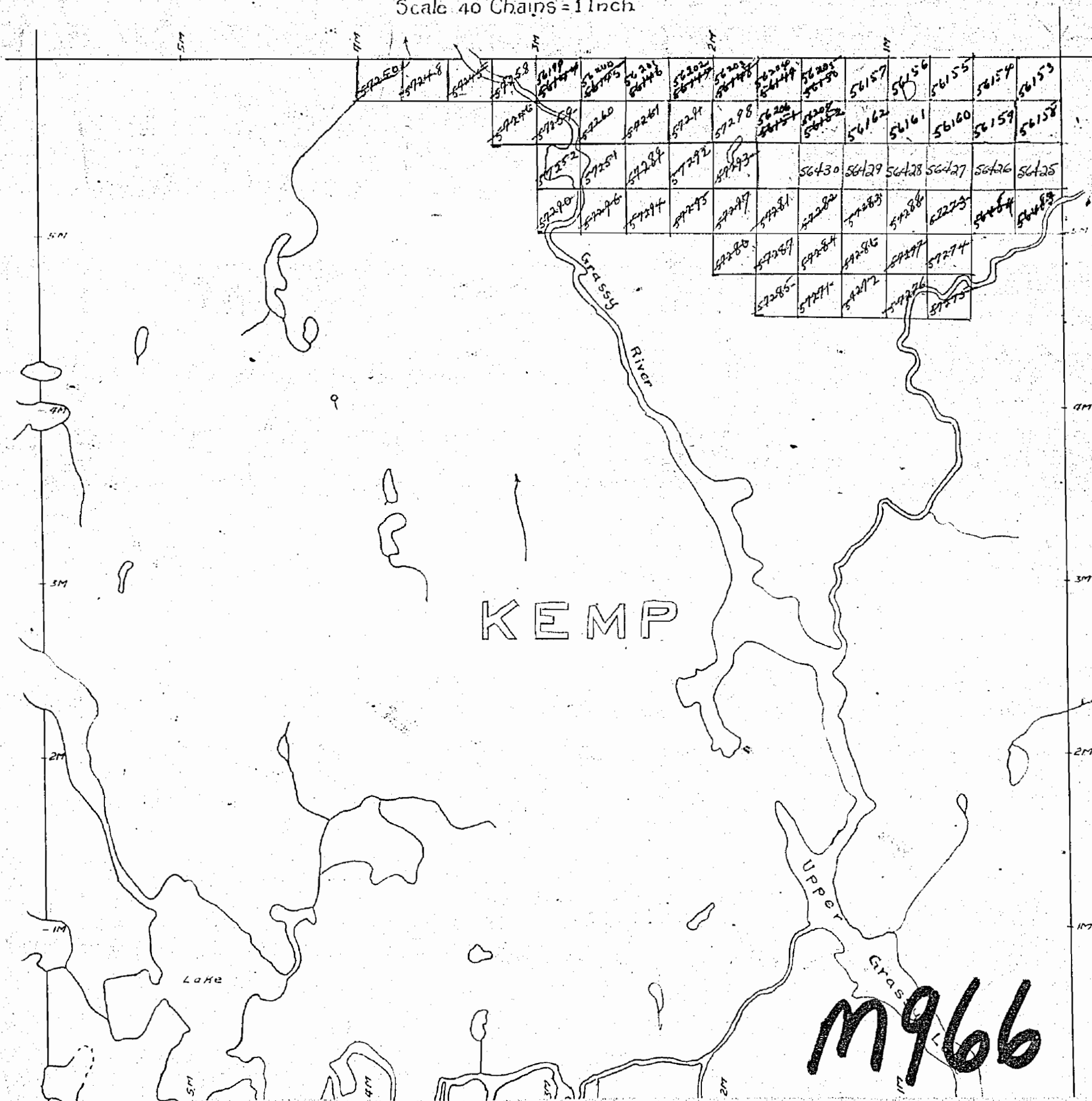

SOTHMAN TWP. M. 1121

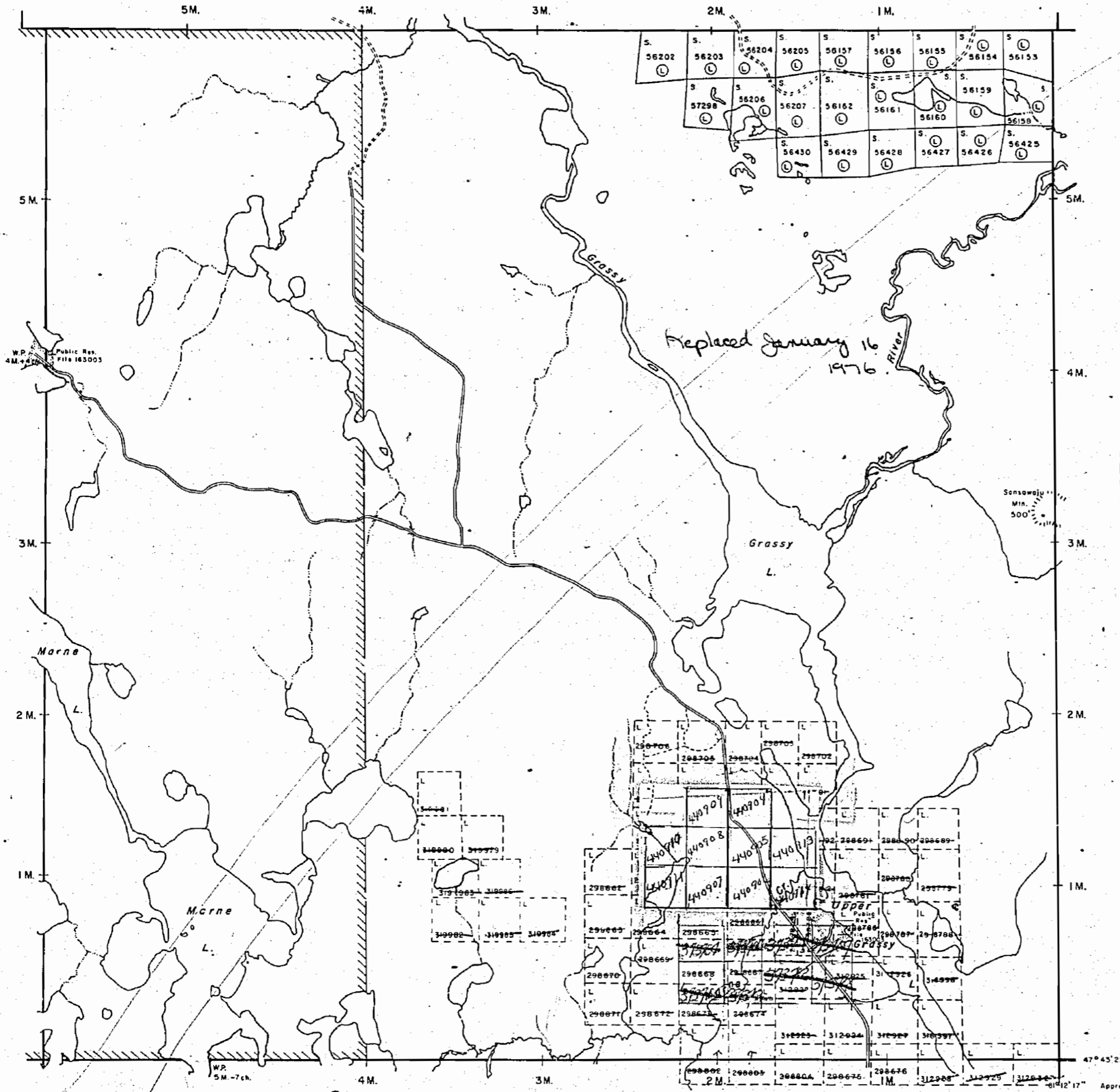

NOTES

400' surface rights reservation along the shores of all lakes and rivers.

In area shown thus Mining claims staked after Sept. 13, 1957 - Mining Rights Only. Surface Rights withdrawn for reforestation under Sec. 36(d) of Mining Act File: 160706.

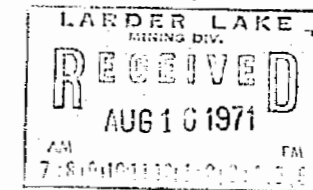

LEGEND

- PATENTED LAND
- PATENTED FOR SURFACE RIGHTS ONLY
- LEASE
- LICENSE OF OCCUPATION
- CROWN LAND SALES
- LOCATED LAND
- CANCELLED
- MINING RIGHTS ONLY
- SURFACE RIGHTS ONLY
- HIGHWAY & ROUTE NO.
- ROADS
- TRAILS
- RAILWAYS
- POWER LINES
- MARSH OR MUSKEG
- MINES

\*used only with summer resort locations or when space is limited

TOWNSHIP OF

**KEMP**

DISTRICT OF  
SUDBURY

LARDER LAKE  
MINING DIVISION

SCALE : 1 INCH = 40 CHAINS (1/2 MILE)

DR. K. INAMOTO  
DATE JUNE '71

PLAN NO. **M. 966**

ONTARIO #3  
DEPARTMENT OF MINES  
AND NORTHERN AFFAIRS

BURROWS TWP. M. 691

MOND TWP. M. 870

KELVIN TWP. M. 964

# KEMP TWP

LARDER LAKE  
MINING DIV.  
RECEIVED  
MAY 28 1971  
AM  
7 18 19 10 11 12 11 2 13 14 15

## LARDER LAKE MINING DIVISION. M.966

MINING CLAIMS CLAIMED AFTER FEBRUARY 13, 1957—MINING RIGHTS ONLY  
SURFACE RIGHTS WITHDRAWN FOR REFORESTATION UNDER SEC 36(4) OF MINING ACT - F. L. (L 8 F 160706 SHOWN THUS: //)

### DISTRICT OF SUDBURY.

NOTE

400' Surface Rights Reservation around all Lakes and Rivers.

Scale: 40 chains to an inch.



### SOTHMAN TWP.

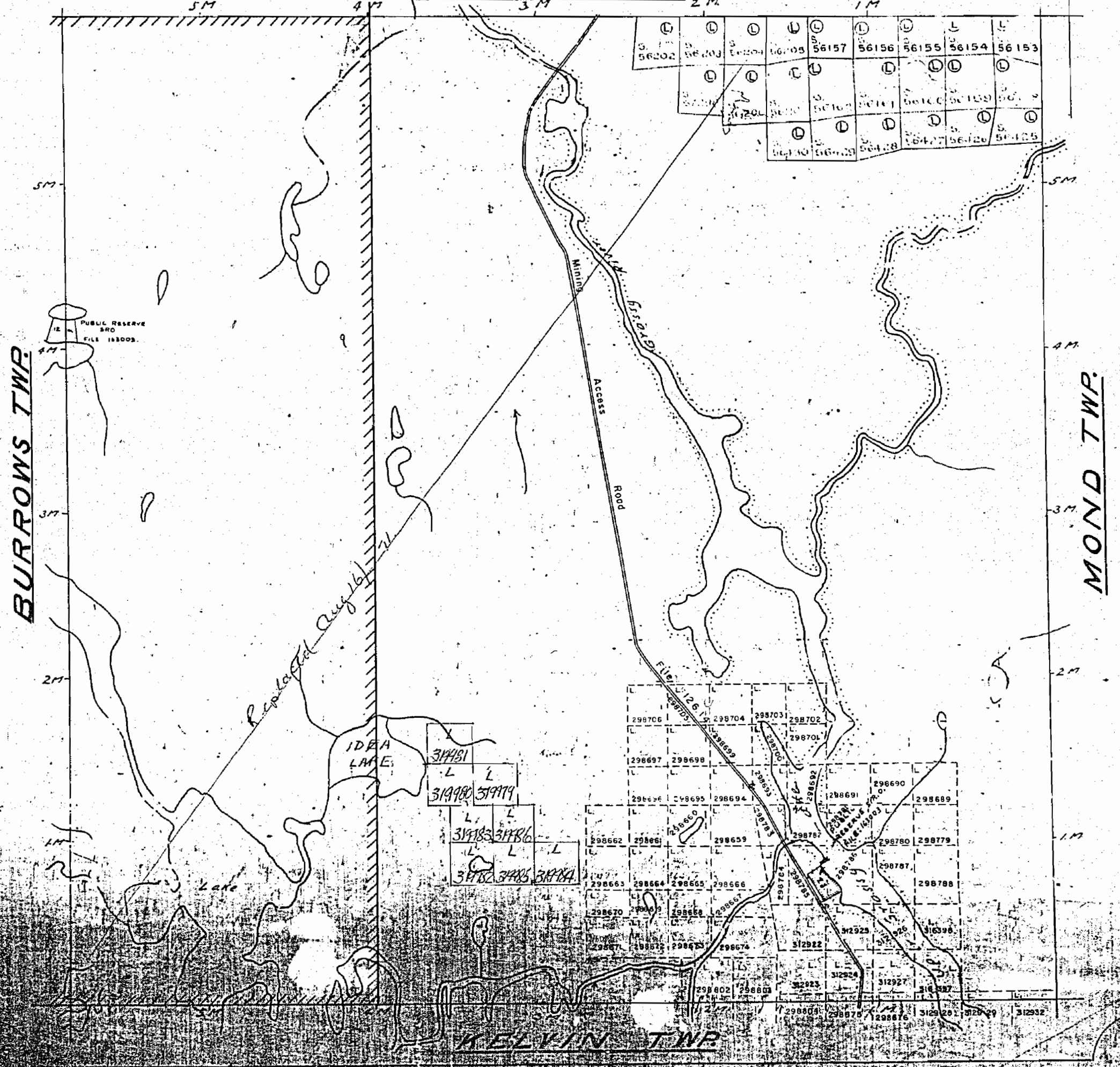

# KEMP TWP.

## MONTREAL RIVER MINING DIVISION.

MINING CLAIMS STAKED AFTER SEPT. 13, 1957—MINING RIGHTS ONLY —

SURFACE RIGHTS WITHDRAWN FOR REFORESTATION UNDER SEC. 36(d) OF

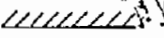
MINING ACT — FILE (L.B.F)160706 SHOWN THUS: 

## DISTRICT OF SUDBURY.

Scale: 40 chains to an inch.

M-966

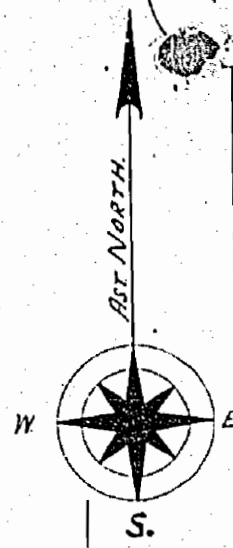

### SOTHMAN TWP

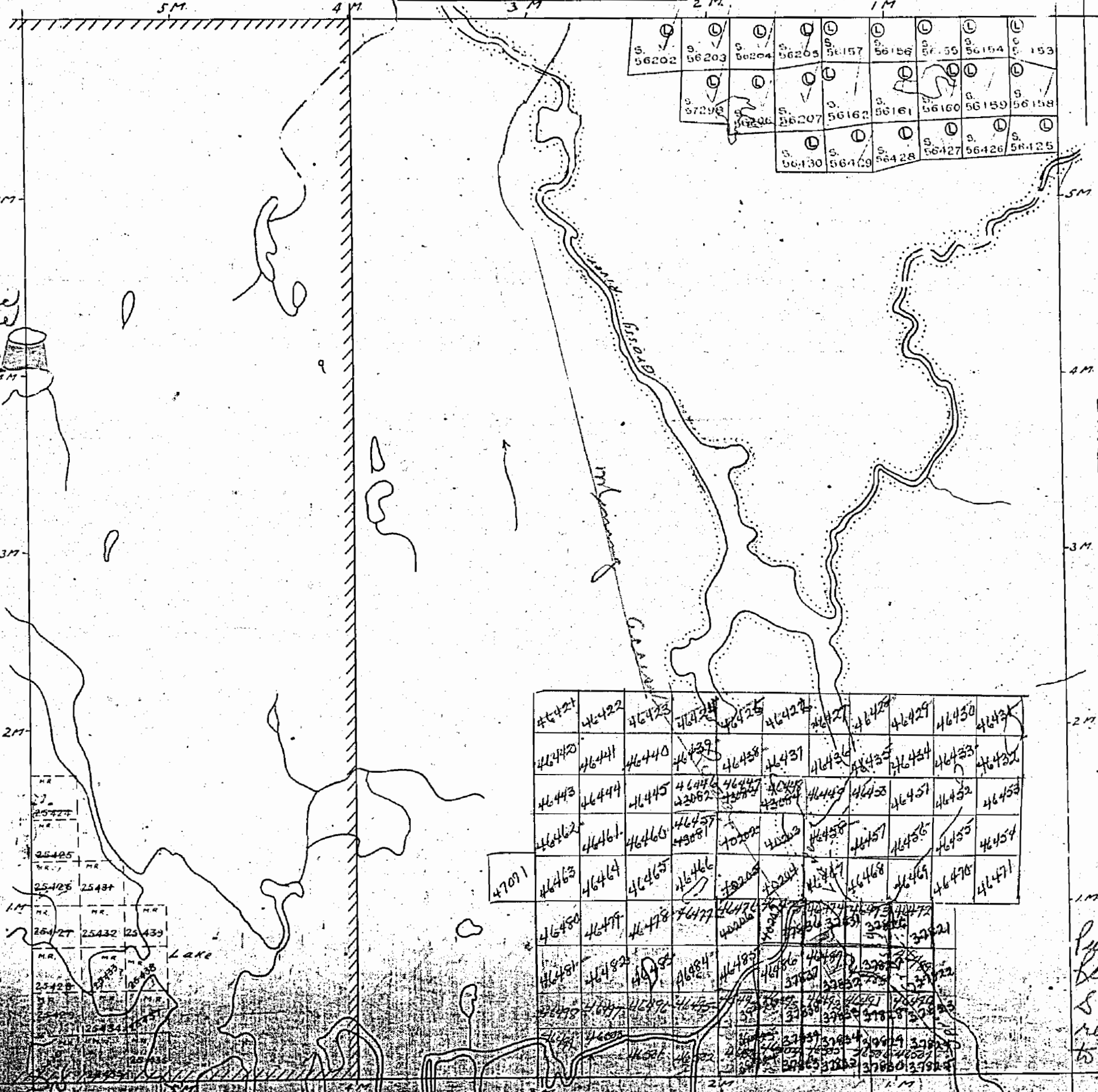

S. 56202	S. 56203	S. 56204	S. 56205	S. 56157	S. 56156	S. 56155	S. 56154	S. 56153
S. 57298	S. 56206	S. 56207	S. 56162	S. 56161	S. 56160	S. 56159	S. 56158	
S. 56130	S. 56429	S. 56428	S. 56427	S. 56426	S. 56425			

46421	46422	46423	46424	46425	46426	46427	46428	46429	46430	46431
46440	46441	46440	46439	46438	46437	46436	46435	46434	46433	46432
46443	46444	46445	46446	46447	46448	46449	46450	46451	46452	46453
46462	46461	46460	46459	46458	46457	46456	46455	46454	46453	46452
47001	46463	46464	46465	46466	46467	46468	46469	46470	46471	46472
46480	46479	46478	46477	46476	46475	46474	46473	46472	46471	46470
46481	46482	46483	46484	46485	46486	46487	46488	46489	46490	46491
46492	46493	46494	46495	46496	46497	46498	46499	46500	46501	46502
46503	46504	46505	46506	46507	46508	46509	46510	46511	46512	46513
46514	46515	46516	46517	46518	46519	46520	46521	46522	46523	46524

Public Reserve  
SRO reserved

Public Reserve  
SRO reserved to Crown

### KELVIN TWP

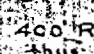
400 Reserve to Dept. of Lands & Forests shown thus: 



966

# PLAN OF KEMP TWP

## MONTREAL RIVER MINING DIVISION.

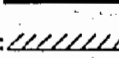
MINING CLAIMS STAKED AFTER SEPT  
13, 1957 - MINING RIGHTS ONLY -  
SURFACE RIGHTS WITHDRAWN FOR  
REFORESTATION UNDER SEC. 36(d) OF  
MINING ACT - FILE (L&F) 160706 SHOWN THUS: 

### DISTRICT OF SUDBURY.

Scale: 40 chains to an inch.

NOTE

400' Surface Rights Reservation  
around all Lakes and Rivers.

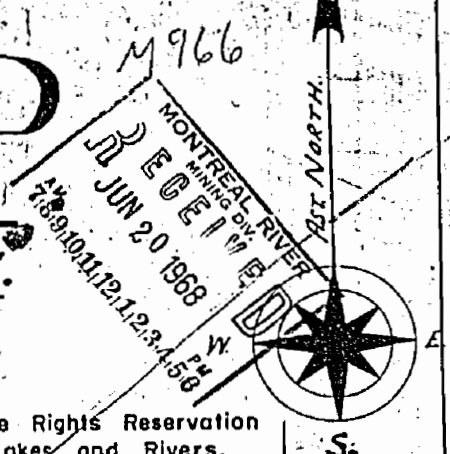

SOTHMAN TWP

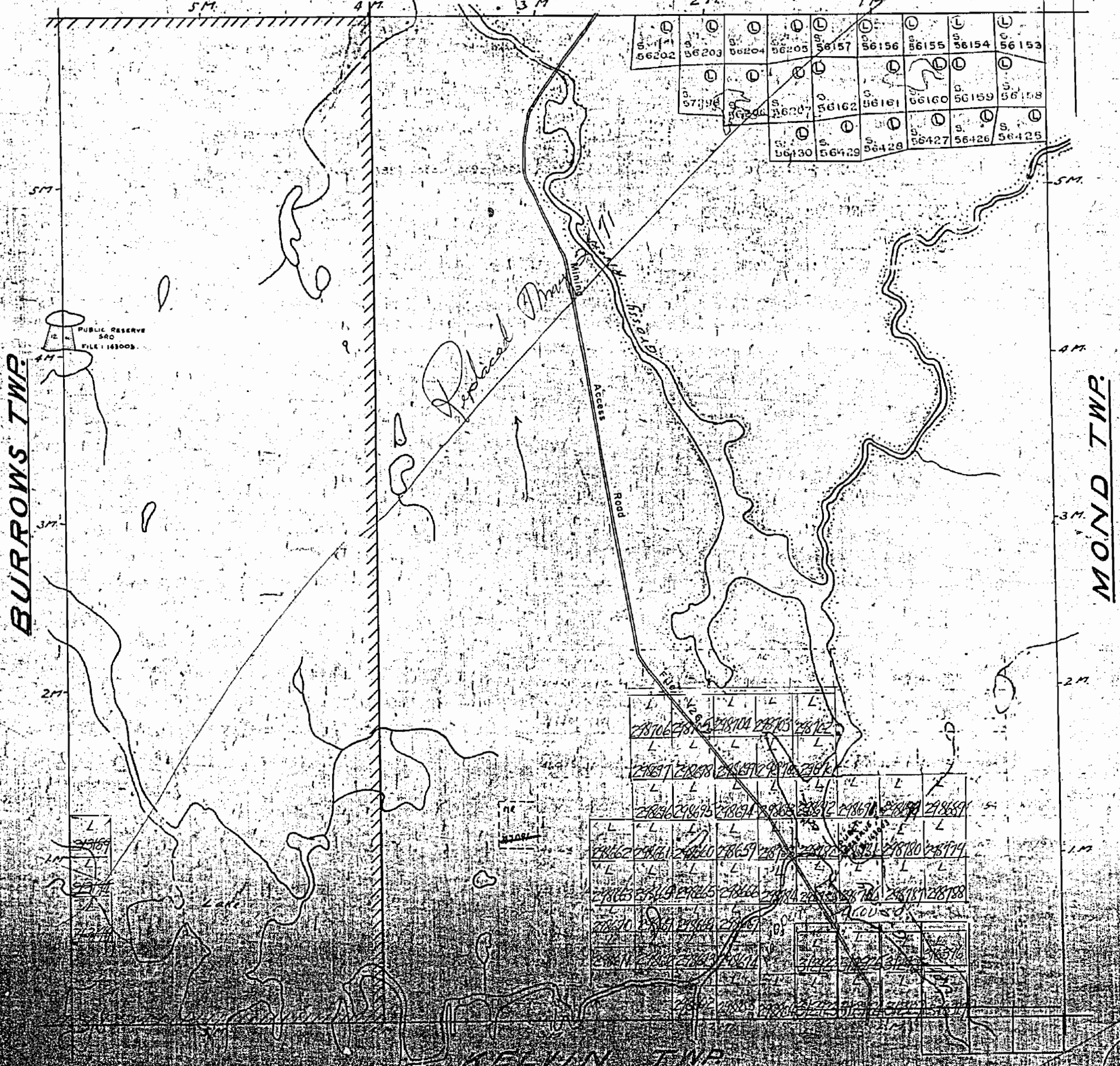

56202	56203	56204	56205	56157	56156	56155	56154	56153
57118	56206	56207	56162	56161	56160	56159	56158	
56130	56429	56428	56427	56426	56425			

28706	28707	28708	28709	28710	28711	28712		
28713	28714	28715	28716	28717	28718	28719	28720	28721
28722	28723	28724	28725	28726	28727	28728	28729	28730
28731	28732	28733	28734	28735	28736	28737	28738	28739
28740	28741	28742	28743	28744	28745	28746	28747	28748
28749	28750	28751	28752	28753	28754	28755	28756	28757
28758	28759	28760	28761	28762	28763	28764	28765	28766
28767	28768	28769	28770	28771	28772	28773	28774	28775
28776	28777	28778	28779	28780	28781	28782	28783	28784
28785	28786	28787	28788	28789	28790	28791	28792	28793
28794	28795	28796	28797	28798	28799	28800		

PUBLIC RESERVE  
540  
FILE: 143003

BURROWS TWP

MOND TWP

KELVIN TWP

—PLAN OF—

# KEMP TWP.

S U D B U R Y M I N I N G D I V I S I O N .

D I S T R I C T O F S U D B U R Y .

Scale: 40 chains to an inch.

M-966



## S O T H M A N T W P .

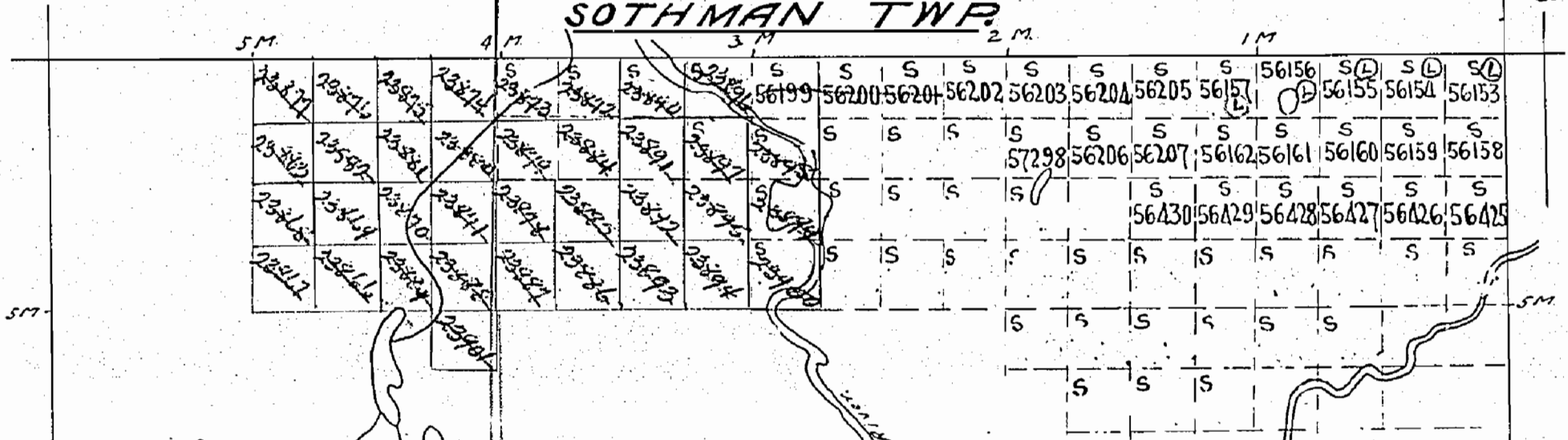

BURROWS TWP.

M O N D T W P .

*mining rights only*

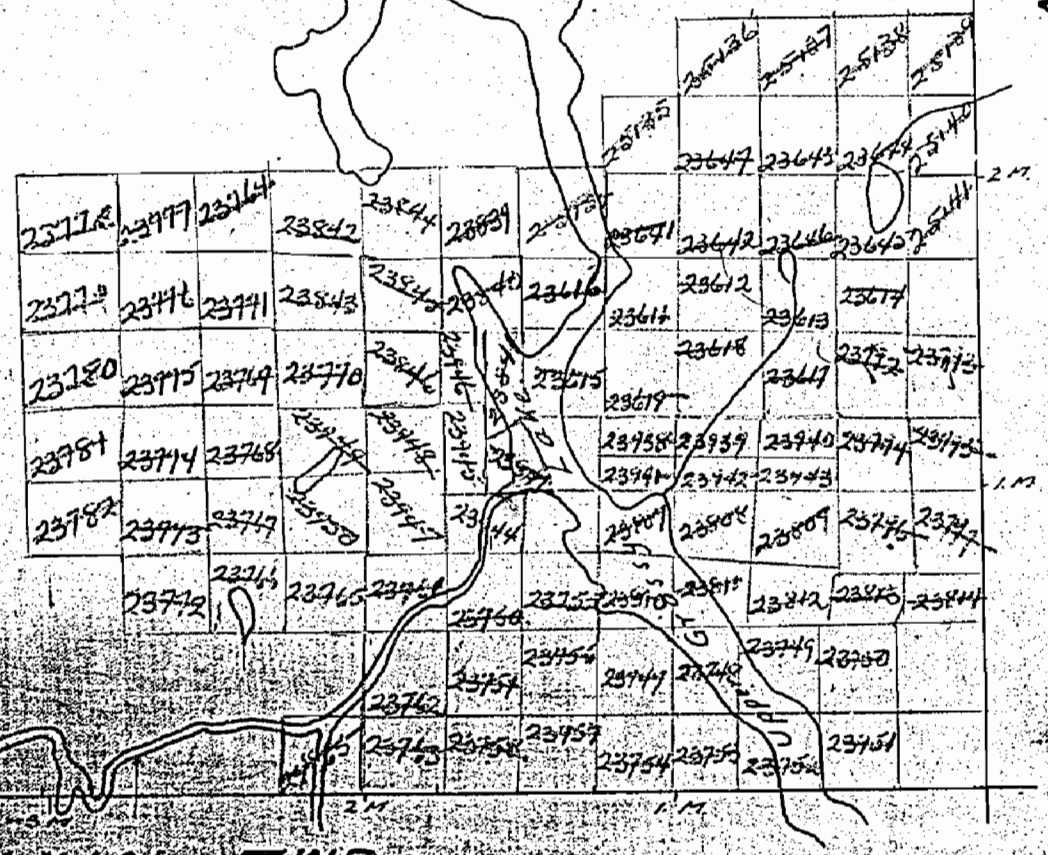
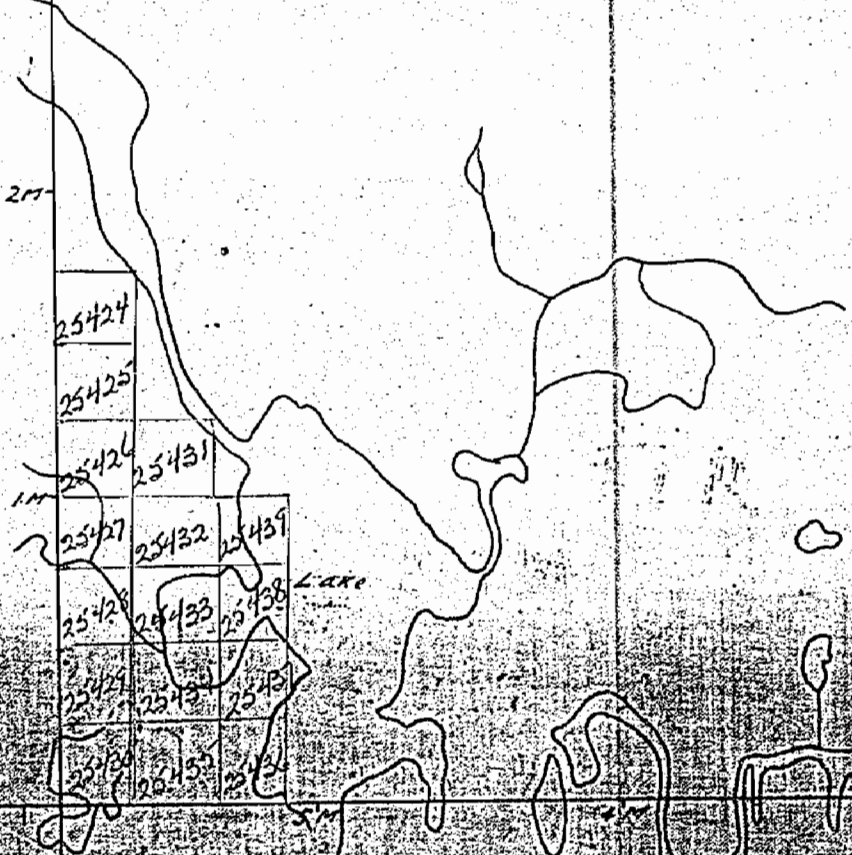

## K E L V I N T W P .

# geology reference-COBALT

RESIDENT GEO.

SOTHMAN TWP. M.1121

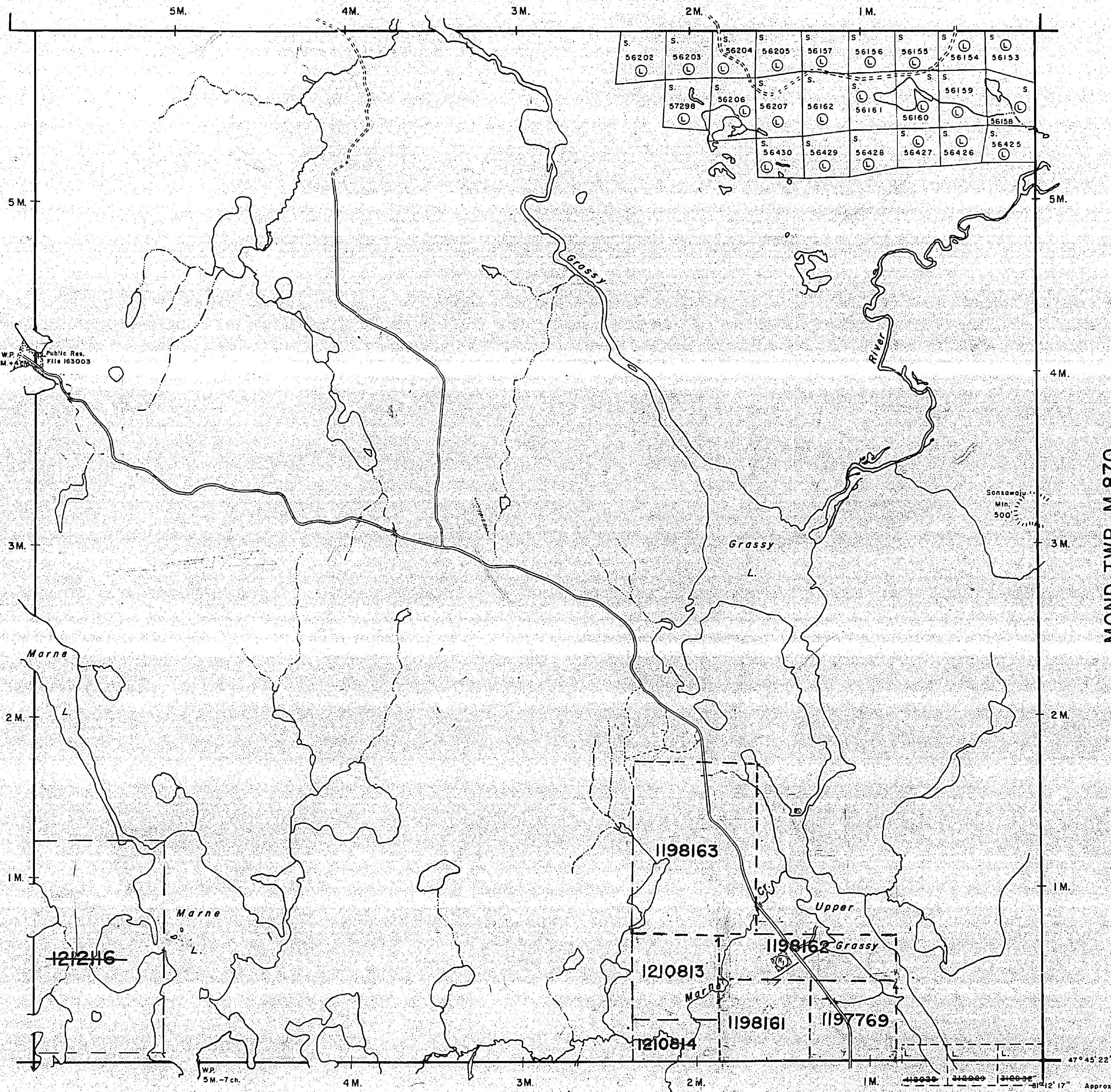

## NOTES

400' surface rights reservation along the shores of all lakes and rivers.

■ Trapline Cabin

Areas withdrawn from staking under Section 43 of the Mining Act, R.S.O. 1970.

Order No.	File	Date	Disposition
(R) w.66/76	188517	19/11/76	S.R.O.

THE INFORMATION THAT APPEARS ON THIS MAP HAS BEEN COMPILED FROM VARIOUS SOURCES, AND ACCURACY IS NOT GUARANTEED. THOSE WISHING TO STAKE MINING CLAIMS SHOULD CONSULT WITH THE MINING RECORDER, MINISTRY OF NORTHERN DEVELOPMENT AND MINES, FOR ADDITIONAL INFORMATION ON THE STATUS OF THE LANDS SHOWN HEREON.

## LEGEND

PATENTED LAND	(P) or (S)
PATENTED FOR SURFACE RIGHTS ONLY	(S)
LEASE	(L)
LICENSE OF OCCUPATION	L.O.
CROWN LAND SALES	C.S.
LOCATED LAND	Loc.
CANCELLED	C.
MINING RIGHTS ONLY	M.R.O.
SURFACE RIGHTS ONLY	S.R.O.
HIGHWAY & ROUTE NO.	(17)
ROADS	—
TRAILS	- - -
RAILWAYS	—+—
POWER LINES	—•—
MARSH OR MUSKEG	(wavy lines)
MINES	(mine symbol)

\*used only with summer resort locations or when space is limited

TOWNSHIP OF

# KEMP

DISTRICT OF  
SUDBURY

LARDER LAKE  
MINING DIVISION

SCALE: 1 INCH = 40 CHAINS (1/2 MILE)

DR. K. INAMOTO

DATE: JUNE '71

PLAN NO. **G.0984**

ONTARIO #3

MINISTRY OF NATURAL RESOURCES

SURVEYS AND MAPPING BRANCH

KELVIN TWP. M.964

COPY OF THIS MYLAR  
ARCHIVED MAY 15/92  
ARCHIVED NOV 1/96

SOTHMAN TWP.

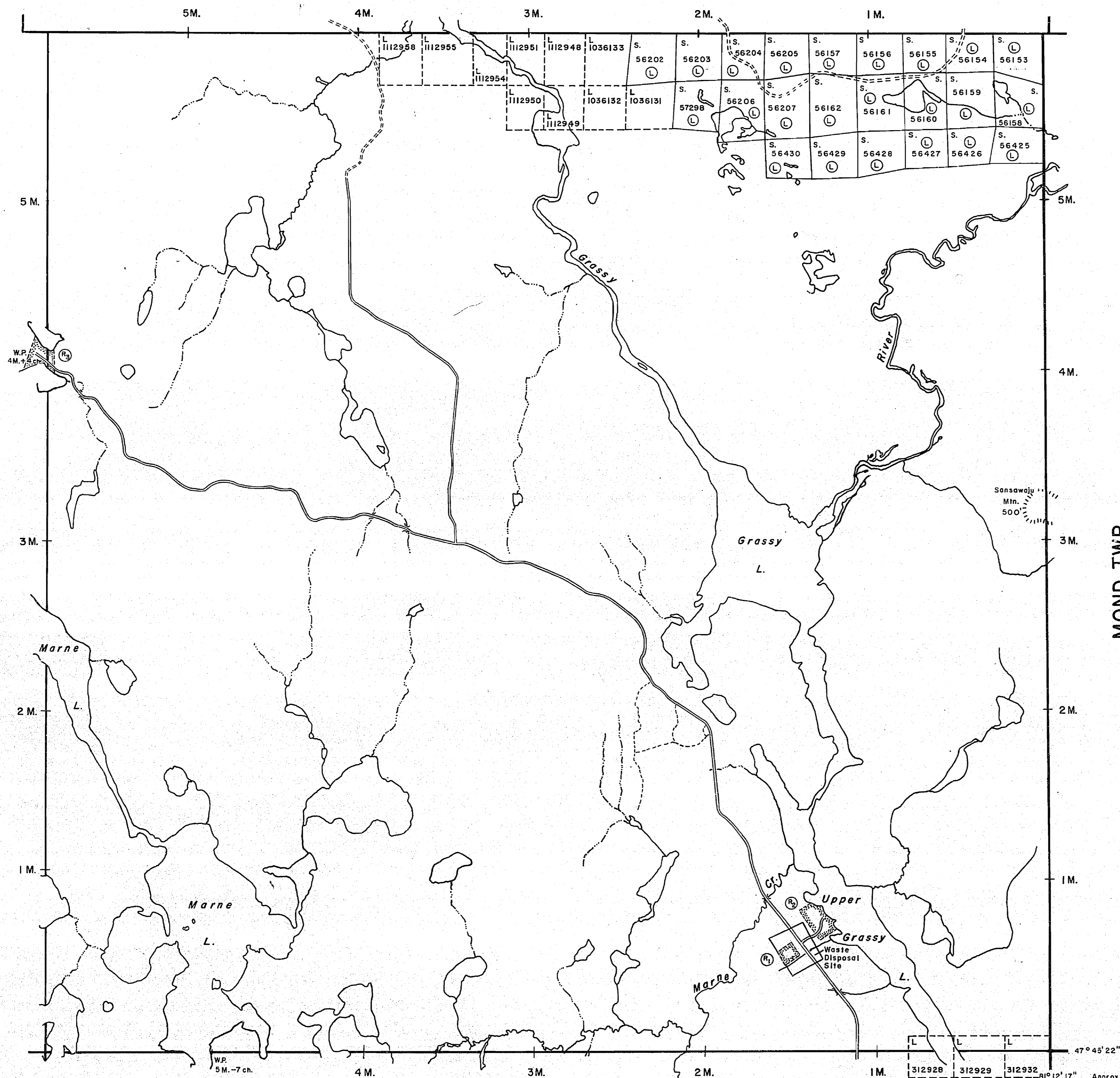

NOTES

400' surface rights reservation along the shores of all lakes and rivers.

AREAS WITHDRAWN FROM DISPOSITION

- M.R.O. - MINING RIGHTS ONLY
- S.R.O. - SURFACE RIGHTS ONLY
- M.+S. - MINING AND SURFACE RIGHTS

Description	Order No.	Date	Disposition	File
(R <sub>1</sub> )	W. 66/76	19/11/76	S.R.O.	188517
(R <sub>2</sub> )				163003
(R <sub>3</sub> )				163003

LEGEND

- PATENTED LAND (P or \*)
- PATENTED FOR SURFACE RIGHTS ONLY (P\*)
- LEASE (L)
- LICENSE OF OCCUPATION (L.O.)
- CROWN LAND SALES (C.S.)
- LOCATED LAND (Loc.)
- CANCELLED (C.)
- MINING RIGHTS ONLY (M.R.O.)
- SURFACE RIGHTS ONLY (S.R.O.)
- HIGHWAY & ROUTE NO. (17)
- ROADS (— — — — —)
- TRAILS (--- ---)
- RAILWAYS (—+—+—+—+—)
- POWER LINES (— — — — —)
- MARSH OR MUSKEG (— — — — —)
- MINES (X)

\*used only with summer resort locations or when space is limited

TOWNSHIP OF

**KEMP**

DISTRICT OF  
SUDBURY

LARDER LAKE  
MINING DIVISION

SCALE : 1 INCH = 40 CHAINS (1/2 MILE)

DR. K. INAMOTO  
DATE NOV. 1989

PLAN NO. **G-984**



Ministry of  
Natural  
Resources

Ministry of  
Northern Development  
and Mines