

Hugel Twp.

Dunnet Twp.

Caldwell Twp.

Macpherson Twp.

THE TOWNSHIP
OF
KIRKPATRICK

DISTRICT OF
NIPISSING

SUDBURY
MINING DIVISION

SCALE: 1-INCH = 40 CHAINS

LEGEND

PATENTED LAND	(P)
CROWN LAND SALE	C.S.
LEASES	(L)
LOCATED LAND	Loc.
LICENSE OF OCCUPATION	L.O.
ROADS	—
IMPROVED ROADS	—
RAILWAYS	—
KING'S HIGHWAY	—
POWER LINES	—
MARSH OR MUSKEG	—
GEODETIC STA.	△
MINES	✕

NOTES

400' Surface Rights Reservation around
all Lakes and Rivers.

Areas withdrawn from staking
43 of the Mining Act (F.S.O.)

Order No. File Date

(R) W. 11/75 14249 S.R.O.

THE INFORMATION THAT
APPEARS ON THIS MAP
HAS BEEN COMPILED
FROM VARIOUS SOURCES,
AND ACCURACY IS NOT
GUARANTEED. THOSE
WISHING TO STAKE MIN-
ING CLAIMS SHOULD CON-
SULT WITH THE MINING
RECORDER, MINISTRY OF
NORTHERN DEVELOP-
MENT AND MINES, FOR AD-
DITIONAL INFORMATION
ON THE STATUS OF THE
LANDS SHOWN HEREON.

KIRKPATRICK
PLAN NO.- M. 971

ONTARIO
MINISTRY OF NATURAL RESOURCES
SURVEYS AND MAPPING BRANCH

971

PROPOSED NATURAL
GAS PIPELINE

Hugel Twp.

THE TOWNSHIP #11
OF
KIRKPATRICK

DISTRICT OF
NIPISSING

SUDBURY
MINING DIVISION

SCALE: 1-INCH = 40 CHAINS

LEGEND

PATENTED LAND	Ⓟ
CROWN LAND SALE	CS
LEASES	Ⓛ
LOCATED LAND	Loc.
LICENSE OF OCCUPATION	L.O.
ROADS	—
IMPROVED ROADS	—
RAILWAYS	—
KING'S HIGHWAY	—
POWER LINES	—
MARSH OR MUSKEG	—
GEODETIC STA.	Δ
MINES	X

NOTES

M-971

PLAN NO. S-287

DEPARTMENT OF MINES
—ONTARIO—

Dunnet Twp.

Caldwell Twp.

Macpherson Twp.

VI

V

IV

III

II

I

12 11 10 9 8 7 6 5 4 3 2 1

971

KIRKPATRICK

Scale 40 Chains to an inch

Hugel

DUNNET

CALDWELL

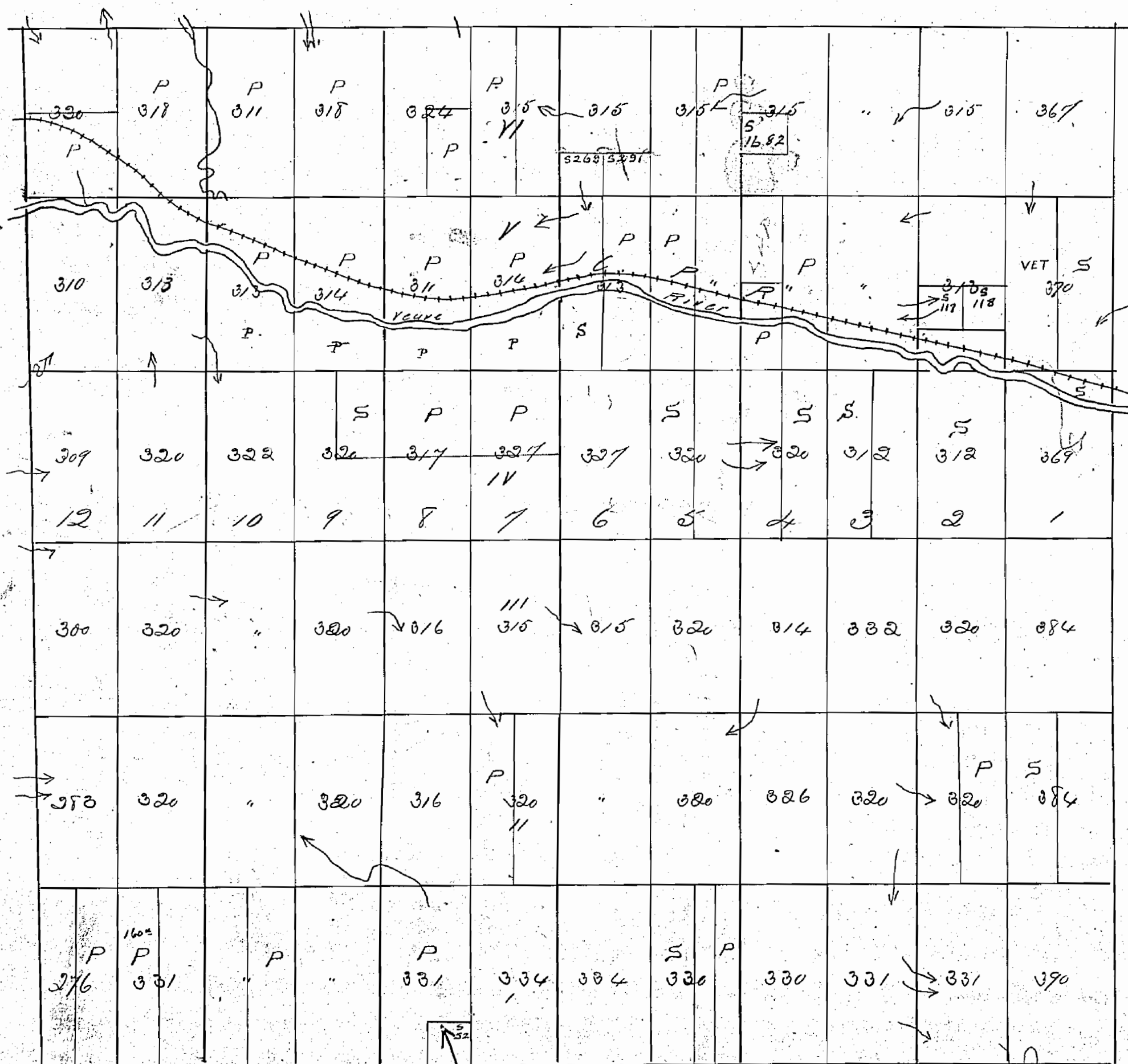

m971

PROPOSED NATURAL GAS PIPELINE

Hugel Twp.

THE TOWNSHIP #11
OF
KIRKPATRICK
DISTRICT OF NIPISSING
SUDBURY MINING DIVISION
SCALE: 1-INCH = 40 CHAINS

Dunnet Twp.

Caldwell Twp.

VI

V

IV

III

II

I

Macpherson Twp.

LEGEND

PATENTED LAND	Ⓟ
CROWN LAND SALE	C.S.
LEASES	Ⓛ
LOCATED LAND	Loc.
LICENSE OF OCCUPATION	L.O.
ROADS	— — — — —
IMPROVED ROADS	— — — — —
RAILWAYS	— — — — —
KING'S HIGHWAY	— — — — —
POWER LINES	— — — — —
MARSH OR MUSKEG	* * *
GEODETIC STA.	Δ
MINES	⋈

NOTES

M-971

PLAN NO. S.287

DEPARTMENT OF MINES
—ONTARIO—

Dunnet Twp.

Hugel Twp.

Caldwell Twp.

Macpherson Twp.

THE TOWNSHIP
OF
KIRKPATRICK
DISTRICT OF
NIPISSING,
SUDBURY
MINING DIVISION
SCALE: 1-INCH = 40 CHAINS

LEGEND

- | | |
|-----------------------|-----------|
| PATENTED LAND | Ⓟ |
| CROWN LAND SALE | C.S. |
| LEASES | Ⓛ |
| LOCATED LAND | Loc. |
| LICENSE OF OCCUPATION | L.O. |
| ROADS | — — — — — |
| IMPROVED ROADS | — — — — — |
| RAILWAYS | — — — — — |
| KING'S HIGHWAY | — — — — — |
| POWER LINES | — — — — — |
| MARSH OR MUSKEG | — — — — — |
| GEODETIC STA. | Δ |
| MINES | ✕ |

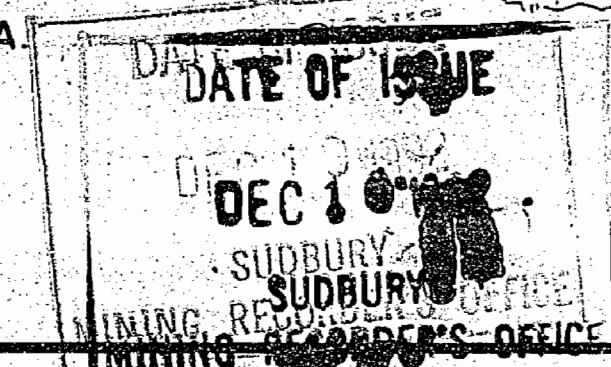

NOTES

400' Surface Rights Reservation around
all Lakes and Rivers.

Areas withdrawn from staking
43 of the Mining Act (F.S.O.)
Order No. File Date

W. 11/75 14249 S.R.O.

THE INFORMATION THAT
APPEARS ON THIS MAP
HAS BEEN COMPILED
FROM VARIOUS SOURCES,
AND ACCURACY IS NOT
GUARANTEED. THOSE
WISHING TO STAKE MIN-
ING CLAIMS SHOULD CON-
SULT WITH THE MINING
RECORDER, MINISTRY OF
NORTHERN DEVELOP-
MENT AND MINES, FOR AD-
DITIONAL INFORMATION
ON THE STATUS OF THE
LANDS SHOWN HEREON.

KIRKPATRICK
PLAN NO. - M. 971

ONTARIO
MINISTRY OF NATURAL RESOURCES
SURVEYS AND MAPPING BRANCH

971

KIRKPATRICK

Scale 40 Chains to an inch

Hugel

DUNNET

CALDWELL

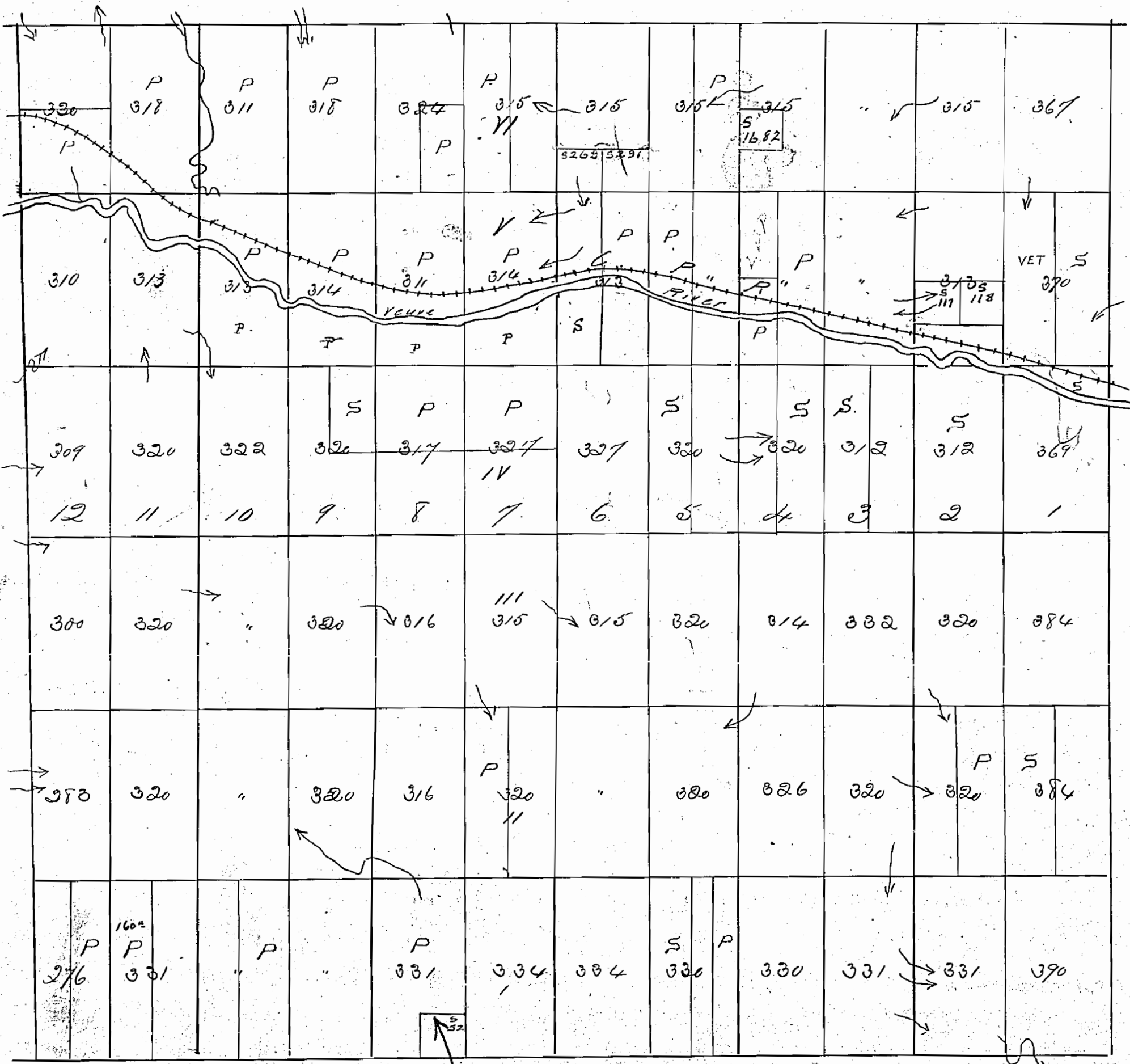

m971

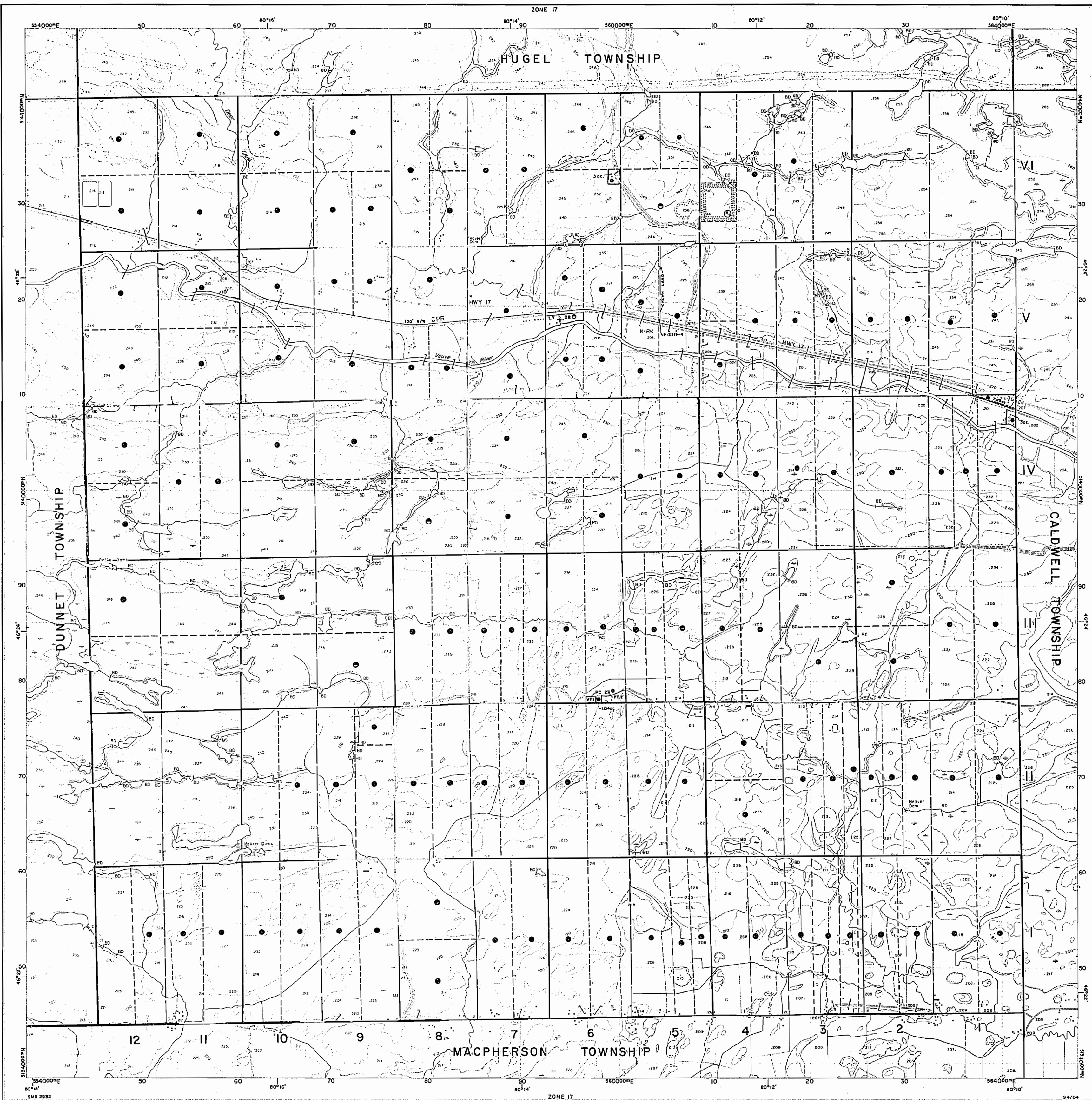

Ministry of
Natural
Resources

Ministry of
Northern Development
and Mines

In Service March 10, 1995

INDEX TO LAND DISPOSITION

PLAN
G-2932
TOWNSHIP

M.N.R. ADMINISTRATIVE DISTRICT
NORTH BAY
MINING DIVISION
SUDBURY
LAND TITLES/REGISTRY DIVISION
NIPISSING

KIRKPATRICK

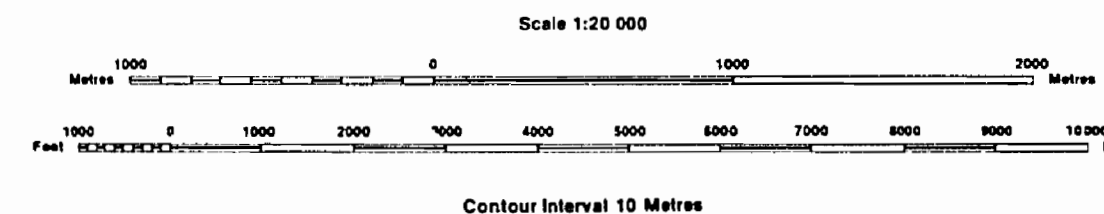

THE INFORMATION THAT
APPEARS ON THIS MAP
HAS BEEN COMPILED
FROM VARIOUS SOURCES
AND ACCURACY IS NOT
GUARANTEED. THOSE
WISHING TO STAKE MIN-
ING CLAIMS SHOULD CON-
SULT WITH THE MINING
RECORDER, MINISTRY OF
NORTHERN DEVELOP-
MENT AND MINES, FOR AD-
DITIONAL INFORMATION
ON THE STATUS OF THE
LANDS SHOWN HEREON.

AREAS WITHDRAWN FROM DISPOSITION

Description	Order No.	Date	Disposition	File
MRO - Mining Rights Only				
SRO - Surface Rights Only				
M + S - Mining and Surface Rights				
W.11/15	20/2/75	SRO		14249

SYMBOLS

Boundary	
Township, Meridian, Baseline	
Road allowance; surveyed	
shoreline	
Lot/Concession; surveyed	
unsurveyed	
Parcel; surveyed	
unsurveyed	
Right-of-way; road	
railway	
utility	
Reservation	
Cliff, Pit, Pile	
Contour	
Interpolated	
Approximate	
Depression	
Control point (horizontal)	
Flooded land	
Mine head frame	
Pipeline (above ground)	
Railway; single track	
double track	
abandoned	
Road; highway, county, township	
access	
trail, bush	
Shoreline (original)	
Transmission line	
Wooded area	

DISPOSITION OF CROWN LANDS

Patent	
Surface & Mining Rights	
Surface Rights Only	
Mining Rights Only	
Lease	
Surface & Mining Rights	
Surface Rights Only	
Mining Rights Only	
Licence of Occupation	
Order-in-Council	
Cancelled	
Reservation	
Sand & Gravel	