

Marven Twp.

THE TOWNSHIP OF

LEITCH

DISTRICT OF COCHRANE

PORCUPINE MINING DIVISION

SCALE: 1-INCH=40 CHAINS

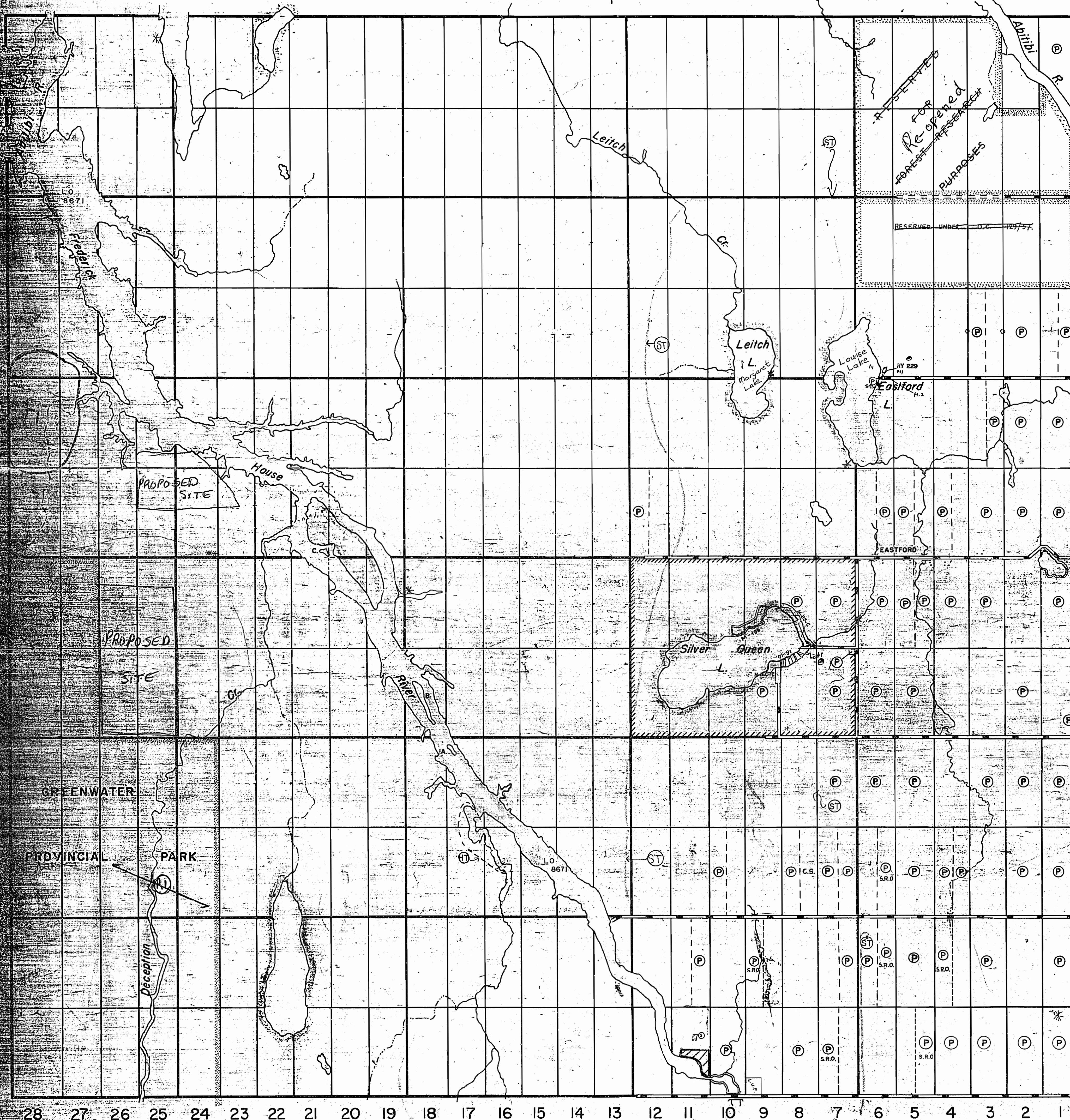

XII  
 XI  
 X  
 IX  
 VIII  
 VII  
 VI  
 V  
 IV  
 III  
 II  
 I

LEGEND

- PATENTED LAND (P)
- CROWN LAND SALE (C.S.)
- LEASES (L)
- LOCATED LAND (Loc.)
- LICENSE OF OCCUPATION (L.O.)
- ROADS (—)
- IMPROVED ROADS (—)
- WATER POWER LEASE (W.P.L.)
- RAILWAYS (—)
- POWER LINES (—)
- MARSH OR MUSKOGEE (—)
- LAND USE PERMIT (—)

NOTES

- 400' Surface Rights Reservation around all Lakes and Rivers.
- Flooding rights on lands bordering the Abitibi & Frederick River, L.O. 8671
- Silver Queen Lake Subdivision shown thus: [hatched pattern]
- Areas withdrawn from staking under section 43 of the Mining Act, R.S.O. 1920

Order No.	File	Date	Disposition
W. 69,75	163318	19/12/75	...

- S.U.P. \* FOR RECREATIONAL USE DEC 15/92 TO DEC 14/95
- POLAR BEAR RIDERS
- SNOWMOBILE TRAIL 92-SEP-27 NOTICE RECEIVED 95-JAN-16
- THIS TWP IS SUBJECT TO FOREST ACTIVITIES IN 1994/95
- PENDING APPLICATION FOR HIKING TRAIL MAY 15/98

SAND AND GRAVEL

- Q QUARRY PERMIT

THE INFORMATION THAT APPEARS ON THIS MAP HAS BEEN COMPILED FROM VARIOUS SOURCES, AND ACCURACY IS NOT GUARANTEED. THOSE WISHING TO STAKE MINING CLAIMS SHOULD CONSULT WITH THE MINING RECORDER, MINISTRY OF NORTHERN DEVELOPMENT AND MINES, FOR ADDITIONAL INFORMATION ON THE STATUS OF THE LANDS SHOWN HEREON.

PLAN NO. - M-530

ONTARIO  
 MINISTRY OF NATURAL RESOURCES  
 SURVEYS AND MAPPING BRANCH

28 27 26 25 24 23 22 21 20 19 18 17 16 15 14 13 12 11 10 9 8 7 6 5 4 3 2 1

Clute Twp.

Blount Twp.

Marven Twp.

~~M-530~~

THE TOWNSHIP OF LEITCH

DISTRICT OF COCHRANE  
PORCUPINE MINING DIVISION

M 530 B5

SCALE: 1-INCH = 40 CHAINS

LEGEND

- PATENTED LAND
- CROWN LAND SALE
- LEASES
- LOCATED LAND
- LICENSE OF OCCUPATION
- ROADS
- IMPROVED ROADS
- WATER POWER LEASE
- RAILWAYS
- POWER LINES
- MARSH OR MUSKEG

NOTES

400' Surface Rights Reservation around all Lakes and Rivers.

Flooding rights on lands bordering the Abitibi & Frederick River

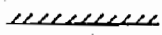
Silver Queen Lake Subdivision shown thus: 

~~Mining Rights Only to apply on mining claims staked out and recorded on or after July 25, 1950 in this Township Ontario Regulation 169-50, Ontario Gazette Aug. 5, 1950.~~

By O. Reg. 199-50, effective Sept 1, 1950, mining rights in this township are withdrawn from disposition under The Public Lands Act.

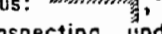
Area shown thus: , withdrawn from staking and prospecting under Section 42 of the Mining Act, by reg 136/57 JUN 10 1957

*Land Use Permit*

MINING RECORDER RECEIVED  
NOV 9 1962

PORCUPINE MINING DIVISION

PLAN NO. - M-530

DEPARTMENT OF MINES - ONTARIO -

Colquhoun Twp.

Blount Twp.

XII  
XI  
X  
IX  
VIII  
VII  
VI  
V  
IV  
III  
II  
I

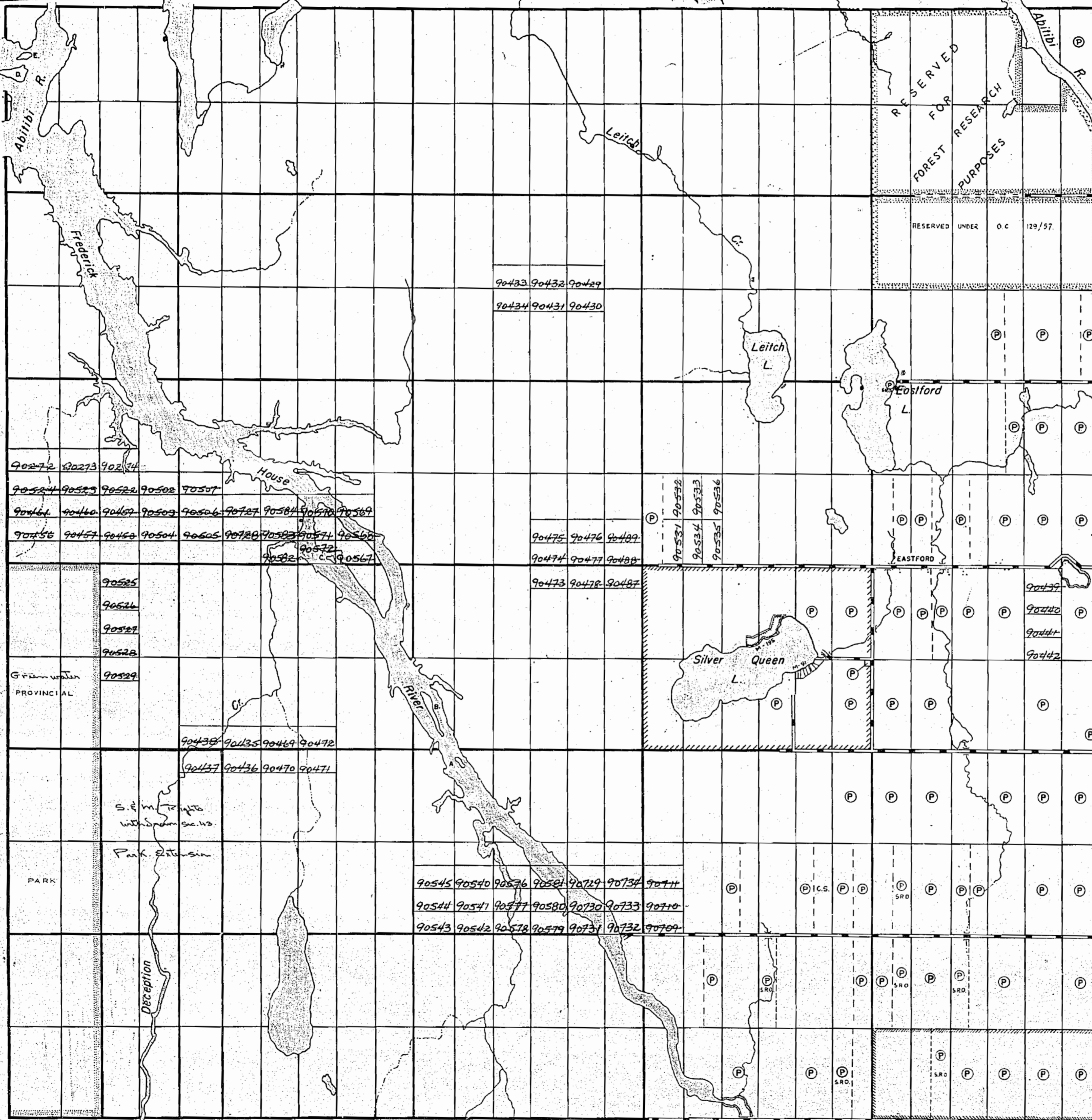

28 27 26 25 24 23 22 21 20 19 18 17 16 15 14 13 12 11 10 9 8 7 6 5 4 3 2 1

Clute Twp.

~~M-530~~

Marven Twp.

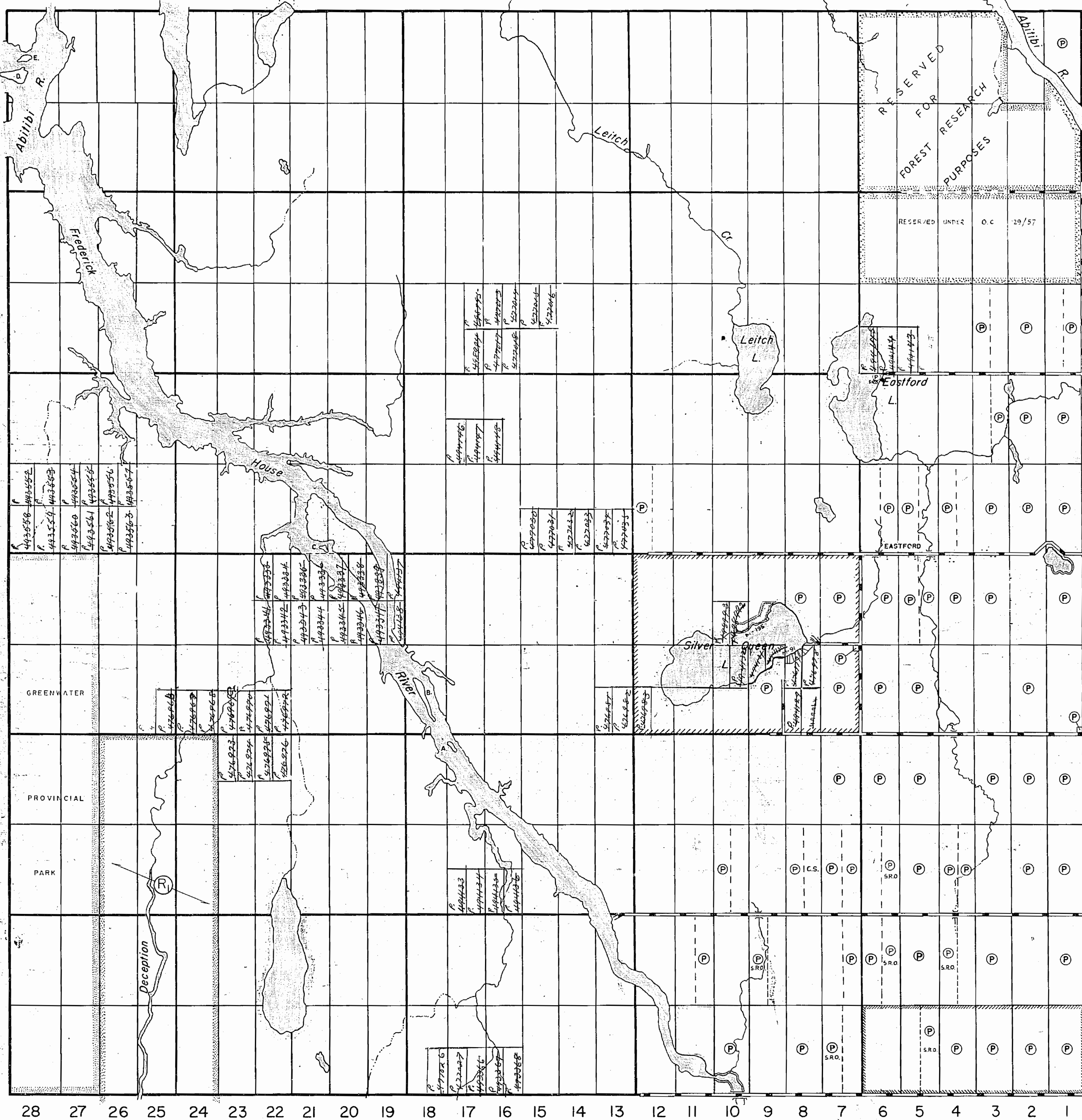

XII

XI

X

IX

VIII

VII

VI

V

IV

III

II

I

THE TOWNSHIP OF

LEITCH

DISTRICT OF COCHRANE

PORCUPINE MINING DIVISION

SCALE: 1-INCH=40 CHAINS

LEGEND

- PATENTED LAND (P)
- CROWN LAND SALE (C.S.)
- LEASES (L)
- LOCATED LAND (Loc.)
- LICENSE OF OCCUPATION (L.O.)
- ROADS (---)
- IMPROVED ROADS (—+—)
- WATER POWER LEASE (W.P.L.)
- RAILWAYS (—+—+—)
- POWER LINES (—+—+—)
- MARSH OR MUSKEG (shaded area)

NOTES

400' Surface Rights Reservation around all Lakes and Rivers.

Flooding rights on lands bordering the Abitibi & Frederick River

Silver Queen Lake Subdivision shown thus: [hatched pattern]

Areas withdrawn from staking under Section 43 of the Mining Act, R.S.O. 1970.

Order No.	File	Date	Disposition
W 69/75	163315	19/12/75	S.R. & M.R.

Area shown thus: [hatched pattern], withdrawn from staking and prospecting under Section 42 of the Mining Act, by reg 136/57 JUN 10 1957

Order received March 16/77 by Ontario Council #694/77 Lot 5 & 6, Cont.

D.U.P.

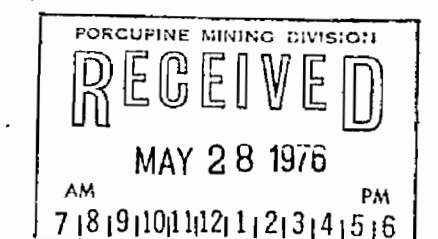
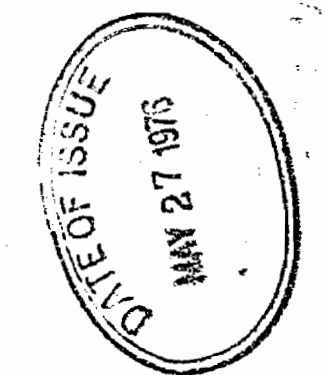

PLAN NO. - M-530

ONTARIO MINISTRY OF NATURAL RESOURCES SURVEYS AND MAPPING BRANCH

Colquhoun Twp.

Blount Twp.

Clute Twp.

26  
10  
10

**INDEX TO LAND DISPOSITION**

PLAN  
**G - 3667**  
 TOWNSHIP  
**LEITH**

M.N.R. ADMINISTRATIVE DISTRICT  
**KIRKLAND LAKE**  
 MINING DIVISION  
**LARDER LAKE**  
 LAND TITLES/REGISTRY DIVISION  
**TIMISKAMING**

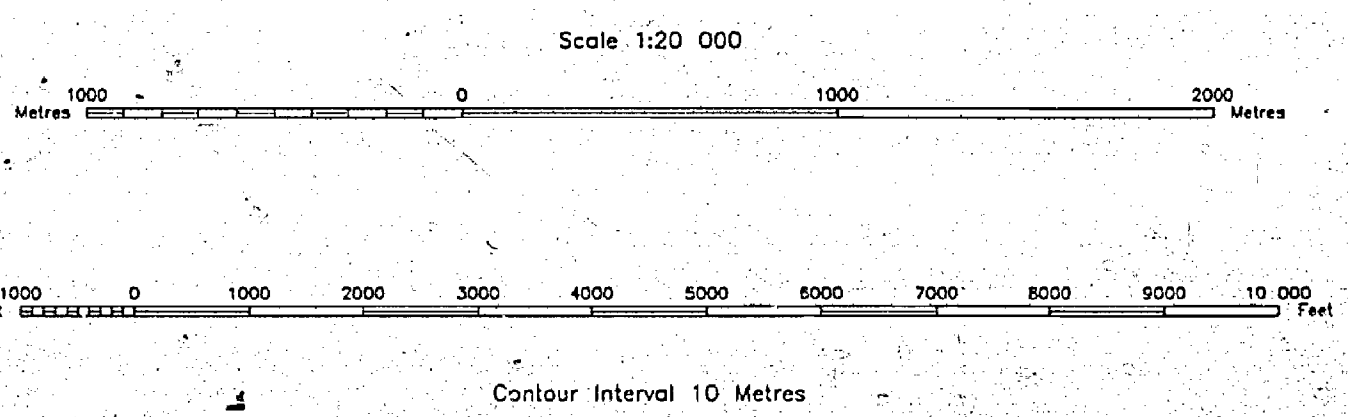

**AREAS WITHDRAWN FROM DISPOSITION**

MRQ - Mining Rights Only  
 SRO - Surface Rights Only  
 M+S - Mining and Surface Rights

**SYMBOLS**

Boundary	
Administrative District	—
Township, Meridian, Baseline	—
Road allowance: surveyed	—
Lot/Concession: surveyed	—
unsurveyed	—
Parcel: surveyed	—
unsurveyed	—
Right-of-way: road	—
railway	—
utility	—
Reservation	—
Cliff, Pit, Filling	—
Contour	—
Interpolated	—
Approximate	—
Depression	—
Control point (horizontal)	—
Flooded land	—
Mine shaft	—
Pipeline (above ground)	—
Railway: single track	—
double track	—
abandoned	—
River/Stream/Creek	—
intermittent	—
Road: highway, county, township	—
access	—
trail, bush	—
Shoreline (original)	—
Transmission line	—
Wooded area	—

400' Surface Rights along the shores of all lakes and rivers

**DISPOSITION OF CROWN LANDS**

Patent	
Surface & Mining Rights	●
Surface Rights Only	○
Mining Rights Only	◐
Lease	
Surface & Mining Rights	■
Surface Rights Only	□
Mining Rights Only	◻
Licence of Occupation	
Order-in-Council	◊
Cancelled	◌
Reservation	◐
Sand & Gravel	◑
Land Use permit	◒

THE INFORMATION THAT APPEARS ON THIS MAP HAS BEEN COMPILED FROM VARIOUS SOURCES AND ACCURACY IS NOT GUARANTEED. THOSE WISHING TO STAKE MINING CLAIMS SHOULD CONSULT WITH THE MINING RECORDER, MINISTRY OF NORTHERN DEVELOPMENT AND MINES, FOR ADDITIONAL INFORMATION ON THE STATUS OF THE LANDS SHOWN HEREON.

CIRCULATED AUGUST 19, 1996  
 ARCHIVED SEPT. 19, 1996

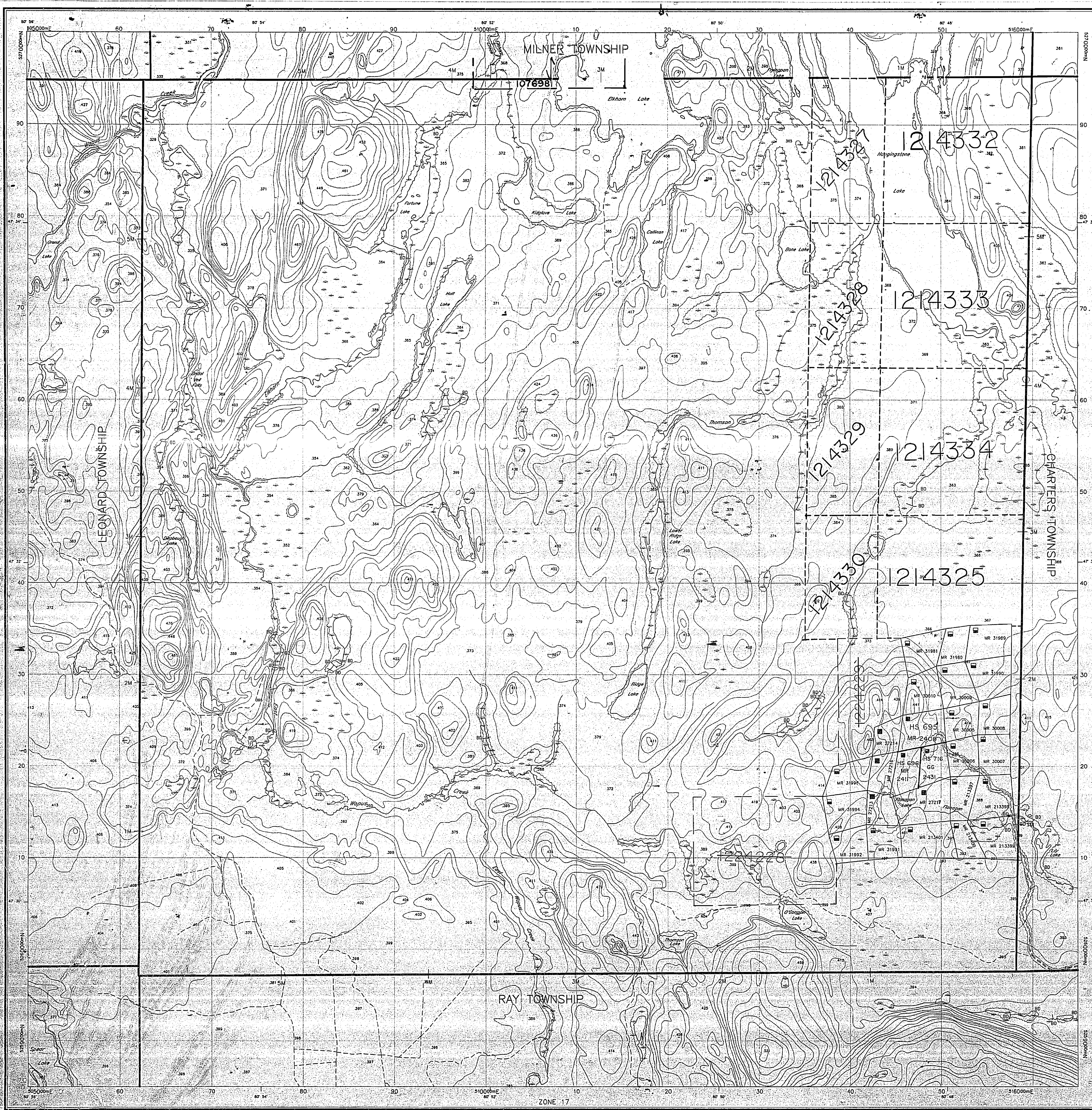

LEITH G 3667

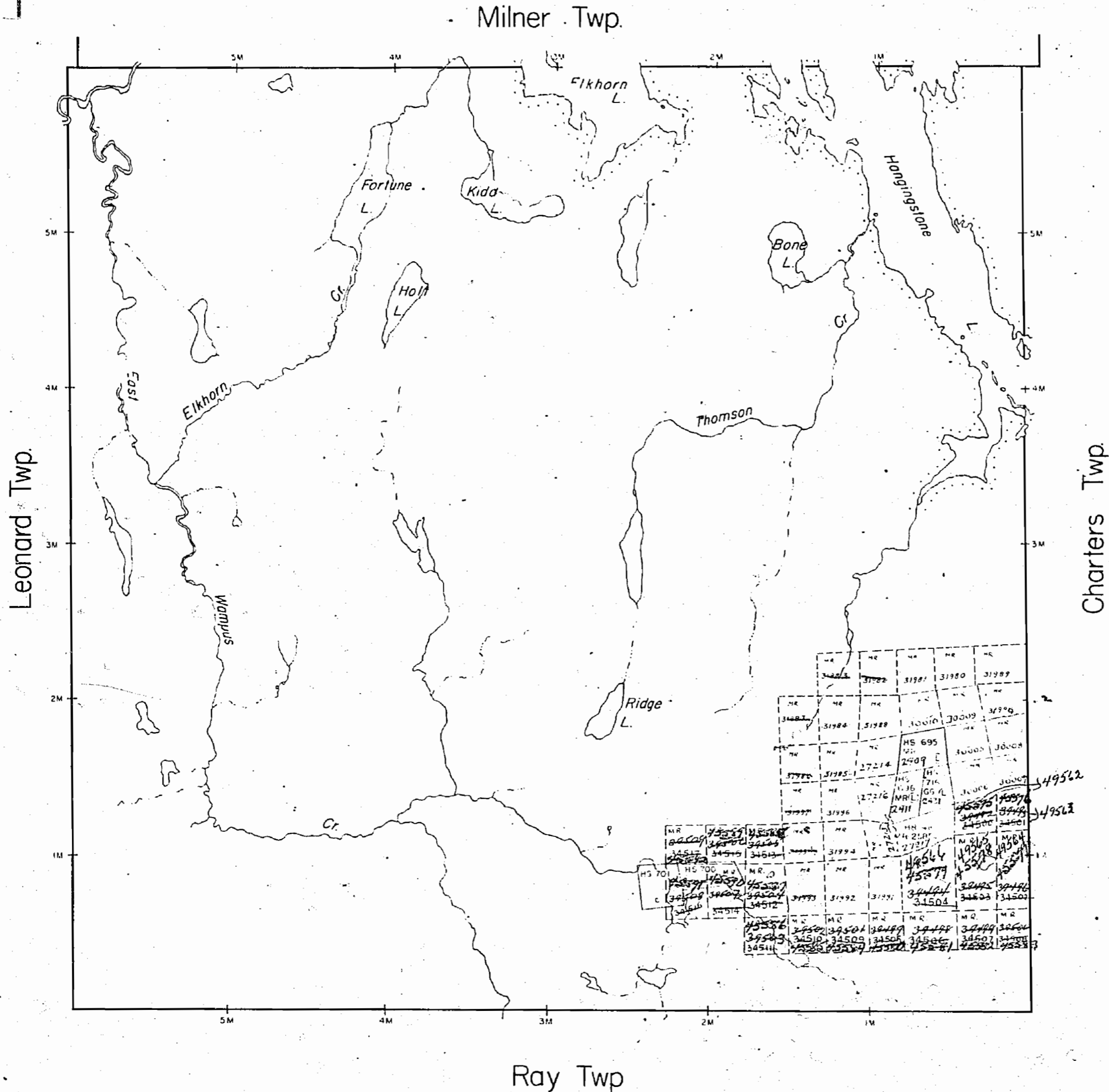

THE TOWNSHIP OF

# LEITH

DISTRICT OF  
TIMISKAMING

MONTREAL RIVER  
MINING DIVISION

SCALE: 1-INCH=40 CHAINS

### LEGEND

PATENTED LAND	Ⓟ
CROWN LAND SALE	C.S.
LEASES	Ⓛ
LOCATED LAND	Loc.
LICENSE OF OCCUPATION	L.O.
MINING RIGHTS ONLY	M.R.O.
SURFACE RIGHTS ONLY	S.R.O.
ROADS	—
IMPROVED ROADS	—
KING'S HIGHWAYS	—
RAILWAYS	—
POWER LINES	—
MARSH OR MUSKEG	—
MINES	✕

### NOTES

Note: This Twp. Lies in the  
TIMAGAMI PROVINCIAL FOREST

400' Surface rights reservation around all lakes  
and rivers.



PLAN NO - M-231

DEPARTMENT OF MINES  
— ONTARIO —

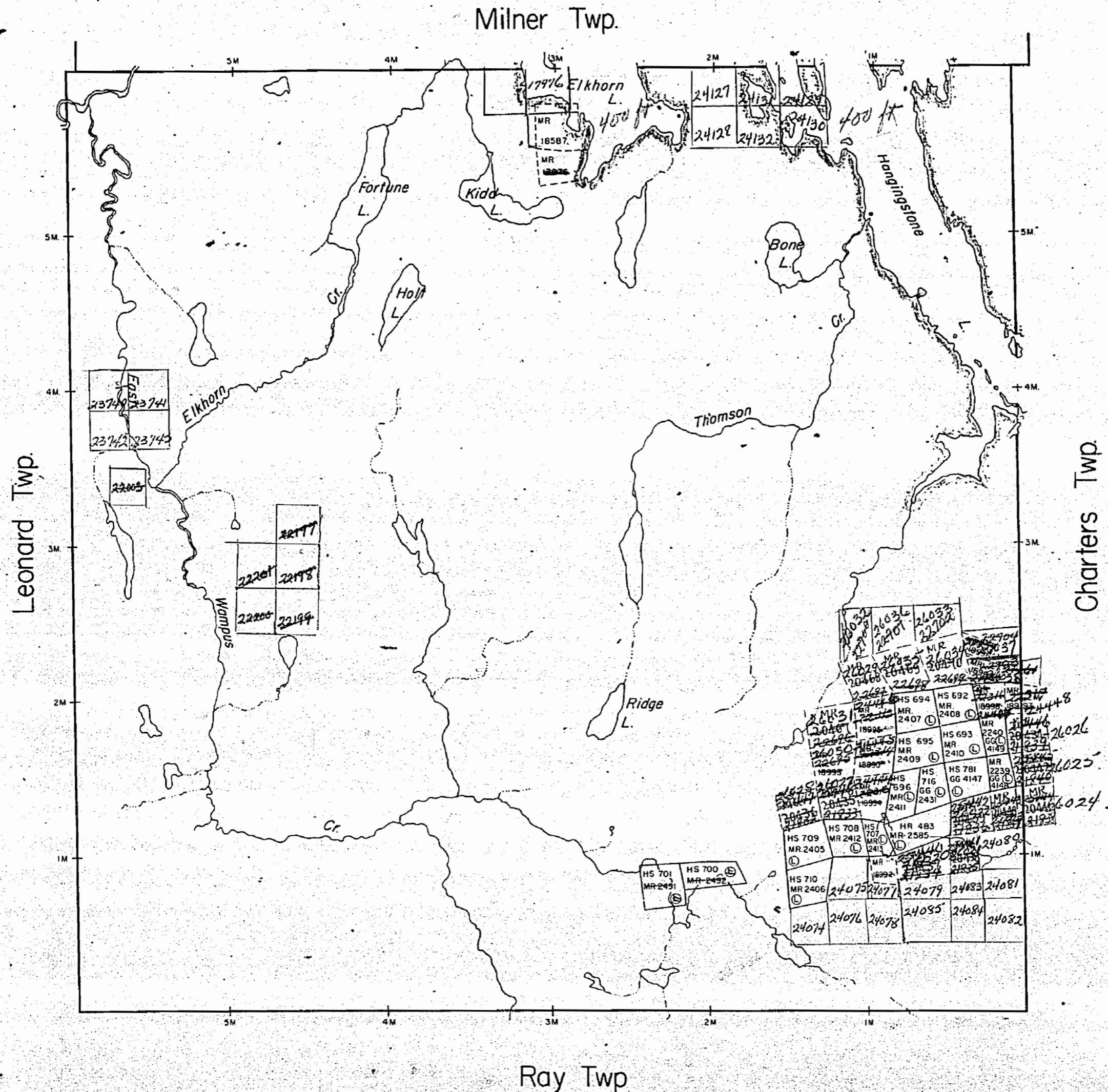

THE TOWNSHIP OF

# LEITH

DISTRICT OF  
TIMISKAMING

MONTREAL RIVER  
MINING DIVISION

SCALE: 1-INCH= 40 CHAINS

### LEGEND

- PATENTED LAND ⊙
- CROWN LAND SALE C.S.
- LEASES ⊖
- LOCATED LAND Loc.
- LICENSE OF OCCUPATION L.O.
- MINING RIGHTS ONLY M.R.O.
- SURFACE RIGHTS ONLY S.R.O.
- ROADS —
- IMPROVED ROADS —
- KING'S HIGHWAYS —
- RAILWAYS —
- POWER LINES —
- MARSH OR MUSKEG —
- MINES X

### NOTES

Note: This Twp. Lies in the  
TIMAGAMI PROVINCIAL FOREST

200' Reserve to Dept. of Lands & Forest  
shown thus: —

M 231

PLAN NO - MR 30

DEPARTMENT OF MINES  
—ONTARIO—

Marven Twp.

Colquhoun Twp.

Clute Twp.

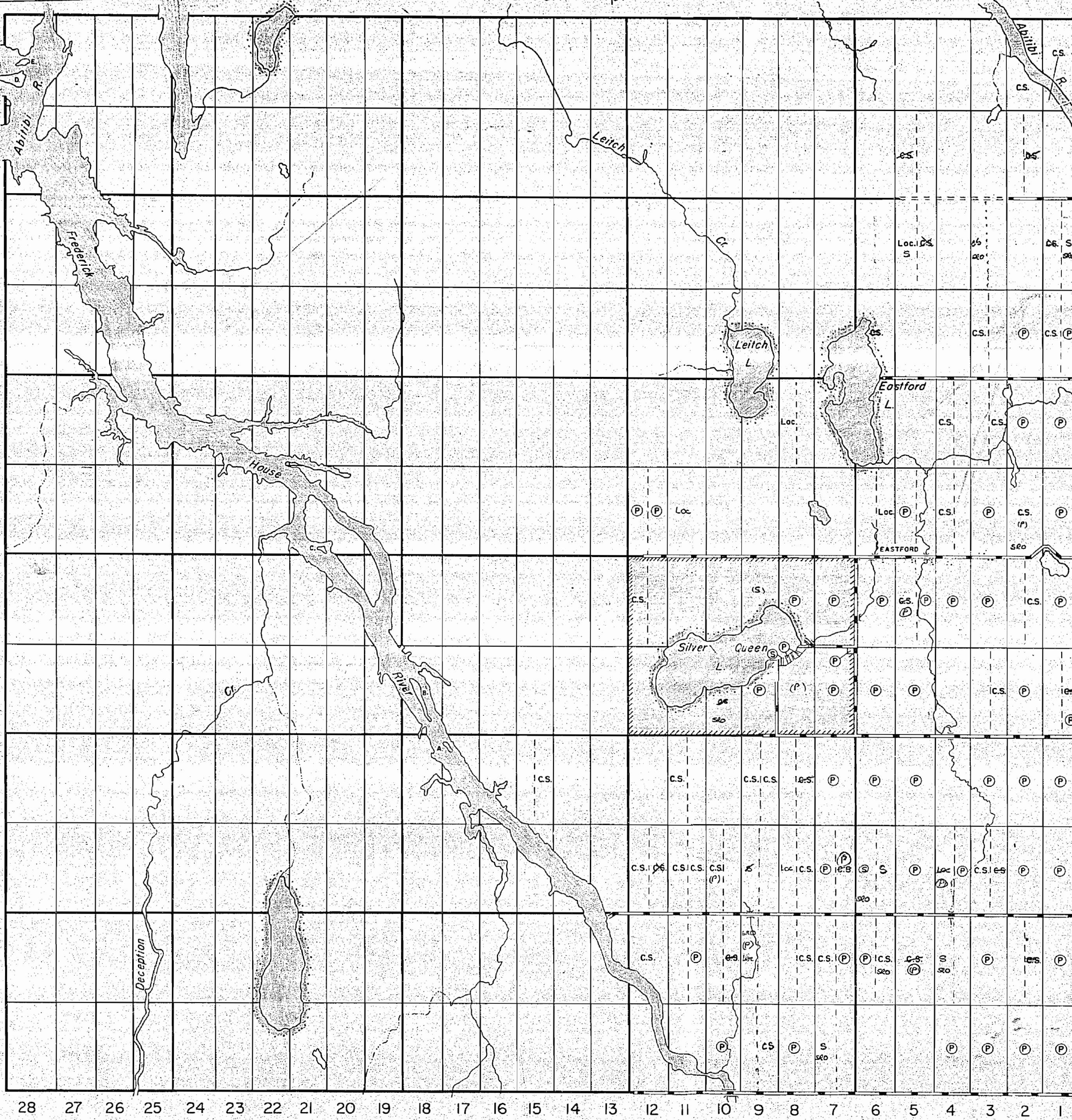

THE TOWNSHIP  
OF  
**LEITCH**  
DISTRICT OF  
COCHRANE  
TIMISKAMING  
MINING DIVISION  
SCALE: 1-INCH=40 CHAINS

LEGEND

- PATENTED LAND (P)
- CROWN LAND SALE (C.S.)
- LEASES (L)
- LOCATED LAND (Loc.)
- LICENSE OF OCCUPATION (L.O.)
- ROADS (---)
- IMPROVED ROADS (—)
- WATER POWER LEASE (W.P.L.)
- RAILWAYS (—+—+—)
- POWER LINES (—o—o—)
- MARSH OR MUSKEG (---)

NOTES

Reserve to Dept. of Lands & Forest shown thus: (---)

Flooding rights on lands bordering the Abitibi & Frederick River

Silver Queen Lake Subdivision shown thus: (hatched)



*Mining rights only - 25 July 50*

*M-530*

PLAN NO. - T.117.

DEPARTMENT OF MINING  
—ONTARIO—

530

Marven Twp.

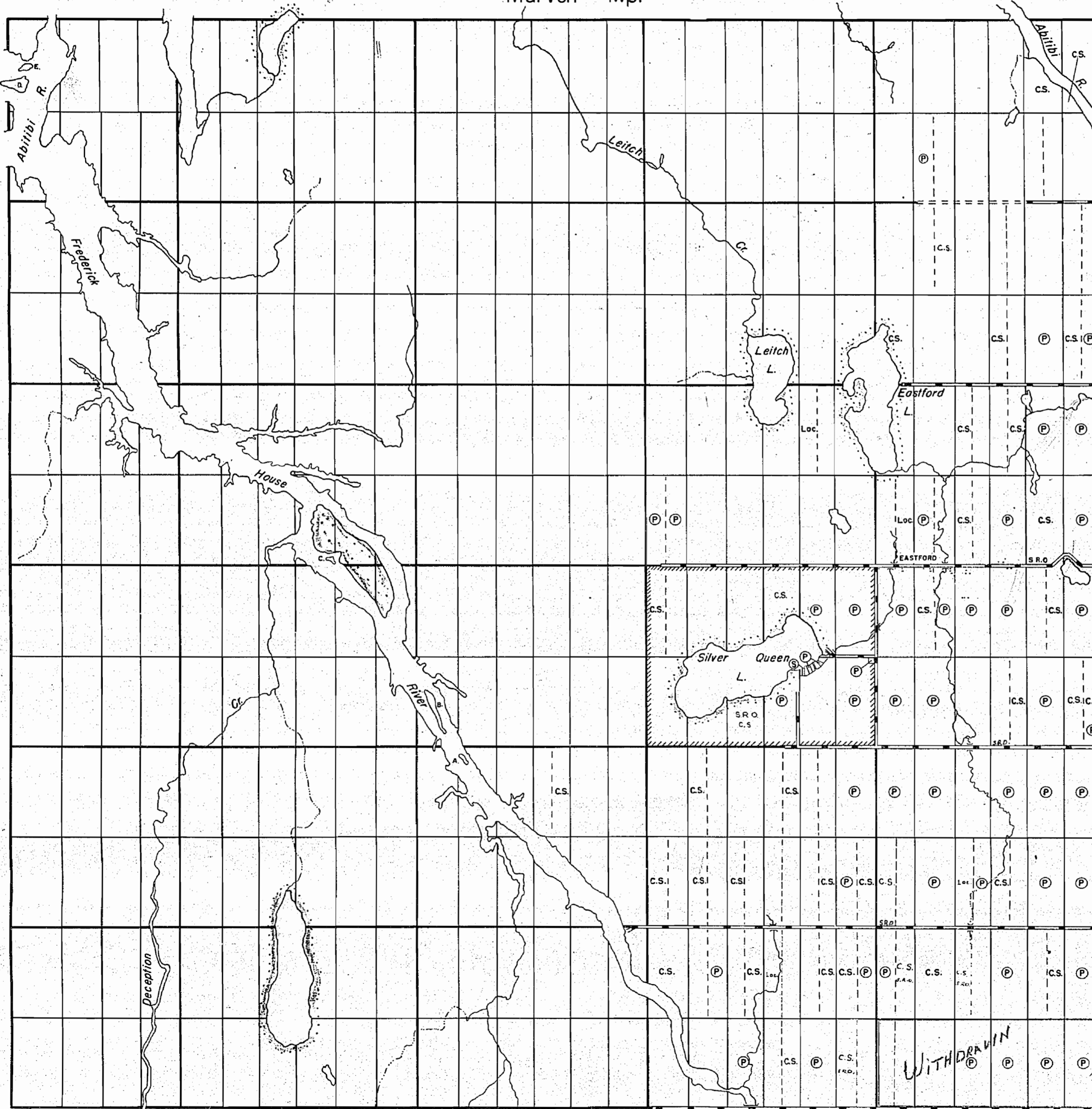

XII

XI

X

IX

VIII

VII

VI

V

IV

III

II

I

THE TOWNSHIP  
OF  
**LEITCH**

DISTRICT OF  
COCHRANE  
PORCUPINE  
MINING DIVISION

SCALE: 1-INCH=40 CHAINS

LEGEND

PATENTED LAND	(P)
CROWN LAND SALE	(C.S.)
LEASES	(L)
LOCATED LAND	(Loc.)
LICENSE OF OCCUPATION	(L.O.)
ROADS	(---)
IMPROVED ROADS	(=)
WATER POWER LEASE	(W.P.L.)
RAILWAYS	(---)
POWER LINES	(---)
MARSH OR MUSKEG	(---)

NOTES

400' Reserve to Dept. of Lands & Forest shown thus: (---)

Flooding rights on lands bordering the Abitibi & Frederick River

Silver Queen Lake Subdivision shown thus: (---)

Mining Rights Only to apply on mining claims staked out and recorded on or after July 25, 1950 in this Township. Ontario Regulation 169-50, Ontario gazette. Aug. 5, 1950.

By O. Reg. 199-50 which amends previous regulations and which is effective as of Sept. 1, 1950, the mines & minerals in this Township are reserved.

See Road Roll

WITHDRAWN

Clute Twp.

PLAN NO. - M-530

DEPARTMENT OF MINES  
—ONTARIO—



# LEITCH.

30

DISTRICT OF SUBURRY  
now Timiskaming.  
Scale: 40 Chs. = 1 Inch.

M530

White C. D. before recording claim

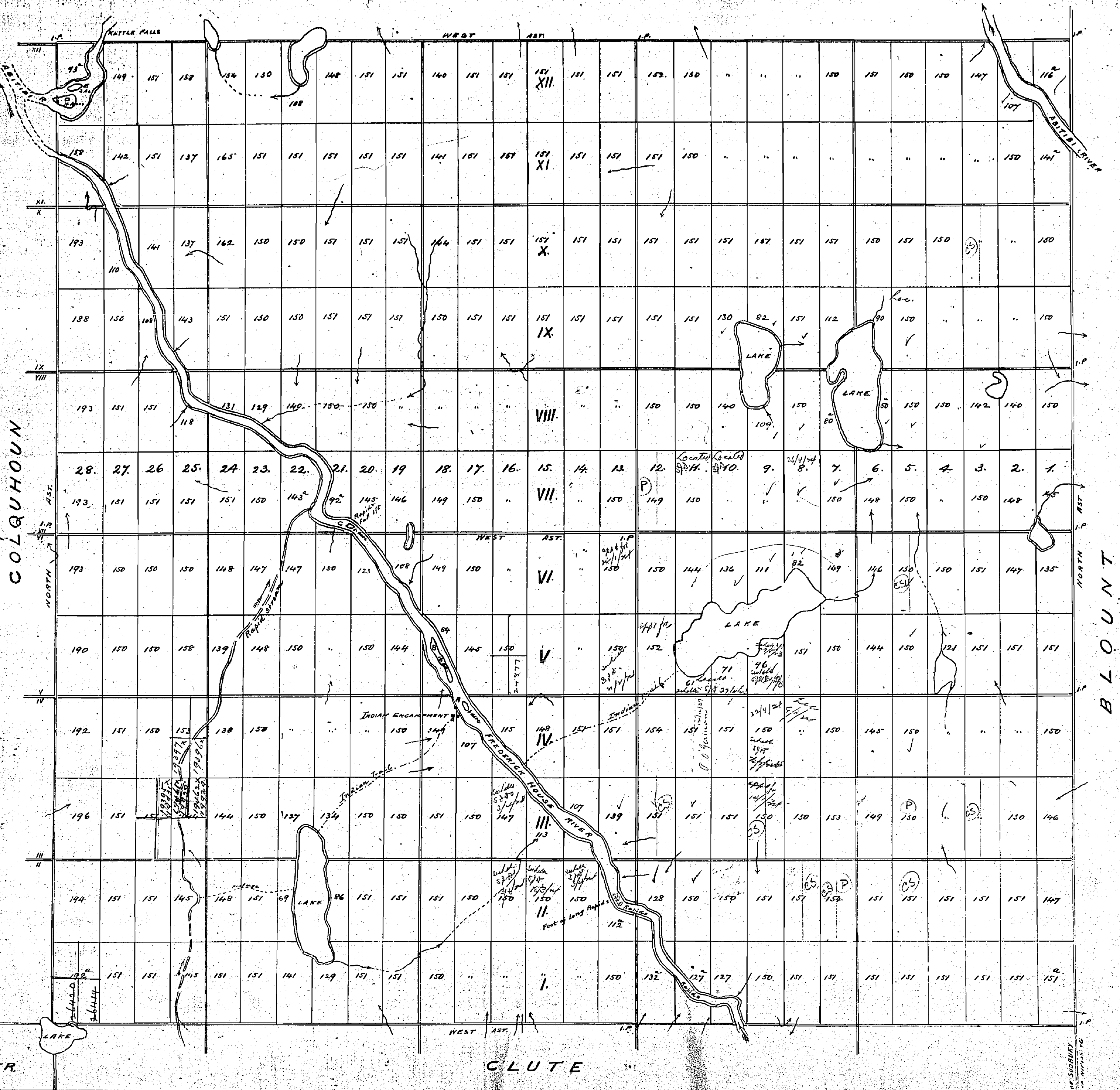

ALDER

DISTRICT OF SUBURRY  
DISTRICT OF TIMISKAMING

*M-530*

THE TOWNSHIP OF LEITCH

DISTRICT OF COCHRANE  
PORCUPINE MINING DIVISION

M 530 85

SCALE: 1-INCH=40 CHAINS

LEGEND

- PATENTED LAND (P)
- CROWN LAND SALE (C.S.)
- LEASES (L)
- LOCATED LAND (Loc.)
- LICENSE OF OCCUPATION (L.O.)
- ROADS (---)
- IMPROVED ROADS (—+—)
- WATER POWER LEASE (W.P.L.)
- RAILWAYS (—+—+—)
- POWER LINES (—o—o—)
- MARSH OR MUSKEG (---)

NOTES

400' Surface Rights Reservation around all Lakes and Rivers.

Flooding rights on lands bordering the Abitibi & Frederick River

Silver Queen Lake Subdivision shown thus: *|||||*

*SEE LAND COLL.*  
Mining Rights Only to apply on mining claims staked out and recorded on or after July 25, 1950 in this Township, Ontario Regulation, 169-50, Ontario Gazette, Aug. 5, 1950.

By O. Reg. 199-50, effective Sept 1, 1950, mining rights in this township are withdrawn from disposition under The Public Lands Act.

Area shown thus: *|||||*, withdrawn from staking and prospecting under Section 42 of the Mining Act, by reg 136/57 JUN 10 1957

*Reel 115 Permit*

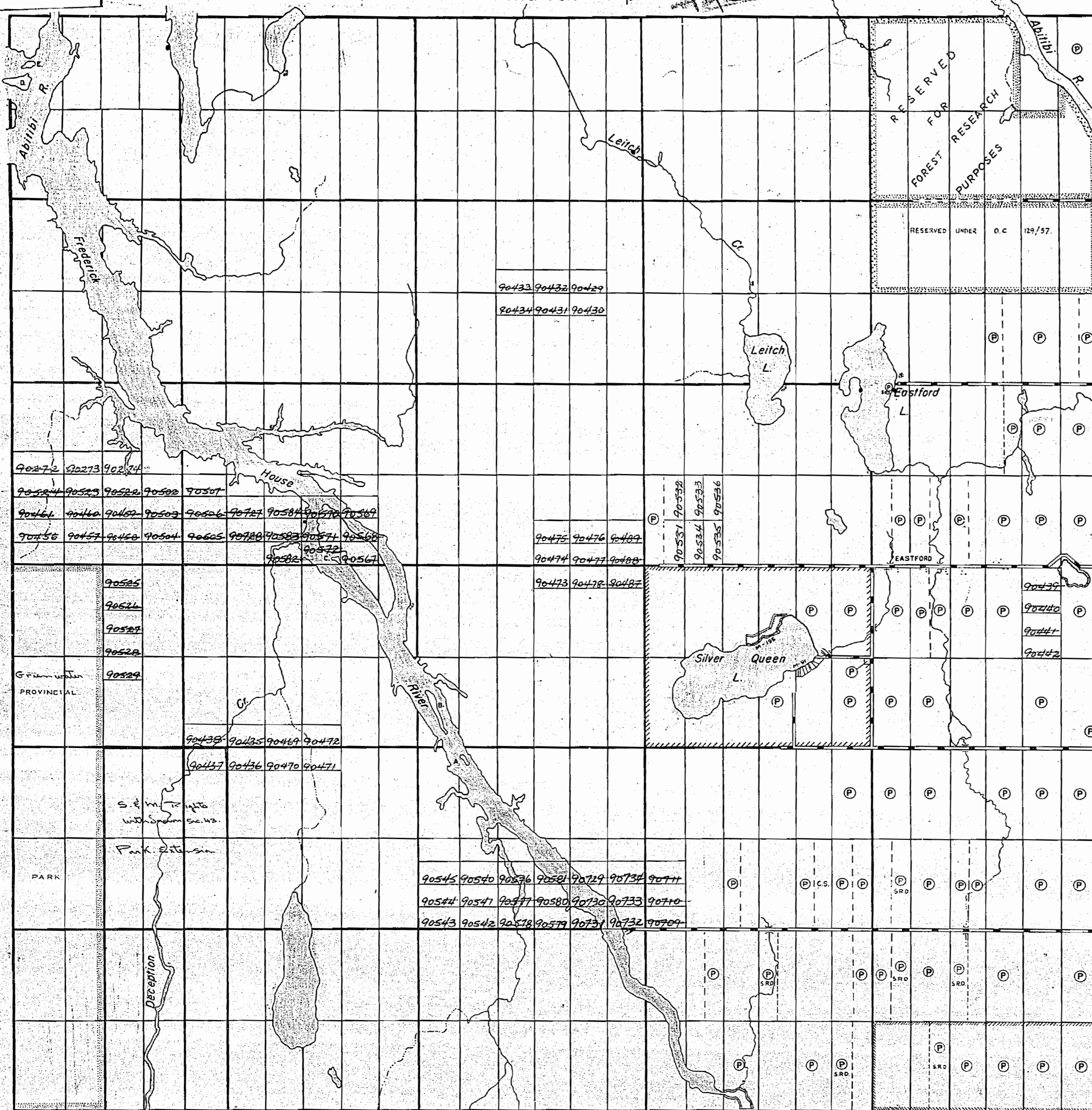

XII  
XI  
X  
IX  
VIII  
VII  
VI  
V  
IV  
III  
II  
I

Colquhoun Twp.

Blount Twp.

*M-530*

MINING RECORDER RECEIVED NOV 9 1962

PORCUPINE MINING DIVISION

Marven Twp.

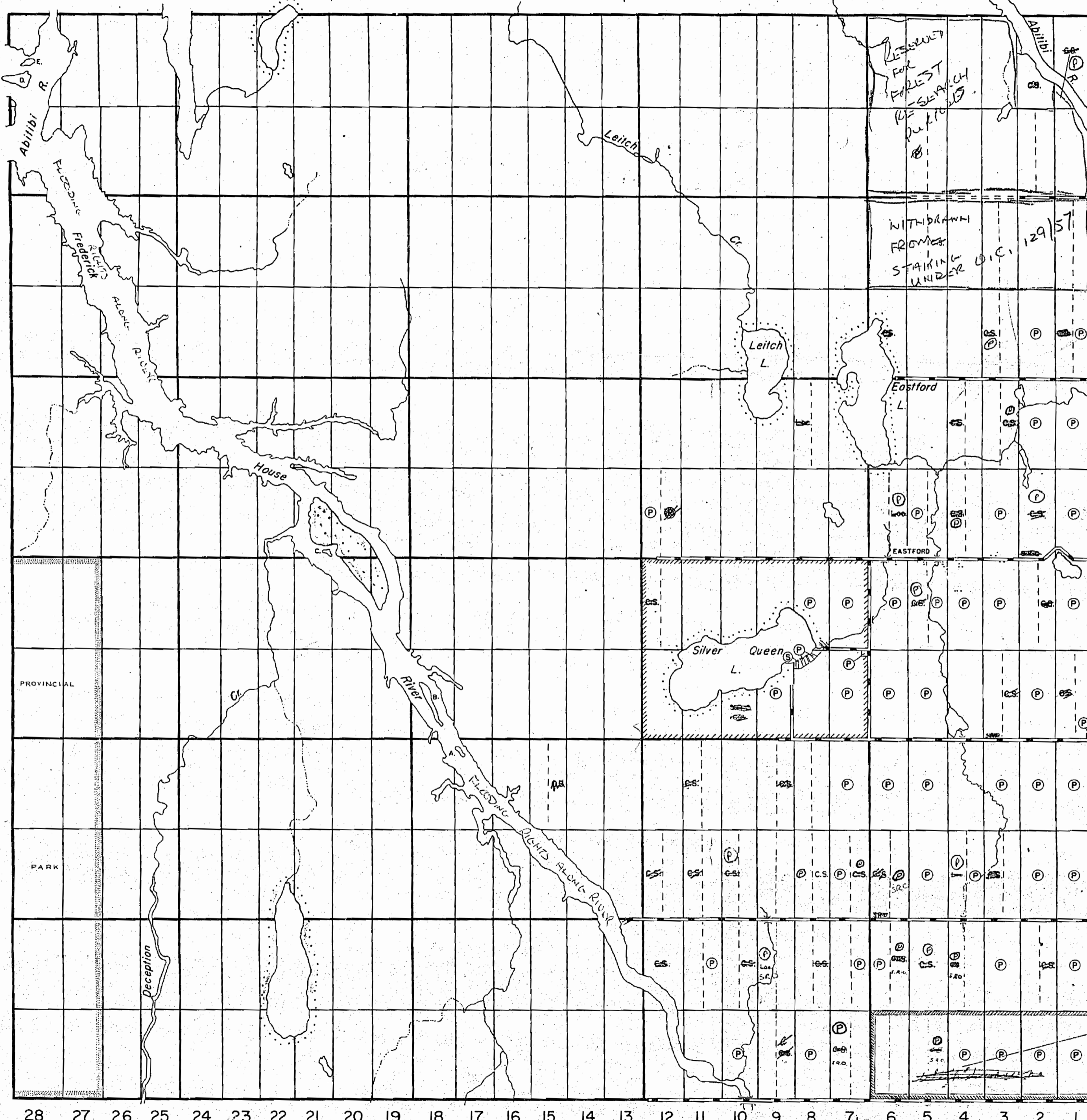

XII  
XI  
X  
IX  
VIII  
VII  
VI  
V  
IV  
III  
II  
I

Colquhoun Twp.

Blount Twp.

28 27 26 25 24 23 22 21 20 19 18 17 16 15 14 13 12 11 10 9 8 7 6 5 4 3 2 1

Clute Twp.

THE TOWNSHIP OF  
OF  
**LEITCH**

DISTRICT OF COCHRANE  
PORCUPINE MINING DIVISION

SCALE: 1-INCH = 40 CHAINS

**LEGEND**

- PATENTED LAND (P)
- CROWN LAND SALE (C.S.)
- LEASES (L)
- LOCATED LAND (Loc.)
- LICENSE OF OCCUPATION (L.O.)
- ROADS (—)
- IMPROVED ROADS (—)
- WATER POWER LEASE (W.P.L.)
- RAILWAYS (—)
- POWER LINES (—)
- MARSH OR MUSKEG (—)

**NOTES**

400' Reserve to Dept. of Lands & Forest shown thus: (---)

Flooding rights on lands bordering the Abitibi & Frederick River

Silver Queen Lake Subdivision shown thus: (//////)

Mining Rights Only to apply on mining claims staked out and recorded on or after July 25, 1950 in this Township. Ontario Regulation 169-50, Ontario Gazette, Aug. 5, 1950.

By O. Reg. 199-50 which amends previous regulations and which is effective as of Sept. 1, 1950, the mines & minerals in this Township are reserved.

Area shown thus: (hatched), withdrawn from staking and prospecting under Section 42 of the Mining Act, by reg. 136/57, JUN. 10, 1957

*[Handwritten signature]*

PLAN NO. - M-530

DEPARTMENT OF MINES  
—ONTARIO—

Marven Twp.

Colquhoun Twp.

Glute Twp.

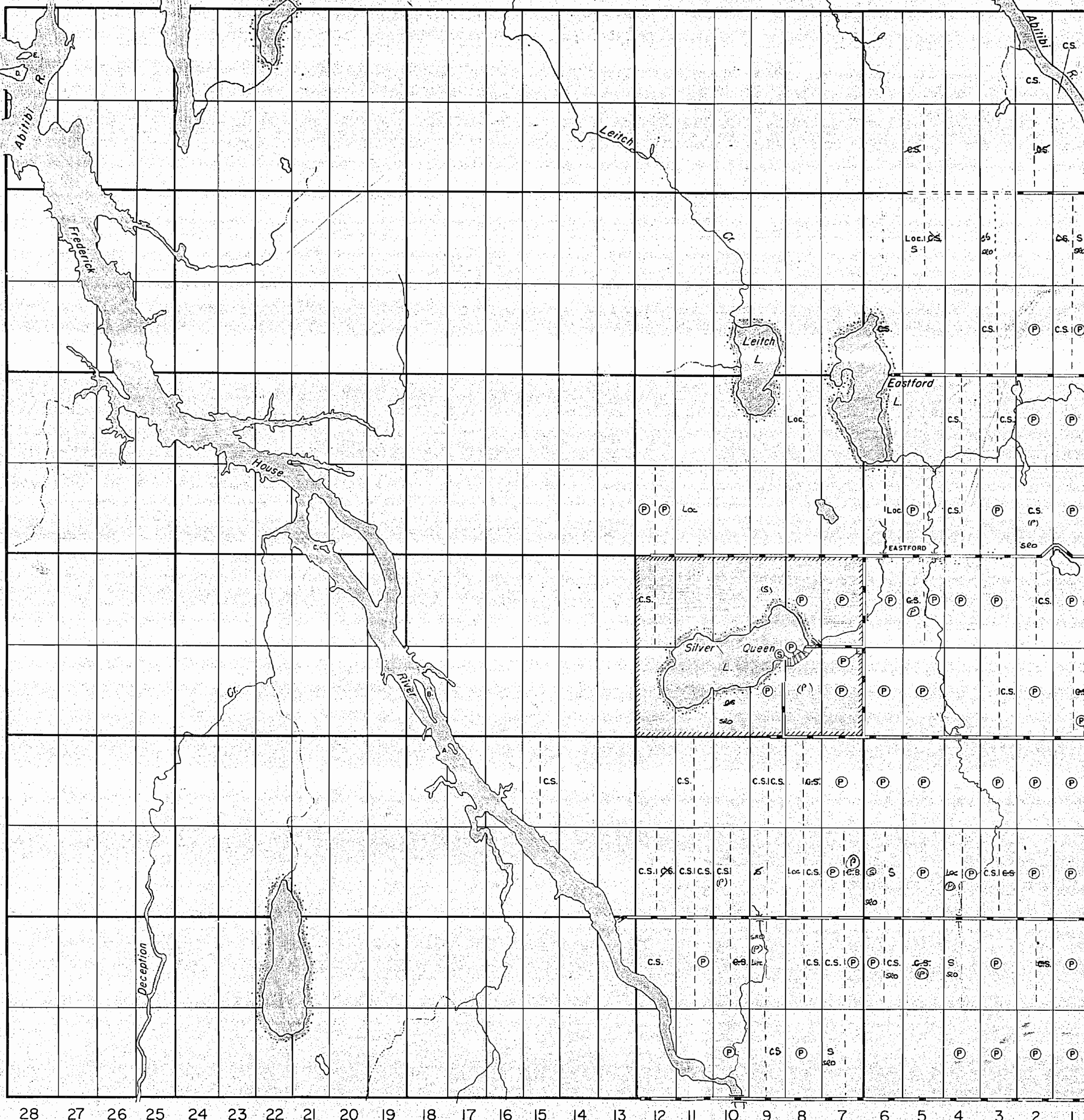

THE TOWNSHIP  
OF  
**LEITCH**  
DISTRICT OF  
COCHRANE  
TIMISKAMING  
MINING DIVISION  
SCALE: 1-INCH=40 CHAINS

**LEGEND**

PATENTED LAND	(P)
CROWN LAND SALE	(C.S.)
LEASES	(L)
LOCATED LAND	(Loc.)
LICENSE OF OCCUPATION	(L.O.)
ROADS	(---)
IMPROVED ROADS	(=)
WATER POWER LEASE	(W.P.L.)
RAILWAYS	(+)
POWER LINES	(- - -)
MARSH OR MUSKEG	(---)

**NOTES**

400' Reserve to Dept. of Lands & Forest shown thus: (---)

Flooding rights on lands bordering the Abitibi & Frederick River

Silver Queen Lake Subdivision shown thus: (---)



*Mining rights only, 25 July 50*

M-530  
PLAN NO. - T.117.  
DEPARTMENT OF MINING  
- ONTARIO -

Marven Twp.

Colquhoun Twp.

Blount Twp.

Clute Twp.

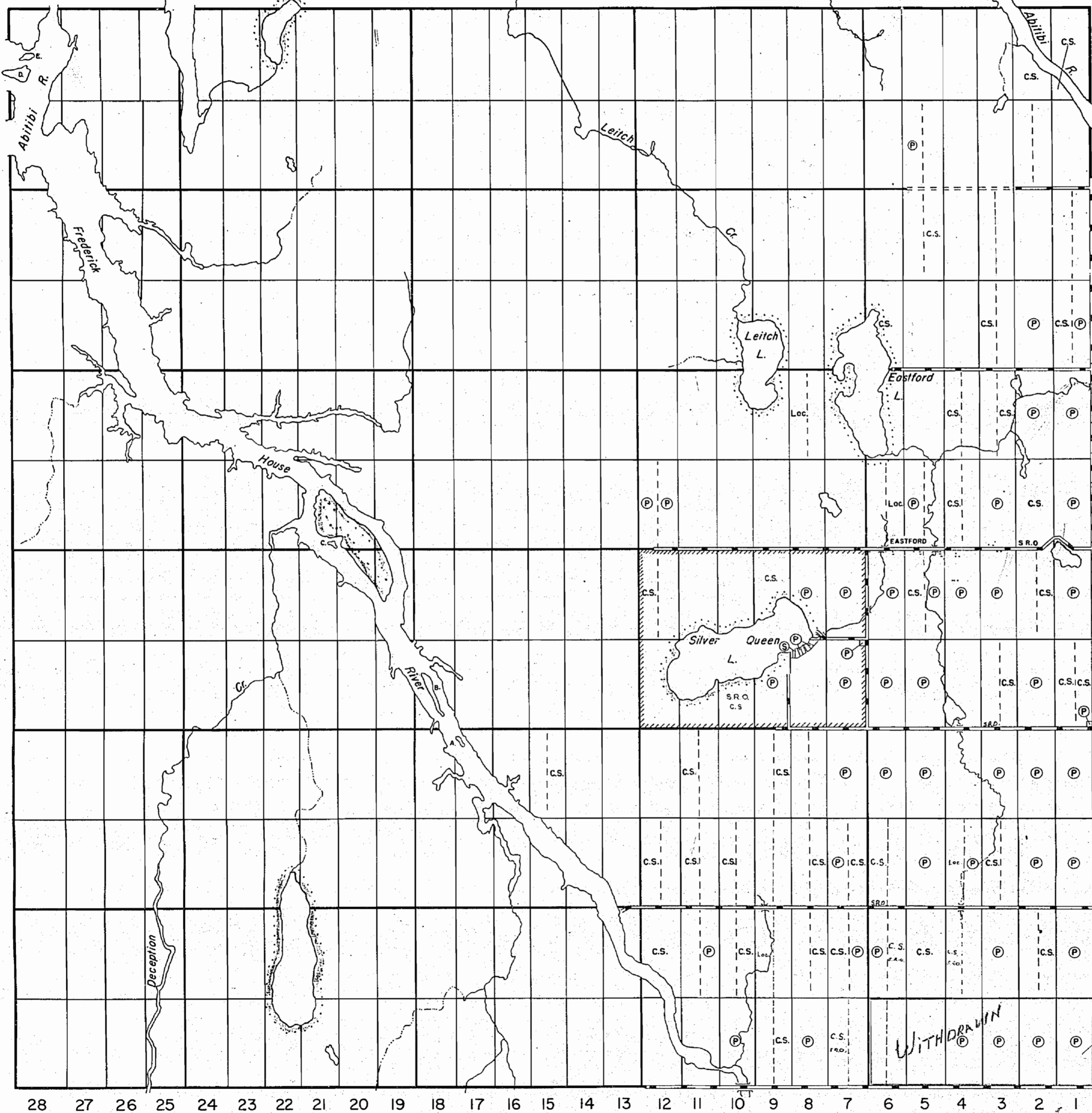

THE TOWNSHIP  
OF  
**LEITCH**

DISTRICT OF  
COCHRANE  
PORCUPINE  
MINING DIVISION

SCALE: 1-INCH=40 CHAINS

**LEGEND**

PATENTED LAND	(P)
CROWN LAND SALE	C.S.
LEASES	(L)
LOCATED LAND	Loc.
LICENSE OF OCCUPATION	L.O.
ROADS	—
IMPROVED ROADS	—
WATER POWER LEASE	W.P.L.
RAILWAYS	—
POWER LINES	—
MARSH OR MUSKEG	—

**NOTES**

400' Reserve to Dept of Lands & Forest shown thus: —

Flooding rights on lands bordering the Abitibi & Frederick River

Silver Queen Lake Subdivision shown thus: —

Mining Rights Only to apply on mining claims staked out and recorded on or after July 25, 1950 in this Township. Ontario Regulation 169-50, Ontario gazette. Aug. 5, 1950.

By O. Reg. 199-50 which amends previous regulations and which is effective as of Sept. 1, 1950, the mines & minerals in this Township are reserved.

PLAN NO. - M-530

DEPARTMENT OF MINES  
—ONTARIO—

*See Rural Road*

*WITHDRAWN*

Marven Twp.

Colquhoun Twp.

Blount Twp.

Clute Twp.

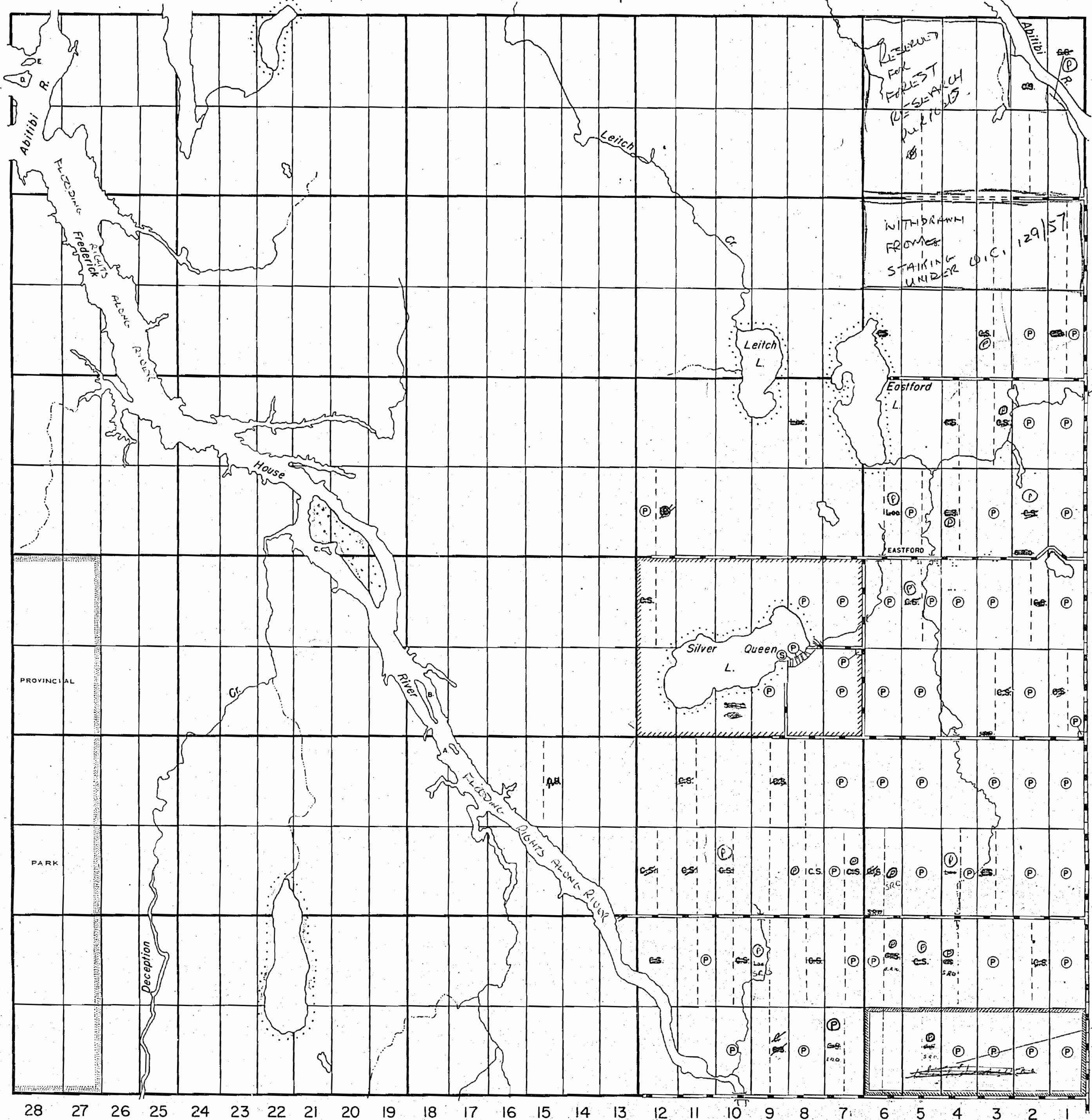

THE TOWNSHIP  
OF  
**LEITCH**

DISTRICT OF  
COCHRANE  
PORCUPINE  
MINING DIVISION

SCALE: 1-INCH = 40 CHAINS

**LEGEND**

- PATENTED LAND (P)
- CROWN LAND SALE (C.S.)
- LEASES (L)
- LOCATED LAND (Loc.)
- LICENSE OF OCCUPATION (L.O.)
- ROADS (R)
- IMPROVED ROADS (R with double line)
- WATER POWER LEASE (W.P.L.)
- RAILWAYS (R with cross-ticks)
- POWER LINES (P with cross-ticks)
- MARSH OR MUSKEG (M)

**NOTES**

- 400' Reserve to Dept. of Lands & Forest shown thus: (dotted line)
- Flooding rights on lands bordering the Abitibi & Frederick River (wavy line)
- Silver Queen Lake Subdivision shown thus: (hatched area)
- Mining Rights Only to apply on mining claims staked out and recorded on or after July 25, 1950 in this Township. Ontario Regulation 169-50, Ontario gazette. Aug. 5. 1950.
- By O. Reg. 199-50 which amends previous regulations and which is effective as of Sept. 1, 1950, the mines & minerals in this Township are reserved.
- Area shown thus: (hatched area), withdrawn from staking and prospecting under Section 42 of the Mining Act, by reg 136/57 JUN. 10. 1957

PLAN NO. - M-530

DEPARTMENT OF MINES  
- ONTARIO -

*Handwritten signature*