



# INDEX TO LAND DISPOSITION

PLAN  
 G-3064  
 TOWNSHIP  
 LEY

M.N.R. ADMINISTRATIVE DISTRICT  
 SAULT STE. MARIE  
 MINING DIVISION  
 SAULT STE. MARIE  
 LAND TITLES/REGISTRY DIVISION  
 ALGOMA

## SYMBOLS

Boundary	.....
Township, Meridian, Baseline	.....
Road allowance; surveyed	.....
shoreline	.....
Lot/Concession; surveyed	.....
unsurveyed	.....
Parcel; surveyed	.....
unsurveyed	.....
Right-of-way; road	.....
railway	.....
utility	.....
Reservation	.....
Cliff, Pit, Pile	.....
Contour	.....
Interpolated	.....
Approximate	.....
Depression	.....
Control point (horizontal)	.....
Flooded land	.....
Mine head frame	.....
Pipeline (above ground)	.....
Railway; single track	.....
double track	.....
abandoned	.....
Road; highway, county, township	.....
access	.....
trail, bush	.....
Shoreline (original)	.....
Transmission line	.....
Wooded area	.....

## DISPOSITION OF CROWN LANDS

Patent	.....
Surface & Mining Rights	.....
Surface Rights Only	.....
Mining Rights Only	.....
Lease	.....
Surface & Mining Rights	.....
Surface Rights Only	.....
Mining Rights Only	.....
Licence of Occupation	.....
Order-in-Council	.....
Cancelled	.....
Reservation	.....
Sand & Gravel	.....

## AREAS WITHDRAWN FROM DISPOSITION

MRO - Mining Rights Only	.....
SRO - Surface Rights Only	.....
M + S - Mining and Surface Rights	.....

Description	Order No.	Date	Disposition	File
-------------	-----------	------	-------------	------

THE INFORMATION THAT APPEARS ON THIS MAP HAS BEEN COMPILED FROM VARIOUS SOURCES, AND ACCURACY IS NOT GUARANTEED. THOSE WISHING TO STAKE MINING CLAIMS SHOULD CONSULT WITH THE MINING RECORDER, MINISTRY OF NORTHERN DEVELOPMENT AND MINES, FOR ADDITIONAL INFORMATION ON THE STATUS OF THE LANDS SHOWN HEREON.

### NOTES

- (A) Surface & Mining Rights controlled by the Crown (Canada)
- (G.S.) Gold & Silver only controlled by the Crown (Canada)
- (M) All Mining Rights controlled by the Crown (Canada)

Enquiries regarding (A), (G.S.), (M) should be directed to the Director, Lands, Revenues and Treaties, Ontario Region, Department of Indian and Northern Affairs.

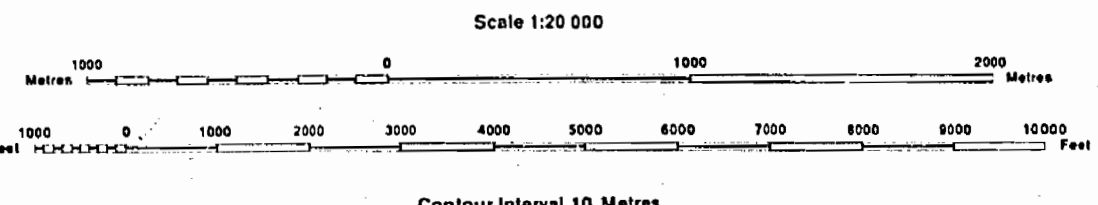

Map base and land disposition drafting by Surveys and Mapping Branch, Ministry of Natural Resources.

The disposition of land, location of lot fabric and parcel boundaries on this index was compiled for administrative purposes only.

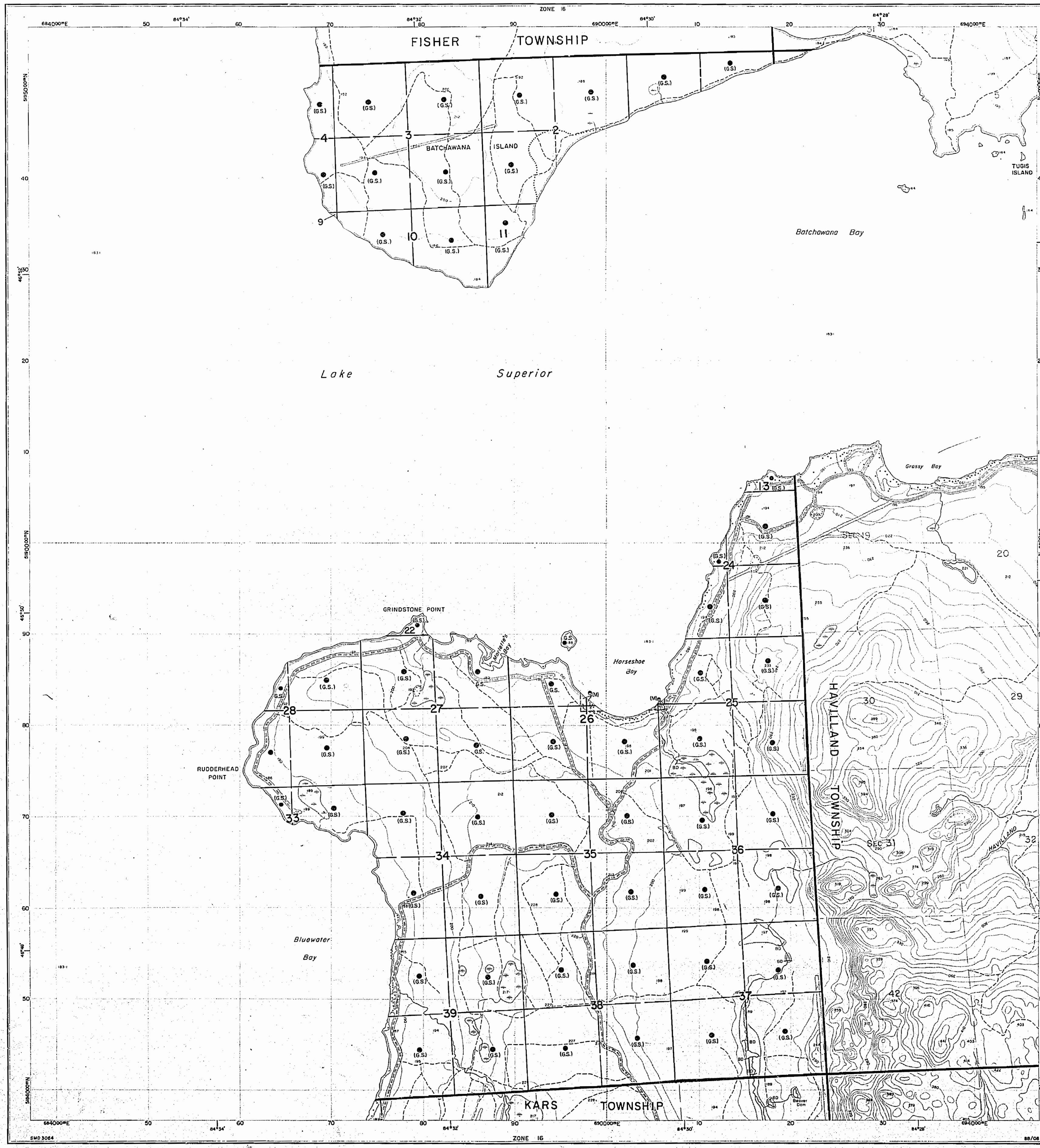

# PLAN OF LEY TWP 6-3064

## SAULT STE. MARIE MINING DIVISION DISTRICT OF ALGOMA.

Scale: 40 chains to an inch.

DATE OF ISSUE  
NOV 25 1961  
SAULT STE. MARIE  
MINING RECORDER'S OFFICE

*Five per cent of the area of this Township is reserved for roads  
and the Right of The Crown to lay out roads where necessary.*

Area.	
Land	8,019 Ac.
Water	000 "
<b>Total</b>	<b>8,019 Ac.</b>

**NOTES**

- (A) - Surface & Mining Rights controlled by the Crown (Canada).
- (G.S) - Gold & Silver only controlled by the Crown (Canada).
- (M) - All Mining Rights controlled by the Crown (Canada).
- Enquiries regarding (A), (G.S) & (M) should be directed to the Chief, Reserves & Trusts, Indian Affairs Branch, Dept. of Citizenship & Immigration, Ottawa.

- Ⓟ - Patented land.
- S.R.O - Surface rights only.
- M.R.O - Mining rights only.

400' Reserve around all lakes & rivers to Dept. of Lands & Forests.

*Replaced by mylar Sept. 4/84*

BATCHAWAUNG BAY.

LAKE SUPERIOR.

Land under Lake Superior withdrawn from staking by Order in Council dated April 30, 1912.

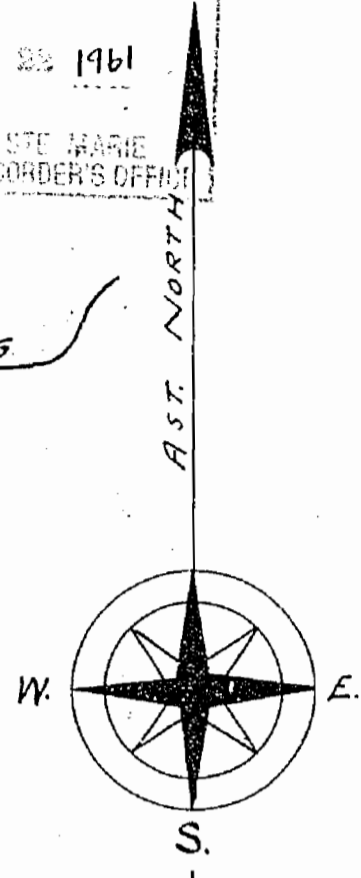
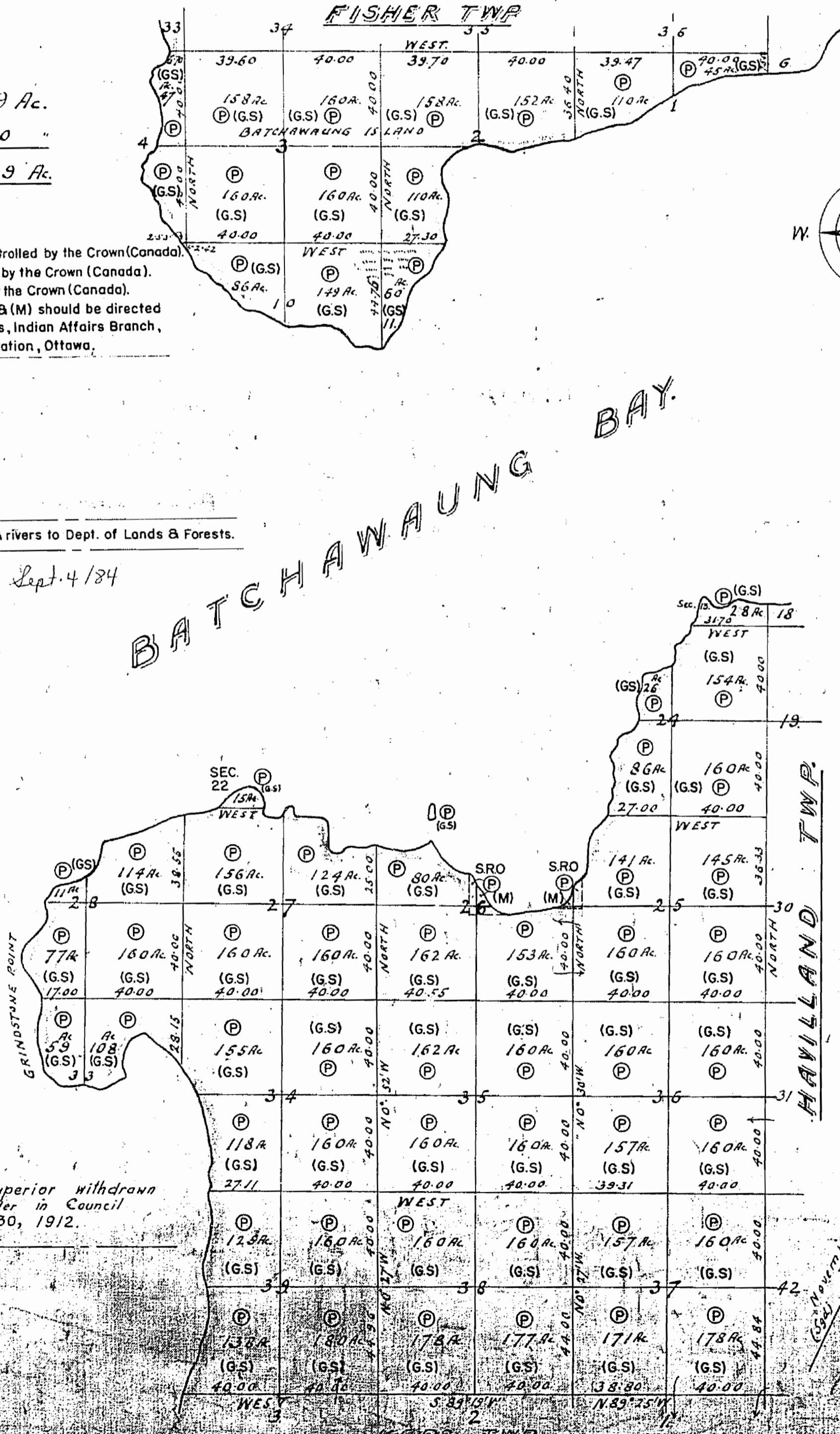

By Order of the Minister of Lands and Forests  
November 25, 1961  
Thos. Byrne O.S.

SAULT STE. MARIE  
RECEIVED  
SEP 04 1984  
A.M. 11:00, 10:11, 12:11, 1:00, 4:00, 6:00 P.M.

ONTARIO  
MINISTRY OF NATURAL RESOURCES  
SURVEYS AND MAPPING BRANCH

PLAN OF

M. 1297

# LEY TWP 6-3064

SAULT STE. MARIE MINING DIVISION  
DISTRICT OF ALGOMA.

Scale: 40 chains to an inch.

Five per cent of the area of this Township is reserved for roads  
and the Right of The Crown to lay out roads where necessary.

Area.	
Land	8,019 Ac.
Water	000 "
<b>Total</b>	<b>8,019 Ac.</b>

**NOTES**

- (A) - Surface & Mining Rights controlled by the Crown (Canada).
  - (G.S.) - Gold & Silver only controlled by the Crown (Canada).
  - (M) - All Mining Rights controlled by the Crown (Canada).
- Enquiries regarding (A), (G.S.) & (M) should be directed to the Chief, Reserves & Trusts, Indian Affairs Branch, Dept. of Citizenship & Immigration, Ottawa.

- (P) - Patented land.
- S.R.O - Surface rights only.
- M.R.O - Mining rights only.

400' surface rights reservation around all lakes & rivers.

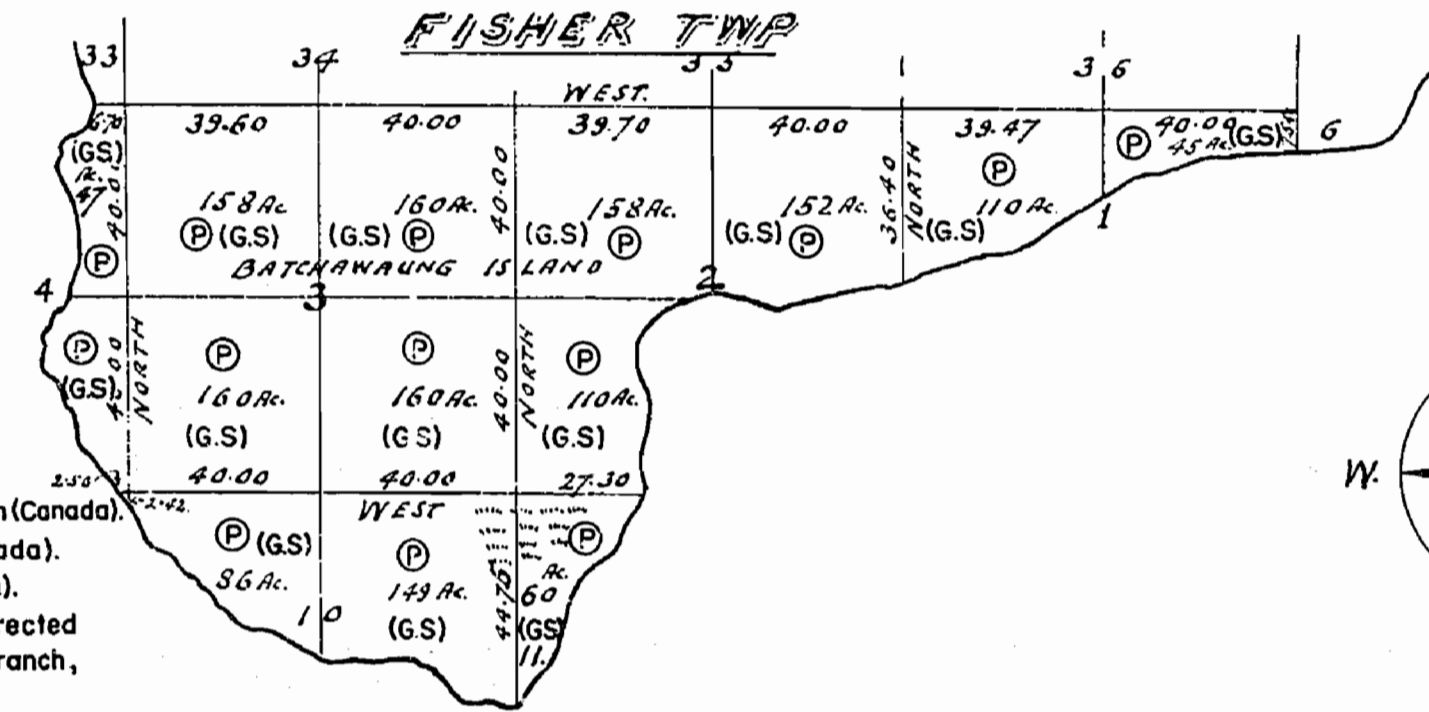

LAKE SUPERIOR

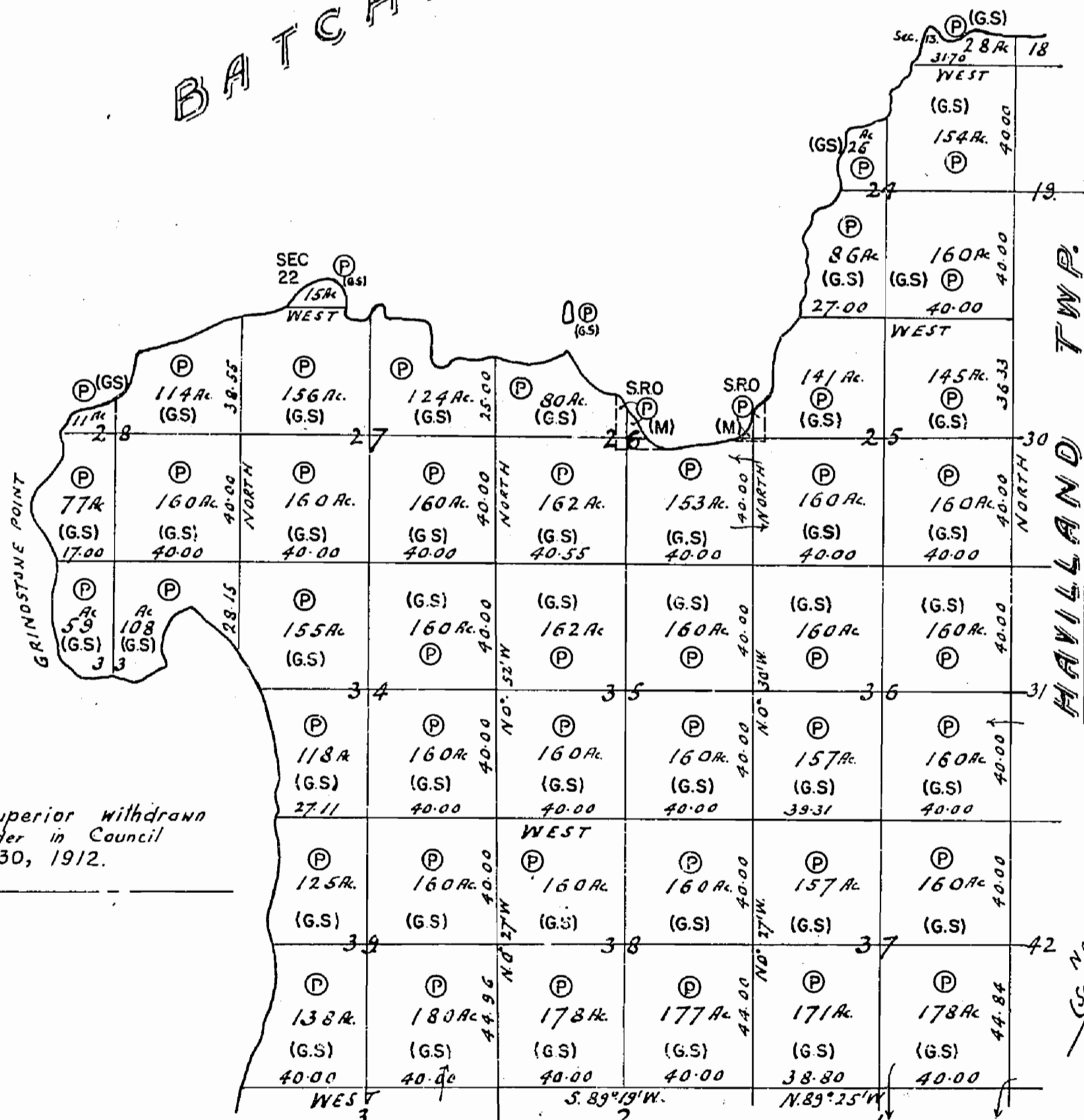

Land under Lake Superior withdrawn from staking by Order in Council dated April 30, 1912.

KARS TWP 400' Resrd. b. Dept. of L. & F. shown fees: .....

Repland. by G. 3044. On 20/12/77.

REFERENCES

AREAS WITHDRAWN FROM DISPOSITION

- M.R.O. - MINING RIGHTS ONLY
- S.R.O. - SURFACE RIGHTS ONLY
- M.+S. - MINING AND SURFACE RIGHTS

Description	Order No.	Date	Disposition	File

NOTES

(A)- Surface & Mining Rights Controlled by the Crown (Canada)  
 (G.S)- Gold & Silver only controlled by the Crown (Canada).  
 (M)- All Mining Rights controlled by the Crown (Canada).  
 Enquiries regarding (A), (G.S) & (M) should be directed to the Chief, Reserves & Trusts, Indian Affairs Branch Dept. of Citizenship & Immigration, Ottawa.

Land under Lake Superior withdrawn from staking by Order in Council dated April 30, 1912

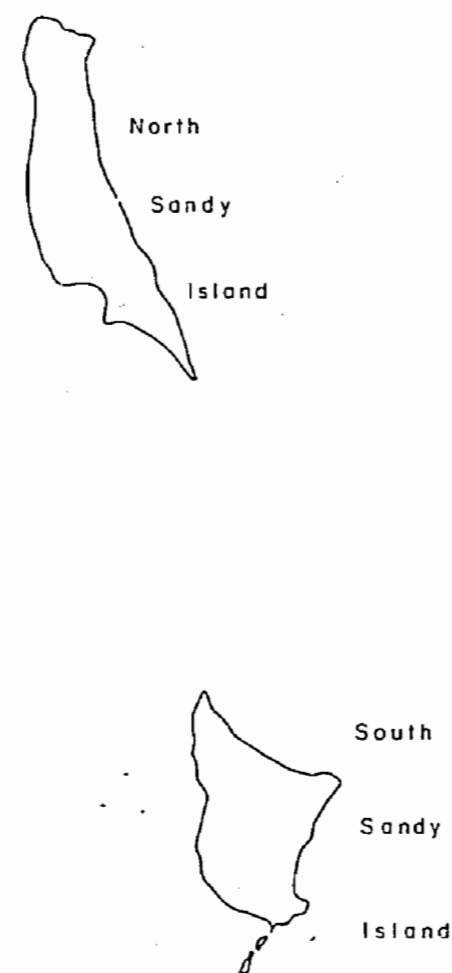
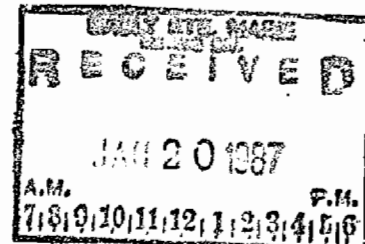

84°37'30"

FISHER TOWNSHIP

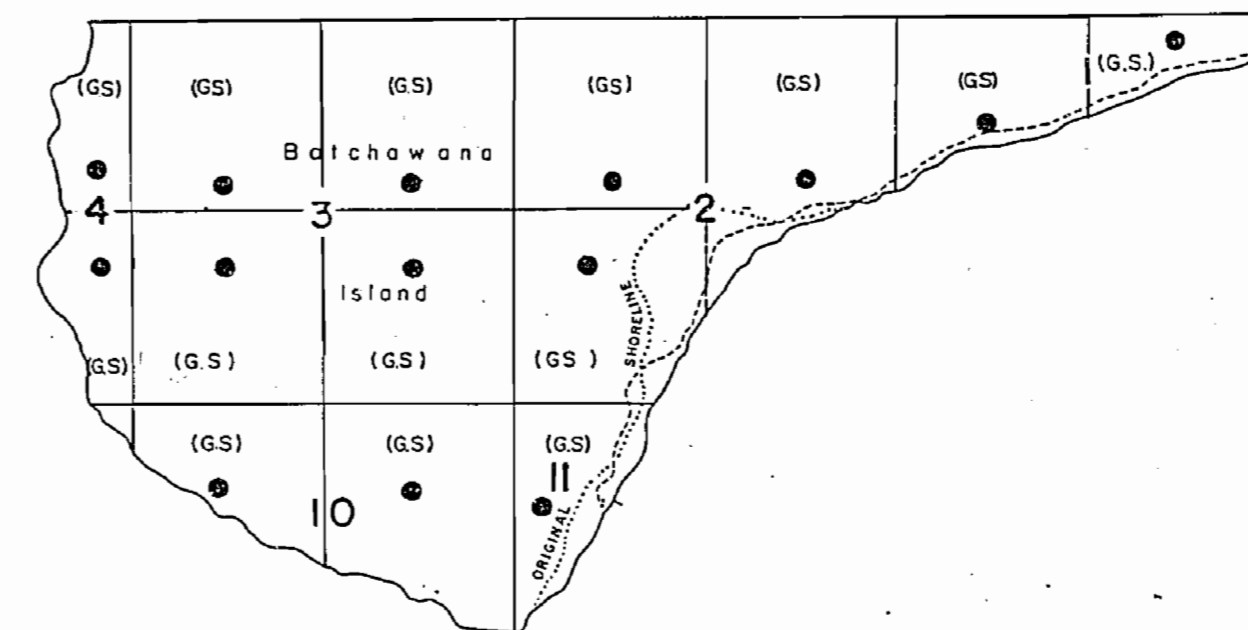

Batchawana

Bay

LAKE

SUPERIOR

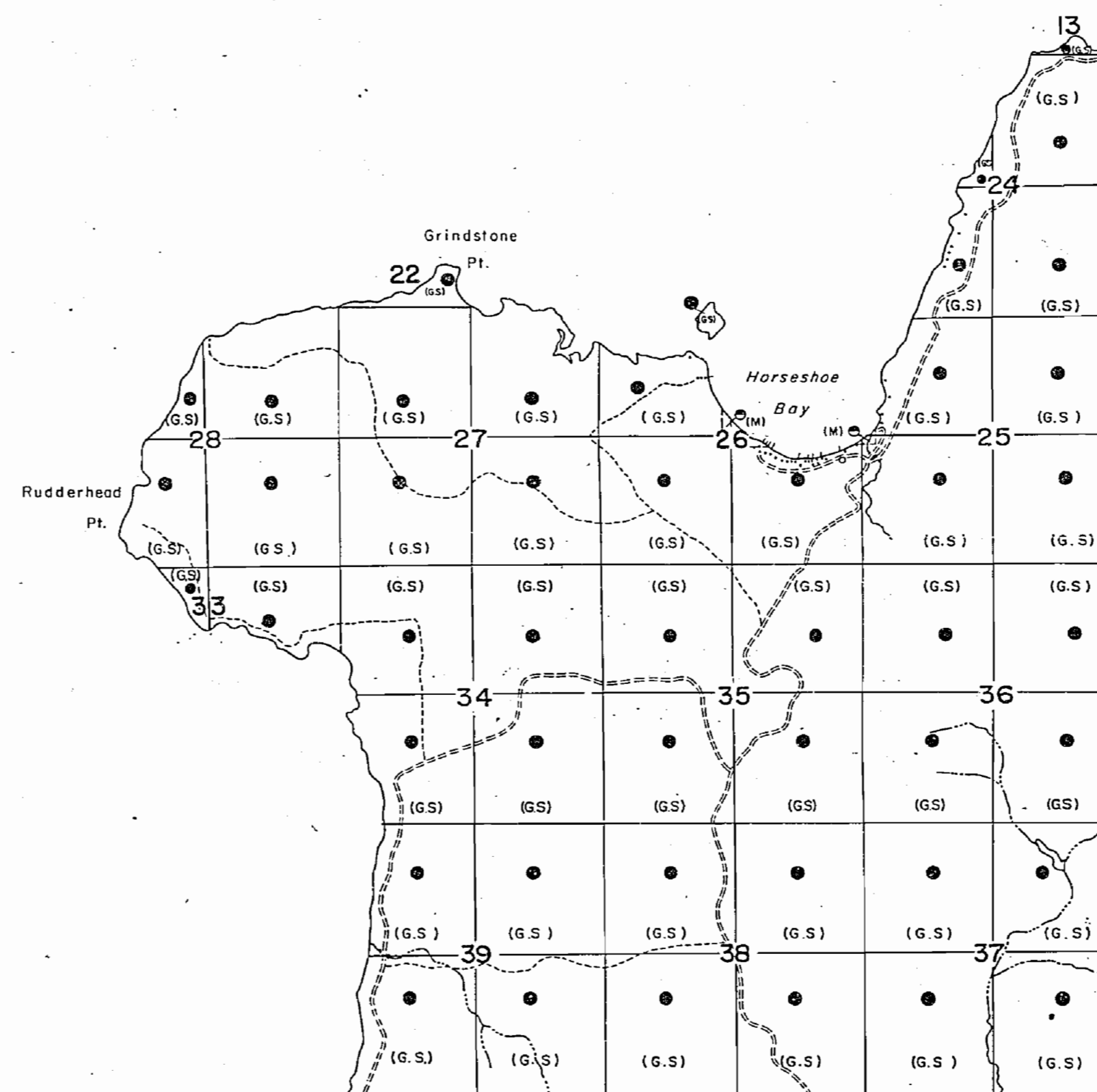

KARS TOWNSHIP

HAVILLAND TOWNSHIP

LEGEND

- HIGHWAY AND ROUTE No.
- OTHER ROADS
- TRAILS
- SURVEYED LINES:
  - TOWNSHIPS, BASE LINES, ETC.
  - LOTS, MINING CLAIMS, PARCELS, ETC.
- UNSURVEYED LINES:
  - LOT LINES
  - PARCEL BOUNDARY
  - MINING CLAIMS ETC.
- RAILWAY AND RIGHT OF WAY
- UTILITY LINES
- NON-PERENNIAL STREAM
- FLOODING OR FLOODING RIGHTS
- SUBDIVISION OR COMPOSITE PLAN RESERVATIONS
- ORIGINAL SHORELINE
- MARSH OR MUSKEG
- MINES
- TRAVERSE MONUMENT

DISPOSITION OF CROWN LANDS

- | TYPE OF DOCUMENT                | SYMBOL |
|---------------------------------|--------|
| PATENT, SURFACE & MINING RIGHTS |        |
| " SURFACE RIGHTS ONLY           |        |
| " MINING RIGHTS ONLY            |        |
| LEASE, SURFACE & MINING RIGHTS  |        |
| " SURFACE RIGHTS ONLY           |        |
| " MINING RIGHTS ONLY            |        |
| LICENCE OF OCCUPATION           |        |
| ORDER-IN-COUNCIL                |        |
| RESERVATION                     |        |
| CANCELLED                       |        |
| SAND & GRAVEL                   |        |

NOTE: MINING RIGHTS IN PARCELS PATENTED PRIOR TO MAY 6, 1913, VESTED IN ORIGINAL PATENTEE BY THE PUBLIC LANDS ACT, R.S.O. 1970, CHAP. 380, SEC. 63, SUBSEC 1.

SCALE: 1 INCH = 40 CHAINS

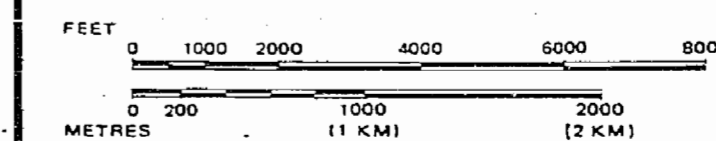

TOWNSHIP LEY

M.N.R. ADMINISTRATIVE DISTRICT  
 SAULT STE. MARIE  
 MINING DIVISION  
 SAULT STE. MARIE  
 LAND TITLES / REGISTRY DIVISION  
 ALGOMA

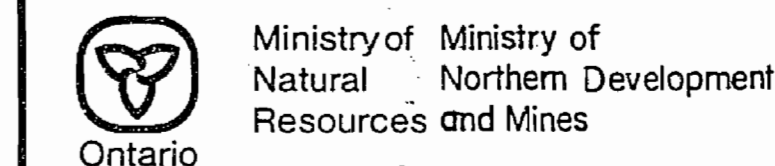

Date DEC. 1986

Number G-3064

Approved by DBO March 14/89 P.P.

# LEY TWP

SAULT STE. MARIE MINING DIVISION  
DISTRICT OF ALGOMA.

Scale: 40 chains to an inch.

Five per cent of the area of this Township is reserved for roads and the Right of The Crown to lay out roads where necessary.

Area.	
Land	8,019 Ac.
Water	000
<b>Total</b>	<b>8,019 Ac.</b>

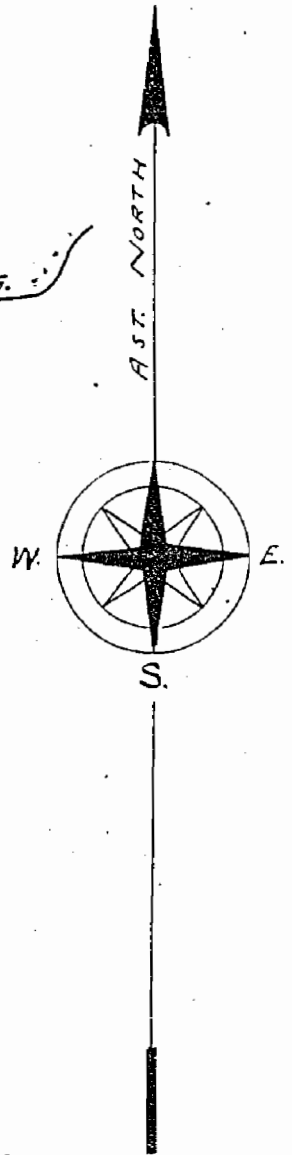
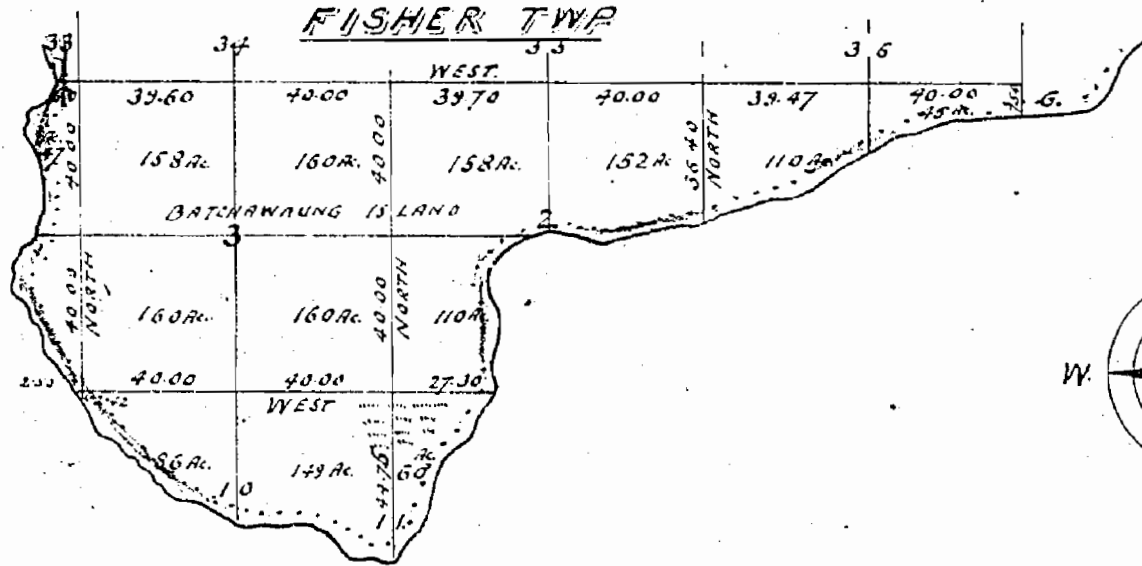

**NOTE:** This Twp. is Indian Land and as such, administered by the Dept. of Indian Affairs Ottawa.

BATCHAWAUNG BAY.

LAKE SUPERIOR.

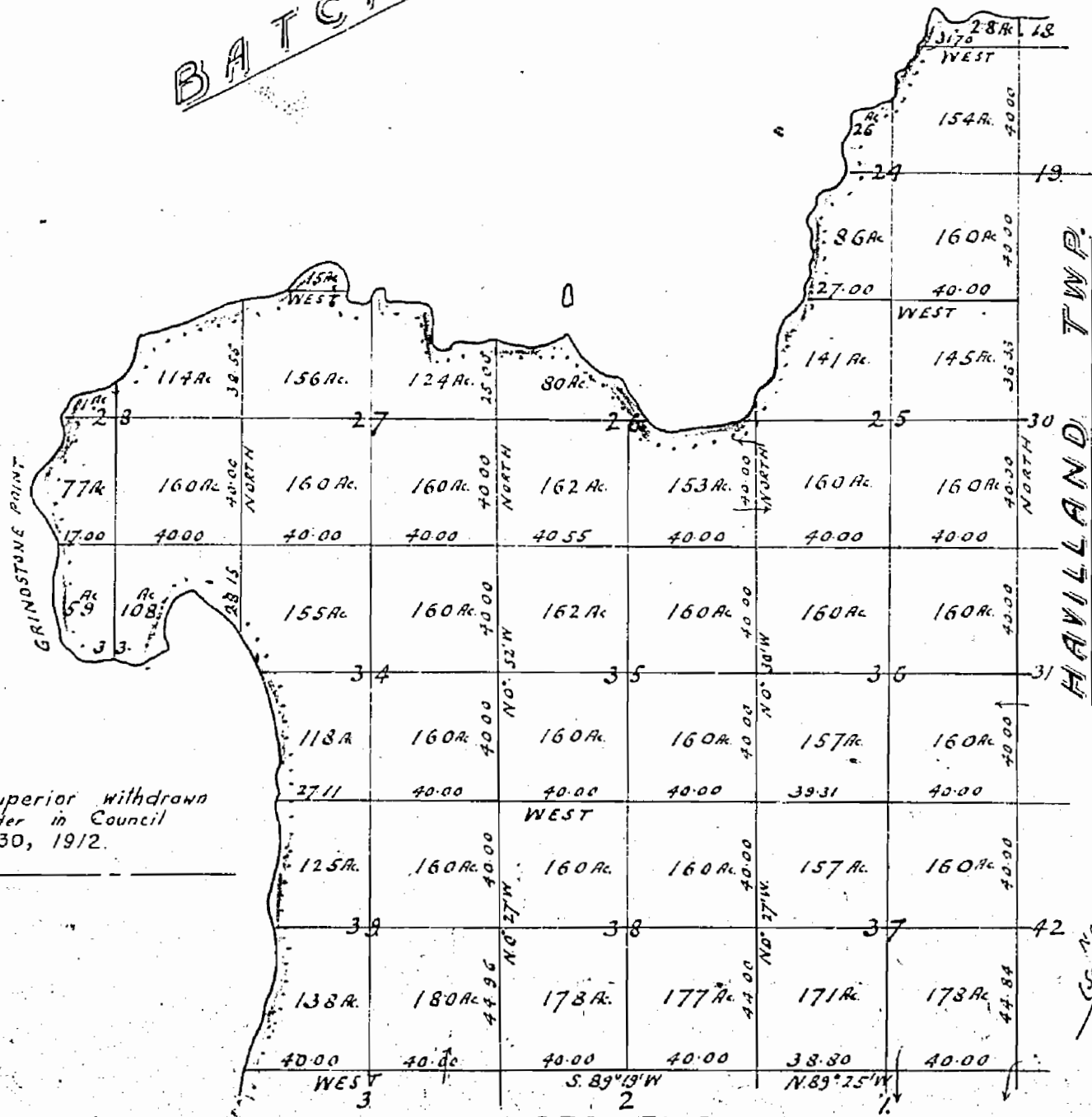

Land under Lake Superior withdrawn from staking by Order in Council dated April 30, 1912.

November 27th 1898  
(194) Thos. Byrne O.L.S.

# LEY TWP

SAULT STE. MARIE MINING DIVISION  
DISTRICT OF ALGOMA.

Scale: 40 chains to an inch.

Five per cent of the area of this Township is reserved for roads and the right of the Crown to lay out roads where necessary.

Area.	
Land	8,019 Ac.
Water	000 "
<b>Total</b>	<b>8,019 Ac.</b>

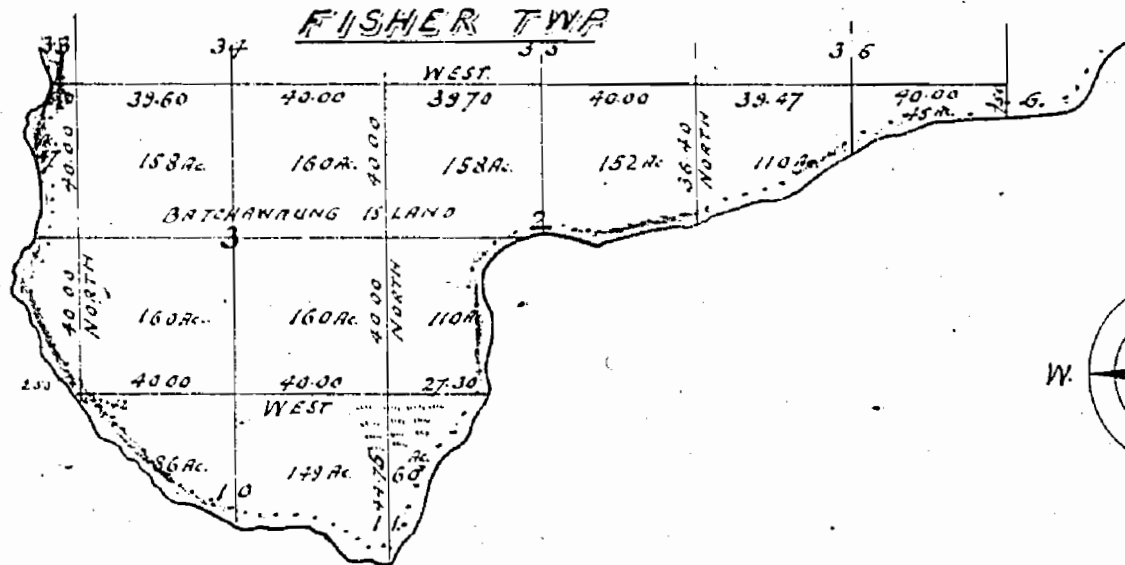

NOTE: This Twp. is Indian Land and as such, administered by the Dept. of Indian Affairs Ottawa.

BATCHAWAUNG BAY.

LAKE SUPERIOR.

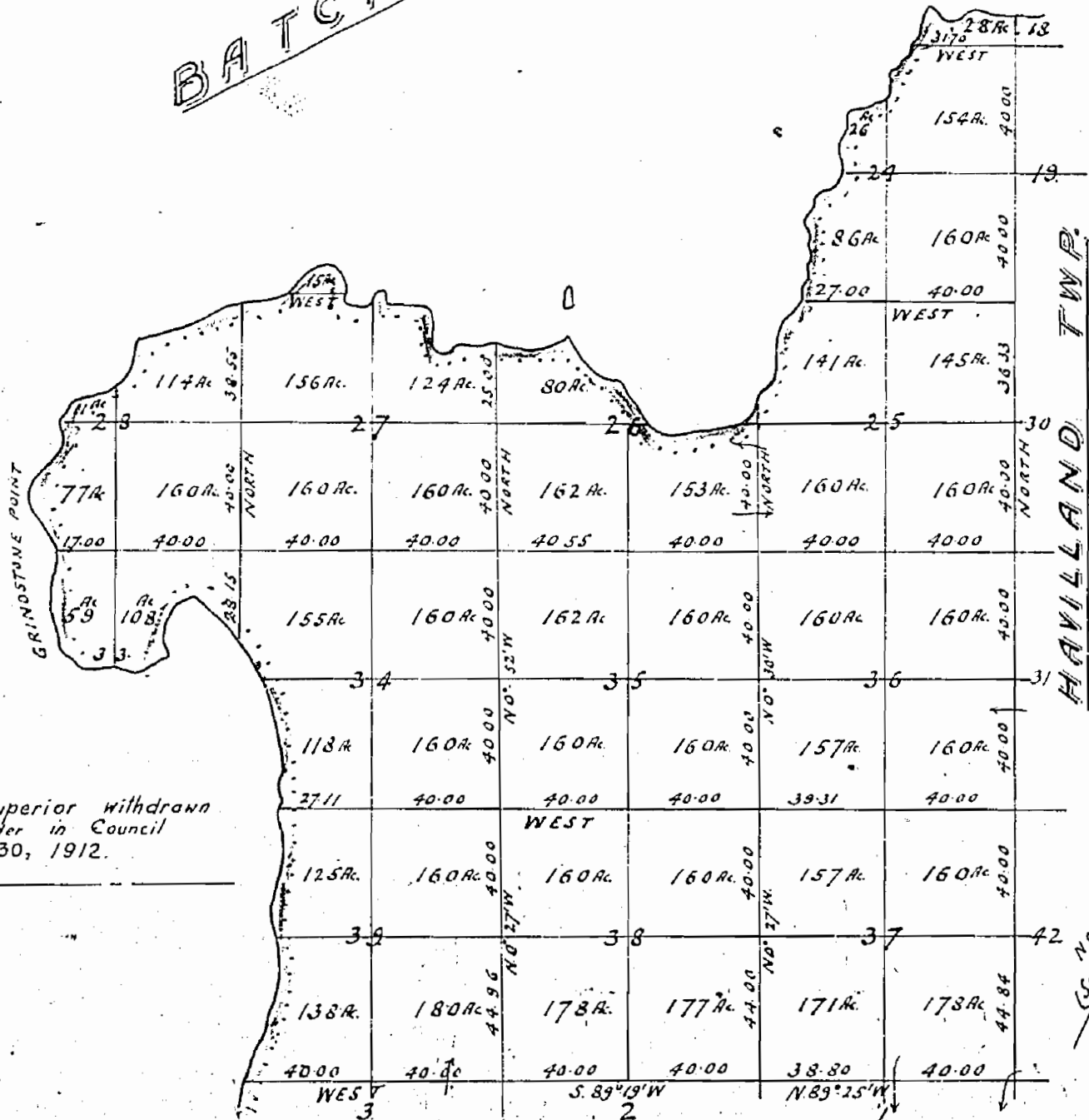

Land under Lake Superior withdrawn from staking by Order in Council dated April 30, 1912.

November 2nd 1893  
Geo. Thos. Byrne O.L.S.

KARS TWP 400' Resrd. b. Dept. of L. & E. shown thus.