

2434

ONTARIO

STATE OF MINNESOTA  
U.S.A.

STATE OF MINNESOTA  
U.S.A.

PLAN OF  
SAND POINT LAKE AREA  
DISTRICT OF RAINY RIVER - WESTERN ONTARIO.  
Scale: 40 Chains to One Inch.

1946



1244	1257	1260	1265	1270	1275
1280	1285	1290	1295	1300	1305
1310	1315	1320	1325	1330	1335
1340	1345	1350	1355	1360	1365

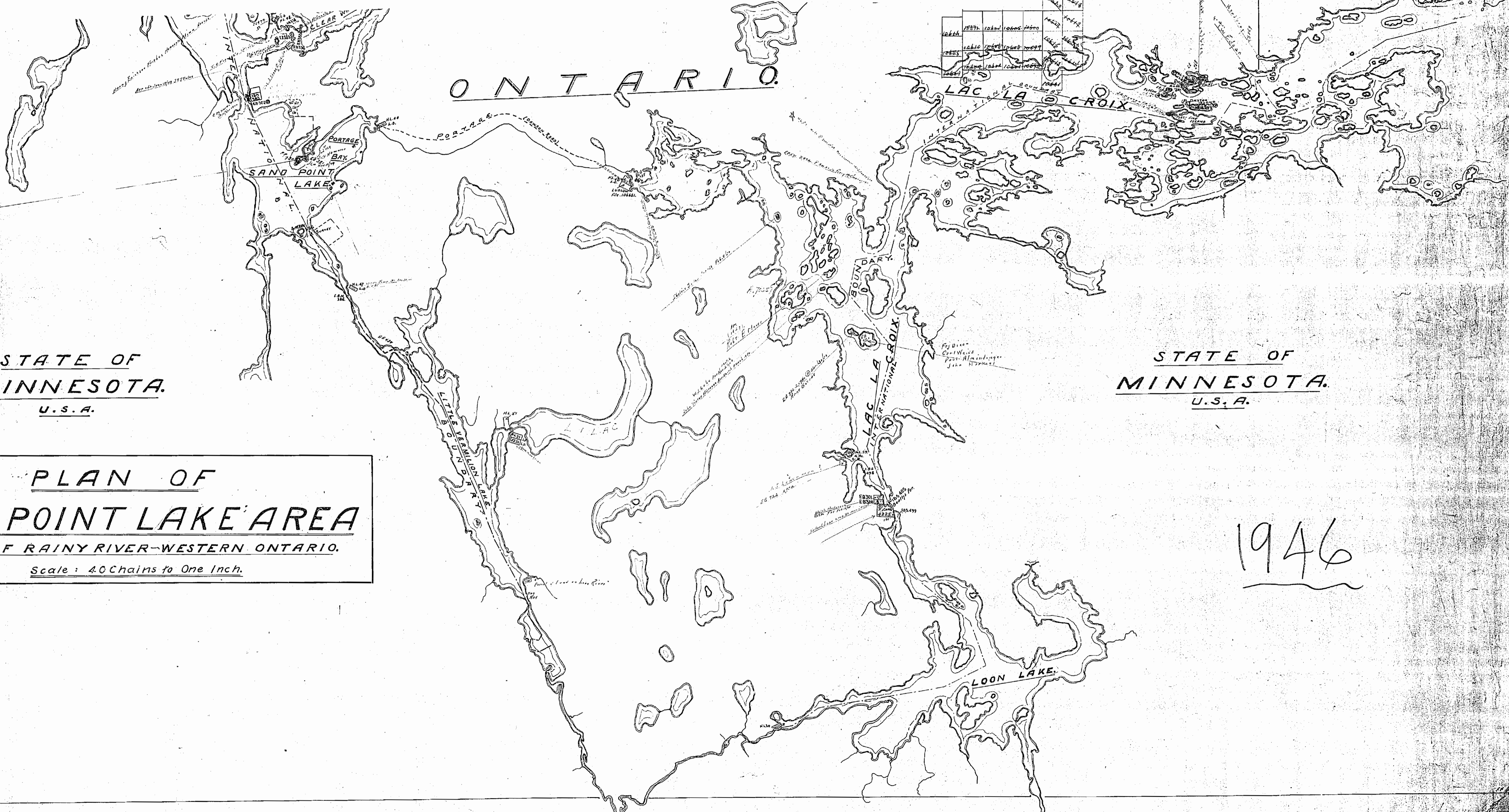

AREA OF  
**LILAC LAKE**  
 DISTRICT OF  
 RAINY RIVER  
 THUNDER BAY  
 MINING DIVISION  
 SCALE: 1-INCH = 40 CHAINS

**LEGEND**

PATENTED LAND	⊙
CROWN LAND SALE	C.S.
LEASES	⊙
LOCATED LAND	Loc.
LICENSE OF OCCUPATION	L.O.
MINING RIGHTS ONLY	M.R.O.
SURFACE RIGHTS ONLY	S.R.O.
ROADS	—
IMPROVED ROADS	—
KING'S HIGHWAYS	—
RAILWAYS	—
POWER LINES	—
MARSH OR MUSKEG	—
MINES	✱

**NOTES**

400' Reserve around all Lakes & Rivers to Dept. of Lands & Forests

Areas withdrawn from staking under Section 43 of the Mining Act. (R.S.O. '70)

Order No.	File	Date	Disposition
W 63/74	185215	28/10/74	S.F.

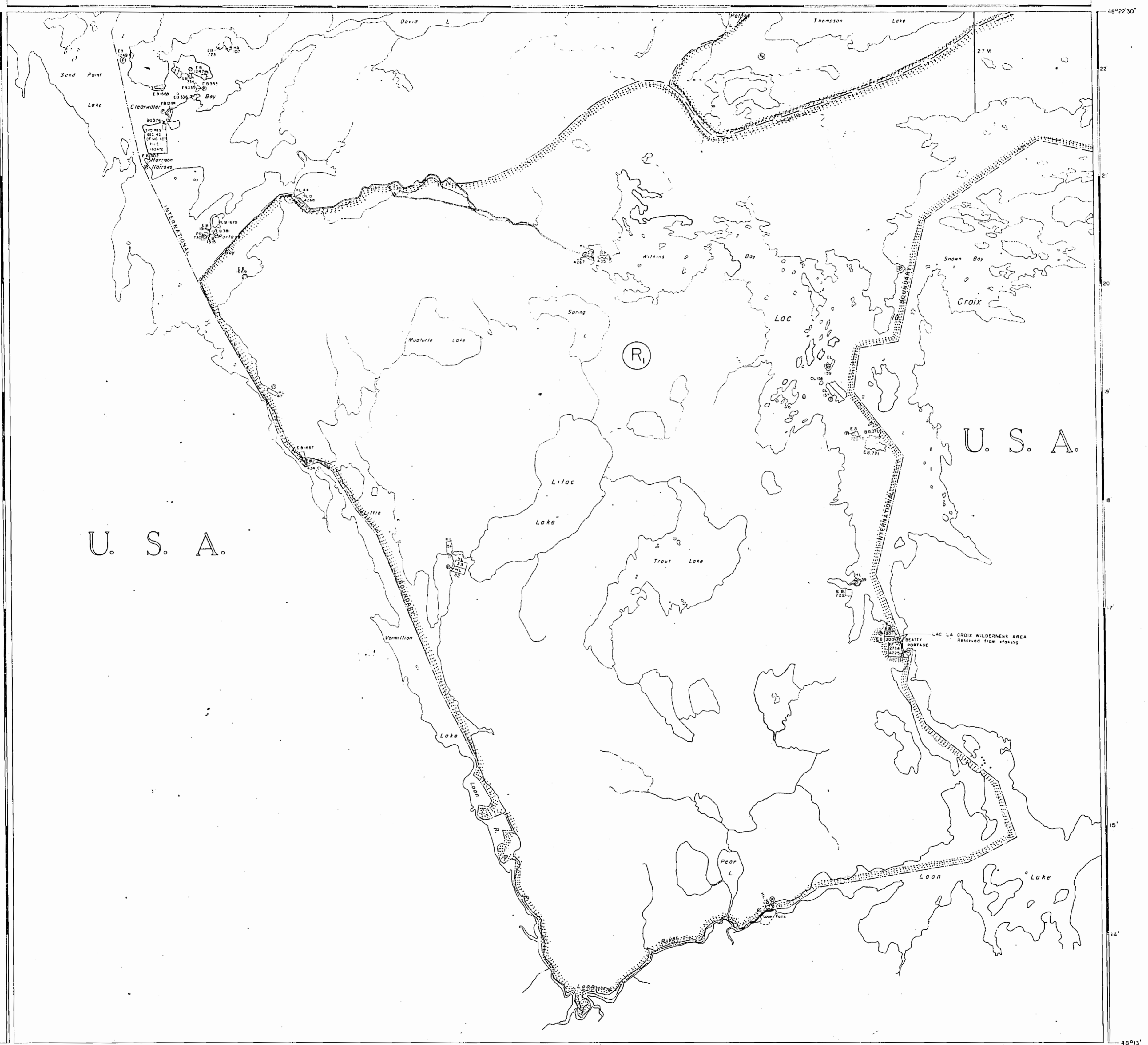

U. S. A.

U. S. A.

1977

FEB. 15/77  
 ATIKOKAN DIST.  
 NATIONAL TOPOGRAPHIC SERIES 52C8  
**PLAN NO. M. 2434**

ONTARIO  
 MINISTRY OF NATURAL RESOURCES  
 SURVEYS AND MAPPING BRANCH

REDHORSE LAKE G-552

REFERENCES

AREAS WITHDRAWN FROM DISPOSITION

SR - SURFACE RIGHTS	M.R. - MINING RIGHTS			
Description	Order No.	Date	Disposition	File
W 66/74		24/2/74	S.R. & M.R.	185216
W 65/74		28/11/74	S.R.O.	185216
O.N.C.R. 27/83 - Respond				

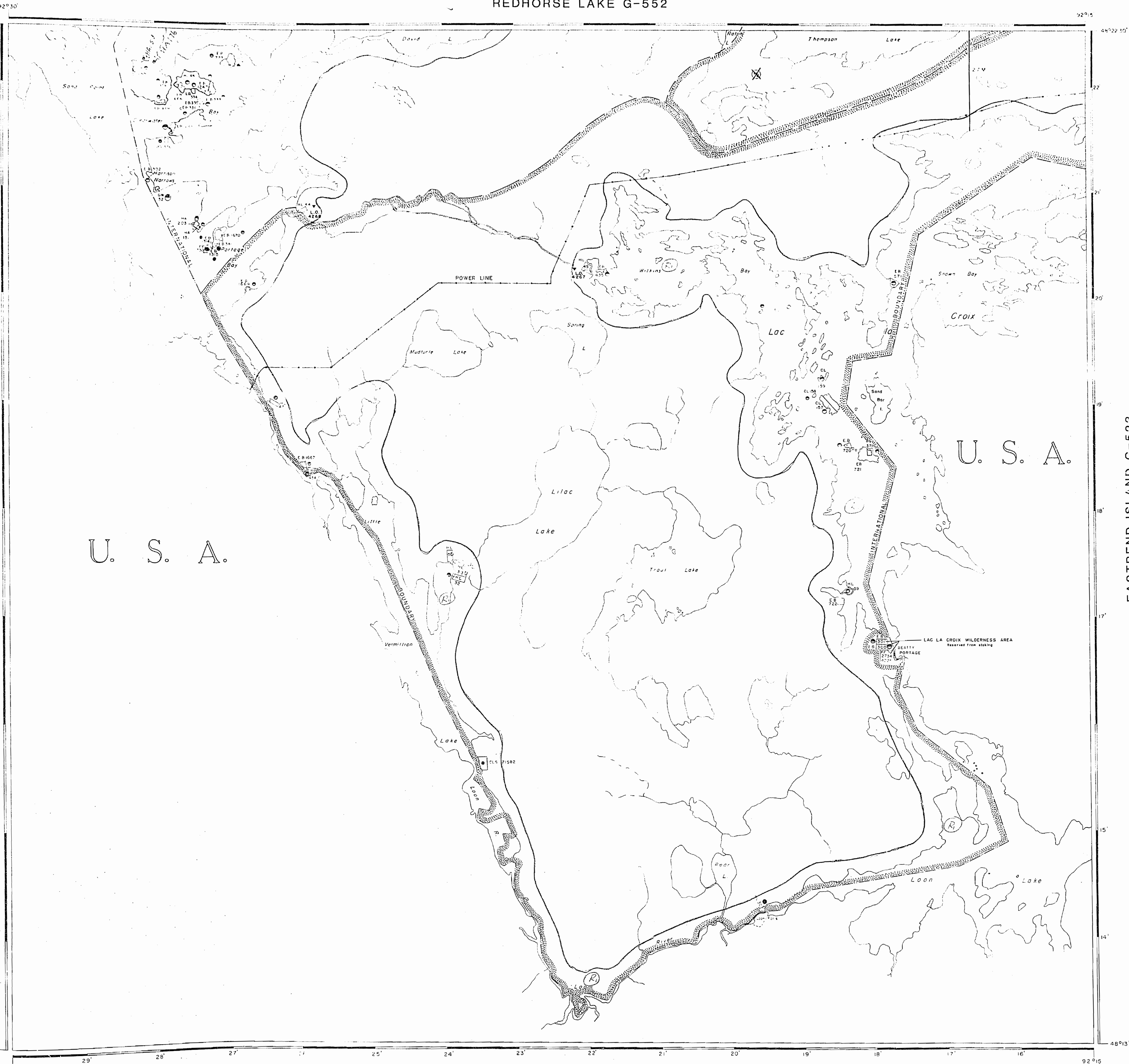

EASTBEND ISLAND G-523

LEGEND

HIGHWAY AND ROUTE No.	
OTHER ROADS	
TRAILS	
SURVEYED LINES	
TOWNSHIPS, BASE LINES, ETC.	
LOTS, MINING CLAIMS, PARCELS, ETC.	
UNSURVEYED LINES	
LOT LINES	
PARCEL BOUNDARY	
MINING CLAIMS ETC.	
RAILWAY AND RIGHT OF WAY	
UTILITY LINES	
NON-PERENNIAL STREAM	
FLOODING OR FLOODING RIGHTS	
SUBDIVISION OR COMPOSITE PLAN	
RESERVATIONS	
ORIGINAL SHORELINE	
MARSH OR MUSKEG	
MINES	
TRAVERSE MONUMENT	

DISPOSITION OF CROWN LANDS

TYPE OF DOCUMENT	SYMBOL
PATENT, SURFACE & MINING RIGHTS	
" SURFACE RIGHTS ONLY	
" MINING RIGHTS ONLY	
LEASE, SURFACE & MINING RIGHTS	
" SURFACE RIGHTS ONLY	
" MINING RIGHTS ONLY	
LICENCE OF OCCUPATION	
ORDER-IN-COUNCIL	
RESERVATION	
CANCELLED	
SAND & GRAVEL	

NOTE: MINING RIGHTS IN PARCELS PATENTED PRIOR TO MAY 6, 1913, VESTED IN ORIGINAL PATENTEE BY THE PUBLIC LANDS ACT, R.S.O. 1970, CHAP. 380, SEC. 62, SUBSEC. 1

SCALE: 1 INCH = 40 CHAINS

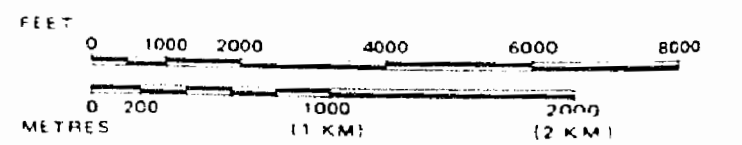

AREA  
**LILAC LAKE**  
 M.N.R. ADMINISTRATIVE DISTRICT  
**ATIKOKAN**  
 MINING DIVISION  
**THUNDER BAY**  
 LAND TITLES / REGISTRY DIVISION  
**RAINY RIVER**

Ministry of Natural Resources  
 Land Management  
 Ontario  
 April 19, 1982

Date: JANUARY 1982  
 Number: **G-535**

REDHORSE LAKE G-552

REFERENCES

AREAS WITHDRAWN FROM DISPOSITION

S.R. - SURFACE RIGHTS M.R. - MINING RIGHTS

Description	Order No.	Date	Disposition	File
SEC. 36/80	W. 76/85	9/11/85	M.S.S.	188501

THE INFORMATION THAT APPEARS ON THIS MAP HAS BEEN COMPILED FROM VARIOUS SOURCES, AND ACCURACY IS NOT GUARANTEED. THOSE WISHING TO STAKE MINING CLAIMS SHOULD CONSULT WITH THE MINING RECORDER, MINISTRY OF NORTHERN DEVELOPMENT AND MINES, FOR ADDITIONAL INFORMATION ON THE STATUS OF THE LANDS SHOWN HEREON.

LEGEND

HIGHWAY AND ROUTE No.	
OTHER ROADS	
TRAILS	
SURVEYED LINES:	
TOWNSHIPS, BASE LINES, ETC.	
LOTS, MINING CLAIMS, PARCELS, ETC.	
UNSURVEYED LINES	
LOT LINES	
PARCEL BOUNDARY	
MINING CLAIMS ETC.	
RAILWAY AND RIGHT OF WAY	
UTILITY LINES	
NON-PERENNIAL STREAM	
FLOODING OR FLOODING RIGHTS	
SUBDIVISION OR COMPOSITE PLAN	
RESERVATIONS	
ORIGINAL SHORELINE	
MARSH OR MUSKEG	
MINES	
TRAVERSE MONUMENT	

DISPOSITION OF CROWN LANDS

TYPE OF DOCUMENT	SYMBOL
PATENT, SURFACE & MINING RIGHTS	
" SURFACE RIGHTS ONLY	
" MINING RIGHTS ONLY	
LEASE, SURFACE & MINING RIGHTS	
" SURFACE RIGHTS ONLY	
" MINING RIGHTS ONLY	
LICENCE OF OCCUPATION	
ORDER IN COUNCIL	
RESERVATION	
CANCELLED	
SAND & GRAVEL	
LAND USE PERMITS FOR COMMERCIAL TOURISM/OUTPOST CAMPS	

NOTE: MINING RIGHTS IN PARCELS PATENTED PRIOR TO MAY 6, 1913 VESTED IN ORIGINAL PATENTEE BY THE PUBLIC LANDS ACT, R.S.O. 1970, CHAP. 380, SEC. 63, SUBSEC. 1

SCALE: 1 INCH = 40 CHAINS

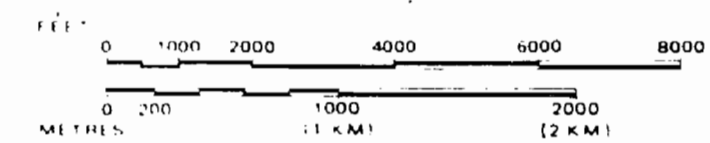

AREA  
**LILAC LAKE**  
 M.N.R. ADMINISTRATIVE DISTRICT  
**ATIKOKAN**  
 MINING DIVISION  
**THUNDER BAY**  
 LAND TITLES / REGISTRY DIVISION  
**RAINY RIVER**

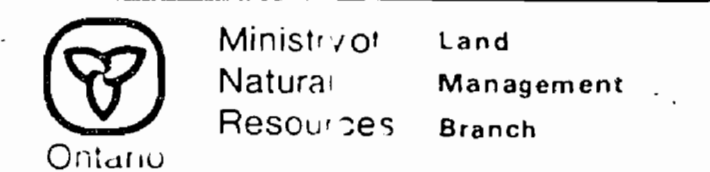

Date JANUARY 1982

Out of Service Nov. 28/1985 **G-535**

EASTBEND ISLAND G-523

U. S. A.

U. S. A.

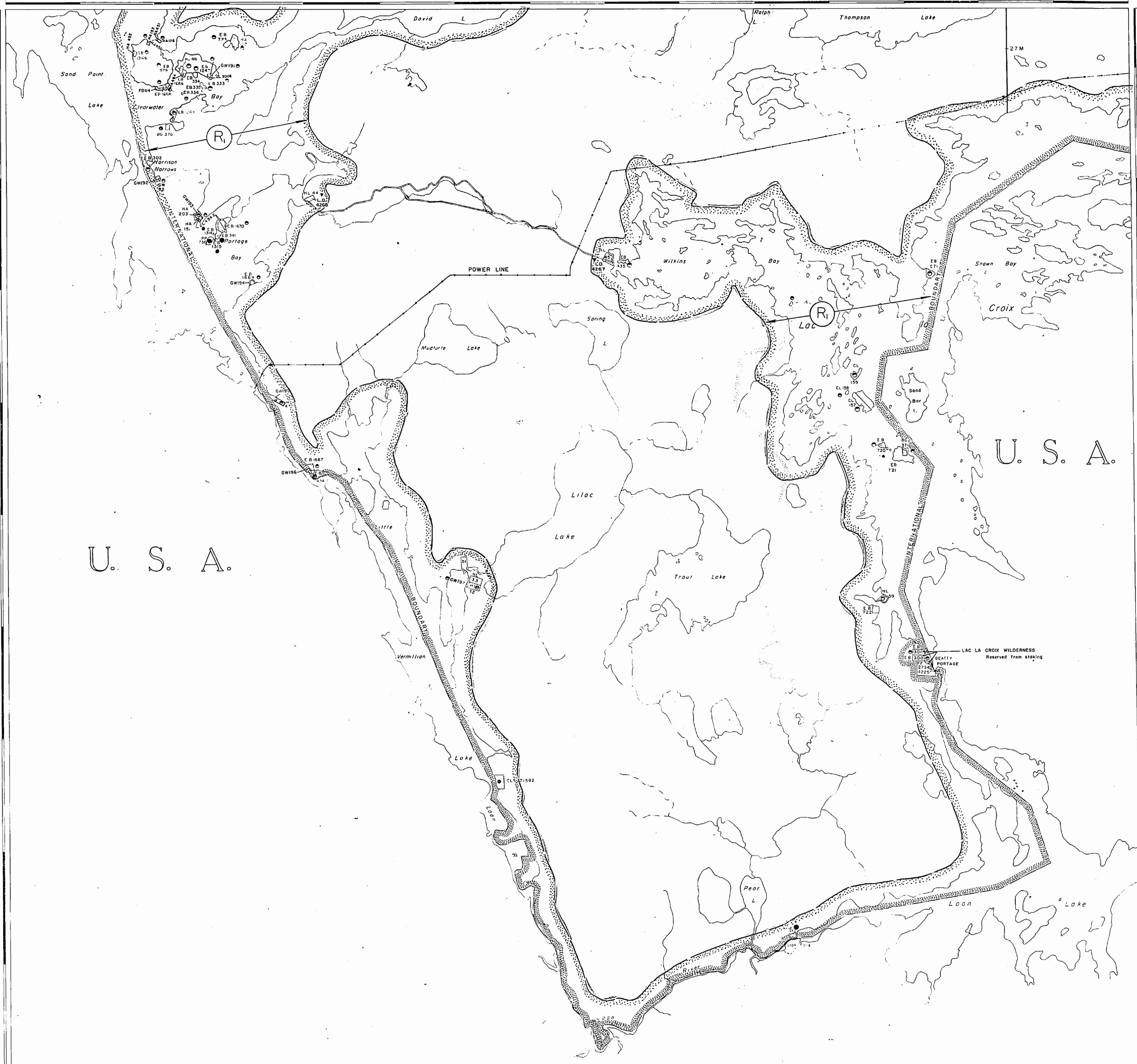

**AREAS WITHDRAWN FROM DISPOSITION**  
**M.R.O. - MINING RIGHTS ONLY**  
**S.R.O. - SURFACE RIGHTS ONLY**  
**M. + S. - MINING AND SURFACE RIGHTS**

Description	Order No.	Date	Disposition	File
SEC. 36/80	W 74/83	5/1/83	M. & S.	188501

**REDHORSE LAKE**

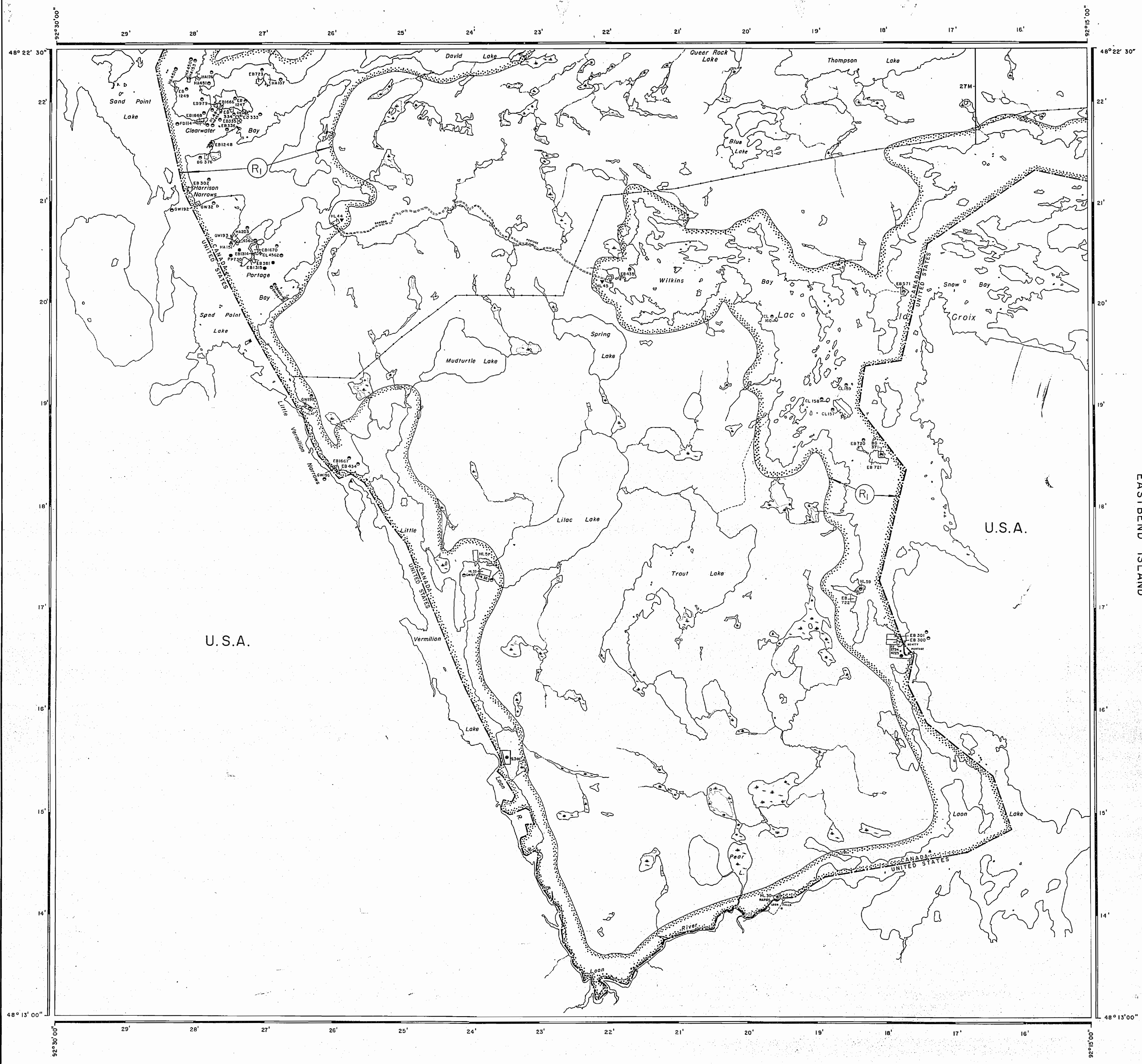

**NOTICE**  
 The information that appears on this map has been compiled from various sources and accuracy is not guaranteed. Those wishing to obtain MINING CLAIMS should consult with the MINING RECORDER, Ministry of Northern Development and Mines, for additional information on the status of the lands shown hereon.

**LEGEND**

HWY AND ROUTE No.	
OTHER ROADS	
TRAILS	
SURVEYED LINES:	
TOWNSHIPS, BASE LINES, ETC.	
LOTS, MINING CLAIMS, PARCELS, ETC.	
UNSURVEYED LINES:	
LOT LINES	
PARCEL BOUNDARY	
MINING CLAIMS ETC.	
RAILWAY AND RIGHT OF WAY	
UTILITY LINES	
NON-PERENNIAL STREAM	
FLOODING OR FLOODING RIGHTS	
SUBDIVISION OR COMPOSITE PLAN	
RESERVATIONS	
ORIGINAL SHORELINE	
MARSH OR MUSKEG	
MINES	
TRAVERSE MONUMENT	

**DISPOSITION OF CROWN LANDS**

TYPE OF DOCUMENT	SYMBOL
PATENT, SURFACE & MINING RIGHTS	
" SURFACE RIGHTS ONLY	
" MINING RIGHTS ONLY	
LEASE, SURFACE & MINING RIGHTS	
" SURFACE RIGHTS ONLY	
" MINING RIGHTS ONLY	
LICENCE OF OCCUPATION	
ORDER-IN-COUNCIL	
RESERVATION	
CANCELLED	
SAND & GRAVEL	

NOTE: MINING RIGHTS IN PARCELS PATENTED PRIOR TO MAY 6, 1913, VESTED IN ORIGINAL PATENTEE BY THE PUBLIC LANDS ACT, R.S.O. 1970, CHAP. 380, SEC. 62, SUBSEC. 1.

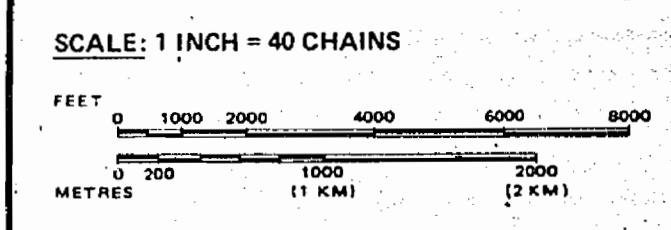

**AREA**  
**LILAC LAKE**  
 M.N.R. ADMINISTRATIVE DISTRICT  
**ATIKOKAN**  
 MINING DIVISION  
**THUNDER BAY**  
 LAND TITLES / REGISTRY DIVISION  
**RAINY RIVER**

Ministry of Natural Resources  
 Ministry of Northern Development and Mines

Date: DECEMBER 1986  
 Number: G-535  
 Service Nov. 28/95, LA

AREA OF  
**LILAC LAKE**  
 DISTRICT OF  
 RAINY RIVER  
 THUNDER BAY  
 MINING DIVISION  
 SCALE: 1-INCH = 40 CHAINS

**LEGEND**

PATENTED LAND	Ⓢ
CROWN LAND SALE	Ⓞ
LEASES	Ⓜ
LOCATED LAND	Loc.
LICENSE OF OCCUPATION	L.O.
MINING RIGHTS ONLY	M.R.O.
SURFACE RIGHTS ONLY	S.R.O.
ROADS	—
IMPROVED ROADS	—
KING'S HIGHWAYS	—
RAILWAYS	—
POWER LINES	—
MARSH OR MUSKEG	—
MINES	—

**NOTES**

400' Reserve around all Lakes & Rivers to Dept. of Lands & Forests

Areas withdrawn from staking under Section 43 of the Mining Act. (R.S.O. 70)

Order No.	File	Date	Disposition	
1	14	1952	24/12/74	54 N.M.M.
2	14	1952	18/10/74	54 N.M.M.

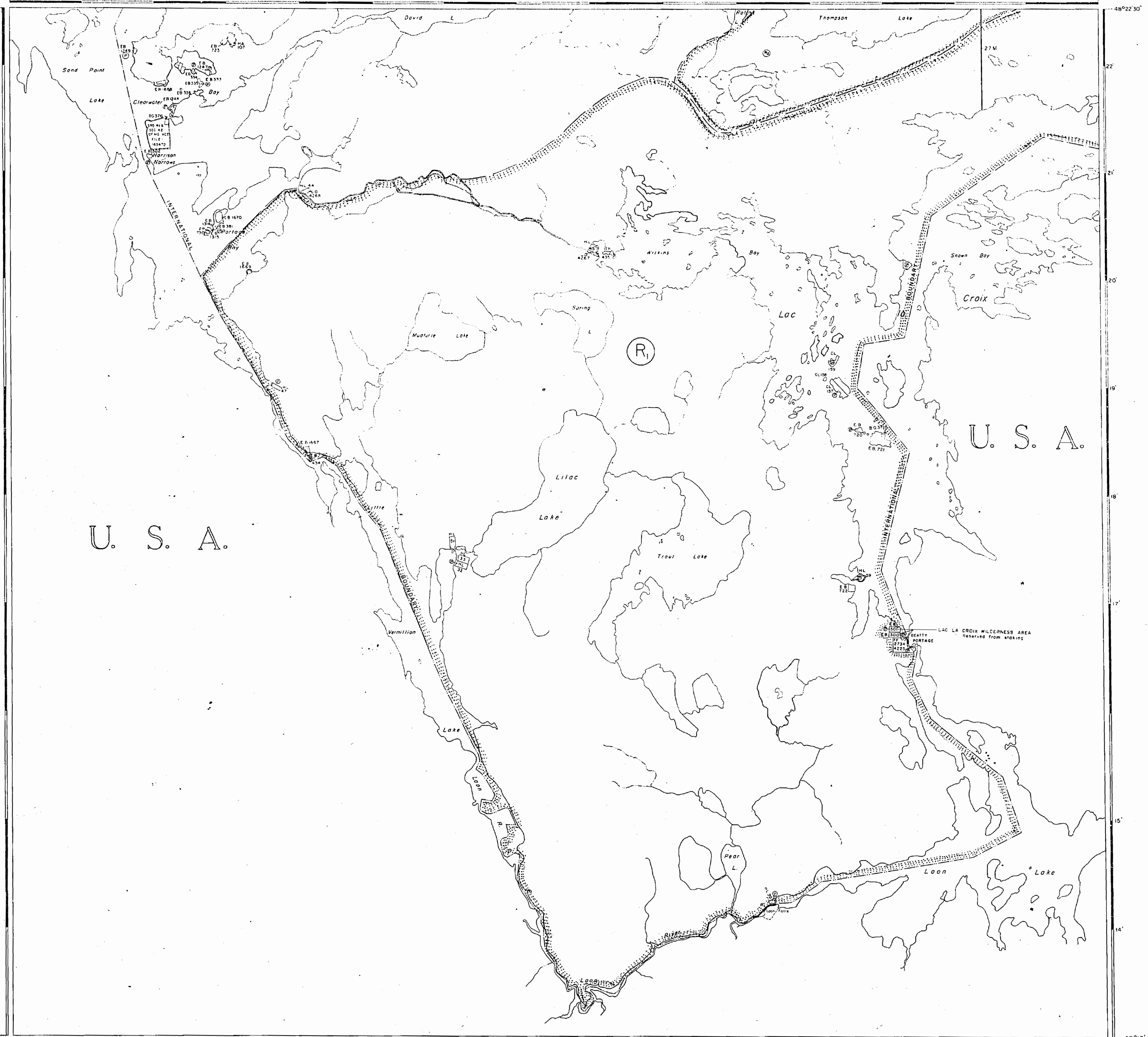

1977

FEB 15/77  
 ATIKOKAN DIST.  
 NATIONAL TOPOGRAPHIC SERIES 52C8  
 PLAN NO. M. 2434

ONTARIO  
 MINISTRY OF NATURAL RESOURCES  
 SURVEYS AND MAPPING BRANCH

2434

ONTARIO

STATE OF MINNESOTA.  
U.S.A.

STATE OF MINNESOTA.  
U.S.A.

PLAN OF  
SAND POINT LAKE AREA  
DISTRICT OF RAINY RIVER-WESTERN ONTARIO.  
Scale: 40 Chains to One Inch.

1946

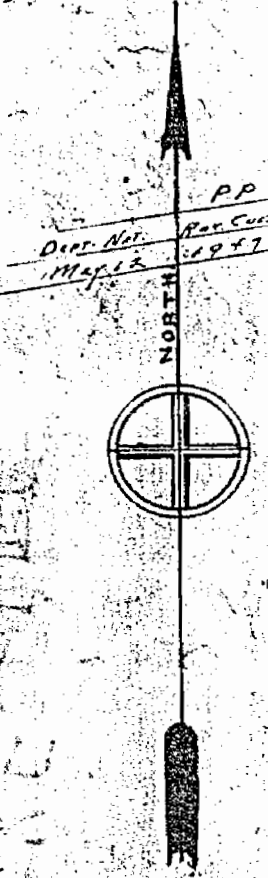

1000	1000	1000	1000	1000	1000	1000	1000	1000	1000
1000	1000	1000	1000	1000	1000	1000	1000	1000	1000
1000	1000	1000	1000	1000	1000	1000	1000	1000	1000
1000	1000	1000	1000	1000	1000	1000	1000	1000	1000
1000	1000	1000	1000	1000	1000	1000	1000	1000	1000
1000	1000	1000	1000	1000	1000	1000	1000	1000	1000
1000	1000	1000	1000	1000	1000	1000	1000	1000	1000
1000	1000	1000	1000	1000	1000	1000	1000	1000	1000
1000	1000	1000	1000	1000	1000	1000	1000	1000	1000
1000	1000	1000	1000	1000	1000	1000	1000	1000	1000

