

**REFERENCES**

**AREAS WITHDRAWN FROM DISPOSITION**

- M.R.O. - MINING RIGHTS ONLY
- S.R.O. - SURFACE RIGHTS ONLY
- M. + S. - MINING AND SURFACE RIGHTS

Description	Order No.	Date	Disposition	File
(R) WITHDRAWAL	KRL-81/96	OCT.02/96	S.35/M/A/R.S.03990	MNR FILE 19550

**NORTH OF LINGMAN LAKE**

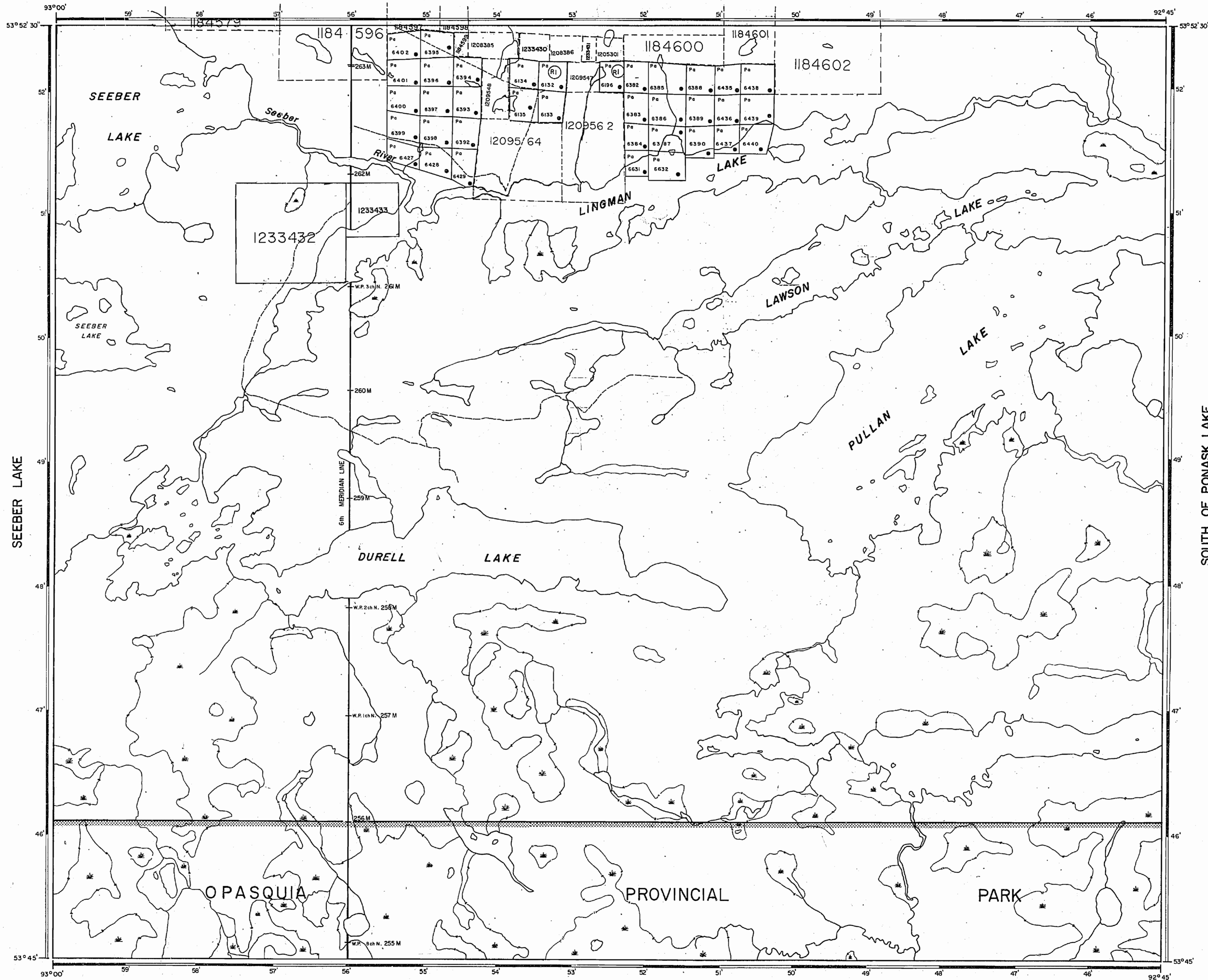

**LEGEND**

- HIGHWAY AND ROUTE No.
- OTHER ROADS
- TRAILS
- SURVEYED LINES:
  - TOWNSHIPS, BASE LINES, ETC.
  - LOTS, MINING CLAIMS, PARCELS, ETC.
- UNSURVEYED LINES:
  - LOT LINES
  - PARCEL BOUNDARY
  - MINING CLAIMS ETC.
- RAILWAY AND RIGHT OF WAY
- UTILITY LINES
- NON-PERENNIAL STREAM
- FLOODING OR FLOODING RIGHTS
- SUBDIVISION OR COMPOSITE PLAN RESERVATIONS
- ORIGINAL SHORELINE
- MARSH OR MUSKOG
- MINES
- TRAVERSE MONUMENT

**DISPOSITION OF CROWN LANDS**

TYPE OF DOCUMENT	SYMBOL
PATENT, SURFACE & MINING RIGHTS	
" SURFACE RIGHTS ONLY	
" MINING RIGHTS ONLY	
LEASE, SURFACE & MINING RIGHTS	
" SURFACE RIGHTS ONLY	
" MINING RIGHTS ONLY	
LICENCE OF OCCUPATION	
ORDER-IN-COUNCIL	
RESERVATION	
CANCELLED	
SAND & GRAVEL	

NOTE: MINING RIGHTS IN PARCELS PATENTED PRIOR TO MAY 6, 1913 VESTED IN ORIGINAL PATENTEE BY THE PUBLIC LANDS ACT, R.S.O. 1970, CHAP. 380, SEC. 63, SUBSEC. 1.

SCALE: 1 INCH = 40 CHAINS

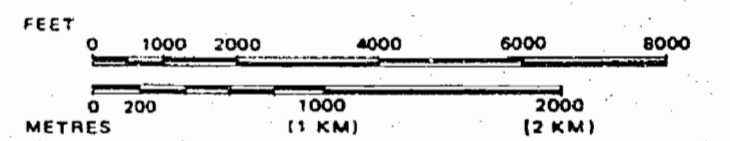

THE INFORMATION THAT APPEARS ON THIS MAP HAS BEEN COMPILED FROM VARIOUS SOURCES, AND ACCURACY IS NOT GUARANTEED. THOSE WISHING TO STAKE MINING CLAIMS SHOULD CONSULT WITH THE MINING RECORDER, MINISTRY OF NORTHERN DEVELOPMENT AND MINES, FOR ADDITIONAL INFORMATION ON THE STATUS OF THE LANDS SHOWN HEREON.

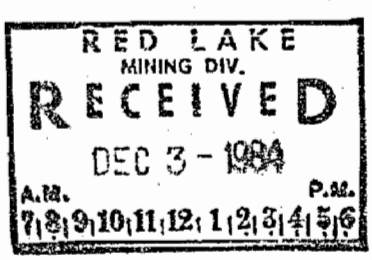

AREA  
**LINGMAN LAKE**  
M.N.R. ADMINISTRATIVE DISTRICT  
RED LAKE  
MINING DIVISION  
RED LAKE  
LAND TITLES / REGISTRY DIVISION  
KENORA (Patricia Portion)

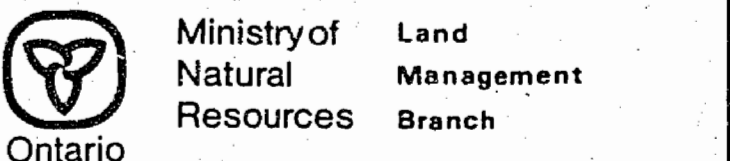

Date NOVEMBER 1984  
Number **G-1808**

REFERENCES

AREAS WITHDRAWN FROM DISPOSITION

- M.R.O. - MINING RIGHTS ONLY
- S.R.O. - SURFACE RIGHTS ONLY
- M.+S. - MINING AND SURFACE RIGHTS

Description	Order No.	Date	Disposition	File
(R) WITHDRAWAL	KRL-81/96	OCT.02/96	S.35 M/A/R.S.03990	MNR FILE 19510

NORTH OF LINGMAN LAKE

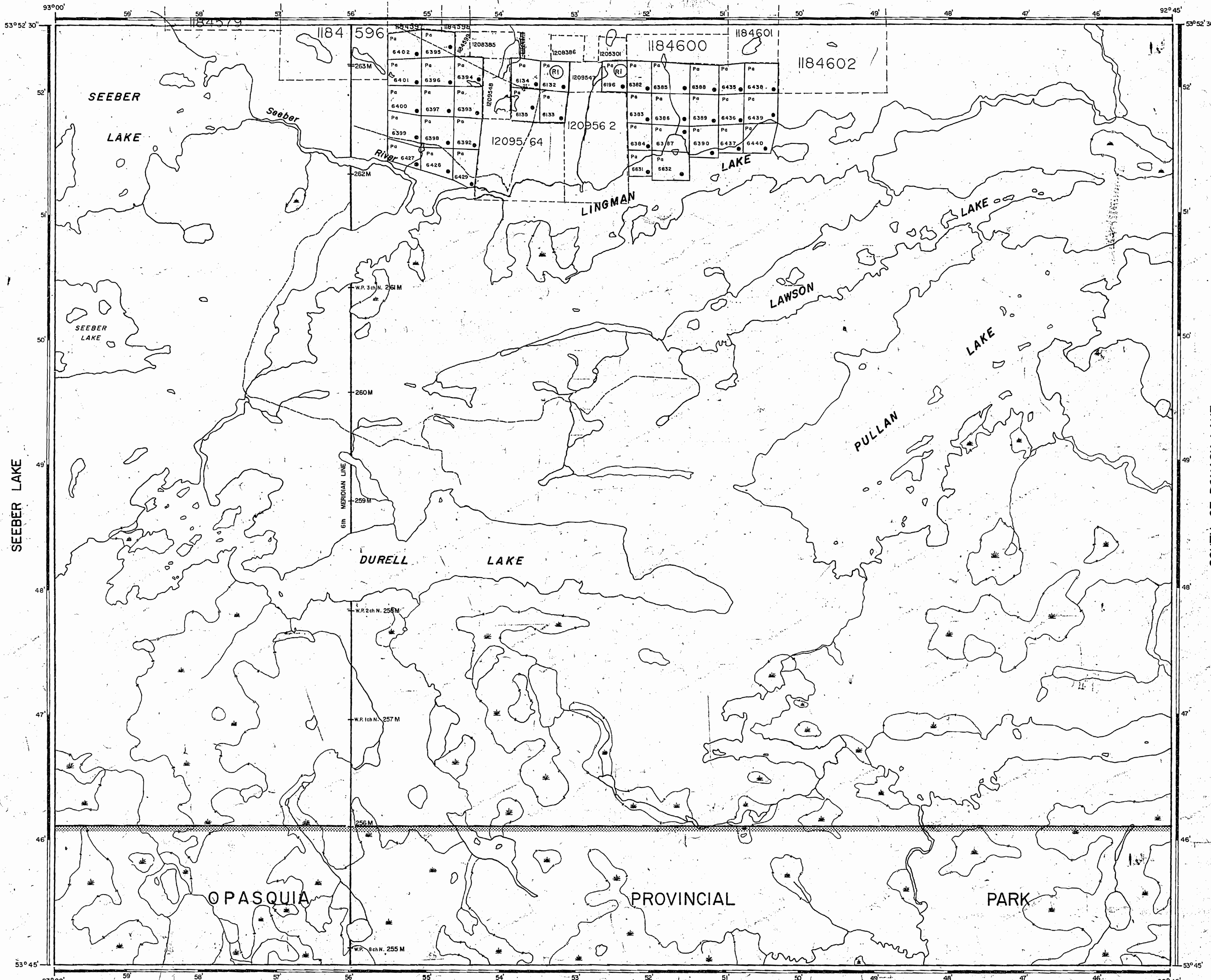

LEGEND

- HIGHWAY AND ROUTE No.
- OTHER ROADS
- TRAILS
- SURVEYED LINES: TOWNSHIPS, BASE LINES, ETC.
- LOTS, MINING CLAIMS, PARCELS, ETC.
- UNSURVEYED LINES: LOT LINES
- PARCEL BOUNDARY
- MINING CLAIMS ETC.
- RAILWAY AND RIGHT OF WAY
- UTILITY LINES
- NON-PERENNIAL STREAM
- FLOODING OR FLOODING RIGHTS
- SUBDIVISION OR COMPOSITE PLAN
- RESERVATIONS
- ORIGINAL SHORELINE
- MARSH OR MUSKEG
- MINES
- TRAVERSE MONUMENT

DISPOSITION OF CROWN LANDS

TYPE OF DOCUMENT	SYMBOL
PATENT, SURFACE & MINING RIGHTS	
" SURFACE RIGHTS ONLY	
" MINING RIGHTS ONLY	
LEASE, SURFACE & MINING RIGHTS	
" SURFACE RIGHTS ONLY	
" MINING RIGHTS ONLY	
LICENCE OF OCCUPATION	
ORDER-IN-COUNCIL	
RESERVATION	
CANCELLED	
SAND & GRAVEL	

NOTE: MINING RIGHTS IN PARCELS PATENTED PRIOR TO MAY 6, 1913, VESTED IN ORIGINAL PATENTEE BY THE PUBLIC LANDS ACT, R.S.O. 1970, CHAP. 380, SEC. 63, SUBSEC. 1.

SCALE: 1 INCH = 40 CHAINS

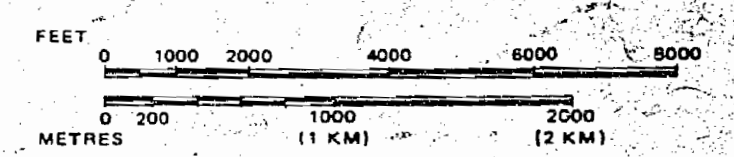

THE INFORMATION THAT APPEARS ON THIS MAP HAS BEEN COMPILED FROM VARIOUS SOURCES, AND ACCURACY IS NOT GUARANTEED. THOSE WISHING TO STAKE MINING CLAIMS SHOULD CONSULT WITH THE MINING RECORDER, MINISTRY OF NORTHERN DEVELOPMENT AND MINES, FOR ADDITIONAL INFORMATION ON THE STATUS OF THE LANDS SHOWN HEREON.

DATE OF ISSUE

JAN 23 1998

PROVINCIAL RECORDING OFFICE SUDBURY  
 RECEIVED  
 DEC 3 - 1998  
 A.M. P.M.  
 7 8 9 10 11 12 1 2 3 4 5 6

AREA  
**LINGMAN LAKE**  
 M.N.R. ADMINISTRATIVE DISTRICT  
 RED LAKE  
 MINING DIVISION  
 RED LAKE  
 LAND TITLES / REGISTRY DIVISION  
 KENORA (Patricia Portion)

Ministry of Natural Resources  
 Land Management Branch  
 Ontario

2064

Area North Of Lingman Lake (M.2198)

AREA OF  
**LINGMAN LAKE**

DISTRICT OF  
KENORA  
(PATRICIA PORTION)

RED LAKE  
MINING DIVISION

SCALE: 1-INCH = 40 CHAINS

LEGEND

- PATENTED LAND Ⓟ
- CROWN LAND SALE C.S.
- LEASES Ⓛ
- LOCATED LAND Loc
- LICENSE OF OCCUPATION L.O.
- MINING RIGHTS ONLY M.R.O.
- SURFACE RIGHTS ONLY S.R.O.
- ROADS —
- IMPROVED ROADS —
- KING'S HIGHWAYS —
- RAILWAYS —
- POWER LINES —
- MARSH OR MUSKEG —
- MINES Ⓧ
- CANCELLED C.

NOTES

400' SURFACE RIGHTS RESERVATION AROUND  
ALL LAKES AND RIVERS.

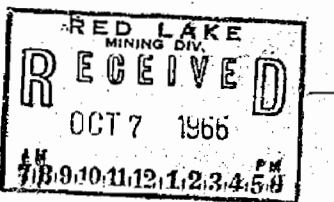

PLAN NO. M.2064

DEPARTMENT OF MINES  
— ONTARIO —

Seeber Lake Area (M.2179)

Area South Of Ponask Lake (M.2027)

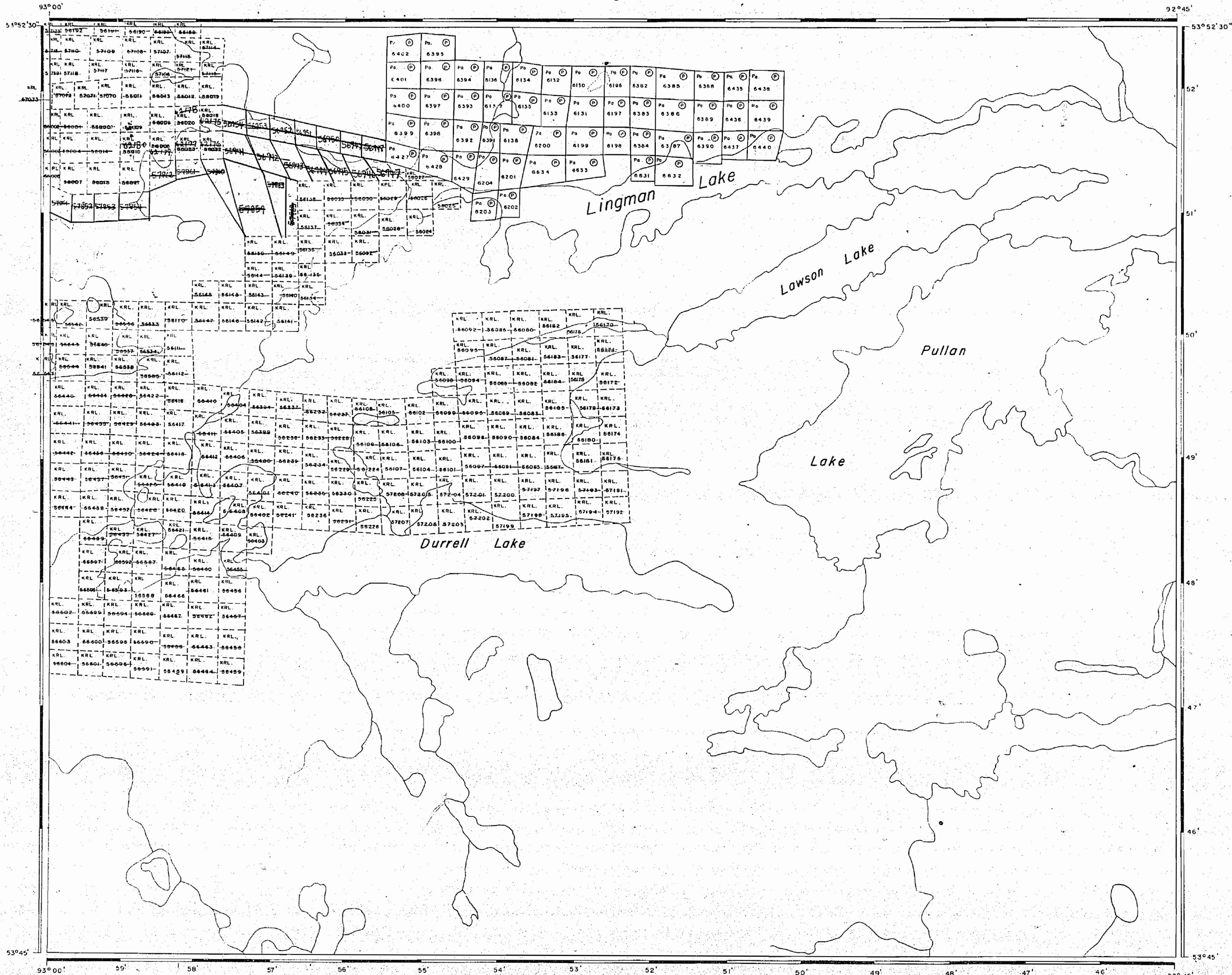

Area North Of Lingman Lake (M. 2198)

Seeber Lake Area (M. 2179)

Area South Of Ponusk Lake (M. 2027)

AREA OF LINGMAN LAKE

DISTRICT OF KENORA (PATRICIA PORTION)

RED LAKE MINING DIVISION

SCALE: 1-INCH = 40 CHAINS

LEGEND

- PATENTED LAND (P)
- CROWN LAND SALE (CS)
- LEASES (L)
- LOCATED LAND (Loc)
- LICENSE OF OCCUPATION (L.O.)
- MINING RIGHTS ONLY (M.R.O.)
- SURFACE RIGHTS ONLY (S.R.O.)
- ROADS (—)
- IMPROVED ROADS (—)
- KING'S HIGHWAYS (—)
- RAILWAYS (—)
- POWER LINES (—)
- MARSH OR MUSKEG (—)
- MINES (X)
- CANCELLED (C)

NOTES

ALL SURFACE RIGHTS RESERVED UNLESS SHOWN OTHERWISE  
ALL RIVERS AND RIVERS



NATIONAL TOPOGRAPHIC SERIES 53 F

PLAN NO. M.2064

ONTARIO DEPARTMENT OF MINES AND NORTHERN AFFAIRS

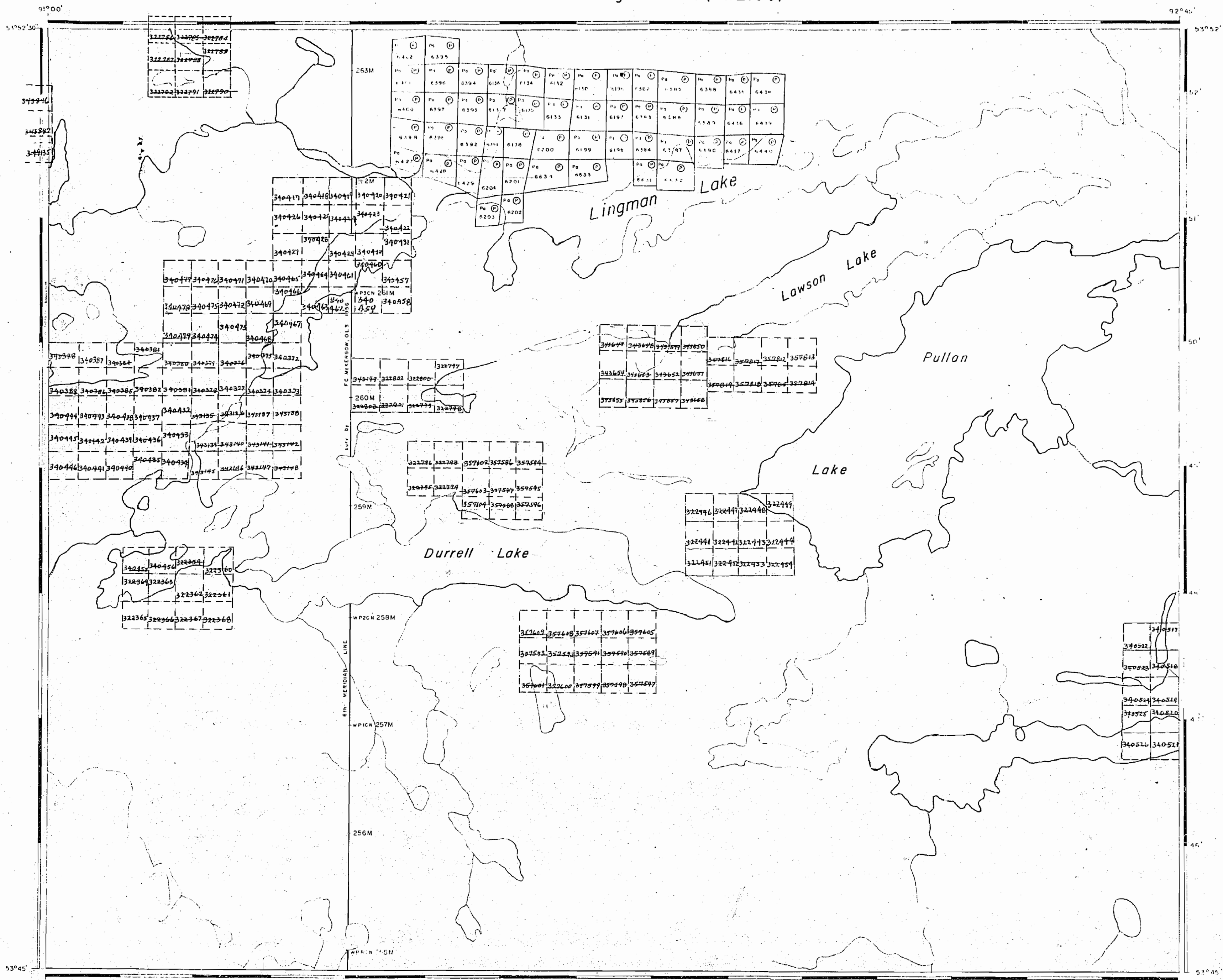

SEE PLAN M. 1815

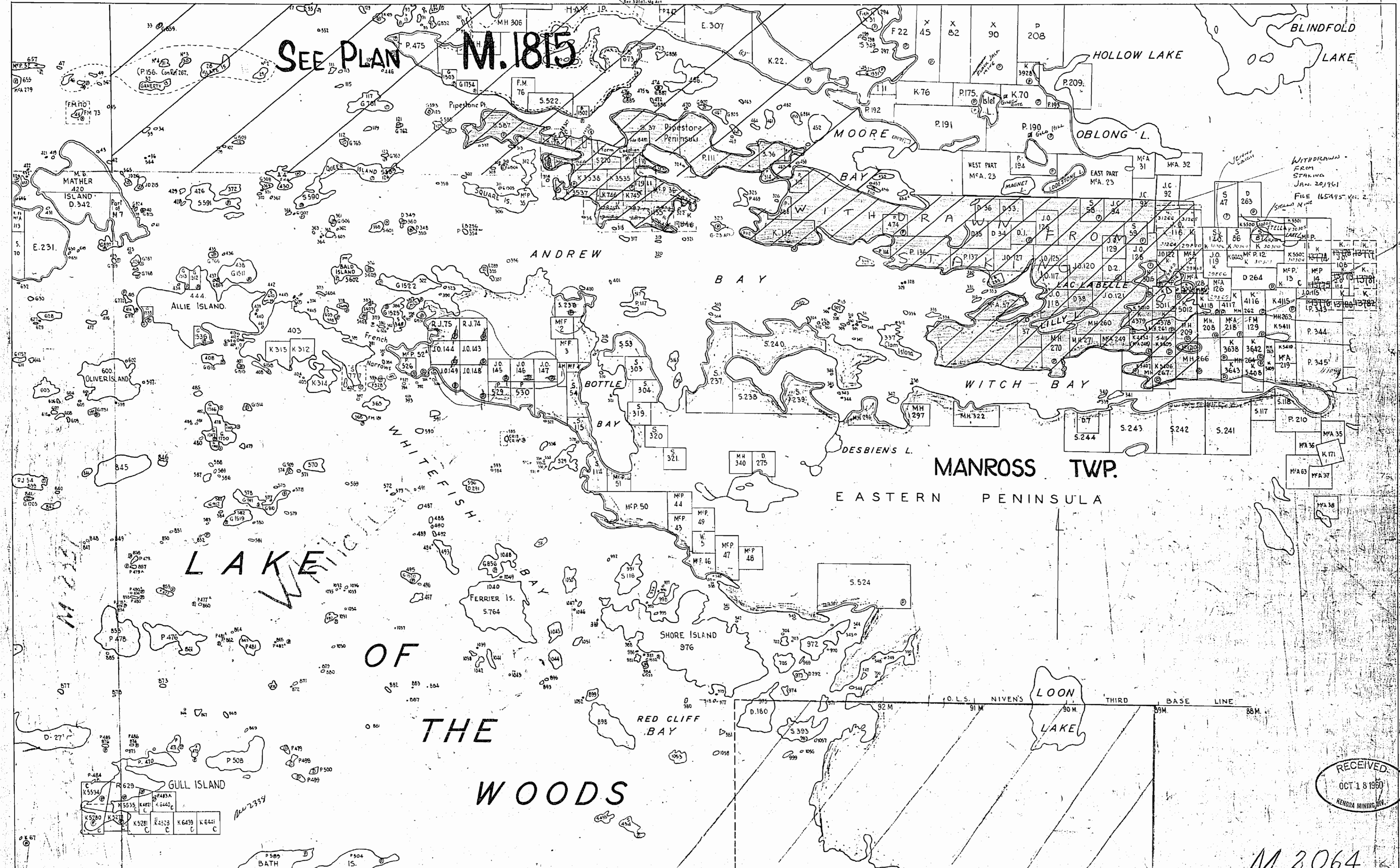

**FLOODING:**  
 In the disposition of Crown lands, the Flooding Rights, without compensation, by Easement Contours 1051.20 and 1053.86, Survey of CANADA, DATUM 1923, Adjusted for detail of Contour Refer to plans filed in PATENTS BRANCH and Survey Division, see FILE 4922.  
 Contour 1051.20 is from the head Dalles Rapids to controls Old Fort Controls Old Fort Island including Lake Bay and Tributaries Jan 1940.

WITHDRAWN FROM STAKING  
 Jan. 20, 1961  
 FILE 165495 Vol. 2

Islands in Lake of the Woods withdrawn from staking under Sect. 39 Sub c. File 67051

M 2064  
 MANROSS TWP

Islands in Lake of the Woods withdrawn from staking under Sect. 39 Sub c. File 67051

RECEIVED  
 OCT 18 1960  
 RENOVIA MINING DIV.

29-D

DISTRICT OF KENORA

TRACED

APPROVED

DEPARTMENT

2064

Nov 18/60  
165495-11

THE TOWNSHIP OF  
OF  
**MANROSS**

DISTRICT OF  
KENORA

KENORA  
MINING DIVISION

SCALE: 1-INCH = 40 CHAINS

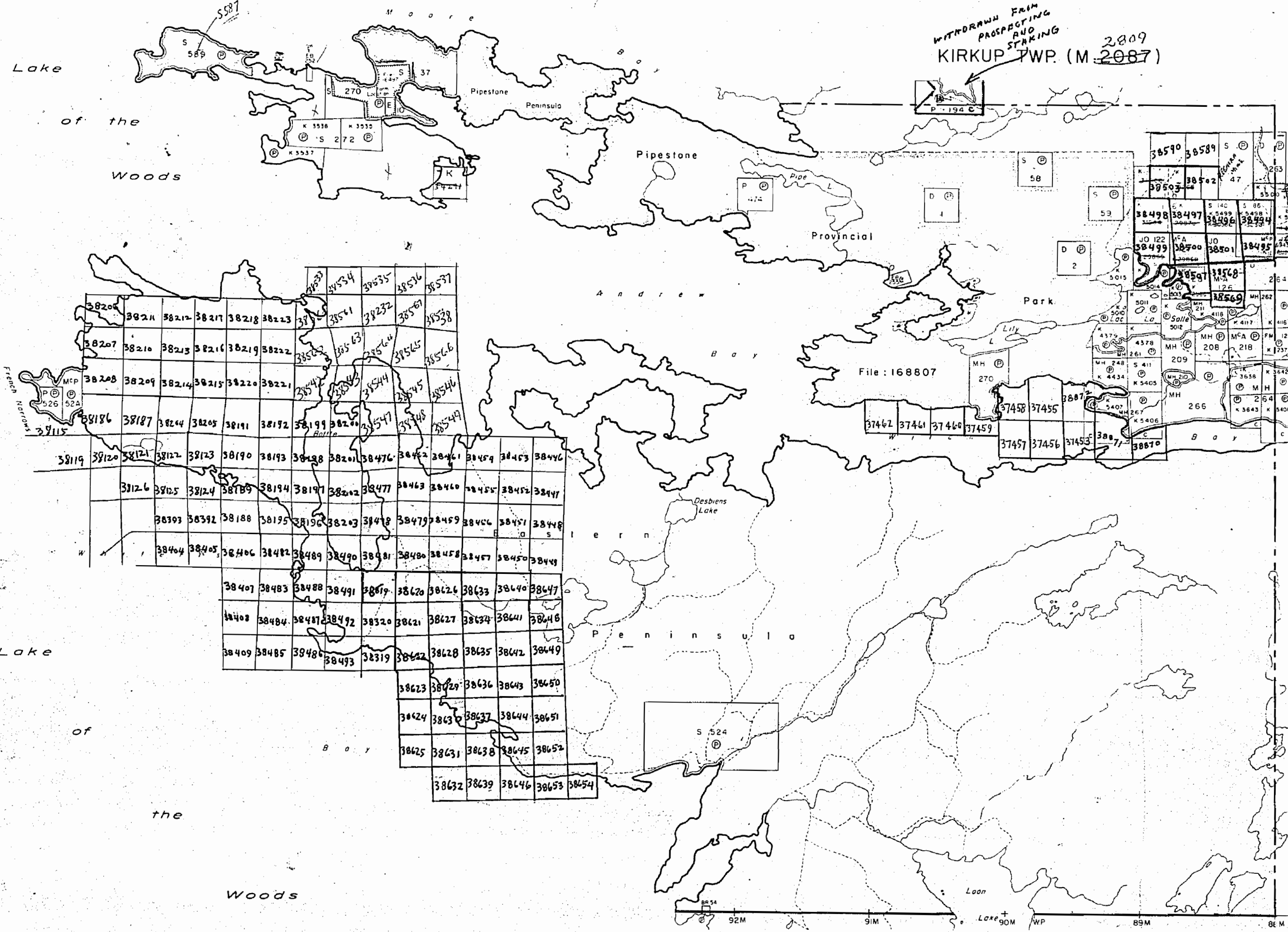

LEGEND

- PATENTED LAND Ⓟ
- CROWN LAND SALE C.S.
- LEASES Ⓛ
- LOCATED LAND Loc.
- LICENSE OF OCCUPATION L.O.
- MINING RIGHTS ONLY M.R.O.
- SURFACE RIGHTS ONLY S.R.O.
- ROADS —
- IMPROVED ROADS —
- KING'S HIGHWAYS —
- RAILWAYS —
- POWER LINES —
- MARSH OR MUSKEG —
- MINES X
- CANCELLED C.

NOTES

- 400' surface rights reservation around all lakes and rivers.
- Reserve flooding rights up to 1064' above mean sea level on all lands bordering on Lake of the Woods. File - 4922 vol. 1.

RECEIVED  
JUN 20 1962  
KENORA MINING DIV.

October 11/62  
Oct. 23/62  
July 29/64  
Jan. 27/65  
June 23/65  
MAR. 21/66  
APR. 1/66  
April 6/66  
Apr. 20/66

Large area Pipestone Peninsula, withdrawn from staking. Sec. 34(d) See RES.P. 1/20/61 (163474)

PLAN NO.- M.2064

DEPARTMENT OF MINES

MANROSS

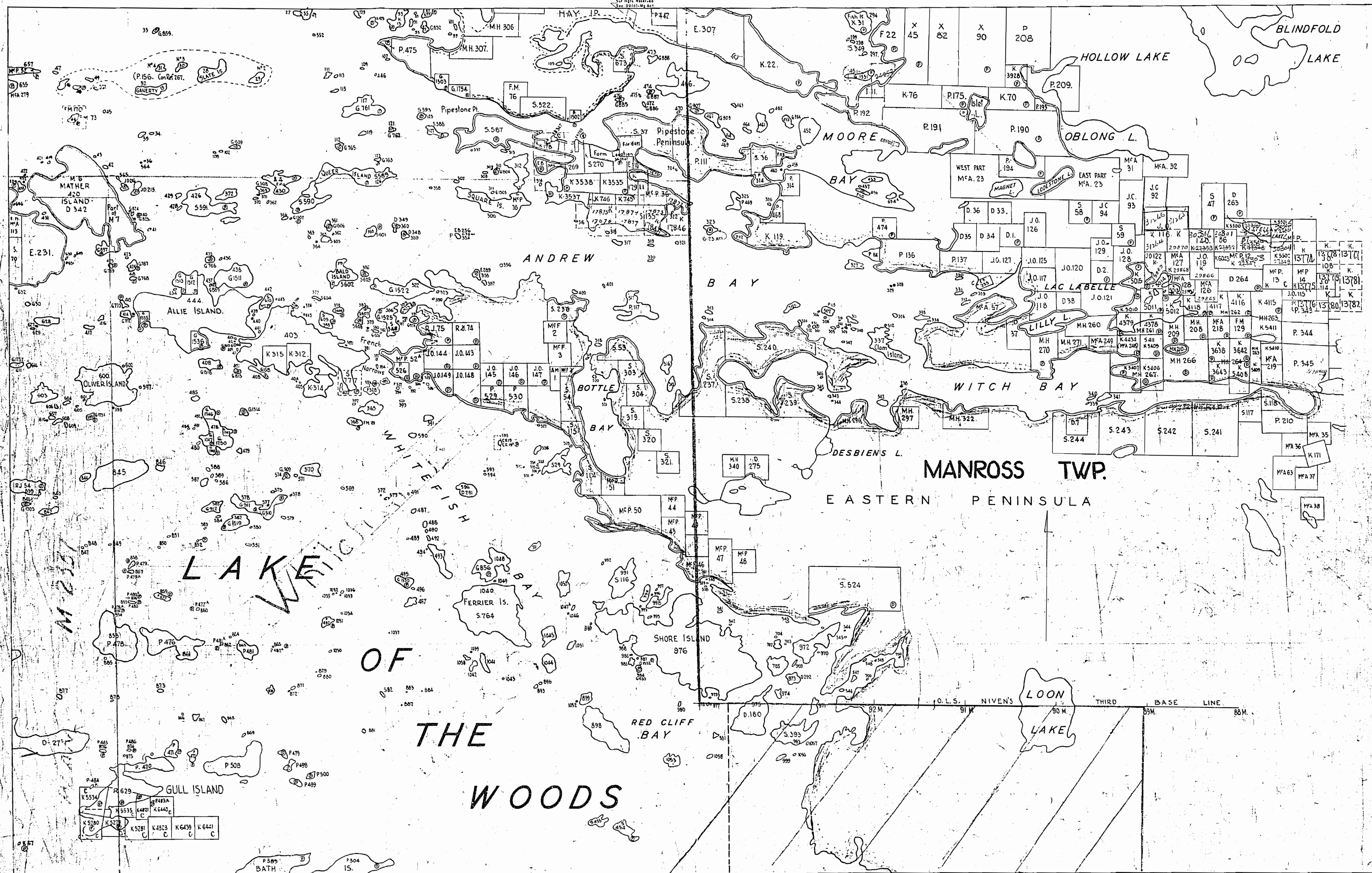

REFERENCES

**FLOODING:-**  
 In the disposition of Crown Lands, Easement Contours 1051-20 and 1053-86. Ge. Survey of CANADA, DATUM, 1923 Adjusted. For detail of Contour, Refer to plans filed in PATENTS BRANCH AND SURV. DIVISION, see FILE 4922.  
 Contour 1051-20 is from the head of Dalles Rapids to controls Old Fort Island including: DARLINGTON BAY and TAUBURIES Jan 1940.

*2064*  
 MANROSS 2064

Islands in Lake of the Woods withdrawn from staking under Sect. 39, Sub. c. File 67051.

**LEGEND**

- Railway
- Paved Highway
- Gravel Highway
- Other Motor Road
- Wagon Road
- Trail for Path
- Highway (Route Number)
- Telephone or Telegraph Line
- Electric Power Line
- SURFACE RIGHTS RESERVED FOR SUMMER RESORTS

**DISPOSITION OF CROWN LANDS**

- PATENTED
- LEASE
- LICENSE OF OCCUPATION
- AREA PLAN

**DISTRICT OF WENORA**

TRACED BY J.D. CHECKED BY S.C.A.  
 APPROVED BY J.D. ON FILE  
 DEPARTMENT OF TORONTO (ONTARIO)

Islands in Lake of the Woods withdrawn from staking under Sect. 39, Sub. c. File 67051.

SEE PLAN M. 1815

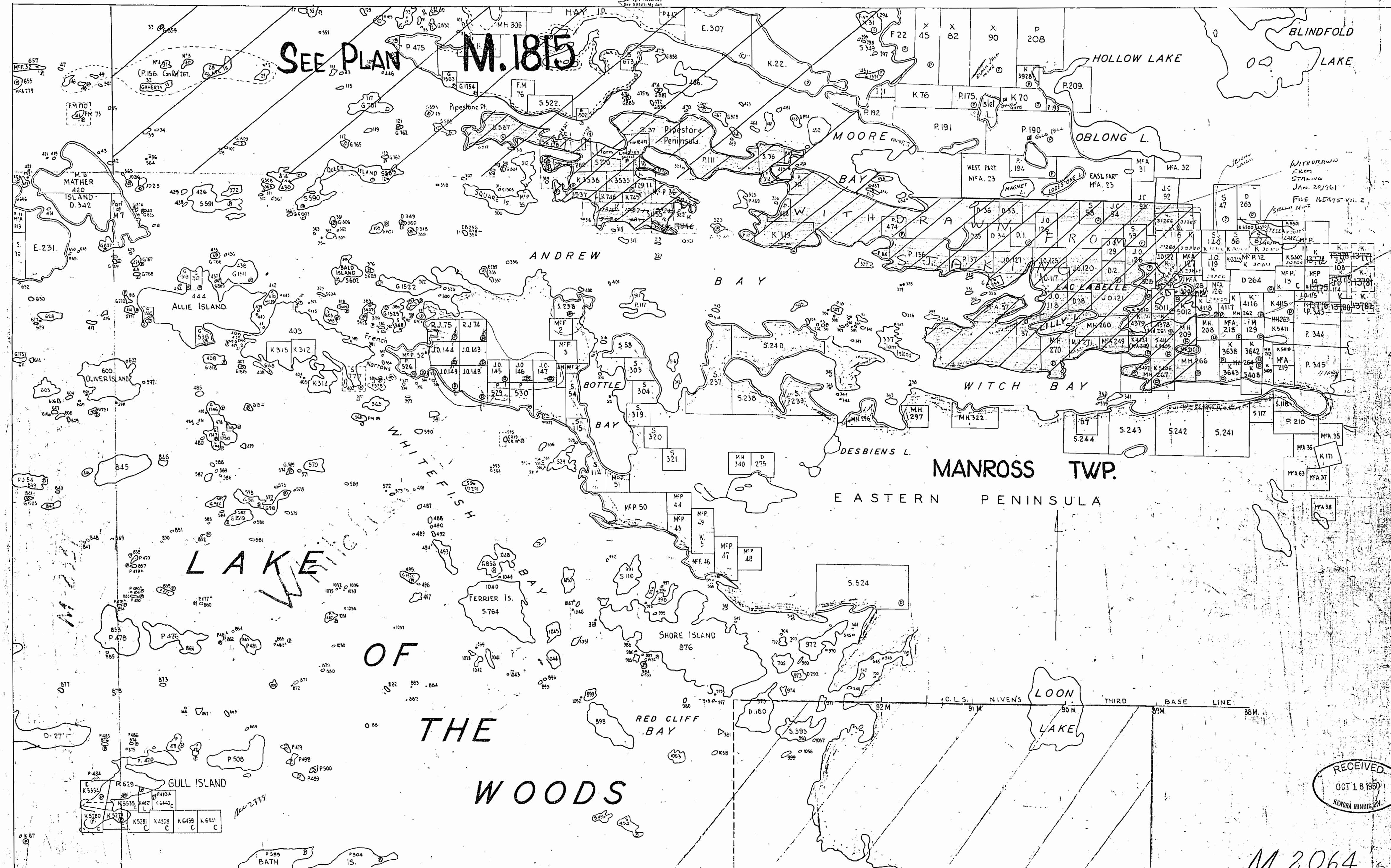

**FLOODING:**  
In the disposition of Crown lands, the Flooding Rights, without compensation, of Easement Contours 105120 and 105386 of the SURVEY OF CANADA, Datum 1923, Adjusted, For detail of Contour, refer to port plans filed in PATENTS BRANCH, LAND SURVEY DIVISION, see File 4922.  
Contour 105120 is from the head of Dalles Rapids to controls Old Fort Controls Old Fort Island including Mather Bay and Tributaries Jan 1940.

WITHDRAWN FROM STAKING  
Jan. 20/1961  
FILE 165415 Vol. 2

RECEIVED  
OCT 18 1960  
KENORA MINING DIV.

Islands in Lake of the Woods withdrawn from staking under Sect 39 Sub. c. File 67051.

M 2064  
MANROSS TWP

Islands in Lake of the Woods withdrawn from staking under Sect 39 Sub. c. File 67051.

29-D

DISTRICT OF KENORA

TRACED

APPROVED

DEPARTMENT



REFERENCES

**FLOODING:**  
 In the disposition of Crown Lands, R. Flooding Rights, without compensation up to Easement Contours 1051-20 and 1053-86. G. SURVEY OF CANADA, DATUM, 1923 Adjusted. For detail of Contour, Refer to plans filed in PATENTS BRANCH AND SURVEY DIVISION, SEE FILE 4922.  
 Contour 1051-20 is from the head of Dalles Rapids to controls Old Fort Contour 1053-86 is from the Head of Controls: Old Fort Island including Darby Bay and Tributaries Jan. 1940.

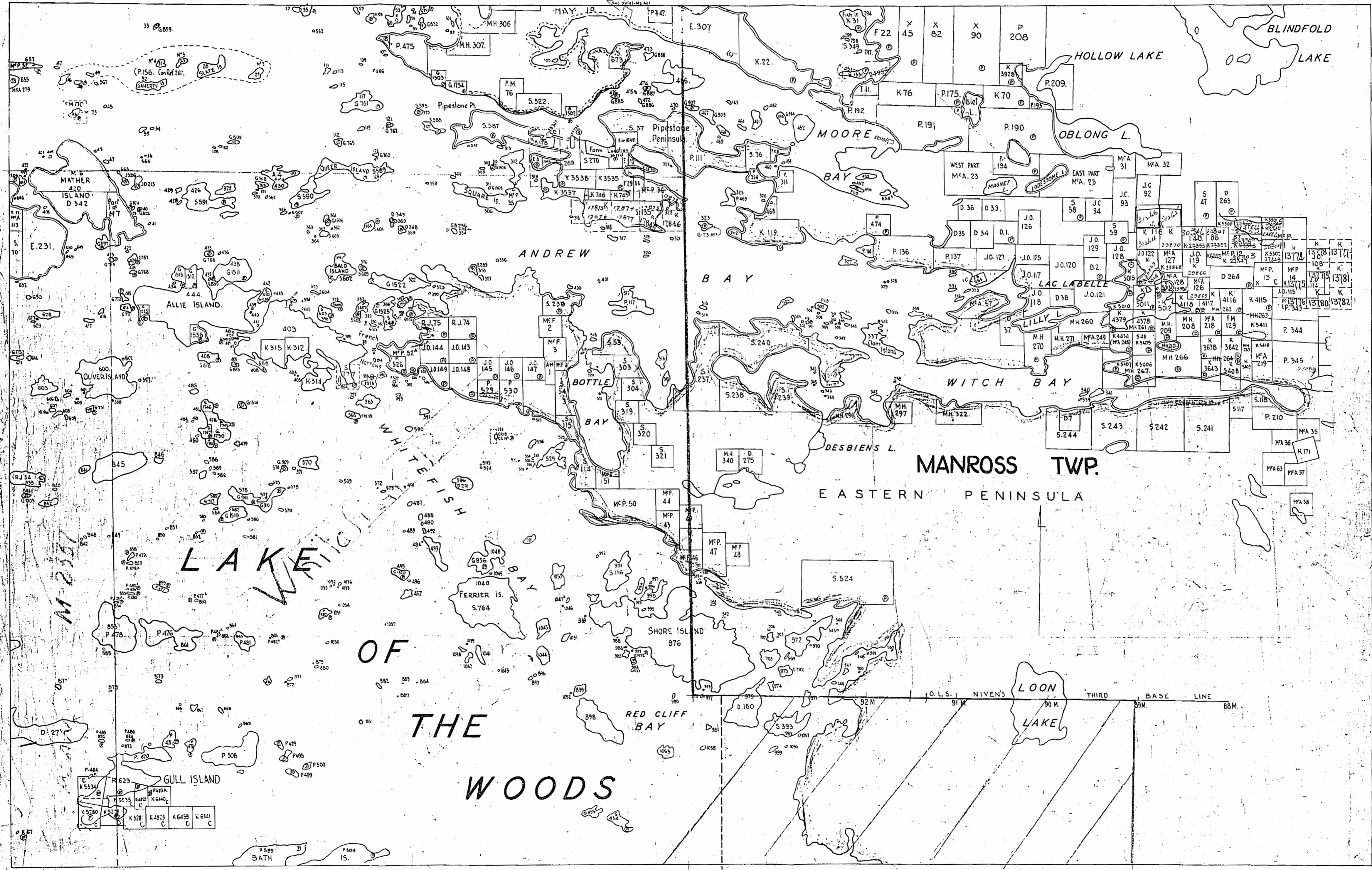

**LEGEND**

- Railway
- Paved Highway
- Gravel Highway
- Other Motor Road
- Wagon Road
- Trail or Path
- Highway Route Number
- Telephone or Teletype Line
- Electric Power Line
- SURFACE RIGHTS RESERVED FOR SUMMER RESORTS

**DISPOSITION OF CROWN LANDS**

PATENTED

LEASE

LICENSE OF OCCUPATION

AREA PLAN

DISTRICT OF **KENORA**

TRACED  IE: D:  CHECKED

APPROVED: *[Signature]* SC

DEPARTMENT OF LANDS AND FORESTS  
 TORONTO ONTARIO

Islands in Lake of the Woods withdrawn from staking under Sect. 39, Sub. c. File 67051.

2338

2064 MANROSS 2064

2064

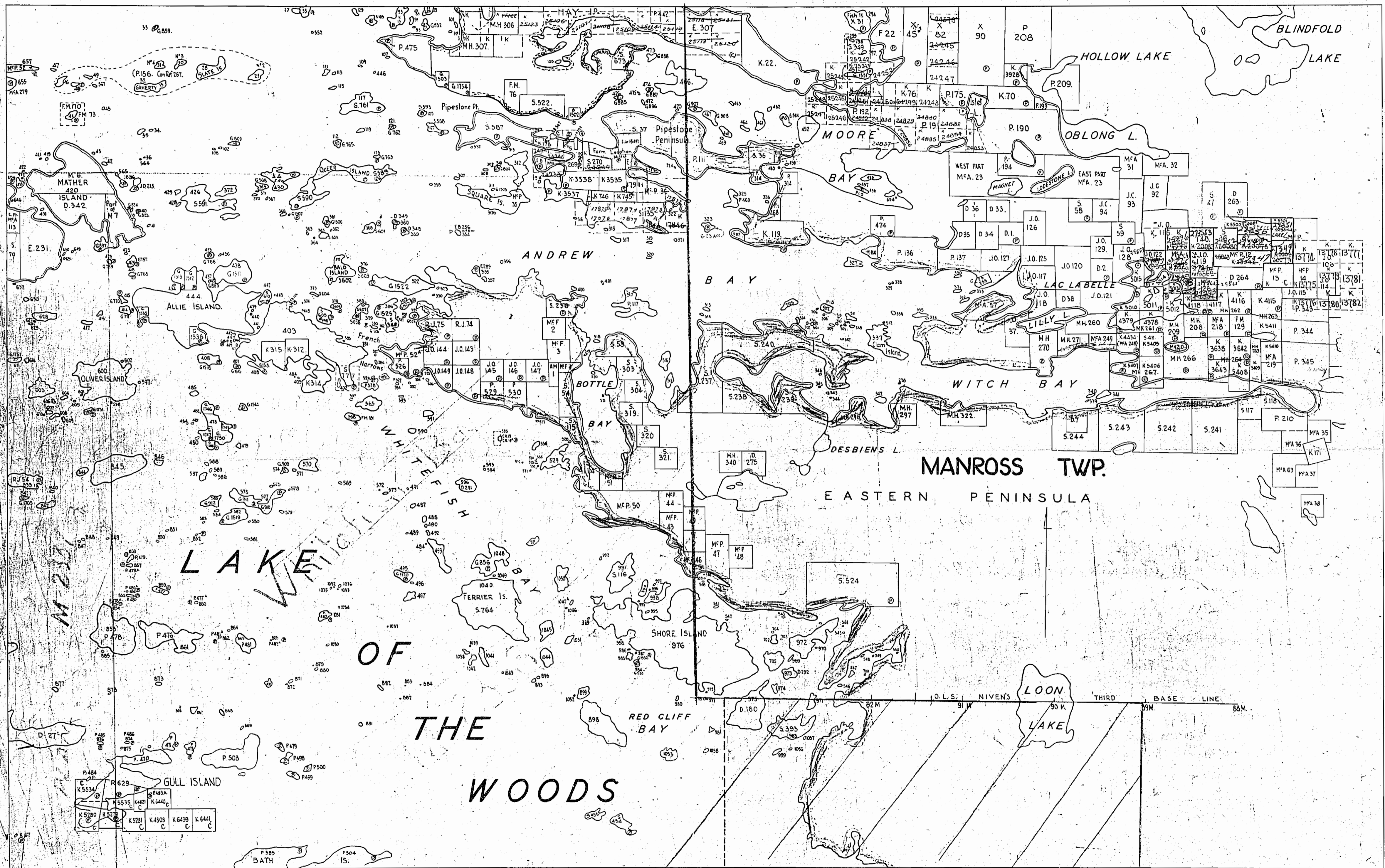

**REFERENCES**

**FLOODING:**  
 In the disposition of Crown Lands, Reserve Flooding Rights, without compensation up to Easement Contours 1051-20 and 1053-86 Geodetic SURVEY OF CANADA, DATUM, 1923 Adjustment. For detail of Contour, Refer to portfolio Plans filed in PATENTS BRANCH AND SURVEYS DIVISION, SEE FILE 4322.  
 Contour 1051-20 is from the head of Dalles Rapids to controls Old Fort Island.  
 Contour 1053-86 is from the Head of Controls Old Fort Island including DARLINGTON BAY and TRIBUTARIES Jan 1940.

**LEGEND**

- Railway
- Paved Highway
- Gravel Highway
- Other Motor Road
- Wagon Road
- Trail or Path
- Highway Route Number
- Telephone or Telegraph Line
- Electric Power Line
- SURFACE RIGHTS RESERVED FOR SUMMER RESORTS 100 FEET WIDE

**DISPOSITION OF CROWN LANDS**

PATENTED

LEASE

LICENSE OF OCCUPATION

**AREA PLAN**

DISTRICT OF **KENORA**

TRACED BY J.D. CHECKED BY J.D.

APPROVED: [Signature] SCALE: 1 IN. = 140 CHS.

DEPARTMENT OF LANDS AND FORESTS

TORONTO, ONTARIO, CANADA

Islands in Lake of the Woods, withdrawn from staking under Sect. 39 Sub. c. File 67051

2064

2064

REFERENCES

FLOODING:-  
 In the disposition of Crown Lands, Reserve Flooding Rights, without compensation up to Esameur Contours 1051-20 and 1053-86 Geopetric Survey of Canada, Datum, 1923 Adjustment. For detail of Contour, Refer to portfolio plans filed in PATENTS BRANCH AND SURVEYS DIVISION, see FILE 4922.  
 Contour 1051-20 is from the head of Dalles Rapids to controls Old Fort Island.  
 Contour 1053-86 is from the Head of Controls Old Fort Island including DARLINGTON Bay and TRIBUTARIES Jan 1940.

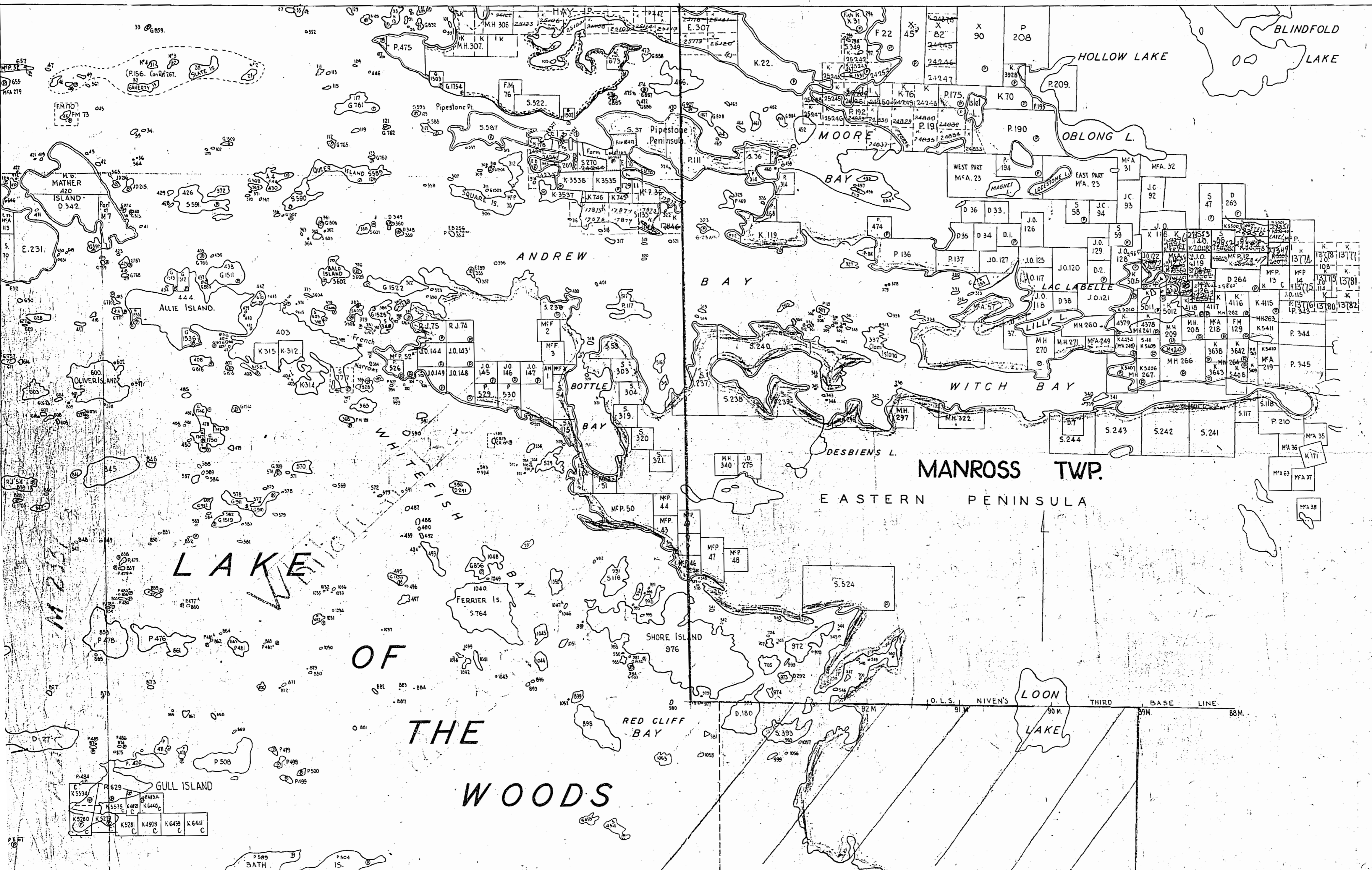

2064

L.E.G.E.N.D.

- Railway
- Paved Highway
- Gravel Highway
- Other Motor Road
- Wagon Road
- Trail or Path
- Highway Route Number
- Telephone or Telegraph Line
- Electric Power Line
- SURFACE RIGHTS RESERVED FOR SUMMER RESORTS 100 FEET WIDE

DISPOSITION OF CROWN LANDS

PATENTED

LEASE

LICENSE OF OCCUPATION

AREA PLAN

DISTRICT OF KENORA

TRACED E.J.D. CHECKED E.J.D.

APPROVED: [Signature] SCALE: 1 IN. = 40 CH.

DEPARTMENT OF THE AGRI-CULTURE

TORONTO ONTARIO CANADA

Islands in Lake of the Woods withdrawn from staking under Sect 39 Sub c. File 67051

Area North Of Lingman Lake (M. 2198)

AREA OF  
**LINGMAN LAKE**

DISTRICT OF  
KENORA  
(PATRICIA PORTION)

RED LAKE  
MINING DIVISION

SCALE: 1-INCH = 40 CHAINS

**LEGEND**

- PATENTED LAND Ⓟ
- CROWN LAND SALE CS
- LEASES Ⓛ
- LOCATED LAND Loc
- LICENSE OF OCCUPATION L.O.
- MINING RIGHTS ONLY M.R.O.
- SURFACE RIGHTS ONLY S.R.O.
- ROADS — — — — —
- IMPROVED ROADS = = = = =
- KING'S HIGHWAYS — — — — —
- RAILWAYS — — — — —
- POWER LINES — — — — —
- MARSH OR MUSKEG — — — — —
- MINES X
- CANCELLED C

**NOTES**

400' SURFACE RIGHTS RESERVATION AROUND  
ALL LAKES AND RIVERS.

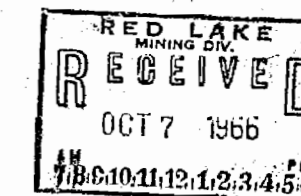

PLAN NO. M.2064

DEPARTMENT OF MINES  
— ONTARIO —

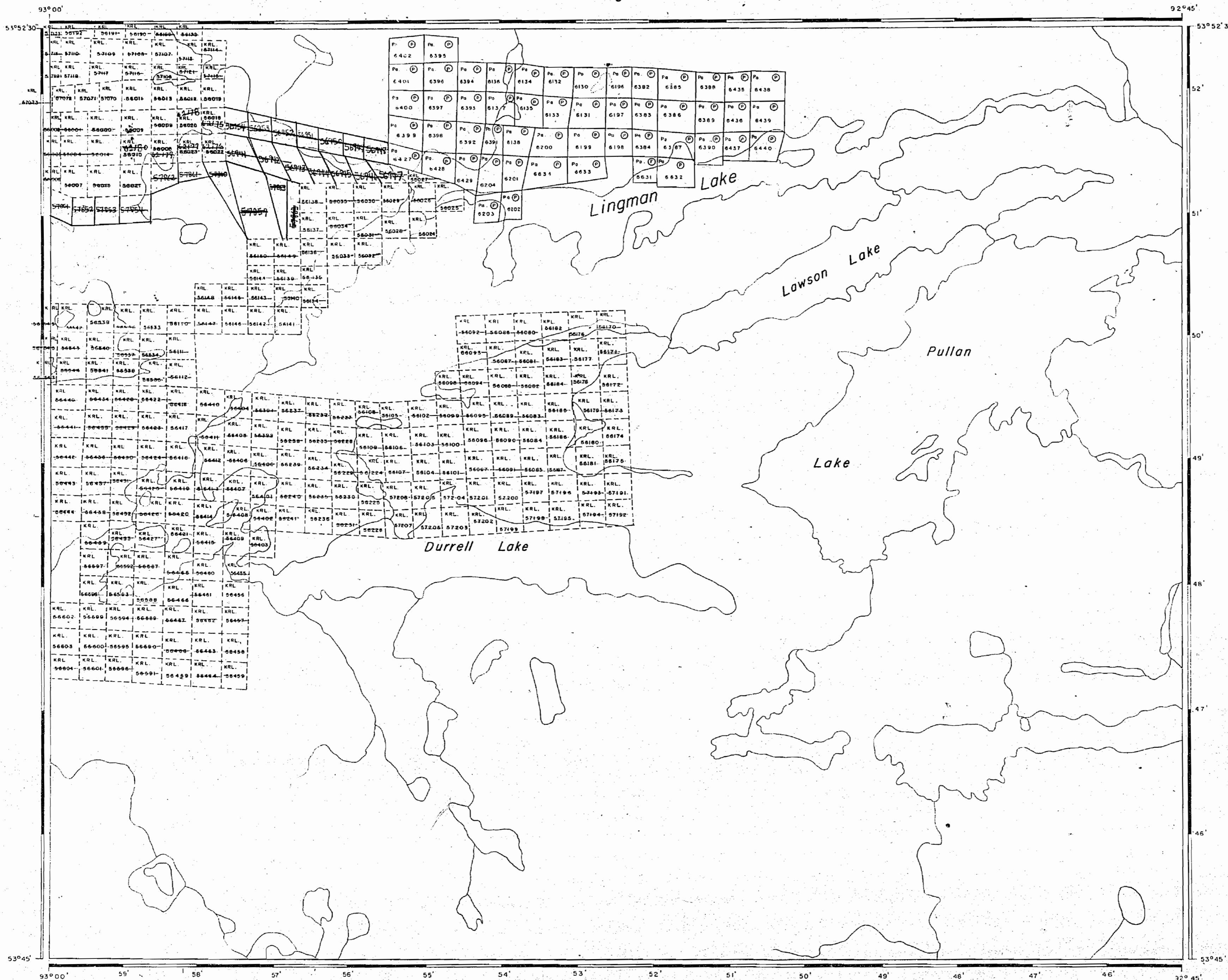

Seeber Lake Area (M. 2179)

Area South Of Ponusk Lake (M. 2027)

Area North Of Lingman Lake (M.2198)

Seeber Lake Area (M.2179)

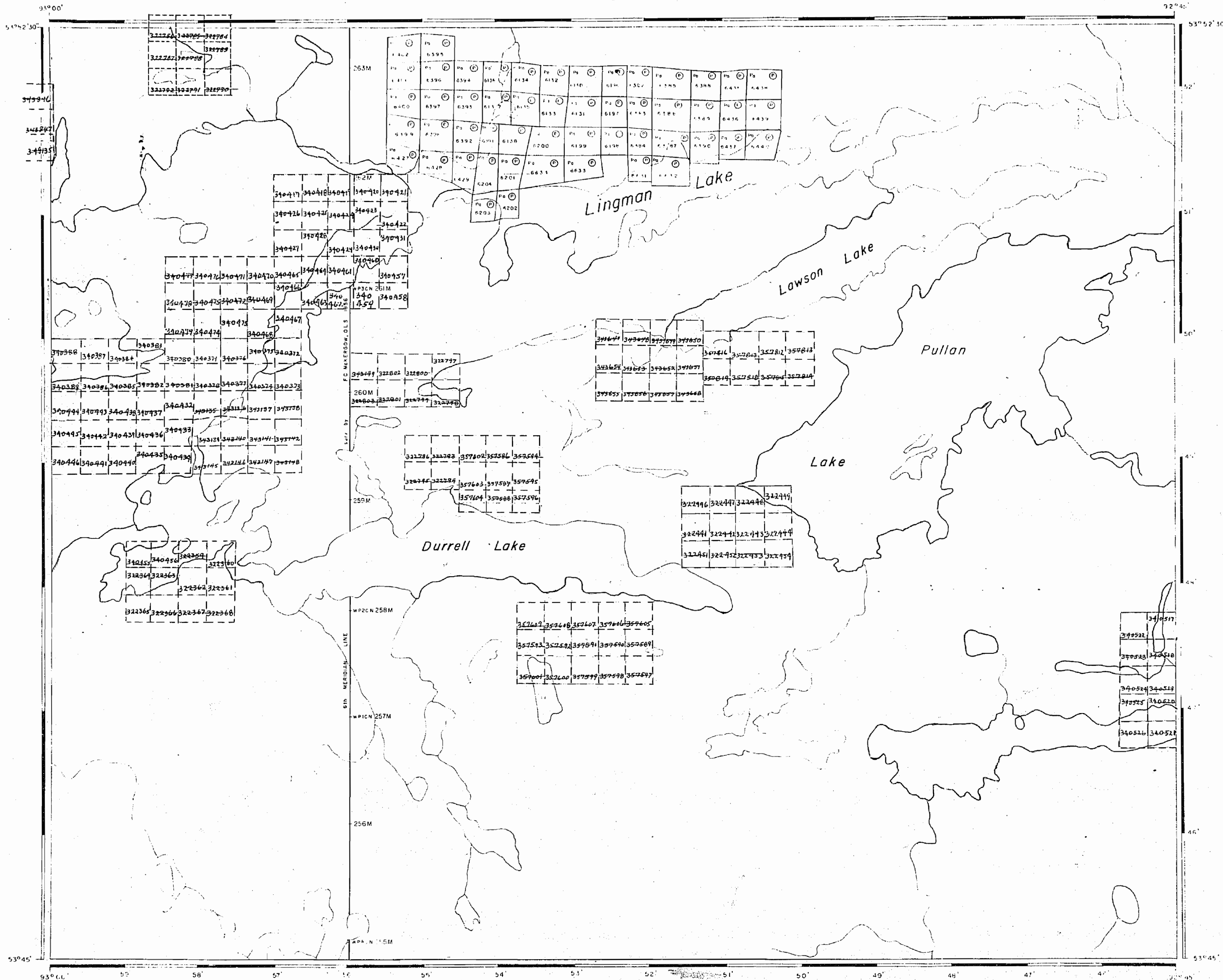

AREA OF  
**LINGMAN LAKE**

DISTRICT OF  
KENORA  
(PATRICIA PORTION)

RED LAKE  
MINING DIVISION

SCALE: 1-INCH = 40 CHAINS

**LEGEND**

- PATENTED LAND (P)
- CROWN LAND SALE (CS)
- LEASES (L)
- LOCATED LAND (Loc)
- LICENSE OF OCCUPATION (LO)
- MINING RIGHTS ONLY (MRO)
- SURFACE RIGHTS ONLY (SRO)
- ROADS (—)
- IMPROVED ROADS (—)
- KING'S HIGHWAYS (—)
- RAILWAYS (—)
- POWER LINES (—)
- MARSH OR MUSKEG (—)
- MINES (—)
- CANCELLED (—)

**NOTES**

ALL SURFACE RIGHTS RESERVED ON AROUND  
ALL LAKES AND RIVERS

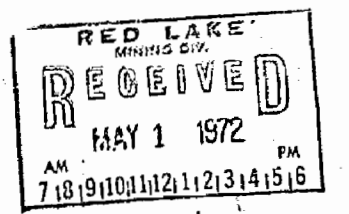

NATIONAL TOPOGRAPHIC SERIES 53 F

PLAN NO. M.2064

ONTARIO  
DEPARTMENT OF MINES  
AND NORTHERN AFFAIRS