



INDEX TO LAND DISPOSITION

PLAN
 G-3253
 TOWNSHIP

LYMAN

M.N.R. ADMINISTRATIVE DISTRICT
 NORTH BAY
 MINING DIVISION
 SUDBURY
 LAND TITLES/REGISTRY DIVISION
 NIPISSING

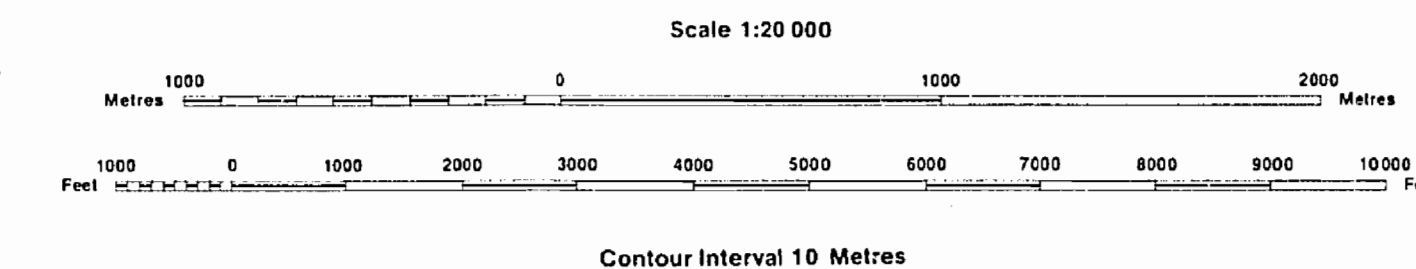

AREAS WITHDRAWN FROM DISPOSITION

MRO - Mining Rights Only
 SRO - Surface Rights Only
 M+S - Mining and Surface Rights

Description	Order No.	Date	Disposition	File
(1) TOWER & CABIN		9/1959	SRO	139169
(2) TOWER & CABIN		9/1959	SRO	139169
(3) GARBAGE DISPOSAL SITE		12/1/1970	SRO	160707 VOL. 2
(4) TILDEN LAKE DAM		28/1/1972	SRO	71096 VOL. 2
(5) FOREST RESERVE		27/6/1927	SRO	71096
(6) W-01/91/ONT 3.R.O.		SEP. 20/91	L.R. FILE	

SYMBOLS

- Boundary
- Township, Meridian, Baseline
- Road allowance; surveyed
- shoreline
- Lot/Concession; surveyed
- unsurveyed
- Parcel; surveyed
- unsurveyed
- Right-of-way; road
- railway
- utility
- Reservation
- Cliff, Pit, Pile
- Contour
- Interpolated
- Approximate
- Depression
- Control point (horizontal)
- Flooded land
- Mine head frame
- Pipeline (above ground)
- Railway; single track
- double track
- abandoned
- Road; highway, county, township
- access
- trail, bush
- Shoreline (original)
- Transmission line
- Wooded area

DISPOSITION OF CROWN LANDS

- Patent
- Surface & Mining Rights
- Surface Rights Only
- Mining Rights Only
- Lease
- Surface & Mining Rights
- Surface Rights Only
- Mining Rights Only
- Licence of Occupation
- Order-in-Council
- Cancelled
- Reservation
- Sand & Gravel
- LAND USE PERMIT

THE INFORMATION THAT APPEARS ON THIS MAP HAS BEEN COMPILED FROM VARIOUS SOURCES, AND ACCURACY IS NOT GUARANTEED. THOSE WISHING TO STAKE MINING CLAIMS SHOULD CONSULT WITH THE MINING RECORDER, MINISTRY OF NORTHERN DEVELOPMENT AND MINES, FOR ADDITIONAL INFORMATION ON THE STATUS OF THE LANDS SHOWN HEREON.

LYMAN

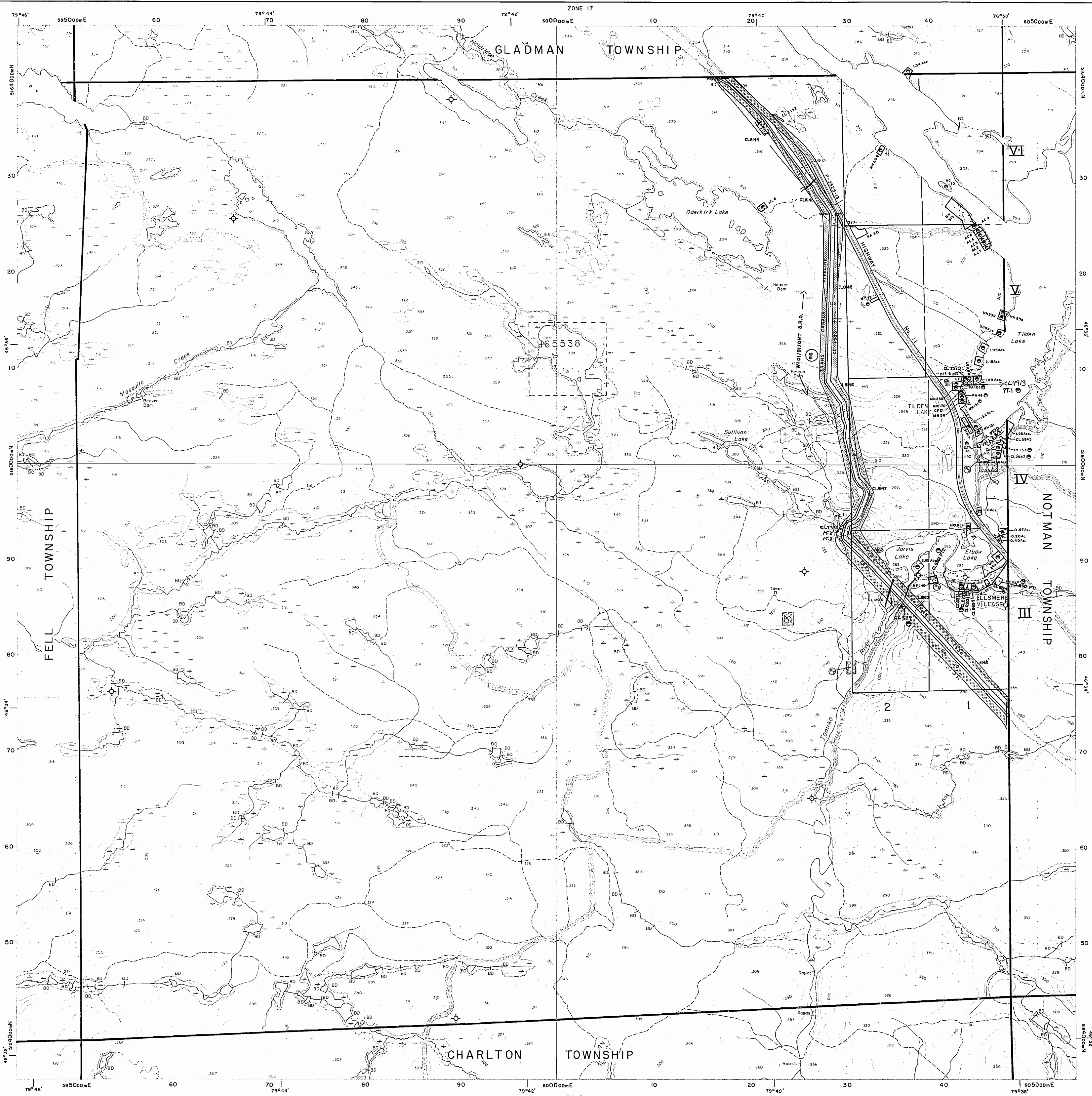

DISPOSITION OF CROWN LANDS

TYPE OF DOCUMENT	SYMBOL
PATENT, SURFACE & MINING RIGHTS	●
" SURFACE RIGHTS ONLY	○
" MINING RIGHTS ONLY	○
LEASE SURFACE & MINING RIGHTS	■
" SURFACE RIGHTS ONLY	■
" MINING RIGHTS ONLY	■
LICENCE OF OCCUPATION	▼
ORDER-IN-COUNCIL	OC
RESERVATION	Ⓜ
CANCELLED	⊗
SAND & GRAVEL	Ⓢ

NOTE: MINING RIGHTS IN PARCELS PATENTED PRIOR TO MAY 6, 1913, VESTED IN ORIGINAL PATENTEE BY THE PUBLIC LANDS ACT, R.S.O. 1970, CHAP. 380, SEC. 63, SUBSEC 1.

400' Surface rights reservation along the shores of all lakes and rivers.

AREAS WITHDRAWN FROM DISPOSITION

S.R. — SURFACE RIGHTS		M.R. — MINING RIGHTS	
Description	Order No.	Date	File
Ⓜ TOWER & CABIN		SEPT. 1959	S.R. 139169
Ⓜ TOWER & CABIN		SEPT. 1959	S.R. 139169
Ⓜ GARBAGE DISPOSAL SITE		12/1/1970	S.R. 160707 Vol. 2
Ⓜ TILDEN LAKE DAM		28/1/1972	S.R. 71096 Vol 2
Ⓜ FOREST RESERVE		27/6/1927	S.R. 71096

SAND and GRAVEL

- Ⓢ GRAVEL FILE 127913
- Ⓢ GRAVEL FILES 139169, 127913
- Ⓢ GRAVEL FILE 139169
- Ⓢ M.T.C. GRAVEL PIT 1616, FILE 96166
- Ⓢ GRAVEL FILE 71096*
- Ⓢ M.T.C. GRAVEL PIT, FILE 71096*
- Ⓢ M.N.R. GRAVEL RESERVE No. 289, FILE 193491

* Release of Pits held by M.T.C. (Memo 1980 0724 in North Bay File)

** Location PA 46 Parts 1, 2, & 3 Plan 36R-6057 See Land Roll File

*** M.N.R. Gravel Reserve (See Land Roll File)

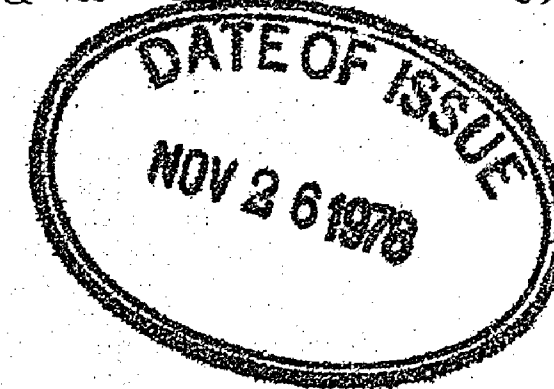

OFFICE USE ONLY

GLADMAN M-1021

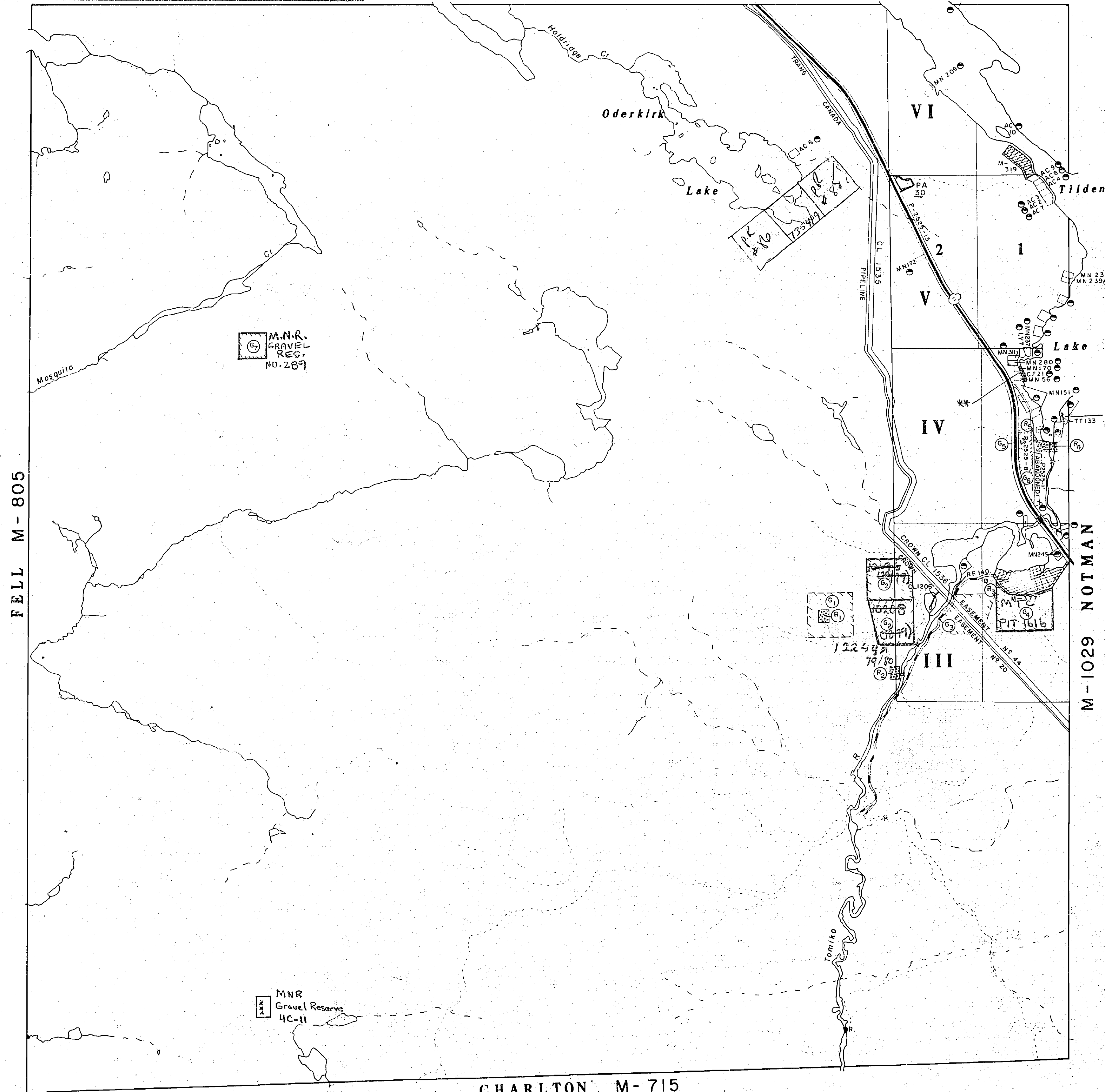

LEGEND

HIGHWAY AND ROUTE No.	
OTHER ROADS	
TRAILS	
SURVEYED LINES:	
TOWNSHIPS, BASE LINES, ETC.	
LOTS, MINING CLAIMS, PARCELS, ETC.	
UNSURVEYED LINES:	
LOT LINES	
PARCEL BOUNDARY	
MINING CLAIMS ETC.	
RAILWAY AND RIGHT OF WAY	
UTILITY LINES	
NON-PERENNIAL STREAM	
FLOODING OR FLOODING RIGHTS	
SUBDIVISION OR COMPOSITE PLAN	
RESERVATIONS	
ORIGINAL SHORELINE	
MARSH OR MUSKEG	
MINES	
TRAVERSE MONUMENT	

SCALE: 1 INCH = 40 CHAINS

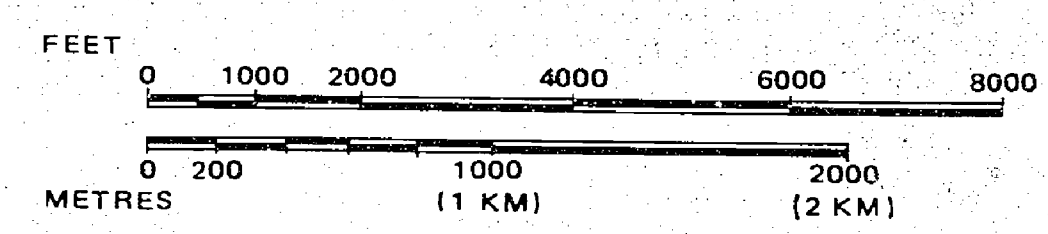

ACRES HECTARES

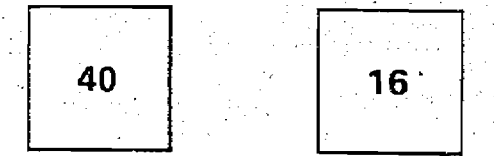

TOWNSHIP OF
LYMAN

DISTRICT
NIPISSING
MINING DIVISION
SUDBURY

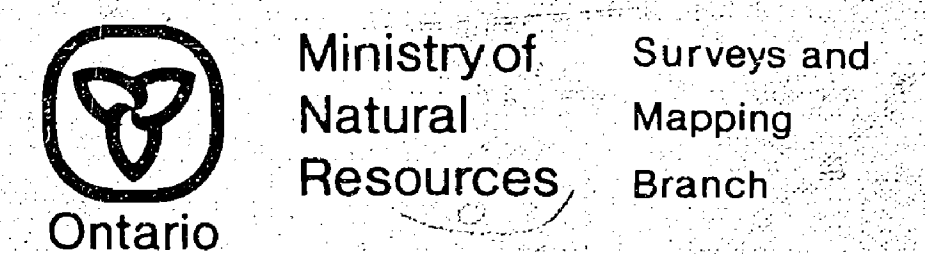

Date: MARCH 20, 1978
National Topographic Series
Plan No. **M-1001**

DISPOSITION OF CROWN LANDS

TYPE OF DOCUMENT	SYMBOL
PATENT SURFACE & MINING RIGHTS	●
SURFACE RIGHTS ONLY	○
MINING RIGHTS ONLY	○
LEASE SURFACE & MINING RIGHTS	■
SURFACE RIGHTS ONLY	■
MINING RIGHTS ONLY	■
LICENCE OF OCCUPATION	○
ORDER IN COUNCIL	○
RESERVATION	○
CANCELLED	○
SAND & GRAVEL	○

NOTE: MINING RIGHTS IN PARCELS PATENTED PRIOR TO MAY 6 1912, VESTED IN ORIGINAL PATENTEE BY THE PUBLIC LANDS ACT, R.S.O. 1970, CHAP. 390, SEC. 62 SUBSEC. 1

400' Surface rights reservation along the shores of all lakes and rivers

AREAS WITHDRAWN FROM DISPOSITION

S.R. - SURFACE RIGHTS		M.R. - MINING RIGHTS		
Description	Order No.	Date	Disposition	File
TOURER CABIN		SEPT 1979	S.R.	159143
TOURER CABIN		SEPT 1979	S.R.	159143
LAYFRSE DISTURBANCE SITE		12/21/1970	S.R.	14070146.2
TILDEN LAKE DAM		28/1/1972	S.R.	71094.1412
FOREST RESERVE		2/26/1927	S.R.	71096

SAND and GRAVEL

- ① GRAVEL FILE 127913
- ② GRAVEL FILES 159169, 127913
- ③ GRAVEL FILE 159169
- ④ M.T.C. GRAVEL PIT 1616, FILE 96166
- ⑤ M.N.R. 40-11 GRAVEL RESERVE
- ⑥ M.N.R. GRAVEL RESERVE No 289, FILE 193491
- ⑦ QUARRY PERMIT

GLADMAN M-1021

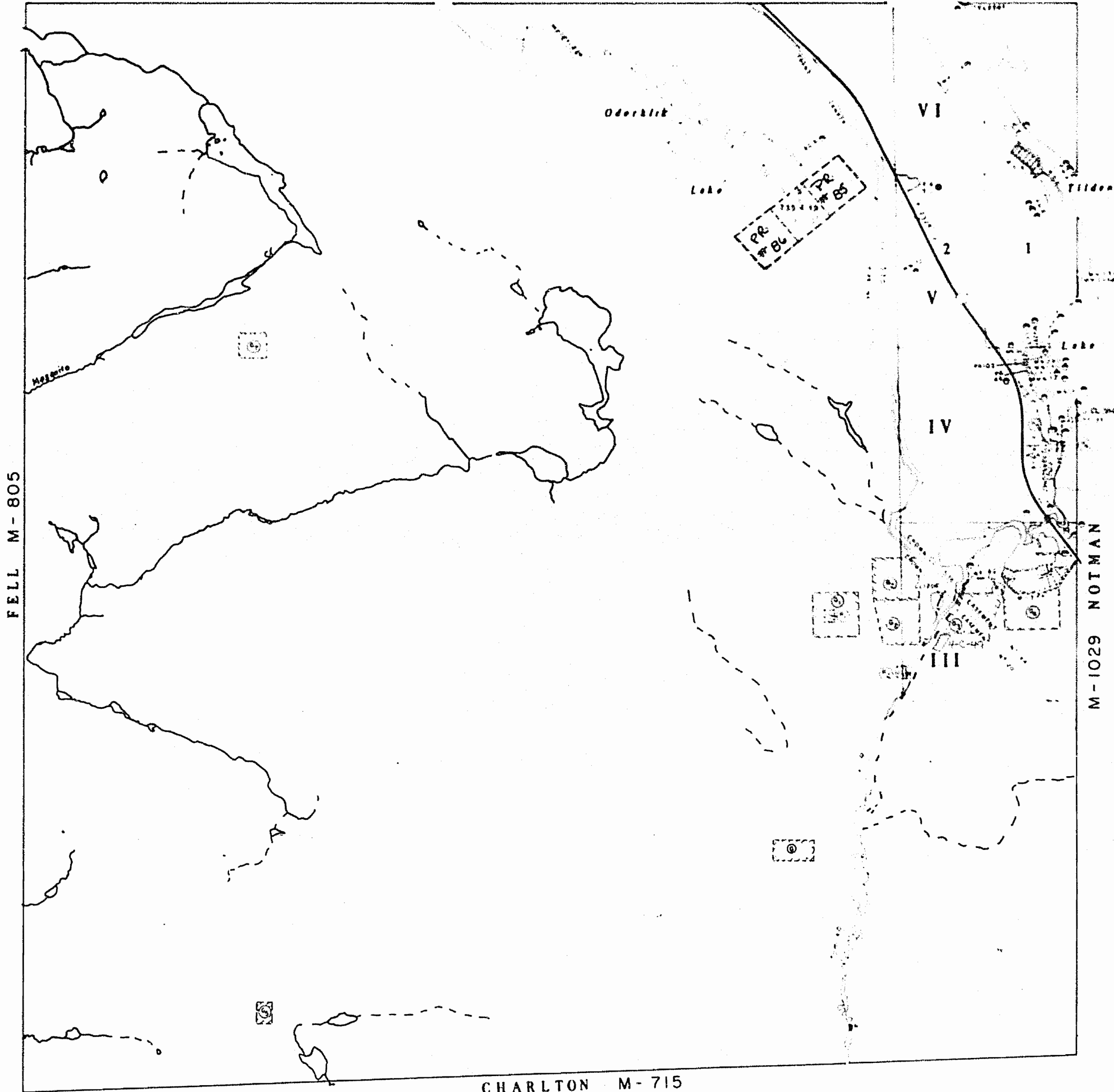

LEGEND

HIGHWAY AND ROUTE 11	—●—
OTHER ROADS	—
TRAILS	- - -
SURVEYED LINES	—
TOWNSHIP BASE LINES ETC	—
LOTS MINING CLAIMS PARCELS ETC	—
UNSURVEYED LINES	—
LOT LINES	—
PARCEL BOUNDARY	—
MINING CLAIMS ETC	—
RAILWAY AND RIGHT OF WAY	—
UTILITY LINES	—
NON PERENNIAL STREAM	—
FLOODING OR FLOODING RIGHTS	—
SUBDIVISION OR COMPOSITE PLAN	—
RESERVATIONS	—
ORIGINAL SHORELINE	—
MARSH OR MUSKIEG	—
MINES	⊗
TRAVELSE MONUMENT	⊙

File No. 40-40-Exp. Data 1980

* IN SERVICE 1984 08 22 - v

SCALE: 1 INCH = 40 CHAINS

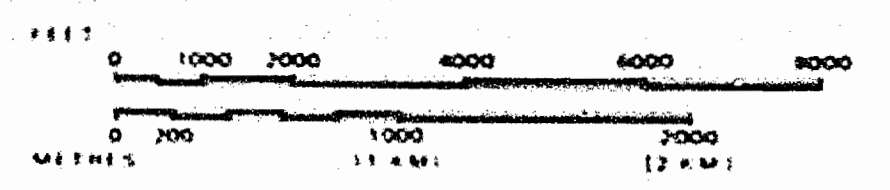

ACRES HECTARES



TOWNSHIP OF
LYMAN
DISTRICT
NIPISSING
MINING DIVISION
SUDBURY

Ministry of Natural Resources
Ontario
Surveys and Mapping Branch

Date: MARCH 20, 1978
National Topographic Series
Plan No: **M-1001**

CHARLTON M-715

INDEX TO LAND DISPOSITION

PLAN
 G-3253
 TOWNSHIP

M.N.R. ADMINISTRATIVE DISTRICT
 NORTH BAY
 MINING DIVISION
 SUDBURY
 LAND TITLES/REGISTRY DIVISION
 NIPISSING

LYMAN

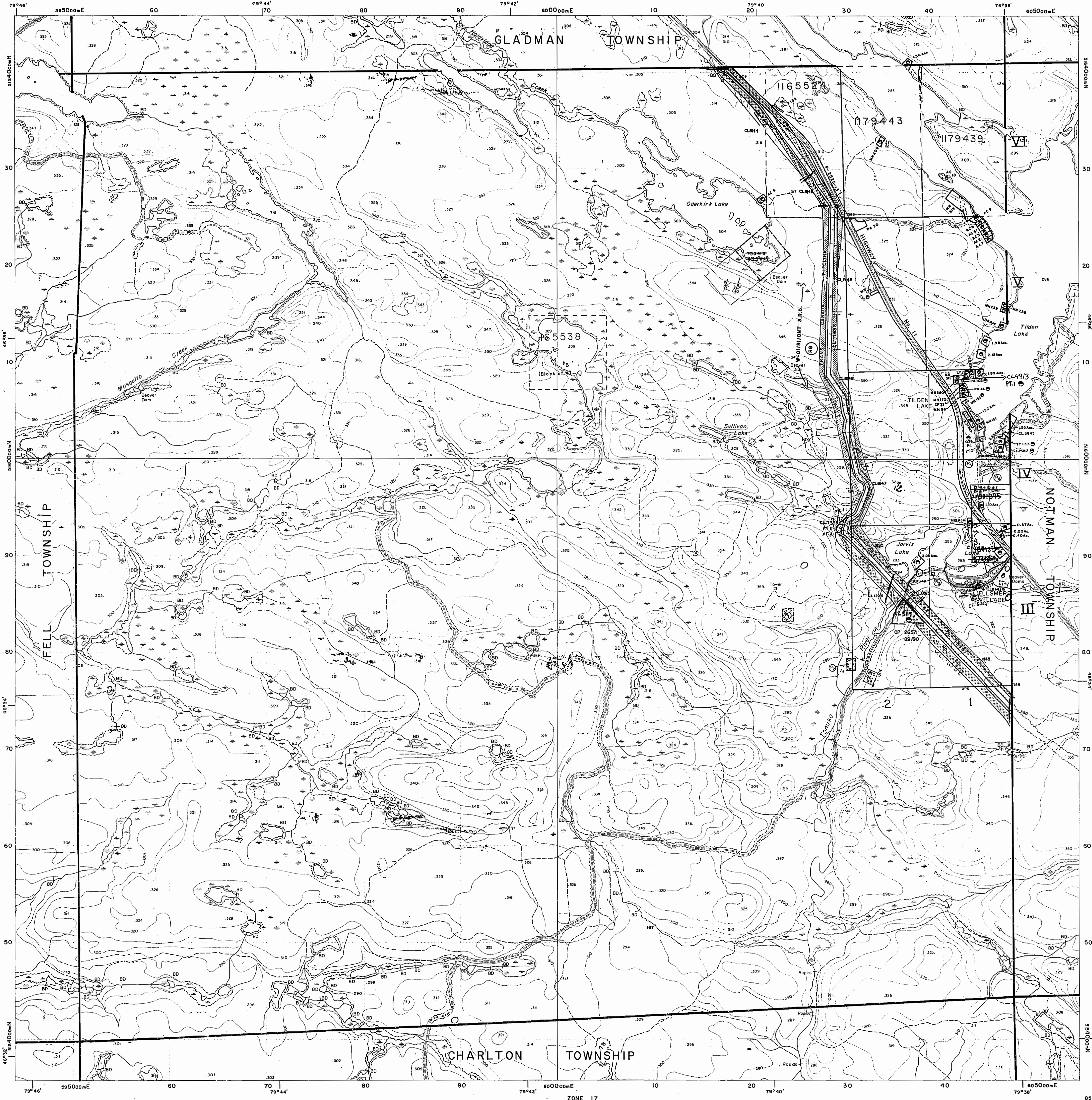
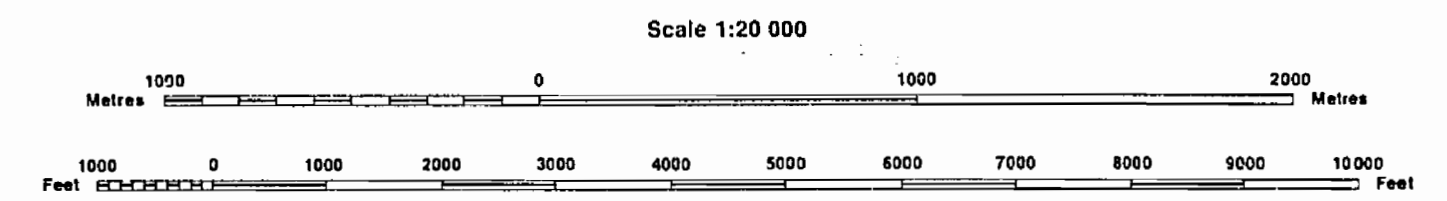

SYMBOLS

- Boundary
- Township, Meridian, Baseline
- Road allowance; surveyed
- shoreline
- Lot/Concession; surveyed
- unsurveyed
- Parcel; surveyed
- unsurveyed
- Right-of-way; road
- railway
- utility
- Reservation
- Cliff, Pit, Pile
- Contour
- Interpolated
- Approximate
- Depression
- Control point (horizontal)
- Flooded land
- Mine head frame
- Pipeline (above ground)
- Railway; single track
- double track
- abandoned
- Road; highway, county, township
- access
- trail, bush
- Shoreline (original)
- Transmission line
- Wooded area

AREAS WITHDRAWN FROM DISPOSITION

MRO - Mining Rights Only
 SRO - Surface Rights Only
 M + S - Mining and Surface Rights

Description	Order No.	Date	Disposition	File
TOWER & CABIN	9/1959	9/1959	SRO	139169
TOWER & CABIN	9/1959	9/1959	SRO	139169
GARBAGE DISPOSAL SITE	12/1970	12/1970	SRO	160707 VOL.2
TILDEN LAKE DAM	28/1/1972	28/1/1972	SRO	71096 VOL.2
FOREST RESERVE	27/4/1927	27/4/1927	SRO	71096
W-01/91/ONT S.R.O.	SEP.20/91	SEP.20/91	L.R. FILE	

DISPOSITION OF CROWN LANDS

- Patent
- Surface & Mining Rights
- Surface Rights Only
- Mining Rights Only
- Lease
- Surface & Mining Rights
- Surface Rights Only
- Mining Rights Only
- Licence of Occupation
- Order-in-Council
- Cancelled
- Reservation
- Sand & Gravel

THE INFORMATION THAT
 APPEARS ON THIS MAP
 HAS BEEN COMPILED
 FROM VARIOUS SOURCES.
 AND ACCURACY IS NOT
 GUARANTEED. THOSE
 WISHING TO STAKE
 MINING CLAIMS SHOULD
 CONSULT WITH THE
 MINING RECORDER,
 MINISTRY OF
 NORTHERN DEVELOPMENT
 AND MINES, FOR
 ADDITIONAL INFORMATION
 ON THE STATUS OF THE
 LANDS SHOWN HEREON.

DATE OF ISSUE
 1994
 MINING RECORDER'S OFFICE

LYMAN

INDEX TO LAND DISPOSITION

PLAN
 G-3253
 TOWNSHIP

LYMAN

M.N.R. ADMINISTRATIVE DISTRICT
 NORTH BAY
 MINING DIVISION
 SUDBURY
 LAND TITLES/REGISTRY DIVISION
 NIPISSING

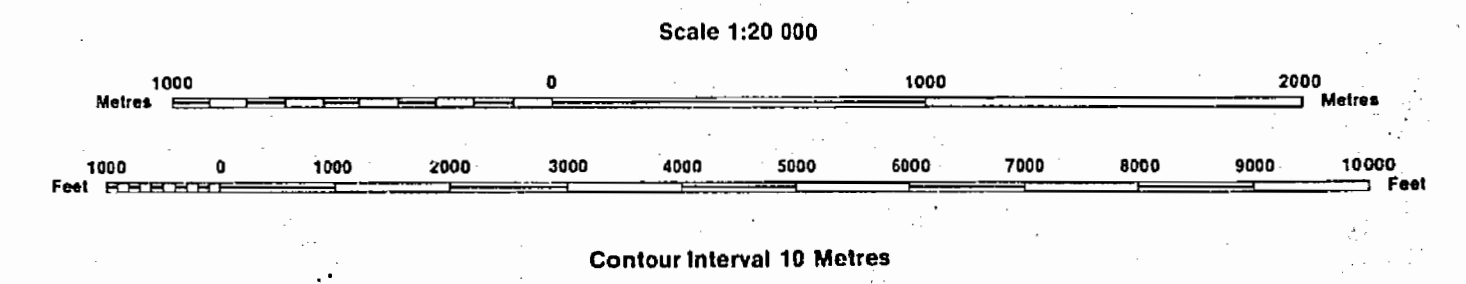

AREAS WITHDRAWN FROM DISPOSITION

MRO - Mining Rights Only
 SRO - Surface Rights Only
 M+S - Mining and Surface Rights

Description	Order No.	Date	Disposition	File
TOWER & CABIN	9/1959	9/1959	SRO	13 91 6 D
TOWER & CABIN	9/1959	9/1959	SRO	13 91 6 D
GARBAGE DISPOSAL SITE	12/A/1970	12/A/1970	SRO	160707 VOL. 2
TILDEN LAKE DAM	28/A/1972	28/A/1972	SRO	71096 VOL. 2
FOREST RESERVE	27/6/1927	27/6/1927	SRO	71096
W-O/I/BI/ONT S.R.O.	SEP. 20/81	SEP. 20/81	L.R. FILE	

SYMBOLS

Boundary	Township, Meridian, Baseline.....	—————
Road allowance; surveyed	shoreline	—————
Lot/Concession; surveyed	unsurveyed	—————
Parcel; surveyed	unsurveyed	—————
Right-of-way; road	railway	—————
utility		—————
Reservation		—————
Cliff, Pit, Pile		—————
Contour	Interpolated	—————
Approximate	Depression	—————
Control point (horizontal)		—————
Flooded land		—————
Mine head frame		—————
Pipeline (above ground)		—————
Railway; single track	double track	—————
abandoned		—————
Road; highway, county, township	access	—————
trail, bush		—————
Shoreline (original)		—————
Transmission line		—————
Wooded area		—————

DATE OF ISSUE

JUN 17 1998
 PROVINCIAL RECORDING
 OFFICE - SUDBURY

DISPOSITION OF CROWN LANDS

Patent	Surface & Mining Rights	●
Surface Rights Only	Mining Rights Only	○
Lease	Surface & Mining Rights	■
Surface Rights Only	Mining Rights Only	□
Licence of Occupation	Order-in-Council	▼
Cancelled	Reservation	⊙
Sand & Gravel	LAND USE PERMIT	◇

THE INFORMATION THAT APPEARS ON THIS MAP HAS BEEN COMPILED FROM VARIOUS SOURCES, AND ACCURACY IS NOT GUARANTEED. THOSE WISHING TO STAKE MINING CLAIMS SHOULD CONSULT WITH THE MINING RECORDER, MINISTRY OF NORTHERN DEVELOPMENT AND MINES, FOR ADDITIONAL INFORMATION ON THE STATUS OF THE LANDS SHOWN HEREON.

LYMAN

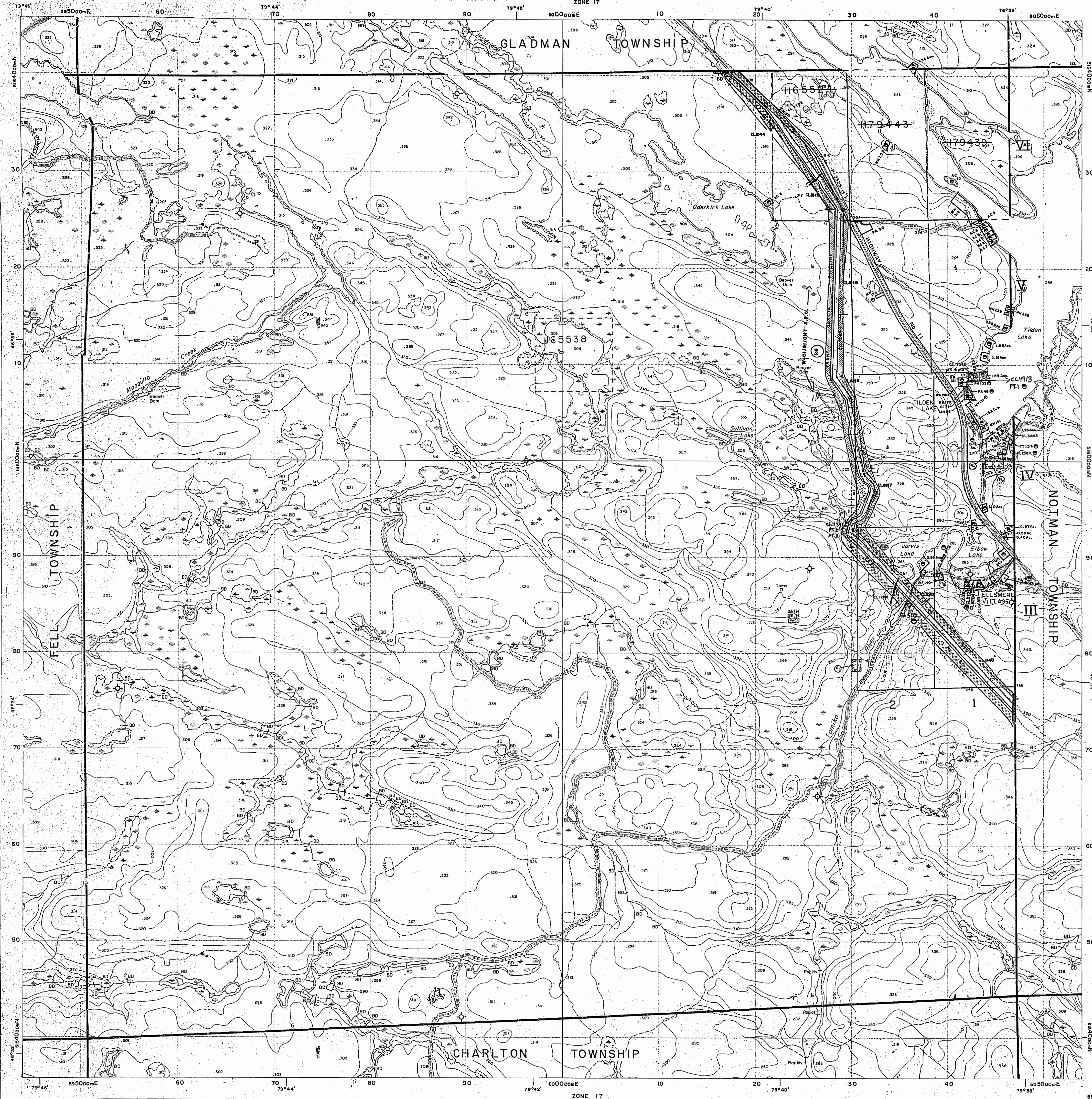

Order in Council June 9, 1927
 withdrawing one mile wide on
 either side of North Bay-Cobalt road

LYMAN

SCALE 40 CHAINS TO AN INCH

CLIFTON

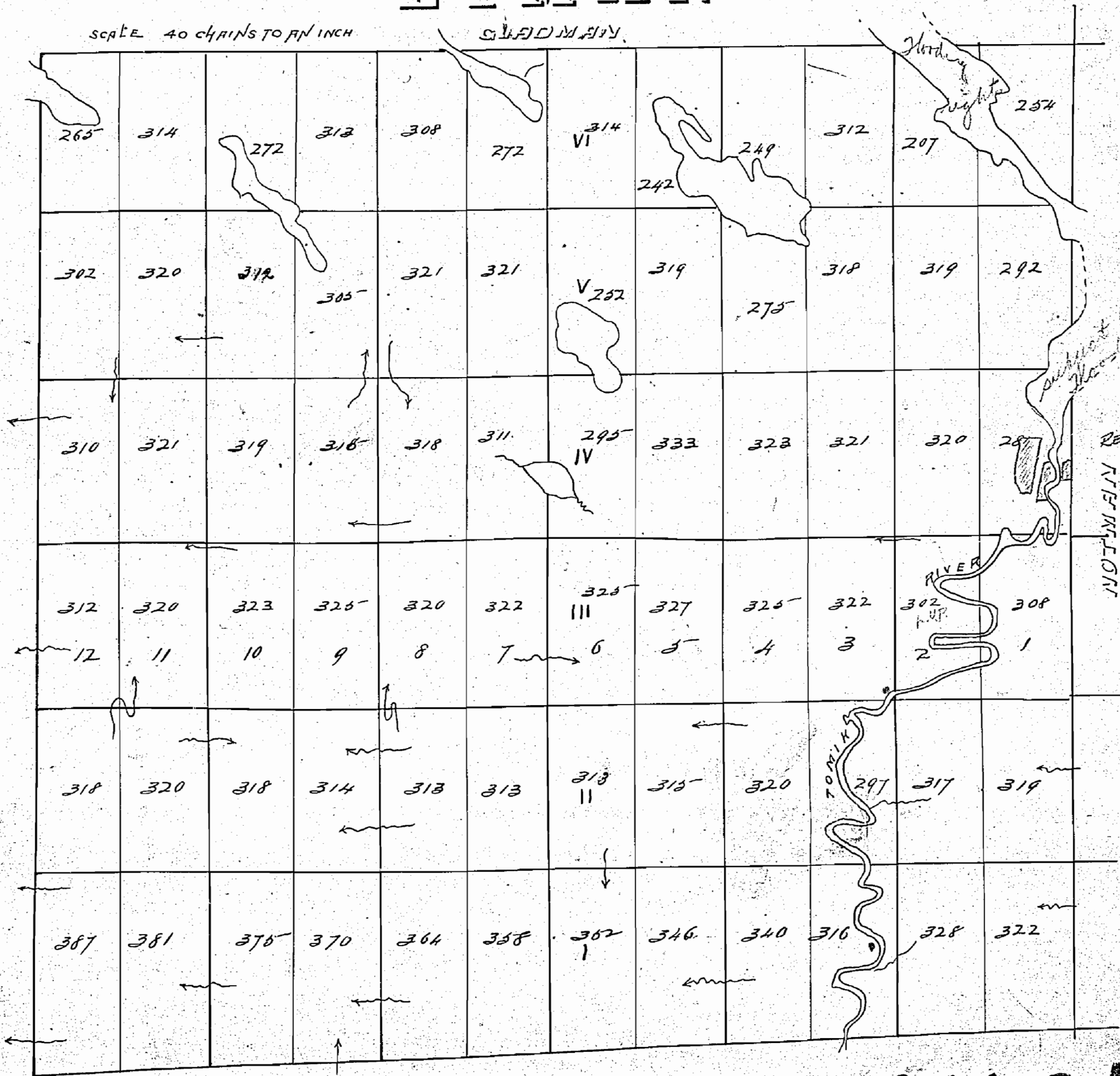

RESERVED TO
 DEPT OF
 HIGHWAYS
 23.8 A

CLIFTON

CHARLTON

M1001

1001

PLAN OF LYMAN TWP.

SADBURY MINING DIVISION DISTRICT OF NIPISSING

Scale, 40 chains to an inch

GLADMAN TWP.

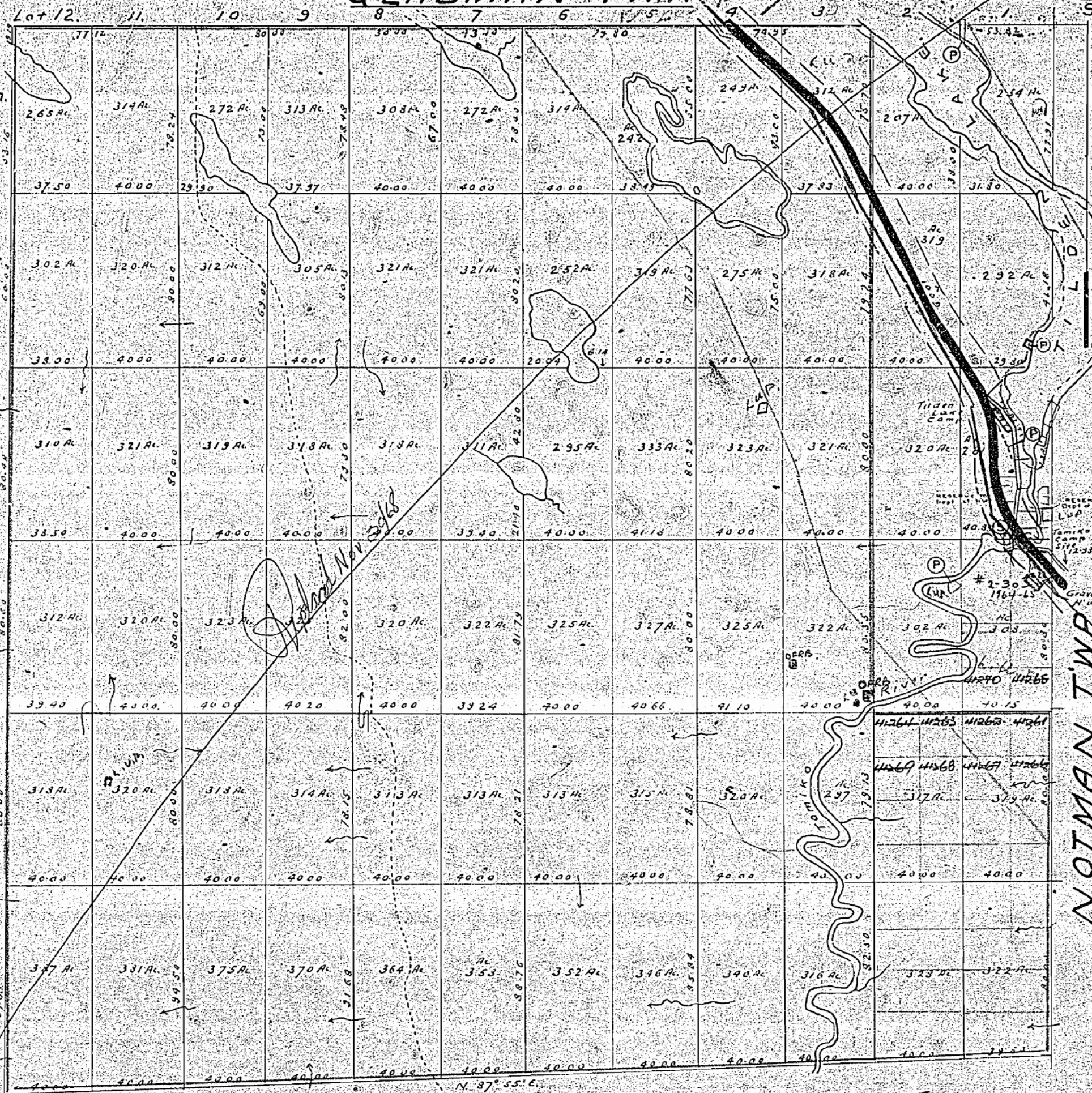

Notes.

- Railways shown thus: [Symbol]
- Paved Highways: [Symbol]
- Gravel: [Symbol]
- Other Roads: [Symbol]
- Highway Route No. 1: [Symbol]
- Trails & Paths: [Symbol]
- Telephone & Telegraph Lines: [Symbol]
- Electric Power Lines: [Symbol]
- Non-perennial streams: [Symbol]
- Bridges: [Symbol]
- Buildings: [Symbol]
- Swamps: [Symbol]
- Areas marked (P) or (L) on Patent: [Symbol]
- Leased: [Symbol]
- L.O. held under License of Occupation: [Symbol]

1 mile Right of Way Reserved on either side of each side of Natural Gas Line of F.M. Sept 24/55

SUBDIVISIONS PARTLY ANNULLLED

DISPOSITION OF CROWN LANDS

OFFICE USE ONLY

GLADMAN M-1021

LEGEND

- HIGHWAY AND ROUTE No.
- OTHER ROADS
- TRAILS
- SURVEYED LINES:
 - TOWNSHIPS, BASE LINES, ETC.
 - LOTS, MINING CLAIMS, PARCELS, ETC.
- UNSURVEYED LINES:
 - LOT LINES
 - PARCEL BOUNDARY
 - MINING CLAIMS ETC.
- RAILWAY AND RIGHT OF WAY
- UTILITY LINES
- NON-PERENNIAL STREAM
- FLOODING OR FLOODING RIGHTS
- SUBDIVISION OR COMPOSITE PLAN
- RESERVATIONS
- ORIGINAL SHORELINE
- MARSH OR MUSKEG
- MINES
- TRAVERSE MONUMENT

TYPE OF DOCUMENT	SYMBOL
PATENT, SURFACE & MINING RIGHTS	●
" SURFACE RIGHTS ONLY	○
" MINING RIGHTS ONLY	◐
LEASE, SURFACE & MINING RIGHTS	■
" SURFACE RIGHTS ONLY	□
" MINING RIGHTS ONLY	◻
LICENCE OF OCCUPATION	▼
ORDER-IN-COUNCIL	OC
RESERVATION	Ⓜ
CANCELLED	⊗
SAND & GRAVEL	Ⓜ

NOTE: MINING RIGHTS IN PARCELS PATENTED PRIOR TO MAY 6, 1913, VESTED IN ORIGINAL PATENTEE BY THE PUBLIC LANDS ACT, R.S.O. 1970, CHAP. 380, SEC. 63, SUBSEC 1.

400' Surface rights reservation along the shores of all lakes and rivers.

AREAS WITHDRAWN FROM DISPOSITION

S.R. — SURFACE RIGHTS		M.R. — MINING RIGHTS	
Description	Order No.	Date	Disposition File
(R1) TOWER & CABIN		SEPT. 1959	S.R. 139169
(R2) TOWER & CABIN		SEPT. 1959	S.R. 139169
(R3) GARBAGE DISPOSAL SITE		12/1/1970	S.R. 160707 Vol. 2
(R4) TILDEN LAKE DAM		28/1/1972	S.R. 71096 Vol 2
(R5) FOREST RESERVE		27/6/1927	S.R. 71096

SAND and GRAVEL

- (G1) GRAVEL FILE 127913
- (G2) GRAVEL FILES 139169, 127913
- (G3) GRAVEL FILE 139169
- (G4) M.T.C. GRAVEL PIT 1616, FILE 96166
- (G5) GRAVEL FILE 71096*
- (G6) M.T.C. GRAVEL PIT, FILE 71096*
- (G7) M.N.R. GRAVEL RESERVE No. 289, FILE 193491

* Release of Pits held by M.T.C. (Memo 1980 0724 in North Bay File)

** Location PA 46 Parts 1, 2, & 3 Plan 36R-6057 See Land Roll File

*** M.N.R. Gravel Reserve (See Land Roll File)

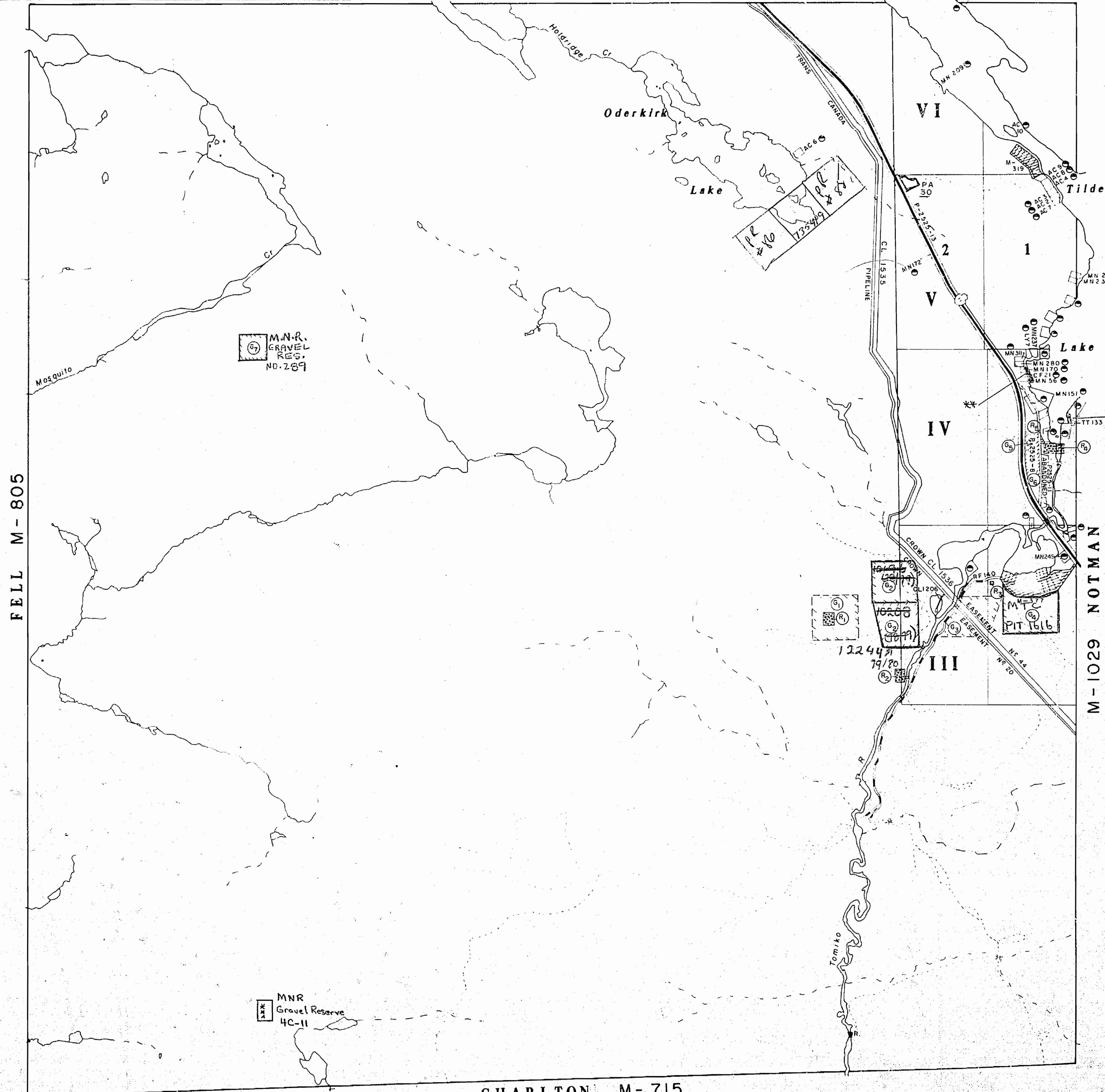
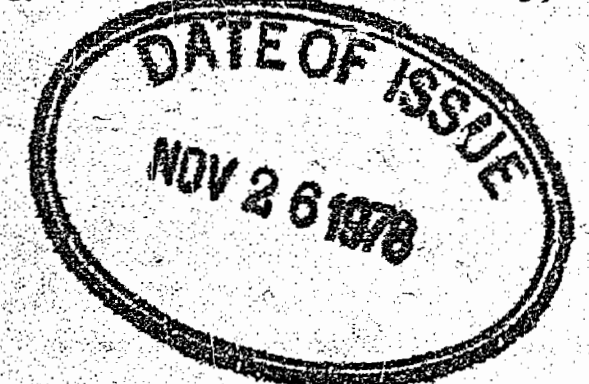

SCALE: 1 INCH = 40 CHAINS

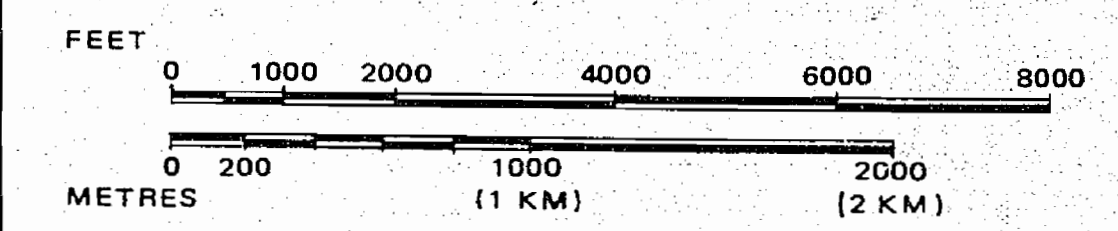

ACRES	HECTARES
40	16

TOWNSHIP OF
LYMAN
DISTRICT
NIPISSING
MINING DIVISION
SUDBURY

Ministry of Natural Resources
Ontario
Surveys and Mapping Branch

Date: MARCH 20, 1978
National Topographic Series
Plan No. **M-1001**

PLAN OF LYMAN TWP.

SUBBURY MINING DIVISION.
DISTRICT OF NIPISSING

M-1001

Scale, 40 chains to an inch

GLADMAN TWP.

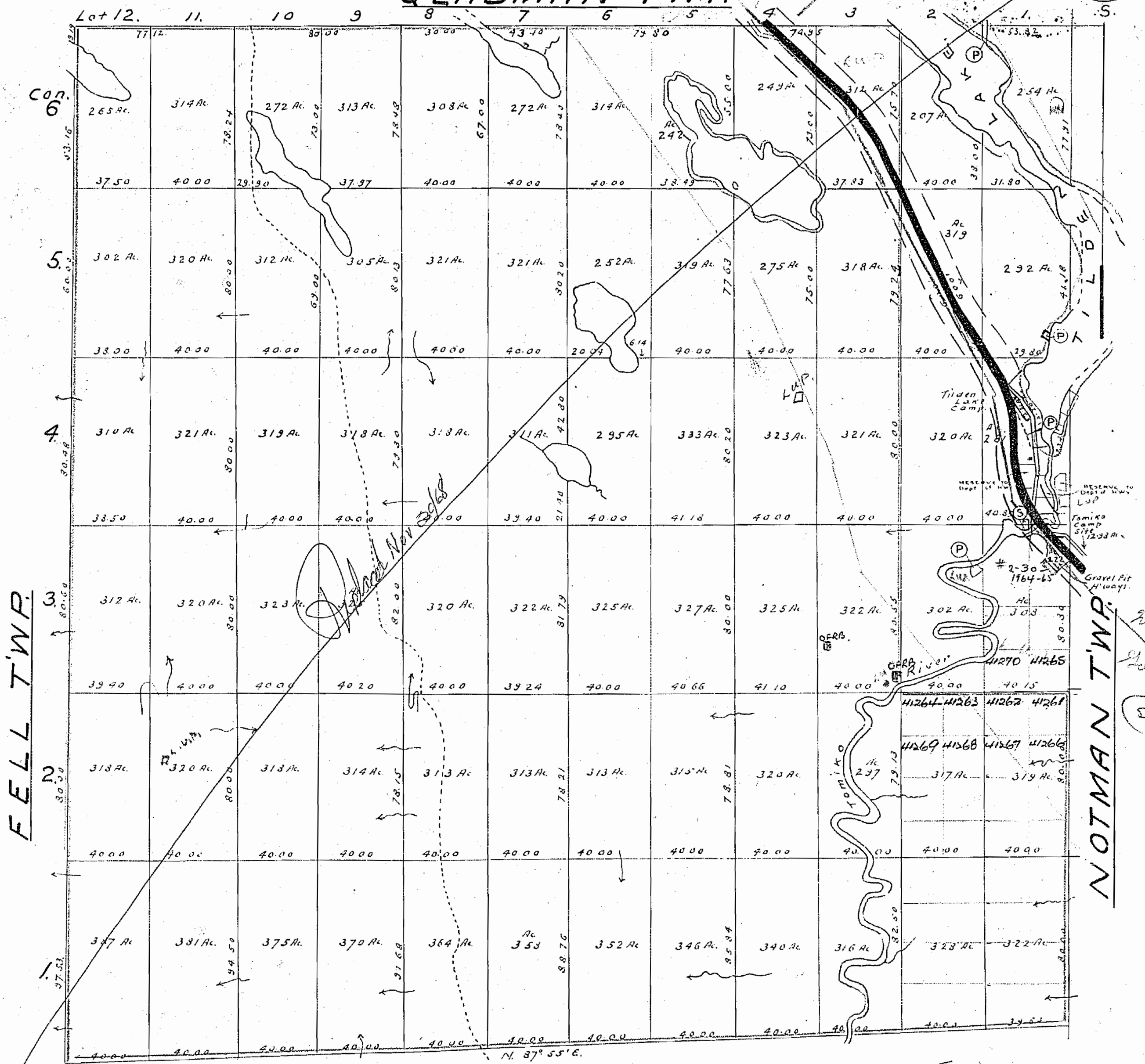

FELL TWP.

NOTMAN TWP.

CHARLTON TWP.

Notes.

- Railways shown thus
- Paved Highways
- Gravel
- Other Roads
- Highway Route No.
- Trails & Paths
- Telephone & Telegraph Lines
- Electric Power Lines
- Non-perennial streams
- Bridges
- Buildings
- Swamps
- Areas marked (P) are Patented
- Areas marked (L) are Leased
- Areas marked L.O. are held under License of Occupation

1 mile Right of Way Reserved on all chains on each side of Highway No. 9 & 10 Sept 24/52

SUBDIVISIONS PARTLY APPROVED

Order-in-Council June 9-1927
 withdrawing one mile wide on
 either side of North Bay, Cabot road

LYMAN

SCALE 40 CHAINS TO AN INCH

GLADWIN

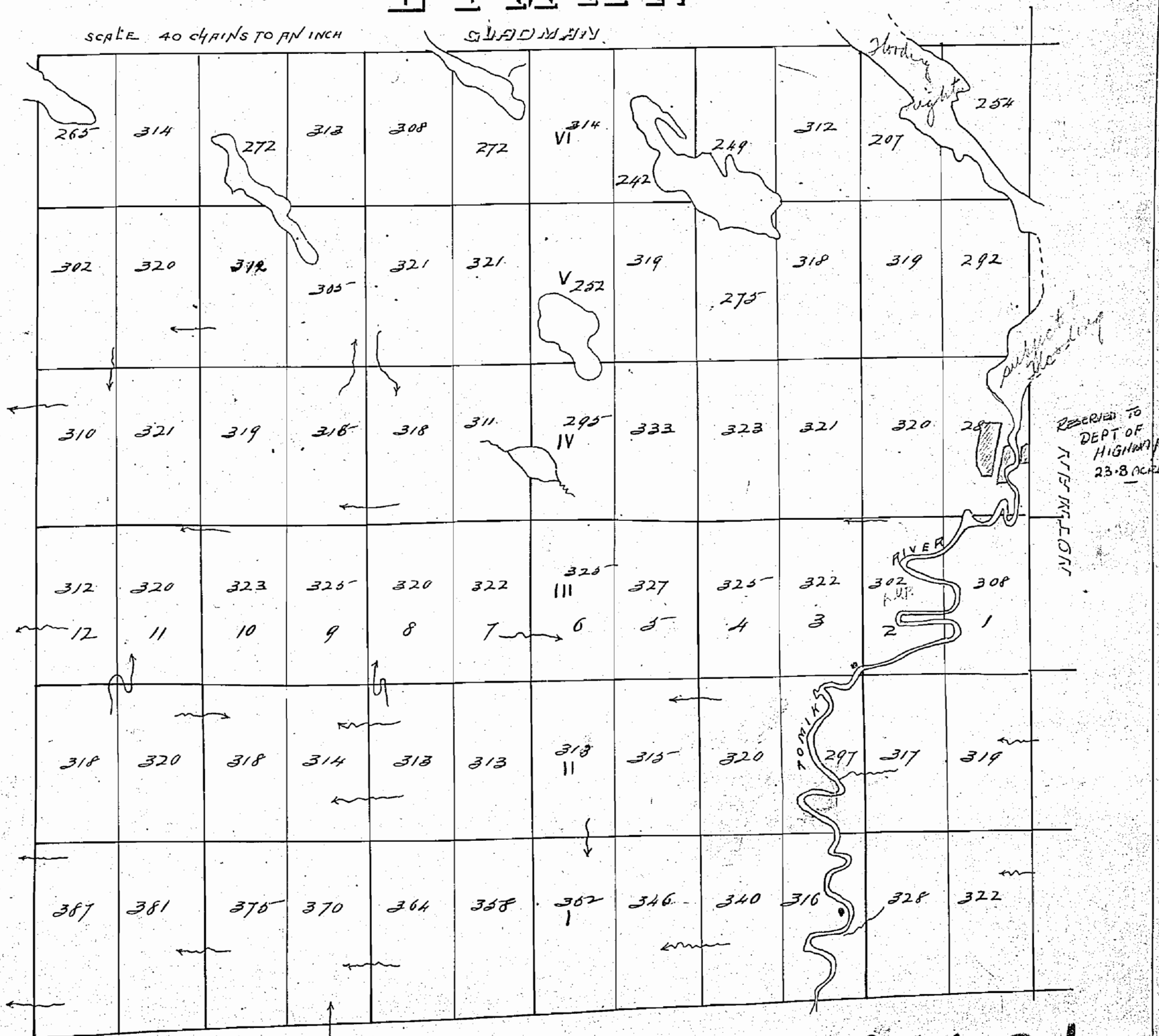

CHARLTON

M1001

Gladman Twp.

Fell Twp.

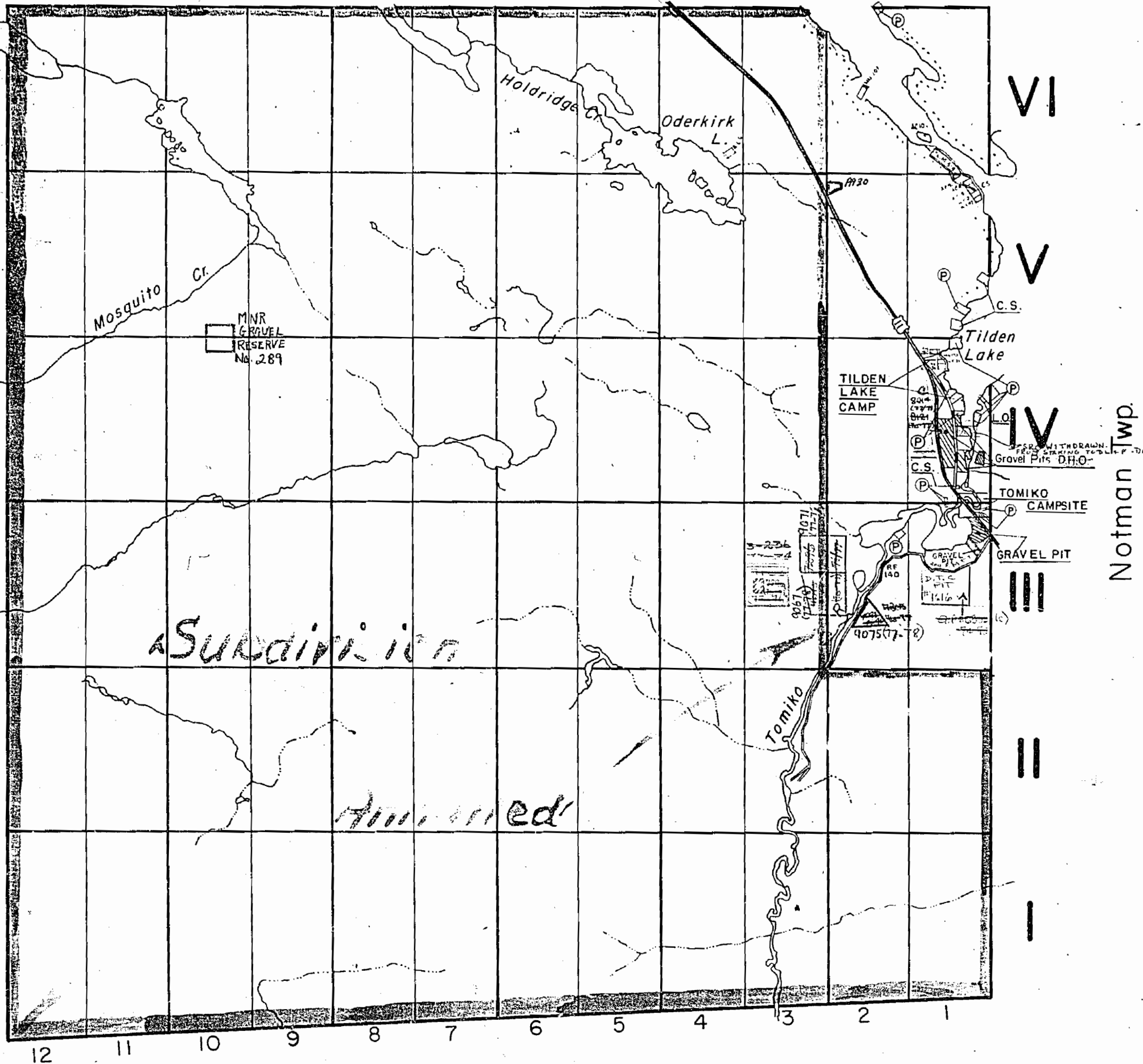

12 11 10 9 8 7 6 5 4 3 2 1

Charlton Twp.

THE TOWNSHIP OF

LYMAN

DISTRICT OF
NIPISSING
LARDER LAKE
MINING DIVISION

SCALE: 1-INCH=40 CHAINS

LEGEND

PATENTED LAND	Ⓟ
CROWN LAND SALE	C.S.
LEASES	Ⓛ
LOCATED LAND	Loc.
LICENSE OF OCCUPATION	L.O.
MINING RIGHTS ONLY	M.R.O.
SURFACE RIGHTS ONLY	S.R.O.
ROADS	—
IMPROVED ROADS	—
KING'S HIGHWAYS	—
RAILWAYS	—
POWER LINES	—
MARSH OR MUSKEG	—
MINES	ⓧ
CANCELLED	C.

NOTES

400' surface rights reservation around all lakes and rivers.

Surface Rights Only reserved under Sec.39 (d) of the Mining Act on parts of lots 2 & 3 Con. 3 shown thus: 73. Files 139169 & 127913.

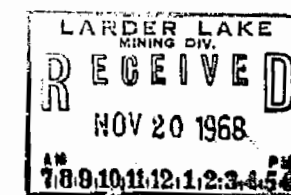

LYMAN

PLAN NO.- M-1001

DEPARTMENT OF MINES

— ONTARIO —

DISPOSITION OF CROWN LANDS

TYPE OF DOCUMENT	SYMBOL
PATENT, SURFACE & MINING RIGHTS	●
" SURFACE RIGHTS ONLY	○
" MINING RIGHTS ONLY	○
LEASE SURFACE & MINING RIGHTS	■
" SURFACE RIGHTS ONLY	■
" MINING RIGHTS ONLY	■
LICENCE OF OCCUPATION	▼
ORDER-IN-COUNCIL	OC
RESERVATION	⊙
CANCELLED	⊗
SAND & GRAVEL	⊕

NOTE: MINING RIGHTS IN PARCELS PATENTED PRIOR TO MAY 6, 1913, VESTED IN ORIGINAL PATENTEE BY THE PUBLIC LANDS ACT, R.S.O. 1970, CHAP 380, SEC 63, SUBSEC 1.

400' Surface rights reservation along the shores of all lakes and rivers.

AREAS WITHDRAWN FROM DISPOSITION

S.R. — SURFACE RIGHTS		M.R. — MINING RIGHTS		
Description	Order No.	Date	Disposition	File
(R1) TOWER & CABIN		SEPT. 1959	S R	139169
(R2) TOWER & CABIN		SEPT. 1959	S R	139169
(R3) GARBAGE DISPOSAL SITE		12/1/1970	S R	160707 Vol 2
(R4) TILDEN LAKE DAM		28/1/1972	S R	71096 Vol 2
(R5) FOREST RESERVE		27/6/1927	S R	71096

SAND and GRAVEL

- (G1) GRAVEL FILE 127913
- (G2) GRAVEL FILES 139169, 127913
- (G3) GRAVEL FILE 139169
- (G4) M.T.C. GRAVEL PIT 1616, FILE 96166
- (G5) MNR 4C-11 GRAVEL RESERVE
- (G7) M.N.R. GRAVEL RESERVE No. 289, FILE 193491
- (G) QUARRY PERMIT

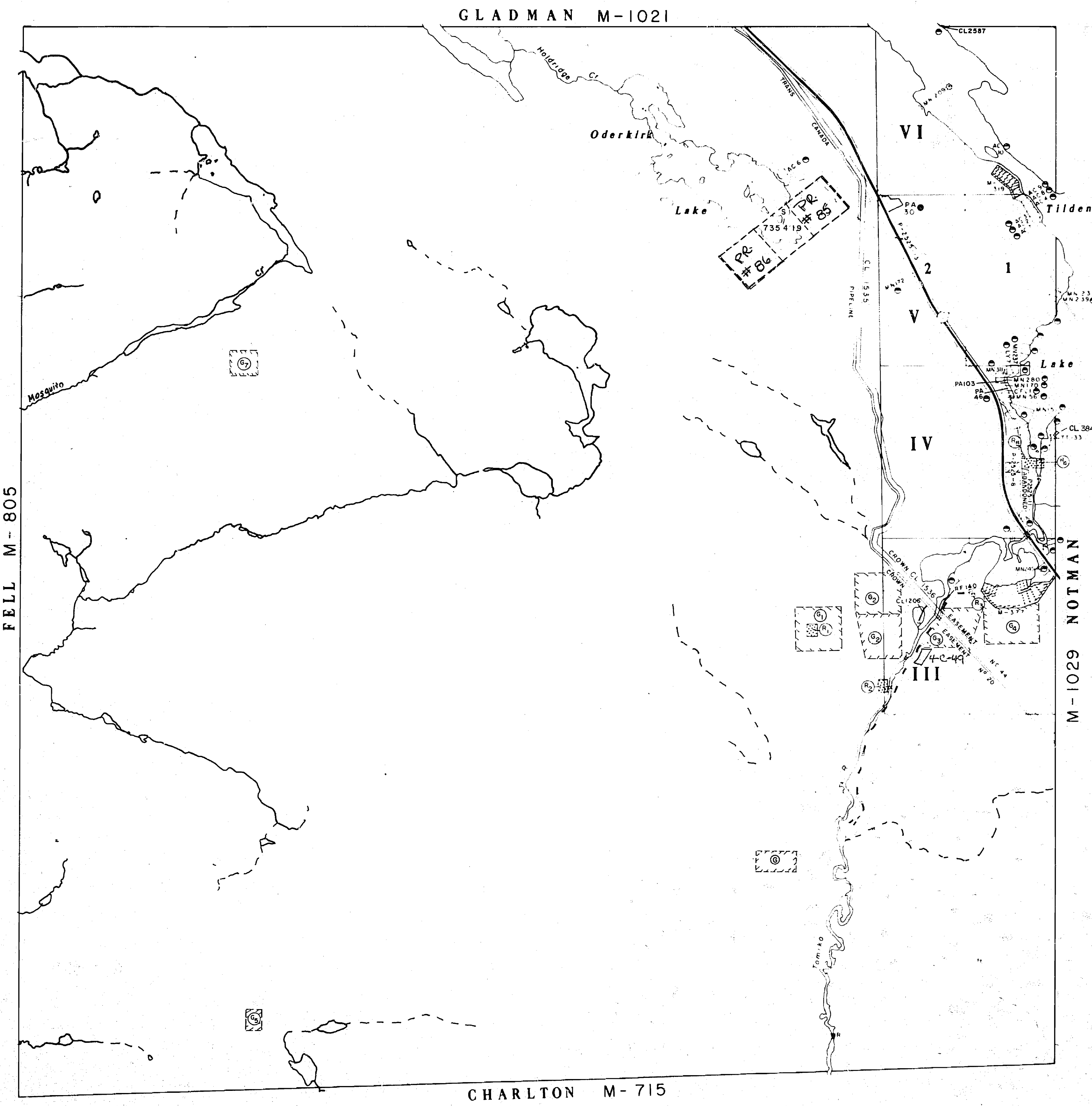

LEGEND

- HIGHWAY AND ROUTE No.
- OTHER ROADS
- TRAILS
- SURVEYED LINES:
 - TOWNSHIPS, BASE LINES, ETC.
 - LOTS, MINING CLAIMS, PARCELS, ETC.
- UNSURVEYED LINES:
 - LOT LINES
 - PARCEL BOUNDARY
 - MINING CLAIMS ETC.
- RAILWAY AND RIGHT OF WAY
- UTILITY LINES
- NON-PERENNIAL STREAM
- FLOODING OR FLOODING RIGHTS
- SUBDIVISION OR COMPOSITE PLAN
- RESERVATIONS
- ORIGINAL SHORELINE
- MARSH OR MUSKEG
- MINES
- TRAVERSE MONUMENT

Pit No. 4C-49 - Expiry Date 1985 10 01

* In Service 1984 08 22 - J

SCALE: 1 INCH = 40 CHAINS

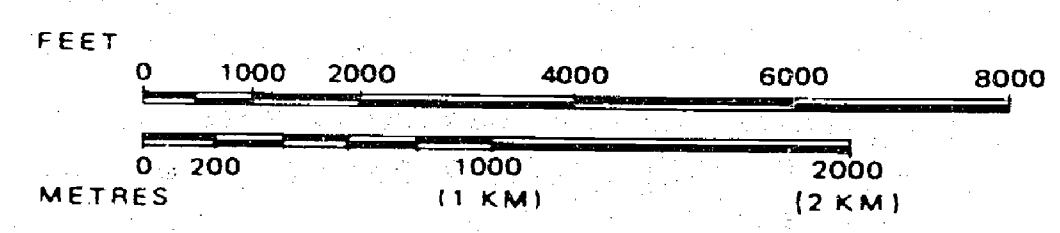

ACRES	HECTARES
40	16

TOWNSHIP OF
LYMAN
DISTRICT
NIPISSING
MINING DIVISION
SUDBURY

Ministry of Natural Resources
Surveys and Mapping Branch

Date: MARCH 20, 1978
Plan No.: **M-1001**
National Topographic Series