

STIRLING TP G-175

HELE TP G-183 NIPIGON TP G-176

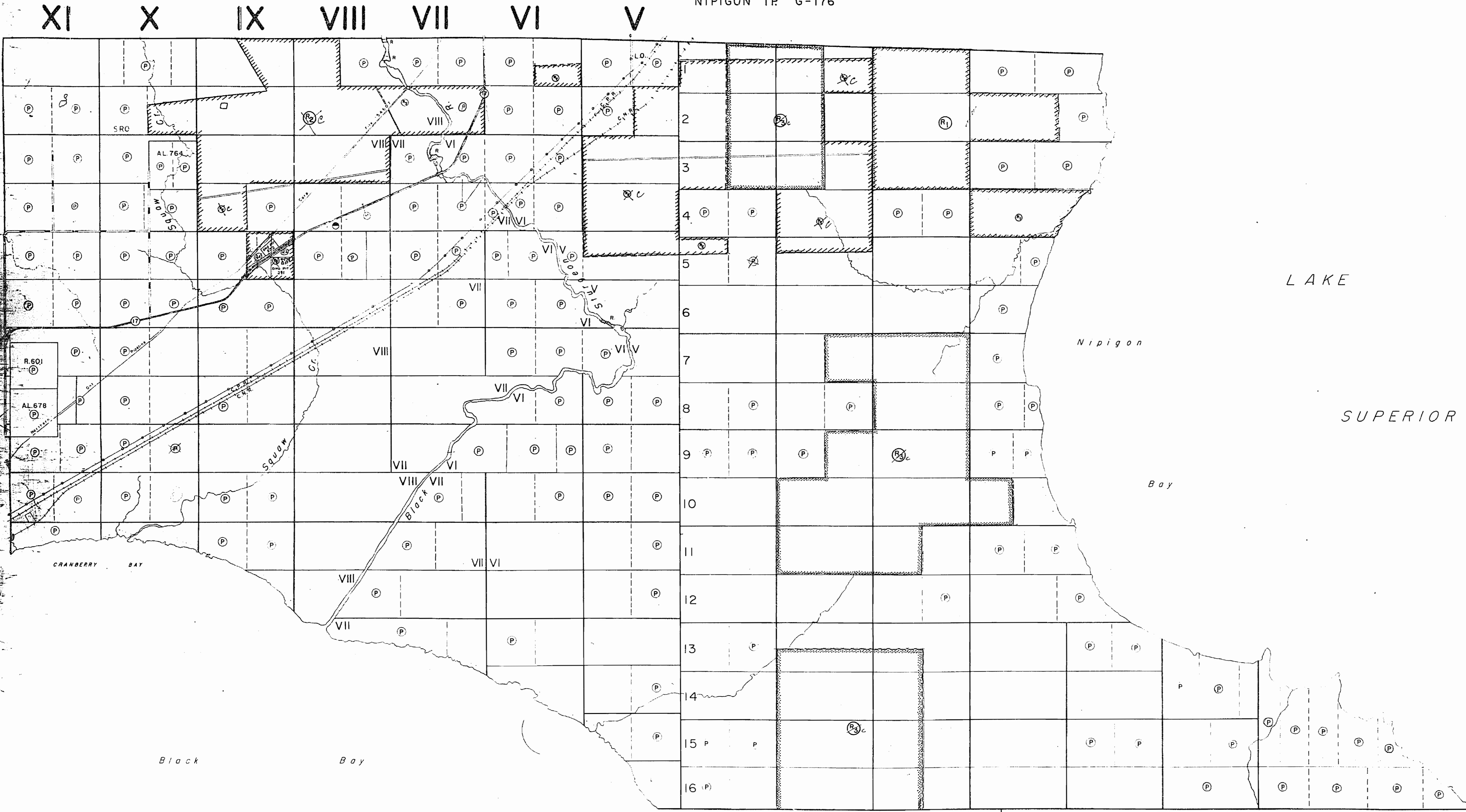

BLACK BAY AREA G-10

IV III II I A B C

WILLIAMSON LAKE AREA G-158

LEGEND

- HIGHWAY AND ROUTE No.
- OTHER ROADS
- TRAILS
- SURVEYED LINES
 - TOWNSHIPS, BASE LINES, ETC.
 - LOTS, MINING CLAIMS, PARCELS, ETC.
- UNSURVEYED LINES
 - LOT LINES
 - PARCEL BOUNDARY
 - MINING CLAIMS ETC.
- RAILWAY AND RIGHT OF WAY
- UTILITY LINES
- NON-PERENNIAL STREAM
- FLOODING OR FLOODING RIGHTS
- SUBDIVISION OR COMPOSITE PLAN
- RESERVATIONS
- ORIGINAL SHORELINE
- MARSH OR MUSKEG
- MINES
- TRAVERSE MONUMENT

DISPOSITION OF CROWN LANDS

TYPE OF DOCUMENT	SYMBOL
PATENT, SURFACE & MINING RIGHTS	⊙ or ⊚
SURFACE RIGHTS ONLY	⊙
MINING RIGHTS ONLY	⊚
LEASE SURFACE & MINING RIGHTS	⊙ or ⊚
SURFACE RIGHTS ONLY	⊙
MINING RIGHTS ONLY	⊚
LICENCE OF OCCUPATION	⊙
ORDER-IN-COUNCIL	OC
RESERVATION	⊙
CANCELLED	⊙
SAND & GRAVEL	⊙

NOTE: MINING RIGHTS IN PARCELS PATENTED PRIOR TO MAY 6 1913, VESTED IN ORIGINAL PATENTEE BY THE PUBLIC LANDS ACT, R.S.O. 1970, CHAP. 180, SEC. 63, SUBSEC. 1

AREAS WITHDRAWN FROM DISPOSITION

S.R. - SURFACE RIGHTS		M.R. - MINING RIGHTS	
Description	Order No.	Date	Disposition File
	W 29/75	17/6/75	SR & MR 112748
⊙	W 3760	18/7/75	SR & MR 112748
⊙	W 14/80	12/11/80	SR & MR 194020

NOTE: CANCELLED ORDER 66/69/81

SCALE: 1 INCH = 40 CHAINS

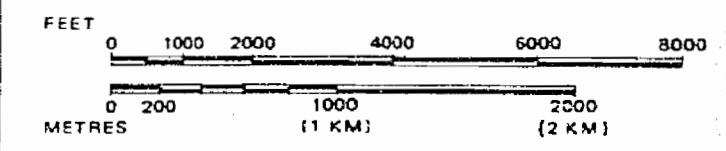

TOWNSHIP

LYON

M.N.R. ADMINISTRATIVE DISTRICT

NIPIGON

MINING DIVISION

THUNDER BAY

LAND TITLES / REGISTRY DIVISION

THUNDER BAY

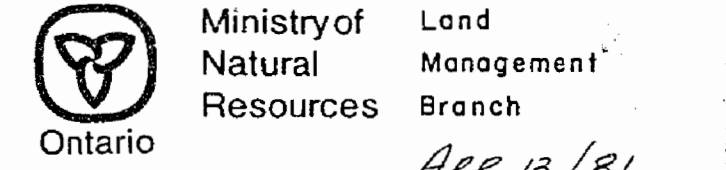

Date FEB. 12 /81 Number

G-180

1801

XI X IX VIII VII VI V NIPIGON TWP

THE TOWNSHIP OF LYON DISTRICT OF THUNDER BAY PORT ARTHUR MINING DIVISION SCALE 1-INCH=40 CHAINS

STIRLING TWP

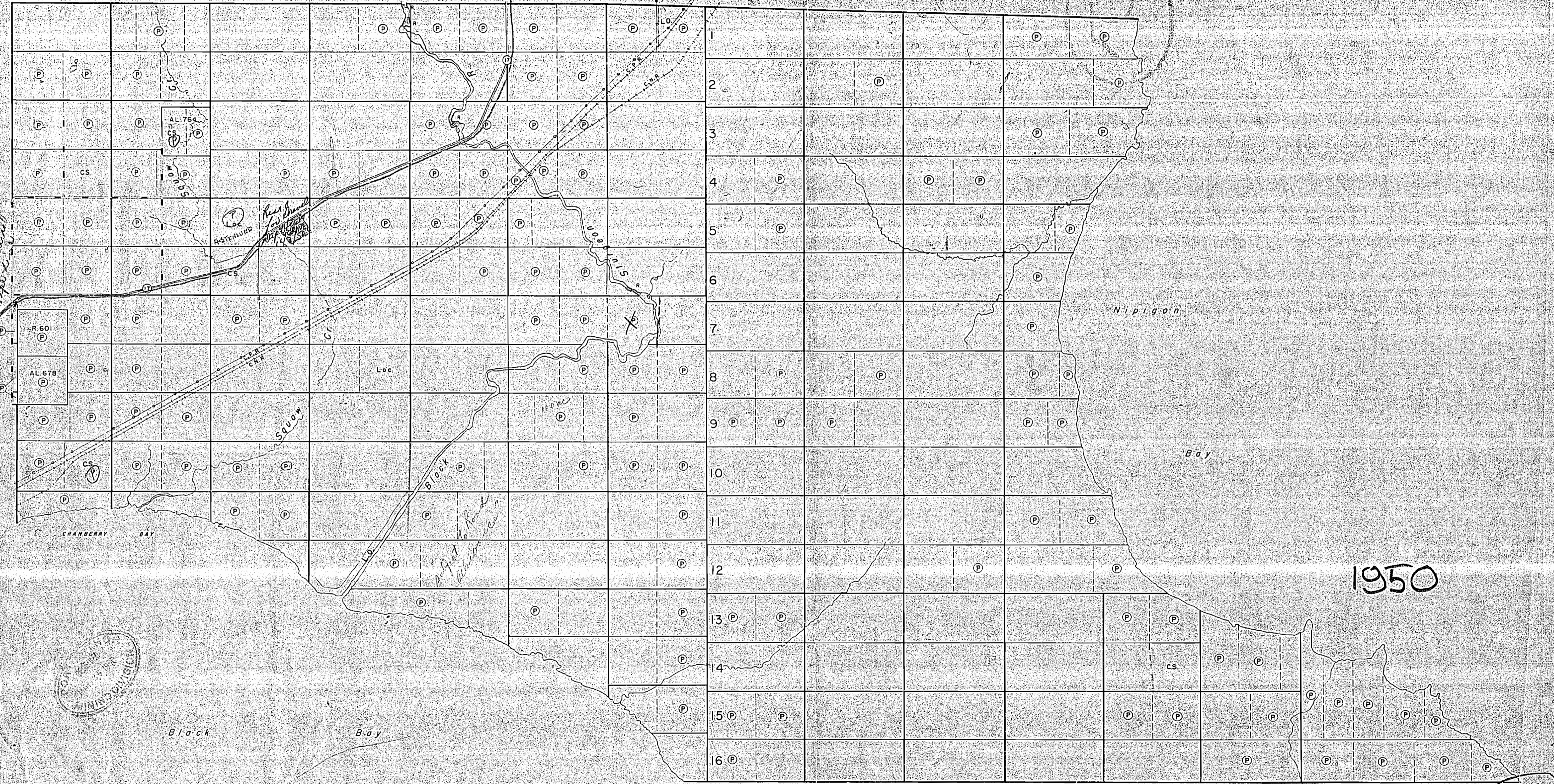

LEGEND

- PATENTED LAND (P)
- CROWN LAND SALE (CS)
- LEASES (L)
- LOCATED LAND (Loc)
- LICENSE OF OCCUPATION (L.O.)
- ROADS (---)
- IMPROVED ROADS (—)
- RAILWAYS (—+—)
- POWER LINES (—|—)
- MARSH OR MUSKEG (---)

NOTES



1950



Handwritten signature

MAY 26, 1950

PLAN NO.-T.B.127

DEPARTMENT OF MINES -ONTARIO-

M1801 777

IV III II I A B C

LYON

DISTRICT OF THUNDER BAY

PORT ARTHUR MINING DIVISION

SCALE: 1-INCH = 40 CHAINS

LEGEND

- PATENTED LAND (P)
- CROWN LAND SALE (CS)
- LEASES (L)
- LOCATED LAND (Loc.)
- LICENSE OF OCCUPATION (L.O.)
- ROADS (—)
- IMPROVED ROADS (—)
- RAILWAYS (—)
- POWER LINES (—)
- MARSH OR MUSKEG (—)

NOTES

400' Reserve to the Dept. of Lands & Forests shown thus: —

LAND UNDER LAKE SUPERIOR WITHDRAWN FROM STAKING BY ORDER IN COUNCIL DATED APRIL 30, 1912

NOTE: HATCHED AREA STAKINGS ACCEPTED. "SCALE OF ALLUVIAL MINERALS" LETTERS OF DEPT. OF MINES, 1910. LETTERS OF DEPT. OF MINES, 1910. LETTER JAN. 1911. JULY 15, 1910. EXPENSES FOR EXAMINATION OF STAKES. HATCHED OUT WITH DEC. 31, 1910.

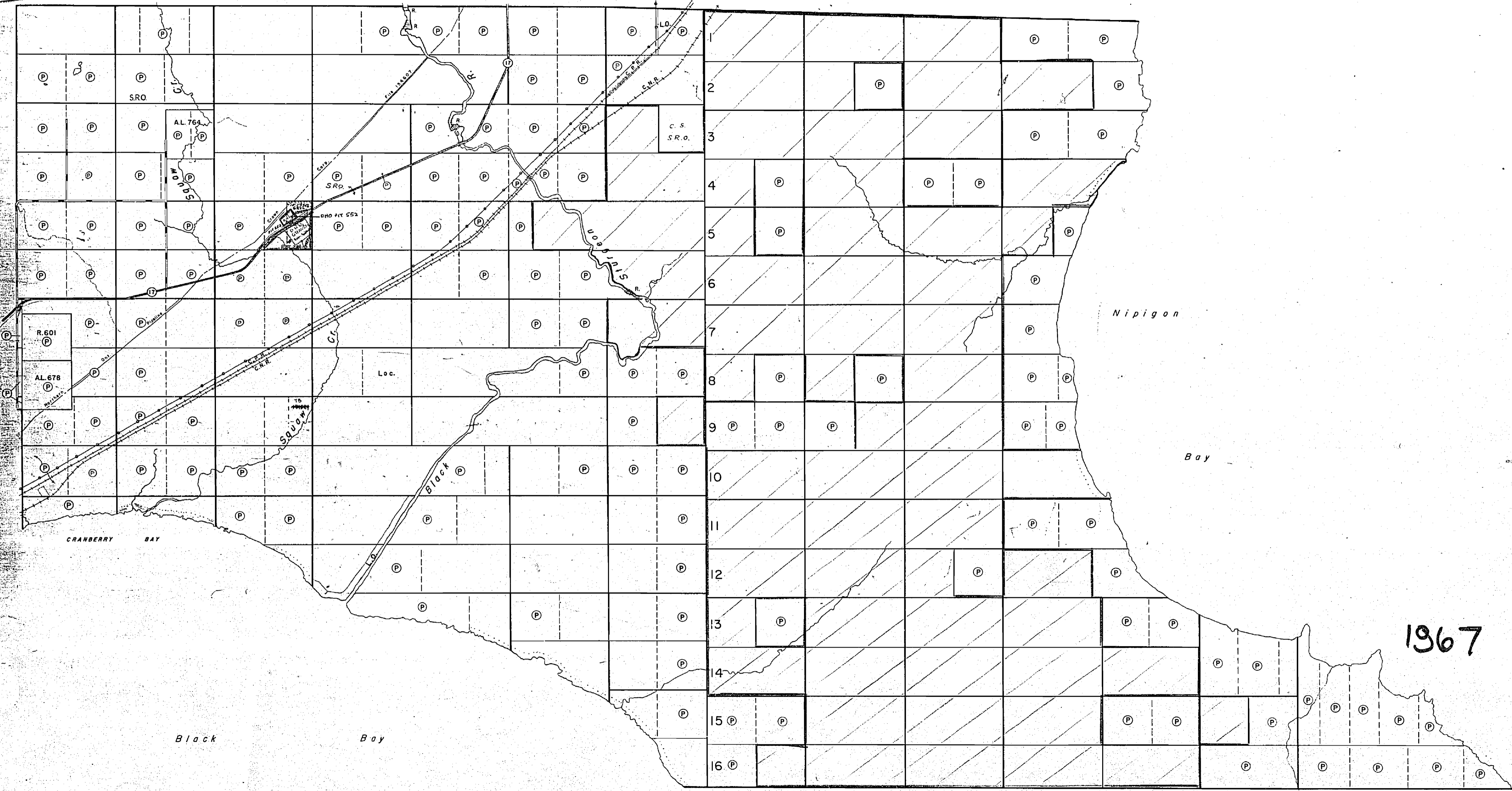

1967

1801

XI X IX VIII VII VI V NIPIGON TWP

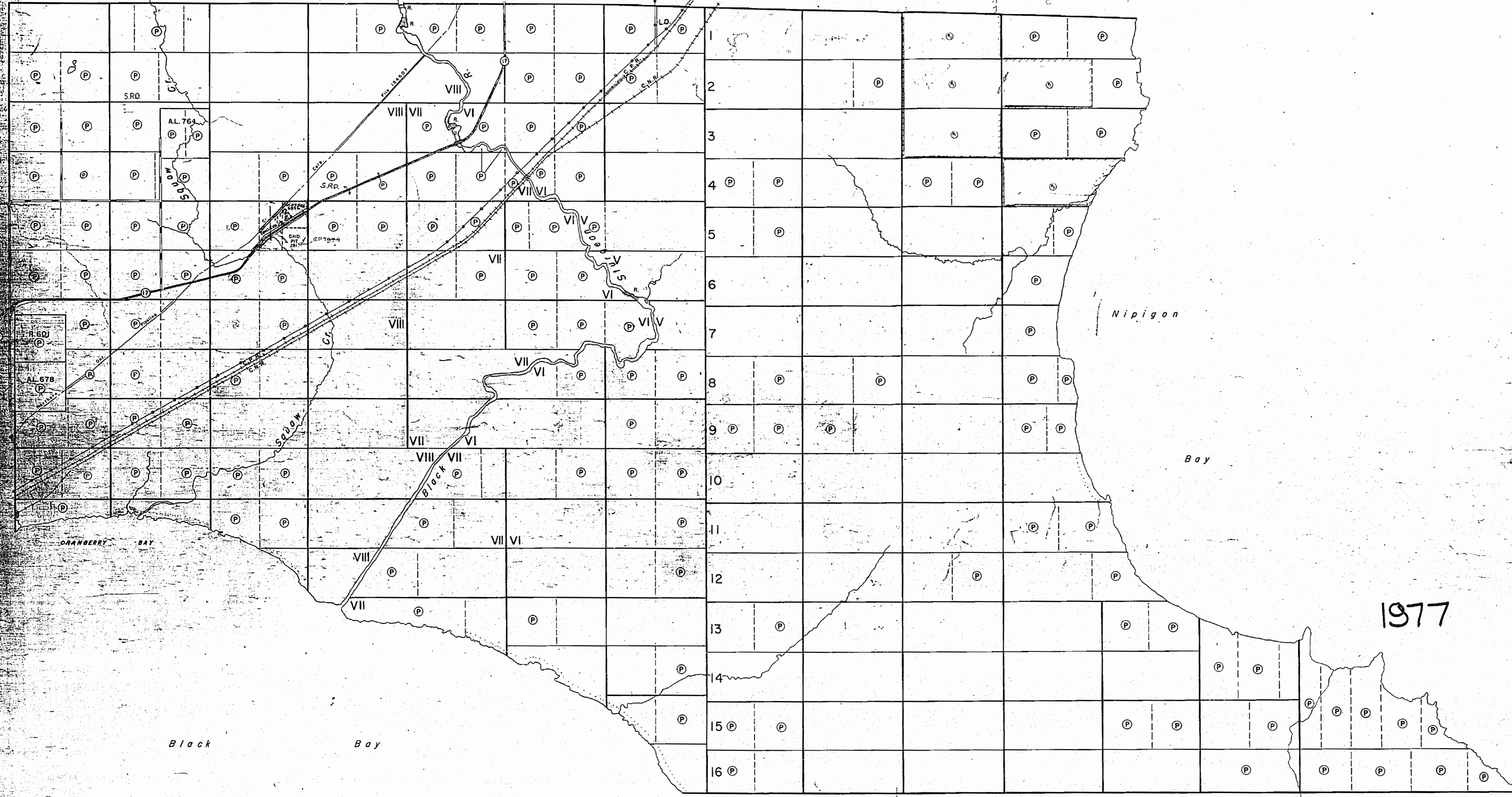

THE TOWNSHIP OF

LYON

DISTRICT OF THUNDER BAY

THUNDER BAY MINING DIVISION

SCALE: 1-INCH=40 CHAINS

LEGEND

- PATENTED LAND (P)
- CROWN LAND SALE (CS)
- LEASES (L)
- LOCATED LAND (Loc)
- LICENSE OF OCCUPATION (L.O.)
- ROADS (—)
- IMPROVED ROADS (—)
- RAILWAYS (—)
- POWER LINES (—)
- MARSH OR MUSKEG (—)

NOTES

400' Reserve to the Dept. of Lands & Forests shown thus: —

LAND UNDER LAKE "SUPERIOR" WITHDRAWN FROM STAKING BY ORDER IN COUNCIL DATED APRIL 30, 1912.

Areas withdrawn from staking under Section 43 of the Mining Act, R.S.O. 1970:

Order No.	File	Date	Disposition
W.29/75	112748	17/6/75	S.R. & M.A.

JAN. 26/77

THUNDER BAY - NIPIGON DIST.

PLAN NO. - M-1801

ONTARIO
MINISTRY OF NATURAL RESOURCES
SURVEYS AND MAPPING BRANCH

N E P I C O N

N O R T H E S T R O U P S I D E

#180

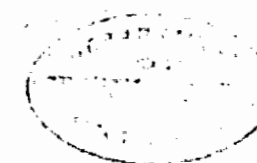

(T. 36)

PLAN

OF THE RESIDUE OF

THE TOWNSHIP OF

LYON

IN THE DISTRICT OF

THUNDER BAY

SCALE - FORTY CHAINS TO ONE INCH

Area... 23950 Acres

WEST PORTION TOWNSHIP OF LYON

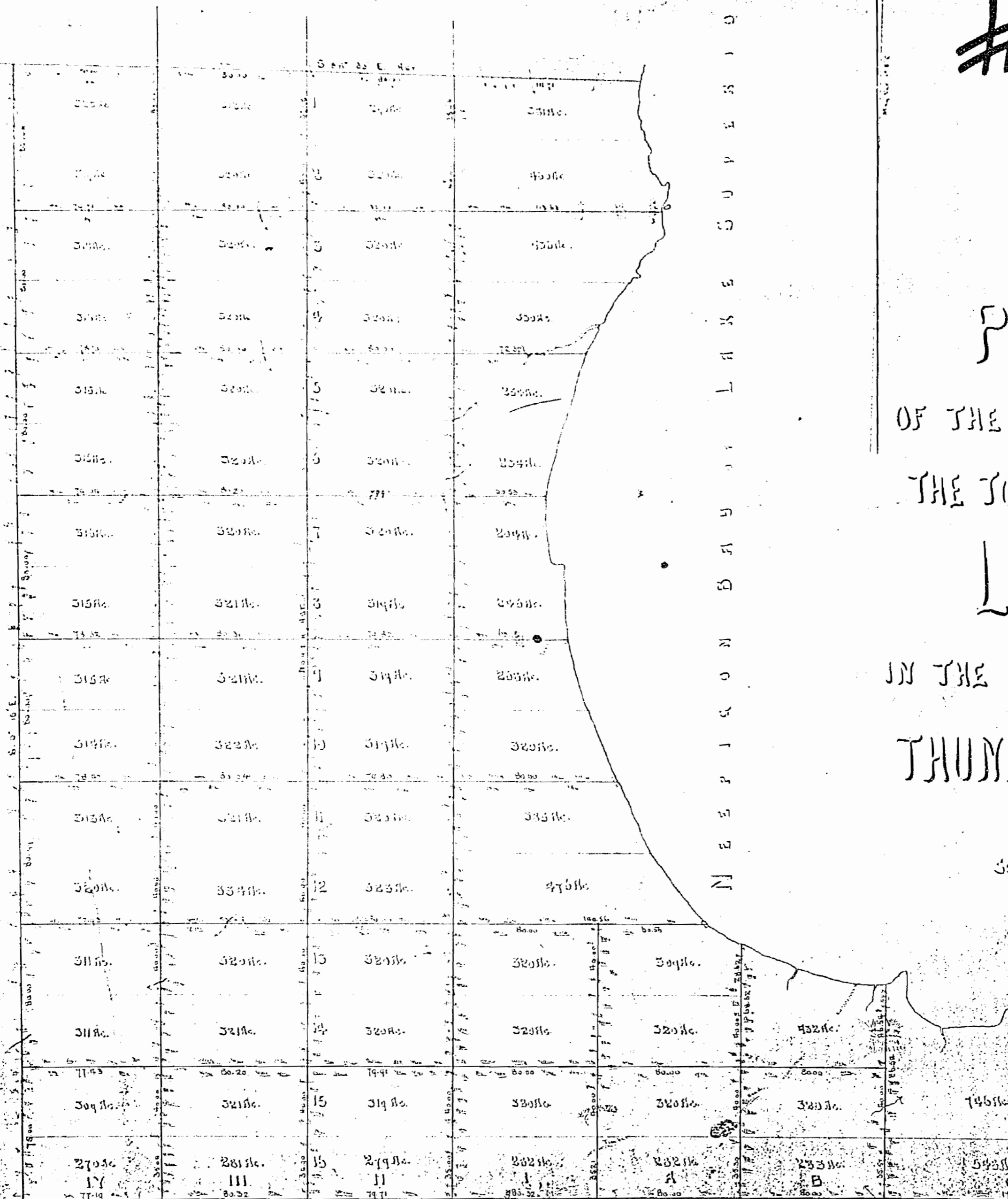

U N S U R V E Y E D L A N D S

Examined with Fieldnotes Dec 19th 1894. *CP*
 Copied for Registrar July 21st 1896. *DR*
 Taken for Office June 15th 1895. *MR*
 Copied for Office Sept 25th 1904. *R.G.J.*

MS. Collins. C. & S.

(L-52)
PLAN

429/68/11

1529

OF PART OF THE TOWNSHIP OF
LYON
DISTRICT OF THUNDER BAY
ONT.

#180

AREA

Area of Land 6149 Acres
Locations A.L. 764, 601, 678 not included.

SCALE 40 CHAINS TO AN INCH

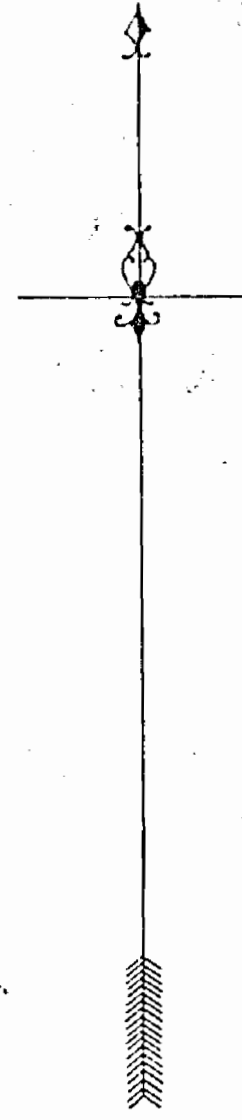
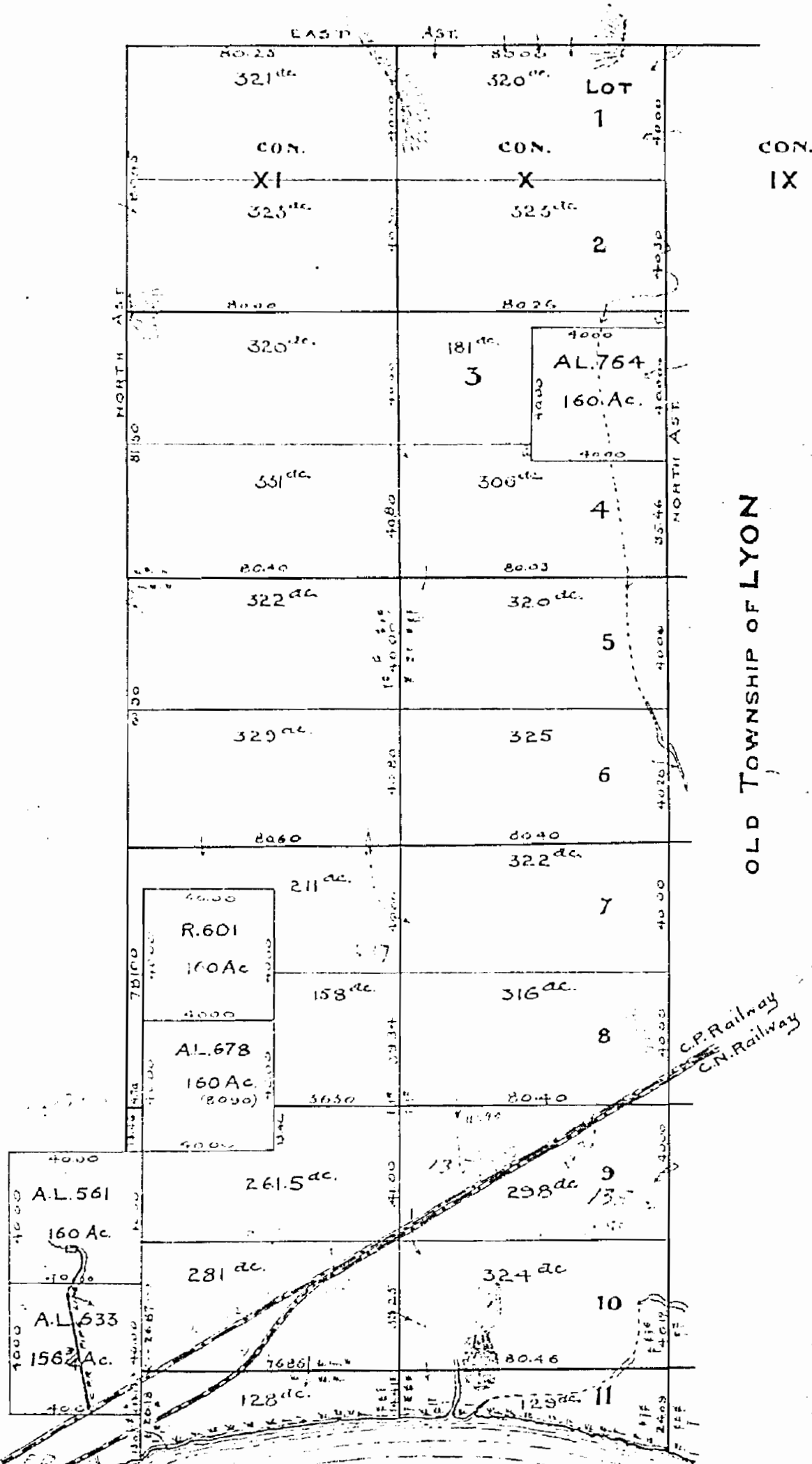

BLACK BAY

West Ast.
TOWNSHIP OF DORION

Total Area including Res = 301 ac
H₂O = 150 1/2

#180

NIPICON TOWNSHIP
CON. V

Lot. No. 1

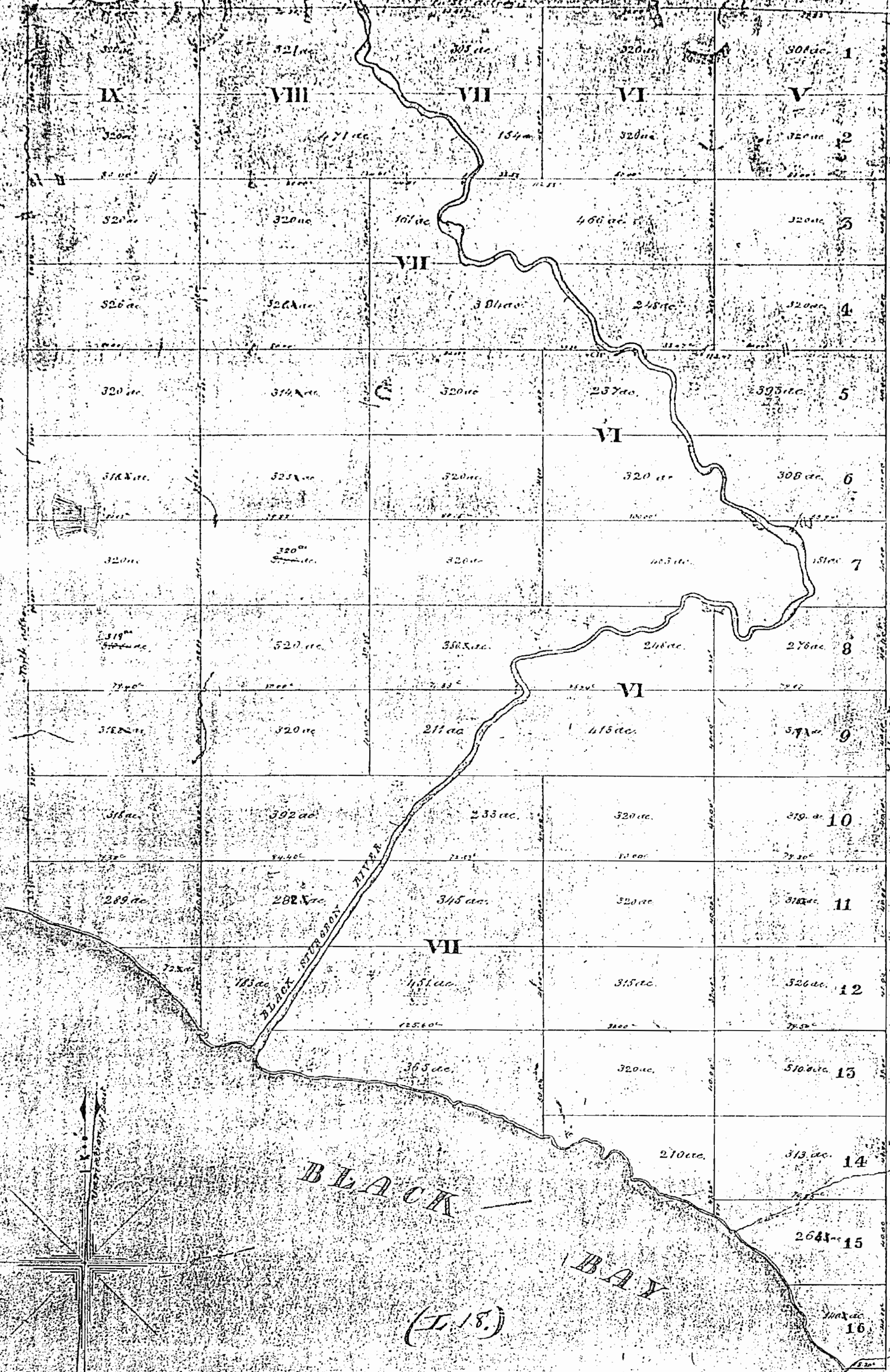

BLACK RIVER
BLACK BAY

PLAN

OF A PORTION OF THE TOWNSHIP OF

LYON

DISTRICT OF THUNDER BAY

#180

Area of Lots	2087
Area of River	165
Total area	2252

Case X and XI Surveyed by S. D. Baker in 1871

Scale 40 CHAINS ONE INCH

Lyon and the Black River, D. Robertson, 1878, 981
 Lyon and the Black River, S. D. Baker, 1879, 100
 Lyon and the Black River, S. D. Baker, 1880, 100
 Lyon and the Black River, S. D. Baker, 1881, 100
 Lyon and the Black River, S. D. Baker, 1882, 100
 Lyon and the Black River, S. D. Baker, 1883, 100
 Lyon and the Black River, S. D. Baker, 1884, 100
 Lyon and the Black River, S. D. Baker, 1885, 100
 Lyon and the Black River, S. D. Baker, 1886, 100
 Lyon and the Black River, S. D. Baker, 1887, 100
 Lyon and the Black River, S. D. Baker, 1888, 100
 Lyon and the Black River, S. D. Baker, 1889, 100
 Lyon and the Black River, S. D. Baker, 1890, 100
 Lyon and the Black River, S. D. Baker, 1891, 100
 Lyon and the Black River, S. D. Baker, 1892, 100
 Lyon and the Black River, S. D. Baker, 1893, 100
 Lyon and the Black River, S. D. Baker, 1894, 100
 Lyon and the Black River, S. D. Baker, 1895, 100
 Lyon and the Black River, S. D. Baker, 1896, 100
 Lyon and the Black River, S. D. Baker, 1897, 100
 Lyon and the Black River, S. D. Baker, 1898, 100
 Lyon and the Black River, S. D. Baker, 1899, 100
 Lyon and the Black River, S. D. Baker, 1900, 100

Handwritten signature and date

1801

N E E P I G O N



LYON
 District of
 Thunder Bay
 Scale 40 Chains to an Inch.

M 1801

Part of the Township of
LYON

HELE TP. G-183

NIPIGON TP. G-176

XI X IX VIII VII VI V

STIRLING TP. G-175

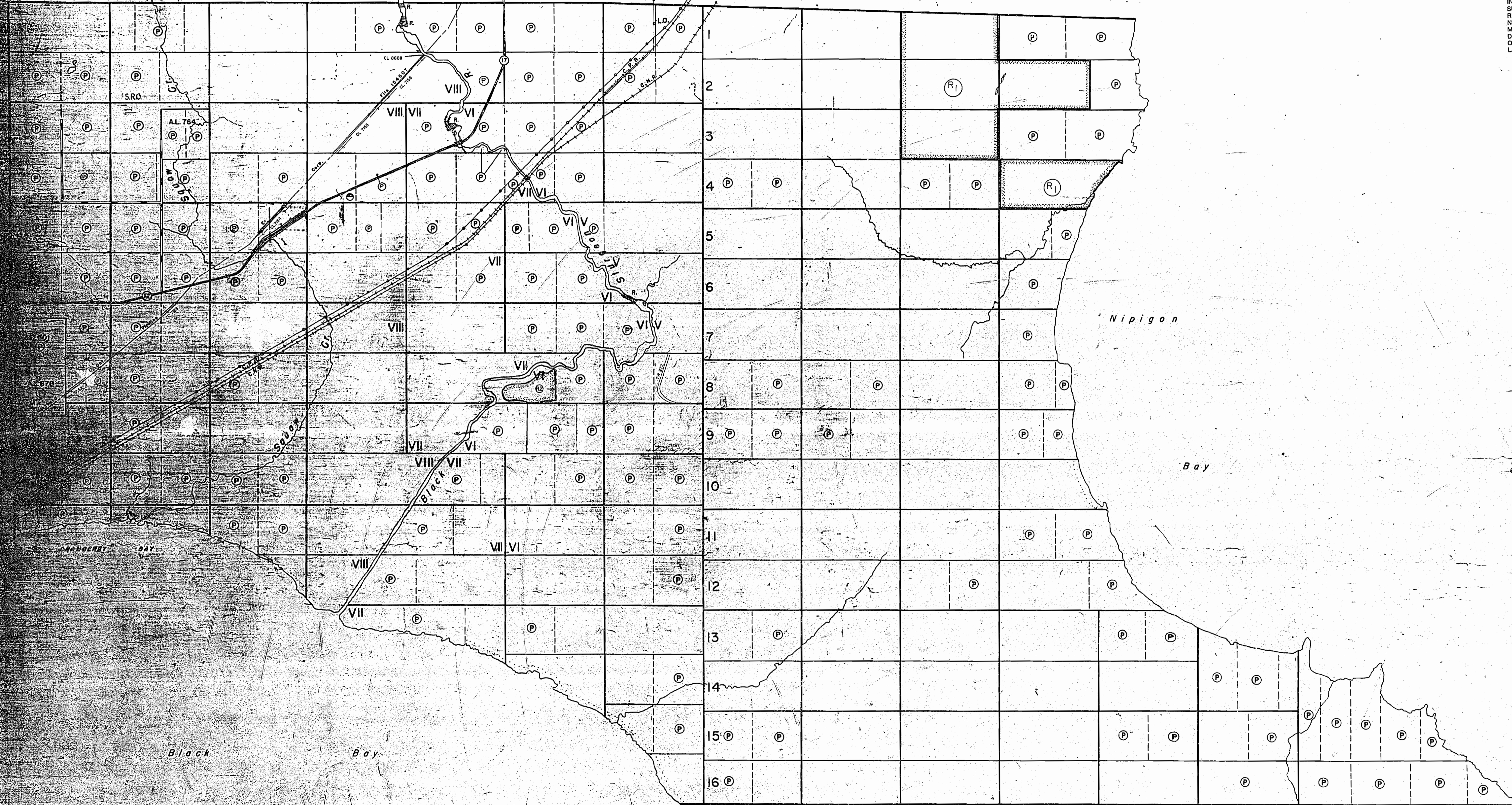

THE SURFACE RIGHTS LYING WITHIN 40.25 FT. OF THE CENTERLINE OF THE TRANS-CANADA PIPELINE RIGHT-OF-WAY ARE WITHDRAWN FROM STAKING OUT, PROSPECTING, SALE OR LEASE BY ORDER W-01/91/ONT. DATED SEPT. 26, 1991. SECTION 112 OF THE NATIONAL ENERGY ACT APPLIES TO THIS AREA.

BLACK BAY AREA G-10

WILLIAMSON LAKE AREA G-158

IV III II I A B C

LEGEND

- HIGHWAY AND ROUTE No.
- OTHER ROADS
- TRAILS
- SURVEYED LINES:
 - TOWNSHIPS, BASE LINES, ETC.
 - LOTS, MINING CLAIMS, PARCELS, ETC.
- UNSURVEYED LINES:
 - LOT LINES
 - PARCEL BOUNDARY
 - MINING CLAIMS ETC.
- RAILWAY AND RIGHT OF WAY
- UTILITY LINES
- NON-PERENNIAL STREAM
- FLOODING OR FLOODING RIGHTS, SUBDIVISION OR COMPOSITE PLAN
- RESERVATIONS
- ORIGINAL SHORELINE
- MARSH OR MUSKEG
- MINES
- TRAVERSE MONUMENT

DISPOSITION OF CROWN LANDS

TYPE OF DOCUMENT	SYMBOL
PATENT, SURFACE & MINING RIGHTS	
" SURFACE RIGHTS ONLY	
" MINING RIGHTS ONLY	
LEASE, SURFACE & MINING RIGHTS	
" SURFACE RIGHTS ONLY	
" MINING RIGHTS ONLY	
LICENCE OF OCCUPATION	
ORDER-IN-COUNCIL	
RESERVATION	
CANCELLED	
SAND & GRAVEL	
LAND USE PERMITS FOR COMMERCIAL TOURISM/OUTPOST CAMPS	

NOTE: MINING RIGHTS IN PARCELS PATENTED PRIOR TO MAY 9, 1912, VESTED IN ORIGINAL PATENTEES BY THE PUBLIC LANDS ACT, R.S.O. 1970, CHAP. 280, SEC. 63, SUBSEC. 1.

AREAS WITHDRAWN FROM DISPOSITION

S.R. - SURFACE RIGHTS	M.R. - MINING RIGHTS
Description	Order No. Date Disposition File
Sec. 43/70	W 29/75 17/06/75 S.B.M.R. 7598 v.5

MINING & SURFACE RIGHTS WITHDRAWN ORDER W-75-33/93, NWR DATED 9/30/87, TO PROTECT PROJECT & DEMONSTRATION AREAS FOR NORTHWEST REGION VEGETATION MANAGEMENT ALTERNATIVE PROGRAM

NOTES
Land under Lake Superior withdrawn from staking by O.C. dated April 30, 1912. SEE LANDROLL

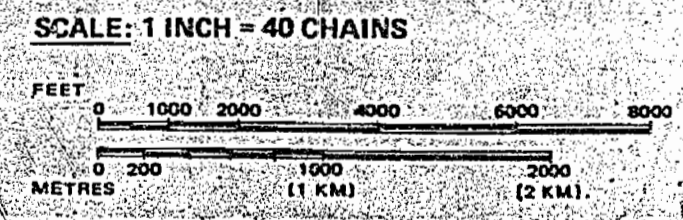

TOWNSHIP
LYON
M.N.R. ADMINISTRATIVE DISTRICT
NIPIGON
MINING DIVISION
THUNDER BAY
LAND TITLES / REGISTRY DIVISION
THUNDER BAY

Ministry of Natural Resources
Land Management Branch
Ontario
Date FEB. 12 /91
Number
G-180

1801

N E P I G O N

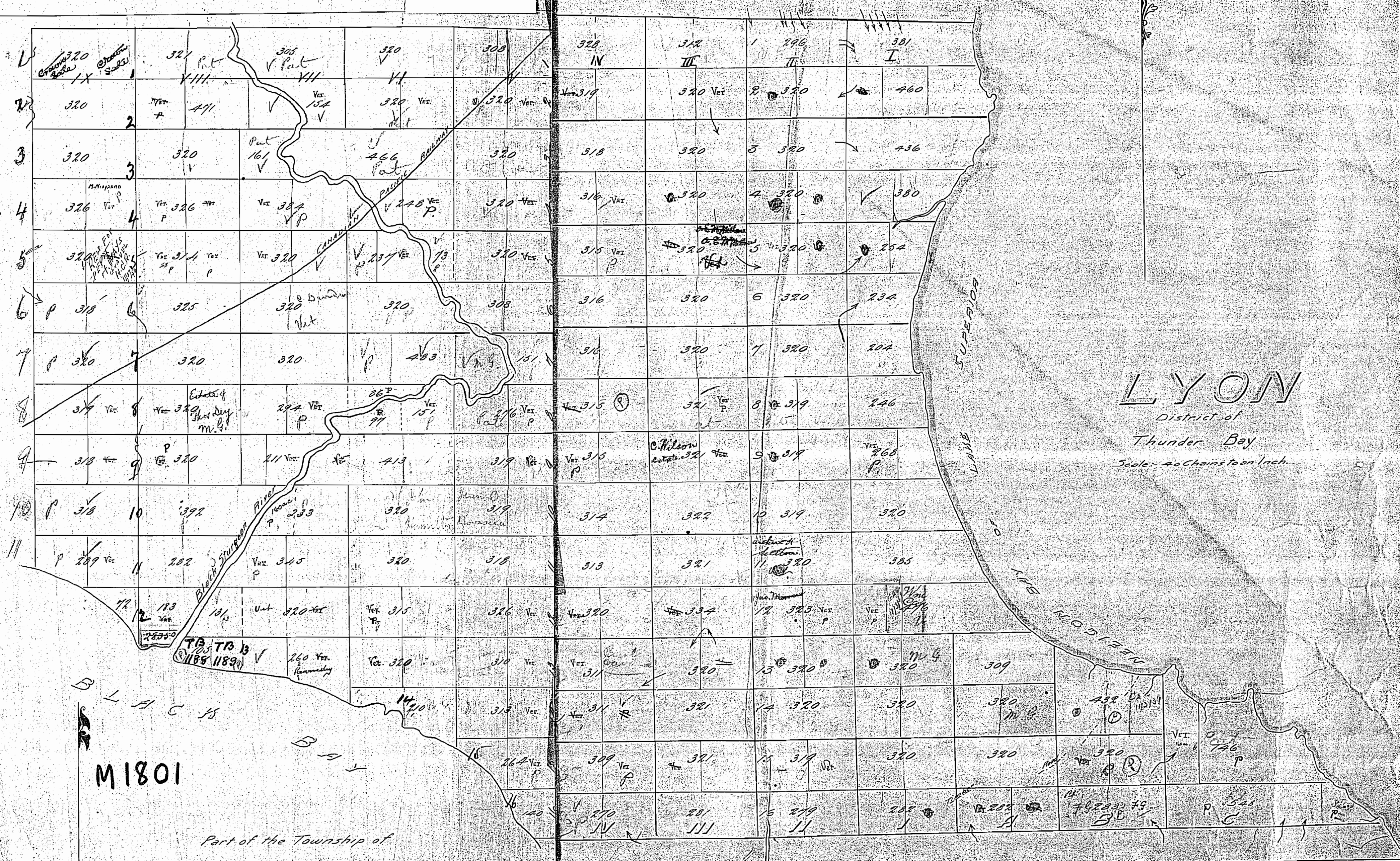

LYON

District of
Thunder Bay
Scale - 40 Chains to an Inch.

M1801

Part of the Township of
LYON

1801

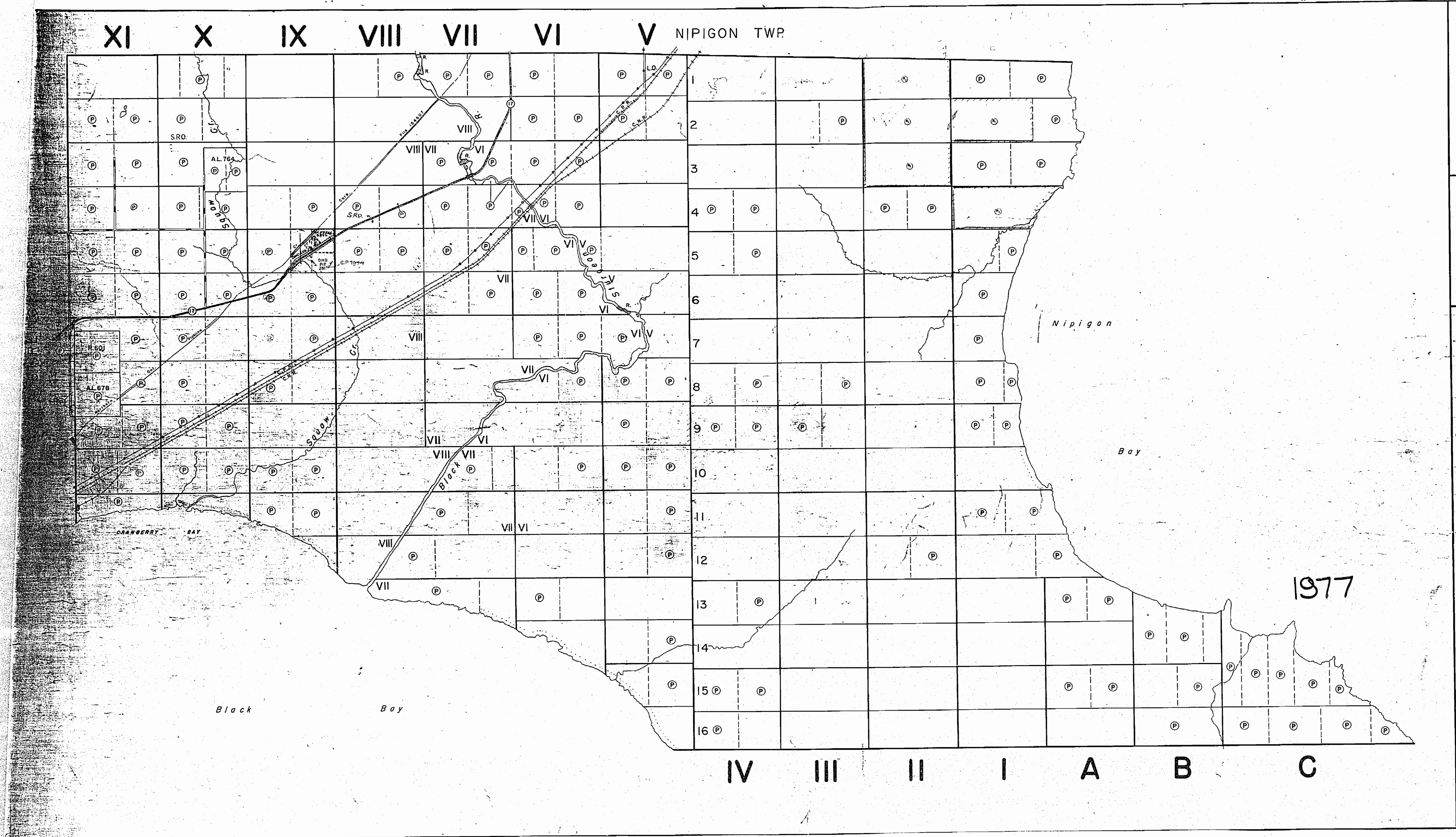

THE TOWNSHIP
OF
LYON
DISTRICT OF
THUNDER BAY
THUNDER BAY
MINING DIVISION
SCALE: 1-INCH=40 CHAINS

LEGEND

PATENTED LAND	⊙
CROWN LAND SALE	⊙
LEASES	⊙
LOCATED LAND	⊙
LICENSE OF OCCUPATION	L.O.
ROADS	—
IMPROVED ROADS	—
RAILWAYS	—
POWER LINES	—
MARSH OR MUSKEG	—

NOTES

400' Reserve to the Dept. of Lands & Forests shown in heavy lines.

LAND UNDER LAKE SUPERIOR WITHDRAWN FROM STAKING BY ORDER IN COUNCIL DATED APRIL 30, 1912.

Areas withdrawn from staking under Section 23 of the Mining Act (S.S. 1970) Order No. 1111 Date of Disposition: 11/21/75 S.A. & M.P.

Jan. 26/77
Thunder Bay-Nipigon Dist.
PLAN NO. - M-1801
ONTARIO
MINISTRY OF NATURAL RESOURCES
SURVEYS AND MAPPING BRANCH

1801

XI X IX VIII VII VI V NIPIGON TWP

STIRLING TWP



THE TOWNSHIP
OF
LYON
DISTRICT OF
THUNDER BAY
PORT ARTHUR
MINING DIVISION
SCALE 1-INCH = 40 CHAINS

LEGEND

PATENTED LAND	(P)
CROWN LAND SALE	(CS)
LEASES	(L)
LOCATED LAND	(LO)
LICENSE OF OCCUPATION	(L.O.)
ROADS	(—)
IMPROVED ROADS	(—)
RAILWAYS	(—)
POWER LINES	(—)
MARSH OR MUSKEG	(—)

NOTES

1950

DEPARTMENT OF MINES
ONTARIO

MAY 26, 1950

PLAN NO. T.B. 127

DEPARTMENT OF MINES
ONTARIO

1801 777

1801

XI X IX VIII VII VI V NIPIGON TWP.

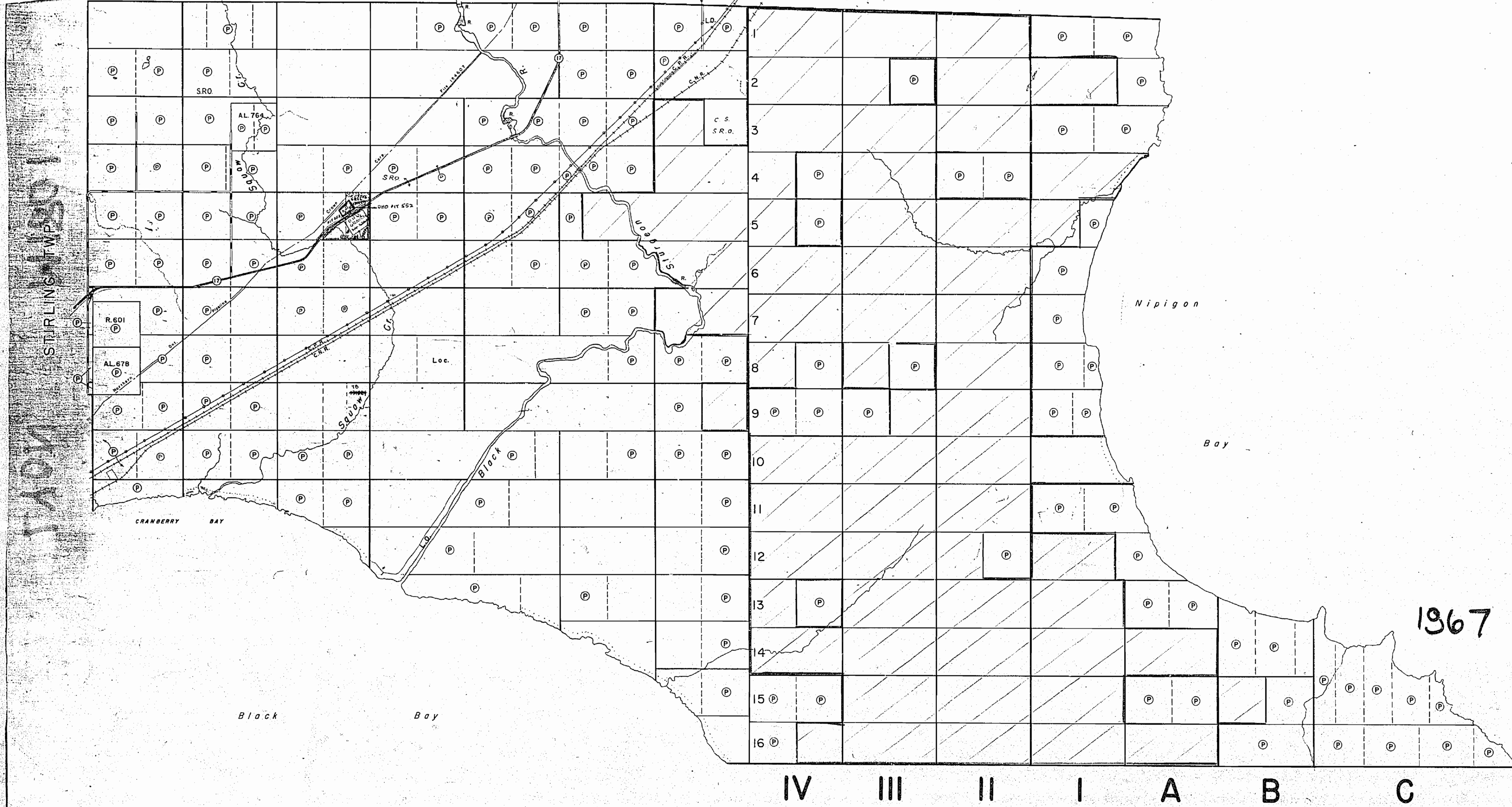

THE TOWNSHIP
OF
LYON
DISTRICT OF
THUNDER BAY
PORT ARTHUR
MINING DIVISION
SCALE: 1-INCH=40 CHAINS

LEGEND

PATENTED LAND	⊙
CROWN LAND SALE	CS
LEASES	⊙
LOCATED LAND	Loc.
LICENSE OF OCCUPATION	LO
ROADS	—
IMPROVED ROADS	—
RAILWAYS	—
POWER LINES	—
MARSH OR MUSKEG	—

NOTES

400 Reserve to the Dept. of Lands & Forests shown thus: —

LAND UNDER LAKE SUPERIOR WITHDRAWN FROM STAKING BY ORDER IN COUNCIL 95-ED APRIL 30, 1912

M.T.C. NOTES ARE STAMPS ACCEPTED. "ONE OF QUANTITY MINED"

LETTER BY DEPT. OF MINES, 1867

Letter dated July 18, 1912

Approved by Department of Mines

London on July 18, 1912

PLAN NO.— M-1801
DEPARTMENT OF MINES
—ONTARIO—