

TWP. 6E-M.1996

TWP. 5F-M.1423

TWP. 5D - M.1421

TWP. 4E-M.1398

46°58'36"  
83°12'44" approx.

NOTES

400' surface rights reservation along the shores of all lakes and rivers.

S. S. MARIE  
MINING DIV.  
**RECEIVED**  
AUG 16 1971  
AM 78910412123450  
PAT

LEGEND

- PATENTED LAND (P) or ●
- PATENTED FOR SURFACE RIGHTS ONLY ●
- LEASE (L)
- LICENSE OF OCCUPATION L O
- CROWN LAND SALES C S
- LOCATED LAND Loc
- CANCELLED C
- MINING RIGHTS ONLY M R O
- SURFACE RIGHTS ONLY S R O
- HIGHWAY & ROUTE NO. 17
- ROADS |||
- TRAILS ---
- RAILWAYS =
- POWER LINES -o-
- MARSH OR MUSKEG ~
- MINES X

\* used only with summer resort locations or when space is limited

TOWNSHIP OF

**5E** (MAECK)

DISTRICT OF  
ALGOMA

**G.3299**

SAULT STE. MARIE  
MINING DIVISION

SCALE : 1 INCH = 40 CHAINS (1/2 MILE)

DR. D.J.P. KAVANAGH  
DATE 9-11-1970

PLAN NO. **M.1422**

ONTARIO  
DEPARTMENT OF MINES  
AND NORTHERN AFFAIRS

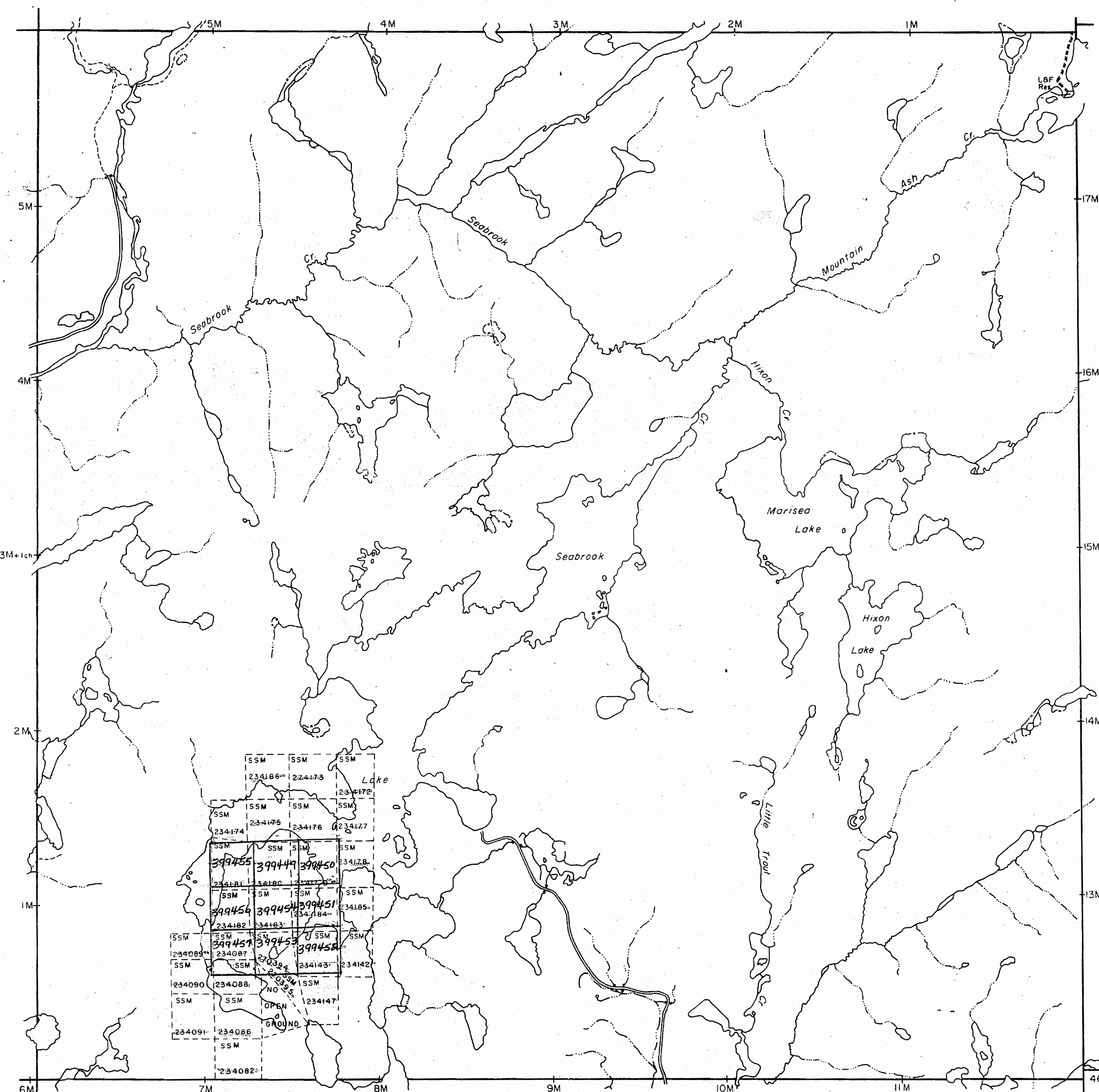

JESSIMAN TP M.1996

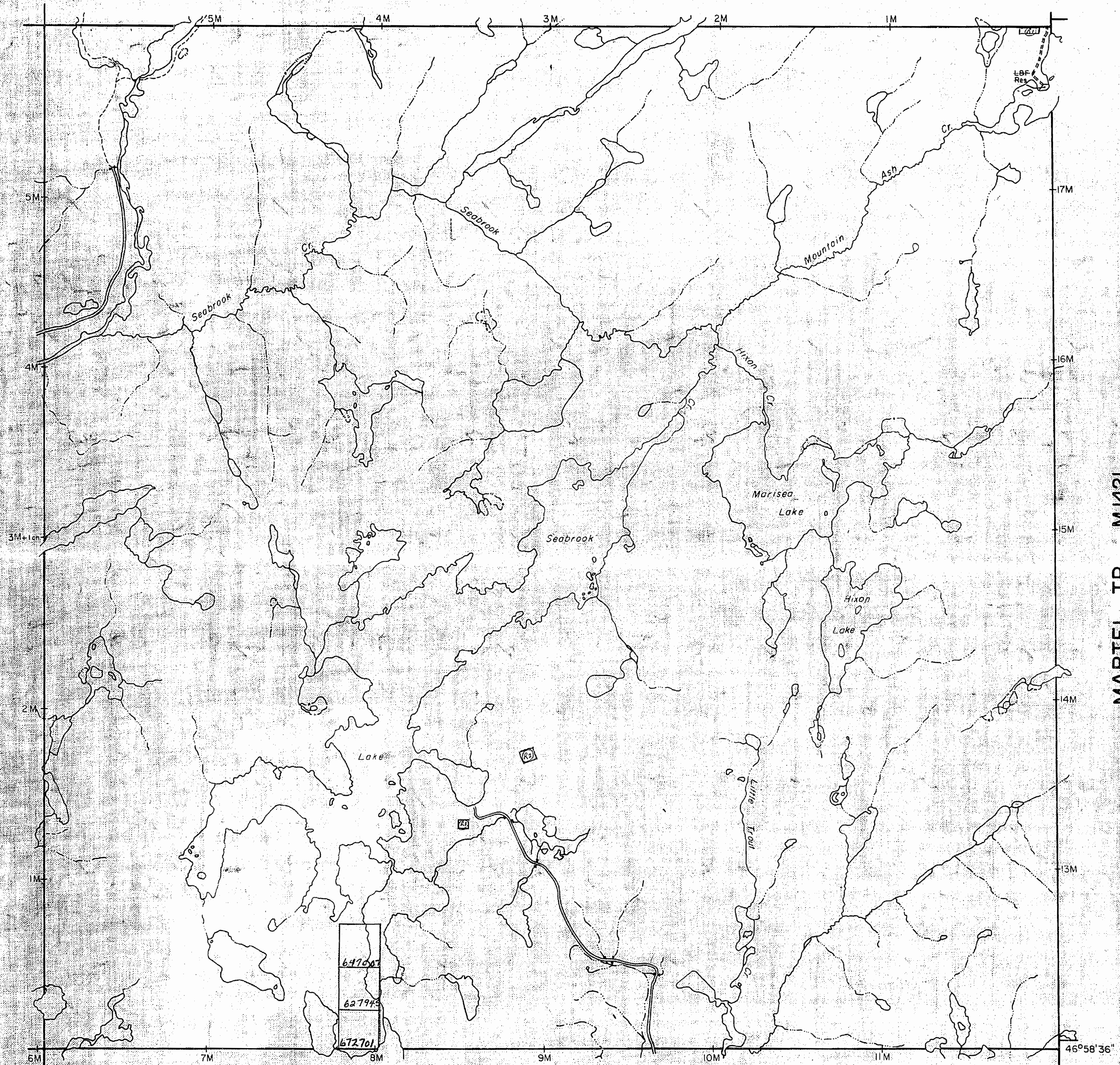

NOTES

400' surface rights reservation along the shores of all lakes and rivers.

- (R) Surface Rights Only withdrawn from staking. See order # W. 3/32- BLIND RIVER Nov. 15/82.
- (B) Surface Rights Only withdrawn from staking. See ORDER NO. W. 12/32- BLIND RIVER - NOV. 15/82.
- (S) S.R.O. withdrawn from staking. See ORDER # W. 16/82 BLIND RIVER - NOV. 15/82.

DATE OF ISSUE  
 FEB 27 1980  
 SURVEYS AND MAPPING  
 BRANCH

LEGEND

- |                                  |            |
|----------------------------------|------------|
| PATENTED LAND                    | (P) or (S) |
| PATENTED FOR SURFACE RIGHTS ONLY | (L)        |
| LEASE                            | (L)        |
| LICENSE OF OCCUPATION            | (L.O.)     |
| CROWN LAND SALES                 | (C.S.)     |
| LOCATED LAND                     | (Loc)      |
| CANCELLED                        | (C)        |
| MINING RIGHTS ONLY               | (M.R.O.)   |
| SURFACE RIGHTS ONLY              | (S.R.O.)   |
| HIGHWAY & ROUTE NO               | (17)       |
| ROADS                            | (—)        |
| TRAILS                           | (—)        |
| RAILWAYS                         | (—)        |
| POWER LINES                      | (—)        |
| MARSH OR MUSKOG                  | (—)        |
| MINES                            | (—)        |

\* used only with summer resort locations or when space is limited.

TOWNSHIP OF  
**MAECK**  
 (TP. 5E)  
 DISTRICT OF  
 ALGOMA

SAULT STE. MARIE  
 MINING DIVISION

SCALE : 1 INCH = 40 CHAINS (1/2 MILE)

DR. D.J.P. KAVANAGH  
 DATE 9-11-1970  
 PLAN NO. **M.1996**

ONTARIO  
 MINISTRY OF NATURAL RESOURCES  
 SURVEYS AND MAPPING BRANCH

ROLLINS TP M.1398

*Replaced by mylar May 25/84*

**G.3299**

JESSIMAN TP. M.1996

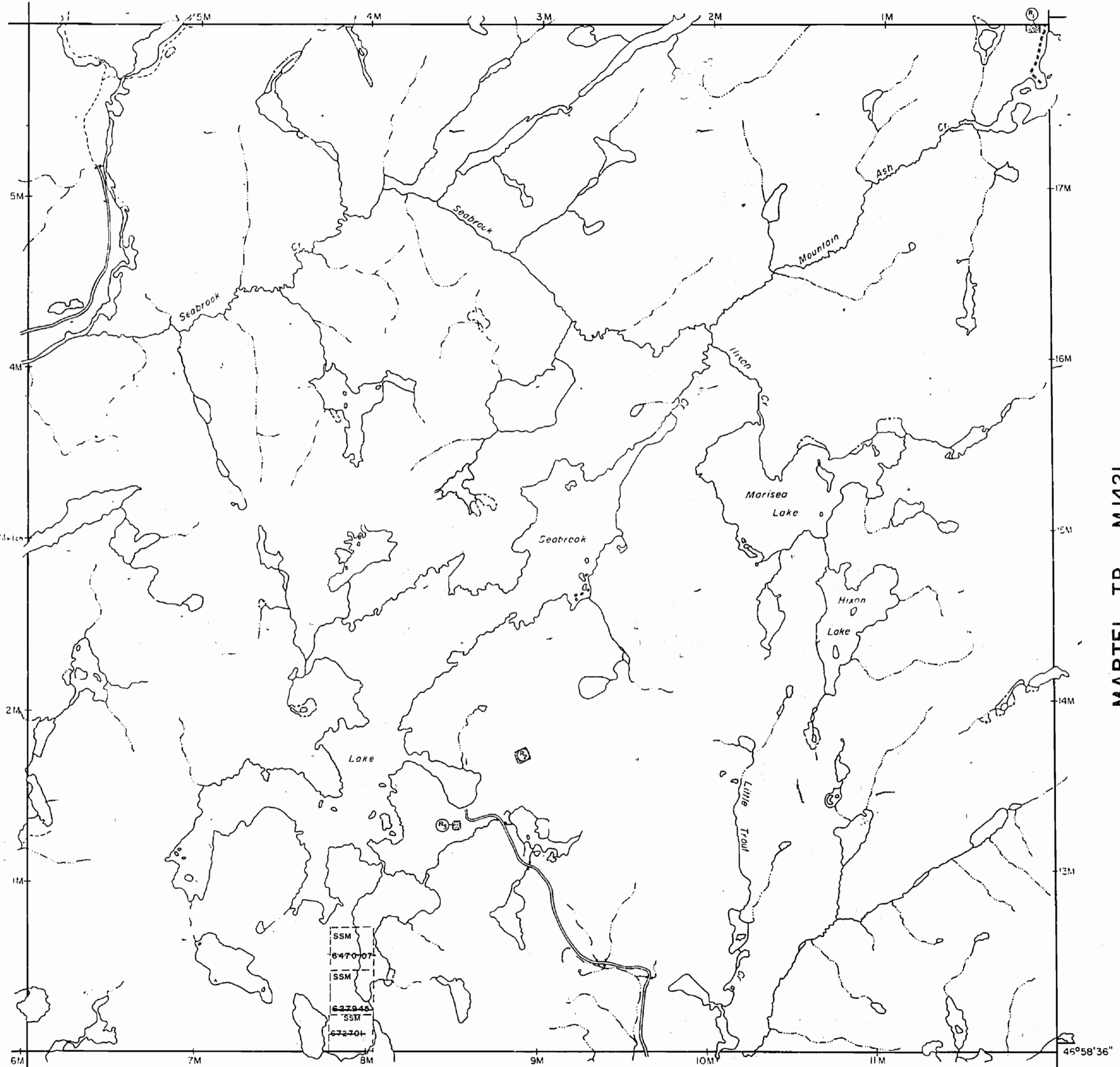

ROLLINS TP. M.1398

NOTES

400' surface rights reservation along the shores of all lakes and rivers.

AREAS WITHDRAWN FROM DISPOSITION

S.R. - SURFACE RIGHTS		M.R. - MINING RIGHTS		
Description	Order No.	Date	Disposition	File
(1) SEC. 36/80	W.8/82	15/11/82	S.R.	188505
(2) SEC. 36/80	W.12/82	15/11/82	S.R.	188505
(3) SEC. 36/80	W.16/82	15/11/82	S.R.	188505

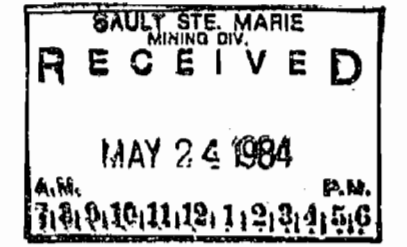

LEGEND

- PATENTED LAND (P) or (S)
- PATENTED FOR SURFACE RIGHTS ONLY (L)
- LEASE (LO)
- LICENSE OF OCCUPATION (CS)
- CROWN LAND SALE (Loc)
- DECATED LAND (C)
- CANCELLED (MRO)
- MINING RIGHTS ONLY (SRO)
- SURFACE RIGHTS ONLY (17)
- HIGHWAY & ROUTE NO. ROADS (17)
- TRAILS (---)
- RAILWAYS (---)
- POWER LINES (---)
- MARSH OR MUSKEG (---)
- MINES (X)

(P) used only with summer resort locations or when space is limited

TOWNSHIP OF  
**MAECK**  
TP. 5E  
DISTRICT OF ALGOMA

SAULT STE. MARIE  
MINING DIVISION

SCALE: 1 INCH = 40 CHAINS (1/2 MILE)

DR. D.J.F. KAVANAGH  
DATE 9/1/1970  
PLAN NO. **M.1422**

ONTARIO  
MINISTRY OF NATURAL RESOURCES  
SURVEYS AND MAPPING BRANCH

Replaced by G.3299 June 13/86 ml.

**G.3299**

TWP 6E-M.1996

NOTES

400' surface rights reservation along the shores of all lakes and rivers.

TWP 5F-M.1423

TWP 5D-M.1421

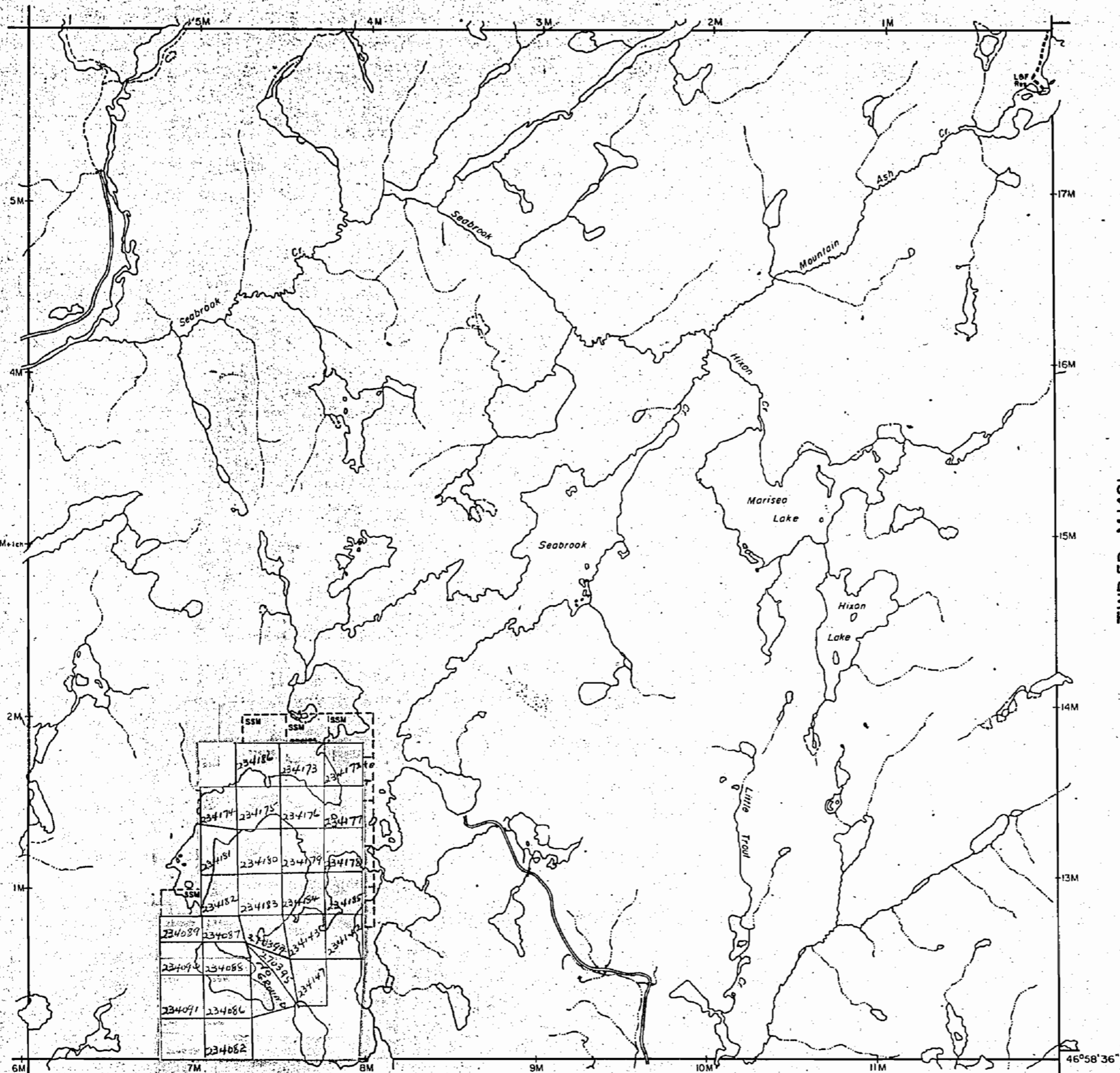

LEGEND

- PATENTED LAND
  - PATENTED FOR SURFACE RIGHTS ONLY
  - LEASE
  - LICENSE OF OCCUPATION
  - CROWN LAND SALES
  - LOCATED LAND
  - CANCELLED
  - MINING RIGHTS ONLY
  - SURFACE RIGHTS ONLY
  - HIGHWAY B ROUTE NO.
  - ROADS
  - TRAILS
  - RAILWAYS
  - POWER LINES
  - MARSH OR MUSKEG
  - MINES
- ⊙ used only with summer resort locations or when space is limited

TOWNSHIP OF

**5E** (MAECK)

DISTRICT OF  
ALGOMA

SAULT STE. MARIE  
MINING DIVISION

SCALE : 1 INCH = 40 CHAINS (1/2 MILE)

DR. D.J.P. KAVANAGH  
DATE, 9-11-1970

PLAN NO. **M.1422**

TWP 4E-M.1398

ONTARIO  
DEPARTMENT OF MINES  
AND NORTHERN AFFAIRS

1422

PLAN OF  
**TWP. 5E.** (MAECK)

m. 14/22

MISSISSAGI PROVINCIAL FOREST.  
SAULT STE. MARIE MINING DIVISION.  
DISTRICT OF ALGOMA.

— Scale, 40 chains to an inch. —

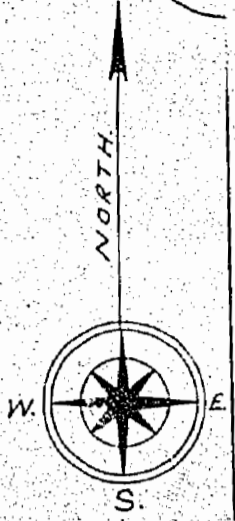

TWP. 6E.

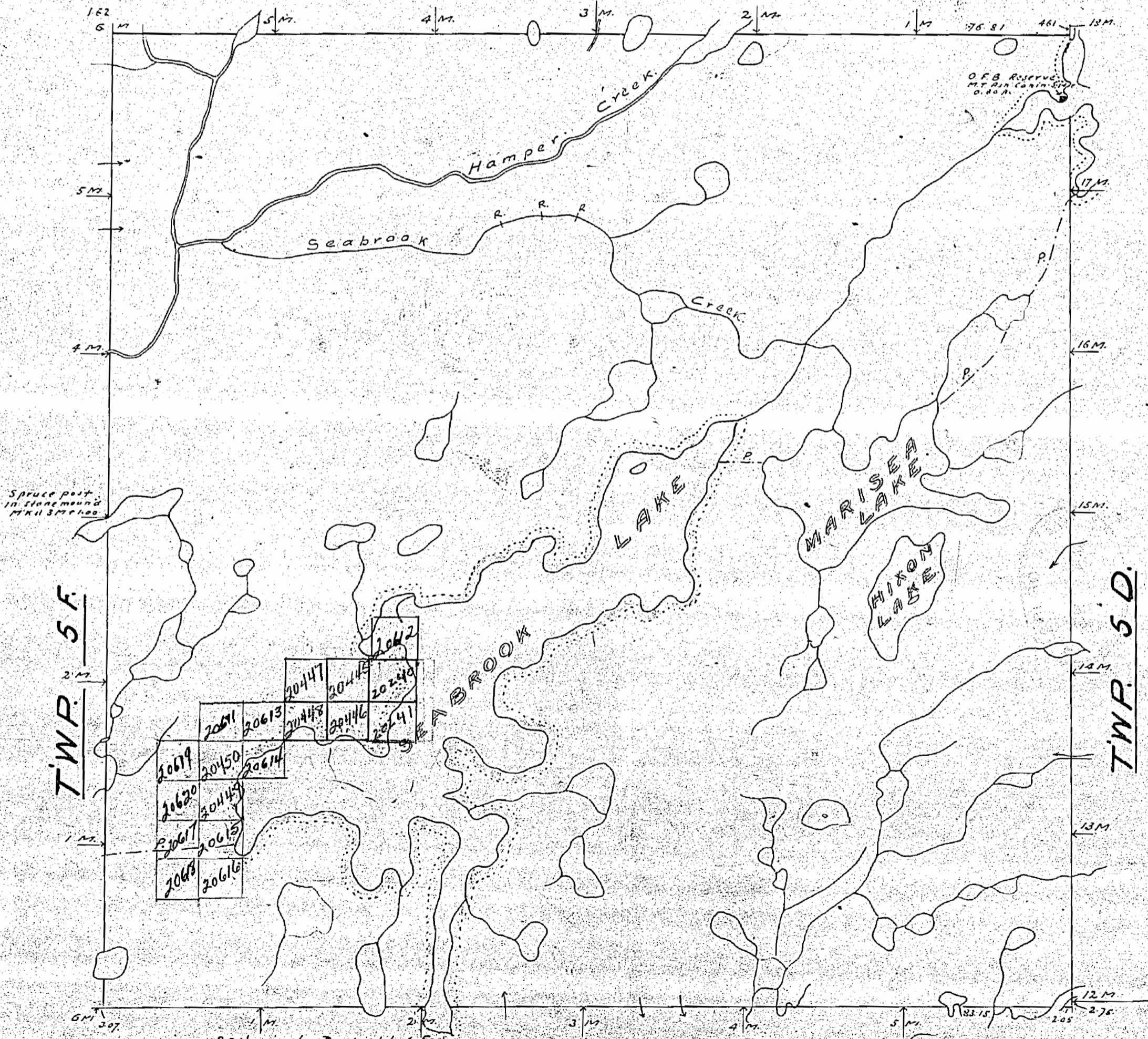

Spruce post  
in stone mound  
MK 11 3 M 1.00

TWP. 5F.

TWP. 5D.

Surface reservations 200' wide by Dept of L. & F.  
shown hereon thus

TWP. 4E.

1422

# PLAN OF TWP. 5E. (MAECK)

## MISSISSAGI PROVINCIAL FOREST. SAULT STE. MARIE MINING DIVISION. DISTRICT OF ALGOMA.

Scale, 40 chains to an inch.

M 1422

### OFFICE MAP

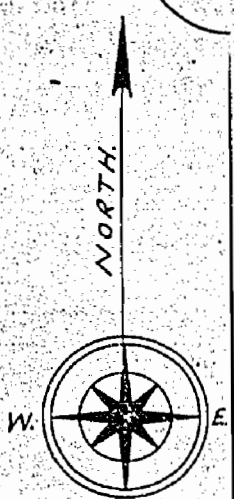

TWP. 6E.

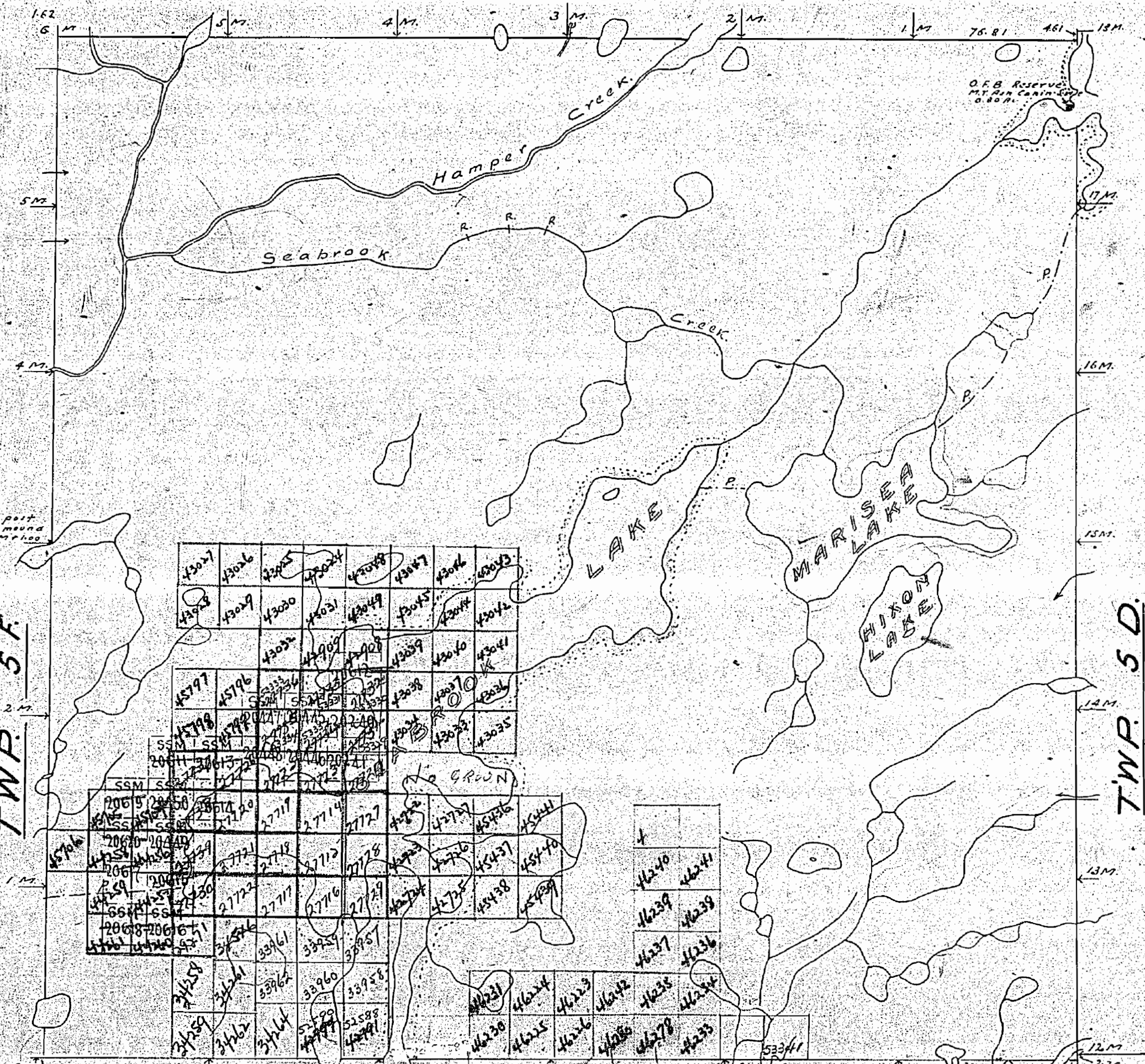

Spruce post  
in stone mound  
MK 11 37 100

O.F.B. Reserve  
Mt. Ash Canin  
0.8071

43027	43026	43025	43024	43023	43022	43021	43020
43028	43029	43030	43031	43032	43033	43034	43035
43036	43037	43038	43039	43040	43041	43042	43043
43044	43045	43046	43047	43048	43049	43050	43051
43052	43053	43054	43055	43056	43057	43058	43059
43060	43061	43062	43063	43064	43065	43066	43067
43068	43069	43070	43071	43072	43073	43074	43075
43076	43077	43078	43079	43080	43081	43082	43083
43084	43085	43086	43087	43088	43089	43090	43091
43092	43093	43094	43095	43096	43097	43098	43099
43100	43101	43102	43103	43104	43105	43106	43107
43108	43109	43110	43111	43112	43113	43114	43115
43116	43117	43118	43119	43120	43121	43122	43123
43124	43125	43126	43127	43128	43129	43130	43131
43132	43133	43134	43135	43136	43137	43138	43139
43140	43141	43142	43143	43144	43145	43146	43147
43148	43149	43150	43151	43152	43153	43154	43155
43156	43157	43158	43159	43160	43161	43162	43163
43164	43165	43166	43167	43168	43169	43170	43171
43172	43173	43174	43175	43176	43177	43178	43179
43180	43181	43182	43183	43184	43185	43186	43187
43188	43189	43190	43191	43192	43193	43194	43195
43196	43197	43198	43199	43200	43201	43202	43203
43204	43205	43206	43207	43208	43209	43210	43211
43212	43213	43214	43215	43216	43217	43218	43219
43220	43221	43222	43223	43224	43225	43226	43227
43228	43229	43230	43231	43232	43233	43234	43235
43236	43237	43238	43239	43240	43241	43242	43243
43244	43245	43246	43247	43248	43249	43250	43251
43252	43253	43254	43255	43256	43257	43258	43259
43260	43261	43262	43263	43264	43265	43266	43267
43268	43269	43270	43271	43272	43273	43274	43275
43276	43277	43278	43279	43280	43281	43282	43283
43284	43285	43286	43287	43288	43289	43290	43291
43292	43293	43294	43295	43296	43297	43298	43299
43300	43301	43302	43303	43304	43305	43306	43307
43308	43309	43310	43311	43312	43313	43314	43315
43316	43317	43318	43319	43320	43321	43322	43323
43324	43325	43326	43327	43328	43329	43330	43331
43332	43333	43334	43335	43336	43337	43338	43339
43340	43341	43342	43343	43344	43345	43346	43347
43348	43349	43350	43351	43352	43353	43354	43355
43356	43357	43358	43359	43360	43361	43362	43363
43364	43365	43366	43367	43368	43369	43370	43371
43372	43373	43374	43375	43376	43377	43378	43379
43380	43381	43382	43383	43384	43385	43386	43387
43388	43389	43390	43391	43392	43393	43394	43395
43396	43397	43398	43399	43400	43401	43402	43403
43404	43405	43406	43407	43408	43409	43410	43411
43412	43413	43414	43415	43416	43417	43418	43419
43420	43421	43422	43423	43424	43425	43426	43427
43428	43429	43430	43431	43432	43433	43434	43435
43436	43437	43438	43439	43440	43441	43442	43443
43444	43445	43446	43447	43448	43449	43450	43451
43452	43453	43454	43455	43456	43457	43458	43459
43460	43461	43462	43463	43464	43465	43466	43467
43468	43469	43470	43471	43472	43473	43474	43475
43476	43477	43478	43479	43480	43481	43482	43483
43484	43485	43486	43487	43488	43489	43490	43491
43492	43493	43494	43495	43496	43497	43498	43499
43500	43501	43502	43503	43504	43505	43506	43507
43508	43509	43510	43511	43512	43513	43514	43515
43516	43517	43518	43519	43520	43521	43522	43523
43524	43525	43526	43527	43528	43529	43530	43531
43532	43533	43534	43535	43536	43537	43538	43539
43540	43541	43542	43543	43544	43545	43546	43547
43548	43549	43550	43551	43552	43553	43554	43555
43556	43557	43558	43559	43560	43561	43562	43563
43564	43565	43566	43567	43568	43569	43570	43571
43572	43573	43574	43575	43576	43577	43578	43579
43580	43581	43582	43583	43584	43585	43586	43587
43588	43589	43590	43591	43592	43593	43594	43595
43596	43597	43598	43599	43600	43601	43602	43603
43604	43605	43606	43607	43608	43609	43610	43611
43612	43613	43614	43615	43616	43617	43618	43619
43620	43621	43622	43623	43624	43625	43626	43627
43628	43629	43630	43631	43632	43633	43634	43635
43636	43637	43638	43639	43640	43641	43642	43643
43644	43645	43646	43647	43648	43649	43650	43651
43652	43653	43654	43655	43656	43657	43658	43659
43660	43661	43662	43663	43664	43665	43666	43667
43668	43669	43670	43671	43672	43673	43674	43675
43676	43677	43678	43679	43680	43681	43682	43683
43684	43685	43686	43687	43688	43689	43690	43691
43692	43693	43694	43695	43696	43697	43698	43699
43700	43701	43702	43703	43704	43705	43706	43707
43708	43709	43710	43711	43712	43713	43714	43715
43716	43717	43718	43719	43720	43721	43722	43723
43724	43725	43726	43727	43728	43729	43730	43731
43732	43733	43734	43735	43736	43737	43738	43739
43740	43741	43742	43743	43744	43745	43746	43747
43748	43749	43750	43751	43752	43753	43754	43755
43756	43757	43758	43759	43760	43761	43762	43763
43764	43765	43766	43767	43768	43769	43770	43771
43772	43773	43774	43775	43776	43777	43778	43779
43780	43781	43782	43783	43784	43785	43786	43787
43788	43789	43790	43791	43792	43793	43794	43795
43796	43797	43798	43799	43800	43801	43802	43803
43804	43805	43806	43807	43808	43809	43810	43811
43812	43813	43814	43815	43816	43817	43818	43819
43820	43821	43822	43823	43824	43825	43826	43827
43828	43829	43830	43831	43832	43833	43834	43835
43836	43837	43838	43839	43840	43841	43842	43843
43844	43845	43846	43847	43848	43849	43850	43851
43852	43853	43854	43855	43856	43857	43858	43859
43860	43861	43862	43863	43864	43865	43866	43867
43868	43869	43870	43871	43872	43873	43874	43875
43876	43877	43878	43879	43880	43881	43882	43883
43884	43885	43886	43887	43888	43889	43890	43891
43892	43893	43894	43895	43896	43897	43898	43899
43900	43901	43902	43903	43904	43905	43906	43907
43908	43909	43910	43911	43912	43913	43914	43915
43916	43917	43918	43919	43920	43921	43922	43923
43924	43925	43926	43927	43928	43929	43930	43931
43932	43933	43934	43935	43936	43937	43938	43939
43940	43941	43942	43943	43944	43945	43946	43947
43948	43949	43950	43951	43952	43953	43954	43955
43956	43957	43958	43959	43960	43961	43962	43963
43964	43965	43966	43967	43968	43969	43970	43971
43972	43973	43974	43975	43976	43977	43978	43979
43980	43981	43982	43983	43984	43985	43986	43987
43988	43989	43990	43991	43992	43993	43994	43995
43996	43997	43998	43999	44000	44001	44002	44003

Surface reservations 200 wide by Dept of L. & F. shown hereon thus

TWP. 4E.

reservations for summer resort locations



1422

M. 1422

# PLAN OF TWP. 5E. (MAECK)

MISSISSAGI PROVINCIAL FOREST.  
SAULT STE. MARIE MINING DIVISION.  
DISTRICT OF ALGOMA.

Scale, 40 chains to an inch.

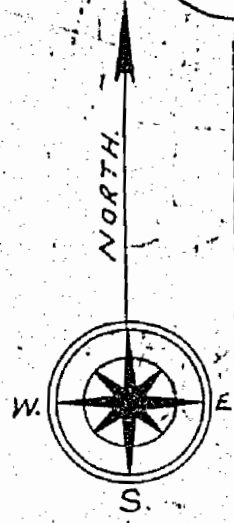

TWP. 6E.

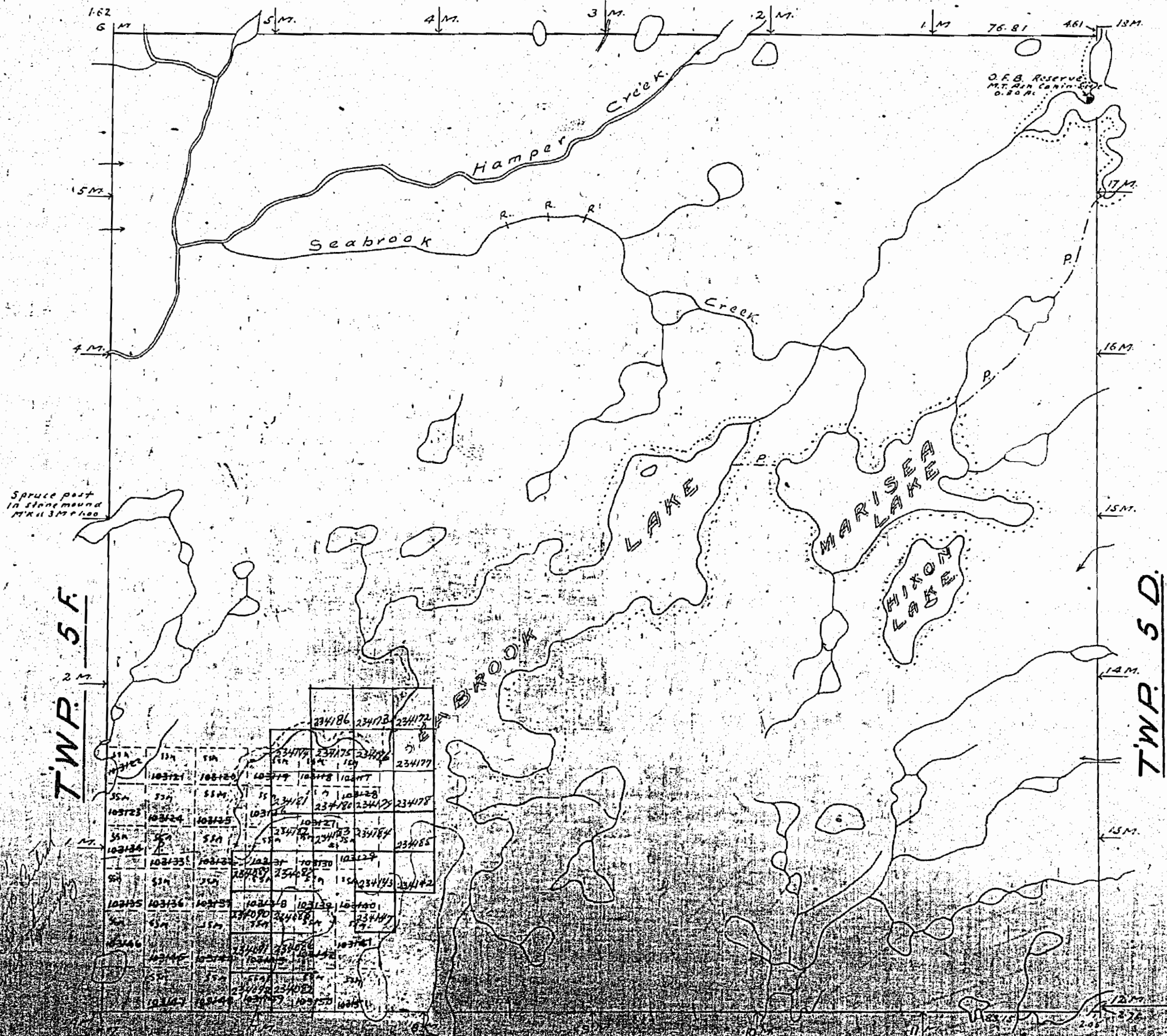

Spruce post  
in stone mound  
N. 11 3 1/2 1/2 1/2

TWP. 5F.

TWP. 5D.

103121	103122	103123	103124	103125	103126	103127	103128	103129	103130
103131	103132	103133	103134	103135	103136	103137	103138	103139	103140
103141	103142	103143	103144	103145	103146	103147	103148	103149	103150
103151	103152	103153	103154	103155	103156	103157	103158	103159	103160
103161	103162	103163	103164	103165	103166	103167	103168	103169	103170
103171	103172	103173	103174	103175	103176	103177	103178	103179	103180
103181	103182	103183	103184	103185	103186	103187	103188	103189	103190
103191	103192	103193	103194	103195	103196	103197	103198	103199	103200

100' BUFFER ZONE RESERVATION AROUND ALL LAKES



PLAN OF  
**TWP. 5E.** (MAECK)

MISSISSAGI PROVINCIAL FOREST.  
SAULT STE. MARIE MINING DIVISION.  
DISTRICT OF ALGOMA.

— Scale, 40 chains to an inch. — M. 14/22

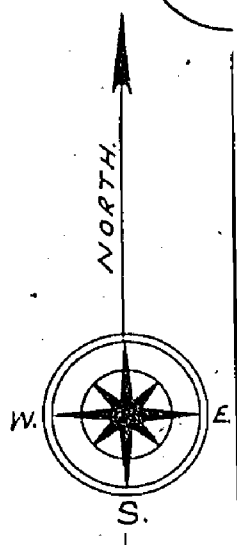

TWP. 6E.

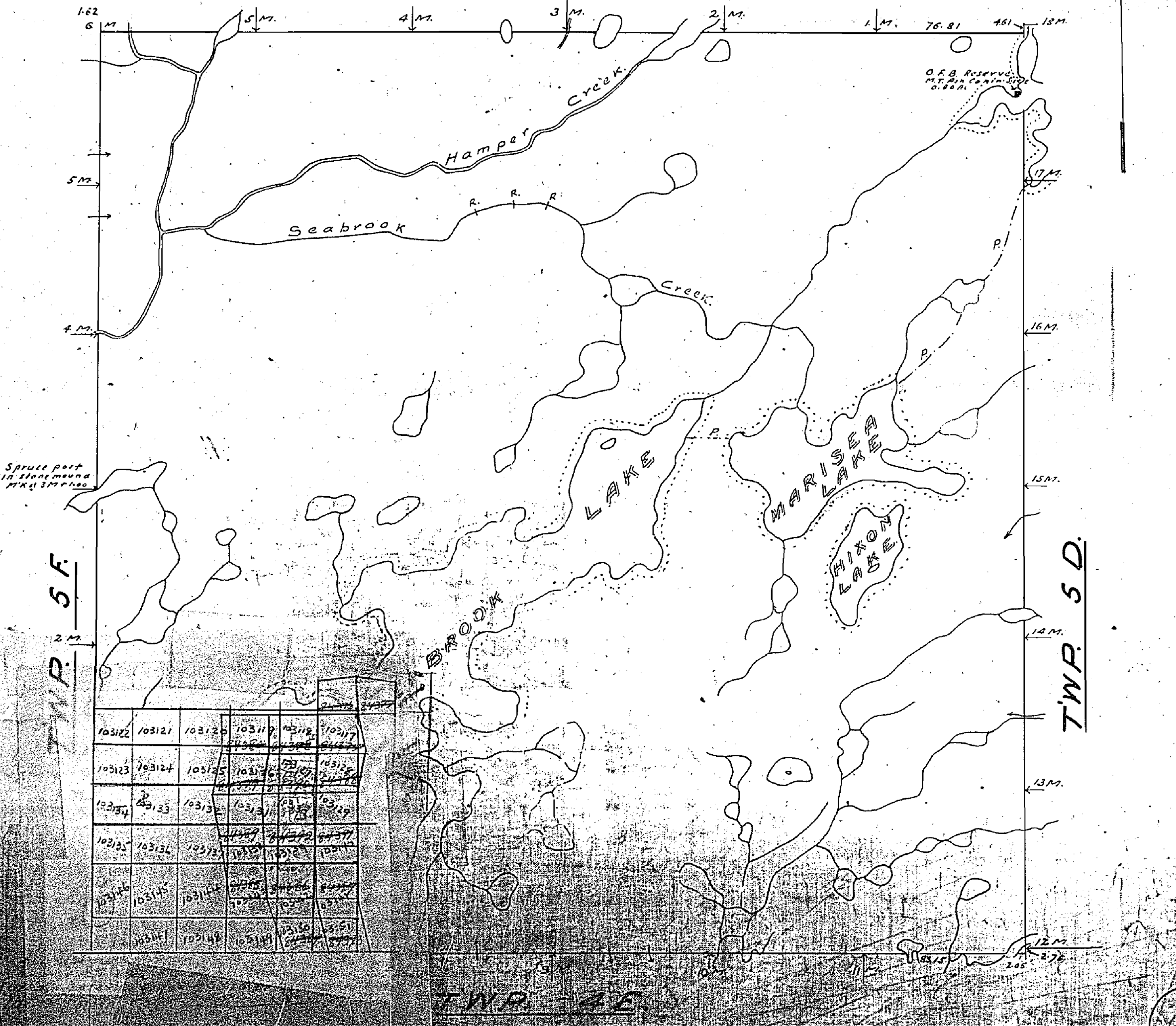

103122	103121	103120	103119	103118	103117
103123	103124	103125	103126	103127	103128
103129	103130	103131	103132	103133	103134
103135	103136	103137	103138	103139	103140
103141	103142	103143	103144	103145	103146
103147	103148	103149	103150	103151	103152

244  
5E  
08

Spruce point  
in stone mound  
N. 41. 377 P. 100

TWP. 5E

TWP. 5D

TWP. 4E

# PLAN OF TWP. 5E. (MAECK)

MISSISSAGI PROVINCIAL FOREST.  
SAULT STE. MARIE MINING DIVISION.  
DISTRICT OF ALGOMA.

Scale, 40 chains to an inch.

M. 1422

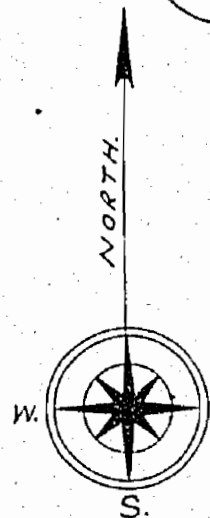

TWP. 6E.

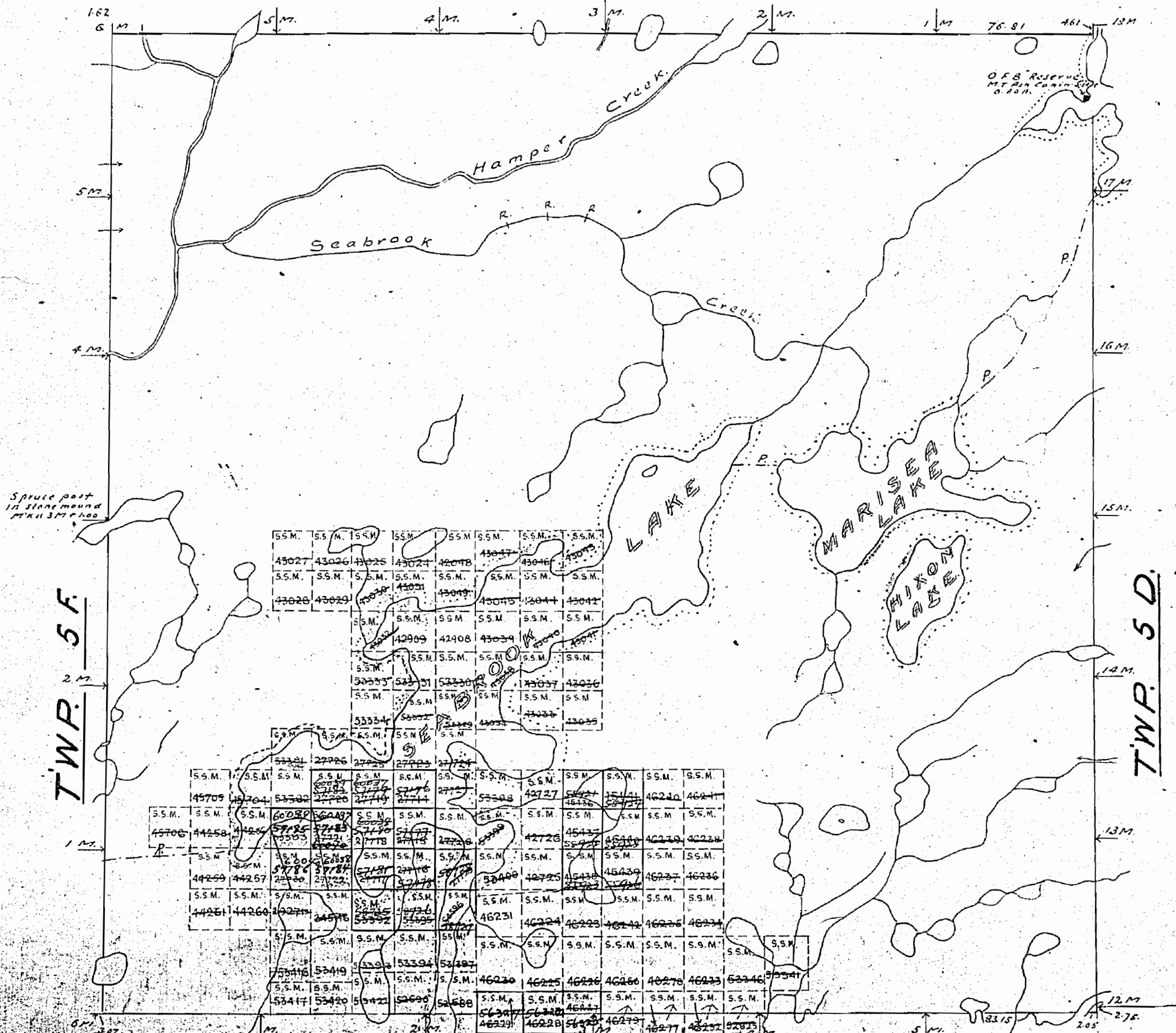

TWP. 4E.

Surface reservations 100 wide by Dept. of L. & F. shown hereon thus

1422

# PLAN OF TWP. 5E. (MAECK)

MISSISSAGI PROVINCIAL FOREST.  
SAULT STE. MARIE MINING DIVISION.  
DISTRICT OF ALGOMA.

Scale, 40 chains to an inch.

M. 1422

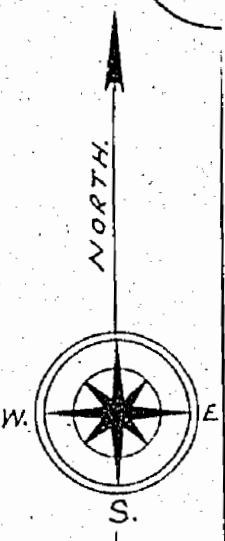

TWP. 6E.

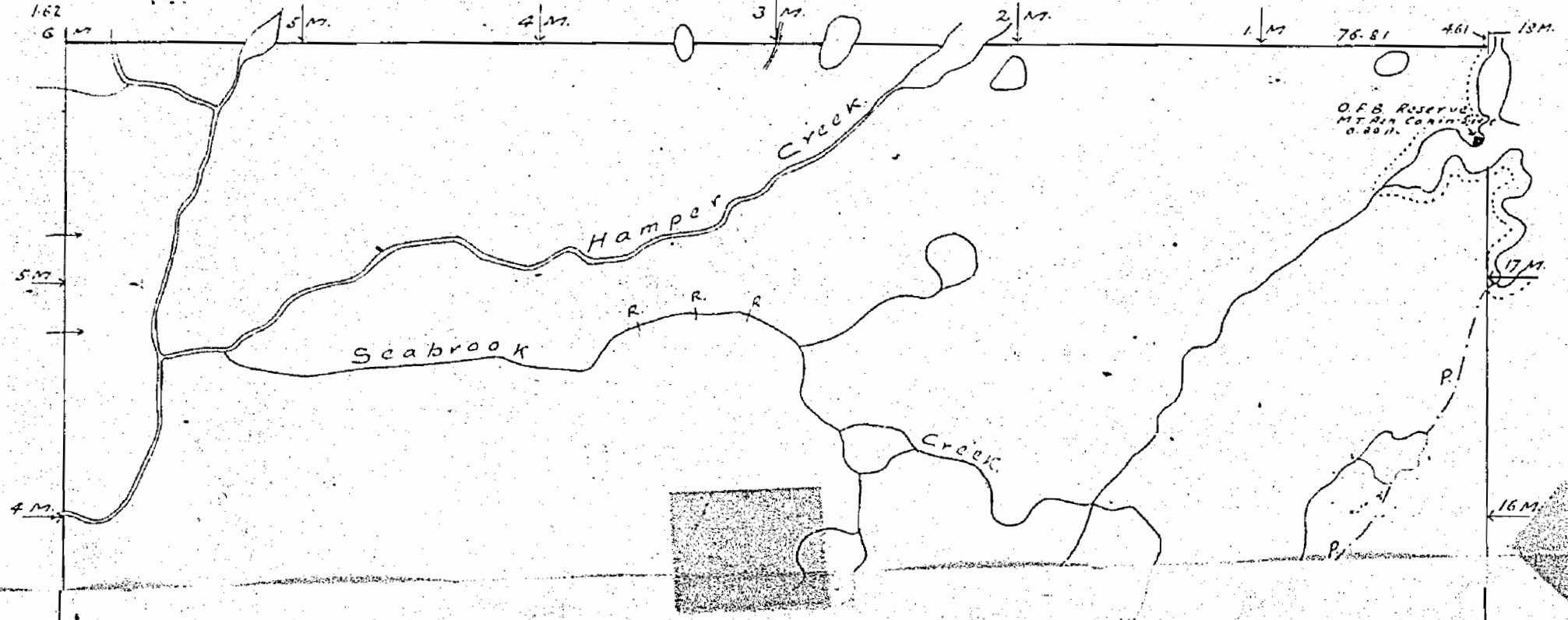

43027	43026	43025	43024	42048	43047	43046	43043
43028	43029	43030	43031	43049	43045	43044	43042
	43032	42909	42908	43039	43040	43041	
	53333	53331	53330	43038	43037	43036	
	53334	53332	53329	43034	43033	43035	
	53381	27726	27725	27723	27724		
45706	45705	45704	53382	27720	27719	27714	27727
	44258	44256	53383	27721	27718	27715	27728
	44259	44257	27720	27722	27717	27716	27729
	44261	44260	27721	34546	53392	53395	53396
		53416	53419	53393	53394	53397	
		53417	53420	53422	52590	52588	
					46230	46225	46226
					46229	46228	46227
						46224	46223
						46242	46235
						46237	46234
						45437	45440
						45436	45441
						46239	46240
						46238	46241
						46236	46239
						46235	46238
						46234	46237
						46233	46236
						55346	55341
						52925	

TWP. 6E-M.1996

TWP. 5F-M.1423

TWP. 5D - M.1421

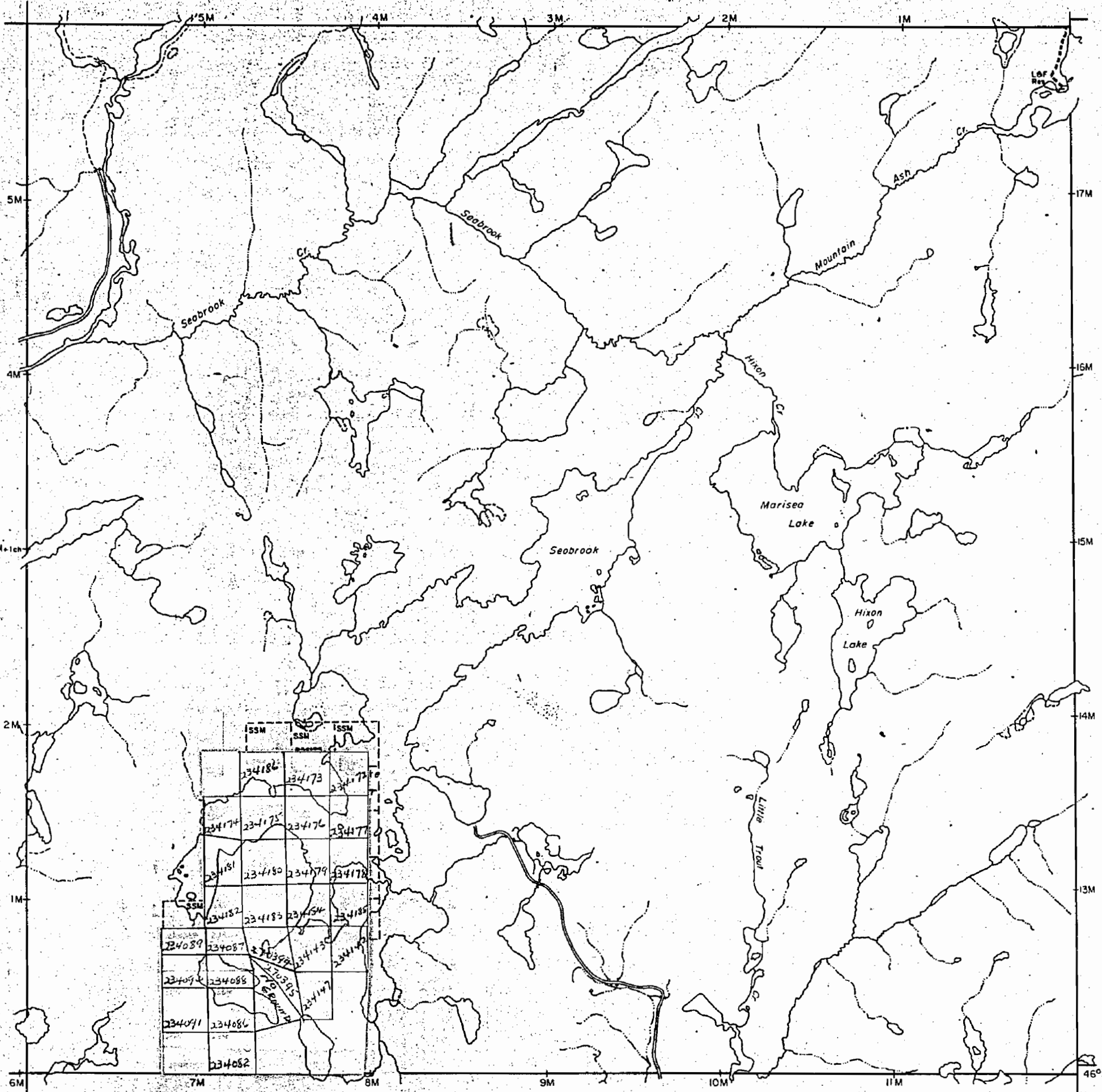

TWP. 4E-M.1398

**NOTES**

400' surface rights reservation along the shores of all lakes and rivers.

**LEGEND**

- PATENTED LAND (P) or (S)
  - PATENTED FOR SURFACE RIGHTS ONLY (SR)
  - LEASE (L)
  - LICENSE OF OCCUPATION (LO)
  - CROWN LAND SALES (CS)
  - LOCATED LAND (Loc)
  - CANCELLED (C)
  - MINING RIGHTS ONLY (MRO)
  - SURFACE RIGHTS ONLY (SRO)
  - HIGHWAY & ROUTE NO. (17)
  - ROADS (---)
  - TRAILS (---)
  - RAILWAYS (---)
  - POWER LINES (---)
  - MARSH OR MUSKEG (---)
  - MINES (X)
- ⊙ used only with summer resort locations or when space is limited

TOWNSHIP OF

**5E (MAECK)**

DISTRICT OF  
**ALGOMA**

**SAULT STE. MARIE**  
MINING DIVISION

SCALE : 1 INCH = 40 CHAINS (1/2 MILE)

DR. **D.J.P. KAVANAGH**  
DATE: 9-11-1970 PLAN NO. **M.1422**

**ONTARIO**  
DEPARTMENT OF MINES  
AND NORTHERN AFFAIRS

46°58'36"  
83°12'44" approx.

1422

M. 1422

# PLAN OF TWP. 5E. (MAECK)

## MISSISSAGI PROVINCIAL FOREST. SAULT STE. MARIE MINING DIVISION. DISTRICT OF ALGOMA.

Scale, 40 chains to an inch.

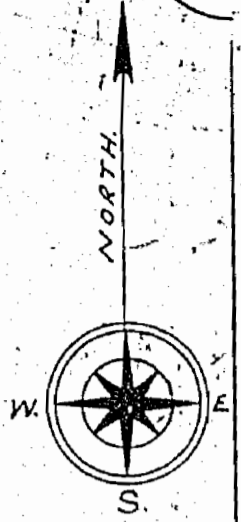

TWP. 6E.

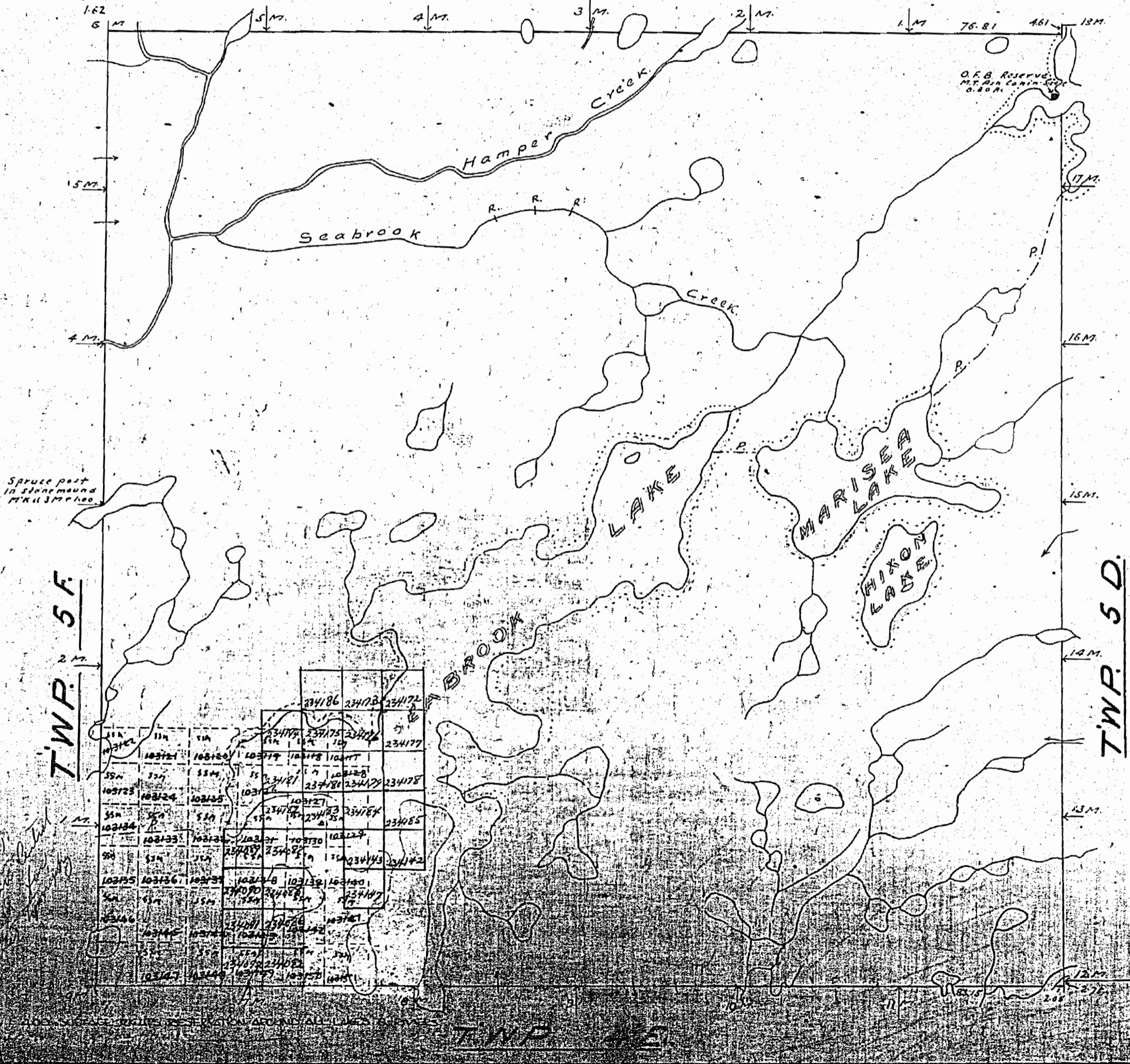

1422

# PLAN OF TWP. 5E.

(MAECK)  
m. 14/22

MISSISSAGI PROVINCIAL FOREST.  
SAULT STE. MARIE MINING DIVISION.  
DISTRICT OF ALGOMA.

Scale, 40 chains to an inch.

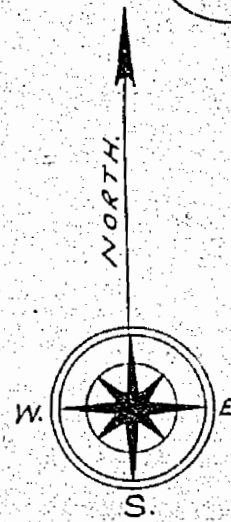

TWP. 6E.

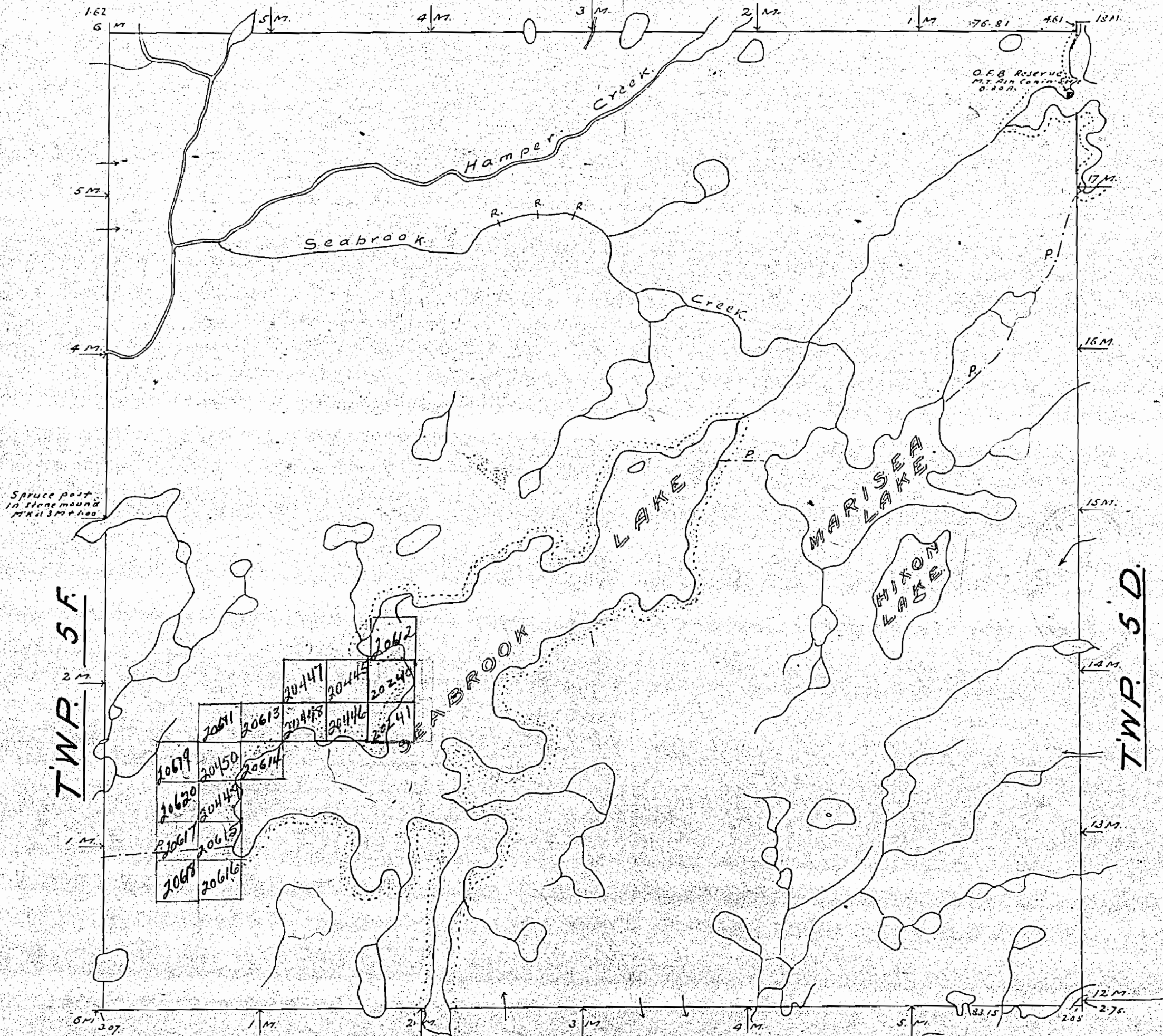

Spruce post  
in stone mound  
N.W. 1/4 3M + 100

TWP. 5F.

TWP. 5D.

TWP. 4E.

Surface reservations, 200' wide by Dept. of L. & F.  
shown hereon thus

1422

# PLAN OF TWP. 5E. (MAECK)

MISSISSAGI PROVINCIAL FOREST.  
SAULT STE. MARIE MINING DIVISION.  
DISTRICT OF ALGOMA.

Scale, 40 chains to an inch.

m. 1422

OFFICE MAP

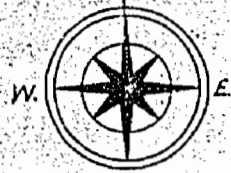

TWP. 6E.

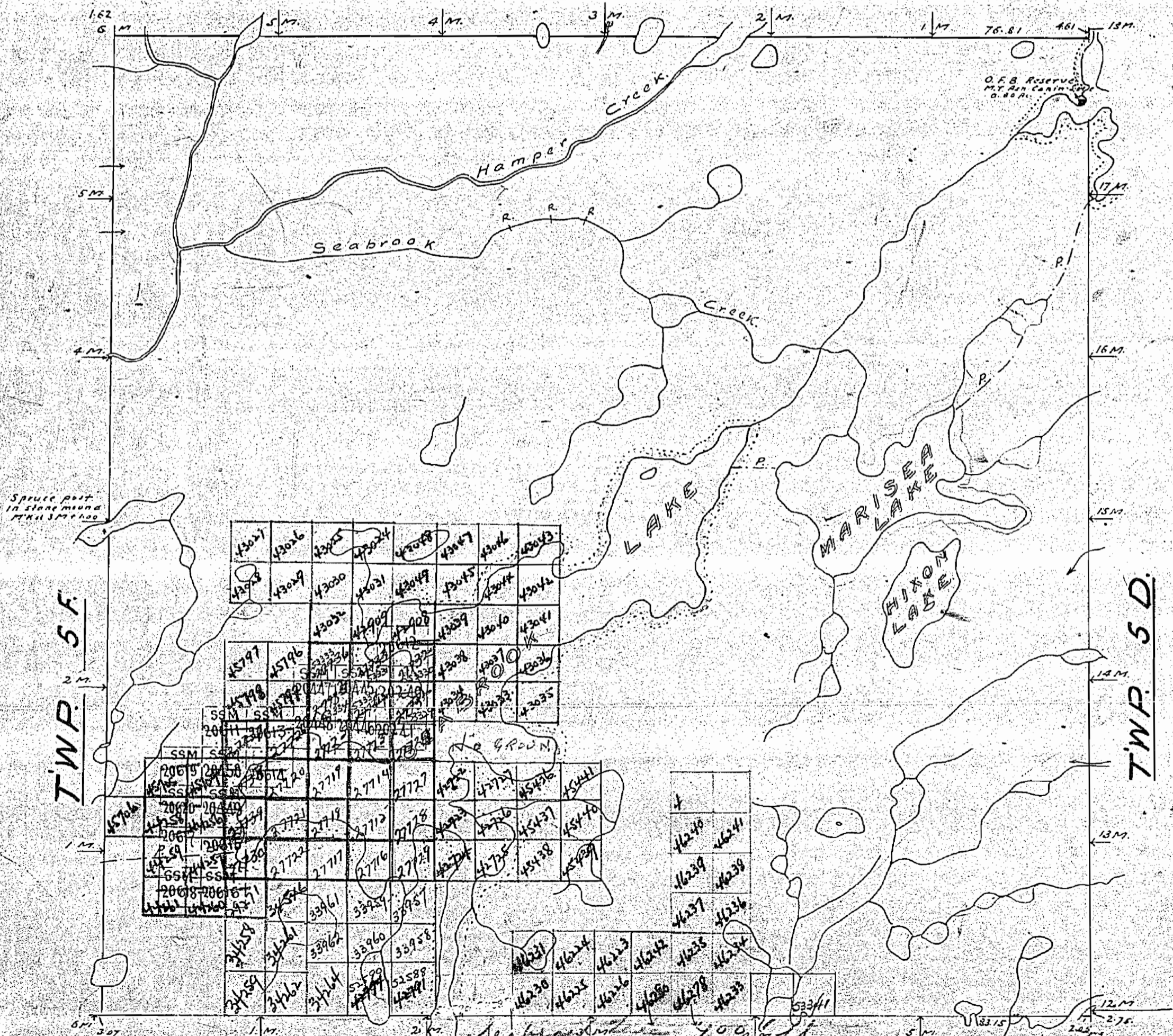

Surface reservations 200' wide by Dept. of L. & F. shown hereon thus

TWP. 4E.

Reservations shown hereon thus

**INDEX TO LAND DISPOSITION**

PLAN  
G-3299  
TOWNSHIP

**MAECK**

M.N.R. ADMINISTRATIVE DISTRICT  
**BLIND RIVER**  
MINING DIVISION  
**SAULT STE. MARIE**  
LAND TITLES/REGISTRY DIVISION  
**ALGOMA**

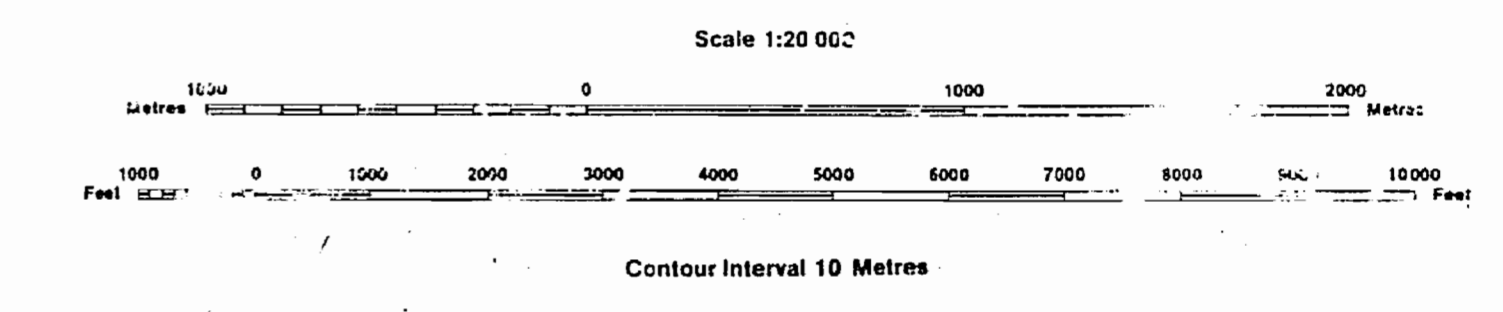

**SYMBOLS**

- Boundary
- Township, Meridian, Baseline
- Road allowance; surveyed shoreline
- Lot/Concession; surveyed unsurveyed
- Parcel; surveyed unsurveyed
- Right-of-way; road railway utility
- Reservation
- Cliff, Pt, Pile
- Contour
- Interpolated
- Approximate
- Depression
- Control point (horizontal)
- Flooded land
- Mine head frame
- Pipeline (above ground)
- Railway; single track double track abandoned
- Road; highway, county, township access trail, bush
- Shoreline (original)
- Transmission line
- Wooded area

**AREAS WITHDRAWN FROM DISPOSITION**

Description	Order No.	Date	Disposition	File
SEC. 36/80	W 8/82	15/11/82	S.R.O.	188505
SEC. 36/80	W 12/82	15/11/82	S.R.O.	188502
SEC. 36/80	W 16/82	15/11/82	S.R.O.	188505

**DISPOSITION OF CROWN LANDS**

- Patent
- Surface & Mining Rights
- Surface Rights Only
- Mining Rights Only
- Lease
- Surface & Mining Rights
- Surface Rights Only
- Mining Rights Only
- Licence of Occupation
- Order-in-Council
- Cancelled
- Reservation
- Sand & Gravel

The 1975 Magnetic Bearing  
Approx. 62W Annual Change  
Decreasing 21'

THE INFORMATION THAT APPEARS ON THIS MAP HAS BEEN COMPILED FROM VARIOUS SOURCES AND ACCURACY IS NOT GUARANTEED. THOSE WISHING TO STAKE MINING CLAIMS SHOULD CONSULT WITH THE MINING RECORDER, MINISTRY OF NORTHERN DEVELOPMENT AND MINES, FOR ADDITIONAL INFORMATION ON THE STATUS OF THE LANDS SHOWN HEREON.

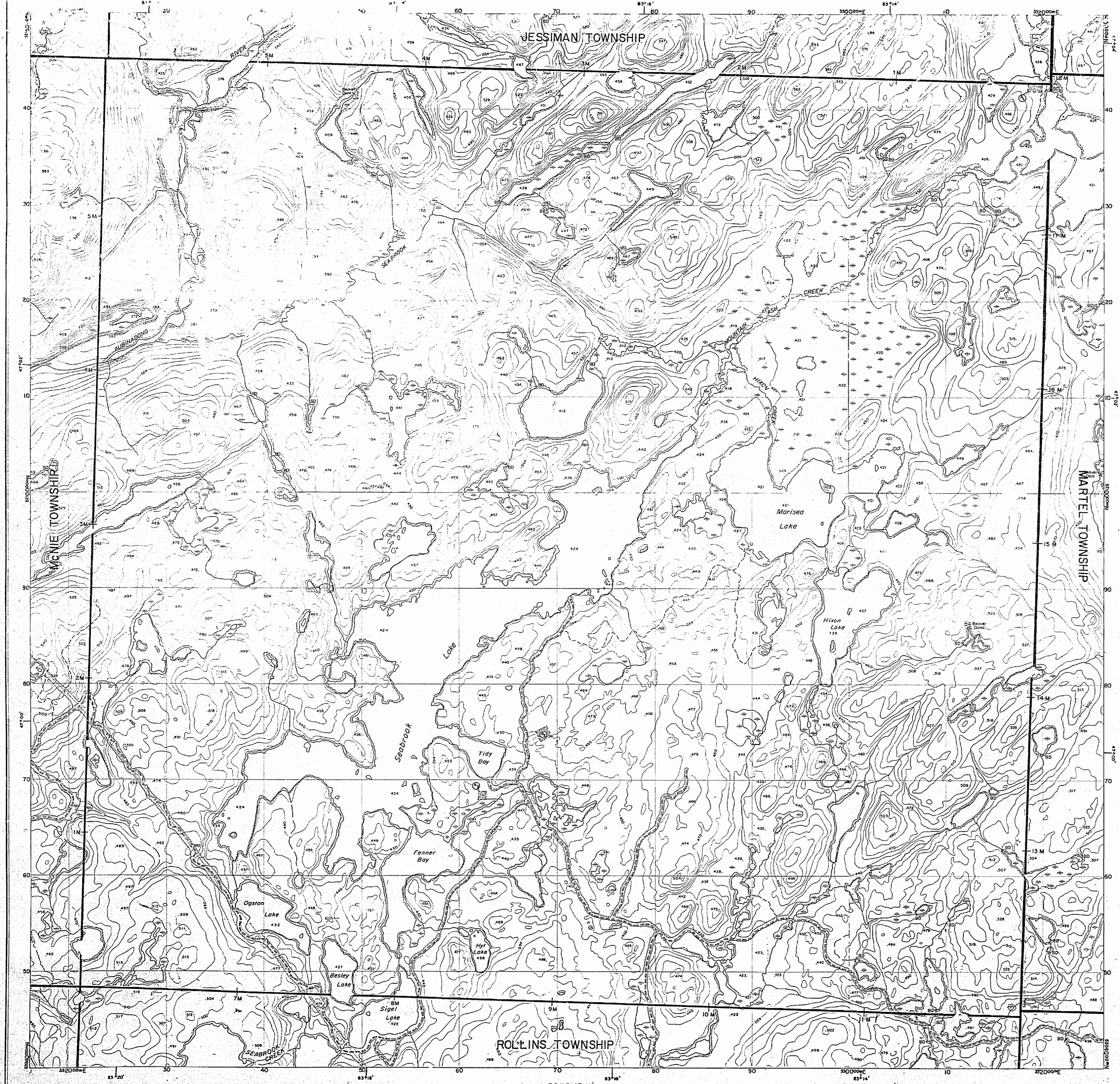
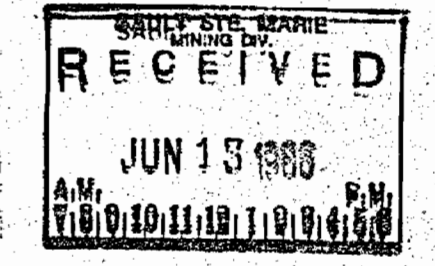

WMECK T.M.P.

G-3588





# PLAN OF TWP. 5E. (MAECK)

MISSISSAGI PROVINCIAL FOREST.  
SAULT STE. MARIE MINING DIVISION.  
DISTRICT OF ALGOMA.

Scale, 40 chains to an inch. M. 1422

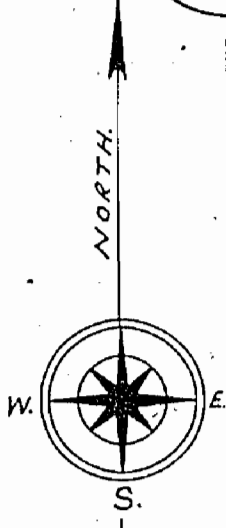

TWP. 6E.

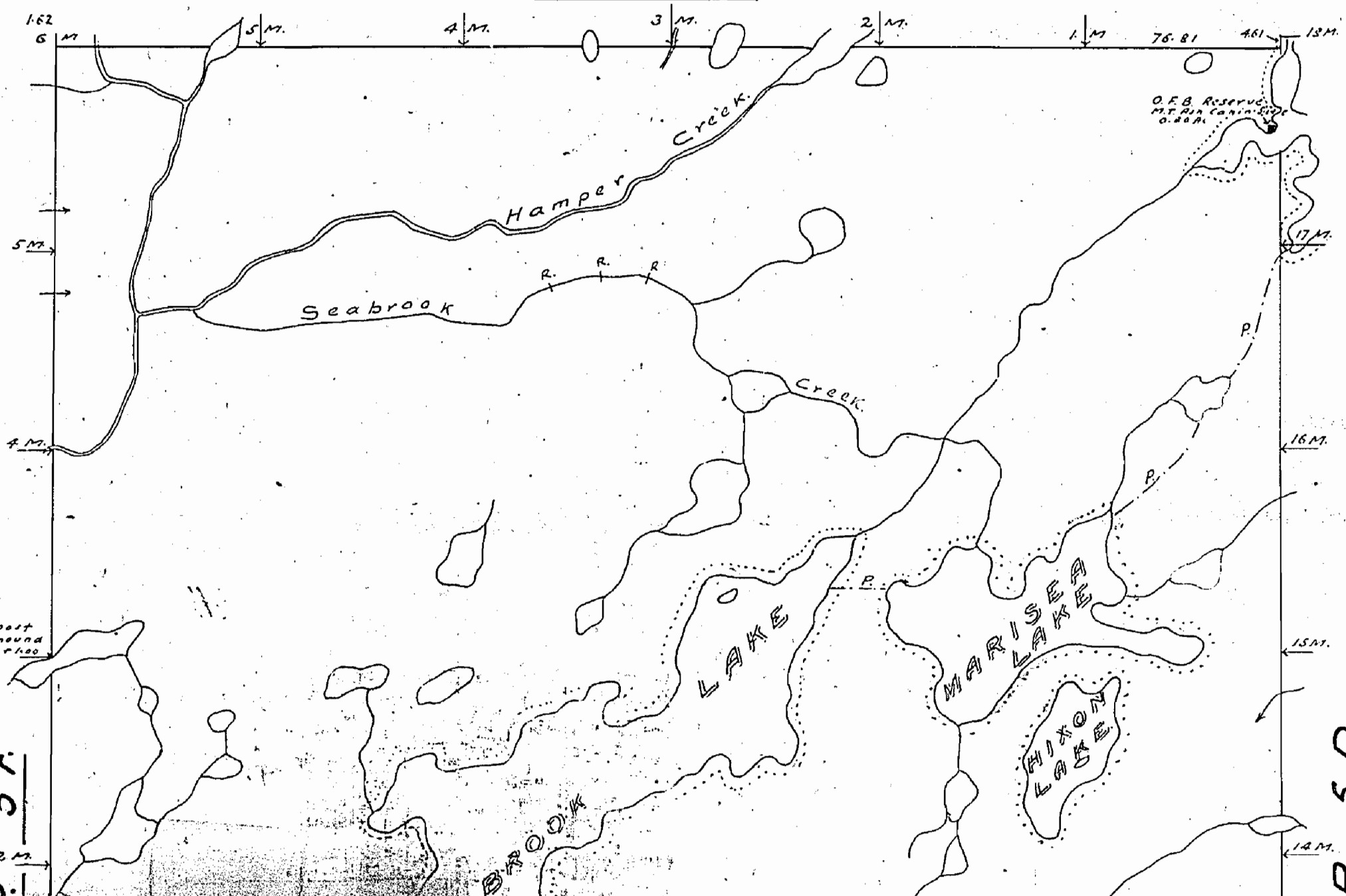

103122	103121	103120	103119	103118	103117
103123	103124	103125	103126	103127	103128
103124	103133	103132	103131	103130	103129
103135	103136	103137	103138	103139	103140
103146	103145	103144	103143	103142	103141
103147	103148	103149	103150	103151	103152

TWP. 4E.