

STAUNTON TWP. M-1126

BARKER TWP. M-649

THE TOWNSHIP OF

MAGLADERY

DISTRICT OF COCHRANE

PORCUPINE MINING DIVISION

SCALE: 1-INCH = 40 CHAINS

LEGEND

PATENTED LAND	Ⓟ
CROWN LAND SALE	C.S.
LEASES	Ⓛ
LOCATED LAND	Loc.
LICENSE OF OCCUPATION	L.O.
MINING RIGHTS ONLY	M.R.O.
SURFACE RIGHTS ONLY	S.R.O.
ROADS	—
IMPROVED ROADS	—
KING'S HIGHWAYS	—
RAILWAYS	—
POWER LINES	—
MARSH OR MUSKEG	—
MINES	X
CANCELLED	C.

NOTES

400' surface rights reservation along the shores of all lakes and rivers.

ALL THIS TWP. PATENTED FOR S.R.O.

Areas withdrawn from staking under Section 42 of the Mining Act.

File	Date	Disposition
42 a 183199	OCT. 6, 70.	SK. & MR.

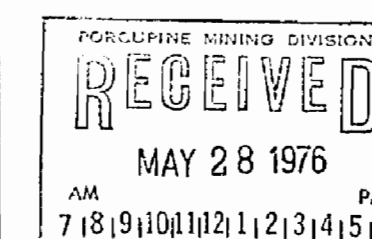

PLAN NO.- M-846

ONTARIO
MINISTRY OF NATURAL RESOURCES
SURVEYS AND MAPPING BRANCH

ORKNEY TWP. M-1324

SHEARER TWP. M-1108

RYKERT TWP. M-1083

49°19'10" APPROX.
83°13'20"

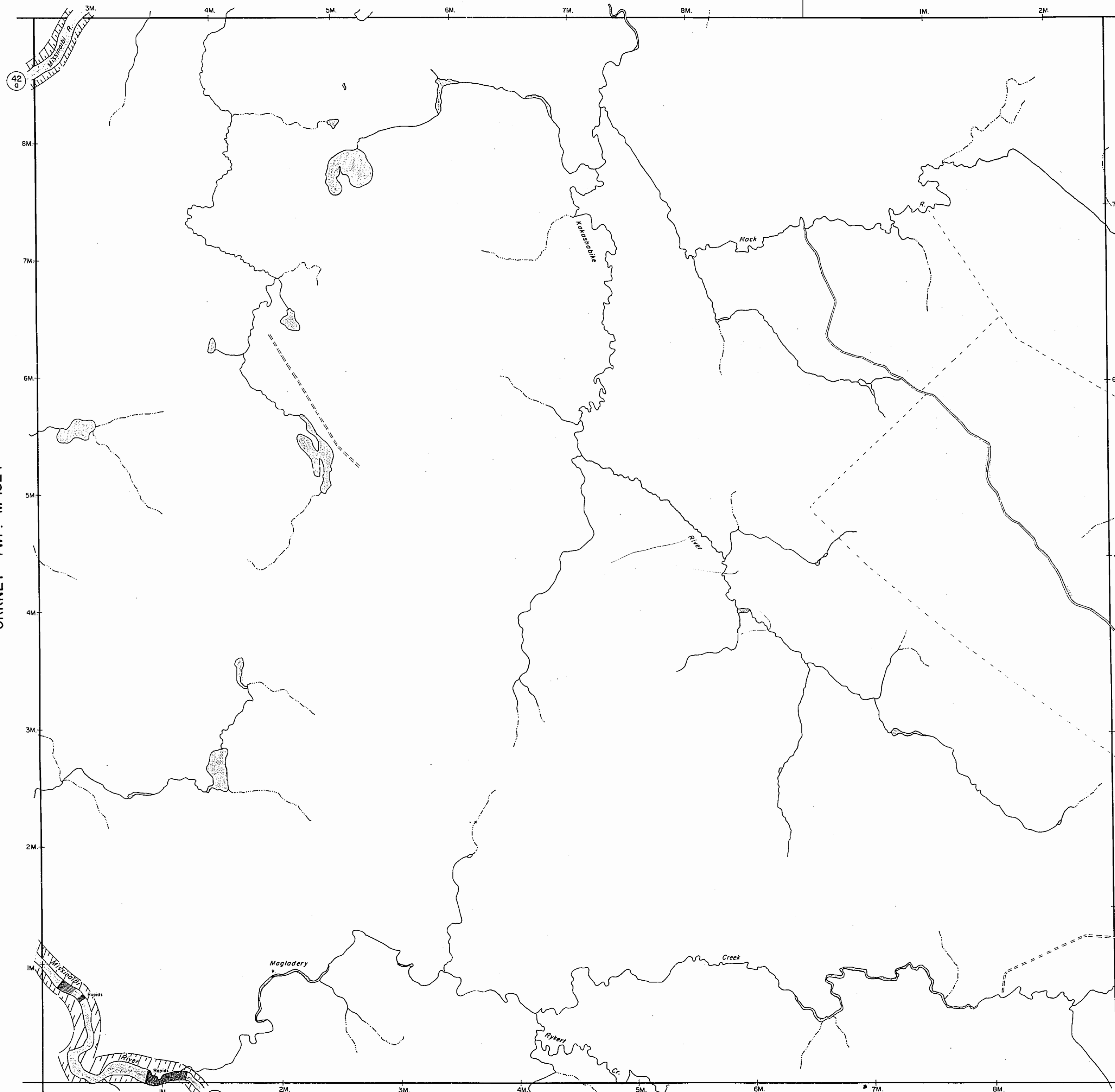

STAUNTON TWP. M-1126

BARKER TWP. M-649

THE TOWNSHIP OF

MAGLADERY

DISTRICT OF COCHRANE

PORCUPINE MINING DIVISION

SCALE: 1-INCH = 40 CHAINS

LEGEND

PATENTED LAND	⊙
CROWN LAND SALE	C.S.
LEASES	⊕
LOCATED LAND	Loc.
LICENSE OF OCCUPATION	L.O.
MINING RIGHTS ONLY	M.R.O.
SURFACE RIGHTS ONLY	S.R.O.
ROADS	—
IMPROVED ROADS	—
KING'S HIGHWAYS	—
RAILWAYS	—
POWER LINES	—
MARSH OR MUSKEG	—
MINES	⋈
CANCELLED	C.

NOTES

400' surface rights reservation along the shores of all lakes and rivers.

ALL THIS TWP. PATENTED FOR S.R.O.

Areas withdrawn from staking under Section 42 of the Mining Act.

File	Date	Disposition
42 a	183199	OCT. 8, 70. SR. & MR.

Ⓡ PENDING APPLICATION UNDER THE PUBLIC LANDS ACT
DUCKS UNLIMITED NOTICE RECEIVED 90-JUL-12.

Ⓢ PROPOSED MISSISSAUGA PARK BOUNDARY EXPANSION
NOTICE RECEIVED JULY 4, 1991

MAP REPLACED JULY 13, 1992
BY D.C.

Received Apr 3/80

PLAN NO. **M-846**

ONTARIO
MINISTRY OF NATURAL RESOURCES
SURVEYS AND MAPPING BRANCH

ORKNEY TWP. M-1324

SHEARER TWP. M-1108

RYKERT TWP. M-1083

49°19'10"
83°13'20"
APPROX.

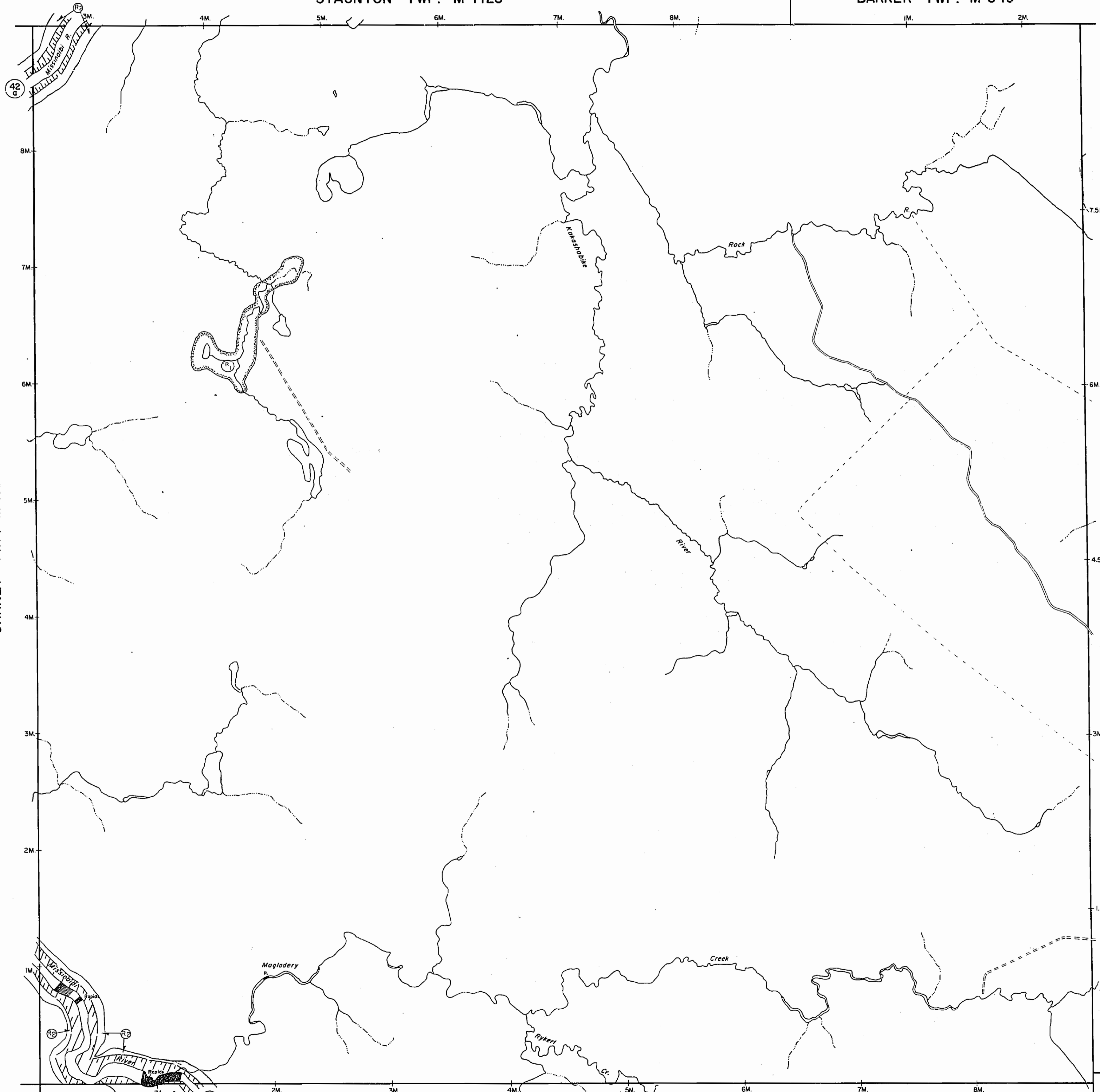

STAUNTON TWP.

BARKER TWP.

LEGEND

HIGHWAY AND ROUTE No.	
OTHER ROADS	
TRAILS	
SURVEYED LINES:	
TOWNSHIPS, BASE LINES, ETC.	
LOTS, MINING CLAIMS, PARCELS, ETC.	
UNSURVEYED LINES:	
LOT LINES	
PARCEL BOUNDARY	
MINING CLAIMS ETC.	
RAILWAY AND RIGHT OF WAY	
UTILITY LINES	
NON-PERENNIAL STREAM	
FLOODING OR FLOODING RIGHTS	
SUBDIVISION OR COMPOSITE PLAN	
RESERVATIONS	
ORIGINAL SHORELINE	
MARSH OR MUSKEG	
MINES	
TRAVERSE MONUMENT	



DISPOSITION OF CROWN LANDS

TYPE OF DOCUMENT	SYMBOL
PATENT, SURFACE & MINING RIGHTS	
" SURFACE RIGHTS ONLY	
" MINING RIGHTS ONLY	
LEASE, SURFACE & MINING RIGHTS	
" SURFACE RIGHTS ONLY	
" MINING RIGHTS ONLY	
LICENCE OF OCCUPATION	
ORDER-IN-COUNCIL	
RESERVATION	
CANCELLED	
SAND & GRAVEL	

THE INFORMATION THAT APPEARS ON THIS MAP HAS BEEN COMPILED FROM VARIOUS SOURCES, AND ACCURACY IS NOT GUARANTEED. THOSE WISHING TO STAKE MINING CLAIMS SHOULD CONSULT WITH THE MINING RECORDER, MINISTRY OF NORTHERN DEVELOPMENT AND MINES, FOR ADDITIONAL INFORMATION ON THE STATUS OF THE LANDS SHOWN HEREON.

SCALE: 1 INCH = 40 CHAINS

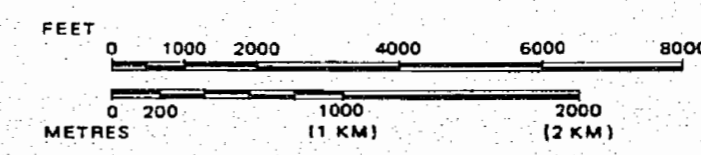

ALL THIS TWP. PATENTED FOR S.R.O.

Areas withdrawn from staking under Section 42 of the Mining Act

FILE	DATE	DISPOSITION
42 d	183199	OCT. 8/70 S.R. & M.R.

PENDING APPLICATION UNDER THE PUBLIC LANDS ACT DUCKS UNLIMITED. NOTICE RECEIVED 90-JUL-12.

PROPOSED MISSISSAUGA PARK BOUNDARY EXPANSION NOTICE RECEIVED JULY 4, 1991

MISSISSAUGA PROVINCIAL PARK

TOWNSHIP MAGLADERY

M.N.R. ADMINISTRATIVE DISTRICT HEARST

MINING DIVISION PORCUPINE

LAND TITLES / REGISTRY DIVISION COCHRANE

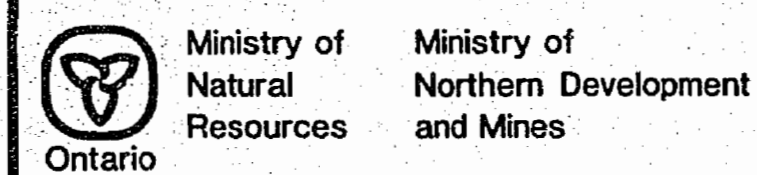

Date ACTIVATED JULY 13, 1992 BY D.C. CHECKED BY G.W.

Number G-901

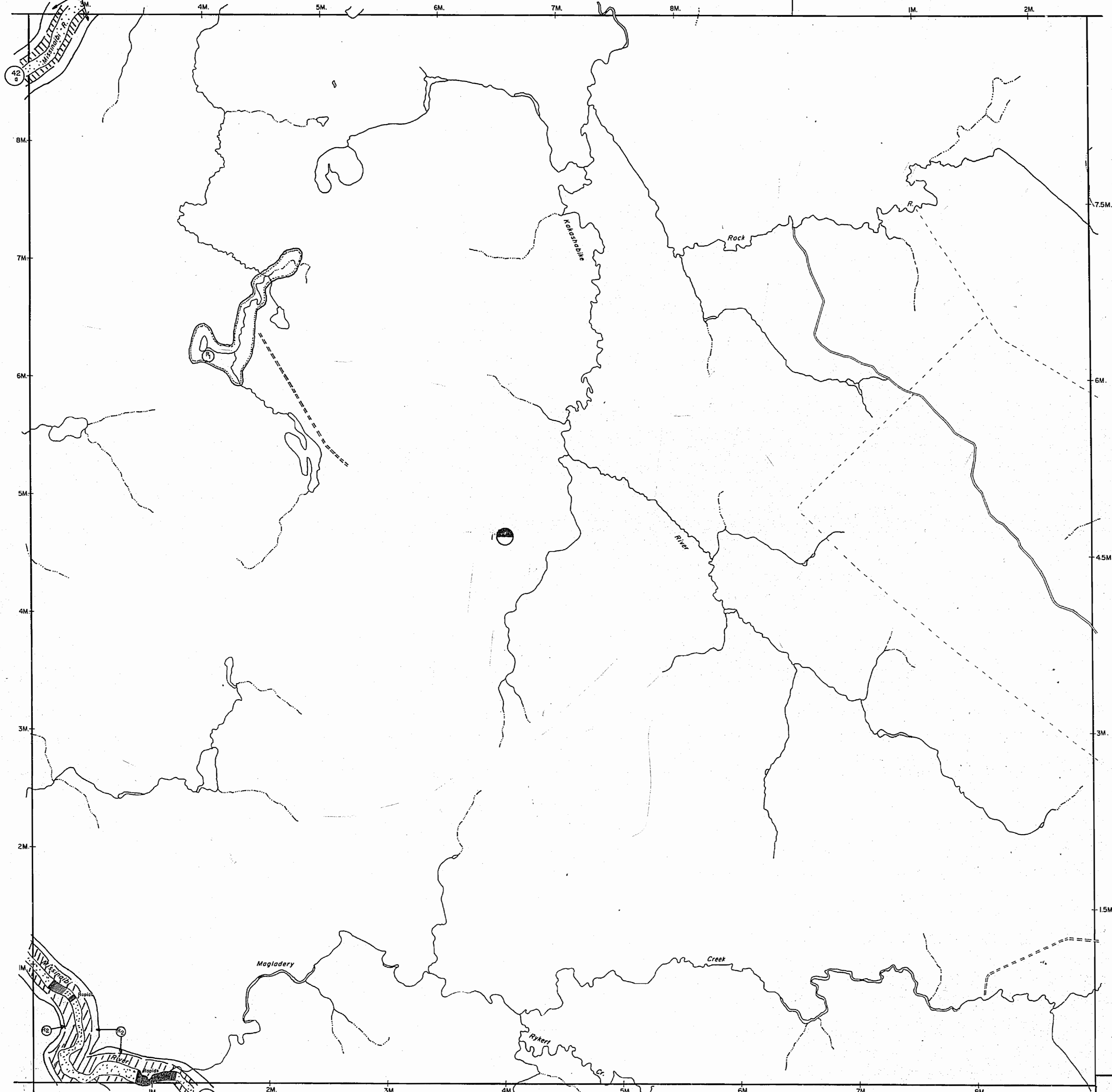

THE INFORMATION THAT APPEARS ON THIS MAP HAS BEEN COMPILED FROM VARIOUS SOURCES, AND ACCURACY IS NOT GUARANTEED. THOSE WISHING TO STAKE MINING CLAIMS SHOULD CONSULT WITH THE MINING RECORDER, MINISTRY OF NORTHERN DEVELOPMENT AND MINES, FOR ADDITIONAL INFORMATION ON THE STATUS OF THE LANDS SHOWN HEREON.

49° 19' 10" APPROX. 83° 13' 20"

846

M.846

PLAN OF MAGLADERY TWP.

PORCUPINE MINING DIVISION

DISTRICT OF COCHRANE.

Scale 40 chains to an inch.

PORCUPINE MINING DIVISION
RECEIVED
AUG 16 1971
AM 7 18 19 10 11 12 1 2 3 4 5 6

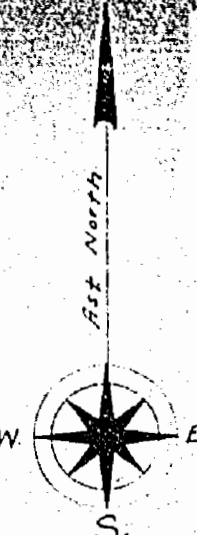

Areas withdrawn from staking under Section 42 of the Mining Act.

File	Date	Disposition
42 B319	1-1-8/70	SR & MR

NOTE
400' Surface Rights Reservation
around all Lakes and Rivers.

STAUNTON TWP.

BARKER TWP.

ORKNEY TWP.

SHEARER TWP.

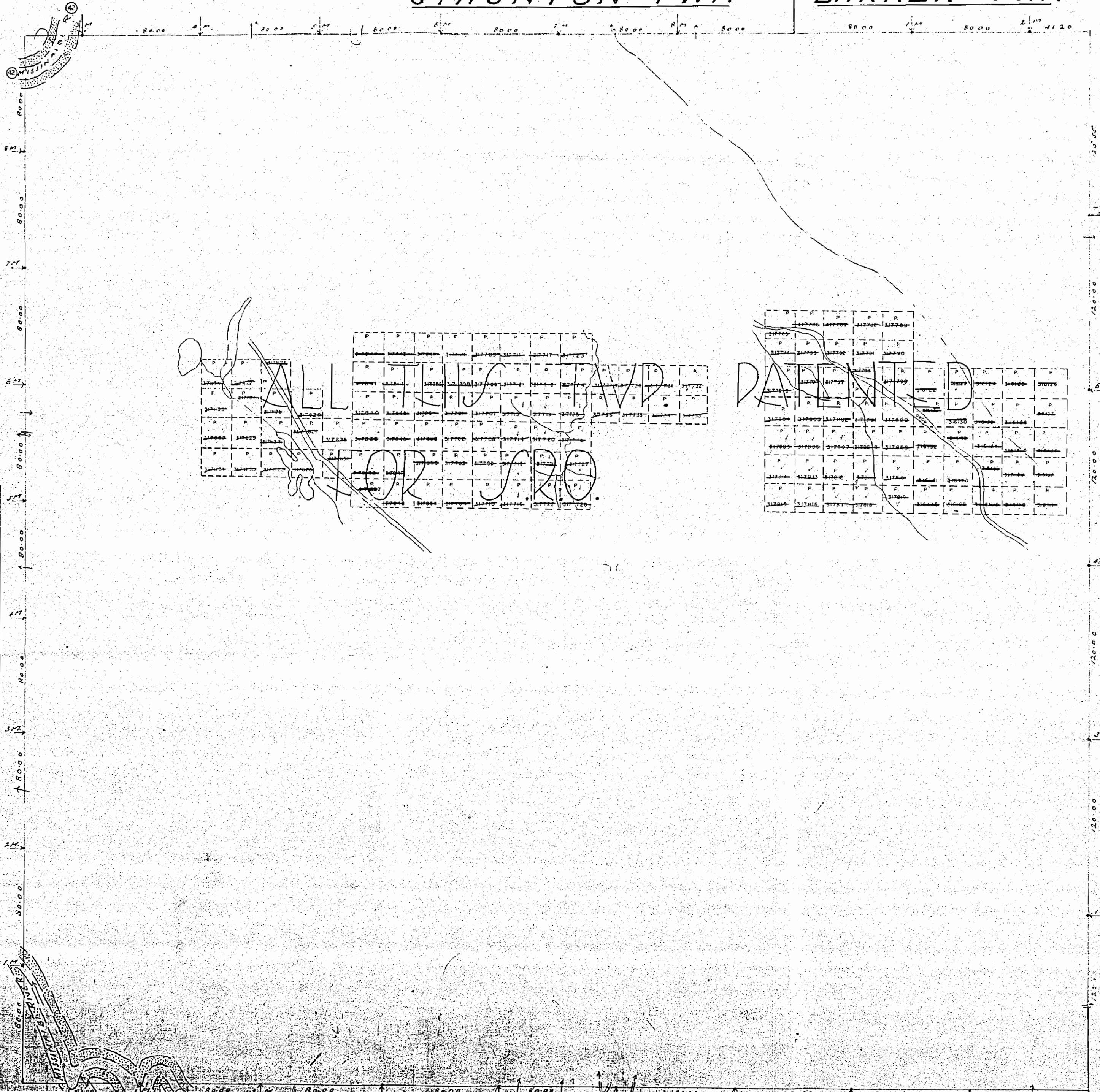

846

M.846

PLAN OF MAGLADERY TWP.

PORCUPINE MINING DIVISION

DISTRICT OF COCHRANE.

Scale 40 chains to an inch.

PORCUPINE MINING DIVISION
RECEIVED
 AUG 16 1971
 AM 7 18 9 10 11 12 1 2 3 4 5 6 PM

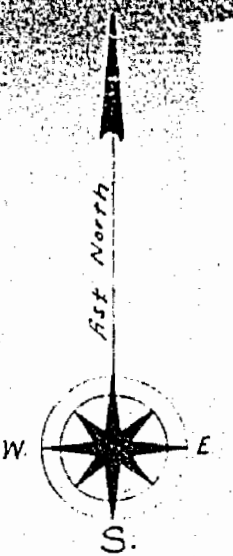

Areas withdrawn from staking under Section
 42 of the Mining Act.
 File 8339 Date Disposition
 8/70 SR & MR

NOTE
 400' Surface Rights Reservation
 around all Lakes and Rivers.

STAUNTON TWP.

BARKER TWP.

ORKNEY TWP.

SHEARER TWP.

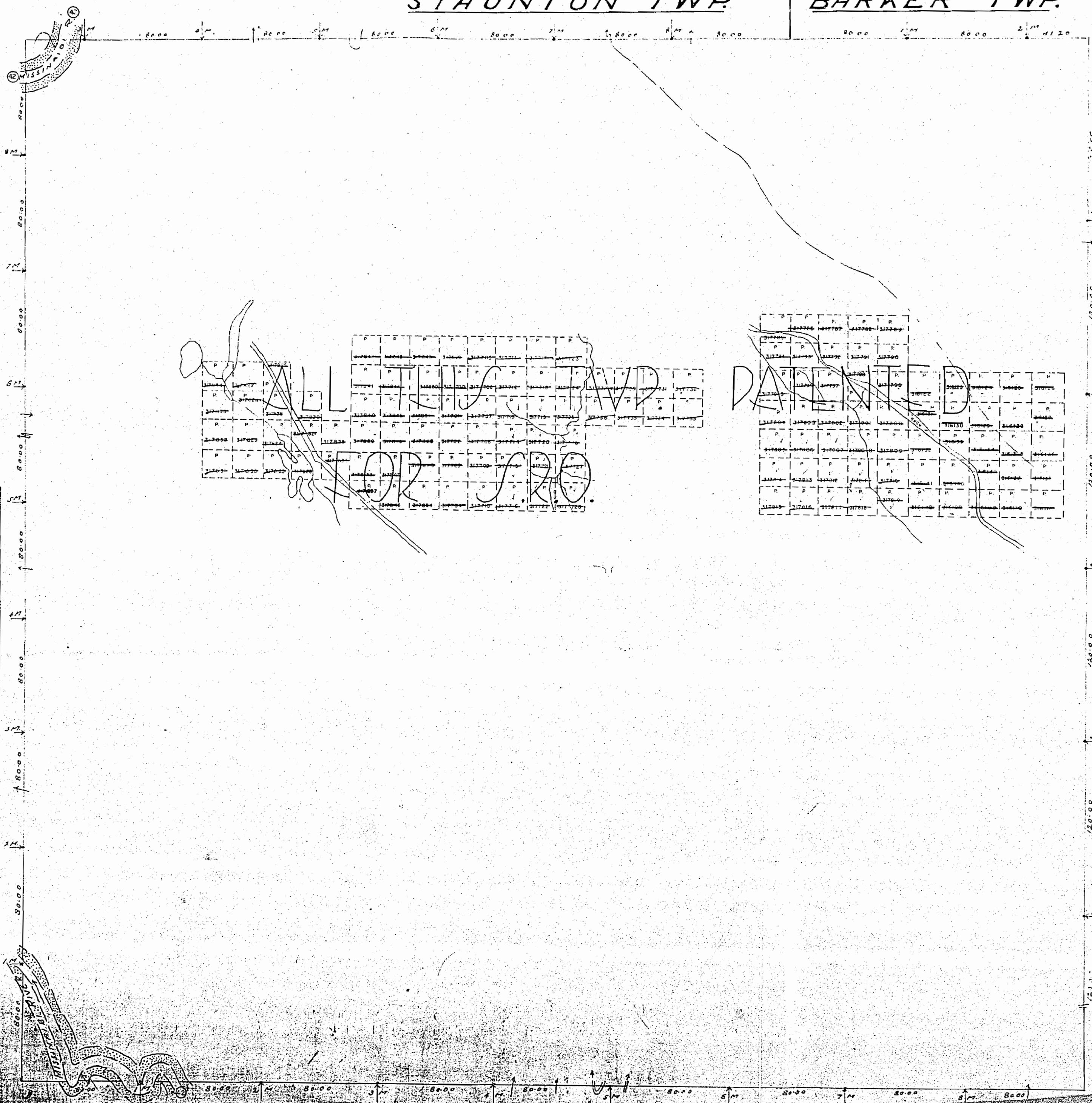
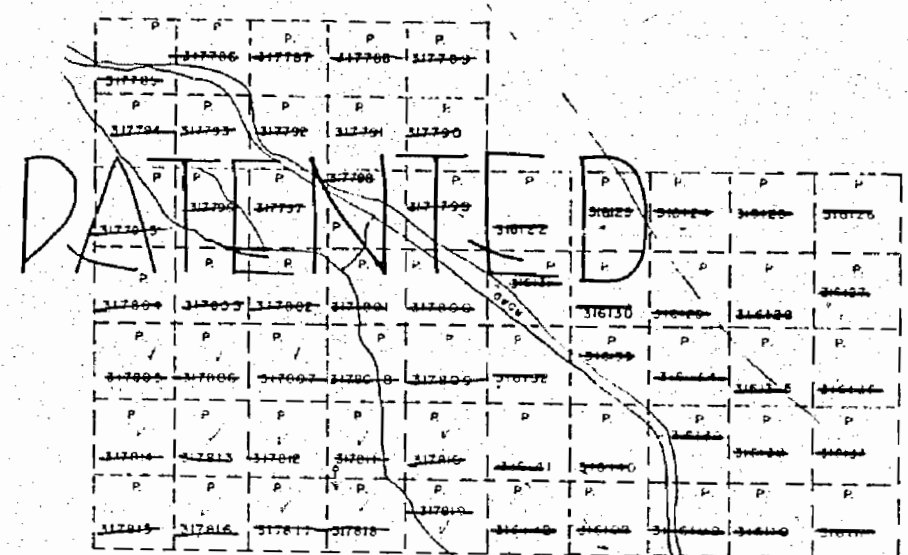
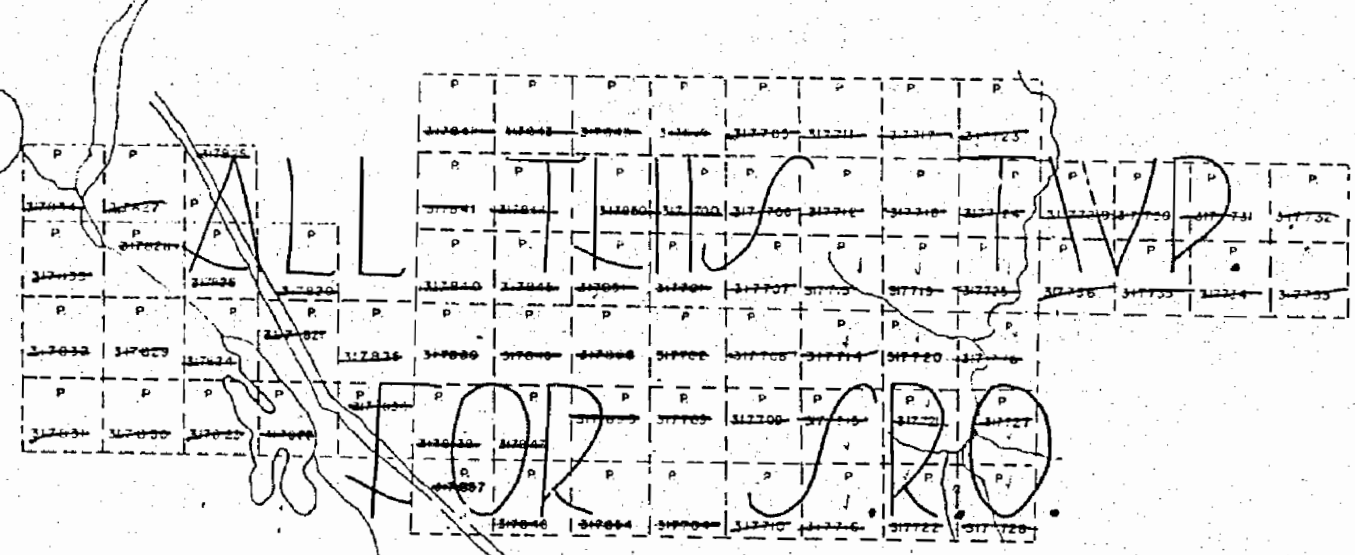

846

PLAN OF MAGLADERY TWP.

m-846

PORCUPINE MINING DIVISION

DISTRICT OF COCHRANE.

Scale, 40 chains to an inch.

ALL CLAIMS
M.R.O

STAUNTON TWP

BARKER TWP

OPEN JUNE 1/59 7 am Stand Time
DITTO GAZETTE MAY 9/59
MINE RIGHTS ONLY

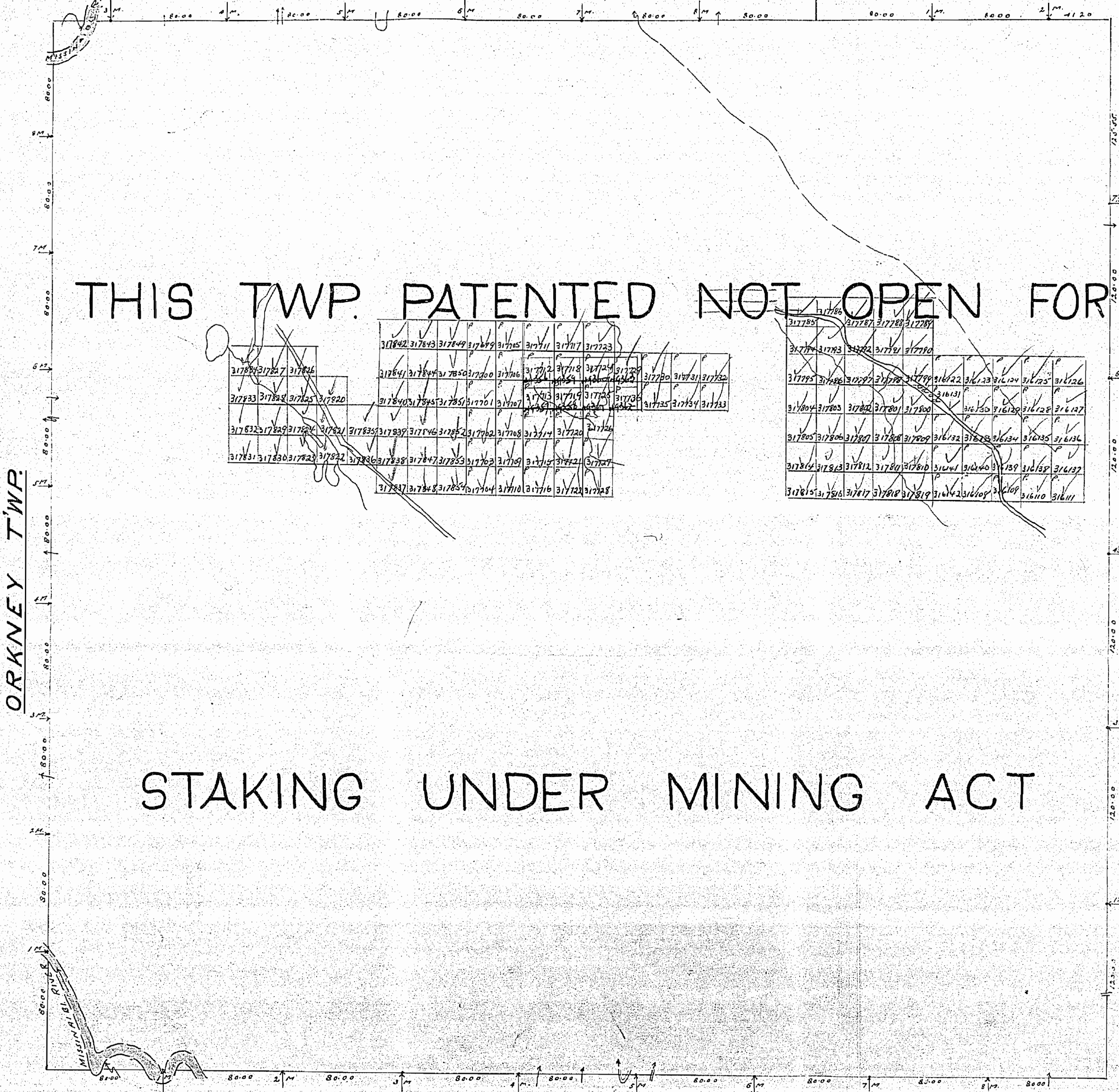
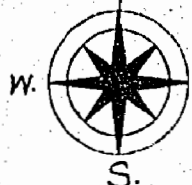

THIS TWP. PATENTED NOT OPEN FOR

STAKING UNDER MINING ACT

ORKNEY TWP

SHEARER TWP

RYKERT TWP

846

M.846

PLAN OF MAGLADERY TWP.

PORCUPINE MINING DIVISION
DISTRICT OF COCHRANE.

Areas withdrawn from staking under Section 42 of the Mining Act.

File	Date	Disposition
83 79	8/70	SR & MR

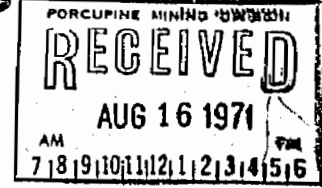

NOTE
400' Surface Rights Reservation
around all Lakes and Rivers.

Scale 40 chains to an inch.



STAUNTON TWP.

BARKER TWP.

ORKNEY TWP.

SHEARER TWP.

RYKERT TWP.

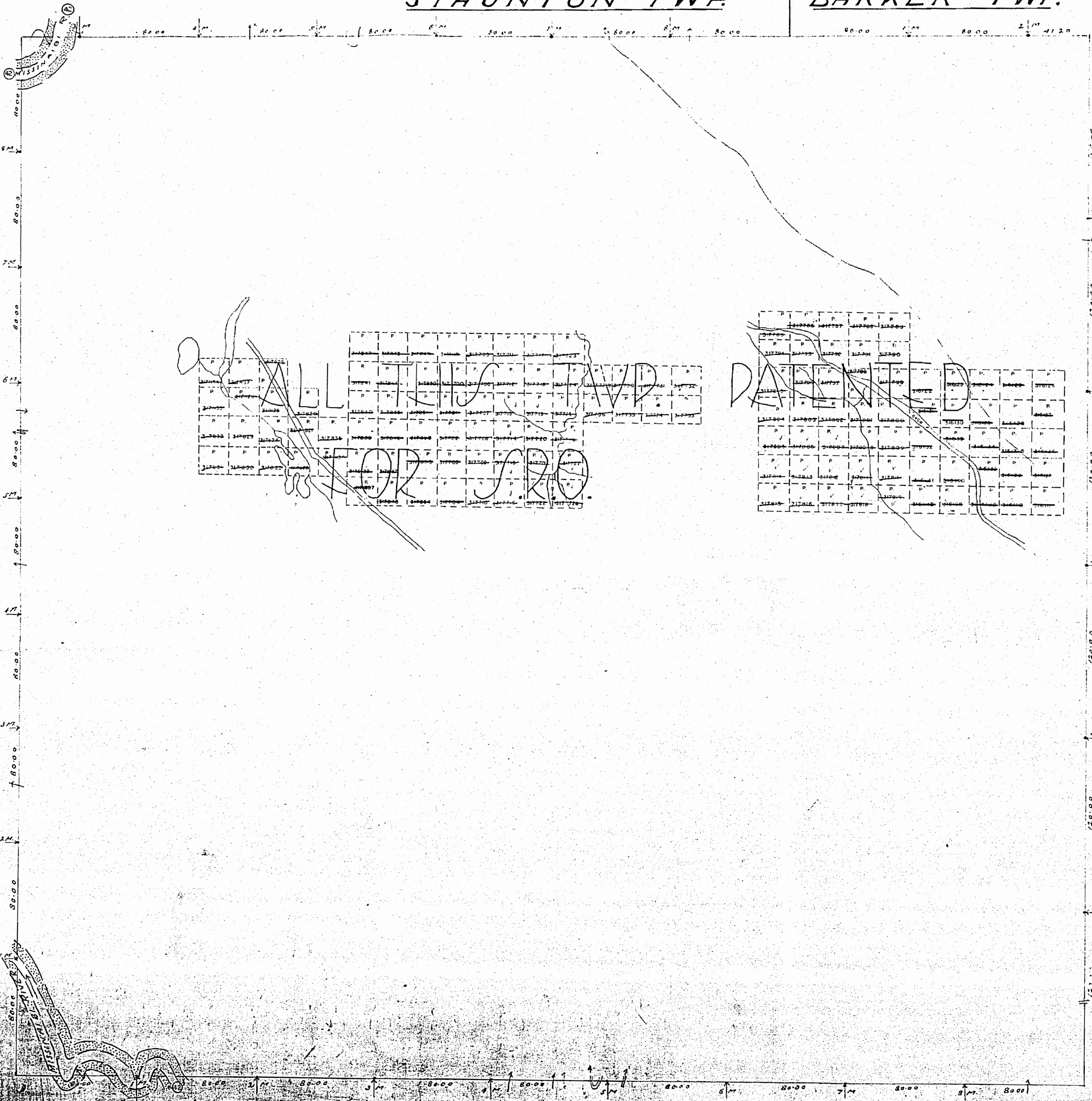

PLAN OF MAGLADERY TWP.

m-846

PORCUPINE MINING DIVISION

DISTRICT OF COCHRANE.

Scale, 40 chains to an inch.

ALL CLAIMS
M.R.O.

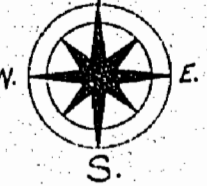

OPEN JUNE 1/59 7am STARS TIME
DITTO GAZETTE MAY 7/59
MINING RIGHTS D/L

STAUNTON TWP.

BARKER TWP.

THIS TWP. PATENTED NOT OPEN FOR

317842	317843	317844	317845	317846	317847	317848	317849	317850	317851	317852	317853	317854	317855	317856	317857	317858	317859	317860	317861	317862	317863	317864	317865	317866	317867	317868	317869	317870	317871	317872	317873	317874	317875	317876	317877	317878	317879	317880	317881	317882	317883	317884	317885	317886	317887	317888	317889	317890	317891	317892	317893	317894	317895	317896	317897	317898	317899	317900	317901	317902	317903	317904	317905	317906	317907	317908	317909	317910	317911	317912	317913	317914	317915	317916	317917	317918	317919	317920	317921	317922	317923	317924	317925	317926	317927	317928	317929	317930	317931	317932	317933	317934	317935	317936	317937	317938	317939	317940	317941	317942	317943	317944	317945	317946	317947	317948	317949	317950	317951	317952	317953	317954	317955	317956	317957	317958	317959	317960	317961	317962	317963	317964	317965	317966	317967	317968	317969	317970	317971	317972	317973	317974	317975	317976	317977	317978	317979	317980	317981	317982	317983	317984	317985	317986	317987	317988	317989	317990	317991	317992	317993	317994	317995	317996	317997	317998	317999	318000
--------	--------	--------	--------	--------	--------	--------	--------	--------	--------	--------	--------	--------	--------	--------	--------	--------	--------	--------	--------	--------	--------	--------	--------	--------	--------	--------	--------	--------	--------	--------	--------	--------	--------	--------	--------	--------	--------	--------	--------	--------	--------	--------	--------	--------	--------	--------	--------	--------	--------	--------	--------	--------	--------	--------	--------	--------	--------	--------	--------	--------	--------	--------	--------	--------	--------	--------	--------	--------	--------	--------	--------	--------	--------	--------	--------	--------	--------	--------	--------	--------	--------	--------	--------	--------	--------	--------	--------	--------	--------	--------	--------	--------	--------	--------	--------	--------	--------	--------	--------	--------	--------	--------	--------	--------	--------	--------	--------	--------	--------	--------	--------	--------	--------	--------	--------	--------	--------	--------	--------	--------	--------	--------	--------	--------	--------	--------	--------	--------	--------	--------	--------	--------	--------	--------	--------	--------	--------	--------	--------	--------	--------	--------	--------	--------	--------	--------	--------	--------	--------	--------	--------	--------	--------	--------	--------	--------	--------	--------

STAKING UNDER MINING ACT

ORKNEY TWP.

SHEARER TWP.

RYKERT TWP.

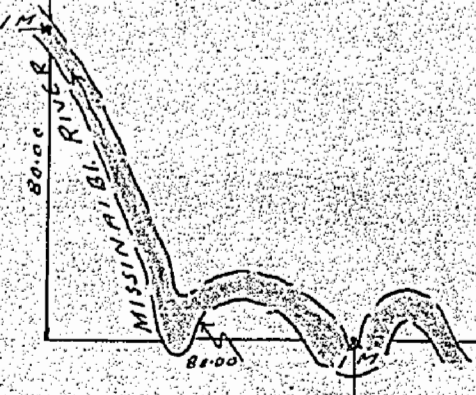

846

M.846

PLAN OF MAGLADERY TWP.

Areas withdrawn from staking under Section 42 of the Mining Act.

File	Date	Disposition
83-99	8/70	SR & MR

PORCUPINE MINING DIVISION

DISTRICT OF COCHRANE.

Scale, 40 chains to an inch.

RECEIVED
AUG 16 1971
AM 7 18 19 10 11 12 13 14 15 16 PM



NOTE
400' Surface Rights Reservation
around all Lakes and Rivers.

STAUNTON TWP.

BARKER TWP.

ORKNEY TWP.

SHEARER TWP.

RYKERT TWP.

