

SAULT STE. MARIE  
MINING DIV.  
**RECEIVED**  
OCT 27 1983  
A.M. 7 8 9 10 11 12 1 2 3 4 5 6 P.M.

**A.C. AND H.B. RLY. LAND GRANT.**  
**—PLAN OF—**  
**MANESS TP.**  
(Tp. 27 R. 23)  
**G. 2998**  
**SAULT STE. MARIE MINING DIVISION.**  
**DISTRICT OF ALGOMA.**

Scale 40 chains to an inch.

~~M. 1523~~  
M. 1523  
ONTARIO

MINISTRY OF NATURAL RESOURCES W.

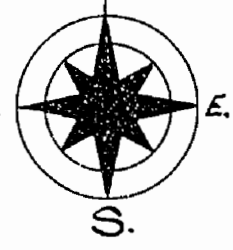

Fiddler Tp. M. 1524

SURVEYS AND MAPPING BRANCH  
BORZOI

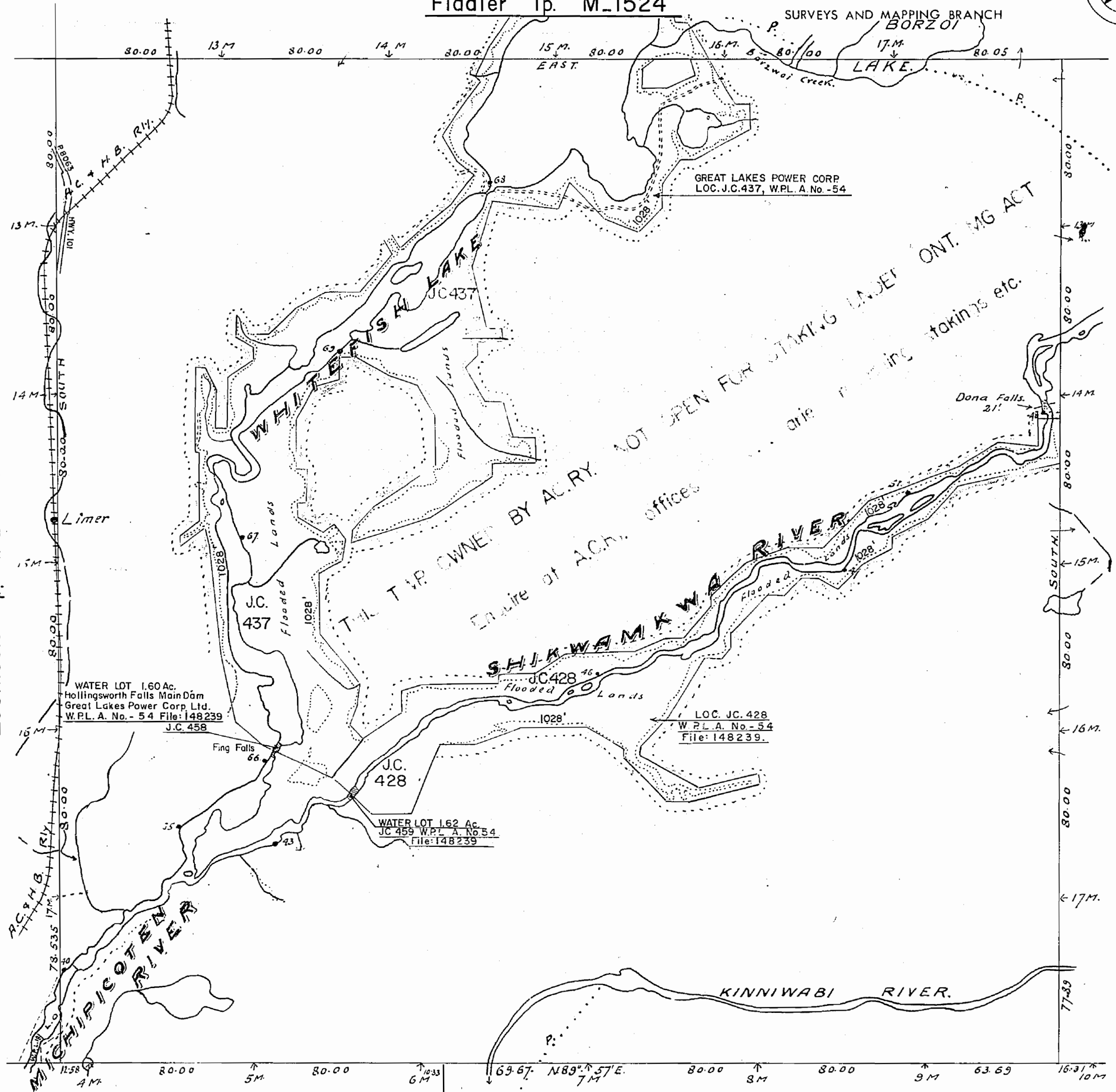

Lastheels Tp. M. 1534

MICHANO Tp.

← TWP. 28 - R. 22. →

Noganosh Tp.  
M. 1522

Surface reservations 400' wide by Dept. of L. & F  
shewn hereon thus

Note. W.P.L.A. No. 54 COVERS FLOODING RIGHTS  
TO CONTOUR ELEV. 1028' TO GREAT LAKES  
POWER CORP. FILE: 148239.  
Arbitrary boundaries shewn thus.  
Traverse posts shewn thus 67, etc.  
Railway from A.C. & H.B. Rly. Plan 1908



# REFERENCES

## AREAS WITHDRAWN FROM DISPOSITION

M.R.O. - MINING RIGHTS ONLY

S.R.O. - SURFACE RIGHTS ONLY

M.+S. - MINING AND SURFACE RIGHTS

Description	Order No.	Date	Disposition	File

## NOTES

W.P.L.A. No. 54 COVERS FLOODING RIGHTS TO  
CONTOUR ELEV. 1028' (JC. 428, JC. 437)  
FILE: 148239

\* THIS TWP. OWNED BY A.C.R.Y. NOT OPEN FOR STAKING  
UNDER ONT. MINING ACT. ENQUIRE AT A.C.R.Y. OFFICES  
AT S.S.TE. MARIE REGARDING STAKINGS ETC.

The 1985 Magnetic Bearing  
Approx. 6°30' N. Annual Change  
Increasing 10'

THE INFORMATION THAT  
APPEARS ON THIS MAP  
HAS BEEN COMPILED  
FROM VARIOUS SOURCES,  
AND ACCURACY IS NOT  
GUARANTEED. THOSE  
WISHING TO STAKE MIN-  
ING CLAIMS SHOULD CON-  
SULT WITH THE MINING  
RECORDER, MINISTRY OF  
NORTHERN DEVELOP-  
MENT AND MINES, FOR AD-  
DITIONAL INFORMATION  
ON THE STATUS OF THE  
LANDS SHOWN HEREON.

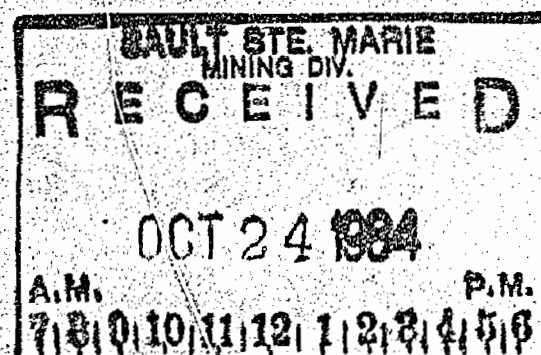

## FIDDLER TWP G-2759

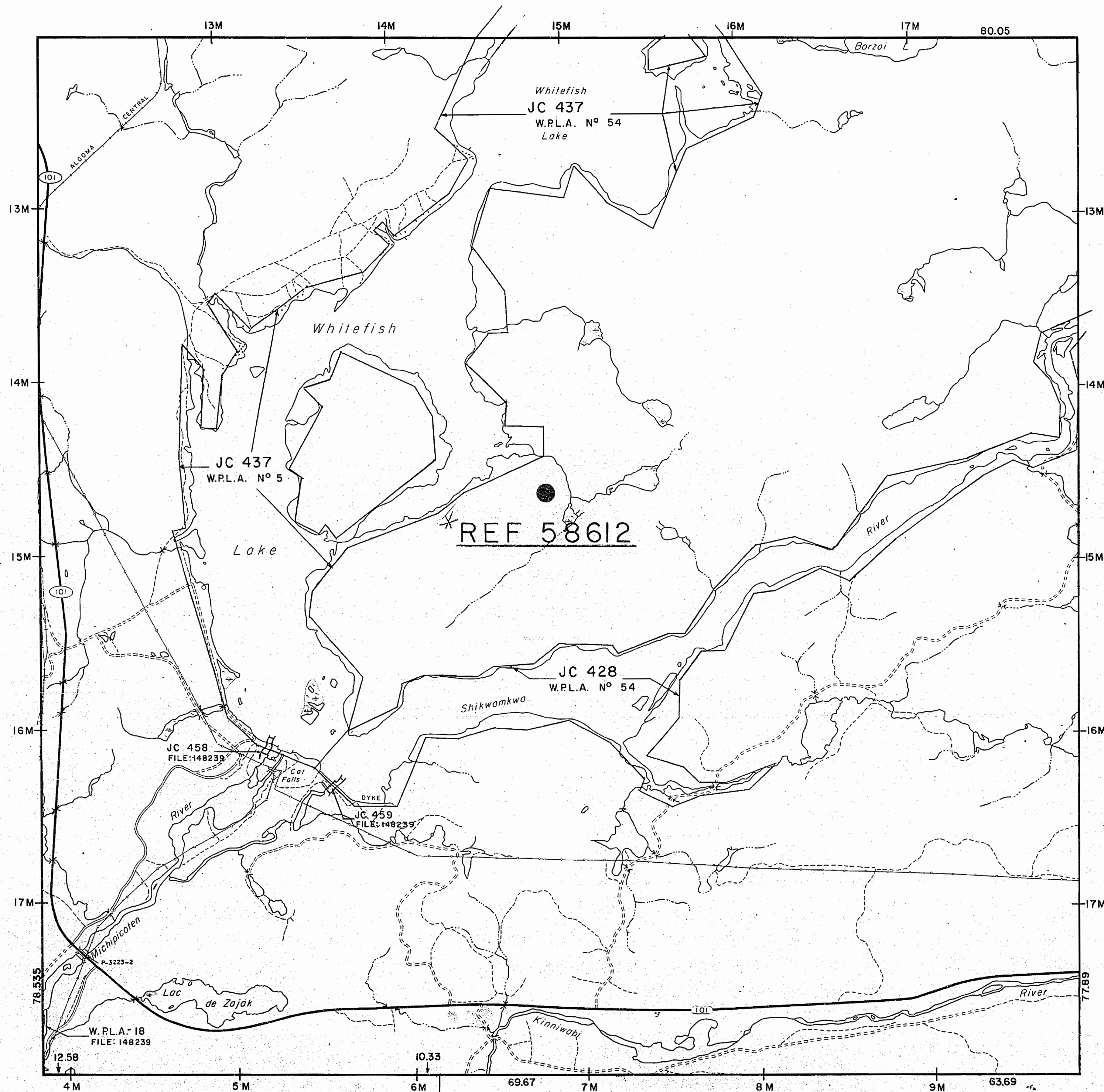

NEBONAIONQUET TWP G-2405

NOGANOSH TWP G-2402

## LEGEND

HIGHWAY AND ROUTE No.	
OTHER ROADS	
TRAILS	
SURVEYED LINES:	
TOWNSHIPS, BASE LINES, ETC.	
LOTS, MINING CLAIMS, PARCELS, ETC.	
UNSURVEYED LINES:	
LOT LINES	
PARCEL BOUNDARY	
MINING CLAIMS ETC.	
RAILWAY AND RIGHT OF WAY	
UTILITY LINES	
NON-PERENNIAL STREAM	
FLOODING OR FLOODING RIGHTS	
SUBDIVISION OR COMPOSITE PLAN	
RESERVATIONS	
ORIGINAL SHORELINE	
MARSH OR MUSKEG	
MINES	
TRAVERSE MONUMENT	

## DISPOSITION OF CROWN LANDS

TYPE OF DOCUMENT	SYMBOL
PATENT, SURFACE & MINING RIGHTS	
" SURFACE RIGHTS ONLY	
" MINING RIGHTS ONLY	
LEASE, SURFACE & MINING RIGHTS	
" SURFACE RIGHTS ONLY	
" MINING RIGHTS ONLY	
LICENCE OF OCCUPATION	
ORDER-IN-COUNCIL	
RESERVATION	
CANCELLED	
SAND & GRAVEL	

NOTE: MINING RIGHTS IN PARCELS PATENTED PRIOR TO MAY 6,  
1913, VESTED IN ORIGINAL PATENTEE BY THE PUBLIC  
LANDS ACT, R.S.O. 1970, CHAP. 380, SEC. 63, SUBSEC. 1.

SCALE: 1 INCH = 40 CHAINS

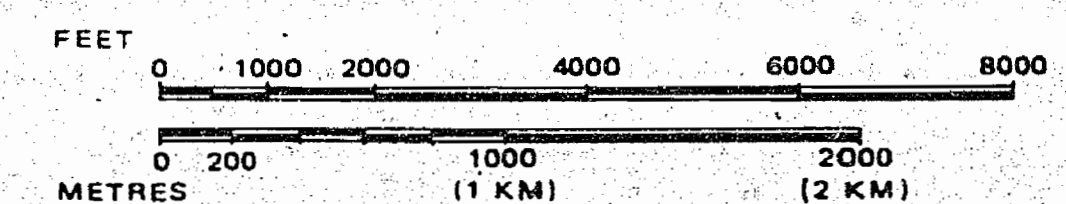

TOWNSHIP

MANESS

M.N.R. ADMINISTRATIVE DISTRICT

WAWA

MINING DIVISION

SAULT STE. MARIE

LAND TITLES / REGISTRY DIVISION

ALGOMA



Ministry of  
Natural  
Resources  
Land  
Management  
Branch

Date  
FEBRUARY, 1984

Number  
G-2998



MANESS G.2998 MB 51 B 52 W-1253

—A.C. AND H.B. RLY. LAND GRANT.—  
—PLAN OF—

**TWP. 27.—R. 23.**

**SAULT STE. MARIE MINING DIVISION.**

**DISTRICT OF ALGOMA.**

Scale 40 chains to an inch.

**TWP. 27. R. 24.**

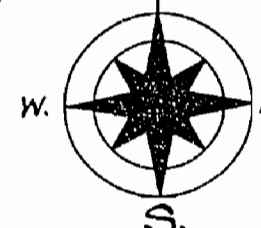

DATE OF ISSUE  
JUL 12 1958  
SAULT STE. MARIE  
MINING RECORDS OFFICE

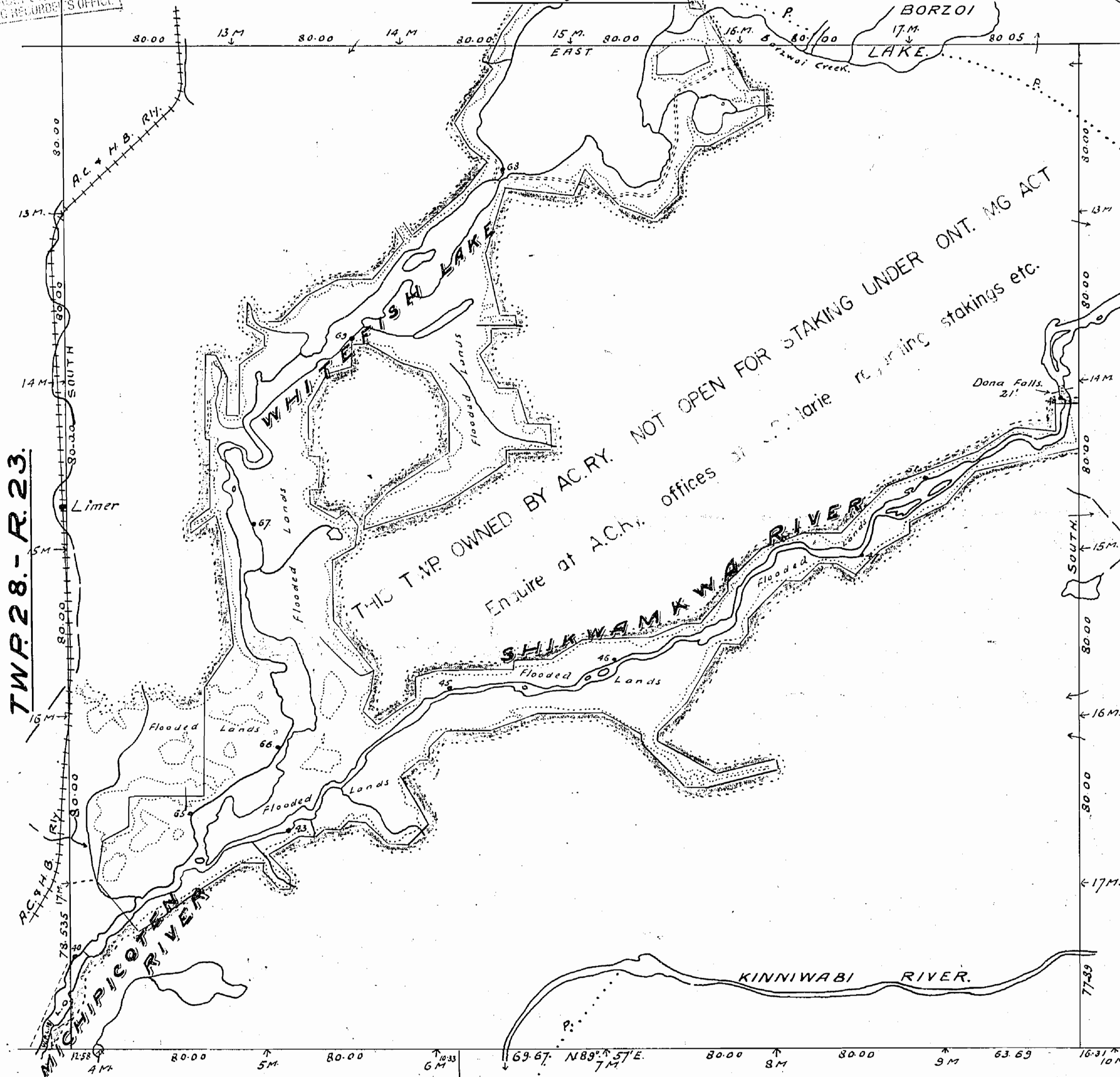

**TWP. 28.—R. 23.**

**TWP. 26.—R. 23.**

← **TWP. 28.—R. 22.** → **TWP. 27. R. 22.** →

Note.  
Flooded areas of Whitefish Lake, Michipicoten and Shikwamkwa Rivers shown thus. Arbitrary boundaries shown thus. Traverse posts shown thus 7/16 etc. Railway from A.C. & H.B. Rly. Plan 1908

Surface reservations 200' wide by Dept. of L. & F. shown hereon thus