

MARCONI

DISTRICT OF SUDBURY

Scale: - 40 Chains = 1 Inch.

OLD

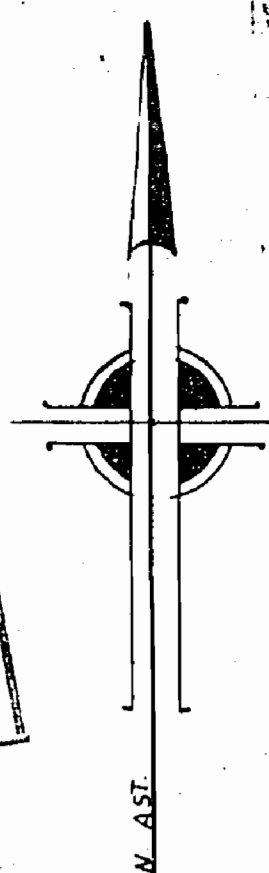
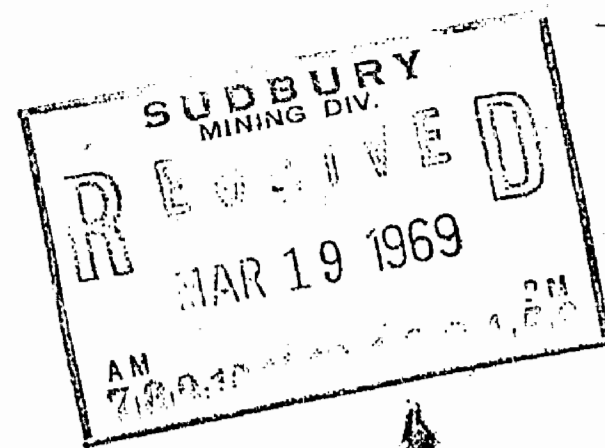

NOTE
400' Surface Rights Reservation
around all Lakes and Rivers.

SELKIRK

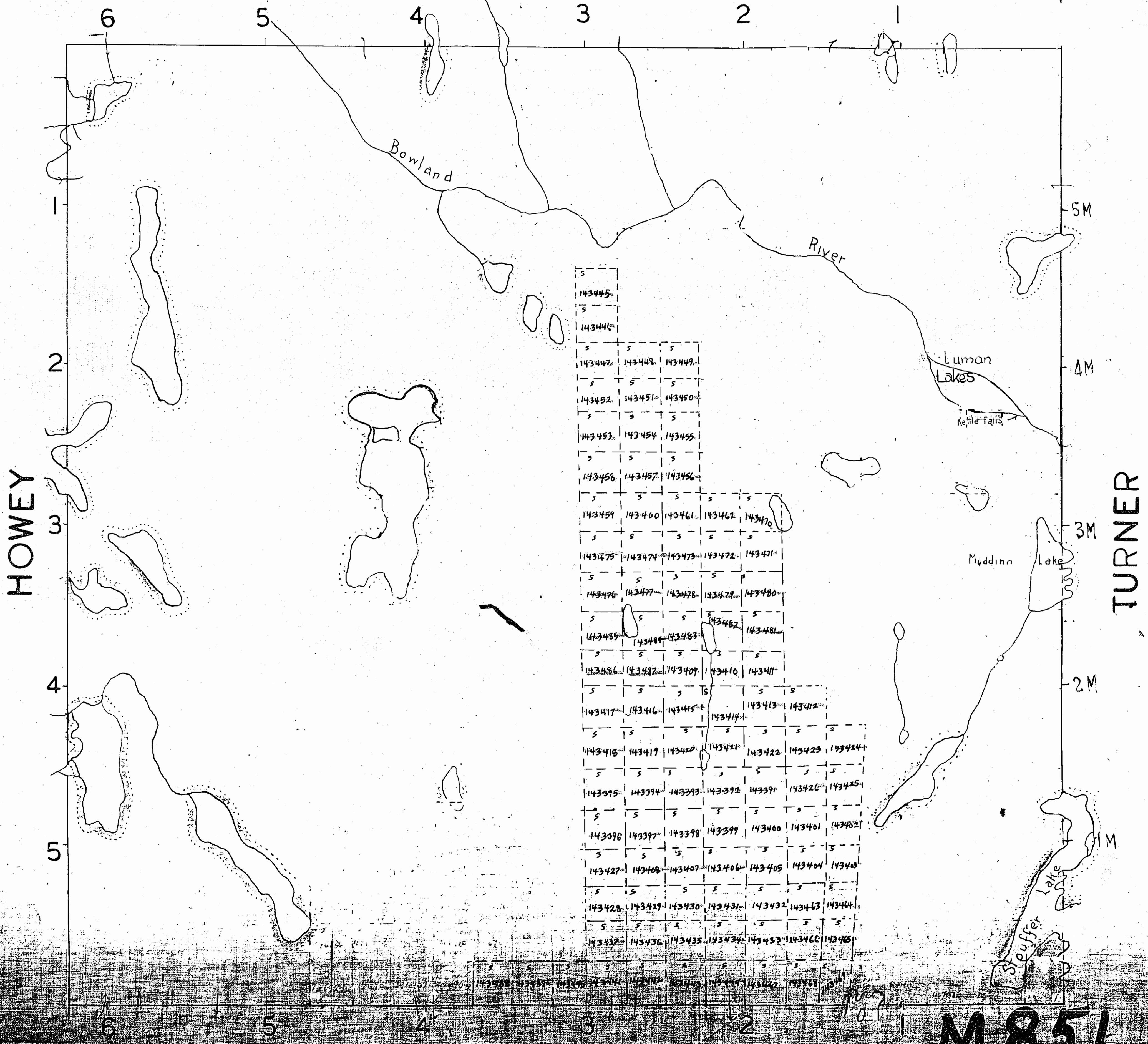

M 851

MARCONI

DISTRICT OF SUDBURY

M.851

ONTARIO

MINISTRY OF NATURAL RESOURCES

Scale: - 40 Chains = 1 Inch.

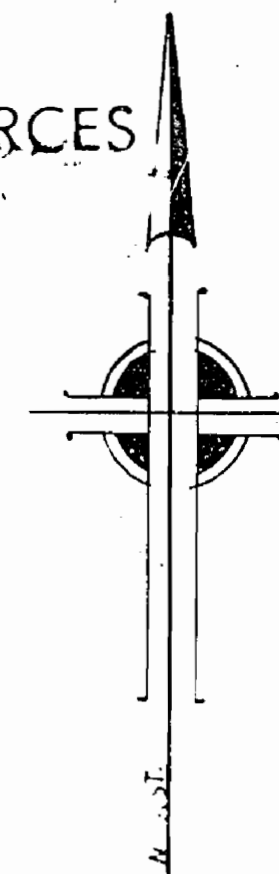

NOTE

400' Surface Rights Reservation
around all Lakes and Rivers.

Township closed to staking effective May 8/78,
Section 38(f) of the Mining Act.

SELKIRK

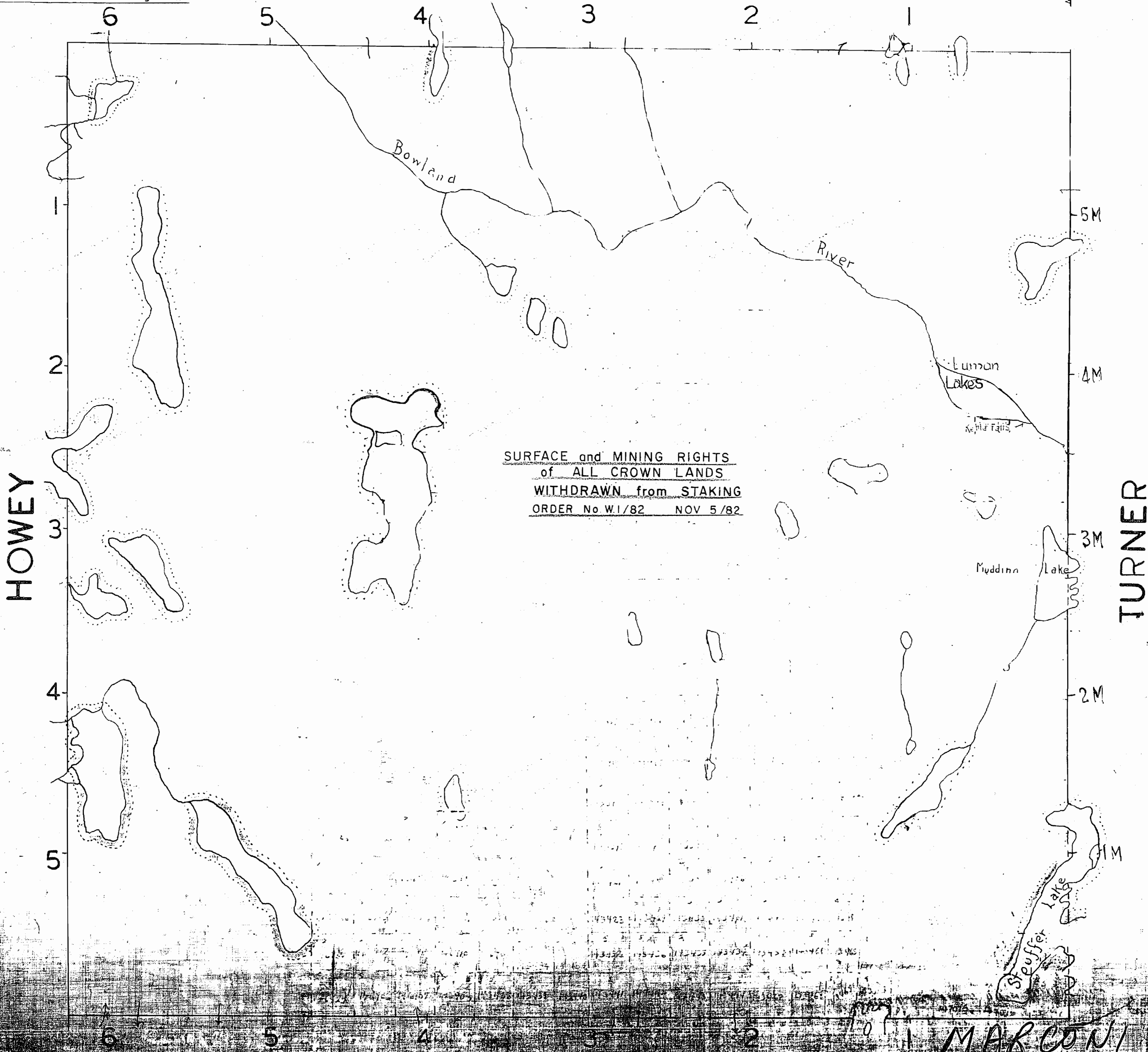

INDEX TO LAND DISPOSITION

PLAN
G-4079

TOWNSHIP
MARCONI

M.N.R. ADMINISTRATIVE DISTRICT
SUDBURY

MINING DIVISION
SUDBURY

LAND TITLES/REGISTRY DIVISION
SUDBURY

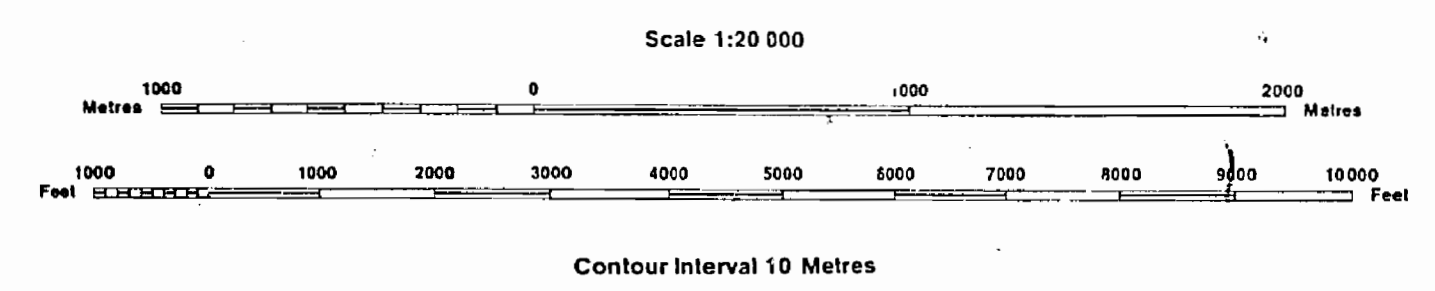

AREAS WITHDRAWN FROM DISPOSITION

MFO - Mining Rights Only
SRO - Surface Rights Only
M + S - Mining and Surface Rights

Description	Order No.	Date	Disposition	File
SEC. 36/90	X.1/82	11/05/82	M+S	
PARK RESERVE	W.10/83	12/10/83	M+S	188559
STURGEON RIVER PROVINCIAL PARK			ONTARIO REGULATION NO.256/89	SCHEDULE NO.230

Part of order W 1182 REOPENED by order O-M. 0190 NER effective April 3/90 at 7:00 AM E.S.T.

SYMBOLS

Boundary
Township, Meridian, Baseline	————
Road allowance; surveyed	————
shoreline	~~~~~
Lot/Concession; surveyed	————
unsurveyed
Parcel; surveyed	————
unsurveyed
Right-of-way; road	————
railway	————
utility	————
Reservation
Cliff, Pit, Pile
Contour
Interpolated
Approximate
Depression
Control point (horizontal)
Flooded land
Mine head frame
Pipeline (above ground)
Railway; single track
double track
abandoned
Road; highway, county, township
access
trail, bush
Shoreline (original)
Transmission line
Wooded area

NOTE:
"THIS MAP SHOWS THE APPROXIMATE LOCATION OF THE BOUNDARIES OF THE AREA WHICH IS THE SUBJECT OF CURRENT LITIGATION. THE EXACT LOCATION WILL BE SHOWN FOLLOWING CONFIRMATION BY THE PARTIES TO THE ACTION"

DISPOSITION OF CROWN LANDS

Patent
Surface & Mining Rights
Surface Rights Only
Mining Rights Only
Lease
Surface & Mining Rights
Surface Rights Only
Mining Rights Only
Licence of Occupation
Order-in-Council
Cancelled
Reservation
Sand & Gravel

DATE OF ISSUE
F-4 x 3
DATE OF ISSUE
RECORDERS OFFICE
JUN 27 1985
SUDBURY
RECORDERS OFFICE

THE INFORMATION THAT APPEARS ON THIS MAP HAS BEEN COMPILED FROM VARIOUS SOURCES, AND ACCURACY IS NOT GUARANTEED. THOSE WISHING TO STAKE MINING CLAIMS SHOULD CONSULT WITH THE MINING RECORDER, MINISTRY OF NORTHERN DEVELOPMENT AND MINES, FOR ADDITIONAL INFORMATION ON THE STATUS OF THE LANDS SHOWN HEREON.

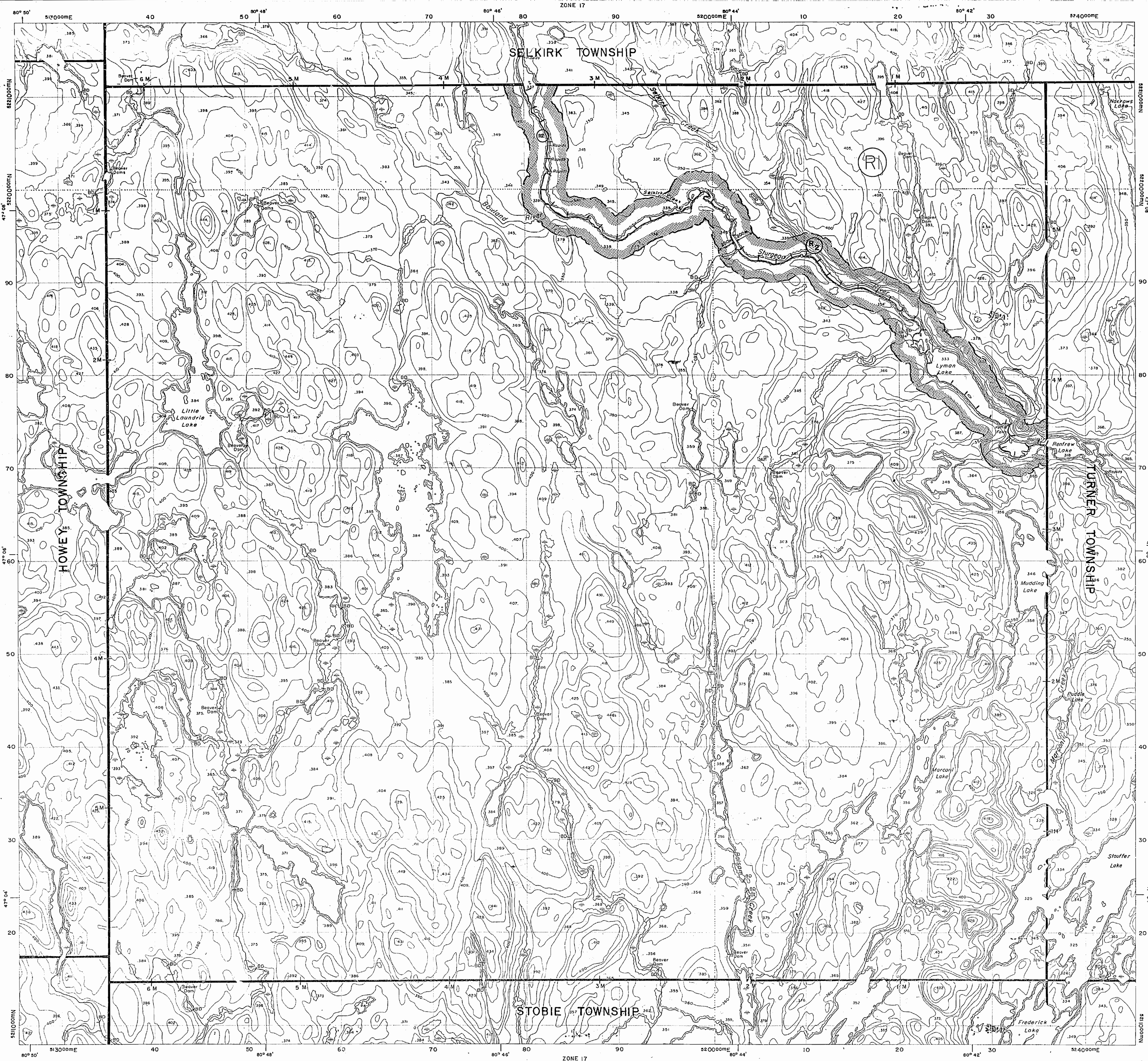

INDEX TO LAND DISPOSITION

PLAN
G-4079
 TOWNSHIP
MARCONI

M.N.R. ADMINISTRATIVE DISTRICT
SUDBURY
 MINING DIVISION
SUDBURY
 LAND TITLES/REGISTRY DIVISION,
SUDBURY

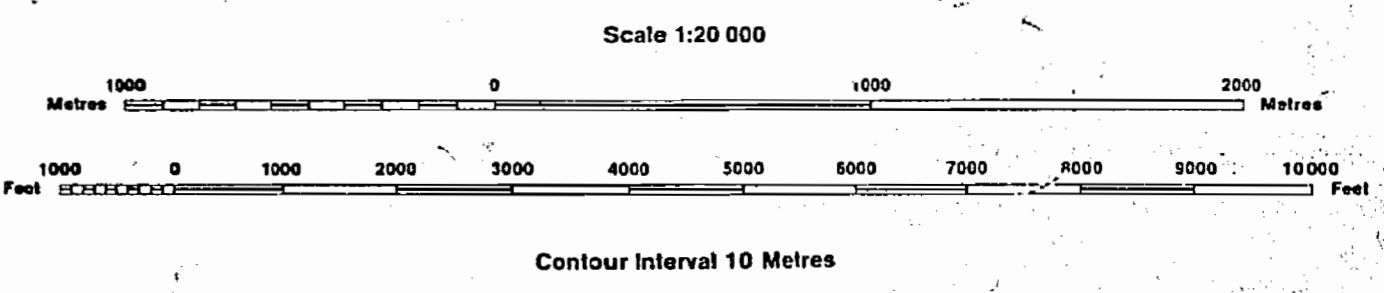

AREAS WITHDRAWN FROM DISPOSITION

Description	Order No.	Date	Disposition	File
28C35180	0-3-22116	03/05/93	M & S	138180
28C-36780	4-4792	4/09/92	M & S	141-3
Ⓢ PARK RESERVE	W10/83	12/07/83	M & S	108338
Ⓢ STURGEON RIVER PROVINCIAL PARK			ONTARIO REGULATION NO.256/89	SCHEDULE NO.230

Part of order W 1182 REOPENED by order O-M. 01/90 NER effective April 3, 1990 at 7:00 AM E.S.T.

STURGEON RIVER PROVINCIAL PARK
 ONTARIO REGULATION NO.256/89 SCHEDULE NO.230
 NOTE - THE LIMITS OF THE PARK ARE POSITION 200 METERS IN PERPENDICULAR DISTANCE FROM THE HIGH WATER MARK UNLESS OTHERWISE STATED ON THE SCHEDULE.

SYMBOLS

- Boundary
 - Township, Meridian, Baseline
- Road allowance; surveyed
- shoreline
- Lot/Concession; surveyed
- unsurveyed
- Parcel; surveyed
- unsurveyed
- Right-of-way; road
- railway
- utility
- Reservation
- Cliff, Pit, Pile
- Contour
 - Interpolated
 - Approximate
 - Depression
- Control point (horizontal)
- Flooded land
- Mine head frame
- Pipeline (above ground)
- Railway; single track
- double track
- abandoned
- Road; highway, county, township
- access
- trail, bush
- Shoreline (original)
- Transmission line
- Wooded area

DATE OF ISSUE

JUN 17 1998
 PROVINCIAL RECORDING
 OFFICE - SUDBURY

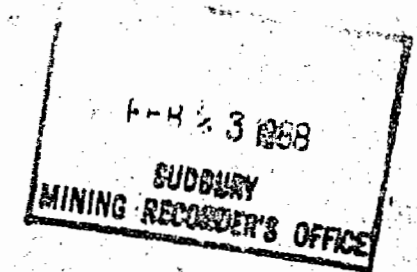

DISPOSITION OF CROWN LANDS

- Patent
 - Surface & Mining Rights
 - Surface Rights Only
 - Mining Rights Only
- Lease
 - Surface & Mining Rights
 - Surface Rights Only
 - Mining Rights Only
- Licence of Occupation
- Order-in-Council
- Cancelled
- Reservation
- Sand & Gravel

THE INFORMATION THAT APPEARS ON THIS MAP HAS BEEN COMPILED FROM VARIOUS SOURCES, AND ACCURACY IS NOT GUARANTEED. THOSE WISHING TO STAKE MINING CLAIMS SHOULD CONSULT WITH THE MINING RECORDER, MINISTRY OF NORTHERN DEVELOPMENT AND MINES, FOR ADDITIONAL INFORMATION ON THE STATUS OF THE LANDS SHOWN HEREON.

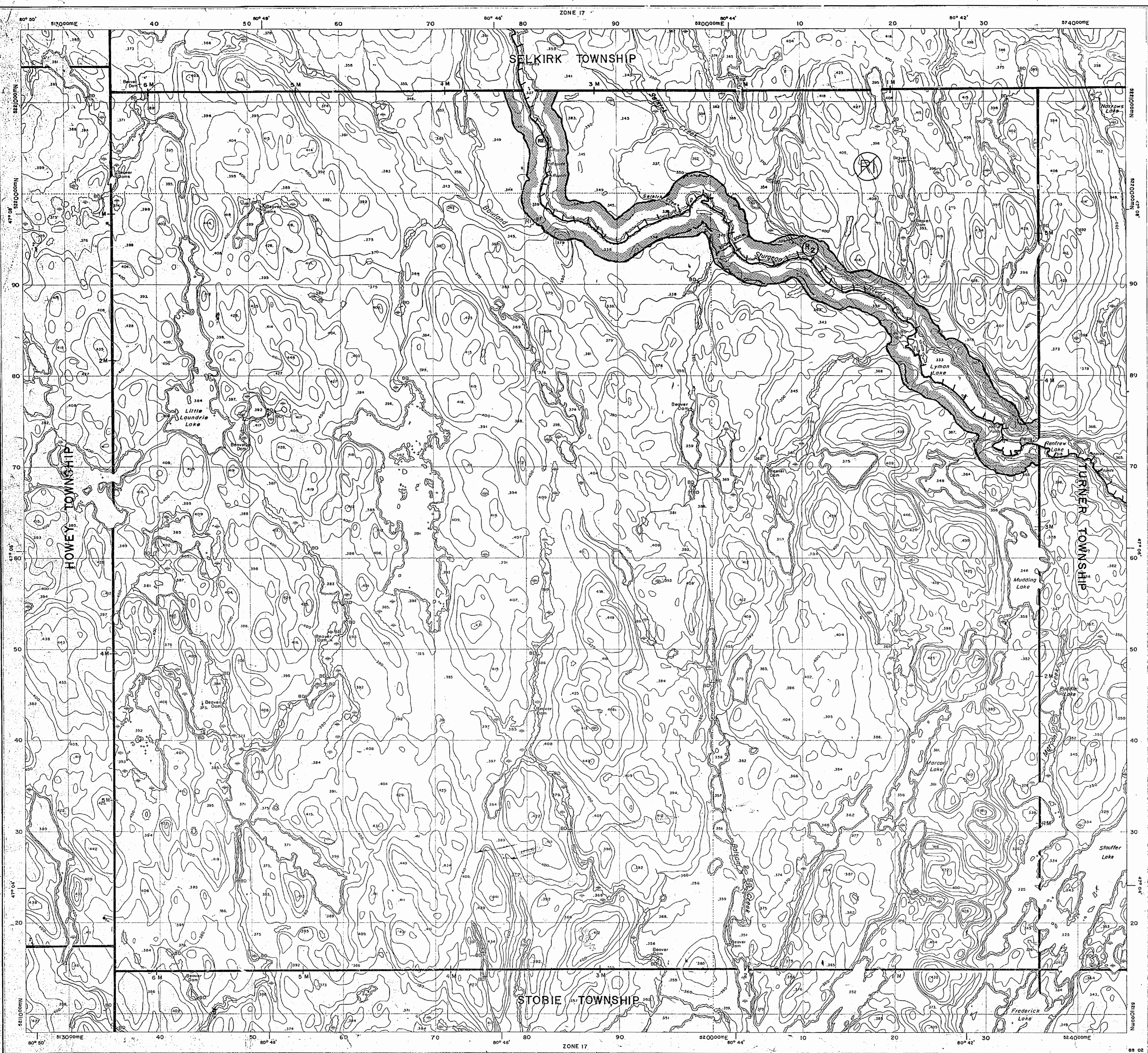

MARCONI

DISTRICT OF SUDBURY

Scale: - 40 Chains = 1 Inch.

TEMP. Res.
400' Res.
Jell

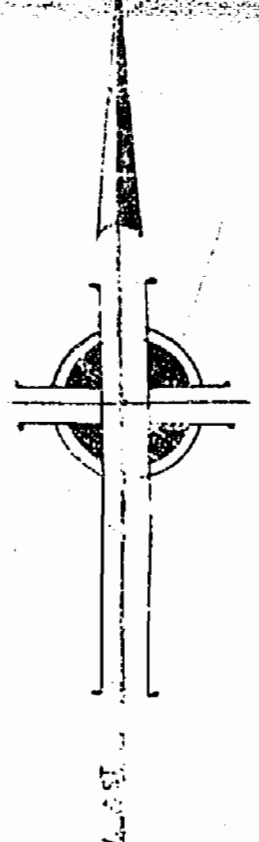

SELKIRK

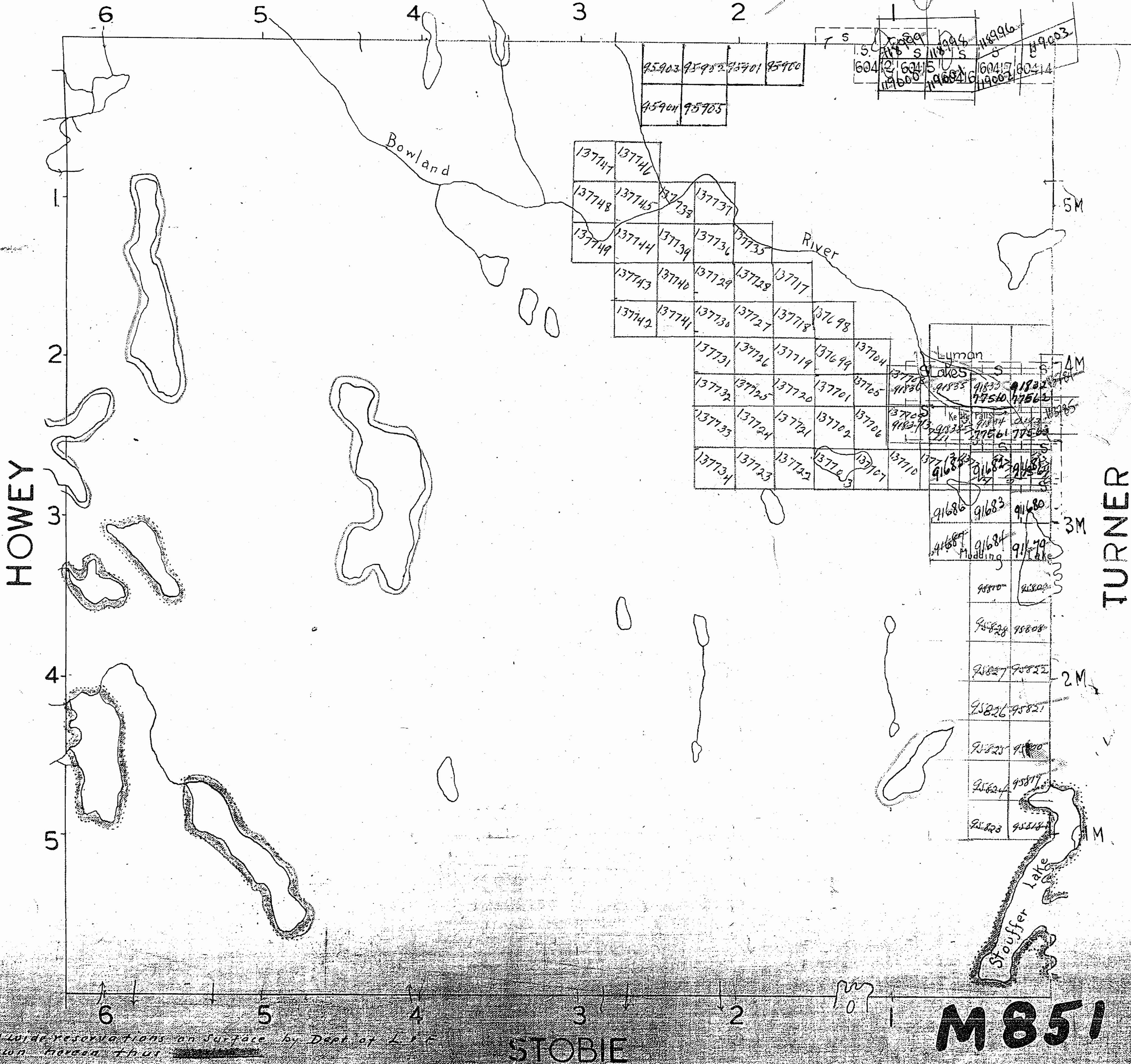

200' wide reservations on surface by Dept. of L. & C. shown in green thru

STOBIE

M 851

851

MARCONI

DISTRICT OF SUDBURY

Scale :- 40 Chains = 1 Inch

SELKIRK

TEM. Res.
400' Res.

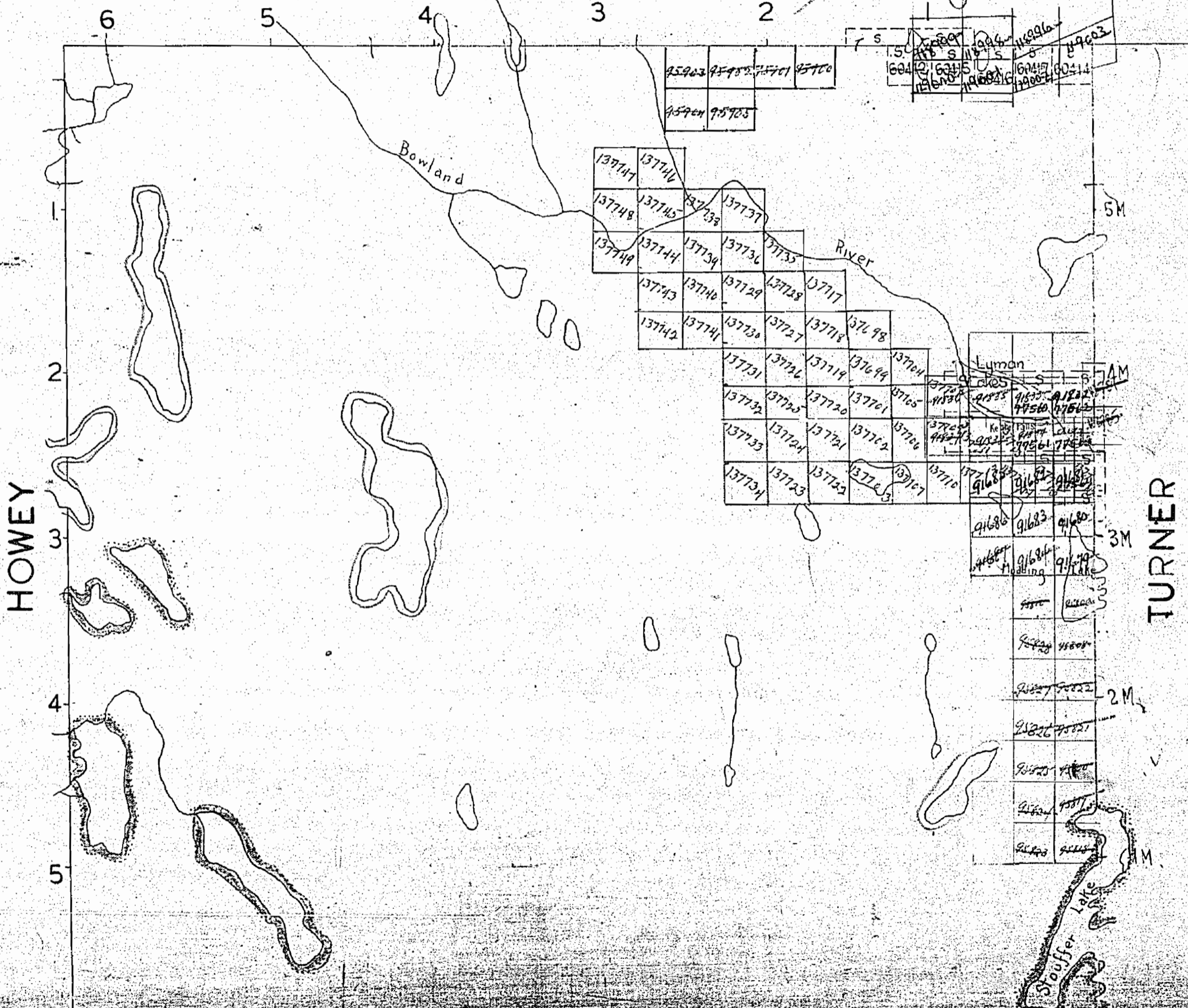

MARCONI DISTRICT OF SUDBURY

M 851

851

MARCONI

DISTRICT OF SUDBURY

Scale: - 40 Chains = 1 Inch

200 Res.

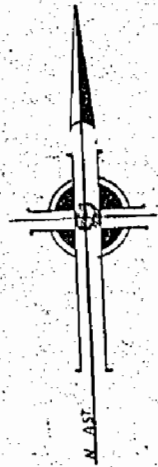

SELKIRK

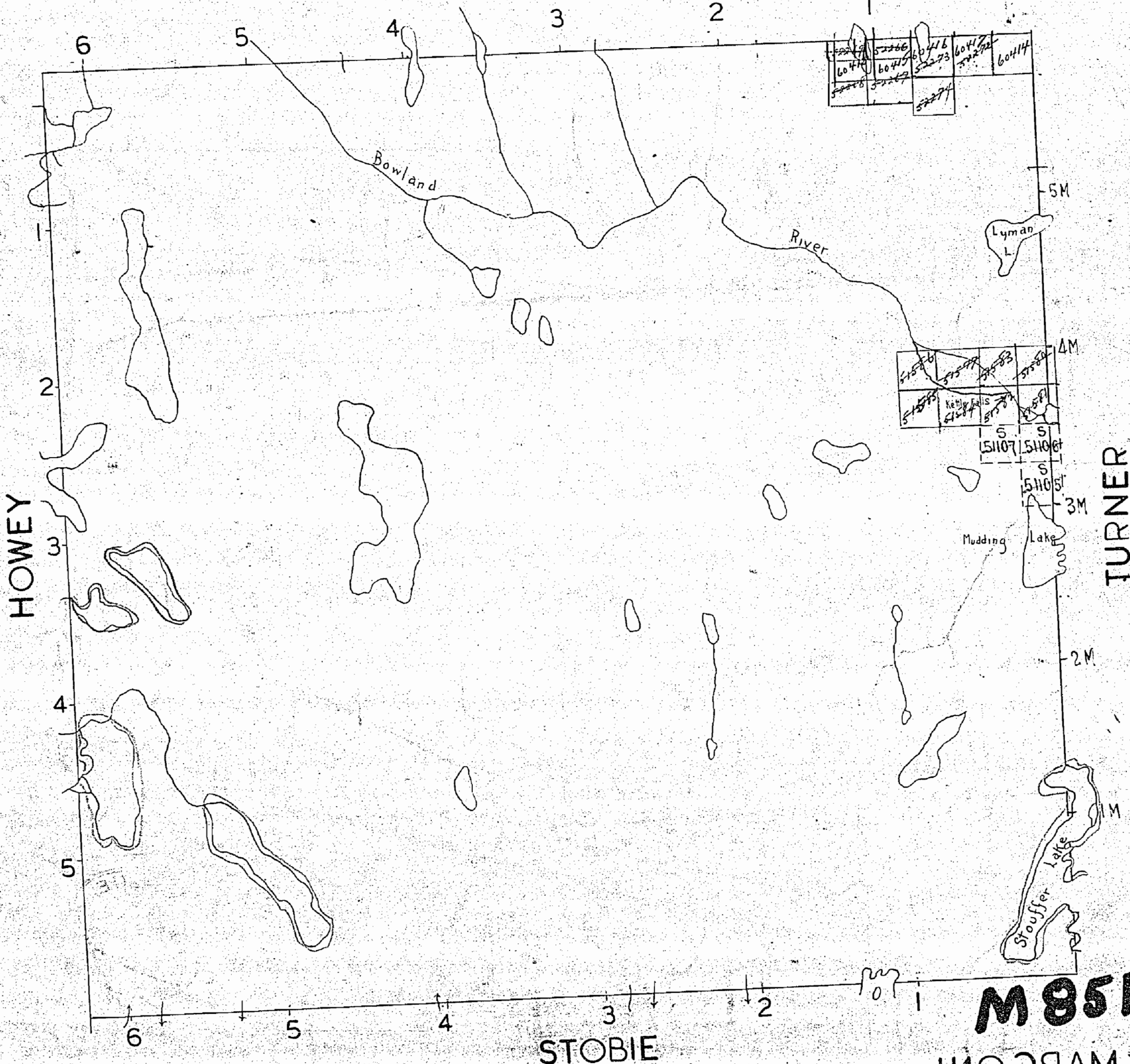

M 851

STOBIE

MARCONI

851

MARCONI

DISTRICT OF SUDBURY

Scale: - 40 Chains = 1 Inch.

OLD

SUDBURY
MINING DIV.
REGISTERED
MAR 19 1969
AM



NOTE
400' Surface Rights Reservation
around all Lakes and Rivers.

SELKIRK

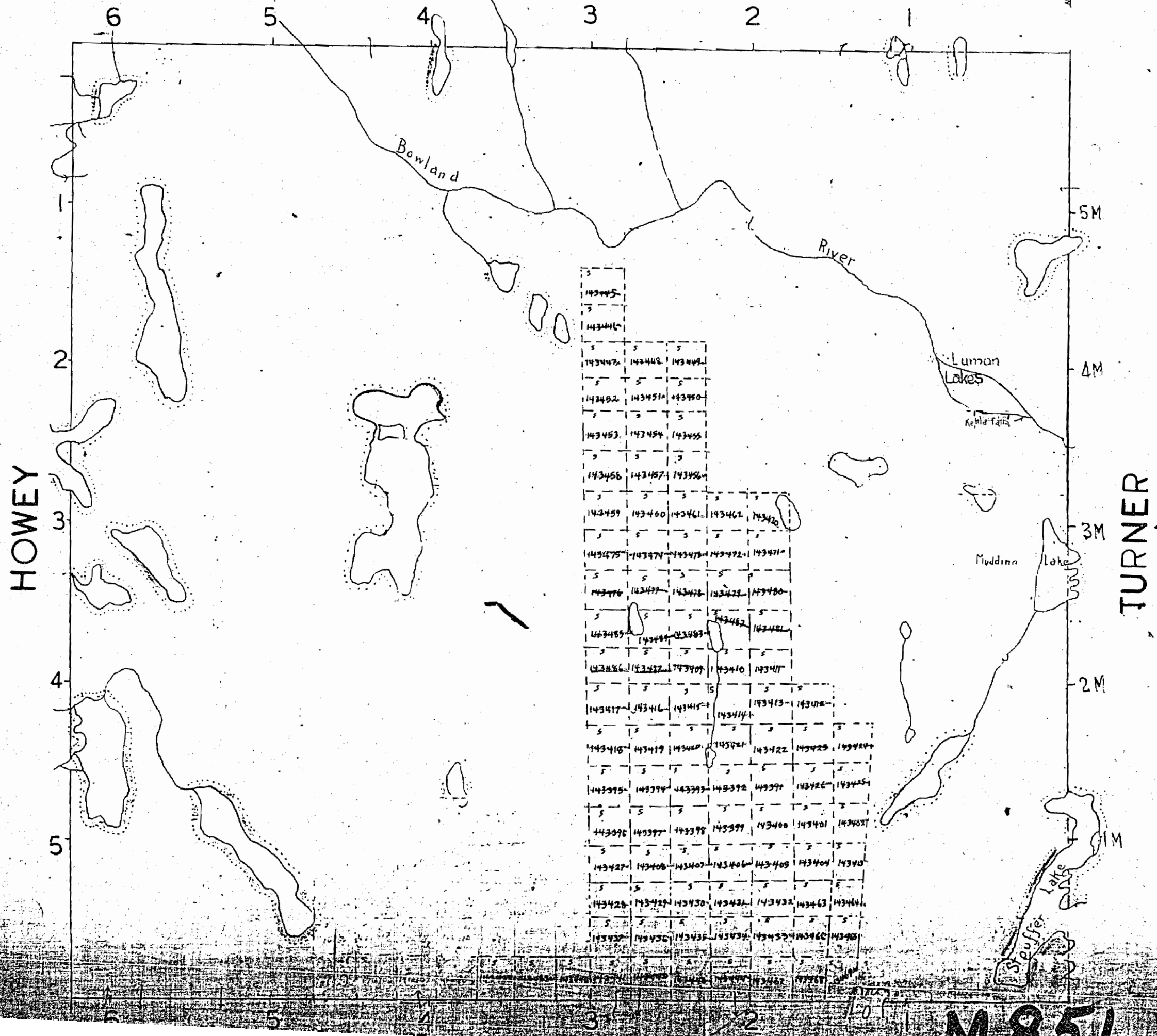

M 851

851

MARCONI

DISTRICT OF SUDBURY

Scale: - 40 Chains = 1 Inch.



NOTE

400' Surface Rights Reservation
around all Lakes and Rivers.

SELKIRK

Handwritten signature

July 30/68

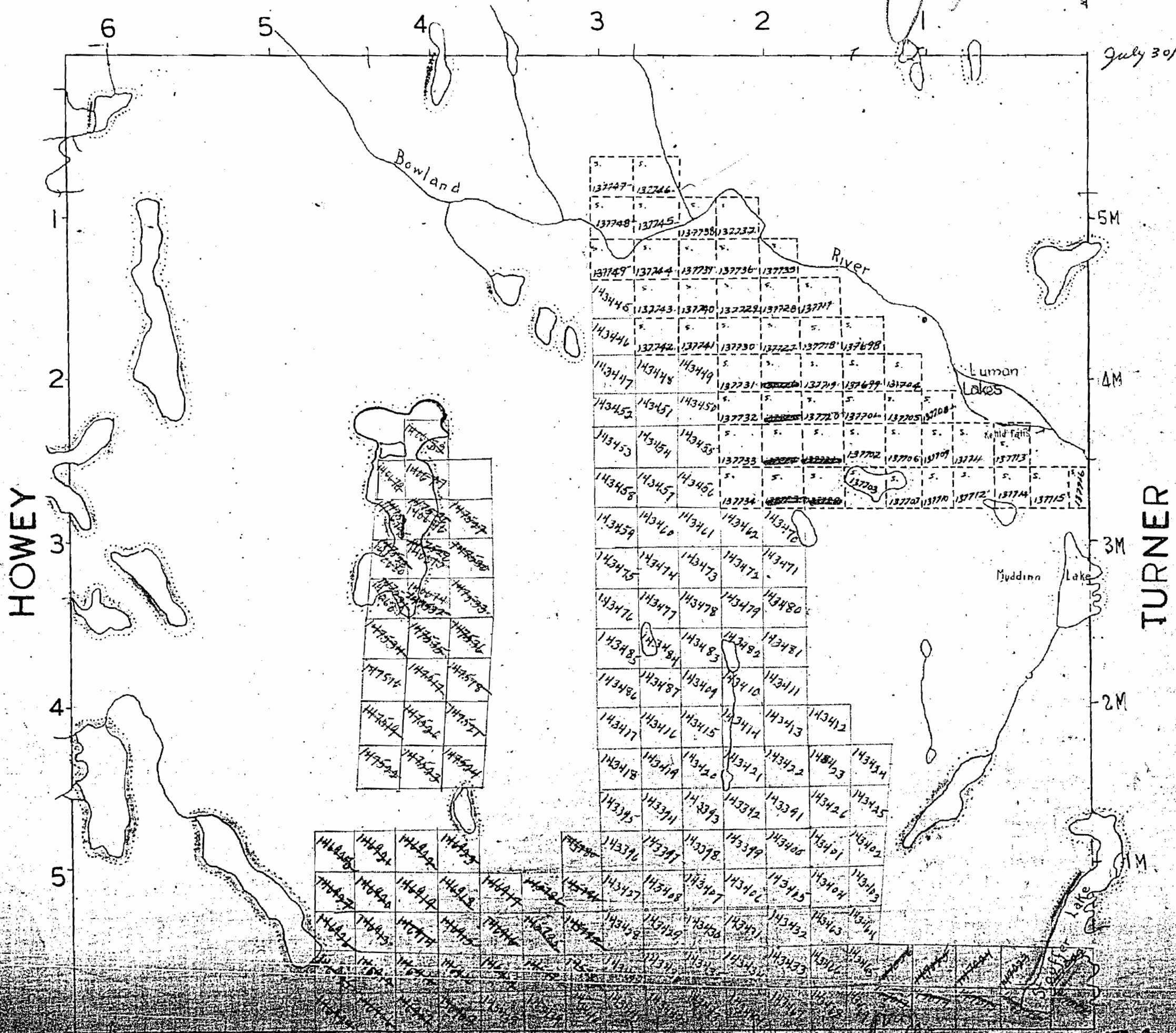

HOWEY

TURNER

STOBIE

M851

INDEX TO LAND DISPOSITION

PLAN
G-4079

TOWNSHIP
MARCONI

M.H.R. ADMINISTRATIVE DISTRICT
SUDBURY
MINING DIVISION
SUDBURY
LAND TITLES/REGISTRY DIVISION
SUDBURY

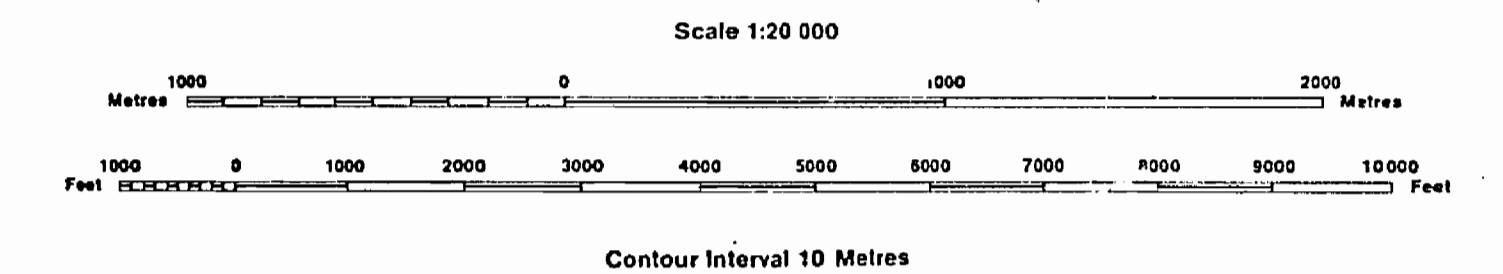

AREAS WITHDRAWN FROM DISPOSITION

Description	Order No.	Date	Disposition	File
3FC/35/80	0-3-22/86	09/05/86	M & S	136150
45C-36/80	4-1/88	4/05/88	M & S	
(P) PARK RESERVE W/10/83 12/10/83 M & S 188559 (R) STURGEON RIVER PROVINCIAL PARK ONTARIO REGULATION NO.256/89 SCHEDULE NO.230 SCHEDULE NO.230 Part of order W 1162 REOPENED by order O.M. O/90 NER effective April 3/1990 at 7:00 AM E.A.T.				

SYMBOLS

- Boundary
- Township, Meridian, Baseline
- Road allowance; surveyed
- shoreline
- Lot/Concession; surveyed
- unsurveyed
- Parcel; surveyed
- unsurveyed
- Right-of-way; road
- railway
- utility
- Reservation
- Cliff, Pit, Pile
- Contour
- Interpolated
- Approximate
- Depression
- Control point (horizontal)
- Flooded land
- Mine head frame
- Pipeline (above ground)
- Railway; single track
- double track
- abandoned
- Road; highway, county, township
- access
- trail, bush
- Shoreline (original)
- Transmission line
- Wooded area

DISPOSITION OF CROWN LANDS

- Patent
- Surface & Mining Rights
- Surface Rights Only
- Mining Rights Only
- Lease
- Surface & Mining Rights
- Surface Rights Only
- Mining Rights Only
- Licence of Occupation
- Order-in-Council
- Cancelled
- Reservation
- Sand & Gravel

THE INFORMATION THAT APPEARS ON THIS MAP HAS BEEN COMPILLED FROM VARIOUS SOURCES, AND ACCURACY IS NOT GUARANTEED. THOSE WISHING TO STAKE MINING CLAIMS SHOULD CONSULT WITH THE MINING RECORDER, MINISTRY OF NORTHERN DEVELOPMENT AND MINES, FOR ADDITIONAL INFORMATION ON THE STATUS OF THE LANDS SHOWN HEREON.

F-4 x 3 1988
SUDBURY
MINING RECORDER'S OFFICE

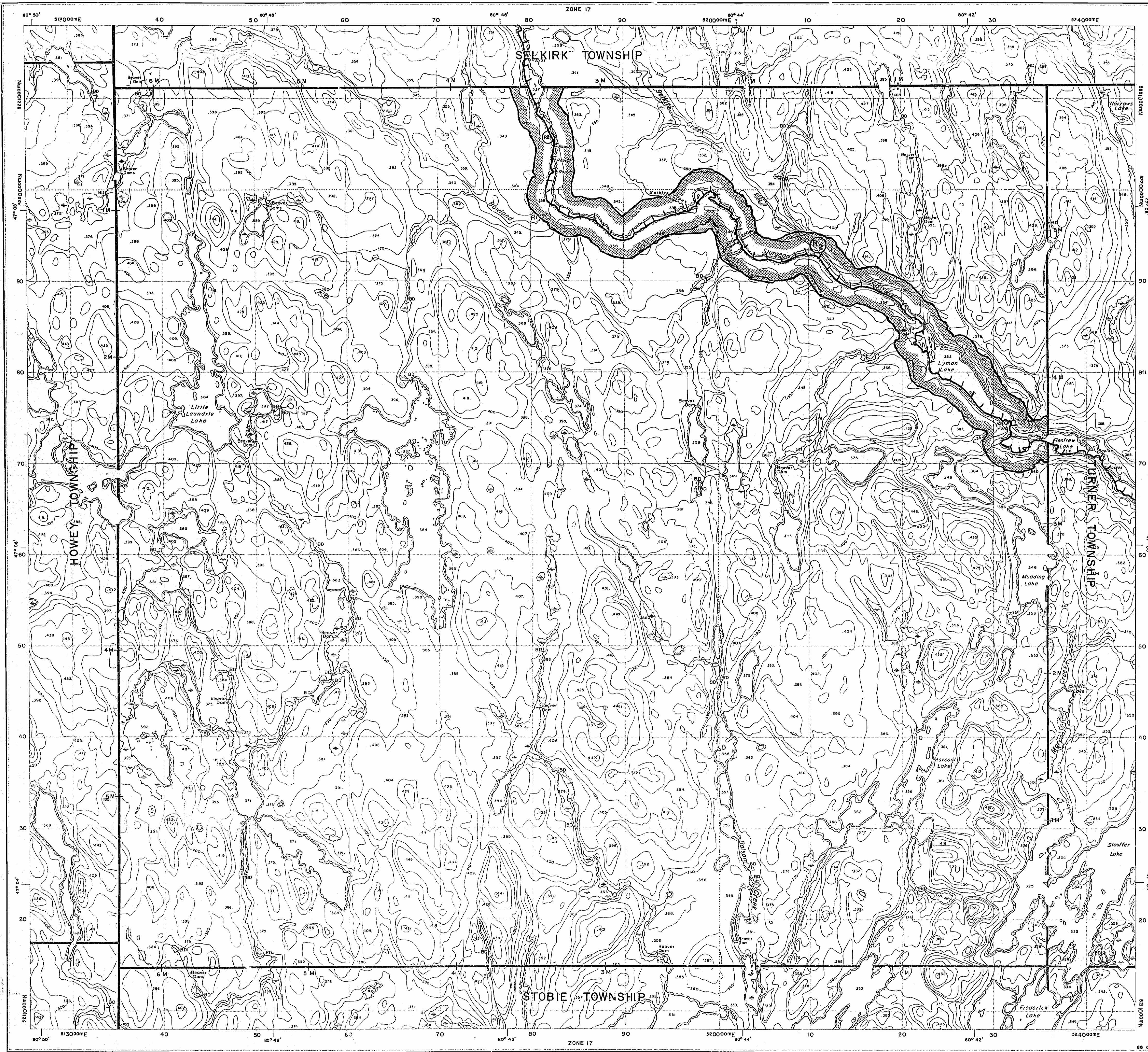

MARCONI

DISTRICT OF SUDBURY

Scale: - 40 Chains = 1 Inch.

200 Res. TR

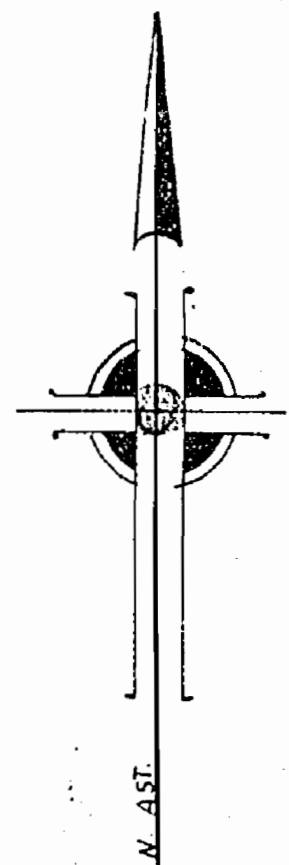

SELKIRK

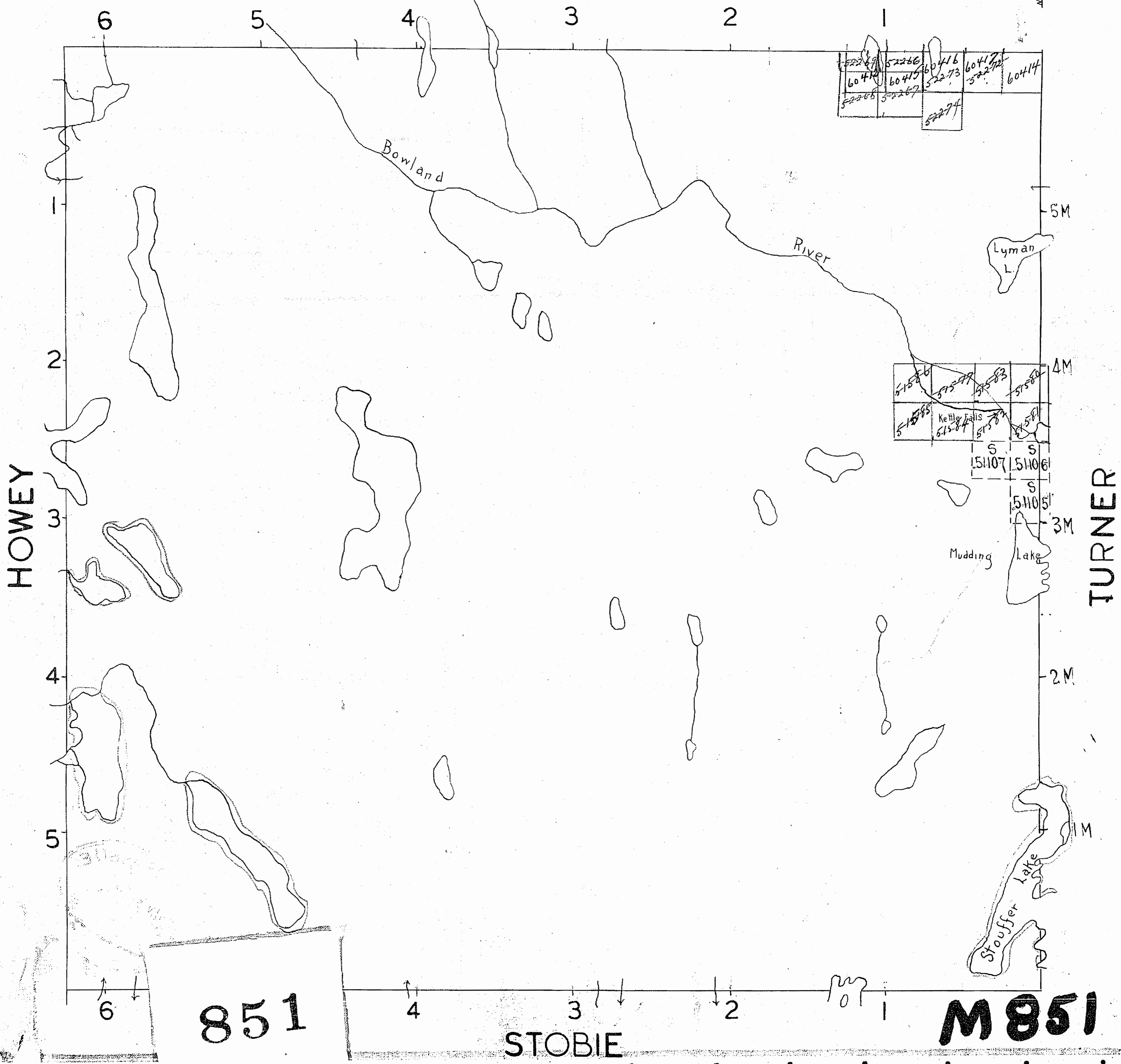

851

MARCONI

DISTRICT OF SUDBURY

Scale: - 40 Chains = 1 Inch

200 Res. ✓

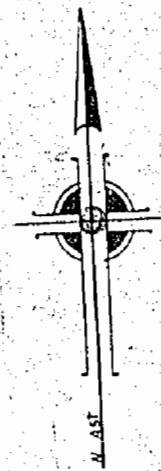

SELKIRK

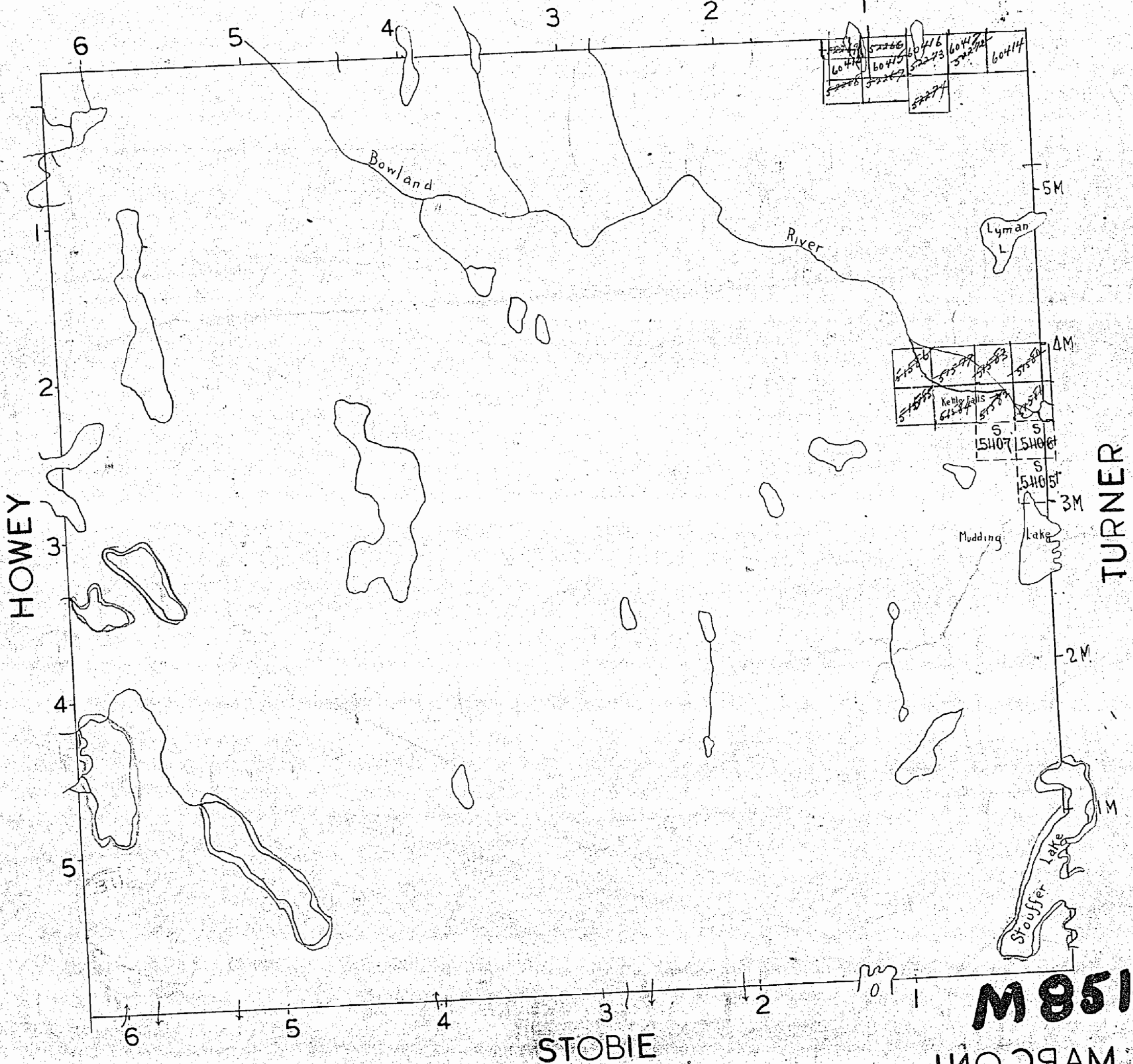

MARCONI

M 851

MARCONI

851

MARCONI

DISTRICT OF SUDBURY

Scale :- 40 Chains = 1 Inch

TEM. Res.
400' Res.
JLL

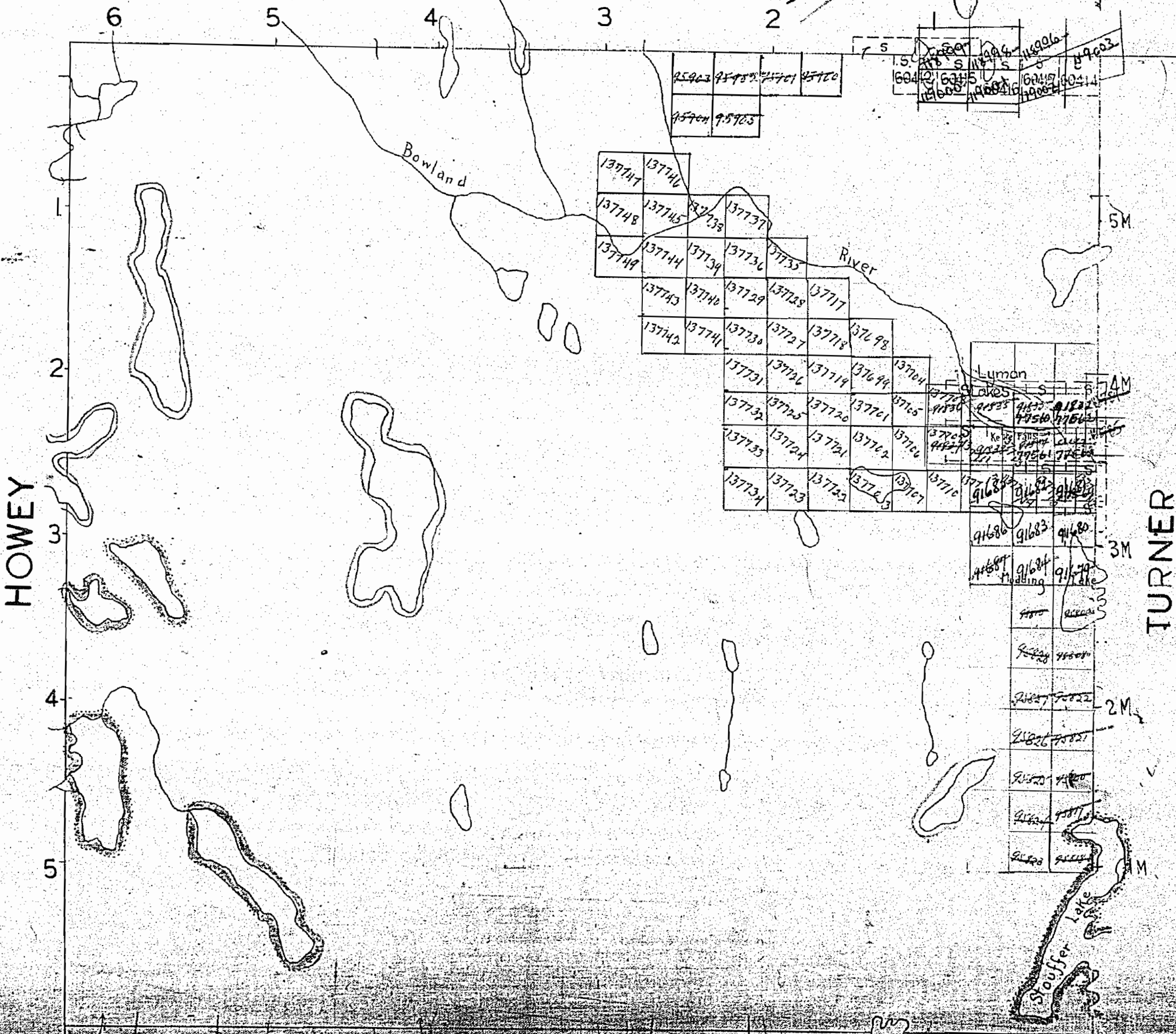

HOWEY

TURNER

STOBIE

M 851

MARCONI

MARCONI

200 yard reservations on surface by Dept. of L.S.C. shown hereafter

851

MARCONI

DISTRICT OF SUDBURY

Scale: - 40 Chains = 1 Inch.



NOTE

400' Surface Rights Reservation
around all Lakes and Rivers.

SELKIRK

Handwritten signature

July 30/68

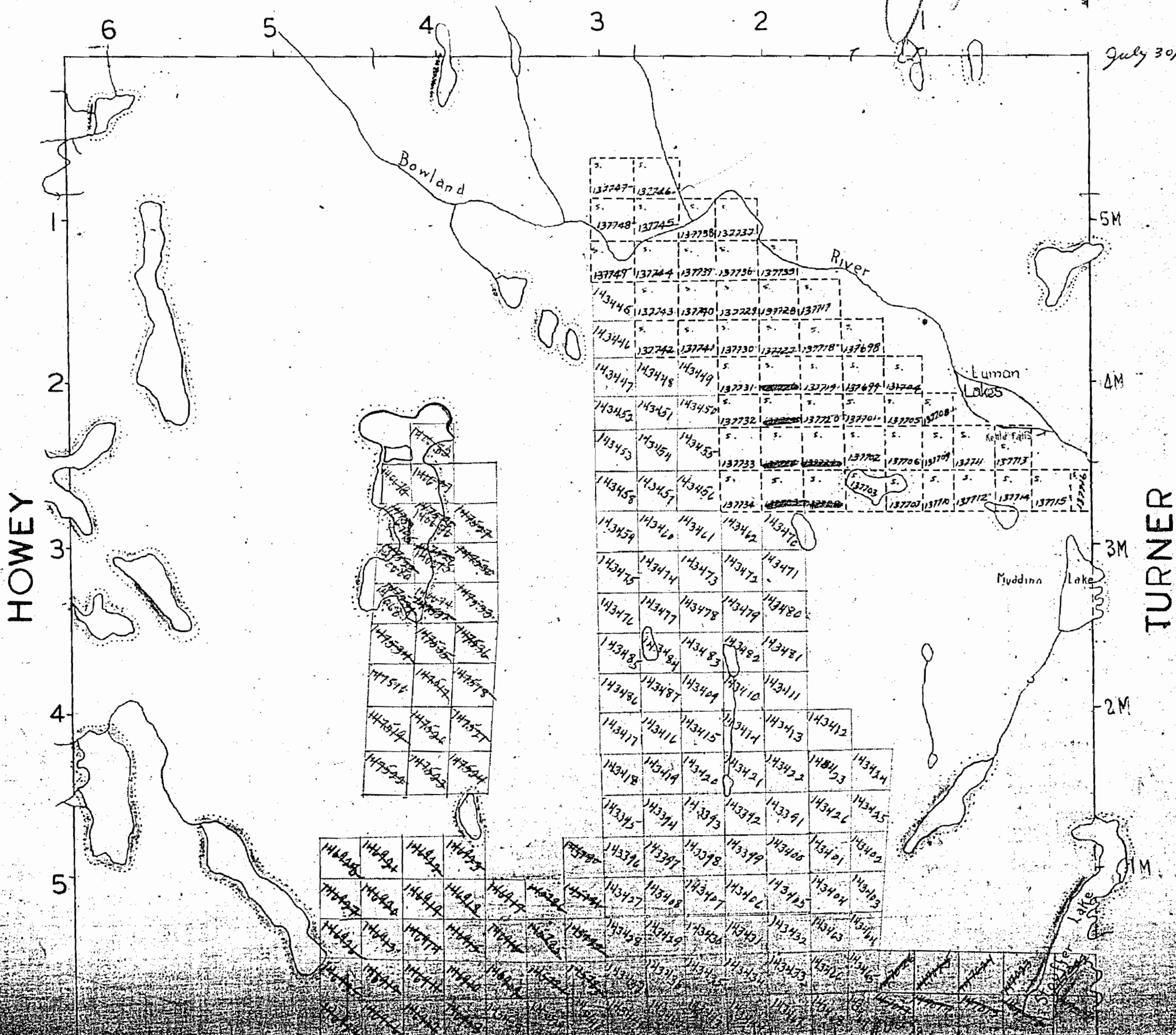

HOWEY

TURNER

M851

851

MARCONI

DISTRICT OF SUDBURY

Scale - 40 Chains = 1 Inch

OLD

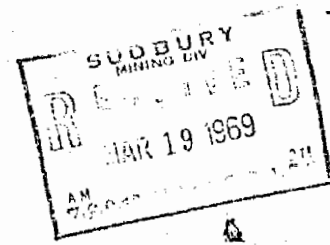

DTE

20' Surface Rights Reservation
around all Lakes and Rivers.

SELKIRK

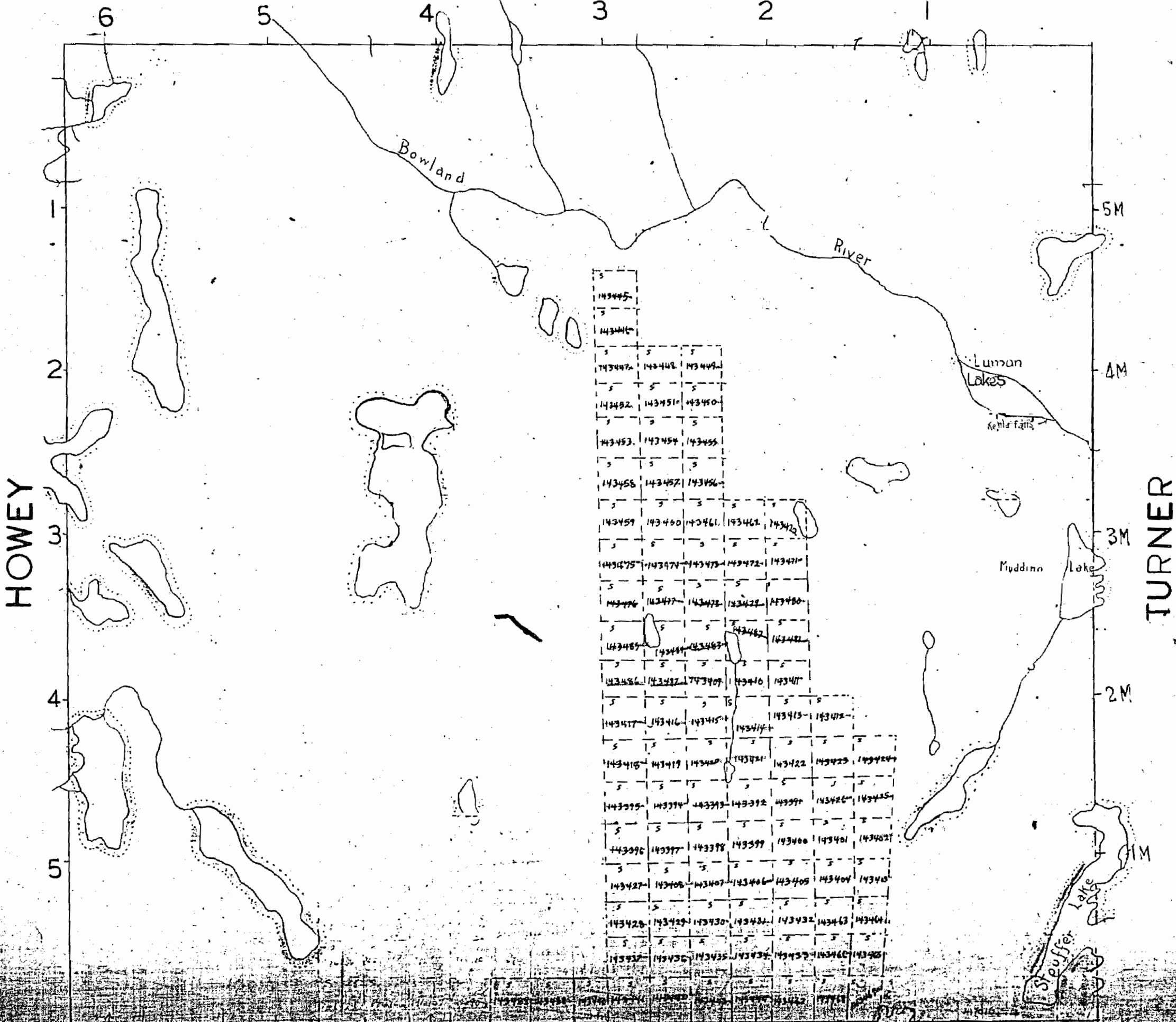

M 851

OFFICE USE ONLY

MARCONI

DISTRICT OF SUDBURY

Township Closed to Staking
Effective Nov. 5, 1982,
Section 36(1) (a) The Mining
Act.

Scale: - 40 Chains = 1 Inch

TOWNSHIP CLOSED TO STAKING
EFFECTIVE MAY 8, 1978
SECTION 38(f) THE MINING ACT



SELKIRK

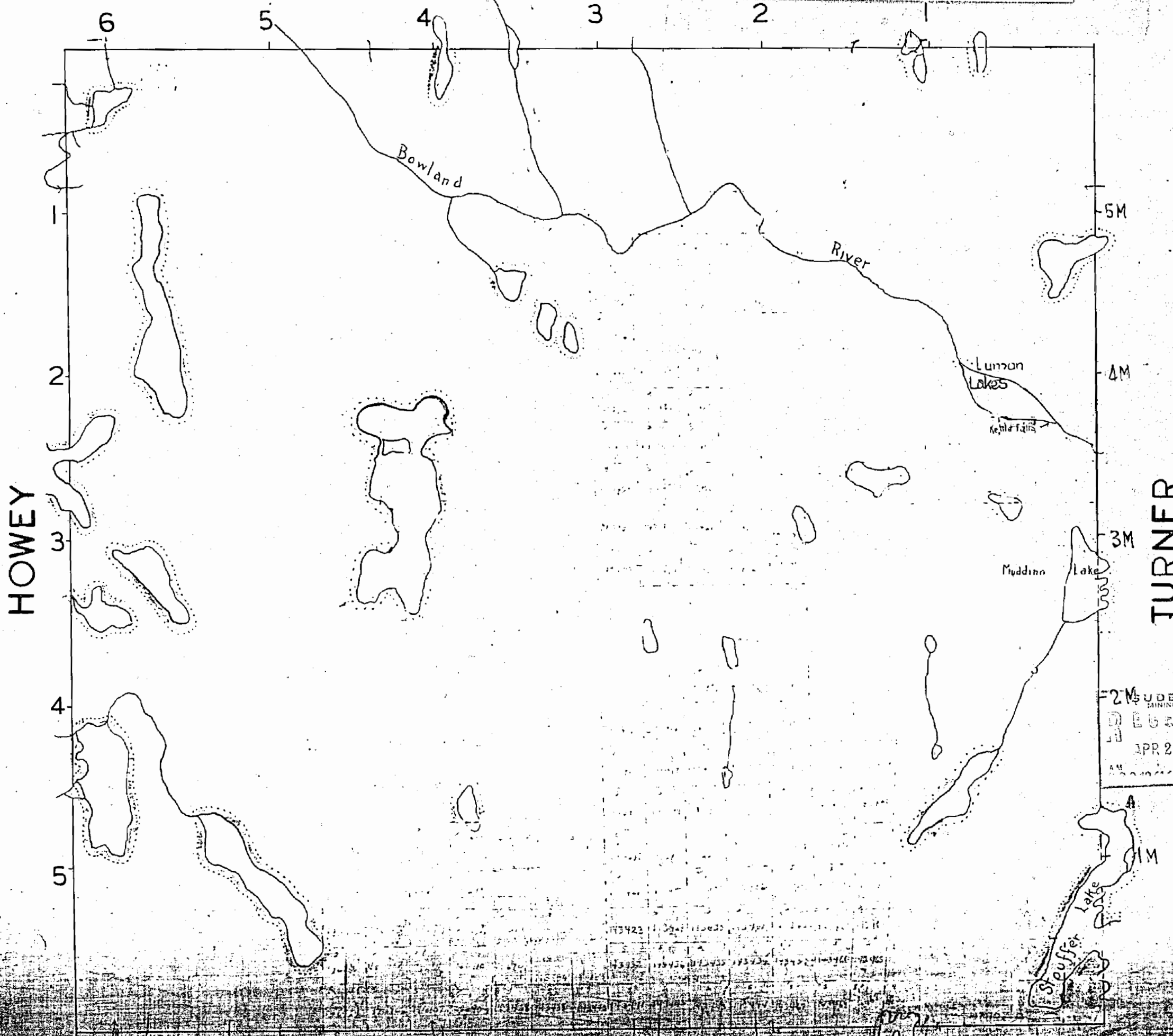

HOWEY

TURNER

SUDBURY
MINING DIV
DEPUTY
APR 28 1969

STOBIE

MARCONI

MARCONI

DISTRICT OF SUDBURY

Scale: - 40 Chains = 1 Inch.

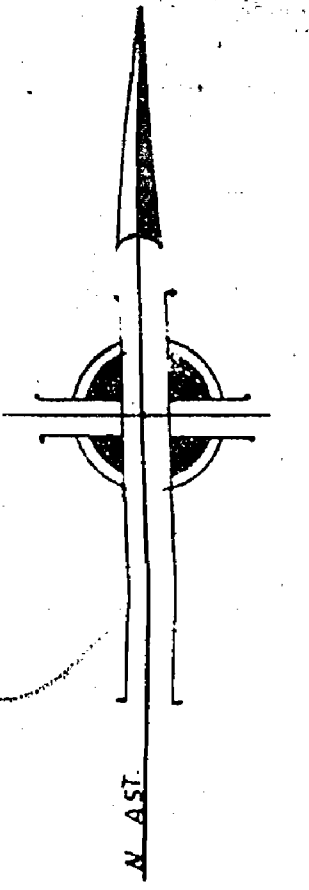

NOTE
400' Surface Rights Reservation
around all Lakes and Rivers.

SELKIRK

July 30/68

